





**KANSAS DEPARTMENT OF AGRICULTURE  
Division of Water Resources**

**M E M O R A N D U M**

**TO:** Files

**DATE:**

August 4, 2016

**FROM:** Alex Whitesell

**RE:** Appropriation of Water, File No. 49,569

John Paul Grother filed the above referenced file on May 2, 2016. The original application was returned to the applicant on March 14, 2016. The applicant was given the final deadline of July 5, 2016 to submit the information or request an extension of time. The applicant was reminded of the deadline on May 5, 2016. No correspondence was received from the applicant by the July 5, 2016 deadline. Therefore, the file should be dismissed.

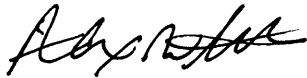

Alex Whitesell  
Environmental Scientist  
Division of Water Resources



1320 Research Park Drive  
Manhattan, Kansas 66502  
(785) 564-6700

900 SW Jackson, Room 456  
Topeka, Kansas 66612  
(785) 296-3556

Jackie McClaskey, Secretary

Governor Sam Brownback

JOHN PAUL GROTHER  
11804 S HYDRAULIC ST  
PECK KS 67120

**FILE COPY**

RE: Dismissal of Application  
File No. 49,570

Dear Mr. Grother;

The referenced application was returned to you for additional information on March 14, 2016. Enclosed is a Findings and Order by the Chief Engineer, Division of Water Resources, Kansas Department of Agriculture, dismissing Application, File No. 49,570, for failure to return the original application and provide the required information, prior to the final deadline of July 5, 2016.

This is a final agency action. If you choose to appeal this decision or any finding or part thereof, you must do so by filing a petition for review in the manner set forth in the enclosed order.

If you have any questions, please contact our office. If you wish to discuss a specific file, please have the file number ready so that we may help you more efficiently.

Sincerely,

Brent A. Turney, P.G.  
Change Application Unit Supervisor  
Water Appropriation Program

BAT:AJW

Enclosures

pc: Stafford Field Office  
Marvin R & Alma J Kling

THE STATE OF KANSAS



**KANSAS DEPARTMENT OF AGRICULTURE**  
Jackie McClaskey, Secretary of Agriculture

**DIVISION OF WATER RESOURCES**  
David W. Barfield, Chief Engineer

**FINDINGS AND ORDER  
IN THE MATTER OF THE  
DISMISSAL OF APPLICATION  
FILE NO. 49,570**

After due consideration, the Chief Engineer, Division of Water Resources, Kansas Department of Agriculture (hereinafter referred to as the "Chief Engineer"), makes the following findings and order:

**FINDINGS**

1. That on May 02, 2016, the Chief Engineer received an application from John Paul Grother for permit to appropriate water for beneficial use, assigned File No. 49,569, proposing the appropriation of 85.8 acre-feet of groundwater, for irrigation use, at a maximum requested diversion rate of 1200 gallons per minute, from a point of diversion located in the Northeast Quarter (NE¼) of Section 16, Township 30 South, Range 1 East, Sumner County, Kansas.
2. That in accordance with K.A.R. 5-3-1, the application was accepted for filing provided that the applicant submit a more specific location of the point of diversion within 60 days of receipt of the new application.
3. That in accordance with K.S.A. 82a-710 and K.A.R. 5-3-1b, the application was returned to the applicant on March 14, 2016, with a letter requesting additional information, including the specific location for the proposed point of diversion, in order to complete the application.
4. That on May 5, 2016, the applicant was provided a final deadline of July 5, 2016, in which to return the application with the required information and notified that the application would be dismissed if it was not returned within the time allowed or within any authorized extension of time thereof.
5. That the applicant was reminded of the deadline by letter dated June 9, 2016.
6. That no further correspondence was received from the applicant by the deadline of July 5, 2016.
7. That as required by K.S.A. 82a-710, the application, described in Paragraph No. 1, shall be denied and dismissed for failure to return the application with the requested information.

**ORDER**

NOW, THEREFORE, It is the decision and order of the Chief Engineer, Division of Water Resources, Kansas Department of Agriculture, that effective the date of this order, in accordance with the law, Application, File No. 49,570, is herewith dismissed and the priority assigned to it is considered to be forfeited.

This is a final agency action. If you choose to appeal this decision or any finding or part thereof, you must do so by filing a petition for review in the manner prescribed by the Kansas Act for Judicial Review and Civil Enforcement of Agency Actions (KJRA K.S.A. 77-601 et seq.) within 30 days of service of this order. Your appeal must be made with the appropriate district court for the district of Kansas.



THE STATE OF KANSAS



KANSAS DEPARTMENT OF AGRICULTURE  
Jackie McClaskey, Secretary of Agriculture

DIVISION OF WATER RESOURCES  
David W. Barfield, Chief Engineer

File Number 49,570  
This item to be completed by the Division of Water Resources.

WATER RESOURCES  
RECEIVED

**APPLICATION FOR PERMIT TO  
APPROPRIATE WATER FOR BENEFICIAL USE**  
Filing Fee Must Accompany the Application  
(Please refer to Fee Schedule attached to this application form.)

MAR 02 2016  
3 25  
KS DEPT OF AGRICULTURE

To the Chief Engineer of the Division of Water Resources, Kansas Department of Agriculture,  
1320 Research Park Drive, Manhattan, KS 66502:

1. Name of Applicant (Please Print): JOHN PAUL GROTHER  
Address: 11804 S HYDRAULIC ST  
City: PECK State: KS Zip Code 67120-9702  
Telephone Number: (316) 570-3343

2. The source of water is:  surface water in \_\_\_\_\_ (stream)  
OR  groundwater in NINNESCAH RIVER (drainage basin)

Certain streams in Kansas have minimum target flows established by law or may be subject to administration when water is released from storage for use by water assurance district members. If your application is subject to these regulations on the date we receive your application, you will be sent the appropriate form to complete and return to the Division of Water Resources.

3. The maximum quantity of water desired is 85.8 acre-feet OR \_\_\_\_\_ gallons per calendar year, to be diverted at a maximum rate of 1200 gallons per minute OR \_\_\_\_\_ cubic feet per second.

Once your application has been assigned a priority, the requested maximum rate of diversion and maximum requested quantity of water under that priority number can **NOT** be increased. Please be certain your requested maximum rate of diversion and maximum quantity of water are appropriate and reasonable for your proposed project and are in agreement with the Division of Water Resources' requirements.

4. The water is intended to be appropriated for (Check use intended):  
(a)  Artificial Recharge (b)  Irrigation (c)  Recreational (d)  Water Power  
(e)  Industrial (f)  Municipal (g)  Stockwatering (h)  Sediment Control  
(i)  Domestic (j)  Dewatering (k)  Hydraulic Dredging (l)  Fire Protection  
(m)  Thermal Exchange (n)  Contamination Remediation

YOU **MUST** COMPLETE AND ATTACH ADDITIONAL DIVISION OF WATER RESOURCES FORM(S) PROVIDING INFORMATION TO SUBSTANTIATE YOUR REQUEST FOR THE AMOUNT OF WATER FOR THE INTENDED USE REFERENCED ABOVE.

For Office Use Only:  
F.O. 2 GMD 5 Meets K.A.R. 5-3-1 (YES / NO) Use IR2 Source GS County SU By AW Date 3/2/16  
Code \_\_\_\_\_ REG Fee \$ 200 TR # 11031580 Receipt Date 3/2/16 Check # 7410

SCANNED

3/7/2016 LUM

5. The location of the proposed wells, pump sites or other works for diversion of water is:

**Note:** For the application to be accepted, the point of diversion location must be described to at least a 10 acre tract, unless you specifically request a 60 day period of time in which to locate the site within a specifically described, minimal legal quarter section of land.

(A) One in the \_\_\_\_\_ quarter of the ~~SE~~ quarter of the **NE** quarter of Section 16, more particularly described as being near a point \_\_\_\_\_ feet North and \_\_\_\_\_ feet West of the Southeast corner of said section, in Township 30 South, Range 1 EAST, SUMNER County, Kansas.

**\*REQUEST 60 DAYS TO LOCATE**

(B) One in the \_\_\_\_\_ quarter of the \_\_\_\_\_ quarter of the \_\_\_\_\_ quarter of Section \_\_\_\_\_, more particularly described as being near a point \_\_\_\_\_ feet North and \_\_\_\_\_ feet West of the Southeast corner of said section, in Township \_\_\_\_\_ South, Range \_\_\_\_\_ East/West (circle one), \_\_\_\_\_ County, Kansas.

(C) One in the \_\_\_\_\_ quarter of the \_\_\_\_\_ quarter of the \_\_\_\_\_ quarter of Section \_\_\_\_\_, more particularly described as being near a point \_\_\_\_\_ feet North and \_\_\_\_\_ feet West of the Southeast corner of said section, in Township \_\_\_\_\_ South, Range \_\_\_\_\_ East/West (circle one), \_\_\_\_\_ County, Kansas.

(D) One in the \_\_\_\_\_ quarter of the \_\_\_\_\_ quarter of the \_\_\_\_\_ quarter of Section \_\_\_\_\_, more particularly described as being near a point \_\_\_\_\_ feet North and \_\_\_\_\_ feet West of the Southeast corner of said section, in Township \_\_\_\_\_ South, Range \_\_\_\_\_ East/West (circle one), \_\_\_\_\_ County, Kansas.

If the source of supply is groundwater, a separate application shall be filed for each proposed well or battery of wells, except that a single application may include up to four wells within a circle with a quarter (1/4) mile radius in the same local source of supply which do not exceed a maximum diversion rate of 20 gallons per minute per well.

A battery of wells is defined as two or more wells connected to a common pump by a manifold; or not more than four wells in the same local source of supply within a 300 foot radius circle which are being operated by pumps not to exceed a total maximum diversion rate of 800 gallons per minute and which supply water to a common distribution system.

6. The owner of the point of diversion, if other than the applicant is (please print):

Applicant MARVIN R & ALMA KING 1259 N HYDROLIC RD, MULVANE KS 67110  
(name, address and telephone number)

\_\_\_\_\_  
(name, address and telephone number)

You must provide evidence of legal access to, or control of, the point of diversion from the landowner or the landowner's authorized representative. Provide a copy of a recorded deed, lease, easement or other document with this application. In lieu thereof, you may sign the following sworn statement:

I have legal access to, or control of, the point of diversion described in this application from the landowner or the landowner's authorized representative. I declare under penalty of perjury that the foregoing is true and correct.

Executed on March 2, 2016.  
Manhattan, KS

John P. Guther  
Applicant's Signature

7. The proposed project for diversion of water will consist of ONE well or a battery of 4 wells  
(number of wells, pumps or dams, etc.)

and (was)(will be) completed (by) SUMMER 2016  
(Month/Day/Year - each was or will be completed)

8. The first actual application of water for the proposed beneficial use was or is estimated to be SUMMER 2016.  
(Mo/Day/Year)



13. Furnish the following well information if the proposed appropriation is for the use of groundwater. If the well has not been completed, give information obtained from test holes, if available.

Information below is from:  Test holes  Well as completed  Drillers log attached

| Well location as shown in paragraph No. | (A)   | (B)   | (C)   | (D)   |
|---|-------|-------|-------|-------|
| Date Drilled                            | _____ | _____ | _____ | _____ |
| Total depth of well                     | _____ | _____ | _____ | _____ |
| Depth to water bearing formation        | _____ | _____ | _____ | _____ |
| Depth to static water level             | _____ | _____ | _____ | _____ |
| Depth to bottom of pump intake pipe     | _____ | _____ | _____ | _____ |

14. The relationship of the applicant to the proposed place where the water will be used is that of Tenant  
(owner, tenant, agent or otherwise)

15. The owner(s) of the property where the water is used, if other than the applicant, is (please print):

\_\_\_\_\_  
(name, address and telephone number)

\_\_\_\_\_  
(name, address and telephone number)

16. The undersigned states that the information set forth above is true to the best of his/her knowledge and that this application is submitted in good faith.

Dated at Manhattan, Kansas, this 2 day of MARCH, 2016  
(month) (year)

John P. Guther  
(Applicant Signature)

50  
APPLICANT(S) SOCIAL SECURITY IDENTIFICATION NUMBER(S)

By \_\_\_\_\_  
(Agent or Officer Signature)

and/or  
APPLICANT(S) TAXPAYER I.D. NO.(S)

\_\_\_\_\_  
(Agent or Officer - Please Print)

Assisted by LI/DWR HQ (office/title) Date: 2/2/2016

SCANNED

9. Will pesticide, fertilizer, or other foreign substance be injected into the water pumped from the diversion works?

Yes  No If "yes", a check valve shall be required.

All chemigation safety requirements must be met including a chemigation permit and reporting requirements.

10. If you are planning to impound water, please contact the Division of Water Resources for assistance, prior to submitting the application. Please attach a reservoir area capacity table and inform us of the total acres of surface drainage area above the reservoir.

Have you also made an application for a permit for construction of this dam and reservoir with the Division of Water Resources?  Yes  No

• If yes, show the Water Structures permit number here \_\_\_\_\_

• If no, explain here why a Water Structures permit is not required \_\_\_\_\_

11. The application must be supplemented by a U.S.G.S. topographic map, aerial photograph or a detailed plat showing the following information. On the topographic map, aerial photograph, or plat, identify the center of the section, the section lines or the section corners and show the appropriate section, township and range numbers. Also, please show the following information:

(a) The location of the proposed point(s) of diversion (wells, stream-bank installations, dams, or other diversion works) should be plotted as described in Paragraph No. 5 of the application, showing the North-South distance and the East-West distance from a section line or southeast corner of section.

(b) If the application is for groundwater, please show the location of any existing water wells of any kind within 1/2 mile of the proposed well or wells. Identify each existing well as to its use and furnish the name and mailing address of the property owner or owners. If there are no wells within 1/2 mile, please advise us.

(c) If the application is for surface water, the names and addresses of the landowner(s) 1/2 mile downstream and 1/2 mile upstream from your property lines must be shown.

(d) The location of the proposed place of use should be shown by crosshatching on the topographic map, aerial photograph or plat.

(e) Show the location of the pipelines, canals, reservoirs or other facilities for conveying water from the point of diversion to the place of use.

A 7.5 minute U.S.G.S. topographic map may be obtained by providing the section, township and range numbers to: Kansas Geological Survey, 1930 Constant, Campus West, University of Kansas, Lawrence, Kansas 66047.

12. List any application, appropriation of water, water right, or vested right file number that covers the same diversion points or any of the same place of use described in this application. Also list any other recent modifications made to existing permits or water rights in conjunction with the filing of this application.

NONE \_\_\_\_\_

\_\_\_\_\_

\_\_\_\_\_

WATER RESOURCES  
RECEIVED

MAR 02 2016

**IRRIGATION USE  
SUPPLEMENTAL SHEET**

File No. 49,570

Name of Applicant (Please Print): JOHN PAUL GROTHER

1. Please supply the name and address of each landowner, the legal description of the lands to be irrigated, and designate the actual number of acres to be irrigated in each forty acre tract or fractional portion thereof:

**Landowner of Record** NAME: <sup>KING?</sup> ~~KLING~~ MARVIN R & ALMA J -  
 ADDRESS: 1253 N HYDRAULIC RD MULVANE, KS 67110

| S  | T  | R  | NE¼ |    |    |    | NW¼ |    |    |    | SW¼ |    |    |    | SE¼ |    |    |    | TOTAL |
|----|----|----|-----|----|----|----|-----|----|----|----|-----|----|----|----|-----|----|----|----|-------|
|    |    |    | NE  | NW | SW | SE | NE  | NW | SW | SE | NE  | NW | SW | SE | NE  | NW | SW | SE |       |
| 16 | 30 | 1E |     |    | 40 | 26 |     |    |    |    |     |    |    |    |     |    |    |    | 66    |
|    |    |    |     |    |    |    |     |    |    |    |     |    |    |    |     |    |    |    |       |
|    |    |    |     |    |    |    |     |    |    |    |     |    |    |    |     |    |    |    |       |

**Landowner of Record** NAME: \_\_\_\_\_  
 ADDRESS: \_\_\_\_\_

| S | T | R | NE¼ |    |    |    | NW¼ |    |    |    | SW¼ |    |    |    | SE¼ |    |    |    | TOTAL |
|---|---|---|-----|----|----|----|-----|----|----|----|-----|----|----|----|-----|----|----|----|-------|
|   |   |   | NE  | NW | SW | SE | NE  | NW | SW | SE | NE  | NW | SW | SE | NE  | NW | SW | SE |       |
|   |   |   |     |    |    |    |     |    |    |    |     |    |    |    |     |    |    |    |       |
|   |   |   |     |    |    |    |     |    |    |    |     |    |    |    |     |    |    |    |       |

**Landowner of Record** NAME: \_\_\_\_\_  
 ADDRESS: \_\_\_\_\_

| S | T | R | NE¼ |    |    |    | NW¼ |    |    |    | SW¼ |    |    |    | SE¼ |    |    |    | TOTAL |
|---|---|---|-----|----|----|----|-----|----|----|----|-----|----|----|----|-----|----|----|----|-------|
|   |   |   | NE  | NW | SW | SE | NE  | NW | SW | SE | NE  | NW | SW | SE | NE  | NW | SW | SE |       |
|   |   |   |     |    |    |    |     |    |    |    |     |    |    |    |     |    |    |    |       |
|   |   |   |     |    |    |    |     |    |    |    |     |    |    |    |     |    |    |    |       |

WATER RESOURCES  
RECEIVED

2. Please complete the following information for the description of the operation for the irrigation project. Attach supplemental sheets as needed.

a. Indicate the soils in the field(s) and their intake rates:

| Soil Name | Percent of field (%) | Intake Rate (in/hr) | Irrigation Design Group |
|-----------|----------------------|---------------------|-------------------------|
| _____     | _____                | _____               | _____                   |
| _____     | _____                | _____               | _____                   |
| _____     | _____                | _____               | _____                   |
| _____     | _____                | _____               | _____                   |
| Total:    | 100 %                |                     |                         |

b. Estimate the average land slope in the field(s): \_\_\_\_\_ %

Estimate the maximum land slope in the field(s): \_\_\_\_\_ %

c. Type of irrigation system you propose to use (check one):

- Center pivot                       Center pivot - LEPA                       "Big gun" sprinkler  
 Gravity system (furrows)                       Gravity system (borders)                       Sideroll sprinkler

Other, please describe: \_\_\_\_\_

d. System design features:

i. Describe how you will control tailwater:

ii. For sprinkler systems:

(1) Estimate the operating pressure at the distribution system: \_\_\_\_\_ psi

(2) What is the sprinkler package design rate? \_\_\_\_\_ gpm

(3) What is the wetted diameter (twice the distance the sprinkler throws water) of a sprinkler on the outer 100 feet of the system? \_\_\_\_\_ feet

(4) Please include a copy of the sprinkler package design information.

e. Crop(s) you intend to irrigate. Please note any planned crop rotations:

f. Please describe how you will determine when to irrigate and how much water to apply (particularly important if you do not plan a full irrigation).

You may attach any additional information you believe will assist in informing the Division of the need for your request.

# Proposed Appropriation of Water for Irrigation Use

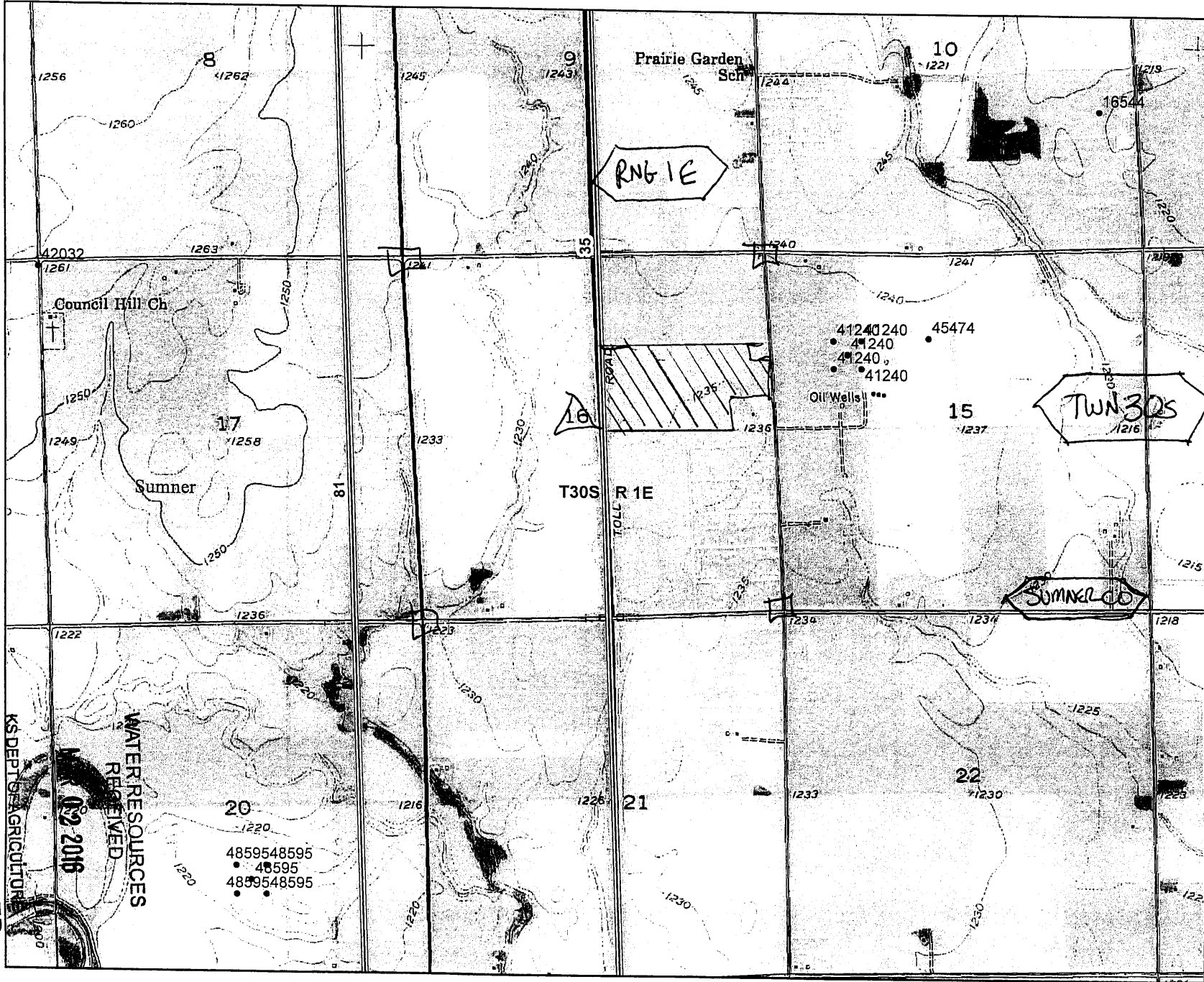

## Legend

WIMAS\_PD

S\_UMW

- G\_IRR
- ▲ G\_MUN
- ⚡ G\_THX

||||| Proposed Irrigated Area

## Index Map

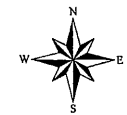
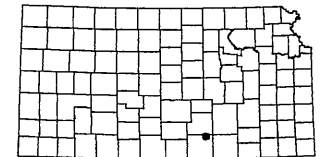

44,570

SCANNED

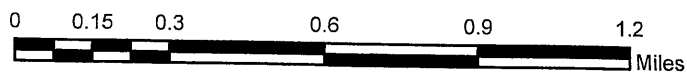

This map was created by L. Ireland in WRIS on 3/2/2016

\_\_\_\_\_  
(Date)

Kansas Department of Agriculture  
Division of Water Resources  
David W. Barfield, Chief Engineer  
1320 Research Park Drive  
Manhattan, Kansas 66502

Re: Application File No. 49,570

Minimum Desirable Streamflow

Dear Sir:

I understand that a Minimum Desirable Streamflow requirement has been established by the legislature for the source of supply to which the above referenced application applies.

I understand that diversion of water pursuant to this application will be subject to regulation any time Minimum Desirable Streamflow requirements are not being met.

I also understand that if this application is approved, there could be times, as determined by the Division of Water Resources, when I would not be allowed to divert water. I realize that this could affect the economics of my decision to appropriate water.

I am aware of the above factors, and with the knowledge thereof, request that the Division of Water Resources proceed with processing and approval, if possible, of the above referenced application.

John P. Grothar  
Signature of Applicant

JOHN P. GROTHAR  
(Print Applicant's Name)

State of Kansas )  
County of Riley ) ss

I hereby certify that the foregoing instrument was signed in my presence and sworn to before me this 2<sup>nd</sup> day of March, 2016.

Amber L. Herring  
Notary Public

My Commission Expires:

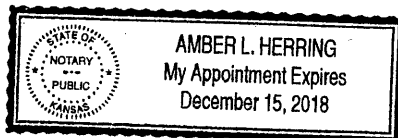

SCANNED

WATER RESOURCES RECEIVED

MAR 02 2016

**MINIMUM DESIRABLE STREAMFLOW FORM TO BE USED WHEN  
APPLICABLE WHEN FILING AN APPLICATION FOR PERMIT  
TO APPROPRIATE WATER FOR BENEFICIAL USE**

The Kansas Legislature has established minimum desirable streamflows for the streams listed below. If your proposed diversion of water is going to be from one of these watercourses or adjacent alluvial aquifers, please complete the back side of this page and submit it along with your application for permit to appropriate water.

Arkansas River

Big Blue River

Chapman Creek

Chikaskia River

Cottonwood River

Delaware River

Little Arkansas River

Little Blue River

Marais des Cygnes River

Medicine Lodge River

Mill Creek (Wabaunsee Co. area)

Neosho River

Ninnescah River

North Fork Ninnescah River

Rattlesnake Creek

Republican River

Saline River

Smoky Hill River

Solomon River

South Fork Ninnescah

Spring River

Walnut River

Whitewater River

1320 Research Park Drive  
Manhattan, Kansas 66502  
(785) 564-6700



900 SW Jackson, Room 456  
Topeka, Kansas 66612  
(785) 296-3556

Jackie McClaskey, Secretary

Governor Sam Brownback

June 9, 2016

JOHN PAUL GROTHER  
11804 S HYDRAULIC ST  
PECK KS 67120

Re: Pending Applications,  
File Nos. 49,569 and 49,570

Dear Mr. Grother:

The Division of Water Resources returned the above referenced applications to you for additional information on March 14, 2016, and the current deadline for your response is July 5, 2016. The purpose of this letter is to provide a reminder that in order for you to retain your priority of filing, the original applications and requested information needs to be returned to this office on or before **July 5, 2016**, or within any authorized extension of time thereof. According to law, default in refiling of the completed applications and attachments within the time allowed shall constitute forfeiture of priority date and dismissal of the applications.

If an extension of time is necessary to supply the requested information, please request the extension of time in writing before **July 5, 2016**. Provide information as to why the additional time is needed and how much additional time is requested. Please note that since there are instances when the Chief Engineer may deny your request for an extension of time, there is no guarantee that future requests for more time will be granted.

If you have any questions, please contact me at (785) 564-6631 or by email at alex.whitesell@kda.ks.gov. If you wish to discuss a specific file, please have the file number ready so that I may help you more efficiently.

Sincerely,

A handwritten signature in black ink, appearing to read "Alex Whitesell".

Alex Whitesell  
Environmental Scientist  
Water Appropriation Program

pc: Stafford Field Office





1320 Research Park Drive  
Manhattan, Kansas 66502  
(785) 564-6700

900 SW Jackson, Room 456  
Topeka, Kansas 66612  
(785) 296-3556

Jackie McClaskey, Secretary

Governor Sam Brownback

April 4, 2016

JOHN PAUL GROTHER  
1804 S HYDRAULIC ST  
PECK KS 67120

Re: Pending Applications,  
File Nos. 49,569 and 49,570

Dear Mr. Grother:

The Division of Water Resources returned the above referenced applications to you for additional information on March 14, 2016, and the current deadline for your response is May 2, 2016. The purpose of this letter is to provide a reminder that in order for you to retain your priority of filing, the original applications and requested information needs to be returned to this office on or before **May 2, 2016**, or within any authorized extension of time thereof. According to law, default in refiling of the completed applications and attachments within the time allowed shall constitute forfeiture of priority date and dismissal of the applications.

If an extension of time is necessary to supply the requested information, please request the extension of time in writing before **May 2, 2016**. Provide information as to why the additional time is needed and how much additional time is requested. Please note that since there are instances when the Chief Engineer may deny your request for an extension of time, there is no guarantee that future requests for more time will be granted.

If you have any questions, please contact me at (785) 564-6631 or by email at alex.whitesell@kda.ks.gov. If you wish to discuss a specific file, please have the file number ready so that I may help you more efficiently.

Sincerely,

Alex Whitesell  
Environmental Scientist  
Water Appropriation Program

pc: Stafford Field Office

1320 Research Park Drive  
Manhattan, Kansas 66502  
(785) 564-6700



900 SW Jackson, Room 456  
Topeka, Kansas 66612  
(785) 296-3556

Jackie McClaskey, Secretary

Governor Sam Brownback

March 14, 2016

JOHN PAUL GROTHER  
1804 S HYDRAULIC ST  
PECK KS 67120

Re: Pending Applications,  
File Nos. 49,569 and 49,570

Dear Mr. Grother:

After a preliminary review of your above referenced applications for permits to appropriate water received in this office on March 2, 2016, they are being returned to you for additional information. In your original applications, you requested a 60-day period of time in which to determine the precise locations for your points of diversion within specified quarter section tracts of land described as the Northeast Quarter (NE¼) of Section 16, in Township 30 South, Range 1 East, Sumner County, Kansas.

Once you've determined the precise locations for your points of diversion, complete the rest of Paragraph No. 5 for each of your applications by providing the description for the 10-acre tract location of the point of diversion as well as the feet distances North and West of the Southeast corner of the Section. The locations of the points of diversion must also be plotted on the topographical map(s) included. In the case of a battery of wells, please provide the description of the location of the proposed geographic center of the well battery, as well as **the location for each of the individual wells comprising the battery of wells**.

The locations of all other water wells of every kind within one-half mile (½) of the points of diversion must be plotted on the topographical map(s) as well. Each well should be identified as to its use (e.g. domestic, irrigation, industrial, etc.) and must **include the name and mailing address of the well owner**. A signed statement should be included on the map(s) declaring that all wells within one-half mile (½) of the points of diversion have been plotted, or it should declare that none exist. Please provide this information once you have established your points of diversion.

Paragraph No. 13 of the application requests well information so the source of supply of the proposed wells may be determined. Pursuant to K.A.R. 5-3-4d, this office requires a stratigraphic log of wells or test holes within 300 feet of the proposed points of diversion. Please supply the indicated information and test hole logs or driller's logs with the returned applications.

In order to retain their priority of filing, the original applications and attachments must be returned to this office with the requested information on or before **May 2, 2016**, or within any authorized extension of time thereof. According to law, default in refileing of the completed applications and attachments within the time allowed shall constitute forfeiture of priority date and dismissal of the applications.

(over)

SCANNED

John Paul Grother  
March 2, 2016  
Page 2 of 2

If you have any questions, please contact me at (785) 564-6631 or by email at alexander.whitesell@kda.ks.gov. If you wish to discuss a specific file, please have the file number ready so that I may help you more efficiently.

Sincerely,

A handwritten signature in black ink, appearing to read "Alex Whitesell". The signature is fluid and cursive, with the first name "Alex" being more prominent than the last name "Whitesell".

Alex Whitesell  
Environmental Scientist  
Water Appropriation Program

enclosures  
pc: Stafford Field Office



1320 Research Park Drive  
Manhattan, Kansas 66502

Jackie McClaskey, Secretary

Phone: (785) 564-6700  
Fax: (785) 564-6777  
Email: ksag@kda.ks.gov  
www.agriculture.ks.gov  
Sam Brownback, Governor

March 4, 2016

JOHN PAUL GROTHER  
11804 S HYDRAULIC ST  
PECK KS 67120

RE: Application  
File No. 49570

Dear Sir or Madam:

Your application for permit to appropriate water in 16-30S-1E in Sumner County, was received and has been assigned the file number noted above.

As a matter of record, the Division of Water Resources has on hand a large number of applications awaiting processing. Therefore to be fair to all concerned, and so that we can process those applications on hand in the order they were received, we intend to concentrate on the backlog of applications until the issue is resolved. Once review of your application has begun, we will contact you, if additional information is required.

In accordance with the provisions of the Kansas Water Appropriation Act, a portion of which is included below, the use of water as proposed prior to approval of the application is unlawful. Once approved, compliance with the terms, conditions and limitations of the permit is necessary. Conservation of the water resources of Kansas is required.

**Section 82a-728 of the Kansas Water Appropriation Act, provides (a) except for the appropriation of water for the purpose of domestic use, . . . it shall be unlawful for any person to appropriate or threaten to appropriate water from any source without first applying for and obtaining a permit to appropriate water in accordance with the provisions of the Water Appropriation Act or for any person to violate any condition of a vested right, appropriation right or an approved application for a permit to appropriate water for beneficial use.**

**(b) (1) The violation of any provision of this section by any person is a class C misdemeanor . . .**

**A class C misdemeanor is punishable by a fine not to exceed \$500 and/or a term of confinement not to exceed one month in the county jail. Each day that the violation occurs constitutes a separate offense.**

If you have any questions, please contact me at (785) 564-6634. If you wish to discuss a specific file, please have the file number ready so that we may help you more efficiently.

Sincerely,

Kenneth A. Kopp, P.G.  
New Application Unit Supervisor  
Water Appropriation Program

KAK: DLW  
pc: STAFFORDField Office  
GMD

SCANNED