

Submit To: CHIEF ENGINEER
Division of Water Resources
Kansas Department of Agriculture
1320 Research Park Drive
Manhattan, Kansas 66502
http://agriculture.ks.gov/dwr

**APPLICATION FOR APPROVAL TO
CHANGE THE PLACE OF USE, THE
POINT OF DIVERSION OR THE USE
MADE OF THE WATER UNDER AN
EXISTING WATER RIGHT**



State of Kansas

Filing Fee Must Accompany the Application
(Please refer to Fee Schedule on signature page of application form.)

Paragraph Nos. 1, 2, 3, 4 & 8 must be completed. Complete all other applicable portions. A topographic map or detailed plat showing the authorized and proposed points(s) of diversion and /or place of use must accompany this application.

WATER RESOURCES
RECEIVED

MAY 12 2017

10:44

KS DEPT OF AGRICULTURE

1. Application is hereby made for approval of the Chief Engineer to change the

- Place of Use
 Point of Diversion
 Use Made of Water

(Check one or more)

File No. 15907

2. Name of applicant: City of Cunningham

Address: PO Box 188

City, State and Zip: Cunningham, KS 67035

Phone Number: (620)298-3077

E-mail address: clerk@67035

What is your relationship to the water right; owner tenant agent other? If other, please explain. _____

Name of water use correspondent: City of Cunningham

Address: PO Box 188

City, State and Zip: Cunningham, KS 67035

Phone Number: (620) 298-3077

E-mail address: clerk@67035

3. The change(s) proposed herein are desired for the following reasons (please be specific): This change will make a battery of three (3) wells, created from the two (2) currently authorized wells and the addition of one (1) well. The creation of a battery and addition of a third well will ensure redundancy and will aid in blending efforts for the system. The currently authorized wells meet the definition of a battery and have been operated as such. There is no proposed increase to rate or quantity.
The change(s) will be completed by as soon as feasible after approval of change application.
(Date)

For Office Use Only:

F.O. 2 GMD 0 Meets K.A.R. 5-5-1 (YES / NO) Use MUN Source G S County KM By MW Date 5/12/17
Code CGT Fee \$ 200 TR # _____ Receipt Date 5/12/17 Check # 57946

4. The presently authorized place of use is:

Owner of Land — NAME: City of Cunningham

ADDRESS: PO Box 188, Cunningham KS 67035

Sec.	Twp.	Range	NE¼				NW¼				SW¼				SE¼				TOTAL ACRES
			NE¼	NW¼	SW¼	SE¼	NE¼	NW¼	SW¼	SE¼	NE¼	NW¼	SW¼	SE¼	NE¼	NW¼	SW¼	SE¼	
32	27S	10W	CITY OF CUNNINGHAM & VICINITY																

List any other water rights that cover this place of use. KM 004

Owner of Land — NAME: ---

ADDRESS: ---

Sec.	Twp.	Range	NE¼				NW¼				SW¼				SE¼				TOTAL ACRES
			NE¼	NW¼	SW¼	SE¼	NE¼	NW¼	SW¼	SE¼	NE¼	NW¼	SW¼	SE¼	NE¼	NW¼	SW¼	SE¼	

List any other water rights that cover this place of use. ---

(If there are more than two landowners, attach additional sheets as necessary.)

5. It is proposed that the place of use be changed to:

Owner of Land — NAME: No Change

ADDRESS: ---

Sec.	Twp.	Range	NE¼				NW¼				SW¼				SE¼				TOTAL ACRES
			NE¼	NW¼	SW¼	SE¼	NE¼	NW¼	SW¼	SE¼	NE¼	NW¼	SW¼	SE¼	NE¼	NW¼	SW¼	SE¼	

List any other water rights that cover this place of use. ---

Owner of Land — NAME: ---

ADDRESS: ---

Sec.	Twp.	Range	NE¼				NW¼				SW¼				SE¼				TOTAL ACRES
			NE¼	NW¼	SW¼	SE¼	NE¼	NW¼	SW¼	SE¼	NE¼	NW¼	SW¼	SE¼	NE¼	NW¼	SW¼	SE¼	

WATER RESOURCES RECEIVED

List any other water rights that cover this place of use. ---

MAY 12 2017

IF MORE SPACE IS NEEDED, ATTACH ADDITIONAL SHEETS AS NECESSARY

6. The presently authorized point(s) of diversion are two (2) wells with diversion works
(Provide description and number of points)
7. The proposed point(s) of diversion is a battery of three (3) wells with diversion works
(Provide description and number of points)

List all presently authorized point(s) of diversion:

8. **Presently authorized point of diversion:**
 One in the NW Quarter of the SW Quarter of the SE (Lot 8) Quarter of Section 32, Township 27 South, Range 10 W, in Kingman County, Kansas, 842 feet North 2607 feet West of Southeast corner of section.
 Authorized Rate 250 GPM (Limited) Authorized Quantity 47.747 MGY (Limited)
(DWR use only: Computer ID No. 1 GPS 834 feet North 2590 feet West)
 This point will not be changed This point will be changed as follows:
Proposed point of diversion: (Complete only if change is requested) West Well of Battery
 One in the _____ Quarter of the _____ Quarter of the _____ Quarter of Section _____, Township _____ South, Range _____ W, in _____ County, Kansas, _____ feet North _____ feet West of Southeast corner of section.
 Proposed Rate see geocenter Proposed Quantity see geocenter
 This point is: Additional Well Geo Center List other water rights that will use this point KM 004

9. **Presently authorized point of diversion:**
 One in the NW Quarter of the SW Quarter of the SE (Lot 8) Quarter of Section 32, Township 27 South, Range 10 W, in Kingman County, Kansas, 838 feet North 2497 feet West of Southeast corner of section.
 Authorized Rate 295 GPM (Limited) Authorized Quantity 47.747 MGY (Limited)
(DWR use only: Computer ID No. 2 GPS 845 feet North 2480 feet West)
 This point will not be changed This point will be changed as follows:
Proposed point of diversion: (Complete only if change is requested) East Well of Battery
 One in the _____ Quarter of the _____ Quarter of the _____ Quarter of Section _____, Township _____ South, Range _____ W, in _____ County, Kansas, _____ feet North _____ feet West of Southeast corner of section.
 Proposed Rate see geocenter Proposed Quantity see geocenter
 This point is: Additional Well Geo Center List other water rights that will use this point KM 004

10. **Presently authorized point of diversion:**
 One in the _____ Quarter of the _____ Quarter of the _____ Quarter of Section _____, Township _____ South, Range _____, in _____ County, Kansas, _____ feet North _____ feet West of Southeast corner of section.
 Authorized Rate _____ Authorized Quantity _____
(DWR use only: Computer ID No. _____ GPS _____ feet North _____ feet West)
 This point will not be changed This point will be changed as follows:
Proposed point of diversion: (Complete only if change is requested) Proposed New South Well of Battery
 One in the NW Quarter of the SW Quarter of the SE (Lot 8) Quarter of Section 32, Township 27 South, Range 10 W, in Kingman County, Kansas, 671 feet North 2320 feet West of Southeast corner of section.
 Proposed Rate see geocenter Proposed Quantity see geocenter
 This point is: Additional Well Geo Center List other water rights that will use this point KM 004

11. Describe the current condition of and future plans for any point(s) of diversion which will no longer be used. Not applicable

WATER RESOURCES
RECEIVED

IF MORE SPACE IS NEEDED, ATTACH ADDITIONAL SHEETS AS NECESSARY

MAY 12 2017

12. The presently authorized use of water is for Municipal purposes.
It is proposed that the use be changed to No Change purposes.
13. If changing the place of use and/or use made of water, describe how the consumptive use will not be increased.
No proposed change to the place of use or use made of water.
-
- (Please show any calculations here.)
14. It is requested that the maximum annual quantity of water be reduced to --- (acre-feet or million gallons).
15. It is requested that the maximum rate of diversion of water be reduced to --- gallons per minute (--- c.f.s.).
16. The application must include either a topographic map or detailed plat. A U.S. Geological Survey Topographic Map, scale 1:24,000, is available through the Kansas Geological Survey, 1930 Constant Avenue, University of Kansas, Lawrence, Kansas 66047-3726 (www.usgs.gov). The map should show the location of the presently authorized point(s) of diversion. Distances North and West of the Southeast corner of the section must be shown. The presently authorized place of use should also be shown. Identify the center of the section, the section lines and the section corners and show the appropriate section, township, and range numbers on the map. In addition the following information must also be shown on the map.
- a. If a change in the location of the point(s) of diversion is proposed, show:
 - 1) The location of the proposed point(s) of diversion. Distances North and West of the Southeast corner of the section must be shown. Please be certain that the information shown on the map agrees with the information shown in Paragraph Nos. 9, 10 and 11 of the application.
 - 2) If the source of supply is groundwater, please show the location of existing water wells of any kind, including domestic wells, within ½ mile of the proposed well or wells. Identify each well as to its use and furnish name and mailing address of the property owner or owners. If there are no wells within ½ mile, please indicate so on the map.
 - 3) If the source of supply is surface water, the names and mailing addresses of all landowner(s) ½ mile downstream and ½ mile upstream from your property lines must be shown.
 - b. If a change in the place of use is desired, show the proposed place of use by crosshatching on the map. Please be certain that the information shown on the map agrees with the information shown in Paragraph No. 5 of the application.
17. Attach documentation to show the change(s) proposed herein will not impair existing water rights and relates to the same local source of supply as to which the water right relates. This information may include statements, plats, geology reports, well logs, test hole logs, and other information as necessary information to show the above. Additional comments may be made below.

All wells will be placed in the same local source of supply which is undifferentiated Kansan Nebraskan age materials. Test hole logs are attached. Since the rate and quantity are not being increased and the current system has been in place for decades impairment will not occur.

18. If the proposed change(s) does not meet all applicable rules and regulations of the Kansas Water Appropriation Act, please identify the rules and regulations for which you request a waiver. State the reason why a waiver is needed and why the request should be granted. Attach documentation showing that granting the request will not impair existing water rights and will not prejudicially and unreasonably affect the public interest.

Request a waiver of K.A.R 5-2-3 Battery of Wells. Current wells meet the definition of a battery and have always been operated as such. Need the additional flexibility of a battery of wells and the addition of a third well for redundancy and public health and safety if one well should go down. In asking for a third well to the battery, rate and quantity shall not be increased. Additionally, third well will be needed to assist with mixing due to increasing nitrates in the upper aquifer that the current wells are placed in. Well will be completed in the same local source of supply and aquifer. Current wells are approximately 80 years old.

WATER RESOURCES
RECEIVED

IF MORE SPACE IS NEEDED, ATTACH ADDITIONAL SHEETS AS NECESSARY

MAY 12 2017

APPLICATION FOR APPROVAL TO CHANGE
THE PLACE OF USE AND/OR POINT OF DIVERSION
SUPPLEMENTAL SHEET
FILE NO. 15907

Presently authorized point of diversion:

One in the _____ Quarter of the _____ Quarter of the _____ Quarter
of Section _____, Township _____ South, Range _____ (E/W),
in _____ County, Kansas, _____ feet North _____ feet West of Southeast corner of section.
Authorized Rate _____ Authorized Quantity _____ Depth of well _____ (feet)
(DWR use only: Computer ID No. _____ GPS _____ feet North _____ feet West)

This point will not be changed This point will be changed as follows: No redrill, point better described with GPS as follows:

Proposed point of diversion: (Complete only if change is requested) Geocenter of Battery of 3 Wells

One in the NW Quarter of the SW Quarter of the SE (Lot 8) Quarter
of Section 32, Township 27 South, Range 10 W,
in Kingman County, Kansas, 784 feet North 2475 feet West of Southeast corner of section.
Proposed Rate 545 GPM (Limited) Proposed Quantity 47.747 MGY (Limited) Proposed well depth (feet) —.
This point is: Additional Well Geo Center List other water rights that will use this point KM 004

Presently authorized point of diversion:

One in the _____ Quarter of the _____ Quarter of the _____ Quarter
of Section _____, Township _____ South, Range _____ (E/W),
in _____ County, Kansas, _____ feet North _____ feet West of Southeast corner of section.
Authorized Rate _____ Authorized Quantity _____ Depth of well _____ (feet)
(DWR use only: Computer ID No. _____ GPS _____ feet North _____ feet West)

This point will not be changed This point will be changed as follows: No redrill, point better described with GPS as follows:

Proposed point of diversion: (Complete only if change is requested)

One in the _____ Quarter of the _____ Quarter of the _____ Quarter
of Section _____, Township _____ South, Range _____ (E/W),
in _____ County, Kansas, _____ feet North _____ feet West of Southeast corner of section.
Proposed Rate _____ Proposed Quantity _____ Proposed well depth (feet) _____.
This point is: Additional Well Geo Center List other water rights that will use this point _____

Presently authorized point of diversion:

One in the _____ Quarter of the _____ Quarter of the _____ Quarter
of Section _____, Township _____ South, Range _____ (E/W),
in _____ County, Kansas, _____ feet North _____ feet West of Southeast corner of section.
Authorized Rate _____ Authorized Quantity _____ Depth of well _____ (feet)
(DWR use only: Computer ID No. _____ GPS _____ feet North _____ feet West)

This point will not be changed This point will be changed as follows: No redrill, point better described with GPS as follows:

Proposed point of diversion: (Complete only if change is requested)

One in the _____ Quarter of the _____ Quarter of the _____ Quarter
of Section _____, Township _____ South, Range _____ (E/W),
in _____ County, Kansas, _____ feet North _____ feet West of Southeast corner of section.
Proposed Rate _____ Proposed Quantity _____ Proposed well depth (feet) _____.
This point is: Additional Well Geo Center List other water rights that will use this point _____

Presently authorized point of diversion:

One in the _____ Quarter of the _____ Quarter of the _____ Quarter
of Section _____, Township _____ South, Range _____ (E/W),
in _____ County, Kansas, _____ feet North _____ feet West of Southeast corner of section.
Authorized Rate _____ Authorized Quantity _____ Depth of well _____ (feet)
(DWR use only: Computer ID No. _____ GPS _____ feet North _____ feet West)

This point will not be changed This point will be changed as follows: No redrill, point better described with GPS as follows:

Proposed point of diversion: (Complete only if change is requested)

One in the _____ Quarter of the _____ Quarter of the _____ Quarter
of Section _____, Township _____ South, Range _____ (E/W),
in _____ County, Kansas, _____ feet North _____ feet West of Southeast corner of section.
Proposed Rate _____ Proposed Quantity _____ Proposed well depth (feet) _____.
This point is: Additional Well Geo Center List other water rights that will use this point _____

WATER RESOURCES
RECEIVED

MAY 12 2017

KS DEPT OF AGRICULTURE

Any use of water that is not as authorized by the water right or permit to authorize water **before** the chief engineer approves this application is a violation of the Kansas Water Appropriation Act for which criminal or civil penalties may be assessed. Such violation is a class C misdemeanor, punishable by a fine not to exceed \$500 and/or a term of confinement not to exceed one month in the county jail. K.S.A. 82a-728(b). Civil penalties shall be not less than \$100 nor more than \$1,000 per violation. In the case of a continuing violation, each day such violation continues may be deemed a separate violation. In addition to these penalties the water right may be modified or suspended. K.S.A. 82a-737, as amended.

The application must be signed by all owners of the place of use authorized under the water right and his or her spouse, if married. Please indicate if there is no spouse. If land is being purchased under contract, the seller must sign as landowner until such time as the contract is completed.

In the event that all applicants cannot appear before one notary public, they may as necessary sign separate copies of the application before any notary public conveniently available to them. All copies signed in this manner shall be considered to be valid parts of the application.

If the request is signed on behalf of any Owner by someone with legal authority to do so (for example, an agent, one who has power of attorney, or an executor, executrix, conservator), it will be necessary to attach proper documents showing such authority.

I declare that I am an owner of the currently authorized place of use as identified herein, or that I represent all such owners and am authorized to make this application on their behalf, and declare further that the statements contained herein are true, correct, and complete. By filing this application I authorize the chief engineer to permanently reduce the quantity of water and/or rate of diversion as specified in Sections 14 and 15 of this application.

Dated at Lunningham, Kansas, this 8th day of May, 20 17.

[Signature]
(Owner)

(Spouse)

Aaron Murphy Mayor
(Please Print)

(Please Print)

(Owner)

(Spouse)

(Please Print)

(Please Print)

(Owner)

(Spouse)

(Please Print)

(Please Print)

State of Kansas }
County of Kingman } SS



I hereby certify that the foregoing application was signed in my presence and sworn to before me this 8th day of May, 20 17.

Kathleen Albers
Notary Public

My Commission Expires 3-9-18

FEE SCHEDULE

Each application to change the place of use, the point of diversion or the use made of the water under this section shall be accompanied by the application fee set forth in the schedule below:

- (1) Application to change a point of diversion 300 feet or less \$100
- (2) Application to change a point of diversion more than 300 feet \$200
- (3) Application to change the place of use \$200
- (4) Application to change the use made of the water \$300

Make check payable to **Kansas Department of Agriculture.**

WATER RESOURCES
RECEIVED

MAY 12 2017

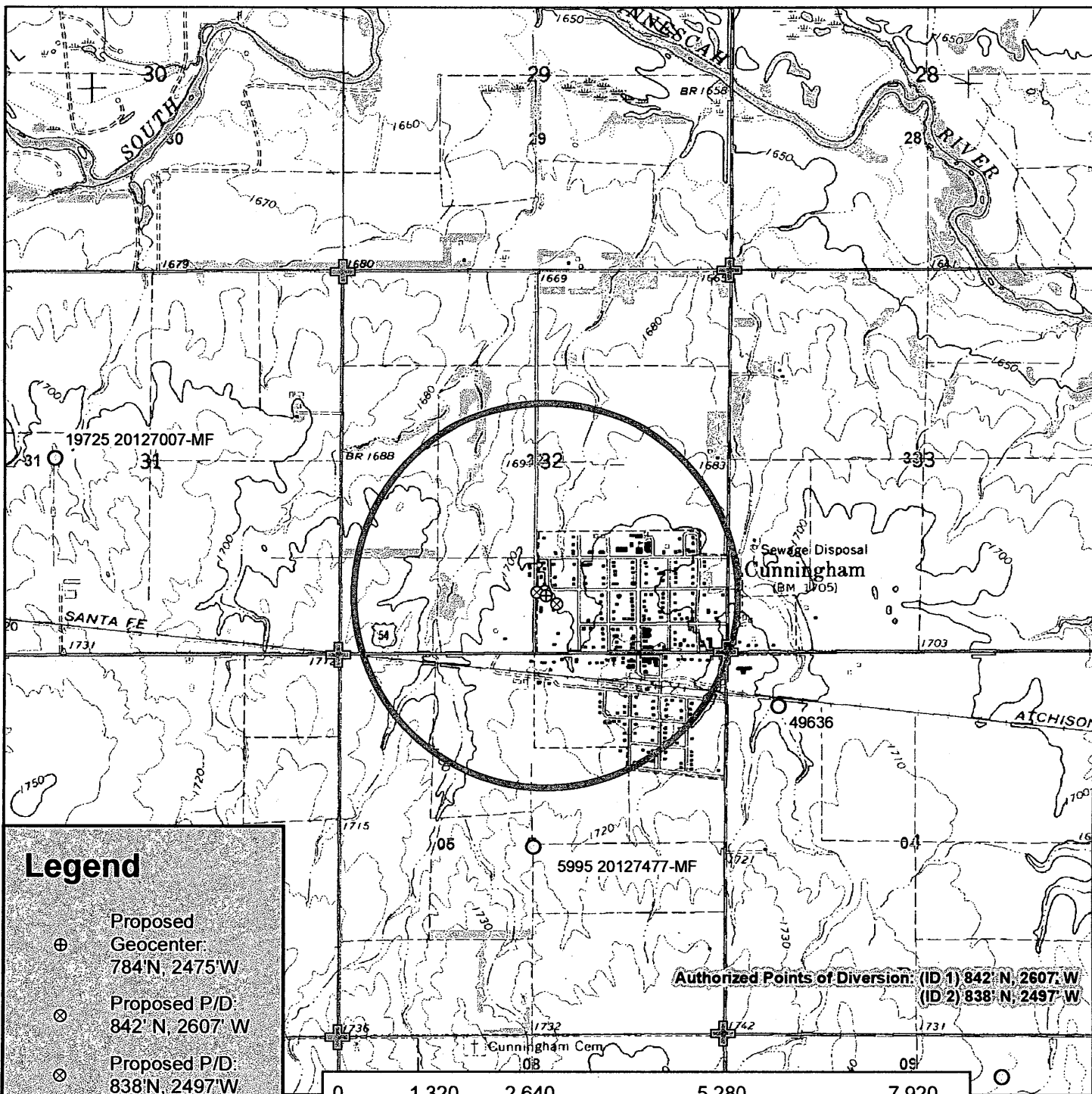

Legend

- ⊕ Proposed Geocenter: 784' N, 2475' W
- ⊗ Proposed P/D: 842' N, 2607' W
- ⊗ Proposed P/D: 838' N, 2497' W
- ⊗ Proposed P/D: 671' N, 2320' W
- Water Appropriations
- ⊕ Section Corner
- ▭ Section Line
- ☆ Domestic Well
- ▭ 1/2 Mile Buffer

Authorized Points of Diversion: (ID 1) 842' N, 2607' W
 (ID 2) 838' N, 2497' W

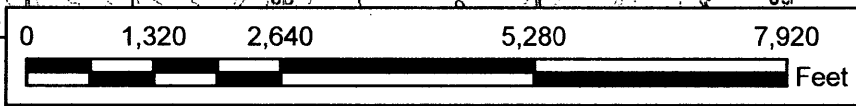

Water Right, File No. 15907

Change in Point of Diversion, Application Map
 32-27S-10W // Kingman County



Due to the large number of wells within 1/2 mile of the proposed geocenter, the applicant requests that a public notice be published in the area newspaper to notify nearby well owners.

MAY 12 2017
 KS DEPT OF AGRICULTURE

Signature

4/26/2017 TJS-SFFO 1:24,000 scale

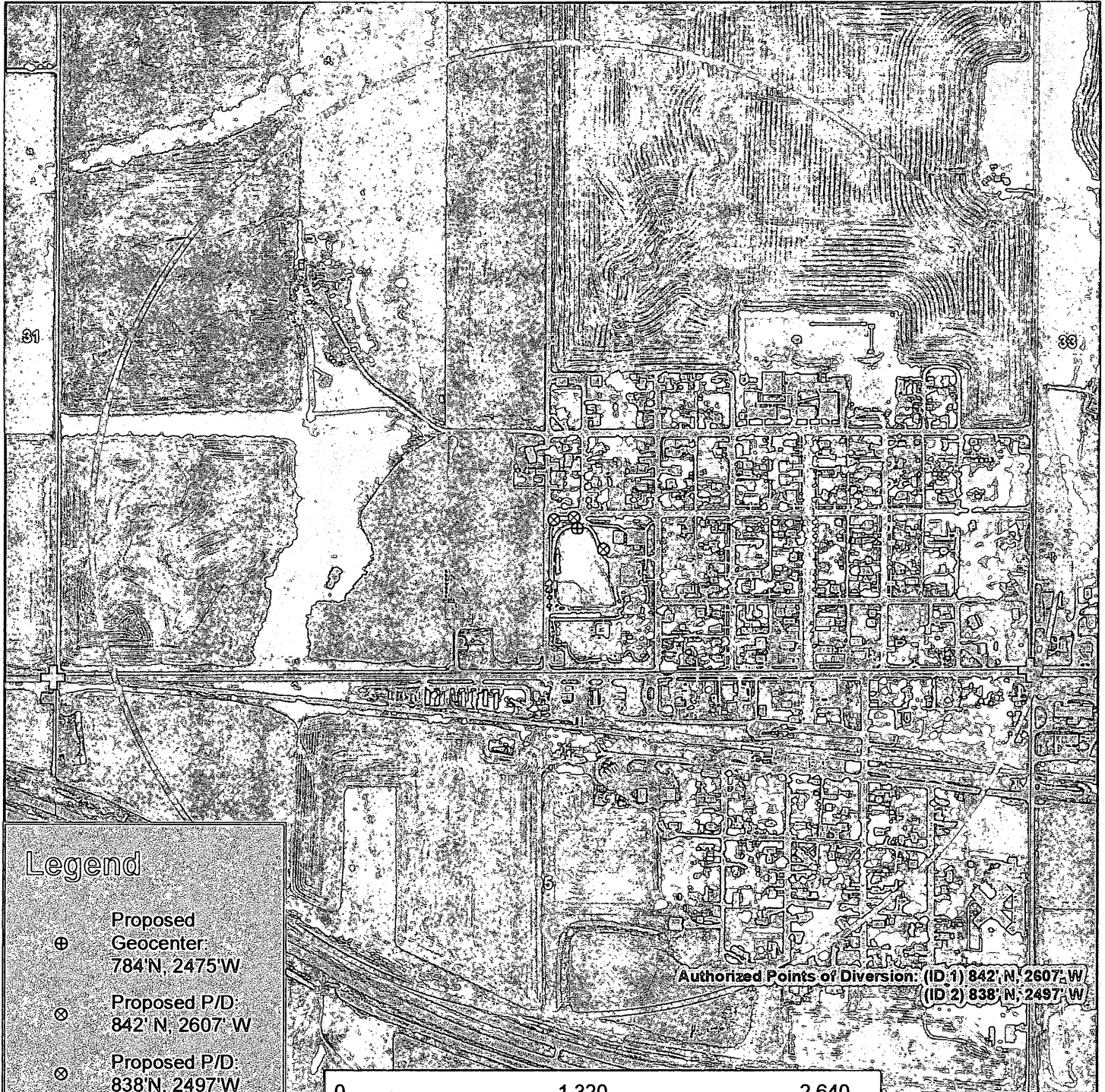

Authorized Points of Diversion: (ID:1) 842' N, 2607' W
 (ID:2) 838' N, 2497' W

Legend

- ⊕ Proposed Geocenter
784' N, 2475' W
- ⊗ Proposed P/D
842' N, 2607' W
- ⊗ Proposed P/D
838' N, 2497' W
- ⊗ Proposed P/D
671' N, 2320' W
- Water Appropriations
- ⊕ Section Corner
- ▭ Section Line
- ☆ Domestic Well
- ▭ 1/2 Mile Buffer

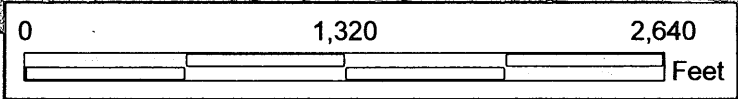

Water Right, File No. 15907
Change in Point of Diversion, Aerial Map
32-27S-10W // Kingman County

N
 WATER RESOURCES
 RECEIVED
 S

MAY 12 2017

KS DEPT OF AGRICULTURE

Terrane Resources Co.

P.O. Box 173 Stafford, KS 67578 620-234-5200

KANSAS GROUND WATER: STRAIGHT UP FROM THE ROCKS!

04 May, 2017

WATER RESOURCES
RECEIVED

MAY 12 2017

Mr. Brent Turney, P.G.
Division of Water Resources
Kansas Dept. of Agriculture
1320 Research Park Drive
Manhattan, Kansas 66502

KS DEPT OF AGRICULTURE

Re: Files KM 04 and #15,907

Dear Mr. Turney,

This letter is written on behalf of the City of Cunningham, KS to provide information pertaining to the processing of the proposed changes to the above files. The data attached is provided to help in the determination to allow the change to battery permits and the installation of a third well.

We met with Jeff Lanterman and Tyler Saryerwinnie at the DWR Stafford Field Office. This meeting resulted in the enclosed change applications.

The proposed changes are requested for public health and safety reasons and to add redundancy to the system. The City is currently operating on two wells which were installed in late 1935 and early 1936. Both wells have been impacted by nitrates and the east well has exceeded the drinking water standard of 10 mg/l nitrate as nitrogen(NO₃-N). Fortunately, they were able to blend with the west well and remain in compliance with regards to water quality. The proposed additional well will allow them to blend if the west well fails or has to be taken out of service.

The City has taken great care to manage the fertilizer they apply to the football field and have subsequently reduce the nitrate contamination to the wells. It is expected they will continue to manage the nutrients and monitor the water quality. The approval of the proposed changes will allow the city to manage their wellfield to minimize future water quality issues and be able to handle potential well/pump failures.

The current wells are of sufficient age and need to be evaluated and possibly updated. However due to the current demands on the system it is not feasible to take one of the wells out of service for an extended period of time. With the

additional well the City will have two low nitrate wells they can depend on to blend with the high nitrate well should it exceed the drinking water standard in the future. At this time we do not plan to replace the existing wells. However, the City does plan to upgrade them as needed to hopefully get another 80 years of service out of them.

Attached you will find two WWC-5's, the first is for MW 1-12 which is near the East well and the other is for TW 5-16 which is approximately 15 feet east of the proposed new well site. The existing City wells are approximately 60 feet deep and withdraw from the very upper portion of the aquifer. The proposed new well will withdraw low nitrate water from the bottom of the same aquifer unit.

Based on the data we have obtained and collected the water levels in the area are essentially unchanged. The water level in the East well was 26.6 feet below land surface(bls) Dec., 1935. Water levels from MW 1-12, which is approximately, 30 feet SSW of the East Well, were 21.62' (11/26/12), 21.22' (04/06/16) and 21.16' (08/29/16) all below land surface.

The City is aware they will not receive any additional rate or quantity over what they are already approved for.

The geographic center of the the well field will shift to the south and east. This will move the geo-center away from any nearby domestic wells. Since we are moving away from any nearby wells and with the multitude of landowners involved the City is requesting guidance as to how DWR would like for them to proceed with landowner notifications. Additionally, The City will look at nearby landowners and try to identify any domestic wells within 660 feet of the proposed geo-center.

Brent, as always should you, or any of your staff have any questions, do not hesitate to contact us. We would also ask that we be copied on any correspondence regarding these matters.

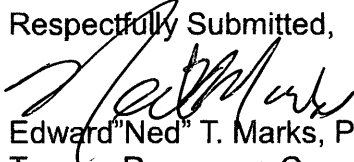
Respectfully Submitted,

Edward "Ned" T. Marks, PG
Terrane Resources Co.
P.O. Box 173
Stafford, KS 67578-0173
620-546-3616 cell
terresco@yahoo.com

WATER RESOURCES
RECEIVED

MAY 12 2017

KS DEPT OF AGRICULTURE



305 11882 OB-1-12
WATER WELL RECORD Form WWC-5 Division of Water Resources App. No. _____

1 LOCATION OF WATER WELL: Fraction $\frac{1}{4}$ NW $\frac{1}{4}$ SW $\frac{1}{4}$ SE $\frac{1}{4}$ E
 County: Kingman Section Number 32 Township No. T 27 S Range Number R 10 E W

Street/Rural Address of Well Location; if unknown, distance & direction from nearest town or intersection: If at owner's address, check here
 Approximately 0.5 miles north of Cunningham.

2 WATER WELL OWNER: City of Cunningham
 RR#, Street Address, Box #: P.O. Box 188
 City, State, ZIP Code : Cunningham, KS 67053

Global Positioning System (GPS) information:
 Latitude: 37.647483 (in decimal degrees)
 Longitude: -98.437356 (in decimal degrees)
 Elevation: Unknown
 Datum: WGS 84, NAD 83, NAD 27
 Collection Method:
 GPS unit (Make/Model: WAAS)
 Digital Map/Photo, Topographic Map, Land Survey
 Est. Accuracy: <3 m, 3-5 m, 5-15 m, >15 m

3 LOCATE WELL WITH AN "X" IN SECTION BOX:

N			
W	-NW-	-NE-	
			E
	-SW-	-SE-	
S			

1/4 mile

4 DEPTH OF COMPLETED WELL 105 ft.
 Depth(s) Groundwater Encountered (1) _____ ft. (2) _____ ft. (3) _____ ft.
 WELL'S STATIC WATER LEVEL 21.60 ft. below land surface measured on mo/day/yr 11/26/12
 Pump test data: Well water was not checked ft. after _____ hours pumping _____ gpm
 EST. YIELD _____ gpm. Well water was _____ ft. after _____ hours pumping _____ gpm
 Bore Hole Diameter 6 in. to 107 ft., and _____ in. to _____ ft.
 WELL WATER TO BE USED AS: Public water supply Geothermal Injection well
 Domestic Feedlot Oil field water supply Dewatering Other (Specify below)
 Irrigation Industrial Domestic-lawn & garden Monitoring well
 Was a chemical/bacteriological sample submitted to Department? Yes No
 If yes, mo/day/yr sample was submitted _____
 Water well disinfected? Yes No

5 TYPE OF CASING USED: Steel PVC Other
 CASING JOINTS: Glued Clamped Welded Threaded
 Casing diameter 2 in. to 83 ft., Diameter _____ in. to _____ ft., Diameter _____ in. to _____ ft.
 Casing height above land surface 24 in., Weight 70 lbs./ft., Wall thickness or gauge No. 154
 TYPE OF SCREEN OR PERFORATION MATERIAL:
 Steel Stainless Steel PVC Other (Specify) _____
 Brass Galvanized Steel None used (open hole)
 SCREEN OR PERFORATION OPENINGS ARE:
 Continuous slot Mill slot Gauze wrapped Torch cut Drilled holes None (open hole)
 Louvered shutter Key punched Wire wrapped Saw cut Other (specify) _____
 SCREEN-PERFORATED INTERVALS: From 83 ft. to 103 ft., From _____ ft. to _____ ft.
 From _____ ft. to _____ ft., From _____ ft. to _____ ft.
 GRAVEL PACK INTERVALS: From 78 ft. to 103 ft., From _____ ft. to _____ ft.
 From _____ ft. to _____ ft., From _____ ft. to _____ ft.

6 GROUT MATERIAL: Neat cement Cement grout Bentonite Other
 Grout Intervals: From 3 ft. to 78 ft., From _____ ft. to _____ ft., From _____ ft. to _____ ft.
 What is the nearest source of possible contamination:
 Septic tank Lateral lines Pit privy Livestock pens Insecticide storage Other (specify below)
 Sewer lines Cesspool Sewage lagoon Fuel storage Abandoned water well
 Watertight sewer lines Seepage pit Feedyard Fertilizer storage Oil well/gas well
 Direction from well East Distance from well 15'

FROM	TO	LITHOLOGIC LOG	FROM	TO	LITHO. LOG (cont.) or PLUGGING INTERVALS
0	4	Topsoil	33	38	Clay, brown, sandy
4	8	Clay, white, caliche, sand streaks	38	52	Sand, fine to coarse, white clay streaks
8	9	Sand, gravel, fine to coarse	52	57	Sand, gravel, fine to medium
9	11	Clay, gray	57	58	Clay, gray
11	15	Sand, gravel, fine to coarse	58	72	Sand, fine to coarse
15	19	Clay, brown, sandy	72	74	Clay, gray
19	21	Clay, yellow, gray	74	92	Sand, fine to coarse, gray clay streaks
21	25	Sand, fine to coarse, white clay streaks	92	97	Clay, brown, very sandy, sand streaks
25	27	Cemented sand	97	104	Sand, fine to coarse
27	33	Clay, brown, yellow, gray	104	107	Shale, red

7 CONTRACTOR'S OR LANDOWNER'S CERTIFICATION: This water well was constructed, reconstructed, or plugged under my jurisdiction and was completed on (mo/day/year) 11/26/12 and this record is true to the best of my knowledge and belief.
 Kansas Water Well Contractor's License No. 185 This Water Well Record was completed on (mo/day/year) 12/10/12
 under the business name of Clarke Well & Equipment, Inc. by (signature)

INSTRUCTIONS: Use typewriter or ball point pen. PLEASE PRESS FIRMLY and PRINT clearly. Please fill in blanks and check the correct answers. Send three copies (white, blue, pink) to Kansas Department of Health and Environment, Bureau of Water, Geology Section, 1000 SW Jackson St., Suite 420, Topeka, Kansas 66612-1367. Telephone 785-296-5522. Send one copy to WATER WELL OWNER and retain one for your records. Include fee of \$5.00 for each constructed well. Visit us at <http://www.kdheks.gov/waterwell/index.html>.

KSA 82a-1212

Check: White Copy Blue Copy

WATER RESOURCES
 RECEIVED

MAY 12 2017

KS DEPT OF AGRICULTURE

606 14014 TW-5-16
WATER WELL RECORD Form WWC-5 Division of Water Resources App. No. []

1 LOCATION OF WATER WELL: Fraction 1/4 NW 1/4 SW 1/4 SE 1/4 Section Number 32 Township No. T 27 S Range Number R 10 E W
 County: Kingman
 Street/Rural Address of Well Location; if unknown, distance & direction from nearest town or intersection: If at owner's address, check here
From 1st St (Old Hwy 54) & Stadium St on west edge of Cunningham, north to 3rd St., east ~150' on south side

2 WATER WELL OWNER: City of Cunningham
 RR#, Street Address, Box #: P.O. Box 188
 City, State, ZIP Code : Cunningham, KS 67053

Global Positioning System (GPS) information:
 Latitude: 37.647156 (in decimal degrees)
 Longitude: -98.4367 (in decimal degrees)
 Elevation: Unknown
 Datum: WGS 84, NAD 83, NAD 27
 Collection Method:
 GPS unit (Make/Model: WAAS)
 Digital Map/Photo, Topographic Map, Land Survey
 Est. Accuracy: <3 m, 3-5 m, 5-15 m, >15 m

3 LOCATE WELL WITH AN "X" IN SECTION BOX:

 N
 W -NW- -NE- E
 -SW- -SE-
 S
 |-----| mile -----|

4 DEPTH OF COMPLETED WELL 104 ft.
 Depth(s) Groundwater Encountered (1) 22.66 ft. (2) _____ ft. (3) _____ ft.
 WELL'S STATIC WATER LEVEL 22.66 ft. below land surface measured on mo/day/yr 08/22/16
 Pump test data: Well water was not checked ft. after _____ hours pumping _____ gpm
 EST. YIELD _____ gpm. Well water was _____ ft. after _____ hours pumping _____ gpm
 Bore Hole Diameter 10 in. to 105 ft., and _____ in. to _____ ft.
 WELL WATER TO BE USED AS: Public water supply Geothermal Injection well
 Domestic Feedlot Oil field water supply Dewatering Other (Specify below)
 Irrigation Industrial Domestic-lawn & garden Monitoring well Test Well
 Was a chemical/bacteriological sample submitted to Department? Yes No
 If yes, mo/day/yr sample was submitted _____
 Water well disinfected? Yes No

5 TYPE OF CASING USED: Steel PVC Other _____
 CASING JOINTS: Glued Clamped Welded Threaded Other (Specify) S.S. Screws
 Casing diameter 5 in. to 82 ft., Diameter _____ in. to _____ ft., Diameter _____ in. to _____ ft.
 Casing height above land surface 24 in., Weight 2.36 lbs./ft., Wall thickness or gauge No. 214
 TYPE OF SCREEN OR PERFORATION MATERIAL:
 Steel Stainless Steel PVC Other (Specify) _____
 Brass Galvanized Steel None used (open hole)
 SCREEN OR PERFORATION OPENINGS ARE:
 Continuous slot Mill slot Gauge wrapped Torch cut Drilled holes None (open hole)
 Louvered shutter Key punched Wire wrapped Saw cut Other (specify) _____
 SCREEN-PERFORATED INTERVALS: From 82 ft. to 102 ft., From _____ ft. to _____ ft.
 From _____ ft. to _____ ft., From _____ ft. to _____ ft.
 GRAVEL PACK INTERVALS: From 75 ft. to 105 ft., From _____ ft. to _____ ft.
 From _____ ft. to _____ ft., From _____ ft. to _____ ft.

6 GROUT MATERIAL: Neat cement Cement grout Bentonite Other _____
 Grout Intervals: From 0 ft. to 75 ft., From _____ ft. to _____ ft., From _____ ft. to _____ ft.
 What is the nearest source of possible contamination:
 Septic tank Lateral lines Pit privy Livestock pens Insecticide storage Other (specify below)
 Sewer lines Cesspool Sewage lagoon Fuel storage Abandoned water well
 Watertight sewer lines Seepage pit Feedyard Fertilizer storage Oil well/gas well
 Direction from well East Distance from well 15'

FROM	TO	LITHOLOGIC LOG	FROM	TO	LITHO. LOG (cont.) or PLUGGING INTERVALS
0	4	Topsoil	58	102	Sand, fine to coarse, some medium gravel,
4	7	Clay, brown, gray, caliche			thin brown clay streaks
7	10	Clay, tan	102	105	Shale, red
10	14	Sand, gravel, fine to coarse			
14	21	Clay, brown, white, caliche			
21	27	Sand, gravel, fine to medium			
27	37	Clay, brown, cemented sand streaks, fine sand mix			
37	56	Sand, gravel, fine to medium			
56	58	Clay, brown, gray			

7 CONTRACTOR'S OR LANDOWNER'S CERTIFICATION: This water well was constructed, reconstructed, or plugged under my jurisdiction and was completed on (mo/day/year) 08/22/16 and this record is true to the best of my knowledge and belief.
 Kansas Water Well Contractor's License No. 185 This Water Well Record was completed on (mo/day/year) 08/25/16
 under the business name of Clarke Well & Equipment, Inc. by (signature) [Signature]

INSTRUCTIONS: Use typewriter or ball point pen. PLEASE PRESS FIRMLY and PRINT clearly. Please fill in blanks and check the correct answers. Send three copies (white, blue, pink) to Kansas Department of Health and Environment, Bureau of Water, Geology Section, 1000 SW Jackson St., Suite 420, Topeka, Kansas 66612-1367. Telephone 785-296-5522. Send one copy to WATER WELL OWNER and retain one for your records. Include fee of \$5.00 for each constructed well. Visit us at <http://www.kdheks.gov/waterwell/index.html>.

KSA 82a-1212

WATER RESOURCES
 RECEIVED

MAY 12 2017

KS DEPT OF AGRICULTURE

1320 Research Park Drive
Manhattan, Kansas 66502
(785) 564-6700



900 SW Jackson, Room 456
Topeka, Kansas 66612
(785) 296-3556

Jackie McClaskey, Secretary

Governor Sam Brownback

FILE COPY

CITY OF CUNNINGHAM
PO BOX 188
CUNNINGHAM, KS 67035

May 12, 2017

RE: File No 15907

Dear Sir or Madam:

An application for approval of the Chief Engineer to change the following condition or conditions of the file number referred to above has been received:

- place of use PD
- point of diversion
- use made of water

As a matter of record, the Division of Water Resources has on hand a large number of applications awaiting processing. Therefore, to be fair to all concerned, and so that we can process those applications on hand in the order they were received, we intend to concentrate on the backlog of applications until the issue is resolved. You will be contacted regarding this application as soon as it has been examined.

In accordance with the provisions of the Kansas Water Appropriation Act, a portion of which is included below, the use of water prior to approval of the application is unlawful. You should not proceed and divert water as indicated by your plans in your application for a change for this file until you receive approval for this change from the Chief Engineer. Once approved, compliance with the terms, conditions and limitations of the permit is necessary. Conservation of the water resources of Kansas is required.

Section 82a-728 of the Kansas Water Appropriation Act, provides (a) except for the appropriation of water for the purpose of domestic use, . . . it shall be unlawful for any person to appropriate or threaten to appropriate water from any source without first applying for and obtaining a permit to appropriate water in accordance with the provisions of the Water Appropriation Act or for any person to violate any condition of a vested right, appropriation right or an approved application for a permit to appropriate water for beneficial use.

(b) (1) The violation of any provision of this section by any person is a class C misdemeanor...

A class C misdemeanor is punishable by a fine not to exceed \$500 and/or a term of confinement not to exceed one month in the county jail. Each day that the violation occurs constitutes a separate offense.

If you have any questions, please contact me at (785) 564-6645. If you wish to discuss a specific file, please have the file number ready so that we may help you more efficiently.

Sincerely,

A handwritten signature in cursive script that reads "Kristen A. Baum".

Kristen A. Baum
New Applications Unit Supervisor
Water Appropriation Program

BAT: DLW
pc: STAFFORD Field Office GMD