

CHECK SHEET Short Change

(To be completed and attached to each application)

File No. 30358

Field Office No. 2

GMD No. 3

1. **Plugging agreement obtained for GMD?** Yes No Non Applicable
2. **Is Landowner correct as currently shown in WRIS?** Yes No **Address Change?** YES
If applicable, list Place of Use Overlap File Nos. 23120
3. **Is Water Use Correspondent correct as currently shown in WRIS?** Yes No **Address Change?** YES
Name of Former WUC ROY B & JUDITH A AUSTIN Name of New WUC LANCE & HEIDI FIEKERT LIVING TRUST
4. a. **Point of diversion computer ID No(s).** N/A **for point(s) being changed.**
b. **Show feet distances from the** SE **corner of the section for the new point(s) of diversion:**

Action	PDIV ID	Geo Ctr?	Sec	Twp	Rng	'N	'W	County	Qualifiers
NO CHG	41160	NO	29	28S	21W	1360	3940	Ford	SW NE SW

- c. **If multiple points of diversion exist and rates and quantities are individually assigned, show:**
- | Old PDIV ID | Authorized Rate | Additional Rate | Authorized Quantity | Additional Quantity |
|-------------|-----------------|-----------------|---------------------|---------------------|
| _____ | _____ gpm/cfs | _____ gpm/cfs | _____ af/mgy | _____ af/mgy |
| _____ | _____ gpm/cfs | _____ gpm/cfs | _____ af/mgy | _____ af/mgy |
| _____ | _____ gpm/cfs | _____ gpm/cfs | _____ af/mgy | _____ af/mgy |
- d. **Name of Drainage Basin** _____ **Is this correctly shown in WRIS?** Yes No
- e. **Formation Name & No.** _____ **Special Use Area** _____

5. **Distances from the previous/original p/d:** _____ ' N / S _____ ' E / W

6. WATER RIGHT ACTION TRAIL COMMENTS

4/03/2017 Change Application Received (date accepted for priority)
4 / 14 / 17 Change Approved
Notice and Proof by _____ / _____ / _____
Completion Requirement Removed (Change No. C _____)

7. METER ACTION TRAIL COMMENTS

4 / 14 / 17 DWR Meter Required by 12/31/2017
Anti-Reverse Meter Required by _____ / _____ / _____
Meter Seal Required by _____ / _____ / _____

8. Base Acres NA Identical Overlap Year --- Minimum Reasonable Quantity 1.34 AF/acre

Date Created 4/11/17 by TJS
Date Entered _____ by _____

CHECK SHEET ATTACHMENT

File Number 30358

9. Changes to the place of use will be:

Action	Owner Person ID	Place Use ID #	Sec.	Twp.	Range		NE¼				NW¼				SW¼				SE¼				TOTAL ACRES
							NE¼	NW¼	SW¼	SE¼	NE¼	NW¼	SW¼	SE¼	NE¼	NW¼	SW¼	SE¼	NE¼	NW¼	SW¼	SE¼	
ENT	_____	26249	29	28S	21W	Acres Authorized									40	40	40	40			40	40	240
						New Acres																	
DEL	524	22517	29	28S	21W	Acres Authorized									10			10		40	40		100
						New Acres																	
						Acres Authorized																	
						New Acres																	
						Acres Authorized																	
						New Acres																	

Names and Address:

1. Person ID # _____ LANCE & HEIDI FEIKERT LIVING TRUST BOX 212 BUCKLIN KS 67834	2. Person ID # _____ _____ _____ _____ _____	3. Person ID # _____ _____ _____ _____ _____
---	--	--

GENERAL INSTRUCTIONS

- | | | |
|--|---|---|
| 1. Give to Applicant:
a. <u>Original</u> application/approval
b. Original receipt (one for <u>each</u> application)
c. Information packet containing:
<ul style="list-style-type: none"> • Notice and Proof form • Water Meter Specifications • Acceptable Meter list • Water level measurement tube specifications • Check Valve specifications • Pink Sheet - K.S.A. 82a-728 letter • Form stating to record in Register of Deeds Office (OPTIONAL AS NEEDED) | 2. Send to headquarters:
a. Good, scannable copy of application and/or approval and this check sheet
b. Original check and copy of receipt
c. Test hole log
d. GMD recommendation, if any
e. Map or aerial photograph, if any
3. Send to KDHE: Letter (KDHE.LT) advising of location of abandoned well. <input type="checkbox"/> | 4. Date stamp received and approved.
5. Complete ownership and WUC change information. |
|--|---|---|

ADDITIONAL PHOTOCOPIES

HQ _____

GMD #3 _____

CONDITIONS

1. Insert notice and proof date.
2. Type or print applicant's/owner's name on line.
3. Complete notary statement.

Submit completed application to:
 Kansas Department of Agriculture
 Division of Water Resources
 Field Office for your area.
 Call for address:

Topeka -- (785) 296-5733
 Stafford -- (620) 234-5311
 Stockton -- (785) 425-6787
 Garden City -- (620) 276-2901
<http://agriculture.ks.gov/dwr>

DWR FIELD OFFICE APPLICATION FOR APPROVAL TO CHANGE THE PLACE OF USE AND/OR THE POINT OF DIVERSION **WATER METER REQUIRED**



STATE OF KANSAS

Filing Fee Must Accompany the Application, K.S.A. 82a-708b(b), as amended.
 Fee Schedule is on the third page of this application form.

Paragraph Nos. 1, 2, 3 & 5 must be completed. Complete all other applicable portions. If change in point of diversion is greater than 100 feet, or if place of use will be changed, include a topographic map or detailed plat showing the authorized and proposed point(s) of diversion and/or place of use.

RECEIVED
 10:28am
 APR 03 2017

File No. 30358

1. Application is hereby made for approval of the Chief Engineer to change the (check one or both):

Place of Use Point of Diversion

under the water right which is the subject of this application in accordance with the conditions described below.

The source of supply is: Groundwater Surface water

Stafford Field Office
 Division of Water Resources

2. Name and address of Applicant: Lance Feikert

Box 212, Bucklin, KS 67834

Phone Number: (620)826-5111 Email address: lancefeikert@yahoo.com

Name and address of Water Use Correspondent: Lance & Heidi Feikert Living Trust

Box 212, Bucklin, KS 67834

Phone Number: (620)826-5111 Email address: lancefeikert@yahoo.com

3. The presently authorized place of use is:

Owner of Land --- NAME: Lance & Heidi Feikert Living Trust

ADDRESS: Box 212, Bucklin, KS 67834

(If there is more than one landowner, attach supplemental sheets as necessary.)

Sec.	Twp.	Range	NE¼				NW¼				SW¼				SE¼				TOTAL ACRES				
			NE¼	NW¼	SW¼	SE¼	NE¼	NW¼	SW¼	SE¼	NE¼	NW¼	SW¼	SE¼	NE¼	NW¼	SW¼	SE¼					
29	28S	21W									10				10						40	40	100

4. If this application is for a change in place of use, it is proposed that the place of use be changed to:

Owner of Land --- NAME: Lance & Heidi Feikert Living Trust

ADDRESS: Box 212, Bucklin, KS 67834

(If there is more than one landowner, attach supplemental sheets as necessary.)

Sec.	Twp.	Range	NE¼				NW¼				SW¼				SE¼				TOTAL ACRES		
			NE¼	NW¼	SW¼	SE¼	NE¼	NW¼	SW¼	SE¼	NE¼	NW¼	SW¼	SE¼	NE¼	NW¼	SW¼	SE¼			
29	28S	21W									40	40	40	40			40	40			240

For Office Use Only: Code _____ Fee \$ 300- TR # _____ Receipt Date _____ Check # 1499

5. **Presently authorized point of diversion:**
 One in the SW Quarter of the NE Quarter of the SW Quarter of Section 29, Township 28 South, Range 21 W, in Ford County, Kansas, 1360 feet North 3940 feet West of Southeast corner of section.
 Authorized Rate 810 GPM (Limited) Authorized Quantity 85 AF Depth of well --- (feet)
 (DWR use only: Computer ID No. 1 GPS 1293 feet North 3945 feet West)
 This point will not be changed This point will be changed as follows:
Proposed point of diversion: (Complete only if change is requested)
 One in the _____ Quarter of the _____ Quarter of the _____ Quarter of Section _____, Township _____ South, Range _____ (E/W), in _____ County, Kansas, _____ feet North _____ feet West of Southeast corner of section.
 Proposed Rate _____ Proposed Quantity _____ Proposed well depth (feet) _____
 This point is: Additional Well Geo Center List other water rights that will use this point 23120

6. **Presently authorized point of diversion:**
 One in the _____ Quarter of the _____ Quarter of the _____ Quarter of Section _____, Township _____ South, Range _____ (E/W), in _____ County, Kansas, _____ feet North _____ feet West of Southeast corner of section.
 Authorized Rate _____ Authorized Quantity _____ Depth of well _____ (feet)
 (DWR use only: Computer ID No. _____ GPS _____ feet North _____ feet West)
 This point will not be changed This point will be changed as follows:
Proposed point of diversion: (Complete only if change is requested)
 One in the _____ Quarter of the _____ Quarter of the _____ Quarter of Section _____, Township _____ South, Range _____ (E/W), in _____ County, Kansas, _____ feet North _____ feet West of Southeast corner of section.
 Proposed Rate _____ Proposed Quantity _____ Proposed well depth (feet) _____
 This point is: Additional Well Geo Center List other water rights that will use this point _____

7. Why do you need a new point of diversion? N/A

13a. If the proposed point of diversion will be relocated within 100 feet of the existing point of diversion, indicate its location on the diagram below in relation to the existing point of diversion. (PLEASE NOTE: The "X" in center of diagram below represents presently authorized point of diversion.)

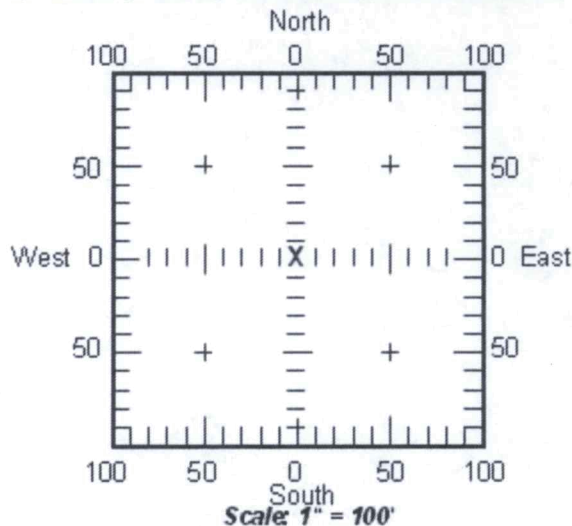

8. If a well, is the test hole log attached? Yes No

9. When do you propose to complete the new point of diversion?
N/A

10. If the point of diversion is a well:
 (a) What are you going to do with the old well?
N/A

(b) When will this be done? N/A

11. Groundwater Management District recommendation attached? Yes No 4/5/17* TJS-SFFO

12. Assisted by TJS-SFFO

13b. If the proposed point of diversion will be relocated more than 100 feet but within 2640 feet from the existing point of diversion, attach a topographic map or aerial photograph. For groundwater sources, show all wells (including domestic) within one-half mile of the proposed point of diversion and the names and mailing addresses of the owners. For surface water sources, show the names and addresses of the landowner(s) one-half mile downstream and one-half mile upstream from your property lines.

RECEIVED

APR 03 2017

14. If the proposed groundwater point of diversion is 300 or fewer feet from existing point of diversion, complete the following:

- (a) Does the undersigned represent all owners of the currently authorized place(s) of use identified in this application?
 Yes No (If no, all owners must sign this application.)
- (b) Will the ownership interest of any owner of the currently authorized place(s) of use identified in this application be adversely affected if this application is approved as requested?
 Yes No (If yes, all owners must sign this application.)
- (c) If this application is not approved expeditiously, will there be substantial damage to property, public health or safety?
 Yes No (If no, all owners must sign this application.)

If the application proposes a surface water change in point of diversion, a groundwater change in point of diversion greater than 300 feet, or a change in place of use, the application must be signed by all owners of the currently authorized place of use, or their duly authorized agent (attach notarized statement authorizing representation).

I hereby verify, being first duly sworn upon my oath or affirmation and under penalty of perjury, that I am of lawful age and the owner, the spouse of the owner, or a duly authorized agent of the owner(s) to make this application on their behalf, in regard to the water right(s) to which this application pertains. I further verify that the statements contained in this application are true, correct and complete.

Dated at _____, Kansas, this _____ day of _____, 20_____.

Carrie Jane Dance
 ↓

 (Please Print)

 (Owner)

 (Please Print)

 (Owner)

 (Please Print)

 (Owner)

 (Please Print)

Heidi Feikert
 (Spouse)

 (Please Print)

 (Spouse)

 (Please Print)

 (Spouse)

 (Please Print)

State of Kansas }
County of Ford } SS

I hereby certify that the foregoing application was signed in my presence and sworn to before me this 31st day of March, 2017.

GINA DOWNEY
 Notary Public - State of Kansas
 My Appt. Expires 08042019

Gina Downey

 Notary Public

My Commission Expires 08042019.

ONLY COMPLETE APPLICATIONS WILL BE PROCESSED. To be complete, all of the applicable portions of the application form must be completed with accurate information; maps, if necessary, must be included; signatures of all the appropriate owners' must be affixed to the application and notarized; and the appropriate fee must be paid.

FEE SCHEDULE

Each application to change the place of use or the point of diversion under this section shall be accompanied by the application fee set forth in the schedule below: Make checks payable to: **Kansas Department of Agriculture**

- (1) Application to change a point of diversion 300 feet or less \$100
- (2) Application to change a point of diversion more than 300 feet \$200
- (3) Application to change the place of use \$200

RECEIVED

APR 03 2017

SUMMARY ORDER APPROVING APPLICATION FOR CHANGE AND IMPOSING CONDITIONS

This Summary Order is issued under authority of K.S.A. 82a-708b, as amended, and K.A.R. 5-14-3 and other applicable provisions of the *Kansas Water Appropriation Law, K.S.A. 82a-701 et. seq.*, and rules and regulations promulgated thereunder, K.A.R. 5-1-1 et. seq. With the exception of those conditions expressly contained herein, this Summary Order does not change the terms, conditions and limitations of File No. 30358.

- 1. A change application was received on 4/3/17 requesting that the place of use and / or point of diversion authorized under the above-referenced file number be changed as described in the application.
- 2. On and after the effective date of this summary order, the authorized place(s) of use shall be located substantially as shown on the topographic map accompanying the application to change the place of use. Applicable Not Applicable
- 3. The change in point of diversion shall not impair existing rights and shall be limited to the same source or sources of water as previously authorized. The point of diversion authorized by this summary order shall be located within a _____ foot radius of the authorized point(s) of diversion. Applicable Not Applicable
- 4. The point(s) of diversion authorized herein shall not actually be located more than _____ feet from the previously authorized point(s) of diversion. Applicable Not Applicable
- 5. As required by K.A.R. 5-3-5d, if the works for diversion is a well with a diversion rate of 100 gallons per minute or more, a tube or other device suitable for making water level measurements shall be installed, operated and maintained in accordance with K.A.R. 5-6-13. Applicable Not Applicable
- 6. **The owner of the authorized place(s) of use shall properly install an acceptable water flow meter on or before December 31, 2017**, or before the first use of water, whichever occurs first. The water flow meter shall be installed, operated and maintained in accordance with K.A.R. 5-1-4 through 5-1-12. As required by K.S.A. 82a-732, as amended, and K.A.R. 5-3-5e, the owner shall maintain records and report the reading of the water flow meter and the total quantity of water diverted annually to the Chief Engineer by March 1 following the end of each calendar year. Applicable Not Applicable
- 7. **Installation of the works for diversion of water shall be completed on or before December 31, 20_____**, or within any authorized extension of time. By March 1, 20_____ the applicant shall notify the Chief Engineer that construction of the works for diversion has been completed, on the form provided by the Chief Engineer, as required by K.A.R. 5-8-4e. Applicable Not Applicable
- 8. **The completed well log shall be submitted with the required notice.** Applicable Not Applicable
- 9. All diversion works into which any type of chemical or other foreign substance will be injected into the water shall be equipped with an in-line, automatic, quick-closing check valve capable of preventing pollution of the source of the water supply. The check valve(s) shall be installed, operated and maintained in accordance with K.A.R. 5-3-5c. Applicable Not Applicable
- 10. Additional Conditions are attached. Yes No
- 11. In accordance with K.S.A. 82a-708a, as amended, and K.A.R. 5-5-14, all of the owners of the authorized place(s) of use of water appropriated under the above-referenced file number are responsible for compliance with its terms, conditions and limitations, as amended and/or supplemented by this Summary Order, and with applicable provisions of the *Kansas Water Appropriation Law* and the *Rules and Regulations* promulgated thereunder. Failure to comply with these provisions may result in civil penalties pursuant to K.S.A. 82a-737, as amended, and/or the suspension or revocation and dismissal of the water or appropriation right or any other enforcement actions authorized by law.

Administrative Appeal and Effective Date of Order

You have the right to a hearing in accordance with K.A.R. 5-14-3 before this Summary Order becomes final action of the Kansas Department of Agriculture. Any request for a hearing must be filed with the **Chief Engineer, Division of Water Resources, Kansas Department of Agriculture, 1320 Research Park Drive, Topeka, Kansas 66502**, within 15 days after the date shown on the Certificate of Service attached hereto. If a hearing is not requested in accordance with K.A.R. 5-14-3, this Summary Order will become effective on the 15th day after the date shown on the Certificate of Service.

For Use by Register of Deeds

FOR OFFICE USE ONLY
**APPLICATION APPROVED AND
SUMMARY ORDER ISSUED**

By: Jeff Lanterman
Duly Authorized Designee of the Chief Engineer
(Print Name): Jeff Lanterman
Division of Water Resources - Kansas Department of Agriculture
Date of Issuance: 4/18/17
State of Kansas)
County of Stafford) SS
Acknowledged before me on 4/18/2017
by Jeff Lanterman
Signature: Jessica Engelbrecht
Notary Public



My commission expires

(Notary Seal)

RECEIVED

APR 03 2017

Stafford Field Office
Division of Water Resources

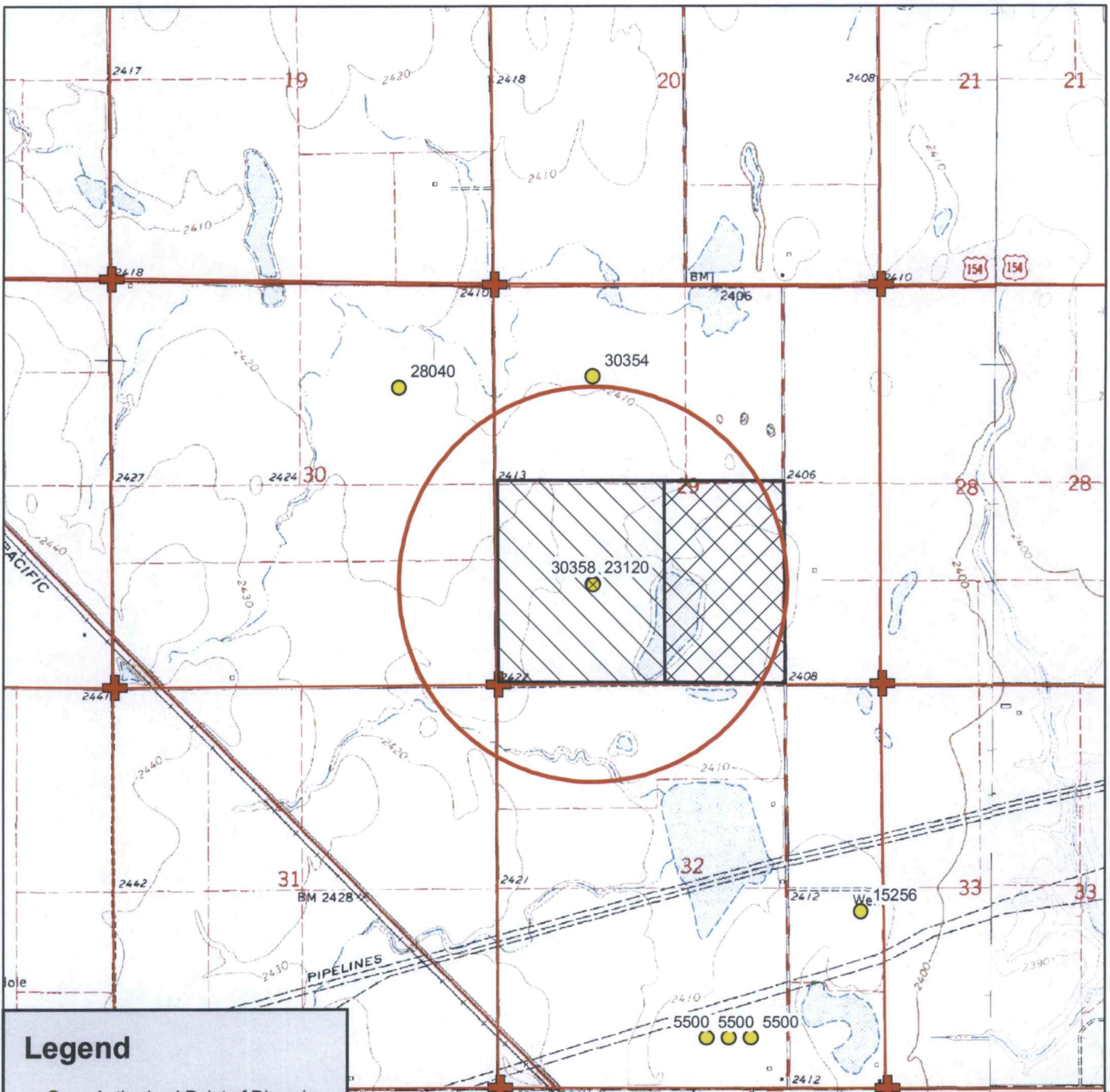

Legend

- Authorized Point of Diversion
- Water Appropriations
- Section Corner
- Section Line
- Domestic Well
- 1/2 Mile Buffer

Place of Use

- Authorized
- Proposed

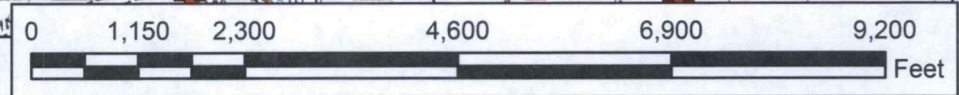

Water Right, File No. 30,358

Change in Place of Use, Application Map
29-28S-21W // Ford County

To the best of my knowledge, all water wells including domestic, within 1/2 mile of the authorized point of diversion have been shown.



RECEIVED







APR 03 2017

Signature
Signature



Stafford Field Office
Division of Water Resources



Legend

-  Authorized Point of Diversion
-  Water Appropriations
-  Section Corner
-  Section Line
-  Domestic Well
-  1/2 Mile Buffer

Place of Use

-  Authorized
-  Proposed

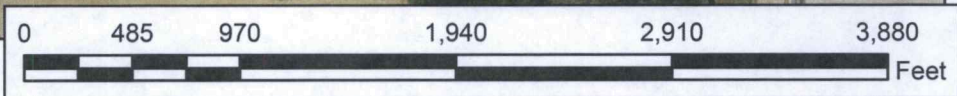

Water Right, File No. 30,358

Change in Place of Use, Aerial Map
29-28S-21W // Ford County



RECEIVED

APR 03 2017

Lana Jentel



Stafford Field Office
300 S. Main Street
Stafford, Kansas 67578-1521
Jackie McClaskey, Secretary
David W. Barfield, Chief Engineer
Jeff Lanterman, Water Commissioner

Phone: (620) 234-5311
Fax: (620) 234-6900
www.agriculture.ks.gov
Sam Brownback, Governor

April 18, 2017

Lance & Heidi Feikert Living Trust
Box 212
Bucklin KS 67834

Re: Water Right, File No(s). 30358

Dear Water Right Owner:

Enclosed is the order executed by the Chief Engineer, Division of Water Resources, Kansas Department of Agriculture, approving the application for change under the above referenced file number(s).

Your attention is directed to the enclosures and to the terms, conditions and limitations specified in this approval for change. An acceptable water flow meter must be installed on your well before any water is applied as authorized under this change approval. A copy of the approved list of Certified Water Flowmeters as well as the regulations regarding the installation of flowmeters, measurement tubes and check valves can be found at <http://agriculture.ks.gov/divisions-programs/dwr/water-appropriation/water-flowmeters>. If you do not have access to the internet, please contact this office and we will send you a paper copy of the referenced information.

Since this order modifies the original document referred to above, it should be recorded with the Register of Deeds as other instruments affecting real estate.

Should you have any questions, please feel free to contact this office. If you wish to refer to a specific file, please reference it when you contact us.

Sincerely,

A handwritten signature in black ink, appearing to read "Jeff Lanterman".

Jeff Lanterman
Water Commissioner

Enclosures

pc: Water Rights Section
Ground Water Management District 3

CERTIFICATE OF SERVICE

On this **18 April 2017**, I hereby certify that the attached Change in Place of Use, File No. 30358 dated April 18, 2017 was mailed to the following:

Lance & Heidi Feikert Living Trust
Box 212
Bucklin KS 67834

pc: Water Rights Section
GMD #3



Staff

Saryerwinnie, Tyler

From: Saryerwinnie, Tyler
Sent: Tuesday, April 04, 2017 10:36 AM
To: 'norquest@gmd3.org'
Cc: Conant, Cameron
Subject: GMD Recommendation Request - File Nos. 23120 & 30358
Attachments: 23120.30358.GMD cover letter.pdf; 23120.Change App.pdf; 30358.Change App.pdf

Jason,

I have attached a cover letter and copies of two (2) place of use change applications for GMD review and recommendation. Please provide the GMD recommendation by no later than April 24, 2017.

Please let me know if you have any questions or concerns.

Thank you,
Tyler

Tyler Saryerwinnie, Environmental Scientist
Kansas Department of Agriculture
Division of Water Resources
Stafford Field Office
Phone: (620)234-5311

Kansas

Department of Agriculture
Division of Water Resources

Stafford Field Office
300 S. Main Street
Stafford, Kansas 67578-1521

Jackie McClaskey, Secretary
David W. Barfield, Chief Engineer
Jeff Lanterman, Water Commissioner

Phone: (620) 234-5311

Fax: (620) 234-6900

www.agriculture.ks.gov

Sam Brownback, Governor

April 4, 2017

Jason Norquest
Southwest Groundwater Management District No. 3
2009 E. Spruce Street
Garden City, Kansas 67846

RE: Place of Use Change Applications, File No(s). 23,120 & 30,358

Dear Mr. Norquest,

We are enclosing copies of the applications, as referenced above, for your review and recommendations. At this time the applications appear to be in proper form.

This office will delay any further action on these files for a period of 15 business days from the date of this letter to allow you time to submit your recommendations concerning the applications. Please submit your recommendations within the allotted time, or any authorized extension of time thereof.

Sincerely,



Tyler Saryerwinnie
Environmental Scientist
Stafford Field Office
tyler.saryerwinnie@ks.gov

Enclosures: Two (2) Change Applications

Saryerwinnie, Tyler

From: Jason Norquest <norquest@gmd3.org>
Sent: Wednesday, April 05, 2017 3:29 PM
To: Saryerwinnie, Tyler
Subject: RE: GMD Recommendation Request - File Nos. 23120 & 30358
Attachments: 23120+_ReviewMat_PU_040517.pdf

And here is this one. Both letters will be in the mail going out tomorrow.

Jason Norquest

Assistant Manager, GMD3
Office: 620-275-7147 Cell: 620-271-1289
norquest@gmd3.org
www.gmd3.org

From: Saryerwinnie, Tyler [<mailto:Tyler.Saryerwinnie@ks.gov>]
Sent: Tuesday, April 04, 2017 10:37 AM
To: Jason Norquest <norquest@gmd3.org>
Cc: Conant, Cameron <Cameron.Conant@ks.gov>
Subject: GMD Recommendation Request - File Nos. 23120 & 30358

Jason,

I have attached a cover letter and copies of two (2) place of use change applications for GMD review and recommendation. Please provide the GMD recommendation by no later than April 24, 2017.

Please let me know if you have any questions or concerns.

Thank you,
Tyler

Tyler Saryerwinnie, Environmental Scientist
Kansas Department of Agriculture
Division of Water Resources
Stafford Field Office
Phone: (620)234-5311



Southwest Kansas
Groundwater Management District No. 3
2009 E. Spruce Street
Garden City, Kansas 67846
(620) 275-7147 phone (620) 275-1431 fax
www.gmd3.org

April 5, 2017

Division of Water Resources
Tyler Saryerwinnie
300 S Main Street
Stafford, Kansas 67578-1521

RE: Applications for Change in Point of Diversion
Water Right, File Nos. 23120 & 30358

Dear Tyler:

We have completed a review of the application for the above referenced water right. The proposal is not in conflict with the Management Program of the Southwest Kansas Groundwater Management District No. 3 (GMD3). The proposed complete overlap in place of use is in accordance with K.A.R. 5-5-11(b)(1). It is therefore recommended that the applications be approved at this time.

Thank you for the opportunity to review the applications and to provide a recommendation. If you have any questions, please don't hesitate to contact us.

Sincerely,

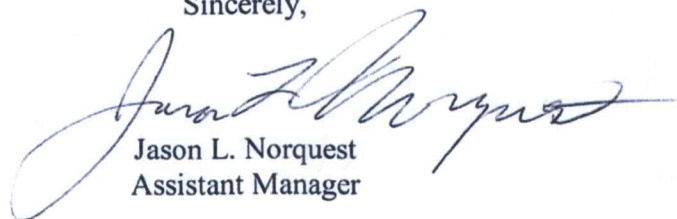

Jason L. Norquest
Assistant Manager

RECEIVED
APR 05 2017
Stafford Field Office
Division of Water Resources

GMD3 Change Review

Change Application(s); PU

File No(s). 23120 & 30358; Lance Feikert

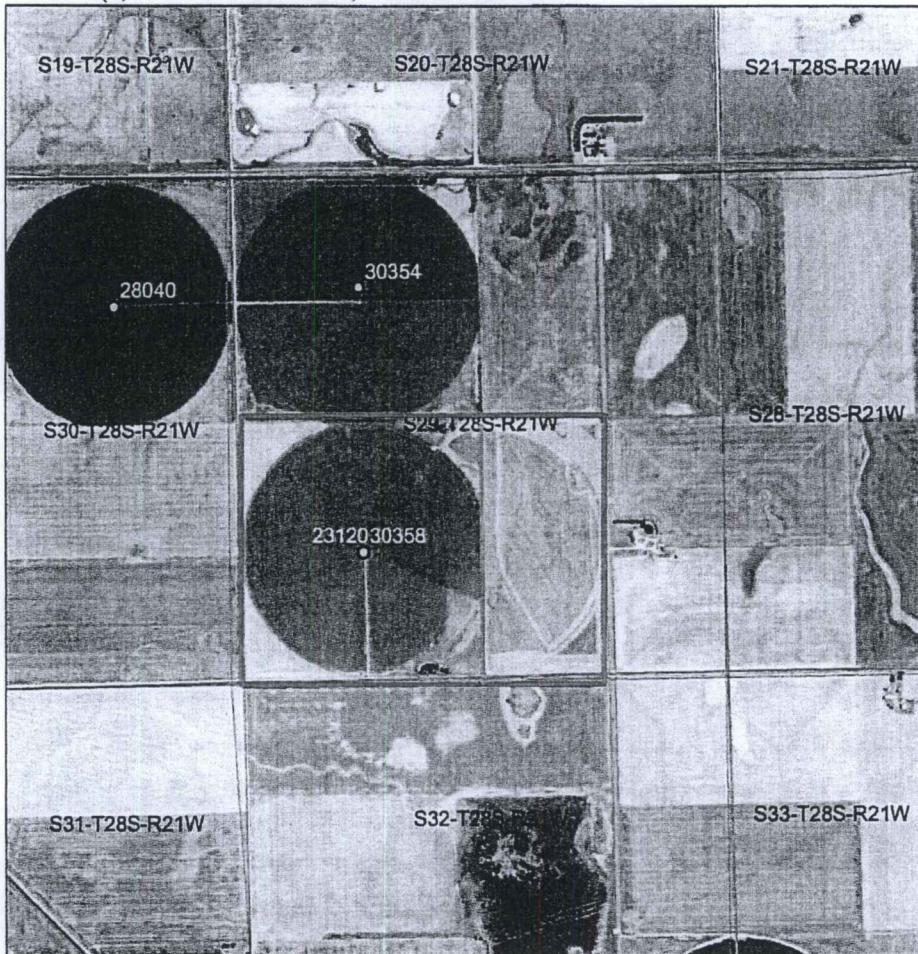

This application is to make a complete overlap. Currently the water rights overlap on the PD, but had separate authorized acres. Now it will be a complete overlap on PD and PU

Neighboring wells: NA

Domestic wells: NA

Regulation(s) Reviewed: KAR 5-5-11

Board Review Date: NA

Board Recommendation: NA

Waiver Reason: NA

Final Recommendation: After review of all available information, it appears current area rules are met. Staff therefore recommends the approval for a complete overlap be approved.

RECEIVED

APR 05 2017

State of Kansas
Division of Water Resources

Entered in transfer record in my office
this 14th day of March A.D.
2017 Dallas GC
County Clerk



INDEXED
GRANTOR
GRANTEE
NUMERICAL
PHOTOGRAPHED

STATE OF KANSAS, FORD COUNTY
This instrument was filed for
Record on 03/14/2017 10:32 AM
BOOK D: B: 248 P: 297
201700743
HERITAGE TRUST FEE: 1.00
RECORDING FEE: 14.00
TECHNOLOGY FEE: 3.00
PAGES: 1
BRENDA FOGUE, REGISTER OF DEEDS



DEED OF EXECUTOR

Robert Austin, as Executrix of the Estate of Roy B. Austin, Deceased, does hereby grant, bargain, sell and convey all of the interest of Roy B. Austin, Deceased, discharged from liability for his debts, in and to the following described real estate in Ford County, Kansas:

SURFACE ESTATE ONLY IN AND TO:
The Southwest Quarter (SW/4) and ~~the West Half of the Southeast Quarter (SW/4) and~~ West Half of the Southeast Quarter (W/2 SE/4) of Section Twenty-nine (29), Township Twenty-eight (28) South, Range Twenty-one (21) West of the 6th P.M., Ford County, Kansas

to **Lance and Heidi Fiekert Living Trust,**

for and in consideration of the sum of \$678,000.00,

This deed given pursuant to an order approving sale entered on the 9th day of March, 2017, in a proceeding in the District Court of Ford County, Kansas, captioned "In the Matter of the Estate of Roy B. Austin, Deceased", Case No: 16 PR 58.

Dated this 13th day of March, 2017,

Taxes: P.O. Box 212
Bucklin KS 67834

Robert Austin Exc
Robert Austin, Executor OEO
Roy B. Austin

ACKNOWLEDGMENT

STATE OF KANSAS,
COUNTY OF FORD, SS:

The foregoing Executor's Deed was acknowledged before me, a notary public, on the 13th day of March, 2017, by Robert Austin as Executor of the Roy B. Austin Estate.

Maria I Rivera
Notary Public

My appointment expires : 10/28/2018

MARIA I RIVERA
NOTARY PUBLIC
STATE OF KANSAS
My Appointment Expires:
10/28/2018

RECEIVED
APR 03 2017
Staff
Division of Resources

