

# CHECK SHEET Short Change

(To be completed and attached to each application)

File No. 48126

Field Office No. 2

GMD No. \_\_\_\_\_

1. **Plugging agreement obtained for GMD?** Yes  No  Non Applicable
2. **Is Landowner correct as currently shown in WRIS?** Yes  No  **Address Change?** NO  
If applicable, list Place of Use Overlap File Nos. 49450, 49544
3. **Is Water Use Correspondent correct as currently shown in WRIS?** Yes  No  **Address Change?** NO  
Name of Former WUC --- Name of New WUC ---
4. a. **Point of diversion computer ID No(s).** N/A for point(s) being changed.

b. **Show feet distances from the** SE **corner of the section for the new point(s) of diversion:**

Action	PDIV ID	Geo Ctr?	Sec	Twp	Rng	'N	'W	County	Qualifiers
NO CHG	79885	YES	10	28S	4W	811	3480	Sedgwick	NW SE SW

c. **If multiple points of diversion exist and rates and quantities are individually assigned, show:**

Old PDIV ID	Authorized Rate	Additional Rate	Authorized Quantity	Additional Quantity
_____	_____ gpm/cfs	_____ gpm/cfs	_____ af/mgy	_____ af/mgy
_____	_____ gpm/cfs	_____ gpm/cfs	_____ af/mgy	_____ af/mgy
_____	_____ gpm/cfs	_____ gpm/cfs	_____ af/mgy	_____ af/mgy

d. **Name of Drainage Basin** --- **Is this correctly shown in WRIS?**  Yes  No

e. **Formation Name & No.** --- **Special Use Area** ---

5. **Distances from the previous/original p/d:** \_\_\_\_\_ ' N / S \_\_\_\_\_ ' E / W

**6. WATER RIGHT ACTION TRAIL COMMENTS**

09/29/2017 Change Application Received (date accepted for priority)  
10 / 5 / 17 Change Approved  
 \_\_\_\_\_ / \_\_\_\_\_ / \_\_\_\_\_ Notice and Proof by \_\_\_\_\_ / \_\_\_\_\_ / \_\_\_\_\_  
 \_\_\_\_\_ / \_\_\_\_\_ / \_\_\_\_\_ Completion Requirement Removed (Change No. C \_\_\_\_\_)

**7. METER ACTION TRAIL COMMENTS**

10 / 5 / 17 DWR Meter Required by 12/31/2017  
 \_\_\_\_\_ / \_\_\_\_\_ / \_\_\_\_\_ Anti-Reverse Meter Required by \_\_\_\_\_ / \_\_\_\_\_ / \_\_\_\_\_  
 \_\_\_\_\_ / \_\_\_\_\_ / \_\_\_\_\_ Meter Seal Required by \_\_\_\_\_ / \_\_\_\_\_ / \_\_\_\_\_

8. Base Acres 107 (Permit) Year --- Minimum Reasonable Quantity 1.05 AF/acre

Date Created **10/3/17** by **TJS**  
Date Entered by

CHECK SHEET ATTACHMENT

9. Changes to the place of use will be:

File Number 48126

Action	Owner Person ID	Place Use ID #	Sec.	Twp.	Range	NE¼				NW¼				SW¼				SE¼				TOTAL ACRES		
						NE¼	NW¼	SW¼	SE¼	NE¼	NW¼	SW¼	SE¼	NE¼	NW¼	SW¼	SE¼	NE¼	NW¼	SW¼	SE¼			
MOD	_____	61678	10	28S	4W	Acres Authorized							0.3	0.2	40	34	32	40			32.5	30.5		209.5
						New Acres											0.3	0.2	40	34	32	40		
ENT	53124	_____	10	28S	4W	Acres Authorized															1.5	2		3.5
						New Acres																		
						Acres Authorized																		
						New Acres																		
						Acres Authorized																		
						New Acres																		

Names and Address:

1. Person ID # _____ Max E Wells Wells M-M Farmland LLC 7069 S 375 <sup>th</sup> St W Cheney KS 67025	2. Person ID # <u>53124</u> Max E Wells Wells M&M Dairy 7069 S 375 <sup>th</sup> St W Cheney KS 67025	3. Person ID # _____     
---	---	--

**GENERAL INSTRUCTIONS**

1. Give to Applicant:
  - a. Original application/approval
  - b. Original receipt (one for each application)
  - c. Information packet containing:
    - Notice and Proof form
    - Water Meter Specifications
    - Acceptable Meter list
    - Water level measurement tube specifications
    - Check Valve specifications
    - Pink Sheet - K.S.A. 82a-728 letter
    - Form stating to record in Register of Deeds Office (OPTIONAL AS NEEDED)

2. Send to headquarters:
  - a. Good, **scannable** copy of application and/or approval and this check sheet
  - b. Original check and copy of receipt
  - c. Test hole log
  - d. GMD recommendation, if any
  - e. Map or aerial photograph, if any
3. Send to KDHE: Letter (KDHE.LT) advising of location of abandoned well.

4. Date stamp received and approved.
5. Complete ownership and WUC change information.

ADDITIONAL PHOTOCOPIES

HQ \_\_\_\_\_

\_\_\_\_\_

\_\_\_\_\_

\_\_\_\_\_

\_\_\_\_\_

\_\_\_\_\_

\_\_\_\_\_

CONDITIONS

1. Insert notice and proof date.
2. Type or print applicant's/owner's name on line.
3. Complete notary statement.

Submit completed application to:  
 Kansas Department of Agriculture  
 Division of Water Resources  
 Field Office for your area.  
 Call for address:

Topeka -- (785) 296-5733  
 Stafford -- (620) 234-5311  
 Stockton -- (785) 425-6787  
 Garden City -- (620) 276-2901  
<http://agriculture.ks.gov/dwr>

# DWR FIELD OFFICE APPLICATION FOR APPROVAL TO CHANGE THE PLACE OF USE AND/OR THE POINT OF DIVERSION WATER METER REQUIRED



**STATE OF KANSAS**

**Filing Fee Must Accompany the Application, K.S.A. 82a-708b(b), as amended.**  
 Fee Schedule is on the third page of this application form.

**Paragraph Nos. 1, 2, 3 & 5 must be completed. Complete all other applicable portions.** If change in point of diversion is greater than 100 feet, or if place of use will be changed, include a topographic map or detailed plat showing the authorized and proposed point(s) of diversion and/or place of use.

File No. 48126

RECEIVED  
 1:02 pm  
 SEP 29 2017

Stafford Field Office  
 Division of Water Resources

1. Application is hereby made for approval of the Chief Engineer to change the (check one or both):

Place of Use       Point of Diversion

under the water right which is the subject of this application in accordance with the conditions described below.

The source of supply is:       Groundwater       Surface water

2. Name and address of Applicant: Max Wells

7051 S 375<sup>th</sup> St W, Cheney KS 67025-9112

Phone Number: (316)393-1780

Email address: \_\_\_\_\_

Name and address of Water Use Correspondent: Wells M-M Farmland LLC

7051 S 375<sup>th</sup> St W, Cheney KS 67025-9112

Phone Number: (316)393-1780

Email address: \_\_\_\_\_

3. The presently authorized place of use is:

Owner of Land ---- NAME: Wells M-M Farmland LLC

ADDRESS: 7051 S 375th St W, Cheney KS 67025-9112

(If there is more than one landowner, attach supplemental sheets as necessary.)

Sec.	Twp.	Range	NE¼				NW¼				SW¼				SE¼				TOTAL ACRES
			NE¼	NW¼	SW¼	SE¼	NE¼	NW¼	SW¼	SE¼	NE¼	NW¼	SW¼	SE¼	NE¼	NW¼	SW¼	SE¼	
10	28S	4W									30	35	31	29					125

4. If this application is for a change in place of use, it is proposed that the place of use be changed to:

Owner of Land ---- NAME: A.) Wells M-M Farmland LLC

// B.) Wells M-M Dairy

ADDRESS: A.) 7051 S 375th St W, Cheney KS 67025-9112 // B.) 7051 S 375<sup>th</sup> St W, Cheney KS 67025-9112

(If there is more than one landowner, attach supplemental sheets as necessary.)

Sec.	Twp.	Range	NE¼				NW¼				SW¼				SE¼				TOTAL ACRES
			NE¼	NW¼	SW¼	SE¼	NE¼	NW¼	SW¼	SE¼	NE¼	NW¼	SW¼	SE¼	NE¼	NW¼	SW¼	SE¼	
A.) 10	28S	4W							0.3	0.2	40	34	32	40			32.5	30.5	209.5
B.) 10	28S	4W															1.5	2	3.5

For Office Use Only: Code \_\_\_\_\_ Fee \$ 200 TR # \_\_\_\_\_ Receipt Date \_\_\_\_\_ Check # 9222

5. **Presently authorized point of diversion:**  
 One in the NW Quarter of the SE Quarter of the SW Quarter of Section 10, Township 28 South, Range 4 W, in Sedgwick County, Kansas, 1003 feet North 3627 feet West of Southeast corner of section.  
 Authorized Rate See Geocenter Authorized Quantity See Geocenter Depth of well NA (feet)  
**(DWR use only: Computer ID No. 6 GPS 921 feet North 3672 feet West)**  
 This point will not be changed  This point will be changed as follows:  No change, point better described with GPS as follows:  
**Proposed point of diversion: (Complete only if change is requested or if existing point is better described by GPS)**  
 One in the \_\_\_\_\_ Quarter of the \_\_\_\_\_ Quarter of the \_\_\_\_\_ Quarter of Section \_\_\_\_\_, Township \_\_\_\_\_ South, Range \_\_\_\_\_ (E/W), in \_\_\_\_\_ County, Kansas, \_\_\_\_\_ feet North \_\_\_\_\_ feet West of Southeast corner of section.  
 Proposed Rate \_\_\_\_\_ Proposed Quantity \_\_\_\_\_ Proposed well depth (feet) \_\_\_\_\_  
 This point is:  Additional Well  Geo Center List other water rights that will use this point 49450

6. **Presently authorized point of diversion:**  
 One in the NW Quarter of the SE Quarter of the SW Quarter of Section 10, Township 28 South, Range 4 W, in Sedgwick County, Kansas, 570 feet North 3303 feet West of Southeast corner of section.  
 Authorized Rate See Geocenter Authorized Quantity See Geocenter Depth of well NA (feet)  
**(DWR use only: Computer ID No. 7 GPS 506 feet North 3321 feet West)**  
 This point will not be changed  This point will be changed as follows:  No change, point better described with GPS as follows:  
**Proposed point of diversion: (Complete only if change is requested or if existing point is better described by GPS)**  
 One in the \_\_\_\_\_ Quarter of the \_\_\_\_\_ Quarter of the \_\_\_\_\_ Quarter of Section \_\_\_\_\_, Township \_\_\_\_\_ South, Range \_\_\_\_\_ (E/W), in \_\_\_\_\_ County, Kansas, \_\_\_\_\_ feet North \_\_\_\_\_ feet West of Southeast corner of section.  
 Proposed Rate \_\_\_\_\_ Proposed Quantity \_\_\_\_\_ Proposed well depth (feet) \_\_\_\_\_  
 This point is:  Additional Well  Geo Center List other water rights that will use this point 49450

7. The changes herein are desired for the following reasons?  
 (please be specific) Creating a complete overlap with File Nos. 49450 and 49544

8. If a well, is the test hole log attached?  Yes  No

9. The change(s) (was)(will be) completed by?  
ASAP

10. If the point of diversion is a well:  
 (a) What are you going to do with the old well?  
NA  
 (b) When will this be done? NA

11. Groundwater Management District recommendation attached?  Yes  No

12. Assisted by TJS - SFFO

13a. If the proposed point of diversion will be relocated within 100 feet of the existing point of diversion, indicate its location on the diagram below in relation to the existing point of diversion. (PLEASE NOTE: The "X" in center of diagram below represents presently authorized point of diversion.)

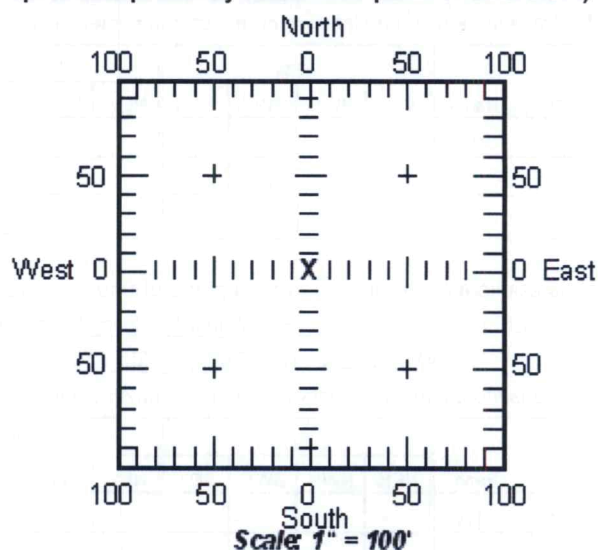

13b. If the proposed point of diversion will be relocated more than 100 feet but within 1320 feet from the existing point of diversion, attach a topographic map or aerial photograph. For groundwater sources, show all wells (including domestic) within one-half mile of the proposed point of diversion and the names and mailing addresses of the owners. For surface water sources, show the names and addresses of the landowner(s) one-half mile downstream and one-half mile upstream from your property lines.

RECEIVED  
 SEP 29 2017

14. If the proposed groundwater point of diversion is 300 or fewer feet from existing point of diversion, complete the following:

- (a) Does the undersigned represent all owners of the currently authorized place(s) of use identified in this application?  
 Yes     No    (If no, all owners must sign this application.)
- (b) Will the ownership interest of any owner of the currently authorized place(s) of use identified in this application be adversely affected if this application is approved as requested?  
 Yes     No    (If yes, all owners must sign this application.)
- (c) If this application is not approved expeditiously, will there be substantial damage to property, public health or safety?  
 Yes     No    (If no, all owners must sign this application.)

If the application proposes a surface water change in point of diversion, a groundwater change in point of diversion greater than 300 feet, or a change in place of use, the application must be signed by all owners of the currently authorized place of use, or their duly authorized agent (attach notarized statement authorizing representation).

I hereby verify, being first duly sworn upon my oath or affirmation and under penalty of perjury, that I am of lawful age and the owner, the spouse of the owner, or a duly authorized agent of the owner(s) to make this application on their behalf, in regards to the water right(s) to which this application pertains. I further verify that the statements contained in this application are true, correct and complete.

Dated at \_\_\_\_\_, Kansas, this \_\_\_\_\_ day of \_\_\_\_\_, 20\_\_\_\_\_.

Max E Wells Manager for both Entities (Owner) \_\_\_\_\_ (Spouse) \_\_\_\_\_  
 \_\_\_\_\_ (Please Print) \_\_\_\_\_ (Please Print)  
 \_\_\_\_\_ (Owner) \_\_\_\_\_ (Spouse) \_\_\_\_\_  
 \_\_\_\_\_ (Please Print) \_\_\_\_\_ (Please Print)  
 \_\_\_\_\_ (Owner) \_\_\_\_\_ (Spouse) \_\_\_\_\_  
 \_\_\_\_\_ (Please Print) \_\_\_\_\_ (Please Print)

State of Kansas }  
County of Stafford } SS

I hereby certify that the foregoing application was signed in my presence and sworn to before me this 29th day of September, 2017 by max E wells, manager for both entities

My Commission Expires \_\_\_\_\_  
  
 \_\_\_\_\_ Notary Public

ONLY COMPLETE APPLICATIONS WILL BE PROCESSED. To be complete, all of the applicable portions of the application form must be completed with accurate information; maps, if necessary, must be included; signatures of all the appropriate owners' must be affixed to the application and notarized; and the appropriate fee must be paid.

**FEE SCHEDULE**

Each application to change the place of use or the point of diversion under this section shall be accompanied by the application fee set forth in the schedule below: Make checks payable to: **Kansas Department of Agriculture**

- (1) Application to change a point of diversion 300 feet or less ..... \$100
- (2) Application to change a point of diversion more than 300 feet ..... \$200
- (3) Application to change the place of use ..... \$200



**SUMMARY ORDER APPROVING APPLICATION FOR CHANGE AND IMPOSING CONDITIONS**

This Summary Order is issued under authority of K.S.A. 82a-708b, as amended, and K.A.R. 5-5-1, *et seq.* and other applicable provisions of the *Kansas Water Appropriation Law, K.S.A. 82a-701 et. seq.*, and rules and regulations promulgated thereunder, With the exception of those conditions expressly contained herein, this Summary Order does not change the terms, conditions and limitations of File No. 48126.

1. A change application was received on September 29, 2017 requesting that the place of use and / or point of diversion authorized under the above-referenced file number be changed as described in the application.
2. On and after the effective date of this summary order, the authorized place(s) of use shall be located substantially as shown on the topographic map accompanying the application to change the place of use.  Applicable  Not Applicable
3. The change in point of diversion shall not impair existing rights and shall be limited to the same source or sources of water as previously authorized. The point of diversion authorized by this summary order shall be located within a \_\_\_\_\_ foot radius of the authorized point(s) of diversion.  Applicable  Not Applicable
4. The point(s) of diversion authorized herein shall not actually be located more than \_\_\_\_\_ feet from the previously authorized point(s) of diversion.  Applicable  Not Applicable
5. As required by K.A.R. 5-3-5d, if the works for diversion is a well with a diversion rate of 100 gallons per minute or more, a tube or other device suitable for making water level measurements shall be installed, operated and maintained in accordance with K.A.R. 5-6-13.  Applicable  Not Applicable
6. **The owner of the authorized place(s) of use shall properly install an acceptable water flow meter on or before December 31, 2017**, or before the first use of water, whichever occurs first. The water flow meter shall be installed, operated and maintained in accordance with K.A.R. 5-1-4 through 5-1-12. As required by K.S.A. 82a-732, as amended, and K.A.R. 5-3-5e, the owner shall maintain records and report the reading of the water flow meter and the total quantity of water diverted annually to the Chief Engineer by March 1 following the end of each calendar year.  Applicable  Not Applicable
7. **Installation of the works for diversion of water shall be completed on or before December 31, 20\_\_\_\_**, or within any authorized extension of time. By March 1, 20\_\_\_\_ the applicant shall notify the Chief Engineer that construction of the works for diversion has been completed, on the form provided by the Chief Engineer, as required by K.A.R. 5-8-4e.  Applicable  Not Applicable
8. **The completed well log shall be submitted with the required notice.**  Applicable  Not Applicable
9. All diversion works into which any type of chemical or other foreign substance will be injected into the water shall be equipped with an in-line, automatic, quick-closing check valve capable of preventing pollution of the source of the water supply. The check valve(s) shall be installed, operated and maintained in accordance with K.A.R. 5-3-5c.  Applicable  Not Applicable
10. Additional Conditions are attached.  Yes  No
11. In accordance with K.S.A. 82a-708a, as amended, and K.A.R. 5-5-14, all of the owners of the authorized place(s) of use of water appropriated under the above-referenced file number are responsible for compliance with its terms, conditions and limitations, as amended and/or supplemented by this Summary Order, and with applicable provisions of the *Kansas Water Appropriation Law* and the *Rules and Regulations* promulgated thereunder. Failure to comply with these provisions may result in civil penalties pursuant to K.S.A. 82a-737, as amended, and/or the suspension or revocation and dismissal of the water or appropriation right or any other enforcement actions authorized by law.

**Administrative Appeal and Effective Date of Order**

If you are aggrieved by this order, pursuant to K.S.A. 82a-1901, you may request an evidentiary hearing before the Chief Engineer or request administrative review by the Secretary of Agriculture. A request for hearing by the Chief Engineer must be filed within **15 days** of service of this Order and a request for administrative review by the Secretary must be filed within **30 days** pursuant to K.S.A. 77-531. Any request for administrative review must state a basis for review pursuant to K.S.A. 77-527. File any request with **Kansas Department of Agriculture, Legal Division, 1320 Research Park Drive, Manhattan, KS 66502**. Failure to timely request a hearing or review may preclude review under the Kansas Judicial Review Act.

*For Use by Register of Deeds*

FOR OFFICE USE ONLY  
**APPLICATION APPROVED AND SUMMARY ORDER ISSUED**

By: Cameron R. Conant  
Duly Authorized Designee of the Chief Engineer  
(Print Name): Cameron R. Conant  
Division of Water Resources - Kansas Department of Agriculture

Date of Issuance: 10/5/17

State of Kansas )  
County of Stafford ) SS

Acknowledged before me on 10/05/17  
by Cameron Conant

Signature: Jessica Engelbrecht



My commission expires \_\_\_\_\_

(Notary Seal)

File No. 48126

RECEIVED

SEP 29 2017

APPLICATION FOR APPROVAL TO CHANGE  
THE PLACE OF USE AND/OR POINT OF DIVERSION  
SUPPLEMENTAL SHEET  
FILE NO. 48126

**Presently authorized point of diversion:**  
One in the NW Quarter of the SE Quarter of the SW Quarter  
of Section 10, Township 28 South, Range 4 W,  
in Sedgwick County, Kansas, 1009 feet North 3304 feet West of Southeast corner of section.  
Authorized Rate See Geocenter Authorized Quantity See Geocenter Depth of well NA (feet)  
(DWR use only: Computer ID No. 9 GPS 1008 feet North 3350 feet West)  
 This point will not be changed  This point will be changed as follows:  No redrill, point better described with GPS as follows:  
**Proposed point of diversion: (Complete only if change is requested)**  
One in the \_\_\_\_\_ Quarter of the \_\_\_\_\_ Quarter of the \_\_\_\_\_ Quarter  
of Section \_\_\_\_\_, Township \_\_\_\_\_ South, Range \_\_\_\_\_ (E/W),  
in \_\_\_\_\_ County, Kansas, \_\_\_\_\_ feet North \_\_\_\_\_ feet West of Southeast corner of section.  
Proposed Rate \_\_\_\_\_ Proposed Quantity \_\_\_\_\_ Proposed well depth (feet) \_\_\_\_\_  
This point is:  Additional Well  Geo Center List other water rights that will use this point 49450

**Presently authorized point of diversion:**  
One in the NW Quarter of the SE Quarter of the SW Quarter  
of Section 10, Township 28 South, Range 4 W,  
in Sedgwick County, Kansas, 662 feet North 3687 feet West of Southeast corner of section.  
Authorized Rate See Geocenter Authorized Quantity See Geocenter Depth of well NA (feet)  
(DWR use only: Computer ID No. 10 GPS 575 feet North 3686 feet West)  
 This point will not be changed  This point will be changed as follows:  No redrill, point better described with GPS as follows:  
**Proposed point of diversion: (Complete only if change is requested)**  
One in the \_\_\_\_\_ Quarter of the \_\_\_\_\_ Quarter of the \_\_\_\_\_ Quarter  
of Section \_\_\_\_\_, Township \_\_\_\_\_ South, Range \_\_\_\_\_ (E/W),  
in \_\_\_\_\_ County, Kansas, \_\_\_\_\_ feet North \_\_\_\_\_ feet West of Southeast corner of section.  
Proposed Rate \_\_\_\_\_ Proposed Quantity \_\_\_\_\_ Proposed well depth (feet) \_\_\_\_\_  
This point is:  Additional Well  Geo Center List other water rights that will use this point 49450

**Presently authorized point of diversion: (GEOCENTER)**  
One in the NW Quarter of the SE Quarter of the SW Quarter  
of Section 10, Township 28 South, Range 4 W,  
in Sedgwick County, Kansas, 811 feet North 3480 feet West of Southeast corner of section.  
Authorized Rate No Change Authorized Quantity No Change Depth of well NA (feet)  
(DWR use only: Computer ID No. 11 GPS 753 feet North 3507 feet West)  
 This point will not be changed  This point will be changed as follows:  No redrill, point better described with GPS as follows:  
**Proposed point of diversion: (Complete only if change is requested)**  
One in the \_\_\_\_\_ Quarter of the \_\_\_\_\_ Quarter of the \_\_\_\_\_ Quarter  
of Section \_\_\_\_\_, Township \_\_\_\_\_ South, Range \_\_\_\_\_ (E/W),  
in \_\_\_\_\_ County, Kansas, \_\_\_\_\_ feet North \_\_\_\_\_ feet West of Southeast corner of section.  
Proposed Rate \_\_\_\_\_ Proposed Quantity \_\_\_\_\_ Proposed well depth (feet) \_\_\_\_\_  
This point is:  Additional Well  Geo Center List other water rights that will use this point 49450

**Presently authorized point of diversion:**  
One in the \_\_\_\_\_ Quarter of the \_\_\_\_\_ Quarter of the \_\_\_\_\_ Quarter  
of Section \_\_\_\_\_, Township \_\_\_\_\_ South, Range \_\_\_\_\_ (E/W),  
in \_\_\_\_\_ County, Kansas, \_\_\_\_\_ feet North \_\_\_\_\_ feet West of Southeast corner of section.  
Authorized Rate \_\_\_\_\_ Authorized Quantity \_\_\_\_\_ Depth of well \_\_\_\_\_ (feet)  
(DWR use only: Computer ID No. \_\_\_\_\_ GPS \_\_\_\_\_ feet North \_\_\_\_\_ feet West)  
 This point will not be changed  This point will be changed as follows:  No redrill, point better described with GPS as follows:  
**Proposed point of diversion: (Complete only if change is requested)**  
One in the \_\_\_\_\_ Quarter of the \_\_\_\_\_ Quarter of the \_\_\_\_\_ Quarter  
of Section \_\_\_\_\_, Township \_\_\_\_\_ South, Range \_\_\_\_\_ (E/W),  
in \_\_\_\_\_ County, Kansas, \_\_\_\_\_ feet North \_\_\_\_\_ feet West of Southeast corner of section.  
Proposed Rate \_\_\_\_\_ Proposed Quantity \_\_\_\_\_ Proposed well depth (feet) \_\_\_\_\_  
This point is:  Additional Well  Geo Center List other water rights that will use this point \_\_\_\_\_

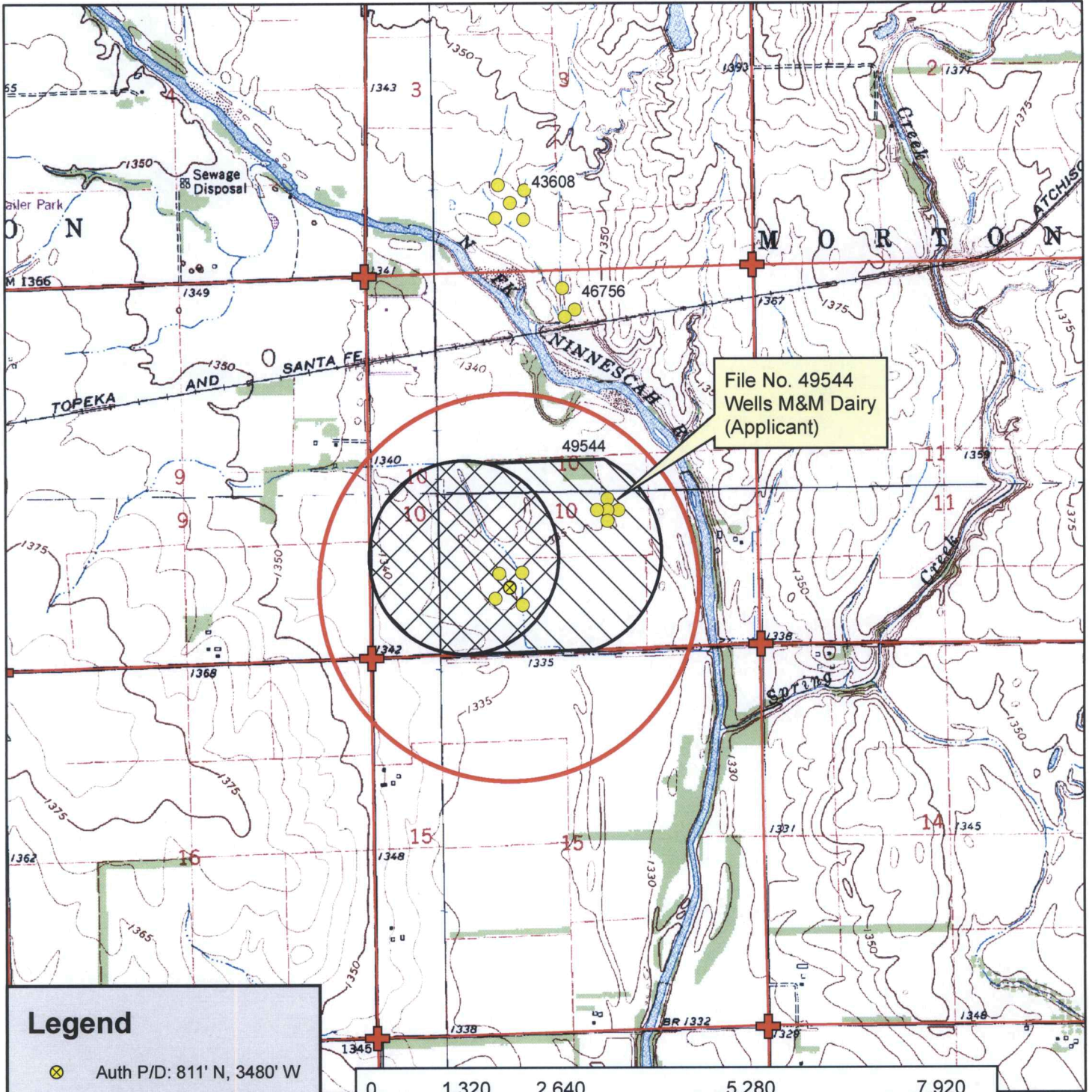

File No. 49544  
Wells M&M Dairy  
(Applicant)

**Legend**

- ⊗ Auth P/D: 811' N, 3480' W
- Water Appropriations
- ⊕ Section Corner
- ▭ Section Line
- ★ Domestic Well
- ▭ 1/2 Mile Buffer

**Place of Use**

- ▨ Authorized
- ▨ Proposed

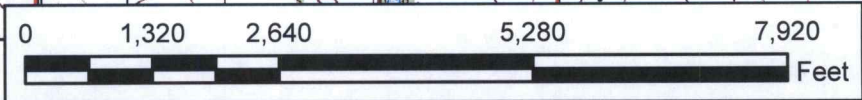

**Water Appropriation, File No. 48126**  
Change in Place of Use Application Map  
10-28S-4W // Sedgwick County



To the best of my knowledge, all water wells including domestic, within 1/2 mile of the authorized point of diversion have been shown.

RECEIVED  
SEP 29 2017

*Max E. Wells* 9-29-17





Stafford Field Office  
300 S. Main Street  
Stafford, Kansas 67578-1521

Jackie McClaskey, Secretary  
David W. Barfield, Chief Engineer  
Jeff Lanterman, Water Commissioner

Phone: (620) 234-5311  
Fax: (620) 234-6900  
[www.agriculture.ks.gov](http://www.agriculture.ks.gov)  
Sam Brownback, Governor

October 6, 2017

Max E Wells  
Wells M-M Farmland LLC  
7069 S 375<sup>th</sup> St W  
Cheney KS 67025

Re: Water Right, File No(s). 48126

Dear Water Right Owner:

Enclosed is the order executed by the Chief Engineer, Division of Water Resources, Kansas Department of Agriculture, approving the application for change under the above referenced file number(s).

Your attention is directed to the enclosures and to the terms, conditions and limitations specified in this approval for change. An acceptable water flow meter must be installed on your well before any water is applied as authorized under this change approval. A copy of the approved list of Certified Water Flowmeters as well as the regulations regarding the installation of flowmeters, measurement tubes and check valves can be found at <http://agriculture.ks.gov/divisions-programs/dwr/water-appropriation/water-flowmeters>. If you do not have access to the internet, please contact this office and we will send you a paper copy of the referenced information.

Since this order modifies the original document referred to above, it should be recorded with the Register of Deeds as other instruments affecting real estate.

Should you have any questions, please feel free to contact this office. If you wish to refer to a specific file, please reference it when you contact us.

Sincerely,

A handwritten signature in black ink, appearing to read "Jeff Lanterman".

Jeff Lanterman  
Water Commissioner

Enclosures

pc: Water Rights Section

## CERTIFICATE OF SERVICE

On this **6 October 2017**, I hereby certify that the attached Change in Place of Use, File No. 48126 dated October 05, 2017 was mailed to the following:

Max E Wells  
Wells M-M Farmland LLC  
7069 S 375<sup>th</sup> St W  
Cheney KS 67025

pc: Water Rights Section

  
-----  
Staff



# KANSAS DEPARTMENT OF AGRICULTURE

Division of Water Resources

Stafford Field Office

## MEMORANDUM

---

**TO:** File

**DATE:** 9/29/2017

**FROM:** Tyler Saryerwinnie

**RE:** File Nos. 48126, 49450, 49544

This is a memorandum regarding surrounding well owner notification on irrigation field office PU changes and pertains to decisions made during the Water Commissioner meeting which took place on 11/16/2016. With directive from Lane Letourneau Program Manager.

This is applicable to field office changes to increase the place of use by 10 acres or 10% (whichever is less) or a change in place of use to create a complete overlap in which no new acres are being irrigated.

During that meeting it was determined that no surrounding well owner notification will be sent under this type of Place of Use change. All well rates and quantities will remain unchanged and the referenced change will not cause impairment or impact surrounding well owners.

The change in place of use applications filed on 9/29/2017 for the above referenced files meet this criteria and surrounding well owners will not be notified.



# KANSAS DEPARTMENT OF AGRICULTURE

Division of Water Resources

Stafford Field Office

## MEMORANDUM

---

**TO:** File

**DATE:** 10/03/2017

**FROM:** Tyler Saryerwinnie

**RE:** File No. 48126, 49450, & 49544

Three (3) applications to change the place of use under the above referenced water appropriations were filed on September 29, 2017. The applicant, water use correspondent, and ownership addresses on each application reflect information found on the Sedgwick County Parcel Search.

Max Wells, who represents both Wells M-M Farmland LLC and Wells M-M Dairy, indicated during an office visit that the address included on the change applications (7051 S 375<sup>th</sup> St W, Cheney KS 67025-9112) was the billing address for both entities. He requested that there not be any changes to the addresses previously on file in our office and WRIS. The correct address for ownership should be as follows:

*Max E Wells  
Wells M-M Farmland LLC  
7069 S 375<sup>th</sup> St W  
Cheney KS 67025*

*PID:53124  
Max E Wells  
Wells M&M Dairy  
7069 S 375<sup>th</sup> St W  
Cheney KS 67025*

The correct water use correspondent should be the current correspondent listed in WRIS:

*PID:53124  
Max E Wells  
Wells M&M Dairy  
7069 S 375<sup>th</sup> St W  
Cheney KS 67025*