

File No. **49,178** 15. Formation Code: 190 Drainage Basin: Little Arkansas County: HV Special Use: Stream:

16. Points of Diversion										
MOD	DEL	ENT	PDIV	Qualifier	S	T	R	ID	'N	'W
										Battery ID #2017
MOD			83542	NE SW NE	2	22S	3W	6	3514	1834 Geo-Cent
ENT			85978	NE SW NE	2	22S	3W		3714	1634 Bat 1 of 4
ENT			85979	NW SW NE	2	22S	3W		3714	2034 Bat 2 of 4
ENT			85980	NE SW NE	2	22S	3W		3314	1634 Bat 3 of 4
ENT			85981	NWSW NE	2	22S	3W		3314	2034 Bat 4 of 4

17. Rate and Quantity				
Authorized		Additional		
Rate gpm	Quantity af	Rate gpm	Quantity af	Overlap PD Files
800	188.5	800	188.5	

18. Storage: Rate _____ NF Quantity _____ ac/ft Additional Rate _____ NF Additional Quantity _____ ac/ft

19. Limitation: _____ - af/yr at _____ - gpm (_____ cfs) when combined with file number(s) _____
 Limitation: _____ - af/yr at _____ - gpm (_____ cfs) when combined with file number(s) _____

20. Meter Required? Yes No To be installed by 12/31/2018 Date Acceptable Meter Installed _____

21. Place of Use		NE 1/4				NW 1/4				SW 1/4				SE 1/4				Total	Owner	Chg?	Overlap Files		
MOD	DEL	ENT	PUSE	S	T	R	ID	NE 1/4	NW 1/4	SW 1/4	SE 1/4	NE 1/4	NW 1/4	SW 1/4	SE 1/4	NE 1/4	NW 1/4	SW 1/4	SE 1/4				
√			66323	2	22S	3W	4			40	33.6					40	40			153.6	7b.		N

Comments: **Quantity and rate were reduced during processing at request of applicant. Changed from single well to battery of wells, location of Geo-center was modified, and ownership of PD & PU was changed as well.**

KANSAS DEPARTMENT OF AGRICULTURE
Division of Water Resources

M E M O R A N D U M

TO: Files

DATE: March 16, 2017

FROM: Matt Meier

RE: Application, File No. 49,178

Brain Bretz has filed the referenced application to appropriate groundwater for irrigation use, requesting a battery of four (4) wells, a quantity of 188.5 acre-feet, and a diversion rate of 800 gallons per minute. The proposed well is to be located in the Northeast Quarter of the Southwest Quarter of the Northeast Quarter (NE $\frac{1}{4}$ SW $\frac{1}{4}$ NE $\frac{1}{4}$) of Section 2, more particularly described as being near a point 3,514 feet North and 1,834 feet West of the Southeast corner of said section, in Township 22 South, Range 3 West, Harvey County, within the Little Arkansas drainage basin. The proposed point of diversion is located within the boundaries of Equus Beds Groundwater Management District No. 2. There are no existing water rights overlapping the proposed point of diversion and place of use. The proposed place of use is owned by the Blazefork Farms LLC (ownership changed during processing of application). The applicant signed the application form stating that they have legal access to the point of diversion.

Multiple modifications were made to the application (including reducing quantity, rate, and modifying geo-center location) because of the conditions Equus Beds Groundwater Management District No. 2 required for approval. The applicant stated they were aware of the conditions and ok making them via a phone call and email on March 14, 2017.

The applicant identified 1 domestic well within one-half mile of the proposed well and 1 non-domestic wells, which WRIS confirmed. Nearby well notification letters were sent out on April 29, 2015. A phone call was received from Ernie Kreibel who called to complain about the well location and state he felt it should be moved further away from his well. According to the WRIS database, the nearest non-domestic point of diversion (File No. 42,507) is located 2,120 feet away. Based on the site map the nearest domestic well is approximately 1,600 feet away. The proposed point of diversion meets minimum well spacing to all other existing wells. Per the requirements in K.A.R. 5-22-2(a) for wells located within Equus Beds Groundwater Management District No. 2, the minimum well spacing should be 1,320 feet to all other non-domestic wells and 660 feet to domestic wells.

A test hole log submitted with the application shows top soil from 0 to 3 feet, tan clay from 3 to 48 feet, fine sand with clay from 48 to 53 feet, small to fine sand from 53 to 67 feet, tan clay from 67 to 69 feet, fine sand with clay from 69 to 74 feet, and green shale from 74 to 75 feet below ground. Static water level was listed at 43 feet which provides a saturated thickness of 31 feet.

The requested quantity of water, which was reduced to 188.5 acre-feet to comply with GMD#2 approval conditions, is to irrigate the proposed 153.6 acres identified in the application. This is 1.23 acre-feet per acre which is slightly less than the maximum 1.3 acre-feet per acre allowed for Reno County, Kansas. There are multiple pending applications in this general area of the state, and they are being worked in priority order to ensure that senior applications are provided the available water.

A copy of the application was submitted to Equus Beds Groundwater Management District No. 2 on May 27, 2015. GMD #2 recommended denial of the application in a letter received on February 8, 2016. The denial recommendation was based on a long-term groundwater decline trend that was observed in the area. The applicant appealed the decision to the Board of Directors on February 15, 2016. On March 13, 2017, a letter recommending approval of the application was received (see included letter for full discussion and recommendation). In the letter, they said the Board of Directors recommended approval of the application subject to the following conditions:

1. The proposed annual quantity of water is reduced to 188.5 acre-feet;
2. The proposed maximum rate of diversion is reduced to 800 gpm to comply with the "Battery of wells" definition K.A.R. 5-33-1(n);
3. The proposed well battery geo-center is moved 200 feet south and 200 feet east of the currently proposed location;
4. The implementation of the enclosed groundwater-monitoring schedule which includes monitoring for water level fluctuations and water quality to be taken at the proposed point of diversion, dedicated monitoring well, and irrigation well authorized by Water Right No. 42507 for minimum period of ten (10) years;
5. Installation of the monitoring well and implementation of the groundwater monitoring plan at the applicants expense; and
6. Construction of the monitoring well pursuant to District specifications (copy enclosed) to allow for inorganic water quality analyses.

In accordance with K.S.A. 82a-706c, the Chief Engineer retains full authority to require any water user to install meters, gages, or other measuring devices, which devices he or she or his or her agents may read at any time. Water flowmeter requirements are further described in K.A.R. 5-1-4 through K.A.R. 5-1-12. If any chemical or foreign substance is injected into the water pumped under this permit, a check valve will also need to be installed.

The proposed application is subject to minimum desirable streamflow requirements. The applicant signed, notarized, and returned the required form to our office.

Jeff Lanterman, Water Commissioner, Stafford Field Office, recommended approval of the referenced application on March 15, 2017. Based on the above discussion, well spacing and safe yield criteria are met, and approval of the application will not impair senior water rights nor prejudicially or unreasonably affect the public interest, it is recommended that the referenced application be approved.

Matthew J. Meier
Environmental Scientist
Water Appropriations Unit



1320 Research Park Drive
Manhattan, Kansas 66502
Jackie McClaskey, Secretary

Phone: (785) 564-6700
Fax: (785) 564-6777
Email: ksag@kda.ks.gov
www.agriculture.ks.gov
Sam Brownback, Governor

BRIAN BRETZ
1770 APACHE RD
MOUNDRIDGE KS 67107

March 30, 2017 **FILE COPY**

RE: Application, File No. 49,178

Dear Mr. Bretz:

There is enclosed a permit to appropriate water authorizing you to proceed with construction of the proposed diversion works (except those dams and stream obstructions regulated by K.S.A. 82a-301 through 305a), to divert such unappropriated water as may be available from the source and at the location specified in the permit, and to use it for the purpose and at the location described in the permit.

Your attention is directed to the enclosures and to the terms, conditions, and limitations specified in this permit. A water meter is required and you must install it prior to water being put to beneficial use in order for you to maintain accurate records of water use. The meter should be used to provide the information required on the annual water use report.

Failure to notify the Chief Engineer of the Division of Water Resources of the completion of the diversion works within the time allowed, or within any authorized extension of time thereof, will result in the dismissal of this permit. Enclosed is a form which may be used to notify the Chief Engineer that the proposed diversion works have been completed.

All requests for extensions of time to complete diversion works, or to perfect appropriations, must be submitted to the Chief Engineer before the expiration of time originally set forth in the permit to complete diversion works or to perfect an appropriation. If for any reason, you require an extension of time, you must request it before the expiration of time set forth in this permit. Failure to comply with this regulation will result in the dismissal of your permit or your water right. Any request for an extension of time shall be accompanied by the required statutory fee, which is currently \$100.00.

There is also enclosed an information sheet setting forth the procedure to obtain a Certificate of Appropriation which will establish the extent of your water right. If you have any questions, please contact our office. If you wish to discuss this specific file, please have the file number ready so that we may help you more efficiently.

Sincerely,

Brent A. Turney, PG.
Change Application Unit Supervisor
Water Appropriation Program

Enclosures

pc: Stafford Field Office
GMD#2

THE STATE OF KANSAS



KANSAS DEPARTMENT OF AGRICULTURE
Jackie McClaskey, Secretary of Agriculture

DIVISION OF WATER RESOURCES
David W. Barfield, Chief Engineer

**APPROVAL OF APPLICATION
and
PERMIT TO PROCEED**
(This Is Not a Certificate of Appropriation)

This is to certify that I have examined Application, File No. 49,178 of the applicant

**BRIAN BRETZ
1770 APACHE RD
MOUNDRIDGE KS 67107**

for a permit to appropriate water for beneficial use, together with the maps, plans and other submitted data, and that the application is hereby approved and the applicant is hereby authorized, subject to vested rights and prior appropriations, to proceed with the construction of the proposed diversion works (except those dams and stream obstructions regulated by K.S.A. 82a-301 through 305a, as amended), and to proceed with all steps necessary for the application of the water to the approved and proposed beneficial use and otherwise perfect the proposed appropriation subject to the following terms, conditions and limitations:

1. That the priority date assigned to such application is **September 15, 2014**.
2. That the water sought to be appropriated shall be used for irrigation use on land described in the application, as follows:

Sec.	Twp.	Range	NE¼				NW¼				SW¼				SE¼				TOTAL			
			NE¼	NW¼	SW¼	SE¼	NE¼	NW¼	SW¼	SE¼	NE¼	NW¼	SW¼	SE¼	NE¼	NW¼	SW¼	SE¼				
2	22S	3W			40	33.6												40	40			153.6

3. That the authorized source from which the appropriation shall be made is groundwater, to be withdrawn by means of a battery of four (4) wells, the geo-center of which is to be located in the Northeast Quarter of the Southwest Quarter of the Northeast Quarter (NE¼ SW¼ NE¼) of Section 2, more particularly described as being near a point 3,514 feet North and 1,834 feet West of the Southeast corner of said section, in Township 22 South, Range 3 West, Harvey County, located substantially as shown on the topographic map accompanying the application.

4. That the appropriation sought shall be limited to a maximum diversion rate not in excess of **800 gallons per minute (1.783 c.f.s.)** and to a quantity not to exceed **188.5 acre-feet** of water for any calendar year.

5. That installation of works for diversion of water shall be completed on or before **December 31, 2018** or within any authorized extension thereof. The applicant shall notify the Chief Engineer and pay the statutorily required field inspection fee of \$400.00 when construction of the works has been completed. Failure to timely submit the notice and the fee will result in revocation of the permit. Any request for an extension of time shall be submitted prior to the expiration of the deadline and shall be accompanied by the required statutory fee of \$100.00.

6. That the proposed appropriation shall be perfected by the actual application of water to the proposed beneficial use on or before **December 31, 2022** or any authorized extension thereof. Any request for an extension of time shall be submitted prior to the expiration of the deadline and shall be accompanied by the required statutory fee of \$100.00.

7. That the applicant shall not be deemed to have acquired a water appropriation for a quantity in excess of the amount approved herein nor in excess of the amount found by the Chief Engineer to have been actually used for the approved purpose during one calendar year subsequent to approval of the application and within the time specified for perfection or any authorized extension thereof.

8. That the use of water herein authorized shall not be made so as to impair any use under existing water rights nor prejudicially and unreasonably affect the public interest.

9. That the right of the appropriator shall relate to a specific quantity of water and such right must allow for a reasonable raising or lowering of the static water level and for the reasonable increase or decrease of the streamflow at the appropriator's point of diversion.

10. That this permit does not constitute authority under K.S.A. 82a-301 through 305a to construct any dam or other obstruction; nor does it grant any right-of-way, or authorize entry upon or injury to, public or private property.

11. That all diversion works constructed under the authority of this permit into which any type of chemical or other foreign substance will be injected into the water pumped from the diversion works shall be equipped with an in-line, automatic quick-closing, check valve capable of preventing pollution of the source of the water supply. The type of valve installed shall meet specifications adopted by the Chief Engineer and shall be maintained in an operating condition satisfactory to the Chief Engineer.

12. That an acceptable water flow meter shall be installed and maintained on the diversion works authorized by this permit in accordance with Kansas Administrative Regulations 5-1-4 through 5-1-12 adopted by the Chief Engineer. This water flow meter shall be used to provide an accurate quantity of water diverted as required for the annual water use report (including the meter reading at the beginning and end of the report year).

13. That all wells with a diversion rate of 100 gallons per minute or more drilled under the authority of this permit shall have a tube or other device installed in a manner acceptable to, and in accordance with specifications adopted by, the Chief Engineer. This tube or device shall be suitable for making water level measurements and shall be maintained in a condition satisfactory to the Chief Engineer.

14. That the applicant shall maintain accurate and complete records from which the quantity of water diverted during each calendar year may be readily determined and the applicant shall file an annual water use report with the Chief Engineer by March 1 following the end of each calendar year. Failure to file the annual water use report by the due date shall cause the applicant to be subject to a civil penalty.

15. That no water user shall engage in nor allow the waste of any water diverted under the authority of this permit.

16. That failure without cause to comply with provisions of the permit and its terms, conditions and limitations will result in the forfeiture of the priority date, revocation of the permit and dismissal of the application.

17. That the right to appropriate water under authority of this permit is subject to any minimum desirable streamflow requirements identified and established pursuant to K.S.A. 82a-703c for the source of supply to which this water right applies.

CERTIFICATE OF SERVICE

On this 30th day of March, 2017, I hereby certify that the foregoing Approval of Application and Permit to Proceed, File No. 49,178, dated March 24, 2017 was mailed postage prepaid, first class, US mail to the following:

BRIAN BRETZ
1770 APACHE RD
MOUNDRIDGE KS 67107

With photocopies to:

Equus Beds Groundwater Management District #2
Stafford Field Office



Division of Water Resources

WATER RESOURCES RECEIVED

DEC 04 2014

KS DEPT OF AGRICULTURE

APPLICATION COMPLETE
12/4/14
Reviewer MGA

THE STATE OF KANSAS



KANSAS DEPARTMENT OF AGRICULTURE
Jackie McClaskey, Secretary of Agriculture

DIVISION OF WATER RESOURCES
David W. Barfield, Chief Engineer

File Number 49178
This item to be completed by the Division of Water Resources.

WATER RESOURCES RECEIVED

SEP 15 2014
3:04

KS DEPT OF AGRICULTURE

APPLICATION COMPLETE
3/13/14
Reviewer MGA

APPLICATION FOR PERMIT TO APPROPRIATE WATER FOR BENEFICIAL USE

Filing Fee Must Accompany the Application
(Please refer to Fee Schedule attached to this application form.)

To the Chief Engineer of the Division of Water Resources, Kansas Department of Agriculture,
1320 Research Park Drive, Manhattan, Kansas 66502:

1. Name of Applicant (Please Print): Brian Bretz
Address: 1770 Apache Road
City: Moundridge State KS Zip Code 67107
Telephone Number: (620) 899-5765

2. The source of water is: surface water in _____ (stream)
OR groundwater in Little Arkansas River Drainage Basin - Equus Beds Aquifer (drainage basin)

Certain streams in Kansas have minimum target flows established by law or may be subject to administration when water is released from storage for use by water assurance district members. If your application is subject to these regulations on the date we receive your application, you will be sent the appropriate form to complete and return to the Division of Water Resources.

3. The maximum quantity of water desired is 188.5 acre-feet OR 3/14/17 rate & quantity reduced at applicant's request to meet conditions required by GMD#2. Confirmed via phone call & email. gallons per calendar year,
to be diverted at a maximum rate of 800 gallons per minute OR _____ cubic feet per second.

Once your application has been assigned a priority, the requested maximum rate of diversion and maximum requested quantity of water under that priority number can **NOT** be increased. Please be certain your requested maximum rate of diversion and maximum quantity of water are appropriate and reasonable for your proposed project and are in agreement with the Division of Water Resources' requirements.

4. The water is intended to be appropriated for (Check use intended):
(a) Artificial Recharge (b) Irrigation (c) Recreational (d) Water Power
(e) Industrial (f) Municipal (g) Stockwatering (h) Sediment Control
(i) Domestic (j) Dewatering (k) Hydraulic Dredging (l) Fire Protection
(m) Thermal Exchange (n) Contamination Remediation

RECEIVED

APR 27 2015

YOU **MUST** COMPLETE AND ATTACH ADDITIONAL DIVISION OF WATER RESOURCES FORM(S) PROVIDING INFORMATION TO SUBSTANTIATE YOUR REQUEST FOR THE AMOUNT OF WATER FOR THE INTENDED USE REFERENCED ABOVE.
Stafford Field Office
Division of Water Resources

For Office Use Only:
F.O. 2 GMD 2 Meets K.A.R. 5-3-1 (YES/NO) Use 1A Source GDS County HW By AGL Date 9-15-14
Code FE2 Fee \$ 300 TR # _____ Receipt Date 9-15-14 Check # 484

SCANNED 9/18/14 dwo

* 3/15/17 Geo-Center & wells situated 200' south of 200' east to comply with GMD 2 approval conditions applicant agreed to change use. Applicant requests 60 days to conduct test drilling & locate the proposed PD. File No. _____ on 3/14/17.

Geo-Center: NW-SW-NE 3714' N 2034' W, Section 2-22S-3W, Harvey County

5. The location of the proposed wells, pump sites or other works for diversion of water is:

Note: For the application to be accepted, the point of diversion location must be described to at least a 10 acre tract, unless you specifically request a 60 day period of time in which to locate the site within a specifically described, minimal legal quarter section of land.

BTB
12-2-14
NE well
NW well
SE well
SW well

(A) One in the ~~NW~~ NE quarter of the SW quarter of the NE quarter of Section 2, more particularly described as being near a point 3714⁽³⁷¹⁴⁾ feet North and 1634⁽¹⁶³⁴⁾ feet West of the Southeast corner of said section, in Township 22 South, Range 3 East West (circle one), Harvey County, Kansas.

(B) One in the NW quarter of the SW quarter of the NE quarter of Section 2, more particularly described as being near a point 3714⁽³⁷¹⁴⁾ feet North and 2234⁽²⁰³⁴⁾ feet West of the Southeast corner of said section, in Township 22 South, Range 3 East West (circle one), Harvey County, Kansas.

(C) One in the NE quarter of the SW quarter of the NE quarter of Section 2, more particularly described as being near a point 3714⁽³⁷¹⁴⁾ feet North and 1634⁽¹⁶³⁴⁾ feet West of the Southeast corner of said section, in Township 22 South, Range 3 East West (circle one), Harvey County, Kansas.

(D) One in the NW quarter of the SW quarter of the NE quarter of Section 2, more particularly described as being near a point 3714⁽³⁷¹⁴⁾ feet North and 2234⁽²⁰³⁴⁾ feet West of the Southeast corner of said section, in Township 22 South, Range 3 East West (circle one), Harvey County, Kansas.

If the source of supply is groundwater, a separate application shall be filed for each proposed well or battery of wells, except that a single application may include up to four wells within a circle with a quarter (1/4) mile radius in the same local source of supply which do not exceed a maximum diversion rate of 20 gallons per minute per well.

A battery of wells is defined as two or more wells connected to a common pump by a manifold; or not more than four wells in the same local source of supply within a 300 foot radius circle which are being operated by pumps not to exceed a total maximum diversion rate of 800 gallons per minute and which supply water to a common distribution system.

6. The owner of the point of diversion, if other than the applicant is (please print):

BTB
12-2-14

Homer B. & Betty R. Stucky, 6140 W. Maple St., Apt. #2, Wichita, KS 67209
Blazefork Farms LLC (name, address and telephone number)
Selling to: Brian & Laura Bretz, 1770 Apache Road, Moundridge, KS, 67107. 620-899-5765 (name, address and telephone number)

You must provide evidence of legal access to, or control of, the point of diversion from the landowner or the landowner's authorized representative. Provide a copy of a recorded deed, lease, easement or other document with this application. In lieu thereof, you may sign the following sworn statement:

I have legal access to, or control of, the point of diversion described in this application from the landowner or the landowner's authorized representative. I declare under penalty of perjury that the foregoing is true and correct.

Executed on Sept. 10, 2014. Brian Bretz
Applicant's Signature

The applicant must provide the required information or signature irrespective of whether they are the landowner. Failure to complete this portion of the application will cause it to be unacceptable for filing and the application will be returned to the applicant.

7. The proposed project for diversion of water will consist of ~~One Well~~ a battery of 4 wells (number of wells, pumps or dams, etc.) and (was)(will be) completed (by) 5/1/2015 (Month/Day/Year - each was or will be completed)

BTB
12-2-14

8. The first actual application of water for the proposed beneficial use was or is estimated to be 6/1/2015 (Mo/Day/Year)

9. Will pesticide, fertilizer, or other foreign substance be injected into the water pumped from the diversion works?
 Yes No If "yes", a check valve shall be required.

All chemigation safety requirements must be met including a chemigation permit and reporting requirements.

10. If you are planning to impound water, please contact the Division of Water Resources for assistance, prior to submitting the application. Please attach a reservoir area capacity table and inform us of the total acres of surface drainage area above the reservoir.

Have you also made an application for a permit for construction of this dam and reservoir with the Division of Water Resources? Yes No

- If yes, show the Water Structures permit number here _____
- If no, explain here why a Water Structures permit is not required _____

11. The application must be supplemented by a U.S.G.S. topographic map, aerial photograph or a detailed plat showing the following information. On the topographic map, aerial photograph, or plat, identify the center of the section, the section lines or the section corners and show the appropriate section, township and range numbers. Also, please show the following information:

- (a) The location of the proposed point(s) of diversion (wells, stream-bank installations, dams, or other diversion works) should be plotted as described in Paragraph No. 5 of the application, showing the North-South distance and the East-West distance from a section line or southeast corner of section.
- (b) If the application is for groundwater, please show the location of any existing water wells of any kind within 1/2 mile of the proposed well or wells. Identify each existing well as to its use and furnish the name and mailing address of the property owner or owners. If there are no wells within 1/2 mile, please advise us.
- (c) If the application is for surface water, the names and addresses of the landowner(s) 1/2 mile downstream and 1/2 mile upstream from your property lines must be shown.
- (d) The location of the proposed place of use should be shown by crosshatching on the topographic map, aerial photograph or plat.
- (e) Show the location of the pipelines, canals, reservoirs or other facilities for conveying water from the point of diversion to the place of use.

A 7.5 minute U.S.G.S. topographic map may be obtained by providing the section, township and range numbers to: Kansas Geological Survey, 1930 Constant, Campus West, University of Kansas, Lawrence, Kansas 66047.

12. List any application, appropriation of water, water right, or vested right file number that covers the same diversion points or any of the same place of use described in this application. Also list any other recent modifications made to existing permits or water rights in conjunction with the filing of this application.

None

WATER RESOURCES RECEIVED

DEC 04 2014

KS DEPT OF AGRICULTURE

RECEIVED

APR 27 2015

SCANNED
Stafford Field Office
Division of Water Resources

WATER RESOURCES RECEIVED

SEP 15 2014

KS DEPT OF AGRICULTURE

* Applicant requests 60 days to conduct test drilling & locate the PD & submit the log

13. Furnish the following well information if the proposed appropriation is for the use of groundwater. If the well has not been completed, give information obtained from test holes, if available.

Information below is from: Test holes Well as completed Drillers log attached

Well location as shown in paragraph No.	(A)	(B)	(C)	(D)
Date Drilled	11-11-14			
Total depth of well	75'			
Depth to water bearing formation	48'			
Depth to static water level	43'			
Depth to bottom of pump intake pipe	NA			

12-2-14
BTB

14. The relationship of the applicant to the proposed place where the water will be used is that of

Buyer
(owner, tenant, agent or otherwise)

15. The owner(s) of the property where the water is used, if other than the applicant, is (please print):

~~Homer B. & Betty R. Stucky, 6110 W. Maple St., Apt. #2, Wichita, KS 67209~~

BTB
12-2-14

Blazefork Farms, LLC

(name, address and telephone number)

Selling to: Brian & Laura Bretz, 1770 Apache Road, Moundridge, KS, 67107. 620-899-5765

(name, address and telephone number)

16. The undersigned states that the information set forth above is true to the best of his/her knowledge and that this application is submitted in good faith.

Dated at Halstead, Kansas, this 10th day of September, 2014
(month) (year)

(Applicant Signature)

By _____
(Agent or Officer Signature)

(Agent or Officer - Please Print)

Assisted by T. Boese GMD2/Manager Date: 9/10/2014
(office/title)

IRRIGATION USE SUPPLEMENTAL SHEET

File No. 49178

Name of Applicant (Please Print): Brian Bretz

1. Please supply the name and address of each landowner, the legal description of the lands to be irrigated, and designate the actual number of acres to be irrigated in each forty acre tract or fractional portion thereof:

Landowner of Record NAME: Homer B. & Betty R. Stucky, 6110 W. Maple St., Apt. #2, Wichita, KS 67209
BTB
Blazefork Farms LLC
 ADDRESS: Selling to: Brian & Laura Bretz, 1770 Apache Road, Moundridge, KS, 67107
12-2-14

S	T	R	NE¼				NW¼				SW¼				SE¼				TOTAL		
			NE	NW	SW	SE	NE	NW	SW	SE	NE	NW	SW	SE	NE	NW	SW	SE			
2	22S	3W			40	33.6										40	40			153.6	

Landowner of Record NAME: _____
 ADDRESS: _____

S	T	R	NE¼				NW¼				SW¼				SE¼				TOTAL			
			NE	NW	SW	SE	NE	NW	SW	SE	NE	NW	SW	SE	NE	NW	SW	SE				

Landowner of Record NAME: _____
 ADDRESS: _____

S	T	R	NE¼				NW¼				SW¼				SE¼				TOTAL				
			NE	NW	SW	SE	NE	NW	SW	SE	NE	NW	SW	SE	NE	NW	SW	SE					

RECEIVED WATER RESOURCES RECEIVED

2. Please complete the following information for the description of the operation for the irrigation project. Attach supplemental sheets as needed.

a. Indicate the soils in the field(s) and their intake rates:

Soil Name	Percent of field (%)	Intake Rate (in/hr)	Irrigation Design Group
<u>Crete Silt Loam</u>	<u>19</u>	<u>0.06-0.20</u>	<u>3</u>
<u>Geary Silt Loam</u>	<u>0.5</u>	<u>0.20-0.60</u>	<u>5</u>
<u>Ladysmith SC Loam</u>	<u>72</u>	<u>0.00-0.06</u>	<u>1</u>
<u>Smolan SC Loam</u>	<u>8.5</u>	<u>0.06-0.14</u>	<u>3</u>
Total:	100 %		

b. Estimate the average land slope in the field(s): 1 %

Estimate the maximum land slope in the field(s): 2 %

c. Type of irrigation system you propose to use (check one):

Center pivot Center pivot - LEPA "Big gun" sprinkler

Gravity system (furrows) Gravity system (borders) Sideroll sprinkler

Other, please describe: Center pivot and/or subsurface drip irrigation

d. System design features:

i. Describe how you will control tailwater: Will schedule and apply irrigation to eliminate run-off

ii. For sprinkler systems:

(1) Estimate the operating pressure at the distribution system: _____ psi

(2) What is the sprinkler package design rate? _____ gpm

(3) What is the wetted diameter (twice the distance the sprinkler throws water) of a sprinkler on the outer 100 feet of the system? _____ feet

(4) Please include a copy of the sprinkler package design information.

NOT available at this time

e. Crop(s) you intend to irrigate. Please note any planned crop rotations: Corn, soybeans, milo, wheat

f. Please describe how you will determine when to irrigate and how much water to apply (particularly important if you do not plan a full irrigation). Contract with crop consultant.

You may attach any additional information you believe will assist in informing the Division of the need for your request.

9-11-14

(Date)

Kansas Department of Agriculture
Division of Water Resources
David W. Barfield, Chief Engineer
109 SW 9th Street, 2nd Floor
Topeka, Kansas 66612-1283

Re: Application File No. 49178

Minimum Desirable Streamflow

Dear Sir:

I understand that a Minimum Desirable Streamflow requirement has been established by the legislature for the source of supply to which the above referenced application applies.

I understand that diversion of water pursuant to this application will be subject to regulation any time Minimum Desirable Streamflow requirements are not being met.

I also understand that if this application is approved, there could be times, as determined by the Division of Water Resources, when I would not be allowed to divert water. I realize that this could affect the economics of my decision to appropriate water.

I am aware of the above factors, and with the knowledge thereof, request that the Division of Water Resources proceed with processing and approval, if possible, of the above referenced application.

Brian T. Bretz
Signature of Applicant
Brian T. Bretz
(Print Applicant's Name)

State of Kansas)
County of McPherson) ss

I hereby certify that the foregoing instrument was signed in my presence and sworn to before me this 11th day of September, 2014.

[Signature]
Notary Public

My Commission Expires: 04/26/2017



WATER RESOURCES
RECEIVED
SEP 15 2014
KS DEPT OF AGRICULTURE

**MINIMUM DESIRABLE STREAMFLOW FORM TO BE USED WHEN
APPLICABLE WHEN FILING AN APPLICATION FOR PERMIT
TO APPROPRIATE WATER FOR BENEFICIAL USE**

The Kansas Legislature has established minimum desirable streamflows for the streams listed below. If your proposed diversion of water is going to be from one of these watercourses or adjacent alluvial aquifers, please complete the back side of this page and submit it along with your application for permit to appropriate water.

Arkansas River
Big Blue River
Chapman Creek
Chikaskia River
Cottonwood River
Delaware River
Little Arkansas River
Little Blue River
Marais des Cygnes River
Medicine Lodge River
Mill Creek (Wabaunsee Co. area)
Neosho River

Ninnescah River
North Fork Ninnescah River
Rattlesnake Creek
Republican River
Saline River
Smoky Hill River
Solomon River
South Fork Ninnescah
Spring River
Walnut River
Whitewater River

Meier, Matt

From: Brian Bretz <blazeforkfarms@yahoo.com>
Sent: Tuesday, March 14, 2017 10:46 AM
To: Meier, Matt
Subject: 49178 Well Application Changes

Matt

Blazefork Farms will make the following changes to well application 49178:

1. The annual quantity of water reduced to 188.5 acre-feet.
2. The maximum rate of diversion set to 800 GPM.
3. The well battery geo-center moved 200 feet south and 200 feet east of the original proposed geo-center.
4. Implementing a ground-water monitoring schedule to include water level fluctuations and water quality at the point of diversion for well 49178, well 42507, and a dedicated monitoring well for a minimum of 10 years.
5. Blazefork Farms will pay for the expenses associated with the ground water monitoring for water level fluctuations and water quality.
6. The construction of the monitoring well pursuant to GMD#2 specifications for inorganic water quality analysis.

Thank you for your help.

Brian Bretz
620-899-5765

RECEIVED

MAR 14 2017

Staff & Field Office
Division of Water Resources

Darling Drilling Company
Telephone (620) 662-7901 3916 W. 56th Ave.
Hutchinson, Ks. 67501
DRILLER'S TEST LOG

Date: 11/11/2014
Name: Brian Bretz test hole #2
Address:

WATER RESOURCES
RECEIVED

DEC 04 2014 RECEIVED

KS DEPT OF AGRICULTURE APR 27 2015

Stafford Field Office
Division of Water Resources

County: Harvey

Quarter: NE

Section: 2

Township: 22S

Range: 3W

DRILLED FOOTAGE		DESCRIPTION OF STRATA				
From	To					
0	3	Top Soil				
3	48	Tan clay				
48	53	Fine sand w/pcs of clay				
53	67	Small-fine sand				
67	69	Tan clay				
69	74	Fine sand w/pcs of clay				
74	75	Green shale				
		Latitude: 38.17031				
		Longitude: 097.61670				
		Elevation: 1457				
			Static water level: 43'			
			Depth of well: 75'			
			Type & size of casing: 4" 160#			
			Plain: 54' to 0			
			Perf: 74' to 54'			
			Gravel pack intervals: 74' to 20'			
			Grout material: 0 to 20'			
			Contamination: none			
			Direction from well:			
			Casing above surface: 14"			
			Bore hole: 7"			
			Remarks:			
			Pumped well centrifugally.			
			Took water sample.			

WATER RESOURCES
RECEIVED

RECEIVED

DEC 04 2014

APR 27 2015

KS DEPT OF AGRICULTURE

Stafford Field Office
Division of Water Resources

Warranty Deed
Kansas Statutory Form

Betty R. Stucky, a single person

Conveys and Warrants to

Blazefork Farms, LLC

all the following described REAL ESTATE in the County of Harvey, and the State of Kansas, to-wit:

Tract 1: The North Half (N/2) of the Southeast Quarter (SE/4) of Section Two (2), Township Twenty-two (22) South, Range Three (3) West of the 6th P.M., Harvey County, Kansas.

Tract 2: The South Half (S/2) of the Northeast Quarter (NE/4) of Section Two (2), Township Twenty-two (22) South, Range Three (3) West of the 6th P.M., Harvey County, Kansas, EXCEPT the East 443 feet of the North Half (N/2) of the South Half (S/2) of said Northeast Quarter (N/4).

for the sum of one dollar and other good and valuable consideration.

EXCEPT AND SUBJECT TO: Easements, restrictions and assessments of record, and all the taxes and assessments that may be levied, imposed or become payable hereafter.

Grantors hereby retain unto themselves, their heirs, successors and/or assigns all oil, gas and other minerals in and under and that may be produced from subject property.

Dated this 30 day of October, 2014.

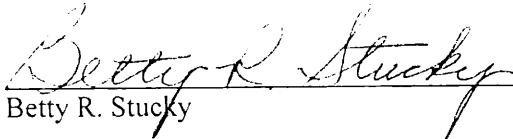
Betty R. Stucky

STATE OF KANSAS, COUNTY OF HARVEY ss:

The foregoing instrument was acknowledged before me this 30 day of Oct, 2014 by Betty R. Stucky, a single person.

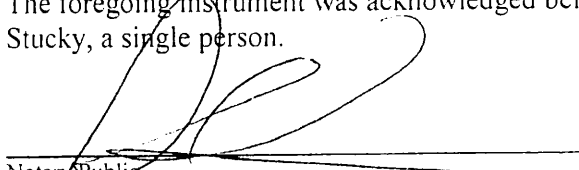

Notary Public

REBECCA I. KEATING
Notary Public - State of Kansas
My Appt Expires February 27, 2018

RECEIVED
APR 27 2015

WATER RESOURCES
RECEIVED
DEC 04 2014

State Field Office
Division of Water Resources

KS DEPT OF AGRICULTURE

December 2, 2014

Katie Goff
Kansas Department of Agriculture
Division of Water Resources
1320 Research Park Drive
Manhattan, KS 66502

Re: Application Nos. 49178 & 49179

Dear Ms. Goff:

Enclosed please find the completed original application for Water Permit Application No. 49178. Additionally, please find the original application for Water Permit Application 49179 and a signed Voluntary Dismissal of an Application for Permit to Appropriate Water form, requesting that Application No. 49179 be dismissed.

Additionally, enclosed is the deed showing the ownership of the proposed place of use and point of diversion for Application No. 49178 has changed to Blazefork Farms, LLC. Please update the application and your records with the new owner.

Thank you for your assistance in this matter. Please contact me if you need any additional information.

Sincerely,

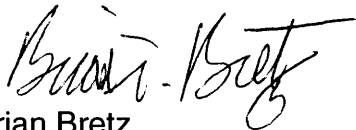

Brian Bretz
1770 Apache Road
Moundridge, KS 67107
Cell: 620-899-5765

Enclosures

WATER RESOURCES
RECEIVED

DEC 04 2014

KS DEPT OF AGRICULTURE

SCANNED

RECEIVED

APR 27 2015

B:\MSOFFICE\LETTERS_APP\49178_49179_Bretz.doc
Stafford Field Office
Division of Water Resources

1320 Research Park Drive
Manhattan, Kansas 66502
(785) 564-6700



900 SW Jackson, Room 456
Topeka, Kansas 66612
(785) 296-3556

Jackie McClaskey, Secretary

Governor Sam Brownback

November 17, 2014

BRIAN BRETZ
1770 APACHE RD
MOUNDRIDGE KS 67107

RE: Pending Applications, File Nos. 49,178 and 49,179

Dear Mr. Bretz:

In response to your electronic written request received in this office on November 14, 2014, the Chief Engineer is allowing an additional extension of time for sixty (60) days, in which to supply further information concerning the above referenced files. The original applications were returned to you on September 25, 2014, and with your current extension of time the due date was November 15, 2014. With this extension of time, the revised deadline will be **January 15, 2015**.

Extension requests are evaluated on a case by case basis. Since it appears that no pending application would be adversely affected by granting an extension, you are being allowed this additional 60 days. If near the end of the current extension you determine that additional time will be needed, you may submit another request for an extension prior to the deadline given above. Since there are instances when the Chief Engineer may deny your request for an extension of time, there is no guarantee that future requests for more time will be granted.

In order for the applications to retain their priority of filing, the original applications and attachments must be returned, with the requested information to this office on or before **January 15, 2015**, or within any authorized extension of time thereof. According to the law, default in the refiling of the completed original applications and attachments, within the time allowed, shall constitute forfeiture of priority date and dismissal of the applications.

If you have any questions, please contact me at (785) 564-6631 or by email at katie.goff@kda.ks.gov. If you wish to discuss a specific file, please have the file number ready so that I may help you more efficiently.

Sincerely,

A handwritten signature in cursive script that reads "Katie Goff".

Katie Goff
Environmental Scientist
Water Appropriation Program

RECEIVED

APR 27 2015

Stafford Field Office
Division of Water Resources

Katie Goff

From: Tim Boese <tboese@gmd2.org>
Sent: Friday, November 14, 2014 12:07 PM
To: Katie Goff
Subject: Application Nos. 49178 & 49179 - Brian Bretz

Katie - Pursuant to our telephone conversation today, the District, on behalf of Mr. Brian Bretz, is requesting a 60 day extension of time to complete and return Application Nos. 49178 and 49179. Mr. Bretz has completed test drilling recently and the District will GPS the proposed well location(s) and assist Mr. Bretz in completing the applications in the near future.

Thank you for consideration of this request.

Tim Boese, Manager
Equus Beds GMD2
313 Spruce, Halstead, Kansas 67056
316-835-2224
Fax: 316-835-2225
tboese@gmd2.org
www.gmd2.org

RECEIVED

APR 27 2015

Stafford Field Office
Division of Water Resources

1320 Research Park Drive
Manhattan, Kansas 66502
(785) 564-6700



900 SW Jackson, Room 456
Topeka, Kansas 66612
(785) 296-3556

Jackie McClaskey, Secretary

Governor Sam Brownback

October 15, 2014

BRIAN BRETZ
1770 APACHE RD
MOUNDRIDGE KS 67107

RE: Pending Applications, File Nos. 49,178 and 49,179

Dear Mr. Bretz:

The applications referred to above were returned to you for additional information on September 25, 2014, and with your current extension of time the required response date is November 15, 2014. The purpose of this letter is to provide a reminder that in order for you to retain your priority of filing, the original applications, and requested information, need to be returned to this office on or before **November 15, 2014**, or within any authorized extension of time thereof. According to the law, default in the refiling of the completed applications and attachments, within the time allowed, shall constitute forfeiture of priority date and dismissal of the applications.

If an extension of time is necessary to supply the requested information, please request the extension of time, in writing, before **November 15, 2014**. Provide information on why the additional time is needed and how much additional time is requested. Since there are instances when the Chief Engineer may deny your request for an extension of time, there is no guarantee that future requests for more time will be granted.

If you have any questions, please contact me at (785) 564-6631 or by email at katie.goff@kda.ks.gov. If you wish to discuss a specific file, please have the file number ready so that I may help you more efficiently.

Sincerely,

A handwritten signature in cursive script that reads "Katie Goff".

Katie Goff
Environmental Scientist
Water Appropriation Program

RECEIVED

APR 27 2015

Stafford Field Office
Division of Water Resources

1320 Research Park Drive
Manhattan, Kansas 66502
(785) 564-6700



900 SW Jackson, Room 456
Topeka, Kansas 66612
(785) 296-3556

Jackie McClaskey, Secretary

Governor Sam Brownback

September 25, 2014

BRIAN BRETZ
1770 APACHE ROAD
MOUNDRIDGE KS 67107

RE: Pending Applications, File Nos. 49,178 and 49,179

Dear Mr. Bretz:

After reviewing your above referenced applications for permits to appropriate water for beneficial use, all files are being returned to you for additional information. As specified in K.A.R. 5-3-1, an application acceptable for filing shall show the source of water supply and either shall show a description of the location of the proposed point of diversion or shall request a 60-day period of time in which to establish the location of the proposed point of diversion within a limited area. In your original applications, all received in this office on September 15, 2014, you had requested a 60-day period of time in which to locate the specific points of diversion within specified quarter section tracts of land described as the Northeast Quarter of Section 2, in Township 22 South, Range 3 West, Harvey County, Kansas.

In Paragraph No. 5 of each of the applications, please provide the description of the location of the proposed point of diversion for the wells. The feet distances North and West from the Southeast corner of the section must be listed for each well. The location of the points of diversion for each file must be plotted on the enclosed topographic maps. Per K.A.R. 5-3-4, the location of all water wells of every kind within one-half (½) mile of the point of diversion covered by the proposed appropriations must be plotted on the topographic maps, identified as to its use, and **include the name and mailing address of the well owner**. Please provide this information once you have established your point of diversion for each of these files. If there are no wells, please state this on the map.

Paragraph No. 13 of the applications requests well information so the source of supply of the proposed wells may be determined. Pursuant to K.A.R. 5-3-4d, this office requires a stratigraphic log of a well or test hole within 300 feet of each of the proposed points of diversion, unless the chief engineer has sufficient information to understand the lithology and determine the groundwater source formation. Please supply the indicated information and a test hole log or a driller's log with the returned original applications.

RECEIVED

APR 27 2015

Stafford Field Office
Division of Water Resources

(over)

Brian Bretz
Applications, File Nos. 49,178 and 49,179
Page 2

In order for the applications to retain their priority of filing, the original applications and attachments must be returned, with the requested information to this office on or before **November 15, 2014**, or within any authorized extension of time thereof. According to the law, default in the refiling of the completed applications and attachments, within the time allowed, shall constitute forfeiture of priority dates and dismissal of the applications. If you have any questions, please contact me at (785) 564-6631 or by email at katie.goff@kda.ks.gov. If you wish to discuss a specific file, please have the file number ready so that I may help you more efficiently.

Sincerely,

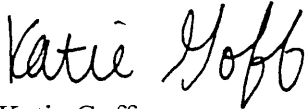

Katie Goff
Environmental Scientist
Water Appropriation Program

Enclosure
pc: GMD 2

New location

Water Rights and Points of Diversion Within 2.00 miles of point defined as:

3514 ft N and 1834 ft W of the SE Corner of Section 2, T 22S, R 3W

Located at: 97.616715 West Longitude and 38.169242 North Latitude

#49,178

meets spacing

GROUNDWATER ONLY

File Number	Use	ST	SR	Dist (ft)	Q4	Q3	Q2	Q1	FeetN	FeetW	Sec	Twp	Rng	ID	Batt	Auth_Quan	Add_Quan	Unit			
A__	1714	00	IRR	NK	G	3129	--	NE	SW	SW	1250	4000	2	22	3W	3	228.00	228.00	AF		
A__	3975	00	IRR	NK	G	5413	--	SE	NW	NW	4191	4372	12	22	3W	4	80.00	80.00	AF		
A__	6064	00	IRR	NK	G	7901	--	NW	SE	NE	3728	1118	12	22	3W	5	37.00	37.00	AF		
A__	11800	00	IRR	NK	G	3464	--	SE	SW	SE	50	1850	2	22	3W	2	53.00	53.00	AF		
A__	12144	00	IRR	NK	G	5819	--	SE	SE	NE	3281	61	11	22	3W	1	36.00	36.00	AF		
A__	12275	00	IRR	NK	G	10355	--	--	--	--	3707	3289	7	22	2W	10	G	3	56.00	56.00	AF
Same						10301	--	--	--	--	3940	3223	7	22	2W	4	B	3			
Same						10546	--	--	--	--	3440	3223	7	22	2W	6	B	3			
Same						10346	--	--	--	--	3735	3284	7	22	2W	11	B	3			
A__	16621	00	IRR	NK	G	5302	--	CE	SE	SW	660	2650	1	22	3W	1	60.00	60.00	AF		
A__	19015	00	IRR	NK	G	9630	--	NE	NW	NW	4890	4400	13	22	3W	1	45.00	45.00	AF		
A__	25719	00	IRR	NK	G	9387	--	NW	SW	SE	940	2050	12	22	3W	3	135.00	135.00	AF		
A__	25790	00	IRR	NK	G	5767	--	--	NC	NE	3950	1350	35	21	3W	1	166.00	166.00	AF		
A__	30544	00	IRR	NK	G	9005	--	--	NC	SW	1362	3855	31	21	2W	1	219.00	219.00	AF		
A__	32898	00	IRR	NK	G	10229	--	--	NC	SE	1350	1298	4	22	3W	5	212.00	212.00	AF		
A__	34689	00	IRR	NK	G	3153	--	--	NC	SE	1320	1320	35	21	3W	2	164.00	164.00	AF		
A__	35900	00	IRR	NK	G	8338	--	SE	SW	SE	500	1500	11	22	3W	2	139.00	139.00	AF		
A__	37287	00	IRR	NK	G	9630	--	NE	NW	NW	4890	4400	13	22	3W	1	98.00	98.00	AF		
A__	39003	00	IRR	NK	G	7901	--	NW	SE	NE	3728	1118	12	22	3W	5	122.00	85.00	AF		
A__	39569	00	IRR	NK	G	6541	--	SE	NW	SE	1960	1762	36	21	3W	1	40.00	40.00	AF		
A__	40298	00	IRR	NK	G	2949	--	NE	NW	SW	2487	4362	1	22	3W	2	G	2	117.00	117.00	AF
Same						2945	--	NE	NW	SW	2372	4409	1	22	3W	3	B	2			
Same						2958	--	NE	NW	SW	2602	4314	1	22	3W	4	B	2			
A__	42424	00	IRR	NK	G	8651	--	NC	SE	SW	657	3255	25	21	3W	1	189.00	189.00	AF		
A__	42507	00	IRR	NK	G	2120	--	--	--	--	4052	3885	2	22	3W	5	176.00	176.00	AF		
A__	42932	00	IRR	NK	G	3671	--	NW	SE	SW	1214	3948	35	21	3W	4	149.00	149.00	AF		
A__	43032	00	IRR	NK	G	8371	--	--	NC	SE	1268	1322	26	21	3W	3	187.00	187.00	AF		
A__	44845	00	IRR	NK	G	4716	--	SE	SE	SW	26	2769	36	21	3W	3	G	2	43.00	43.00	AF
Same						4848	--	SW	SW	SE	24	2625	36	21	3W	2	B	2			
Same						4585	--	SE	SE	SE	28	2912	36	21	3W	4	B	2			
A__	44912	00	IRR	LR	G	10355	--	--	--	--	3707	3289	7	22	2W	10	G	3	188.50	132.50	AF
Same						10301	--	--	--	--	3940	3223	7	22	2W	4	B	3			
Same						10546	--	--	--	--	3440	3223	7	22	2W	6	B	3			
Same						10346	--	--	--	--	3735	3284	7	22	2W	11	B	3			
A__	45890	00	IRR	NK	G	5819	--	SE	SE	NE	3281	61	11	22	3W	1	45.00	9.00	AF		
A__	47611	00	IRR	LR	G	5001	--	NE	SE	NW	3926	2779	11	22	3W	6	G	2	100.00	100.00	AF
Same						5262	--	NW	SW	NE	3626	2574	11	22	3W	4	B	2			
Same						5045	--	NE	SE	NW	3926	2984	11	22	3W	5	B	2			
A__	48379	00	IRR	KE	G	3464	--	SE	SW	SE	50	1850	2	22	3W	2	306.80	25.80	AF		
A__	49148	00	IRR	KE	G	5819	--	SE	SE	NE	3281	61	11	22	3W	1	97.50	52.50	AF		
A__	49178	00	IRR	AY	G	681	--	--	--	NE	3960	1320	2	22	3W	6	199.68	199.68	AF		
T__	20127427	MF	IRR	GY	G	5302	--	CE	SE	SW	660	2650	1	22	3W	1	234.64	.00	AF		

Total Net Quantities Authorized:	Direct	Storage
Total Requested Amount (AF) =	199.68	.00
Total Permitted Amount (AF) =	78.30	.00

Total Inspected Amount (AF) =	232.50	.00
Total Pro_Cert Amount (AF) =	.00	.00
Total Certified Amount (AF) =	2723.00	.00
Total Vested Amount (AF) =	.00	.00
TOTAL AMOUNT (AF) =	3233.48	.00

An * after the source of supply indicates a pending application for change for the file number.

An * after the ID indicates a 15 AF exemption was granted for the file number.

A "G" in the Batt column indicates the GEO CTR of a battery. A "B" indicates a well in the battery.

The number in the Batt column is the number of wells in the battery.

Water Rights and Points of Diversion Within 2.00 miles of point defined as:

97.616715 West Longitude and 38.169242 North Latitude

GROUNDWATER ONLY

WATER USE CORRESPONDENTS:

=====

File Number Use ST SR

A__ 1714 00 IRR NK G

> BRUCE REGIER

>

> 18902 NW 96TH ST

> MOUNDRIDGE KS 67107

A__ 3975 00 IRR NK G

> EVELYN KAUFMAN TRUST

> PETER A KAUFMAN TRUSTEE

> 2074 CHEYENNE ROAD

> MOUNDRIDGE KS 67107

A__ 6064 00 IRR NK G

> KEITH & MARIA ALBRECHT

>

> 17009 NW 96TH ST

> MOUNDRIDGE KS 67107

A__ 11800 00 IRR NK G

> BRUCE REGIER

>

> 18902 NW 96TH ST

> MOUNDRIDGE KS 67107

A__ 12144 00 IRR NK G

> KELTON E & MICHELE PITTS

>

> 9117 N WILLOW LAKE RD

> MOUNDRIDGE KS 67107

A__ 12275 00 IRR NK G

> ALLEN SCHRAG

>

> 5616 NW 60TH ST

> HALSTEAD KS 67056

#49178

A__ 18621 00 IRR NK G
> EVELYN KAUFMAN TRUST
> PETER A KAUFMAN TRUSTEE
> 2074 CHEYENNE ROAD
> MOUNDRIDGE KS 67107

A__ 19015 00 IRR NK G
> SUNARK FARMS INC
> ROBERT J FAST
> 17901 W DUTCH AVE
> MOUNDRIDGE KS 67107

A__ 25719 00 IRR NK G
> ALLEN SCHRAG
>
> 5616 NW 60TH ST
> HALSTEAD KS 67056

A__ 25790 00 IRR NK G
> LELAND R GOERING
>
> 1646 ARAPAHO RD
> MOUNDRIDGE KS 67107

A__ 30544 00 IRR NK G
> DALE JANTZEN ET AL
>
> 41 19TH AVE
> MOUNDRIDGE KS 67107

A__ 32898 00 IRR NK G
> PHILIP E & MARY D SCHMIDT
>
> 21827 W DUTCH AVE
> BUHLER KS 67522

A__ 34689 00 IRR NK G
> TJS FARMS LLC
>
> 13007 NW 108TH ST
> MOUNDRIDGE KS 67107

A__ 35900 00 IRR NK G
> SUNARK FARMS INC
> ROBERT J FAST
> 17901 W DUTCH AVE
> MOUNDRIDGE KS 67107

A__ 37287 00 IRR NK G
> SUNARK FARMS INC
> ROBERT J FAST
> 17901 W DUTCH AVE

> MOUNDRIDGE KS 67107

A__ 39003 00 IRR NK G

> KEITH & MARIA ALBRECHT

>
> 17009 NW 96TH ST

> MOUNDRIDGE KS 67107

A__ 39569 00 IRR NK G

> TJS FARMS LLC

>
> 13007 NW 108TH ST

> MOUNDRIDGE KS 67107

A__ 40298 00 IRR NK G

> JUSTIN B SCHRAG

>
> 14030 NW 96TH

> MOUNDRIDGE KS 67107

A__ 42424 00 IRR NK G

> GARY A REGIER ET AL

>
> 1742 ARAPAHO RD

> MOUNDRIDGE KS 67107

A__ 42507 00 IRR NK G

> ERNEST M KREHBIEL JR

>
> 1613 ARAPAHO RD

> MOUNDRIDGE KS 67107

A__ 42932 00 IRR NK G

> TJS FARMS LLC

>
> 13007 NW 108TH ST

> MOUNDRIDGE KS 67107

A__ 43032 00 IRR NK G

> ALAN W & MARI RUTH JUHNKE REV TRUST

>
> 7 SUNSET DR

> HESSTON KS 67062

A__ 44845 00 IRR NK G

> MARK VOGTS

>
> 1795 ARAPAHO RD

> MOUNDRIDGE KS 67107

A__ 44912 00 IRR LR G

> ALLEN SCHRAG

#49,178

> 5616 NW 60TH ST
> HALSTEAD KS 67056

A__ 45890 00 IRR NK G
> KELTON E & MICHELE PITTS
>
> 9117 N WILLOW LAKE RD
> MOUNDRIDGE KS 67107

A__ 47611 00 IRR LR G
> JOSH & EMILY REGIER
>
> 525 PARK PL
> MOUNDRIDGE KS 67107

A__ 48379 00 IRR KE G
> BRUCE REGIER
>
> 18902 NW 96TH ST
> MOUNDRIDGE KS 67107

A__ 49148 00 IRR KE G
> KELTON E & MICHELE PITTS
>
> 9117 N WILLOW LAKE RD
> MOUNDRIDGE KS 67107

A__ 49178 00 IRR AY G
> HOMER B & BETTY R STUCKY
>
> 6110 W MAPLE ST APT 2
> WICHITA KS 67209

T__20127427 MF IRR GY G
> EVELYN KAUFMAN TRUST
> PETER A KAUFMAN TRUSTEE
> 2074 CHEYENNE ROAD
> MOUNDRIDGE KS 67107

=====

Kansas

Department of Agriculture
Division of Water Resources

Stafford Field Office
300 S. Main Street
Stafford, Kansas 67578-1521

Jackie McClaskey, Secretary
David W. Barfield, Chief Engineer
Jeff Lanterman, Water Commissioner

Phone: (620) 234-5311
Fax: (620) 234-6900
www.agriculture.ks.gov
Sam Brownback, Governor

April 29, 2015

Cedric & Rebecca Blough
10333 N. Willow Lake Rd
Moundridge, KS 67107

Re: Pending Application, File No. 49,178

Dear Sir:

This is to advise you that Brian Bretz has filed the application referred to above for a permit to appropriate 199.68 acre-feet of groundwater per calendar year for irrigation use to be diverted at a maximum rate of 1,000 gallons per minute. The proposed point of diversion for 49,178 is a one well located as follows:

Northwest Quarter of the Southwest Quarter of the Northeast Quarter of Section 2, Township 22 South, Range 3 West, Harvey County, Kansas.

A map is enclosed indicating the location of the proposed well. Records in this office indicate that you may have a well or wells in this vicinity and you are notified of receipt of this application in order that you may be fully informed of the proposed location of the applicant's point of diversion and proposed use of water. Consideration will be given to comments or other information which you desire to submit to this office **within 15 days** from the date of this letter.

If you have any questions or comments, you may also contact me at (620) 234-5311. If you call, please reference the file number so I can help you more efficiently. Mailed comments can be sent to the Stafford Field Office at 300 S. Main St. Stafford, KS 67578-1521.

Sincerely,



Matt Meier
Environmental Scientist
Water Appropriations Program

Enclosure

pc:

SCANNED

Kansas

Department of Agriculture
Division of Water Resources



Stafford Field Office
300 S. Main Street
Stafford, Kansas 67578-1521

Jackie McClaskey, Secretary
David W. Barfield, Chief Engineer
Jeff Lanterman, Water Commissioner

Phone: (620) 234-5311
Fax: (620) 234-6900
www.agriculture.ks.gov
Sam Brownback, Governor



Legend

-  Section Corners
-  Section Lines

MJM-DWR 4/29/15
1:12,000

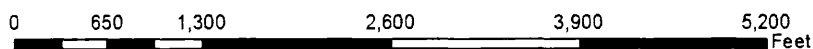

Proposed Water Appropriation, File No. 49,178
2-22S-3W
Harvey County



Kansas
Department of Agriculture
Division of Water Resources

Stafford Field Office
300 S. Main Street
Stafford, Kansas 67578-1521

Jackie McClaskey, Secretary
David W. Barfield, Chief Engineer
Jeff Lanterman, Water Commissioner

Phone: (620) 234-5311
Fax: (620) 234-6900
www.agriculture.ks.gov
Sam Brownback, Governor

April 29, 2015

Ernest M Krehbiel Jr.
1613 Arapaho Rd
Moundridge, KS 67107

Re: Pending Application, File No. 49,178

Dear Sir:

This is to advise you that Brian Bretz has filed the application referred to above for a permit to appropriate 199.68 acre-feet of groundwater per calendar year for irrigation use to be diverted at a maximum rate of 1,000 gallons per minute. The proposed point of diversion for 49,178 is a one well located as follows:

Northwest Quarter of the Southwest Quarter of the Northeast Quarter of Section 2, Township 22 South, Range 3 West, Harvey County, Kansas.

A map is enclosed indicating the location of the proposed well. Records in this office indicate that you may have a well or wells in this vicinity and you are notified of receipt of this application in order that you may be fully informed of the proposed location of the applicant's point of diversion and proposed use of water. Consideration will be given to comments or other information which you desire to submit to this office **within 15 days** from the date of this letter.

If you have any questions or comments, you may also contact me at (620) 234-5311. If you call, please reference the file number so I can help you more efficiently. Mailed comments can be sent to the Stafford Field Office at 300 S. Main St. Stafford, KS 67578-1521.

Sincerely,



Matt Meier
Environmental Scientist
Water Appropriations Program

Enclosure

pc:

SCANNED

Kansas



Department of Agriculture
Division of Water Resources

Stafford Field Office
300 S. Main Street
Stafford, Kansas 67578-1521
Jackie McClaskey, Secretary
David W. Barfield, Chief Engineer
Jeff Lanterman, Water Commissioner

Phone: (620) 234-5311
Fax: (620) 234-6900
www.agriculture.ks.gov
Sam Brownback, Governor



Legend

-  Section Corners
-  Section Lines

MJM-DWR 4/29/15
1:12,000

0 650 1,300 2,600 3,900 5,200 Feet

Proposed Water Appropriation, File No. 49,178
2-22S-3W
Harvey County



Kansas

Stafford Field Office
300 S. Main Street
Stafford, Kansas 67578-1521

Jackie McClaskey, Secretary
David W. Barfield, Chief Engineer
Jeff Lantennan, Water Commissioner

Department of Agriculture
Division of Water Resources

Phone: (620) 234-5311
Fax: (620) 234-6900
www.agriculture.ks.gov
Sam Brownback, Governor

May 27, 2015

GROUNDWATER MANAGEMENT DISTRICT NO 2
% TIM BOESE
313 SPRUCE ST
HALSTEAD KS 67056-1925

Re: Pending Application, File No. 49,178

Dear Mr. Boese:

We are enclosing a copy of the application referred to above which appears to be in proper form. Nearby well owner notification letters were sent out on April 29, 2015. A phone call was received from Ernie Kreibel who stated he was against the location of the well and wanted it to be moved further from his. No other response was received.

We are delaying any further action for a period of **30 days** from the date of this letter to allow you time to submit your recommendations concerning this application. Please submit your recommendations within the allotted time, or any authorized extension of time thereof.

If you have any questions, please contact me at (620) 234-5311. If you wish to discuss a specific file, please have the file number ready so that I may help you more efficiently.

Sincerely,



Matt Meier
Environmental Scientist
Water Appropriation Program

Enclosure

pc:

Meier, Matt

From: Tim Boese <tboese@gmd2.org>
Sent: Friday, July 10, 2015 10:01 AM
To: Meier, Matt
Subject: No. 49178 - Brian Bretz

Follow Up Flag: Follow up
Flag Status: Completed

Matt – The District requests a 30 day extension of time to review and submit recommendations for Application No. 49178. The extension is needed due to our current staff shortage and workload.

Thanks.

Tim Boese, Manager
Equus Beds GMD2
313 Spruce, Halstead, Kansas 67056
316-835-2224
Fax: 316-835-2225
tboese@gmd2.org
www.gmd2.org

FRED SEILER, PRESIDENT
VIN KISSICK, VICE PRESIDENT
JEFF WINTER, SECRETARY
MIKE MCGINN, TREASURER
TIM BOESE, MANAGER
THOMAS A. ADRIAN, ATTORNEY



DIRECTORS:
DAVID BOGNER
ALAN BURGHART
JOE PAJOR
BOB SEILER
DAVID STROBERG

EQUUS BEDS GROUNDWATER MANAGEMENT DISTRICT NO. 2

313 SPRUCE STREET • HALSTEAD, KANSAS 67056-1925 • PHONE (316) 835-2224 • FAX (316) 835-2225 • equusbeds@gmd2.org • www.gmd2.org

February 5, 2016

Chief Engineer, Division of Water Resources
Attn: Matt Meier, Stafford Field Office
300 South Main
Stafford, KS 67578

Re: Appropriation Application No. 49178 – Blazefork Farms LLC

Dear Mr. Meier:

The Equus Beds Groundwater Management District reviewed the referenced application on February 5, 2016, using the District's Revised Management Program (effective May 1, 1995) and Rules and Regulations K.A.R. 5-22-1 through 5-22-17.

The review found that the application complies with the District's Rules and Regulations K.A.R. 5-22-1 through 5-22-17. However, the application does not comply with the District's Revised Management Program, as the application area is experiencing a long term groundwater decline trend.

The District's approved Management Program dictates, "It is the goal of the District to manage the groundwater supplies within its boundaries by balancing groundwater withdrawals with annual recharge to prevent groundwater mining and protect the natural water quality of the aquifer and remediate groundwater contamination." The District's review found that the proposed application is inconsistent with the District's Management Program goal to balance groundwater withdrawals with annual recharge and approval of the application is not in the public's interest due to the declining groundwater levels in the application area. The additional pumping proposed by the application will increase the rate of groundwater decline and further exacerbate the groundwater mining problem occurring in the application area.

Therefore, the application is recommended for denial by the Equus Beds Groundwater Management District.

A District decision may be appealed to the District Board of Directors by submitting a written petition to the District office within 30 days from date of this notification, pursuant to K.A.R. 5-22-12. Please contact the District should you have any questions regarding the review or recommendation.

Sincerely,
EQUUS BEDS GROUNDWATER
MANAGEMENT DISTRICT NO. 2

Tim Boese
Manager
TDB/db

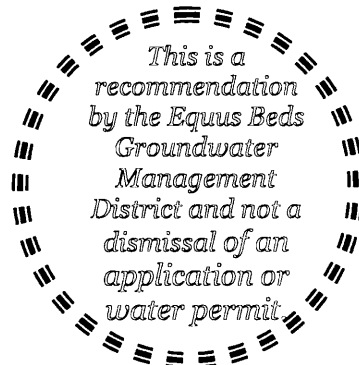

pc: Brian Bretz, Blazefork Farms LLC, Applicant, with copy of K.A.R 5-22-12
Ernest M. Krehbiel, Nearby well owner

RECEIVED

Water Level Measurements ?

AN 59

380937097365501

Note that depth to water is feet below land surface and all measurements for the well are included.

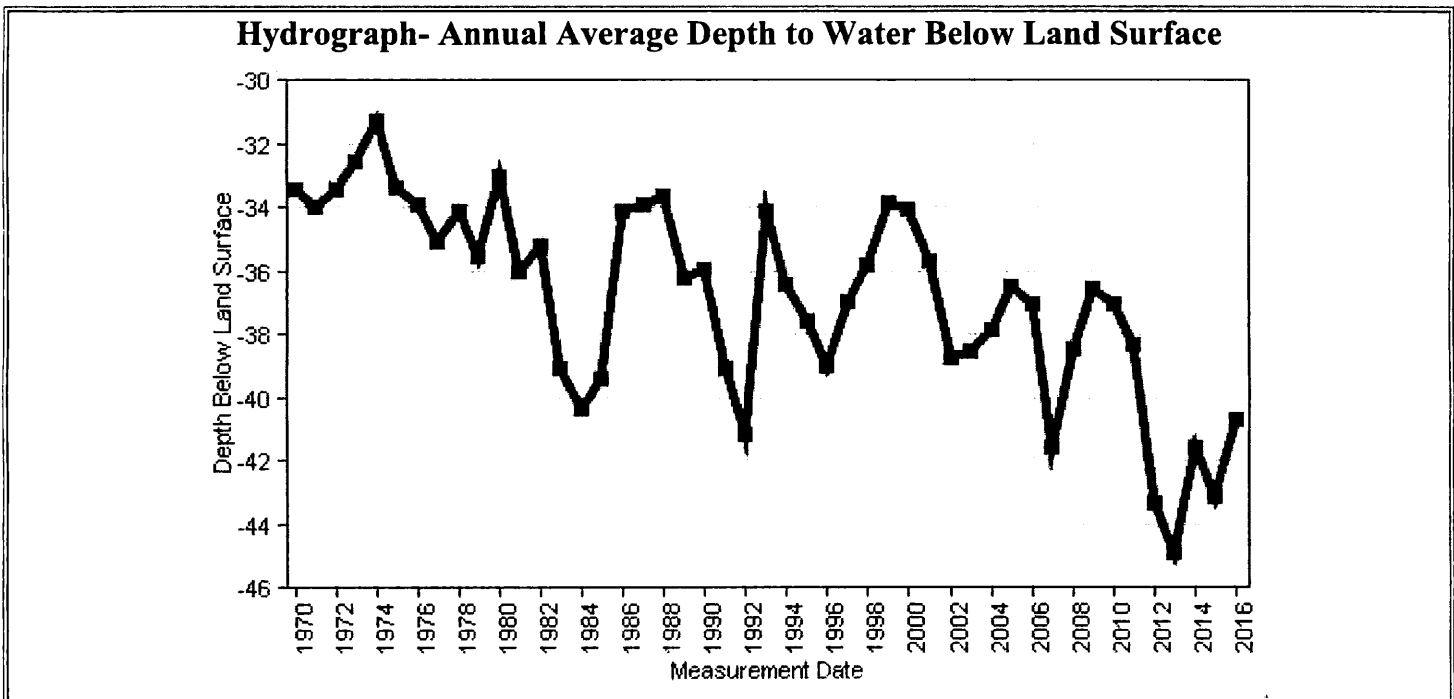

Date	Depth to Water	Status	Agency	Method	WL Source	Tape Hold	Chalk Cut	Initials
MAY-01-1970	-33.4	-	-	Unknown	-	-	---	-
MAY-12-1970	-33.4	-	-	Steel Tape	-	-	---	-
MAR-03-1971	-33.95	-	-	Steel Tape	-	-	---	-
JAN-17-1972	-33.41	-	-	Steel Tape	-	-	---	-
JAN-24-1973	-34.29	-	-	Steel Tape	-	-	---	-
MAY-08-1973	-30.82	-	-	Steel Tape	-	-	---	-
JAN-15-1974	-31.25	-	-	Steel Tape	-	-	---	-
JAN-14-1975	-33.37	-	-	Steel Tape	-	-	---	-
JAN-09-1976	-33.93	-	-	Steel Tape	-	-	RECEIVED	
MAR-03-1977	-35.06	-	-	Steel Tape	-	-	FEB 08 2016	

JAN-11-1978	-34.08	-	-	Unknown	-	-	---	-
JAN-01-1979	-35.53	-	-	Steel Tape	-	-	---	-
JAN-29-1980	-33.03	-	-	Steel Tape	-	-	---	-
JAN-21-1981	-36.01	-	-	Steel Tape	-	-	---	-
FEB-19-1982	-35.17	-	-	Steel Tape	-	-	---	-
JAN-21-1983	-39.03	-	-	Steel Tape	-	-	---	-
JAN-20-1984	-40.32	-	-	Steel Tape	-	-	---	-
JAN-16-1985	-39.42	-	-	Steel Tape	-	-	---	-
JAN-15-1986	-34.09	-	-	Steel Tape	-	-	---	-
JAN-14-1987	-33.93	-	-	Steel Tape	-	-	---	-
JAN-21-1988	-33.64	-	-	Steel Tape	-	-	---	-
JAN-19-1989	-36.17	-	-	Steel Tape	-	-	---	-
JAN-18-1990	-35.9	-	-	Steel Tape	-	-	---	-
JAN-16-1991	-39.08	-	-	Steel Tape	-	-	---	-
JAN-16-1992	-41.14	-	-	Steel Tape	-	-	---	-
JAN-25-1993	-38.02	-	-	Steel Tape	-	-	---	-
MAY-27-1993	-31.86	-	GMD2	Steel Tape	-	32	0.14	TB
AUG-11-1993	-33.14	-	GMD2	Steel Tape	-	41	7.86	TB
OCT-25-1993	-33.41	-	GMD2	Steel Tape	-	35	1.59	TB
JAN-11-1994	-34.2	-	-	Steel Tape	-	-	---	-
JAN-31-1994	-34.25	-	GMD2	Steel Tape	-	35	0.75	TB
FEB-21-1994	-34.32	-	GMD2	Steel Tape	-	35	0.68	TB

MAR-24-1994	-34.63	-	GMD2	Steel Tape	-	35	0.37	TB
APR-21-1994	-34.48	-	GMD2	Steel Tape	-	35	0.52	TB
MAY-19-1994	-34.68	-	GMD2	Steel Tape	-	35	0.32	TB
JUN-23-1994	-36.07	-	GMD2	Steel Tape	-	45	8.93	TB
JUL-19-1994	-37.71	-	GMD2	Steel Tape	-	39	1.29	TB
AUG-30-1994	-40.34	-	GMD2	Steel Tape	-	43	2.66	TB
SEP-30-1994	-39.45	-	GMD2	Steel Tape	-	41	1.55	TB
OCT-28-1994	-38.82	-	GMD2	Steel Tape	-	40	1.18	TB
DEC-12-1994	-38.33	-	GMD2	Steel Tape	-	39	0.67	TB
JAN-20-1995	-38.06	-	GMD2	Steel Tape	-	39	0.94	TB
JAN-23-1995	-38.05	-	-	Steel Tape	-	-	---	-
FEB-21-1995	-37.87	-	GMD2	Steel Tape	-	38	0.13	TB
MAR-22-1995	-37.66	-	GMD2	Steel Tape	-	38	0.34	TB
APR-27-1995	-37.55	-	GMD2	Steel Tape	-	38	0.45	TB
MAY-30-1995	-34.79	-	GMD2	Steel Tape	-	36	1.21	TB
JUN-21-1995	-33.51	-	GMD2	Steel Tape	-	34	0.49	TB
JUL-21-1995	-37.31	-	GMD2	Steel Tape	-	38	0.69	TB
AUG-31-1995	-39.99	-	GMD2	Steel Tape	-	44	4.01	TB
SEP-28-1995	-39.31	-	GMD2	Steel Tape	-	40	0.69	TB
OCT-27-1995	-38.55	-	GMD2	Steel Tape	-	39	0.45	TB
DEC-13-1995	-37.67	-	GMD2	Steel Tape	-	38	0.33	TB
JAN-16-1996	-37.4	-	GMD2	Steel Tape	-	38	0.60	TB
FEB-21-1996	-37.68	-	GMD2	Steel Tape	-	38	0.32	TB
MAR-22-	-37.46	-	GMD2	Steel Tape	-	38	0.54	TB

1996								
APR-18-1996	-37.32	-	GMD2	Steel Tape	-	38	0.68	TB
MAY-29-1996	-37.34	-	GMD2	Steel Tape	-	38	0.66	TB
JUN-27-1996	-39.3	-	GMD2	Steel Tape	-	40	0.70	TB
JUL-30-1996	-42.45	-	GMD2	Steel Tape	-	45	2.55	TB
AUG-28-1996	-41.63	-	GMD2	Steel Tape	-	42	0.37	TB
SEP-27-1996	-40.39	-	GMD2	Steel Tape	-	41	0.61	TB
OCT-28-1996	-39.59	-	GMD2	Steel Tape	-	40	0.41	TB
NOV-19-1996	-38.97	-	GMD2	Steel Tape	-	40	1.03	TB
DEC-16-1996	-38.26	-	GMD2	Steel Tape	-	39	0.74	TB
JAN-15-1997	-37.94	-	DWR	Steel Tape	-	39	1.06	SB
JAN-21-1997	-37.83	-	GMD2	Steel Tape	-	38	0.17	TB
FEB-18-1997	-37.72	-	GMD2	Steel Tape	-	38	0.28	TB
MAR-27-1997	-37.32	-	GMD2	Steel Tape	-	38	0.68	TB
APR-15-1997	-37.15	-	GMD2	Steel Tape	-	38	0.85	TB
MAY-23-1997	-36.75	-	GMD2	Steel Tape	-	37	0.25	TB
JUN-17-1997	-35.65	-	GMD2	Steel Tape	-	37	1.35	TB
AUG-22-1997	-38.56	-	GMD2	Steel Tape	-	42	3.44	TB
SEP-17-1997	-37.75	-	GMD2	Steel Tape	-	38	0.25	TB
OCT-17-1997	-36.1	-	GMD2	Steel Tape	-	37	0.90	TB
NOV-25-1997	-35.51	-	GMD2	Steel Tape	-	36	0.49	TB
DEC-18-1997	-35.37	-	GMD2	Steel Tape	-	36	0.63	TB
JAN-14-1998	-34.99	-	DWR	Steel Tape	-	40	5.01	SB
JAN-23-	-34.91	-	GMD2	Steel Tape	-	36	1.09	TB

1998								
APR-24-1998	-33.27	-	GMD2	Steel Tape	-	35	1.73	TB
JUL-24-1998	-39.6	-	GMD2	Steel Tape	-	42	2.40	TB
OCT-29-1998	-37.04	-	GMD2	Steel Tape	-	39	1.96	TB
NOV-12-1998	-35.12	-	GMD2	Steel Tape	-	36	0.88	TB
JAN-13-1999	-34.62	-	DWR	Steel Tape	-	37	2.38	SB
JAN-25-1999	-34.59	-	GMD2	Steel Tape	-	36	1.41	TB
APR-27-1999	-32.64	-	GMD2	Steel Tape	-	33	0.36	TB
JUL-20-1999	-33.28	-	GMD2	Steel Tape	-	35	1.72	TB
OCT-22-1999	-34.14	-	GMD2	Steel Tape	-	35	0.86	TB
JAN-05-2000	-33.48	-	DWR	Steel Tape	-	36	2.52	SB
JAN-17-2000	-33.43	-	GMD2	Steel Tape	-	34	0.57	TB
APR-21-2000	-31.59	-	GMD2	Steel Tape	-	33	1.41	TB
JUL-27-2000	-34.94	-	GMD2	Steel Tape	-	38	3.06	TB
OCT-23-2000	-36.88	-	GMD2	Steel Tape	-	38	1.12	TB
JAN-10-2001	-35.29	-	DWR	Steel Tape	-	37	1.71	SB
JAN-12-2001	-35.25	-	GMD2	Steel Tape	-	36	0.75	TB
APR-20-2001	-33.01	-	GMD2	Steel Tape	-	35	1.99	TB
OCT-15-2001	-39.2	-	GMD2	Steel Tape	-	40	0.80	TB
JAN-17-2002	-37.33	-	DWR	Steel Tape	-	39	1.67	SB
JAN-22-2002	-37	-	GMD2	Steel Tape	-	38	1.00	TB
APR-19-2002	-36.76	-	GMD2	Steel Tape	-	37	0.24	TB
JUL-24-2002	-42.38	-	GMD2	Steel Tape	-	47	4.62	TDB
OCT-28-2002	-40.16	-	GMD2	Steel Tape	-	42	1.84	TDB
JAN-09-								

RECEIVED

FEB 08 2016

2003	-38.65	-	GMD2	Steel Tape	-	40	1.35	TB
JAN-13-2003	-38.66	-	DWR	Steel Tape	-	40	1.34	SB
APR-22-2003	-36.82	-	GMD2	Steel Tape	-	40	3.18	TB
OCT-29-2003	-39.88	-	GMD2	Electronic-Tape	-	39.88	0.00	TB
JAN-07-2004	-38.57	-	DWR	Steel Tape	-	40	1.43	SB
JAN-12-2004	-38.55	-	GMD2	Steel Tape	-	41	2.45	TB
APR-21-2004	-36.3	-	GMD2	Electronic-Tape	-	36.3	0.00	TB
JAN-14-2005	-37.35	-	GMD2	Steel Tape	-	40	2.65	TB
JAN-16-2005	-37.02	-	DWR	Steel Tape	-	40	2.98	SB
APR-20-2005	-35.08	-	GMD2	Electronic-Tape	-	35.08	0.00	TB
JAN-04-2006	-37.17	-	DWR	Steel Tape	-	40	2.83	SB
JAN-17-2006	-36.8	-	GMD2	Steel Tape	-	55	18.20	DR
JAN-03-2007	-41.66	-	DWR	Steel Tape	-	47	5.34	DM
JAN-18-2007	-41.49	-	GMD2	Steel Tape	-	43	1.51	DR
JAN-09-2008	-38.29	-	DWR	Steel Tape	-	42	3.71	DM
JAN-23-2008	-38.6	-	GMD2	Steel Tape	-	40	1.40	DR
JAN-06-2009	-35.89	-	DWR	Steel Tape	-	43	7.11	DM
JAN-23-2009	-36.01	-	GMD2	Steel Tape	-	38	1.99	DR
DEC-30-2009	-37.74	-	DWR	Steel Tape	-	41	3.26	DM
JAN-08-2010	-37.05	-	GMD2	Steel Tape	-	40	2.95	DR
JAN-05-2011	-38.27	-	DWR	Steel Tape	-	41	2.73	DM
JAN-06-2011	-38.31	-	GMD2	Steel Tape	-	39	0.69	DR

JAN-03-2012	-43.4	-	DWR	Steel Tape	-	45	1.60	DM
JAN-19-2012	-43.29	-	GMD2	Steel Tape	-	47	3.71	DR
JAN-14-2013	-44.9	-	GMD2	Steel Tape	-	47	2.10	DR
JAN-15-2013	-44.84	-	DWR	Steel Tape	-	50	5.16	DEM
JAN-15-2014	-41.47	-	DWR	Steel Tape	-	50	8.53	DEM
JAN-23-2014	-41.63	-	GMD2	Steel Tape	-	45	3.37	DR
JAN-06-2015	-43.29	-	DWR	Steel Tape	-	50	6.71	DM
JAN-20-2015	-43.01	-	GMD2	Steel Tape	-	44	0.99	DR
JAN-13-2016	-40.68	-	GMD2	Electronic-Tape	-	40.68	0.00	DR

Download

RECEIVED

FEB 08 2016

SCANNED

Kansas

Stafford Field Office
300 S. Main Street
Stafford, Kansas 67578-1521
Jackie McClaskey, Secretary
David W. Barfield, Chief Engineer
Jeff Lanterman, Water Commissioner

Department of Agriculture
Division of Water Resources

Phone: (620) 234-5311
Fax: (620) 234-6900
www.agriculture.ks.gov
Sam Brownback, Governor

February 8, 2016

BRIAN BRETZ
1770 APACHE RD
MOUNDRIDGE KS 67107

RE: Pending Application, File No. 49,178

Dear Mr. Bretz:

On February 8, 2016, we received a recommendation from the Equus Beds Groundwater Management District No. 2 that the referenced Application for Permit to Appropriate Water for Beneficial Use be denied. This recommendation was based upon the groundwater management program adopted by the District and approved by the Chief Engineer, Division of Water Resources, Kansas Department of Agriculture. The application was recommended for denial due to it being located in an area which has been experiencing a long term groundwater decline trend.

We are advising you of this recommendation in order to allow you an opportunity to consult with the District regarding their recommendation if you have not already done so. If you have already contacted the District regarding this recommendation, then we are allowing you this opportunity to submit any additional information you wish to have considered before the Chief Engineer.

We will delay any further action on the referenced application until **March 6, 2016**, at which time the application will be submitted to the Chief Engineer for a final decision.

If you have any questions, please contact me at (620) 234-5311, and please have the specific file number ready so that I may help you more efficiently.

Sincerely,

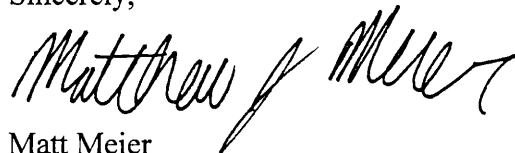

Matt Meier
New Application Unit
Water Appropriation Program

pc: Groundwater Management District No. 2

SCANNED

February 15, 2016

Equus Beds Groundwater Management District No. 2
Attn: Tim Boese, Manager, and District Board of Directors
313 Spruce Street
Halstead, KS 67056-1925

Re: Appropriation Application No. 49178- Blazefork Farms LLC

Dear Mr. Boese and District Board of Directors:

Blazefork Farms LLC would like to appeal the recommended denial of Application for Permit to Appropriate Water for Beneficial Use Appropriation Application No. 49178. We feel the proposed application meets all current Rules and Regulations K.A.R. 5-22-1 through 5-22-17, which has been acknowledged by the Equus Beds Groundwater Management District No. 2. We feel the policy quoted from the Districts Revised Management Program, stated in the recommendation for denial, is not applicable for this application. The closest water level test well AN54 located approximately 3800' south of the proposed application shows a small decline over time but it is no different than earlier approved water application permits which met current Rules and Regulations K.A.R. 5-22-1 through 5-22-17. The current rate of change is less than when earlier permits were granted.

In an effort to seek approval and make all interested parties comfortable with the outcome we propose monitoring the water level changes that may or may not occur on wells with in a 4000' radius of the proposed well geo-center. We do not wish to impair any neighboring wells.

We also propose lowering the requested appropriation of 199.68 ac-feet to 188.5 ac-feet. Current practices to efficiently use water we implement on other farms and would implement on this farm include no end guns, low drift nozzle packages, soil moisture probes, variable rate irrigation, and use of a crop consultant for irrigation scheduling. We also use strip-till and no-till farming practices.

Thank you for your time and consideration.

Sincerely,
Blazefork Farms LLC

Brian Bretz

Ryan Reiff

FRED SEILER, PRESIDENT
VIN KISSICK, VICE PRESIDENT
JEFF WINTER, SECRETARY
MIKE MCGINN, TREASURER
TIM BOESE, MANAGER
THOMAS A. ADRIAN, ATTORNEY



DIRECTORS:
DAVID BOGNER
ALAN BURGHART
JOE PAJOR
BOB SEILER
DAVID STROBERG

EQUUS BEDS GROUNDWATER MANAGEMENT DISTRICT NO. 2

313 SPRUCE STREET • HALSTEAD, KANSAS 67056-1925 • PHONE (316) 835-2224 • FAX (316) 835-2225 • equusbeds@gmd2.org • www.gmd2.org

February 19, 2016

Blazefork Farms LLC
c/o Brian Bretz
1770 Apache Road
Moundridge, KS 67107

Re: Water Appropriation Application No. 49178

Dear Mr. Bretz:

The Equus Beds Groundwater Management District No. 2 received your Petition of Appeal on February 17, 2016, in the matter of the District's February 5, 2016, recommendation of the above referenced application. The petition was found to be in proper form and that, pursuant to K.A.R 5-22-12(b)(4), you are a valid petitioner.

The District Board of Directors will tentatively hear the appeal on Tuesday, March 29, 2016, in the conference room of the Equus Beds Groundwater Management District office, 313 Spruce Street, Halstead, Kansas. The meeting is planned to begin at 1:00 PM. A copy of the meeting agenda will be forwarded to you once it is finalized.

At the appeal hearing, the Board will permit the petitioner to present briefs and may afford any interested party the opportunity to present oral or written arguments, if appropriate.

Please contact the District if you have any questions or need additional information.

Sincerely,
EQUUS BEDS GROUNDWATER
MANAGEMENT DISTRICT NO. 2

Tim Boese
Manager

TDB/db

Pc: Matt Meier, Division of Water Resources, Stafford
Ryan Reiff
Ernest M. Krehbiel

RECEIVED
SCANNED
FEB 22 2016



Stafford Field Office
Division of Water Resources

FRED SEILER, PRESIDENT
VIN KISSICK, VICE PRESIDENT
JEFF WINTER, SECRETARY
MIKE MCGINN, TREASURER
TIM BOESE, MANAGER
THOMAS A. ADRIAN, ATTORNEY



DIRECTORS:
DAVID BOGNER
ALAN BURGHART
JOE PAJOR
BOB SEILER
DAVID STROBERG

EQUUS BEDS GROUNDWATER MANAGEMENT DISTRICT NO. 2

313 SPRUCE STREET • HALSTEAD, KANSAS 67056-1925 • PHONE (316) 835-2224 • FAX (316) 835-2225 • equusbeds@gmd2.org • www.gmd2.org

April 6, 2016

Blazefork Farms LLC
c/o Brian Bretz
1770 Apache Road
Moundridge, KS 67107

Re: Water Appropriation Application No. 49178

Dear Mr. Bretz:

The purpose of this correspondence is to advise you that the referenced water appropriation application is scheduled for review at the April 12, 2016, Board of Directors meeting of the Equus Beds Groundwater Management District.

Please find enclosed a copy of the meeting agenda. The public meeting begins at 1:00 p.m. and will be held in the Equus Beds Groundwater Management District's conference room at 313 Spruce Street, Halstead, Kansas.

Please contact the District if you have any questions or need additional information.

Sincerely,
EQUUS BEDS GROUNDWATER
MANAGEMENT DISTRICT NO. 2

Tim Boese
Manager

TDB/db

Enclosure: Agenda

Pc: Matt Meier, Division of Water Resources, Stafford
Ryan Reiff
Ernest M. Krehbiel

RECEIVED

APR 06 2016

**PROPOSED AGENDA
BOARD OF DIRECTORS MEETING
EQUUS BEDS GROUNDWATER MANAGEMENT DISTRICT NO. 2**

**Tuesday, April 12, 2016
1:00 p.m.**

**313 Spruce Street • Halstead, KS 67056-1925
Phone: (316) 835-2224 • Fax: (316) 835-2225 • E-mail: equusbeds@gmd2.org**

- 1. APPROVAL OF MINUTES**
 - a) March 10th Meeting
 - b) Annual Meeting Review
- 2. APPROVAL OF AGENDA**
- 3. FINANCIAL REPORT –**
 - a) Annual Financial Audit – Jack Blazer, Knudsen, Monroe & Co., LLC.
 - b) March Financial Report
- 4. APPROVAL OF EXPENDITURES**
- 5. PUBLIC FORUM –** *Persons may present written or verbal comments concerning non-agenda business. Please limit presentation to five minutes.*
- 6. APPEAL REVIEW**
 - a) Blazefork Farms LLC, Application. No. 49178, NE 02-22S-3W, Harvey Co.
 - b) Kris Nicholson, Application No. 49087, NW 16-26S-1W, Sedgwick Co.
- 7. OLD BUSINESS – None Pending**
- 8. NEW BUSINESS**
 - a) Review of McPherson BPU Application Nos. 47955, 47956, 47957
 - b) Status of Current Water-Related Legislation & Rules & Regulations
 - c) District Dental Insurance Options
 - d) Election of Board Officers
- 9. AGENCY & COMMITTEE REPORTS**
 - a) Division of Water Resources
 - b) Kansas Water Authority
 - c) Equus – Walnut Regional Advisory Committee
- 10. MANAGER'S REPORT**
 - a) ASR Project Report
 - b) Administrative and field tasks
 - c) Monthly information and service report
- 11. ADDITIONS TO THE AGENDA**
- 12. BOARD ROUND TABLE DISCUSSION – Fred Seiler, President**

Notice: All Board of Directors meeting and any portion thereof are open to the public, except for closed or executive meetings, as prescribed by K.S.A. 75-4319. Please complete a meeting notice form, if you wish to be notified of Board of Directors meetings, hearings, work sessions or other business meetings. Notice forms may be obtained by contacting the Equus Beds Groundwater Management District No. 2.

FRED SEILER, PRESIDENT
VIN KISSICK, VICE PRESIDENT
JEFF WINTER, SECRETARY
MIKE MCGINN, TREASURER
TIM BOESE, MANAGER
THOMAS A. ADRIAN, ATTORNEY



DIRECTORS:
DAVID BOGNER
ALAN BURGHART
JOE PAJOR
BOB SEILER
DAVID STROBERG

EQUUS BEDS GROUNDWATER MANAGEMENT DISTRICT NO. 2

313 SPRUCE STREET • HALSTEAD, KANSAS 67056-1925 • PHONE (316) 835-2224 • FAX (316) 835-2225 • equusbeds@gmd2.org • www.gmd2.org

April 13, 2016

Chief Engineer, Division of Water Resources
Attn: Matt Meier, Stafford Field Office
300 S. Main Street
Stafford, Kansas 67578

Re: Water Appropriation Application No. 49178 – Blazefork Farms LLC

Dear Mr. Meier:

The referenced application was reviewed by the Equus Beds Groundwater Management District No. 2 Board of Directors at the April 12, 2016, meeting. District staff and the applicant presented information regarding the application.

It was the decision of the Board of Directors to table making a recommendation on the application until the January, 2017, District Board of Directors meeting to allow the District time to complete and review the District-wide safe yield and recharge study and modeling effort being conducted in conjunction with the Kansas Geological Survey.

Sincerely,

EQUUS BEDS GROUNDWATER
MANAGEMENT DISTRICT NO. 2

Tim Boese
Manager

TDB/db

pc: Blazefork Farms LLC
Ernest Krehbiel

RECEIVED
SCANNED
APR 18 2016

Stafford Field Office
Division of Water Resources



FRED SEILER, PRESIDENT
VIN KISSICK, VICE PRESIDENT
JEFF WINTER, SECRETARY
MIKE MCGINN, TREASURER
TIM BOESE, MANAGER
THOMAS A. ADRIAN, ATTORNEY



DIRECTORS:
DAVID BOGNER
ALAN BURGHART
JOE PAJOR
BOB SEILER
DAVID STROBERG

EQUUS BEDS GROUNDWATER MANAGEMENT DISTRICT NO. 2

313 SPRUCE STREET • HALSTEAD, KANSAS 67056-1925 • PHONE (316) 835-2224 • FAX (316) 835-2225 • equusbeds@gmd2.org • www.gmd2.org

February 3, 2017

Chief Engineer, Division of Water Resources
Attn: Matt Meier, Stafford Field Office
300 S. Main Street
Stafford, Kansas 67578

Re: Water Appropriation Application No. 49178 – Blazefork Farms LLC

Dear Mr. Meier:

The referenced application was scheduled for review by the Equus Beds Groundwater Management District No. 2 Board of Directors at the January 31, 2017, meeting.

It was the decision of the Board of Directors to table making a recommendation on the application until the next District Board of Directors meeting to allow the District staff and Board time to complete the review of the District-wide sustainability assessment recently completed by the Kansas Geological Survey and for District staff to compile additional information. The application review is now scheduled for the February 22, 2017, meeting.

Sincerely,

EQUUS BEDS GROUNDWATER
MANAGEMENT DISTRICT NO. 2

Tim Boese
Manager

TDB/db

pc: Blazefork Farms LLC
Ernest Krehbiel

RECEIVED

FEB 06 2017

Stafford Field Office
Division of Water Resources

SCANNED



FRED SEILER, PRESIDENT
VIN KISSICK, VICE PRESIDENT
JEFF WINTER, SECRETARY
MIKE MCGINN, TREASURER
TIM BOESE, MANAGER
THOMAS A. ADRIAN, ATTORNEY



DIRECTORS:
DAVID BOGNER
ALAN BURGHART
JOE PAJOR
BOB SEILER
DAVID STROBERG

EQUUS BEDS GROUNDWATER MANAGEMENT DISTRICT NO. 2

313 SPRUCE STREET • HALSTEAD, KANSAS 67056-1925 • PHONE (316) 835-2224 • FAX (316) 835-2225 • equusbeds@gmd2.org • www.gmd2.org

March 8, 2017

RECEIVED

Chief Engineer, Division of Water Resources
Attn: Matt Meier, Stafford Field Office
300 S. Main Street
Stafford, KS 67578

MAR 13 2017

Stafford Field Office
Division of Water Resources

Re: Application No. 49178 – Blazefork Farms LLC

Dear Mr. Meier:

The referenced application was reviewed by the Equus Beds Groundwater Management District No. 2, Board of Directors on February 22, 2017. A copy of the District's application review report is enclosed for your information.

Based on District findings and information provided by the applicant that:

1. Application No. 49178 proposes the withdrawal 199.68 acre-feet at a maximum rate of 1000 gallons per minute for irrigation of 153.6 acres from a proposed battery of 4 wells with a geographic center located in the Northwest quarter of the Southwest quarter of the Northeast quarter (3714' N & 2034' W), Section 02, Township 22 South, Range 3 West, Harvey County.
2. The application complies with the District's domestic well spacing rule and regulation K.A.R. 5-22-2(b).
3. The application complies with the District's nondomestic well spacing rule and regulation K.A.R. 5-22-2(b).
4. The application complies with the current safe yield Rule and Regulation K.A.R. 5-22-7.
5. Subject to the proposed rate of diversion being reduced to 800 GPM, the application complies with the District's Rules and Regulations, K.A.R. 5-22-1 through K.A.R. 5-22-17.
6. One nearby well owner responded in opposition to Application No. 49178 during the 15 day comment period provided by Division of Water Resources.
7. The applicant submitted a letter signed by the applicants and the owner of nearby water right No. 42507 advising that if the proposed geo-center is moved 200 feet south and 200 feet east of the initially proposed location and the applicant monitors any interactions with Water Right No. 42507, "[the owner of permit no. 42507] has no issues with the new proposed well". The letter details monitoring plan requirements and that if an interaction is discovered between the two wells, that applicant will develop a crop management plan so as to not impair No. 42507.
8. At a proposed modified geo-center location 200 feet south and 200 feet east of the originally proposed geo-center, the application will not comply with the District's Safe Yield Regulation K.A.R. 5-22-7, unless the proposed quantity is reduced by a minimum of 4.98 acre-feet.
9. The test log submitted with the application indicates that depth to bedrock near the proposed point of diversion is approximately 74 feet and the aquifer has a saturated thickness of approximately 31 feet, with only 24 feet being water yielding material consisting of fine and small sand
10. Nearby water level measurements indicate the aquifer in the vicinity of the proposed point of diversion is declining and groundwater is being mined, especially since about the year 2000.
11. The minimal saturated thickness at the application location increases the chance of impairment to existing water rights.

RECEIVED

MAR 13 2017

12. The application presents a clear long term impairment issue for prior existing water rights, as the proposed point of diversion will only contribute to active groundwater mining occurring in the area.
13. The application does not comply with the District's Aquifer Management Program goal of managing the groundwater supplies within the District boundaries by balancing groundwater withdrawals with annual recharge to the aquifer to prevent groundwater mining.
14. Allowing new permits in an area where groundwater levels are showing a long term declining trend is not consistent with the Kansas Water Appropriation Act, specifically K.S.A. 82a-711.
15. The recent Sustainability Assessment report published by the Kansas Geological Survey indicates that the sustainable water usage in this area is 3.1% to 4.48% lower than current reported usage, and 43.25% to 41.32% below current authorized quantity, demonstrating that the area is over-appropriated and groundwater use is exceeding sustainable yield.
16. K.S.A. 82a-711(c) states that impairment shall include the unreasonable raising or lowering of the static water level. Three representative hydrographs show a lowering of static water levels within .5 to 2.5 miles of the proposed point of diversion and the KGS GMD2 Sustainability Assessment indicates that the actual recent average water use is not sustainable in Township 22 South, Range 3 West, Harvey County.

It was the decision of the Board of Directors to recommend the application for approval subject to the following conditions:

1. The proposed annual quantity of water is reduced to 188.5 acre-feet as proposed by the applicant;
2. The proposed maximum rate of diversion is reduced to 800 GPM to comply with the "Battery of wells" definition K.A.R. 5-22-1(n);
3. The proposed well battery geo-center is moved 200 feet south and 200 feet east of the currently proposed location;
4. The implementation of the enclosed groundwater-monitoring schedule which includes monitoring for water level fluctuations and water quality to be taken at the proposed point of diversion, dedicated monitoring well, and the irrigation well authorized by Water Right No. 42507 for a minimum period of ten (10) years;
5. Installation of the monitoring well and implementation of the groundwater monitoring plan at the applicant's expense; and
6. Construction of the monitoring well pursuant to District specifications (copy enclosed) to allow for inorganic water quality analyses.

A District Board of Director's decision may be requested for reconsideration by the Board by submitting a written request to the District office within 15 days from the date of this notification, pursuant to K.A.R. 5-22-12.

Sincerely,
EQUUS BEDS GROUNDWATER
MANAGEMENT DISTRICT NO. 2

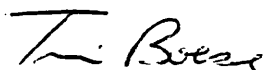

Tim Boese
Manager

TDB/db

Enclosure

pc: Blazefork Farms LLC, Applicant & Landowner, with copy of monitoring plan & observation well specs
Ernest Krehbiel, Nearby Well Owner

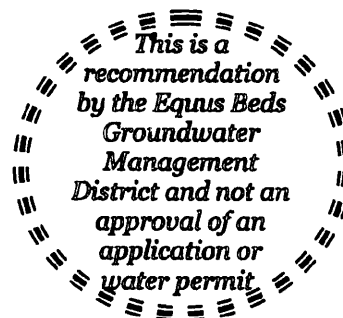

FRED SEILER, PRESIDENT
VIN KISSICK, VICE PRESIDENT
JEFF WINTER, SECRETARY
MIKE MCGINN, TREASURER
TIM BOESE, MANAGER
THOMAS A. ADRIAN, ATTORNEY



DIRECTORS:
DAVID BOGNER
ALAN BURGHART
JOE PAJOR
BOB SEILER
DAVID STROBERG

EQUUS BEDS GROUNDWATER MANAGEMENT DISTRICT NO. 2

313 SPRUCE STREET • HALSTEAD, KANSAS 67056-1925 • PHONE (316) 835-2224 • FAX (316) 835-2225 • equusbeds@gmd2.org • www.gmd2.org

March 8, 2017

Blazefork Farms LLC
Attn: Brian Bretz
1770 Apache Road
Moundridge, KS 67107

Re: Appropriation Application No. 49178

Dear Mr. Bretz:

The Equus Beds Groundwater Management District No. 2 made a recommendation to the Division of Water Resources that Appropriation Application No. 49178 be approved. Pursuant to K.A.R. 5-22-4a, the well battery described in the application must be equipped with a District approved water flowmeter: The well battery geo-center is located in the Northeast Quarter of the Southwest Quarter of the Northeast Quarter of Section 2, Township 22 South, Range 3 West, Harvey County.

The well battery must be properly equipped with an approved meter within 30 days after the approved well battery is operational and prior to its operation. If more time is needed to install the meter or modify an existing meter installation, you may request an extension of time. The request must be made to the District before the end of the 30-day period.

Enclosed is a Flow Meter Installation form to be completed and returned to this office after completion of the meter installation or modifications. A copy of the Division of Water Resources' meter installation notification form (Notice and Proof of Completion of Works) may be substituted for the District form. Upon receiving the completed form, the District will inspect the installation.

Also enclosed is a copy of water meter and installation specifications. The water meter must meet these specifications and the list of certified water meters provided under K.A.R. 5-1-12, for District approval. The list of certified water meters can be obtained by contacting the District or at following link: <http://agriculture.ks.gov/divisions-programs/dwr/water-appropriation/water-flowmeters>. If you have any questions about the District's metering program or the enclosed material, please contact the District for assistance.

Sincerely,
EQUUS BEDS GROUNDWATER
MANAGEMENT DISTRICT NO. 2

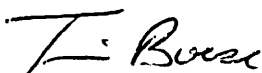
Tim Boese
Manager
TDB/STF

Enclosures

Pc: Jeff Lanterman, Division of Water Resources, Stafford

RECEIVED

MAR 13 2017

Stafford Field Office
Division of Water Resources

MAR 13 2017

Station Field Office
Division of Water Resources

**GROUNDWATER MONITORING PLAN
for
WATER APPROPRIATION FILE NO. 49178 – BLAZEFORK FARMS LLC**

Prepared by
Equus Beds Groundwater Management District No. 2
March 8, 2017

A SCOPE - To monitor and record water quality and water level changes in the Equus Beds Aquifer in an area that encompasses the point of diversion described by Water Appropriation Application No. 49178.

B DATA COLLECTION

- B.1 Data collection points may include the proposed production wells, dedicated observation wells, and nearby irrigation wells.
- B.2 The data collection point locations are described as:
 - B.2.1 One irrigation well battery authorized by Water Permit No. 49178 in the northeast quarter of the southwest quarter of the northeast quarter of Section 02, Township 22 south, Range 3 west, Harvey County, approximately 3,514 feet north and 1,834 feet west of the apparent southeast section corner.
 - B.2.2 One observation well in the northwest quarter of the southeast quarter of the northeast quarter of Section 02, Township 22 south, Range 3 west, Harvey County, approximately 3,900 feet north and 1,000 feet west of the apparent southeast section corner.
 - B.2.3 One irrigation well authorized by Water Right No. 42507 in Lot 2 of the northwest quarter of Section 02, Township 22 south, Range 3 west, Harvey County, approximately 4,052 feet north and 3,885 feet west of the apparent southeast section corner
- B.3 Each data collection point shall be assigned an identification character and marked so as to be easily visible on the data collection point.
- B.4 The water permit owner is responsible for water level measurements and collection and analysis of initial baseline water samples.
- B.5 A trained and qualified person, as determined by the Division of Water Resources and the Equus Beds Groundwater Management District, shall conduct all measurements and sample collection.
- B.6 The water permit owner shall provide the Equus Beds Groundwater Management District and the Division of Water Resources rights of ingress and egress to the monitoring well and irrigation wells as may be reasonably necessary for data gathering or sample collection.

MAR 13 2017

C DATA COLLECTION RECORDS

- C.1 The water permit owner shall maintain accurate permanent records of all water level measurements and water quality analyses.
- C.2 All water level measurements shall be recorded to the nearest 0.1 foot.
- C.3 Record data for each water level measurement shall include:
 - C.3.1 Identification of the data collection point by identification character and legal description;
 - C.3.2 Date of measurement;
 - C.3.3 Time of measurement;
 - C.3.4 Name of person making measurement;
 - C.3.5 Description and elevation of measuring point;
 - C.3.6 Measurement of depth to water from measuring point in feet;
 - C.3.7 Computed depth to water from land surface;
 - C.3.8 Computed water table elevation;
 - C.3.9 If the data collection point is a production well, the date the well was last operated, and
 - C.3.10 Any field observations that may have an effect on the water table.
- C.4 Record data for the initial baseline inorganic water quality analysis shall include:
 - C.4.1 Laboratory name, address and telephone number;
 - C.4.2 Laboratory certification identification number issued by the Kansas Department of Health and Environment;
 - C.4.3 Identification of the data collection point by identification character and legal description;
 - C.4.4 Name of sample collector;
 - C.4.5 Time and date sample was collected;
 - C.4.6 Depth sample was collected;
 - C.4.7 Total depth of the well;
 - C.4.8 Depth to the top of the screen and length of screened interval of the well;
 - C.4.9 Date sample was received by the water chemistry laboratory;
 - C.4.10 Date analysis was performed or reported;
 - C.4.11 Results of analysis, and
 - C.4.12 Name of analyst.

D EQUIPMENT

- D.1 Water level measurements shall be made using one of the following devices:
 - D.1.1 A chalked steel tape with a weight attached to the lower end and graduated to a minimum of 0.1 foot;
 - D.1.2 An M-scope or electric tape graduated to a minimum of 0.1 foot;
 - D.1.3 A factory calibrated pressure transducer;
 - D.1.4 Other devices approved by the Division of Water Resources and the Equus Beds Groundwater Management District; and.
 - D.1.5 Equipment must be clean and free of any contaminants.

MAR 13 2017

Stafford Field Office
Division of Water Resources

- D.2 Initial water quality sample shall be:**
- D.2.1 Taken after water standing in the well casing and in the annulus adjacent to the well screen is removed so that formation water replaces the standing water;
 - D.2.2 Collected by means of:
 - D.2.2.1 A bladder pump;
 - D.2.2.2 A bailer with a double check valve and a bottom emptying device;
 - D.2.2.3 An air lift pump;
 - D.2.2.4 A centrifugal pump, or
 - D.2.2.5 a turbine pump,
 - D.2.3 Placed in new, clean, high-density polyethylene, eight ounce (oz), sample container free of contaminants and sealed with a polyethylene threaded cap, (or container provided by the analyzing laboratory):
 - D.2.3.1 The sample container shall be marked with a durable and waterproof label.
 - D.2.3.2 The label shall contain:
 - D.2.3.2.1 Data collection identification number;
 - D.2.3.2.2 Name of the collector;
 - D.2.3.2.3 Date and time of the sample collection, and
 - D.2.3.2.4 Legal description of the data collection point.
 - D.2.4 Cooled to 4° C and protected from contaminants, and
 - D.2.5 Delivered to a certified laboratory within 24 hours of collection.

E FREQUENCY OF WATER LEVEL MEASUREMENTS

- E.1 An initial water level measurement shall be taken at the data collection point, described in paragraph B.2.2, prior to the installation of the proposed diversion works (irrigation well(s)) described in water permit application #49178.
- E.2 Upon installation of the proposed diversion works, water level measurements shall commence on the data collection points described in paragraphs B.2.1, B.2.2, and B.2.3 (irrigation well(s) and observation well) for a period of ten (10) years as described:
 - E.2.1 Manual water level measurements shall be collected on a monthly basis for two years.
 - E.2.2 Manual monthly measurements shall be collected during the first full week beginning with the first Monday of each month.
 - E.2.3 After two years of monthly measurements, manual water level measurements shall be collected on a quarterly basis for three years.
 - E.2.4 Manual quarterly measurements shall be collected during the first full week beginning with the first Monday of each calendar quarter.
 - E.2.5 After three years of manual quarterly measurements, manual water level measurements shall be collected on an annual basis for five years.
 - E.2.6 Manual annual measurements shall be collected during the first full week beginning with the first Monday of each calendar year.

- E.2.7 Pressure transducer dataloggers will be installed in one of the irrigation wells authorized by Water Permit No. 49178 described in B.2.1, the monitoring well described in B.2.2., and the irrigation well authorized by Water Right No. 42507 described in B.2.3.
- E.2.8 The installation, monitoring, and downloading of the transducer dataloggers will be performed by trained and qualified person, as determined by the Division of Water Resources and the Equus Beds Groundwater Management District.
- E.2.9 The frequency of water-level measurements taken by the transducer dataloggers and downloading frequency will be determined by the Equus Beds Groundwater Management District.
- E.3 Measurements may extend beyond ten (10) years, if it is found by the Chief Engineer, Division of Water Resources and the Board of Directors, Equus Beds Groundwater Management District No. 2 that such data is necessary to:
 - E.3.1 Determine groundwater level changes at the site;
 - E.3.2 Prevent impairment of existing wells and water rights, or
 - E.3.3 Determine other site conditions.

F FREQUENCY AND ANALYSIS OF WATER QUALITY SAMPLES

- F.1 An initial water quality sample shall be collected and analyzed from the data collection point, described in paragraph B.2.2, prior to the operation of the proposed diversion of works (irrigation well(s)) described in water permit application #49178.
- F.2 An initial water quality sample shall be collected and analyzed from the data collection point described in paragraph B.2.1 immediately following its completion.
- F.3 Type of water quality analysis to be performed on each initial sample shall be an inorganic analysis comprised of minerals and metals and including specific conductance.
- F.4 All water chemistry analysis shall be performed by a laboratory certified by the Kansas Department of Health and Environment to perform such analyses.

G REPORTING

- G.1 The applicant shall furnish all water level measurements and water quality analyses performed on the data collection points to the Chief Engineer, Division of Water Resources and the Equus Beds Groundwater Management District, within ten days of a measurement or receipt of an analysis.

RECEIVED

MAR 13 2017

Staff
Division

MAR 13 2017

Stafford City Office
Division of Water Resources**EQUUS BEDS GROUNDWATER MANAGEMENT DISTRICT NO. 2****OBSERVATION WELL SPECIFICATIONS FOR GROUNDWATER LEVEL OR
WATER QUALITY (INORGANIC) MONITORING****SECTION 1 - GENERAL**

1.01—The contractor shall furnish all necessary supervision, labor, tools, materials and equipment, except as maybe noted, to properly drill and construct groundwater observation wells.

1.02--The contractor shall furnish a certificate of insurance to the water permit owner for Workers' Compensation (\$500,000 bodily, \$500,000 property, \$500,000 disease); Comprehensive General Liability, including XCU liability coverage (\$500,000); Property Damage Liability (\$500,000); and Automobile Liability Insurance (\$500,000).

1.03--The Equus Beds Groundwater Management District No. 2 shall furnish a site geologist for the following purposes:

1.03.1.to inspect the well and site during and after well construction and completion;

1.03.2.to determine the well completion and screen depth and placement of the gravel pack ;

1.03.3.to make measurements or collect samples as maybe necessary; and

1.03.4.other matters that may arise during the project that are not listed in the Observation Well Specifications for Groundwater Level or Water Quality (Inorganic) Monitoring, location map and these specifications.

1.04--The contractor shall protect any adjacent equipment, drainage ditches, pavements, crops, fences, above and below ground utility lines and any other site work liable to damage from the execution of this work. Repair of damaged areas shall be made as approved by the water permit owner or the Equus Beds Groundwater Management District No. 2 at the contractor's expense.

1.05--The contractor shall have a valid and current water well contractors drilling license issued by the State of Kansas.

1.06--The contractor shall complete a Kansas Department of Health and Environment form WWC-5 for each well drilled and constructed. The form shall be typed and submitted to the Kansas Department of Health and Environment the Equus Beds Groundwater Management District No. 2, and the water permit owner not later than 30 days upon completion of a well.

MAR 13 2017

1.07--The contractor shall remove all drilling and grouting equipment from the borehole when drilling and construction operations are suspended for the day or interrupted by an unforeseen circumstance.

1.08--The contractor and/or water permit owner shall notify the Equus Beds Groundwater Management District a minimum of 72 hours prior to drilling operations and shall schedule drilling and well construction to allow District staff to witness the drilling and well construction.

SECTION 2- SITE PREPARATION

2.01--The contractor or a representative of the contractor shall identify or locate above and below ground utilities. If necessary, utility locations shall be marked.

2.02--Subject to the approval of the site geologist; the staked observation well location may be moved for safety reasons or to avoid property or equipment damage.

2.03--When the use of wooden or steel planking will not provide rig stabilization; rough grading, cutting and filling shall be permitted for drilling rig stabilization.

2.04--The contractor shall erect and maintain guardrails, lights, temporary enclosures or other equipment as required to safeguard the public.

SECTION 3 - DRILLING

3.01--Pursuant to K.S.A. 82a-1201 through 82a-1215 and amendments thereto, all drilling shall comply with the Kansas Department of Health and Environment Article 30 (Water Well Contractor's License; Water Well Construction and Abandonment).

3.02--The minimum diameter of the borehole shall be six inches from ground level to total depth (TD).

3.03--A portable above-ground drill tank or pit shall be used to circulate drilling fluid and contain drill cuttings.

3.04--Prior to setting casing the borehole TD shall be "tagged" or measured to determine borehole depth.

3.05--Any portion of the borehole that penetrates greater than five feet into bedrock, as determined by the site geologist, shall be plugged back to the observation well's TD.

3.06--Any borehole that is not completed due to unforeseen circumstances shall be plugged from TD to ground level.

RECEIVED
MAR 13 2017

SECTION 4 - WELL CONSTRUCTION

Health Office
Water Resources

4.01--Pursuant to K.S.A. 82a-1201 through 82a-1215 and amendments thereto, well construction shall comply with the Kansas Department of Health and Environment Article 30 (Water Well Contractor's License; Water Well Construction and Abandonment).

4.02--All materials used in the construction of each well shall be properly prepared and installed according to manufacturers' specifications.

4.03--A two inch PVC, schedule 40, slip cap shall be glued to the bottom end of the screen prior to screen installation.

4.04--A ten foot section or joint of two-inch diameter, PVC, schedule 40, slip joint, screen with 0.030 openings shall be set at TD.

4.05--Two-inch diameter, PVC, schedule 40, bell joint, well casing shall be installed from the screen to seven feet below land surface.

4.06--A two-inch diameter, PVC, schedule 40, threaded and slip end, female adapter shall be installed on the PVC well casing. The slip end shall be installed on the PVC well casing using glue and two galvanized screws that do not penetrate the inside surface of the well casing when tightened.

4.07--A prefabricated two-inch diameter, galvanized casing consisting of two, threaded, five feet sections coupled together shall be installed. A non-toxic thread sealing compound shall be used on the threaded joints.

4.08--A two-inch diameter, PVC, schedule 40, threaded, cap shall be installed, without thread sealing compound, on the well casing opening. A 1/8" diameter vent hole shall be drilled through the side of the cap.

4.08—The completed observation well shall be protected by a steel 6 X 6 inch square well protector that is of 5 feet minimum length and has a lockable lid. The monitoring well and square well protector shall be seated in a standard well pad.

4.09—The top of the observation well shall be 9 inches below the top of the square well protector.

MAR 13 2017

SECTION 5 - GRAVEL PACK

5.01--Pursuant to K.S.A. 82a-1201 through 82a-1215 and amendments thereto, installation of the gravel pack shall comply with the Kansas Department of Health and Environment Article 30 (Water Well Contractor's License; Water Well Construction and Abandonment).

5.02--Immediately after the well screen and casing has been installed in the borehole; a gravel pack shall be installed from TD to a maximum of five feet above the top of the screen.

5.03--The gravel pack shall be placed in the same hydrologic unit or zone as determined by the site geologist and shall not connect multiple hydrologic units or zones.

5.04--The gravel pack material shall be clean sand 1/8 inch to 1/4 inch in diameter, placed with a tremie pipe.

5.05--After installation, the top of the gravel pack shall be "tagged" or measured to determine placement. Additional gravel pack shall be added, if needed.

SECTION 6 - GROUTING

6.01--Pursuant to K.S.A. 82a-1201 through 82a-1215 and amendments thereto, grouting shall comply with the Kansas Department of Health and Environment Article 30 (Water Well Contractor's License; Water Well Construction and Abandonment).

6.02--Bentonite clay grout shall be installed in the annular space from the top of the gravel pack to ground level.

6.03--The grout shall be plugging sodium bentonite clay such as that manufactured under the trade name of "HolePlug" or an equivalent approved by the site geologist.

6.04--The grout shall be installed or placed with a tremie pipe or as recommended by the manufacturer.

6.05--Grout intervals less than or equal to 70 feet shall be plugged with sodium bentonite clay such as that manufactured under the trade name of "HolePlug" or an equivalent approved by the site geologist.

6.06--Grout intervals greater than 70 feet shall be plugged with a grout mixture consisting of fresh water and commercial grouting or plugging sodium bentonite clay containing high solids such as that manufactured under the trade name of "Volclay grout" or an equivalent approved by the site geologist. The grout mixture shall be as per manufacturer's recommendations to achieve a minimum weight of 9.4 pounds per gallon of mix. The grout shall be installed or placed with a tremie pipe.

6.07--Grout intervals for all wells from ten feet below land surface to land surface shall be grouted pursuant to Section 6.05.

SECTION 7 - WELL DEVELOPMENT AND SITE CLEANUP

7.01--To insure the well is functioning properly; each well shall be sufficiently developed to remove any drilling fluid and cuttings from the well and gravel pack.

7.02--Litter, drill cuttings and other materials associated with the drilling and construction of the well shall be removed and properly disposed of by the contractor.

7.03--Upon completion of the well, all drilling equipment shall be removed from the site as soon as possible and the site returned to pre-drilling conditions.

SECTION 8 - LOGGING

8.01--To determine the lithology of the unconsolidated material from ground level to TD; the contractor shall collect and log drilling samples at a maximum sample interval of five feet and less, if needed to determine lithology.

RECEIVED

MAR 13 2017

Stafford Field Office
Division of Water Resources

KANSAS DEPARTMENT OF AGRICULTURE
Division of Water Resources

M E M O R A N D U M

TO: Files

DATE: March 15, 2017

FROM: Matt Meier

RE: Application, File No. 49,178

Brain Bretz has filed the referenced application to appropriate groundwater for irrigation use, requesting a battery of four (4) wells, a quantity of 188.5 acre-feet, and a diversion rate of 800 gallons per minute. The proposed well is to be located in the Northeast Quarter of the Southwest Quarter of the Northeast Quarter (NE $\frac{1}{4}$ SW $\frac{1}{4}$ NE $\frac{1}{4}$) of Section 2, more particularly described as being near a point 3,514 feet North and 1,834 feet West of the Southeast corner of said section, in Township 22 South, Range 3 West, Harvey County, within the Little Arkansas drainage basin. The proposed point of diversion is located within the boundaries of Equus Beds Groundwater Management District No. 2. There are no existing water rights overlapping the proposed point of diversion and place of use. The proposed place of use is owned by the Blazefork Farms LLC (ownership changed during processing of application). The applicant signed the application form stating that they have legal access to the point of diversion.

Multiple modifications were made to the application (including reducing quantity, rate, and modifying geo-center location) because of the conditions Equus Beds Groundwater Management District No. 2 required for approval. The applicant stated they were aware of the conditions and ok making them via a phone call and email on March 14, 2017.

The applicant identified 1 domestic well within one-half mile of the proposed well and 1 non-domestic wells, which WRIS confirmed. Nearby well notification letters were sent out on April 29, 2015. A phone call was received from Ernie Kreibel who called to complain about the well location and state he felt it should be moved further away from his well. According to the WRIS database, the nearest non-domestic point of diversion (File No. 42,507) is located 2,120 feet away. Based on the site map the nearest domestic well is approximately 1,600 feet away. The proposed point of diversion meets minimum well spacing to all other existing wells. Per the requirements in K.A.R. 5-22-2(a) for wells located within Equus Beds Groundwater Management District No. 2, the minimum well spacing should be 1,320 feet to all other non-domestic wells and 660 feet to domestic wells.

A test hole log submitted with the application shows top soil from 0 to 3 feet, tan clay from 3 to 48 feet, fine sand with clay from 48 to 53 feet, small to fine sand from 53 to 67 feet, tan clay from 67 to 69 feet, fine sand with clay from 69 to 74 feet, and green shale from 74 to 75 feet below ground. Static water level was listed at 43 feet which provides a saturated thickness of 31 feet.

The requested quantity of water, which was reduced to 188.5 acre-feet to comply with GMD#2 approval conditions, is to irrigate the proposed 153.6 acres identified in the application. This is 1.23 acre-feet per acre which is slightly less than the maximum 1.3 acre-feet per acre allowed for Reno County, Kansas. There are multiple pending applications in this general area of the state, and they are being worked in priority order to ensure that senior applications are provided the available water.

A copy of the application was submitted to Equus Beds Groundwater Management District No. 2 on May 27, 2015. GMD #2 recommended denial of the application in a letter received on February 8, 2016. The denial recommendation was based on a long-term groundwater decline trend that was observed in the area. The applicant appealed the decision to the Board of Directors on February 15, 2016. On March 13, 2017, a letter recommending approval of the application was received (see included letter for full discussion and recommendation). In the letter, they said the Board of Directors recommended approval of the application subject to the following conditions:

1. The proposed annual quantity of water is reduced to 188.5 acre-feet;
2. The proposed maximum rate of diversion is reduced to 800 gpm to comply with the "Battery of wells" definition K.A.R. 5-33-1(n);
3. The proposed well battery geo-center is moved 200 feet south and 200 feet east of the currently proposed location;
4. The implementation of the enclosed groundwater-monitoring schedule which includes monitoring for water level fluctuations and water quality to be taken at the proposed point of diversion, dedicated monitoring well, and irrigation well authorized by Water Right No. 42507 for minimum period of ten (10) years;
5. Installation of the monitoring well and implementation of the groundwater monitoring plan at the applicants expense; and
6. Construction of the monitoring well pursuant to District specifications (copy enclosed) to allow for inorganic water quality analyses.

In accordance with K.S.A. 82a-706c, the Chief Engineer retains full authority to require any water user to install meters, gages, or other measuring devices, which devices he or she or his or her agents may read at any time. Water flowmeter requirements are further described in K.A.R. 5-1-4 through K.A.R. 5-1-12. If any chemical or foreign substance is injected into the water pumped under this permit, a check valve will also need to be installed.

The proposed application is subject to minimum desirable streamflow requirements. The applicant signed, notarized, and returned the required form to our office.

Based on the above discussion, well spacing and safe yield criteria are met, and approval of the application will not impair senior water rights nor prejudicially or unreasonably affect the public interest, it is recommended that the referenced application be approved.

Matthew J. Meier
Environmental Scientist
Water Appropriations Unit

* 3/15/17
Recommended Approval w/GMD conditions.
DK W.C.

1320 Research Park Drive
Manhattan, Kansas 66502
Jackie McClaskey, Secretary



Phone: (785) 564-6700
Fax: (785) 564-6777
Email: ksag@kda.ks.gov
www.agriculture.ks.gov
Sam Brownback, Governor

September 16, 2014

BRIAN BRETZ
1770 APACHE ROAD
MOUNDRIDGE KS 67107

RE: Application
File No. 49,178

Dear Sir or Madam:

Your application for permit to appropriate water in 2-22S-3W, in Harvey County, was received and has been assigned the file number noted above.

As a matter of record, the Division of Water Resources has on hand a large number of applications awaiting processing. Therefore to be fair to all concerned, and so that we can process those applications on hand in the order they were received, we intend to concentrate on the backlog of applications until the issue is resolved. Once review of your application has begun, we will contact you, if additional information is required.

In accordance with the provisions of the Kansas Water Appropriation Act, a portion of which is included below, the use of water as proposed prior to approval of the application is unlawful. Once approved, compliance with the terms, conditions and limitations of the permit is necessary. Conservation of the water resources of Kansas is required.

Section 82a-728 of the Kansas Water Appropriation Act, provides (a) except for the appropriation of water for the purpose of domestic use, . . . it shall be unlawful for any person to appropriate or threaten to appropriate water from any source without first applying for and obtaining a permit to appropriate water in accordance with the provisions of the Water Appropriation Act or for any person to violate any condition of a vested right, appropriation right or an approved application for a permit to appropriate water for beneficial use.

(b) (1) The violation of any provision of this section by any person is a class C misdemeanor . . .

A class C misdemeanor is punishable by a fine not to exceed \$500 and/or a term of confinement not to exceed one month in the county jail. Each day that the violation occurs constitutes a separate offense.

If you have any questions, please contact me at (785) 564-6643. If you wish to discuss a specific file, please have the file number ready so that we may help you more efficiently.

Sincerely,

A handwritten signature in black ink, appearing to read "Richard Rockel".

Richard Rockel
New Application Unit Supervisor
Water Appropriation Program

RAR: al
pc: Stafford Field Office
GMD 2

SCANNED

NW well of battery

Report Date Wednesday, October 14 2015

Water Rights and Points of Diversion Within 2.00 miles of point defined as:

3914 ft N and 2234 ft W of the SE Corner of Section 2, T 22S, R 3W

Located at: 97.618106 West Longitude and 38.170340 North Latitude

GROUNDWATER ONLY

File Number	Use	ST	SR	Dist	(ft)	Q4	Q3	Q2	Q1	FeetN	FeetW	Sec	Twp	Rng	ID	Batt	Auth_Quan	Add_Quan	Unit
A_ 1714	00	IRR	NK	G	3192	--	NE	SW	SW	1250	4000	2	22	3W	3		228.00	228.00	AF
A_ 3975	00	IRR	NK	G	5964	--	SE	NW	NW	4191	4372	12	22	3W	4		80.00	80.00	AF
A_ 6064	00	IRR	NK	G	8465	--	NW	SE	NE	3728	1118	12	22	3W	5		37.00	37.00	AF
A_ 11800	00	IRR	NK	G	3884	--	SE	SW	SE	50	1850	2	22	3W	2		53.00	53.00	AF
A_ 12144	00	IRR	NK	G	6326	--	SE	SE	NE	3281	61	11	22	3W	1		36.00	36.00	AF
A_ 16621	00	IRR	NK	G	5855	--	CE	SE	SW	660	2650	1	22	3W	1		60.00	60.00	AF
A_ 19015	00	IRR	NK	G	10132	--	NE	NW	NW	4890	4400	13	22	3W	1		45.00	45.00	AF
A_ 25719	00	IRR	NK	G	9941	--	NW	SW	SE	940	2050	12	22	3W	3		135.00	135.00	AF
A_ 25790	00	IRR	NK	G	5419	--	--	NC	NE	3950	1350	35	21	3W	1		166.00	166.00	AF
A_ 30544	00	IRR	NK	G	9254	--	--	NC	SW	1362	3855	31	21	2W	1		219.00	219.00	AF
A_ 32898	00	IRR	NK	G	9936	--	--	NC	SE	1350	1298	4	22	3W	5		212.00	212.00	AF
A_ 34689	00	IRR	NK	G	2861	--	--	NC	SE	1320	1320	35	21	3W	2		164.00	164.00	AF
A_ 35900	00	IRR	NK	G	8761	--	SE	SW	SE	500	1500	11	22	3W	2		139.00	139.00	AF
A_ 37287	00	IRR	NK	G	10132	--	NE	NW	NW	4890	4400	13	22	3W	1		98.00	98.00	AF
A_ 39003	00	IRR	NK	G	8465	--	NW	SE	NE	3728	1118	12	22	3W	5		122.00	85.00	AF
A_ 39569	00	IRR	NK	G	6663	--	SE	NW	SE	1960	1762	36	21	3W	1		40.00	40.00	AF
A_ 40298	00	IRR	NK	G	3468	--	NE	NW	SW	2487	4362	1	22	3W	2	G 2	117.00	117.00	AF
Same					3472	--	NE	NW	SW	2372	4409	1	22	3W	3	B 2			
Same					3468	--	NE	NW	SW	2602	4314	1	22	3W	4	B 2			
A_ 42424	00	IRR	NK	G	8490	--	NC	SE	SW	657	3255	25	21	3W	1		189.00	189.00	AF
A_ 42507	00	IRR	NK	G	1657	--	--	--	--	4052	3885	2	22	3W	5		176.00	176.00	AF
A_ 42932	00	IRR	NK	G	3115	--	NW	SE	SW	1214	3948	35	21	3W	4		149.00	149.00	AF
A_ 43032	00	IRR	NK	G	8007	--	--	NC	SE	1268	1322	26	21	3W	3		187.00	187.00	AF
A_ 44845	00	IRR	NK	G	4958	--	SE	SE	SW	26	2769	36	21	3W	3	G 2	43.00	43.00	AF
Same					5096	--	SW	SW	SE	24	2625	36	21	3W	2	B 2			
Same					4822	--	SE	SE	SE	28	2912	36	21	3W	4	B 2			
A_ 45890	00	IRR	NK	G	6326	--	SE	SE	NE	3281	61	11	22	3W	1		45.00	9.00	AF
A_ 47611	00	IRR	LO	G	5337	--	NE	SE	NW	3926	2779	11	22	3W	6	G 2	100.00	100.00	AF
Same					5618	--	NW	SW	NE	3626	2574	11	22	3W	4	B 2			
Same					5362	--	NE	SE	NW	3926	2984	11	22	3W	5	B 2			
A_ 48379	00	IRR	KE	G	3884	--	SE	SW	SE	50	1850	2	22	3W	2		306.80	25.80	AF
A_ 49148	00	IRR	GY	G	6326	--	SE	SE	NE	3281	61	11	22	3W	1		97.50	52.50	AF
A_ 49178	00	IRR	AY	G	915	--	--	--	NE	3960	1320	2	22	3W	6		199.68	199.68	AF
T_20127427	MF	IRR	GY	G	5855	--	CE	SE	SW	660	2650	1	22	3W	1		234.64	.00	AF

Total Net Quantities Authorized:	Direct	Storage
Total Requested Amount (AF) =	199.68	.00
Total Permitted Amount (AF) =	78.30	.00
Total Inspected Amount (AF) =	100.00	.00
Total Pro_Cert Amount (AF) =	.00	.00
Total Certified Amount (AF) =	2667.00	.00
Total Vested Amount (AF) =	.00	.00
TOTAL AMOUNT (AF) =	3044.98	.00

An * after the source of supply indicates a pending application for change for the file number.

An * after the ID indicates a 15 AF exemption was granted for the file number.

A "G" in the Batt column indicates the GEO CTR of a battery. A "B" indicates a well in the battery.

The number in the Batt column is the number of wells in the battery.

Water Rights and Points of Diversion Within 2.00 miles of point defined as:

97.618106 West Longitude and 38.170340 North Latitude

GROUNDWATER ONLY

WATER USE CORRESPONDENTS:

=====

File Number Use ST SR

A__ 1714 00 IRR NK G

> BRUCE REGIER

>

> 18902 NW 96TH ST

> MOUNDRIDGE KS 67107

A__ 3975 00 IRR NK G

> EVELYN KAUFMAN TRUST

> PETER A KAUFMAN TRUSTEE

> 2074 CHEYENNE ROAD

> MOUNDRIDGE KS 67107

A__ 6064 00 IRR NK G

> KEITH & MARIA ALBRECHT

>

> 17009 NW 96TH ST

> MOUNDRIDGE KS 67107

A__ 11800 00 IRR NK G

> BRUCE REGIER

>

> 18902 NW 96TH ST

> MOUNDRIDGE KS 67107

A__ 12144 00 IRR NK G

> KELTON E & MICHELE PITTS

>

> 9117 N WILLOW LAKE RD

> MOUNDRIDGE KS 67107

A__ 16621 00 IRR NK G

> EVELYN KAUFMAN TRUST

> PETER A KAUFMAN TRUSTEE

> 2074 CHEYENNE ROAD

> MOUNDRIDGE KS 67107

A__ 19015 00 IRR NK G

> SUNARK FARMS INC

> ROBERT J FAST

> 17901 W DUTCH AVE

> MOUNDRIDGE KS 67107

A__ 25719 00 IRR NK G

> ALLEN SCHRAG

>
> 5616 NW 60TH ST
> HALSTEAD KS 67056

A__ 25790 00 IRR NK G
> LELAND R GOERING

>
> 1646 ARAPAHO RD
> MOUNDRIDGE KS 67107

A__ 30544 00 IRR NK G
> DALE JANTZEN ET AL

>
> 41 19TH AVE
> MOUNDRIDGE KS 67107

A__ 32898 00 IRR NK G
> PHILIP E & MARY D SCHMIDT

>
> 21827 W DUTCH AVE
> BUHLER KS 67522

A__ 34689 00 IRR NK G
> TJS FARMS LLC

>
> 13007 NW 108TH ST
> MOUNDRIDGE KS 67107

A__ 35900 00 IRR NK G
> SUNARK FARMS INC

> ROBERT J FAST
> 17901 W DUTCH AVE
> MOUNDRIDGE KS 67107

A__ 37287 00 IRR NK G
> SUNARK FARMS INC

> ROBERT J FAST
> 17901 W DUTCH AVE
> MOUNDRIDGE KS 67107

A__ 39003 00 IRR NK G
> KEITH & MARIA ALBRECHT

>
> 17009 NW 96TH ST
> MOUNDRIDGE KS 67107

A__ 39569 00 IRR NK G
> TJS FARMS LLC

>
> 13007 NW 108TH ST
> MOUNDRIDGE KS 67107

A__ 40298 00 IRR NK G

> JUSTIN B SCHRAG
>
> 14030 NW 96TH
> MOUNDRIDGE KS 67107

A__ 42424 00 IRR NK G

> GARY A REGIER ET AL
>
> 1742 ARAPAHO RD
> MOUNDRIDGE KS 67107

A__ 42507 00 IRR NK G

> ERNEST M KREHBIEL JR
>
> 1613 ARAPAHO RD
> MOUNDRIDGE KS 67107

A__ 42932 00 IRR NK G

> TJS FARMS LLC
>
> 13007 NW 108TH ST
> MOUNDRIDGE KS 67107

A__ 43032 00 IRR NK G

> ALAN W & MARI RUTH JUHNKE REV TRUST
>
> 7 SUNSET DR
> HESSTON KS 67062

A__ 44845 00 IRR NK G

> MARK VOGTS
>
> 1795 ARAPAHO RD
> MOUNDRIDGE KS 67107

A__ 45890 00 IRR NK G

> KELTON E & MICHELE PITTS
>
> 9117 N WILLOW LAKE RD
> MOUNDRIDGE KS 67107

A__ 47611 00 IRR LO G

> JOSH & EMILY REGIER
>
> 525 PARK PL
> MOUNDRIDGE KS 67107

A__ 48379 00 IRR KE G

> BRUCE REGIER
>
> 18902 NW 96TH ST

> MOUNDRIDGE KS 67107

>-----

A_ 49148 00 IRR GY G

> KELTON E & MICHELE PITTS

>

> 9117 N WILLOW LAKE RD

> MOUNDRIDGE KS 67107

>-----

A_ 49178 00 IRR AY G

> HOMER B & BETTY R STUCKY

>

> 6110 W MAPLE ST APT 2

> WICHITA KS 67209

>-----

T_ 20127427 MF IRR GY G

> EVELYN KAUFMAN TRUST

> PETER A KAUFMAN TRUSTEE

> 2074 CHEYENNE ROAD

> MOUNDRIDGE KS 67107

>-----

=====

Safe Yield Report Sheet

Proposed Water Right Application

Point of Diversion in NWNESWNE 02-22S-03W

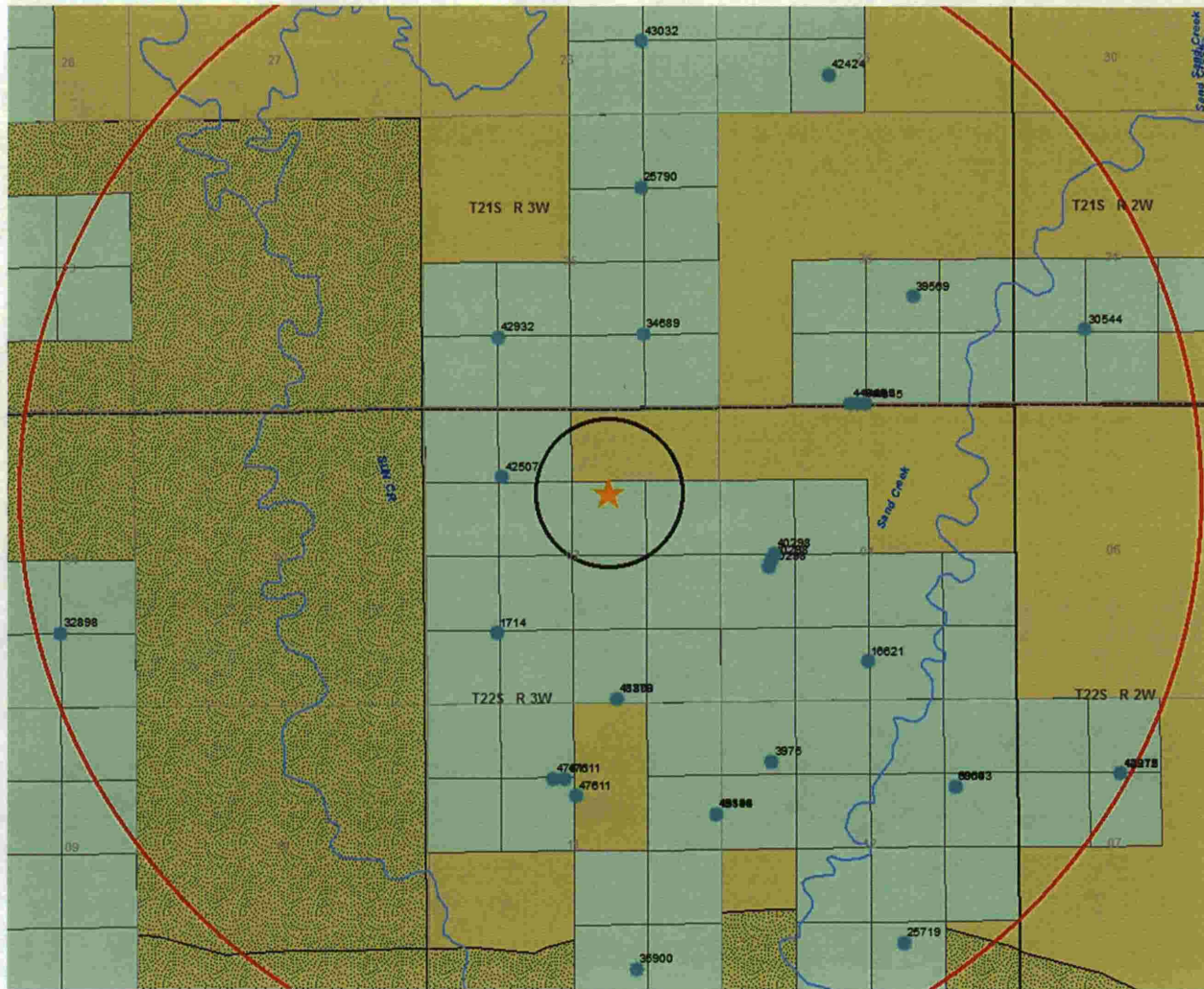

Analysis Results

The selected PD is in an area to new appropriations.
The safe yield, based on the variables listed below is 4,021.00 AF.
Total prior appropriation in the circle is 3,033.80 AF.
Total quantity of water available for appropriation is 987.20 AF.

Safe Yield Variables

The area used for the analysis is set at 8,042 acres.
Potential annual recharge of the area is estimated to be 6 inches.
The percent of recharge available for appropriation is 100%.

Authorized Quantity values are as of 14-OCT-2015 and are based on Appropriated and Vested ground water right and possible stream nodes for GMD #2. Domestic, Term and Temporary water rights have been excluded.

There are 28 water right(s) and 28 point(s) of diversion within the circle.

=====

File Number	Use	ST	SR	Q4	Q3	Q2	Q1	FeetN	FeetW	Sec	Tw	Rng	ID	Qind	Auth_Quant	Add_Quant	Tacres	Nacres
-------------	-----	----	----	----	----	----	----	-------	-------	-----	----	-----	----	------	------------	-----------	--------	--------

A	1714	00	IRR	NK	G	NE SW SW	1250	4000	02	22	03W	3	WR	228.00	228.00	236.00	236.00
A	3975	00	IRR	NK	G	SE NW NW	4191	4372	12	22	03W	4	WR	80.00	80.00	104.00	104.00
A	6064	00	IRR	NK	G	NW SE NE	3728	1118	12	22	03W	5	WR	37.00	37.00	121.00	121.00
A	11800	00	IRR	NK	G	SE SW SE	50	1850	02	22	03W	2	WR	53.00	53.00	236.00	0.00
A	12144	00	IRR	NK	G	SE SE NE	3281	61	11	22	03W	1	WR	36.00	36.00	75.00	75.00
A	12275	00	IRR	NK	G		3940	3223	07	22	02W	4	WR	56.00	56.00	145.00	145.00
A	16621	00	IRR	NK	G	CE SE SW	660	2650	01	22	03W	1	WR	60.00	60.00	43.00	43.00
A	19015	00	IRR	NK	G	NE NW NW	4890	4400	13	22	03W	1	WR	45.00	45.00	95.00	95.00
A	25719	00	IRR	NK	G	NW SW SE	940	2050	12	22	03W	3	WR	135.00	135.00	105.50	105.50
A	25790	00	IRR	NK	G	NC NE	3950	1350	35	21	03W	1	WR	166.00	166.00	140.00	140.00
A	30544	00	IRR	NK	G	NC SW	1362	3855	31	21	02W	1	WR	219.00	219.00	155.00	155.00
A	32898	00	IRR	NK	G	NC SE	1350	1298	04	22	03W	5	WR	212.00	212.00	160.00	160.00
A	34689	00	IRR	NK	G	NC SE	1320	1320	35	21	03W	2	WR	164.00	164.00	131.20	131.20
A	35900	00	IRR	NK	G	SE SW SE	500	1500	11	22	03W	2	WR	139.00	139.00	152.00	152.00
A	37287	00	IRR	NK	G	NE NW NW	4890	4400	13	22	03W	1	WR	98.00	98.00	95.00	0.00
A	39003	00	IRR	NK	G	NW SE NE	3728	1118	12	22	03W	5	WR	122.00	85.00	121.00	0.00
A	39569	00	IRR	NK	G	SE NW SE	1960	1762	36	21	03W	1	WR	40.00	40.00	71.50	71.50
A	40298	00	IRR	NK	G	NE NW SW	2487	4362	01	22	03W	2	WR	117.00	117.00	105.00	105.00
Same			IRR	NK	G	NE NW SW	2602	4314	01	22	03W	4	WR				
Same			IRR	NK	G	NE NW SW	2372	4409	01	22	03W	3	WR				

A	42424	00	IRR	NK	G	NC SE SW	657	3255	25	21	03W	1	WR	189.00	189.00	132.00	132.00
A	42507	00	IRR	NK	G		4052	3885	02	22	03W	5	WR	176.00	176.00	132.00	132.00
A	42932	00	IRR	NK	G	NW SE SW	1214	3948	35	21	03W	4	WR	149.00	149.00	114.00	114.00
A	43032	00	IRR	NK	G	NC SE	1268	1322	26	21	03W	3	WR	187.00	187.00	129.00	129.00
A	44845	00	IRR	NK	G	SW SW SE	24	2625	36	21	03W	2	WR	43.00	43.00	40.00	40.00
Same			IRR	NK	G	SE SE SW	26	2769	36	21	03W	3	WR				
Same			IRR	NK	G	SE SE SE	28	2912	36	21	03W	4	WR				
A	44912	00	IRR	LR	G		3940	3223	07	22	02W	4	WR	188.50	132.50	145.00	0.00
A	45890	00	IRR	NK	G	SE SE NE	3281	61	11	22	03W	1	WR	45.00	9.00	75.00	0.00
A	47611	00	IRR	LO	G	NW SW NE	3626	2574	11	22	03W	4	WR	100.00	100.00	77.00	77.00
Same			IRR	LO	G	NE SE NW	3926	2984	11	22	03W	5	WR				
Same			IRR	LO	G	NE SE NW	3926	2779	11	22	03W	6	WR				
A	48379	00	IRR	KE	G	SE SW SE	50	1850	02	22	03W	2	WR	306.80	25.80	236.00	0.00
A	49148	00	IRR	GY	G	SE SE NE	3281	61	11	22	03W	1	WR	97.50	52.50	75.00	0.00

=====

Water Rights and Points of Diversion Within 2.00 miles of point defined as:

3714 ft N and 2034 ft W of the SE Corner of Section 2, T 22S, R 3W

Located at: 97.617410 West Longitude and 38.169791 North Latitude

GROUNDWATER ONLY

File Number	Use	ST	SR	Dist	(mi)	Q4	Q3	Q2	Q1	FeetN	FeetW	Sec	Twp	Rng	ID	Batt	Auth_Quan	Add_Quan	Unit
A_ 1714	00	IRR	NK	G	.60	--	NE	SW	SW	1250	4000	2	22	3W	3		228.00	228.00	AF
A_ 3975	00	IRR	NK	G	1.08	--	SE	NW	NW	4191	4372	12	22	3W	4		80.00	80.00	AF
A_ 6064	00	IRR	NK	G	1.55	--	NW	SE	NE	3728	1118	12	22	3W	5		37.00	37.00	AF
A_ 11800	00	IRR	NK	G	.69	--	SE	SW	SE	50	1850	2	22	3W	2		53.00	53.00	AF
A_ 12144	00	IRR	NK	G	1.15	--	SE	SE	NE	3281	61	11	22	3W	1		36.00	36.00	AF
A_ 16621	00	IRR	NK	G	1.06	--	CE	SE	SW	660	2650	1	22	3W	1		60.00	60.00	AF
A_ 19015	00	IRR	NK	G	1.87	--	NE	NW	NW	4890	4400	13	22	3W	1		45.00	45.00	AF
A_ 25719	00	IRR	NK	G	1.83	--	NW	SW	SE	940	2050	12	22	3W	3		135.00	135.00	AF
A_ 25790	00	IRR	NK	G	1.06	--	--	NC	NE	3950	1350	35	21	3W	1		166.00	166.00	AF
A_ 30544	00	IRR	NK	G	1.73	--	--	NC	SW	1362	3855	31	21	2W	1		219.00	219.00	AF
A_ 32898	00	IRR	NK	G	1.91	--	--	NC	SE	1350	1298	4	22	3W	5		212.00	212.00	AF
A_ 34689	00	IRR	NK	G	.57	--	--	NC	SE	1320	1320	35	21	3W	2		164.00	164.00	AF
A_ 35900	00	IRR	NK	G	1.62	--	SE	SW	SE	500	1500	11	22	3W	2		139.00	139.00	AF
A_ 37287	00	IRR	NK	G	1.87	--	NE	NW	NW	4890	4400	13	22	3W	1		98.00	98.00	AF
A_ 39003	00	IRR	NK	G	1.55	--	NW	SE	NE	3728	1118	12	22	3W	5		122.00	85.00	AF
A_ 39569	00	IRR	NK	G	1.25	--	SE	NW	SE	1960	1762	36	21	3W	1		40.00	40.00	AF
A_ 40298	00	IRR	NK	G	.61	--	NE	NW	SW	2487	4362	1	22	3W	2	G 2	117.00	117.00	AF
Same					.61	--	NE	NW	SW	2372	4409	1	22	3W	3	B 2			
Same					.61	--	NE	NW	SW	2602	4314	1	22	3W	4	B 2			
A_ 42424	00	IRR	NK	G	1.62	--	NC	SE	SW	657	3255	25	21	3W	1		189.00	189.00	AF
A_ 42507	00	IRR	NK	G	.36	--	--	--	--	4052	3885	2	22	3W	5		176.00	176.00	AF
A_ 42932	00	IRR	NK	G	.64	--	NW	SE	SW	1214	3948	35	21	3W	4		149.00	149.00	AF
A_ 43032	00	IRR	NK	G	1.55	--	--	NC	SE	1268	1322	26	21	3W	3		187.00	187.00	AF
A_ 44845	00	IRR	NK	G	.91	--	SE	SE	SW	26	2769	36	21	3W	3	G 2	43.00	43.00	AF
Same					.94	--	SW	SW	SE	24	2625	36	21	3W	2	B 2			
Same					.89	--	SE	SE	SE	28	2912	36	21	3W	4	B 2			
A_ 45890	00	IRR	NK	G	1.15	--	SE	SE	NE	3281	61	11	22	3W	1		45.00	9.00	AF
A_ 47611	00	IRR	LO	G	.98	--	NE	SE	NW	3926	2779	11	22	3W	6	G 2	100.00	100.00	AF
Same					1.03	--	NW	SW	NE	3626	2574	11	22	3W	4	B 2			
Same					.98	--	NE	SE	NW	3926	2984	11	22	3W	5	B 2			
A_ 48379	00	IRR	KE	G	.69	--	SE	SW	SE	50	1850	2	22	3W	2		306.80	25.80	AF
A_ 49148	00	IRR	GY	G	1.15	--	SE	SE	NE	3281	61	11	22	3W	1		97.50	52.50	AF
A_ 49178	00	IRR	AY	G	.14	--	--	--	NE	3960	1320	2	22	3W	6		199.68	199.68	AF
T_ 20127427	MF	IRR	GY	G	1.06	--	CE	SE	SW	660	2650	1	22	3W	1		234.64	.00	AF

Total Net Quantities Authorized:	Direct	Storage
Total Requested Amount (AF) =	199.68	.00
Total Permitted Amount (AF) =	78.30	.00
Total Inspected Amount (AF) =	100.00	.00
Total Pro_Cert Amount (AF) =	.00	.00
Total Certified Amount (AF) =	2667.00	.00
Total Vested Amount (AF) =	.00	.00
TOTAL AMOUNT (AF) =	3044.98	.00

2,845.3

An * after the source of supply indicates a pending application for change for the file number.

An * after the ID indicates a 15 AF exemption was granted for the file number.

A "G" in the Batt column indicates the GEO CTR of a battery. A "B" indicates a well in the battery.

The number in the Batt column is the number of wells in the battery.

Water Rights and Points of Diversion Within 2.00 miles of point defined as:

97.617410 West Longitude and 38.169791 North Latitude

GROUNDWATER ONLY

WATER USE CORRESPONDENTS:

=====

File Number Use ST SR

A__ 1714 00 IRR NK G

> BRUCE REGIER

>

> 18902 NW 96TH ST

> MOUNDRIDGE KS 67107

A__ 3975 00 IRR NK G

> EVELYN KAUFMAN TRUST

> PETER A KAUFMAN TRUSTEE

> 2074 CHEYENNE ROAD

> MOUNDRIDGE KS 67107

A__ 6064 00 IRR NK G

> KEITH & MARIA ALBRECHT

>

> 17009 NW 96TH ST

> MOUNDRIDGE KS 67107

A__ 11800 00 IRR NK G

> BRUCE REGIER

>

> 18902 NW 96TH ST

> MOUNDRIDGE KS 67107

A__ 12144 00 IRR NK G

> KELTON E & MICHELE PITTS

>

> 9117 N WILLOW LAKE RD

> MOUNDRIDGE KS 67107

A__ 16621 00 IRR NK G

> EVELYN KAUFMAN TRUST

> PETER A KAUFMAN TRUSTEE

> 2074 CHEYENNE ROAD

> MOUNDRIDGE KS 67107

A__ 19015 00 IRR NK G

> SUNARK FARMS INC

> ROBERT J FAST

> 17901 W DUTCH AVE

> MOUNDRIDGE KS 67107

A__ 25719 00 IRR NK G

> ALLEN SCHRAG

>
> 5616 NW 60TH ST
> HALSTEAD KS 67056

A__ 25790 00 IRR NK G
> LELAND R GOERING

>
> 1646 ARAPAHO RD
> MOUNDRIDGE KS 67107

A__ 30544 00 IRR NK G
> DALE JANTZEN ET AL

>
> 41 19TH AVE
> MOUNDRIDGE KS 67107

A__ 32898 00 IRR NK G
> PHILIP E & MARY D SCHMIDT

>
> 21827 W DUTCH AVE
> BUHLER KS 67522

A__ 34689 00 IRR NK G
> TJS FARMS LLC

>
> 13007 NW 108TH ST
> MOUNDRIDGE KS 67107

A__ 35900 00 IRR NK G
> SUNARK FARMS INC

> ROBERT J FAST
> 17901 W DUTCH AVE
> MOUNDRIDGE KS 67107

A__ 37287 00 IRR NK G
> SUNARK FARMS INC

> ROBERT J FAST
> 17901 W DUTCH AVE
> MOUNDRIDGE KS 67107

A__ 39003 00 IRR NK G
> KEITH & MARIA ALBRECHT

>
> 17009 NW 96TH ST
> MOUNDRIDGE KS 67107

A__ 39569 00 IRR NK G
> TJS FARMS LLC

>
> 13007 NW 108TH ST
> MOUNDRIDGE KS 67107

A__ 40298 00 IRR NK G
> JUSTIN B SCHRAG
>
> 14030 NW 96TH
> MOUNDRIDGE KS 67107
>-----

A__ 42424 00 IRR NK G
> GARY A REGIER ET AL
>
> 1742 ARAPAHO RD
> MOUNDRIDGE KS 67107
>-----

A__ 42507 00 IRR NK G
> ERNEST M KREHBIEL JR
>
> 1613 ARAPAHO RD
> MOUNDRIDGE KS 67107
>-----

A__ 42932 00 IRR NK G
> TJS FARMS LLC
>
> 13007 NW 108TH ST
> MOUNDRIDGE KS 67107
>-----

A__ 43032 00 IRR NK G
> ALAN W & MARI RUTH JUHNKE REV TRUST
>
> 7 SUNSET DR
> HESSTON KS 67062
>-----

A__ 44845 00 IRR NK G
> MARK VOGTS
>
> 1795 ARAPAHO RD
> MOUNDRIDGE KS 67107
>-----

A__ 45890 00 IRR NK G
> KELTON E & MICHELE PITTS
>
> 9117 N WILLOW LAKE RD
> MOUNDRIDGE KS 67107
>-----

A__ 47611 00 IRR LO G
> JOSH & EMILY REGIER
>
> 525 PARK PL
> MOUNDRIDGE KS 67107
>-----

A__ 48379 00 IRR KE G
> BRUCE REGIER
>
> 18902 NW 96TH ST

> MOUNDRIDGE KS 67107

>-----

A_ 49148 00 IRR GY G

> KELTON E & MICHELE PITTS

>

> 9117 N WILLOW LAKE RD

> MOUNDRIDGE KS 67107

>-----

A_ 49178 00 IRR AY G

> HOMER B & BETTY R STUCKY

>

> 6110 W MAPLE ST APT 2

> WICHITA KS 67209

>-----

T_ 20127427 MF IRR GY G

> EVELYN KAUFMAN TRUST

> PETER A KAUFMAN TRUSTEE

> 2074 CHEYENNE ROAD

> MOUNDRIDGE KS 67107

>-----

=====

3/14/17

*Geo-center moved 200' South & 200' West of location currently shown.

Application Map - File No. 49178

per requirements of GMD2 board recommendation.

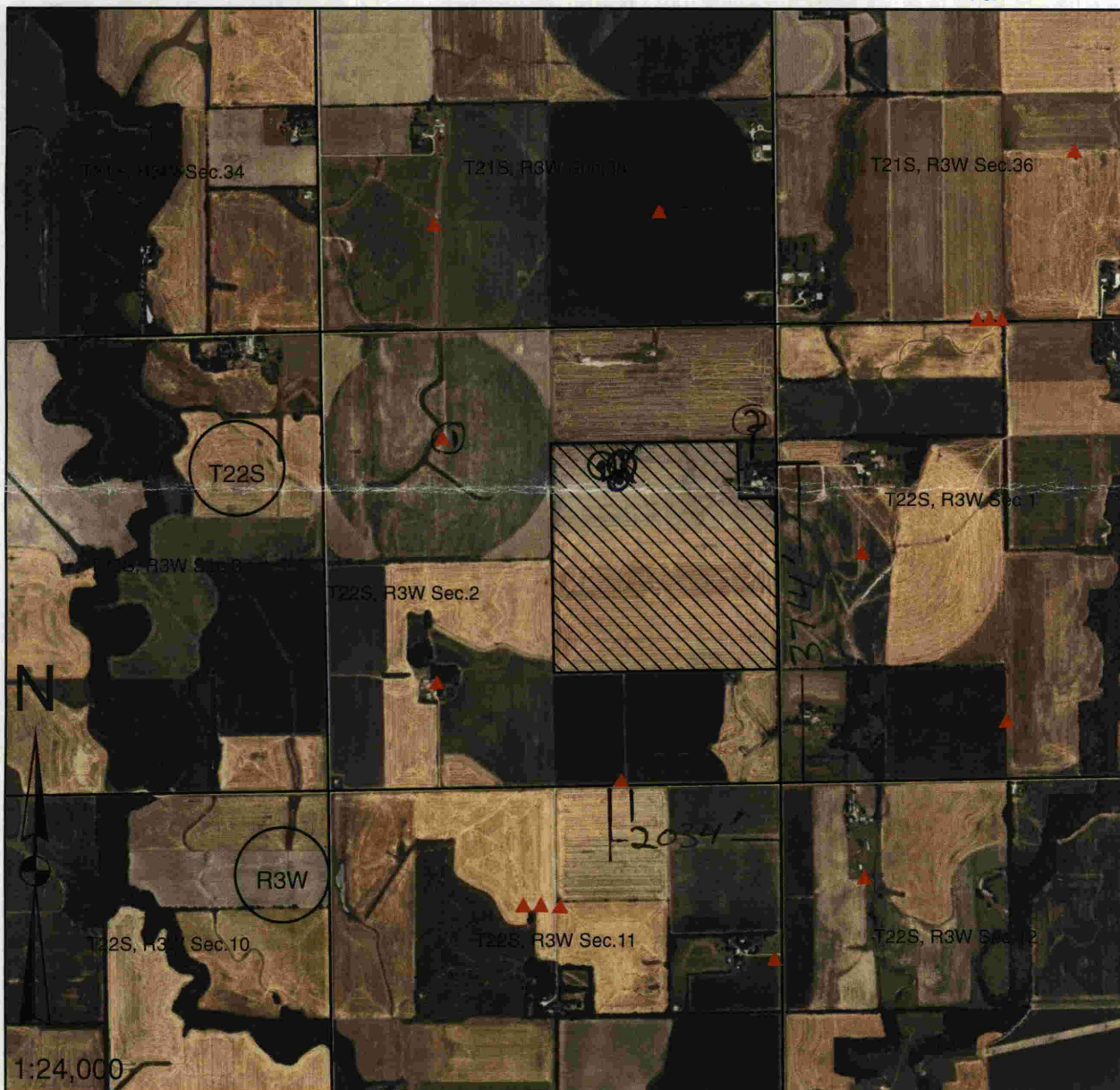

New Geo-center location is 3514' N, 1834' W

I declare that all water wells or diversion sites using the same source of supply and within 1/2 mile of the proposed point of diversion have been plotted on the application map.

Brian J. Boese
Signature

12-2-14
Date

New Application

Application No. _____

Point of Diversion

Place of Use

Use Made of Water

Proposed Point of Diversion

Existing Points of Diversion

Proposed Place of Use

Authorized Place of Use

To Change:
WATER RESOURCES RECEIVED

DEC 04 2014

KS DEPT OF AGRICULTURE

RECEIVED

APR 27 2015

Stafford Field Office
Division of Water Resources

Water wells within 1/2 mile of proposed point of diversion include: (type use, owner, address)

1) Irrigation well - # 42507
Ernest M. Krehbiel Jr.
1613 Arapaho Rd, Moundridge, KS 67107

2) Domestic well
Cedric & Rebecca Blough
10333 N. Willow Lake Rd,
Moundridge, KS 67107

WATER RESOURCES RECEIVED

SEP 15 2014

KS DEPT OF AGRICULTURE

SCANNED

Equus Beds Groundwater Management District No. 2

Spacing Evaluation #49178 for Brian Bretz

NWSWNE (3714'N & 2034'W) 02-22S-03W, Harvey County

Prepared By: S. Flaherty Date: 7/20/2015



R3W

Map Legend

Monitoring Wells

- P_Wells
- AN_Wells
- ⊕ EB_Wells
- IW_Wells

RECEIVED

FEB 08 2016

- Proposed Point of Diversion
- District Boundary
- ▲ Points of Diversion

- Burrton IGUCA
- Hollow Nikkel SWQUA
- McPherson IGUCA
- Enhanced Well Spacing Area



Equus Beds Groundwater Management District No. 2
313 Spruce Street, Halstead, KS 67056
316-835-2224, equusbeds@gmd2.org

Equus Beds Groundwater Management District No. 2

Safe Yield Evaluation #49178 for Brian Bretz

NWSWNE (3714'N & 2034'W) 02-22S-03W, Harvey County

Prepared By: S. Flaherty Date: 7/20/2015

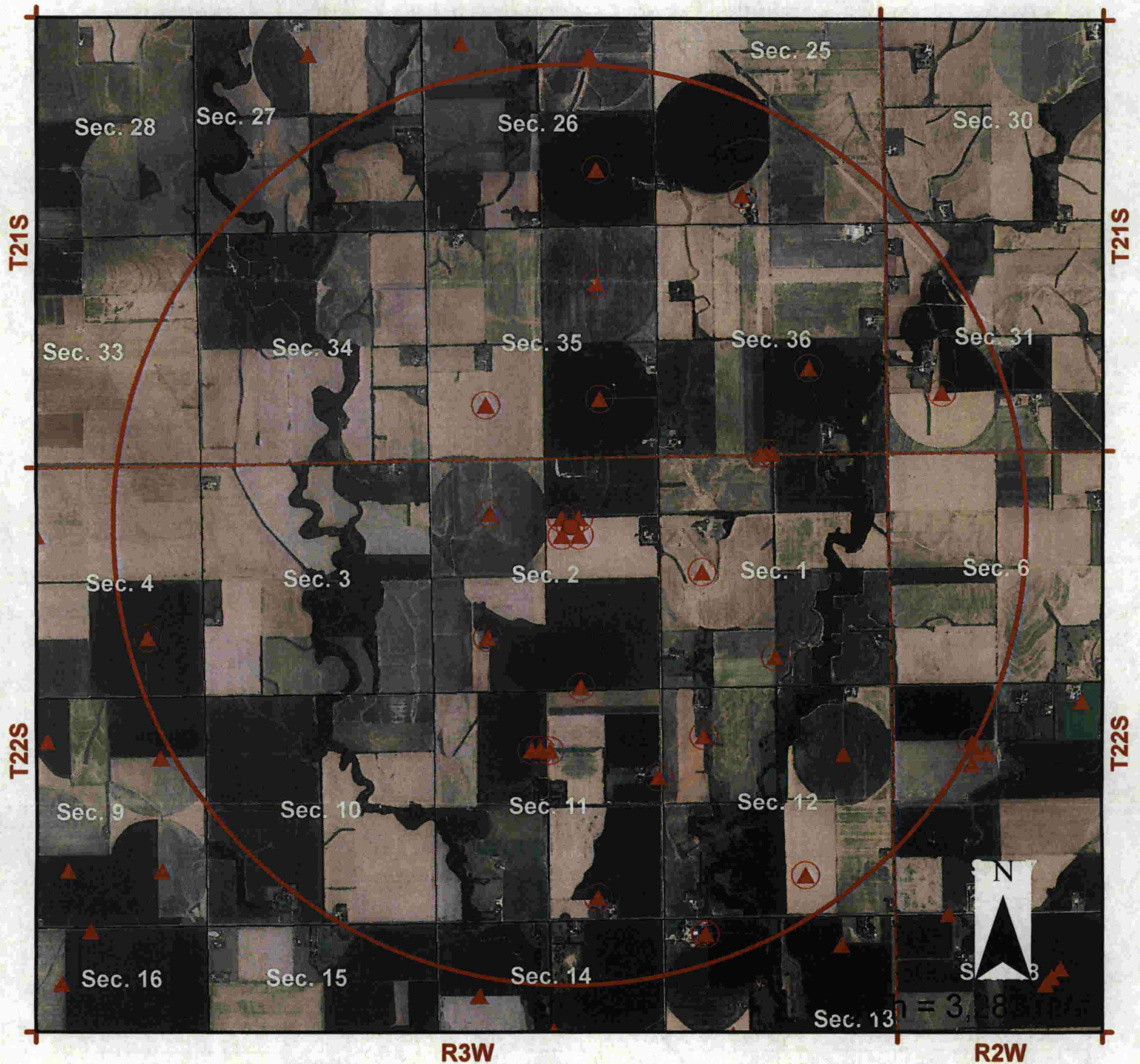

Map Legend

Monitoring Wells

- P_Wells
- AN_Wells
- EB_Wells
- IW_Wells

RECEIVED

FEB 08 2016

Stafford Field Office

Division of Water Resources

Proposed Point of Diversion

District Boundary

Points of Diversion

- Burrton IGUCA
- Hollow Nikkel SWQUA
- McPherson IGUCA
- Enhanced Well Spacing Area



Equus Beds Groundwater Management District No. 2
313 Spruce Street, Halstead, KS 67056
316-835-2224, equusbeds@gmd2.org

SCANNED

SAFEYIELD EVALUATION #49178 for Brian Bretz
LOCATION: NWSWNE (3714'N & 2034'W) 02-22S-03W, Harvey County
SPECIAL USE AREA: None
EVALUATION DATE:- 7/20/2015

Total Areas: 8,042 acres; Area in 3 inch discharge zone: 3,262 acres; Area in 6 inch discharge zone: 4,780 acres

FILE_ID	WELL_ID	TOWNSHIP	RANGE	SECTION	QUALIFIER	USE	AUTHQUANTITY
A00171400	1282	22S	03W	2	12504000	IRR	228
A00397500	841	22S	03W	12	41914372	IRR	80
A00606400	391	22S	03W	12	37281118	IRR	0
A01180000	924	22S	03W	2	501850	IRR	53
A01214400	1485	22S	03W	11	32810061	IRR	36
A01227500	2987	22S	02W	7	39463290	IRR	0
A01662100	1073	22S	03W	1	6602650	IRR	60
A01901500	194	22S	03W	13	48904400	IRR	45
A02571900	3560	22S	03W	12	9402050	IRR	135
A02579000	1777	21S	03W	35	39501350	IRR	166
A03054400	14	21S	02W	31	13623855	IRR	219
A03289800	1696	22S	03W	4	13501298	IRR	212
A03468900	826	21S	03W	35	13201320	IRR	164
A03590000	855	22S	03W	11	5001500	IRR	139
A03728700	1839	22S	03W	13	48904400	IRR	98
A03900300	1076	22S	03W	12	37281118	IRR	122
A03956900	1745	21S	03W	36	19601762	IRR	40
A04029800	723	22S	03W	1	24874362	IRR	117
A04242400	2298	21S	03W	25	6673255	IRR	189
A04250700	2403	22S	03W	2	40523885	IRR	176
A04293200	2484	21S	03W	35	12143948	IRR	149
A04303200	2503	21S	03W	26	12681322	IRR	187
A04484500	3194	21S	03W	36	242625	IRR	0
A04484500	3195	21S	03W	36	282912	IRR	0
A04484500	2902	21S	03W	36	262679	IRR	43
A04491200	2911	22S	02W	7	39463290	IRR	0
A04589000	3183	22S	03W	11	32810061	IRR	9
A04761100	4033	22S	03W	11	39262574	IRR	0
A04761100	4034	22S	03W	11	39262779	IRR	100
A04761100	4035	22S	03W	11	39262984	IRR	0
A04837900	4078	22S	03W	2	501850	IRR	25.8
A04914800	4253	22S	03W	11	32810061	IRR	52.5
A04917800	4279	22S	03W	2	37142034	IRR	199.68
A04917800	4280	22S	03W	2	39141834	IRR	0
A04917800	4281	22S	03W	2	39142234	IRR	0
A04917800	4282	22S	03W	2	35141834	IRR	0
A04917800	4283	22S	03W	2	35142234	IRR	0

Allowable Appropriations	3,205.50	Total Existing Appropriation	3,044.98
Small User Quantity	0	Non Consumptive Appropriations	0
Remaining SUQ	45	Consumptive Appropriations	3,044.98
Note- Values are in acre-feet		Available Appropriations	160.52

49178 - Safe Yield Analysis

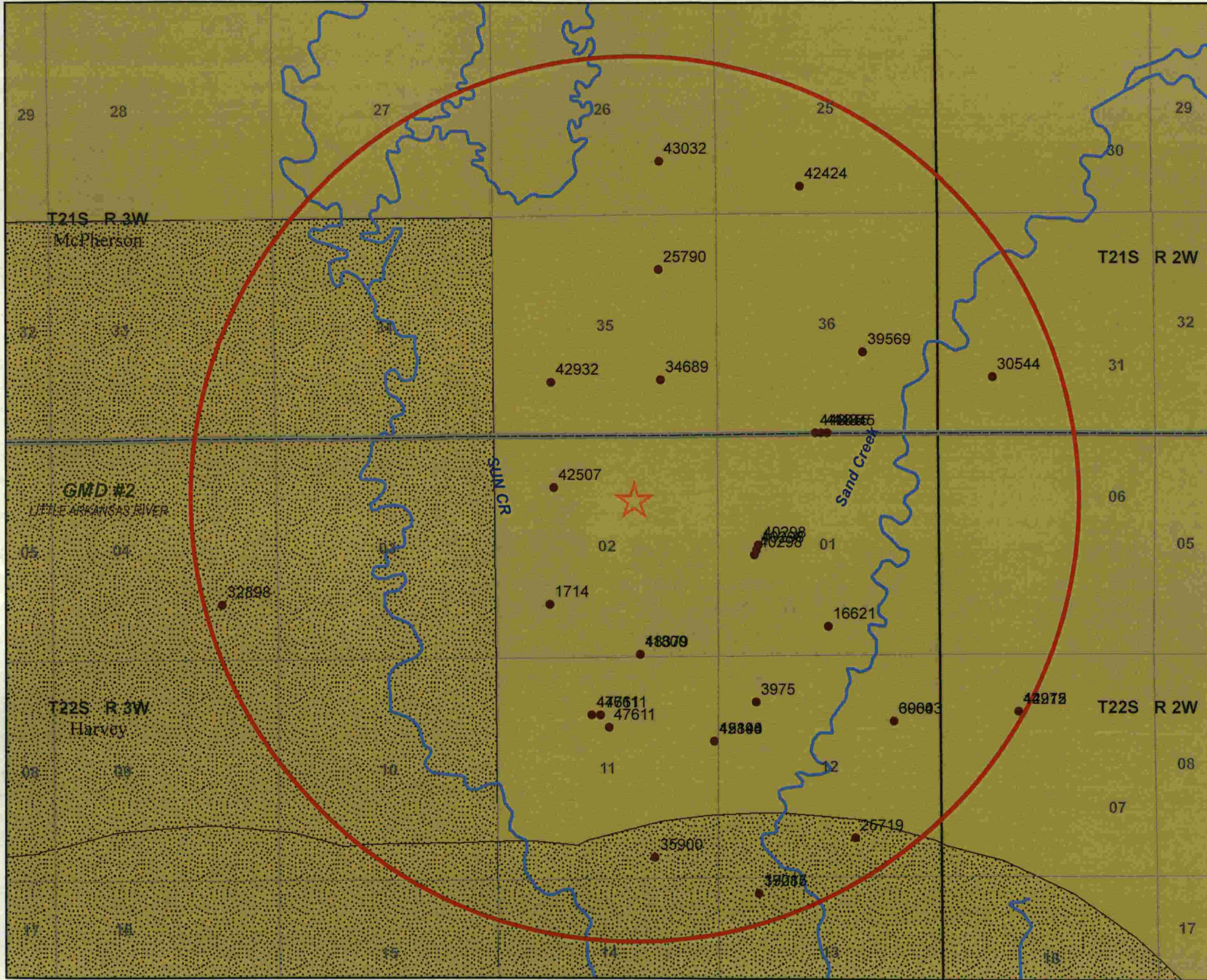

Legend

- Points of Diversion

Index Map

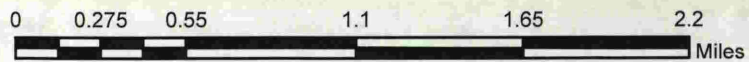
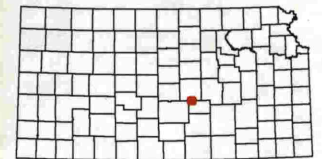

This map was created by WIMAS on 10/14/2015 3:01:02 PM

49178 - Proposed Point of Diversion

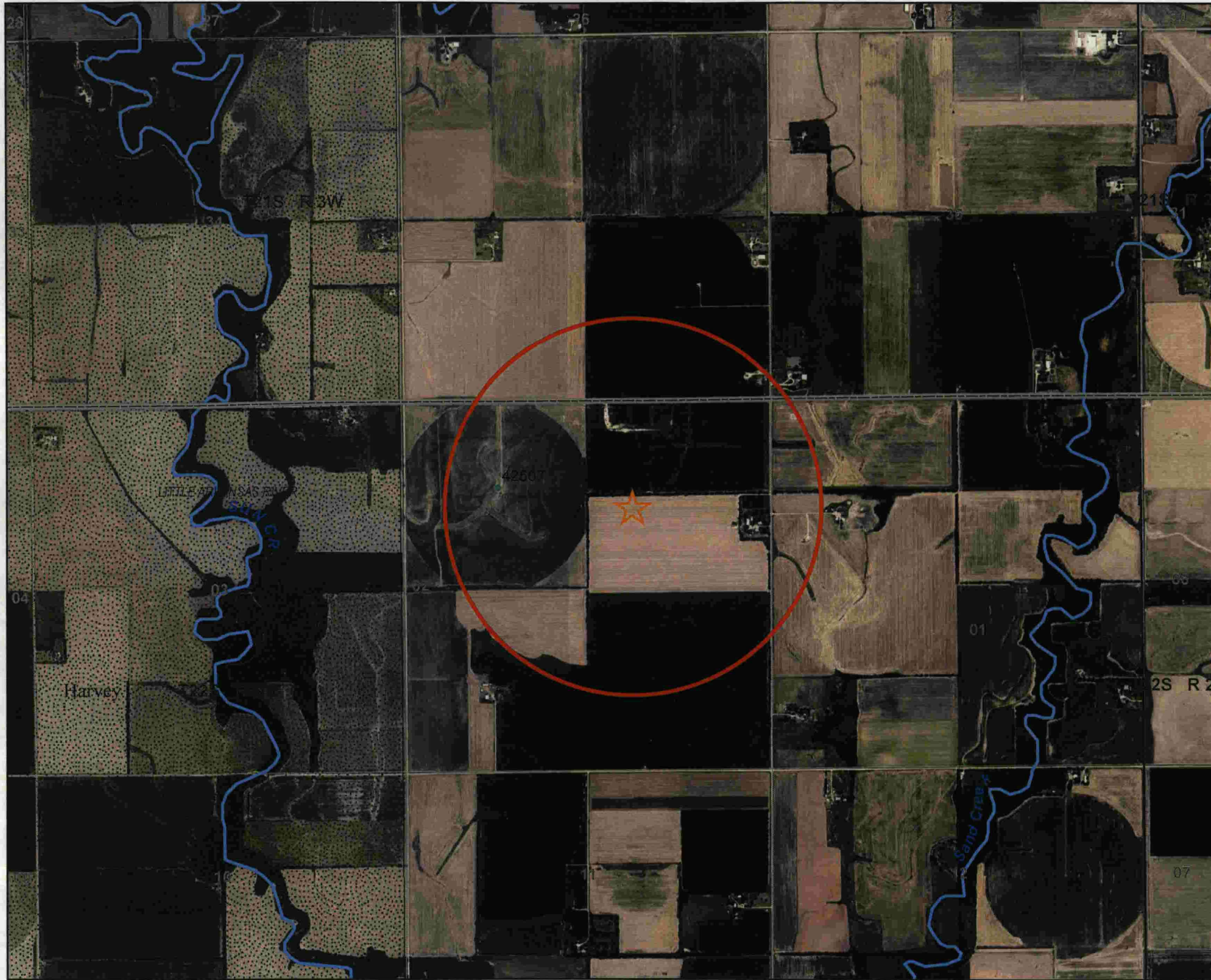

Legend

- Point of Diversion

Index Map

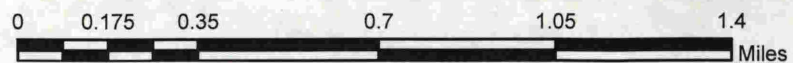
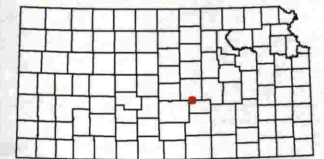

This map was created by AJW/DWR on 10/14/2015