

Submit completed application to:
 Kansas Department of Agriculture
 Division of Water Resources
 Field Office for your area.

Call for address:

Topeka -- (785) 296-5733
 Stafford -- (620) 234-5311
 Stockton -- (785) 425-6787
 Garden City -- (620) 276-2901
<http://agriculture.ks.gov/dwr>

DWR FIELD OFFICE APPLICATION FOR APPROVAL TO CHANGE THE PLACE OF USE AND/OR THE POINT OF DIVERSION



WATER METER REQUIRED

STATE OF KANSAS

Filing Fee Must Accompany the Application, K.S.A. 82a-708b(b), as amended.
 Fee Schedule is on the third page of this application form.

Paragraph Nos. 1, 2, 3 & 5 must be completed. Complete all other applicable portions. If change in point of diversion is greater than 100 feet, or if place of use will be changed, include a topographic map or detailed plat showing the authorized and proposed point(s) of diversion and/or place of use.

RECEIVED
 12:56pm
 SEP 29 2017

File No. 49450

Stafford Field Office
 Division of Water Resources

1. Application is hereby made for approval of the Chief Engineer to change the (check one or both):

Place of Use Point of Diversion

under the water right which is the subject of this application in accordance with the conditions described below.

The source of supply is: Groundwater Surface water

2. Name and address of Applicant: Max Wells

7051 S 375th St W, Cheney KS 67025-9112

Phone Number: (316)393-1780 Email address: _____

Name and address of Water Use Correspondent: Wells M-M Farmland LLC

7051 S 375th St W, Cheney KS 67025-9112

Phone Number: (316)393-1780 Email address: _____

3. The presently authorized place of use is:

Owner of Land ---- NAME: Wells M-M Farmland LLC

ADDRESS: 7051 S 375th St W, Cheney KS 67025-9112

(If there is more than one landowner, attach supplemental sheets as necessary.)

Sec.	Twp.	Range	NE¼				NW¼				SW¼				SE¼				TOTAL ACRES
			NE¼	NW¼	SW¼	SE¼	NE¼	NW¼	SW¼	SE¼	NE¼	NW¼	SW¼	SE¼	NE¼	NW¼	SW¼	SE¼	
10	28S	4W									30	35	31	29					125

4. If this application is for a change in place of use, it is proposed that the place of use be changed to:

Owner of Land ---- NAME: A.) Wells M-M Farmland LLC // B.) Wells M-M Dairy

ADDRESS: A.) 7051 S 375th St W, Cheney KS 67025-9112 // B.) 7051 S 375th St W, Cheney KS 67025-9112

(If there is more than one landowner, attach supplemental sheets as necessary.)

Sec.	Twp.	Range	NE¼				NW¼				SW¼				SE¼				TOTAL ACRES
			NE¼	NW¼	SW¼	SE¼	NE¼	NW¼	SW¼	SE¼	NE¼	NW¼	SW¼	SE¼	NE¼	NW¼	SW¼	SE¼	
A.) 10	28S	4W							0.3	0.2	40	34	32	40			32.5	30.5	209.5
B.) 10	28S	4W															1.5	2	3.5

For Office Use Only: Code _____ Fee \$ <u>200</u> TR # _____ Receipt Date _____ Check # <u>9232</u>
--

5. **Presently authorized point of diversion:**
 One in the NW Quarter of the SE Quarter of the SW Quarter of Section 10, Township 28 South, Range 4 W, in Sedgwick County, Kansas, 1003 feet North 3627 feet West of Southeast corner of section.
 Authorized Rate See Geocenter Authorized Quantity See Geocenter Depth of well NA (feet)
(DWR use only: Computer ID No. 6 GPS 921 feet North 3672 feet West)
 This point will not be changed This point will be changed as follows: No change, point better described with GPS as follows:
Proposed point of diversion: (Complete only if change is requested or if existing point is better described by GPS)
 One in the _____ Quarter of the _____ Quarter of the _____ Quarter of Section _____, Township _____ South, Range _____ (E/W), in _____ County, Kansas, _____ feet North _____ feet West of Southeast corner of section.
 Proposed Rate _____ Proposed Quantity _____ Proposed well depth (feet) _____
 This point is: Additional Well Geo Center List other water rights that will use this point 48126

6. **Presently authorized point of diversion:**
 One in the NW Quarter of the SE Quarter of the SW Quarter of Section 10, Township 28 South, Range 4 W, in Sedgwick County, Kansas, 570 feet North 3303 feet West of Southeast corner of section.
 Authorized Rate See Geocenter Authorized Quantity See Geocenter Depth of well NA (feet)
(DWR use only: Computer ID No. 7 GPS 506 feet North 3321 feet West)
 This point will not be changed This point will be changed as follows: No change, point better described with GPS as follows:
Proposed point of diversion: (Complete only if change is requested or if existing point is better described by GPS)
 One in the _____ Quarter of the _____ Quarter of the _____ Quarter of Section _____, Township _____ South, Range _____ (E/W), in _____ County, Kansas, _____ feet North _____ feet West of Southeast corner of section.
 Proposed Rate _____ Proposed Quantity _____ Proposed well depth (feet) _____
 This point is: Additional Well Geo Center List other water rights that will use this point 48126

7. The changes herein are desired for the following reasons?
 (please be specific) Creating a complete overlap with File Nos. 48126 and 49544

13a. If the proposed point of diversion will be relocated within 100 feet of the existing point of diversion, indicate its location on the diagram below in relation to the existing point of diversion. (PLEASE NOTE: The "X" in center of diagram below represents presently authorized point of diversion.)

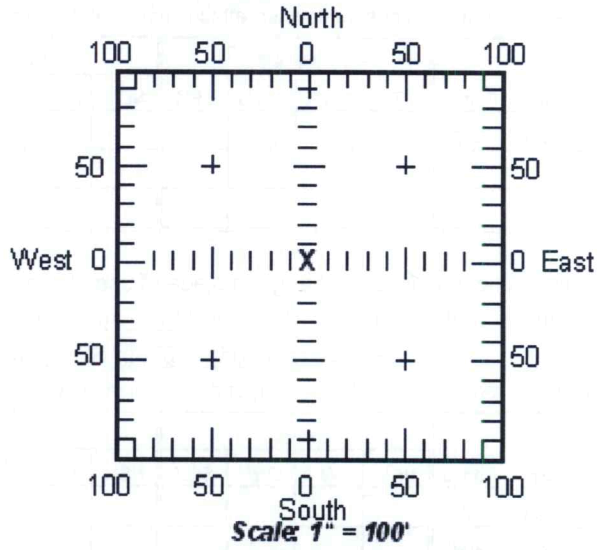

8. If a well, is the test hole log attached? Yes No
9. The change(s) (was)(will be) completed by?
ASAP
10. If the point of diversion is a well:
 (a) What are you going to do with the old well?
NA
 (b) When will this be done? NA
11. Groundwater Management District recommendation attached? Yes No
12. Assisted by TJS - SFFO

13b. If the proposed point of diversion will be relocated more than 100 feet but within 1320 feet from the existing point of diversion, attach a topographic map or aerial photograph. For groundwater sources, show all wells (including domestic) within one-half mile of the proposed point of diversion and the names and mailing addresses of the owners. For surface water sources, show the names and addresses of the landowner(s) one-half mile downstream and one-half mile upstream from your property lines.

RECEIVED
 SEP 29 2017

14. If the proposed groundwater point of diversion is 300 or fewer feet from existing point of diversion, complete the following:
- (a) Does the undersigned represent all owners of the currently authorized place(s) of use identified in this application?
 Yes No (If no, all owners must sign this application.)
 - (b) Will the ownership interest of any owner of the currently authorized place(s) of use identified in this application be adversely affected if this application is approved as requested?
 Yes No (If yes, all owners must sign this application.)
 - (c) If this application is not approved expeditiously, will there be substantial damage to property, public health or safety?
 Yes No (If no, all owners must sign this application.)

If the application proposes a surface water change in point of diversion, a groundwater change in point of diversion greater than 300 feet, or a change in place of use, the application must be signed by all owners of the currently authorized place of use, or their duly authorized agent (attach notarized statement authorizing representation).

I hereby verify, being first duly sworn upon my oath or affirmation and under penalty of perjury, that I am of lawful age and the owner, the spouse of the owner, or a duly authorized agent of the owner(s) to make this application on their behalf, in regards to the water right(s) to which this application pertains. I further verify that the statements contained in this application are true, correct and complete.

Dated at Stafford, Kansas, this 29th day of September, 2017.

<p>x <u>Max E. Wells</u> <u>Manager</u> (Owner) <i>for both entities</i></p> <p><u>Max E. Wells</u> (Please Print)</p> <p>_____ (Owner)</p> <p>_____ (Please Print)</p> <p>_____ (Owner)</p> <p>_____ (Please Print)</p> <p>_____ (Owner)</p> <p>_____ (Please Print)</p>	<p>_____ (Spouse)</p> <p>_____ (Please Print)</p> <p>_____ (Spouse)</p> <p>_____ (Please Print)</p> <p>_____ (Spouse)</p> <p>_____ (Please Print)</p> <p>_____ (Spouse)</p> <p>_____ (Please Print)</p>
---	---

State of Kansas }
 County of Stafford } SS

I hereby certify that the foregoing application was signed in my presence and sworn to before me this 29th day of September, 2017 by Max E. Wells, manager for both entities.



My Commission Expires _____

[Signature]
 Notary Public

ONLY COMPLETE APPLICATIONS WILL BE PROCESSED. To be complete, all of the applicable portions of the application form must be completed with accurate information; maps, if necessary, must be included; signatures of all the appropriate owners' must be affixed to the application and notarized; and the appropriate fee must be paid.

FEE SCHEDULE

Each application to change the place of use or the point of diversion under this section shall be accompanied by the application fee set forth in the schedule below: Make checks payable to: **Kansas Department of Agriculture**

- (1) Application to change a point of diversion 300 feet or less \$100
- (2) Application to change a point of diversion more than 300 feet \$200
- (3) Application to change the place of use \$200

RECEIVED

SEP 29 2017

APPLICATION FOR APPROVAL TO CHANGE
THE PLACE OF USE AND/OR POINT OF DIVERSION
SUPPLEMENTAL SHEET
FILE NO. 49450

Presently authorized point of diversion:

One in the NW Quarter of the SE Quarter of the SW Quarter
of Section 10, Township 28 South, Range 4 W,
in Sedgwick County, Kansas, 1009 feet North 3304 feet West of Southeast corner of section.
Authorized Rate See Geocenter Authorized Quantity See Geocenter Depth of well NA (feet)
(DWR use only: Computer ID No. 9 GPS 1008 feet North 3350 feet West)
 This point will not be changed This point will be changed as follows: No redrill, point better described with GPS as follows:

Proposed point of diversion: (Complete only if change is requested)

One in the _____ Quarter of the _____ Quarter of the _____ Quarter
of Section _____, Township _____ South, Range _____ (E/W),
in _____ County, Kansas, _____ feet North _____ feet West of Southeast corner of section.
Proposed Rate _____ Proposed Quantity _____ Proposed well depth (feet) _____
This point is: Additional Well Geo Center List other water rights that will use this point 48126

Presently authorized point of diversion:

One in the NW Quarter of the SE Quarter of the SW Quarter
of Section 10, Township 28 South, Range 4 W,
in Sedgwick County, Kansas, 662 feet North 3687 feet West of Southeast corner of section.
Authorized Rate See Geocenter Authorized Quantity See Geocenter Depth of well NA (feet)
(DWR use only: Computer ID No. 10 GPS 575 feet North 3686 feet West)
 This point will not be changed This point will be changed as follows: No redrill, point better described with GPS as follows:

Proposed point of diversion: (Complete only if change is requested)

One in the _____ Quarter of the _____ Quarter of the _____ Quarter
of Section _____, Township _____ South, Range _____ (E/W),
in _____ County, Kansas, _____ feet North _____ feet West of Southeast corner of section.
Proposed Rate _____ Proposed Quantity _____ Proposed well depth (feet) _____
This point is: Additional Well Geo Center List other water rights that will use this point 48126

Presently authorized point of diversion: (GEOCENTER)

One in the NW Quarter of the SE Quarter of the SW Quarter
of Section 10, Township 28 South, Range 4 W,
in Sedgwick County, Kansas, 811 feet North 3480 feet West of Southeast corner of section.
Authorized Rate No Change Authorized Quantity No Change Depth of well NA (feet)
(DWR use only: Computer ID No. 11 GPS 753 feet North 3507 feet West)
 This point will not be changed This point will be changed as follows: No redrill, point better described with GPS as follows:

Proposed point of diversion: (Complete only if change is requested)

One in the _____ Quarter of the _____ Quarter of the _____ Quarter
of Section _____, Township _____ South, Range _____ (E/W),
in _____ County, Kansas, _____ feet North _____ feet West of Southeast corner of section.
Proposed Rate _____ Proposed Quantity _____ Proposed well depth (feet) _____
This point is: Additional Well Geo Center List other water rights that will use this point 48126

Presently authorized point of diversion:

One in the _____ Quarter of the _____ Quarter of the _____ Quarter
of Section _____, Township _____ South, Range _____ (E/W),
in _____ County, Kansas, _____ feet North _____ feet West of Southeast corner of section.
Authorized Rate _____ Authorized Quantity _____ Depth of well _____ (feet)
(DWR use only: Computer ID No. _____ GPS _____ feet North _____ feet West)
 This point will not be changed This point will be changed as follows: No redrill, point better described with GPS as follows:

Proposed point of diversion: (Complete only if change is requested)

One in the _____ Quarter of the _____ Quarter of the _____ Quarter
of Section _____, Township _____ South, Range _____ (E/W),
in _____ County, Kansas, _____ feet North _____ feet West of Southeast corner of section.
Proposed Rate _____ Proposed Quantity _____ Proposed well depth (feet) _____
This point is: Additional Well Geo Center List other water rights that will use this point _____

RECEIVED
SEP 29 2017

Stafford Field Office
Division of Water Resources

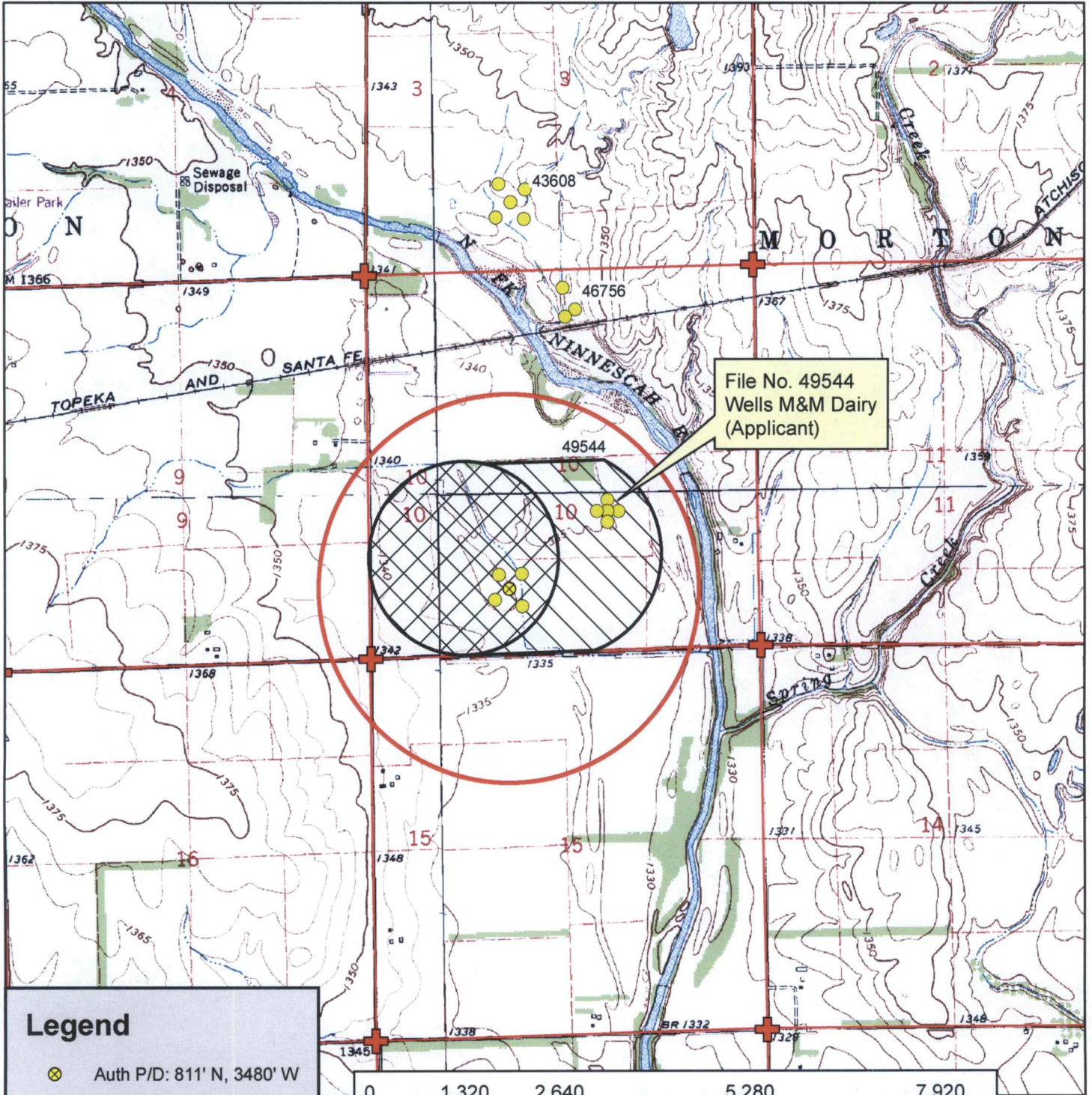

File No. 49544
Wells M&M Dairy
(Applicant)

Legend

- ⊗ Auth P/D: 811' N, 3480' W
- Water Appropriations
- ⊕ Section Corner
- ▭ Section Line
- ★ Domestic Well
- 1/2 Mile Buffer

Place of Use

- ▨ Authorized
- ▩ Proposed

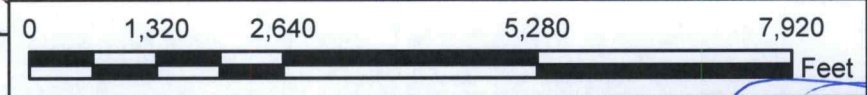

Water Appropriation, File No. 49450

Change in Place of Use Application Map
10-28S-4W // Sedgwick County

49544
OK
Sang
9/29/17

RECEIVED to the best of my knowledge, all water wells including domestic, within 1/2 mile of the authorized point of diversion have been shown.

SEP 29 2017

Stafford Field Office
Division of Water Resources

Signature
May E. Wells

9-29-17