

Kansas Department of Agriculture
Division of Water Resources
PERMIT OF NEW APPLICATION WORKSHEET

| | | | |
|---|---|--|---|
| 1. File Number: <p style="text-align: center;">49,545</p> | 2. Status Change Date: <p style="text-align: center;">7/11/2017</p> | 3. Field Office: <p style="text-align: center;">02</p> | 4. GMD: <p style="text-align: center;">02</p> |
| 5. Status: <input checked="" type="checkbox"/> Approved <input type="checkbox"/> Denied by DWR/GMD <input type="checkbox"/> Dismiss by Request/Failure to Return | | | |
| 6. Enclosures: <input checked="" type="checkbox"/> Check Valve <input checked="" type="checkbox"/> N of C Form <input type="checkbox"/> Water Tube <input checked="" type="checkbox"/> Driller Copy <input checked="" type="checkbox"/> Meter | | | |
| <p>7a. Applicant(s) Person ID <u>62038</u> New to system <input type="checkbox"/> Add Seq# _____</p> <p>UNDERGROUND CAVERN STABILIZATION LLC 7513 S K-14 HWY HUTCHINSON KS 67501</p> | <p>7c. Landowner(s) Person ID _____ New to system <input type="checkbox"/> Add Seq# _____</p> | | |
| <p>7b. Landowner(s) Person ID _____ New to system <input type="checkbox"/> Add Seq# _____</p> <p>7A</p> | <p>7d. Landowner Person ID _____ New to system <input type="checkbox"/> Add Seq# _____</p> | | |
| <p>8. WUR Correspondent Person ID _____ New to system <input type="checkbox"/> Add Seq# _____ Overlap File (s) WUC Notarized WUC Form <input type="checkbox"/> Agree <input type="checkbox"/> Yes <input type="checkbox"/> No</p> <p>7a</p> | <p>9. Use of Water: Changing? <input type="checkbox"/> Yes <input checked="" type="checkbox"/> No</p> <p style="padding-left: 40px;"><input checked="" type="checkbox"/> Groundwater <input type="checkbox"/> Surface Water</p> <p><input type="checkbox"/> IRR <input type="checkbox"/> REC <input type="checkbox"/> DEW <input type="checkbox"/> MUN</p> <p><input type="checkbox"/> STK <input type="checkbox"/> SED <input type="checkbox"/> DOM <input type="checkbox"/> CON</p> <p><input type="checkbox"/> HYD DRG <input type="checkbox"/> WTR PWR <input type="checkbox"/> ART RECHRG</p> <p><input checked="" type="checkbox"/> IND SIC: <u>1310</u> <input type="checkbox"/> OTHER: _____</p> | | |
| 10. Completion Date: <u>12/31/2018</u> 11. Perfection Date: <u>12/31/2022</u> 12. Exp Date: _____ | | | |
| 13. Conservation Plan Required? <input type="checkbox"/> Yes <input checked="" type="checkbox"/> No Date Required: _____ Date Approved: _____ Date to Comply: _____ | | | |
| 14. Water Level Measuring Device? <input type="checkbox"/> Yes <input checked="" type="checkbox"/> No Date to Comply: _____ Date WLMD Installed: _____ | | | |
| <p>Date Prepared: 6/19/17 By: MJM Date Entered: 7/12/2017 By: UM</p> | | | |

File No. **49,545** 15. Formation Code: 190 Drainage Basin: **Arkansas River** County: **RN** Special Use: Stream:

16. Points of Diversion

T
MOD
DEL PDIV
ENT Qualifier S T R ID 'N 'W

| | | | | | | | | | | |
|---|-------|--------|----|-----|----|----|------|------|--|--|
| ✓ | 84972 | NWSENE | 14 | 24S | 6W | 11 | 3852 | 1226 | | |
| | | | | | | | | | | |
| | | | | | | | | | | |
| | | | | | | | | | | |
| | | | | | | | | | | |

17. Rate and Quantity

| Authorized | | Additional | | Overlap PD Files |
|------------|-----------------------------------|------------|-----------------------------------|------------------|
| Rate gpm | Quantity af <i>mgd</i> | Rate gpm | Quantity af <i>mgd</i> | |
| 50 | 5 | 50 | 5 | none |
| | 1.629 | | 1.629 | |
| | | | | |
| | | | | |
| | | | | |

18. Storage: Rate _____ NF Quantity _____ ac/ft Additional Rate _____ NF Additional Quantity _____ ac/ft

19. Limitation: _____ - af/yr at _____ - _____ gpm (_____ cfs) when combined with file number(s) _____
 Limitation: _____ - _____ af/yr at _____ - _____ gpm (_____ cfs) when combined with file number(s) _____

20. Meter Required? Yes No To be installed by **12/31/2018** Date Acceptable Meter Installed _____

21. Place of Use

T
MOD
DEL
ENT PUSE S T R ID

| | NE¼ | | | | NW¼ | | | | SW¼ | | | | SE¼ | | | | Total | Owner | Chg? NO | Overlap Files | |
|---|-------|------|------|------|------|------|------|------|------|------|------|------|------|------|------|------|-------|-------|---------|------------------|--|
| | NE ¼ | NW ¼ | SW ¼ | SE ¼ | NE ¼ | NW ¼ | SW ¼ | SE ¼ | NE ¼ | NW ¼ | SW ¼ | SE ¼ | NE ¼ | NW ¼ | SW ¼ | SE ¼ | | | | | |
| ✓ | 62441 | 14 | 24S | 6W | 6 | | | | | | | | | | | | | 71.7 | 7b. | 47973 & 20129421 | |
| | | | | | | | | | | | | | | | | | | | | | |
| | | | | | | | | | | | | | | | | | | | | | |
| | | | | | | | | | | | | | | | | | | | | | |
| | | | | | | | | | | | | | | | | | | | | | |
| | | | | | | | | | | | | | | | | | | | | | |

Comments: **47973 is to be dismissed.**

KANSAS DEPARTMENT OF AGRICULTURE
Division of Water Resources

M E M O R A N D U M

TO: Files

DATE: June 19, 2017

FROM: Matt Meier

RE: Application, File No. 49,545

The Underground Cavern Stabilization LLC has filed the referenced application to appropriate groundwater for industrial use, requesting one (1) well, a quantity of 5 acre-feet, and a diversion rate of 50 gallons per minute. The proposed well is to be located in the Northwest Quarter of the Southeast Quarter of the Northeast Quarter of Section 15, more particularly described as being near a point 3,852 feet North and 1,226 feet West of the Southeast corner of said section, in Township 24 South, Range 6 West, Reno County, within the Arkansas River drainage basin. The proposed point of diversion is located within the boundaries of Equus Beds Groundwater Management District No. 2. Appropriation of Water, File No. 47,973 overlaps the proposed place of use and is to be dismissed upon approval of the new application. A signed voluntary dismissal form for File No. 47,973 was received on June 12, 2017. File No. 20129421 also covers the same place of use but is used in a different fashion. The proposed place of use is owned by the Underground Cavern Stabilization LLC. The applicant signed the application form stating that they have legal access to the point of diversion.

The applicant identified 13 domestic wells within one-half mile of the proposed well and zero non-domestic wells, which WRIS confirmed. Nearby well notification letters were sent out on February 8, 2017. Phone calls were received from domestic well owners Janice Stuart, Charles Schmid, and Peggy from Cruppers Corner to obtain more information about the application. A letter was received from Danny & Linda Chambers stating that they were against the approval of the application. According to the WRIS database, the nearest non-domestic point of diversion (File No. 38,357) is located 3,172 feet away. Based on the site map the nearest domestic well is approximately 1,200 feet away. The proposed point of diversion meets minimum well spacing to all existing wells. Per the requirements in K.A.R. 5-22-2(a) for a single well located within Equus Beds Groundwater Management District No. 2, the minimum well spacing should be 1,320 feet to all other non-domestic wells and 660 feet to domestic wells.

A well log submitted with the application which shows sandy topsoil from 0 to 4 feet, clay layers from 4 to 18 feet, m sand and gravel from 18 to 50 feet, and tan shale from 50 to 65 feet below ground. Static water level was listed at 24 feet which provides a saturated thickness of 26 feet.

The requested quantity of water, 5 acre-feet, is to be used for truck wash for brine contaminated soils, rock formation cutting, etc and building facility use and qualifies as industrial use. The application is replacing Appropriation of Water, File No 47,973 and based on the supporting information the quantity appears reasonable. There are multiple pending applications in this general area of the state, and they are being worked in priority order to ensure that senior applications are provided the available water.

A copy of the application was submitted to Equus Beds Groundwater management District No. 2 on March 2, 2017. GMD #2 recommended approval of the application in a letter received on April 14, 2017. In the letter they said the application complies with all GMD #2s rules and Regulations, K.A.R. 5-22-1 through 5-22-17, and recommended approval of the application subject to Water Permit No. 47973 being dismissed.

In accordance with K.S.A. 82a-706c, the Chief Engineer retains full authority to require any water user to install meters, gages, or other measuring devices, which devices he or she or his or her agents may read at any time. Water flowmeter requirements are further described in K.A.R. 5-1-4 through K.A.R. 5-1-12. If any chemical or foreign substance is injected into the water pumped under this permit, a check valve will also need to be installed.

The proposed application is subject to minimum desirable streamflow requirements. The applicant signed, notarized, and returned the required form to our office.

Jeff Lanterman, Water Commissioner, Stafford Field Office, recommended approval of the referenced application on March 24, 2017. Based on the above discussion, recommendation from GMD #2, well spacing and safe yield criteria (through a small user exemption) are met, and approval of the application will not impair senior water rights nor prejudicially or unreasonably affect the public interest, it is recommended that the referenced application be approved.

Matthew J. Meier
Environmental Scientist
Water Appropriations Unit

1320 Research Park Drive
Manhattan, Kansas 66502
Jackie McClaskey, Secretary



Phone: (785) 564-6700
Fax: (785) 564-6777
Email: ksag@kda.ks.gov
www.agriculture.ks.gov
Sam Brownback, Governor

July 13, 2017

FILE COPY

UNDERGROUND CAVERN STABILIZATION LLC
7513 S K-14 HWY
HUTCHINSON KS 67501

RE: Application, File No. 49,545

Dear Water User:

There is enclosed a permit to appropriate water authorizing you to proceed with construction of the proposed diversion works (except those dams and stream obstructions regulated by K.S.A. 82a-301 through 305a), to divert such unappropriated water as may be available from the source and at the location specified in the permit, and to use it for the purpose and at the location described in the permit.

Your attention is directed to the enclosures and to the terms, conditions, and limitations specified in this permit. A water meter is required and you must install it prior to water being put to beneficial use in order for you to maintain accurate records of water use. The meter should be used to provide the information required on the annual water use report.

Failure to notify the Chief Engineer of the Division of Water Resources of the completion of the diversion works within the time allowed, or within any authorized extension of time thereof, will result in the dismissal of this permit. Enclosed is a form which may be used to notify the Chief Engineer that the proposed diversion works have been completed.

All requests for extensions of time to complete diversion works, or to perfect appropriations, must be submitted to the Chief Engineer before the expiration of time originally set forth in the permit to complete diversion works or to perfect an appropriation. If for any reason, you require an extension of time, you must request it before the expiration of time set forth in this permit. Failure to comply with this regulation will result in the dismissal of your permit or your water right. Any request for an extension of time shall be accompanied by the required statutory fee, which is currently \$100.00.

There is also enclosed an information sheet setting forth the procedure to obtain a Certificate of Appropriation which will establish the extent of your water right. If you have any questions, please contact our office. If you wish to discuss this specific file, please have the file number ready so that we may help you more efficiently.

Sincerely,

Kristen A. Baum
New Application Unit Supervisor
Water Appropriation Program

Enclosures

pc: Stafford Field Office
GMD#2



KANSAS DEPARTMENT OF AGRICULTURE
Jackie McClaskey, Secretary of Agriculture

DIVISION OF WATER RESOURCES
David W. Barfield, Chief Engineer

**APPROVAL OF APPLICATION
and
PERMIT TO PROCEED**

(This Is Not a Certificate of Appropriation)

This is to certify that I have examined Application, **File No. 49,545** of the applicant

**UNDERGROUND CAVERN STABILIZATION LLC
7513 S K-14 HWY
HUTCHINSON KS 67501**

for a permit to appropriate water for beneficial use, together with the maps, plans and other submitted data, and that the application is hereby approved and the applicant is hereby authorized, subject to vested rights and prior appropriations, to proceed with the construction of the proposed diversion works (except those dams and stream obstructions regulated by K.S.A. 82a-301 through 305a, as amended), and to proceed with all steps necessary for the application of the water to the approved and proposed beneficial use and otherwise perfect the proposed appropriation subject to the following terms, conditions and limitations:

1. That the priority date assigned to such application is **January 22, 2016**.
2. That the water sought to be appropriated shall be used for industrial use on 71.7 acres in the South Half of the Northeast Quarter (S $\frac{1}{2}$ NE $\frac{1}{4}$) of Section 14, Township 24 South, Range 6 West, Reno County, Kansas.
3. That the authorized source from which the appropriation shall be made is groundwater, to be withdrawn by means of one (1) well, which is to located in the Northwest Quarter of the Southeast Quarter of the Northeast Quarter (NW $\frac{1}{4}$ SE $\frac{1}{4}$ NE $\frac{1}{4}$) of Section 14, more particularly described as being near a point 3,852 feet North and 1,226 feet West of the Southeast corner of said section, in Township 24 South, Range 6 West, Reno County, located substantially as shown on the map accompanying the application.
4. That the appropriation sought shall be limited to a maximum diversion rate not in excess of **50 gallons per minute (0.111 c.f.s.)** and to a quantity not to exceed **1.629 million gallons (5 acre-feet)** of water for any calendar year.
5. That installation of works for diversion of water shall be completed on or before **December 31, 2018** or within any authorized extension thereof. The applicant shall notify the Chief Engineer and pay the statutorily required field inspection fee of \$400.00 when construction of the works has been completed. Failure to timely submit the notice and the fee will result in revocation of the permit. Any request for an extension of time shall be submitted prior to the expiration of the deadline and shall be accompanied by the required statutory fee of \$100.00.

6. That the proposed appropriation shall be perfected by the actual application of water to the proposed beneficial use on or before **December 31, 2022** or any authorized extension thereof. Any request for an extension of time shall be submitted prior to the expiration of the deadline and shall be accompanied by the required statutory fee of \$100.00.

7. That the applicant shall not be deemed to have acquired a water appropriation for a quantity in excess of the amount approved herein nor in excess of the amount found by the Chief Engineer to have been actually used for the approved purpose during one calendar year subsequent to approval of the application and within the time specified for perfection or any authorized extension thereof.

8. That the use of water herein authorized shall not be made so as to impair any use under existing water rights nor prejudicially and unreasonably affect the public interest.

9. That the right of the appropriator shall relate to a specific quantity of water and such right must allow for a reasonable raising or lowering of the static water level and for the reasonable increase or decrease of the streamflow at the appropriator's point of diversion.

10. That this permit does not constitute authority under K.S.A. 82a-301 through 305a to construct any dam or other obstruction; nor does it grant any right-of-way, or authorize entry upon or injury to, public or private property.

11. That all diversion works constructed under the authority of this permit into which any type of chemical or other foreign substance will be injected into the water pumped from the diversion works shall be equipped with an in-line, automatic quick-closing, check valve capable of preventing pollution of the source of the water supply. The type of valve installed shall meet specifications adopted by the Chief Engineer and shall be maintained in an operating condition satisfactory to the Chief Engineer.

12. That an acceptable water flow meter shall be installed and maintained on the diversion works authorized by this permit in accordance with Kansas Administrative Regulations 5-1-4 through 5-1-12 adopted by the Chief Engineer. This water flow meter shall be used to provide an accurate quantity of water diverted as required for the annual water use report (including the meter reading at the beginning and end of the report year).

13. That the applicant shall maintain accurate and complete records from which the quantity of water diverted during each calendar year may be readily determined and the applicant shall file an annual water use report with the Chief Engineer by March 1 following the end of each calendar year. Failure to file the annual water use report by the due date shall cause the applicant to be subject to a civil penalty.

14. That no water user shall engage in nor allow the waste of any water diverted under the authority of this permit.

15. That failure without cause to comply with provisions of the permit and its terms, conditions and limitations will result in the forfeiture of the priority date, revocation of the permit and dismissal of the application.

16. That the right to appropriate water under authority of this permit is subject to any minimum desirable streamflow requirements identified and established pursuant to K.S.A. 82a-703c for the source of supply to which this water right applies.

This Order shall become a final agency action, as defined by K.S.A. 77-607(b), without further notice to the parties, if a request for hearing or a petition for administrative review is not filed as set forth below.

Request for Hearing. According to K.A.R. 5-14-3(c), any party who desires a hearing must submit a request within 15 days after the date shown on the Certificate of Service attached to this Order. Filing a request for a hearing will give you the opportunity to submit additional facts for consideration, contest any findings made by the Chief Engineer, or present any other information you believe should be considered in this matter. A timely-filed request for hearing will stay the deadline for requesting administrative review of this Order pending the outcome of the hearing.

Petition for Review. The applicant, if aggrieved by this Order, may petition for administrative review, pursuant to K.S.A. 82a-711(c) and K.S.A. 82a-1901(a). The petition must be filed within 30 days after the date shown on the Certificate of Service attached to this Order and must set forth the basis for the review, unless stayed by the timely filing of a request for hearing.

Any request for hearing or petition for administrative review shall be in writing and shall be submitted to the attention of: Chief Legal Counsel, Kansas Department of Agriculture, 1320 Research Park Drive, Manhattan, Kansas 66502, Fax: (785) 564 - 6777.

Ordered this 11th day of July, 2017, in Topeka, Shawnee County, Kansas.

Lane P. Letourneau

Lane P. Letourneau, L.G.
Program Manager
Water Appropriation Program
Division of Water Resources
Kansas Department of Agriculture

State of Kansas)
) SS
County of Riley)

The foregoing instrument was acknowledged before me this 11th day of July, 2017, by Lane P. Letourneau, L.G., Program Manager, Division of Water Resources, Kansas Department of Agriculture.



Danielle Wilson

Notary Public

CERTIFICATE OF SERVICE

On this 13th day of July, 2017, I hereby certify that the foregoing Approval of Application and Permit to Proceed, File No. 49,545, dated July 11, 2017 was mailed postage prepaid, first class, US mail to the following:

UNDERGROUND CAVERN STABILIZATION LLC
7513 S K-14 HWY
HUTCHINSON KS 67501

With photocopies to:

Stafford Field Office
Equus Beds Groundwater Management District #2

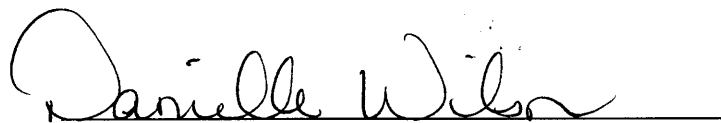

Division of Water Resources

THE STATE OF KANSAS



APPLICATION COMPLETE
1/22/16
Reviewer

KANSAS DEPARTMENT OF AGRICULTURE
Jackie McClaskey, Secretary of Agriculture

DIVISION OF WATER RESOURCES
David W. Barfield, Chief Engineer

File Number 49,545
This item to be completed by the Division of Water Resources.

**APPLICATION FOR PERMIT TO
APPROPRIATE WATER FOR BENEFICIAL USE**
Filing Fee Must Accompany the Application
(Please refer to Fee Schedule attached to this application form.)

WATER RESOURCES
RECEIVED

JAN 22 2016

KS DEPT OF AGRICULTURE

To the Chief Engineer of the Division of Water Resources, Kansas Department of Agriculture,
1320 Research Park Drive, Manhattan, Kansas 66502:

1. Name of Applicant (Please Print): Underground Cavern Stabilization LLC
Address: 7513 S K14 HWY
City: Hutchinson State KS Zip Code 67501
Telephone Number: (620) 662-6367

2. The source of water is: surface water in _____ (stream)
OR groundwater in Arkansas River (drainage basin)

Certain streams in Kansas have minimum target flows established by law or may be subject to administration when water is released from storage for use by water assurance district members. If your application is subject to these regulations on the date we receive your application, you will be sent the appropriate form to complete and return to the Division of Water Resources.

3. The maximum quantity of water desired is 5.0 acre-feet OR 1,629,000 gallons per calendar year, to be diverted at a maximum rate of 50 gallons per minute OR 0.111 cubic feet per second.

Once your application has been assigned a priority, the requested maximum rate of diversion and maximum requested quantity of water under that priority number can **NOT** be increased. Please be certain your requested maximum rate of diversion and maximum quantity of water are appropriate and reasonable for your proposed project and are in agreement with the Division of Water Resources' requirements.

4. The water is intended to be appropriated for (Check use intended):
(a) Artificial Recharge (b) Irrigation (c) Recreational (d) Water Power
(e) Industrial (f) Municipal (g) Stockwatering (h) Sediment Control
(i) Domestic (j) Dewatering (k) Hydraulic Dredging (l) Fire Protection
(m) Thermal Exchange (n) Contamination Remediation

YOU **MUST** COMPLETE AND ATTACH ADDITIONAL DIVISION OF WATER RESOURCES FORM(S) PROVIDING INFORMATION TO SUBSTANTIATE YOUR REQUEST FOR THE AMOUNT OF WATER FOR THE INTENDED USE REFERENCED ABOVE.

FEB 08 2016

Stafford Field Office
Division of Water Resources

For Office Use Only:
F.O. 2 GMD 2 Meets K.A.R. 5-3-1 (YES/NO) Use IND Source G/S County EN By AJW Date 1/22/16
Code REG Fee \$ 200 TR # _____ Receipt Date 1/22/16 Check # 2296

5. The location of the proposed wells, pump sites or other works for diversion of water is:

Note: For the application to be accepted, the point of diversion location must be described to at least a 10 acre tract, unless you specifically request a 60 day period of time in which to locate the site within a specifically described, minimal legal quarter section of land.

(A) One in the NW quarter of the SE quarter of the NE quarter of Section 14, more particularly described as being near a point 3852 feet North and 1226 feet West of the Southeast corner of said section, in Township 24 South, Range 6 West, Reno County, Kansas.

(B) One in the _____ quarter of the _____ quarter of the _____ quarter of Section _____, more particularly described as being near a point _____ feet North and _____ feet West of the Southeast corner of said section, in Township _____ South, Range _____ East/West (circle one), _____ County, Kansas.

(C) One in the _____ quarter of the _____ quarter of the _____ quarter of Section _____, more particularly described as being near a point _____ feet North and _____ feet West of the Southeast corner of said section, in Township _____ South, Range _____ East/West (circle one), _____ County, Kansas.

(D) One in the _____ quarter of the _____ quarter of the _____ quarter of Section _____, more particularly described as being near a point _____ feet North and _____ feet West of the Southeast corner of said section, in Township _____ South, Range _____ East/West (circle one), _____ County, Kansas.

If the source of supply is groundwater, a separate application shall be filed for each proposed well or battery of wells, except that a single application may include up to four wells within a circle with a quarter (1/4) mile radius in the same local source of supply which do not exceed a maximum diversion rate of 20 gallons per minute per well.

A battery of wells is defined as two or more wells connected to a common pump by a manifold; or not more than four wells in the same local source of supply within a 300 foot radius circle which are being operated by pumps not to exceed a total maximum diversion rate of 800 gallons per minute and which supply water to a common distribution system.

6. The owner of the point of diversion, if other than the applicant is (please print):

Same as applicant
(name, address and telephone number)

(name, address and telephone number)

You must provide evidence of legal access to, or control of, the point of diversion from the landowner or the landowner's authorized representative. Provide a copy of a recorded deed, lease, easement or other document with this application. In lieu thereof, you may sign the following sworn statement:

I have legal access to, or control of, the point of diversion described in this application from the landowner or the landowner's authorized representative. I declare under penalty of perjury that the foregoing is true and correct.

Executed on 01/05, 2016. Steve D. Parker
Applicant's Signature

The applicant must provide the required information or signature irrespective of whether they are the landowner. Failure to complete this portion of the application will cause it to be unacceptable for filing and the application will be returned to the applicant.

7. The proposed project for diversion of water will consist of one (1) well & distribution system
(number of wells, pumps or dams, etc.)

and was completed (by) 12/12/15
(Month/Day/Year - each was or will be completed)

8. The first actual application of water for the proposed beneficial use was or is estimated to be 12/12/15
(Mo/Day/Year)

RECEIVED

WATER RESOURCES
RECEIVED

FEB 08 2016

SCANNED JAN 22 2016

- 9. Will pesticide, fertilizer, or other foreign substance be injected into the water pumped from the diversion works?
 Yes No If "yes", a check valve shall be required.

All chemigation safety requirements must be met including a chemigation permit and reporting requirements.

- 10. If you are planning to impound water, please contact the Division of Water Resources for assistance, prior to submitting the application. Please attach a reservoir area capacity table and inform us of the total acres of surface drainage area above the reservoir.

Have you also made an application for a permit for construction of this dam and reservoir with the Division of Water Resources? Yes No

- If yes, show the Water Structures permit number here _____
- If no, explain here why a Water Structures permit is not required _____

- 11. The application must be supplemented by a U.S.G.S. topographic map, aerial photograph or a detailed plat showing the following information. On the topographic map, aerial photograph, or plat, identify the center of the section, the section lines or the section corners and show the appropriate section, township and range numbers. Also, please show the following information:

- (a) The location of the proposed point(s) of diversion (wells, stream-bank installations, dams, or other diversion works) should be plotted as described in Paragraph No. 5 of the application, showing the North-South distance and the East-West distance from a section line or southeast corner of section.
- (b) If the application is for groundwater, please show the location of any existing water wells of any kind within 1/2 mile of the proposed well or wells. Identify each existing well as to its use and furnish the name and mailing address of the property owner or owners. If there are no wells within 1/2 mile, please advise us.
- (c) If the application is for surface water, the names and addresses of the landowner(s) 1/2 mile downstream and 1/2 mile upstream from your property lines must be shown.
- (d) The location of the proposed place of use should be shown by crosshatching on the topographic map, aerial photograph or plat.
- (e) Show the location of the pipelines, canals, reservoirs or other facilities for conveying water from the point of diversion to the place of use.

A 7.5 minute U.S.G.S. topographic map may be obtained by providing the section, township and range numbers to: Kansas Geological Survey, 1930 Constant, Campus West, University of Kansas, Lawrence, Kansas 66047.

- 12. List any application, appropriation of water, water right, or vested right file number that covers the same diversion points or any of the same place of use described in this application. Also list any other recent modifications made to existing permits or water rights in conjunction with the filing of this application.

File No. 47973 authorizes the same place of use and will be dismissed upon approval of this application.

File No. 20129421 authorizes the same place of use, but is used in a different fashion.

WATER RESOURCES
RECEIVED

JAN 22 2016

RECEIVED

FEB 08 2016

KS DEPT OF AGRICULTURE

SCANNED

13. Furnish the following well information if the proposed appropriation is for the use of groundwater. If the well has not been completed, give information obtained from test holes, if available.

Information below is from: Test holes Well as completed Drillers log attached

| Well location as shown in paragraph No. | (A) | (B) | (C) | (D) |
|---|-----------------|-------|-------|-------|
| Date Drilled | <u>12/12/15</u> | _____ | _____ | _____ |
| Total depth of well | <u>65</u> | _____ | _____ | _____ |
| Depth to water bearing formation | <u>18</u> | _____ | _____ | _____ |
| Depth to static water level | <u>24</u> | _____ | _____ | _____ |
| Depth to bottom of pump intake pipe | _____ | _____ | _____ | _____ |

14. The relationship of the applicant to the proposed place where the water will be used is that of

owner
(owner, tenant, agent or otherwise)

15. The owner(s) of the property where the water is used, if other than the applicant, is (please print):

same as applicant
(name, address and telephone number)

(name, address and telephone number)

16. The undersigned states that the information set forth above is true to the best of his/her knowledge and that this application is submitted in good faith.

Dated at 01/05/16, Kansas, this 05 day of January, 2016.
(month) (year)

(Applicant Signature)

By _____
(Agent or Officer Signature)

(Agent or Officer - Please Print)

Assisted by EKF SFFO/ESII Date: 12/29/15
(office/title)

RECEIVED

FEB 08 2016

WATER RESOURCES RECEIVED

JAN 22 2016

SCANNED

KS DEPT OF AGRICULTURE

INDUSTRIAL USE SUPPLEMENTAL SHEET

File No. 49,545

Name of Applicant (Please Print): Underground Cavern Stabilization LLC

- Please describe type of industry or product produced: Truck Wash for brine contaminated soils, rock formation cuttings, etc and building facility use Standard Industrial Classification Code Number: 1310
- Please complete the following table to show your past and present water requirements:

PAST PRODUCT PRODUCTION AND WATER DIVERTED, IF APPLICABLE

| LAST 5 YEARS | AMOUNT OF PRODUCT | WATER DIVERTED (GALLONS) | GALLONS PER PRODUCT PER DAY |
|--------------|-------------------|--------------------------|-----------------------------|
| 5 years ago | N/A | N/A | N/A |
| Last year | N/A | 45,570 | N/A |
| Present year | N/A | 31,000 | N/A |

- Please complete the following table to show your future water requirements:

ESTIMATED FUTURE PRODUCT PRODUCTION AND WATER DIVERTED

| NEXT 5 YEARS | AMOUNT OF PRODUCT | WATER TO BE DIVERTED (GALLONS) | GALLONS PER PRODUCT PER DAY |
|--------------|-------------------|--------------------------------|-----------------------------|
| Year 1 | N/A | 1,626,255 | N/A |
| Year 2 | N/A | 1,626,255 | N/A |
| Year 3 | N/A | 1,626,255 | N/A |
| Year 4 | N/A | 1,626,255 | N/A |
| Year 5 | N/A | 1,626,255 | N/A |

Number of days of operation of the industry per year is 365 days.

Please attach any tables, curves or additional information showing past, present and estimated future water requirements to substantiate the amount of water requested.

- Please designate the legal description of the location where the water is to be used. Show in the space provided below the Section (S), Township (T), and Range (R), and the number of acres in each forty acre tract or fractional portion thereof.

| S | T | R | NE¼ | | | | NW¼ | | | | SW¼ | | | | SE¼ | | | | TOTAL |
|----|-----|----|-----|----|----|------|-----|----|----|----|-----|----|----|----|-----|----|----|----|-------|
| | | | NE | NW | SW | SE | NE | NW | SW | SE | NE | NW | SW | SE | NE | NW | SW | SE | |
| 14 | 24S | 6W | | | 40 | 31.7 | | | | | | | | | | | | | 71.7 |
| | | | | | | | | | | | | | | | | | | | |

You may attach any additional information you believe will assist in informing the Division of the need for your request.

RECEIVED

**WATER RESOURCES
RECEIVED**

FEB 08 2016

JAN 22 2016

SCANNED

Draft

KANSAS DEPARTMENT OF AGRICULTURE
Division of Water Resources

M E M O R A N D U M

TO: Files

DATE: May 23, 2017

FROM: Matt Meier

RE: Application, File No. 49,545

The Underground Cavern Stabilization LLC has filed the referenced application to appropriate groundwater for industrial use, requesting one (1) well, a quantity of 5 acre-feet, and a diversion rate of 50 gallons per minute. The proposed well is to be located in the Northwest Quarter of the Southeast Quarter of the Northeast Quarter of Section 15, more particularly described as being near a point 3,852 feet North and 1,226 feet West of the Southeast corner of said section, in Township 24 South, Range 6 West, Reno County, within the Arkansas River drainage basin. The proposed point of diversion is located within the boundaries of Equus Beds Groundwater Management District No. 2. Appropriation of Water, File No. 47973 overlaps the proposed place of use and is to be dismissed upon approval of the new application. File No. 20129421 also covers the same place of use but is used in a different fashion. The proposed place of use is owned by the Underground Cavern Stabilization LLC. The applicant signed the application form stating that they have legal access to the point of diversion.

The applicant identified 13 domestic wells within one-half mile of the proposed well and zero non-domestic wells, which WRIS confirmed. Nearby well notification letters were sent out on February 8, 2017. Phone calls were received from domestic well owners Janice Stuart, Charles Schmid, and Peggy from Cruppers Corner to obtain more information about the application. A letter was received from Danny & Linda Chambers stating that they were against the approval of the application. According to the WRIS database, the nearest non-domestic point of diversion (File No. 38,357) is located 3,172 feet away. Based on the site map the nearest domestic well is approximately 1,200 feet away. The proposed point of diversion meets minimum well spacing to all existing wells. Per the requirements in K.A.R. 5-22-2(a) for a single well located within Equus Beds Groundwater Management District No. 2, the minimum well spacing should be 1,320 feet to all other non-domestic wells and 660 feet to domestic wells.

A well log submitted with the application which shows sandy topsoil from 0 to 4 feet, clay layers from 4 to 18 feet, m sand and gravel from 18 to 50 feet, and tan shale from 50 to 65 feet below ground. Static water level was listed at 24 feet which provides a saturated thickness of 26 feet.

The requested quantity of water, 5 acre-feet, is to be used for truck wash for brine contaminated soils, rock formation cutting, etc and building facility use and qualifies as industrial use. The application is replacing Appropriation of Water, File No 47,973 and based on the supporting information the quantity appears reasonable. There are multiple pending applications in this general area of the state, and they are being worked in priority order to ensure that senior applications are provided the available water.

A copy of the application was submitted to Equus Beds Groundwater management District No. 2 on March 2, 2017. GMD #2 recommended approval of the application in a letter received on April 14, 2017. In the letter they said the application complies with all GMD #2s rules and Regulations, K.A.R. 5-22-1 through 5-22-17, and recommended approval of the application subject to Water Permit No. 47973 being dismissed.

In accordance with K.S.A. 82a-706c, the Chief Engineer retains full authority to require any water user to install meters, gages, or other measuring devices, which devices he or she or his or her agents may read at any time. Water flowmeter requirements are further described in K.A.R. 5-1-4 through K.A.R. 5-1-12. If any chemical or foreign substance is injected into the water pumped under this permit, a check valve will also need to be installed.

The proposed application is subject to minimum desirable streamflow requirements. The applicant signed, notarized, and returned the required form to our office.

Based on the above discussion, recommendation from GMD #2, well spacing and safe yield criteria (through a small user exemption) are met, and approval of the application will not impair senior water rights nor prejudicially or unreasonably affect the public interest, it is recommended that the referenced application be approved.

Matthew J. Meier
Environmental Scientist
Water Appropriations Unit

*5/24 Approve it
MJP*

FRED SEILER, PRESIDENT
VIN KISSICK, VICE PRESIDENT
JEFF WINTER, SECRETARY
MIKE MCGINN, TREASURER
TIM BOESE, MANAGER
THOMAS A. ADRIAN, ATTORNEY



DIRECTORS:
DAVID BOGNER
ALAN BURGHART
JOE PAJOR
BOB SEILER
DAVID STROBERG

EQUUS BEDS GROUNDWATER MANAGEMENT DISTRICT NO. 2

313 SPRUCE STREET • HALSTEAD, KANSAS 67056-1925 • PHONE (316) 835-2224 • FAX (316) 835-2225 • equusbeds@gmd2.org • www.gmd2.org

April 11, 2017

Chief Engineer, Division of Water Resources
Attn: Matt Meier
300 S. Main St.
Stafford, Kansas 67578

Re: Appropriation Application No. 49,545 – Underground Cavern Stabilization LLC

Dear Mr. Meier:

The Equus Beds Groundwater Management District No. 2 reviewed the referenced appropriation application on April 11, 2017, using the District's Revised Management Program (effective May 1, 1995) and Rules and Regulations K.A.R. 5-22-1 through 5-22-17.

The application complies with the Revised Aquifer Management program approved by the Chief Engineer and with the District's Rules and Regulations K.A.R. 5-22-1 through 5-22-17. Therefore, the application is recommended for approval by the Equus Beds Groundwater Management District No. 2, subject to Water Permit No. 47973 being dismissed as requested by the applicant.

A District decision may be appealed to the District Board of Directors by submitting a written petition to the District office within 30 days from date of this notification, pursuant to K.A.R. 5-22-12.

Please contact the District should you have any questions regarding the review or recommendation.

Sincerely,
EQUUS BEDS GROUNDWATER
MANAGEMENT DISTRICT NO. 2

Tim Boese
Manager
TDB/STF

Enclosures

pc: Underground Cavern Stabilization LLC., Applicant and Landowner
Danny and Linda Chambers, Nearby well owners

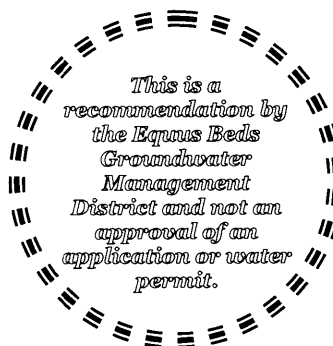

RECEIVED
SCANNED
APR 14 2017

Stafford Field Office
Division of Water Resources



EQUUS BEDS GROUNDWATER MANAGEMENT DISTRICT NO. 2 FINAL APPLICATION REVIEW CHECKLIST

- 1) Application No. 49545 Date filed: 01/22/16
- 2) Applicant: Underground Cavern Stabilization LLC County: RN
- 3) Proposed maximum quantity: 5.0 acre-feet/year Rate: 50 GPM
- 4) Proposed Use: Industrial
- 5) P/D location: NW SE NE 14-24S-6W Geo Center: North 3852 ft, West 1226 ft
- 6) Number and type of points of diversion listed on the application 1 Well
-
- 7) Meter required K.A.R. 5-22-4a or K.A.R. 5-22-8? Yes No, Why _____
-
- 8) Meets Safe Yield K.A.R. 5-22-7? Yes No N/A
- (a) Total allowable appropriations: 2662.67 af/yr
- (b) Total existing appropriations: 5308.5 af/yr
- (c) Total small user exemptions: 5.00 af/yr
- (d) Total non-consumptive use: 0.00 af/yr
- (e) Total consumptive use: 5308.50 af/yr
(Total existing appropriations) - (Total non-consumptive use)
- (f) exempt from regulation? Yes No,
Cite exemption: K.A.R. 5-22-7(b)(1) - Small User exemption
-
- 9) Meets Well Spacing K.A.R. 5-22-2? Yes No N/A
- (a) POD in enhanced well spacing area? Yes No
- (b) Domestic well spacing interval: >660 ft
- (c) Non-Domestic well spacing interval: >1320 ft
-
- 10) Meets Max Reasonable Quantity K.A.R. 5-22-14? Yes No N/A
- (a) Irrigation max quantity: _____ acre-feet / acre
application paragraph 3 value (acre-feet) / proposed acres = Q
- (b) Stockwater max quantity: _____ GPD _____ unit
- (c) Industry max quantity: _____ Acre
Industry standard: _____
- (d) Municipal max quantity: _____ GCD
Lesser of either 200 GCD or
 $1.10 * (X - Y) * 365 d * (z + t)$
X - Average of last three years usage in Gallons per Capita per Day (GCD)
Y - water usage for industries that use over 200,000 gal/yr (GCD)
Z - Projected population in 20 years
T - Reasonable projected water use for industries that use over 200,000 gallons per year (GCD)
- (e) Pond max quantity is _____
(Net evap + seepage)/12 x pond area + any initial fill
- (f) Groundwater pit max Q: _____
Net evap * pit area/12
-
- 11) Reasonable rate for intended use? Yes No N/A
- 12) Depth to water: 17 ft bls at observation well: SC 42652-1
-
- 13) Date reviewed: 4/11/2017
- 14) Reviewed by: S. Flaherty Title: Hydrogeologist *Reviewed 4-11-17*
- 15) District recommendation: Approve Deny Other, see comment

16) Comments and Calculations:

New application submitted by Underground Cavern Stabilization LLC for a Small User permit for Industrial use in Reno County. Proposed point of diversion is the well that is authorized by Water Permit No. 47973, but the well was drilled more than 300 feet from the authorized location. Application replaces No. 47973 and proposed PD is the actual well location.

Proposed use is for washing trucks out that hauled brine contaminated soil, etc to facility for disposal in storage caverns. Applicant advised all wash wastewater will be collected and disposed of into waste storage caverns on site. Requested quantity of 5 AF appears to be reasonable

No Overlapping Place of Use when File No 47973 is dismissed. No Overlapping Point of Diversion

Surrounding Well Owner Notifications Sent

Well Owner Inquiries: 3 calls for info and one opposition letter

No additional Rate/Quantity Limitations

Application is in the Enhanced well Spacing Area, rate is less than 400 gpm. Meets "small use" safe yield exemption criteria.

Recommend approval, complies with K.A.R. 5-22-1 through 5-22-17 subject to dismissal of 47973.

RECEIVED
SCANNED
APR 14 2017

Equus Beds Groundwater Management District No. 2

SAFEYIELD EVALUATION No. 49545

LOCATION: NWSENE (3852'N & 1226'W) 14-24S-06W, Reno County

Prepared By: Stephen Flaherty Date: 3/22/2017

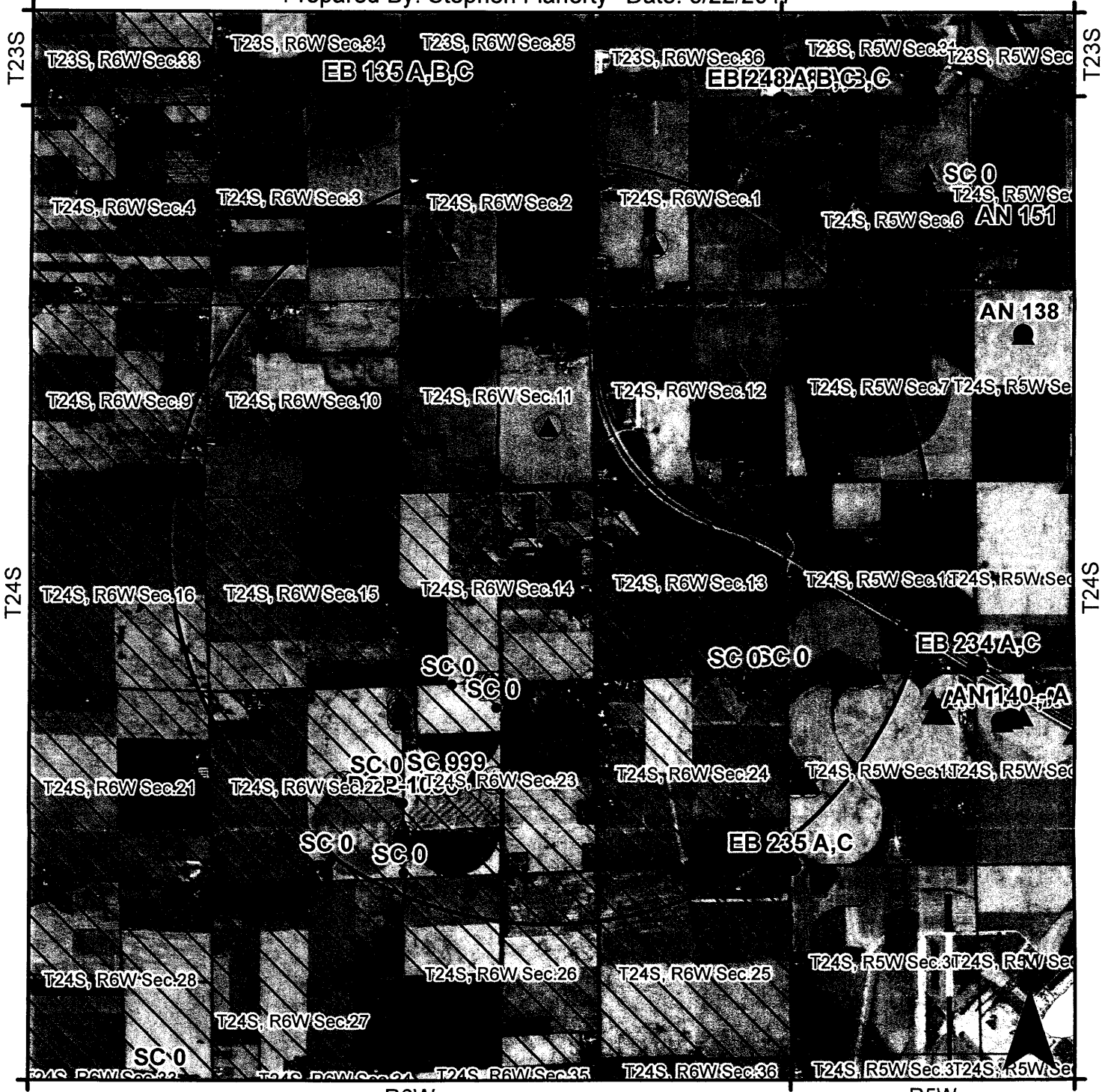

R6W

R5W

0 1,320, 640 5,280 Feet

Map Legend

| | | | | | |
|--|-------------------------|--|-----------------------------|--|---------------------|
| | Observation Well | | Proposed Point of Diversion | | Burrton IGUCA |
| | Bedrock | | Authorized Location | | Hollow Nickel SWQUA |
| | Authorized Place of Use | | Application Suspension Area | | McPherson IGUCA |
| | Proposed Place of Use | | Enhanced Well Spacing Area | | |

RECEIVED

APR 14 2017

Equus Beds Groundwater Management District No. 2
 313 Spruce Street, Halstead, KS 67056
 Staff Office 316-835-2224, equusbeds@gmd2.org
 Division of Water Resources

SCANNED

SAFEYIELD EVALUATION No. 49545
 LOCATION: NWSENE (3852'N & 1226'W) 14-245-06W, Reno County
 SPECIAL USE AREA: ENHANCED WELL SPACING AREA
 EVALUATION DATE: 3/22/2017

Total Areas: 3,967 acres; Area in 3 inch discharge zone: 0 acres; Area in 6 inch discharge zone: 3,967 acres

| FILE_ID | WELL_ID | TOWNSHIP | RANGE | SECTION | QUALIFIER | USE | AUTHQUANTITY |
|--------------------------------------|-----------------|----------|-------|---------|---------------------------------------|-----|-----------------|
| A01212700 | 68 | 245 | 05W | 18 | 45001400 | IRR | 117 |
| A02648800 | 1344 | 245 | 06W | 23 | 26253430 | IRR | 33 |
| A02648800 | 1345 | 245 | 06W | 23 | 26152885 | IRR | 21 |
| A02648800 | 1342 | 245 | 06W | 23 | 26254060 | IRR | 40 |
| A02648800 | 1343 | 245 | 06W | 23 | 26004560 | IRR | 44 |
| A02729900 | 1 | 245 | 05W | 18 | 25694397 | IRR | 0 |
| A02729900 | 2274 | 245 | 05W | 18 | 26644524 | IRR | 0 |
| A02729900 | 2275 | 245 | 05W | 18 | 26174461 | IRR | 111 |
| A02787500 | 1101 | 245 | 06W | 1 | 13913589 | IRR | 23 |
| A02997400 | 635 | 245 | 06W | 12 | 16851290 | IRR | 159 |
| A02997500 | 772 | 245 | 05W | 18 | 45001400 | IRR | 88 |
| A03016400 | 196 | 245 | 06W | 11 | 52613470 | MUN | 138 |
| A03016400 | 197 | 245 | 06W | 11 | 52504764 | MUN | 138 |
| A03016400 | 198 | 245 | 06W | 11 | 39795298 | MUN | 138 |
| A03216900 | 1893 | 245 | 06W | 12 | 31001310 | IRR | 153 |
| A03683800 | 815 | 245 | 06W | 11 | 17501305 | IRR | 215 |
| A03822100 | 955 | 245 | 05W | 7 | 17712670 | IRR | 152 |
| A03835700 | 1513 | 245 | 06W | 11 | 17501305 | IRR | 40 |
| A04053600 | 612 | 245 | 06W | 11 | 52153480 | MUN | 219.45 |
| A04053700 | 1008 | 245 | 06W | 11 | 39805215 | MUN | 219.45 |
| A04053800 | 321 | 245 | 06W | 11 | 52154780 | MUN | 219.45 |
| A04130800 | 2556 | 245 | 06W | 22 | 11340072 | IRR | 180 |
| A04130800 | 1351 | 245 | 06W | 22 | 8380072 | IRR | 0 |
| A04130800 | 1348 | 245 | 06W | 22 | 14350066 | IRR | 0 |
| A04130800 | 1349 | 245 | 06W | 22 | 10310078 | IRR | 0 |
| A04130800 | 1350 | 245 | 06W | 22 | 12310072 | IRR | 0 |
| A04151400 | 2123 | 245 | 06W | 14 | 9004970 | IRR | 8.6 |
| A04151900 | 2125 | 245 | 05W | 7 | 27614821 | IRR | 237 |
| A04152100 | 2127 | 245 | 06W | 11 | 40051368 | IRR | 95 |
| A04153500 | 2417 | 245 | 06W | 24 | 52360893 | IRR | 0 |
| A04153500 | 2418 | 245 | 06W | 24 | 52420559 | IRR | 0 |
| A04153500 | 2419 | 245 | 06W | 24 | 52400729 | IRR | 0 |
| A04153500 | 2420 | 245 | 06W | 24 | 48780902 | IRR | 0 |
| A04153500 | 2128 | 245 | 06W | 24 | 51490771 | IRR | 137 |
| A04165300 | 2276 | 245 | 05W | 18 | 26644524 | IRR | 0 |
| A04165300 | 2277 | 245 | 05W | 18 | 26174461 | IRR | 141 |
| A04165300 | 2130 | 245 | 05W | 18 | 25694397 | IRR | 0 |
| A04192900 | 2231 | 245 | 06W | 2 | 26692617 | IRR | 195 |
| A04260600 | 2422 | 245 | 06W | 2 | 13304020 | IRR | 210 |
| A04265200 | 2429 | 245 | 06W | 23 | 51953100 | IRR | 153 |
| A04265200 | 2430 | 245 | 06W | 23 | 52532693 | IRR | 0 |
| A04265200 | 2431 | 245 | 06W | 23 | 52532893 | IRR | 0 |
| A04265200 | 2432 | 245 | 06W | 23 | 52533093 | IRR | 0 |
| A04265200 | 2433 | 245 | 06W | 23 | 52533293 | IRR | 0 |
| A04270000 | 2448 | 245 | 05W | 19 | 52573143 | IRR | 170 |
| A04270000 | 2449 | 245 | 05W | 19 | 52783138 | IRR | 0 |
| A04270000 | 2450 | 245 | 05W | 19 | 52163437 | IRR | 0 |
| A04270000 | 4164 | 245 | 05W | 19 | 52782853 | IRR | 0 |
| A04305000 | 2508 | 245 | 05W | 18 | 26174461 | REC | 13.75 |
| A04305000 | 2509 | 245 | 05W | 18 | 25694397 | REC | 0 |
| A04305000 | 2510 | 245 | 05W | 18 | 26644524 | REC | 0 |
| A04371800 | 2678 | 245 | 06W | 10 | 20630966 | IRR | 222 |
| A04371800 | 2691 | 245 | 06W | 10 | 23071055 | IRR | 0 |
| A04371800 | 2690 | 245 | 06W | 10 | 18190877 | IRR | 0 |
| A04452500 | 3448 | 245 | 06W | 22 | 26431646 | IRR | 0 |
| A04452500 | 2850 | 245 | 06W | 22 | 26431635 | IRR | 108 |
| A04452500 | 2851 | 245 | 06W | 22 | 26401900 | IRR | 0 |
| A04452500 | 2852 | 245 | 06W | 22 | 26461361 | IRR | 0 |
| A04463400 | 2863 | 245 | 06W | 22 | 43270072 | IRR | 0 |
| A04463400 | 2864 | 245 | 06W | 22 | 47450063 | IRR | 0 |
| A04463400 | 2865 | 245 | 06W | 22 | 45590066 | IRR | 0 |
| A04463400 | 2866 | 245 | 06W | 22 | 43730063 | IRR | 0 |
| A04463400 | 2862 | 245 | 06W | 22 | 46510063 | IRR | 121 |
| A04647900 | 3363 | 245 | 05W | 18 | 13821716 | IRR | 131.6 |
| A04647900 | 3388 | 245 | 05W | 18 | 15461978 | IRR | 0 |
| A04655500 | 3420 | 245 | 06W | 24 | 14411542 | IRR | 0 |
| A04655500 | 3421 | 245 | 06W | 24 | 17141541 | IRR | 0 |
| A04655500 | 3422 | 245 | 06W | 24 | 17251267 | IRR | 0 |
| A04655500 | 3419 | 245 | 06W | 24 | 14151272 | IRR | 0 |
| A04655500 | 3391 | 245 | 06W | 24 | 15741406 | IRR | 182 |
| A04664600 | 3428 | 245 | 06W | 10 | 21363922 | IRR | 0 |
| A04664600 | 3425 | 245 | 06W | 10 | 23784082 | IRR | 170.8 |
| A04664600 | 3426 | 245 | 06W | 10 | 23784082 | IRR | 0 |
| A04664600 | 3427 | 245 | 06W | 10 | 26204242 | IRR | 0 |
| A04721700 | 3571 | 245 | 06W | 11 | 35023611 | IRR | 190.4 |
| A04752200 | 3661 | 245 | 05W | 19 | 24234910 | IRR | 182 |
| A04752200 | 3662 | 245 | 05W | 19 | 26235110 | IRR | 0 |
| A04752200 | 3663 | 245 | 05W | 19 | 26234710 | IRR | 0 |
| A04752200 | 3664 | 245 | 05W | 19 | 22235110 | IRR | 0 |
| A04752200 | 3665 | 245 | 05W | 19 | 22234710 | IRR | 0 |
| A04752400 | 3660 | 245 | 06W | 12 | 31001310 | IRR | 0 |
| A04767100 | 3734 | 245 | 06W | 2 | 7632100 | IRR | 182 |
| A04797300 | 3856 | 245 | 06W | 14 | 33001650 | IND | 5 |
| A04954500P | 4901 | 245 | 06W | 14 | 38521226 | IND | 5 |
| Allowable Appropriations | 2,662.67 | | | | Total Existing Appropriation | | 5,308.50 |
| Small User Quantity | 5 | | | | Non Consumptive Appropriations | | 0 |
| Remaining SUQ | 40 | | | | Consumptive Appropriations | | 5,308.50 |
| Note- Values are in acre-feet | | | | | Available Appropriations | | 0 |

RECEIVED

APR 14 2017

Equus Beds Groundwater Management District No. 2

Spacing Evaluation No. 49545

LOCATION: NWSENE (3852'N & 1226'W) 14-24S-06W, Reno County

Prepared By: Stephen Flaherty Date: 4/11/2017

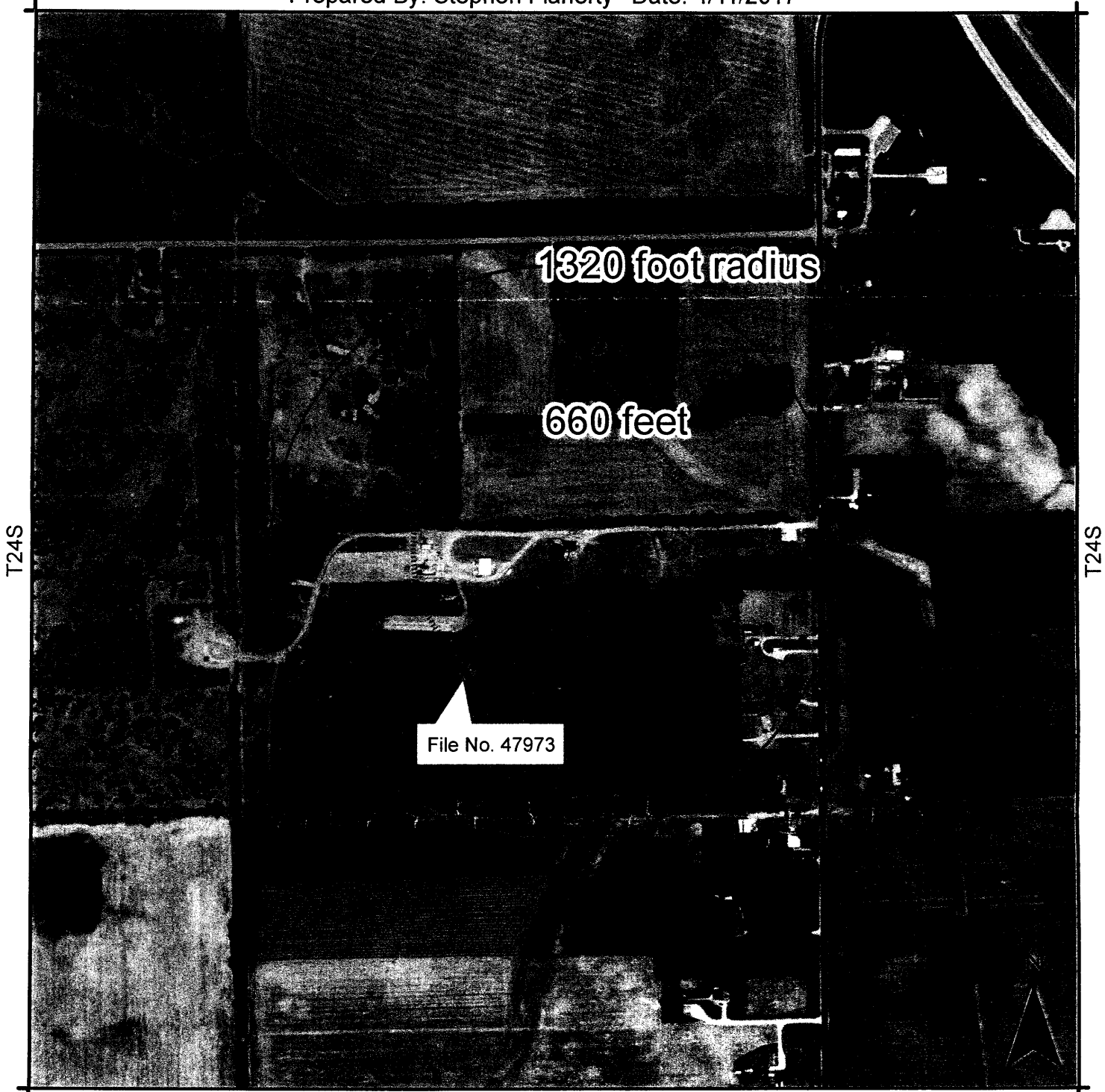

R6W

0 330 660 1,320 Feet

Map Legend

| | | | | | | |
|---|-------------------------|--|---|-----------------------------|-----------------------------|--|
| ● | Observation Well | RECEIVED | ● | Proposed Point of Diversion | Burrton IGUCA | |
| □ | Bedrock | APR 14 2017 | ● | Authorized Location | Hollow Nickel SWQUA | |
| | Authorized Place of Use | Equus Beds Groundwater Management District No. 2 | | | McPherson IGUCA | |
| | Proposed Place of Use | 313 Spruce Street, Halstead, KS 67056 | | | Enhanced Well Spacing Area | |
| | | Stafford Field Office | | | Application Suspension Area | |
| | | Division of Water Resources | | | | |

SCANNED

Kansas
Department of Agriculture
Division of Water Resources

Stafford Field Office
300 S. Main Street
Stafford, Kansas 67578-1521

Jackie McClaskey, Secretary
David W. Barfield, Chief Engineer
Jeff Lanterman, Water Commissioner

Phone: (620) 234-5311
Fax: (620) 234-6900
www.agriculture.ks.gov
Sam Brownback, Governor

March 2, 2017

GROUNDWATER MANAGEMENT DISTRICT NO 2
% TIM BOESE
313 SPRUCE ST
HALSTEAD KS 67056-1925

Re: Pending Application, File No. 49,545

Dear Mr. Boese:

We are enclosing a copy of the application referred to above which appears to be in proper form. Nearby well owner notification letters were sent out on February 8, 2017. Phone calls were received from well owners Janice Stuart, Charles Schmid, and Peggy from Cruppers Corner to obtain more information about the application but none objected to its approval. A letter was received from Danny & Linda Chambers stating their objection to the approval of the application.

We are delaying any further action for a period of **30 days** from the date of this letter to allow you time to submit your recommendations concerning this application. Please submit your recommendations within the allotted time, or any authorized extension of time thereof.

If you have any questions, please contact me at (620) 234-5311. If you wish to discuss a specific file, please have the file number ready so that I may help you more efficiently.

Sincerely,



Matt Meier
Environmental Scientist
Water Appropriation Program

Enclosure

pc:

Kansas

Department of Agriculture
Division of Water Resources

Stafford Field Office
300 S. Main Street
Stafford, Kansas 67578-1521

Jackie McClaskey, Secretary
David W. Barfield, Chief Engineer
Jeff Lanterman, Water Commissioner

Phone: (620) 234-5311
Fax: (620) 234-6900
www.agriculture.ks.gov
Sam Brownback, Governor

March 2, 2017

Danny & Linda Chambers
8105 S. K-14 Hwy
Hutchinson, KS 67501

Re: Pending Application, File No. 49,545

Dear Mr. & Mrs. Chambers:

This will acknowledge receipt of your letter, received in this office on February 24, 2017 in which you expressed concerns regarding the proposed appropriation of groundwater by the Underground Cavern Stabilization LLC under the above referenced application. In the letter you mentioned that you were concerned about the possible impact of the well on your well, other irrigation development in area effecting the water table, and that you were against the approval of the application. The application is proposing to appropriate groundwater for industrial use.

We are in the process of thoroughly reviewing this pending application to ensure that it complies with the Kansas Water Appropriation Act and applicable rules and regulations. The next step in processing will be to forward the application on to Equus Bends Groundwater Management District No. 2 for their review of the application.

The Chief Engineer is required to approve applications for water appropriation unless the proposed appropriation will impair existing water rights or prejudicially and unreasonably affect the public interest. Impairment is indicated if existing water rights will experience an unreasonable lowering of the static water level.

The applicable rules and regulations (K.A.R. 5-22-2) require that new non-domestic wells must meet specific spacing guidelines in order to minimize the potential that existing water wells of any kind would be impaired. The specific regulation in this case requires a minimum well spacing of 660 feet from any existing domestic well. Based on the location of your existing domestic well, it appears to be approximately 2,600 feet from the proposed well, and the application complies with minimum well spacing criterion.

Additionally, the rules and regulations (K.A.R. 5-4-1) require the Chief Engineer to investigate any complaint that a prior right to the use of water is being impaired. If such impairment is found, the Chief Engineer must secure water to satisfy prior water rights. Therefore, if this permit application is approved by the Chief Engineer and you believe the diversion of water is impairing your water right, you should notify Jeff Lanterman, Water Commissioner, Stafford Field Office, as follows, so that an investigation can be made.

Division of Water Resources
Stafford Field Office
300 S Main Street
Stafford, Kansas 67578-1342
Telephone: 620-234-5311

If an applicant without cause fails to comply with the provisions of the permit and its terms, conditions and limitations, it could result in the forfeiture of the priority date, revocation of the permit and dismissal of the application. If you have any further questions, please contact me at 620-234-5311. If you wish to discuss a specific file, please have the file number ready so that I may help you more efficiently.

Sincerely,

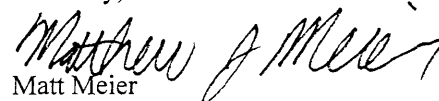

Matt Meier
New Application Unit
Water Appropriation Program

SCANNED

pc:

=

February 20, 2017

Danny and Linda Chambers Sr.

Property Owners

8105 S. K-14 Hwy. Hutchinson KS 67501

Phone: No. 620-899-3893

Dear Sir. I am writing this letter in regards to the Pending Application, File No. 49,545. As a property owner I've never been in favor of The Underground Cavern Stabilization LLC I do not trust this Company, they are so secretive about everything that goes on . A person who has always had permission to ride a trail that came close to the fence. Was told he could not ride his horse down their anymore. So I am against any well being drilled at the Underground Cavern Stabilization LLC. I've sent a letter in the past in regards to Application File No. 49,005 for an irrigation well being drilled east of my property. They are wanting to drill wells north and east of my property. I don't want to have too worry about my water table, and my property value if something would happen too my well.

So That's A Big No For Drilling From Use.

Sincerely,

Danny and Linda Chambers Sr.

RECEIVED
FEB 24 2017
Stafford Field Office
DIVISION OF WATER RESOURCES

Kansas

Department of Agriculture
Division of Water Resources

Stafford Field Office
300 S. Main Street
Stafford, Kansas 67578-1521

Jackie McClaskey, Secretary
David W. Barfield, Chief Engineer
Jeff Lanterman, Water Commissioner

Phone: (620) 234-5311
Fax: (620) 234-6900
www.agriculture.ks.gov
Sam Brownback, Governor

February 8, 2017

Cruppers Corner
7104 S K14 Hwy
Hutchinson, KS 67501

Re: Pending Application, File No. 49,545

Dear Sir:

This is to advise you that Underground Cavern Stabilization LLC has filed the application referred to above for a permit to appropriate 5 acre-feet of groundwater per calendar year for industrial use to be diverted at a maximum rate of 50 gallons per minute. The proposed point of diversion for 49,545 is one (1) well located as follows:

In the Northwest Quarter of the Southeast Quarter of the Northeast Quarter of Section 14, Township 24 South, Range 6 West, Reno County, Kansas.

A map is enclosed indicating the location of the proposed well. Records in this office indicate that you may have a well or wells in this vicinity and you are notified of receipt of this application in order that you may be fully informed of the proposed location of the applicant's point of diversion and proposed use of water. Consideration will be given to comments or other information which you desire to submit to this office **within 15 days** from the date of this letter.

If you have any questions or comments, you may also contact me at (620) 234-5311. If you call, please reference the file number so I can help you more efficiently. Mailed comments can be sent to the Stafford Field Office at 300 S. Main St. Stafford, KS 67578-1521.

Sincerely,



Matt Meier
Environmental Scientist
Water Appropriations Program

Enclosure

pc:

SCANNED

Kansas

Department of Agriculture
Division of Water Resources

Stafford Field Office
300 S. Main Street
Stafford, Kansas 67578-1521
Jackie McClaskey, Secretary
David W. Barfield, Chief Engineer
Jeff Lanterman, Water Commissioner

Phone: (620) 234-5311
Fax: (620) 234-6900
www.agriculture.ks.gov
Sam Brownback, Governor

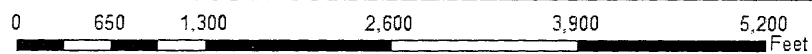

| Legend | |
|--------|-----------------|
| | Section Corners |
| | Section Lines |

MJM-DWR 2/8/17

Proposed Water Appropriation, File No. 49,545
14-24S-6W
Reno County



Kansas
Department of Agriculture
Division of Water Resources

Stafford Field Office
300 S. Main Street
Stafford, Kansas 67578-1521
Jackie McClaskey, Secretary
David W. Barfield, Chief Engineer
Jeff Lanterman, Water Commissioner

Phone: (620) 234-5311
Fax: (620) 234-6900
www.agriculture.ks.gov
Sam Brownback, Governor

February 8, 2017

Roger E Givens
121 E 16th Ave
Hutchinson, KS 67501

Re: Pending Application, File No. 49,545

Dear Sir:

This is to advise you that Underground Cavern Stabilization LLC has filed the application referred to above for a permit to appropriate 5 acre-feet of groundwater per calendar year for industrial use to be diverted at a maximum rate of 50 gallons per minute. The proposed point of diversion for 49,545 is one (1) well located as follows:

In the Northwest Quarter of the Southeast Quarter of the Northeast Quarter of Section 14, Township 24 South, Range 6 West, Reno County, Kansas.

A map is enclosed indicating the location of the proposed well. Records in this office indicate that you may have a well or wells in this vicinity and you are notified of receipt of this application in order that you may be fully informed of the proposed location of the applicant's point of diversion and proposed use of water. Consideration will be given to comments or other information which you desire to submit to this office **within 15 days** from the date of this letter.

If you have any questions or comments, you may also contact me at (620) 234-5311. If you call, please reference the file number so I can help you more efficiently. Mailed comments can be sent to the Stafford Field Office at 300 S. Main St. Stafford, KS 67578-1521.

Sincerely,



Matt Meier
Environmental Scientist
Water Appropriations Program

Enclosure

pc:

SCANNED

Kansas

Department of Agriculture
Division of Water Resources

Stafford Field Office
300 S. Main Street
Stafford, Kansas 67578-1521

Jackie McClaskey, Secretary
David W. Barfield, Chief Engineer
Jeff Lanterman, Water Commissioner

Phone: (620) 234-5311
Fax: (620) 234-6900
www.agriculture.ks.gov
Sam Brownback, Governor

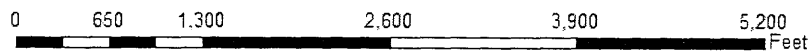

Legend

- + Section Corners
- ▭ Section Lines

MJM-DWR 2/8/17

Proposed Water Appropriation, File No. 49,545
14-24S-6W
Reno County



Kansas
Department of Agriculture
Division of Water Resources

Stafford Field Office
300 S. Main Street
Stafford, Kansas 67578-1521

Jackie McClaskey, Secretary
David W. Barfield, Chief Engineer
Jeff Lanterman, Water Commissioner

Phone: (620) 234-5311
Fax: (620) 234-6900
www.agriculture.ks.gov
Sam Brownback, Governor

February 8, 2017

Andes Rental Properties
7204 S K14 Hwy
Hutchinson, KS 67501

Re: Pending Application, File No. 49,545

Dear Sir:

This is to advise you that Underground Cavern Stabilization LLC has filed the application referred to above for a permit to appropriate 5 acre-feet of groundwater per calendar year for industrial use to be diverted at a maximum rate of 50 gallons per minute. The proposed point of diversion for 49,545 is one (1) well located as follows:

In the Northwest Quarter of the Southeast Quarter of the Northeast Quarter of Section 14, Township 24 South, Range 6 West, Reno County, Kansas.

A map is enclosed indicating the location of the proposed well. Records in this office indicate that you may have a well or wells in this vicinity and you are notified of receipt of this application in order that you may be fully informed of the proposed location of the applicant's point of diversion and proposed use of water. Consideration will be given to comments or other information which you desire to submit to this office **within 15 days** from the date of this letter.

If you have any questions or comments, you may also contact me at (620) 234-5311. If you call, please reference the file number so I can help you more efficiently. Mailed comments can be sent to the Stafford Field Office at 300 S. Main St. Stafford, KS 67578-1521.

Sincerely,



Matt Meier
Environmental Scientist
Water Appropriations Program

Enclosure

pc:

SCANNED

Kansas

Department of Agriculture
Division of Water Resources

Stafford Field Office
300 S. Main Street
Stafford, Kansas 67578-1521
Jackie McClaskey, Secretary
David W. Barfield, Chief Engineer
Jeff Lanterman, Water Commissioner

Phone: (620) 234-5311
Fax: (620) 234-6900
www.agriculture.ks.gov
Sam Brownback, Governor





1:12,000

2015 aerial

0 650 1,300 2,600 3,900 5,200 Feet

Legend

-  Section Corners
-  Section Lines

MJM-DWR 2/8/17

Proposed Water Appropriation, File No. 49,545
14-24S-6W
Reno County



Kansas
Department of Agriculture
Division of Water Resources

Stafford Field Office
300 S. Main Street
Stafford, Kansas 67578-1521
Jackie McClaskey, Secretary
David W. Barfield, Chief Engineer
Jeff Lanterman, Water Commissioner

Phone: (620) 234-5311
Fax: (620) 234-6900
www.agriculture.ks.gov
Sam Brownback, Governor

February 8, 2017

Daniel & Carolyn Borntrager
7314 S K14 Hwy
Hutchinson, KS 67501

Re: Pending Application, File No. 49,545

Dear Sir:

This is to advise you that Underground Cavern Stabilization LLC has filed the application referred to above for a permit to appropriate 5 acre-feet of groundwater per calendar year for industrial use to be diverted at a maximum rate of 50 gallons per minute. The proposed point of diversion for 49,545 is one (1) well located as follows:

In the Northwest Quarter of the Southeast Quarter of the Northeast Quarter of Section 14, Township 24 South, Range 6 West, Reno County, Kansas.

A map is enclosed indicating the location of the proposed well. Records in this office indicate that you may have a well or wells in this vicinity and you are notified of receipt of this application in order that you may be fully informed of the proposed location of the applicant's point of diversion and proposed use of water. Consideration will be given to comments or other information which you desire to submit to this office **within 15 days** from the date of this letter.

If you have any questions or comments, you may also contact me at (620) 234-5311. If you call, please reference the file number so I can help you more efficiently. Mailed comments can be sent to the Stafford Field Office at 300 S. Main St. Stafford, KS 67578-1521.

Sincerely,



Matt Meier
Environmental Scientist
Water Appropriations Program

Enclosure

pc:

SCANNED

Kansas

Department of Agriculture
Division of Water Resources

Stafford Field Office
300 S. Main Street
Stafford, Kansas 67578-1521
Jackie McClaskey, Secretary
David W. Barfield, Chief Engineer
Jeff Lanterman, Water Commissioner

Phone: (620) 234-5311
Fax: (620) 234-6900
www.agriculture.ks.gov
Sam Brownback, Governor

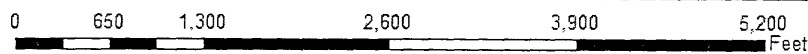

Legend

- Section Corners
- Section Lines

MJM-DWR 2/8/17

Proposed Water Appropriation, File No. 49,545
14-24S-6W
Reno County



Kansas
Department of Agriculture
Division of Water Resources

Stafford Field Office
300 S. Main Street
Stafford, Kansas 67578-1521
Jackie McClaskey, Secretary
David W. Barfield, Chief Engineer
Jeff Lanterman, Water Commissioner

Phone: (620) 234-5311
Fax: (620) 234-6900
www.agriculture.ks.gov
Sam Brownback, Governor

February 8, 2017

Charles S Schmid
7502 S K14 Hwy
Hutchinson, KS 67501

Re: Pending Application, File No. 49,545

Dear Sir:

This is to advise you that Underground Cavern Stabilization LLC has filed the application referred to above for a permit to appropriate 5 acre-feet of groundwater per calendar year for industrial use to be diverted at a maximum rate of 50 gallons per minute. The proposed point of diversion for 49,545 is one (1) well located as follows:

In the Northwest Quarter of the Southeast Quarter of the Northeast Quarter of Section 14, Township 24 South, Range 6 West, Reno County, Kansas.

A map is enclosed indicating the location of the proposed well. Records in this office indicate that you may have a well or wells in this vicinity and you are notified of receipt of this application in order that you may be fully informed of the proposed location of the applicant's point of diversion and proposed use of water. Consideration will be given to comments or other information which you desire to submit to this office **within 15 days** from the date of this letter.

If you have any questions or comments, you may also contact me at (620) 234-5311. If you call, please reference the file number so I can help you more efficiently. Mailed comments can be sent to the Stafford Field Office at 300 S. Main St. Stafford, KS 67578-1521.

Sincerely,



Matt Meier
Environmental Scientist
Water Appropriations Program

Enclosure

pc:

SCANNED

Kansas

Department of Agriculture
Division of Water Resources

Stafford Field Office
300 S. Main Street
Stafford, Kansas 67578-1521
Jackie McClaskey, Secretary
David W. Barfield, Chief Engineer
Jeff Lanterman, Water Commissioner

Phone: (620) 234-5311
Fax: (620) 234-6900
www.agriculture.ks.gov
Sam Brownback, Governor

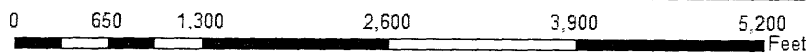

Legend

- Section Corners
- Section Lines

MJM-DWR 2/8/17

Proposed Water Appropriation, File No. 49,545
14-24S-6W
Reno County



Kansas

Department of Agriculture
Division of Water Resources

Stafford Field Office
300 S. Main Street
Stafford, Kansas 67578-1521

Jackie McClaskey, Secretary
David W. Barfield, Chief Engineer
Jeff Lanterman, Water Commissioner

Phone: (620) 234-5311
Fax: (620) 234-6900
www.agriculture.ks.gov
Sam Brownback, Governor

February 8, 2017

Robert A & Janice M Stewart
7703 S K14 Hwy
Hutchinson, KS 67501

Re: Pending Application, File No. 49,545

Dear Sir:

This is to advise you that Underground Cavern Stabilization LLC has filed the application referred to above for a permit to appropriate 5 acre-feet of groundwater per calendar year for industrial use to be diverted at a maximum rate of 50 gallons per minute. The proposed point of diversion for 49,545 is one (1) well located as follows:

In the Northwest Quarter of the Southeast Quarter of the Northeast Quarter of Section 14, Township 24 South, Range 6 West, Reno County, Kansas.

A map is enclosed indicating the location of the proposed well. Records in this office indicate that you may have a well or wells in this vicinity and you are notified of receipt of this application in order that you may be fully informed of the proposed location of the applicant's point of diversion and proposed use of water. Consideration will be given to comments or other information which you desire to submit to this office **within 15 days** from the date of this letter.

If you have any questions or comments, you may also contact me at (620) 234-5311. If you call, please reference the file number so I can help you more efficiently. Mailed comments can be sent to the Stafford Field Office at 300 S. Main St. Stafford, KS 67578-1521.

Sincerely,



Matt Meier
Environmental Scientist
Water Appropriations Program

Enclosure

pc:

SCANNED

Kansas

Department of Agriculture
Division of Water Resources

Stafford Field Office
300 S. Main Street
Stafford, Kansas 67578-1521

Jackie McClaskey, Secretary
David W. Barfield, Chief Engineer
Jeff Lanterman, Water Commissioner

Phone: (620) 234-5311
Fax: (620) 234-6900
www.agriculture.ks.gov
Sam Brownback, Governor

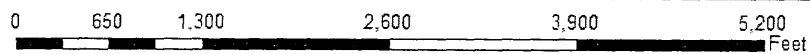

| Legend | |
|--------|-----------------|
| | Section Corners |
| | Section Lines |

M3M-DWR 2/8/17

Proposed Water Appropriation, File No. 49,545
14-24S-6W
Reno County



Kansas

Department of Agriculture
Division of Water Resources

Stafford Field Office
300 S. Main Street
Stafford, Kansas 67578-1521

Jackie McClaskey, Secretary
David W. Barfield, Chief Engineer
Jeff Lanterman, Water Commissioner

Phone: (620) 234-5311
Fax: (620) 234-6900
www.agriculture.ks.gov
Sam Brownback, Governor

February 8, 2017

Bradley A Harmony
7717 S K14 Hwy
Hutchinson, KS 67501

Re: Pending Application, File No. 49,545

Dear Sir:

This is to advise you that Underground Cavern Stabilization LLC has filed the application referred to above for a permit to appropriate 5 acre-feet of groundwater per calendar year for industrial use to be diverted at a maximum rate of 50 gallons per minute. The proposed point of diversion for 49,545 is one (1) well located as follows:

In the Northwest Quarter of the Southeast Quarter of the Northeast Quarter of Section 14, Township 24 South, Range 6 West, Reno County, Kansas.

A map is enclosed indicating the location of the proposed well. Records in this office indicate that you may have a well or wells in this vicinity and you are notified of receipt of this application in order that you may be fully informed of the proposed location of the applicant's point of diversion and proposed use of water. Consideration will be given to comments or other information which you desire to submit to this office **within 15 days** from the date of this letter.

If you have any questions or comments, you may also contact me at (620) 234-5311. If you call, please reference the file number so I can help you more efficiently. Mailed comments can be sent to the Stafford Field Office at 300 S. Main St. Stafford, KS 67578-1521.

Sincerely,



Matt Meier
Environmental Scientist
Water Appropriations Program

Enclosure

pc:

SCANNED

Kansas

Department of Agriculture
Division of Water Resources

Stafford Field Office
300 S. Main Street
Stafford, Kansas 67578-1521

Jackie McClaskey, Secretary
David W. Barfield, Chief Engineer
Jeff Lanterman, Water Commissioner

Phone: (620) 234-5311
Fax: (620) 234-6900
www.agriculture.ks.gov
Sam Brownback, Governor

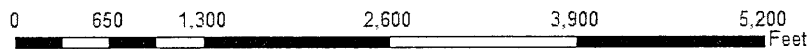

Legend

- + Section Corners
- ▭ Section Lines

MJM-DWR 2/8/17

Proposed Water Appropriation, File No. 49,545
14-24S-6W
Reno County



Kansas

Department of Agriculture
Division of Water Resources

Stafford Field Office
300 S. Main Street
Stafford, Kansas 67578-1521
Jackie McClaskey, Secretary
David W. Barfield, Chief Engineer
Jeff Lanterman, Water Commissioner

Phone: (620) 234-5311
Fax: (620) 234-6900
www.agriculture.ks.gov
Sam Brownback, Governor

February 8, 2017

Penny Keene & Terry Barker
7905 S K14 Hwy
Hutchinson, KS 67501

Re: Pending Application, File No. 49,545

Dear Sir:

This is to advise you that Underground Cavern Stabilization LLC has filed the application referred to above for a permit to appropriate 5 acre-feet of groundwater per calendar year for industrial use to be diverted at a maximum rate of 50 gallons per minute. The proposed point of diversion for 49,545 is one (1) well located as follows:

In the Northwest Quarter of the Southeast Quarter of the Northeast Quarter of Section 14, Township 24 South, Range 6 West, Reno County, Kansas.

A map is enclosed indicating the location of the proposed well. Records in this office indicate that you may have a well or wells in this vicinity and you are notified of receipt of this application in order that you may be fully informed of the proposed location of the applicant's point of diversion and proposed use of water. Consideration will be given to comments or other information which you desire to submit to this office **within 15 days** from the date of this letter.

If you have any questions or comments, you may also contact me at (620) 234-5311. If you call, please reference the file number so I can help you more efficiently. Mailed comments can be sent to the Stafford Field Office at 300 S. Main St. Stafford, KS 67578-1521.

Sincerely,

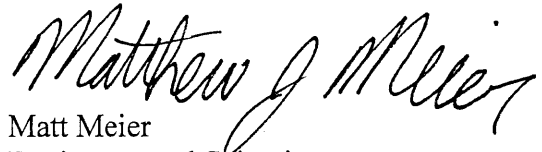

Matt Meier
Environmental Scientist
Water Appropriations Program

Enclosure

pc:

SCANNED

Kansas

Department of Agriculture
Division of Water Resources

Stafford Field Office
300 S. Main Street
Stafford, Kansas 67578-1521

Jackie McClaskey, Secretary
David W. Barfield, Chief Engineer
Jeff Lanterman, Water Commissioner

Phone: (620) 234-5311
Fax: (620) 234-6900
www.agriculture.ks.gov
Sam Brownback, Governor

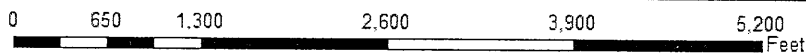

Legend

- + Section Corners
- Section Lines

MJM-DWR 2/8/17

Proposed Water Appropriation, File No. 49,545
14-24S-6W
Reno County



Kansas
Department of Agriculture
Division of Water Resources

Stafford Field Office
300 S. Main Street
Stafford, Kansas 67578-1521

Jackie McClaskey, Secretary
David W. Barfield, Chief Engineer
Jeff Lanterman, Water Commissioner

Phone: (620) 234-5311
Fax: (620) 234-6900
www.agriculture.ks.gov
Sam Brownback, Governor

February 8, 2017

Nathan Hostetler
7917 S K14 Hwy
Hutchinson, KS 67501

Re: Pending Application, File No. 49,545

Dear Sir:

This is to advise you that Underground Cavern Stabilization LLC has filed the application referred to above for a permit to appropriate 5 acre-feet of groundwater per calendar year for industrial use to be diverted at a maximum rate of 50 gallons per minute. The proposed point of diversion for 49,545 is one (1) well located as follows:

In the Northwest Quarter of the Southeast Quarter of the Northeast Quarter of Section 14, Township 24 South, Range 6 West, Reno County, Kansas.

A map is enclosed indicating the location of the proposed well. Records in this office indicate that you may have a well or wells in this vicinity and you are notified of receipt of this application in order that you may be fully informed of the proposed location of the applicant's point of diversion and proposed use of water. Consideration will be given to comments or other information which you desire to submit to this office **within 15 days** from the date of this letter.

If you have any questions or comments, you may also contact me at (620) 234-5311. If you call, please reference the file number so I can help you more efficiently. Mailed comments can be sent to the Stafford Field Office at 300 S. Main St. Stafford, KS 67578-1521.

Sincerely,

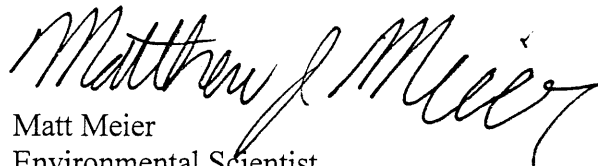

Matt Meier
Environmental Scientist
Water Appropriations Program

Enclosure

pc:

SCANNED

Kansas

Department of Agriculture
Division of Water Resources

Stafford Field Office
300 S. Main Street
Stafford, Kansas 67578-1521
Jackie McClaskey, Secretary
David W. Barfield, Chief Engineer
Jeff Lanterman, Water Commissioner

Phone: (620) 234-5311
Fax: (620) 234-6900
www.agriculture.ks.gov
Sam Brownback, Governor

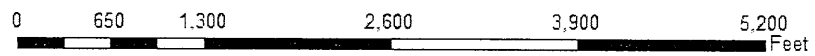

Legend

- + Section Corners
- Section Lines

MJM-DWR 2/8/17

Proposed Water Appropriation, File No. 49,545
14-24S-6W
Reno County



Kansas
Department of Agriculture
Division of Water Resources

Stafford Field Office
300 S. Main Street
Stafford, Kansas 67578-1521
Jackie McClaskey, Secretary
David W. Barfield, Chief Engineer
Jeff Lanterman, Water Commissioner

Phone: (620) 234-5311
Fax: (620) 234-6900
www.agriculture.ks.gov
Sam Brownback, Governor

February 8, 2017

Edwin W & Debra M Soper
8005 S K14 Hwy
Hutchinson, KS 67501

Re: Pending Application, File No. 49,545

Dear Sir:

This is to advise you that Underground Cavern Stabilization LLC has filed the application referred to above for a permit to appropriate 5 acre-feet of groundwater per calendar year for industrial use to be diverted at a maximum rate of 50 gallons per minute. The proposed point of diversion for 49,545 is one (1) well located as follows:

In the Northwest Quarter of the Southeast Quarter of the Northeast Quarter of Section 14, Township 24 South, Range 6 West, Reno County, Kansas.

A map is enclosed indicating the location of the proposed well. Records in this office indicate that you may have a well or wells in this vicinity and you are notified of receipt of this application in order that you may be fully informed of the proposed location of the applicant's point of diversion and proposed use of water. Consideration will be given to comments or other information which you desire to submit to this office **within 15 days** from the date of this letter.

If you have any questions or comments, you may also contact me at (620) 234-5311. If you call, please reference the file number so I can help you more efficiently. Mailed comments can be sent to the Stafford Field Office at 300 S. Main St. Stafford, KS 67578-1521.

Sincerely,



Matt Meier
Environmental Scientist
Water Appropriations Program

Enclosure

pc:

SCANNED

Kansas

Department of Agriculture
Division of Water Resources

Stafford Field Office
300 S. Main Street
Stafford, Kansas 67578-1521
Jackie McClaskey, Secretary
David W. Barfield, Chief Engineer
Jeff Lanterman, Water Commissioner

Phone: (620) 234-5311
Fax: (620) 234-6900
www.agriculture.ks.gov
Sam Brownback, Governor

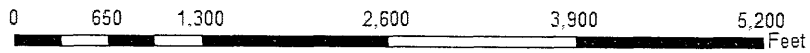

Legend

- + Section Corners
- ▭ Section Lines

MJM-DWR 2/8/17

Proposed Water Appropriation, File No. 49,545
14-24S-6W
Reno County



Kansas
Department of Agriculture
Division of Water Resources

Stafford Field Office
300 S. Main Street
Stafford, Kansas 67578-1521

Jackie McClaskey, Secretary
David W. Barfield, Chief Engineer
Jeff Lanterman, Water Commissioner

Phone: (620) 234-5311
Fax: (620) 234-6900
www.agriculture.ks.gov
Sam Brownback, Governor

February 8, 2017

Gary & K Bontrager Trusts
8101 S K14 Hwy
Hutchinson, KS 67501

Re: Pending Application, File No. 49,545

Dear Sir:

This is to advise you that Underground Cavern Stabilization LLC has filed the application referred to above for a permit to appropriate 5 acre-feet of groundwater per calendar year for industrial use to be diverted at a maximum rate of 50 gallons per minute. The proposed point of diversion for 49,545 is one (1) well located as follows:

In the Northwest Quarter of the Southeast Quarter of the Northeast Quarter of Section 14, Township 24 South, Range 6 West, Reno County, Kansas.

A map is enclosed indicating the location of the proposed well. Records in this office indicate that you may have a well or wells in this vicinity and you are notified of receipt of this application in order that you may be fully informed of the proposed location of the applicant's point of diversion and proposed use of water. Consideration will be given to comments or other information which you desire to submit to this office **within 15 days** from the date of this letter.

If you have any questions or comments, you may also contact me at (620) 234-5311. If you call, please reference the file number so I can help you more efficiently. Mailed comments can be sent to the Stafford Field Office at 300 S. Main St. Stafford, KS 67578-1521.

Sincerely,



Matt Meier
Environmental Scientist
Water Appropriations Program

Enclosure

pc:

SCANNED

Kansas



Department of Agriculture
Division of Water Resources

Stafford Field Office
300 S. Main Street
Stafford, Kansas 67578-1521
Jackie McClaskey, Secretary
David W. Barfield, Chief Engineer
Jeff Lanterman, Water Commissioner

Phone: (620) 234-5311
Fax: (620) 234-6900
www.agriculture.ks.gov
Sam Brownback, Governor



Legend

-  Section Corners
-  Section Lines

MJM-DWR 2/8/17

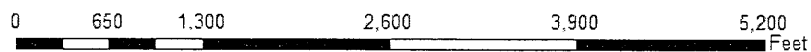

Proposed Water Appropriation, File No. 49,545
14-24S-6W
Reno County



Kansas
Department of Agriculture
Division of Water Resources

Stafford Field Office
300 S. Main Street
Stafford, Kansas 67578-1521
Jackie McClaskey, Secretary
David W. Barfield, Chief Engineer
Jeff Lanterman, Water Commissioner

Phone: (620) 234-5311
Fax: (620) 234-6900
www.agriculture.ks.gov
Sam Brownback, Governor

February 8, 2017

Danny R Sr & Linda J Chambers
8105 S K14 Hwy
Hutchinson, KS 67501

Re: Pending Application, File No. 49,545

Dear Sir:

This is to advise you that Underground Cavern Stabilization LLC has filed the application referred to above for a permit to appropriate 5 acre-feet of groundwater per calendar year for industrial use to be diverted at a maximum rate of 50 gallons per minute. The proposed point of diversion for 49,545 is one (1) well located as follows:

In the Northwest Quarter of the Southeast Quarter of the Northeast Quarter of Section 14, Township 24 South, Range 6 West, Reno County, Kansas.

A map is enclosed indicating the location of the proposed well. Records in this office indicate that you may have a well or wells in this vicinity and you are notified of receipt of this application in order that you may be fully informed of the proposed location of the applicant's point of diversion and proposed use of water. Consideration will be given to comments or other information which you desire to submit to this office **within 15 days** from the date of this letter.

If you have any questions or comments, you may also contact me at (620) 234-5311. If you call, please reference the file number so I can help you more efficiently. Mailed comments can be sent to the Stafford Field Office at 300 S. Main St. Stafford, KS 67578-1521.

Sincerely,



Matt Meier
Environmental Scientist
Water Appropriations Program

Enclosure

pc:

SCANNED

Kansas

Department of Agriculture
Division of Water Resources

Stafford Field Office
300 S. Main Street
Stafford, Kansas 67578-1521

Jackie McClaskey, Secretary
David W. Barfield, Chief Engineer
Jeff Lanterman, Water Commissioner

Phone: (620) 234-5311

Fax: (620) 234-6900

www.agriculture.ks.gov

Sam Brownback, Governor

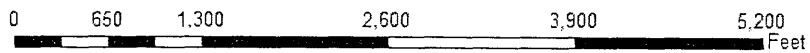

Legend

- Section Corners
- Section Lines

MJM-DWR 2/8/17

Proposed Water Appropriation, File No. 49,545
14-24S-6W
Reno County



Kansas

Department of Agriculture
Division of Water Resources

Stafford Field Office
300 S. Main Street
Stafford, Kansas 67578-1521

Jackie McClaskey, Secretary
David W. Barfield, Chief Engineer
Jeff Lanterman, Water Commissioner

Phone: (620) 234-5311
Fax: (620) 234-6900
www.agriculture.ks.gov
Sam Brownback, Governor

February 8, 2017

Bobb G & Mary Jo Perser Rev Trusts
7816 S K14 Hwy
Hutchinson, KS 67501

Re: Pending Application, File No. 49,545

Dear Sir:

This is to advise you that Underground Cavern Stabilization LLC has filed the application referred to above for a permit to appropriate 5 acre-feet of groundwater per calendar year for industrial use to be diverted at a maximum rate of 50 gallons per minute. The proposed point of diversion for 49,545 is one (1) well located as follows:

In the Northwest Quarter of the Southeast Quarter of the Northeast Quarter of Section 14, Township 24 South, Range 6 West, Reno County, Kansas.

A map is enclosed indicating the location of the proposed well. Records in this office indicate that you may have a well or wells in this vicinity and you are notified of receipt of this application in order that you may be fully informed of the proposed location of the applicant's point of diversion and proposed use of water. Consideration will be given to comments or other information which you desire to submit to this office **within 15 days** from the date of this letter.

If you have any questions or comments, you may also contact me at (620) 234-5311. If you call, please reference the file number so I can help you more efficiently. Mailed comments can be sent to the Stafford Field Office at 300 S. Main St. Stafford, KS 67578-1521.

Sincerely,



Matt Meier
Environmental Scientist
Water Appropriations Program

Enclosure

pc:

SCANNED

Kansas

Department of Agriculture
Division of Water Resources

Stafford Field Office
300 S. Main Street
Stafford, Kansas 67578-1521

Jackie McClaskey, Secretary
David W. Barfield, Chief Engineer
Jeff Lanterman, Water Commissioner

Phone: (620) 234-5311
Fax: (620) 234-6900
www.agriculture.ks.gov
Sam Brownback, Governor



Legend

- + Section Corners
- Section Lines

MJM-DWR 2/8/17

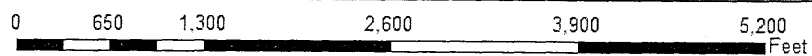

Proposed Water Appropriation, File No. 49,545
14-24S-6W
Reno County



Water Rights and Points of Diversion Within 2.00 miles of point defined as:

3852 ft N and 1226 ft W of the SE Corner of Section 14, T 24S, R 6W

Located at: 97.944300 West Longitude and 37.965931 North Latitude

GROUNDWATER ONLY

#49545

| File Number | Use | ST | SR | Dist (ft) | Q4 | Q3 | Q2 | Q1 | FeetN | FeetW | Sec | Twp | Rng | ID | Batt | Auth_Quan | Add_Quan | Unit |
|-------------|-----|-----|----|-----------|-------|----|----|----|-------|-------|------|-----|-----|----|--------|-----------|----------|------|
| A__ 12127 | 00 | IRR | NK | G | 10462 | -- | SE | NW | NE | 4500 | 1400 | 18 | 24 | 5W | 1 | 117.00 | 117.00 | AF |
| A__ 26488 | 00 | IRR | NK | G | 6837 | -- | CN | NE | SW | 2625 | 3430 | 23 | 24 | 6W | 3 | 33.00 | 33.00 | AF |
| Same | | | | | 7088 | -- | -- | CN | SW | 2610 | 4075 | 23 | 24 | 6W | 10 | 40.00 | 40.00 | AF |
| Same | | | | | 7304 | -- | CN | NW | SW | 2600 | 4560 | 23 | 24 | 6W | 11 | 44.00 | 44.00 | AF |
| Same | | | | | 6698 | -- | NE | NE | SW | 2615 | 2885 | 23 | 24 | 6W | 12 | 21.00 | 21.00 | AF |
| A__ 27299 | 00 | IRR | NK | G | 7476 | -- | -- | -- | -- | 2617 | 4461 | 18 | 24 | 5W | 5 G 2 | 111.00 | 111.00 | AF |
| Same | | | | | 7547 | -- | -- | -- | -- | 2569 | 4397 | 18 | 24 | 5W | 4 B 2 | | | |
| Same | | | | | 7406 | -- | -- | -- | -- | 2664 | 4524 | 18 | 24 | 5W | 6 B 2 | | | |
| A__ 27875 | 00 | IRR | NK | G | 8739 | -- | SW | NE | SW | 1391 | 3589 | 1 | 24 | 6W | 1 | 23.00 | 23.00 | AF |
| A__ 29974 | 00 | IRR | NK | G | 6149 | NC | S2 | N2 | SE | 1685 | 1290 | 12 | 24 | 6W | 1 | 159.00 | 159.00 | AF |
| A__ 29975 | 00 | IRR | NK | G | 10462 | -- | SE | NW | NE | 4500 | 1400 | 18 | 24 | 5W | 1 | 88.00 | 88.00 | AF |
| A__ 30164 | 00 | MUN | NK | G | 7042 | -- | NW | NE | NW | 5261 | 3470 | 11 | 24 | 6W | 2 | 208.99 | 129.58 | AF |
| Same | | | | | 6750 | -- | SW | NW | NW | 3979 | 5298 | 11 | 24 | 6W | 3 | 235.08 | 145.73 | AF |
| Same | | | | | 7541 | -- | NW | NW | NW | 5250 | 4764 | 11 | 24 | 6W | 4 | 223.42 | 138.69 | AF |
| A__ 32169 | 00 | IRR | NK | G | 6984 | -- | SW | SE | NE | 3100 | 1310 | 12 | 24 | 6W | 2 | 153.00 | 153.00 | AF |
| A__ 36838 | 00 | IRR | NK | G | 3172 | -- | SW | NE | SE | 1750 | 1335 | 11 | 24 | 6W | 9 | 215.00 | 215.00 | AF |
| A__ 38221 | 00 | IRR | NK | G | 9764 | -- | SE | NE | SW | 1771 | 2670 | 7 | 24 | 5W | 2 | 152.00 | 152.00 | AF |
| A__ 38357 | 00 | IRR | NK | G | 3172 | -- | SW | NE | SE | 1750 | 1335 | 11 | 24 | 6W | 9 | 40.00 | 40.00 | AF |
| A__ 40536 | 00 | MUN | LR | G | 7042 | -- | NW | NE | NW | 5261 | 3470 | 11 | 24 | 6W | 2 | 219.46 | 219.46 | AF |
| A__ 40537 | 00 | MUN | LR | G | 6750 | -- | SW | NW | NW | 3979 | 5298 | 11 | 24 | 6W | 3 | 219.46 | 219.46 | AF |
| A__ 40538 | 00 | MUN | LR | G | 7541 | -- | NW | NW | NW | 5250 | 4764 | 11 | 24 | 6W | 4 | 219.46 | 219.46 | AF |
| A__ 41308 | 00 | IRR | NK | G | 9147 | -- | NE | SE | SE | 1134 | 72 | 22 | 24 | 6W | 1 G 4 | 180.00 | 180.00 | AF |
| Same | | | | | 9061 | -- | NE | SE | SE | 1231 | 72 | 22 | 24 | 6W | 2 B 4 | | | |
| Same | | | | | 9241 | -- | NE | SE | SE | 1031 | 78 | 22 | 24 | 6W | 3 B 4 | | | |
| Same | | | | | 9411 | -- | NE | SE | SE | 838 | 72 | 22 | 24 | 6W | 4 B 4 | | | |
| Same | | | | | 8877 | -- | SE | NE | SE | 1435 | 66 | 22 | 24 | 6W | 6 B 4 | | | |
| A__ 41514 | 00 | IRR | NK | G | 4768 | -- | NW | SW | SW | 900 | 4970 | 14 | 24 | 6W | 7 | 8.60 | 8.60 | AF |
| A__ 41519 | 00 | IRR | NK | G | 8239 | -- | -- | -- | -- | 2761 | 4821 | 7 | 24 | 5W | 3 | 237.00 | 237.00 | AF |
| A__ 41521 | 00 | IRR | NK | G | 5427 | -- | SE | NW | NE | 4005 | 1368 | 11 | 24 | 6W | 8 | 95.00 | 95.00 | AF |
| A__ 41535 | 00 | IRR | NK | G | 6948 | -- | NW | NE | NE | 5149 | 771 | 24 | 24 | 6W | 4 G 4 | 137.00 | 137.00 | AF |
| Same | | | | | 7075 | -- | NE | NE | NE | 5242 | 559 | 24 | 24 | 6W | 1 B 4 | | | |
| Same | | | | | 6933 | -- | NW | NE | NE | 5240 | 729 | 24 | 24 | 6W | 2 B 4 | | | |
| Same | | | | | 6798 | -- | NW | NE | NE | 5236 | 893 | 24 | 24 | 6W | 3 B 4 | | | |
| Same | | | | | 6996 | -- | NW | NE | NE | 4878 | 902 | 24 | 24 | 6W | 5 B 4 | | | |
| A__ 41653 | 00 | IRR | NK | G | 7476 | -- | -- | -- | -- | 2617 | 4461 | 18 | 24 | 5W | 5 G 2 | 159.00 | 141.00 | AF |
| Same | | | | | 7547 | -- | -- | -- | -- | 2569 | 4397 | 18 | 24 | 5W | 4 B 2 | | | |
| Same | | | | | 7406 | -- | -- | -- | -- | 2664 | 4524 | 18 | 24 | 5W | 6 B 2 | | | |
| A__ 41929 | 00 | IRR | NK | G | 9514 | -- | SW | SW | NE | 2669 | 2617 | 2 | 24 | 6W | 1 | 195.00 | 195.00 | AF |
| A__ 42606 | 00 | IRR | NK | G | 8534 | -- | -- | NC | SW | 1330 | 4020 | 2 | 24 | 6W | 2 | 210.00 | 210.00 | AF |
| A__ 42652 | 00 | IRR | NK | G | 4331 | -- | NE | NE | NW | 5195 | 3100 | 23 | 24 | 6W | 5 G 4 | 153.00 | 153.00 | AF |
| Same | | | | | 4210 | -- | NE | NE | NW | 5201 | 2810 | 23 | 24 | 6W | 6 B 4 | | | |
| Same | | | | | 4288 | -- | NE | NE | NW | 5197 | 3000 | 23 | 24 | 6W | 7 B 4 | | | |
| Same | | | | | 4375 | -- | NE | NE | NW | 5194 | 3199 | 23 | 24 | 6W | 8 B 4 | | | |
| Same | | | | | 4471 | -- | NW | NE | NW | 5186 | 3389 | 23 | 24 | 6W | 9 B 4 | | | |
| A__ 42700 | 00 | IRR | NK | G | 9474 | -- | NE | NE | NW | 5257 | 3143 | 19 | 24 | 5W | 19 G 3 | 170.00 | 170.00 | AF |
| Same | | | | | 9223 | -- | NE | NE | NW | 5216 | 3437 | 19 | 24 | 5W | 2 B 3 | | | |

| | | | | | | | | | | | | | |
|-------------------------|-------|-------------|------|------|----|----|----|----|---|---|--------|--------|----|
| Same | 9470 | -- NE NE NW | 5278 | 3138 | 19 | 24 | 5W | 3 | B | 3 | | | |
| Same | 9732 | -- NE NE NW | 5278 | 2853 | 19 | 24 | 5W | 20 | B | 3 | | | |
| A__ 43050 00 REC NK G | 7476 | -- -- -- | 2617 | 4461 | 18 | 24 | 5W | 5 | G | 2 | 13.75 | 13.75 | AF |
| Same | 7547 | -- -- -- | 2569 | 4397 | 18 | 24 | 5W | 4 | B | 2 | | | |
| Same | 7406 | -- -- -- | 2664 | 4524 | 18 | 24 | 5W | 6 | B | 2 | | | |
| A__ 43718 00 IRR NK G | 6180 | -- NW NE SE | 2063 | 966 | 10 | 24 | 6W | 3 | G | 2 | 222.00 | 222.00 | AF |
| Same | 5972 | -- SW NE SE | 1819 | 877 | 10 | 24 | 6W | 1 | B | 2 | | | |
| Same | 6391 | -- NW NE SE | 2307 | 1055 | 10 | 24 | 6W | 2 | B | 2 | | | |
| A__ 44525 00 IRR NK G | 8766 | -- SE SW NE | 2643 | 1635 | 22 | 24 | 6W | 7 | G | 3 | 108.00 | 108.00 | AF |
| Same | 8944 | -- NC W2 E2 | 2640 | 1900 | 22 | 24 | 6W | 8 | B | 3 | | | |
| Same | 8587 | -- SE SW NE | 2646 | 1361 | 22 | 24 | 6W | 9 | B | 3 | | | |
| Same | 8773 | -- SE SW NE | 2643 | 1646 | 22 | 24 | 6W | 15 | B | 3 | | | |
| A__ 44634 00 IRR NK G | 6220 | -- NE NE NE | 4651 | 63 | 22 | 24 | 6W | 10 | G | 4 | 121.00 | 121.00 | AF |
| Same | 6024 | -- NE NE NE | 4927 | 72 | 22 | 24 | 6W | 11 | B | 4 | | | |
| Same | 6151 | -- NE NE NE | 4745 | 63 | 22 | 24 | 6W | 12 | B | 4 | | | |
| Same | 6291 | -- SE NE NE | 4559 | 66 | 22 | 24 | 6W | 13 | B | 4 | | | |
| Same | 6430 | -- SE NE NE | 4373 | 63 | 22 | 24 | 6W | 14 | B | 4 | | | |
| A__ 46479 00 IRR LR G | 10410 | -- SE NW SE | 1382 | 1718 | 18 | 24 | 5W | 10 | G | 3 | 131.60 | 131.60 | AF |
| Same | 10139 | -- S2 NW SE | 1450 | 1980 | 18 | 24 | 5W | 8 | B | 3 | | | |
| Same | 10544 | -- NE SW SE | 1300 | 1600 | 18 | 24 | 5W | 9 | B | 3 | | | |
| Same | 10412 | -- SE NW SE | 1382 | 1716 | 18 | 24 | 5W | 11 | B | 3 | | | |
| A__ 46555 00 IRR LR G | 9045 | -- SW NE SE | 1574 | 1406 | 24 | 24 | 6W | 13 | G | 4 | 182.00 | 182.00 | AF |
| Same | 9100 | -- SW NE SE | 1620 | 1245 | 24 | 24 | 6W | 10 | B | 4 | | | |
| Same | 8853 | -- SE NW SE | 1714 | 1541 | 24 | 24 | 6W | 12 | B | 4 | | | |
| Same | 9079 | -- SW NE SE | 1441 | 1542 | 24 | 24 | 6W | 14 | B | 4 | | | |
| Same | 9252 | -- SW NE SE | 1415 | 1272 | 24 | 24 | 6W | 15 | B | 4 | | | |
| A__ 46646 00 IRR LR G | 9066 | -- NE NW SW | 2378 | 4082 | 10 | 24 | 6W | 4 | G | 3 | 170.80 | 170.80 | AF |
| Same | 9313 | -- NE NW SW | 2620 | 4242 | 10 | 24 | 6W | 5 | B | 3 | | | |
| Same | 8821 | -- NW NE SW | 2136 | 3922 | 10 | 24 | 6W | 6 | B | 3 | | | |
| Same | 9066 | -- NE NW SW | 2378 | 4082 | 10 | 24 | 6W | 7 | B | 3 | | | |
| A__ 47217 00 IRR LO G | 5461 | -- NW SE NW | 3502 | 3611 | 11 | 24 | 6W | 11 | | | 190.40 | 190.40 | AF |
| A__ 47522 00 IRR LO G | 9585 | -- NW NW SW | 2423 | 4910 | 19 | 24 | 5W | 14 | G | 4 | 182.00 | 182.00 | AF |
| Same | 9303 | -- NW NW SW | 2623 | 5110 | 19 | 24 | 5W | 15 | B | 4 | | | |
| Same | 9595 | -- NW NW SW | 2623 | 4710 | 19 | 24 | 5W | 16 | B | 4 | | | |
| Same | 9584 | -- NW NW SW | 2223 | 5110 | 19 | 24 | 5W | 17 | B | 4 | | | |
| Same | 9868 | -- NW NW SW | 2223 | 4710 | 19 | 24 | 5W | 18 | B | 4 | | | |
| A__ 47524 00 IRR LO G | 6984 | -- SW SE NE | 3100 | 1310 | 12 | 24 | 6W | 2 | | | 153.00 | .00 | AF |
| A__ 47671 00 IRR LR G | 7558 | -- NW SW SE | 763 | 2100 | 2 | 24 | 6W | 7 | | | 182.00 | 182.00 | AF |
| A__ 47973 00 IND LO G | 696 | NC E2 SW NE | 3300 | 1650 | 14 | 24 | 6W | 8 | | | 5.00 | 5.00 | AF |
| A__ 49545 00 IND AY G | 0 | -- NW SE NE | 3852 | 1226 | 14 | 24 | 6W | 11 | | | 5.00 | 5.00 | AF |
| T__20127585 MF IRR GY G | 9147 | -- NE SE SE | 1134 | 72 | 22 | 24 | 6W | 1 | G | 4 | 747.00 | .00 | AF |
| Same | 9061 | -- NE SE SE | 1231 | 72 | 22 | 24 | 6W | 2 | B | 4 | | | |
| Same | 9241 | -- NE SE SE | 1031 | 78 | 22 | 24 | 6W | 3 | B | 4 | | | |
| Same | 9411 | -- NE SE SE | 838 | 72 | 22 | 24 | 6W | 4 | B | 4 | | | |
| Same | 8877 | -- SE NE SE | 1435 | 66 | 22 | 24 | 6W | 6 | B | 4 | | | |
| T__20127586 MF IRR GY G | 5427 | -- SE NW NE | 4005 | 1368 | 11 | 24 | 6W | 8 | | | 382.06 | .00 | AF |
| T__20129421 00 IND GY G | 928 | -- NE SE NE | 3785 | 300 | 14 | 24 | 6W | 9 | | | 16.00 | 16.00 | AF |

=====
 Total Net Quantities Authorized: Direct Storage
 Total Requested Amount (AF) = 5.00 .00
 Total Permitted Amount (AF) = 16.00 .00
 Total Inspected Amount (AF) = 1702.17 .00

| | | | |
|-----------------|---------------|---------|-----|
| Total Pro_Cert | Amount (AF) = | .00 | .00 |
| Total Certified | Amount (AF) = | 3601.35 | .00 |
| Total Vested | Amount (AF) = | .00 | .00 |
| TOTAL AMOUNT | (AF) = | 5324.52 | .00 |

#49,545

An * after the source of supply indicates a pending application for change for the file number.
 An * after the ID indicates a 15 AF exemption was granted for the file number.
 A "G" in the Batt column indicates the GEO CTR of a battery. A "B" indicates a well in the battery.
 The number in the Batt column is the number of wells in the battery.

Water Rights and Points of Diversion Within 2.00 miles of point defined as:

97.944300 West Longitude and 37.965931 North Latitude

GROUNDWATER ONLY

WATER USE CORRESPONDENTS:

=====

File Number Use ST SR

A__ 12127 00 IRR NK G
 > LEONARD R & MARILYN K YODER TRUST
 >
 > PO BOX 48
 > YODER KS 67585
 >-----

A__ 26488 00 IRR NK G
 > C B & JOAN K SHOWALTER
 >
 > 8803 E ARLINGTON RD
 > HAVEN KS 67543
 >-----

A__ 27299 00 IRR NK G
 > JARED C & YOLANDA M OATNEY
 >
 > 11215 W LONGVIEW RD
 > PARTRIDGE KS 67566
 >-----

A__ 27875 00 IRR NK G
 > KEITH & JANET GOERTZEN
 >
 > 110 E MILLS AVE
 > HUTCHINSON KS 67505
 >-----

A__ 29974 00 IRR NK G
 > LEONARD R & MARILYN K YODER TRUST
 >
 > PO BOX 48
 > YODER KS 67585
 >-----

A__ 29975 00 IRR NK G
 > LEONARD R & MARILYN K YODER TRUST
 >
 > PO BOX 48
 > YODER KS 67585
 >-----

A__ 30164 00 MUN NK G

> CITY OF SOUTH HUTCHINSON
> DIRECTOR OF PUBLIC WORKS
> 2 S MAIN ST
> SOUTH HUTCHINSON KS 67505

>-----

A__ 32169 00 IRR NK G

> WAYNE E YODER

>

> 7912 S MCNEW RD

> HUTCHINSON KS 67501

>-----

A__ 36838 00 IRR NK G

> C B & JOAN K SHOWALTER

>

> 8803 E ARLINGTON RD

> HAVEN KS 67543

>-----

A__ 38221 00 IRR NK G

> LEONARD R & MARILYN K YODER TRUST

>

> PO BOX 48

> YODER KS 67585

>-----

A__ 38357 00 IRR NK G

> C B & JOAN K SHOWALTER

>

> 8803 E ARLINGTON RD

> HAVEN KS 67543

>-----

A__ 40536 00 MUN LR G

> CITY OF SOUTH HUTCHINSON

> DIRECTOR OF PUBLIC WORKS

> 2 S MAIN ST

> SOUTH HUTCHINSON KS 67505

>-----

A__ 40537 00 MUN LR G

> CITY OF SOUTH HUTCHINSON

> DIRECTOR OF PUBLIC WORKS

> 2 S MAIN ST

> SOUTH HUTCHINSON KS 67505

>-----

A__ 40538 00 MUN LR G

> CITY OF SOUTH HUTCHINSON

> DIRECTOR OF PUBLIC WORKS

> 2 S MAIN ST

> SOUTH HUTCHINSON KS 67505

>-----

A__ 41308 00 IRR NK G

> C B & JOAN K SHOWALTER

>

> 8803 E ARLINGTON RD

> HAVEN KS 67543

#49545

A__ 41514 00 IRR NK G

> JASON YODER

> 8216 S VALLEY PRIDE RD

> HUTCHINSON KS 67501

A__ 41519 00 IRR NK G

> C B & JOAN K SHOWALTER

> 8803 E ARLINGTON RD

> HAVEN KS 67543

A__ 41521 00 IRR NK G

> C B & JOAN K SHOWALTER

> 8803 E ARLINGTON RD

> HAVEN KS 67543

A__ 41535 00 IRR NK G

> LINWOOD L & MARIE A STEVENS

> 401 E LONGVIEW RD

> HUTCHINSON KS 67501

A__ 41653 00 IRR NK G

> JARED C & YOLANDA M OATNEY

> 11215 W LONGVIEW RD

> PARTRIDGE KS 67566

A__ 41929 00 IRR NK G

> MARCELINE WEEKS TRUST

> FNB FARM MGMT DEPT

> PO BOX 913

> HUTCHINSON KS 67504

A__ 42606 00 IRR NK G

> C B & JOAN K SHOWALTER

> 8803 E ARLINGTON RD

> HAVEN KS 67543

A__ 42652 00 IRR NK G

> C B & JOAN K SHOWALTER

> 8803 E ARLINGTON RD

> HAVEN KS 67543

A__ 42700 00 IRR NK G

> VERNON H & ARLENE K BONTRAGER TRUSTS

> VERNON & ARLENE BONTRAGER

> 8705 S SANDCREEK RD
> HUTCHINSON KS 67501

>-----

A__ 43050 00 REC NK G
> JARED C & YOLANDA M OATNEY

>
> 11215 W LONGVIEW RD
> PARTRIDGE KS 67566

>-----

A__ 43718 00 IRR NK G
> RYAN JACQUES

>
> 10919 S DEAN RD
> HUTCHINSON KS 67501

>-----

A__ 44525 00 IRR NK G
> C B & JOAN K SHOWALTER

>
> 8803 E ARLINGTON RD
> HAVEN KS 67543

>-----

A__ 44634 00 IRR NK G
> GLENN R & ETHELYN SHOWALTER

>
> 2415 W LONGVIEW RD
> HUTCHINSON KS 67501

>-----

A__ 46479 00 IRR LR G
> STEPHEN W & DEDRA K SAWATZKY

>
> 8001 S YODER RD
> HAVEN KS 67543

>-----

A__ 46555 00 IRR LR G
> JARED C & YOLANDA M OATNEY

>
> 11215 W LONGVIEW RD
> PARTRIDGE KS 67566

>-----

A__ 46646 00 IRR LR G
> C B & JOAN K SHOWALTER

>
> 8803 E ARLINGTON RD
> HAVEN KS 67543

>-----

A__ 47217 00 IRR LO G
> C B & JOAN K SHOWALTER

>
> 8803 E ARLINGTON RD
> HAVEN KS 67543

>-----

A__ 47522 00 IRR LO G

#49545

'
 > VERNON H & ARLENE K BONTRAGER TRUSTS
 > VERNON & ARLENE BONTRAGER
 > 8705 S SANDCREEK RD
 > HUTCHINSON KS 67501

>-----

A__ 47524 00 IRR LO G
 > WAYNE E YODER

>
 > 7912 S MCNEW RD
 > HUTCHINSON KS 67501

>-----

A__ 47671 00 IRR LR G
 > C B & JOAN K SHOWALTER

>
 > 8803 E ARLINGTON RD
 > HAVEN KS 67543

>-----

A__ 47973 00 IND LO G
 > UNDERGROUND CAVERN STABILIZATION LLC

>
 > 7513 S K-14 HWY
 > HUTCHINSON KS 67501

>-----

A__ 49545 00 IND AY G
 > UNDERGROUND CAVERN STABILIZATION LLC

>
 > 7513 S K-14 HWY
 > HUTCHINSON KS 67501

>-----

T__20127585 MF IRR GY G
 > C B & JOAN K SHOWALTER

>
 > 8803 E ARLINGTON RD
 > HAVEN KS 67543

>-----

T__20127586 MF IRR GY G
 > C B & JOAN K SHOWALTER

>
 > 8803 E ARLINGTON RD
 > HAVEN KS 67543

>-----

T__20129421 00 IND GY G
 > UNDERGROUND CAVERN STABILIZATION LLC

>
 > 7513 S K-14 HWY
 > HUTCHINSON KS 67501

>-----

=====

Domestic Well Owner Names and Address for New Application, File No. 49,545
Map.

1. Cruppers Corner Inc, 7104 S K14 HWY, Hutchinson KS 67501
2. Roger E Givens, 121 E 16th Ave, Hutchinson KS 67501
3. Andes Rental Properties, 7204 S K14 HWY Hutchinson KS 67501
4. Daniel & Carolyn Borntrager, 7314 S K14 HWY Hutchinson KS 67501
5. Charles S Schmid, 7502 S K14 HWY Hutchinson KS 67501
6. Robert A & Janice M Stewart, 7703 S K14 HWY Hutchinson KS 67501
7. Bradley A Harmony, 7717 S K14 HWY Hutchinson KS 67501
8. Penny Keene & Terry Barker, 7905 S K14 HWY Hutchinson KS 67501
9. Nathan J Hostetler, 7917 S K14 HWY Hutchinson KS 67501
10. Edwin W & Debra M Soper, 8005 S K14 HWY Hutchinson KS 67501
11. Gary & Kay Bontrager Trusts, 8101 S K14 HWY Hutchinson KS 67501
12. Danny R Sr & Linda J Chambers, 8105 S K14 HWY Hutchinson KS 67501
13. Bobby G & Mary Jo Perser Rev Trusts, 7816 S K14 HWY Hutchinson KS 67501

WATER RESOURCES
RECEIVED

JAN 22 2016

RECEIVED

FEB 08 2016

SCANNED
KS DEPT OF AGRICULTURE

1-20-2016
(Date)

Kansas Department of Agriculture
Division of Water Resources
David W. Barfield, Chief Engineer
1320 Research Park Drive
Manhattan, Kansas 66502

Re: Application File No. 49,545

Minimum Desirable Streamflow

Dear Sir:

I understand that a Minimum Desirable Streamflow requirement has been established by the legislature for the source of supply to which the above referenced application applies.

I understand that diversion of water pursuant to this application will be subject to regulation any time Minimum Desirable Streamflow requirements are not being met.

I also understand that if this application is approved, there could be times, as determined by the Division of Water Resources, when I would not be allowed to divert water. I realize that this could affect the economics of my decision to appropriate water.

I am aware of the above factors, and with the knowledge thereof, request that the Division of Water Resources proceed with processing and approval, if possible, of the above referenced application.

Steven Pangburn
Signature of Applicant

Steven Pangburn
(Print Applicant's Name)

State of Kansas)
County of Reno) ss

I hereby certify that the foregoing instrument was signed in my presence and sworn to before me this 20 day of January, 2016.

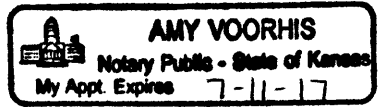

[Signature]
Notary Public

My Commission Expires:

7-11-17

WATER RESOURCES RECEIVED

RECEIVED

JAN 22 2016

SCANNED

JAN 08 2016

KS DEPT OF AGRICULTURE

**MINIMUM DESIRABLE STREAMFLOW FORM TO BE USED WHEN
APPLICABLE WHEN FILING AN APPLICATION FOR PERMIT
TO APPROPRIATE WATER FOR BENEFICIAL USE**

The Kansas Legislature has established minimum desirable streamflows for the streams listed below. If your proposed diversion of water is going to be from one of these watercourses or adjacent alluvial aquifers, please complete the back side of this page and submit it along with your application for permit to appropriate water.

Arkansas River
Big Blue River
Chapman Creek
Chikaskia River
Cottonwood River
Delaware River
Little Arkansas River
Little Blue River
Marais des Cygnes River
Medicine Lodge River
Mill Creek (Wabaunsee Co. area)
Neosho River

Ninnescah River
North Fork Ninnescah River
Rattlesnake Creek
Republican River
Saline River
Smoky Hill River
Solomon River
South Fork Ninnescah
Spring River
Walnut River
Whitewater River

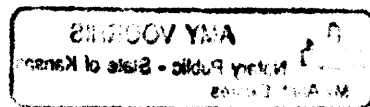

WATER WELL RECORD

Form WWC-5

Division of Water Resources App. No.

49,545

| | | | | |
|--|------------------------------|----------------------|------------------------|--|
| 1 LOCATION OF WATER WELL: County: Reno | Fraction ¼ NE ¼ SW ¼ NE ¼ | Section Number 14 | Township No. T 24 S | Range Number R 6 <input type="checkbox"/> E <input checked="" type="checkbox"/> W |
|--|------------------------------|----------------------|------------------------|--|

Street/Rural Address of Well Location; if unknown, distance & direction from nearest town or intersection: If at owner's address, check here .
from junction of K96 & K17 S of Hutch, go S on K17 1/2 mile west into site

Global Positioning System (GPS) information:
Latitude: (in decimal degrees)
Longitude: (in decimal degrees)
Elevation:
Datum: WGS 84, NAD 83, NAD 27
Collection Method:
 GPS unit (Make/Model:)
 Digital Map/Photo, Topographic Map, Land Survey
Est. Accuracy: <3 m, 3-5 m, 5-15 m, >15 m

2 WATER WELL OWNER: UCS LLC
RR#, Street Address, Box #: P. O. Box 225
City, State, ZIP Code : Great Bend, KS 67530-0225

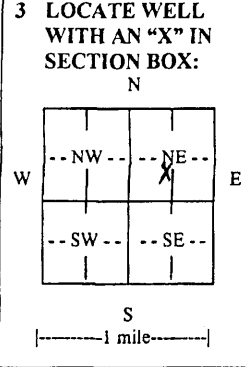

4 DEPTH OF COMPLETED WELL 65 ft.
Depth(s) Groundwater Encountered (1)..... ft. (2)..... ft. (3)..... ft.
WELL'S STATIC WATER LEVEL 24ft. below land surface measured on mo/day/yr. 12/12/12.....
Pump test data: Well water wasft. after hours pumping gpm
EST. YIELD 60gpm. Well water wasft. after hours pumping gpm
Bore Hole Diameter 9.7/8in. to .65ft., andin. toft.
WELL WATER TO BE USED AS: Public water supply Geothermal Injection well
 Domestic Feedlot Oil field water supply Dewatering Other (Specify below)
 Irrigation Industrial Domestic-lawn & garden Monitoring well
Was a chemical/bacteriological sample submitted to Department? Yes No
If yes, mo/day/yr sample was submitted.....
Water well disinfected? Yes No

5 TYPE OF CASING USED: Steel PVC Other
CASING JOINTS: Glued Clamped Welded Threaded
Casing diameter .5 in. to .45 ft., Diameter in. to ft., Diameter in. to ft.
Casing height above land surface .30 in., Weight lbs./ft., Wall thickness or gauge No.
TYPE OF SCREEN OR PERFORATION MATERIAL:
 Steel Stainless Steel PVC Other (Specify)
 Brass Galvanized Steel None used (open hole)
SCREEN OR PERFORATION OPENINGS ARE:
 Continuous slot Mill slot Gauze wrapped Torch cut Drilled holes None (open hole)
 Louvered shutter Key punched Wire wrapped Saw cut Other (specify)
SCREEN-PERFORATED INTERVALS: From .65 ft. to .45 ft., From ft. to ft.
From ft. to ft., From ft. to ft.
GRAVEL PACK INTERVALS: From .65 ft. to .20 ft., From ft. to ft.
From ft. to ft., From ft. to ft.

6 GROUT MATERIAL: Neat cement Cement grout Bentonite Other
Grout Intervals: From .20 ft. to 0 ft., From ft. to ft., From ft. to ft.
What is the nearest source of possible contamination:
 Septic tank Lateral lines Pit privy Livestock pens Insecticide storage Other (specify below)
 Sewer lines Cesspool Sewage lagoon Fuel storage Abandoned water well
 Watertight sewer lines Seepage pit Feedyard Fertilizer storage Oil well/gas well
Direction from well East Distance from well 150 ft.

| FROM | TO | LITHOLOGIC LOG | FROM | TO | LITHO. LOG (cont.) or PLUGGING INTERVALS |
|------|----|----------------|------|----|--|
| 0 | 4 | Sandy Topsoil | | | |
| 4 | 18 | Clay Layers | | | |
| 18 | 50 | Sand & Gravel | | | |
| 50 | 65 | Tan Shale | | | |
| | | | | | |
| | | | | | |
| | | | | | |
| | | | | | |
| | | | | | |

7 CONTRACTOR'S OR LANDOWNER'S CERTIFICATION: This water well was constructed, reconstructed, or plugged under my jurisdiction and was completed on (mo/day/year) 12/12/12 and this record is true to the best of my knowledge and belief.
Kansas Water Well Contractor's License No. 665 This Water Well Record was completed on (mo/day/year) 12/31/12
under the business name of Pratt Well Service, Inc. by (signature) *Pratt Well Service, Inc. President*

INSTRUCTIONS: Use typewriter or ball point pen. PLEASE PRESS FIRMLY and PRINT clearly. Please fill in blanks and check the correct answers. Send three copies (white, blue, pink) to Kansas Department of Health and Environment, Bureau of Water, Geology Section, 1000 SW Jackson St., Suite 420, Topeka, Kansas 66612-1367. Telephone 785-296-5524. Send one copy to WATER WELL OWNER and retain one for your records. I include fee of \$5.00 for each constructed well. Visit us at <http://www.kdheks.gov/waterwell/index.html>.

FEB 22

SCANNED

49,545

| INPUTS | |
|---|------------|
| Target Section Definition | |
| Section | 14 |
| Township | 24 |
| Range | 6 |
| Range Direction | w |
| Target Point Coordinates (NAD27 or NAD83) | |
| Target Longitude | -97.944300 |
| Target Latitude | 37.965930 |

Load Data and Compute

- Instructions**
1. Enter values for section, township, range and range direction.
 2. Enter *NAD27* or *NAD83* longitude and latitude of target point.
 3. Click "Load Data and Compute" button.
 4. Use feet distances corresponding to datum of target point.

Water Appropriation, File No. 47973

| Loaded Section Data From LEOBASE using NAD83 | | |
|---|------------------------|----------------------|
| Corner | Corner Latitudes | Corner Longitudes |
| SW | 37.95512104 | -97.95891937 |
| NW | 37.96970790 | -97.95910226 |
| NE | 37.96984486 | -97.94030282 |
| SE | 37.95536495 | -97.94037893 |
| Degrees Longitude per Foot | | 3.46839199E-06 |
| Degrees Latitude per Foot | | 2.74610806E-06 |
| Target Point Distances from Corners using NAD83 | | |
| Corner | Feet North(+)/South(-) | Feet East(-)/West(+) |
| SW | 3936 | -4215 |
| NW | -1376 | -4268 |
| NE | -1426 | 1152 |
| SE | 3847 | 1131 |

| Loaded Section Data From LEOBASE using NAD27 | | |
|---|------------------------|----------------------|
| Corner | Corner Latitudes | Corner Longitudes |
| SW | 37.95510900 | -97.95858800 |
| NW | 37.96969600 | -97.95877100 |
| NE | 37.96983300 | -97.93997200 |
| SE | 37.95535300 | -97.94004800 |
| Degrees Longitude per Foot | | 3.46839143E-06 |
| Degrees Latitude per Foot | | 2.74598553E-06 |
| Target Point Distances from Corners using NAD27 | | |
| Corner | Feet North(+)/South(-) | Feet East(-)/West(+) |
| SW | 3941 | -4119 |
| NW | -1371 | -4172 |
| NE | -1421 | 1248 |
| SE | 3852 | 1226 |

WATER RESOURCES
RECEIVED

JAN 22 2016

RECEIVED

KS DEPT OF AGRICULTURE

FEB 08 2016

Field Office
Resources

SCANNED

1320 Research Park Drive
Manhattan, Kansas 66502
Jackie McClaskey, Secretary



Phone: (785) 564-6700
Fax: (785) 564-6777
Email: ksag@kda.ks.gov
www.agriculture.ks.gov
Sam Brownback, Governor

January 25, 2016

UNDERGROUND CAVERN STABILIZATION LLC
7513 S K14 HWY
HUTCHINSON KS 67501

RE: Application
File No. 49545

Dear Sir or Madam:

Your application for permit to appropriate water in 14-24S-6W in Reno County, was received and has been assigned the file number noted above.

As a matter of record, the Division of Water Resources has on hand a large number of applications awaiting processing. Therefore to be fair to all concerned, and so that we can process those applications on hand in the order they were received, we intend to concentrate on the backlog of applications until the issue is resolved. Once review of your application has begun, we will contact you, if additional information is required.

In accordance with the provisions of the Kansas Water Appropriation Act, a portion of which is included below, the use of water as proposed prior to approval of the application is unlawful. Once approved, compliance with the terms, conditions and limitations of the permit is necessary. Conservation of the water resources of Kansas is required.

Section 82a-728 of the Kansas Water Appropriation Act, provides (a) except for the appropriation of water for the purpose of domestic use, . . . it shall be unlawful for any person to appropriate or threaten to appropriate water from any source without first applying for and obtaining a permit to appropriate water in accordance with the provisions of the Water Appropriation Act or for any person to violate any condition of a vested right, appropriation right or an approved application for a permit to appropriate water for beneficial use.

(b) (1) The violation of any provision of this section by any person is a class C misdemeanor . . .

A class C misdemeanor is punishable by a fine not to exceed \$500 and/or a term of confinement not to exceed one month in the county jail. Each day that the violation occurs constitutes a separate offense.

If you have any questions, please contact me at (785) 564-6634. If you wish to discuss a specific file, please have the file number ready so that we may help you more efficiently.

Sincerely,

A handwritten signature in black ink, appearing to read "K. Kopp", written over a white background.

Kenneth A. Kopp, P.G.
New Application Unit Supervisor
Water Appropriation Program

KAK: DLW
pc: STAFFORDField Office
GMD 2

SCANNED

49, 545

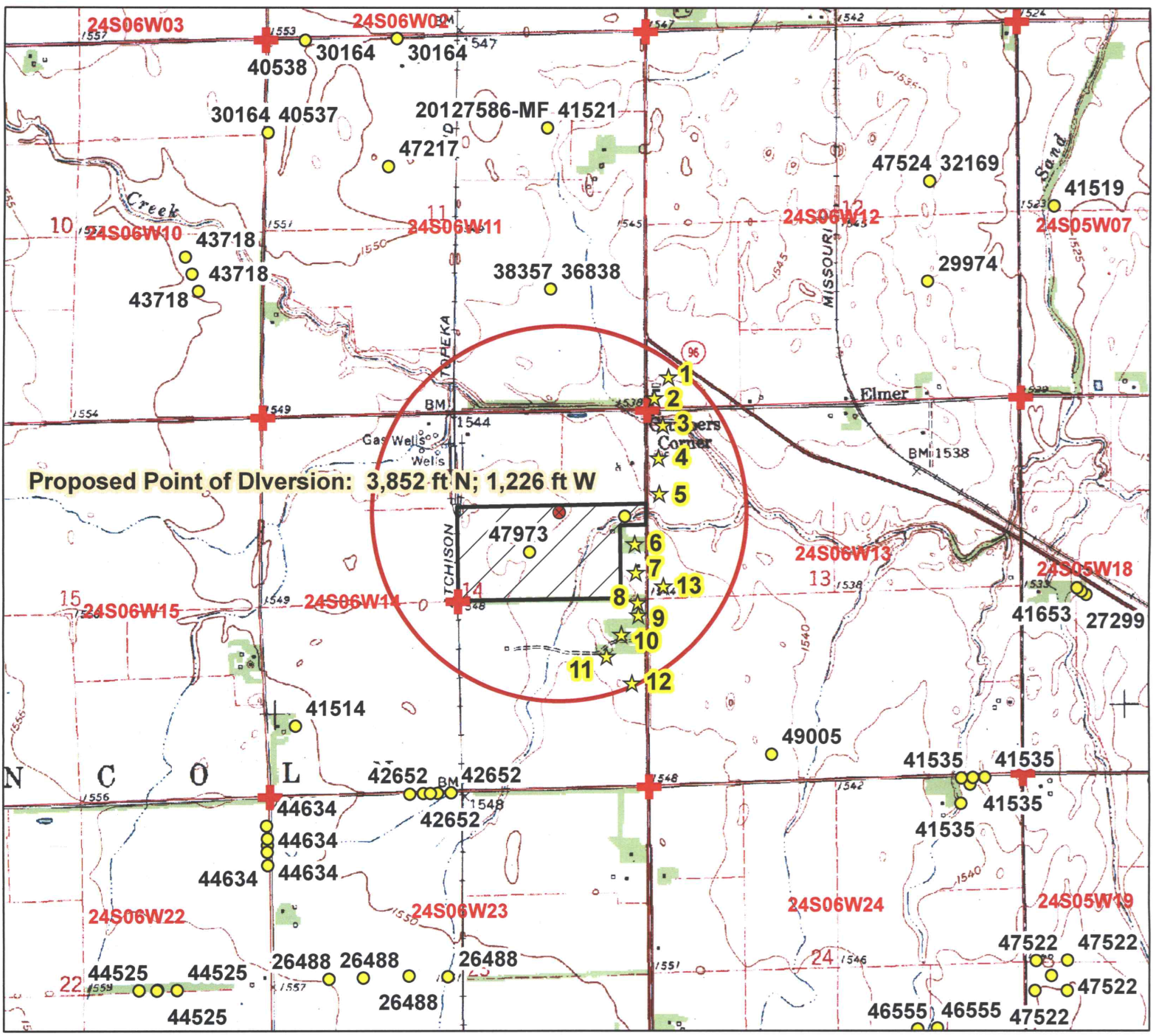

Legend

- Water Appropriations
- Proposed Point of Diversion
- ★ Domestic Well
- + Section Corner
- Section Line
- Proposed Place of Use



Water Appropriation, File No. FEB 08 2016
Permit to Proceed Application Map Stafford Field Office
14-24S-6W Division of Water Resources
Reno County

I declare that all water wells of any kind have been shown within 1/2 mile of the proposed point of diversion. **JAN 22 2016**

Stuart Parker
 Signature

WATER RESOURCES
 RECEIVED
SCANNED
 KS DEPT OF AGRICULTURE