

NOTICE

This scan only represents the application as filed. The information contained herein meets the requirements of K.A.R. 5-3-1 or K.A.R. 5-5-1, and has been found acceptable for filing in the office of the Chief Engineer. The application should not be considered to be a complete application as per K.A.R. 5-3-1b or K.A.R. 5-5-2a.

THE STATE OF KANSAS



KANSAS DEPARTMENT OF AGRICULTURE
Jackie McClaskey, Secretary of Agriculture

DIVISION OF WATER RESOURCES
David W. Barfield, Chief Engineer

WATER RESOURCES RECEIVED
UNACCEPTABLE FOR PRIORITY
JAN 23 2017
1:00
KS DEPT OF AGRICULTURE

File Number 49,782
This item to be completed by the Division of Water Resources.

WATER RESOURCES RECEIVED

MAR 02 2017
10:40
KS DEPT OF AGRICULTURE

APPLICATION FOR PERMIT TO APPROPRIATE WATER FOR BENEFICIAL USE
Filing Fee Must Accompany the Application
(Please refer to Fee Schedule attached to this application form.)

To the Chief Engineer of the Division of Water Resources, Kansas Department of Agriculture,
1320 Research Park Drive, Manhattan, KS 66502:

1. Name of Applicant (Please Print): Martin and David Ternes
Address: 1068 N West Rd
City: Peck State KS Zip Code 67120
Telephone Number: (316) 524 1351

2. The source of water is: surface water in _____ (stream)
OR groundwater in Ninnescah River (drainage basin)

Certain streams in Kansas have minimum target flows established by law or may be subject to administration when water is released from storage for use by water assurance district members. If your application is subject to these regulations on the date we receive your application, you will be sent the appropriate form to complete and return to the Division of Water Resources.

3. The maximum quantity of water desired is 103.5 (44.5 add) acre-feet OR _____ gallons per calendar year, to be diverted at a maximum rate of 600 gallons per minute OR _____ cubic feet per second.

Once your application has been assigned a priority, the requested maximum rate of diversion and maximum requested quantity of water under that priority number can **NOT** be increased. Please be certain your requested maximum rate of diversion and maximum quantity of water are appropriate and reasonable for your proposed project and are in agreement with the Division of Water Resources' requirements.

4. The water is intended to be appropriated for (Check use intended):
(a) Artificial Recharge (b) Irrigation (c) Recreational (d) Water Power
(e) Industrial (f) Municipal (g) Stockwatering (h) Sediment Control
(i) Domestic (j) Dewatering (k) Hydraulic Dredging (l) Fire Protection
(m) Thermal Exchange (n) Contamination Remediation

YOU **MUST** COMPLETE AND ATTACH ADDITIONAL DIVISION OF WATER RESOURCES FORM(S) PROVIDING INFORMATION TO SUBSTANTIATE YOUR REQUEST FOR THE AMOUNT OF WATER FOR THE INTENDED USE REFERENCED ABOVE.

For Office Use Only:							
F.O. <u>2</u>	GMD <u>0</u>	Meets K.A.R. 5-3-1 (YES/NO) <u>(YES)</u>	Use <u>IRR</u>	Source <u>G/S</u>	County <u>SW</u>	By <u>AW</u>	Date <u>1/23/17</u>
Code <u>RE2</u>	Fee \$ <u>300</u>	TR # _____	Receipt Date <u>3/2/17</u>	Check # <u>8242</u>			

3/10/2017 UM

5. The location of the proposed wells, pump sites or other works for diversion of water is:

Note: For the application to be accepted, the point of diversion location must be described to at least a 10 acre tract, unless you specifically request a 60 day period of time in which to locate the site within a specifically described, minimal legal quarter section of land.

(A) One in the SE quarter of the NW quarter of the SE quarter of Section 7, more particularly described as being near a point 1419 feet North and 1936 feet West of the Southeast corner of said section, in Township 30 South, Range 1 East, Sumner County, Kansas.

(B) One in the _____ quarter of the _____ quarter of the _____ quarter of Section _____, more particularly described as being near a point _____ feet North and _____ feet West of the Southeast corner of said section, in Township _____ South, Range _____ East/West (circle one), _____ County, Kansas.

(C) One in the _____ quarter of the _____ quarter of the _____ quarter of Section _____, more particularly described as being near a point _____ feet North and _____ feet West of the Southeast corner of said section, in Township _____ South, Range _____ East/West (circle one), _____ County, Kansas.

(D) One in the _____ quarter of the _____ quarter of the _____ quarter of Section _____, more particularly described as being near a point _____ feet North and _____ feet West of the Southeast corner of said section, in Township _____ South, Range _____ East/West (circle one), _____ County, Kansas.

If the source of supply is groundwater, a separate application shall be filed for each proposed well or battery of wells, except that a single application may include up to four wells within a circle with a quarter (1/4) mile radius in the same local source of supply which do not exceed a maximum diversion rate of 20 gallons per minute per well.

A battery of wells is defined as two or more wells connected to a common pump by a manifold; or not more than four wells in the same local source of supply within a 300 foot radius circle which are being operated by pumps not to exceed a total maximum diversion rate of 800 gallons per minute and which supply water to a common distribution system.

6. The owner of the point of diversion, if other than the applicant is (please print):

FREDERICK L SIMS Martin + David Terners
(name, address and telephone number)

417 E 140TH AVE N PECK, KS 67120 1068 NW 1st RD Peck KS 67120
(name, address and telephone number)

You must provide evidence of legal access to, or control of, the point of diversion from the landowner or the landowner's authorized representative. Provide a copy of a recorded deed, lease, easement or other document with this application. In lieu thereof, you may sign the following sworn statement:

I have legal access to, or control of, the point of diversion described in this application from the landowner or the landowner's authorized representative. I declare under penalty of perjury that the foregoing is true and correct.

Executed on 16 Dec, 2016. Martin Scott Tern
Applicant's Signature

The applicant must provide the required information or signature irrespective of whether they are the landowner. Failure to complete this portion of the application will cause it to be unacceptable for filing and the application will be returned to the applicant.

7. The proposed project for diversion of water will consist of 1 well and pump
(number of wells, pumps or dams, etc.)
and was completed (by) 12/20/2000
(Month/Day/Year - each was or will be completed)

8. The first actual application of water for the proposed beneficial use was or is estimated to be ASAP
(Mo/Day/Year)

9. Will pesticide, fertilizer, or other foreign substance be injected into the water pumped from the diversion works?

Yes No If "yes", a check valve shall be required.

All chemigation safety requirements must be met including a chemigation permit and reporting requirements.

10. If you are planning to impound water, please contact the Division of Water Resources for assistance, prior to submitting the application. Please attach a reservoir area capacity table and inform us of the total acres of surface drainage area above the reservoir.

Have you also made an application for a permit for construction of this dam and reservoir with the Division of Water Resources? Yes No

- If yes, show the Water Structures permit number here _____
- If no, explain here why a Water Structures permit is not required N.A.

11. The application must be supplemented by a U.S.G.S. topographic map, aerial photograph or a detailed plat showing the following information. On the topographic map, aerial photograph, or plat, identify the center of the section, the section lines or the section corners and show the appropriate section, township and range numbers. Also, please show the following information:

- (a) The location of the proposed point(s) of diversion (wells, stream-bank installations, dams, or other diversion works) should be plotted as described in Paragraph No. 5 of the application, showing the North-South distance and the East-West distance from a section line or southeast corner of section.
- (b) If the application is for groundwater, please show the location of any existing water wells of any kind within 1/2 mile of the proposed well or wells. Identify each existing well as to its use and furnish the name and mailing address of the property owner or owners. If there are no wells within 1/2 mile, please advise us.
- (c) If the application is for surface water, the names and addresses of the landowner(s) 1/2 mile downstream and 1/2 mile upstream from your property lines must be shown.
- (d) The location of the proposed place of use should be shown by crosshatching on the topographic map, aerial photograph or plat.
- (e) Show the location of the pipelines, canals, reservoirs or other facilities for conveying water from the point of diversion to the place of use.

A 7.5 minute U.S.G.S. topographic map may be obtained by providing the section, township and range numbers to: Kansas Geological Survey, 1930 Constant, Campus West, University of Kansas, Lawrence, Kansas 66047.

12. List any application, appropriation of water, water right, or vested right file number that covers the same diversion points or any of the same place of use described in this application. Also list any other recent modifications made to existing permits or water rights in conjunction with the filing of this application.

Overlaps PD and PU with File No. 42,428. Requesting an additional 44.5 AF of water.

WATER RESOURCES RECEIVED

WATER RESOURCES RECEIVED
UNACCEPTABLE FOR PRIORITY
JAN 23 2017

MAR 02 2017

KS DEPT OF AGRICULTURE

13. Furnish the following well information if the proposed appropriation is for the use of groundwater. If the well has not been completed, give information obtained from test holes, if available.

Information below is from: Test holes Well as completed Drillers log attached

Well location as shown in paragraph No.	(A)	(B)	(C)	(D)
Date Drilled	_____	_____	_____	_____
Total depth of well	_____	_____	_____	_____
Depth to water bearing formation	_____	_____	_____	_____
Depth to static water level	_____	_____	_____	_____
Depth to bottom of pump intake pipe	_____	_____	_____	_____

14. The relationship of the applicant to the proposed place where the water will be used is that of

Owner
(owner, tenant, agent or otherwise)

15. The owner(s) of the property where the water is used, if other than the applicant, is (please print):

~~FREDERICK L SIMS~~ Martin and David Terres
(name, address and telephone number)

417 E 140TH AVE N PECK, KS 67120 1068 W West RD Peck KS 67120
(name, address and telephone number)

16. The undersigned states that the information set forth above is true to the best of his/her knowledge and that this application is submitted in good faith.

Dated at Peck, Kansas, this 17 day of JAN, 17
(month) (year)

Martin Scott Terres
(Applicant Signature)

By _____
(Agent or Officer Signature)

(Agent or Officer - Please Print)

Assisted by MJM/SFFO ESII Date: 12/7/2016
(office/title)

UNACCEPTABLE FOR PRIORITY
JAN 17 2017
KANSAS DEPARTMENT OF REVENUE

FEE SCHEDULE

1. The fee for an application for a permit to appropriate water for beneficial use, except for domestic use, shall be (see paragraph No. 2 below if requesting storage):

ACRE-FEET	FEE
0-100	\$200.00
101-320	\$300.00
More than 320	\$300.00 plus \$20.00 for each additional 100 acre-feet or any part thereof.

2. The fee for an application in which storage is requested, except for domestic use, shall be:

ACRE-FEET	FEE
0-250	\$200.00
More than 250	\$200.00 plus \$20.00 for each additional 250 acre-feet of storage or any part thereof.

Note: If an application requests both direct use *and* storage, the fee charged shall be as determined under No. 1 or No. 2 above, whichever is greater, but not both fees.

3. The fee for an application for a permit to appropriate water for water power or dewatering purposes shall be \$100.00 plus \$200.00 for each 100 cubic feet per second, or part thereof, of the diversion rate requested.

Note: The applicant shall notify the Chief Engineer and pay the statutorily required field inspection fee of \$400.00 when construction of the works for diversion has been completed, except that for applications filed on or after July 1, 2009, for works constructed for sediment control use and for evaporation from a groundwater pit for industrial use shall be accompanied by a field inspection fee of \$200.00.

MAKE CHECKS PAYABLE TO THE KANSAS DEPARTMENT OF AGRICULTURE

ATTENTION

A Water Conservation Plan may be required per K.S.A. 82a-733. A statement that your application for permit to appropriate water may be subject to the minimum desirable streamflow requirements per K.S.A. 82a-703a, b, and c may also be required from you. After the Division of Water Resources has had the opportunity to review your application, you will be notified whether or not you will need to submit a Water Conservation Plan. You also may be required to install a water flow meter or water stage measuring device on your diversion works prior to diverting water. There may be other special conditions or Groundwater Management District regulations that you will need to comply with if this application is approved.

CONVERSION FACTORS

1 acre-foot equals 325,851 gallons
1 million gallons equal 3.07 acre-feet

WATER RESOURCES RECEIVED

MAR 02 2017

KS DEPT OF AGRICULTURE

WATER RESOURCES RECEIVED

UNACCEPTABLE FOR PRIORITY

KS DEPT OF AGRICULTURE

Nearby Well Owners

#1: WR # 32,269

FORREST G BUTTS
205 S CENTRAL AVE
MULVANE KS 67110-1719

#2: WR # 42,032

GARLAND J BELL REV TRUST
1420 N MERIDIAN RD
PECK KS 67120-9046

Domestic Well Owners

John Jones.
751 E 136TH AVE N
Peck, Ks 67120

Phone - 316-524 1420

WATER RESOURCES
RECEIVED

MAR 02 2017

KS DEPT OF AGRICULTURE

WATER RESOURCES
RECEIVED

JAN 23 2017

UNACCEPTABLE FOR PRIORITY

KS DEPT OF AGRICULTURE

IRRIGATION USE SUPPLEMENTAL SHEET

File No. 49,782

Name of Applicant (Please Print): Martin + David Ternes

1. Please supply the name and address of each landowner, the legal description of the lands to be irrigated, and designate the actual number of acres to be irrigated in each forty acre tract or fractional portion thereof:

Landowner of Record NAME: ~~FREDERICK L SIMS~~ Martin + David Ternes

ADDRESS: ~~417 E. 140TH AVE N PECK, KS 67120~~ 10108 W West RD Peck KS 67120

S	T	R	NE¼				NW¼				SW¼				SE¼				TOTAL
			NE	NW	SW	SE	NE	NW	SW	SE	NE	NW	SW	SE	NE	NW	SW	SE	
7	30S	1E															39.8	39.8	79.6

Landowner of Record NAME: _____

ADDRESS: _____

S	T	R	NE¼				NW¼				SW¼				SE¼				TOTAL
			NE	NW	SW	SE	NE	NW	SW	SE	NE	NW	SW	SE	NE	NW	SW	SE	

Landowner of Record NAME: _____

ADDRESS: _____

S	T	R	NE¼				NW¼				SW¼				SE¼				TOTAL
			NE	NW	SW	SE	NE	NW	SW	SE	NE	NW	SW	SE	NE	NW	SW	SE	

WATER RESOURCES
RECEIVED

MAR 02 2017

WATER RESOURCES
RECEIVED
UNACCEPTABLE FOR PRIORITY
JAN 23 2017

2. Please complete the following information for the description of the operation for the irrigation project. Attach supplemental sheets as needed.

a. Indicate the soils in the field(s) and their intake rates:

Soil Name	Percent of field (%)	Intake Rate (in/hr)	Irrigation Design Group
_____	_____	_____	_____
_____	_____	_____	_____
_____	_____	_____	_____
_____	_____	_____	_____
Total:	100 %		

b. Estimate the average land slope in the field(s): _____ %

Estimate the maximum land slope in the field(s): _____ %

c. Type of irrigation system you propose to use (check one):

- Center pivot
 Center pivot - LEPA
 "Big gun" sprinkler
 Gravity system (furrows)
 Gravity system (borders)
 Sideroll sprinkler

Other, please describe: _____

d. System design features:

i. Describe how you will control tailwater:

ii. For sprinkler systems:

(1) Estimate the operating pressure at the distribution system: _____ psi

(2) What is the sprinkler package design rate? _____ gpm

(3) What is the wetted diameter (twice the distance the sprinkler throws water) of a sprinkler on the outer 100 feet of the system? _____ feet

(4) Please include a copy of the sprinkler package design information.

e. Crop(s) you intend to irrigate. Please note any planned crop rotations:

f. Please describe how you will determine when to irrigate and how much water to apply (particularly important if you do not plan a full irrigation).

You may attach any additional information you believe will assist in informing the Division of the need for your request.

49,782

WATER WELL RECORD Form WWC-5 KSA 82a-1212 ID No.

1 LOCATION OF WATER WELL:		Fraction	Section Number	Township Number	Range Number
County: <u>Sumner</u>		<u>SW 1/4 NW 1/4 SE 1/4</u>	<u>7</u>	<u>T 30 S</u>	<u>R 1 EW</u>
Distance and direction from nearest town or city street address of well if located within city? <u>2 mile So., 3/4 East, 1/4 North of Peck, Ks.</u>					
2 WATER WELL OWNER:		Board of Agriculture, Division of Water Resources			
RR#, St. Address, Box #		Application Number: <u>42,428</u>			
City, State, ZIP Code		<u>Mulvane, Ks 67110</u>			
3 LOCATE WELL'S LOCATION WITH AN "X" IN SECTION BOX:		4 DEPTH OF COMPLETED WELL: <u>50</u> ft. ELEVATION:			
		Depth(s) Groundwater Encountered 1. ft. 2. ft. 3. ft.			
		WELL'S STATIC WATER LEVEL <u>16</u> ft. below land surface measured on <u>04/24/10</u>			
		Pump test data: Well water was ft. after hours pumping gpm			
		Est. Yield gpm: Well water was ft. after hours pumping gpm			
		Bore Hole Diameter: <u>2.8</u> in. to <u>50</u> ft. and in. to ft.			
		WELL WATER TO BE USED AS: 5 Public water supply 8 Air conditioning 11 Injection well			
		1 Domestic 3 Feedlot 8 Oil field water supply 9 Dewatering 12 Other (Specify below)			
		2 Irrigation 4 Industrial 7 Domestic (lawn & garden) 10 Monitoring well			
		Was a chemical/bacteriological sample submitted to Department? Yes. No. <u>X</u> ... If yes, mo/day/yr sample was submitted			
		Water Well Disinfected? Yes <u>X</u> No			
5 TYPE OF BLANK CASING USED:					
1 Steel		3 RMP (SR)		8 Concrete tile	
2 PVC		4 ABS		9 Other (specify below)	
Blank casing diameter: <u>16</u> in. to <u>30</u> ft. Dia		Casing joints: <u>Glued</u> Clamped		Welded	
Casing height above land surface: <u>12</u> in. weight <u>SCH 40</u> lbs./ft. Wall thickness or gauge No. <u>500</u>		7 Fiberglass		Threaded	
TYPE OF SCREEN OR PERFORATION MATERIAL:					
1 Steel		3 Stainless steel		7 PVC	
2 Brass		4 Galvanized steel		8 RMP (SR)	
SCREEN OR PERFORATION OPENINGS ARE:		5 Gauzed wrapped		8 Saw cut	
1 Continuous slot		3 Mill slot		9 Drilled holes	
2 Louvered shutter		4 Key punched		7 Torch cut	
SCREEN-PERFORATED INTERVALS: From <u>30</u> ft. to <u>50</u> ft.		10 Asbestos-cement		11 Other (specify)	
GRAVEL PACK INTERVALS: From <u>20</u> ft. to <u>50</u> ft.		12 None used (open hole)		11 None (open hole)	
6 GROUT MATERIAL:					
1 Neat cement		2 Cement grout		3 Bentonite	
4 Other: <u>HOLE PLUG</u>		GROUT INTERVALS: From <u>20</u> ft. to <u>3</u> ft.		ft. to ft.	
What is the nearest source of possible contamination:					
1 Septic tank		4 Lateral lines		7 Pit privy	
2 Sewer lines		5 Cess pool		8 Sewage lagoon	
3 Watertight sewer lines		6 Seepage pit		9 Feedyard	
Direction from well?		10 Livestock pens		14 Abandoned water well	
		11 Fuel storage		15 Oil well/Gas well	
		12 Fertilizer storage		16 Other (specify below)	
		13 Insecticide storage		<u>None</u>	
		How many feet?			
7 CONTRACTOR'S OR LANDOWNER'S CERTIFICATION: This water well was (1) constructed, (2) reconstructed, or (3) plugged under my jurisdiction and was completed on (mo/day/year) <u>04/24/10</u> and this record is true to the best of my knowledge and belief. Kansas Water Well Contractor's License No. <u>134</u> This Water Well Record was completed on (mo/day/yr) <u>05/30/10</u> under the business name of <u>Reservoirs & Services Int.</u> by (signature) <u>Jessie Dodson</u>					
INSTRUCTIONS: Use typewriter or ball point pen. PLEASE PRESS FIRM and PRINT clearly. Please fill in blanks, underline or circle the correct answers. Send top three copies to Kansas Department of Health and Environment, Bureau of Water, Topeka, Kansas 66620-0001. Telephone 785-296-5526. Send one to WATER WELL OWNER and retain one for your records. Fee of \$5.00 for each constructed well.					

WATER RESOURCES RECEIVED

WATER RESOURCES RECEIVED

JAN 23 2017

MAR 02 2017

UNACCEPTABLE FOR PRIORITY

KS DEPT OF AGRICULTURE

KS DEPT OF AGRICULTURE

1320 Research Park Drive
Manhattan, Kansas 66502
Jackie McClaskey, Secretary



Phone: (785) 564-6700
Fax: (785) 564-6777
Email: ksag@kda.ks.gov
www.agriculture.ks.gov
Sam Brownback, Governor

March 3, 2017

MARTIN AND DAVID TERNES
1068 N WEST RD
PECK KS 67120

FILE COPY

RE: Application
File No. 49782

Dear Sir or Madam:

Your application for permit to appropriate water in 7-30S-13E in Sumner County, was received and has been assigned the file number noted above.

As a matter of record, the Division of Water Resources has on hand a large number of applications awaiting processing. Therefore to be fair to all concerned, and so that we can process those applications on hand in the order they were received, we intend to concentrate on the backlog of applications until the issue is resolved. Once review of your application has begun, we will contact you, if additional information is required.

In accordance with the provisions of the Kansas Water Appropriation Act, a portion of which is included below, the use of water as proposed prior to approval of the application is unlawful. Once approved, compliance with the terms, conditions and limitations of the permit is necessary. Conservation of the water resources of Kansas is required.

Section 82a-728 of the Kansas Water Appropriation Act, provides (a) except for the appropriation of water for the purpose of domestic use, . . . it shall be unlawful for any person to appropriate or threaten to appropriate water from any source without first applying for and obtaining a permit to appropriate water in accordance with the provisions of the Water Appropriation Act or for any person to violate any condition of a vested right, appropriation right or an approved application for a permit to appropriate water for beneficial use.

(b) (1) The violation of any provision of this section by any person is a class C misdemeanor . . .

A class C misdemeanor is punishable by a fine not to exceed \$500 and/or a term of confinement not to exceed one month in the county jail. Each day that the violation occurs constitutes a separate offense.

If you have any questions, please contact me at (785) 564-6645. If you wish to discuss a specific file, please have the file number ready so that we may help you more efficiently.

Sincerely,

Brent A Turney, P.G.
Change Application Unit Supervisor
Water Appropriation Program

BAT: dlw
pc: STAFFORD Field Office
GMD



I declare that all water wells or diversion sites using the same source of supply and within 1/2 mile of the proposed point of diversion have been plotted on the application map.

- ★ Domestic Wells
- Proposed PD
- ▲ Water Rights
- ✚ SFFOsec_corners
- ▨ ProposedPlaceOfUse

Martin Scott Peirce
 Signature _____ Date _____



WATER RESOURCES RECEIVED
 WATER RESOURCES RECEIVED
 UNACCEPTABLE FOR PRIORITY
 F.O. 2
 Date: 12/6/2016
 KS DEPT OF AGRICULTURE

JAN 29 2017

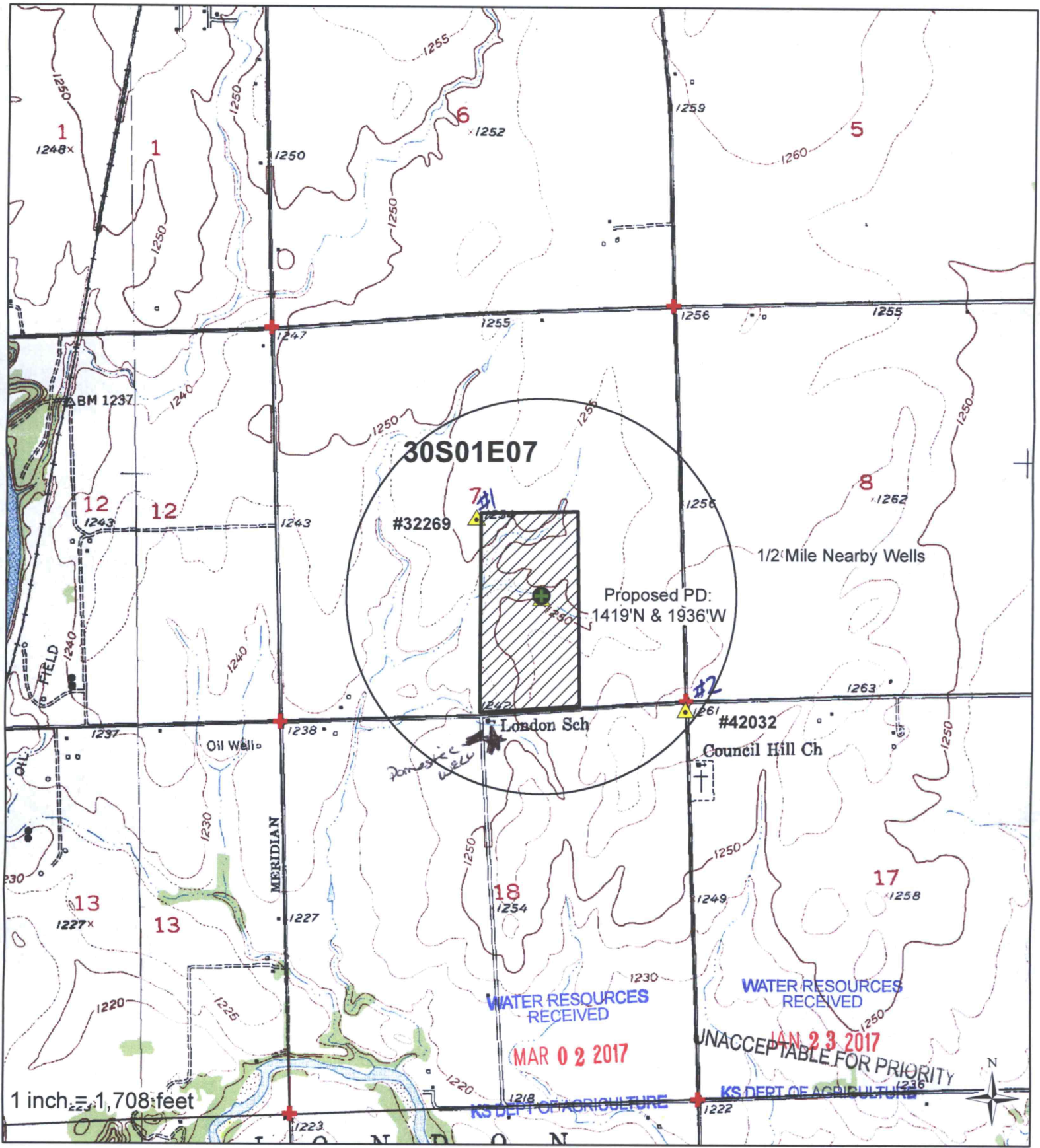

I declare that all water wells or diversion sites using the same source of supply and within 1/2 mile of the proposed point of diversion have been plotted on the application map.

- ★ Domestic Wells
- Proposed PD
- ▲ Water Rights
- ⊕ SFFOsec_corners
- ▨ ProposedPlaceOfUse

Matt Scott Zane _____ 1/17/17

Signature _____ Date _____
 0 650 1,300 2,600 3,900 5,200 Feet

Created By: Matt Meier
 F.O. 2
 Date: 12/6/2016