

NOTICE

This scan only represents the application as filed. The information contained herein meets the requirements of K.A.R. 5-3-1 or K.A.R. 5-5-1, and has been found acceptable for filing in the office of the Chief Engineer. The application should not be considered to be a complete application as per K.A.R. 5-3-1b or K.A.R. 5-5-2a.

THE STATE OF KANSAS



KANSAS DEPARTMENT OF AGRICULTURE
Jackie McClaskey, Secretary of Agriculture

DIVISION OF WATER RESOURCES
David W. Barfield, Chief Engineer

File Number 49943
This item to be completed by the Division of Water Resources.

WATER RESOURCES RECEIVED

APPLICATION FOR PERMIT TO APPROPRIATE WATER FOR BENEFICIAL USE

Filing Fee Must Accompany the Application
(Please refer to Fee Schedule attached to this application form.)

NOV 20 2017
12:59
KS DEPT OF AGRICULTURE

To the Chief Engineer of the Division of Water Resources, Kansas Department of Agriculture,
1320 Research Park Drive, Manhattan, Kansas 66502:

1. Name of Applicant (Please Print): Unified School District 419
Address: 506 S Kansas
City: Canton State KS Zip Code 67428
Telephone Number: (620) 654-6603

2. The source of water is: [] surface water in (stream)
OR [x] groundwater in Little Arkansas River (drainage basin)

Certain streams in Kansas have minimum target flows established by law or may be subject to administration when water is released from storage for use by water assurance district members. If your application is subject to these regulations on the date we receive your application, you will be sent the appropriate form to complete and return to the Division of Water Resources.

3. The maximum quantity of water desired is 11.7 acre-feet OR --- gallons per calendar year, to be diverted at a maximum rate of 99 gallons per minute OR 0.22 cubic feet per second.

Once your application has been assigned a priority, the requested maximum rate of diversion and maximum requested quantity of water under that priority number can NOT be increased. Please be certain your requested maximum rate of diversion and maximum quantity of water are appropriate and reasonable for your proposed project and are in agreement with the Division of Water Resources' requirements.

4. The water is intended to be appropriated for (Check use intended):
(a) [] Artificial Recharge (b) [x] Irrigation (c) [] Recreational (d) [] Water Power
(e) [] Industrial (f) [] Municipal (g) [] Stockwatering (h) [] Sediment Control
(i) [] Domestic (j) [] Dewatering (k) [] Hydraulic Dredging (l) [] Fire Protection
(m) [] Thermal Exchange (n) [] Contamination Remediation

YOU MUST COMPLETE AND ATTACH ADDITIONAL DIVISION OF WATER RESOURCES FORM(S) PROVIDING INFORMATION TO SUBSTANTIATE YOUR REQUEST FOR THE AMOUNT OF WATER FOR THE INTENDED USE REFERENCED ABOVE.

For Office Use Only:
F.O. 2 GMD 2 Meets K.A.R. 5-3-1 (YES/NO) Use FFE Source G S County MP By AW Date 11/20/17
Code REG Fee \$ 200 TR # Receipt Date 11/20/17 Check # 24184

12/6/2017 LLM

5. The location of the proposed wells, pump sites or other works for diversion of water is:

Note: For the application to be accepted, the point of diversion location must be described to at least a 10 acre tract, unless you specifically request a 60 day period of time in which to locate the site within a specifically described, minimal legal quarter section of land.

- (A) One **Battery of 2 wells w/ a Geocenter** in the SE quarter of the NW quarter of the SE quarter of Section 21, more particularly described as being near a point 1,818 feet North and 1,822 feet West of the Southeast corner of said section, in Township 19 South, Range 1 West, McPherson County, Kansas.
- (B) One in the NE quarter of the NW quarter of the SE quarter of Section 21, more particularly described as being near a point 2,026 feet North and 1,783 feet West of the Southeast corner of said section, in Township 19 South, Range 1 West, McPherson County, Kansas.
- (C) One in the SE quarter of the NW quarter of the SE quarter of Section 21, more particularly described as being near a point 1,611 feet North and 1,861 feet West of the Southeast corner of said section, in Township 19 South, Range 1 West, McPherson County, Kansas.
- (D) One in the _____ quarter of the _____ quarter of the _____ quarter of Section _____, more particularly described as being near a point _____ feet North and _____ feet West of the Southeast corner of said section, in Township _____ South, Range _____ East/West (circle one), _____ County, Kansas.

If the source of supply is groundwater, a separate application shall be filed for each proposed well or battery of wells, except that a single application may include up to four wells within a circle with a quarter (1/4) mile radius in the same local source of supply which do not exceed a maximum diversion rate of 20 gallons per minute per well.

A battery of wells is defined as two or more wells connected to a common pump by a manifold; or not more than four wells in the same local source of supply within a 300 foot radius circle which are being operated by pumps not to exceed a total maximum diversion rate of 800 gallons per minute and which supply water to a common distribution system.

6. The owner of the point of diversion, if other than the applicant is (please print):

Applicant _____
(name, address and telephone number)

You must provide evidence of legal access to, or control of, the point of diversion from the landowner or the landowner's authorized representative. Provide a copy of a recorded deed, lease, easement or other document with this application. In lieu thereof, you may sign the following sworn statement:

I have legal access to, or control of, the point of diversion described in this application from the landowner or the landowner's authorized representative. I declare under penalty of perjury that the foregoing is true and correct.

Executed on November 6, 2017. _____
Applicant's Signature

The applicant must provide the required information or signature irrespective of whether they are the landowner. Failure to complete this portion of the application will cause it to be unacceptable for filing and the application will be returned to the applicant.

7. The proposed project for diversion of water will consist of a battery of 2 wells and diversion system
(number of wells, pumps or dams, etc.)
and was completed (by) 12/31/11
(Month/Day/Year - each was or will be completed)

8. The first actual application of water for the proposed beneficial use was or is estimated to be 2011
(Mo/Day/Year)

13. Furnish the following well information if the proposed appropriation is for the use of groundwater. If the well has not been completed, give information obtained from test holes, if available.

Information below is from: Test holes Well as completed Drillers log attached

Well location as shown in paragraph No.	(A)	(B)	(C)	(D)
Date Drilled	<u>9/13/11</u>	<u>9/13/11</u>	_____	_____
Total depth of well	<u>84</u>	<u>80</u>	_____	_____
Depth to water bearing formation	<u>46</u>	<u>30</u>	_____	_____
Depth to static water level	<u>30</u>	<u>35</u>	_____	_____
Depth to bottom of pump intake pipe	_____	_____	_____	_____

14. The relationship of the applicant to the proposed place where the water will be used is that of owner
(owner, tenant, agent or otherwise)

15. The owner(s) of the property where the water is used, if other than the applicant, is (please print):
applicant
(name, address and telephone number)

(name, address and telephone number)

16. The undersigned states that the information set forth above is true to the best of his/her knowledge and that this application is submitted in good faith.

Dated at Canton, Kansas, this 6th day of November, 2017.
(month) (year)

(Applicant Signature)

By _____
(Agent or Officer Signature)

(Agent or Officer - Please Print)

WATER RESOURCES
RECEIVED
NOV 20 2017
KS DEPT OF AGRICULTURE

- 9. Will pesticide, fertilizer, or other foreign substance be injected into the water pumped from the diversion works?
 Yes No If "yes", a check valve shall be required.

All chemigation safety requirements must be met including a chemigation permit and reporting requirements.

- 10. If you are planning to impound water, please contact the Division of Water Resources for assistance, prior to submitting the application. Please attach a reservoir area capacity table and inform us of the total acres of surface drainage area above the reservoir.

Have you also made an application for a permit for construction of this dam and reservoir with the Division of Water Resources? Yes No

- If yes, show the Water Structures permit number here _____
- If no, explain here why a Water Structures permit is not required _____

- 11. The application must be supplemented by a U.S.G.S. topographic map, aerial photograph or a detailed plat showing the following information. On the topographic map, aerial photograph, or plat, identify the center of the section, the section lines or the section corners and show the appropriate section, township and range numbers. Also, please show the following information:

- (a) The location of the proposed point(s) of diversion (wells, stream-bank installations, dams, or other diversion works) should be plotted as described in Paragraph No. 5 of the application, showing the North-South distance and the East-West distance from a section line or southeast corner of section.
- (b) If the application is for groundwater, please show the location of any existing water wells of any kind within 1/2 mile of the proposed well or wells. Identify each existing well as to its use and furnish the name and mailing address of the property owner or owners. If there are no wells within 1/2 mile, please advise us.
- (c) If the application is for surface water, the names and addresses of the landowner(s) 1/2 mile downstream and 1/2 mile upstream from your property lines must be shown.
- (d) The location of the proposed place of use should be shown by crosshatching on the topographic map, aerial photograph or plat.
- (e) Show the location of the pipelines, canals, reservoirs or other facilities for conveying water from the point of diversion to the place of use.

A 7.5 minute U.S.G.S. topographic map may be obtained by providing the section, township and range numbers to: Kansas Geological Survey, 1930 Constant, Campus West, University of Kansas, Lawrence, Kansas 66047.

- 12. List any application, appropriation of water, water right, or vested right file number that covers the same diversion points or any of the same place of use described in this application. Also list any other recent modifications made to existing permits or water rights in conjunction with the filing of this application.

File No. 47977 is a P/D and P/U overlap. It will be dismissed contingent upon approval of this new application.

IRRIGATION USE SUPPLEMENTAL SHEET

File No. 49943

Name of Applicant (Please Print): Unified School Distric 419

1. Please supply the name and address of each landowner, the legal description of the lands to be irrigated, and designate the actual number of acres to be irrigated in each forty acre tract or fractional portion thereof:

Landowner of Record NAME: Unified School Distric 419

ADDRESS: _____

S	T	R	NE¼				NW¼				SW¼				SE¼				TOTAL
			NE	NW	SW	SE	NE	NW	SW	SE	NE	NW	SW	SE	NE	NW	SW	SE	
21	19	1W														8.5	0.5		9.0

Landowner of Record NAME: _____

ADDRESS: _____

S	T	R	NE¼				NW¼				SW¼				SE¼				TOTAL
			NE	NW	SW	SE	NE	NW	SW	SE	NE	NW	SW	SE	NE	NW	SW	SE	

Landowner of Record NAME: _____

ADDRESS: _____

S	T	R	NE¼				NW¼				SW¼				SE¼				TOTAL
			NE	NW	SW	SE	NE	NW	SW	SE	NE	NW	SW	SE	NE	NW	SW	SE	

WATER RESOURCES
RECEIVED

NOV 20 2017

2. Please complete the following information for the description of the operation for the irrigation project. Attach supplemental sheets as needed.

a. Indicate the soils in the field(s) and their intake rates:

Soil Name	Percent of field (%)	Intake Rate (in/hr)	Irrigation Design Group
Ladysmith Silty Clay Loam	100	0 - 0.06	
_____	_____	_____	_____
_____	_____	_____	_____
_____	_____	_____	_____
Total:	100 %		

b. Estimate the average land slope in the field(s): 0.5 %

Estimate the maximum land slope in the field(s): 0.5 %

c. Type of irrigation system you propose to use (check one):

Center pivot
 Center pivot - LEPA
 "Big gun" sprinkler
 Gravity system (furrows)
 Gravity system (borders)
 Sideroll sprinkler

Other, please describe: _____

d. System design features:

i. Describe how you will control tailwater: manage application rates so that there is little to no runoff

ii. For sprinkler systems:

(1) Estimate the operating pressure at the distribution system: _____ psi

(2) What is the sprinkler package design rate? _____ gpm

(3) What is the wetted diameter (twice the distance the sprinkler throws water) of a sprinkler on the outer 100 feet of the system? _____ feet

(4) Please include a copy of the sprinkler package design information.

e. Crop(s) you intend to irrigate. Please note any planned crop rotations: turf grass for football and practice fields

f. Please describe how you will determine when to irrigate and how much water to apply (particularly important if you do not plan a full irrigation). as needed to keep the playing surface safe

You may attach any additional information you believe will assist in informing the Division of the need for your request.

**MINIMUM DESIRABLE STREAMFLOW FORM TO BE USED WHEN
APPLICABLE WHEN FILING AN APPLICATION FOR PERMIT
TO APPROPRIATE WATER FOR BENEFICIAL USE**

The Kansas Legislature has established minimum desirable streamflows for the streams listed below. If your proposed diversion of water is going to be from one of these watercourses or adjacent alluvial aquifers, please complete the back side of this page and submit it along with your application for permit to appropriate water.

Arkansas River
Big Blue River
Chapman Creek
Chikaskia River
Cottonwood River
Delaware River
Little Arkansas River
Little Blue River
Marais des Cygnes River
Medicine Lodge River
Mill Creek (Wabaunsee Co. area)
Neosho River

Ninnescah River
North Fork Ninnescah River
Rattlesnake Creek
Republican River
Saline River
Smoky Hill River
Solomon River
South Fork Ninnescah
Spring River
Walnut River
Whitewater River

WATER WELL RECORD

Form WWC-5

Division of Water Resources App. No.

Well#1

49943

1 LOCATION OF WATER WELL: County: McPherson	Fraction $\frac{1}{4}$ SE $\frac{1}{4}$ NE $\frac{1}{4}$ SE $\frac{1}{4}$	Section Number 21	Township No. T 19 S	Range Number R 1 E <input checked="" type="checkbox"/> W
Street/Rural Address of Well Location; if unknown, distance & direction from nearest town or intersection: If at owner's address, check here <input checked="" type="checkbox"/>		Global Positioning System (GPS) information: Latitude: (in decimal degrees) Longitude: (in decimal degrees) Elevation: Datum: <input type="checkbox"/> WGS 84, <input type="checkbox"/> NAD 83, <input type="checkbox"/> NAD 27 Collection Method: <input type="checkbox"/> GPS unit (Make/Model:) <input type="checkbox"/> Digital Map/Photo, <input type="checkbox"/> Topographic Map, <input type="checkbox"/> Land Survey Est. Accuracy: <input type="checkbox"/> <3 m, <input type="checkbox"/> 3-5 m, <input type="checkbox"/> 5-15 m, <input type="checkbox"/> >15 m		
2 WATER WELL OWNER: RR#, Street Address, Box #: Canton-Galva High School 506 S. Kansas City, State, ZIP Code: Canton, KS 67428				

3 LOCATE WELL WITH AN "X" IN SECTION BOX:

N

NW	NE
SW	SE X

S

-----1 mile-----

4 DEPTH OF COMPLETED WELL **84** ft.

Depth(s) Groundwater Encountered (1)..... ft. (2)..... ft. (3)..... ft.

WELL'S STATIC WATER LEVEL... **30**ft. below land surface measured on mo/day/yr. **9/8/11**.....

Pump test data: Well water was.....ft. after..... hours pumping..... gpm

EST. YIELD. **20-30** gpm. Well water was.....ft. after..... hours pumping..... gpm

Bore Hole Diameter .. **9**.....in. to .. **84**ft., andin. toft.

WELL WATER TO BE USED AS: Public water supply Geothermal Injection well
 Domestic Feedlot Oil field water supply Dewatering Other (Specify below)
 Irrigation Industrial Domestic-lawn & garden Monitoring well

Was a chemical/bacteriological sample submitted to Department? Yes No

If yes, mo/day/yr sample was submitted.....

Water well disinfected? Yes No

5 TYPE OF CASING USED: Steel PVC Other

CASING JOINTS: Glued Clamped Welded Threaded

Casing diameter **0**..... **5**.. in. to **44**..... ft., Diameter in. to ft., Diameter in. to ft.

Casing height above land surface..... **12**..... in., Weightlbs./ft., Wall thickness or gauge No.

TYPE OF SCREEN OR PERFORATION MATERIAL:
 Steel Stainless Steel PVC Other (Specify)
 Brass Galvanized Steel None used (open hole)

SCREEN OR PERFORATION OPENINGS ARE:
 Continuous slot Mill slot Gauze wrapped Torch cut Drilled holes None (open hole)
 Louvered shutter Key punched Wire wrapped Saw cut Other (specify)

SCREEN-PERFORATED INTERVALS: From..... **44**..... ft. to **84**..... ft., From ft. to ft.

GRAVEL PACK INTERVALS: From..... **20**..... ft. to **84**..... ft., From ft. to ft.

6 GROUT MATERIAL: Neat cement Cement grout Bentonite Other

Grout Intervals: From **0**..... ft. to ... **20**..... ft., From ft. to ft., From ft. to ft.

What is the nearest source of possible contamination: **None within 1/4 mile**

Septic tank Lateral lines Pit privy Livestock pens Insecticide storage Other (specify below)
 Sewer lines Cesspool Sewage lagoon Fuel storage Abandoned water well
 Watertight sewer lines Seepage pit Feedyard Fertilizer storage Oil well/gas well

Direction from well Distance from well

FROM	TO	LITHOLOGIC LOG	FROM	TO	LITHO. LOG (cont.) or PLUGGING INTERVALS
0	2	Topsoil			
2	16	Clay, gray			
16	46	Clay, tan			
46	52	Sand, fine			WATER RESOURCES RECEIVED
52	61	Clay, gray			
61	80	Sand, fine w/clay layers			NOV 20 2017
80	85	Shale, green			
					KS DEPT OF AGRICULTURE

7 CONTRACTOR'S OR LANDOWNER'S CERTIFICATION: This water well was constructed, reconstructed, or plugged under my jurisdiction and was completed on (mo/day/year) .. **9/8/11**..... and this record is true to the best of my knowledge and belief.

Kansas Water Well Contractor's License No. **138**..... This Water Well Record was completed on (mo/day/yr) **9/13/11**..... under the business name of .. **Peterson Irrigation, Inc.**..... by (signature)..... *Mike Peterson*

INSTRUCTIONS: Use typewriter or ball point pen. **PLEASE PRESS FIRMLY** and **PRINT** clearly. Please fill in blanks and check the correct answers. Send three copies (white, blue, pink) to Kansas Department of Health and Environment, Bureau of Water, Geology Section, 1000 SW Jackson St., Suite 420, Topeka, Kansas 66612-1367. Telephone 785-296-5524. Send one copy to WATER WELL OWNER and retain one for your records. Include fee of \$5.00 for each constructed well. Visit us at <http://www.kdheks.gov/waterwell/index.html>.

WATER WELL RECORD

Form WWC-5

Division of Water Resources App. No.

Well #2

49943

1 LOCATION OF WATER WELL:
 County: **McPherson** Fraction $\frac{1}{4}$ SE $\frac{1}{4}$ NE $\frac{1}{4}$ SE $\frac{1}{4}$ Section Number **21** Township No. **T 19 S** Range Number **R 1** E W

Street/Rural Address of Well Location; if unknown, distance & direction from nearest town or intersection: If at owner's address, check here . **Global Positioning System (GPS) information:**
 Latitude: (in decimal degrees)
 Longitude: (in decimal degrees)
 Elevation:
 Datum: WGS 84, NAD 83, NAD 27
 Collection Method:
 GPS unit (Make/Model:)
 Digital Map/Photo, Topographic Map, Land Survey
 Est. Accuracy: <3 m, 3-5 m, 5-15 m, >15 m

2 WATER WELL OWNER: **Canton-Galva High School**
 RR#, Street Address, Box #: **506 S. Kansas**
 City, State, ZIP Code : **Canton, KS 67428**

3 LOCATE WELL WITH AN "X" IN SECTION BOX:

N

NW	NE
SW	SE

S

----- 1 mile -----

4 DEPTH OF COMPLETED WELL **80** ft.
 Depth(s) Groundwater Encountered (1)..... ft. (2)..... ft. (3)..... ft.
 WELL'S STATIC WATER LEVEL **35** ft. below land surface measured on mo/day/yr **9/9/11**
 Pump test data: Well water was..... ft. after..... hours pumping..... gpm
 EST. YIELD **20-30** gpm. Well water was..... ft. after..... hours pumping..... gpm
 Bore Hole Diameter **9** in. to **80** ft., and in. to ft.
 WELL WATER TO BE USED AS: Public water supply Geothermal Injection well
 Domestic Feedlot Oil field water supply Dewatering Other (Specify below)
 Irrigation Industrial Domestic-lawn & garden Monitoring well
 Was a chemical/bacteriological sample submitted to Department? Yes No
 If yes, mo/day/yr sample was submitted.....
 Water well disinfected? Yes No

5 TYPE OF CASING USED: Steel PVC Other
 CASING JOINTS: Glued Clamped Welded Threaded
 Casing diameter **5** in. to **40** ft., Diameter in. to ft., Diameter in. to ft.
 Casing height above land surface..... **12** in., Weight **2.37** lbs./ft., Wall thickness or gauge No. **214**
 TYPE OF SCREEN OR PERFORATION MATERIAL:
 Steel Stainless Steel PVC Other (Specify)
 Brass Galvanized Steel None used (open hole)
 SCREEN OR PERFORATION OPENINGS ARE:
 Continuous slot Mill slot Gauze wrapped Torch cut Drilled holes None (open hole)
 Louvered shutter Key punched Wire wrapped Saw cut Other (specify)
 SCREEN-PERFORATED INTERVALS: From **40** ft. to **80** ft., From ft. to ft.
 GRAVEL PACK INTERVALS: From **20** ft. to **80** ft., From ft. to ft.

6 GROUT MATERIAL: Neat cement Cement grout Bentonite Other
 Grout Intervals: From **0** ft. to **20** ft., From ft. to ft., From ft. to ft.
 What is the nearest source of possible contamination: **None within 1/4 mile**
 Septic tank Lateral lines Pit privy Livestock pens Insecticide storage Other (specify below)
 Sewer lines Cesspool Sewage lagoon Fuel storage Abandoned water well
 Watertight sewer lines Seepage pit Feedyard Fertilizer storage Oil well/gas well
 Direction from well Distance from well

FROM	TO	LITHOLOGIC LOG	FROM	TO	LITHO. LOG (cont.) or PLUGGING INTERVALS
0	2	Topsoil	74	78	Clay, gray
2	17	Clay, gray	78	80	Shale, green
17	30	Clay, Tan			
30	36	Sand, fine			
36	41	Clay, gray			
41	43	Sand, fine			
43	51	Clay, gray			
51	54	Sand, fine			
54	69	Clay, gray			
69	74	Sand, fine			

7 CONTRACTOR'S OR LANDOWNER'S CERTIFICATION: This water well was constructed, reconstructed, or plugged under my jurisdiction and was completed on (mo/day/year) **9/9/11**..... and this record is true to the best of my knowledge and belief. Kansas Water Well Contractor's License No. **138**..... This Water Well Record was completed on (mo/day/year) **9/13/11**..... under the business name of **Peterson Irrigation, Inc.**..... by (signature) *[Signature]*

INSTRUCTIONS: Use typewriter or ball point pen. **PLEASE PRESS FIRMLY** and **PRINT** clearly. Please fill in blanks and check the correct answers. Send three copies (white, blue, pink) to Kansas Department of Health and Environment, Bureau of Water, Geology Section, 1000 SW Jackson St., Suite 420, Topeka, Kansas 66612-1367. Telephone 785-296-5524. Send one copy to WATER WELL OWNER and retain one for your records. Include fee of \$5.00 for each **constructed** well. Visit us at <http://www.kdheks.gov/waterwell/index.html>.



1320 Research Park Drive
Manhattan, Kansas 66502

Jackie McClaskey, Secretary

Phone: (785) 564-6700

Fax: (785) 564-6777

Email: ksag@kda.ks.gov

www.agriculture.ks.gov

Sam Brownback, Governor

November 21, 2017

UNIFIED SCHOOL DISTRICT 419
506 S KANSAS
CANTON KS 67428

FILE COPY

RE: Application
File No. 49943

Dear Sir or Madam:

Your application for permit to appropriate water in 21-19S-1W in McPherson County, was received and has been assigned the file number noted above.

As a matter of record, the Division of Water Resources has on hand a large number of applications awaiting processing. Therefore to be fair to all concerned, and so that we can process those applications on hand in the order they were received, we intend to concentrate on the backlog of applications until the issue is resolved. Once review of your application has begun, we will contact you, if additional information is required.

In accordance with the provisions of the Kansas Water Appropriation Act, a portion of which is included below, the use of water as proposed prior to approval of the application is unlawful. Once approved, compliance with the terms, conditions and limitations of the permit is necessary. Conservation of the water resources of Kansas is required.

Section 82a-728 of the Kansas Water Appropriation Act, provides (a) except for the appropriation of water for the purpose of domestic use, . . . it shall be unlawful for any person to appropriate or threaten to appropriate water from any source without first applying for and obtaining a permit to appropriate water in accordance with the provisions of the Water Appropriation Act or for any person to violate any condition of a vested right, appropriation right or an approved application for a permit to appropriate water for beneficial use.

(b) (1) The violation of any provision of this section by any person is a class C misdemeanor . . .

A class C misdemeanor is punishable by a fine not to exceed \$500 and/or a term of confinement not to exceed one month in the county jail. Each day that the violation occurs constitutes a separate offense.

If you have any questions, please contact me at (785) 564-6645. If you wish to discuss a specific file, please have the file number ready so that we may help you more efficiently.

Sincerely,

Kristen A. Baum
New Applications Unit Supervisor
Water Appropriation Program

BAT: dlw
pc: STAFFORD Field Office
GMD 2

49943

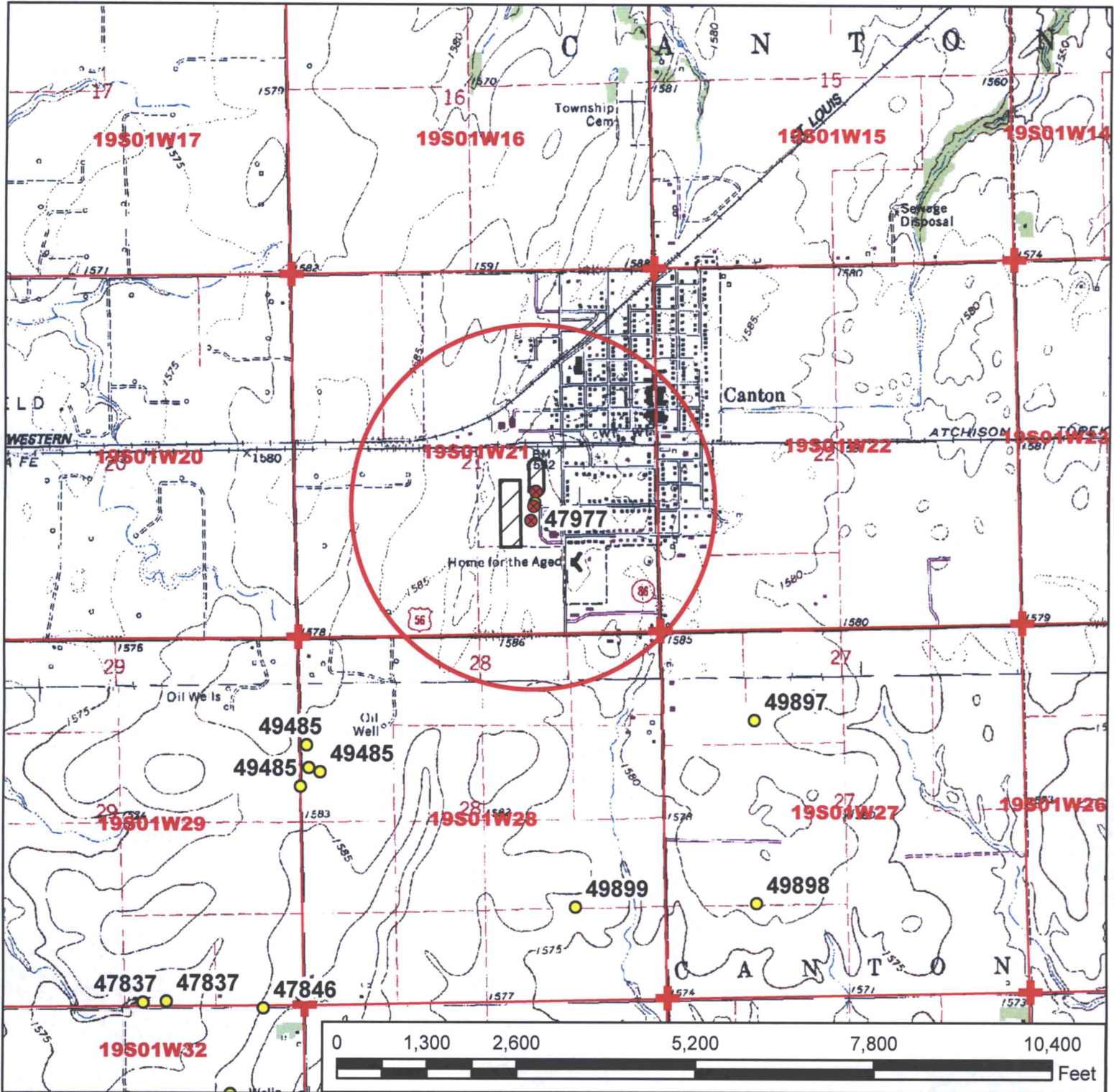

Legend

- Water Appropriations
- ⊗ Proposed Point of Diversion
- + Section Corner
- Section Lines
- Half Mile Circle
- Proposed Place of Use

Water Appropriation, File No. _____

New Application Map
 21-19S-1W // McPherson County WATER RESOURCES RECEIVED
 Assistance with a public notice is requested due to the density of potential nearby domestic wells.

NOV 20 2017

KS DEPT OF AGRICULTURE



Signature *[Handwritten Signature]*