

Kansas Department of Agriculture
 Division of Water Resources
CHANGE: P/D WORKSHEET

1. File Number: 10084	2. Status Change Date:	3. Change Num: 3	4. Field Office: 02	5. GMD:
---------------------------------	------------------------	----------------------------	-------------------------------	---------

6. Status: <input checked="" type="checkbox"/> Approved <input type="checkbox"/> Denied by DWR/GMD <input type="checkbox"/> Dismiss by Request/Failure to Return	7. Filing Date of Change: 1/30/18
--	---

8a. Applicant(s) <input type="checkbox"/> New to system <input type="checkbox"/> Person ID _____ Add Seq# _____	8c. Landowner(s) <input type="checkbox"/> New to system <input type="checkbox"/> Person ID _____ Add Seq# _____
---	---

8b. Landowner(s) <input type="checkbox"/> New to system <input type="checkbox"/> Person ID 413 Add Seq# 1 CITY OF ARKANSAS CITY DIRECTOR OF PUBLIC WORKS 118 W CENTRAL ARKANSAS CITY KS 67005	8d. WUC <input type="checkbox"/> New to system <input type="checkbox"/> Person ID 413 Add Seq# 1 CITY OF ARKANSAS CITY DIRECTOR OF PUBLIC WORKS 118 W CENTRAL ARKANSAS CITY KS 67005
--	---

9. Documents and Enclosure(s): <input checked="" type="checkbox"/> DWR Meter(s) Date to Comply: 12/31/18 <input checked="" type="checkbox"/> N & P Date to Comply: 12/31/18	
<input type="checkbox"/> Anti-Reverse Meter <input type="checkbox"/> Meter Seal <input checked="" type="checkbox"/> Check Valve <input checked="" type="checkbox"/> N & P Form <input checked="" type="checkbox"/> Water Tube <input checked="" type="checkbox"/> Driller Copy <input checked="" type="checkbox"/> H & E Letter	
<input type="checkbox"/> Conservation Plan Date Required: _____ Date Approved: _____ Date to Comply: _____	

10. Use Made of Water From: _____ To: _____

Date Prepared: 1/31/18	By: TJS
Date Entered:	By:

File No. **10084** 11. County: **COWLEY** Basin: **Arkansas River** Stream: --- Formation Code: **113 (Main Stem Alluvium)** Special Use: **None**

12. Points of Diversion											Rate and Quantity					
CHK	MOD	DEL	PDIV	Qualifier	S	T	R	ID	'N	'W	Comment (AKA Line)	Rate gpm/cfs	Quantity af/mgy	Rate gpm/cfs	Quantity af/mgy	Overlap PD Files
DEL				46388				13								
ENT				Lot 5	26	34S	3E		478	1918	WELL #11	No Change	No Change	No Change	No Change	CL 05
CHK				14882												
CHK				25341												
CHK				45011												
CHK				45285												
CHK				52711												
CHK				74902												
CHK				85047												
CHK				1098												
CHK				6608												

13. Storage: Rate _____ NF Quantity _____ ac/ft Additional Rate _____ NF Additional Quantity _____ ac/ft

14. Limitation: _____ af/yr at _____ gpm (_____ cfs) when combined with file number(s) _____
 Limitation: _____ af/yr at _____ gpm (_____ cfs) when combined with file number(s) _____

15. 5YR Allocation: Allocation Type _____ Start Year _____ 5 YR Amount _____ Amount Unit _____ Base Acres _____ Comment _____

16. Place of Use																		Owner	Chg?	Overlap Files									
CHK	MOD	DEL	ENT	PUSE	S	T	R	ID		NE¼				NW¼				SW¼				SE¼				Total			
										NE ¼	NW ¼	SW ¼	SE ¼	NE ¼	NW ¼	SW ¼	SE ¼	NE ¼	NW ¼	SW ¼	SE ¼	NE ¼	NW ¼	SW ¼	SE ¼				
CHK				24244																							8b.	N	CL 05, 27679
CHK				39646																							8b.	N	CL 05, 27679, 37163

Base Acres: --- Year: --- Minimum Reasonable Quantity: ---
 Comments: ---

Submit completed application to:
 Kansas Department of Agriculture
 Division of Water Resources
 Field Office for your area.

Call for address:

- Topeka -- (785) 862-6300
- Stafford -- (620) 234-5311
- Stockton -- (785) 425-6787
- Garden City -- (620) 276-2901
- www.ksda.gov/dwr

DWR FIELD OFFICE APPLICATION FOR APPROVAL TO CHANGE THE PLACE OF USE AND/OR THE POINT OF DIVERSION



WATER METER REQUIRED

STATE OF KANSAS

Filing Fee Must Accompany the Application, K.S.A. 82a-708b(b), as amended.
 Fee Schedule is on the third page of this application form.

Paragraph Nos. 1, 2, 3 & 5 must be completed. Complete all other applicable portions. If change in point of diversion is greater than 100 feet, or if place of use will be changed, include a topographic map or detailed plat showing the authorized and proposed point(s) of diversion and/or place of use.

File No. 10084

RECEIVED
9:26 am
 JAN 30 2018

1. Application is hereby made for approval of the Chief Engineer to change the (check one or both):

- Place of Use Point of Diversion

under the water right which is the subject of this application in accordance with the conditions described below.

Stafford Field Office
 Division of Water Resources

The source of supply is: Groundwater Surface water

2. Name and address of Applicant: CITY OF ARKANSAS CITY DIRECTOR OF PUBLIC WORKS

118 W CENTRAL ARKANSAS CITY KS 67005

Phone Number: () _____ Email address: _____

Name and address of Water Use Correspondent: Same as Applicant

Phone Number: () _____ Email address: _____

3. The presently authorized place of use is:

Owner of Land ---- NAME: CITY OF ARKANSAS CITY DIRECTOR OF PUBLIC WORKS

ADDRESS: 118 W CENTRAL ARKANSAS CITY KS 67005

(If there is more than one landowner, attach supplemental sheets as necessary.)

Sec.	Twp.	Range	NE¼				NW¼				SW¼				SE¼				TOTAL ACRES	
			NE¼	NW¼	SW¼	SE¼	NE¼	NW¼	SW¼	SE¼	NE¼	NW¼	SW¼	SE¼	NE¼	NW¼	SW¼	SE¼		

4. If this application is for a change in place of use, it is proposed that the place of use be changed to:

Owner of Land ---- NAME: NO CHANGE

ADDRESS: _____

(If there is more than one landowner, attach supplemental sheets as necessary.)

Sec.	Twp.	Range	NE¼				NW¼				SW¼				SE¼				TOTAL ACRES		
			NE¼	NW¼	SW¼	SE¼	NE¼	NW¼	SW¼	SE¼	NE¼	NW¼	SW¼	SE¼	NE¼	NW¼	SW¼	SE¼			

For Office Use Only: Code _____ Fee \$ <u>100</u> - TR # _____ Receipt Date _____ Check # <u>170309</u>
--

5. **Presently authorized point of diversion:** WELL#11 (PDIV ID: 46388)

One in the Lot 5 Quarter of the _____ Quarter of the _____ Quarter of the _____ Quarter of the _____
of Section 26, Township 34 South, Range 3 EAST,
in Cowley County, Kansas, 445 feet North 1970 feet West of Southeast corner of section.
Authorized Rate No Change* Authorized Quantity No Change* Depth of well 36* (feet)
(DWR use only: Computer ID No. 13 GPS 548* feet North 1918* feet West)
 This point will not be changed This point will be changed as follows: UPDATE point of diversion better described with GPS as:
Proposed point of diversion: (Complete only if change is requested)
One in the Lot 5 Quarter of the _____ Quarter of the _____ Quarter of the _____ Quarter of the _____
of Section 26, Township 34 South, Range 3 EAST,
in Cowley County, Kansas, 375478* feet North 19701918* feet West of Southeast corner of section.
Proposed Rate No Change* Proposed Quantity No Change* Proposed well depth (feet) ~34
This point is: Additional Well Geo Center List other water rights that will use this point 10084

6. **Presently authorized point of diversion:** WELL#3 (PDIV ID: 14882)

One in the SE Quarter of the NE Quarter of the NW Quarter of the _____ Quarter of the _____
of Section 26, Township 34 South, Range 3 EAST,
in Cowley County, Kansas, 4050 feet North 2750 feet West of Southeast corner of section.
Authorized Rate No Change* Authorized Quantity No Change* Depth of well - (feet)
(DWR use only: Computer ID No. 3 GPS _____ feet North _____ feet West)
 This point will not be changed This point will be changed as follows: UPDATE point of diversion better described with GPS as:
Proposed point of diversion: (Complete only if change is requested)
One in the _____ Quarter of the _____ Quarter of the _____ Quarter of the _____
of Section _____, Township _____ South, Range _____ (E/W),
in _____ County, Kansas, _____ feet North _____ feet West of Southeast corner of section.
Proposed Rate _____ Proposed Quantity _____ Proposed well depth (feet) _____
This point is: Additional Well Geo Center List other water rights that will use this point _____

7. Why do you need a new point of diversion? _____
Lost capacity due to age and well screen deterioration.

8. If a well, is the test hole log attached? Yes No

9. When do you propose to complete the new point of diversion?
Upon approval - Summer 2018

10. If the point of diversion is a well:
(a) What are you going to do with the old well?
Plug it
(b) When will this be done? Upon completion of new well

11. Groundwater Management District recommendation attached? Yes No

12. Assisted by Lloyd Hemphill/TFO

13a. If the proposed point of diversion will be relocated within 100 feet of the existing point of diversion, indicate its location on the diagram below in relation to the existing point of diversion. (PLEASE NOTE: The "X" in center of diagram below represents presently authorized point of diversion.)

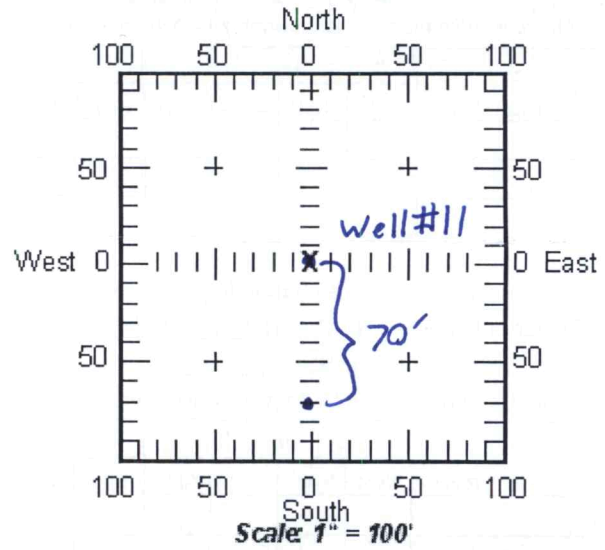

13b. If the proposed point of diversion will be relocated more than 100 feet but within 2640 feet from the existing point of diversion, attach a topographic map or aerial photograph. For groundwater sources, show all wells (including domestic) within one-half mile of the proposed point of diversion and the names and mailing addresses of the owners. For surface water sources, show the names and addresses of the landowner(s) one-half mile downstream and one-half mile upstream from your property lines.

RECEIVED
JAN 30 2018

APPLICATION FOR APPROVAL TO CHANGE
THE PLACE OF USE AND/OR POINT OF DIVERSION
SUPPLEMENTAL SHEET
FILE NO. 10084

Presently authorized point of diversion: WELL#1 (PDIV ID: 25341)

One in the SE Quarter of the SE Quarter of the NW Quarter
of Section 26, Township 34 South, Range 3 E,
in Cowley County, Kansas, 3200 feet North 2750 feet West of Southeast corner of section.
Authorized Rate No Change * Authorized Quantity No Change * Depth of well _____ (feet)
(DWR use only: Computer ID No. 1 GPS _____ feet North _____ feet West)
 This point will not be changed This point will be changed as follows: UPDATE point of diversion better described with GPS as:

Proposed point of diversion: (Complete only if change is requested)

One in the _____ Quarter of the _____ Quarter of the _____ Quarter
of Section _____, Township _____ South, Range _____ (EW),
in _____ County, Kansas, _____ feet North _____ feet West of Southeast corner of section.
Proposed Rate _____ Proposed Quantity _____ Proposed well depth (feet) _____
This point is: Additional Well Geo Center List other water rights that will use this point _____

Presently authorized point of diversion: WELL#6 (PDIV ID: 45011)

One in the Lot 5 Quarter of the _____ Quarter of the _____ Quarter
of Section 26, Township 34 South, Range 3 E,
in Cowley County, Kansas, 675 feet North 2575 feet West of Southeast corner of section.
Authorized Rate No Change * Authorized Quantity No Change * Depth of well _____ (feet)
(DWR use only: Computer ID No. 6 GPS _____ feet North _____ feet West)
 This point will not be changed This point will be changed as follows: UPDATE point of diversion better described with GPS as:

Proposed point of diversion: (Complete only if change is requested)

One in the _____ Quarter of the _____ Quarter of the _____ Quarter
of Section _____, Township _____ South, Range _____ (EW),
in _____ County, Kansas, _____ feet North _____ feet West of Southeast corner of section.
Proposed Rate _____ Proposed Quantity _____ Proposed well depth (feet) _____
This point is: Additional Well Geo Center List other water rights that will use this point _____

Presently authorized point of diversion: WELL#12 (PDIV ID: 45285)

One in the Lot 4 Quarter of the _____ Quarter of the _____ Quarter
of Section 26, Township 34 South, Range 3 E,
in Cowley County, Kansas, 1675 feet North 2575 feet West of Southeast corner of section.
Authorized Rate No Change * Authorized Quantity No Change * Depth of well _____ (feet)
(DWR use only: Computer ID No. 14 GPS _____ feet North _____ feet West)
 This point will not be changed This point will be changed as follows: UPDATE point of diversion better described with GPS as:

Proposed point of diversion: (Complete only if change is requested)

One in the _____ Quarter of the _____ Quarter of the _____ Quarter
of Section _____, Township _____ South, Range _____ (EW),
in _____ County, Kansas, _____ feet North _____ feet West of Southeast corner of section.
Proposed Rate _____ Proposed Quantity _____ Proposed well depth (feet) _____
This point is: Additional Well Geo Center List other water rights that will use this point _____

Presently authorized point of diversion: WELL#4 (PDIV ID: 52711)

One in the SE Quarter of the NE Quarter of the NW Quarter
of Section 26, Township 34 South, Range 3 E,
in Cowley County, Kansas, 4575 feet North 2750 feet West of Southeast corner of section.
Authorized Rate No Change * Authorized Quantity No Change * Depth of well _____ (feet)
(DWR use only: Computer ID No. 4 GPS _____ feet North _____ feet West)
 This point will not be changed This point will be changed as follows: UPDATE point of diversion better described with GPS as:

Proposed point of diversion: (Complete only if change is requested)

One in the _____ Quarter of the _____ Quarter of the _____ Quarter
of Section _____, Township _____ South, Range _____ (EW),
in _____ County, Kansas, _____ feet North _____ feet West of Southeast corner of section.
Proposed Rate _____ Proposed Quantity _____ Proposed well depth (feet) _____
This point is: Additional Well Geo Center List other water rights that will use this point _____

RECEIVED

JAN 30 2018

Stafford Field Office
Division of Water Resources

APPLICATION FOR APPROVAL TO CHANGE
THE PLACE OF USE AND/OR POINT OF DIVERSION
SUPPLEMENTAL SHEET
FILE NO. 10084

Presently authorized point of diversion: WELL#2 (PDIV ID: 74902)

One in the NE Quarter of the SE Quarter of the NW Quarter
of Section 26, Township 34 South, Range 3 E,
in Cowley County, Kansas, 3600 feet North 2700 feet West of Southeast corner of section.
Authorized Rate No Change* Authorized Quantity No Change* Depth of well _____ (feet)
(DWR use only: Computer ID No. 21 GPS _____ feet North _____ feet West)
 This point will not be changed This point will be changed as follows: UPDATE point of diversion better described with GPS as:

Proposed point of diversion: (Complete only if change is requested)

One in the _____ Quarter of the _____ Quarter of the _____ Quarter
of Section _____, Township _____ South, Range _____ (E/W),
in _____ County, Kansas, _____ feet North _____ feet West of Southeast corner of section.
Proposed Rate _____ Proposed Quantity _____ Proposed well depth (feet) _____
This point is: Additional Well Geo Center List other water rights that will use this point _____

Presently authorized point of diversion: WELL#8 (PDIV ID: 85047)

One in the Lot 5 Quarter of the _____ Quarter of the _____ Quarter
of Section 26, Township 34 South, Range 3 E,
in Cowley County, Kansas, 1245 feet North 2010 feet West of Southeast corner of section.
Authorized Rate No Change* Authorized Quantity No Change* Depth of well _____ (feet)
(DWR use only: Computer ID No. 22 GPS _____ feet North _____ feet West)
 This point will not be changed This point will be changed as follows: UPDATE point of diversion better described with GPS as:

Proposed point of diversion: (Complete only if change is requested)

One in the _____ Quarter of the _____ Quarter of the _____ Quarter
of Section _____, Township _____ South, Range _____ (E/W),
in _____ County, Kansas, _____ feet North _____ feet West of Southeast corner of section.
Proposed Rate _____ Proposed Quantity _____ Proposed well depth (feet) _____
This point is: Additional Well Geo Center List other water rights that will use this point _____

Presently authorized point of diversion: WELL#10 (PDIV ID: 1098)

One in the Lot 4 Quarter of the _____ Quarter of the _____ Quarter
of Section 26, Township 34 South, Range 3 E,
in Cowley County, Kansas, 2224225* feet North 1750 feet West of Southeast corner of section.
Authorized Rate No Change* Authorized Quantity No Change* Depth of well _____ (feet)
(DWR use only: Computer ID No. 10 GPS _____ feet North _____ feet West)
 This point will not be changed This point will be changed as follows: UPDATE point of diversion better described with GPS as:

Proposed point of diversion: (Complete only if change is requested)

One in the _____ Quarter of the _____ Quarter of the _____ Quarter
of Section _____, Township _____ South, Range _____ (E/W),
in _____ County, Kansas, _____ feet North _____ feet West of Southeast corner of section.
Proposed Rate _____ Proposed Quantity _____ Proposed well depth (feet) _____
This point is: Additional Well Geo Center List other water rights that will use this point _____

Presently authorized point of diversion: WELL#9 (PDIV ID: 6608)

One in the SE Quarter of the SE Quarter of the NW Quarter
of Section 26, Township 34 South, Range 3 E,
in Cowley County, Kansas, 2800 feet North 2750 feet West of Southeast corner of section.
Authorized Rate No Change* Authorized Quantity No Change* Depth of well _____ (feet)
(DWR use only: Computer ID No. 9 GPS _____ feet North _____ feet West)
 This point will not be changed This point will be changed as follows: UPDATE point of diversion better described with GPS as:

Proposed point of diversion: (Complete only if change is requested)

One in the _____ Quarter of the _____ Quarter of the _____ Quarter
of Section _____, Township _____ South, Range JAN 30 2018 (E/W),
in _____ County, Kansas, _____ feet North _____ feet West of Southeast corner of section.
Proposed Rate _____ Proposed Quantity _____ Proposed well depth (feet) _____
This point is: Additional Well Geo Center List other water rights that will use this point _____

RECEIVED

Field Office
Division of Water Resources

14. If the proposed groundwater point of diversion is 300 or fewer feet from existing point of diversion, complete the following:
- (a) Does the undersigned represent all owners of the currently authorized place(s) of use identified in this application?
 Yes No (If no, all owners must sign this application.)
 - (b) Will the ownership interest of any owner of the currently authorized place(s) of use identified in this application be adversely affected if this application is approved as requested?
 Yes No (If yes, all owners must sign this application.)
 - (c) If this application is not approved expeditiously, will there be substantial damage to property, public health or safety?
 Yes No (If no, all owners must sign this application.)

If the application proposes a surface water change in point of diversion, a groundwater change in point of diversion greater than 300 feet, or a change in place of use, the application must be signed by all owners of the currently authorized place of use, or their duly authorized agent (attach notarized statement authorizing representation).

I hereby verify, being first duly sworn upon my oath or affirmation and under penalty of perjury, that I am of lawful age and the owner, the spouse of the owner, or a duly authorized agent of the owner(s) to make this application on their behalf, in regard to the water right(s) to which this application pertains. I further verify that the statements contained in this application are true, correct and complete.

Dated at Arkansas City, Kansas, this 25th day of January, 20 18.

<u>Rod Philo</u>	
(Owner)	(Spouse)
<u>Rod Philo</u>	
(Please Print)	(Please Print)
(Owner)	(Spouse)
(Please Print)	(Please Print)
(Owner)	(Spouse)
(Please Print)	(Please Print)

State of Kansas }
 County of Cowley } SS

I hereby certify that the foregoing application was signed in my presence and sworn to before me this 25th day of January, 20 18.



 TERICE L. WATTS
 Notary Public - State of Kansas
 My Comm. Expires 3/12/2020

[Signature]
 Notary Public

My Commission Expires _____

ONLY COMPLETE APPLICATIONS WILL BE PROCESSED. To be complete, all of the applicable portions of the application form must be completed with accurate information; maps, if necessary, must be included; signatures of all the appropriate owners' must be affixed to the application and notarized; and the appropriate fee must be paid.

FEE SCHEDULE

Each application to change the place of use or the point of diversion under this section shall be accompanied by the application fee set forth in the schedule below: Make checks payable to: **Kansas Department of Agriculture**

- (1) Application to change a point of diversion **300 feet or less** \$100
- (2) Application to change a point of diversion **more than 300 feet** \$200
- (3) Application to change the place of use \$200

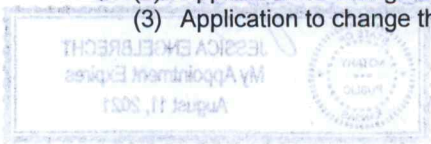

RECEIVED

JAN 30 2018

Stafford Field Office
 Division of Water Resources
 File No. 19084

SUMMARY ORDER APPROVING APPLICATION FOR CHANGE AND IMPOSING CONDITIONS

This Summary Order is issued under authority of K.S.A. 82a-708b, as amended, and K.A.R. 5-14-3 and other applicable provisions of the *Kansas Water Appropriation Law, K.S.A. 82a-701 et. seq.*, and rules and regulations promulgated thereunder, K.A.R. 5-1-1 *et. seq.* With the exception of those conditions expressly contained herein, this Summary Order does not change the terms, conditions and limitations of File No. 10,084.

1. A change application was received on 1/30/2018 requesting that the place of use and / or point of diversion authorized under the above-referenced file number be changed as described in the application.
2. On and after the effective date of this summary order, the authorized place(s) of use shall be located substantially as shown on the topographic map accompanying the application to change the place of use. Applicable Not Applicable
3. The change in point of diversion shall not impair existing rights and shall be limited to the same source or sources of water as previously authorized. The point of diversion authorized by this summary order shall be located within a 50 foot radius of the authorized point(s) of diversion. Applicable Not Applicable
4. The point(s) of diversion authorized herein shall not actually be located more than 120 feet from the previously authorized point(s) of diversion. Applicable Not Applicable
5. As required by K.A.R. 5-3-5d, if the works for diversion is a well with a diversion rate of 100 gallons per minute or more, a tube or other device suitable for making water level measurements shall be installed, operated and maintained in accordance with K.A.R. 5-6-13. Applicable Not Applicable
6. **The owner of the authorized place(s) of use shall properly install an acceptable water flow meter on or before December 31, 2018**, or before the first use of water, whichever occurs first. The water flow meter shall be installed, operated and maintained in accordance with K.A.R. 5-1-4 through 5-1-12. As required by K.S.A. 82a-732, as amended, and K.A.R. 5-3-5e, the owner shall maintain records and report the reading of the water flow meter and the total quantity of water diverted annually to the Chief Engineer by March 1 following the end of each calendar year. Applicable Not Applicable
7. **Installation of the works for diversion of water shall be completed on or before December 31, 2018**, or within any authorized extension of time. By March 1, 2019 the applicant shall notify the Chief Engineer that construction of the works for diversion has been completed, on the form provided by the Chief Engineer, as required by K.A.R. 5-8-4e. Applicable Not Applicable
8. **The completed well log shall be submitted with the required notice.** Applicable Not Applicable
9. All diversion works into which any type of chemical or other foreign substance will be injected into the water shall be equipped with an in-line, automatic, quick-closing check valve capable of preventing pollution of the source of the water supply. The check valve(s) shall be installed, operated and maintained in accordance with K.A.R. 5-3-5c. Applicable Not Applicable
10. Additional Conditions are attached. Yes No
11. In accordance with K.S.A. 82a-708a, as amended, and K.A.R. 5-5-14, all of the owners of the authorized place(s) of use of water appropriated under the above-referenced file number are responsible for compliance with its terms, conditions and limitations, as amended and/or supplemented by this Summary Order, and with applicable provisions of the *Kansas Water Appropriation Law* and the *Rules and Regulations* promulgated thereunder. Failure to comply with these provisions may result in civil penalties pursuant to K.S.A. 82a-737, as amended, and/or the suspension or revocation and dismissal of the water or appropriation right or any other enforcement actions authorized by law.

RECEIVED

Administrative Appeal and Effective Date of Order

You have the right to a hearing in accordance with K.A.R. 5-14-3 before this Summary Order becomes final action of the Kansas Department of Agriculture. Any request for a hearing must be filed with the **Chief Engineer, Division of Water Resources, Kansas Department of Agriculture, 109 SW 9th Street, Topeka, Kansas 66612**, within 15 days after the date shown on the Certificate of Service attached hereto. If a hearing is not requested in accordance with K.A.R. 5-14-3, this Summary Order will become effective on the 15th day after the date shown on the Certificate of Service.

For Use by Register of Deeds

FOR OFFICE USE ONLY
APPLICATION APPROVED AND 30 2018
SUMMARY ORDER ISSUED

By: Cameron R. Couart Stafford Field Office
Division of Water Resources
 Duly Authorized Designee of the Chief Engineer
 (Print Name): Cameron R. Couart
 Division of Water Resources - Kansas Department of Agriculture

Date of Issuance: 2/2/18

State of Kansas)
) SS
 County of Stafford)

Acknowledged before me on 2/2/18
 by Cameron Couart

Signature: Jessica Engelbrecht



My commission expires: _____
 (Notary Seal)

SITE TOPO MAP

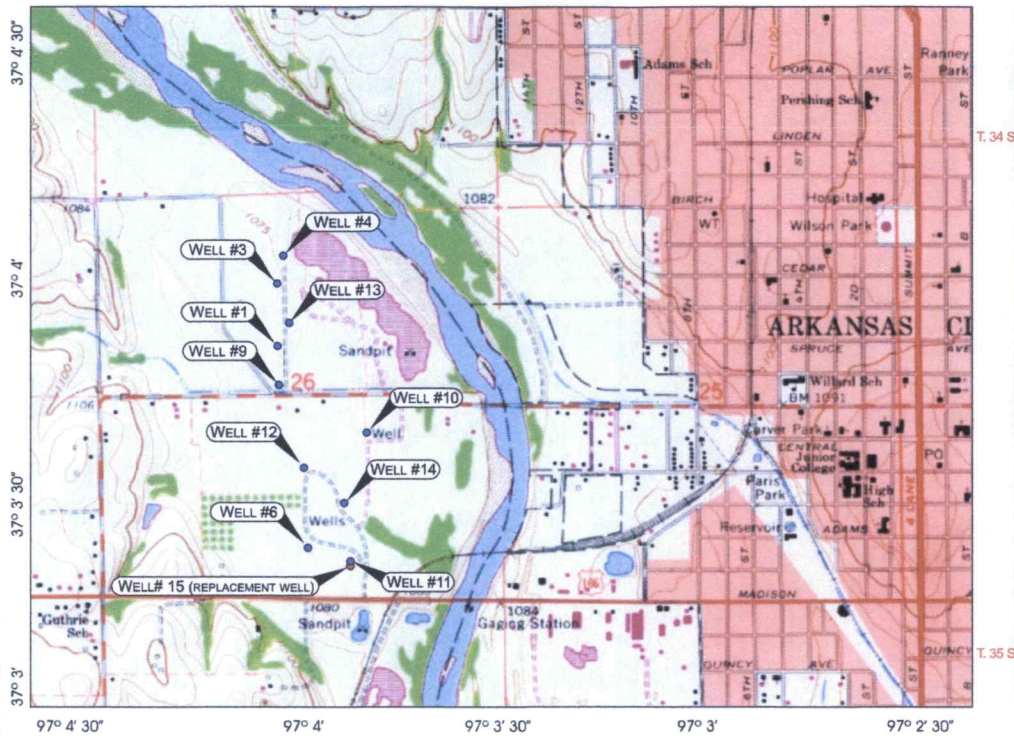

SITE AERIAL MAP



WELL LOCATION: SE 1/4 SW 1/4 SE 1/4 Sec 26, T-34-S, R-3-E, Cowley County, KS

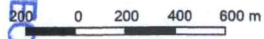

NOTE: Approximate location of New Replacement Well #5 (70' SW)



APPROVAL OF REVISIONS					
REV.	SHEETS	ENGINEER	DATE	USER DEPT.	DATE

SEAL	Carl E. Nuzman, P.E., P.Hg. (Consulting Engineer/Hydrologist)	3314 NW Hickman Road Shawnee, KS 66204-8243 Mobile: (785)224-9923 e-mail: carl@cednuzman.com
	TITLE: SITE LOCATION MAPS	
	DRAWN BY: DAVID LUJAN	DATE: 01/16/18
	CHECKED BY: CARL E. NUZMAN	DATE:
APPROVED BY:	DATE:	DRAWING N ^o CAKS-1
		SHEET 1 OF 2

JAN 30 2018

RECEIVED



Stafford Field Office
300 S. Main Street
Stafford, Kansas 67578-1521

Jackie McClaskey, Secretary
David W. Barfield, Chief Engineer
Jeff Lanterman, Water Commissioner

Phone: 620-234-5311
Fax: 620-234-6900
www.agriculture.ks.gov
Governor Jeff Colyer, M.D.

February 2, 2018

City of Arkansas City
Director of Public Works
118 W Central
Arkansas City KS 67005

Re: Water Right, File No(s). 10084

Dear Water Right Owner:

Enclosed is the order executed by the Chief Engineer, Division of Water Resources, Kansas Department of Agriculture, approving the application for change under the above referenced file number(s).

Your attention is directed to the enclosures and to the terms, conditions and limitations specified in this approval for change. An acceptable water flow meter must be installed on your well before any water is applied as authorized under this change approval. A copy of the approved list of Certified Water Flowmeters as well as the regulations regarding the installation of flowmeters, measurement tubes and check valves can be found at <http://agriculture.ks.gov/divisions-programs/dwr/water-appropriation/water-flowmeters>. If you do not have access to the internet, please contact this office and we will send you a paper copy of the referenced information.

Since this order modifies the original document referred to above, it should be recorded with the Register of Deeds as other instruments affecting real estate.

This order requires that a notice and completion of works form be submitted once the diversion works are completed, including a properly installed flowmeter. This form is available at the referenced website.

Any abandoned well must be plugged in accordance with the requirements of Article 30 of the Rules and Regulations as adopted by the Kansas Department of Health and Environment.

Should you have any questions, please feel free to contact this office. If you wish to refer to a specific file, please reference it when you contact us.

Sincerely,

A handwritten signature in black ink that reads "Jeff Lanterman".

Jeff Lanterman
Water Commissioner

Enclosures
pc: Water Rights Section

CERTIFICATE OF SERVICE

On this **2nd** day of **February, 2018**, I hereby certify that the attached Change in Point of Diversion for Water Right, File No. **10084**, dated **February 2, 2018** was mailed via Certified U.S. mail to the following:

City of Arkansas City
Director of Public Works
118 W Central
Arkansas City KS 67005



Staff