

Submit completed application to:  
 Kansas Department of Agriculture  
 Division of Water Resources  
 Field Office for your area.  
 Call for address:

Topeka -- (785) 296-5733  
 Stafford -- (620) 234-5311  
 Stockton -- (785) 425-6787  
 Garden City -- (620) 276-2901  
<http://agriculture.ks.gov/dwr>

## DWR FIELD OFFICE APPLICATION FOR APPROVAL TO CHANGE THE PLACE OF USE AND/OR THE POINT OF DIVERSION



**STATE OF KANSAS**

**WATER METER REQUIRED**

Filing Fee Must Accompany the Application, K.S.A. 82a-708b(b), as amended.  
 Fee Schedule is on the third page of this application form.

**Paragraph Nos. 1, 2, 3 & 5 must be completed. Complete all other applicable portions.** If change in point of diversion is greater than 100 feet, or if place of use will be changed, include a topographic map or detailed plat showing the authorized and proposed point(s) of diversion and/or place of use.

File No. 13812

RECEIVED  
 10:30am  
 NOV 16 2018

Stafford Field Office  
 DIVISION OF WATER RESOURCES

1. Application is hereby made for approval of the Chief Engineer to change the (check one or both):

Place of Use                       Point of Diversion

under the water right which is the subject of this application in accordance with the conditions described below.

The source of supply is:                       Groundwater                       Surface water

2. Name and address of Applicant: Darrell Wood

1983 260<sup>th</sup> Ave, Lewis KS 67552-5133

Phone Number: (620)546-3429

Email address: dnwfarm@gmail.com

Name and address of Water Use Correspondent: Darrell N & Natalie D Wood Rev Trusts

Darrell-Natalie Wood TTEE, 1983 260<sup>th</sup> Ave, Lewis KS 67552-5133

Phone Number: (620)546-3429

Email address: dnwfarm@gmail.com

3. The presently authorized place of use is:

Owner of Land ---- NAME: Darrell N & Natalie D Wood Rev Trusts, Darrell-Natalie Wood TTEE

ADDRESS: 1983 260th Ave, Lewis KS 67552-5133

(If there is more than one landowner, attach supplemental sheets as necessary.)

Sec.	Twp.	Range	NE¼				NW¼				SW¼				SE¼				TOTAL ACRES
			NE¼	NW¼	SW¼	SE¼	NE¼	NW¼	SW¼	SE¼	NE¼	NW¼	SW¼	SE¼	NE¼	NW¼	SW¼	SE¼	
29	25S	16W					40	40	39.5	40	40	39.5	38.5	38.5					316

4. If this application is for a change in place of use, it is proposed that the place of use be changed to:

Owner of Land ---- NAME: No Change

ADDRESS: ---

(If there is more than one landowner, attach supplemental sheets as necessary.)

Sec.	Twp.	Range	NE¼				NW¼				SW¼				SE¼				TOTAL ACRES
			NE¼	NW¼	SW¼	SE¼	NE¼	NW¼	SW¼	SE¼	NE¼	NW¼	SW¼	SE¼	NE¼	NW¼	SW¼	SE¼	

For Office Use Only: Code \_\_\_\_\_ Fee \$ 200 - TR # \_\_\_\_\_ Receipt Date \_\_\_\_\_ Check # 5411

5. **Presently authorized point of diversion:**  
 One in the \_\_\_\_\_ Quarter of the \_\_\_\_\_ Quarter of the CS NW Quarter  
 of Section 29, Township 25 South, Range 16 W,  
 in Edwards County, Kansas, 2925 feet North 3980 feet West of Southeast corner of section.  
 Authorized Rate 960 GPM Authorized Quantity 152 AF Depth of well 94 (feet)  
**(DWR use only: Computer ID No. 1 GPS --- feet North --- feet West)**  
 This point will not be changed  This point will be changed as follows:  No change, point better described with GPS as follows:  
**Proposed point of diversion: (Complete only if change is requested or if existing point is better described by GPS)**  
 One in the \_\_\_\_\_ Quarter of the \_\_\_\_\_ Quarter of the NC SW Quarter  
 of Section 29, Township 25 South, Range 16 W,  
 in Edwards County, Kansas, 2925 <sup>1383</sup> feet North 3980 <sup>3941</sup> feet West of Southeast corner of section.  
 Proposed Rate No Change Proposed Quantity No Change Proposed well depth (feet) ~155.  
 This point is:  Additional Well  Geo Center List other water rights that will use this point None.

6. **Presently authorized point of diversion:**  
 One in the \_\_\_\_\_ Quarter of the \_\_\_\_\_ Quarter of the \_\_\_\_\_ Quarter  
 of Section \_\_\_\_\_, Township \_\_\_\_\_ South, Range \_\_\_\_\_ (E/W),  
 in \_\_\_\_\_ County, Kansas, \_\_\_\_\_ feet North \_\_\_\_\_ feet West of Southeast corner of section.  
 Authorized Rate \_\_\_\_\_ Authorized Quantity \_\_\_\_\_ Depth of well \_\_\_\_\_ (feet)  
**(DWR use only: Computer ID No. \_\_\_\_\_ GPS \_\_\_\_\_ feet North \_\_\_\_\_ feet West)**  
 This point will not be changed  This point will be changed as follows:  No change, point better described with GPS as follows:  
**Proposed point of diversion: (Complete only if change is requested or if existing point is better described by GPS)**  
 One in the \_\_\_\_\_ Quarter of the \_\_\_\_\_ Quarter of the \_\_\_\_\_ Quarter  
 of Section \_\_\_\_\_, Township \_\_\_\_\_ South, Range \_\_\_\_\_ (E/W),  
 in \_\_\_\_\_ County, Kansas, \_\_\_\_\_ feet North \_\_\_\_\_ feet West of Southeast corner of section.  
 Proposed Rate \_\_\_\_\_ Proposed Quantity \_\_\_\_\_ Proposed well depth (feet) \_\_\_\_\_.  
 This point is:  Additional Well  Geo Center List other water rights that will use this point \_\_\_\_\_.

7. The changes herein are desired for the following reasons?  
 (please be specific) Moving entire point of diversion  
in order to authorize a new well in the SW 1/4 of Sec 29.

8. If a well, is the test hole log attached?  Yes  No

9. The change(s) (was)(will be) completed by?  
ASAP

10. If the point of diversion is a well:  
 (a) What are you going to do with the old well?  
Existing well will still be utilized by File No. 28124 & 20172001  
 (b) When will this be done? NA

11. Groundwater Management District recommendation attached?  Yes  No

12. Assisted by TJS - SFFO

13a. If the proposed point of diversion will be relocated more than 300 feet but within 2,640 feet of the existing point of diversion, attach a topographic map or aerial photograph. For groundwater sources, show all wells (including domestic) within one-half mile of the proposed point of diversion and the names and mailing addresses of the owners. For surface water sources, show the names and addresses of the landowner(s) one-half mile downstream and one-half mile upstream from your property lines

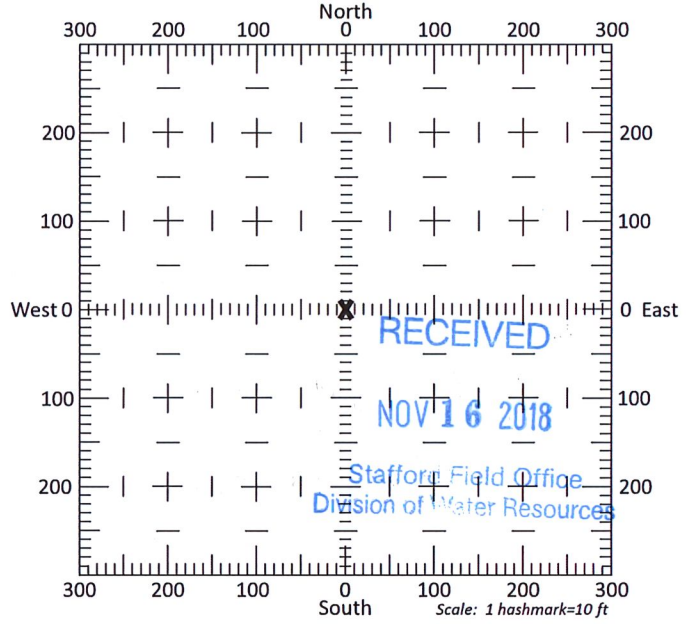

13b. If the proposed point of diversion will be relocated within 300 feet of the existing point of diversion, indicate its location on the diagram shown above in relation to the existing point of diversion. (PLEASE NOTE: The "X" in center of diagram above represents the presently authorized point of diversion.)



14. If the proposed groundwater point of diversion is 300 or fewer feet from the existing point of diversion, complete the following:

- (a) Does the undersigned represent all owners of the currently authorized place(s) of use identified in this application?  
 Yes     No    (If no, all owners must sign this application.)
- (b) Will the ownership interest of any owner of the currently authorized place(s) of use identified in this application be adversely affected if this application is approved as requested?  
 Yes     No    (If yes, all owners must sign this application.)
- (c) If this application is not approved expeditiously, will there be substantial damage to property, public health or safety?  
 Yes     No    (If no, all owners must sign this application.)

If the application proposes a surface water change in point of diversion, a groundwater change in point of diversion greater than 300 feet, or a change in place of use, the application must be signed by all owners of the currently authorized place of use, or their duly authorized agent (attach notarized statement authorizing representation).

I hereby verify, being first duly sworn upon my oath or affirmation and under penalty of perjury, that I am of lawful age and the owner, the spouse of the owner, or a duly authorized agent of the owner(s) to make this application on their behalf, in regards to the water right(s) to which this application pertains. I further verify that the statements contained in this application are true, correct and complete.

Dated at \_\_\_\_\_, Kansas, this \_\_\_\_\_ day of \_\_\_\_\_, 20\_\_\_\_\_.

Danell N. Wood Trustee \_\_\_\_\_ (Spouse)  
 (Owner)

Danell N. Wood Trustee C \_\_\_\_\_ (Please Print)  
 (Please Print)

\_\_\_\_\_  
 (Owner) (Spouse)

\_\_\_\_\_  
 (Please Print) (Please Print)

\_\_\_\_\_  
 (Owner) (Spouse)

\_\_\_\_\_  
 (Please Print) (Please Print)

State of Kansas }  
County of Stafford } SS

I hereby certify that the foregoing application was signed in my presence and sworn to before me this 16<sup>th</sup> day of November, 2018.

My Commission Expires  \_\_\_\_\_  
 \_\_\_\_\_  
 Notary Public

ONLY COMPLETE APPLICATIONS WILL BE PROCESSED. To be complete, all of the applicable portions of the application form must be completed with accurate information; maps, if necessary, must be included; signatures of all the appropriate owners' must be affixed to the application and notarized; and the appropriate fee must be paid.

**FEE SCHEDULE**

Each application to change the place of use or the point of diversion under this section shall be accompanied by the application fee set forth in the schedule below: Make checks payable to: **Kansas Department of Agriculture**

- (1) Application to change a point of diversion 300 feet or less ..... \$100
- (2) Application to change a point of diversion more than 300 feet ..... \$200
- (3) Application to change the place of use ..... \$200

NOV 16 2018

Stafford Field Office  
Division of Water Resources





**ADDITIONAL CONDITIONS TO SUMMARY ORDER APPROVING  
APPLICATION FOR CHANGE AND IMPOSING CONDITIONS**

The effective date of the change shall be the date this order is executed by the Chief Engineer, after which Water Right, File No. 13,812 shall be subject to the following conditions:

- 10a. The approval of this application to change the point of diversion shall be subject to review by the Chief Engineer ten (10) years after the date of approval
- 10b. The static water level at the well authorized herein shall be measured and verified by a representative of the Chief Engineer.
- 10c. That should the static water level measurement decline in excess of ten (10) feet, Water Right, File No. 13,812 shall be considered to have the priority of the date this application for change was filed, for the sole purpose of administering wells concerning direct impairment.

RECEIVED

NOV 16 2018

Stafford Field Office  
Division of Water Resources



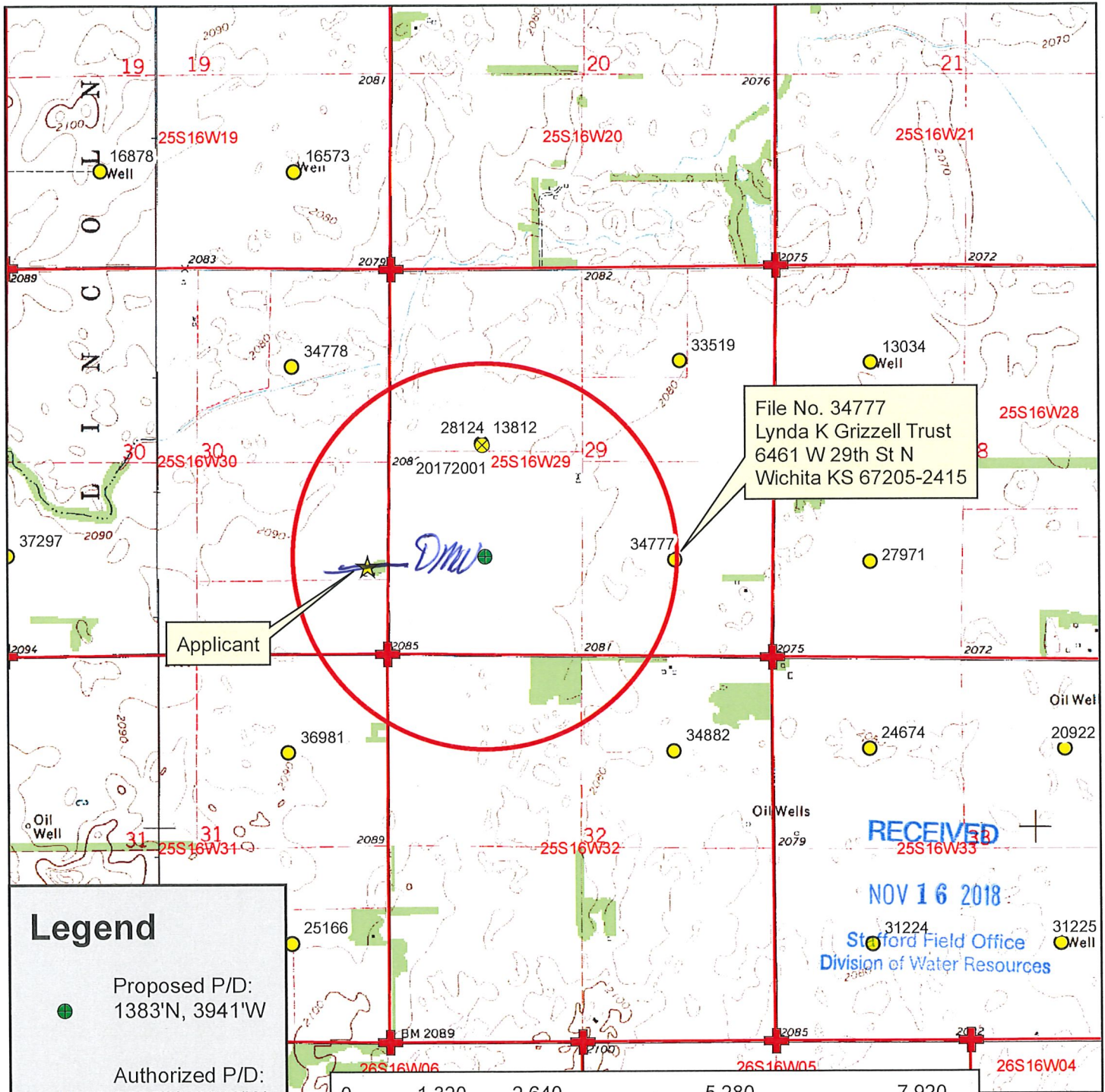

File No. 34777  
 Lynda K Grizzell Trust  
 6461 W 29th St N  
 Wichita KS 67205-2415

Applicant

RECEIVED  
 NOV 16 2018  
 Stanford Field Office  
 Division of Water Resources

**Legend**

- Proposed P/D:  
1383'N, 394'W
- ⊗ Authorized P/D:  
2925'N, 3980'W
- Water Appropriations
- + Section Corner
- Section Line
- ★ Domestic Well
- 1/2 Mile Buffer

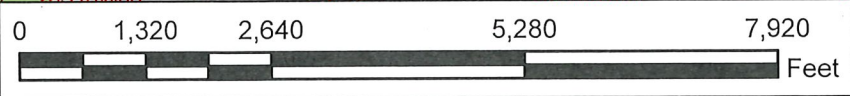

**Water Right, File No. 13812**  
 Change in Point of Diversion, Application Map  
 29-25S-16W // Edwards County



To the best of my knowledge, all water wells including domestic, within 1/2 mile of the proposed point of diversion have been shown.

*David M. Wood*

Signature

11/8/2018 TJS-SFFO 1:24,000 scale