

Kansas Department of Agriculture
 Division of Water Resources
CHANGE: P/D WORKSHEET

| | | | | | | | |
|---|------------------------|---|-------------------------------|--|--|---|--|
| 1. File Number: 2138 A | 2. Status Change Date: | 3. Change Num: 2 | 4. Field Office: 02 | 5. GMD: | | | |
| 6. Status: <input checked="" type="checkbox"/> Approved <input type="checkbox"/> Denied by DWR/GMD <input type="checkbox"/> Dismiss by Request/Failure to Return | | | | 7. Filing Date of Change: 9/24/18 | | | |
| 8a. Applicant(s) New to system <input type="checkbox"/> | | Person ID _____ Add Seq# _____ | | 8c. Landowner(s) New to system <input type="checkbox"/> | | Person ID _____ Add Seq# _____ | |
| 8b. Landowner(s) New to system <input type="checkbox"/> | | Person ID <u>19440</u> Add Seq# <u>1</u> | | 8d. WUC New to system <input type="checkbox"/> | | Person ID <u>19440</u> Add Seq# <u>1</u> | |
| WICHITA AIRPORT AUTHORITY EISENHOWER NAT AIRPORT ENVIRON MNGR 2173 AIR CARGO RD WICHITA KS 67209-1958 | | No Change | | | | | |
| 9. Documents and Enclosure(s): <input checked="" type="checkbox"/> DWR Meter(s) Date to Comply: <u>12/31/18</u> <input checked="" type="checkbox"/> N & P Date to Comply: <u>12/31/2018</u> | | | | | | | |
| <input type="checkbox"/> Anti-Reverse Meter <input type="checkbox"/> Meter Seal <input checked="" type="checkbox"/> Check Valve <input checked="" type="checkbox"/> N & P Form <input type="checkbox"/> Water Tube <input type="checkbox"/> Driller Copy <input type="checkbox"/> H & E Letter <input type="checkbox"/> Conservation Plan Date Required: _____ Date Approved: <u>11/2/18</u> Date to Comply: _____ | | | | | | | |
| 10. Use Made of Water From: _____ To: _____ | | | | | | | |
| | | | | Date Prepared: 10/31/18 By: TJS | | | |
| | | | | Date Entered: _____ By: _____ | | | |

File No. **2138 A** 11. County: **SEDGWICK** Basin: **Arkansas River** Stream: **---** Formation Code: **100 (Quaternary system)** Special Use: **---**

| 12. Points of Diversion | | | | | | | | | | | Rate and Quantity | | | | | | |
|-------------------------|-------|-----|-----|------|-----------|----|-----|----|----|------|-------------------|---------------------------|-------------------|-----------------|-------------------|-----------------|------------------|
| CHK | MOD | DEL | ENT | PDIV | Qualifier | S | T | R | ID | 'N | 'W | Comment (AKA Line) | Rate gpm/cfs | Quantity af/mgy | Rate gpm/cfs | Quantity af/mgy | Overlap PD Files |
| MOD | 81767 | | | | SE NE SE | 33 | 27S | 1W | 4 | 1373 | 282 | Well #1 | 150 GPM, 40 AF | | 150 GPM, 40 AF | | None |
| MOD | 81768 | | | | SE NW SE | 33 | 27S | 1W | 5 | 1817 | 1958 | Well #2 - Additional Well | 150 GPM, 40 AF | | 150 GPM, 40 AF | | None |
| MOD | 81766 | | | | NW SE NE | 33 | 27S | 1W | 3 | 3627 | 1156 | Well #3 - Additional Well | 200 GPM, 38.97 AF | | 200 GPM, 38.97 AF | | None |
| MOD | 81769 | | | | NW SW NW | 34 | 27S | 1W | 11 | 3693 | 4818 | Well #4 - Additional Well | 200 GPM, 38.97 AF | | 200 GPM, 38.97 AF | | None |

13. Storage: Rate _____ NF Quantity _____ ac/ft Additional Rate _____ NF Additional Quantity _____ ac/ft

14. Limitation: _____ af/yr at _____ gpm (_____ cfs) when combined with file number(s) _____
 Limitation: _____ af/yr at _____ gpm (_____ cfs) when combined with file number(s) _____

15. 5YR Allocation: Allocation Type _____ Start Year _____ 5 YR Amount _____ Amount Unit _____ Base Acres _____ Comment _____

| 16. Place of Use | | | | | | | | | | NE¼ | | | | NW¼ | | | | SW¼ | | | | SE¼ | | | | Total | Owner | Chg? | Overlap Files |
|------------------|-------|-----|-----|------|---|---|---|----|--|------|------|------|------|------|------|------|------|------|------|------|------|------|------|------|------|-------|-------|------|---------------|
| CHK | MOD | DEL | ENT | PUSE | S | T | R | ID | | NE ¼ | NW ¼ | SW ¼ | SE ¼ | NE ¼ | NW ¼ | SW ¼ | SE ¼ | NE ¼ | NW ¼ | SW ¼ | SE ¼ | NE ¼ | NW ¼ | SW ¼ | SE ¼ | | | | |
| CHK | 64838 | | | | | | | 3 | | | | | | | | | | | | | | | | | | | 8b. | No | None |
| CHK | 64839 | | | | | | | 3 | | | | | | | | | | | | | | | | | | | 8b. | No | None |
| CHK | 64840 | | | | | | | 4 | | | | | | | | | | | | | | | | | | | 8b. | No | None |
| CHK | 64841 | | | | | | | 8 | | | | | | | | | | | | | | | | | | | 8b. | No | None |

Base Acres: --- Year: --- Minimum Reasonable Quantity: ---

Comments: **Only changing quantities and better describing the footage locations based on GPS data.**

Submit completed application to:
 Kansas Department of Agriculture
 Division of Water Resources
 Field Office for your area.

Call for address:

Topeka -- (785) 296-5733
 Stafford -- (620) 234-5311
 Stockton -- (785) 425-6787
 Garden City -- (620) 276-2901
<http://agriculture.ks.gov/dwr>

DWR FIELD OFFICE APPLICATION FOR APPROVAL TO CHANGE THE PLACE OF USE AND/OR THE POINT OF DIVERSION WATER METER REQUIRED



STATE OF KANSAS

Filing Fee Must Accompany the Application, K.S.A. 82a-708b(b), as amended.
 Fee Schedule is on the third page of this application form.

Paragraph Nos. 1, 2, 3 & 5 must be completed. Complete all other applicable portions. If change in point of diversion is greater than 100 feet, or if place of use will be changed, include a topographic map or detailed plat showing the authorized and proposed point(s) of diversion and/or place of use.

File No. 2138-A

Water Resources
 Received

SEP 24 2018

1:03

KS Dept Of Agriculture

1. Application is hereby made for approval of the Chief Engineer to change the (check one or both):

Place of Use Point of Diversion

under the water right which is the subject of this application in accordance with the conditions described below.

The source of supply is: Groundwater Surface water

2. Name and address of Applicant: Rick Stone

Wichita Airport Authority, Environmental Manager, 2173 Air Cargo Rd, Wichita KS 67209-1958

Phone Number: (316)946-4715

Email address: RLStone@wichita.gov

Name and address of Water Use Correspondent: Wichita Airport Authority, Eisenhower National Airport

Environmental Manager, 2173 Air Cargo Rd, Wichita KS 67209-1958

Phone Number: (316)946-4715

Email address: RLStone@wichita.gov

3. The presently authorized place of use is:

Owner of Land --- NAME: Wichita Airport Authority, Eisenhower National Airport

ADDRESS: Environmental Manager, 2173 Air Cargo Rd, Wichita KS 67209-1958

(If there is more than one landowner, attach supplemental sheets as necessary.)

| Sec. | Twp. | Range | NE¼ | | | | NW¼ | | | | SW¼ | | | | SE¼ | | | | TOTAL ACRES |
|------|------|-------|-----|-----|-----|-----|-----|-----|-----|-----|-----|-----|-----|-----|-----|-----|-----|-----|-------------|
| | | | NE¼ | NW¼ | SW¼ | SE¼ | NE¼ | NW¼ | SW¼ | SE¼ | NE¼ | NW¼ | SW¼ | SE¼ | NE¼ | NW¼ | SW¼ | SE¼ | |
| 27 | 27S | 1W | | | | | | | | | 10 | 10 | 10 | 20 | | | | | 50 |
| 28 | 27S | 1W | | | | | | | | | | | | | 10 | | | 20 | 30 |
| 33 | 27S | 1W | 40 | 10 | 10 | 40 | | | | | | | | | 40 | 40 | 10 | 20 | 210 |
| 34 | 27S | 1W | | | | | 10* | 10 | 10* | | | 10 | | | | | | | 30 |

4. If this application is for a change in place of use, it is proposed that the place of use be changed to:

Owner of Land --- NAME: No Change

ADDRESS: ---

(If there is more than one landowner, attach supplemental sheets as necessary.)

| Sec. | Twp. | Range | NE¼ | | | | NW¼ | | | | SW¼ | | | | SE¼ | | | | TOTAL ACRES |
|------|------|-------|-----|-----|-----|-----|-----|-----|-----|-----|-----|-----|-----|-----|-----|-----|-----|-----|-------------|
| | | | NE¼ | NW¼ | SW¼ | SE¼ | NE¼ | NW¼ | SW¼ | SE¼ | NE¼ | NW¼ | SW¼ | SE¼ | NE¼ | NW¼ | SW¼ | SE¼ | |
| | | | | | | | | | | | | | | | | | | | |

For Office Use Only: Code CGT Fee \$ 200 TR # _____ Receipt Date 9/24/18 Check # 091901

*DS-SFFO

9/24/18

5. **Presently authorized point of diversion:** "Well #1"
 One in the SE Quarter of the NE Quarter of the SE Quarter of Section 33, Township 27 South, Range 1 W, in Sedgwick County, Kansas, 1375 feet North 240 feet West of Southeast corner of section.
 Authorized Rate 150 GPM Authorized Quantity 16 AF Depth of well 115 (feet)
(DWR use only: Computer ID No. 4 GPS 1373 feet North 282 feet West)
 This point will not be changed This point will be changed as follows: No change, point better described with GPS as follows:
Proposed point of diversion: (Complete only if change is requested or if existing point is better described by GPS)
 One in the SE Quarter of the NE Quarter of the SE Quarter of Section 33, Township 27 South, Range 1 W, in Sedgwick County, Kansas, 1373 feet North 282 feet West of Southeast corner of section.
 Proposed Rate No Change Proposed Quantity 40 AF Proposed well depth (feet) NA
 This point is: Additional Well Geo Center List other water rights that will use this point None

6. **Presently authorized point of diversion:** "Well #2"
 One in the SE Quarter of the NW Quarter of the SE Quarter of Section 33, Township 27 South, Range 1 W, in Sedgwick County, Kansas, 1860 feet North 1920 feet West of Southeast corner of section.
 Authorized Rate 150 GPM Authorized Quantity 18.57 AF Depth of well 115' (feet)
(DWR use only: Computer ID No. 5 GPS 1817 feet North 1958 feet West)
 This point will not be changed This point will be changed as follows: No change, point better described with GPS as follows:
Proposed point of diversion: (Complete only if change is requested or if existing point is better described by GPS)
 One in the SE Quarter of the NW Quarter of the SE Quarter of Section 33, Township 27 South, Range 1 W, in Sedgwick County, Kansas, 1817 feet North 1958 feet West of Southeast corner of section.
 Proposed Rate No Change Proposed Quantity 40 AF Proposed well depth (feet) NA
 This point is: Additional Well Geo Center List other water rights that will use this point None

See Supplemental Sheet for Additional PD's

7. The changes herein are desired for the following reasons?
 (please be specific) The change is requested to better re-distribute quantity amongst the four wells. No new wells are proposed by this application. The footage descriptions for each pd have been modified to reflect GPS values.

8. If a well, is the test hole log attached? Yes No

9. The change(s) (was)(will be) completed by?
Upon approval

10. If the point of diversion is a well:
 (a) What are you going to do with the old well?
NA
 (b) When will this be done? NA

11. Groundwater Management District recommendation attached? Yes No

12. Assisted by TJS - SFFO

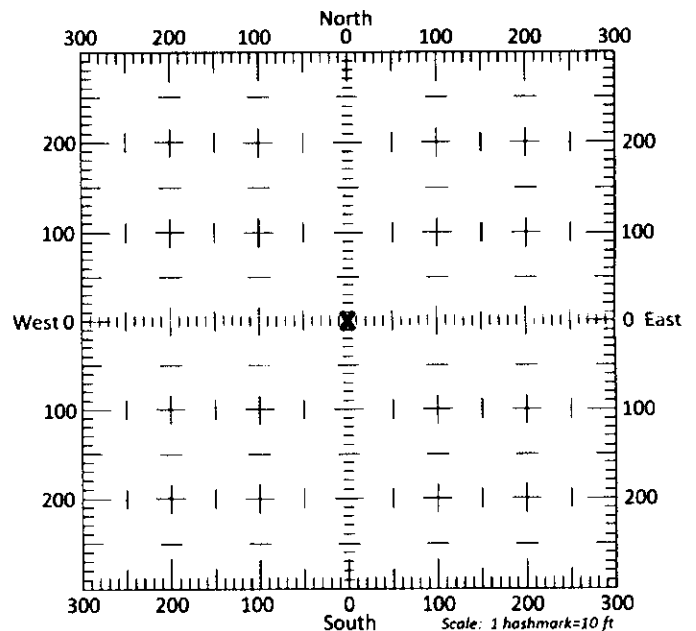

13a. If the proposed point of diversion will be relocated more than 300 feet but within 2,640 feet of the existing point of diversion, attach a topographic map or aerial photograph. For groundwater sources, show all wells (including domestic) within one-half mile of the proposed point of diversion and the names and mailing addresses of the owners. For surface water sources, show the names and addresses of the landowner(s) one-half mile downstream and one-half mile upstream from your property lines

13b. If the proposed point of diversion will be relocated within 300 feet of the existing point of diversion, indicate its location on the diagram shown above in relation to the existing point of diversion. (PLEASE NOTE: The "X" in center of diagram above represents the presently authorized point of diversion)



14. If the proposed groundwater point of diversion is 300 or fewer feet from the existing point of diversion, complete the following:
- (a) Does the undersigned represent all owners of the currently authorized place(s) of use identified in this application?
 Yes No (If no, all owners must sign this application.)
 - (b) Will the ownership interest of any owner of the currently authorized place(s) of use identified in this application be adversely affected if this application is approved as requested?
 Yes No (If yes, all owners must sign this application.)
 - (c) If this application is not approved expeditiously, will there be substantial damage to property, public health or safety?
 Yes No (If no, all owners must sign this application.)

If the application proposes a surface water change in point of diversion, a groundwater change in point of diversion greater than 300 feet, or a change in place of use, the application must be signed by all owners of the currently authorized place of use, or their duly authorized agent (attach notarized statement authorizing representation).

I hereby verify, being first duly sworn upon my oath or affirmation and under penalty of perjury, that I am of lawful age and the owner, the spouse of the owner, or a duly authorized agent of the owner(s) to make this application on their behalf, in regards to the water right(s) to which this application pertains. I further verify that the statements contained in this application are true, correct and complete.

Dated at Wichita, Kansas, this 23 day of AUGUST, 2018.

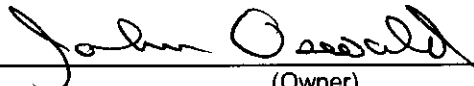
| | |
|---|----------------|
|  | |
| (Owner) | (Spouse) |
| JOHN OSWALD | |
| (Please Print) | (Please Print) |
| | |
| (Owner) | (Spouse) |
| | |
| (Please Print) | (Please Print) |
| | |
| (Owner) | (Spouse) |
| | |
| (Please Print) | (Please Print) |

State of Kansas }
 County of Sedgwick } SS

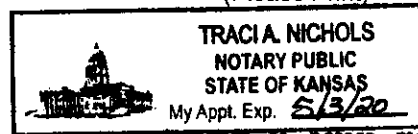

I hereby certify that the foregoing application was signed in my presence and sworn to before me this 23 day of August, 2018.

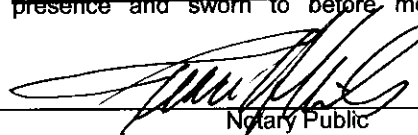
 Notary Public

My Commission Expires May 3, 2020.

ONLY COMPLETE APPLICATIONS WILL BE PROCESSED. To be complete, all of the applicable portions of the application form must be completed with accurate information; maps, if necessary, must be included; signatures of all the appropriate owners' must be affixed to the application and notarized; and the appropriate fee must be paid.

FEE SCHEDULE

Each application to change the place of use or the point of diversion under this section shall be accompanied by the application fee set forth in the schedule below: Make checks payable to: **Kansas Department of Agriculture**

- * (1) Application to change a point of diversion 300 feet or less \$100
- * (2) Application to change a point of diversion more than 300 feet \$200
- (3) Application to change the place of use \$200

Water Resources
 Received

SEP 24 2018

SUMMARY ORDER APPROVING APPLICATION FOR CHANGE AND IMPOSING CONDITIONS

This Summary Order is issued under authority of K.S.A. 82a-708b, as amended, and K.A.R. 5-5-1, *et seq.* and other applicable provisions of the *Kansas Water Appropriation Law, K.S.A. 82a-701 et seq.*, and rules and regulations promulgated thereunder, With the exception of those conditions expressly contained herein, this Summary Order does not change the terms, conditions and limitations of File No. 2138-A.

1. A change application was received on 9/24/2018 requesting that the place of use and / or point of diversion authorized under the above-referenced file number be changed as described in the application.
2. On and after the effective date of this summary order, the authorized place(s) of use shall be located substantially as shown on the topographic map accompanying the application to change the place of use. Applicable Not Applicable
3. The change in point of diversion shall not impair existing rights and shall be limited to the same source or sources of water as previously authorized. The point of diversion authorized by this summary order shall be located within a 300 foot radius of the authorized point(s) of diversion. Applicable Not Applicable
4. The point(s) of diversion described herein is administratively corrected to be more accurately described using the Global Positioning System (GPS), as described in the application. Applicable Not Applicable
5. The point(s) of diversion authorized herein shall not actually be located more than 2640 feet from the previously authorized point(s) of diversion. Applicable Not Applicable
6. As required by K.A.R. 5-3-5d, if the works for diversion is a well with a diversion rate of 100 gallons per minute or more, a tube or other device suitable for making water level measurements shall be installed, operated and maintained in accordance with K.A.R. 5-6-13. Applicable Not Applicable
7. **The owner of the authorized place(s) of use shall properly install an acceptable water flow meter on or before December 31, 2018**, or before the first use of water, whichever occurs first. The water flow meter shall be installed, operated and maintained in accordance with K.A.R. 5-1-4 through 5-1-12. As required by K.S.A. 82a-732, as amended, and K.A.R. 5-3-5e, the owner shall maintain records and report the reading of the water flow meter and the total quantity of water diverted annually to the Chief Engineer by March 1 following the end of each calendar year. Applicable Not Applicable
8. **Installation of the works for diversion of water shall be completed on or before December 31, 2018**, or within any authorized extension of time. By March 1, 2019 the applicant shall notify the Chief Engineer that construction of the works for diversion has been completed, on the form provided by the Chief Engineer, as required by K.A.R. 5-8-4e. Applicable Not Applicable
9. **The completed well log shall be submitted with the required notice.** Applicable Not Applicable
10. All diversion works into which any type of chemical or other foreign substance will be injected into the water shall be equipped with an in-line, automatic, quick-closing check valve capable of preventing pollution of the source of the water supply. The check valve(s) shall be installed, operated and maintained in accordance with K.A.R. 5-3-5c. Applicable Not Applicable
11. Additional Conditions are attached. Yes No
12. In accordance with K.S.A. 82a-708a, as amended, and K.A.R. 5-5-14, all of the owners of the authorized place(s) of use of water appropriated under the above-referenced file number are responsible for compliance with its terms, conditions and limitations, as amended and/or supplemented by this Summary Order, and with applicable provisions of the *Kansas Water Appropriation Law* and the *Rules and Regulations* promulgated thereunder. Failure to comply with these provisions may result in civil penalties pursuant to K.S.A. 82a-737, as amended, and/or the suspension or revocation and dismissal of the water or appropriation right or any other enforcement actions authorized by law.

Administrative Appeal and Effective Date of Order

If you are aggrieved by this order, pursuant to K.S.A. 82a-1901, you may request an evidentiary hearing before the Chief Engineer or request administrative review by the Secretary of Agriculture. A request for hearing by the Chief Engineer must be filed within **15 days** of service of this Order and a request for administrative review by the Secretary must be filed within **30 days** pursuant to K.S.A. 77-531. Any request for administrative review must state a basis for review pursuant to K.S.A. 77-527. File any request with **Kansas Department of Agriculture, Legal Division, 1320 Research Park Drive, Manhattan, KS 66502**. Failure to timely request a hearing or review may preclude review under the Kansas Judicial Review Act.

For Use by Register of Deeds

Water Resources
Received

SEP 24 2018

FOR OFFICE USE ONLY
**APPLICATION APPROVED AND
SUMMARY ORDER ISSUED**

By: Cameron R. Conant
Duly Authorized Designee of the Chief Engineer
(Print Name): Cameron R. Conant
Division of Water Resources - Kansas Department of Agriculture

Date of Issuance: 11/2/18

State of Kansas }
County of Stafford } SS

Acknowledged before me on 11/02/18
by Cameron Conant

Signature: Jessica Engelbrecht

My commission expires SEP 21 2021

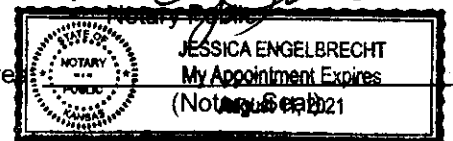

APPLICATION FOR APPROVAL TO CHANGE
THE PLACE OF USE AND/OR POINT OF DIVERSION
SUPPLEMENTAL SHEET
FILE NO. 2138-A

Presently authorized point of diversion: "Well #3"

One in the NW Quarter of the SE Quarter of the NE Quarter
of Section 33, Township 27 South, Range 1 W,
in Sedgwick County, Kansas, 3950 feet North 1000 feet West of Southeast corner of section.
Authorized Rate 200 GPM Authorized Quantity 67.85 AF Depth of well 140 (feet)
(DWR use only: Computer ID No. 3 GPS 3627 feet North 1156 feet West)
 This point will not be changed This point will be changed as follows: No change, point better described with GPS as follows:
Proposed point of diversion: (Complete only if change is requested or if existing point is better described by GPS)
One in the NW Quarter of the SE Quarter of the NE Quarter
of Section 33, Township 27 South, Range 1 W,
in Sedgwick County, Kansas, 3627 feet North 1156 feet West of Southeast corner of section.
Proposed Rate No Change Proposed Quantity 38.97 Proposed well depth (feet) NA
This point is: Additional Well Geo Center List other water rights that will use this point --

Presently authorized point of diversion: "Well #4"

One in the NW Quarter of the SW Quarter of the NW Quarter
of Section ~~33~~ 34^{*}, Township 27 South, Range 1 W,
in Sedgwick County, Kansas, 3790 feet North 4890 feet West of Southeast corner of section.
Authorized Rate 200 GPM Authorized Quantity 55.52 AF Depth of well 120 (feet)
(DWR use only: Computer ID No. 11 GPS 3693 feet North 4818 feet West)
 This point will not be changed This point will be changed as follows: No change, point better described with GPS as follows:
Proposed point of diversion: (Complete only if change is requested or if existing point is better described by GPS)
One in the NW Quarter of the SW Quarter of the NW Quarter
of Section ~~33~~ 34^{*}, Township 27 South, Range 1 W,
in Sedgwick County, Kansas, 3693 feet North 4818 feet West of Southeast corner of section.
Proposed Rate No Change Proposed Quantity 38.97 AF Proposed well depth (feet) NA
This point is: Additional Well Geo Center List other water rights that will use this point --

Presently authorized point of diversion:

One in the _____ Quarter of the _____ Quarter of the _____ Quarter
of Section _____, Township _____ South, Range _____ (EAW),
in _____ County, Kansas, _____ feet North _____ feet West of Southeast corner of section.
Authorized Rate _____ Authorized Quantity _____ Depth of well _____ (feet)
(DWR use only: Computer ID No. _____ GPS _____ feet North _____ feet West)
 This point will not be changed This point will be changed as follows: No change, point better described with GPS as follows:
Proposed point of diversion: (Complete only if change is requested or if existing point is better described by GPS)
One in the _____ Quarter of the _____ Quarter of the _____ Quarter
of Section _____, Township _____ South, Range _____ (EAW),
in _____ County, Kansas, _____ feet North _____ feet West of Southeast corner of section.
Proposed Rate _____ Proposed Quantity _____ Proposed well depth (feet) _____
This point is: Additional Well Geo Center List other water rights that will use this point --

Presently authorized point of diversion:

One in the _____ Quarter of the _____ Quarter of the _____ Quarter
of Section _____, Township _____ South, Range _____ (EAW),
in _____ County, Kansas, _____ feet North _____ feet West of Southeast corner of section.
Authorized Rate _____ Authorized Quantity _____ Depth of well _____ (feet)
(DWR use only: Computer ID No. _____ GPS _____ feet North _____ feet West)
 This point will not be changed This point will be changed as follows: No change, point better described with GPS as follows:
Proposed point of diversion: (Complete only if change is requested or if existing point is better described by GPS)
One in the _____ Quarter of the _____ Quarter of the _____ Quarter
of Section _____, Township _____ South, Range _____ (EAW),
in _____ County, Kansas, _____ feet North _____ feet West of Southeast corner of section.
Proposed Rate _____ Proposed Quantity _____ Proposed well depth (feet) _____
This point is: Additional Well Geo Center List other water rights that will use this point --

Water Resources
Received

Accounting Expenditure Entry - 99 2018 AV844105

Header Standard Detail More Detail Fast Entry

Document Control Data

| Dept | Type | Number | Amount | # Detail Lines | Post Date | Status | Posting Mode |
|------|------|----------|--------|----------------|------------|--------|--------------|
| 99 | AV | AV844105 | 200.00 | 1 | 09/07/2018 | APPR | Online |

Vendor Data

Number / Suffix: 809015 / 025

Name: KANSAS DEPARTMENT OF AGRICULTURE

Address 1: 1320 RESEARCH PARK DRIVE

Address 2:

Address 3:

Address 4:

City / State / Zip: MANHATTAN KS 66502

Payment Control Data

Disbursement Method: Release

Distribution Location: Direct Mail w/ Inserts

Reimbursement Document

Single Payment

Water Resources
Received

SEP 24 2018

KS Dept Of Agriculture

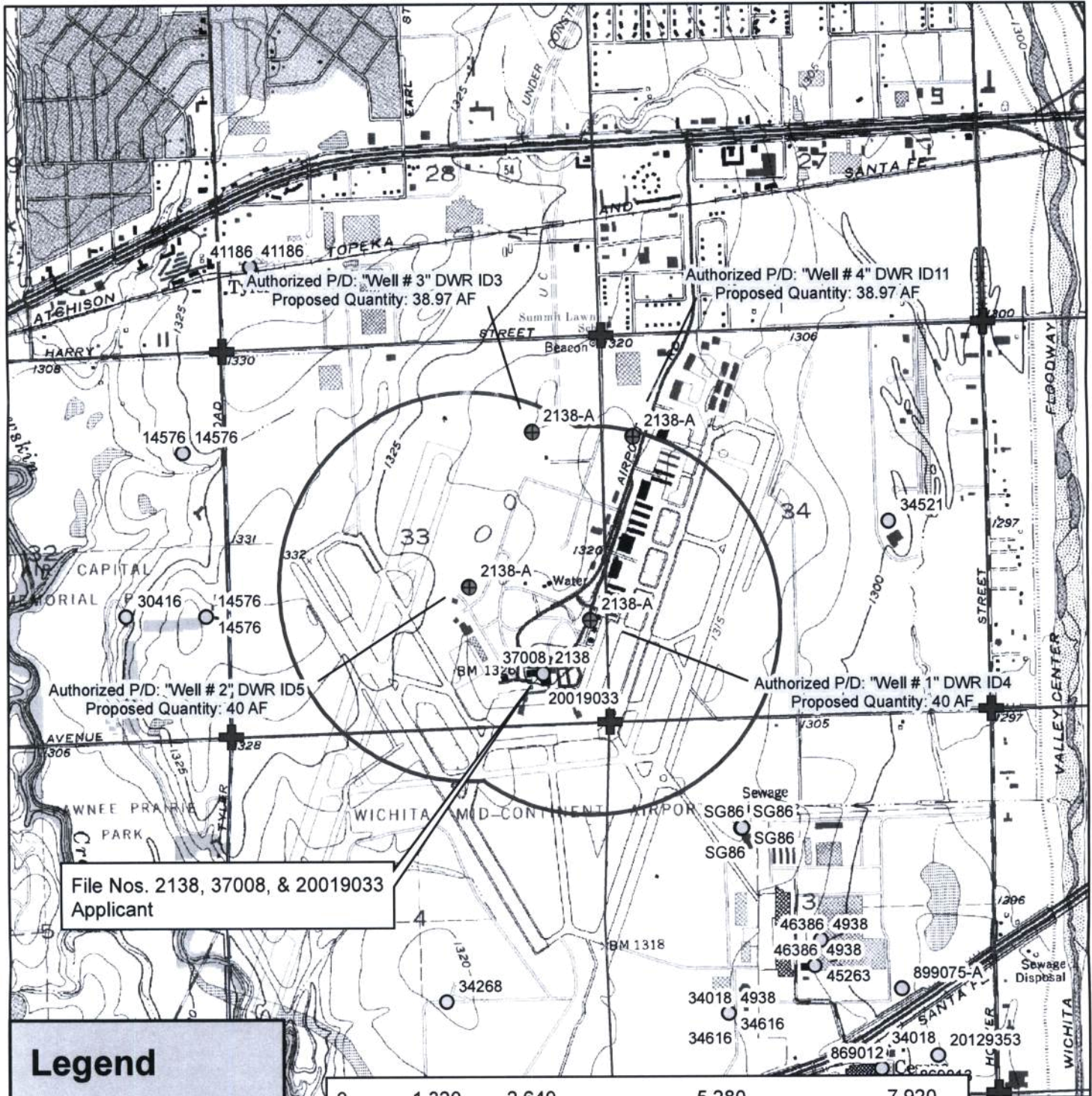

File Nos. 2138, 37008, & 20019033
Applicant

- Legend**
- ⊕ Authorized P/D
 - Water Appropriations
 - ⊕ Section Corner
 - ▭ Section Line
 - ☆ Domestic Well
 - ▭ 1/2 Mile Buffer



Water Right, File No. 2138-A
 Change in Point of Diversion Application Map
 Moving Quantity Only
 33-27S-1W // Sedgwick County

Water Resources
 Received
SEP 24 2018

To the best of my knowledge, all water wells including domestic or agriculture within 1/2 mile of the proposed points of diversion have been shown.



Wichita Airport Authority

August 14, 2018

Tyler Saryerwinnie
Department of Agriculture
Division of Water Resources
Stafford Field Office
300 S Main
Stafford, Kansas 67578-1521

RE: Water Right #2138-A
Point of Diversion Changes
Dwight D. Eisenhower National Airport
Wichita, Kansas

Dear Tyler,

Attached, please find our completed Application For Approval-Point of Diversion Changes- Well #1-Well #4, which I received via email on July 27, 2018. As requested in your letter, please be advised that the Wichita Airport Authority is the rightful owner and of the Terminal Well (industrial application, No. 37008) which has been under term permit (KDHE) for remedial application by Learjet (Bombardier). This well is to be properly abandoned, however, given the upcoming demolition of the abandoned terminal structure. Additionally, it would be noted that this suspension of remedial activity was requested by Learjet and approved by the KDHE-BER group earlier this year. (It is our understanding that the analytical quality of the groundwater will continue to be assessed quarterly through existing monitoring wells located on WAA property).

I have included a map of irrigation wells located on WAA owned property in the vicinity of the requested points of diversion; this map should meet those guidelines regarding groundwater utilization within the 1/2 mile radius of WRB-Appropriation Well-#1 through Well #4:

- The WRB-Appropriation wells are labelled
- WAA has jurisdiction of (2) 5-inch irrigation wells; WWC-5 on record
- Tenant jurisdiction of (8) 5-inch irrigation wells; WWC-5 on record

Water Resources
Received

SEP 24 2018

2173 Air Cargo Road • Wichita, Kansas 67209-1958

T 316.946.4700 F 316.946.4793

www.flywichita.com

KS Dept Of Agriculture
SCANNED

If you have any questions or desire additional information, please contact me at your earliest convenience.

Sincerely,

A handwritten signature in black ink, appearing to read 'Rick Stone', with a long horizontal flourish extending to the right.

Rick Stone, PG
Environmental Services Manager
Wichita Airport Authority

Enclosures (1)
CC: Digital File

Water Resources
Received

SEP 24 2018

KS Dept Of Agriculture

SCANNED

LEGEND

- DOMESTIC WELL
- ◻ PERMITTED WELL

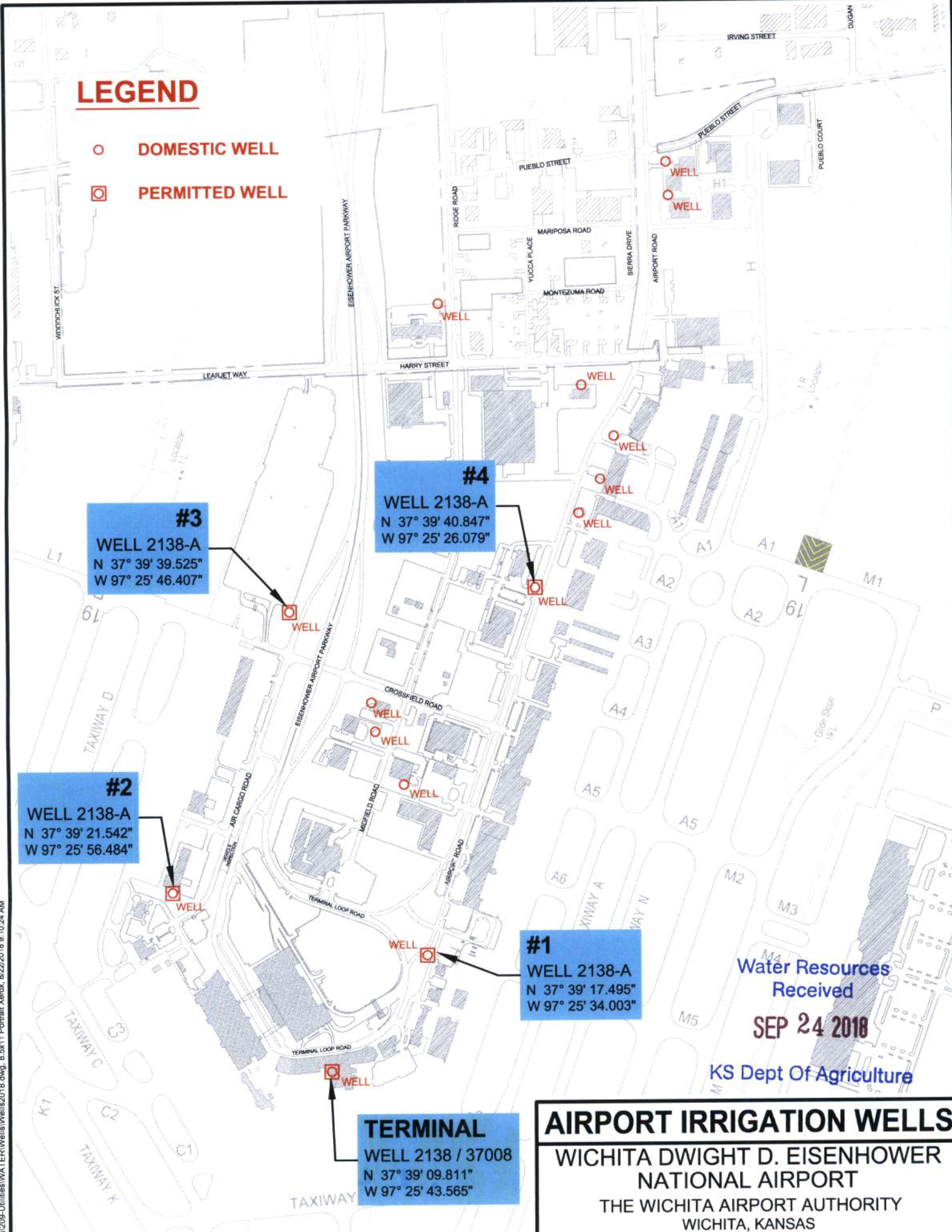

#3
WELL 2138-A
 N 37° 39' 39.525"
 W 97° 25' 46.407"

#4
WELL 2138-A
 N 37° 39' 40.847"
 W 97° 25' 26.079"

#2
WELL 2138-A
 N 37° 39' 21.542"
 W 97° 25' 56.484"

#1
WELL 2138-A
 N 37° 39' 17.495"
 W 97° 25' 34.003"

TERMINAL
WELL 2138 / 37008
 N 37° 39' 09.811"
 W 97° 25' 43.565"

Water Resources
 Received
SEP 24 2018
 KS Dept Of Agriculture

AIRPORT IRRIGATION WELLS

WICHITA DWIGHT D. EISENHOWER NATIONAL AIRPORT
 THE WICHITA AIRPORT AUTHORITY
 WICHITA, KANSAS

| DATE | DR. BY | SCALE | SHEET |
|---------|--------|-----------|--------|
| 8/22/18 | H.G.O. | 1" = 800' | 1 of 1 |

STATE OF KANSAS

DEPARTMENT OF AGRICULTURE
DIVISION OF WATER RESOURCES
STAFFORD FIELD OFFICE
300 S. MAIN STREET
STAFFORD, KS 67578-1521



PHONE: (620) 234-5311
FAX: (620) 234-6900
www.agriculture.ks.gov

GOVERNOR JEFF COLYER, M.D.
JACKIE McCLASKEY, SECRETARY OF AGRICULTURE

November 2, 2018

Rick Stone
Wichita Airport Authority, Environmental Manager
2173 Air Cargo Rd
Wichita KS 67209-1958

Re: Water Right, File No(s). 2138-A

Dear Water Right Owner:

Enclosed is the order executed by the Chief Engineer, Division of Water Resources, Kansas Department of Agriculture, approving the application for change under the above referenced file number(s).

Your attention is directed to the enclosures and to the terms, conditions and limitations specified in this approval for change. An acceptable water flow meter must be installed on your well before any water is applied as authorized under this change approval. A copy of the approved list of Certified Water Flowmeters as well as the regulations regarding the installation of flowmeters, measurement tubes and check valves can be found at <http://agriculture.ks.gov/divisions-programs/dwr/water-appropriation/water-flowmeters>. If you do not have access to the internet, please contact this office and we will send you a paper copy of the referenced information.

Since this order modifies the original document referred to above, it should be recorded with the Register of Deeds as other instruments affecting real estate.

This order requires that a notice and completion of works form be submitted once the diversion works are completed, including a properly installed flowmeter. This form is available at the referenced website.

Any abandoned well must be plugged in accordance with the requirements of Article 30 of the Rules and Regulations as adopted by the Kansas Department of Health and Environment.

Should you have any questions, please feel free to contact this office. If you wish to refer to a specific file, please reference it when you contact us.

Sincerely,

A handwritten signature in black ink, appearing to read "Jeff Lanterman".

Jeff Lanterman
Water Commissioner

Enclosures
pc: Water Rights Section

CERTIFICATE OF SERVICE

On this **2nd** day of **November, 2018**, I hereby certify that the attached Change in Point of Diversion for Water Right, File No. **2138-A**, dated **November 02, 2018** was mailed via Certified U.S. mail to the following:

Rick Stone
Wichita Airport Authority, Environmental Manager
2173 Air Cargo Rd
Wichita KS 67209-1958

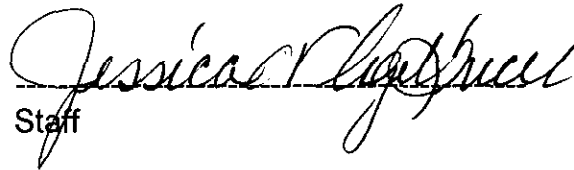
Staff