



File No. **49,648**      15. Formation Code: **100**      Drainage Basin: **Medicine Lodge River**      County: **BA**      Special Use:      Stream:

| 16. Points of Diversion |     |     |      |                     |           |            |            |          |             |            |
|-------------------------|-----|-----|------|---------------------|-----------|------------|------------|----------|-------------|------------|
| T                       | MOD | DEL | PDIV | Qualifier           | S         | T          | R          | ID       | 'N          | 'W         |
| ENT                     |     |     |      |                     |           |            |            |          |             |            |
| √                       |     |     |      | <b>79553 NCNENE</b> | <b>36</b> | <b>31S</b> | <b>13W</b> | <b>1</b> | <b>4620</b> | <b>660</b> |
|                         |     |     |      |                     |           |            |            |          |             |            |
|                         |     |     |      |                     |           |            |            |          |             |            |
|                         |     |     |      |                     |           |            |            |          |             |            |
|                         |     |     |      |                     |           |            |            |          |             |            |

| 17. Rate and Quantity |             |             |             |                  |
|-----------------------|-------------|-------------|-------------|------------------|
| Authorized            |             | Additional  |             |                  |
| Rate gpm              | Quantity af | Rate gpm    | Quantity af | Overlap PD Files |
| <b>1000</b>           | <b>82.6</b> | <b>1000</b> | <b>82.6</b> | <b>None</b>      |
|                       |             |             |             |                  |
|                       |             |             |             |                  |
|                       |             |             |             |                  |
|                       |             |             |             |                  |

18. Storage: Rate \_\_\_\_\_ NF      Quantity \_\_\_\_\_ ac/ft      Additional Rate \_\_\_\_\_ NF      Additional Quantity \_\_\_\_\_ ac/ft

19. Limitation: \_\_\_\_\_ af/yr at \_\_\_\_\_ gpm ( \_\_\_\_\_ cfs) when combined with file number(s) \_\_\_\_\_  
 Limitation: \_\_\_\_\_ af/yr at \_\_\_\_\_ gpm ( \_\_\_\_\_ cfs) when combined with file number(s) \_\_\_\_\_

20. Meter Required?  Yes  No      To be installed by **12/31/2019**      Date Acceptable Meter Installed \_\_\_\_\_

| 21. Place of Use |     |     |      |              |           |            |            |          |          | NE¼       |           |          |      | NW¼  |      |      |      | SW¼  |      |      |      | SE¼  |      |           |            | Total | Owner       | Chg? NO | Overlap Files |
|------------------|-----|-----|------|--------------|-----------|------------|------------|----------|----------|-----------|-----------|----------|------|------|------|------|------|------|------|------|------|------|------|-----------|------------|-------|-------------|---------|---------------|
| T                | MOD | DEL | PUSE | S            | T         | R          | ID         | NE ¼     | NW ¼     | SW ¼      | SE ¼      | NE ¼     | NW ¼ | SW ¼ | SE ¼ | NE ¼ | NW ¼ | SW ¼ | SE ¼ | NE ¼ | NW ¼ | SW ¼ | SE ¼ |           |            |       |             |         |               |
| ENT              |     |     |      |              |           |            |            |          |          |           |           |          |      |      |      |      |      |      |      |      |      |      |      |           |            |       |             |         |               |
| √                |     |     |      | <b>68236</b> | <b>36</b> | <b>31S</b> | <b>13W</b> | <b>2</b> | <b>4</b> | <b>33</b> | <b>21</b> | <b>1</b> |      |      |      |      |      |      |      |      |      |      |      | <b>59</b> | <b>7b.</b> |       | <b>None</b> |         |               |
|                  |     |     |      |              |           |            |            |          |          |           |           |          |      |      |      |      |      |      |      |      |      |      |      |           |            |       |             |         |               |
|                  |     |     |      |              |           |            |            |          |          |           |           |          |      |      |      |      |      |      |      |      |      |      |      |           |            |       |             |         |               |
|                  |     |     |      |              |           |            |            |          |          |           |           |          |      |      |      |      |      |      |      |      |      |      |      |           |            |       |             |         |               |
|                  |     |     |      |              |           |            |            |          |          |           |           |          |      |      |      |      |      |      |      |      |      |      |      |           |            |       |             |         |               |

Comments:

**KANSAS DEPARTMENT OF AGRICULTURE**  
**Division of Water Resources**

**M E M O R A N D U M**

**TO:** Files

**DATE:** June 29, 2018

**FROM:** Matt Meier

**RE:** Application, File No. 49,778

Roger Simpson has filed the referenced application to appropriate groundwater for irrigation use, requesting one (1) well, a quantity of 82.6 acre-feet, and a diversion rate of 1,000 gallons per minute. The proposed well is to be located Near the Center of the Northeast Quarter of the Northeast Quarter (NC NE $\frac{1}{4}$  NE $\frac{1}{4}$ ) of Section 36, more particularly described as being near a point 4,620 feet North and 660 feet West of the Southeast corner of said section, Township 31 South, Range 13 West, Barber County, in the Medicine Lodge River drainage basin within the boundaries of South-Central Kansas Designated Unit Area- MED15. There are currently no overlapping water rights on the proposed place of use or point of diversion. The well is an existing well which had previously been used for industrial use covered by term permit 20129323, which expired 5/1/2017. The proposed place of use is owned by the applicant. The applicant has signed the application form stating that he has legal access to the point of diversion.

The applicant identified that there are zero domestic wells within one-half mile of the proposed well and no existing non-domestic wells (which Wris confirmed). Nearby notification letters were therefore not sent out. Based off WRIS, the nearest non-domestic well (Water Right # 30,719) is located 3,104 feet away. There are no domestic wells within 2,640 feet. The proposed point of diversion meets minimum well spacing to all existing wells. Per the requirements in K.A.R. 5-4-4 for all other aquifers, the minimum well spacing should be one-quarter mile to all other non-domestic wells and 660 feet to domestic wells.

A well log was obtained from the KGS website and shows topsoil from 0 to 2 feet, red clay from 2 to 4 feet, sand from 4 to 19 feet, brown mud from 19 to 25 feet, med gavel with cobbles from 25 to 33 feet, brown mud from 33 to 40 feet, sand streaks with brown mud from 40 to 59 feet, and red shale from 59 to 62 feet below ground. Static water level was 7 feet below ground surface which provides a saturated thickness of 52 feet.

The point of diversion is located within South Central Kansas Designated Unit Area Med15 which is currently open to new appropriations. Per the requirements in K.A.R. 5-3-11, safe yield is determined by the extent of the unconfined aquifer within a two-mile circle radius of the point of diversion, which establishes the area of consideration. Evaluation of the area of consideration included the extent of the unconfined aquifer, which provided an area of consideration of 4,689 acres (Areas on the North and South side of the 2-mile circle were excluded as well logs in the areas showed shallow shale formations with the static water level located in them). With a potential annual recharge of 1.5 inches, and 50% of recharge available for appropriation, safe yield was determined to be 293.09 acre-feet. Existing water rights have appropriated 112 acre-feet, providing a difference of 181.09 acre-feet available for appropriation, and the application requesting 82.6 acre-feet complies with safe yield.

The requested quantity of water, 82.6 acre-feet, is reasonable to irrigate the proposed 59 acres identified in the application. This is the maximum reasonable quantity allowable of 1.4 acre-feet per acre for Barber County, Kansas. There are multiple pending applications in this general area of the state, and they are being worked in priority order to ensure that senior applications are provided the available water.

In accordance with K.S.A. 82a-706c, the Chief Engineer retains full authority to require any water user to install meters, gages, or other measuring devices, which devices he or she or his or her agents may read at any time. Water flowmeter requirements are further described in K.A.R. 5-1-4 through K.A.R. 5-1-12. If any chemical or foreign substance is injected into the water pumped under this permit, a check valve will also need to be installed. A water level measurement tube is required because this is a proposed new well exceeding 100 gpm.

The proposed application is subject to minimum desirable streamflow requirements. The applicant signed, notarized, and returned the required form to our office.

Jeff Lanterman, Water Commissioner, Stafford Field Office, recommended approval of the referenced application on June 25, 2018. Based on the above discussion, well spacing and safe yield criteria are met, and approval of the application will not impair senior water rights nor prejudicially or unreasonably affect the public interest, it is recommended that the referenced application be approved.

Matt Meier  
Environmental Scientist  
Permits Unit

# STATE OF KANSAS

DEPARTMENT OF AGRICULTURE  
1320 RESEARCH PARK DRIVE  
MANHATTAN, KS 66502  
PHONE: (785) 564-6700  
FAX: (785) 564-6777



900 SW JACKSON, ROOM 456  
TOPEKA, KS 66612  
PHONE: (785) 296-3556  
www.agriculture.ks.gov

GOVERNOR JEFF COLYER, M.D.  
JACKIE McCLASKEY, SECRETARY OF AGRICULTURE

**FILE COPY**

July 30, 2018

ROGER L SIMPSON  
5132 NW REUTLINGER  
MEDICINE LODGE KS 67104

RE: Application, File No. 49,778

Dear Water User:

There is enclosed a permit to appropriate water authorizing you to proceed with construction of the proposed diversion works (except those dams and stream obstructions regulated by K.S.A. 82a-301 through 305a), to divert such unappropriated water as may be available from the source and at the location specified in the permit, and to use it for the purpose and at the location described in the permit.

Your attention is directed to the enclosures and to the terms, conditions, and limitations specified in this permit. A water meter is required and you must install it prior to water being put to beneficial use in order for you to maintain accurate records of water use. The meter should be used to provide the information required on the annual water use report.

Failure to notify the Chief Engineer of the Division of Water Resources of the completion of the diversion works within the time allowed, or within any authorized extension of time thereof, will result in the dismissal of this permit. Enclosed is a form which may be used to notify the Chief Engineer that the proposed diversion works have been completed.

All requests for extensions of time to complete diversion works, or to perfect appropriations, must be submitted to the Chief Engineer before the expiration of time originally set forth in the permit to complete diversion works or to perfect an appropriation. If for any reason, you require an extension of time, you must request it before the expiration of time set forth in this permit. Failure to comply with this regulation will result in the dismissal of your permit or your water right. Any request for an extension of time shall be accompanied by the required statutory fee, which is currently \$100.00.

There is also enclosed an information sheet setting forth the procedure to obtain a Certificate of Appropriation which will establish the extent of your water right. If you have any questions, please contact our office. If you wish to discuss this specific file, please have the file number ready so that we may help you more efficiently.

Sincerely,

Kristen A. Baum  
New Application Unit Supervisor  
Water Appropriation Program

Enclosures

pc: Stafford Field Office



**KANSAS DEPARTMENT OF AGRICULTURE**  
Jackie McClaskey, Secretary of Agriculture

**DIVISION OF WATER RESOURCES**  
David W. Barfield, Chief Engineer

**APPROVAL OF APPLICATION  
and  
PERMIT TO PROCEED**  
(This Is Not a Certificate of Appropriation)

This is to certify that I have examined Application, **File No. 49,778** of the applicant

**ROGER L SIMPSON  
5132 NW REUTLINGER  
MEDICINE LODGE KS 67104**

for a permit to appropriate water for beneficial use, together with the maps, plans and other submitted data, and that the application is hereby approved and the applicant is hereby authorized, subject to vested rights and prior appropriations, to proceed with the construction of the proposed diversion works (except those dams and stream obstructions regulated by K.S.A. 82a-301 through 305a, as amended), and to proceed with all steps necessary for the application of the water to the approved and proposed beneficial use and otherwise perfect the proposed appropriation subject to the following terms, conditions and limitations:

- That the priority date assigned to such application is **February 21, 2017**.
- That the water sought to be appropriated shall be used for irrigation use on land described in the application, as follows:

| Sec. Twp. Range | NE¼ |     |     |     | NW¼ |     |     |     | SW¼ |     |     |     | SE¼ |     |     |     | TOTAL |
|-----------------|-----|-----|-----|-----|-----|-----|-----|-----|-----|-----|-----|-----|-----|-----|-----|-----|-------|
|                 | NE¼ | NW¼ | SW¼ | SE¼ | NE¼ | NW¼ | SW¼ | SE¼ | NE¼ | NW¼ | SW¼ | SE¼ | NE¼ | NW¼ | SW¼ | SE¼ |       |
| 36 31S 13W      | 4   | 33  | 21  | 1   |     |     |     |     |     |     |     |     |     |     |     |     | 59    |

- That the authorized source from which the appropriation shall be made is groundwater, to be withdrawn by means of one (1) well, which is to be located near the center of the Northeast Quarter of the Northeast Quarter (NE¼ NE¼) of Section 36, more particularly described as being near a point 4,620 feet North and 660 feet West of the Southeast corner of said section, in Township 31 South, Range 13 West, Barber County, located substantially as shown on the map accompanying the application.
- That the appropriation sought shall be limited to a maximum diversion rate not in excess of **1,000 gallons per minute (2.228 c.f.s.)** and to a quantity not to exceed **82.6 acre-feet** of water for any calendar year.
- That installation of works for diversion of water shall be completed on or before **December 31, 2019** or within any authorized extension thereof. The applicant shall notify the Chief Engineer and pay the statutorily required field inspection fee of \$400.00 when construction of the works has been completed. Failure to timely submit the notice and the fee will result in revocation of the permit. Any request for an extension of time shall be submitted prior to the expiration of the deadline and shall be accompanied by the required statutory fee of \$100.00.
- That the proposed appropriation shall be perfected by the actual application of water to the proposed beneficial use on or before **December 31, 2023** or any authorized extension thereof. Any request for an extension of time shall be submitted prior to the expiration of the deadline and shall be accompanied by the required statutory fee of \$100.00.

7. That the applicant shall not be deemed to have acquired a water appropriation for a quantity in excess of the amount approved herein nor in excess of the amount found by the Chief Engineer to have been actually used for the approved purpose during one calendar year subsequent to approval of the application and within the time specified for perfection or any authorized extension thereof.

8. That the use of water herein authorized shall not be made so as to impair any use under existing water rights nor prejudicially and unreasonably affect the public interest.

9. That the right of the appropriator shall relate to a specific quantity of water and such right must allow for a reasonable raising or lowering of the static water level and for the reasonable increase or decrease of the streamflow at the appropriator's point of diversion.

10. That this permit does not constitute authority under K.S.A. 82a-301 through 305a to construct any dam or other obstruction; nor does it grant any right-of-way, or authorize entry upon or injury to, public or private property.

11. That all diversion works constructed under the authority of this permit into which any type of chemical or other foreign substance will be injected into the water pumped from the diversion works shall be equipped with an in-line, automatic quick-closing, check valve capable of preventing pollution of the source of the water supply. The type of valve installed shall meet specifications adopted by the Chief Engineer and shall be maintained in an operating condition satisfactory to the Chief Engineer.

12. That an acceptable water flow meter shall be installed and maintained on the diversion works authorized by this permit in accordance with Kansas Administrative Regulations 5-1-4 through 5-1-12 adopted by the Chief Engineer. This water flow meter shall be used to provide an accurate quantity of water diverted as required for the annual water use report (including the meter reading at the beginning and end of the report year).

13. That all wells with a diversion rate of 100 gallons per minute or more drilled under the authority of this permit shall have a tube or other device installed in a manner acceptable to, and in accordance with specifications adopted by, the Chief Engineer. This tube or device shall be suitable for making water level measurements and shall be maintained in a condition satisfactory to the Chief Engineer.

14. That the applicant shall maintain accurate and complete records from which the quantity of water diverted during each calendar year may be readily determined and the applicant shall file an annual water use report with the Chief Engineer by March 1 following the end of each calendar year. Failure to file the annual water use report by the due date shall cause the applicant to be subject to a civil penalty.

15. That no water user shall engage in nor allow the waste of any water diverted under the authority of this permit.

16. That failure without cause to comply with provisions of the permit and its terms, conditions and limitations will result in the forfeiture of the priority date, revocation of the permit and dismissal of the application.

17. That the right to appropriate water under authority of this permit is subject to any minimum desirable streamflow requirements identified and established pursuant to K.S.A. 82a-703c for the source of supply to which this water right applies.





### CERTIFICATE OF SERVICE

On this 30<sup>th</sup> day of July, 2018, I hereby certify that the foregoing Approval of Application and Permit to Proceed, File No. 49,778, dated July 26<sup>th</sup>, 2018 was mailed postage prepaid, first class, US mail to the following:

ROGER L SIMPSON  
5132 NW REUTLINGER  
MEDICINE LODGE KS 67104

With photocopies to:

Stafford Field Office

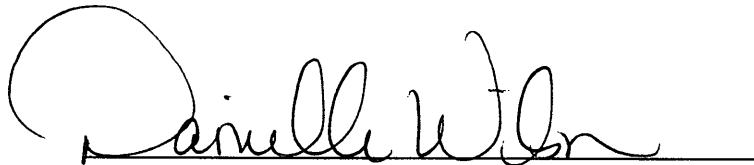
A handwritten signature in black ink, appearing to read "Danielle Wilson", written over a horizontal line.

Division of Water Resources

THE STATE OF KANSAS



6-25-18 KAB  
APPLICATION COMPLETE  
2-21-17  
Reviewer KM

KANSAS DEPARTMENT OF AGRICULTURE  
Jackie McClaskey, Secretary of Agriculture

DIVISION OF WATER RESOURCES  
David W. Barfield, Chief Engineer

File Number 49,778  
This item to be completed by the Division of Water Resources.

WATER RESOURCES  
RECEIVED

APPLICATION FOR PERMIT TO  
APPROPRIATE WATER FOR BENEFICIAL USE  
Filing Fee Must Accompany the Application  
(Please refer to Fee Schedule attached to this application form.)

FEB 21 2017  
1:50  
KS DEPT OF AGRICULTURE

To the Chief Engineer of the Division of Water Resources, Kansas Department of Agriculture,  
1320 Research Park Drive, Manhattan, KS 66502:

1. Name of Applicant (Please Print): Roger Simpson  
Address: 5132 NW Reutlinger  
City: Medicine Lodge State KS Zip Code 67104  
Telephone Number: (620) 886-5346

2. The source of water is:  surface water in \_\_\_\_\_ (stream)  
OR  groundwater in Medicine Lodge River (S.C. KS DUA- Med15) (drainage basin)

Certain streams in Kansas have minimum target flows established by law or may be subject to administration when water is released from storage for use by water assurance district members. If your application is subject to these regulations on the date we receive your application, you will be sent the appropriate form to complete and return to the Division of Water Resources.

3. The maximum quantity of water desired is 82.6 acre-feet OR \_\_\_\_\_ gallons per calendar year, to be diverted at a maximum rate of 1,000 gallons per minute OR \_\_\_\_\_ cubic feet per second.

Once your application has been assigned a priority, the requested maximum rate of diversion and maximum requested quantity of water under that priority number can **NOT** be increased. Please be certain your requested maximum rate of diversion and maximum quantity of water are appropriate and reasonable for your proposed project and are in agreement with the Division of Water Resources' requirements.

4. The water is intended to be appropriated for (Check use intended):  
(a)  Artificial Recharge (b)  Irrigation (c)  Recreational (d)  Water Power  
(e)  Industrial (f)  Municipal (g)  Stockwatering (h)  Sediment Control  
(i)  Domestic (j)  Dewatering (k)  Hydraulic Dredging (l)  Fire Protection  
(m)  Thermal Exchange (n)  Contamination Remediation

YOU **MUST** COMPLETE AND ATTACH ADDITIONAL DIVISION OF WATER RESOURCES FORM(S) PROVIDING INFORMATION TO SUBSTANTIATE YOUR REQUEST FOR THE AMOUNT OF WATER FOR THE INTENDED USE REFERENCED ABOVE.

For Office Use Only:

F.O. 2 GMD - Meets K.A.R. 5-3-1 (YES / NO) Use IRR Source  S County BA By AM Date 2-21-17  
Code REG Fee \$ 200 TR # \_\_\_\_\_ Receipt Date 2-21-17 Check # 3226

5. The location of the proposed wells, pump sites or other works for diversion of water is:

**Note:** For the application to be accepted, the point of diversion location must be described to at least a 10 acre tract, unless you specifically request a 60 day period of time in which to locate the site within a specifically described, minimal legal quarter section of land.

(A) One in the \_\_\_\_ quarter of the NC NE quarter of the NE quarter of Section 36, more particularly described as being near a point 4,620 feet North and 660 feet West of the Southeast corner of said section, in Township 31 South, Range 13 West, Barber County, Kansas.

(B) One in the \_\_\_\_ quarter of the \_\_\_\_ quarter of the \_\_\_\_ quarter of Section \_\_\_\_, more particularly described as being near a point \_\_\_\_ feet North and \_\_\_\_ feet West of the Southeast corner of said section, in Township \_\_\_\_ South, Range \_\_\_\_ East/West (circle one), \_\_\_\_ County, Kansas.

(C) One in the \_\_\_\_ quarter of the \_\_\_\_ quarter of the \_\_\_\_ quarter of Section \_\_\_\_, more particularly described as being near a point \_\_\_\_ feet North and \_\_\_\_ feet West of the Southeast corner of said section, in Township \_\_\_\_ South, Range \_\_\_\_ East/West (circle one), \_\_\_\_ County, Kansas.

(D) One in the \_\_\_\_ quarter of the \_\_\_\_ quarter of the \_\_\_\_ quarter of Section \_\_\_\_, more particularly described as being near a point \_\_\_\_ feet North and \_\_\_\_ feet West of the Southeast corner of said section, in Township \_\_\_\_ South, Range \_\_\_\_ East/West (circle one), \_\_\_\_ County, Kansas.

If the source of supply is groundwater, a separate application shall be filed for each proposed well or battery of wells, except that a single application may include up to four wells within a circle with a quarter (1/4) mile radius in the same local source of supply which do not exceed a maximum diversion rate of 20 gallons per minute per well.

A battery of wells is defined as two or more wells connected to a common pump by a manifold; or not more than four wells in the same local source of supply within a 300 foot radius circle which are being operated by pumps not to exceed a total maximum diversion rate of 800 gallons per minute and which supply water to a common distribution system.

6. The owner of the point of diversion, if other than the applicant is (please print):

Same as Applicant  
(name, address and telephone number)

\_\_\_\_\_  
(name, address and telephone number)

You must provide evidence of legal access to, or control of, the point of diversion from the landowner or the landowner's authorized representative. Provide a copy of a recorded deed, lease, easement or other document with this application. In lieu thereof, you may sign the following sworn statement:

I have legal access to, or control of, the point of diversion described in this application from the landowner or the landowner's authorized representative. I declare under penalty of perjury that the foregoing is true and correct.

Executed on 2/16/17, 20\_\_\_\_. Roger L Simpson  
Applicant's Signature

The applicant must provide the required information or signature irrespective of whether they are the landowner. Failure to complete this portion of the application will cause it to be unacceptable for filing and the application will be returned to the applicant.

7. The proposed project for diversion of water will consist of 1 well and Pump  
(number of wells, pumps or dams, etc.)

and will be completed (by) ASAP  
(Month/Day/Year - each was or will be completed)

8. The first actual application of water for the proposed beneficial use was or is estimated to be ASAP  
(Mo/Day/Year)

9. Will pesticide, fertilizer, or other foreign substance be injected into the water pumped from the diversion works?  
 Yes    No   If "yes", a check valve shall be required.

All chemigation safety requirements must be met including a chemigation permit and reporting requirements.

10. If you are planning to impound water, please contact the Division of Water Resources for assistance, prior to submitting the application. Please attach a reservoir area capacity table and inform us of the total acres of surface drainage area above the reservoir.

Have you also made an application for a permit for construction of this dam and reservoir with the Division of Water Resources?    Yes    No

- If yes, show the Water Structures permit number here \_\_\_\_\_
- If no, explain here why a Water Structures permit is not required \_\_\_\_\_

11. The application must be supplemented by a U.S.G.S. topographic map, aerial photograph or a detailed plat showing the following information. On the topographic map, aerial photograph, or plat, identify the center of the section, the section lines or the section corners and show the appropriate section, township and range numbers. Also, please show the following information:

- (a) The location of the proposed point(s) of diversion (wells, stream-bank installations, dams, or other diversion works) should be plotted as described in Paragraph No. 5 of the application, showing the North-South distance and the East-West distance from a section line or southeast corner of section.
- (b) If the application is for groundwater, please show the location of any existing water wells of any kind within 1/2 mile of the proposed well or wells. Identify each existing well as to its use and furnish the name and mailing address of the property owner or owners. If there are no wells within 1/2 mile, please advise us.
- (c) If the application is for surface water, the names and addresses of the landowner(s) 1/2 mile downstream and 1/2 mile upstream from your property lines must be shown.
- (d) The location of the proposed place of use should be shown by crosshatching on the topographic map, aerial photograph or plat.
- (e) Show the location of the pipelines, canals, reservoirs or other facilities for conveying water from the point of diversion to the place of use.

A 7.5 minute U.S.G.S. topographic map may be obtained by providing the section, township and range numbers to: Kansas Geological Survey, 1930 Constant, Campus West, University of Kansas, Lawrence, Kansas 66047.

12. List any application, appropriation of water, water right, or vested right file number that covers the same diversion points or any of the same place of use described in this application. Also list any other recent modifications made to existing permits or water rights in conjunction with the filing of this application.

None

Existing well currently authorized for industrial use under term permit 20129323, which expires 5/1/2017

\_\_\_\_\_

**WATER RESOURCES  
RECEIVED**

**FEB 21 2017**

13. Furnish the following well information if the proposed appropriation is for the use of groundwater. If the well has not been completed, give information obtained from test holes, if available.

Information below is from:  Test holes  Well as completed  Drillers log attached

| Well location as shown in paragraph No. | (A) | (B) | (C) | (D)            |
|---|-----|-----|-----|----------------|
| Date Drilled                            |     |     |     | <u>See Log</u> |
| Total depth of well                     |     |     |     |                |
| Depth to water bearing formation        |     |     |     |                |
| Depth to static water level             |     |     |     |                |
| Depth to bottom of pump intake pipe     |     |     |     |                |

14. The relationship of the applicant to the proposed place where the water will be used is that of

Owner  
(owner, tenant, agent or otherwise)

15. The owner(s) of the property where the water is used, if other than the applicant, is (please print):

Same as Applicant  
(name, address and telephone number)

\_\_\_\_\_  
(name, address and telephone number)

16. The undersigned states that the information set forth above is true to the best of his/her knowledge and that this application is submitted in good faith.

Dated at Stafford, Kansas, this 16 day of February, 2017.  
(month) (year)

Roger L Simpson  
(Applicant Signature)

By \_\_\_\_\_  
(Agent or Officer Signature)

\_\_\_\_\_  
(Agent or Officer - Please Print)

Assisted by MJM/SFFO ESII Date: 2/16/2017  
(office/title)

RECEIVED BY MR. [unclear]

FILED BY [unclear]

## IRRIGATION USE SUPPLEMENTAL SHEET

File No. 49,779

Name of Applicant (Please Print): Roger Simpson

1. Please supply the name and address of each landowner, the legal description of the lands to be irrigated, and designate the actual number of acres to be irrigated in each forty acre tract or fractional portion thereof:

**Landowner of Record** NAME: Roger Simpson

ADDRESS: 5132 NW Reutlinger Medicine Lodge, KS 67104

| S  | T   | R   | NE¼ |    |    |    | NW¼ |    |    |    | SW¼ |    |    |    | SE¼ |    |    |    | TOTAL |
|----|-----|-----|-----|----|----|----|-----|----|----|----|-----|----|----|----|-----|----|----|----|-------|
|    |     |     | NE  | NW | SW | SE | NE  | NW | SW | SE | NE  | NW | SW | SE | NE  | NW | SW | SE |       |
| 36 | 31S | 13W | 4   | 33 | 21 | 1  |     |    |    |    |     |    |    |    |     |    |    |    | 59    |
|    |     |     |     |    |    |    |     |    |    |    |     |    |    |    |     |    |    |    |       |
|    |     |     |     |    |    |    |     |    |    |    |     |    |    |    |     |    |    |    |       |

**Landowner of Record** NAME: \_\_\_\_\_

ADDRESS: \_\_\_\_\_

| S | T | R | NE¼ |    |    |    | NW¼ |    |    |    | SW¼ |    |    |    | SE¼ |    |    |    | TOTAL |
|---|---|---|-----|----|----|----|-----|----|----|----|-----|----|----|----|-----|----|----|----|-------|
|   |   |   | NE  | NW | SW | SE | NE  | NW | SW | SE | NE  | NW | SW | SE | NE  | NW | SW | SE |       |
|   |   |   |     |    |    |    |     |    |    |    |     |    |    |    |     |    |    |    |       |
|   |   |   |     |    |    |    |     |    |    |    |     |    |    |    |     |    |    |    |       |
|   |   |   |     |    |    |    |     |    |    |    |     |    |    |    |     |    |    |    |       |

**Landowner of Record** NAME: \_\_\_\_\_

ADDRESS: \_\_\_\_\_

| S | T | R | NE¼ |    |    |    | NW¼ |    |    |    | SW¼ |    |    |    | SE¼ |    |    |    | TOTAL |
|---|---|---|-----|----|----|----|-----|----|----|----|-----|----|----|----|-----|----|----|----|-------|
|   |   |   | NE  | NW | SW | SE | NE  | NW | SW | SE | NE  | NW | SW | SE | NE  | NW | SW | SE |       |
|   |   |   |     |    |    |    |     |    |    |    |     |    |    |    |     |    |    |    |       |
|   |   |   |     |    |    |    |     |    |    |    |     |    |    |    |     |    |    |    |       |
|   |   |   |     |    |    |    |     |    |    |    |     |    |    |    |     |    |    |    |       |

**WATER RESOURCES  
RECEIVED**

**FEB 21 2017**

2. Please complete the following information for the description of the operation for the irrigation project. Attach supplemental sheets as needed.

a. Indicate the soils in the field(s) and their intake rates:

| Soil Name | Percent of field (%) | Intake Rate (in/hr) | Irrigation Design Group |
|-----------|----------------------|---------------------|-------------------------|
| _____     | _____                | _____               | _____                   |
| _____     | _____                | _____               | _____                   |
| _____     | _____                | _____               | _____                   |
| _____     | _____                | _____               | _____                   |
| Total:    | 100 %                |                     |                         |

b. Estimate the average land slope in the field(s): \_\_\_\_\_ %

Estimate the maximum land slope in the field(s): \_\_\_\_\_ %

c. Type of irrigation system you propose to use (check one):

- Center pivot                       Center pivot - LEPA                       "Big gun" sprinkler
- Gravity system (furrows)                       Gravity system (borders)                       Sideroll sprinkler

Other, please describe: \_\_\_\_\_

d. System design features:

i. Describe how you will control tailwater:

ii. For sprinkler systems:

(1) Estimate the operating pressure at the distribution system: \_\_\_\_\_ psi

(2) What is the sprinkler package design rate? \_\_\_\_\_ gpm

(3) What is the wetted diameter (twice the distance the sprinkler throws water) of a sprinkler on the outer 100 feet of the system? \_\_\_\_\_ feet

(4) Please include a copy of the sprinkler package design information.

e. Crop(s) you intend to irrigate. Please note any planned crop rotations:

f. Please describe how you will determine when to irrigate and how much water to apply (particularly important if you do not plan a full irrigation).

You may attach any additional information you believe will assist in informing the Division of the need for your request.

Draft

**KANSAS DEPARTMENT OF AGRICULTURE  
Division of Water Resources**

**MEMORANDUM**

6/25/18

**TO:** Files

**DATE:** September 14, 2017

**FROM:** Matt Meier

**RE:** Application, File No. 49,778

Roger Simpson has filed the referenced application to appropriate groundwater for irrigation use, requesting one (1) well, a quantity of 82.6 acre-feet, and a diversion rate of 1,000 gallons per minute. The proposed well is to be located Near the Center of the Northeast Quarter (NC NE¼) of Section 36, more particularly described as being near a point 4,620 feet North and 660 feet West of the Southeast corner of said section, Township 31 South, Range 13 West, Barber County, in the Medicine Lodge River drainage basin within the boundaries of South-Central Kansas Designated Unit Area- MED15. There are currently no overlapping water rights on the proposed place of use or point of diversion. The well is an existing well which had previously been used for industrial use covered by term permit 20129323, which expired 5/1/2017. The proposed place of use is owned by the applicant. The applicant has signed the application form stating that he has legal access to the point of diversion.

The applicant identified that there are zero domestic wells within one-half mile of the proposed well and no existing non-domestic wells (which Wris confirmed). Nearby notification letters were therefore not sent out. Based off WRIS, the nearest non-domestic well (Water Right # 30,719) is located 3,104 feet away. There are no domestic wells within 2,640 feet. The proposed point of diversion meets minimum well spacing to all existing wells. Per the requirements in K.A.R. 5-4-4 for all other aquifers, the minimum well spacing should be one-quarter mile to all other non-domestic wells and 660 feet to domestic wells.

A well log was obtained from the KGS website and shows topsoil from 0 to 2 feet, red clay from 2 to 4 feet, sand from 4 to 19 feet, brown mud from 19 to 25 feet, med gavel with cobbles from 25 to 33 feet, brown mud from 33 to 40 feet, sand streaks with brown mud from 40 to 59 feet, and red shale from 59 to 62 feet below ground. Static water level was 7 feet below ground surface which provides a saturated thickness of 52 feet.

The point of diversion is located within South Central Kansas Designated Unit Area Med15 which is currently open to new appropriations. Per the requirements in K.A.R. 5-3-11, safe yield is determined by the extent of the unconfined aquifer within a two-mile circle radius of the point of diversion, which establishes the area of consideration. Evaluation of the area of consideration included the extent of the unconfined aquifer, which provided an area of consideration of 4,689 acres (Areas on the North and South side of the 2-mile circle were excluded as well logs in the areas showed shallow shale formations with the static water level located in them). With a potential annual recharge of 1.5 inches, and 50% of recharge available for appropriation, safe yield was determined to be 293.09 acre-feet. Existing water rights have appropriated 112 acre-feet, providing a difference of 181.09 acre-feet available for appropriation, and the application requesting 82.6 acre-feet complies with safe yield.

The requested quantity of water, 82.6 acre-feet, is reasonable to irrigate the proposed 59 acres identified in the application. This is the maximum reasonable quantity allowable of 1.4 acre-feet per acre for Barber County, Kansas. There are multiple pending applications in this general area of the state, and they are being worked in priority order to ensure that senior applications are provided the available water.



In accordance with K.S.A. 82a-706c, the Chief Engineer retains full authority to require any water user to install meters, gages, or other measuring devices, which devices he or she or his or her agents may read at any time. Water flowmeter requirements are further described in K.A.R. 5-1-4 through K.A.R. 5-1-12. If any chemical or foreign substance is injected into the water pumped under this permit, a check valve will also need to be installed. A water level measurement tube is required because this is a proposed new well exceeding 100 gpm. *ask Jeff about since existing*

The proposed application is subject to minimum desirable streamflow requirements. The applicant signed, notarized, and returned the required form to our office.

Based on the above discussion, well spacing and safe yield criteria are met, and approval of the application will not impair senior water rights nor prejudicially or unreasonably affect the public interest, it is recommended that the referenced application be approved.

Matt Meier  
Environmental Scientist  
Permits Unit

*Concur w/ recommendations*

*Approve it. Leave note on drs well requirement use it "it needs"*

*Jeff Butner V.L.*

Water Rights and Points of Diversion Within 2.00 miles of point defined as:

4620 ft N and 660 ft W of the SE Corner of Section 36, T 31S, R 13W

Located at: 98.679057 West Longitude and 37.310021 North Latitude

GROUNDWATER ONLY

*#49,778*  
*meets spacing*

| File Number | Use | ST  | SR | Dist (ft) | Q4   | Q3 | Q2 | Q1 | FeetN | FeetW | Sec  | Twp | Rng | ID  | Batt | Auth_Quan | Add_Quan | Unit   |       |    |
|-------------|-----|-----|----|-----------|------|----|----|----|-------|-------|------|-----|-----|-----|------|-----------|----------|--------|-------|----|
| A__ 26374   | 01  | STK | NK | G         | 7821 | -- | NW | SE | NE    | 3859  | 901  | 6   | 32  | 12W | 5    | G         | 2        | 20.00  | 20.00 | AF |
| Same        |     |     |    |           | 7842 | -- | NW | SE | NE    | 3853  | 875  | 6   | 32  | 12W | 6    | B         | 2        |        |       |    |
| Same        |     |     |    |           | 7801 | -- | NW | SE | NE    | 3864  | 927  | 6   | 32  | 12W | 7    | B         | 2        |        |       |    |
| Same        |     |     |    |           | 6508 | -- | -- | N2 | N2    | 4254  | 2620 | 6   | 32  | 12W | 4    |           |          |        |       |    |
| A__ 30719   | 00  | IRR | NK | G         | 4282 | -- | NW | SE | NE    | 3677  | 965  | 25  | 31  | 13W | 1    |           | 60.00    | 60.00  | AF    |    |
| Same        |     |     |    |           | 3104 | -- | NW | NE | SE    | 2492  | 1006 | 25  | 31  | 13W | 2    |           | 36.00    | 32.00  | AF    |    |
| A__ 49778   | 00  | IRR | AY | G         | 0    | -- | NC | NE | NE    | 4620  | 660  | 36  | 31  | 13W | 1    |           | 82.60    | 82.60  | AF    |    |
| T_20129323  | 00  | IND | GY | G         | 0    | -- | NC | NE | NE    | 4620  | 660  | 36  | 31  | 13W | 1    |           | 232.00   | 232.00 | AF    |    |
| T_20179021  | 00  | IND | GY | G         | 0    | -- | NC | NE | NE    | 4620  | 660  | 36  | 31  | 13W | 1    |           | 50.00    | 50.00  | AF    |    |

| Total Net Quantities Authorized: | Direct | Storage |
|----------------------------------|--------|---------|
| Total Requested Amount (AF) =    | 82.60  | .00     |
| Total Permitted Amount (AF) =    | 282.00 | .00     |
| Total Inspected Amount (AF) =    | .00    | .00     |
| Total Pro_Cert Amount (AF) =     | .00    | .00     |
| Total Certified Amount (AF) =    | 112.00 | .00     |
| Total Vested Amount (AF) =       | .00    | .00     |
| TOTAL AMOUNT (AF) =              | 476.60 | .00     |

An \* after the source of supply indicates a pending application for change for the file number.

An \* after the ID indicates a 15 AF exemption was granted for the file number.

A "G" in the Batt column indicates the GEO CTR of a battery. A "B" indicates a well in the battery.

The number in the Batt column is the number of wells in the battery.

Water Rights and Points of Diversion Within 2.00 miles of point defined as:

98.679057 West Longitude and 37.310021 North Latitude

GROUNDWATER ONLY

WATER USE CORRESPONDENTS:

| File Number                           | Use | ST  | SR |
|---------------------------------------|-----|-----|----|
| A__ 26374                             | 01  | STK | NK |
| > THOMAS W & BARBARA J BEDWELL TRUSTS |     |     |    |
| >                                     |     |     |    |
| > 120 LISA CIRCLE                     |     |     |    |
| > MEDICINE LODGE KS 67104             |     |     |    |
| -----                                 |     |     |    |
| A__ 30719                             | 00  | IRR | NK |
| > ESTHER SIMONS                       |     |     |    |
| >                                     |     |     |    |
| > 8326 S LULU ST                      |     |     |    |
| > HAYSVILLE KS 67060                  |     |     |    |
| -----                                 |     |     |    |
| A__ 49778                             | 00  | IRR | AY |
| > ROGER L SIMPSON                     |     |     |    |
| >                                     |     |     |    |
| > 5132 NW REUTLINGER                  |     |     |    |
| > MEDICINE LODGE KS 67104             |     |     |    |

>-----

T\_\_20129323 00 IND GY G  
> FRESHWATER LLC  
> PHILLIP S HELLMAN  
> 2507 SE HWY 160  
> MEDICINE LODGE KS 67104

>-----

T\_\_20179021 00 IND GY G  
> FRESHWATER LLC  
> PHILLIP S HELLMAN  
> 2507 SE HWY 160  
> MEDICINE LODGE KS 67104

>-----

=====



1320 Research Park Drive  
Manhattan, Kansas 66502  
Jackie McClaskey, Secretary

Phone: (785) 564-6700  
Fax: (785) 564-6777  
Email: ksag@kda.ks.gov  
www.agriculture.ks.gov  
Sam Brownback, Governor

February 22, 2017

ROGER SIMPSON  
5132 NW REUTLINGER  
MEDICINE LODGE KS 67104

FILE COPY

RE: Application  
File No. 49778

Dear Sir or Madam:

Your application for permit to appropriate water in 36-31S-13W in Barber County, was received and has been assigned the file number noted above.

As a matter of record, the Division of Water Resources has on hand a large number of applications awaiting processing. Therefore to be fair to all concerned, and so that we can process those applications on hand in the order they were received, we intend to concentrate on the backlog of applications until the issue is resolved. Once review of your application has begun, we will contact you, if additional information is required.

In accordance with the provisions of the Kansas Water Appropriation Act, a portion of which is included below, the use of water as proposed prior to approval of the application is unlawful. Once approved, compliance with the terms, conditions and limitations of the permit is necessary. Conservation of the water resources of Kansas is required.

**Section 82a-728 of the Kansas Water Appropriation Act, provides (a) except for the appropriation of water for the purpose of domestic use, . . . it shall be unlawful for any person to appropriate or threaten to appropriate water from any source without first applying for and obtaining a permit to appropriate water in accordance with the provisions of the Water Appropriation Act or for any person to violate any condition of a vested right, appropriation right or an approved application for a permit to appropriate water for beneficial use.**

**(b) (1) The violation of any provision of this section by any person is a class C misdemeanor . . .**

**A class C misdemeanor is punishable by a fine not to exceed \$500 and/or a term of confinement not to exceed one month in the county jail. Each day that the violation occurs constitutes a separate offense.**

If you have any questions, please contact me at (785) 564-6645. If you wish to discuss a specific file, please have the file number ready so that we may help you more efficiently.

Sincerely,

Brent A Turney, P.G.  
Change Application Unit Supervisor  
Water Appropriation Program

BAT: dlw  
pc: STAFFORD Field Office  
GMD 0

SCANNED

## FEE SCHEDULE

1. The fee for an application for a permit to appropriate water for beneficial use, except for domestic use, shall be (see paragraph No. 2 below if requesting storage):

| ACRE-FEET     | FEE  |
|---------------|--|
| 0-100         | \$200.00   |
| 101-320       | \$300.00   |
| More than 320 | \$300.00 plus \$20.00 for each additional 100 acre-feet or any part thereof. |

2. The fee for an application in which storage is requested, except for domestic use, shall be:

| ACRE-FEET     | FEE   |
|---------------|---|
| 0-250         | \$200.00  |
| More than 250 | \$200.00 plus \$20.00 for each additional 250 acre-feet of storage or any part thereof. |

Note: If an application requests both direct use *and* storage, the fee charged shall be as determined under No. 1 or No. 2 above, whichever is greater, but not both fees.

3. The fee for an application for a permit to appropriate water for water power or dewatering purposes shall be \$100.00 plus \$200.00 for each 100 cubic feet per second, or part thereof, of the diversion rate requested.

Note: The applicant shall notify the Chief Engineer and pay the statutorily required field inspection fee of \$400.00 when construction of the works for diversion has been completed, except that for applications filed on or after July 1, 2009, for works constructed for sediment control use and for evaporation from a groundwater pit for industrial use shall be accompanied by a field inspection fee of \$200.00.

### MAKE CHECKS PAYABLE TO THE KANSAS DEPARTMENT OF AGRICULTURE

### ATTENTION

A Water Conservation Plan may be required per K.S.A. 82a-733. A statement that your application for permit to appropriate water may be subject to the minimum desirable streamflow requirements per K.S.A. 82a-703a, b, and c may also be required from you. After the Division of Water Resources has had the opportunity to review your application, you will be notified whether or not you will need to submit a Water Conservation Plan. You also may be required to install a water flow meter or water stage measuring device on your diversion works prior to diverting water. There may be other special conditions or Groundwater Management District regulations that you will need to comply with if this application is approved.

### CONVERSION FACTORS

1 acre-foot equals 325,851 gallons

1 million gallons equal 3.07 acre-feet

WATER RESOURCES  
RECEIVED

FEB 21 2017

SCANNED KS DEPT OF AGRICULTURE

\_\_\_\_\_  
(Date)

Kansas Department of Agriculture  
Division of Water Resources  
David W. Barfield, Chief Engineer  
109 SW 9<sup>th</sup> Street, 2nd Floor  
Topeka, Kansas 66612-1283

Re: Application  
File No. 49,778

Minimum Desirable Streamflow

Dear Sir:

I understand that a Minimum Desirable Streamflow requirement has been established by the legislature for the source of supply to which the above referenced application applies.

I understand that diversion of water pursuant to this application will be subject to regulation any time Minimum Desirable Streamflow requirements are not being met.

I also understand that if this application is approved, there could be times, as determined by the Division of Water Resources, when I would not be allowed to divert water. I realize that this could affect the economics of my decision to appropriate water.

I am aware of the above factors, and with the knowledge thereof, request that the Division of Water Resources proceed with processing and approval, if possible, of the above referenced application.

Roger L Simpson  
Signature of Applicant

State of Kansas )  
County of Stafford ) ss \_\_\_\_\_  
(Print Applicant's Name)

I hereby certify that the foregoing instrument was signed in my presence and sworn to before me this 16<sup>th</sup> day of February, 2017.

Jessica Engelbrecht  
Notary Public

My Commission Expires

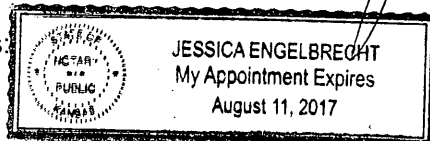

WATER RESOURCES  
RECEIVED

FEB 21 2017

KS DEPT OF AGRICULTURE

SCANNED

**MINIMUM DESIRABLE STREAMFLOW FORM TO BE USED WHEN  
APPLICABLE WHEN FILING AN APPLICATION FOR PERMIT  
TO APPROPRIATE WATER FOR BENEFICIAL USE**

The Kansas Legislature has established minimum desirable streamflows for the streams listed below. If your proposed diversion of water is going to be from one of these watercourses or adjacent alluvial aquifers, please complete the back side of this page and submit it along with your application for permit to appropriate water.

Arkansas River  
Big Blue River  
Chapman Creek  
Chikaskia River  
Cottonwood River  
Delaware River  
Little Arkansas River  
Little Blue River  
Marais des Cygnes River  
Medicine Lodge River  
Mill Creek (Wabaunsee Co. area)  
Neosho River

Ninnescah River  
North Fork Ninnescah River  
Rattlesnake Creek  
Republican River  
Saline River  
Smoky Hill River  
Solomon River  
South Fork Ninnescah  
Spring River  
Walnut River  
Whitewater River

**WATER WELL RECORD**

Form WWC-5

Division of Water Resources App. No.

49,778

**1 LOCATION OF WATER WELL:** Fraction  $\frac{1}{4}$  NE NE NE  
 County: Barber  
 Street/Rural Address of Well Location; if unknown, distance & direction from nearest town or intersection: If at owner's address, check here   
 6 W Medicine Lodge 1/2 S.

**Section Number** 36 **Township No.** T 31 S **Range Number** R 13  E  W

**Global Positioning System (GPS) information:**  
 Latitude: ..... (in decimal degrees)  
 Longitude: ..... (in decimal degrees)  
 Elevation: .....  
 Datum:  WGS 84,  NAD 83,  NAD 27  
 Collection Method:  
 GPS unit (Make/Model: .....)  
 Digital Map/Photo,  Topographic Map,  Land Survey  
 Est. Accuracy:  <3 m,  3-5 m,  5-15 m,  >15 m

**2 WATER WELL OWNER:** Fresh water LLC  
 RR#, Street Address, Box #: P.O. Box 209  
 City, State, ZIP Code: Medicine Lodge, KS 67104

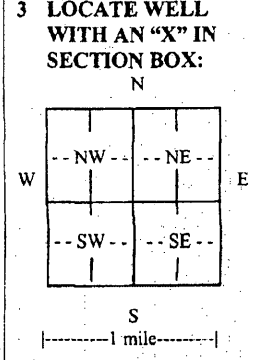

**4 DEPTH OF COMPLETED WELL** 62 ft.  
 Depth(s) Groundwater Encountered (1) 7 ft. (2) ..... ft. (3) ..... ft.  
 WELL'S STATIC WATER LEVEL 7 ft. below land surface measured on mo/day/yr. 5-23-12  
 Pump test data: Well water was ..... ft. after ..... hours pumping ..... gpm  
 EST. YIELD 200 gpm. Well water was ..... ft. after ..... hours pumping ..... gpm  
 Bore Hole Diameter 12 in. to ..... ft., and ..... in. to ..... ft.  
 WELL WATER TO BE USED AS:  Public water supply  Geothermal  Injection well  
 Domestic  Feedlot  Oil field water supply  Dewatering  Other (Specify below)  
 Irrigation  Industrial  Domestic-lawn & garden  Monitoring well  
 Was a chemical/bacteriological sample submitted to Department?  Yes  No  
 If yes, mo/day/yr sample was submitted .....  
 Water well disinfected?  Yes  No

**5 TYPE OF CASING USED:**  Steel  PVC  Other  
**CASING JOINTS:**  Glued  Clamped  Welded  Threaded  
 Casing diameter 8 in. to 6 ft. Diameter ..... in. to ..... ft., Diameter ..... in. to ..... ft.  
 Casing height above land surface 24 in., Weight 160 lbs./ft., Wall thickness or gauge No. ....  
**TYPE OF SCREEN OR PERFORATION MATERIAL:**  
 Steel  Stainless Steel  PVC  Other (Specify) .....  
 Brass  Galvanized Steel  None used (open hole)  
**SCREEN OR PERFORATION OPENINGS ARE:**  
 Continuous slot  Mill slot  Gauze wrapped  Torch cut  Drilled holes  None (open hole)  
 Louvered shutter  Key punched  Wire wrapped  Saw cut  Other (specify) .....  
**SCREEN-PERFORATED INTERVALS:** From 22 ft. to 62 ft., From ..... ft. to ..... ft.  
**GRAVEL PACK INTERVALS:** From 20 ft. to 62 ft., From ..... ft. to ..... ft.

**6 GROUT MATERIAL:**  Neat cement  Cement grout  Bentonite  Other  
 Grout Intervals: From 0 ft. to 20 ft., From ..... ft. to ..... ft., From ..... ft. to ..... ft.  
 What is the nearest source of possible contamination:  
 Septic tank  Lateral lines  Pit privy  Livestock pens  Insecticide storage  Other (specify below)  
 Sewer lines  Cesspool  Sewage lagoon  Fuel storage  Abandoned water well  
 Watertight sewer lines  Seepage pit  Feedyard  Fertilizer storage  Oil well/gas well  
 Direction from well N.W. Distance from well 2500'

| FROM | TO | LITHOLOGIC LOG             | FROM | TO | LITHO. LOG (cont.) or PLUGGING INTERVALS |
|------|----|----------------------------|------|----|--|
| 0    | 2  | Soil                       |      |    |  |
| 2    | 4  | Red Clay                   |      |    |  |
| 4    | 19 | Clean Sand Some Mud        |      |    | WATER RESOURCES RECEIVED                 |
| 19   | 25 | Brown Mud                  |      |    |  |
| 25   | 33 | Med dirty gravel w/cobbles |      |    | FEB 21 2017                              |
| 33   | 40 | Brown Mud                  |      |    |  |
| 40   | 59 | Sand streaks w/brown mud   |      |    |  |
| 59   | 62 | Red Shale                  |      |    | KS DEPT OF AGRICULTURE                   |

**7 CONTRACTOR'S OR LANDOWNER'S CERTIFICATION:** This water well was  constructed,  reconstructed, or  plugged under my jurisdiction and was completed on (mo/day/year) 5-23-12 and this record is true to the best of my knowledge and belief.  
 Kansas Water Well Contractor's License No. 140 This Water Well Record was completed on (mo/day/year) 6-6-12  
 under the business name of Lyman's Inc by (signature) [Signature]

**INSTRUCTIONS:** Use typewriter or ball point pen. PLEASE PRESS FIRMLY and PRINT clearly. Please fill in blanks and check the correct answers. Send three copies (white, blue, pink) to Kansas Department of Health and Environment, Bureau of Water, Geology Section, 1000 SW Jackson St., Suite 420 Topeka, Kansas 66612-1367. Telephone 785-296-5524. Send one copy to WATER WELL OWNER and retain one for your records. Include fee of \$5.00 for each constructed well. Visit us at <http://www.kdheks.gov/waterwell/index.html>.



## Analysis Results

The selected PD is in an area OPEN to new appropriations.

The safe yield based on the variables listed below is 293.09 AF. *-112 = 181.09 AF available*

Total prior appropriations in the circle is 194.60 AF.

Total quantity of water available for appropriation is 98.49 AF.

*#49,778*

*meets safe yield*

## Safe Yield Variables

The area used for the analysis is set at 4,689 acres.

The potential annual recharge at the circle center is estimated to be 1.5 inches.

The percent of recharge available for appropriation is 50%.

Authorized Quantity values are as of 25-JUN-2018 and are based on Appropriated and Vested ground water right and possible stream nodes for GMD #2. Domestic, Term and Temporary water rights have been excluded.

There are 3 water rights and 7 points of diversion within the circle.

| File Number | Use | ST | SR | Q4 | Q3 | Q2 | Q1 | FeetN | FeetW | Sec | Twp | Rng | ID | Qind | Auth Quant | Add Quant | Tot Acres | Net Acres |
|-------------|-----|----|----|----|----|----|----|-------|-------|-----|-----|-----|----|------|------------|-----------|-----------|-----------|
| A 26374 01  | STK | NK | G  |    |    | N2 | N2 | 4254  | 2620  | 06  | 32  | 12W | 4  | WR   | 20.00      | 20.00     |           |           |
| Same        | STK | NK | G  |    | NW | SE | NE | 3859  | 901   | 06  | 32  | 12W | 5  | WR   |            |           |           |           |
| Same        | STK | NK | G  |    | NW | SE | NE | 3853  | 875   | 06  | 32  | 12W | 6  | WR   |            |           |           |           |
| Same        | STK | NK | G  |    | NW | SE | NE | 3864  | 927   | 06  | 32  | 12W | 7  | WR   |            |           |           |           |
| A 30719 00  | IRR | NK | G  |    | NW | NE | SE | 2492  | 1006  | 25  | 31  | 13W | 2  | PD   | 36.00      | 32.00     | 69.50     | 69.50     |
| Same        | IRR | NK | G  |    | NW | SE | NE | 3677  | 965   | 25  | 31  | 13W | 1  | PD   | 60.00      | 60.00     |           |           |
| A 49778 00  | IRR | AY | G  |    | NC | NE | NE | 4620  | 660   | 36  | 31  | 13W | 1  | WR   | 82.60      | 82.60     | 59.00     | 59.00     |

*112 AF app.*

*Pending*

## Limitations

| File Number | Seq Num | Limitations            |
|-------------|---------|------------------------|
| A 30719 00  | 1       | 92AF/YR TOTAL FOR FILE |

**Safe Yield Report Sheet**  
**Water Right- Proposed Point of Diversion**  
**Point of Diversion in 36-31S-13W**  
**Footages from SE corner- 4,620 feet North 660 feet West**

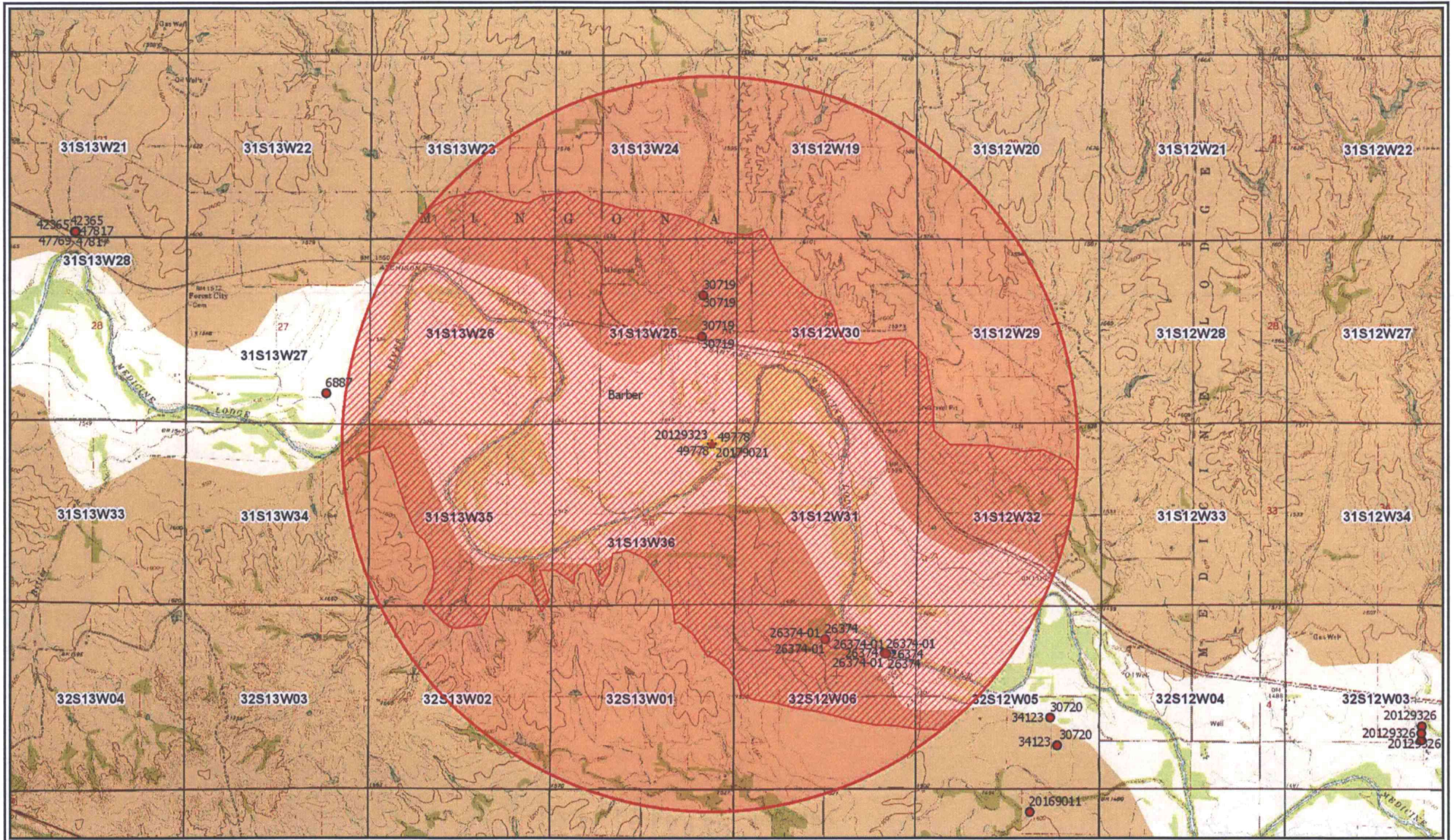

File No. 49,778

No wells within  $\frac{1}{2}$  mile



I declare that all water wells or diversion sites using the same source of supply and within  $\frac{1}{2}$  mile of the proposed point of diversion have been plotted on the application map.

- ★ Domestic Wells
- ⊕ Proposed PD
- ▲ Water Rights
- ⊕ SFFOsec\_corners

*Roger L. Simpson*

2/16/17

Signature

Date

0 400 800 1,600 2,400 3,200 Feet

Created By: Matt Meier  
F.O. 2  
Date: 2/16/2017

SCANNED

ProposedPlaceOfUse

File No. 49,778

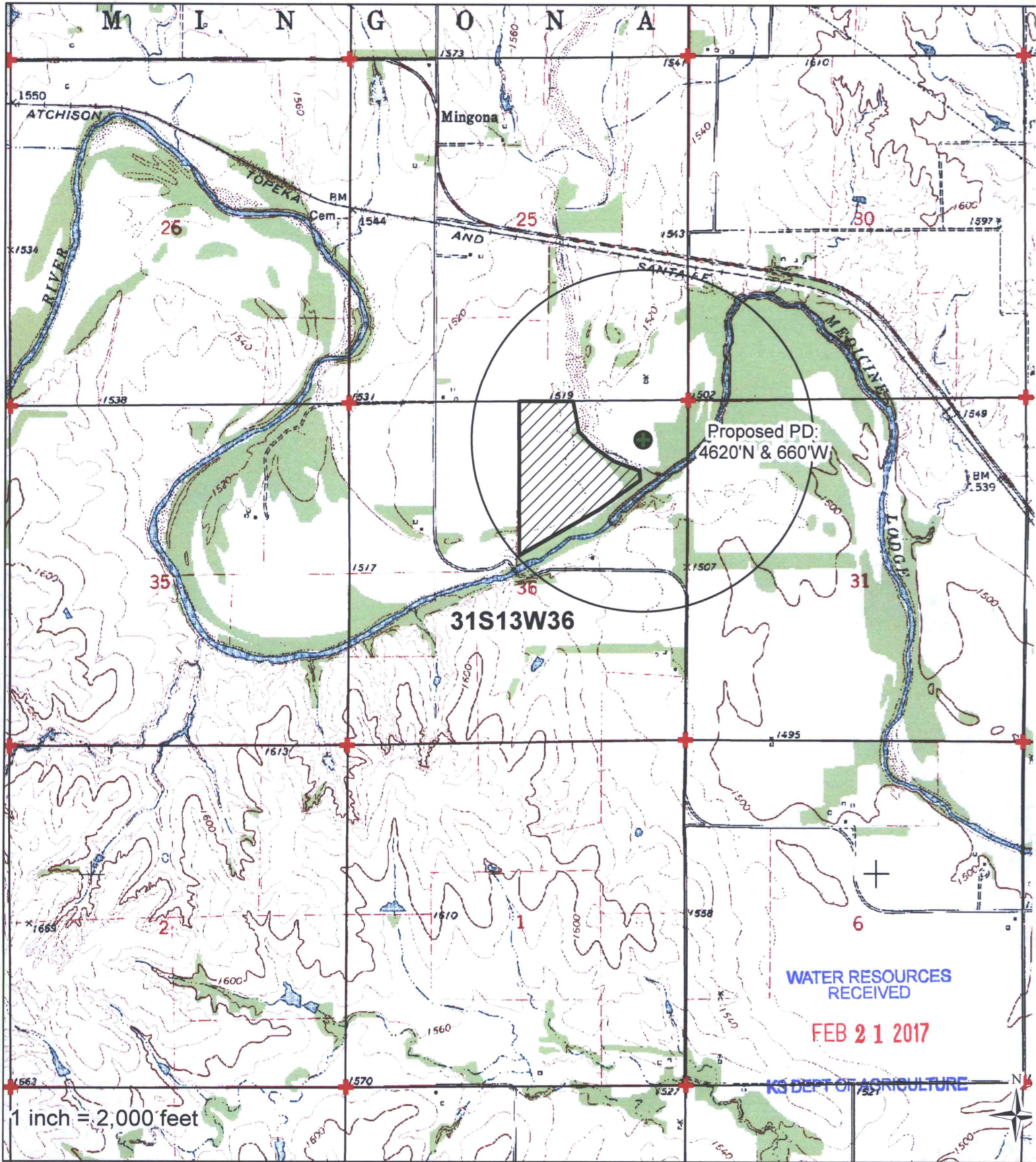

WATER RESOURCES RECEIVED

FEB 21 2017

KS DEPT OF AGRICULTURE

I declare that all water wells or diversion sites using the same source of supply and within 1/2 mile of the proposed point of diversion have been plotted on the application map.

- ★ Domestic Wells
- Proposed PD
- ▲ Water Rights
- ⊕ SFFOsec\_corners

Signature \_\_\_\_\_ Date \_\_\_\_\_

0 800 1 600 3 200 4 800 6 400

SCANNED

Created By: Matt Meier  
F.O. 2  
Date: 2/16/2017