

# NOTICE

This scan only represents the application as filed. The information contained herein meets the requirements of K.A.R. 5-3-1 or K.A.R. 5-5-1, and has been found acceptable for filing in the office of the Chief Engineer. The application should not be considered to be a complete application as per K.A.R. 5-3-1b or K.A.R. 5-5-2a.

THE STATE OF KANSAS



KANSAS DEPARTMENT OF AGRICULTURE  
Jackie McClaskey, Secretary of Agriculture

DIVISION OF WATER RESOURCES  
David W. Barfield, Chief Engineer

File Number 50191  
This item to be completed by the Division of Water Resources.

Water Resources  
Received

DEC 27 2018  
12:34  
KS Dept Of Agriculture

APPLICATION FOR PERMIT TO  
APPROPRIATE WATER FOR BENEFICIAL USE

Filing Fee Must Accompany the Application  
(Please refer to Fee Schedule attached to this application form.)

To the Chief Engineer of the Division of Water Resources, Kansas Department of Agriculture,  
1320 Research Park Drive, Manhattan, Kansas 66502:

1. Name of Applicant (Please Print): Thane J Buss  
Address: 1 Honeysuckle Ct  
City: Oxford State KS Zip Code 67119  
Telephone Number: (620) 202-1932

2. The source of water is:  surface water in \_\_\_\_\_ (stream)  
OR  groundwater in Arkansas River (drainage basin)

Certain streams in Kansas have minimum target flows established by law or may be subject to administration when water is released from storage for use by water assurance district members. If your application is subject to these regulations on the date we receive your application, you will be sent the appropriate form to complete and return to the Division of Water Resources.

3. The maximum quantity of water desired is 106.6 acre-feet OR --- gallons per calendar year,  
to be diverted at a maximum rate of 800 gallons per minute OR --- cubic feet per second.

Once your application has been assigned a priority, the requested maximum rate of diversion and maximum requested quantity of water under that priority number can **NOT** be increased. Please be certain your requested maximum rate of diversion and maximum quantity of water are appropriate and reasonable for your proposed project and are in agreement with the Division of Water Resources' requirements.

4. The water is intended to be appropriated for (Check use intended):  
(a)  Artificial Recharge (b)  Irrigation (c)  Recreational (d)  Water Power  
(e)  Industrial (f)  Municipal (g)  Stockwatering (h)  Sediment Control  
(i)  Domestic (j)  Dewatering (k)  Hydraulic Dredging (l)  Fire Protection  
(m)  Thermal Exchange (n)  Contamination Remediation

YOU **MUST** COMPLETE AND ATTACH ADDITIONAL DIVISION OF WATER RESOURCES FORM(S) PROVIDING INFORMATION TO SUBSTANTIATE YOUR REQUEST FOR THE AMOUNT OF WATER FOR THE INTENDED USE REFERENCED ABOVE.

For Office Use Only:  
F.O. 2 GMD - Meets K.A.R. 5-3-1 (YES / NO) Use 1R2 Source G/S County SU By DAW Date 12/27/18  
Code PER Fee \$ 300 TR # \_\_\_\_\_ Receipt Date 12/27/18 Check # 1380

1/8/2019 LUM

5. The location of the proposed wells, pump sites or other works for diversion of water is: **A battery of four wells with a geocenter located SE NE NE (4,438 ft N; 573 ft W) of 33-30-2E, Sumner Co.**

**Note:** For the application to be accepted, the point of diversion location must be described to at least a 10 acre tract, unless you specifically request a 60 day period of time in which to locate the site within a specifically described, minimal legal quarter section of land.

- (A) One in the SE quarter of the NE quarter of the NE quarter of Section 33, more particularly described as being near a point 4,600 feet North and 347 feet West of the Southeast corner of said section, in Township 30 South, Range 2 East, Sumner County, Kansas.
- (B) One in the SW quarter of the NE quarter of the NE quarter of Section 33, more particularly described as being near a point 4,272 feet North and 804 feet West of the Southeast corner of said section, in Township 30 South, Range 2 East, Sumner County, Kansas.
- (C) One in the SW quarter of the NE quarter of the NE quarter of Section 33, more particularly described as being near a point 4,603 feet North and 786 feet West of the Southeast corner of said section, in Township 30 South, Range 2 East, Sumner County, Kansas.
- (D) One in the SE quarter of the NE quarter of the NE quarter of Section 33, more particularly described as being near a point 4,276 feet North and 353 feet West of the Southeast corner of said section, in Township 30 South, Range 2 East, Sumner County, Kansas.

If the source of supply is groundwater, a separate application shall be filed for each proposed well or battery of wells, except that a single application may include up to four wells within a circle with a quarter (1/4) mile radius in the same local source of supply which do not exceed a maximum diversion rate of 20 gallons per minute per well.

A battery of wells is defined as two or more wells connected to a common pump by a manifold; or not more than four wells in the same local source of supply within a 300 foot radius circle which are being operated by pumps not to exceed a total maximum diversion rate of 800 gallons per minute and which supply water to a common distribution system.

6. The owner of the point of diversion, if other than the applicant is (please print):

Applicant \_\_\_\_\_  
(name, address and telephone number)  
~~Charles C & Lou Ann Buss, 1692 E 30<sup>th</sup> Ave N, Oxford KS 67410~~ \_\_\_\_\_  
(name, address and telephone number)

You must provide evidence of legal access to, or control of, the point of diversion from the landowner or the landowner's authorized representative. Provide a copy of a recorded deed, lease, easement or other document with this application. In lieu thereof, you may sign the following sworn statement:

I have legal access to, or control of, the point of diversion described in this application from the landowner or the landowner's authorized representative. I declare under penalty of perjury that the foregoing is true and correct.

Executed on December 14, 2018.   
Applicant's Signature

The applicant must provide the required information or signature irrespective of whether they are the landowner. Failure to complete this portion of the application will cause it to be unacceptable for filing and the application will be returned to the applicant.

7. The proposed project for diversion of water will consist of a battery of four (4) wells and diversion works \_\_\_\_\_  
(number of wells, pumps or dams, etc.)  
and was completed (by) 7/1/2014 \_\_\_\_\_  
(Month/Day/Year - each was or will be completed)

8. The first actual application of water for the proposed beneficial use was or is estimated to be 7/1/2014 \_\_\_\_\_  
(Mo/Day/Year)

9. Will pesticide, fertilizer, or other foreign substance be injected into the water pumped from the diversion works?  
 Yes    No   If "yes", a check valve shall be required.

All chemigation safety requirements must be met including a chemigation permit and reporting requirements.

10. If you are planning to impound water, please contact the Division of Water Resources for assistance, prior to submitting the application. Please attach a reservoir area capacity table and inform us of the total acres of surface drainage area above the reservoir.

Have you also made an application for a permit for construction of this dam and reservoir with the Division of Water Resources?    Yes    No

- If yes, show the Water Structures permit number here --- \_\_\_\_\_
- If no, explain here why a Water Structures permit is not required --- \_\_\_\_\_

11. The application must be supplemented by a U.S.G.S. topographic map, aerial photograph or a detailed plat showing the following information. On the topographic map, aerial photograph, or plat, identify the center of the section, the section lines or the section corners and show the appropriate section, township and range numbers. Also, please show the following information:

- (a) The location of the proposed point(s) of diversion (wells, stream-bank installations, dams, or other diversion works) should be plotted as described in Paragraph No. 5 of the application, showing the North-South distance and the East-West distance from a section line or southeast corner of section.
- (b) If the application is for groundwater, please show the location of any existing water wells of any kind within 1/2 mile of the proposed well or wells. Identify each existing well as to its use and furnish the name and mailing address of the property owner or owners. If there are no wells within 1/2 mile, please advise us.
- (c) If the application is for surface water, the names and addresses of the landowner(s) 1/2 mile downstream and 1/2 mile upstream from your property lines must be shown.
- (d) The location of the proposed place of use should be shown by crosshatching on the topographic map, aerial photograph or plat.
- (e) Show the location of the pipelines, canals, reservoirs or other facilities for conveying water from the point of diversion to the place of use.

A 7.5 minute U.S.G.S. topographic map may be obtained by providing the section, township and range numbers to: Kansas Geological Survey, 1930 Constant, Campus West, University of Kansas, Lawrence, Kansas 66047.

12. List any application, appropriation of water, water right, or vested right file number that covers the same diversion points or any of the same place of use described in this application. Also list any other recent modifications made to existing permits or water rights in conjunction with the filing of this application.

File No. 47595 authorizes the same wells and a portion of the place of use. Once File No. 47595 is certified, a change in place of use will be filed to create a complete place of use overlap. This new application is designed to add acres and authorized quantity.

13. Furnish the following well information if the proposed appropriation is for the use of groundwater. If the well has not been completed, give information obtained from test holes, if available.

Information below is from:  Test holes  Well as completed  Drillers log attached

Well location as shown in paragraph No.	(A)	(B)	(C)	(D)
Date Drilled	<u>3/19/14</u>	<u>3/19/14</u>	<u>3/19/14</u>	<u>3/19/14</u>
Total depth of well	<u>27</u>	<u>29</u>	<u>26</u>	<u>26</u>
Depth to water bearing formation	<u>10</u>	<u>10</u>	<u>10</u>	<u>10</u>
Depth to static water level	<u>8</u>	<u>8</u>	<u>8</u>	<u>8</u>
Depth to bottom of pump intake pipe	<u>26</u>	<u>28</u>	<u>25</u>	<u>25</u>

14. The relationship of the applicant to the proposed place where the water will be used is that of owner  
(owner, tenant, agent or otherwise)

15. The owner(s) of the property where the water is used, if other than the applicant, is (please print):  
Applicant  
(name, address and telephone number)  
~~Charles C & Lou Ann Buss, 1692 E 30th Ave N, Oxford KS 67119~~  
(name, address and telephone number)

16. The undersigned states that the information set forth above is true to the best of his/her knowledge and that this application is submitted in good faith.

Dated at Oxford, Kansas, this 14 day of December, 2018  
(month) (year)

  
\_\_\_\_\_  
(Applicant Signature)

By \_\_\_\_\_  
(Agent or Officer Signature)

\_\_\_\_\_  
(Agent or Officer - Please Print)

50191

### FEE SCHEDULE

1. The fee for an application for a permit to appropriate water for beneficial use, except for domestic use, shall be (see paragraph No. 2 below if requesting storage):

ACRE-FEET	FEE
0-100	\$200.00
101-320	\$300.00
More than 320	\$300.00 plus \$20.00 for each additional 100 acre-feet or any part thereof.

2. The fee for an application in which storage is requested, except for domestic use, shall be:

ACRE-FEET	FEE
0-250	\$200.00
More than 250	\$200.00 plus \$20.00 for each additional 250 acre-feet of storage or any part thereof.

Note: If an application requests both direct use *and* storage, the fee charged shall be as determined under No. 1 or No. 2 above, whichever is greater, but not both fees.

3. The fee for an application for a permit to appropriate water for water power or dewatering purposes shall be \$100.00 plus \$200.00 for each 100 cubic feet per second, or part thereof, of the diversion rate requested.

Note: The applicant shall notify the Chief Engineer and pay the statutorily required field inspection fee of \$400.00 when construction of the works for diversion has been completed, except that for applications filed on or after July 1, 2009, for works constructed for sediment control use and for evaporation from a groundwater pit for industrial use shall be accompanied by a field inspection fee of \$200.00.

### MAKE CHECKS PAYABLE TO THE KANSAS DEPARTMENT OF AGRICULTURE

#### ATTENTION

A Water Conservation Plan may be required per K.S.A. 82a-733. A statement that your application for permit to appropriate water may be subject to the minimum desirable streamflow requirements per K.S.A. 82a-703a, b, and c may also be required from you. After the Division of Water Resources has had the opportunity to review your application, you will be notified whether or not you will need to submit a Water Conservation Plan. You also may be required to install a water flow meter or water stage measuring device on your diversion works prior to diverting water. There may be other special conditions or Groundwater Management District regulations that you will need to comply with if this application is approved.

#### CONVERSION FACTORS

1 acre-foot equals 325,851 gallons

1 million gallons equal 3.07 acre-feet

## IRRIGATION USE SUPPLEMENTAL SHEET

File No. 50191

Name of Applicant (Please Print): Thane J Buss

1. Please supply the name and address of each landowner, the legal description of the lands to be irrigated, and designate the actual number of acres to be irrigated in each forty acre tract or fractional portion thereof:

**Landowner of Record** NAME: Thane J Buss // Charles C & Lou Ann Buss

ADDRESS: 1 Honeysuckle Ct, Oxford KS 67119 // ~~1692 E 30th Ave N, Oxford KS 67119~~

S	T	R	NE¼				NW¼				SW¼				SE¼				TOTAL
			NE	NW	SW	SE	NE	NW	SW	SE	NE	NW	SW	SE	NE	NW	SW	SE	
33	30	2E	36.5	21.5															58
34	30	2E						15.5	8.5										24
																		Total	82

**Landowner of Record** NAME: \_\_\_\_\_

ADDRESS: \_\_\_\_\_

S	T	R	NE¼				NW¼				SW¼				SE¼				TOTAL
			NE	NW	SW	SE	NE	NW	SW	SE	NE	NW	SW	SE	NE	NW	SW	SE	

**Landowner of Record** NAME: \_\_\_\_\_

ADDRESS: \_\_\_\_\_

S	T	R	NE¼				NW¼				SW¼				SE¼				TOTAL
			NE	NW	SW	SE	NE	NW	SW	SE	NE	NW	SW	SE	NE	NW	SW	SE	

2. Please complete the following information for the description of the operation for the irrigation project. Attach supplemental sheets as needed.

a. Indicate the soils in the field(s) and their intake rates:

Soil Name	Percent of field (%)	Intake Rate (in/hr)	Irrigation Design Group
<u>Lesko Clay loam</u>	<u>50</u>	<u>.2 - .6</u>	
<u>Dale Silt Loam</u>	<u>40</u>	<u>.6 - 2</u>	
<u>Canadian Sand loam</u>	<u>10</u>	<u>2-6</u>	
_____	_____	_____	_____
_____	_____	_____	_____
Total:	100 %		

b. Estimate the average land slope in the field(s): 0-1 %

Estimate the maximum land slope in the field(s): 3 %

c. Type of irrigation system you propose to use (check one):

- Center pivot      \_\_\_\_\_ Center pivot - LEPA      \_\_\_\_\_ "Big gun" sprinkler  
 \_\_\_\_\_ Gravity system (furrows)      \_\_\_\_\_ Gravity system (borders)      \_\_\_\_\_ Sideroll sprinkler

Other, please describe: \_\_\_\_\_

d. System design features:

i. Describe how you will control tailwater: Not applying runoff amounts.

ii. For sprinkler systems:

(1) Estimate the operating pressure at the distribution system: 40 psi

(2) What is the sprinkler package design rate? 800 gpm

(3) What is the wetted diameter (twice the distance the sprinkler throws water) of a sprinkler on the outer 100 feet of the system? 50 feet

(4) Please include a copy of the sprinkler package design information.

e. Crop(s) you intend to irrigate. Please note any planned crop rotations:

Corn, Soybeans, Wheat, Cotton all no-till in that rotation possibly

f. Please describe how you will determine when to irrigate and how much water to apply (particularly important if you do not plan a full irrigation).

I will factor in crop growth stage, soil water profile, weather outlook, and temperature to establish a watering schedule. Will apply a maximum of .75" of water per pass.

You may attach any additional information you believe will assist in informing the Division of the need for your request.



STATE OF KANSAS



DEPARTMENT OF AGRICULTURE  
1320 RESEARCH PARK DRIVE  
MANHATTAN, KS 66502  
PHONE: (785) 564-6700  
FAX: (785) 564-6777

900 SW JACKSON, ROOM 456  
TOPEKA, KS 66612  
PHONE: (785) 296-3556  
www.agriculture.ks.gov

GOVERNOR JEFF COLYER, M.D.  
JACKIE MCCLASKEY, SECRETARY OF AGRICULTURE

January 4, 2019

THANE J BUSS  
1 HONESUCKLE CT  
OXFORD, KS 67119

RE: Application, File No. **50191**

Dear Sir or Madam:

The Division of Water Resources (Division) has received your application for a permit to appropriate water for beneficial use. Your application has been assigned the file number referenced above. Please be aware that the Division may have a large number of pending applications on hand at times and makes every attempt to process them in the order in which they are received. You will be contacted if additional information is required.

Please note, this letter only acknowledges receipt of your application and does not guarantee approval. In accordance with the provisions of the Kansas Water Appropriation Act, the use of water as proposed prior to approval of the application is unlawful.

Additional information about the process may be found on our website at [agriculture.ks.gov/divisions-programs/dwr](http://agriculture.ks.gov/divisions-programs/dwr). If you have any other questions, please contact our office at 785-564-6640 or your local Stafford Field Office at 620-234-5311. If you call, please reference the file number so we can help you more efficiently.

Sincerely,

Brent Tourney, L.G.  
Change Applications Unit Supervisor  
Water Appropriation Program

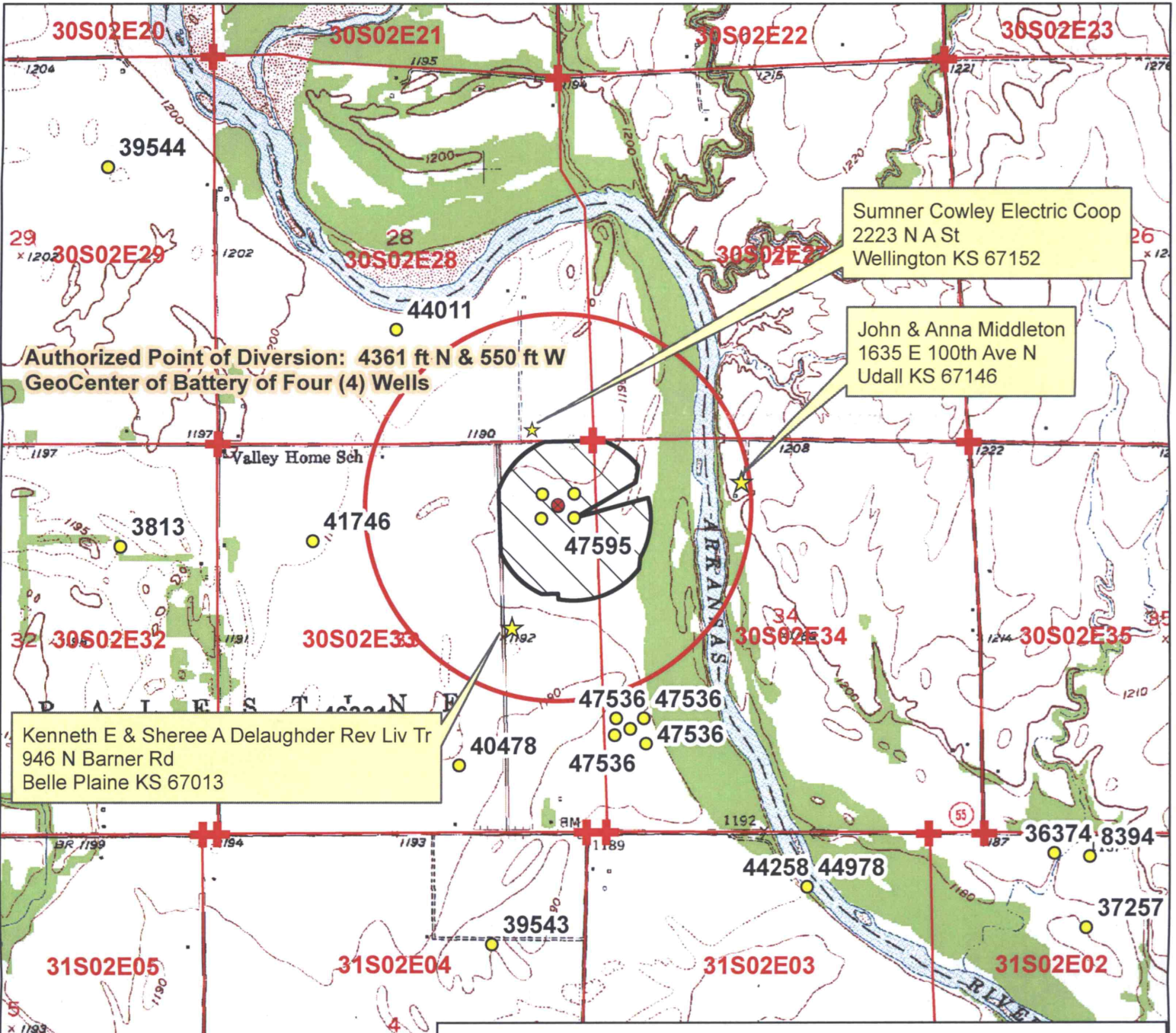

Sumner Cowley Electric Coop  
 2223 N A St  
 Wellington KS 67152

John & Anna Middleton  
 1635 E 100th Ave N  
 Udall KS 67146

Authorized Point of Diversion: 4361 ft N & 550 ft W  
 GeoCenter of Battery of Four (4) Wells

Kenneth E & Sheree A Delaughder Rev Liv Tr  
 946 N Barner Rd  
 Belle Plaine KS 67013



**Legend**

- Water Appropriations
- Proposed Point of Diversion
- ★ Domestic Well
- ⊕ Section Corner
- ▭ Section Lines
- Half Mile Circle

**Place of Use**

- ▭ Proposed

# Water Appropriation, File No. \_\_\_\_\_

New Application Map  
 33 & 34-30-2E // Sumner County

To the best of my knowledge, all wells within 1/2 mile of the authorized point of diversion have been shown.

Signature



12-17-18

(Date)

Kansas Department of Agriculture  
Division of Water Resources  
David W. Barfield, Chief Engineer  
1320 Research Park Drive  
Manhattan, Kansas 66502

Re: Application  
File No. 50191

Minimum Desirable Streamflow

Dear Sir:

I understand that a Minimum Desirable Streamflow requirement has been established by the legislature for the source of supply to which the above referenced application applies.

I understand that diversion of water pursuant to this application will be subject to regulation any time Minimum Desirable Streamflow requirements are not being met.

I also understand that if this application is approved, there could be times, as determined by the Division of Water Resources, when I would not be allowed to divert water. I realize that this could affect the economics of my decision to appropriate water.

I am aware of the above factors, and with the knowledge thereof, request that the Division of Water Resources proceed with processing and approval, if possible, of the above referenced application.

*[Handwritten Signature]*

Signature of Applicant

State of Kansas )  
County of Sumner ) ss

Thane Buss  
(Print Applicant's Name)

I hereby certify that the foregoing instrument was signed in my presence and sworn to before me this 17th day of December, 2018.

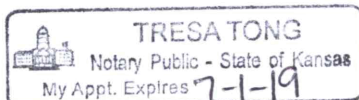

*[Handwritten Signature]*  
Notary Public

My Commission Expires:

**MINIMUM DESIRABLE STREAMFLOW FORM TO BE USED WHEN  
APPLICABLE WHEN FILING AN APPLICATION FOR PERMIT  
TO APPROPRIATE WATER FOR BENEFICIAL USE**

The Kansas Legislature has established minimum desirable streamflows for the streams listed below. If your proposed diversion of water is going to be from one of these watercourses or adjacent alluvial aquifers, please complete the back side of this page and submit it along with your application for permit to appropriate water.

Arkansas River  
Big Blue River  
Chapman Creek  
Chikaskia River  
Cottonwood River  
Delaware River  
Little Arkansas River  
Little Blue River  
Marais des Cygnes River  
Medicine Lodge River  
Mill Creek (Wabaunsee Co. area)  
Neosho River

Ninnescah River  
North Fork Ninnescah River  
Rattlesnake Creek  
Republican River  
Saline River  
Smoky Hill River  
Solomon River  
South Fork Ninnescah  
Spring River  
Walnut River  
Whitewater River