

Submit completed application to:
 Kansas Department of Agriculture
 Division of Water Resources
 Field Office for your area.

Call for address:

Topeka -- (785) 296-5733
 Stafford -- (620) 234-5311
 Stockton -- (785) 425-6787
 Garden City -- (620) 276-2901
<http://agriculture.ks.gov/dwr>

DWR FIELD OFFICE APPLICATION FOR APPROVAL TO CHANGE THE PLACE OF USE AND/OR THE POINT OF DIVERSION



STATE OF KANSAS

WATER METER REQUIRED

Filing Fee Must Accompany the Application, K.S.A. 82a-708b(b), as amended.
 Fee Schedule is on the third page of this application form.

Paragraph Nos. 1, 2, 3 & 5 must be completed. Complete all other applicable portions. If change in point of diversion is greater than 100 feet, or if place of use will be changed, include a topographic map or detailed plat showing the authorized and proposed point(s) of diversion and/or place of use.

File No. 17939

RECEIVED
 10:25 am
 NOV 15 2019

1. Application is hereby made for approval of the Chief Engineer to change the (check one or both):

Place of Use Point of Diversion

Stafford Field Office
 Division of Water Resources

under the water right which is the subject of this application in accordance with the conditions described below.

The source of supply is: Groundwater Surface water

2. Name and address of Applicant: Dudrey Cattle Co Inc

PO Box 65, Saint John KS 67576-0065

Phone Number: (620)793-2093

Email address: _____

Name and address of Water Use Correspondent: Carl E Dudrey Estate

PO Box 65, Saint John KS 67576-0065

Phone Number: (620)793-2093

Email address: _____

3. The presently authorized place of use is:

Owner of Land ---- NAME: A.) Dudrey Cattle Co Inc // B.) Brent G & Marsella G Hearn JTWROS

ADDRESS: A.) PO Box 65, Saint John KS 67576-0065 // B.) 100 Chesnut St, Stafford KS 67578

(If there is more than one landowner, attach supplemental sheets as necessary.)

Sec.	Twp.	Range	NE¼				NW¼				SW¼				SE¼				TOTAL ACRES
			NE¼	NW¼	SW¼	SE¼	NE¼	NW¼	SW¼	SE¼	NE¼	NW¼	SW¼	SE¼	NE¼	NW¼	SW¼	SE¼	
A.) 34	24	12W	33.5	40	40	40													153.5
B.) 34	24	12W	6.5																6.5
																		Total : 160	

4. If this application is for a change in place of use, it is proposed that the place of use be changed to:

Owner of Land ---- NAME: No Change

ADDRESS: ---

(If there is more than one landowner, attach supplemental sheets as necessary.)

Sec.	Twp.	Range	NE¼				NW¼				SW¼				SE¼				TOTAL ACRES
			NE¼	NW¼	SW¼	SE¼	NE¼	NW¼	SW¼	SE¼	NE¼	NW¼	SW¼	SE¼	NE¼	NW¼	SW¼	SE¼	

For Office Use Only: Code _____ Fee \$ 200 - TR # _____ Receipt Date _____ Check # 8577

5. **Presently authorized point of diversion:**
 One in the _____ Quarter of the _____ Quarter of the CW NE Quarter
 of Section 34, Township 24 South, Range 12 W,
 in Stafford County, Kansas, 3880 feet North 2610 feet West of Southeast corner of section.
 Authorized Rate 1000 GPM Authorized Quantity 198 AF Depth of well 70 (feet)
(DWR use only: Computer ID No. 4 GPS 3918 feet North 2640 feet West)
 This point will not be changed This point will be changed as follows: No change, point better described with GPS as follows:
Proposed point of diversion: (Complete only if change is requested or if existing point is better described by GPS)
 One in the _____ Quarter of the _____ Quarter of the CW SW NE Quarter
 of Section 34, Township 24 South, Range 12 W,
 in Stafford County, Kansas, 3240 feet North 2630 feet West of Southeast corner of section.
 Proposed Rate No Change Proposed Quantity No Change Proposed well depth (feet) 70 (FIR).
 This point is: Additional Well Geo Center List other water rights that will use this point 22579.

6. **Presently authorized point of diversion:**
 One in the _____ Quarter of the _____ Quarter of the _____ Quarter
 of Section _____, Township _____ South, Range _____ (E/W),
 in _____ County, Kansas, _____ feet North _____ feet West of Southeast corner of section.
 Authorized Rate _____ Authorized Quantity _____ Depth of well _____ (feet)
(DWR use only: Computer ID No. _____ GPS _____ feet North _____ feet West)
 This point will not be changed This point will be changed as follows: No change, point better described with GPS as follows:
Proposed point of diversion: (Complete only if change is requested or if existing point is better described by GPS)
 One in the _____ Quarter of the _____ Quarter of the _____ Quarter
 of Section _____, Township _____ South, Range _____ (E/W),
 in _____ County, Kansas, _____ feet North _____ feet West of Southeast corner of section.
 Proposed Rate _____ Proposed Quantity _____ Proposed well depth (feet) _____.
 This point is: Additional Well Geo Center List other water rights that will use this point _____.

7. The changes herein are desired for the following reasons?
 (please be specific) Moving the PD (entire rate and quant)
authorized under File No. 17939 and stacking the PD on
the well currently authorized by File No. 22579.

8. If a well, is the test hole log attached? Yes No

9. The change(s) (was)(will be) completed by?
Upon Approval

10. If the point of diversion is a well:
 (a) What are you going to do with the old well?
Disconnect electrical supply from old well.
 (b) When will this be done? After approval

11. Groundwater Management District recommendation attached?
 Yes No

12. Assisted by TJS - SFFO

13a. If the proposed point of diversion will be relocated more than 300
feet but within 2,640 feet of the existing point of diversion, attach
 a topographic map or aerial photograph. For groundwater
 sources, show all wells (including domestic) within one-half mile
 of the proposed point of diversion and the names and mailing
 addresses of the owners. For surface water sources, show the
 names and addresses of the landowner(s) one-half mile
 downstream and one-half mile upstream from your property
 lines

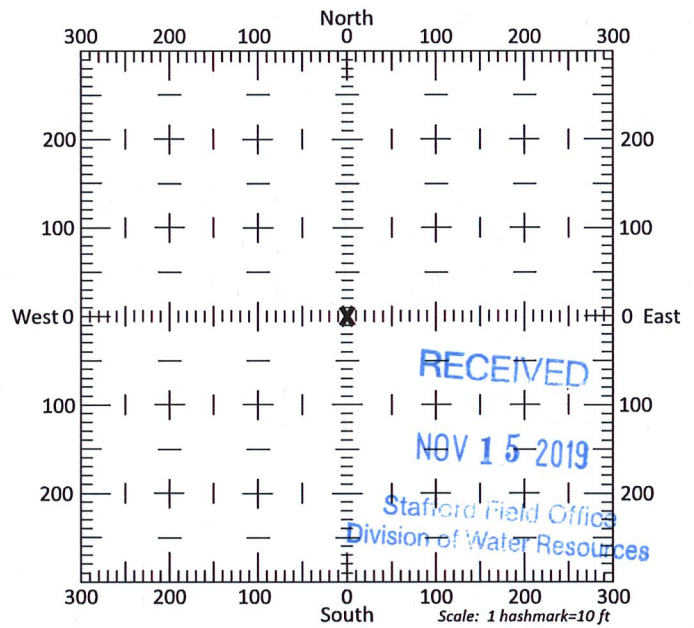

13b. If the proposed point of diversion will be relocated within 300 feet
 of the existing point of diversion, indicate its location on the
 diagram shown above in relation to the existing point of
 diversion. (PLEASE NOTE: The "X" in center of diagram
 above represents the presently authorized point of
 diversion.)

14. If the proposed groundwater point of diversion is 300 or fewer feet from the existing point of diversion, complete the following:
- (a) Does the undersigned represent all owners of the currently authorized place(s) of use identified in this application?
 Yes No (If no, all owners must sign this application.)
 - (b) Will the ownership interest of any owner of the currently authorized place(s) of use identified in this application be adversely affected if this application is approved as requested?
 Yes No (If yes, all owners must sign this application.)
 - (c) If this application is not approved expeditiously, will there be substantial damage to property, public health or safety?
 Yes No (If no, all owners must sign this application.)

If the application proposes a surface water change in point of diversion, a groundwater change in point of diversion greater than 300 feet, or a change in place of use, the application must be signed by all owners of the currently authorized place of use, or their duly authorized agent (attach notarized statement authorizing representation).

I hereby verify, being first duly sworn upon my oath or affirmation and under penalty of perjury, that I am of lawful age and the owner, the spouse of the owner, or a duly authorized agent of the owner(s) to make this application on their behalf, in regards to the water right(s) to which this application pertains. I further verify that the statements contained in this application are true, correct and complete.

Dated at _____, Kansas, this _____ day of _____, 20_____.

Brent G. Hearn
 (Owner)
Brent G. Hearn
 (Please Print)

 (Owner)

 (Please Print)

 (Owner)

 (Please Print)

Marsella G. Hearn
 (Spouse)
Marsella G. Hearn
 (Please Print)

 (Spouse)

 (Please Print)

 (Spouse)

 (Please Print)

State of Kansas }
 County of Stafford } SS

I hereby certify that the foregoing application was signed in my presence and sworn to before me this 22 day of November, 2019.

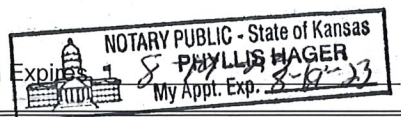

Phyllis Hager
 Notary Public

ONLY COMPLETE APPLICATIONS WILL BE PROCESSED. To be complete, all of the applicable portions of the application form must be completed with accurate information; maps, if necessary, must be included; signatures of all the appropriate owners' must be affixed to the application and notarized; and the appropriate fee must be paid.

FEE SCHEDULE

Each application to change the place of use or the point of diversion under this section shall be accompanied by the application fee set forth in the schedule below: Make checks payable to: **Kansas Department of Agriculture**

- (1) Application to change a point of diversion 300 feet or less \$100
- (2) Application to change a point of diversion more than 300 feet \$200
- (3) Application to change the place of use \$200

RECEIVED

NOV 22 2019

14. If the proposed groundwater point of diversion is 300 or fewer feet from the existing point of diversion, complete the following:
- (a) Does the undersigned represent all owners of the currently authorized place(s) of use identified in this application?
 Yes No (If no, all owners must sign this application.)
 - (b) Will the ownership interest of any owner of the currently authorized place(s) of use identified in this application be adversely affected if this application is approved as requested?
 Yes No (If yes, all owners must sign this application.)
 - (c) If this application is not approved expeditiously, will there be substantial damage to property, public health or safety?
 Yes No (If no, all owners must sign this application.)

If the application proposes a surface water change in point of diversion, a groundwater change in point of diversion greater than 300 feet, or a change in place of use, the application must be signed by all owners of the currently authorized place of use, or their duly authorized agent (attach notarized statement authorizing representation).

I hereby verify, being first duly sworn upon my oath or affirmation and under penalty of perjury, that I am of lawful age and the owner, the spouse of the owner, or a duly authorized agent of the owner(s) to make this application on their behalf, in regards to the water right(s) to which this application pertains. I further verify that the statements contained in this application are true, correct and complete.

Dated at St. John, Kansas, this 15th day of NOVEMBER, 2019.

Richard A. Ball, Pres.
 (Owner)

 (Spouse)

RICHARD A. Ball
 (Please Print)

 (Please Print)

 (Owner)

 (Spouse)

 (Please Print)

 (Please Print)

 (Owner)

 (Spouse)

 (Please Print)

 (Please Print)

State of Kansas }
 County of Stafford } SS

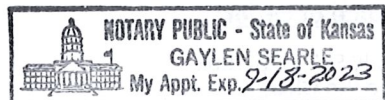

I hereby certify that the foregoing application was signed in my presence and sworn to before me this 15th day of November, 2019.

Gaylen Searle
 Notary Public

My Commission Expires 9/18/2023.

ONLY COMPLETE APPLICATIONS WILL BE PROCESSED. To be complete, all of the applicable portions of the application form must be completed with accurate information; maps, if necessary, must be included; signatures of all the appropriate owners' must be affixed to the application and notarized; and the appropriate fee must be paid.

FEE SCHEDULE

Each application to change the place of use or the point of diversion under this section shall be accompanied by the application fee set forth in the schedule below: Make checks payable to: **Kansas Department of Agriculture**

- (1) Application to change a point of diversion 300 feet or less \$100
- (2) Application to change a point of diversion more than 300 feet **\$200**
- (3) Application to change the place of use \$200

RECEIVED
 NOV 15 2019
 Stafford Field Office
 Division of Water Resources

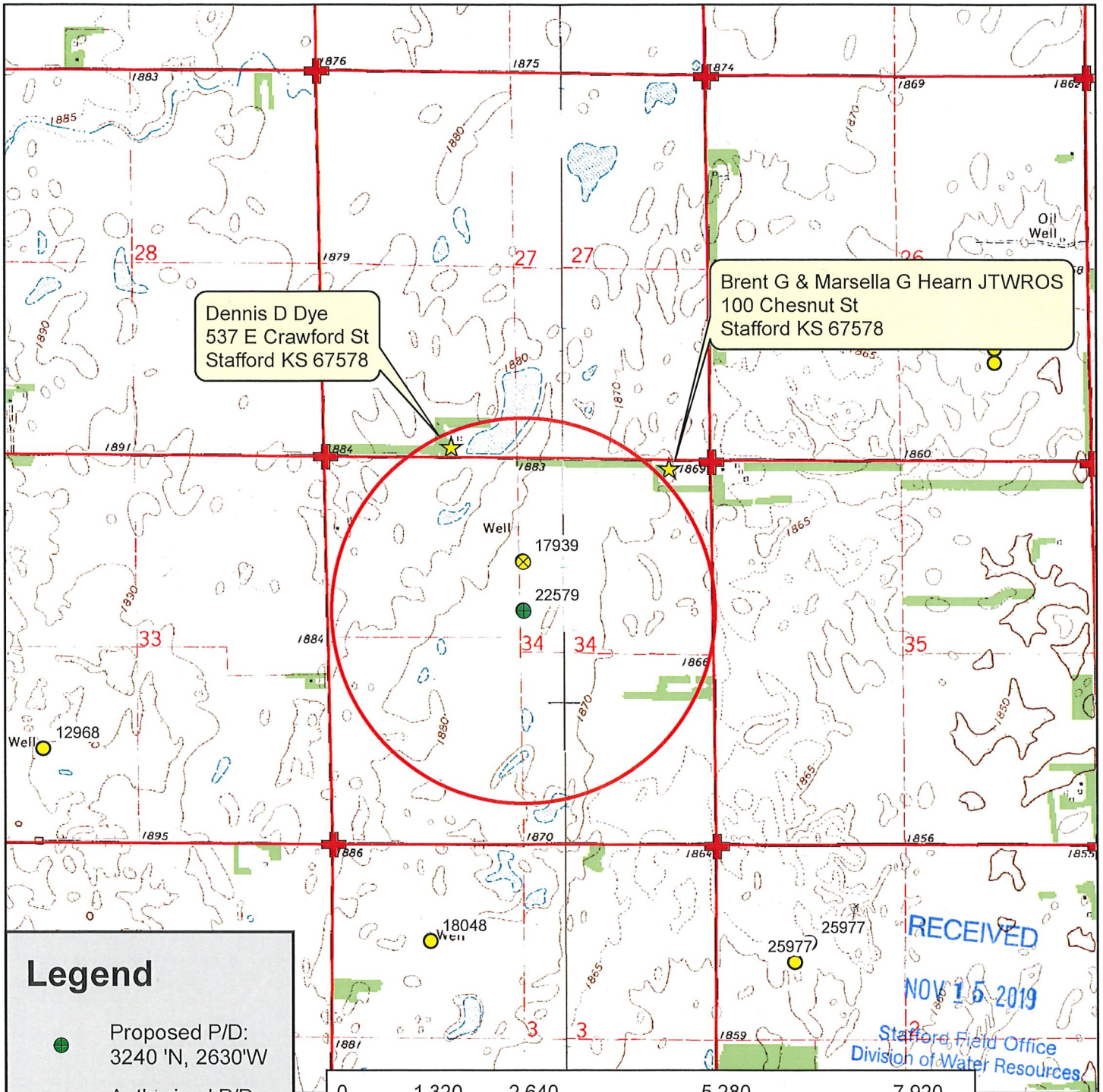

Legend

- Proposed P/D: 3240 'N, 2630'W
- ⊗ Authorized P/D: 3918'N, 2640'W
- Water Appropriations
- + Section Corner
- Section Line
- ★ Domestic Well
- 1/2 Mile Buffer



Water Right, File No. 17939
 Change in Point of Diversion, Application Map
 34-24S-12W // Stafford County



To the best of my knowledge, all water wells including domestic, within 1/2 mile of the proposed point of diversion have been shown.

Deborah A. Ball, Pres. 11/15/19

Signature

11/12/19 TJS-SFFO 1:24,000 scale