

Kansas Department of Agriculture
 Division of Water Resources
CHANGE: P/U WORKSHEET

1. File Number: 18540	2. Status Change Date:	3. Change Num: 1	4. Field Office: 02	5. GMD: 05
---------------------------------	------------------------	----------------------------	-------------------------------	----------------------

6. Status: <input checked="" type="checkbox"/> Approved <input type="checkbox"/> Denied by DWR/GMD <input type="checkbox"/> Dismiss by Request/Failure to Return	7. Filing Date of Change: 4/2/19
--	--

8a. Applicant(s) New to system <input type="checkbox"/> Person ID _____ Add Seq# _____	8c. Landowner(s) New to system <input type="checkbox"/> Person ID _____ Add Seq# _____
---	---

8b. Landowner(s) New to system <input type="checkbox"/> Person ID 61501 Add Seq# 1 BRENT A & AMBER M RUGAN 557 NE 210TH ST ELLINWOOD KS 67526-9291	8d. WUC New to system <input type="checkbox"/> Person ID 61501 Add Seq# 1 NO CHANGE BRENT A & AMBER M RUGAN 557 NE 210TH ST ELLINWOOD KS 67526-9291
---	--

9. Documents and Enclosure(s): DWR Meter(s) Date to Comply: **12/31/19** N & P Date to Comply: _____

Anti-Reverse Meter Meter Seal Check Valve N & P Form Water Tube Driller Copy H & E Letter

Conservation Plan Date Required: _____ Date Approved: **4/25/19** Date to Comply: _____

10. Use Made of Water From: _____ To: _____

Date Prepared: **4/23/19** By: **TJS**
 Date Entered: _____ By: _____

File No. **18540** 11. County: **BARTON** Basin: **Arkansas River** Stream: --- Formation Code: --- Special Use: **None**

12. Points of Diversion										Rate and Quantity				
CHK										Authorized		Additional		
MOD	PDIV	Qualifier	S	T	R	ID	'N	'W	Comment (AKA Line)	Rate gpm/cfs	Quantity af/mgy	Rate gpm/cfs	Quantity af/mgy	Overlap PD Files
MOD	13405	Lot 2 (SW NW)	19	20S	13W	2	3839*	4818*		No change to rate or quantity			20177113-MF	

13. Storage: Rate _____ NF Quantity _____ ac/ft Additional Rate _____ NF Additional Quantity _____ ac/ft

14. Limitation: _____ af/yr at _____ gpm (_____ cfs) when combined with file number(s) _____
 Limitation: _____ af/yr at _____ gpm (_____ cfs) when combined with file number(s) _____

15. 5YR Allocation: Allocation Type _____ Start Year _____ 5 YR Amount _____ Amount Unit _____ Base Acres _____ Comment _____

16. Place of Use										NE¼				NW¼				SW¼				SE¼				Total	Owner	Chg?	Overlap Files	
CHK										NE	NW	SW	SE	NE	NW	SW	SE	NE	NW	SW	SE	NE	NW	SW	SE					
MOD	DEL	ENT	PUSE	S	T	R	ID	NE	NW	SW	SE	NE	NW	SW	SE	NE	NW	SW	SE	NE	NW	SW	SE							
MOD	26901	19	20S	13W	1							11	Lot 1 26	Lot 2 27.5	12.5											77	8b.	No	20177113-MF	

Base Acres: **70** Year: **See File** Minimum Reasonable Quantity: **1.18 AF/acre**
 Comments: ***PD is not actually changing, just better describing footages based on GPS data.**

Submit completed application to:
 Kansas Department of Agriculture
 Division of Water Resources
 Field Office for your area.
 Call for address:

Topeka -- (785) 296-5733
 Stafford -- (620) 234-5311
 Stockton -- (785) 425-6787
 Garden City -- (620) 276-2901
<http://agriculture.ks.gov/dwr>

DWR FIELD OFFICE APPLICATION FOR APPROVAL TO CHANGE THE PLACE OF USE AND/OR THE POINT OF DIVERSION



STATE OF KANSAS

WATER METER REQUIRED

Filing Fee Must Accompany the Application, K.S.A. 82a-708b(b), as amended.
 Fee Schedule is on the third page of this application form.

Paragraph Nos. 1, 2, 3 & 5 must be completed. Complete all other applicable portions. If change in point of diversion is greater than 100 feet, or if place of use will be changed, include a topographic map or detailed plat showing the authorized and proposed point(s) of diversion and/or place of use.

RECEIVED
 10:05am
 APR 02 2019

File No. 18540

1. Application is hereby made for approval of the Chief Engineer to change the (check one or both):

Place of Use Point of Diversion

under the water right which is the subject of this application in accordance with the conditions described below.

The source of supply is: Groundwater Surface water

Stafford Field Office
 Division of Water Resources

2. Name and address of Applicant: Brent Rugan

557 NE 210th St, Ellinwood KS 67526

Phone Number: (620)564-2216

Email address: brentrugan@gmail.com

Name and address of Water Use Correspondent: Brent A & Amber M Rugan

557 NE 210th St, Ellinwood KS 67526

Phone Number: (620)564-2216

Email address: brentrugan@gmail.com

3. The presently authorized place of use is:

Owner of Land --- NAME: Brent A & Amber M Rugan

ADDRESS: 557 NE 210th St, Ellinwood KS 67526

(If there is more than one landowner, attach supplemental sheets as necessary.)

Sec.	Twp.	Range	NE¼				NW¼				SW¼				SE¼				TOTAL ACRES
			NE¼	NW¼	SW¼	SE¼	NE¼	NW¼	SW¼	SE¼	NE¼	NW¼	SW¼	SE¼	NE¼	NW¼	SW¼	SE¼	
19	20S	13W					11	Lot 1 29	Lot 2 19	11									70

4. If this application is for a change in place of use, it is proposed that the place of use be changed to:

Owner of Land --- NAME: Brent A & Amber M Rugan

ADDRESS: 557 NE 210th St, Ellinwood KS 67526

(If there is more than one landowner, attach supplemental sheets as necessary.)

Sec.	Twp.	Range	NE¼				NW¼				SW¼				SE¼				TOTAL ACRES
			NE¼	NW¼	SW¼	SE¼	NE¼	NW¼	SW¼	SE¼	NE¼	NW¼	SW¼	SE¼	NE¼	NW¼	SW¼	SE¼	
19	20S	13W					11	Lot 1 26	Lot 2 27.5	12.5									77

For Office Use Only: Code _____ Fee \$ 200 - TR # _____ Receipt Date _____ Check # 2902

5. **Presently authorized point of diversion:**
 One in the _____ Quarter of the _____ Quarter of the Lot 2 (SW NW) Quarter
 of Section 19, Township 20 South, Range 13 W,
 in Barton _____ County, Kansas, 3820 feet North 4790 feet West of Southeast corner of section.
 Authorized Rate 800 GPM Authorized Quantity 101 AF Depth of well -- (feet)
(DWR use only: Computer ID No. 2 GPS 3839 feet North 4818 feet West)
 This point will not be changed This point will be changed as follows: No change, point better described with GPS as follows:
Proposed point of diversion: (Complete only if change is requested or if existing point is better described by GPS)
 One in the _____ Quarter of the _____ Quarter of the Lot 2 (SW NW) Quarter
 of Section 19, Township 20 South, Range 13 W,
 in Barton _____ County, Kansas, 3839 feet North 4818 feet West of Southeast corner of section.
 Proposed Rate No Change Proposed Quantity No Change Proposed well depth (feet) NA.
 This point is: Additional Well Geo Center List other water rights that will use this point 20177113-MF.

6. **Presently authorized point of diversion:**
 One in the _____ Quarter of the _____ Quarter of the _____ Quarter
 of Section _____, Township _____ South, Range _____ (E/W),
 in _____ County, Kansas, _____ feet North _____ feet West of Southeast corner of section.
 Authorized Rate _____ Authorized Quantity _____ Depth of well _____ (feet)
(DWR use only: Computer ID No. _____ GPS _____ feet North _____ feet West)
 This point will not be changed This point will be changed as follows: No change, point better described with GPS as follows:
Proposed point of diversion: (Complete only if change is requested or if existing point is better described by GPS)
 One in the _____ Quarter of the _____ Quarter of the _____ Quarter
 of Section _____, Township _____ South, Range _____ (E/W),
 in _____ County, Kansas, _____ feet North _____ feet West of Southeast corner of section.
 Proposed Rate _____ Proposed Quantity _____ Proposed well depth (feet) _____.
 This point is: Additional Well Geo Center List other water rights that will use this point _____.

7. The changes herein are desired for the following reasons?
 (please be specific) Modifying the place of use.

8. If a well, is the test hole log attached? Yes No

9. The change(s) (was)(will be) completed by?
ASAP

10. If the point of diversion is a well:
 (a) What are you going to do with the old well?
NA

(b) When will this be done? NA

11. Groundwater Management District recommendation
 attached? Yes No

12. Assisted by TJS- SFFO

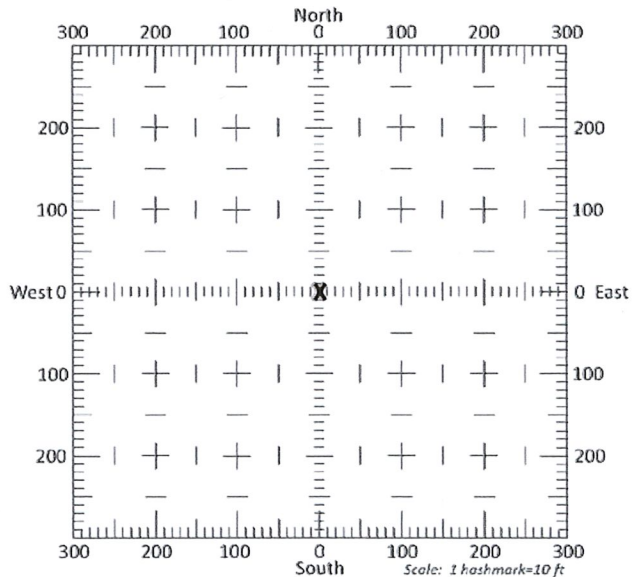

13a. If the proposed point of diversion will be relocated more than 300 feet but within 2,640 feet of the existing point of diversion, attach a topographic map or aerial photograph. For groundwater sources, show all wells (including domestic) within one-half mile of the proposed point of diversion and the names and mailing addresses of the owners. For surface water sources, show the names and addresses of the landowner(s) one-half mile downstream and one-half mile upstream from your property lines

13b. If the proposed point of diversion will be relocated within 300 feet of the existing point of diversion, indicate its location on the diagram shown above in relation to the existing point of diversion. (PLEASE NOTE: The "X" in center of diagram above represents the presently authorized point of diversion.)

14. If the proposed groundwater point of diversion is 300 or fewer feet from the existing point of diversion, complete the following:
- (a) Does the undersigned represent all owners of the currently authorized place(s) of use identified in this application?
 Yes No (If no, all owners must sign this application.)
 - (b) Will the ownership interest of any owner of the currently authorized place(s) of use identified in this application be adversely affected if this application is approved as requested?
 Yes No (If yes, all owners must sign this application.)
 - (c) If this application is not approved expeditiously, will there be substantial damage to property, public health or safety?
 Yes No (If no, all owners must sign this application.)

If the application proposes a surface water change in point of diversion, a groundwater change in point of diversion greater than 300 feet, or a change in place of use, the application must be signed by all owners of the currently authorized place of use, or their duly authorized agent (attach notarized statement authorizing representation).

I hereby verify, being first duly sworn upon my oath or affirmation and under penalty of perjury, that I am of lawful age and the owner, the spouse of the owner, or a duly authorized agent of the owner(s) to make this application on their behalf, in regards to the water right(s) to which this application pertains. I further verify that the statements contained in this application are true, correct and complete.

Dated at Great Bend, Kansas, this 1st day of April, 2019.

Brent A Rugan
 (Owner)
Brent A Rugan
 (Please Print)

 (Owner)

 (Please Print)

 (Owner)

 (Please Print)

Amber Rugan
 (Spouse)
AMBER Rugan
 (Please Print)

 (Spouse)

 (Please Print)

 (Spouse)

 (Please Print)

State of Kansas }
 County of Barton } SS

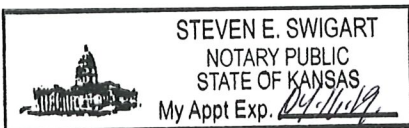

I hereby certify that the foregoing application was signed in my presence and sworn to before me this 1st day of April, 2019.

Steven E Swigart
 Notary Public

My Commission Expires Dec 11 2019

ONLY COMPLETE APPLICATIONS WILL BE PROCESSED. To be complete, all of the applicable portions of the application form must be completed with accurate information; maps, if necessary, must be included; signatures of all the appropriate owners' must be affixed to the application and notarized; and the appropriate fee must be paid.

FEE SCHEDULE

- Each application to change the place of use or the point of diversion under this section shall be accompanied by the application fee set forth in the schedule below: Make checks payable to: **Kansas Department of Agriculture**
- (1) Application to change a point of diversion 300 feet or less \$100
 - (2) Application to change a point of diversion more than 300 feet \$200
 - (3) Application to change the place of use \$200

RECEIVED File No. 18540

APR 02 2019

Stafford Field Office
 Division of Water Resources

SUMMARY ORDER APPROVING APPLICATION FOR CHANGE AND IMPOSING CONDITIONS

This Summary Order is issued under authority of K.S.A. 82a-708b, as amended, and K.A.R. 5-5-1, *et seq.* and other applicable provisions of the *Kansas Water Appropriation Law, K.S.A. 82a-701 et. seq.*, and rules and regulations promulgated thereunder, With the exception of those conditions expressly contained herein, this Summary Order does not change the terms, conditions and limitations of File No. 18540.

1. A change application was received on April 2, 2019 requesting that the place of use and / or point of diversion authorized under the above-referenced file number be changed as described in the application.
2. On and after the effective date of this summary order, the authorized place(s) of use shall be located substantially as shown on the topographic map accompanying the application to change the place of use. Applicable Not Applicable
3. The change in point of diversion shall not impair existing rights and shall be limited to the same source or sources of water as previously authorized. The point of diversion authorized by this summary order shall be located within a _____ foot radius of the authorized point(s) of diversion. Applicable Not Applicable
4. The point(s) of diversion described herein is administratively corrected to be more accurately described using the Global Positioning System (GPS), as described in the application. Applicable Not Applicable
5. The point(s) of diversion authorized herein shall not actually be located more than _____ feet from the previously authorized point(s) of diversion. Applicable Not Applicable
6. As required by K.A.R. 5-3-5d, if the works for diversion is a well with a diversion rate of 100 gallons per minute or more, a tube or other device suitable for making water level measurements shall be installed, operated and maintained in accordance with K.A.R. 5-6-13. Applicable Not Applicable
7. **The owner of the authorized place(s) of use shall properly install an acceptable water flow meter on or before December 31, 2019**, or before the first use of water, whichever occurs first. The water flow meter shall be installed, operated and maintained in accordance with K.A.R. 5-1-4 through 5-1-12. As required by K.S.A. 82a-732, as amended, and K.A.R. 5-3-5e, the owner shall maintain records and report the reading of the water flow meter and the total quantity of water diverted annually to the Chief Engineer by March 1 following the end of each calendar year. Applicable Not Applicable
8. **Installation of the works for diversion of water shall be completed on or before December 31, 20____**, or within any authorized extension of time. By March 1, 20____ the applicant shall notify the Chief Engineer that construction of the works for diversion has been completed, on the form provided by the Chief Engineer, as required by K.A.R. 5-8-4e. Applicable Not Applicable
9. **The completed well log shall be submitted with the required notice.** Applicable Not Applicable
10. All diversion works into which any type of chemical or other foreign substance will be injected into the water shall be equipped with an in-line, automatic, quick-closing check valve capable of preventing pollution of the source of the water supply. The check valve(s) shall be installed, operated and maintained in accordance with K.A.R. 5-3-5c. Applicable Not Applicable
11. Additional Conditions are attached. Yes No
12. In accordance with K.S.A. 82a-708a, as amended, and K.A.R. 5-5-14, all of the owners of the authorized place(s) of use of water appropriated under the above-referenced file number are responsible for compliance with its terms, conditions and limitations, as amended and/or supplemented by this Summary Order, and with applicable provisions of the *Kansas Water Appropriation Law* and the *Rules and Regulations* promulgated thereunder. Failure to comply with these provisions may result in civil penalties pursuant to K.S.A. 82a-737, as amended, and/or the suspension or revocation and dismissal of the water or appropriation right or any other enforcement actions authorized by law.

Administrative Appeal and Effective Date of Order

If you are aggrieved by this order, pursuant to K.S.A. 82a-1901, you may request an evidentiary hearing before the Chief Engineer or request administrative review by the Secretary of Agriculture. A request for hearing by the Chief Engineer must be filed within **15 days** of service of this Order and a request for administrative review by the Secretary must be filed within **30 days** pursuant to K.S.A. 77-531. Any request for administrative review must state a basis for review pursuant to K.S.A. 77-527. File any request with **Kansas Department of Agriculture, Legal Division, 1320 Research Park Drive, Manhattan, KS 66502**. Failure to timely request a hearing or review may preclude review under the Kansas Judicial Review Act.

For Use by Register of Deeds

FOR OFFICE USE ONLY
APPLICATION APPROVED AND SUMMARY ORDER ISSUED

By: Cameron R. Conant
Duly Authorized Designee of the Chief Engineer

(Print Name): Cameron R. Conant
Division of Water Resources - Kansas Department of Agriculture

Date of Issuance: April 25, 2019

State of Kansas)
County of Stafford) SS

Acknowledged before me on 4/25/19
by Cameron Conant

Signature: Jessica Engelbrecht
Notary Public

My commission expires _____

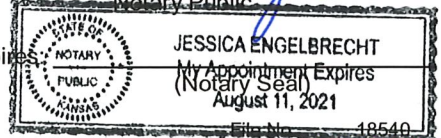

RECEIVED

APR 02 2019

Stafford Field Office
Division of Water Resources

**ADDITIONAL CONDITIONS TO SUMMARY ORDER APPROVING
APPLICATION FOR CHANGE AND IMPOSING CONDITIONS**

The effective date of the change shall be the date this order is executed by the Chief Engineer, after which Water Right, File No. 18540 shall be subject to the following conditions:

- 11a. If the water flowmeter is replaced with a new flowmeter then the owner of the authorized place(s) of use shall properly install an anti-reverse totalizing water flowmeter which meets or exceeds specifications adopted by the Chief Engineer

- 11b. A seal shall be placed on the water flowmeter by the Division of Water Resources in such a manner as to render the meter non-removable from the measuring chamber without breaking the seal. If the seal is broken without the permission of the chief engineer, this shall create a rebuttable presumption that the point of diversion had been unlawfully operated in violation of the order of the chief engineer and that the water right holder had been acting in violation of the conditions of his or her water right.

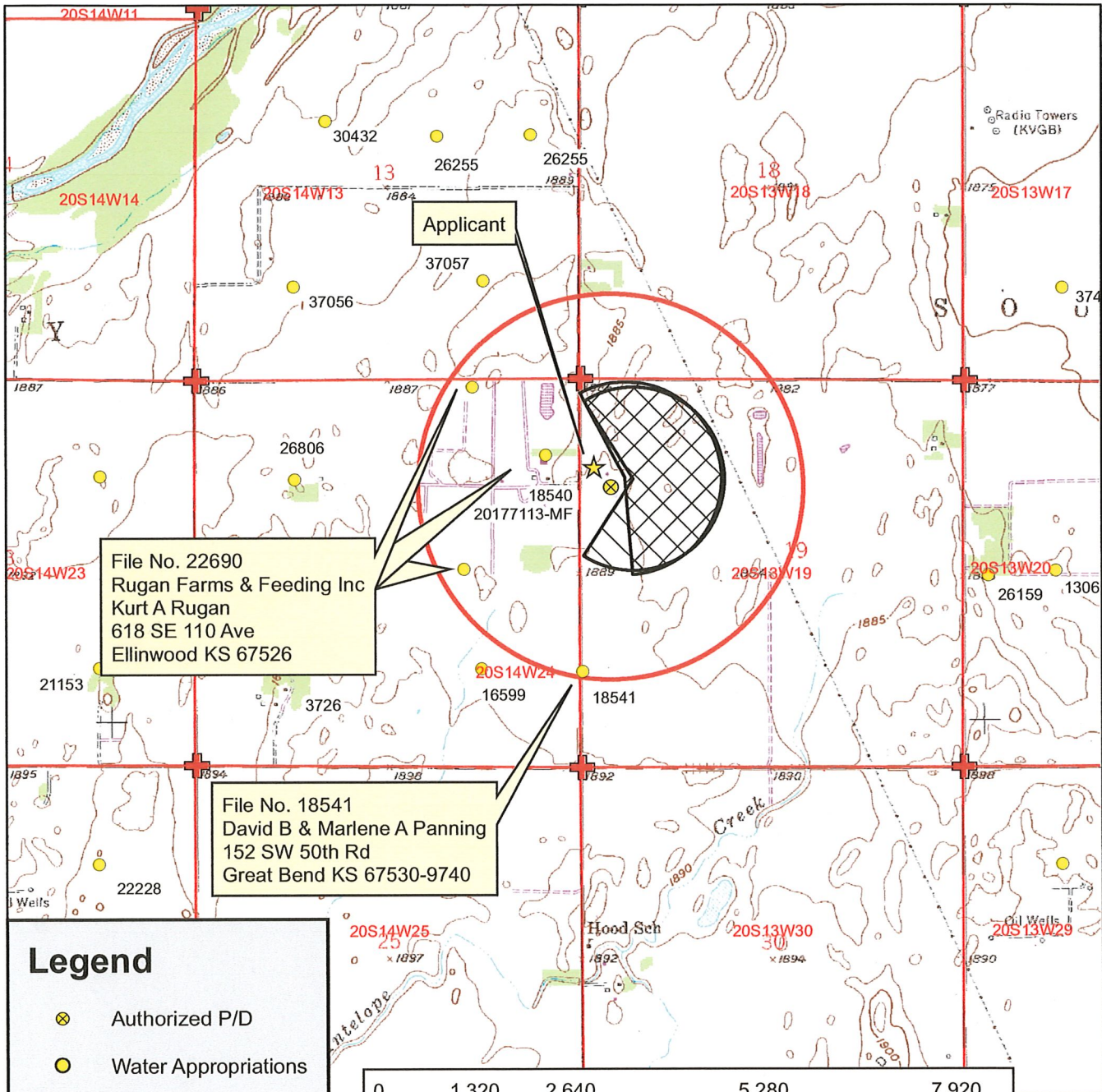

File No. 22690
 Rugan Farms & Feeding Inc
 Kurt A Rugan
 618 SE 110 Ave
 Ellinwood KS 67526

File No. 18541
 David B & Marlene A Panning
 152 SW 50th Rd
 Great Bend KS 67530-9740

Legend

- ⊗ Authorized P/D
- Water Appropriations
- ★ Domestic Well
- Section Line
- ⊕ Section Corner
- 1/2 Mile Buffer

Place of Use

- ▨ Proposed
- ▩ Authorized

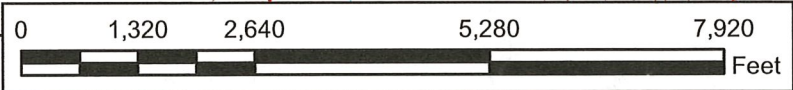

Water Right, File No. 18,540
 Change in Place of Use, Application Map
 19-20S-13W // Barton County



To the best of my knowledge, all water wells including domestic, within 1/2 mile of the authorized point of diversion have been shown.

[Handwritten Signature]

Signature

RECEIVED

3/22/2019 TJS-SFFO 1:24,000 scale

APR 02 2019

Stafford Field Office
300 S. Main Street
Stafford, KS 67578-1521



Phone: 620-234-5311
Fax: 620-234-6900
www.agriculture.ks.gov

Mike Beam, Interim Secretary

Laura Kelly, Governor

April 25, 2019

Brent Rugan
557 NE 210th St
Ellinwood, KS 67526

Re: Water Right, File No(s). 18540

Dear Water Right Owner:

Enclosed is the order executed by the Chief Engineer, Division of Water Resources, Kansas Department of Agriculture, approving the application for change under the above referenced file number(s).

Your attention is directed to the enclosures and to the terms, conditions and limitations specified in this approval for change. An acceptable water flow meter must be installed on your well before any water is applied as authorized under this change approval. A copy of the approved list of Certified Water Flowmeters as well as the regulations regarding the installation of flowmeters, measurement tubes and check valves can be found at <http://agriculture.ks.gov/divisions-programs/dwr/water-appropriation/water-flowmeters>. If you do not have access to the internet, please contact this office and we will send you a paper copy of the referenced information.

Since this order modifies the original document referred to above, it should be recorded with the Register of Deeds as other instruments affecting real estate.

Should you have any questions, please feel free to contact this office. If you wish to refer to a specific file, please reference it when you contact us.

Sincerely,

A handwritten signature in black ink, appearing to read "Jeff Lanterman".

Jeff Lanterman
Water Commissioner

Enclosures

pc: Water Rights Section
Groundwater Management District No. 5

CERTIFICATE OF SERVICE

On this **25th** day of **April, 2019**, I hereby certify that the attached Change of Place of Use for Water Right, File No. **18540**, dated **April 25th, 2019** was mailed via Certified U.S. mail to the following:

Brent Rugan
557 NE 210th St
Ellinwood, KS 67526

A copy of the letter was sent via First Class U.S. Mail to the following:

GMD 5



Staff



KANSAS DEPARTMENT OF AGRICULTURE

Division of Water Resources

Stafford Field Office

MEMORANDUM

TO: File

DATE: 4/9/2019

FROM: Tyler Saryerwinnie

RE: File No. 18540

This is a memorandum regarding surrounding well owner notification on irrigation field office PU changes and pertains to decisions made during the Water Commissioner meeting which took place on 11/16/2016 with directive from Lane Letourneau Program Manager.

This is applicable to field office changes to increase the place of use by 10 acres or 10% (whichever is less) or a change in place of use to create a complete overlap in which no new acres are being irrigated.

During that meeting it was determined that no surrounding well owner notification will be sent under this type of Place of Use change. All well rates and quantities will remain unchanged and the referenced change will not cause impairment or impact surrounding well owners.

The change in place of use filed on 4/2/2019 for the above referenced file meets this criteria and surrounding well owners will not be notified.

Saryerwinnie, Tyler [KDA]

From: Saryerwinnie, Tyler [KDA]
Sent: Tuesday, April 09, 2019 5:18 PM
To: Orrin Feril (oferil@gmd5.org)
Cc: Conant, Cameron [KDA]
Subject: GMD Recommendaition Request - File No. 18540
Attachments: 18540.GMD Cover Letter + memo.pdf; 18540.Change App.pdf

Orrin,

I have attached a cover letter and a copy of one (1) place of use change application for GMD recommendation. I have also included a memo which provides information regarding the base acres for this file. Please provide the GMD recommendation by no later than April 29, 2019.

Please let me know if you are needing anything else, or have any questions.

Thank you,

Tyler

Tyler Saryerwinnie, Environmental Scientist
Kansas Department of Agriculture
Division of Water Resources
Stafford Field Office
Phone: (620)234-5311

Stafford Field Office
300 S. Main Street
Stafford, KS 67578-1521



Phone: 620-234-5311
Fax: 620-234-6900
www.agriculture.ks.gov

Mike Beam, Secretary

Laura Kelly, Governor

April 9, 2019

Orrin Feril
Big Bend – GMD No. 5
125 S Main St.
Stafford, KS 67578

RE: Place of Use Change Application, File No. 18,540

Dear Mr. Feril,

We are enclosing a copy of the application, as referenced above, for your review and recommendation. At this time the application appears to be in proper form.

This office will delay any further action on this file for a period of 15 business days from the date of this letter to allow you time to submit your recommendation concerning the application. Please submit your recommendation within the allotted time, or any authorized extension of time thereof.

If you have any questions, please feel free to contact the office.

Sincerely,

A handwritten signature in blue ink, appearing to read "Tyler Saryerwinnie".

Tyler Saryerwinnie
Environmental Scientist
Stafford Field Office
tyler.saryerwinnie@ks.gov

Enclosure

Saryerwinnie, Tyler [KDA]

From: Orrin Feril <oferil@gmd5.org>
Sent: Tuesday, April 16, 2019 3:14 PM
To: Saryerwinnie, Tyler [KDA]
Subject: Application for Change, Water Right, File No. 18540
Attachments: 18540 2019-04-16 Rec.pdf

EXTERNAL: This email originated from outside of the organization. Do not click any links or open any attachments unless you trust the sender and know the content is safe.

Tyler,
I'm attaching the recommendation requested by your office in a letter dated April 10, 2019. Please let me know if you have any questions.

Thank you for your consideration in this matter,

Orrin

--

Orrin Feril

Manager

Big Bend GMD#5

Email: oferil@gmd5.org

Phone: (620) 234-5352

Mobile: (620) 388-0172

Fax: (620) 234-5718

www.gmd5.org

Facebook/Twitter: @BigBendGMD5

Darrell Wood - Edwards (Pres.)
Fred Grunder - Pratt (V Pres.)
John Janssen - Kiowa (Treas.)
Jerry Cullop - Rice (Sec.)
Justin Gatz - Reno
Marlyn Spare - Stafford
Phil Martin - Barton
Kerry Froetschner - Pawnee
Tom Taylor - At-Large



Orrin Feril, Manager
125 South Main Street
Stafford, Kansas 67578
ph: (620) 234-5352
fx: (620) 234-5718
gmd5@gmd5.org
www.gmd5.org

April 16, 2019

Tyler Saryerwinnie
Division of Water Resources
Kansas Department of Agriculture
300 S. Main Street
Stafford, Kansas 67578-1342

RE: Water Right File No. 18540
Change in the Place of Use

Dear Mr. Saryerwinnie,

Big Bend Groundwater Management District #5 has reviewed the above referenced application. It is the understanding of the District that this change is intended to correct the authorized place of use for the water right file. Based on the information received in the office, the application appears to be consistent with 5-25-20(b) and is recommended for approval.

The application to change is subject to the District's well equipment regulation K.A.R. 5-25-5 for a required flow meter.

Please feel free to give me a call if you have any questions.

Sincerely,

Orrin Feril
Manager

RECEIVED

APR 16 2019

Stafford Field Office
Division of Water Resources