

Submit completed application to:
 Kansas Department of Agriculture
 Division of Water Resources
 Field Office for your area.

Call for address:

Topeka -- (785) 296-5733
 Stafford -- (620) 234-5311
 Stockton -- (785) 425-6787
 Garden City -- (620) 276-2901
<http://agriculture.ks.gov/dwr>

DWR FIELD OFFICE APPLICATION FOR APPROVAL TO CHANGE THE PLACE OF USE AND/OR THE POINT OF DIVERSION



STATE OF KANSAS

WATER METER REQUIRED

Filing Fee Must Accompany the Application, K.S.A. 82a-708b(b), as amended.

Fee Schedule is on the third page of this application form.

Paragraph Nos. 1, 2, 3 & 5 must be completed. Complete all other applicable portions. If change in point of diversion is greater than 100 feet, or if place of use will be changed, include a topographic map or detailed plat showing the authorized and proposed point(s) of diversion and/or place of use.

RECEIVED

9:50 AM
 APR 01 2019

File No. 18876

Stafford Field Office
 Division of Water Resources

1. Application is hereby made for approval of the Chief Engineer to change the (check one or both):

Place of Use Point of Diversion

under the water right which is the subject of this application in accordance with the conditions described below.

The source of supply is: Groundwater Surface water

2. Name and address of Applicant: Mull Investments LP

553 R Rd, Pawnee Rock KS 67567

Phone Number: (620)982-4336 Email address: mullfarms2@yahoo.com

Name and address of Water Use Correspondent: Mull Investments LP

553 R Rd, Pawnee Rock KS 67567

Phone Number: (620)982-4336 Email address: mullfarms2@yahoo.com

3. The presently authorized place of use is:

Owner of Land ---- NAME: Mull Investments LP

ADDRESS: 553 R Rd, Pawnee Rock KS 67567

(If there is more than one landowner, attach supplemental sheets as necessary.)

Sec.	Twp.	Range	NE¼				NW¼				SW¼				SE¼				TOTAL ACRES
			NE¼	NW¼	SW¼	SE¼	NE¼	NW¼	SW¼	SE¼	NE¼	NW¼	SW¼	SE¼	NE¼	NW¼	SW¼	SE¼	
											Lot 6	Lot 7							
6	27	16W									27.13	23.53	21.43	24.46					96.55

4. If this application is for a change in place of use, it is proposed that the place of use be changed to:

Owner of Land ---- NAME: Mull Investments LP

ADDRESS: _____

(If there is more than one landowner, attach supplemental sheets as necessary.)

Sec.	Twp.	Range	NE¼				NW¼				SW¼				SE¼				TOTAL ACRES
			NE¼	NW¼	SW¼	SE¼	NE¼	NW¼	SW¼	SE¼	NE¼	NW¼	SW¼	SE¼	NE¼	NW¼	SW¼	SE¼	
											Lot 6	Lot 7							
6	27	16W									32.5	29.5	35	38					135

For Office Use Only: Code _____ Fee \$ <u>300</u> - TR # _____ Receipt Date _____ Check # <u>2148</u>
--

5. **Presently authorized point of diversion:**
 One in the _____ Quarter of the _____ Quarter of the _____ NC SW _____ Quarter
 of Section _____ 6 _____, Township _____ 27 _____ South, Range _____ 16 _____ W,
 in Kiowa County, Kansas, 1,320 feet North 3,960 feet West of Southeast corner of section.
 Authorized Rate 900 gpm Authorized Quantity 203 AF Depth of well 180 (feet)
(DWR use only: Computer ID No. 2 _____ GPS _____ feet North _____ feet West)
 This point will not be changed This point will be changed as follows: No change, point better described with GPS as follows:
Proposed point of diversion: (Complete only if change is requested or if existing point is better described by GPS)
 One in the _____ Quarter of the _____ Quarter of the _____ Quarter
 of Section _____, Township _____ South, Range _____ (E/W),
 in _____ County, Kansas, _____ feet North _____ feet West of Southeast corner of section.
 Proposed Rate _____ Proposed Quantity _____ Proposed well depth (feet) _____
 This point is: Additional Well Geo Center List other water rights that will use this point NONE

6. **Presently authorized point of diversion:**
 One in the _____ Quarter of the _____ Quarter of the _____ Quarter
 of Section _____, Township _____ South, Range _____ (E/W),
 in _____ County, Kansas, _____ feet North _____ feet West of Southeast corner of section.
 Authorized Rate _____ Authorized Quantity _____ Depth of well _____ (feet)
(DWR use only: Computer ID No. _____ GPS _____ feet North _____ feet West)
 This point will not be changed This point will be changed as follows: No change, point better described with GPS as follows:
Proposed point of diversion: (Complete only if change is requested or if existing point is better described by GPS)
 One in the _____ Quarter of the _____ Quarter of the _____ Quarter
 of Section _____, Township _____ South, Range _____ (E/W),
 in _____ County, Kansas, _____ feet North _____ feet West of Southeast corner of section.
 Proposed Rate _____ Proposed Quantity _____ Proposed well depth (feet) _____
 This point is: Additional Well Geo Center List other water rights that will use this point _____

7. The changes herein are desired for the following reasons?
 (please be specific) Modify place of use to cover the
installed center pivot system. The 2010 AWEP reduction
was in error.

8. If a well, is the test hole log attached? Yes No

9. The change(s) (was)(will be) completed by?
Upon approval of application

10. If the point of diversion is a well:
 (a) What are you going to do with the old well?
N/A
 (b) When will this be done? N/A

11. Groundwater Management District recommendation
 attached? Yes No

12. Assisted by EKF/SFFO

13a. If the proposed point of diversion will be relocated more than
300 feet but within 2,640 feet of the existing point of diversion,
 attach a topographic map or aerial photograph. For
 groundwater sources, show all wells (including domestic) within
 one-half mile of the proposed point of diversion and the names
 and mailing addresses of the owners. For surface water
 sources, show the names and addresses of the landowner(s)
 one-half mile downstream and one-half mile upstream from
 your property lines

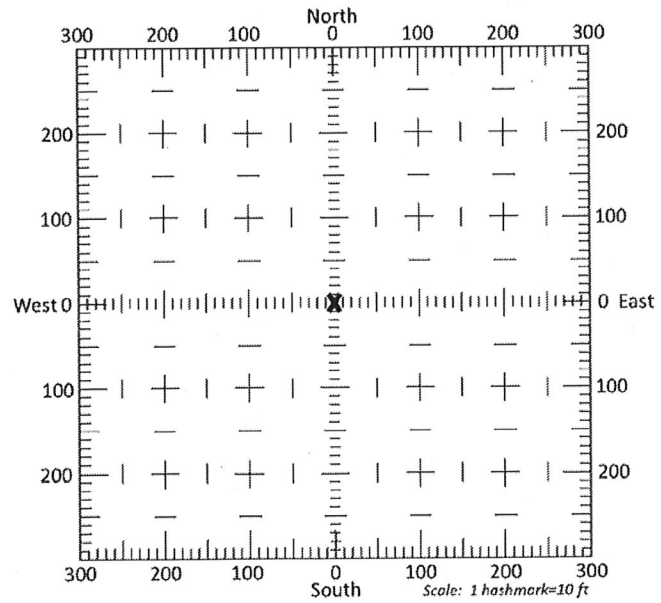

13b. If the proposed point of diversion will be relocated within 300
feet of the existing point of diversion, indicate its location on the
 diagram shown above in relation to the existing point of
 diversion. **(PLEASE NOTE: The "X" in center of diagram**
above represents the presently authorized point of
diversion.)

RECEIVED
 APR 01 2015

14. If the proposed groundwater point of diversion is 300 or fewer feet from the existing point of diversion, complete the following:
- (a) Does the undersigned represent all owners of the currently authorized place(s) of use identified in this application?
 Yes No (If no, all owners must sign this application.)
 - (b) Will the ownership interest of any owner of the currently authorized place(s) of use identified in this application be adversely affected if this application is approved as requested?
 Yes No (If yes, all owners must sign this application.)
 - (c) If this application is not approved expeditiously, will there be substantial damage to property, public health or safety?
 Yes No (If no, all owners must sign this application.)

If the application proposes a surface water change in point of diversion, a groundwater change in point of diversion greater than 300 feet, or a change in place of use, the application must be signed by all owners of the currently authorized place of use, or their duly authorized agent (attach notarized statement authorizing representation).

I hereby verify, being first duly sworn upon my oath or affirmation and under penalty of perjury, that I am of lawful age and the owner, the spouse of the owner, or a duly authorized agent of the owner(s) to make this application on their behalf, in regards to the water right(s) to which this application pertains. I further verify that the statements contained in this application are true, correct and complete.

Dated at Pawnee Rock, Kansas, this 22 day of March, 2019.

<u>Rick Stimatze</u> (Owner)	
<u>Rick Stimatze</u> (Please Print)	

State of Kansas }
 County of Pawnee } SS

I hereby certify that the foregoing application was signed in my presence and sworn to before me this 22 day of March, 2019.

My Commission Expires 3-14-2022



ONLY COMPLETE APPLICATIONS WILL BE PROCESSED. To be complete, all of the applicable portions of the application form must be completed with accurate information; maps, if necessary, must be included; signatures of all the appropriate owners' must be affixed to the application and notarized; and the appropriate fee must be paid.

FEE SCHEDULE

Each application to change the place of use or the point of diversion under this section shall be accompanied by the application fee set forth in the schedule below: Make checks payable to: **Kansas Department of Agriculture**

(1) Application to change a point of diversion 300 feet or less	\$100
(2) Application to change a point of diversion more than 300 feet	\$200
(3) Application to change the place of use	\$200

RECEIVED

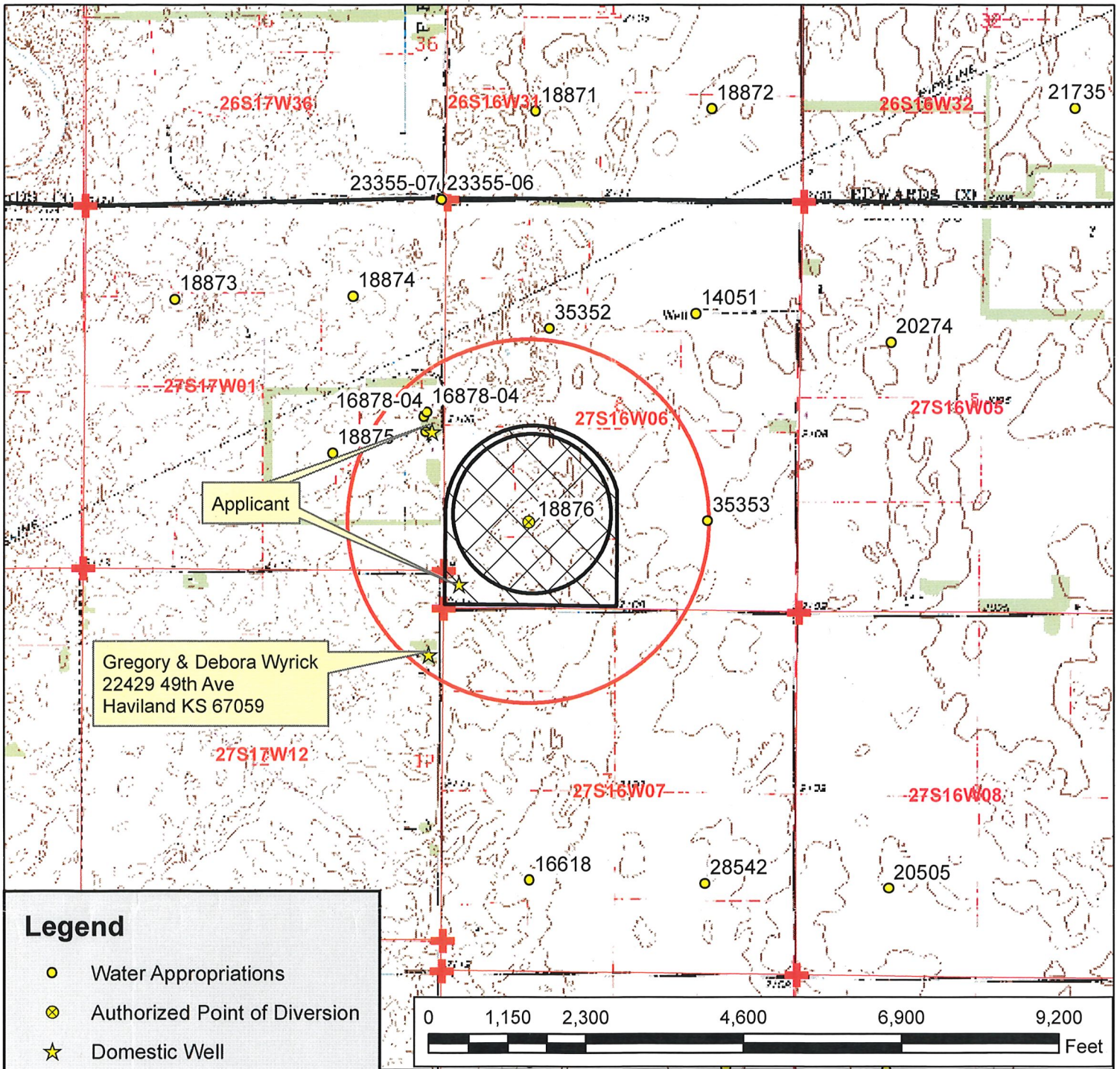

Legend

- Water Appropriations
- ⊗ Authorized Point of Diversion
- ★ Domestic Well
- ⊕ Section Corner
- Half Mile Circle
- Section Line
- County Line
- Place of Use** RECEIVED
- ▨ Proposed
- ▨ Authorized APR 01 2019

Stafford Field Office
Division of Water Resources

Water Right, File No. 18876

Change in Place of Use Application Map
6-27-16W // Kiowa County

To the best of my knowledge, all known groundwater wells within
1/2 mile of the proposed point of diversion have been shown.

Rick Schmitz
Signature

3/21/19 EKF-SFFO 1:24,000 scale

