

Kansas Department of Agriculture  
 Division of Water Resources  
**CHANGE: P/U WORKSHEET**

1. File Number: <b>24035</b>	2. Status Change Date:	3. Change Num: <b>2</b>	4. Field Office: <b>02</b>	5. GMD: <b>05</b>	
6. Status: <input checked="" type="checkbox"/> Approved <input type="checkbox"/> Denied by DWR/GMD <input type="checkbox"/> Dismiss by Request/Failure to Return				7. Filing Date of Change: <b>2/8/19</b>	
8a. Applicant(s) New to system <input type="checkbox"/>		Person ID _____ Add Seq# _____		8c. Landowner(s) New to system <input type="checkbox"/>	
8b. Landowner(s) New to system <input type="checkbox"/>		Person ID <b>50371</b> Add Seq# <b>1</b>		8d. WUC New to system <input type="checkbox"/>	
<b>ADDRESS CHANGE</b>  <b>SCHLESSIGER CATTLE CO</b> <b>1272 NE 120 RD</b> <b>CLAFLIN KS 67525</b>		<b>JOE SCHLESSIGER</b> <b>343 SE 100 AVE</b> <b>ELLINWOOD KS 67526</b>			
9. Documents and Enclosure(s): <input checked="" type="checkbox"/> DWR Meter(s) Date to Comply: <b>12/31/19</b> <input type="checkbox"/> N & P Date to Comply: _____					
<input type="checkbox"/> Anti-Reverse Meter <input type="checkbox"/> Meter Seal <input checked="" type="checkbox"/> Check Valve <input type="checkbox"/> N & P Form <input type="checkbox"/> Water Tube <input type="checkbox"/> Driller Copy <input type="checkbox"/> H & E Letter					
<input type="checkbox"/> Conservation Plan    Date Required: _____    Date Approved: <b>3/1/19</b> Date to Comply: _____					
10. Use Made of Water    From: _____    To: _____					
				Date Prepared: <b>2/28/19</b> By: <b>TJS</b>	
				Date Entered: _____    By: _____	

File No. **24035**      11. County: **BARTON**      Basin: **Arkansas River**      Stream: ---      Formation Code: ---      Special Use: ---

12. Points of Diversion										Rate and Quantity							
CHK	MOD	DEL	ENT	PDIV	Qualifier	S	T	R	ID	'N	'W	Comment (AKA Line)	Rate gpm/cfs	Quantity af/mgy	Rate gpm/cfs	Quantity af/mgy	Overlap PD Files
CHK					359				1								None
CHK					87214				5								37261

13. Storage: Rate \_\_\_\_\_ NF      Quantity \_\_\_\_\_ ac/ft      Additional Rate \_\_\_\_\_ NF      Additional Quantity \_\_\_\_\_ ac/ft

14. Limitation: \_\_\_\_\_ af/yr at \_\_\_\_\_ gpm ( \_\_\_\_\_ cfs) when combined with file number(s) \_\_\_\_\_  
 Limitation: \_\_\_\_\_ af/yr at \_\_\_\_\_ gpm ( \_\_\_\_\_ cfs) when combined with file number(s) \_\_\_\_\_

15. 5YR Allocation: Allocation Type \_\_\_\_\_ Start Year \_\_\_\_\_ 5 YR Amount \_\_\_\_\_ Amount Unit \_\_\_\_\_ Base Acres \_\_\_\_\_ Comment \_\_\_\_\_

16. Place of Use										NE¼				NW¼				SW¼				SE¼				Total	Owner	Chg?	Overlap Files
CHK	MOD	DEL	ENT	PUSE	S	T	R	ID		NE ¼	NW ¼	SW ¼	SE ¼	NE ¼	NW ¼	SW ¼	SE ¼	NE ¼	NW ¼	SW ¼	SE ¼	NE ¼	NW ¼	SW ¼	SE ¼				
DEL				12264				1																			8b.	No	37261
ENT				2539	13	20S	12W	3		40	40	40	38					40	40	32.5	32.5	303				8b.	No	37261	

Base Acres: ---      Year: ---      Minimum Reasonable Quantity: **1.18 AF/acre**

Comments:

Submit completed application to:  
 Kansas Department of Agriculture  
 Division of Water Resources  
 Field Office for your area.  
 Call for address:

Topeka -- (785) 296-5733  
 Stafford -- (620) 234-5311  
 Stockton -- (785) 425-6787  
 Garden City -- (620) 276-2901  
<http://agriculture.ks.gov/dwr>

## DWR FIELD OFFICE APPLICATION FOR APPROVAL TO CHANGE THE PLACE OF USE AND/OR THE POINT OF DIVERSION



**STATE OF KANSAS**

**WATER METER REQUIRED**

**Filing Fee Must Accompany the Application, K.S.A. 82a-708b(b), as amended.**  
 Fee Schedule is on the third page of this application form.

**Paragraph Nos. 1, 2, 3 & 5 must be completed. Complete all other applicable portions.** If change in point of diversion is greater than 100 feet, or if place of use will be changed, include a topographic map or detailed plat showing the authorized and proposed point(s) of diversion and/or place of use.

File No. 24035

RECEIVED  
 1:55pm  
 FEB 08 2010

1. Application is hereby made for approval of the Chief Engineer to change the (check one or both):

Place of Use                       Point of Diversion

under the water right which is the subject of this application in accordance with the conditions described below.

The source of supply is:                       Groundwater                       Surface water

State Field Office  
 Division of Water Resources

2. Name and address of Applicant: Joe Schlessiger

343 SE 100 Ave, Ellinwood KS 67526

Phone Number: (620)786-5856                      Email address: jtscows@gmail.com

Name and address of Water Use Correspondent: Joe Schlessiger

343 SE 100 Ave, Ellinwood KS 67526

Phone Number: (620)786-5856                      Email address: jtscows@gmail.com

3. The presently authorized place of use is:

Owner of Land --- NAME: Schlessiger Cattle Co

ADDRESS: <sup>9-11</sup> ~~1266~~ <sup>1272</sup> NE 120 Rd, Claflin KS 67526

(If there is more than one landowner, attach supplemental sheets as necessary.)

Sec.	Twp.	Range	NE¼				NW¼				SW¼				SE¼				TOTAL ACRES
			NE¼	NW¼	SW¼	SE¼	NE¼	NW¼	SW¼	SE¼	NE¼	NW¼	SW¼	SE¼	NE¼	NW¼	SW¼	SE¼	
13	20S	12W	40	40	40	38													238

4. If this application is for a change in place of use, it is proposed that the place of use be changed to:

Owner of Land --- NAME: Schlessiger Cattle Co

ADDRESS: <sup>2-11</sup> ~~1266~~ <sup>1272</sup> NE 120 Rd, Claflin KS 67526

(If there is more than one landowner, attach supplemental sheets as necessary.)

Sec.	Twp.	Range	NE¼				NW¼				SW¼				SE¼				TOTAL ACRES
			NE¼	NW¼	SW¼	SE¼	NE¼	NW¼	SW¼	SE¼	NE¼	NW¼	SW¼	SE¼	NE¼	NW¼	SW¼	SE¼	
13	20S	12W	40	40	40	38													303

For Office Use Only: Code \_\_\_\_\_ Fee \$ 200 TR # \_\_\_\_\_ Receipt Date \_\_\_\_\_ Check # 7294

5. **Presently authorized point of diversion:**  
 One in the \_\_\_\_\_ Quarter of the \_\_\_\_\_ Quarter of the NC W2 E2 Quarter  
 of Section 13, Township 20S South, Range 12 W,  
 in Barton County, Kansas, 2670 feet North 1685 feet West of Southeast corner of section.  
 Authorized Rate 805 GPM Authorized Quantity 179 AF Depth of well \_\_\_\_\_ (feet)  
**(DWR use only: Computer ID No. 1 GPS --- feet North --- feet West)**  
 This point will not be changed  This point will be changed as follows:  No change, point better described with GPS as follows:  
**Proposed point of diversion: (Complete only if change is requested or if existing point is better described by GPS)**  
 One in the \_\_\_\_\_ Quarter of the \_\_\_\_\_ Quarter of the \_\_\_\_\_ Quarter  
 of Section \_\_\_\_\_, Township \_\_\_\_\_ South, Range \_\_\_\_\_ (E/W),  
 in \_\_\_\_\_ County, Kansas, \_\_\_\_\_ feet North \_\_\_\_\_ feet West of Southeast corner of section.  
 Proposed Rate \_\_\_\_\_ Proposed Quantity \_\_\_\_\_ Proposed well depth (feet) \_\_\_\_\_  
 This point is:  Additional Well  Geo Center List other water rights that will use this point None

6. **Presently authorized point of diversion:**  
 One in the \_\_\_\_\_ Quarter of the \_\_\_\_\_ Quarter of the NC SE Quarter  
 of Section 13, Township 20 South, Range 12 W,  
 in Barton County, Kansas, 1335 feet North 1280 feet West of Southeast corner of section.  
 Authorized Rate 1135 GPM Authorized Quantity 123 AF Depth of well \_\_\_\_\_ (feet)  
**(DWR use only: Computer ID No. 5 GPS --- feet North --- feet West)**  
 This point will not be changed  This point will be changed as follows:  No change, point better described with GPS as follows:  
**Proposed point of diversion: (Complete only if change is requested or if existing point is better described by GPS)**  
 One in the \_\_\_\_\_ Quarter of the \_\_\_\_\_ Quarter of the \_\_\_\_\_ Quarter  
 of Section \_\_\_\_\_, Township \_\_\_\_\_ South, Range \_\_\_\_\_ (E/W),  
 in \_\_\_\_\_ County, Kansas, \_\_\_\_\_ feet North \_\_\_\_\_ feet West of Southeast corner of section.  
 Proposed Rate \_\_\_\_\_ Proposed Quantity \_\_\_\_\_ Proposed well depth (feet) \_\_\_\_\_  
 This point is:  Additional Well  Geo Center List other water rights that will use this point 37261

7. The changes herein are desired for the following reasons?  
 (please be specific) To create a complete place of use  
overlap amongst File Nos. 24035 & 37261

8. If a well, is the test hole log attached?  Yes  No

9. The change(s) (was)(will be) completed by?  
Upon Approval

10. If the point of diversion is a well:  
 (a) What are you going to do with the old well?  
NA  
 (b) When will this be done? NA

11. Groundwater Management District recommendation  
 attached?  Yes  No 2/26/19 TJS-SFFO

12. Assisted by TJS - SFFO

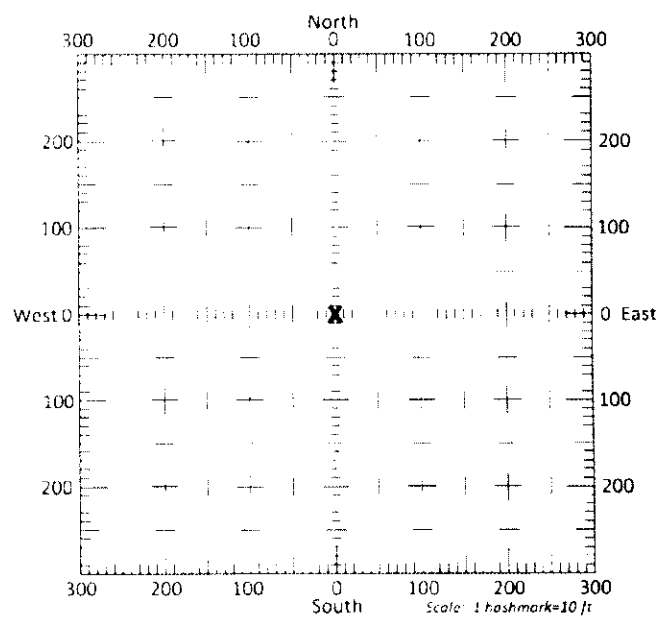

13a. If the proposed point of diversion will be relocated more than 300 feet but within 2,640 feet of the existing point of diversion, attach a topographic map or aerial photograph. For groundwater sources, show all wells (including domestic) within one-half mile of the proposed point of diversion and the names and mailing addresses of the owners. For surface water sources, show the names and addresses of the landowner(s) one-half mile downstream and one-half mile upstream from your property lines

13b. If the proposed point of diversion will be relocated within 300 feet of the existing point of diversion, indicate its location on the diagram shown above in relation to the existing point of diversion. (PLEASE NOTE: The "X" in center of diagram above represents the presently authorized point of diversion.)

14. If the proposed groundwater point of diversion is 300 or fewer feet from the existing point of diversion, complete the following:
- (a) Does the undersigned represent all owners of the currently authorized place(s) of use identified in this application?  
 Yes     No    (If no, all owners must sign this application.)
  - (b) Will the ownership interest of any owner of the currently authorized place(s) of use identified in this application be adversely affected if this application is approved as requested?  
 Yes     No    (If yes, all owners must sign this application.)
  - (c) If this application is not approved expeditiously, will there be substantial damage to property, public health or safety?  
 Yes     No    (If no, all owners must sign this application.)

If the application proposes a surface water change in point of diversion, a groundwater change in point of diversion greater than 300 feet, or a change in place of use, the application must be signed by all owners of the currently authorized place of use, or their duly authorized agent (attach notarized statement authorizing representation).

I hereby verify, being first duly sworn upon my oath or affirmation and under penalty of perjury, that I am of lawful age and the owner, the spouse of the owner, or a duly authorized agent of the owner(s) to make this application on their behalf, in regards to the water right(s) to which this application pertains. I further verify that the statements contained in this application are true, correct and complete.

Dated at Stafford, Kansas, this 8th day of February, 2019.

<u>Joseph T. Schlessiger</u> (Owner)	
<u>Joseph T. Schlessiger</u> (Please Print)	

State of Kansas }  
 County of Stafford } SS

I hereby certify that the foregoing application was signed in my presence and sworn to before me this 8th day of February, 2019.



Jessica Engelbrecht  
 Notary Public

ONLY COMPLETE APPLICATIONS WILL BE PROCESSED. To be complete, all of the applicable portions of the application form must be completed with accurate information; maps, if necessary, must be included; signatures of all the appropriate owners' must be affixed to the application and notarized; and the appropriate fee must be paid.

**FEE SCHEDULE**

Each application to change the place of use or the point of diversion under this section shall be accompanied by the application fee set forth in the schedule below: Make checks payable to: **Kansas Department of Agriculture**

- (1) Application to change a point of diversion 300 feet or less ..... \$100
- (2) Application to change a point of diversion more than 300 feet ..... \$200
- (3) Application to change the place of use ..... \$200

RECEIVED

**SUMMARY ORDER APPROVING APPLICATION FOR CHANGE AND IMPOSING CONDITIONS**

This Summary Order is issued under authority of K.S.A. 82a-708b, as amended, and K.A.R. 5-5-1, *et seq.* and other applicable provisions of the *Kansas Water Appropriation Law, K.S.A. 82a-701 et. seq.*, and rules and regulations promulgated thereunder, With the exception of those conditions expressly contained herein, this Summary Order does not change the terms, conditions and limitations of File No. 24035.

1. A change application was received on 2/12/2019\* 2/8/2019 requesting that the place of use and / or point of diversion authorized under the above-referenced file number be changed as described in the application.
2. On and after the effective date of this summary order, the authorized place(s) of use shall be located substantially as shown on the topographic map accompanying the application to change the place of use.  Applicable  Not Applicable
3. The change in point of diversion shall not impair existing rights and shall be limited to the same source or sources of water as previously authorized. The point of diversion authorized by this summary order shall be located within a \_\_\_\_\_ foot radius of the authorized point(s) of diversion.  Applicable  Not Applicable
4. The point(s) of diversion described herein is administratively corrected to be more accurately described using the Global Positioning System (GPS), as described in the application.  Applicable  Not Applicable
5. The point(s) of diversion authorized herein shall not actually be located more than \_\_\_\_\_ feet from the previously authorized point(s) of diversion.  Applicable  Not Applicable
6. As required by K.A.R. 5-3-5d, if the works for diversion is a well with a diversion rate of 100 gallons per minute or more, a tube or other device suitable for making water level measurements shall be installed, operated and maintained in accordance with K.A.R. 5-6-13.  Applicable  Not Applicable
7. **The owner of the authorized place(s) of use shall properly install an acceptable water flow meter on or before December 31, 2019**, or before the first use of water, whichever occurs first. The water flow meter shall be installed, operated and maintained in accordance with K.A.R. 5-1-4 through 5-1-12. As required by K.S.A. 82a-732, as amended, and K.A.R. 5-3-5e, the owner shall maintain records and report the reading of the water flow meter and the total quantity of water diverted annually to the Chief Engineer by March 1 following the end of each calendar year.  Applicable  Not Applicable
8. **Installation of the works for diversion of water shall be completed on or before December 31, 20\_\_\_\_**, or within any authorized extension of time. By March 1, 20\_\_\_\_ the applicant shall notify the Chief Engineer that construction of the works for diversion has been completed, on the form provided by the Chief Engineer, as required by K.A.R. 5-8-4e.  Applicable  Not Applicable
9. **The completed well log shall be submitted with the required notice.**  Applicable  Not Applicable
10. All diversion works into which any type of chemical or other foreign substance will be injected into the water shall be equipped with an in-line, automatic, quick-closing check valve capable of preventing pollution of the source of the water supply. The check valve(s) shall be installed, operated and maintained in accordance with K.A.R. 5-3-5c.  Applicable  Not Applicable
11. Additional Conditions are attached.  Yes  No
12. In accordance with K.S.A. 82a-708a, as amended, and K.A.R. 5-5-14, all of the owners of the authorized place(s) of use of water appropriated under the above-referenced file number are responsible for compliance with its terms, conditions and limitations, as amended and/or supplemented by this Summary Order, and with applicable provisions of the *Kansas Water Appropriation Law* and the *Rules and Regulations* promulgated thereunder. Failure to comply with these provisions may result in civil penalties pursuant to K.S.A. 82a-737, as amended, and/or the suspension or revocation and dismissal of the water or appropriation right or any other enforcement actions authorized by law.

**Administrative Appeal and Effective Date of Order**

If you are aggrieved by this order, pursuant to K.S.A. 82a-1901, you may request an evidentiary hearing before the Chief Engineer or request administrative review by the Secretary of Agriculture. A request for hearing by the Chief Engineer must be filed within **15 days** of service of this Order and a request for administrative review by the Secretary must be filed within **30 days** pursuant to K.S.A. 77-531. Any request for administrative review must state a basis for review pursuant to K.S.A. 77-527. File any request with **Kansas Department of Agriculture, Legal Division, 1320 Research Park Drive, Manhattan, KS 66502**. Failure to timely request a hearing or review may preclude review under the Kansas Judicial Review Act.

*For Use by Register of Deeds*

\* TJS-SFFO

FOR OFFICE USE ONLY  
**APPLICATION APPROVED AND SUMMARY ORDER ISSUED**

By: Cameron R. Conant  
Duly Authorized Designee of the Chief Engineer

(Print Name): Cameron R. Conant  
Division of Water Resources - Kansas Department of Agriculture

Date of Issuance: March 7, 2019

State of Kansas \_\_\_\_\_ )

County of Stafford ) SS

Acknowledged before me on 03/01/2019

by Cameron Conant

Signature: Jessica Engelbrecht  
Notary Public

My commission expires \_\_\_\_\_

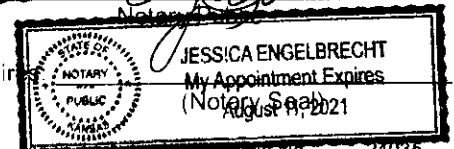

RECEIVED

FEB 08 2019

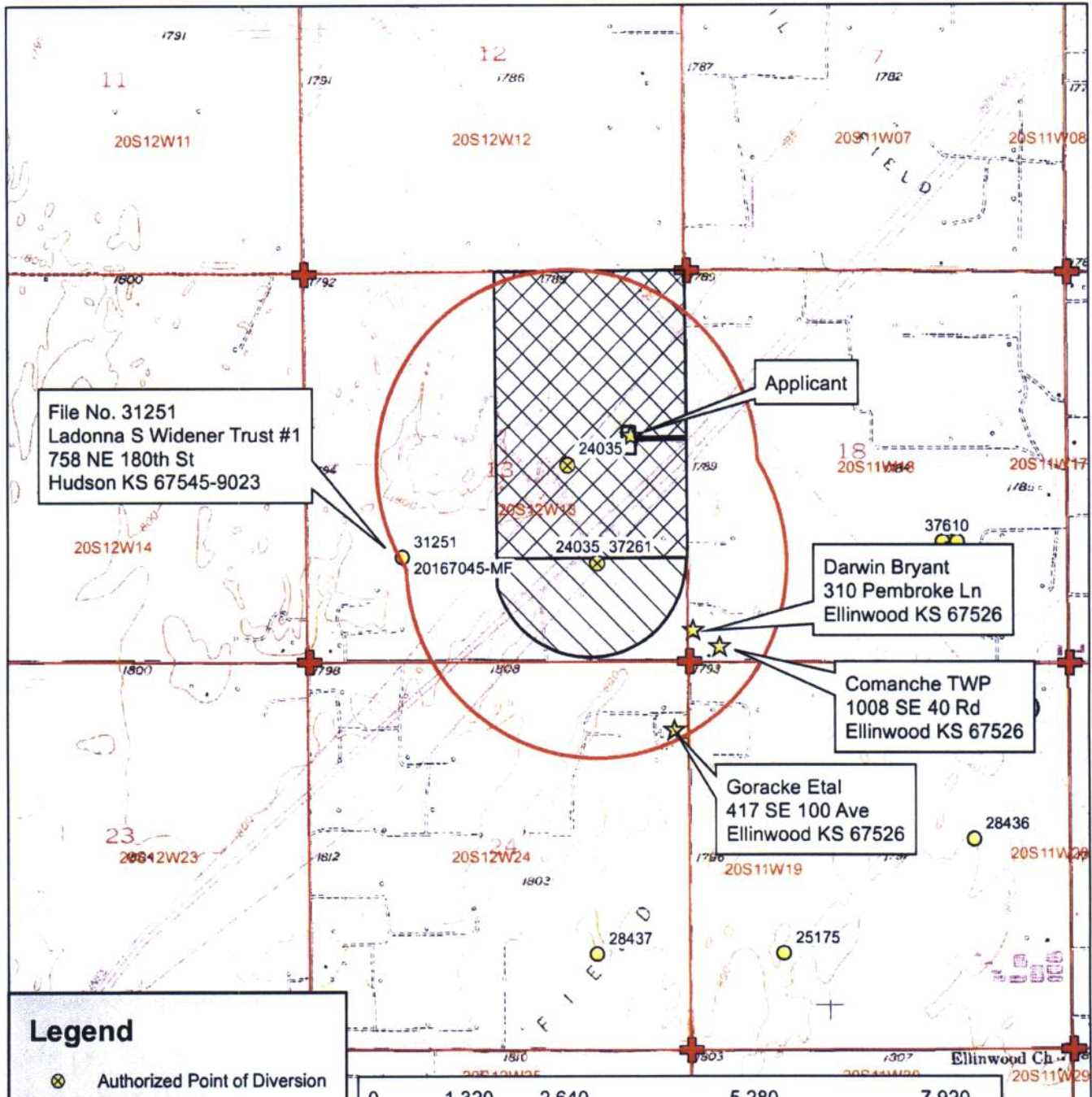

File No. 31251  
 Ladonna S Widener Trust #1  
 758 NE 180th St  
 Hudson KS 67545-9023

Applicant

Darwin Bryant  
 310 Pembroke Ln  
 Ellinwood KS 67526

Comanche TWP  
 1008 SE 40 Rd  
 Ellinwood KS 67526

Goracke Etal  
 417 SE 100 Ave  
 Ellinwood KS 67526

**Legend**

- ⊗ Authorized Point of Diversion
- Water Appropriations
- 1/2 Mile Buffer
- ★ Domestic Well
- Section Line
- ⊕ Section Corner

**Place of Use**

- ▨ Authorized
- ▩ Proposed



**Water Right, File No. 24035**  
 Change in Place of Use, Application Map  
 13-20S-12W // Barton County

RECEIVED  
 FEB 20 2019

Stafford Field Office

To the best of my knowledge, all water wells including domestic wells within 1/2 mile of the authorized point of diversion have been shown.

*James Schlesselman*  
 Signature

## Saryerwinnie, Tyler [KDA]

---

**From:** Joe Schlessiger <jtscows@gmail.com>  
**Sent:** Wednesday, February 20, 2019 5:03 PM  
**To:** Saryerwinnie, Tyler [KDA]  
**Subject:** Re: Water Right File Nos. 24035 & 37261 - Change in Place of Use  
**Attachments:** 152857.PDF

*EXTERNAL:* This email originated from outside of the organization. Do not click any links or open any attachments unless you trust the sender and know the content is safe.

Here are those 2 pages you needed signed.

On Thu, Jan 17, 2019 at 2:00 PM Saryerwinnie, Tyler [KDA] <[Tyler.Saryerwinnie@ks.gov](mailto:Tyler.Saryerwinnie@ks.gov)> wrote:

Joe,

I have attached two applications proposing to completely overlap the place of use for both files in 13-20S-12W. I have also included a cover letter with instructions for submission.

If you have any questions with this information, please don't hesitate to call the Stafford Field Office.

Thank you and have a good afternoon,

Tyler

**Tyler Saryerwinnie**, Environmental Scientist

Kansas Department of Agriculture

Division of Water Resources

Stafford Field Office

Phone: (620)234-5311



Stafford Field Office  
300 S. Main Street  
Stafford, KS 67578-1521

# Kansas

Department of Agriculture  
Division of Water Resources

Phone: 620-234-5311  
Fax: 620-234-6900  
[www.agriculture.ks.gov](http://www.agriculture.ks.gov)

Mike Beam, Interim Secretary

Laura Kelly, Governor

March 1, 2019

Joe Schlessiger  
343 SE 100 Ave  
Ellinwood KS 67526

Re: Water Right, File No(s). 24035

Dear Water Right Owner:

Enclosed is the order executed by the Chief Engineer, Division of Water Resources, Kansas Department of Agriculture, approving the application for change under the above referenced file number(s).

Your attention is directed to the enclosures and to the terms, conditions and limitations specified in this approval for change. An acceptable water flow meter must be installed on your well before any water is applied as authorized under this change approval. A copy of the approved list of Certified Water Flowmeters as well as the regulations regarding the installation of flowmeters, measurement tubes and check valves can be found at <http://agriculture.ks.gov/divisions-programs/dwr/water-appropriation/water-flowmeters>. If you do not have access to the internet, please contact this office and we will send you a paper copy of the referenced information.

Since this order modifies the original document referred to above, it should be recorded with the Register of Deeds as other instruments affecting real estate.

Should you have any questions, please feel free to contact this office. If you wish to refer to a specific file, please reference it when you contact us.

Sincerely,



Jeff Lanterman  
Water Commissioner

Enclosures

pc: Water Rights Section  
Groundwater Management District No.5

## CERTIFICATE OF SERVICE

On this **1st** day of **March, 2019**, I hereby certify that the attached Change in Place of Use for Water Right, File No. **24035**, dated **March 1, 2019** was mailed via Certified U.S. mail to the following:

SCHLESSIGER CATTLE CO  
1272 NE 120 RD  
CLAFLIN KS 67525

A copy of the letter was sent via First Class U.S. Mail to the following:

GMD 5

  
Staff



# KANSAS DEPARTMENT OF AGRICULTURE

Division of Water Resources

Stafford Field Office

## MEMORANDUM

---

**TO:** File

**DATE:** 2/21/2019

**FROM:** Tyler Saryerwinnie

**RE:** File Nos. 24035 & 37261

This is a memorandum regarding surrounding well owner notification on irrigation field office PU changes and pertains to decisions made during the Water Commissioner meeting which took place on 11/16/2016 with directive from Lane Letourneau Program Manager.

This is applicable to field office changes to increase the place of use by 10 acres or 10% (whichever is less) or a change in place of use to create a complete overlap in which no new acres are being irrigated.

During that meeting it was determined that no surrounding well owner notification will be sent under this type of Place of Use change. All well rates and quantities will remain unchanged and the referenced change will not cause impairment or impact surrounding well owners.

The change in place of use applications filed on 2/8/2019 for the above referenced files meet this criteria and surrounding well owners will not be notified.

## **Saryerwinnie, Tyler [KDA]**

---

**From:** Saryerwinnie, Tyler [KDA]  
**Sent:** Thursday, February 21, 2019 10:00 AM  
**To:** Orrin Feril (oferil@gmd5.org)  
**Cc:** Conant, Cameron [KDA]  
**Subject:** GMD Recommendation Request - File Nos. 24035 & 37261  
**Attachments:** 24035.Change App.pdf; 37261.Change App.pdf

Orrin,

I have attached a cover letter and copies of two (2) change applications for GMD recommendation. Please provide the GMD recommendation by no later than March 13, 2019.

Please let me know if you are needing anything else, or have any questions.

Thank you,  
Tyler

**Tyler Saryerwinnie**, Environmental Scientist  
Kansas Department of Agriculture  
Division of Water Resources  
Stafford Field Office  
Phone: (620)234-5311

Stafford Field Office  
300 S. Main Street  
Stafford, KS 67578-1521

# Kansas

Department of Agriculture  
*Division of Water Resources*

Phone: 620-234-5311  
Fax: 620-234-6900  
[www.agriculture.ks.gov](http://www.agriculture.ks.gov)

Mike Beam, Interim Secretary

Laura Kelly, Governor

February 21, 2019

Orrin Feril  
Big Bend – GMD No. 5  
125 S Main St.  
Stafford, KS 67578

RE: Place of Use Change Applications, File Nos. 24035 & 37261

Dear Mr. Feril,

We are enclosing copies of the applications, as referenced above, for your review and recommendation. At this time the applications appear to be in proper form.

This office will delay any further action on this file for a period of 15 business days from the date of this letter to allow you time to submit your recommendation concerning the applications. Please submit your recommendation within the allotted time, or any authorized extension of time thereof.

If you have any questions, please feel free to contact the office.

Sincerely,

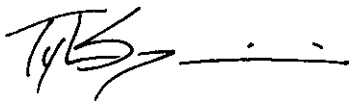

Tyler Saryerwinnic  
Environmental Scientist  
Stafford Field Office  
[tyler.saryerwinnic@ks.gov](mailto:tyler.saryerwinnic@ks.gov)

Enclosure Two (2) Change Applications

## Saryerwinnie, Tyler [KDA]

---

**From:** Orrin Feril <oferil@gmd5.org>  
**Sent:** Tuesday, February 26, 2019 10:34 AM  
**To:** Saryerwinnie, Tyler [KDA]  
**Subject:** Application for Change, Water Right, File Nos. 24035 37261  
**Attachments:** 24035 37261 2019-02-26 Rec.pdf

*EXTERNAL:* This email originated from outside of the organization. Do not click any links or open any attachments unless you trust the sender and know the content is safe.

Tyler,  
I'm attaching the recommendation requested by your office in a letter dated February 21, 2019. Please let me know if you have any questions.

Thank you for your consideration in this matter,

Orrin

--

*Orrin Feril*

Manager  
Big Bend GMD#5  
Email: [oferil@gmd5.org](mailto:oferil@gmd5.org)  
Phone: (620) 234-5352  
Mobile: (620) 388-0172  
Fax: (620) 234-5718  
[www.gmd5.org](http://www.gmd5.org)  
Facebook/Twitter: @BigBendGMD5

Darrell Wood - Edwards (Pres.)  
Fred Grunder - Pratt (V Pres.)  
John Janssen - Kiowa (Treas.)  
Jerry Cullop - Rice (Sec.)  
Justin Gatz - Reno  
Marlyn Spare - Stafford  
Phil Martin - Barton  
Kerry Froetschner - Pawnee  
Tom Taylor - At-Large

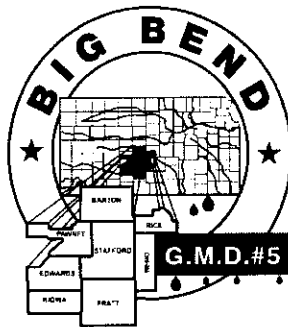

Orrin Feril, Manager  
125 South Main Street  
Stafford, Kansas 67578  
ph: (620) 234-5352  
fx: (620) 234-5718  
gmd5@gmd5.org  
www.gmd5.org

February 26, 2019

Tyler Saryerwinnie  
Division of Water Resources  
Kansas Department of Agriculture  
300 S. Main Street  
Stafford, Kansas 67578-1342

RE: Water Right File Nos. 24035 & 37261  
Change in the Place of Use

Dear Mr. Saryerwinnie,

Big Bend Groundwater Management District #5 has reviewed the above referenced applications. It is the understanding of the District that these changes are intended to create a complete overlap of the places of use for the two water rights. Based on the information received in the office, the applications appear to be consistent with 5-25-20(b) and are recommended for approval.

The applications to change are subject to the District's well equipment regulation K.A.R. 5-25-5 for a required flow meter.

Please feel free to give me a call if you have any questions.

Sincerely,

Orrin Feril  
Manager

RECEIVED  
FEB 28 2019  
Stafford Field Office  
DIVISION OF WATER RESOURCES