

Kansas Department of Agriculture  
 Division of Water Resources  
**CHANGE: P/U WORKSHEET**

1. File Number: <b>30994</b>	2. Status Change Date:	3. Change Num: <b>1</b>	4. Field Office: <b>02</b>	5. GMD:
---------------------------------	------------------------	----------------------------	-------------------------------	---------

6. Status: <input checked="" type="checkbox"/> Approved <input type="checkbox"/> Denied by DWR/GMD <input type="checkbox"/> Dismiss by Request/Failure to Return	7. Filing Date of Change: <b>4/4/19</b>
--	--

8a. Applicant(s)  New to system

Person ID \_\_\_\_\_  
Add Seq# \_\_\_\_\_

8c. Landowner(s)  New to system

Person ID **30551**  
Add Seq# **1**

**NAME CHANGE**

**EDWARD & MAXINE WOOLDRIDGE REV TRUSTS**  
**PO BOX 182**  
**ULYSSES KS 67880**

8b. Landowner(s)  New to system

Person ID \_\_\_\_\_  
Add Seq# **1**

**STEVEN L GEESLING TRUST**  
**3491 N STATE ROAD 14**  
**KINGMAN KS 67068-8043**

8d. WUC  New to system

Person ID **35044**  
Add Seq# **1**

**No Change**

**STEVE GEESLING**  
**3491 N STATE ROAD 14**  
**KINGMAN KS 67068-8043**

9. Documents and Enclosure(s):  DWR Meter(s) Date to Comply: **12/31/19**     N & P Date to Comply: \_\_\_\_\_

Anti-Reverse Meter     Meter Seal     Check Valve     N & P Form     Water Tube     Driller Copy     H & E Letter

Conservation Plan    Date Required: \_\_\_\_\_    Date Approved: **4/15/19**    Date to Comply: \_\_\_\_\_

10. Use Made of Water    From: \_\_\_\_\_    To: \_\_\_\_\_

Date Prepared: **4/10/19**    By: **TJS**  
 Date Entered: \_\_\_\_\_    By: \_\_\_\_\_

File No. <b>30994</b>	11. County: <b>KINGMAN</b>	Basin: <b>S F Ninnescah</b>	Stream: <b>---</b>	Formation Code: <b>---</b>	Special Use: <b>---</b>								
12. Points of Diversion CHK MOD DEL PDIV ENT	Qualifier S T R ID 'N 'W 1362	Comment (AKA Line)	Rate gpm/cfs	Quantity af/mgy	Rate gpm/cfs	Quantity af/mgy	Overlap PD Files						
<b>MOD 45786</b>	<b>SE NW NE 16 27S 8W 2</b>	<b>3969</b>	<b>1362</b>	<b>No change to rate or quant, better define w GPS</b>			<b>None</b>						
13. Storage: Rate _____ NF Quantity _____ ac/ft Additional Rate _____ NF Additional Quantity _____ ac/ft													
14. Limitation: _____ af/yr at _____ gpm (_____ cfs) when combined with file number(s) _____ Limitation: _____ af/yr at _____ gpm (_____ cfs) when combined with file number(s) _____													
15. 5YR Allocation: Allocation Type _____ Start Year _____ 5 YR Amount _____ Amount Unit _____ Base Acres _____ Comment _____													
16. Place of Use CHK MOD DEL ENT	PUSE	S	T	R	ID	NE 1/4 NW 1/4 SE 1/4 SW 1/4	NW 1/4 NE 1/4 SE 1/4 SW 1/4	SW 1/4 NW 1/4 SE 1/4 SW 1/4	SE 1/4 NW 1/4 SE 1/4 SW 1/4	Total	Owner	Chg?	Overlap Files
<b>MOD 28733</b>	<b>16 27S 8W 2</b>					27.7 29.3 30.4 27.9 30.1 28.3 30.3 31.3	30.1 27.2	28.3 31.6	20.7 25.8 24.7 19.6	326.1	<b>8b.</b>	<b>Yes</b>	<b>29650, 36968, 38988</b>
<b>ENT 24284</b>	<b>17 27S 8W 3</b>					28.9 30.5 31.4 29.9 27.2				178.7	<b>8b.</b>	<b>Yes</b>	<b>29650, 36968, 38988</b>
<b>ENT 31393</b>	<b>17 27S 8W 4</b>									59.9	<b>8c.</b>	<b>No</b>	<b>29650, 36968, 38988</b>
Base Acres: <b>130</b> Year: <b>Multiple</b> Minimum Reasonable Quantity: <b>1.15 AF/acre</b>													
Comments: <b>PD not actually changing, only modifying footage descriptions based on GPS data on file.</b>													

Submit completed application to:  
 Kansas Department of Agriculture  
 Division of Water Resources  
 Field Office for your area.  
 Call for address:

Topeka -- (785) 296-5733  
 Stafford -- (620) 234-5311  
 Stockton -- (785) 425-6787  
 Garden City -- (620) 276-2901  
<http://agriculture.ks.gov/dwr>

## DWR FIELD OFFICE APPLICATION FOR APPROVAL TO CHANGE THE PLACE OF USE AND/OR THE POINT OF DIVERSION



**STATE OF KANSAS**

**WATER METER REQUIRED**

**Filing Fee Must Accompany the Application, K.S.A. 82a-708b(b), as amended.**  
 Fee Schedule is on the third page of this application form.

**Paragraph Nos. 1, 2, 3 & 5 must be completed. Complete all other applicable portions.** If change in point of diversion is greater than 100 feet, or if place of use will be changed, include a topographic map or detailed plat showing the authorized and proposed point(s) of diversion and/or place of use.

File No. 30994

**RECEIVED**  
 9:47am  
 APR 04 2019

1. Application is hereby made for approval of the Chief Engineer to change the (check one or both):

Place of Use                       Point of Diversion

Stafford Field Office  
 Division of Water Resources

under the water right which is the subject of this application in accordance with the conditions described below.

The source of supply is:                       Groundwater                       Surface water

2. Name and address of Applicant: Scott Geesling

3491 N Hwy 14, Kingman KS 67068

Phone Number: (620)532-6021                      Email address: sgeesling@yahoo.com

Name and address of Water Use Correspondent: Steve Geesling

3491 N State Road 14, Kingman KS 67068-8043

Phone Number: (620)532-4245                      Email address: \_\_\_\_\_

3. The presently authorized place of use is:

Owner of Land ---- NAME: Steven L Geesling Trust

ADDRESS: 3491 N State Road 14, Kingman KS 67068-8043

(If there is more than one landowner, attach supplemental sheets as necessary.)

Sec.	Twp.	Range	NE¼				NW¼				SW¼				SE¼				TOTAL ACRES
			NE¼	NW¼	SW¼	SE¼	NE¼	NW¼	SW¼	SE¼	NE¼	NW¼	SW¼	SE¼	NE¼	NW¼	SW¼	SE¼	
16	27S	8W	40	40	40	40													160

4. If this application is for a change in place of use, it is proposed that the place of use be changed to:

Owner of Land ---- NAME: A.) Steven L Geesling Trust                      B.) Edward & Maxine Wooldridge Rev Trusts

ADDRESS: A.) 3491 N State Road 14, Kingman KS 67068-8043 B.) PO Box 182, Ulysses KS 67880

(If there is more than one landowner, attach supplemental sheets as necessary.)

Sec.	Twp.	Range	NE¼				NW¼				SW¼				SE¼				TOTAL ACRES	
			NE¼	NW¼	SW¼	SE¼	NE¼	NW¼	SW¼	SE¼	NE¼	NW¼	SW¼	SE¼	NE¼	NW¼	SW¼	SE¼		
A.) 16	27S	8W	27.7	29.3	30.4	27.9	30.1	28.3	30.3	31.3										326.1
A.) 17	27S	8W	28.9	30.5	31.4	29.9	27.2			30.8										178.7
B.) 17	27S	8W						28.3	31.6											59.9

Total = 564.7

<b>For Office Use Only:</b> Code _____ Fee \$ <u>200</u> - TR # _____ Receipt Date _____ Check # <u>10988</u>
---

5. **Presently authorized point of diversion:**  
 One in the \_\_\_\_\_ Quarter of the \_\_\_\_\_ Quarter of the NC NE Quarter  
 of Section 16, Township 27 South, Range 8 W,  
 in Kingman County, Kansas, 3920 feet North 1370 feet West of Southeast corner of section.  
 Authorized Rate 845 GPM Authorized Quantity 195 AF Depth of well --- (feet)  
**(DWR use only: Computer ID No. 2 GPS 3969 feet North 1362 feet West)**  
 This point will not be changed  This point will be changed as follows:  No change, point better described with GPS as follows:  
**Proposed point of diversion: (Complete only if change is requested or if existing point is better described by GPS)**  
 One in the SE Quarter of the NW Quarter of the NE Quarter  
 of Section 16, Township 27 South, Range 8 W,  
 in Kingman County, Kansas, 3969 feet North 1362 feet West of Southeast corner of section.  
 Proposed Rate No Change Proposed Quantity No Change Proposed well depth (feet) ---  
 This point is:  Additional Well  Geo Center List other water rights that will use this point None

6. **Presently authorized point of diversion:**  
 One in the \_\_\_\_\_ Quarter of the \_\_\_\_\_ Quarter of the \_\_\_\_\_ Quarter  
 of Section \_\_\_\_\_, Township \_\_\_\_\_ South, Range \_\_\_\_\_ (E/W),  
 in \_\_\_\_\_ County, Kansas, \_\_\_\_\_ feet North \_\_\_\_\_ feet West of Southeast corner of section.  
 Authorized Rate \_\_\_\_\_ Authorized Quantity \_\_\_\_\_ Depth of well \_\_\_\_\_ (feet)  
**(DWR use only: Computer ID No. \_\_\_\_\_ GPS \_\_\_\_\_ feet North \_\_\_\_\_ feet West)**  
 This point will not be changed  This point will be changed as follows:  No change, point better described with GPS as follows:  
**Proposed point of diversion: (Complete only if change is requested or if existing point is better described by GPS)**  
 One in the \_\_\_\_\_ Quarter of the \_\_\_\_\_ Quarter of the \_\_\_\_\_ Quarter  
 of Section \_\_\_\_\_, Township \_\_\_\_\_ South, Range \_\_\_\_\_ (E/W),  
 in \_\_\_\_\_ County, Kansas, \_\_\_\_\_ feet North \_\_\_\_\_ feet West of Southeast corner of section.  
 Proposed Rate \_\_\_\_\_ Proposed Quantity \_\_\_\_\_ Proposed well depth (feet) \_\_\_\_\_  
 This point is:  Additional Well  Geo Center List other water rights that will use this point \_\_\_\_\_

7. The changes herein are desired for the following reasons?  
 (please be specific) Creating a complete place of use  
overlap amongst File Nos. 29650, 30994, 36968, & 38988  
while also adding acreage in the SE 1/4 of Section 16.

8. If a well, is the test hole log attached?  Yes  No

9. The change(s) (was)(will be) completed by?  
ASAP

10. If the point of diversion is a well:  
 (a) What are you going to do with the old well?  
NA  
 (b) When will this be done? NA

11. Groundwater Management District recommendation attached?  Yes  No

12. Assisted by TJS - SFFO

13a. If the proposed point of diversion will be relocated more than 300 feet but within 2,640 feet of the existing point of diversion, attach a topographic map or aerial photograph. For groundwater sources, show all wells (including domestic) within one-half mile of the proposed point of diversion and the names and mailing addresses of the owners. For surface water sources, show the names and addresses of the landowner(s) one-half mile downstream and one-half mile upstream from your property lines

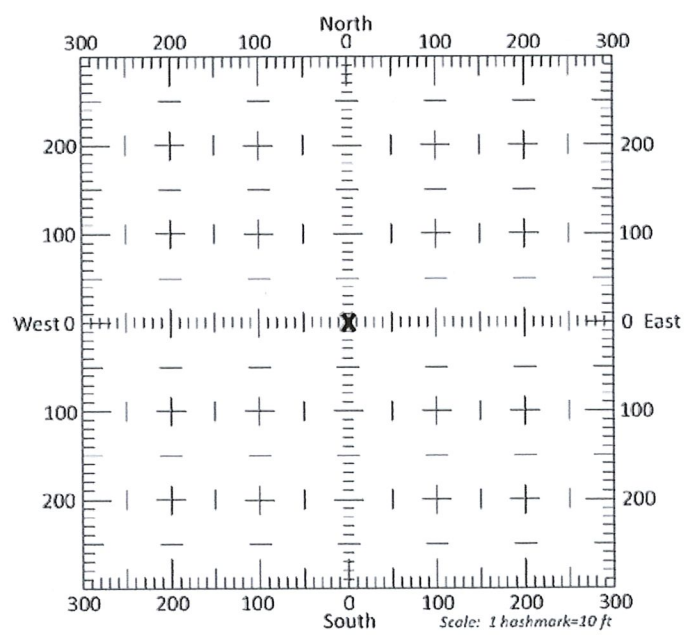

13b. If the proposed point of diversion will be relocated within 300 feet of the existing point of diversion, indicate its location on the diagram shown above in relation to the existing point of diversion. (PLEASE NOTE: The "X" in center of diagram above represents the presently authorized point of diversion.)

Stafford Field Office  
 Division of Water Resources

14. If the proposed groundwater point of diversion is 300 or fewer feet from the existing point of diversion, complete the following:
- (a) Does the undersigned represent all owners of the currently authorized place(s) of use identified in this application?  
 Yes     No    (If no, all owners must sign this application.)
  - (b) Will the ownership interest of any owner of the currently authorized place(s) of use identified in this application be adversely affected if this application is approved as requested?  
 Yes     No    (If yes, all owners must sign this application.)
  - (c) If this application is not approved expeditiously, will there be substantial damage to property, public health or safety?  
 Yes     No    (If no, all owners must sign this application.)

If the application proposes a surface water change in point of diversion, a groundwater change in point of diversion greater than 300 feet, or a change in place of use, the application must be signed by all owners of the currently authorized place of use, or their duly authorized agent (attach notarized statement authorizing representation).

I hereby verify, being first duly sworn upon my oath or affirmation and under penalty of perjury, that I am of lawful age and the owner, the spouse of the owner, or a duly authorized agent of the owner(s) to make this application on their behalf, in regards to the water right(s) to which this application pertains. I further verify that the statements contained in this application are true, correct and complete.

Dated at Kingman, Kansas, this 5 day of March, 2019.

<u>Steve Geesling</u> (Owner)	
<u>Steve Geesling</u> (Please Print)	
<u>Maxine Woodbridge</u> (Owner)	
<u>Maxine Woodbridge</u> (Please Print)	

State of Kansas }  
 County of Kingman } SS

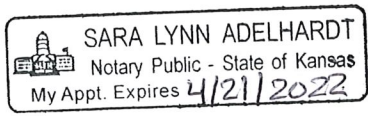

I hereby certify that the foregoing application was signed in my presence and sworn to before me this 5 day of March, 2019.

Sara Lynn Adelhardt  
 Notary Public

My Commission Expires April 21, 2022.

**ONLY COMPLETE APPLICATIONS WILL BE PROCESSED.** To be complete, all of the applicable portions of the application form must be completed with accurate information; maps, if necessary, must be included; signatures of all the appropriate owners' must be affixed to the application and notarized; and the appropriate fee must be paid.

**FEE SCHEDULE**

- Each application to change the place of use or the point of diversion under this section shall be accompanied by the application fee set forth in the schedule below: Make checks payable to: **Kansas Department of Agriculture**
- (1) Application to change a point of diversion 300 feet or less ..... \$100
  - (2) Application to change a point of diversion more than 300 feet ..... \$200
  - (3) Application to change the place of use ..... \$200

RECEIVED

APR 04 2019

**SUMMARY ORDER APPROVING APPLICATION FOR CHANGE AND IMPOSING CONDITIONS**

This Summary Order is issued under authority of K.S.A. 82a-708b, as amended, and K.A.R. 5-5-1, *et seq.* and other applicable provisions of the *Kansas Water Appropriation Law, K.S.A. 82a-701 et. seq.*, and rules and regulations promulgated thereunder, With the exception of those conditions expressly contained herein, this Summary Order does not change the terms, conditions and limitations of File No. 30994.

1. A change application was received on April 4, 2019 requesting that the place of use and / or point of diversion authorized under the above-referenced file number be changed as described in the application.
2. On and after the effective date of this summary order, the authorized place(s) of use shall be located substantially as shown on the topographic map accompanying the application to change the place of use.  Applicable  Not Applicable
3. The change in point of diversion shall not impair existing rights and shall be limited to the same source or sources of water as previously authorized. The point of diversion authorized by this summary order shall be located within a \_\_\_\_\_ foot radius of the authorized point(s) of diversion.  Applicable  Not Applicable
4. The point(s) of diversion described herein is administratively corrected to be more accurately described using the Global Positioning System (GPS), as described in the application.  Applicable  Not Applicable
5. The point(s) of diversion authorized herein shall not actually be located more than \_\_\_\_\_ feet from the previously authorized point(s) of diversion.  Applicable  Not Applicable
6. As required by K.A.R. 5-3-5d, if the works for diversion is a well with a diversion rate of 100 gallons per minute or more, a tube or other device suitable for making water level measurements shall be installed, operated and maintained in accordance with K.A.R. 5-6-13.  Applicable  Not Applicable
7. **The owner of the authorized place(s) of use shall properly install an acceptable water flow meter on or before December 31, 2019**, or before the first use of water, whichever occurs first. The water flow meter shall be installed, operated and maintained in accordance with K.A.R. 5-1-4 through 5-1-12. As required by K.S.A. 82a-732, as amended, and K.A.R. 5-3-5e, the owner shall maintain records and report the reading of the water flow meter and the total quantity of water diverted annually to the Chief Engineer by March 1 following the end of each calendar year.  
 Applicable  Not Applicable
8. **Installation of the works for diversion of water shall be completed on or before December 31, 20\_\_\_\_**, or within any authorized extension of time. By March 1, 20\_\_\_\_ the applicant shall notify the Chief Engineer that construction of the works for diversion has been completed, on the form provided by the Chief Engineer, as required by K.A.R. 5-8-4e.  
 Applicable  Not Applicable
9. **The completed well log shall be submitted with the required notice.**  Applicable  Not Applicable
10. All diversion works into which any type of chemical or other foreign substance will be injected into the water shall be equipped with an in-line, automatic, quick-closing check valve capable of preventing pollution of the source of the water supply. The check valve(s) shall be installed, operated and maintained in accordance with K.A.R. 5-3-5c.  Applicable  Not Applicable
11. Additional Conditions are attached.  Yes  No
12. In accordance with K.S.A. 82a-708a, as amended, and K.A.R. 5-5-14, all of the owners of the authorized place(s) of use of water appropriated under the above-referenced file number are responsible for compliance with its terms, conditions and limitations, as amended and/or supplemented by this Summary Order, and with applicable provisions of the *Kansas Water Appropriation Law* and the *Rules and Regulations* promulgated thereunder. Failure to comply with these provisions may result in civil penalties pursuant to K.S.A. 82a-737, as amended, and/or the suspension or revocation and dismissal of the water or appropriation right or any other enforcement actions authorized by law.

**Administrative Appeal and Effective Date of Order**

If you are aggrieved by this order, pursuant to K.S.A. 82a-1901, you may request an evidentiary hearing before the Chief Engineer or request administrative review by the Secretary of Agriculture. A request for hearing by the Chief Engineer must be filed within **15 days** of service of this Order and a request for administrative review by the Secretary must be filed within **30 days** pursuant to K.S.A. 77-531. Any request for administrative review must state a basis for review pursuant to K.S.A. 77-527. File any request with **Kansas Department of Agriculture, Legal Division, 1320 Research Park Drive, Manhattan, KS 66502**. Failure to timely request a hearing or review may preclude review under the Kansas Judicial Review Act.

*For Use by Register of Deeds*

FOR OFFICE USE ONLY  
**APPLICATION APPROVED AND SUMMARY ORDER ISSUED**

By: Cameron R. Covert  
Duly Authorized Designee of the Chief Engineer

(Print Name): Cameron R. Covert  
Division of Water Resources - Kansas Department of Agriculture

Date of Issuance: April 15, 2019

State of Kansas \_\_\_\_\_ )  
County of Stafford ) SS

Acknowledged before me on 4/15/19  
by Cameron Covert

Signature: Jessica Engelbrecht  
Notary Public

My commission expires \_\_\_\_\_  
JESSICA ENGBRECHT  
My Appointment Expires \_\_\_\_\_  
(Notary Seal 2021)

RECEIVED  
APR 04 2019

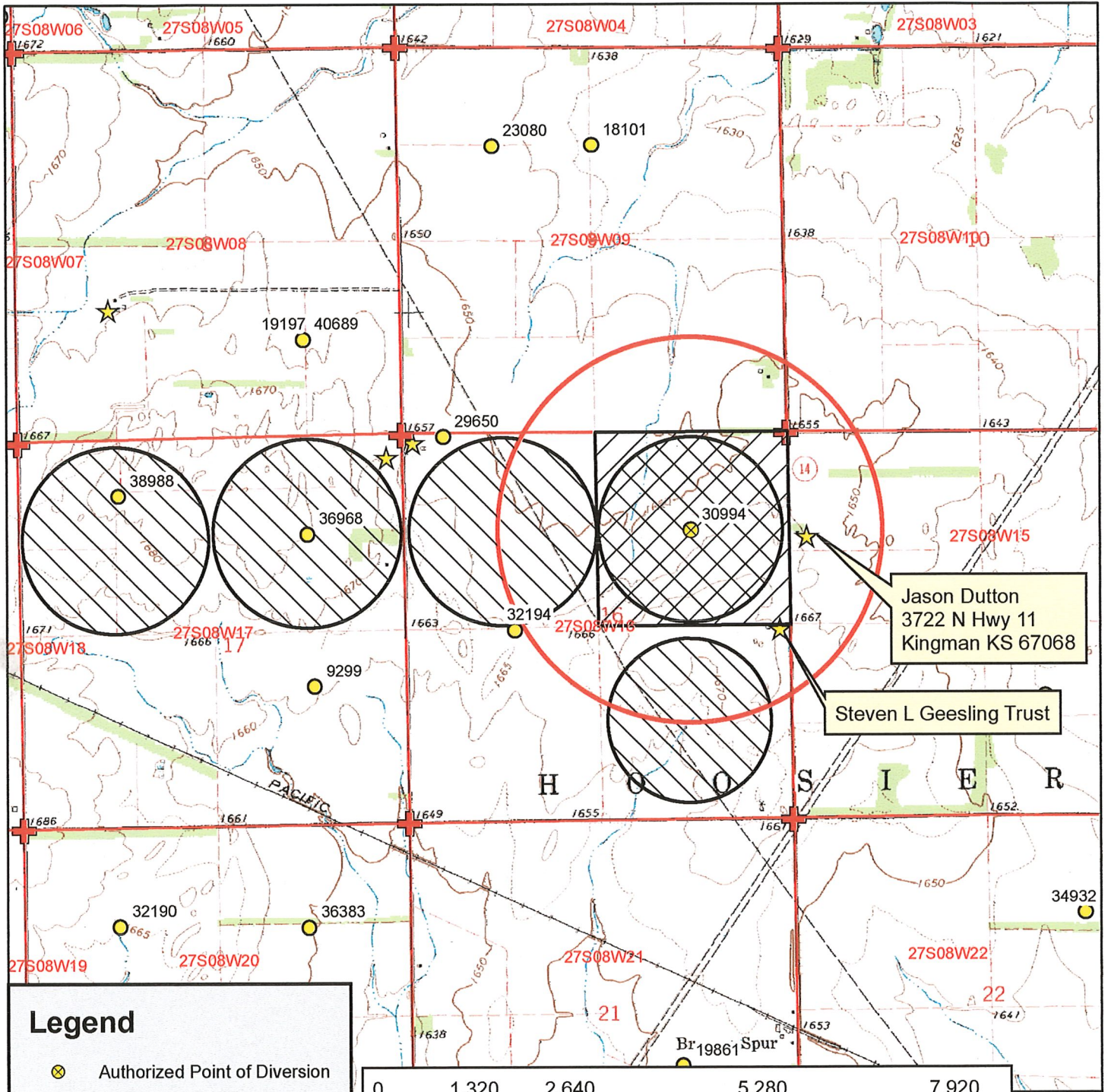

Jason Dutton  
3722 N Hwy 11  
Kingman KS 67068

Steven L Geesling Trust

**Legend**

- Authorized Point of Diversion
- Water Appropriations
- 1/2 Mile Buffer
- Domestic Well
- Section Line
- Section Corner

**Place of Use**

- Authorized
- Proposed



**Water Right, File No. 30994**  
Change in Place of Use, Application Map  
16-27S-8W // Kingman County



To the best of my knowledge, all water wells including domestic, within 1/2 mile of the authorized point of diversion have been shown.

RECEIVED  
APR 04 2019  
Signature  
Stafford Field Office  
Division of Water Resources

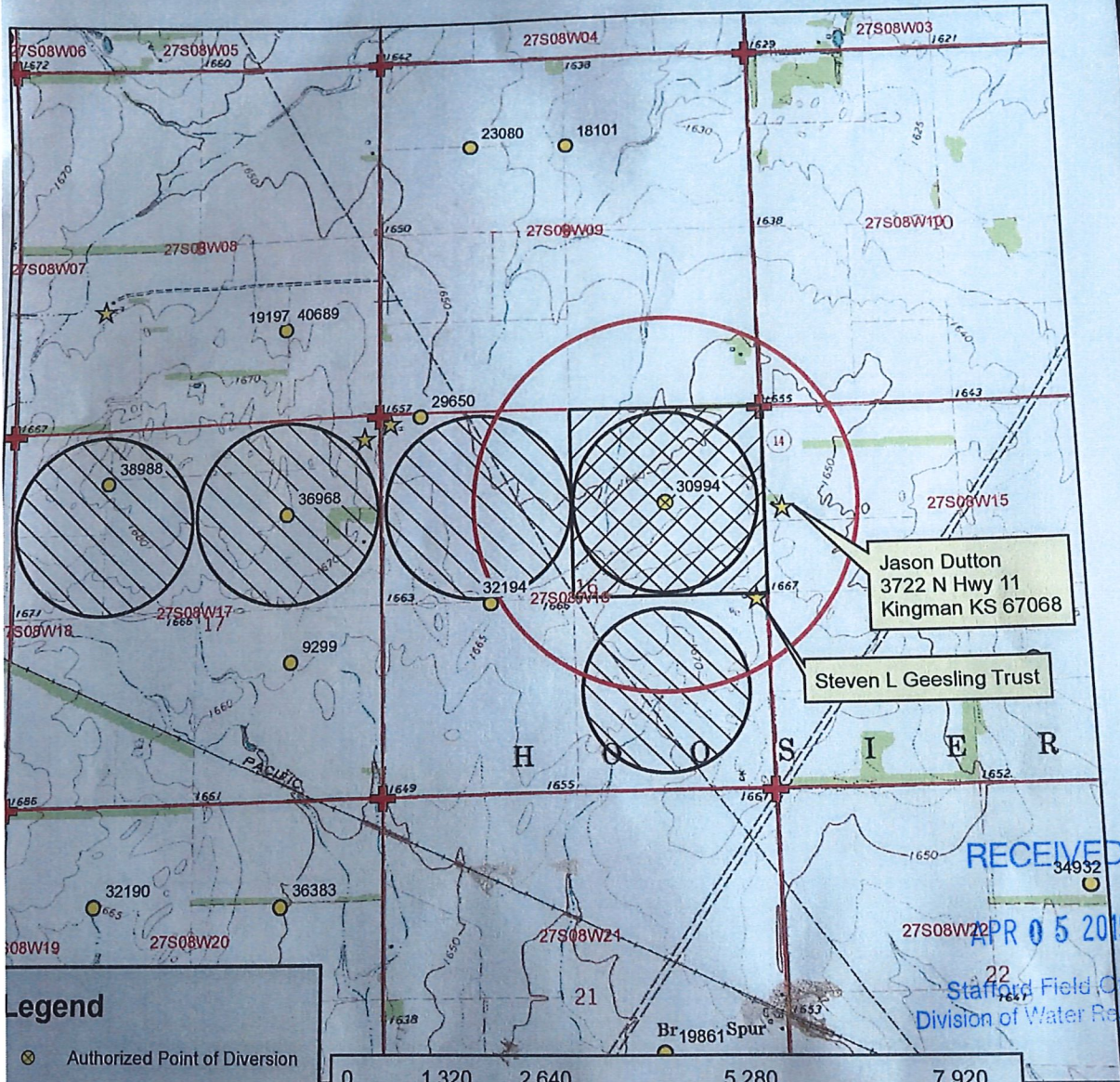

Jason Dutton  
3722 N Hwy 11  
Kingman KS 67068

Steven L Geesling Trust

RECEIVED

APR 05 2019

Stafford Field Office  
Division of Water Resources

**Legend**

- ⊗ Authorized Point of Diversion
- Water Appropriations
- 1/2 Mile Buffer
- ★ Domestic Well
- Section Line
- ⊕ Section Corner

**Place of Use**

- ▨ Authorized
- ▩ Proposed

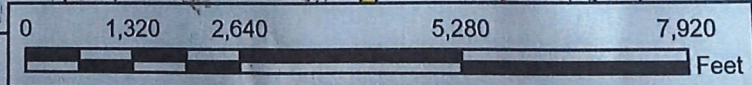

**Water Right, File No. 30994**  
Change in Place of Use, Application Map  
16-27S-8W // Kingman County



To the best of my knowledge, all water wells including domestic, within 1/2 mile of the authorized point of diversion have been shown.

*Steve Geesling*  
Signature





Stafford Field Office  
300 S. Main Street  
Stafford, KS 67578-1521

Phone: 620-234-5311  
Fax: 620-234-6900  
[www.agriculture.ks.gov](http://www.agriculture.ks.gov)

Mike Beam, Interim Secretary

Laura Kelly, Governor

April 15, 2019

Scott Geesling  
3491 N HWY 14  
Kingman KS 67068

Re: Water Right, File No(s). 30994

Dear Water Right Owner:

Enclosed is the order executed by the Chief Engineer, Division of Water Resources, Kansas Department of Agriculture, approving the application for change under the above referenced file number(s).

Your attention is directed to the enclosures and to the terms, conditions and limitations specified in this approval for change. An acceptable water flow meter must be installed on your well before any water is applied as authorized under this change approval. A copy of the approved list of Certified Water Flowmeters as well as the regulations regarding the installation of flowmeters, measurement tubes and check valves can be found at <http://agriculture.ks.gov/divisions-programs/dwr/water-appropriation/water-flowmeters>. If you do not have access to the internet, please contact this office and we will send you a paper copy of the referenced information.

Since this order modifies the original document referred to above, it should be recorded with the Register of Deeds as other instruments affecting real estate.

Should you have any questions, please feel free to contact this office. If you wish to refer to a specific file, please reference it when you contact us.

Sincerely,

A handwritten signature in black ink, appearing to read "Jeff Lanterman".

Jeff Lanterman  
Water Commissioner

Enclosures  
pc: Water Rights Section

## CERTIFICATE OF SERVICE

On this **15th** day of **April, 2019**, I hereby certify that the attached Change in Place of Use for Water Right, File No. **30994**, dated **April 15, 2019** was mailed via Certified U.S. mail to the following:

Scott Geesling  
3491 N HWY 14  
Kingman KS 67068

  
-----  
Staff