

Kansas Department of Agriculture
 Division of Water Resources
CHANGE: P/D WORKSHEET (DISMISSAL)

WRIS MODIFICATION

1. File Number: 31559	2. Status Change Date: 7/1/2019	3. Change Num: C2	4. Field Office: 02	5. GMD:
6. Status: <input type="checkbox"/> Approved <input checked="" type="checkbox"/> Denied by DWR/GMD <input type="checkbox"/> Dismiss by Request/Failure to Return				7. Filing Date of Change: 24-JAN-2019
8a. Applicant(s) New to system <input type="checkbox"/> FORREST G BUTTS 205 S CENTRAL AVE MULVANE KS 67110-1719		Person ID <u>2383</u> Add Seq# <u>1</u>	8c. Landowner(s) New to system <input type="checkbox"/> STEVEN J BUTTS ET AL 2610 E 110TH ST S MULVANE KS 67110	
8b. Landowner(s) New to system <input type="checkbox"/> FORREST G BUTTS REV TRUST 205 S CENTRAL AVE MULVANE KS 67110-1719		Person ID <u>66141</u> Add Seq# <u>1</u>	8d. WUC New to system <input type="checkbox"/> 8A no change	
9. Documents and Enclosure(s): <input type="checkbox"/> DWR Meter(s) Date to Comply: _____ <input type="checkbox"/> N & P Date to Comply: _____ <input type="checkbox"/> Anti-Reverse Meter <input type="checkbox"/> Meter Seal <input type="checkbox"/> Check Valve <input type="checkbox"/> N & P Form <input type="checkbox"/> Water Tube <input type="checkbox"/> Driller Copy <input type="checkbox"/> H & E Letter <input type="checkbox"/> Conservation Plan Date Required: _____ Date Approved: _____ Date to Comply: _____				
10. Use Made of Water From: _____ To: _____				
Date Prepared: 6/25/19 By: RAK Date Entered: 7/3/2019 By: UM				

File No. **31559** 11. County: **SG** Basin: **ARKANSAS RIVER** Stream: Formation Code: Special Use:

12. Points of Diversion
 CHK Rate and Quantity
 MOD Authorized Additional
 DEL PDIV Qualifier S T R ID 'N 'W Comment (AKA Line) Rate Quantity Rate Quantity
 ENT gpm/cfs af/mgy gpm/cfs af/mgy Overlap PD Files

NO CHANGES

13. Storage: Rate _____ NF Quantity _____ ac/ft Additional Rate _____ NF Additional Quantity _____ ac/ft

14. Limitation: _____ af/yr at _____ gpm (_____ cfs) when combined with file number(s) _____
 Limitation: _____ af/yr at _____ gpm (_____ cfs) when combined with file number(s) _____

15. 5YR Allocation: Allocation Type _____ Start Year _____ 5 YR Amount _____ Amount Unit _____ Base Acres _____ Comment _____

16. Place of Use CHK MOD DEL ENT	PUSE	S	T	R	ID	NE¼				NW¼				SW¼				SE¼				Total	Owner	Chg?	Overlap Files
						NE ¼	NW ¼	SW ¼	SE ¼	NE ¼	NW ¼	SW ¼	SE ¼	NE ¼	NW ¼	SW ¼	SE ¼	NE ¼	NW ¼	SW ¼	SE ¼				
✓	26480	28	29	1E	3									5.50			38.00			16.50		60.00	8b	NO	NO
ENT	10218	28	29	1E	1			14 ac 0 new ac	16 ac 0 new ac													30.00	8c	YES	7150
DEL	68940	28	29	1E	8			14	16													30.00			

Base Acres: Year: Minimum Reasonable Quantity:
 Comments: **FIX WRIS TO SHOW INCOMPLETE OLAP IN PU in S½NE¼ 28-29S-1E WITH FILE NO 7150 per 5-22-18 chg pu approval**

KANSAS DEPARTMENT OF AGRICULTURE
Division of Water Resources

MEMORANDUM

TO: Files

DATE: June 25, 2019

FROM: Richelle A. Krueger

RE: Water Right
File No. 31,559

An application to change the point of diversion was received in the office of the Chief Engineer on January 24, 2019 under the above referenced water right, authorized groundwater for irrigation use in the Arkansas River Basin in Sedgwick County. The referenced file number has no overlaps in the two points of diversion but the place of use incompletely overlaps Water Right, File No. 7,150. The water right owners proposed to change one of the two authorized points of diversion by creating a battery of three (3) wells with a geographic center located 1,140 feet North and 2,904 feet West of the Southeast corner of Section 28, Township 29 South, Range 1 East, Sedgwick County, Kansas. The purpose was to authorize existing wells.

In a letter dated May 13, 2019, the water right owners were advised that the Application to Change the Authorized Point of Diversion for File No. 31,559 would be recommended for denial since the application did not meet the requirements of K.A.R. 5-2-3(b) Battery of wells - the time to construct the diversion works has expired and a new application to appropriate water could not be approved because safe yield is not met at the proposed geocenter location.

That further action on the application was delayed until June 3, 2019 to allow the water right owners time to submit additional information to be considered by the Chief Engineer.

Since no additional information was received by that date, the application should be dismissed for failure to meet the requirements of K.A.R. 5-2-3(b).

Richelle A. Krueger
Environmental Scientist

1320 Research Park Drive
Manhattan, KS 66502
785-564-6700
www. agriculture.ks.gov



900 SW Jackson, Room 456
Topeka, KS 66612
785-296-3556

Mike Beam, Secretary

Laura Kelly, Governor

FILE COPY

FORREST G BUTTS REVOCABLE TRUST
205 S CENTRAL AVE
MULVANE KS 67110

July 5, 2019

RE: Water Right, File No. 31,559

Dear Mr. Butts:

Enclosed are the Findings and Order by the Chief Engineer, Division of Water Resources, Kansas Department of Agriculture, which dismisses the Application for Approval to Change the Point of Diversion under Water Right, File No. 31,559, received on January 24, 2019. This dismissal is a result of the failure of the proposed change to meet the requirements of the rules and regulations of the State of Kansas, specifically K.A.R. 5-2-3(b) Battery of wells.

Please be reminded that reports of water usage must be submitted to this office annually. Records indicating the amount of water used should be furnished to the Chief Engineer by March 1 following the end of the previous calendar year so that the continued use of water becomes a matter of record in this office.

If you have any questions, please contact this office. If you wish to discuss a specific file, please have the file number ready so that we may help you more efficiently.

Sincerely,

Brent A. Turney, P.G.
Change Application Unit Supervisor
Division of Water Resources

BAT:rak
Enclosure(s)

pc: Stafford Field Office
Steven J. Butts etal

THE STATE OF KANSAS



KANSAS DEPARTMENT OF AGRICULTURE
Mike Beam, Secretary of Agriculture

DIVISION OF WATER RESOURCES
David W. Barfield, Chief Engineer

**FINDINGS AND ORDER
IN THE MATTER OF THE DISMISSAL
OF AN APPLICATION FOR APPROVAL
TO CHANGE THE AUTHORIZED POINT OF DIVERSION
WATER RIGHT
FILE NO. 31,559**

After due consideration, the Chief Engineer, Division of Water Resources, Kansas Department of Agriculture (hereinafter referred to as the "Chief Engineer"), makes the following findings and order:

FINDINGS

1. That on January 24, 2019, An Application for Approval to Change the Authorized Point of Diversion, was received in the office of the Chief Engineer for Water Right, File No. 31,559.
2. That in a letter dated May 13, 2019, the water right owners were advised that the Application for Approval to Change the Authorized Point of Diversion for File No. 31,559 would be recommended for denial due to the failure of the application to meet K.A.R 5-2-3(b) *Battery of wells* since a new application to appropriate water filed to appropriate water at the geocenter of the proposed battery of wells would not meet the safe yield, allowable appropriation, or similar type of regulation, for a well filed at that location.
3. That further action on the application was delayed until June 3, 2019 to allow the water right owner time to submit additional information to be considered by the Chief Engineer
4. Since no additional information was received by that date, and no request for a further extension of time has been received, the application for File No. 31,559 should be dismissed and its priority forfeited for failure to meet the requirements of K.A.R 5-2-3(b) *Battery of wells*.

ORDER

NOW, THEREFORE, It is the decision and order of the Chief Engineer, Division of Water Resources, Kansas Department of Agriculture, that effective the date of this order, the Application for Approval to Change the Point of Diversion, received on January 24, 2019, under Water Right, File No. 31,559, shall be dismissed.

In all other respects, the Certificate of Appropriation for Beneficial Use of Water, issued pursuant to File No. 31,559, dated April 14, 1993, remains as authorized and amended by the Order of the Chief Engineer dated May 22, 2018.

RIGHT TO A HEARING AND TO ADMINISTRATIVE REVIEW

If you are aggrieved by this Order, then pursuant to K.S.A. 82a-1901, you may:

- 1) request an evidentiary hearing before the Chief Engineer, or
- 2) request administrative review by the Secretary of Agriculture.

Failure to request an evidentiary hearing before the Chief Engineer does not preclude your right to administrative review by the Secretary.

To obtain an evidentiary hearing before the Chief Engineer, a written request for hearing must be filed within 15 days after service of this Order as provided in K.S.A. 77-531 (i.e., within a total of 18 days after this Order was mailed to you), with the Kansas Department of Agriculture, Attn: Legal Section, 1320 Research Park Drive, Manhattan, Kansas 66502, or by FAX (785) 564-6777.

If you do not file a request for an evidentiary hearing before the Chief Engineer, you may petition for administrative review of the Order by the Secretary of Agriculture. A petition for review shall be in writing and state the basis for requesting administrative review. The request for review may be denied if the request fails to clearly establish factual or legal issues for review. See K.S.A. 77-527. The petition must be filed within 30 days after service of this Order as provided in K.S.A. 77-531 (i.e., within a total of 33 days after this Order was mailed to you), and be filed with the Secretary of Agriculture, Attn: Legal Division, Kansas Department of Agriculture, 1320 Research Park Drive, Manhattan, Kansas 66502, or by FAX (785) 564-6777.

If neither a request for an evidentiary hearing nor a petition for administrative review is filed as set forth above, then this Order shall be effective and become a final agency action as defined in K.S.A. 77-607(b). Failure to timely request either an evidentiary hearing or administrative review may preclude further judicial review under the Kansas Judicial Review Act.

Any request for hearing or petition for administrative review shall be in writing and shall be submitted to the attention of: Chief Legal Counsel, Kansas Department of Agriculture, 1320 Research Park Drive, Manhattan, Kansas 66502, Fax: (785) 564-6777.

Ordered this 1st day of July, 2019, in Manhattan, Riley County, Kansas.

Lane P. Letourneau

Lane P. Letourneau, P.G.
Program Manager
Water Appropriation Program
Division of Water Resources
Kansas Department of Agriculture

State of Kansas)
) SS
County of Riley)

July The foregoing instrument was acknowledged before me this 1st day of _____, 2019, by Lane P. Letourneau, P.G., Program Manager, Water Appropriation Program, Division of Water Resources, Kansas Department of Agriculture.

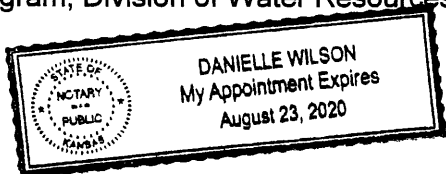

Danielle Wilson
Notary Public

CERTIFICATE OF SERVICE

On this 5th day of July, 2019, I hereby certify that the attached original Findings and Order, File No. 31,559, dated July 1st, 2019, was mailed postage prepaid, first class, US mail to the following:

FORREST G BUTTS REV TRUST
205 S CENTRAL AVE
MULVANE KS 67110

With a photocopy to:

STEVEN J BUTTS ET AL
2610 E 110TH ST S
MULVANE KS 67110

Stafford Field Office

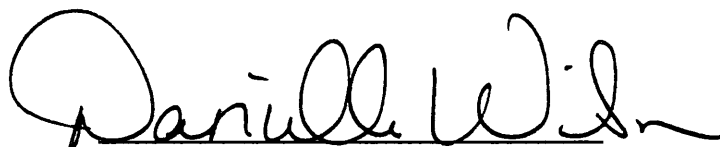
Division of Water Resources

JAN 22 2019

Submit To: CHIEF ENGINEER
Division of Water Resources
Kansas Department of Agriculture
1320 Research Park Drive
Manhattan, Kansas 66502
http://agriculture.ks.gov/dwr

**APPLICATION FOR APPROVAL TO
CHANGE THE PLACE OF USE, THE
POINT OF DIVERSION OR THE USE
MADE OF THE WATER UNDER AN
EXISTING WATER RIGHT**



Filing Fee Must Accompany the Application
(Please refer to Fee Schedule on signature page of application form.)

Paragraph Nos. 1, 2, 3, 4 & 8 must be completed. Complete all other applicable portions. A topographic map or detailed plat showing the authorized and proposed points(s) of diversion and /or place of use must accompany this application.

1. Application is hereby made for approval of the Chief Engineer to change the

- Place of Use
- (Check one or more) Point of Diversion
- Use Made of Water

Water Resources
Received
JAN 24 2019
11:51
KS Dept Of Agriculture

File No. 31559

2. Name of applicant: Forrest G Butts

Address: 205 S Central Ave

City, State and Zip: Mulvane KS 67110

Phone Number: (316)777-1797 E-mail address: _____

What is your relationship to the water right; owner tenant agent other? If other, please explain. _____

Name of water use correspondent: Forrest G Butts

Address: 205 S Central Ave

City, State and Zip: Mulvane KS 67110

Phone Number: (316) 777-1797 E-mail address: _____

3. The change(s) proposed herein are desired for the following reasons (please be specific): Convert the west well from a single well to a battery of three wells.

The change(s) will be completed by December 31, 2018

(Date)

For Office Use Only:					
F.O. <u>2</u>	GMD <u>CGT</u>	Meets K.A.R. 5-5-1 (YES / NO)	Use <u>1/2/2</u>	Source <u>G</u> S County <u>SG</u>	By <u>DAW</u> Date <u>1/24/19</u>
Code	<u>CGT</u>	Fee \$ <u>200</u>	TR #	Receipt Date <u>1/24/19</u>	Check # <u>1274</u>

1/30/2019 ULM

4. The presently authorized place of use is:

Owner of Land — NAME: Forrest G Butts Revocable Trust

ADDRESS: 205 S Central Ave, Mulvane KS 67110

Sec.	Twp.	Range	NE¼				NW¼				SW¼				SE¼				TOTAL ACRES	
			NE¼	NW¼	SW¼	SE¼	NE¼	NW¼	SW¼	SE¼	NE¼	NW¼	SW¼	SE¼	NE¼	NW¼	SW¼	SE¼		
28	29	1E											5.5						16.5	60

List any other water rights that cover this place of use. none

Owner of Land — NAME: Steven J Butts et al

ADDRESS: 205 S Central Ave, Mulvane KS 67110

Sec.	Twp.	Range	NE¼				NW¼				SW¼				SE¼				TOTAL ACRES	
			NE¼	NW¼	SW¼	SE¼	NE¼	NW¼	SW¼	SE¼	NE¼	NW¼	SW¼	SE¼	NE¼	NW¼	SW¼	SE¼		
28	29	1E			14	16														30

List any other water rights that cover this place of use. 7150

(If there are more than two landowners, attach additional sheets as necessary.)

5. It is proposed that the place of use be changed to:

Owner of Land — NAME: No Change

ADDRESS: _____

Sec.	Twp.	Range	NE¼				NW¼				SW¼				SE¼				TOTAL ACRES	
			NE¼	NW¼	SW¼	SE¼	NE¼	NW¼	SW¼	SE¼	NE¼	NW¼	SW¼	SE¼	NE¼	NW¼	SW¼	SE¼		

List any other water rights that cover this place of use. _____

Owner of Land — NAME: _____

ADDRESS: _____

Sec.	Twp.	Range	NE¼				NW¼				SW¼				SE¼				TOTAL ACRES	
			NE¼	NW¼	SW¼	SE¼	NE¼	NW¼	SW¼	SE¼	NE¼	NW¼	SW¼	SE¼	NE¼	NW¼	SW¼	SE¼		

List any other water rights that cover this place of use. _____

IF MORE SPACE IS NEEDED, ATTACH ADDITIONAL SHEETS AS NECESSARY

6. The presently authorized point(s) of diversion is two wells and diversion systems
(Provide description and number of points)
7. The proposed point(s) of diversion are one well and a battery of three wells and diversion systems
(Provide description and number of points)

List all presently authorized point(s) of diversion:

8. **Presently authorized point of diversion:**
 One in the SE Quarter of the NW Quarter of the SE Quarter of Section 28, Township 29 South, Range 1 E, in Sedgwick County, Kansas, 1,584 feet North 1,348 feet West of Southeast corner of section. Authorized Rate 720 gpm Authorized Quantity 57 AF
 (DWR use only: Computer ID No. 08 GPS 1,584 feet North 1,348 feet West)
 This point will not be changed This point will be changed as follows:
Proposed point of diversion: (Complete only if change is requested):
 One in the _____ Quarter of the _____ Quarter of the _____ Quarter of Section _____, Township _____ South, Range _____ (E/W), in _____ County, Kansas, _____ feet North _____ feet West of Southeast corner of section. Proposed Rate _____ Proposed Quantity _____
 This point is: Additional Well Geo Center List other water rights that will use this point none

9. **Presently authorized point of diversion:**
 One in the NE Quarter of the SE Quarter of the SW Quarter of Section 28, Township 29 South, Range 1 E, in Sedgwick County, Kansas, 1,107 feet North 2,845 feet West of Southeast corner of section. Authorized Rate 540 gpm Authorized Quantity 65 AF
 (DWR use only: Computer ID No. 04 GPS 1,107 feet North 2,845 feet West)
 This point will not be changed This point will be changed as follows:
Proposed point of diversion: (Complete only if change is requested) will be one of three wells of a battery
 One in the no change Quarter of the no change Quarter of the no change Quarter of Section no change, Township no change South, Range no change E, in No change County, Kansas, no change feet North no change feet West of Southeast corner of section. Proposed Rate see geocenter Proposed Quantity see geocenter
 This point is: Additional Well Geo Center List other water rights that will use this point none

10. **Presently authorized point of diversion:**
 One in the _____ Quarter of the _____ Quarter of the _____ Quarter of Section _____, Township _____ South, Range _____ (E/W), in _____ County, Kansas, _____ feet North _____ feet West of Southeast corner of section. Authorized Rate _____ Authorized Quantity _____
 (DWR use only: Computer ID No. _____ GPS _____ feet North _____ feet West)
 This point will not be changed This point will be changed as follows:
Proposed point of diversion: (Complete only if change is requested) GeoCenter of a battery of three wells
 One in the NE Quarter of the SE Quarter of the SW Quarter of Section 28, Township 29 South, Range 1 E, in Sedgwick County, Kansas, 1,140 feet North 2,904 feet West of Southeast corner of section. Proposed Rate 540 gpm Proposed Quantity 65 AF
 This point is: Additional Well Geo Center List other water rights that will use this point none

11. Describe the current condition of and future plans for any point(s) of diversion which will no longer be used. N/A

IF MORE SPACE IS NEEDED, ATTACH ADDITIONAL SHEETS AS NECESSARY

12. The presently authorized use of water is for irrigation purposes.

It is proposed that the use be changed to --- purposes.

13. If changing the place of use and/or use made of water, describe how the consumptive use will not be increased.

No changes to the place of use or use made of water are proposed with this application.

(Please show any calculations here.)

14. It is requested that the maximum annual quantity of water be reduced to --- (acre-feet or million gallons).

15. It is requested that the maximum rate of diversion of water be reduced to --- gallons per minute (--- c.f.s.).

16. The application must include either a topographic map or detailed plat. A U.S. Geological Survey Topographic Map, scale 1:24,000, is available through the Kansas Geological Survey, 1930 Constant Avenue, University of Kansas, Lawrence, Kansas 66047-3726 (www.usgs.gov). The map should show the location of the presently authorized point(s) of diversion. Distances North and West of the Southeast corner of the section must be shown. The presently authorized place of use should also be shown. Identify the center of the section, the section lines and the section corners and show the appropriate section, township, and range numbers on the map. In addition the following information must also be shown on the map.

a. If a change in the location of the point(s) of diversion is proposed, show:

- 1) The location of the proposed point(s) of diversion. Distances North and West of the Southeast corner of the section must be shown. Please be certain that the information shown on the map agrees with the information shown in Paragraph Nos. 9, 10 and 11 of the application.
- 2) If the source of supply is groundwater, please show the location of existing water wells of any kind, including domestic wells, within 1/2 mile of the proposed well or wells. Identify each well as to its use and furnish name and mailing address of the property owner or owners. If there are no wells within 1/2 mile, please indicate so on the map.
- 3) If the source of supply is surface water, the names and mailing addresses of all landowner(s) 1/2 mile downstream and 1/2 mile upstream from your property lines must be shown.

b. If a change in the place of use is desired, show the proposed place of use by crosshatching on the map. Please be certain that the information shown on the map agrees with the information shown in Paragraph No. 5 of the application.

17. Attach documentation to show the change(s) proposed herein will not impair existing water rights and relates to the same local source of supply as to which the water right relates. This information may include statements, plats, geology reports, well logs, test hole logs, and other information as necessary information to show the above. Additional comments may be made below.

18. If the proposed change(s) does not meet all applicable rules and regulations of the Kansas Water Appropriation Act, please identify the rules and regulations for which you request a waiver. State the reason why a waiver is needed and why the request should be granted. Attach documentation showing that granting the request will not impair existing water rights and will not prejudicially and unreasonably affect the public interest.

Water Resources
Received

JAN 24 2019

RECEIVED KS Dept Of Agriculture

IF MORE SPACE IS NEEDED, ATTACH ADDITIONAL SHEETS AS NECESSARY

JAN 22 2019 SCANNED

APPLICATION FOR APPROVAL TO CHANGE
THE PLACE OF USE AND/OR POINT OF DIVERSION
SUPPLEMENTAL SHEET
FILE NO. 31559

Presently authorized point of diversion:
One in the _____ Quarter of the _____ Quarter of the _____ Quarter
of Section _____, Township _____ South, Range _____ (E/W),
in _____ County, Kansas, _____ feet North _____ feet West of Southeast corner of section.
Authorized Rate _____ Authorized Quantity _____ Depth of well _____ (feet)
(DWR use only: Computer ID No. _____ GPS _____ feet North _____ feet West)
 This point will not be changed This point will be changed as follows:
Proposed point of diversion: (Complete only if change is requested) will be one of three wells of a battery
One in the _____ NE Quarter of the _____ SE Quarter of the _____ SW Quarter
of Section _____ 28 _____, Township _____ 29 _____ South, Range _____ 1 _____ E,
in Sedgwick _____ County, Kansas, _____ 1,155 _____ feet North _____ 2,950 _____ feet West of Southeast corner of section.
Proposed Rate _____ see geocenter _____ Proposed Quantity _____ see geocenter _____ Proposed well depth (feet) _____
This point is: Additional Well Geo Center List other water rights that will use this point none

Presently authorized point of diversion:
One in the _____ Quarter of the _____ Quarter of the _____ Quarter
of Section _____, Township _____ South, Range _____ (E/W),
in _____ County, Kansas, _____ feet North _____ feet West of Southeast corner of section.
Authorized Rate _____ Authorized Quantity _____ Depth of well _____ (feet)
(DWR use only: Computer ID No. _____ GPS _____ feet North _____ feet West)
 This point will not be changed This point will be changed as follows:
Proposed point of diversion: (Complete only if change is requested) will be one of three wells of a battery
One in the _____ NE Quarter of the _____ SE Quarter of the _____ SW Quarter
of Section _____ 28 _____, Township _____ 29 _____ South, Range _____ 1 _____ E,
in Sedgwick _____ County, Kansas, _____ 1,158 _____ feet North _____ 2,918 _____ feet West of Southeast corner of section.
Proposed Rate _____ see geocenter _____ Proposed Quantity _____ see geocenter _____ Proposed well depth (feet) _____
This point is: Additional Well Geo Center List other water rights that will use this point none

Presently authorized point of diversion:
One in the _____ Quarter of the _____ Quarter of the _____ Quarter
of Section _____, Township _____ South, Range _____ (E/W),
in _____ County, Kansas, _____ feet North _____ feet West of Southeast corner of section.
Authorized Rate _____ Authorized Quantity _____ Depth of well _____ (feet)
(DWR use only: Computer ID No. _____ GPS _____ feet North _____ feet West)
 This point will not be changed This point will be changed as follows:
Proposed point of diversion: (Complete only if change is requested)
One in the _____ Quarter of the _____ Quarter of the _____ Quarter
of Section _____, Township _____ South, Range _____ (E/W),
in _____ County, Kansas, _____ feet North _____ feet West of Southeast corner of section.
Proposed Rate _____ Proposed Quantity _____ Proposed well depth (feet) _____
This point is: Additional Well Geo Center List other water rights that will use this point _____

Presently authorized point of diversion:
One in the _____ Quarter of the _____ Quarter of the _____ Quarter
of Section _____, Township _____ South, Range _____ (E/W),
in _____ County, Kansas, _____ feet North _____ feet West of Southeast corner of section.
Authorized Rate _____ Authorized Quantity _____ Depth of well _____ (feet)
(DWR use only: Computer ID No. _____ GPS _____ feet North _____ feet West)
 This point will not be changed This point will be changed as follows:
Proposed point of diversion: (Complete only if change is requested)
One in the _____ Quarter of the _____ Quarter of the _____ Quarter
of Section _____, Township _____ South, Range _____ (E/W),
in _____ County, Kansas, _____ feet North _____ feet West of Southeast corner of section.
Proposed Rate _____ Proposed Quantity _____ Proposed well depth (feet) _____
This point is: Additional Well Geo Center List other water rights that will use this point _____

Water Resources

Received

JAN 24 2019

KS Dept Of Agriculture

RECEIVED

JAN 22 2019

SCANNED

Any use of water that is not as authorized by the water right or permit to authorize water before the chief engineer approves this application is a violation of the Kansas Water Appropriation Act for which criminal or civil penalties may be assessed. Such violation is a class C misdemeanor, punishable by a fine not to exceed \$500 and/or a term of confinement not to exceed one month in the county jail. K.S.A. 82a-728(b). Civil penalties shall be not less than \$100 nor more than \$1,000 per violation. In the case of a continuing violation, each day such violation continues may be deemed a separate violation. In addition to these penalties the water right may be modified or suspended. K.S.A. 82a-737, as amended.

The application must be signed by all owners of the place of use authorized under the water right and his or her spouse, if married. Please indicate if there is no spouse. If land is being purchased under contract, the seller must sign as landowner until such time as the contract is completed.

In the event that all applicants cannot appear before one notary public, they may as necessary sign separate copies of the application before any notary public conveniently available to them. All copies signed in this manner shall be considered to be valid parts of the application.

If the request is signed on behalf of any Owner by someone with legal authority to do so (for example, an agent, one who has power of attorney, or an executor, executrix, conservator), it will be necessary to attach proper documents showing such authority.

I declare that I am an owner of the currently authorized place of use as identified herein, or that I represent all such owners and am authorized to make this application on their behalf, and declare further that the statements contained herein are true, correct, and complete. By filing this application I authorize the chief engineer to permanently reduce the quantity of water and/or rate of diversion as specified in sections 14 and 15 of this application.

Dated at Mulvane, Kansas, this 4th day of January, 2019.

Forrest G Butts
(Owner)
Forrest G Butts
(Please Print)

(Owner)

(Please Print)

(Owner)

(Please Print)

(Spouse)

(Please Print)

(Spouse)

(Please Print)

(Spouse)

(Please Print)

State of Kansas }
County of Sumner } SS



I hereby certify that the foregoing application was signed in my presence and sworn to before me this 4th day of January, 2019.

Beckie Bowers
Notary Public

My Commission Expires 4-20-21

FEE SCHEDULE

Each application to change the place of use, the point of diversion or the use made of the water under this section shall be accompanied by the application fee set forth in the schedule below:

- (1) Application to change a point of diversion 300 feet or less \$100
- (2) Application to change a point of diversion more than 300 feet \$200
- (3) Application to change the place of use \$200
- (4) Application to change the use made of the water \$300

Make check payable to Kansas Department of Agriculture.

Water Resources
Received
RECEIVED
JAN 22 2019
JAN 24 2019
KS Dept Of Agriculture
SCANNED
Stafford Field Office
Division of Water Resources

Any use of water that is not as authorized by the water right or permit to authorize water before the chief engineer approves this application is a violation of the Kansas Water Appropriation Act for which criminal or civil penalties may be assessed. Such violation is a class C misdemeanor, punishable by a fine not to exceed \$500 and/or a term of confinement not to exceed one month in the county jail. K.S.A. 82a-728(b). Civil penalties shall be not less than \$100 nor more than \$1,000 per violation. In the case of a continuing violation, each day such violation continues may be deemed a separate violation. In addition to these penalties the water right may be modified or suspended. K.S.A. 82a-737, as amended.

The application must be signed by all owners of the place of use authorized under the water right and his or her spouse, if married. Please indicate if there is no spouse. If land is being purchased under contract, the seller must sign as landowner until such time as the contract is completed.

In the event that all applicants cannot appear before one notary public, they may as necessary sign separate copies of the application before any notary public conveniently available to them. All copies signed in this manner shall be considered to be valid parts of the application.

If the request is signed on behalf of any Owner by someone with legal authority to do so (for example, an agent, one who has power of attorney, or an executor, executrix, conservator), it will be necessary to attach proper documents showing such authority.

I declare that I am an owner of the currently authorized place of use as identified herein, or that I represent all such owners and am authorized to make this application on their behalf, and declare further that the statements contained herein are true, correct, and complete. By filing this application I authorize the chief engineer to permanently reduce the quantity of water and/or rate of diversion as specified in sections 14 and 15 of this application.

Dated at Austin Texas 3rd day of January, 2019

Bradley Cary Butts (Owner) (Spouse)
Bradley Cary Butts (Please Print) (Please Print)
(Owner) (Spouse)
(Please Print) (Please Print)
(Owner) (Spouse)
(Please Print) (Please Print)

State of Kansas }
County of Travis } SS

I hereby certify that the foregoing application was signed in my presence and sworn to before me this 3rd day of January, 2019

My Commission Expires 8/10/2022

[Signature]
Notary Public

FEE SCHEDULE

Each application to change the place of use, the point of diversion or the use made of the water under this section shall be accompanied by the application fee set forth in the schedule below:

- (1) Application to change a point of diversion 300 feet or less \$100
- (2) Application to change a point of diversion more than 300 feet \$200
- (3) Application to change the place of use \$200
- (4) Application to change the use made of the water \$300

Make check payable to Kansas Department of Agriculture.

Water Resources
Received
JAN 24 2019
RECEIVED
JAN 22 2019
KS Dept Of Agriculture
SCANNED
Office
Resources

Any use of water that is not as authorized by the water right or permit to authorize water before the chief engineer approves this application is a violation of the Kansas Water Appropriation Act for which criminal or civil penalties may be assessed. Such violation is a class C misdemeanor, punishable by a fine not to exceed \$500 and/or a term of confinement not to exceed one month in the county jail. K.S.A. 82a-728(b). Civil penalties shall be not less than \$100 nor more than \$1,000 per violation. In the case of a continuing violation, each day such violation continues may be deemed a separate violation. In addition to these penalties the water right may be modified or suspended. K.S.A. 82a-737, as amended.

The application must be signed by all owners of the place of use authorized under the water right and his or her spouse, if married. Please indicate if there is no spouse. If land is being purchased under contract, the seller must sign as landowner until such time as the contract is completed.

In the event that all applicants cannot appear before one notary public, they may as necessary sign separate copies of the application before any notary public conveniently available to them. All copies signed in this manner shall be considered to be valid parts of the application.

If the request is signed on behalf of any Owner by someone with legal authority to do so (for example, an agent, one who has power of attorney, or an executor, executrix, conservator), it will be necessary to attach proper documents showing such authority.

I declare that I am an owner of the currently authorized place of use as identified herein, or that I represent all such owners and am authorized to make this application on their behalf, and declare further that the statements contained herein are true, correct, and complete. By filing this application I authorize the chief engineer to permanently reduce the quantity of water and/or rate of diversion as specified in sections 14 and 15 of this application.

Dated at Mulvane, Kansas, this 4th day of January, 2019.

Kurt A. Butts (Owner)
Kurt A. Butts (Please Print)
(Owner)
(Please Print)
(Owner)
(Please Print)
(Owner)
(Please Print)

(Spouse)
(Please Print)
(Spouse)
(Please Print)
(Spouse)
(Please Print)

State of Kansas
County of Sumner } SS

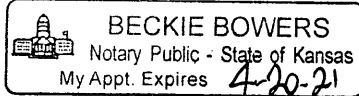

I hereby certify that the foregoing application was signed in my presence and sworn to before me this 4th day of January, 2019.

Beckie Bowers
Notary Public

My Commission Expires 4-20-21

FEE SCHEDULE

Each application to change the place of use, the point of diversion or the use made of the water under this section shall be accompanied by the application fee set forth in the schedule below:

- (1) Application to change a point of diversion 300 feet or less \$100
(2) Application to change a point of diversion more than 300 feet \$200
(3) Application to change the place of use \$200
(4) Application to change the use made of the water \$300

Make check payable to Kansas Department of Agriculture.

Water Resources Received
RECEIVED JAN 24 2019
JAN 22 2019 KS Dept Of Agriculture
SCANNED
Stafford Field Office
Division of Water Resources

Any use of water that is not as authorized by the water right or permit to authorize water before the chief engineer approves this application is a violation of the Kansas Water Appropriation Act for which criminal or civil penalties may be assessed. Such violation is a class C misdemeanor, punishable by a fine not to exceed \$500 and/or a term of confinement not to exceed one month in the county jail. K.S.A. 82a-728(b). Civil penalties shall be not less than \$100 nor more than \$1,000 per violation. In the case of a continuing violation, each day such violation continues may be deemed a separate violation. In addition to these penalties the water right may be modified or suspended. K.S.A. 82a-737, as amended.

The application must be signed by all owners of the place of use authorized under the water right and his or her spouse, if married. Please indicate if there is no spouse. If land is being purchased under contract, the seller must sign as landowner until such time as the contract is completed.

In the event that all applicants cannot appear before one notary public, they may as necessary sign separate copies of the application before any notary public conveniently available to them. All copies signed in this manner shall be considered to be valid parts of the application.

If the request is signed on behalf of any Owner by someone with legal authority to do so (for example, an agent, one who has power of attorney, or an executor, executrix, conservator), it will be necessary to attach proper documents showing such authority.

I declare that I am an owner of the currently authorized place of use as identified herein, or that I represent all such owners and am authorized to make this application on their behalf, and declare further that the statements contained herein are true, correct, and complete. By filing this application I authorize the chief engineer to permanently reduce the quantity of water and/or rate of diversion as specified in sections 14 and 15 of this application.

Dated at MULVANE, Kansas, this 4th day of JANUARY, 20 19.

Bryson G. Butts
(Owner)

(Spouse)

BRYSON G. Butts
(Please Print)

(Please Print)

(Owner)

(Spouse)

(Please Print)

(Please Print)

(Owner)

(Spouse)

(Please Print)

(Please Print)

State of Kansas }
County of Sumner } SS

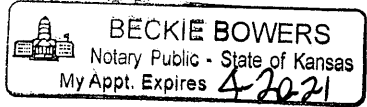

I hereby certify that the foregoing application was signed in my presence and sworn to before me this 4th day of January, 20 19.

Beckie Bowers
Notary Public

My Commission Expires 4-20-21

FEE SCHEDULE

Each application to change the place of use, the point of diversion or the use made of the water under this section shall be accompanied by the application fee set forth in the schedule below:

- (1) Application to change a point of diversion 300 feet or less \$100
- (2) Application to change a point of diversion more than 300 feet \$200
- (3) Application to change the place of use \$200
- (4) Application to change the use made of the water \$300

Make check payable to Kansas Department of Agriculture.

Water Resources
Received
JAN 24 2019
KS Dept Of Agriculture

RECEIVED

JAN 22 2019

Chafford Field Office
Division of Water Resources

SCANNED

Any use of water that is not as authorized by the water right or permit to authorize water before the chief engineer approves this application is a violation of the Kansas Water Appropriation Act for which criminal or civil penalties may be assessed. Such violation is a class C misdemeanor, punishable by a fine not to exceed \$500 and/or a term of confinement not to exceed one month in the county jail. K.S.A. 82a-728(b). Civil penalties shall be not less than \$100 nor more than \$1,000 per violation. In the case of a continuing violation, each day such violation continues may be deemed a separate violation. In addition to these penalties the water right may be modified or suspended. K.S.A. 82a-737, as amended.

The application must be signed by all owners of the place of use authorized under the water right and his or her spouse, if married. Please indicate if there is no spouse. If land is being purchased under contract, the seller must sign as landowner until such time as the contract is completed.

In the event that all applicants cannot appear before one notary public, they may as necessary sign separate copies of the application before any notary public conveniently available to them. All copies signed in this manner shall be considered to be valid parts of the application.

If the request is signed on behalf of any Owner by someone with legal authority to do so (for example, an agent, one who has power of attorney, or an executor, executrix, conservator), it will be necessary to attach proper documents showing such authority.

I declare that I am an owner of the currently authorized place of use as identified herein, or that I represent all such owners and am authorized to make this application on their behalf, and declare further that the statements contained herein are true, correct, and complete. By filing this application I authorize the chief engineer to permanently reduce the quantity of water and/or rate of diversion as specified in sections 14 and 15 of this application.

Dated at 1/2/19 Mulvane, Kansas, this 2nd day of Jan, 20 19.

[Signature]
(Owner)

(Spouse)

(Please Print)

(Please Print)

(Owner)

(Spouse)

(Please Print)

(Please Print)

(Owner)

(Spouse)

(Please Print)

(Please Print)

State of Kansas }
County of SG } SS

I hereby certify that the foregoing application was signed in my presence and sworn to before me this 2nd day of Jan, 20 19.

My Commission Expires 10/1/22

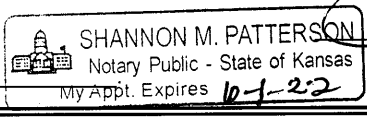

[Signature]
Notary Public

FEE SCHEDULE

Each application to change the place of use, the point of diversion or the use made of the water under this section shall be accompanied by the application fee set forth in the schedule below:

- (1) Application to change a point of diversion 300 feet or less \$100
- (2) Application to change a point of diversion more than 300 feet \$200
- (3) Application to change the place of use \$200
- (4) Application to change the use made of the water \$300

Make check payable to **Kansas Department of Agriculture.**

RECEIVED

JAN 22 2019

Water Resources
Received
JAN 24 2019
KS Dept Of Agriculture

Field Office
Water Resources

SCANNED

1320 Research Park Drive
Manhattan, KS 66502
785-564-6700
www.agriculture.ks.gov



900 SW Jackson, Room 456
Topeka, KS 66612
785-296-3556

Mike Beam, Secretary

Laura Kelly, Governor

FORREST G BUTTS REV TRUST
205 S CENTRAL AVE
MULVANE KS 67110-1719

May 13, 2019

FILE COPY

RE: Water Right
File No. 31,559

Dear Mr. Butts:

Reference is made to the application for approval of the Chief Engineer to change the authorized point of diversion under Water Right, File No. 31,559, received in this office on January 24, 2019. The application proposes to change the authorized point of diversion by creating a battery of three (3) wells with a geographic center located 1,140 feet North and 2,904 feet West of the Southeast corner of Section 28, Township 29 South, Range 1 East, Sedgwick County, Kansas.

Upon further review of the application, it is found that the proposed geocenter under File No. 31,559 will not comply with K.A.R. 5-2-3(b) *Battery of wells* which states in part:

.....if a permit to appropriate water did not authorize a battery of wells, as defined in K.A.R. 5-1-1, before the effective date of this regulation, an application for change filed pursuant to K.S.A. 82a-708b, and amendments thereto, to add one or more wells to the authorized well to create a battery of wells shall not be approved unless all of the following criteria in either subsection (a) or (b) are met at the time that the application for change is filed:

- (a)(1) The time to construct the diversion works has not expired.
- (2) The proposed battery will meet the definition of a battery of wells as defined in K.A.R. 5-1-1.

- (b)(1) The time to construct the diversion works has expired.
- (2) A new application to appropriate water filed to appropriate water at the geocenter of the proposed battery of wells would meet the safe yield, allowable appropriation, or similar type of regulation, for a well filed at that location.
- (3) The proposed battery of wells meets the definition of a battery of wells as defined in K.A.R. 5-1-1.

The application for File No. 31,559 would not meet all of the criteria of K.A.R. 5-2-3(b), which applies in your circumstance. The time to construct the diversion works has expired and a new application to appropriate water could not be approved since safe yield is not met at the proposed geocenter location.

As it appears the application to change the authorized point of diversion under File No. 31,559 cannot be approved as filed, and that there has been no evidence provided to support a waiver of K.A.R. 5-2-3(b), it will be recommended to the Chief Engineer that the application for change in point of diversion under File No. 31,559 be denied and dismissed for failure to comply with K.A.R. 5-2-3(b).

OVER →

SCANNED

File No. 31,559
May 13, 2019
Page No. 2

We are advising you of this recommendation in order to allow you an opportunity to submit additional information to show why our evaluation should be reconsidered. You have a period of 15 days (**until June 3, 2019**) to either (1) submit additional information to our office or (2) to request additional time beyond the 15 days to submit additional information. If you wish to request additional time, you must do so in writing, before the 15 day period expires. Such a request should state what steps are being taken to obtain the information and the amount of time you will need to supply the information to our office.

If you do not request more time within the 15 day period, or if your request is not granted, the above-referenced application will be submitted to the Chief Engineer for final decision based on the recommendation stated above. If you do submit additional information within the 15 day period (or any authorized extension), that information will be given due consideration prior to final action on the application.

If you have any questions, please contact me at (785) 564-6635 or Brent Turney, Change Application Unit Supervisor at (785) 564-6645. If you wish to discuss a specific file, please have the file number ready so that I may help you more efficiently.

Sincerely,

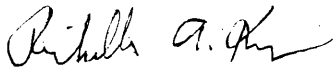

Richelle A. Krueger
Environmental Scientist
Water Appropriation Program

RAK

pc: Stafford Field Office
Steven J. Butts et al

Safe Yield Report Sheet
Water Right- Proposed Point of Diversion
Point of Diversion in 28-29S-01E
Footages from SE corner- 1,140 feet North 2,904 feet West

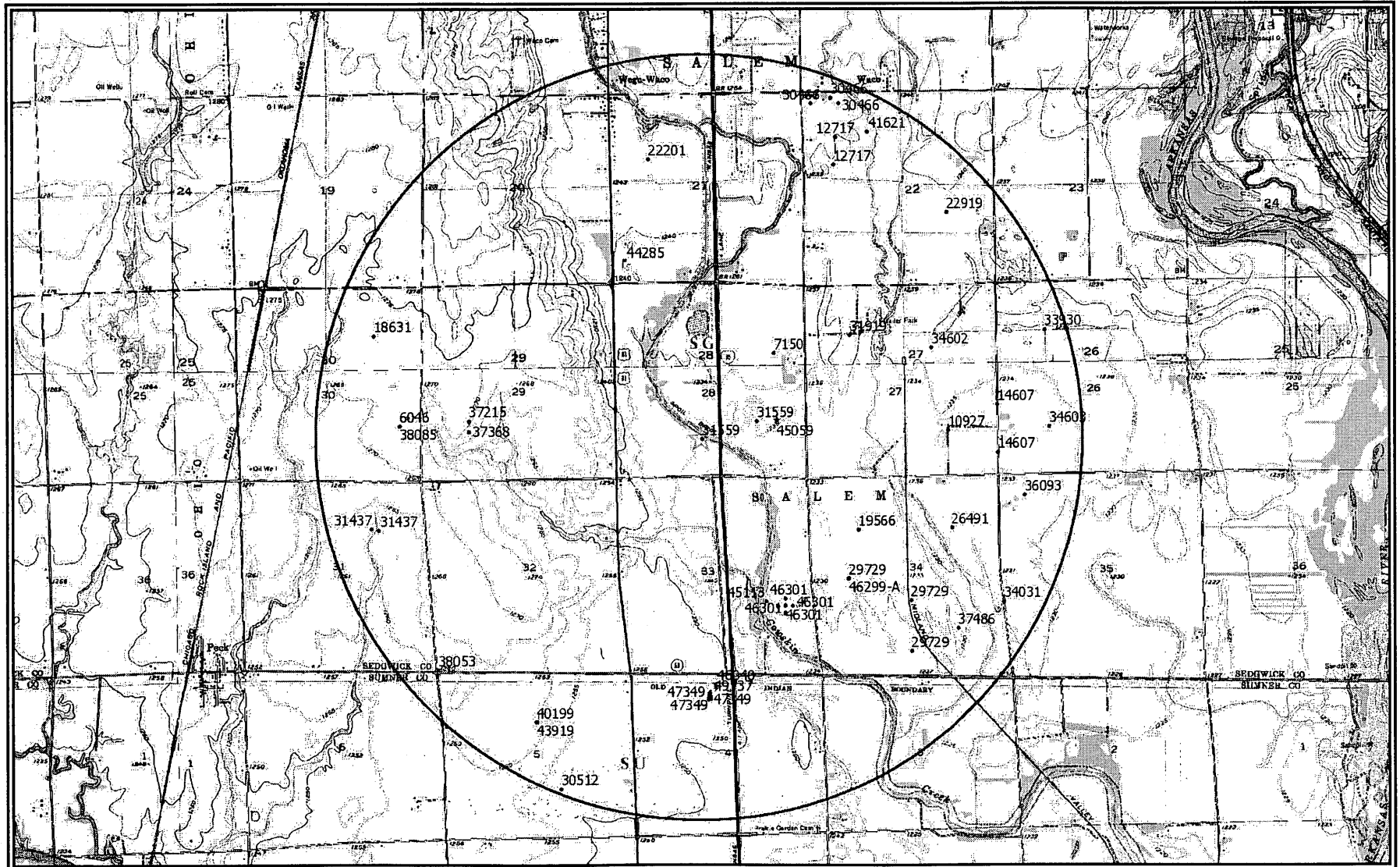

Analysis Results

The selected PD is in an area OPEN to new appropriations.

The safe yield based on the variables listed below is 2,714.34 AF.

Total prior appropriations in the circle is 3,295.55 AF. ~~158~~ = 3353.55 AF

Total quantity of water available for appropriation is 0.00 AF.

Fails safe yield

Safe Yield Variables

The area used for the analysis is set at 8,042 acres.

The potential annual recharge at the circle center is estimated to be 5.4 inches.

The percent of recharge available for appropriation is 75%.

Authorized Quantity values are as of 24-APR-2019 and are based on Appropriated and Vested ground water right and possible stream nodes for GMD #2. Domestic, Term and Temporary water rights have been excluded.

There are 34 water rights and 45 points of diversion within the circle.

File Number	Use	ST	SR	Q4	Q3	Q2	Q1	FeetN	FeetW	Sec	Twp	Rng	ID	Qind	Auth Quant	Add Quant	Tot Acres	Net Acres
A 6046 00	IRR	NK	G		NC	E2	SE	1289	660	30	29	01E	4	WR	125.00	125.00	155.00	155.00
A 7150 00	IRR	NK	G		NW	SE	NE	3453	852	28	29	01E	11	WR	20.00	20.00	136.00	136.00
A 10927 00	IRR	NK	G		NC	SE		1275	1350	27	29	01E	1	WR	180.00	180.00	156.00	156.00
A 12717 00	IRR	NK	G		NE	SW	NW	0	0	22	29	01E	1	PD	27.00	27.00	35.00	35.00
Same	IRR	NK	G		SE	SW	NW	0	0	22	29	01E	2	PD	17.00	17.00		
A 14607 00	IRR	NK	G		SW	SW	SW	600	5220	26	29	01E	6	PD	65.00	65.00	158.00	158.00
Same	IRR	NK	G		CW	NW	SW	1910	5260	26	29	01E	7	PD	102.00	102.00		
A 18631 00	IRR	NK	G		SW	NE	NE	4025	1270	30	29	01E	5	WR	117.00	117.00	80.00	80.00
A 19566 00	IRR	NK	G		NC	NW		4050	3750	34	29	01E	1	WR	162.00	162.00	135.00	135.00
A 22201 00	IRR	NK	G		NE	SW	NW	3550	4200	21	29	01E	3	WR	17.65	17.65	27.00	27.00
A 22919 00	IRR	NK	G		NC	N2	SE	1960	1320	22	29	01E	3	WR	20.00	20.00	80.00	80.00
A 26491 00	IRR	NK	G		SE	NW	NE	4200	1600	34	29	01E	2	WR	203.00	203.00	160.00	160.00
A 29729 00	IRR	NK	G		NE	NE	SW	2157	2784	34	29	01E	7	PD	78.00	✓ 55.50	229.56	229.56
Same	IRR	NK	G		SE	SW	NW	2772	4496	34	29	01E	8	PD	75.00	✓ 52.50		
Same	IRR	NK	G		NE	SE	SW	753	2784	34	29	01E	9	PD	60.00	✓ 42.00		
A 30466 00	IRR	NK	G		NE	NW	NW	5135	4490	22	29	01E	5	WR	27.00	27.00	62.00	62.00
Same	IRR	NK	G		NE	NW	NW	4990	4265	22	29	01E	4	WR				
Same	IRR	NK	G		NW	NW	NW	4990	5040	22	29	01E	16	WR				
A 30512 00	IRR	NK	G		NC	W2	SE	1320	1980	05	30	01E	1	WR	42.00	42.00	79.00	79.00
A 31437 00	IRR	NK	G		NC	NE		3960	1260	31	29	01E	1	WR	195.00	195.00	136.00	136.00
Same	IRR	NK	G		NC	NE		3960	1720	31	29	01E	2	WR				
A 31559 00	IRR	NK	G		SE	NW	SE	1584	1348	28	29	01E	8	PD	57.00	57.00	90.00	90.00
Same	IRR	NK	G		NE	SE	SW	1107	2845	28	29	01E	4	PD	65.00	65.00		
A 31919 00	IRR	NK	G		NE	SW	NW	3872	4052	27	29	01E	6	WR	97.00	97.00	80.00	80.00
A 33930 00	IRR	NK	G		SE	NW	NW	4060	4000	26	29	01E	8	WR	158.00	158.00	157.50	157.50

File Number	Use	ST	SR	Q4	Q3	Q2	Q1	FeetN	FeetW	Sec	Twp	Rng	ID	Qind	Auth Quant	Add Quant	Tot Acres	Net Acres
A 34031 00	IRR	NK	G		SW	NW	SW	1970	5140	35	29	01E	8	WR	135.00	135.00	90.00	90.00
A 34602 00	IRR	NK	G		NE	SW	NE	3500	1800	27	29	01E	5	WR	120.00	120.00	80.00	80.00
A 34603 00	IRR	NK	G			NC	SW	1370	4109	26	29	01E	11	WR	114.00	114.00	158.00	0.00
A 36093 00	IRR	NK	G		NE	NW	NW	5025	4865	35	29	01E	7	WR	53.00	53.00	77.00	0.00
A 37215 00	IRR	NK	G		SE	NW	SW	1620	4000	29	29	01E	1	WR	94.00	94.00	132.00	132.00
A 37368 00	IRR	NK	G			NC	SW	1320	4000	29	29	01E	2	WR	99.00	99.00	132.00	0.00
A 37486 00	IRR	NK	G		SE	NW	SE	1330	1475	34	29	01E	11	WR	191.00	191.00	127.00	127.00
A 38053 00	IRR	NK	G		SW	SW	SW	127	5229	32	29	01E	1	WR	202.50	202.50	135.00	135.00
A 38085 00	IRR	NK	G		NC	E2	SE	1289	660	30	29	01E	4	WR	100.00	100.00	155.00	0.00
A 40199 00	IRR	NK	G					3164	2660	05	30	01E	4	WR	65.30	65.30	111.00	111.00
A 41621 00	IRR	NK	G		SW	NE	NW	4200	3480	22	29	01E	13	WR	15.00	0.00	62.00	0.00
A 43919 00	IRR	LR	G					3164	2660	05	30	01E	4	WR	86.20	86.20	111.00	0.00
A 44285 00	REC	NK	G		SW	SW	SW	653	4831	21	29	01E	5	WR	3.00	3.00		
A 45059 00	IND	KE	G	46299	SW	NE	SE	1600	800	28	29	01E	10	WR	66.90	66.90		
A 46299 A	IRR	HK	G		SE	SW	NW	2772	4496	34	29	01E	8	WR	90.00	90.00	229.56	0.00
A 46301 00	IRR	HK	G		SW	NE	SE	1901	975	33	29	01E	2	WR	88.20	0.00 + 58	229.56	0.00
Same	IRR	HK	G		NW	NE	SE	2101	975	33	29	01E	4	WR				
Same	IRR	HK	G		SW	NE	SE	1701	975	33	29	01E	5	WR				
Same	IRR	HK	G		SW	NE	SE	1901	775	33	29	01E	6	WR				
Same	IRR	HK	G		SW	NE	SE	1901	1175	33	29	01E	7	WR				
A 47349 00	IRR	LO	G					3758	3175	04	30	01E	8	WRF	8.00	8.00	30.00	30.00
A 47349 00	MUN	LO	G					3758	3175	04	30	01E	8	WRF	7.00	7.00		
Same	IRR	LO	G					3789	3176	04	30	01E	9	WRF				
A 47349 00	MUN	LO	G					3789	3176	04	30	01E	9	WRF	7.00	7.00		
Same	IRR	LO	G					3727	3173	04	30	01E	10	WRF				
A 47349 00	MUN	LO	G					3727	3173	04	30	01E	10	WRF	7.00	7.00		

Limitations

File Number	Seq Num	Limitations
A 14607 00	1	102AF/YR @ 1400GPM COM/W WELLS OPERATE SIMULTANEOUSLY
A 29729 00	1	150AF/YR @ 1380GPM WHEN WELLS PUMP SIMULTANEOUSLY
A 30466 00	1	1050GPM WHEN PUMPING FROM MORE THAN ONE WELL
A 31559 00	1	1100GPM WHEN WELLS PUMP SIMULTANEOUSLY
A 38085 00	1	939GPM (2.09CFS) COM/W #6046
A 40199 00	1	5YR ALLOCATION (250AF)
A 41621 00	1	27AF/YR COM/W #30466
A 43919 00	1	OBSERVATION WELL NETWORK - SEE JKT FOR DETAILS
Same	2	151.5AF/YR @ 1000GPM COM/W #40199
A 46301 00	1	298 AF/YR COM/W #29729, #45113 & #46299-A
A 46299 A	1	1380 GPM COM/W #29729

Krueger, Richelle [KDA]

From: Krueger, Richelle [KDA]
Sent: Tuesday, April 23, 2019 11:55 AM
To: Fitch, Elizabeth [KDA]
Subject: Change in PD File No. 31559 Forrest Butts

Hi Elizabeth,

How's it going? Little bit drizzly here today. Hey I have been looking at this change for Forrest Butts, looks like they want to convert one of their two authorized pds to a battery of three wells(already existing in reality).

I haven't checked with Kristen yet but a quick safe yield look (to comply with K.A.R.5-2-3) indicates the area is open to new app but appears overappropriated at a quick glance and could not be approved there.....are there some extenuating circumstances that you are aware of with this change?

Also, is there an incomplete overlap in place of use with File No. 7150 on the 30 acres S½NE¼ 28-29-1E? WRIS doesn't show that but the application indicates it and the maps in the scanned docs.

Brent isn't here today, but thought I would touch base with you before I go any further with this one.

Thanks, as always, for any info you have on this!

Richelle

1320 Research Park Drive
Manhattan, KS 66502
785-564-6700
www. agriculture.ks.gov



900 SW Jackson, Room 456
Topeka, KS 66612
785-296-3556

Mike Beam, Interim Secretary

Laura Kelly, Governor

FORREST G BUTTS
205 S CENTRAL AVE
MULVANE, KS 67110

January 29, 2019

RE: File No 31559

Dear Sir or Madam:

An application for approval of the Chief Engineer to change the following condition or conditions of the file number referred to above has been received:

- place of use PD
- point of diversion
- use made of water

As a matter of record, the Division of Water Resources has on hand a large number of applications awaiting processing. Therefore, to be fair to all concerned, and so that we can process those applications on hand in the order they were received, we intend to concentrate on the backlog of applications until the issue is resolved. You will be contacted regarding this application as soon as it has been examined.

In accordance with the provisions of the Kansas Water Appropriation Act, a portion of which is included below, the use of water prior to approval of the application is unlawful. You should not proceed and divert water as indicated by your plans in your application for a change for this file until you receive approval for this change from the Chief Engineer. Once approved, compliance with the terms, conditions and limitations of the permit is necessary. Conservation of the water resources of Kansas is required.

Section 82a-728 of the Kansas Water Appropriation Act, provides (a) except for the appropriation of water for the purpose of domestic use, . . . it shall be unlawful for any person to appropriate or threaten to appropriate water from any source without first applying for and obtaining a permit to appropriate water in accordance with the provisions of the Water Appropriation Act or for any person to violate any condition of a vested right, appropriation right or an approved application for a permit to appropriate water for beneficial use.

(b) (1) The violation of any provision of this section by any person is a class C misdemeanor...

A class C misdemeanor is punishable by a fine not to exceed \$500 and/or a term of confinement not to exceed one month in the county jail. Each day that the violation occurs constitutes a separate offense.

If you have any questions, please contact me at (785) 564-6645. If you wish to discuss a specific file, please have the file number ready so that we may help you more efficiently.

Sincerely,

Brent Tourney, L.G.
Change Applications Unit Supervisor
Water Appropriation Program

BAT: DLW

SCANNED

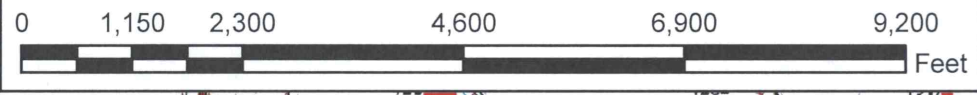
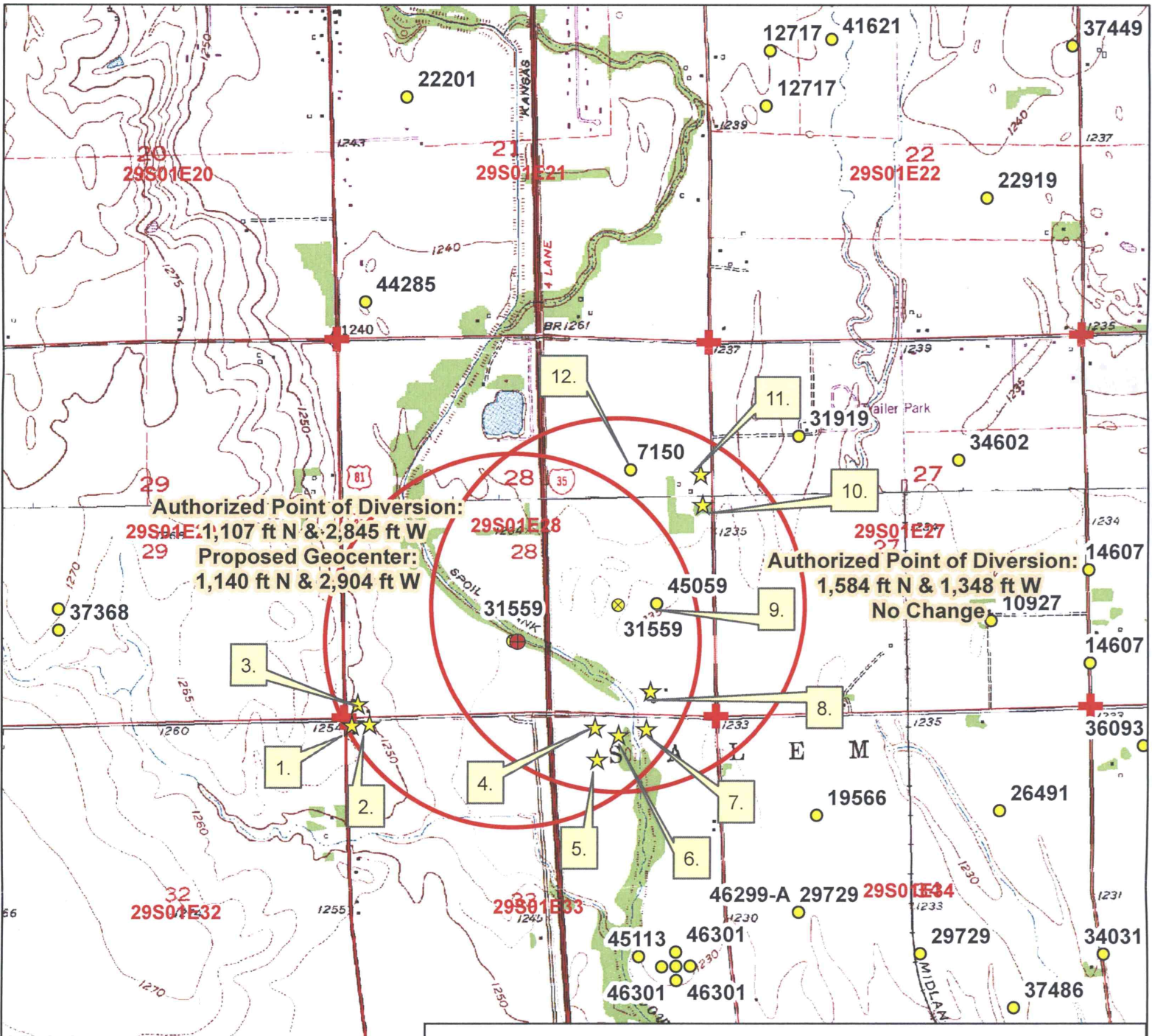

Legend

- Water Appropriations
- ⊗ Authorized Point of Diversion
- Proposed Point of Diversion
- ★ Domestic Well
- ⊕ Section Corner
- ▭ Section Line
- Half Mile Circle

Water Right, File No. 31559

Change in Point of Diversion Application Map
 28-29S-1E // Sedgwick County

To the best of my knowledge, all groundwater wells within 1/2 mile of the proposed point of diversion have been shown.

Robert A. Butts
 Signature

Water Resources
 Received
JAN 24 2019
 KS Dept Of Agriculture
SCANNED



File No. 31559 Change Application
Near-by Domestic Well Owners

1. GARCIA, EUGENE E
11202 S BROADWAY ST
PECK KS 67120-9738
2. JORDAN, TODD D
411 E 111TH ST S
PECK KS 67120
3. SHIRLEY A MCADAM LIV TRUST
801 W 103RD ST S
PECK KS 67120-9757
4. KENDRICK, MICHAEL J & KAREN K
1019 E 111TH ST S
MULVANE KS 67110-9558
5. KENDRICK, EDDIE M & DEBRA L
1025 E 111TH ST S
MULVANE KS 67110-9558
6. DAVIS, RUSSELL D
1125 E 111TH ST S
MULVANE KS 67110-9555
7. COURTNEY, AARON B JR
1419 E 111TH ST S
MULVANE KS 67110-9557
8. KELLY J & KENNETH J CAIN TRUSTS
1422 E 111TH ST S
MULVANE KS 67110-9556
9. CAIN FARMS LLC
1422 E 111TH ST S
MULVANE KS 67110-9556
10. CHANDLER, THOMAS WAYNE
10723 S HYDRAULIC ST
MULVANE KS 67110-9577
11. THOLE, NATHAN E & JESSICA N
10713 S HYDRAULIC ST
MULVANE KS 67110-9577
12. BUTTS, STEVEN J ET AL
205 S CENTRAL
MULVANE KS 67110-1719

RECEIVED

JAN 22 2019

SCANNED

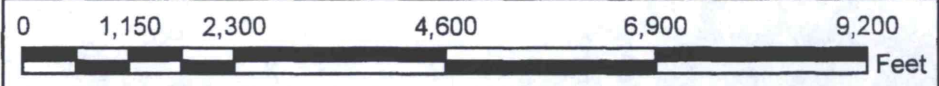
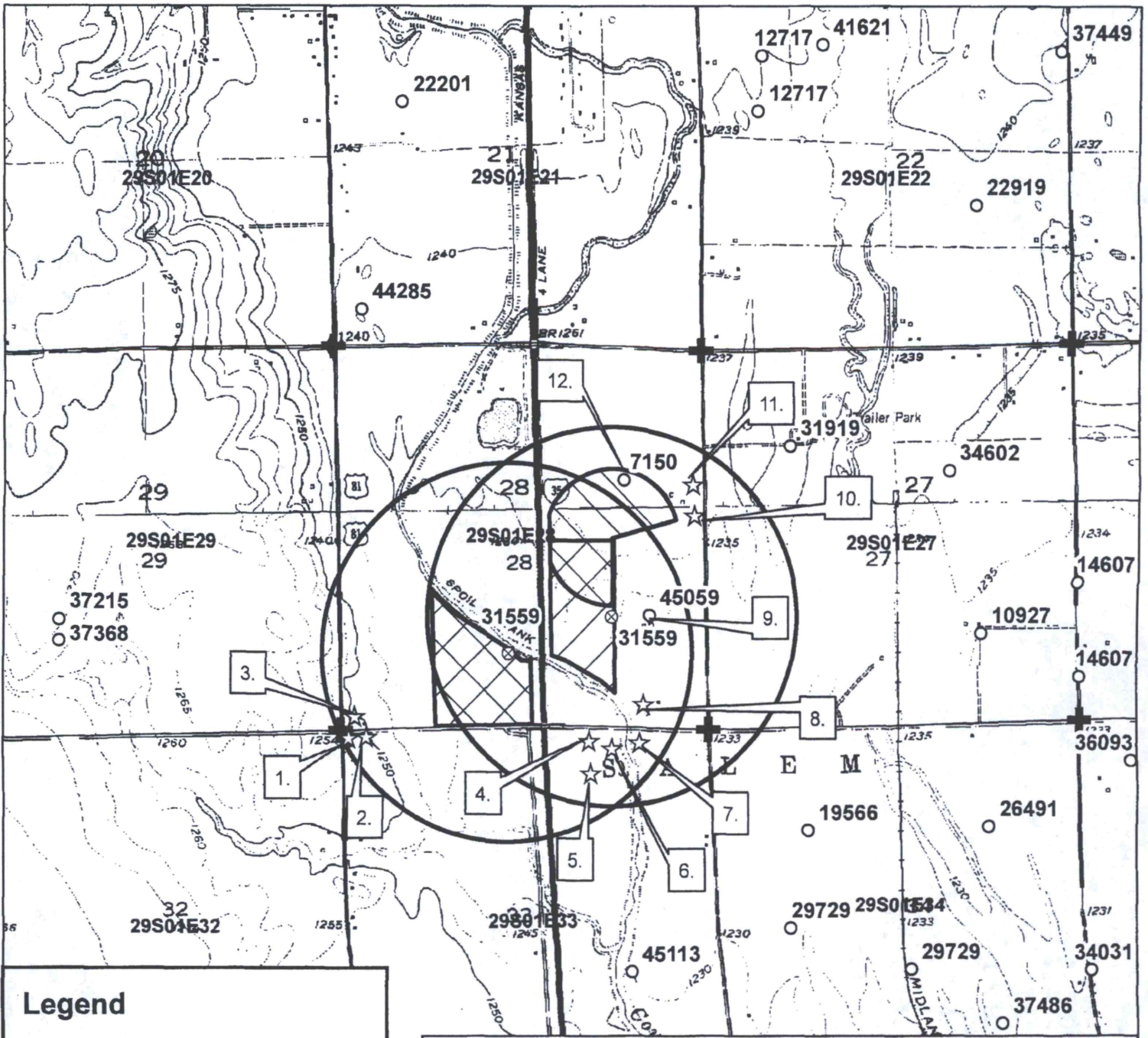

Legend

- Water Appropriations
 - ⊗ Authorized Point of Diversion
 - ☆ Domestic Well
 - ⊕ Section Corner
 - ▭ Section Line
 - ◯ Half Mile Circle
- Place of Use** RECEIVED
- ▨ Authorized MAY 11 2018
 - ▧ Proposed

Water Right, File No. 31559

**Change in Place of Use Application Map
28-29S-1E // Sedgwick County**

To the best of my knowledge, all groundwater wells within 1/2 mile of the proposed point of diversion have been shown.

Forrest Butts





Legend

- Water Appropriations
- Section Line
- File No. 7150-Authorized
- File No. 31559**
- Actual
- Authorized
- Unauthorized

*(Now Authorized 5-22-18)
CHSDU Approver 1*

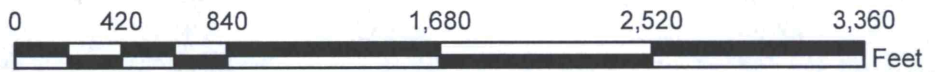

Water Right, File No. 7150 & 31559
 Place of Use Review Map
 28-29S-1E
 Sedgwick County

