

NOTICE

This scan only represents the application as filed. The information contained herein meets the requirements of K.A.R. 5-3-1 or K.A.R. 5-5-1, and has been found acceptable for filing in the office of the Chief Engineer. The application should not be considered to be a complete application as per K.A.R. 5-3-1b or K.A.R. 5-5-2a.

Submit To: CHIEF ENGINEER
Division of Water Resources
Kansas Department of Agriculture
1320 Research Park Drive
Manhattan, Kansas 66502
<http://agriculture.ks.gov/dwr>

APPLICATION FOR TERM PERMIT

- GROUNDWATER
 SURFACE WATER
(check one)

MAY 11 2020
12:52



State of Kansas

5 years

STATUTORY FILING FEE MUST ACCOMPANY THIS APPLICATION
(Make check payable to the Kansas Department of Agriculture)

20209043

1. Applicant: (Please print or type)
Name Tom Lentz
Street 14124 Pinnacle Dr.
City and State Wichita, KS.
Zip Code 67230 Telephone No. (316) 259-7722
E-Mail Address lentzcom@aol.com
Social Security I.D. No. _____
and/or Taxpayer I.D. No. _____

2. Location of Point of Diversion:
Sec. 8, Twp. 23, Rng. 10E, (
Reno County, Kansas.
Distance from Southeast Corner of Section:
3682 feet North from Southeast Corner
1645 feet West from Southeast Corner

NOTE: If point of diversion is not site specific (i.e. groundwater pit) show the approximate geographic center.

3. Water Use Data:
Proposed Max. Pumping Rate (gpm) 150
Amount Requested (acre-feet) 9
per calendar year
Depth of Well (feet) 60
Date (completed) (will be completed) August 31, 2020
Drainage Basin Arkansas
Name of Stream NA

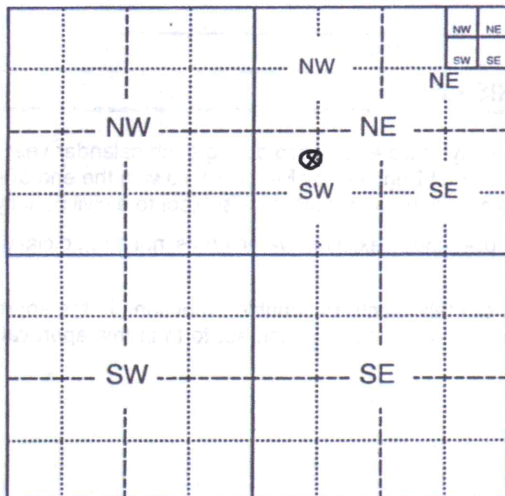

4. Water is to be used for (briefly describe proposed use and explain the rate and quantity requested):
to fill and maintain a duck pond from Sept. thru Dec or each year

5. Location of place of use:
2.5 acres in the NW SW NE or Section 8, T23S, R10 W in Reno County, KS

6. Period of use:
Commencing date: September 1 2020
Ending Date: Dec. 31, 2024 Also enter on Item 12

If off-stream pit, check here
Will pit floor intersect water table? Yes No

7. Location of the proposed point of diversion and those of other water users within 1/2 mile shall be indicated on the diagram to the lower-left, scale 1 inch = 2,000 feet. If surface water, indicate on the diagram the course of the stream, and its name. List other D.W.R. permit numbers that cover the requested point(s) of diversion or place of use here:
Application File No. 50,259

FEE SCHEDULE

- The filing fee for an application is based on the maximum amount of water use proposed within a year. Except for storage, the fee is:

Acre-feet	Fee
0-100	\$200.00
101-320	\$300.00
More than 320	\$300.00

 plus \$20 for each additional 100 acre-feet or any part thereof.
- The fee for an application in which storage is requested, is:

Acre-feet	Fee
0-250	\$200.00
More than 250	\$200.00

 plus \$20.00 for each additional 250 acre-feet of storage or any part thereof.

- NOTE: If an application requests both direct use and storage, the fee charged shall be as determined under No. 1 or No. 2 above, whichever is greater, but not both fees.
- A request for an extension of time to extend the term of a term permit shall be accompanied by a fee of \$100.00.
 - There is a separate application form for domestic use. Do not use this form for domestic use.

CONVERSION FACTORS

1 acre-foot equals 325,851 gallons
1 million gallons equal 3.07 acre-feet

5/11/2020
LMoody

Assisted by Scott E. Ross

For Office Use Only:
F.O. 2 GMD 5 Meets K.A.R. 5-3-1 (YES/NO) Use REC Source G/S County RN By BMM Date 5/11/20
Code TRP Fee \$ 200 TR # 57 Receipt Date 5/11/2020 Check # 5463

8. For groundwater use, list below all wells within 1/2 mile of the proposed well, and plot locations upon the diagram on reverse side. If additional space is needed, attach a map.

Other wells -

Well A Owner(s): See attached sheet
Address: _____

Well B Owner(s): _____
Address: _____

9. For surface water use, list below the names and addresses of all landowners from a point 1/2 mile upstream to a point 1/2 mile downstream of the tract of land upon which the point of diversion is located. If additional space is needed, attach sheet.

Tract A Owner(s): NA
Address: _____

Tract B Owner(s): _____
Address: _____

10. The owner of the point of diversion, if other than the applicant is (please print):

None
(name, address and telephone number)

You must provide evidence of legal access to, or control of, the point of diversion from the landowner or the landowner's authorized representative. Provide a copy of a recorded deed, lease, easement or other document with this application. In lieu thereof, you may sign the following sworn statement:

I have legal access to, or control of, the point of diversion described in this application from the landowner or the landowner's authorized representative. I declare under penalty of perjury that the foregoing is true and correct.

Executed on 5-7-2020, 20____.

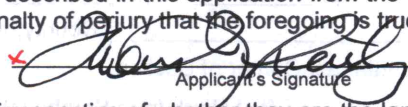
Applicant's Signature

The applicant must provide the required information or signature irrespective of whether they are the landowner. Failure to complete this portion of the application will cause it to be unacceptable for filing and the application will be returned to the applicant.

11. The applicant states that the information set hereon is true and accurate to the best of his/her knowledge.

12. The applicant agrees to waive any right to a hearing on the matter of abandonment of this appropriation right and further agrees that this appropriation right may be dismissed and terminated upon completion of the proposed project, said dismissal date to be on December 31, 2024 or within any extension of time authorized by the Chief Engineer, Division of Water Resources, Kansas Department of Agriculture.

13. The applicant agrees to provide water to nearby water users, at no charge to said users, should their rights to use water become impaired by the project proposed by this application.

14. Water use contact person (in event emergency contact is needed):

Name: Tom Lentz Telephone No. (316-259-7722)

Signature of Applicant

or

Authorized Representative Date 5/7/2020

Thomas Lentz
Applicant's Name Printed

owner
Title

DO NOT WRITE BELOW THIS LINE

CONDITIONS OF APPROVAL:

The applicant shall maintain accurate and complete records from which the quantity of water diverted during each calendar year may be readily determined. Accurate and complete records shall be furnished to the Chief Engineer by March 1 following the end of each calendar year. Failure to file the annual water use report by the due date, shall cause the applicant to be subject to a civil penalty.

The use of water herein authorized shall not be made so as to impair any use under existing water rights nor prejudicially and unreasonably affect the public interest.

The Chief Engineer specifically retains jurisdiction in this matter with authority to make such reasonable reductions in the approved rate of diversion and quantity authorized, and such changes in other terms, conditions, and limitation set forth in this approval and permit to proceed as may be deemed to be in the public interest.

Both 50.259 & 50.267

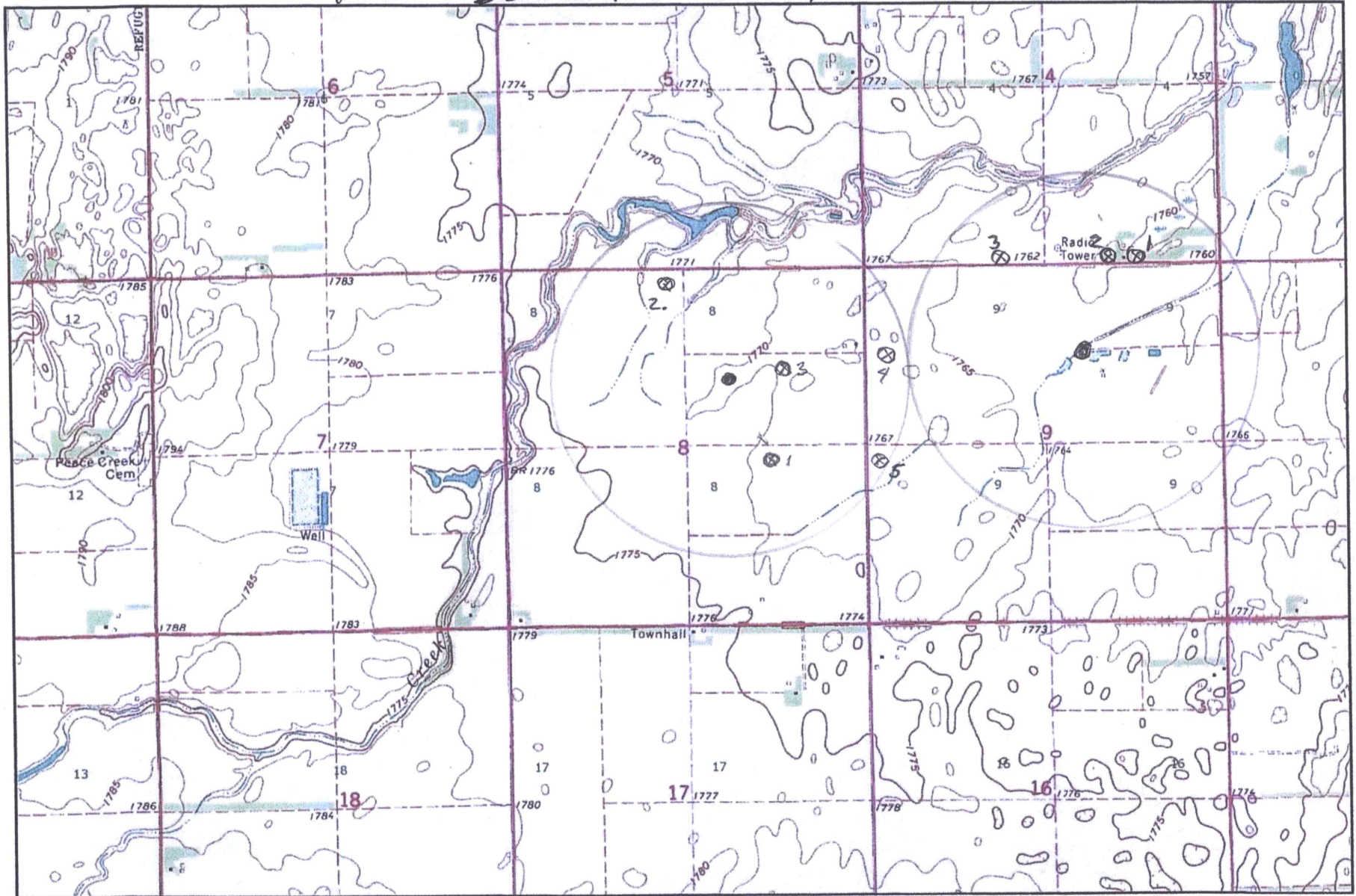

Universal Transverse Mercator (UTM) Projection Zone 14
North American Datum of 1983

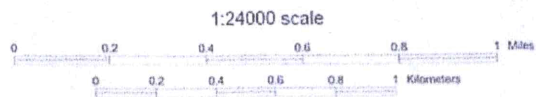

Magnetic declination of 4E at center of map
on March 17, 2011

NEARBY WELLS

FILE NO. 50,259

1. Charlie Hagger	Russell, KS.	Domestic
2. Steve Lindner	759 Apache Ave; Canyon City CO. 81212	Domestic
3. Leon Miller	2406 Brownlee RD, Sylvia, KS. 67581	Domestic
4. Bud Miller	Rt. 1 Box 71; Sylvia, KS. 67581	Domestic
5. Leon Miller	See Above	Domestic



1000 Corey Road
 P.O. Box 886
 Hutchinson, KS 67504-0886
 620-665-5661
 FAX: 620-665-0559
 TOLL FREE: 877-464-0623
 www.sdklabs.com

Tom Lentz will

App No. 50,259

Sample # 1376.20
 Sample: Water
 Other ID: Len

Date Received: 4/7/2020 14:38:00
 Date/Time Sampled: 4/7/2020 9:00:00
 Date Reported: 04/10/2020
 Total Fee: \$ 15.00

SNYDER, BOB
 510 S WALNUT
 SOUTH HUTCHINSON, KS 67505

ANALYSIS

	Result	Units	Date/Time Analyzed	Analyst
Chloride - SM 4500-Cl B	612.00	mg/L	4/9/2020 13:00	SE
Chloride As Salt	1010.00	mg/L	4/9/2020 13:00	SE

**Sample receipt temperature = 24.6 degrees C.

* Denotes analysis was subcontracted to another laboratory for state compliance - see attached.
 Methods of analysis per EPA-600 or EPA SW-846, 3rd Ed., 1986 or Standard Methods for the Examination of Water and Wastewater, 18th Edition, 1992.
 ++Denotes NELAP/KDHE Accredited Method. Lab Certificate #E-10152. Results meet all requirements of NELAC unless noted.

Approved By: *M. Hogan*, Quality Assurance Officer
 Matt Hogan



Copies

The results reported pertain only to the samples as received by the laboratory

DATA ENTRY SYSTEM ID NUMBER SHEET

20209043

FILE NUMBER _____

APPLICANT PERSON ID & SEQ #	87556	PDIV ID	BATTERY ID
66732	_____	_____	_____
_____	_____	_____	_____
_____	_____	_____	_____
_____	_____	_____	_____
_____	_____	_____	_____

LANDOWNER PERSON ID & SEQ #	69484	PUSE ID
66732	_____	_____
_____	_____	_____
_____	_____	_____
_____	_____	_____
_____	_____	_____

WATER USE CORRESPONDENT PERSON ID & SEQ #
66732

