

NOTICE

This scan only represents the application as filed. The information contained herein meets the requirements of K.A.R. 5-3-1 or K.A.R. 5-5-1, and has been found acceptable for filing in the office of the Chief Engineer. The application should not be considered to be a complete application as per K.A.R. 5-3-1b or K.A.R. 5-5-2a.

THE STATE OF KANSAS



KANSAS DEPARTMENT OF AGRICULTURE
Mike Beam, Secretary of Agriculture

DIVISION OF WATER RESOURCES
David W. Barfield, Chief Engineer

50412

File Number _____
This item to be completed by the Division of Water Resources.

WATER RESOURCES RECEIVED
JUL 16 2020 11:00
KS DEPT OF AGRICULTURE

APPLICATION FOR PERMIT TO APPROPRIATE WATER FOR BENEFICIAL USE

Filing Fee Must Accompany the Application
(Please refer to Fee Schedule attached to this application form.)

To the Chief Engineer of the Division of Water Resources, Kansas Department of Agriculture,
1320 Research Park Drive, Manhattan, Kansas 66502:

1. Name of Applicant (Please Print): Weber Land, LLC
Address: 247 Main St
City: Halstead State KANSAS Zip Code 67056
Telephone Number: (316) 835-3555 / 316-772-8900

2. The source of water is: surface water in _____ (stream)
OR groundwater in Little Arkansas River (drainage basin)

Certain streams in Kansas have minimum target flows established by law or may be subject to administration when water is released from storage for use by water assurance district members. If your application is subject to these regulations on the date we receive your application, you will be sent the appropriate form to complete and return to the Division of Water Resources.

3. The maximum quantity of water desired is 237 acre-feet OR _____ gallons per calendar year, to be diverted at a maximum rate of 851 gallons per minute OR _____ cubic feet per second.

Once your application has been assigned a priority, the requested maximum rate of diversion and maximum requested quantity of water under that priority number can **NOT** be increased. Please be certain your requested maximum rate of diversion and maximum quantity of water are appropriate and reasonable for your proposed project and are in agreement with the Division of Water Resources' requirements.

4. The water is intended to be appropriated for (Check use intended):
(a) Artificial Recharge (b) Irrigation (c) Recreational (d) Water Power
(e) Industrial (f) Municipal (g) Stockwatering (h) Sediment Control
(i) Domestic (j) Dewatering (k) Hydraulic Dredging (l) Fire Protection
(m) Thermal Exchange (n) Contamination Remediation

YOU **MUST** COMPLETE AND ATTACH ADDITIONAL DIVISION OF WATER RESOURCES FORM(S) PROVIDING INFORMATION TO SUBSTANTIATE YOUR REQUEST FOR THE AMOUNT OF WATER FOR THE INTENDED USE REFERENCED ABOVE.

For Office Use Only:															
F.O. Code	<u>2</u>	GMD	<u>2</u>	Meets K.A.R. 5-3-1	(YES / NO)	Use	<u>IRR</u>	Source	<u>G/S</u>	County	<u>HV</u>	By	<u>BMM</u>	Date	<u>7/16/20</u>
Fee \$	<u>300</u>	TR #		Receipt Date	<u>7-16-2020</u>	Check #	<u>3244</u>								

5. The location of the proposed wells, pump sites or other works for diversion of water is:

Note: For the application to be accepted, the point of diversion location must be described to at least a 10 acre tract, unless you specifically request a 60 day period of time in which to locate the site within a specifically described, minimal legal quarter section of land.

- (A) One in the SW quarter of the NW quarter of the SE quarter of Section 3, more particularly described as being near a point 1830 feet North and 2580 feet West of the Southeast corner of said section, in Township 24 South, Range 2 West, Harvey County, Kansas.
- (B) One in the _____ quarter of the _____ quarter of the _____ quarter of Section _____, more particularly described as being near a point _____ feet North and _____ feet West of the Southeast corner of said section, in Township _____ South, Range _____ East/West (circle one), _____ County, Kansas.
- (C) One in the _____ quarter of the _____ quarter of the _____ quarter of Section _____, more particularly described as being near a point _____ feet North and _____ feet West of the Southeast corner of said section, in Township _____ South, Range _____ East/West (circle one), _____ County, Kansas.
- (D) One in the _____ quarter of the _____ quarter of the _____ quarter of Section _____, more particularly described as being near a point _____ feet North and _____ feet West of the Southeast corner of said section, in Township _____ South, Range _____ East/West (circle one), _____ County, Kansas.

If the source of supply is groundwater, a separate application shall be filed for each proposed well or battery of wells, except that a single application may include up to four wells within a circle with a quarter (1/4) mile radius in the same local source of supply which do not exceed a maximum diversion rate of 20 gallons per minute per well.

A battery of wells is defined as two or more wells connected to a common pump by a manifold; or not more than four wells in the same local source of supply within a 300 foot radius circle which are being operated by pumps not to exceed a total maximum diversion rate of 800 gallons per minute and which supply water to a common distribution system.

6. The owner of the point of diversion, if other than the applicant is (please print):

(name, address and telephone number)

(name, address and telephone number)

You must provide evidence of legal access to, or control of, the point of diversion from the landowner or the landowner's authorized representative. Provide a copy of a recorded deed, lease, easement or other document with this application. In lieu thereof, you may sign the following sworn statement:

I have legal access to, or control of, the point of diversion described in this application from the landowner or the landowner's authorized representative. I declare under penalty of perjury that the foregoing is true and correct.

Executed on July 10, 2020 Edward J Weber
Applicant's Signature

The applicant must provide the required information or signature irrespective of whether they are the landowner. Failure to complete this portion of the application will cause it to be unacceptable for filing and the application will be returned to the applicant.

7. The proposed project for diversion of water will consist of 1 well

and (was)(will be) completed (by) June 15, 2020
(Month/Day/Year - each was or will be completed)

8. The first actual application of water for the proposed beneficial use was or is estimated to be June 15, 2020
(Mo/Day/Year)

WATER RESOURCES RECEIVED

JUL 16 2020

KS DEPT OF AGRICULTURE

- 9. Will pesticide, fertilizer, or other foreign substance be injected into the water pumped from the diversion works?
 Yes No If "yes", a check valve shall be required.

All chemigation safety requirements must be met including a chemigation permit and reporting requirements.

- 10. If you are planning to impound water, please contact the Division of Water Resources for assistance, prior to submitting the application. Please attach a reservoir area capacity table and inform us of the total acres of surface drainage area above the reservoir.

Have you also made an application for a permit for construction of this dam and reservoir with the Division of Water Resources? Yes No

- If yes, show the Water Structures permit number here _____
- If no, explain here why a Water Structures permit is not required _____

- 11. The application must be supplemented by a U.S.G.S. topographic map, aerial photograph or a detailed plat showing the following information. On the topographic map, aerial photograph, or plat, identify the center of the section, the section lines or the section corners and show the appropriate section, township and range numbers. Also, please show the following information:

- (a) The location of the proposed point(s) of diversion (wells, stream-bank installations, dams, or other diversion works) should be plotted as described in Paragraph No. 5 of the application, showing the North-South distance and the East-West distance from a section line or southeast corner of section.
- (b) If the application is for groundwater, please show the location of any existing water wells of any kind within 1/2 mile of the proposed well or wells. Identify each existing well as to its use and furnish the name and mailing address of the property owner or owners. If there are no wells within 1/2 mile, please advise us.
- (c) If the application is for surface water, the names and addresses of the landowner(s) 1/2 mile downstream and 1/2 mile upstream from your property lines must be shown.
- (d) The location of the proposed place of use should be shown by crosshatching on the topographic map, aerial photograph or plat.
- (e) Show the location of the pipelines, canals, reservoirs or other facilities for conveying water from the point of diversion to the place of use.

A 7.5 minute U.S.G.S. topographic map may be obtained by providing the section, township and range numbers to: Kansas Geological Survey, 1930 Constant, Campus West, University of Kansas, Lawrence, Kansas 66047.

- 12. List any application, appropriation of water, water right, or vested right file number that covers the same diversion points or any of the same place of use described in this application. Also list any other recent modifications made to existing permits or water rights in conjunction with the filing of this application.

PD/PU Overlap 2854 and 6139

WATER RESOURCES RECEIVED

JUL 16 2020

13. Furnish the following well information if the proposed appropriation is for the use of groundwater. If the well has not been completed, give information obtained from test holes, if available.

Information below is from: Test holes Well as completed Drillers log attached

Well location as shown in paragraph No.	(A)	(B)	(C)	(D)
Date Drilled	<u>See Attached</u>			
Total depth of well	_____	_____	_____	_____
Depth to water bearing formation	_____	_____	_____	_____
Depth to static water level	_____	_____	_____	_____
Depth to bottom of pump intake pipe	_____	_____	_____	_____

14. The relationship of the applicant to the proposed place where the water will be used is that of owner
(owner, tenant, agent or otherwise)

15. The owner(s) of the property where the water is used, if other than the applicant, is (please print):

(name, address and telephone number)

(name, address and telephone number)

16. The undersigned states that the information set forth above is true to the best of his/her knowledge and that this application is submitted in good faith.

Dated at Halstead, Kansas, this 10th day of July, 2020.
(month) (year)

Edward J Weber
(Applicant Signature)

By _____
(Agent or Officer Signature)

(Agent or Officer - Please Print)

Assisted by JNE

SFFO/ESII
(office/title)

Date: 07/09/2020

WATER RESOURCES
RECEIVED

JUL 16 2020

FEE SCHEDULE

1. The fee for an application for a permit to appropriate water for beneficial use, except for domestic use, shall be (see paragraph No. 2 below if requesting storage):

ACRE-FEET	FEE
0-100	\$200.00
101-320	\$300.00
More than 320	\$300.00 plus \$20.00 for each additional 100 acre-feet or any part thereof.

2. The fee for an application in which storage is requested, except for domestic use, shall be:

ACRE-FEET	FEE
0-250	\$200.00
More than 250	\$200.00 plus \$20.00 for each additional 250 acre-feet of storage or any part thereof.

Note: If an application requests both direct use *and* storage, the fee charged shall be as determined under No. 1 or No. 2 above, whichever is greater, but not both fees.

3. The fee for an application for a permit to appropriate water for water power or dewatering purposes shall be \$100.00 plus \$200.00 for each 100 cubic feet per second, or part thereof, of the diversion rate requested.

Note: The applicant shall notify the Chief Engineer and pay the statutorily required field inspection fee of \$400.00 when construction of the works for diversion has been completed, except that for applications filed on or after July 1, 2009, for works constructed for sediment control use and for evaporation from a groundwater pit for industrial use shall be accompanied by a field inspection fee of \$200.00.

MAKE CHECKS PAYABLE TO THE KANSAS DEPARTMENT OF AGRICULTURE

ATTENTION

A Water Conservation Plan may be required per K.S.A. 82a-733. A statement that your application for permit to appropriate water may be subject to the minimum desirable streamflow requirements per K.S.A. 82a-703a, b, and c may also be required from you. After the Division of Water Resources has had the opportunity to review your application, you will be notified whether or not you will need to submit a Water Conservation Plan. You also may be required to install a water flow meter or water stage measuring device on your diversion works prior to diverting water. There may be other special conditions or Groundwater Management District regulations that you will need to comply with if this application is approved.

CONVERSION FACTORS

1 acre-foot equals 325,851 gallons

1 million gallons equal 3.07 acre-feet

WATER RESOURCES
RECEIVED

JUL 16 2020

KS DEPT OF AGRICULTURE

JUL 16 2020

KS DEPT OF AGRICULTURE

**IRRIGATION USE
SUPPLEMENTAL SHEET**

File No. _____

Name of Applicant (Please Print): Weber Land Co LLC

1. Please supply the name and address of each landowner, the legal description of the lands to be irrigated, and designate the actual number of acres to be irrigated in each forty acre tract or fractional portion thereof:

Landowner of Record NAME: Weber Land Co LLC

ADDRESS: 2547 Main St., Halstead, KS 67056

S	T	R	NE¼				NW¼				SW¼				SE¼				TOTAL
			NE	NW	SW	SE	NE	NW	SW	SE	NE	NW	SW	SE	NE	NW	SW	SE	
3	24S	2W	23.20	23.00	40.00	39.00			16.40	20.00					12.00	40.00	35.00	5.00	253.60

Landowner of Record NAME: Weber Land LLC
ADDRESS: 247 main Halstead, KS. 67056

S	T	R	NE¼				NW¼				SW¼				SE¼				TOTAL
			NE	NW	SW	SE	NE	NW	SW	SE	NE	NW	SW	SE	NE	NW	SW	SE	

Landowner of Record NAME: _____
ADDRESS: _____

S	T	R	NE¼				NW¼				SW¼				SE¼				TOTAL
			NE	NW	SW	SE	NE	NW	SW	SE	NE	NW	SW	SE	NE	NW	SW	SE	

2. Please complete the following information for the description of the operation for the irrigation project. Attach supplemental sheets as needed.

a. Indicate the soils in the field(s) and their intake rates:

Soil Name	Percent of field (%)	Intake Rate (in/hr)	Irrigation Design Group
Farnum FC	60		
Farnum Fd	10		
Naron Nb	10		
Naron Na	10		
Crete CR	10		
Total:	100 %		

b. Estimate the average land slope in the field(s): 3 %
 Estimate the maximum land slope in the field(s): 6 %

WATER RESOURCES RECEIVED
 JUL 16 2020

c. Type of irrigation system you propose to use (check one):

KS DEPT OF AGRICULTURE

Center pivot Center pivot - LEPA "Big gun" sprinkler
 Gravity system (furrows) Gravity system (borders) Sideroll sprinkler
 Other, please describe: _____

d. System design features:

i. Describe how you will control tailwater:

ii. For sprinkler systems:

(1) Estimate the operating pressure at the distribution system: 40 psi

(2) What is the sprinkler package design rate? 750 gpm

(3) What is the wetted diameter (twice the distance the sprinkler throws water) of a sprinkler on the outer 100 feet of the system? 27 feet

(4) Please include a copy of the sprinkler package design information. - See Attached

e. Crop(s) you intend to irrigate. Please note any planned crop rotations:

Corn, Soybeans, wheat

f. Please describe how you will determine when to irrigate and how much water to apply (particularly important if you do not plan a full irrigation).

Agronomist recommendation

You may attach any additional information you believe will assist in informing the Division of the need for your request.



Legend

- Water Appropriation
- Proposed Point of Diversion
- ✚ Section Corner
- Section Line
- Half Mile Circle

**Proposed Water Appropriation, File
3-24S-2W // Harvey County**

WATER RESOURCES
RECEIVED

JUL 16 2020

KS DEPT OF AGRICULTURE

To the best of my knowledge, all points of diversion within one-half mile of the proposed point of diversion have been shown.

Edward J Weber 7-10-20

Signature / Date

07/09/2020 JNE/SFFO 1:12,000 scale



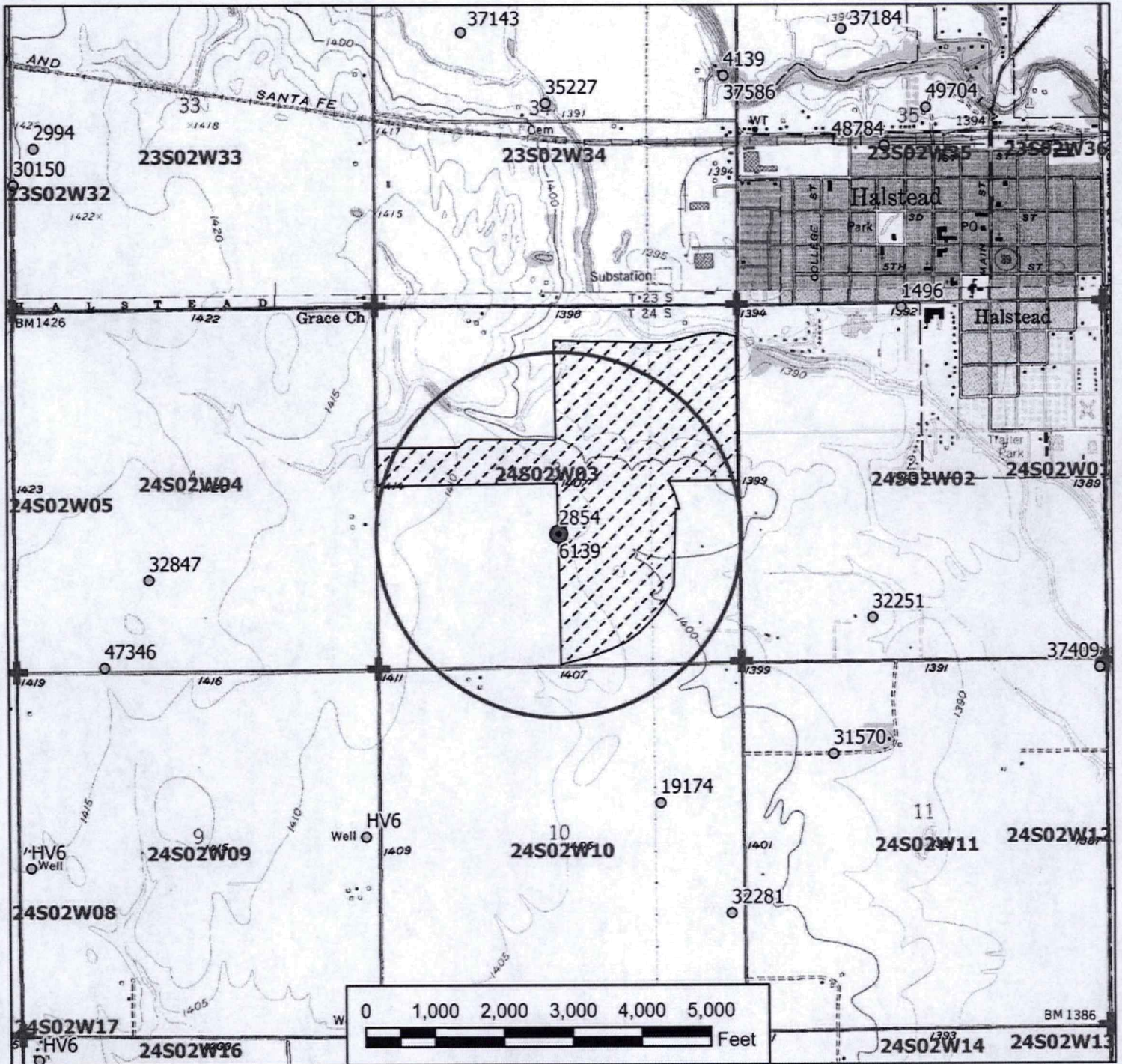

Legend

- Water Appropriation
- Proposed Point of Diversion
- ✚ Section Corner
- ▭ Section Line
- Half Mile Circle

**Proposed Water Appropriation, File
3-24S-2W // Harvey County**

WATER RESOURCES
RECEIVED
JUL 16 2020
KS DEPT OF AGRICULTURE

To the best of my knowledge, all points of diversion within one-half mile of the proposed point of diversion have been shown.

Edward J Weber 7/10/20

Signature / Date

07/09/2020 JNE/SFFO 1:24,000 scale

LINDSAY GEN II - 90

JUNE 12, 2020

WISHNE-37038N

DEALER

CARMICHAEL IRRIGATION
210 N. 96 HWY FRONTAGE RD
MOUNT HOPE, KANSAS 67108

IRRIGATOR

WEBER
MALONES

TOTAL TARGET GPM	750.00	FRICITION FACTOR USED	140	SPANS	LENGTH	PIPE I.D.
TOP OF PIVOT PRESSURE	40.00	TOTAL LENGTH	1700.60	1	137.60	6.395
ENDGUN TARGET GPM	86.23	NUMBER OF TOWERS	10	2	135.00	6.395
NUMBER OF OUTLETS	237	NUMBER OF SPRINKLERS	114	7	179.00	6.395
				OH	40.00	6.395

NELSON R3000 ROTATORS - D4 GREEN PLATES

NO REGULATORS

DROPS AVERAGE 8 FT GROUND CLEARANCE OF 3/4 INCH POLYETHYLENE PIPE

ELEVATION IS 0 FT UP AND 0 FT DOWN

CAUTIONS AND WARNINGS

1. Inadequate crop clearance and/or structural interference may cause poor water distribution, resulting in decreased uniformity and possible streaking.
2. Over watering at beginning of system due to practical limitations on smallest nozzle sizes available and/or allowable for proper operation.
3. Waste water and/or surface water may affect sprinkler performance, water pattern and/or cause plugging.

WATER RESOURCES
RECEIVED

JUL 16 2020

KS DEPT OF AGRICULTURE



Agriculture, Residential & Commercial

WATER RESOURCES RECEIVED

JUL 16 2020

KS DEPT OF AGRICULTURE

Customer's Name Eddie Weber Date 12/6/2019
 Address 247 Main Street Halstead, Ks 67056 Test # 1
 County Harvey Quarter SE Section 3 Township 24S Range 2W

Drilled Footage		Description of Strata	SWL	YIELD	PLAIN	PERF
From	To					
		TEST HOLE #1 UNCASED				
		37.989985 -97.527565	20'			
0	9	Topsoil				
9	30	Tan Medium Coarse Sand				
30	38	Dark Grey Clay				
38	39	Fine Grey Sand Streak				
39	45	Dark Grey Clay				
45	49	Dark Grey Clay with Fine Sand Streaks				
49	57	Grey Fine Sand				
57	58	Grey Clay				
58	70	Grey Sand, Some Fine , Mostly Medium				
70	71	Grey Clay				
71	95	Grey Medium Sand				
95	100	Grey Medium Sand/Some Fine Sand				
100	115	Grey Sand Medium/Coarse				
115	120	White Clay				
120	127	Fine White Sand				
127	133	White Clay				
133	135	Fine White Sand				
135	136	White Clay				
136	140	Fine White Sand				

DATA ENTRY SYSTEM ID NUMBER SHEET

FILE NUMBER _____

APPLICANT PERSON ID & SEQ #	PDIV ID	BATTERY ID
_____	_____	_____
_____	_____	_____
_____	_____	_____
_____	_____	_____
_____	_____	_____

LANDOWNER PERSON ID & SEQ #	PUSE ID
_____	_____
_____	_____
_____	_____
_____	_____
_____	_____

**WATER USE CORRESPONDENT
PERSON ID & SEQ #**
