

NOTICE

This scan only represents the application as filed. The information contained herein meets the requirements of K.A.R. 5-3-1 or K.A.R. 5-5-1, and has been found acceptable for filing in the office of the Chief Engineer. The application should not be considered to be a complete application as per K.A.R. 5-3-1b or K.A.R. 5-5-2a.

Submit To: CHIEF ENGINEER
Division of Water Resources
Kansas Department of Agriculture
1320 Research Park Drive
Manhattan, Kansas 66502
http://agriculture.ks.gov/dwr

**APPLICATION FOR APPROVAL TO
CHANGE THE PLACE OF USE, THE
POINT OF DIVERSION OR THE USE
MADE OF THE WATER UNDER AN
EXISTING WATER RIGHT**



Filing Fee Must Accompany the Application
(Please refer to Fee Schedule on signature page of application form.)

Paragraph Nos. 1, 2, 3, 4 & 8 must be completed. Complete all other applicable portions. A topographic map or detailed plat showing the authorized and proposed points(s) of diversion and /or place of use must accompany this application.

1. Application is hereby made for approval of the Chief Engineer to change the
- Place of Use
 - (Check one or more) Point of Diversion
 - Use Made of Water

Water Resources
Received
FEB 20 2020
12:54
KS Dept Of Agriculture

File No. 9115

2. Name of applicant: Lariat Feeders LLC

Address: Ken Winter, PO Box 115

City, State and Zip: Dodge City KS 67801-0115

Phone Number: (620) 225-4128 E-mail address: ken@LARIATFEEDERS.com

What is your relationship to the water right; owner tenant agent other? If other, please explain. _____

Name of water use correspondent: Lariat Feeders LLC

Address: Ken Winter, PO Box 115

City, State and Zip: Dodge City KS 67801-0115

Phone Number: (620) 225-4128 E-mail address: ken@LARIATFEEDERS.com

3. The change(s) proposed herein are desired for the following reasons (please be specific): To swap the primary/stand-by designation for the two authorized wells.

The change(s) will be completed by approval of change application (Date)

For Office Use Only:															
F.O. Code	<u>2</u>	GMD	<u>3</u>	Meets K.A.R. 5-5-1 (YES / NO)	<input checked="" type="checkbox"/> YES	Use	<u>STK</u>	Source	<input checked="" type="checkbox"/> G	S County	<u>FO</u>	By	<u>KJN</u>	Date	<u>2/20/20</u>
			<u>CGT</u>	Fee \$	<u>200</u>	TR #		Receipt Date	<u>2/20/20</u>	Check #	<u>11501</u>				

2/24/2020
LMoody

4. The presently authorized place of use is:

Owner of Land — NAME: Lariat Feeders LLC

ADDRESS: Ken Winter, PO Box 115, Dodge City KS 67801-0115

Sec.	Twp.	Range	NE¼				NW¼				SW¼				SE¼				TOTAL ACRES
			NE¼	NW¼	SW¼	SE¼	NE¼	NW¼	SW¼	SE¼	NE¼	NW¼	SW¼	SE¼	NE¼	NW¼	SW¼	SE¼	

List any other water rights that cover this place of use. FO-17 (pending change), 15447 & 41364

Owner of Land — NAME: _____

ADDRESS: _____

Sec.	Twp.	Range	NE¼				NW¼				SW¼				SE¼				TOTAL ACRES
			NE¼	NW¼	SW¼	SE¼	NE¼	NW¼	SW¼	SE¼	NE¼	NW¼	SW¼	SE¼	NE¼	NW¼	SW¼	SE¼	

List any other water rights that cover this place of use. _____

(If there are more than two landowners, attach additional sheets as necessary.)

Water Resources
Received

FEB 20 2020

5. It is proposed that the place of use be changed to:

Owner of Land — NAME: _____

ADDRESS: _____

KS Dept Of Agriculture

Sec.	Twp.	Range	NE¼				NW¼				SW¼				SE¼				TOTAL ACRES
			NE¼	NW¼	SW¼	SE¼	NE¼	NW¼	SW¼	SE¼	NE¼	NW¼	SW¼	SE¼	NE¼	NW¼	SW¼	SE¼	

List any other water rights that cover this place of use. _____

Owner of Land — NAME: _____

ADDRESS: _____

Sec.	Twp.	Range	NE¼				NW¼				SW¼				SE¼				TOTAL ACRES
			NE¼	NW¼	SW¼	SE¼	NE¼	NW¼	SW¼	SE¼	NE¼	NW¼	SW¼	SE¼	NE¼	NW¼	SW¼	SE¼	

List any other water rights that cover this place of use. _____

IF MORE SPACE IS NEEDED, ATTACH ADDITIONAL SHEETS AS NECESSARY

- 6. The presently authorized point(s) of diversion are two wells, one primary and one standby
(Provide description and number of points)
- 7. The proposed point(s) of diversion are two wells, one primary and one standby
(Provide description and number of points)

List all presently authorized point(s) of diversion:

8. **Presently authorized point of diversion:**
 One in the SW Quarter of the SE Quarter of the NW Quarter of Section 33, Township 26 South, Range 24 W, in Ford County, Kansas, 3,245 feet North 3,550 feet West of Southeast corner of section.
 Authorized Rate 430 gpm Authorized Quantity 45.990 mgd--Primary Well
 (DWR use only: Computer ID No. 04 GPS N/A feet North N/A feet West)
 This point will not be changed This point will be changed as follows:
Proposed point of diversion: (Complete only if change is requested):
 One in the SW Quarter of the SE Quarter of the NW Quarter of Section 33, Township 26 South, Range 24 W, in Ford County, Kansas, 3,245 feet North 3,550 feet West of Southeast corner of section.
 Proposed Rate STANDBY Proposed Quantity STANDBY
 This point is: Additional Well Geo Center List other water rights that will use this point FO-17 (pending change)

9. **Presently authorized point of diversion:**
 One in the SW Quarter of the NE Quarter of the NW Quarter of Section 33, Township 26 South, Range 24 W, in Ford County, Kansas, 4,320 feet North 3,560 feet West of Southeast corner of section.
 Authorized Rate STANDBY Authorized Quantity STANDBY
 (DWR use only: Computer ID No. 05 GPS N/A feet North N/A feet West)
 This point will not be changed This point will be changed as follows:
Proposed point of diversion: (Complete only if change is requested)
 One in the SW Quarter of the NE Quarter of the NW Quarter of Section 33, Township 26 South, Range 24 W, in Ford County, Kansas, 4,320 feet North 3,560 feet West of Southeast corner of section.
 Proposed Rate 430 gpm Proposed Quantity 45.990 mgd--Primary Well
 This point is: Additional Well Geo Center List other water rights that will use this point FO-17 (pending change)

10. **Presently authorized point of diversion:**
 One in the _____ Quarter of the _____ Quarter of the _____ Quarter of Section _____, Township _____ South, Range _____ (E/W), in _____ County, Kansas, _____ feet North _____ feet West of Southeast corner of section.
 Authorized Rate _____ Authorized Quantity _____
 (DWR use only: Computer ID No. _____ GPS _____ feet North _____ feet West)
 This point will not be changed This point will be changed as follows:
Proposed point of diversion: (Complete only if change is requested)
 One in the _____ Quarter of the _____ Quarter of the _____ Quarter of Section _____, Township _____ South, Range _____ (E/W), in _____ County, Kansas, _____ feet North _____ feet West of Southeast corner of section.
 Proposed Rate _____ Proposed Quantity _____
 This point is: Additional Well Geo Center List other water rights that will use this point _____

- 11. Describe the current condition of and future plans for any point(s) of diversion which will no longer be used. N/A

Water Resources

IF MORE SPACE IS NEEDED, ATTACH ADDITIONAL SHEETS AS NECESSARY

FEB 20 2020

12. The presently authorized use of water is for Stockwater purposes.

It is proposed that the use be changed to --- purposes.

13. If changing the place of use and/or use made of water, describe how the consumptive use will not be increased.

N/A

(Please show any calculations here.)

14. It is requested that the maximum annual quantity of water be reduced to --- (acre-feet or million gallons).

15. It is requested that the maximum rate of diversion of water be reduced to --- gallons per minute (--- c.f.s.).

16. The application must include either a topographic map or detailed plat. A U.S. Geological Survey Topographic Map, scale 1:24,000, is available through the Kansas Geological Survey, 1930 Constant Avenue, University of Kansas, Lawrence, Kansas 66047-3726 (www.usgs.gov). The map should show the location of the presently authorized point(s) of diversion. Distances North and West of the Southeast corner of the section must be shown. The presently authorized place of use should also be shown. Identify the center of the section, the section lines and the section corners and show the appropriate section, township, and range numbers on the map. In addition the following information must also be shown on the map.

a. If a change in the location of the point(s) of diversion is proposed, show:

- 1) The location of the proposed point(s) of diversion. Distances North and West of the Southeast corner of the section must be shown. Please be certain that the information shown on the map agrees with the information shown in Paragraph Nos. 9, 10 and 11 of the application.
- 2) If the source of supply is groundwater, please show the location of existing water wells of any kind, including domestic wells, within 1/2 mile of the proposed well or wells. Identify each well as to its use and furnish name and mailing address of the property owner or owners. If there are no wells within 1/2 mile, please indicate so on the map.
- 3) If the source of supply is surface water, the names and mailing addresses of all landowner(s) 1/2 mile downstream and 1/2 mile upstream from your property lines must be shown.

b. If a change in the place of use is desired, show the proposed place of use by crosshatching on the map. Please be certain that the information shown on the map agrees with the information shown in Paragraph No. 5 of the application.

17. Attach documentation to show the change(s) proposed herein will not impair existing water rights and relates to the same local source of supply as to which the water right relates. This information may include statements, plats, geology reports, well logs, test hole logs, and other information as necessary information to show the above. Additional comments may be made below.

Information on file indicates that both the authorized and proposed points of diversion appear to be in the same source of supply, the Arkansas River main stem alluvium.

Water Resources
Received
FEB 20 2020

KS Dept Of Agriculture

18. If the proposed change(s) does not meet all applicable rules and regulations of the Kansas Water Appropriation Act, please identify the rules and regulations for which you request a waiver. State the reason why a waiver is needed and why the request should be granted. Attach documentation showing that granting the request will not impair existing water rights and will not prejudicially and unreasonably affect the public interest.

A waiver of K.A.R. 5-23-3, Minimum well spacing requirements: high plains aquifer will be need to approve the change as proposed.

IF MORE SPACE IS NEEDED, ATTACH ADDITIONAL SHEETS AS NECESSARY

Any use of water that is not as authorized by the water right or permit to authorize water **before** the chief engineer approves this application is a violation of the Kansas Water Appropriation Act for which criminal or civil penalties may be assessed. Such violation is a class C misdemeanor, punishable by a fine not to exceed \$500 and/or a term of confinement not to exceed one month in the county jail. K.S.A. 82a-728(b). Civil penalties shall be not less than \$100 nor more than \$1,000 per violation. In the case of a continuing violation, each day such violation continues may be deemed a separate violation. In addition to these penalties the water right may be modified or suspended. K.S.A. 82a-737, as amended.

The application must be signed by all owners of the place of use authorized under the water right and his or her spouse, if married. Please indicate if there is no spouse. If land is being purchased under contract, the seller must sign as landowner until such time as the contract is completed.

In the event that all applicants cannot appear before one notary public, they may as necessary sign separate copies of the application before any notary public conveniently available to them. All copies signed in this manner shall be considered to be valid parts of the application.

If the request is signed on behalf of any Owner by someone with legal authority to do so (for example, an agent, one who has power of attorney, or an executor, executrix, conservator), it will be necessary to attach proper documents showing such authority.

I declare that I am an owner of the currently authorized place of use as identified herein, or that I represent all such owners and am authorized to make this application on their behalf, and declare further that the statements contained herein are true, correct, and complete. By filing this application I authorize the chief engineer to permanently reduce the quantity of water and/or rate of diversion as specified in sections 14 and 15 of this application.

Dated at DODGE CITY, KS, Kansas, this 17 day of FEB, 2020.

<u>Ken Winter</u> (Owner)	_____	(Spouse)
<u>KEN WINTER</u> (Please Print)	_____	(Please Print)
_____	_____	(Spouse)
_____	_____	(Please Print)
_____	_____	(Spouse)
_____	_____	(Please Print)

State of Kansas }
County of Ford } SS



I hereby certify that the foregoing application was signed in my presence and sworn to before me this 17 day of February, 2020.

My Commission Expires 12-16-22
Tonya Majer
Notary Public

FEE SCHEDULE

Each application to change the place of use, the point of diversion or the use made of the water under this section shall be accompanied by the application fee set forth in the schedule below:

- (1) Application to change a point of diversion 300 feet or less \$100
- (2) Application to change a point of diversion more than 300 feet \$200
- (3) Application to change the place of use \$200
- (4) Application to change the use made of the water \$300

Make check payable to **Kansas Department of Agriculture.**

Water Resources
Received
FEB 20 2020
KS Dept Of Agriculture

File No. 9115 Application to Change the Point of Diversion: Nearby Well Owners

Domestic Well 1

Dennis & Charlotte Volk, 11448 Ft Dodge Rd, Dodge City KS 67801

Domestic Well 3

Toribio Cortez, 805 Ave D, Dodge City KS 67801-5114

Domestic Well 4

Humberto M Marquez, 11158 114 Rd, Dodge City KS 67801

Domestic Well 5, Vested Right, File No. FO-15 & Water Right, File No. 178

Cook & Sons Construction, Merle Ray & Rhonda D Cook, 3138 Ft Dodge Rd, Dodge City KS 67801-8205

Domestic Well 6

William & Lila Cook Living Trust, PO Box 1651, Dodge City KS 67801-1651

Water Right, File No. FO-17 & 15447

Applicant

Water Right, File No. 17192

Coake Farms Feeders LLC, Mark D Fisher, PO Box 507, Dodge City KS 67801

Water Right, File No. 17012

Koch Fertilizer Dodge City LLC, Plant Manager, PO Box 1337, Dodge City KS 67801

Vested Right, File No. FO-77 & Water Right, File No. 31241

Dodge City Feeders, Manager, 11430 Lariat Rd, Dodge City KS 67801

Water Resources
Received

FEB 20 2020

KS Dept Of Agriculture

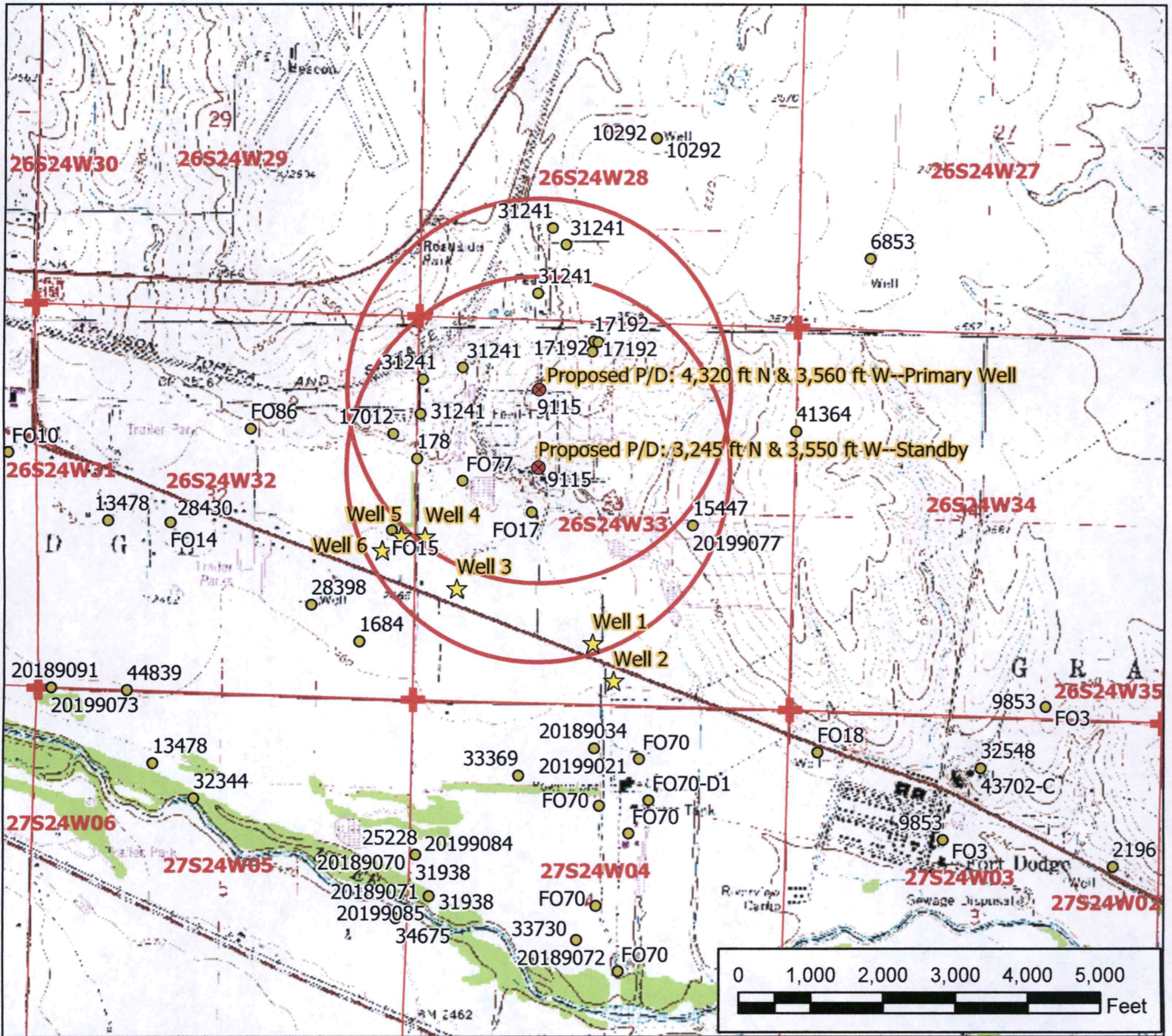

Legend

- Water Appropriation
- ⊗ Authorized/Proposed Point of Diversion
- ★ Domestic Well
- ⊕ Section Corner
- ▭ Section Line
- Half Mile Circle

Place of Use

- ▭ Proposed
- ▭ Authorized

Water Right, File No. 9115

Change in Point of Diversion Application Map 33-26-24W // Ford County



To the best of my knowledge, all wells within one-half mile of the proposed points of diversion have been shown.

KS Dept Of Agriculture

Ben Winter 2/17/2020
 Signature / Date 1/27/2020 EKF/SFFO 1:24,000

1320 Research Park Drive
Manhattan, KS 66502
785-564-6700
www. agriculture.ks.gov



900 SW Jackson, Room 456
Topeka, KS 66612
785-296-3556

Mike Beam, Secretary

Laura Kelly, Governor

LARIAT FEEDERS LLC
Attn: KEN WINTER
PO BOX 115
DODGE CITY KS 67801-0115

February 20, 2020

RE: File Nos. **9115 & FO-17**

Dear Sir or Madam:

Applications for approval of the Chief Engineer to change the following condition or conditions of the file numbers referred to above have been received:

9115:

- place of use
- point of diversion
- use made of water

FO-17:

- place of use
- point of diversion
- use made of water

As a matter of record, the Division of Water Resources has on hand a large number of applications awaiting processing. Therefore, to be fair to all concerned, and so that we can process those applications on hand in the order they were received, we intend to concentrate on the backlog of applications until the issue is resolved. You will be contacted regarding this application as soon as it has been examined.

In accordance with the provisions of the Kansas Water Appropriation Act, a portion of which is included below, the use of water prior to approval of the application is unlawful. You should not proceed and divert water as indicated by your plans in your application for a change for this file until you receive approval for this change from the Chief Engineer. Once approved, compliance with the terms, conditions and limitations of the permit is necessary. Conservation of the water resources of Kansas is required.

Section 82a-728 of the Kansas Water Appropriation Act, provides (a) except for the appropriation of water for the purpose of domestic use, . . . it shall be unlawful for any person to appropriate or threaten to appropriate water from any source without first applying for and obtaining a permit to appropriate water in accordance with the provisions of the Water Appropriation Act or for any person to violate any condition of a vested right, appropriation right or an approved application for a permit to appropriate water for beneficial use.

(b) (1) The violation of any provision of this section by any person is a class C misdemeanor...

A class C misdemeanor is punishable by a fine not to exceed \$500 and/or a term of confinement not to exceed one month in the county jail. Each day that the violation occurs constitutes a separate offense.

If you have any questions, please contact me at (785) 564-6627. If you wish to discuss a specific file, please have the file number ready so that we may help you more efficiently.

Sincerely,

A handwritten signature in cursive script that reads "Kristen A. Baum".

Kristen A. Baum
New Applications Unit Supervisor
Water Appropriation Program

KAB: skj