

# NOTICE

This scan only represents the application as filed. The information contained herein meets the requirements of K.A.R. 5-3-1 or K.A.R. 5-5-1, and has been found acceptable for filing in the office of the Chief Engineer. The application should not be considered to be a complete application as per K.A.R. 5-3-1b or K.A.R. 5-5-2a.

20219016

WATER RESOURCES RECEIVED

MAR 11 2021



Submit To: CHIEF ENGINEER  
Division of Water Resources  
Kansas Department of Agriculture  
1320 Research Park Drive  
Manhattan, Kansas 66502  
http://agriculture.ks.gov/dwr

APPLICATION FOR TERM PERMIT

GROUNDWATER  
 SURFACE WATER  
(check one)

KS DEPT OF AGRICULTURE State of Kansas

STATUTORY FILING FEE MUST ACCOMPANY THIS APPLICATION  
(Make check payable to the Kansas Department of Agriculture)

1. Applicant: (Please print or type)  
Name CURT HOOBLER  
Street 1346 E 130 N  
City and State MULVANE KS 67110  
Zip Code \_\_\_\_\_ Telephone No. (316) 777 4683  
E-Mail Address CURTEVAN.HOOBLER@GMAD.COM  
Social Security I.D. No. 51460 7572  
and/or Taxpayer I.D. No. \_\_\_\_\_

Assisted by \_\_\_\_\_  
4. Water is to be used for (briefly describe proposed use and explain the rate and quantity requested):  
CROPS 600-700 GAL PER ACRE  
CENTER PIVOT TO MINIMIZE  
PUBLIC NUISANCE  
5. Location of place of use:  
24-25-29S-1E  
**OVERLAPS PU WITH 20209018\***

2. Location of Point of Diversion:  
Sec. 25, Twp. 29S, Rng. 1E, (E/W),  
SEDOGWICK County, Kansas.  
Distance from Southeast Corner of Section:  
4995 feet North from Southeast Corner  
3345 feet West from Southeast Corner

6. Period of use:  
Commencing date: ~~4-1-21~~ **1/1/2021**  
Ending Date: 12-31-2025 Also enter on Item 12

If off-stream pit, check here   
Will pit floor intersect water table? Yes  No

3. Water Use Data:  
Proposed Max. Pumping Rate (gpm) 700  
Amount Requested (acre-feet) 60  
per calendar year  
Depth of Well (feet) 45  
Date (completed) (will be completed) 3/10  
Drainage Basin \_\_\_\_\_  
Name of Stream \_\_\_\_\_

7. Location of the proposed point of diversion and those of other water users within 1/2 mile shall be indicated on the diagram to the lower-left, scale 1 inch = 2,000 feet. If surface water, indicate on the diagram the course of the stream, and its name. List other D.W.R. permit numbers that cover the requested point(s) of diversion or place of use here:  
USE WITH 20209018  
ON 1 FLOWMETER

FEE SCHEDULE

- 1. The filing fee for an application is based on the maximum amount of water use proposed within a year. Except for storage, the fee is:  
Acre-feet Fee  
0-100 \$200.00  
101-320 \$300.00  
More than 320 \$300.00  
plus \$20 for each additional 100 acre-feet or any part thereof.
- 2. The fee for an application in which storage is requested, is:  
Acre-feet Fee  
0-250 \$200.00  
More than 250 \$200.00  
plus \$20.00 for each additional 250 acre-feet of storage or any part thereof.

- NOTE: If an application requests both direct use and storage, the fee charged shall be as determined under No. 1 or No. 2 above, whichever is greater, but not both fees.
- 3. A request for an extension of time to extend the term of a term permit shall be accompanied by a fee of \$100.00.
- 4. There is a separate application form for domestic use. Do not use this form for domestic use.

CONVERSION FACTORS

1 acre-foot equals 325,851 gallons  
1 million gallons equal 3.07 acre-feet

3/17/2021  
KJN

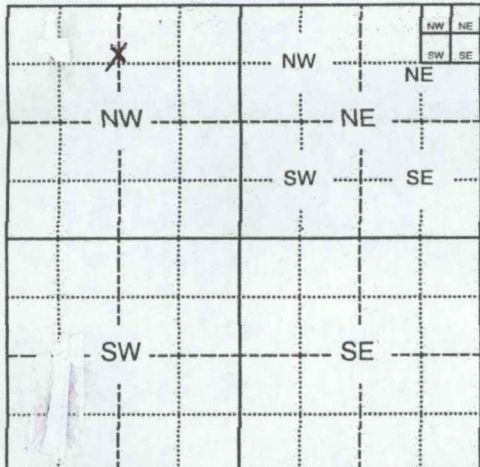

3/18/2021  
LMoody

or Office Use Only:  
Code 2 GMD Meets K.A.R. 5-3-1 (YES/NO) Use IRR Source G/S County SG By BMM Date 3/16/21  
Code TRP Fee \$ 200 TR # \_\_\_\_\_ Receipt Date 3/11/21 Check # 4238



WATER RESOURCES  
RECEIVED

MAR 11 2021

Date: 3/9/21

Kansas Department of Agriculture  
Division of Water Resources  
Christopher W. Beightel, Acting Chief Engineer  
1320 Research Park Drive  
Manhattan, Kansas 66502

KS DEPT OF AGRICULTURE

Re: Application, File No. (to be determined)

I understand that the diversion of groundwater from the source of supply to which the above referenced application applies is subject to the following conditions of approval.

(1) That if I am diverting groundwater, static water level must remain at a sufficient level to satisfy demands of all senior water rights, including domestic water rights in the nearby area. At minimum, the static water level should remain at least 10 feet above bedrock, but I understand that the static water level that must be maintained could be subject to change should it become necessary to protect senior water rights.

(2) That if any impairment of a nearby water right holder is substantiated, I understand I must cease diversion or remedy the impairment immediately.

(3) That the use made of water is for dewatering purposes. Any irrigation use would be considered secondary use in nature and would in no way be guaranteed by the approval of the above referenced application. This may affect the economics of my cropping decisions, should the diversion of water be required to cease.

(4) That the discharged water is controlled and managed by the applicant to minimize flooding, waste, damage, hazards or a public nuisance.

(5) That if the high water table conditions still exist at the end of this five year term permit, and dewatering is still necessary to mitigate flooding basements in Salem Township, the chief engineer will consider issuing an additional term permit for dewatering purposes, provided an appropriate application is filed.

I understand that if this application is approved, there could be times, as determined by the Division of Water Resources, when I would not be allowed to divert water. I realize that this could affect the economics of my decision to appropriate water. I am aware of the above factors, and with the knowledge thereof, request that the Division of Water Resources proceed with processing and approval, if possible, of the above referenced application.

*Curt Hobbler*

Signature of Applicant

CURT HOBBLER

(Print Applicant's Name)

State of Kansas )  
                          ) ss  
County of            )

I hereby certify that the foregoing instrument was signed in my presence and sworn to before me this 9 day of March, 2020.

*Melissa R. Schanz*  
Notary Public





WATER RESOURCES RECEIVED

MAR 11 2021

KANSAS DEPT OF AGRICULTURE

8. For groundwater use, list below all wells within 1/2 mile of the proposed well, and plot locations upon the diagram on reverse side. If additional space is needed, attach a map.

Other wells -

Well A Owner(s): SELF, TO RUN WITH FILE 20209018  
Address: \_\_\_\_\_

Well B Owner(s): \_\_\_\_\_  
Address: \_\_\_\_\_

9. For surface water use, list below the names and addresses of all landowners from a point 1/2 mile upstream to a point 1/2 mile downstream of the tract of land upon which the point of diversion is located. If additional space is needed, attach sheet.

Tract A Owner(s): \_\_\_\_\_  
Address: \_\_\_\_\_

Tract B Owner(s): \_\_\_\_\_  
Address: \_\_\_\_\_

10. The owner of the point of diversion, if other than the applicant is (please print):

\_\_\_\_\_ (name, address and telephone number)

You must provide evidence of legal access to, or control of, the point of diversion from the landowner or the landowner's authorized representative. Provide a copy of a recorded deed, lease, easement or other document with this application. In lieu thereof, you may sign the following sworn statement:

I have legal access to, or control of, the point of diversion described in this application from the landowner or the landowner's authorized representative. I declare under penalty of perjury that the foregoing is true and correct.

Executed on March 12, 2021. \_\_\_\_\_  
Applicant's Signature

The applicant must provide the required information or signature irrespective of whether they are the landowner. Failure to complete this portion of the application will cause it to be unacceptable for filing and the application will be returned to the applicant.

11. The applicant states that the information set hereon is true and accurate to the best of his/her knowledge.

12. The applicant agrees to waive any right to a hearing on the matter of abandonment of this appropriation right and further agrees that this appropriation right may be dismissed and terminated upon completion of the proposed project, said dismissal date to be on 12/31/2025 or within any extension of time authorized by the Chief Engineer, Division of Water Resources, Kansas Department of Agriculture.

13. The applicant agrees to provide water to nearby water users, at no charge to said users, should their rights to use water become impaired by the project proposed by this application.

14. Water use contact person (in event emergency contact is needed):

Name: CURT HOOBLER Telephone No. 316) 777 4683

\_\_\_\_\_  
Signature of Applicant

or

\_\_\_\_\_  
Authorized Representative Date 3/12/21

CURT HOOBLER  
Applicant's Name Printed

\_\_\_\_\_  
Title

DO NOT WRITE BELOW THIS LINE

CONDITIONS OF APPROVAL:

The applicant shall maintain accurate and complete records from which the quantity of water diverted during each calendar year may be readily determined. Accurate and complete records shall be furnished to the Chief Engineer by March 1 following the end of each calendar year. Failure to file the annual water use report by the due date, shall cause the applicant to be subject to a civil penalty.

The use of water herein authorized shall not be made so as to impair any use under existing water rights nor prejudicially and unreasonably affect the public interest.

The Chief Engineer specifically retains jurisdiction in this matter with authority to make such reasonable reductions in the approved rate of diversion and quantity authorized, and such changes in other terms, conditions, and limitation set forth in this approval and permit to proceed as may be deemed to be in the public interest.

1320 Research Park Drive  
Manhattan, KS 66502  
785-564-6700  
www. agriculture.ks.gov



900 SW Jackson, Room 456  
Topeka, KS 66612  
785-296-3556

Mike Beam, Secretary

Laura Kelly, Governor

March 16, 2021

CURT HOOBLER  
1346 E 130 N  
MULVANE KS 67110

RE: Application, File No(s). **20219016**

Dear Sir or Madam:

The Division of Water Resources (Division) has received your application(s) for a permit to appropriate water for beneficial use. Your application(s) has been assigned the file number(s) referenced above. Please be aware that the Division may have a large number of pending applications on hand at times and makes every attempt to process them in the order in which they are received. You will be contacted if additional information is required.

Please note, this letter only acknowledges receipt of your application(s) and does not guarantee approval. In accordance with the provisions of the Kansas Water Appropriation Act, the use of water as proposed prior to approval of the application(s) is unlawful.

Additional information about the process may be found on our website at [agriculture.ks.gov/divisions-programs/dwr](http://agriculture.ks.gov/divisions-programs/dwr). If you have any other questions, please contact our office at 785-564-6640 or your local .. If you call, please reference the file number so we can help you more efficiently.

Sincerely,

Kris Neuhauser  
New Applications Lead  
Water Appropriation Program

**DATA ENTRY SYSTEM ID NUMBER SHEET**

20219016

FILE NUMBER \_\_\_\_\_

APPLICANT

PDIV ID

BATTERY ID

PERSON ID & SEQ #

87955

23601

_____	_____	_____	_____
_____	_____	_____	_____
_____	_____	_____	_____
_____	_____	_____	_____
_____	_____	_____	_____

LANDOWNER

PUSE ID

PERSON ID & SEQ #

70251

23601

_____	_____	_____	_____
_____	_____	_____	_____
_____	_____	_____	_____
_____	_____	_____	_____
_____	_____	_____	_____

WATER USE CORRESPONDENT

PERSON ID & SEQ #

23601

_____	_____
_____	_____
_____	_____
_____	_____