

Kansas Department of Agriculture  
 Division of Water Resources  
**CHANGE: P/D WORKSHEET**

1. File Number: <b>49635</b>	2. Status Change Date:	3. Change Num: <b>1</b>	4. Field Office: <b>02</b>	5. GMD:
---------------------------------	------------------------	----------------------------	-------------------------------	---------

6. Status: <input checked="" type="checkbox"/> Approved <span style="margin-left: 20px;"><input type="checkbox"/> Denied by DWR/GMD</span> <span style="margin-left: 20px;"><input type="checkbox"/> Dismiss by Request/Failure to Return</span> <b>8/3/21</b>	7. Filing Date of Change: <b>7/30/21</b>
---	---

8a. Applicant(s) New to system <input type="checkbox"/>	Person ID _____ Add Seq# _____
--	-----------------------------------

8c. Landowner(s) New to system <input type="checkbox"/>	Person ID _____ Add Seq# _____
--	-----------------------------------

8b. Landowner(s) New to system <input type="checkbox"/>	Person ID <b>63148</b> Add Seq# <b>1</b>
<b>GLENDAM TOTTEN LIVING TRUST 716 TWEED APT 101 WINFIELD KS 67156-1595</b>	

8d. WUC New to system <input type="checkbox"/>	Person ID <b>63147</b> Add Seq# <b>1</b>
<b>RICKY D &amp; KAFFY TOTTEN LIVING TRUST 1724 E 20TH ST S OXFORD KS 67119</b>	

9. Documents and Enclosure(s): <input checked="" type="checkbox"/> DWR Meter(s) Date to Comply: <b>12/31/21</b> <input type="checkbox"/> N & P Date to Comply: _____	
<input type="checkbox"/> Anti-Reverse Meter <input type="checkbox"/> Meter Seal <input checked="" type="checkbox"/> Check Valve <input type="checkbox"/> N & P Form <input type="checkbox"/> Water Tube <input type="checkbox"/> Driller Copy <input type="checkbox"/> H & E Letter	
<input type="checkbox"/> Conservation Plan            Date Required: _____            Date Approved: _____            Date to Comply: _____	

10. Use Made of Water    From: _____	To: _____
--------------------------------------	-----------

	Date Prepared: <b>8/2/21</b>	By: <b>EKF</b>
	Date Entered:	By:

File No. **49635**      11. County: **SU**      Basin: **Arkansas River**      Stream: **---**      Formation Code: **100 & 533**      Special Use: **N/A**

12. Points of Diversion											Rate and Quantity						
CHK	MOD	DEL	ENT	PDIV	Qualifier	S	T	R	ID	'N	'W	Comment (AKA Line)	Rate gpm	Quantity af	Rate gpm	Quantity af	Overlap PD Files
MOD	81658				NW SE SW	10	33	2E	1	685	3,382	GEO CTR	800	208	800	208	NONE
MOD	83675				SE SE SW	10	33	2E	2	648	3,217	BATT 1 OF 4 WELLS					NONE
ENT					NW SE SW	10	33	2E		819	3,433	BATT 1 OF 4 WELLS					NONE
ENT					NE SE SW	10	33	2E		597	3,369	BATT 1 OF 4 WELLS					NONE
MOD	83678				SW SE SW	10	33	2E	5	677	3,509	BATT 1 OF 4 WELLS					NONE
DEL	83676				NW SE SW	10	33	2E	3	953	3,418	BATT 1 OF 4 WELLS					NONE
DEL	83677				NE SE SW	10	33	2E	4	753	3,218	BATT 1 OF 4 WELLS					NONE

13. Storage: Rate \_\_\_\_\_ NF      Quantity \_\_\_\_\_ ac/ft      Additional Rate \_\_\_\_\_ NF      Additional Quantity \_\_\_\_\_ ac/ft

14. Limitation: \_\_\_\_\_ af/yr at \_\_\_\_\_ gpm ( \_\_\_\_\_ cfs) when combined with file number(s) \_\_\_\_\_  
 Limitation: \_\_\_\_\_ af/yr at \_\_\_\_\_ gpm ( \_\_\_\_\_ cfs) when combined with file number(s) \_\_\_\_\_

15. 5YR Allocation:    Allocation Type \_\_\_\_\_    Start Year \_\_\_\_\_    5 YR Amount \_\_\_\_\_    Amount Unit \_\_\_\_\_    Base Acres \_\_\_\_\_    Comment \_\_\_\_\_

16. Place of Use																			Total	Owner	Chg?	Overlap Files						
CHK	MOD	DEL	ENT	PUSE	S	T	R	ID	NE¼				NW¼				SW¼				SE¼							
									NE ¼	NW ¼	SW ¼	SE ¼	NE ¼	NW ¼	SW ¼	SE ¼	NE ¼	NW ¼	SW ¼	SE ¼	NE ¼	NW ¼	SW ¼	SE ¼				
CHK	64760																									8b	N	NONE

Base Acres:      Year:      Minimum Reasonable Quantity:

Comments:

Submit completed application to:  
 Kansas Department of Agriculture  
 Division of Water Resources  
 Field Office for your area.

Call for address:

Topeka -- (785) 296-5733  
 Stafford -- (620) 234-5311  
 Stockton -- (785) 425-6787  
 Garden City -- (620) 276-2901  
<http://agriculture.ks.gov/dwr>

## DWR FIELD OFFICE APPLICATION FOR APPROVAL TO CHANGE THE PLACE OF USE AND/OR THE POINT OF DIVERSION



STATE OF KANSAS

**WATER METER REQUIRED**

Filing Fee Must Accompany the Application, K.S.A. 82a-708b(b), as amended.  
 Fee Schedule is on the third page of this application form.

Paragraph Nos. 1, 2, 3 & 5 must be completed. Complete all other applicable portions. If change in point of diversion is greater than 100 feet, or if place of use will be changed, include a topographic map or detailed plat showing the authorized and proposed point(s) of diversion and/or place of use.

File No. 49635

RECEIVED  
 10:10  
 JUL 30 2021

1. Application is hereby made for approval of the Chief Engineer to change the (check one or both):

Place of Use                       Point of Diversion

under the water right which is the subject of this application in accordance with the conditions described below.

The source of supply is:                       Groundwater                       Surface water

Stafford Field Office  
 DIVISION OF WATER RESOURCES

2. Name and address of Applicant: Rick Totten

1724 E 20th St S, Oxford KS 67119

Phone Number: (620)648-3316

Email address: \_\_\_\_\_

Name and address of Water Use Correspondent: Ricky D & Kaffy Totten Liv Tr

1724 E 20th St S, Oxford KS 67119

Phone Number: (316)648-3316

Email address: \_\_\_\_\_

3. The presently authorized place of use is:

Owner of Land ---- NAME: Glenda M Totten Living Trust

ADDRESS: 716 Tweed Apt 101, Winfield, KS 67156

(If there is more than one landowner, attach supplemental sheets as necessary.)

Sec.	Twp.	Range	NE¼				NW¼				SW¼				SE¼				TOTAL ACRES
			NE¼	NW¼	SW¼	SE¼	NE¼	NW¼	SW¼	SE¼	NE¼	NW¼	SW¼	SE¼	NE¼	NW¼	SW¼	SE¼	
No	Change																		

4. If this application is for a change in place of use, it is proposed that the place of use be changed to:

Owner of Land ---- NAME: \_\_\_\_\_

ADDRESS: \_\_\_\_\_

(If there is more than one landowner, attach supplemental sheets as necessary.)

Sec.	Twp.	Range	NE¼				NW¼				SW¼				SE¼				TOTAL ACRES
			NE¼	NW¼	SW¼	SE¼	NE¼	NW¼	SW¼	SE¼	NE¼	NW¼	SW¼	SE¼	NE¼	NW¼	SW¼	SE¼	

For Office Use Only: Code CLT Fee \$ 100 TR # \_\_\_\_\_ Receipt Date \_\_\_\_\_ Check # 4080

5. **Presently authorized point of diversion: Geographic Center of Four (4) Wells**

One in the NW Quarter of the SE Quarter of the SW Quarter of Section 10, Township 33 South, Range 2 E, in Sumner County, Kansas, 753 feet North 3,418 feet West of Southeast corner of section. Authorized Rate 800 gpm Authorized Quantity 208 AF Depth of well N/A (feet)

(DWR use only: Computer ID No. 01 GPS 847 feet North 3,386 feet West)

This point will not be changed  This point will be changed as follows:  No change, point better described with GPS as follows:

**Proposed point of diversion: (Complete only if change is requested or if existing point is better described by GPS)**

**Geographic Center of Four (4) Wells**

One in the NW Quarter of the SE Quarter of the SW Quarter of Section 10, Township 33 South, Range 2 E, in Sumner County, Kansas, 685 feet North 3,382 feet West of Southeast corner of section. Proposed Rate no change Proposed Quantity no change Proposed well depth (feet) N/A

This point is:  Additional Well  Geo Center List other water rights that will use this point None

6. **Presently authorized point of diversion:**

One in the \_\_\_\_\_ Quarter of the \_\_\_\_\_ Quarter of the \_\_\_\_\_ Quarter of Section \_\_\_\_\_, Township \_\_\_\_\_ South, Range \_\_\_\_\_ (E/W), in \_\_\_\_\_ County, Kansas, \_\_\_\_\_ feet North \_\_\_\_\_ feet West of Southeast corner of section. Authorized Rate \_\_\_\_\_ Authorized Quantity \_\_\_\_\_ Depth of well \_\_\_\_\_ (feet)

(DWR use only: Computer ID No. \_\_\_\_\_ GPS \_\_\_\_\_ feet North \_\_\_\_\_ feet West)

This point will not be changed  This point will be changed as follows:  No change, point better described with GPS as follows:

**Proposed point of diversion: (Complete only if change is requested or if existing point is better described by GPS)**

One in the \_\_\_\_\_ Quarter of the \_\_\_\_\_ Quarter of the \_\_\_\_\_ Quarter of Section \_\_\_\_\_, Township \_\_\_\_\_ South, Range \_\_\_\_\_ (E/W), in \_\_\_\_\_ County, Kansas, \_\_\_\_\_ feet North \_\_\_\_\_ feet West of Southeast corner of section. Proposed Rate \_\_\_\_\_ Proposed Quantity \_\_\_\_\_ Proposed well depth (feet) \_\_\_\_\_

This point is:  Additional Well  Geo Center List other water rights that will use this point \_\_\_\_\_

7. The changes herein are desired for the following reasons?  
 (please be specific) To bring file into compliance. Two (2) wells were re-drilled in 2020 without permission after 12/31/2017 completion deadline.

8. If a well, is the test hole log attached?  Yes  No

9. The change(s) (was)(will be) completed by?  
Was completed in 2020

10. If the point of diversion is a well:  
 (a) What are you going to do with the old well?  
plug both old wells 8/3/21 cpe  
 (b) When will this be done? in near future

11. Groundwater Management District recommendation attached?  
 Yes  No

12. Assisted by MJM & EKF/SFFO

13a. If the proposed point of diversion will be relocated more than 300 feet but within 2,640 feet of the existing point of diversion, attach a topographic map or aerial photograph. For groundwater sources, show all wells (including domestic) within one-half mile of the proposed point of diversion and the names and mailing addresses of the owners. For surface water sources, show the names and addresses of the landowner(s) one-half mile downstream and one-half mile upstream from your property lines

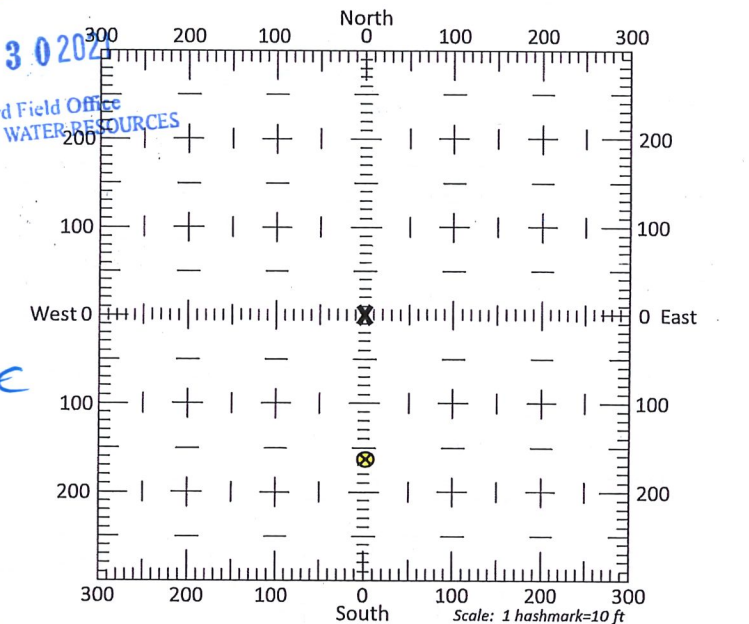

13b. If the proposed point of diversion will be relocated within 300 feet of the existing point of diversion, indicate its location on the diagram shown above in relation to the existing point of diversion. (PLEASE NOTE: The "X" in center of diagram above represents the presently authorized point of diversion.)

**SUMMARY ORDER APPROVING APPLICATION FOR CHANGE AND IMPOSING CONDITIONS**

This Summary Order is issued under authority of K.S.A. 82a-708b, as amended, and K.A.R. 5-5-1, *et seq.* and other applicable provisions of the *Kansas Water Appropriation Law, K.S.A. 82a-701 et seq.*, and rules and regulations promulgated thereunder, With the exception of those conditions expressly contained herein, this Summary Order does not change the terms, conditions and limitations of File No. 49635

1. A change application was received on July 30, 2021 requesting that the place of use and / or point of diversion authorized under the above-referenced file number be changed as described in the application.
2. On and after the effective date of this summary order, the authorized place(s) of use shall be located substantially as shown on the topographic map accompanying the application to change the place of use.  Applicable  Not Applicable
3. The change in point of diversion shall not impair existing rights and shall be limited to the same source or sources of water as previously authorized. The point of diversion authorized by this summary order shall be located within a 50 foot radius of the authorized point(s) of diversion.  Applicable  Not Applicable
4. The point(s) of diversion described herein is administratively corrected to be more accurately described using the Global Positioning System (GPS), as described in the application.  Applicable  Not Applicable
5. The point(s) of diversion authorized herein shall not actually be located more than 212 feet from the previously authorized point(s) of diversion.  Applicable  Not Applicable
6. As required by K.A.R. 5-3-5d, if the works for diversion is a well with a diversion rate of 100 gallons per minute or more, a tube or other device suitable for making water level measurements shall be installed, operated and maintained in accordance with K.A.R. 5-6-13.  Applicable  Not Applicable
7. The owner of the authorized place(s) of use shall properly install an acceptable water flow meter on or before **December 31, 2021**, or before the first use of water, whichever occurs first. The water flow meter shall be installed, operated and maintained in accordance with K.A.R. 5-1-4 through 5-1-12. As required by K.S.A. 82a-732, as amended, and K.A.R. 5-3-5e, the owner shall maintain records and report the reading of the water flow meter and the total quantity of water diverted annually to the Chief Engineer by March 1 following the end of each calendar year.  Applicable  Not Applicable
8. Installation of the works for diversion of water shall be completed on or before **December 31, 2021**, or within any authorized extension of time. By March 1, 2022 the applicant shall notify the Chief Engineer that construction of the works for diversion has been completed, on the form provided by the Chief Engineer, as required by K.A.R. 5-8-4e.  Applicable  Not Applicable
9. The completed well log shall be submitted with the required notice.  Applicable  Not Applicable
10. All diversion works into which any type of chemical or other foreign substance will be injected into the water shall be equipped with an in-line, automatic, quick-closing check valve capable of preventing pollution of the source of the water supply. The check valve(s) shall be installed, operated and maintained in accordance with K.A.R. 5-3-5c.  Applicable  Not Applicable
11. Additional Conditions are attached.  Yes  No
12. In accordance with K.S.A. 82a-708a, as amended, and K.A.R. 5-5-14, all of the owners of the authorized place(s) of use of water appropriated under the above-referenced file number are responsible for compliance with its terms, conditions and limitations, as amended and/or supplemented by this Summary Order, and with applicable provisions of the *Kansas Water Appropriation Law* and the *Rules and Regulations* promulgated thereunder. Failure to comply with these provisions may result in civil penalties pursuant to K.S.A. 82a-737, as amended, and/or the suspension or revocation and dismissal of the water or appropriation right or any other enforcement actions authorized by law.

**Administrative Appeal and Effective Date of Order**

If you are aggrieved by this order, pursuant to K.S.A. 82a-1901, you may request an evidentiary hearing before the Chief Engineer or request administrative review by the Secretary of Agriculture. A request for hearing by the Chief Engineer must be filed within **15 days** of service of this Order and a request for administrative review by the Secretary must be filed within **30 days** pursuant to K.S.A. 77-531. Any request for administrative review must state a basis for review pursuant to K.S.A. 77-527. File any request with **Kansas Department of Agriculture, Legal Division, 1320 Research Park Drive, Manhattan, KS 66502**. Failure to timely request a hearing or review may preclude review under the Kansas Judicial Review Act.

*For Use by Register of Deeds*

FOR OFFICE USE ONLY  
**APPLICATION APPROVED AND  
SUMMARY ORDER ISSUED**

By: Cameron R. Conant  
Duly Authorized Designee of the Chief Engineer  
(Print Name): Cameron R. Conant  
Division of Water Resources - Kansas Department of Agriculture  
Date of Issuance: August 3, 2021  
State of Kansas )  
County of Stafford ) SS  
Acknowledged before me on 8/3/2021  
by Faith Curtis  
Signature: Faith C  
Notary Public

My commission expires: \_\_\_\_\_ (Notary Seal)

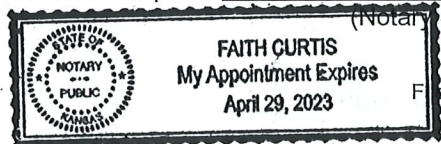

RECEIVED  
**JUL 30 2021**

14. If the proposed groundwater point of diversion is 300 or fewer feet from the existing point of diversion, complete the following:
- (a) Does the undersigned represent all owners of the currently authorized place(s) of use identified in this application?  
 Yes     No    (If no, all owners must sign this application.)
  - (b) Will the ownership interest of any owner of the currently authorized place(s) of use identified in this application be adversely affected if this application is approved as requested?  
 Yes     No    (If yes, all owners must sign this application.)
  - (c) If this application is not approved expeditiously, will there be substantial damage to property, public health or safety?  
 Yes     No    (If no, all owners must sign this application.)

If the application proposes a surface water change in point of diversion, a groundwater change in point of diversion greater than 300 feet, or a change in place of use, the application must be signed by all owners of the currently authorized place of use, or their duly authorized agent (attach notarized statement authorizing representation).

I hereby verify, being first duly sworn upon my oath or affirmation and under penalty of perjury, that I am of lawful age and the owner, the spouse of the owner, or a duly authorized agent of the owner(s) to make this application on their behalf, in regards to the water right(s) to which this application pertains. I further verify that the statements contained in this application are true, correct and complete.

Dated at Oxford, Kansas 101 N. Sumner, Kansas, this 28<sup>th</sup> day of July, 20 21.

Glenda M. Totten  
(Owner)

\_\_\_\_\_  
(Spouse)

Glenda M. Totten  
(Please Print)

\_\_\_\_\_  
(Please Print)

Ricky D. Totten  
(Owner)

Kaffy Totten  
(Spouse)

Ricky D. Totten  
(Please Print)

Kaffy Totten  
(Please Print)

\_\_\_\_\_  
(Owner)

\_\_\_\_\_  
(Spouse)

\_\_\_\_\_  
(Please Print)

\_\_\_\_\_  
(Please Print)

State of Kansas }  
County of Sumner } SS



I hereby certify that the foregoing application was signed in my presence and sworn to before me this 28<sup>th</sup> day of July, 20 21.

Edie Marsh  
Notary Public

My Commission Expires 10/22/2021

**ONLY COMPLETE APPLICATIONS WILL BE PROCESSED.** To be complete, all of the applicable portions of the application form must be completed with accurate information; maps, if necessary, must be included; signatures of all the appropriate owners' must be affixed to the application and notarized; and the appropriate fee must be paid.

**FEE SCHEDULE**

Each application to change the place of use or the point of diversion under this section shall be accompanied by the application fee set forth in the schedule below: Make checks payable to: **Kansas Department of Agriculture**

- (1) Application to change a point of diversion 300 feet or less ..... \$100
- (2) Application to change a point of diversion more than 300 feet ..... \$200
- (3) Application to change the place of use ..... \$200

RECEIVED

JUL 30 2021

Stafford Field Office  
DIVISION OF WATER RESOURCES

File No. 49635

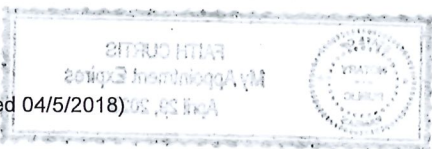

Stafford Field Office  
300 S. Main Street  
Stafford, KS 67578-1521



Phone: 620-234-5311  
Fax: 620-234-6900  
www.agriculture.ks.gov

Mike Beam, Secretary

Laura Kelly, Governor

August 3, 2021

Rick Totten  
1724 E 20<sup>th</sup> St S  
Oxford, KS 67119

Re: Water Right, File No(s). 49635

Dear Water Right Owner:

Enclosed is the order executed by the Chief Engineer, Division of Water Resources, Kansas Department of Agriculture, approving the application for change under the above referenced file number(s).

Your attention is directed to the enclosures and to the terms, conditions and limitations specified in this approval for change. An acceptable water flow meter must be installed on your well before any water is applied as authorized under this change approval. A copy of the approved list of Certified Water Flowmeters as well as the regulations regarding the installation of flowmeters, measurement tubes and check valves can be found at [www.ksda.gov/includes/document\\_center/dwr/Forms/ApprovalPack.pdf](http://www.ksda.gov/includes/document_center/dwr/Forms/ApprovalPack.pdf). If you do not have access to the internet, please contact this office and we will send you a paper copy of the referenced information.

Since this order modifies the original document referred to above, it should be recorded with the Register of Deeds as other instruments affecting real estate.

Any abandoned well must be plugged in accordance with the requirements of Article 30 of the Rules and Regulations as adopted by the Kansas Department of Health and Environment.

Should you have any questions, please feel free to contact this office. If you wish to refer to a specific file, please reference it when you contact us.

Sincerely,

A handwritten signature in black ink, appearing to read "Jeff Lanterman".

Jeff Lanterman  
Water Commissioner

Enclosures

pc: Water Rights Section  
Groundwater Management District No.2

## CERTIFICATE OF SERVICE

On this **3 August 2021**, I hereby certify that the attached Change in Point of Diversion, File No. 49635 dated 8/3/2021 was mailed to the following:

Rick Totten  
1724 E 20<sup>th</sup> St S  
Oxford, KS 67119

pc: Water Rights Section  
GMD #2

A handwritten signature in blue ink, appearing to read "Faith C.", is written above a horizontal dashed line.

Staff