

# NOTICE

This scan only represents the application as filed. The information contained herein meets the requirements of K.A.R. 5-3-1 or K.A.R. 5-5-1, and has been found acceptable for filing in the office of the Chief Engineer. The application should not be considered to be a complete application as per K.A.R. 5-3-1b or K.A.R. 5-5-2a.

THE STATE OF KANSAS



KANSAS DEPARTMENT OF AGRICULTURE
Mike Beam, Secretary of Agriculture

DIVISION OF WATER RESOURCES
Earl D. Lewis Jr., Chief Engineer

File Number 50696
This item to be completed by the Division of Water Resources.

WATER RESOURCES RECEIVED

APPLICATION FOR PERMIT TO APPROPRIATE WATER FOR BENEFICIAL USE

Filing Fee Must Accompany the Application
(Please refer to Fee Schedule attached to this application form.)

DEC 27 2021 1:12

KS DEPT OF AGRICULTURE

To the Chief Engineer of the Division of Water Resources, Kansas Department of Agriculture, 1320 Research Park Drive, Manhattan, Kansas 66502:

1. Name of Applicant (Please Print): CITY OF LEON
Address: 111 SOUTH MAIN STREET
City: LEON State KANSAS Zip Code 67074
Telephone Number: (316) 742-3438

2. The source of water is: [ ] surface water in (stream)
OR [X] groundwater in WALNUT RIVER (drainage basin)

Certain streams in Kansas have minimum target flows established by law or may be subject to administration when water is released from storage for use by water assurance district members. If your application is subject to these regulations on the date we receive your application, you will be sent the appropriate form to complete and return to the Division of Water Resources.

3. The maximum quantity of water desired is acre-feet OR 18,000,000 gallons per calendar year, to be diverted at a maximum rate of 100 gallons per minute OR cubic feet per second.

Once your application has been assigned a priority, the requested maximum rate of diversion and maximum requested quantity of water under that priority number can NOT be increased. Please be certain your requested maximum rate of diversion and maximum quantity of water are appropriate and reasonable for your proposed project and are in agreement with the Division of Water Resources' requirements.

4. The water is intended to be appropriated for (Check use intended):
(a) [ ] Artificial Recharge (b) [ ] Irrigation (c) [ ] Recreational (d) [ ] Water Power
(e) [ ] Industrial (f) [X] Municipal (g) [ ] Stockwatering (h) [ ] Sediment Control
(i) [ ] Domestic (j) [ ] Dewatering (k) [ ] Hydraulic Dredging (l) [ ] Fire Protection
(m) [ ] Thermal Exchange (n) [ ] Contamination Remediation

YOU MUST COMPLETE AND ATTACH ADDITIONAL DIVISION OF WATER RESOURCES FORM(S) PROVIDING INFORMATION TO SUBSTANTIATE YOUR REQUEST FOR THE AMOUNT OF WATER FOR THE INTENDED USE REFERENCED ABOVE.

For Office Use Only:
F.O. 2 GMD Meets K.A.R. 5-3-1 (YES/NO) Use MUN Source G/S County BU By BMM Date 12/28/21
Code REG Fee \$ 200 TR # Receipt Date 12-27-21 Check # 18172

1/5/2022
LMoody

5. The location of the proposed wells, pump sites or other works for diversion of water is:

**Note:** For the application to be accepted, the point of diversion location must be described to at least a 10 acre tract, unless you specifically request a 60 day period of time in which to locate the site within a specifically described, minimal legal quarter section of land.

- (A) One in the NORTHWEST quarter of the SOUTHEAST quarter of the NORTHWEST quarter of Section 22, more particularly described as being near a point 3551 feet North and 3763 feet West of the Southeast corner of said section, in Township 27 South, Range 6 EAST, BUTLER County, Kansas.
- (B) One in the \_\_\_\_\_ quarter of the \_\_\_\_\_ quarter of the \_\_\_\_\_ quarter of Section \_\_\_\_\_, more particularly described as being near a point \_\_\_\_\_ feet North and \_\_\_\_\_ feet West of the Southeast corner of said section, in Township \_\_\_\_\_ South, Range \_\_\_\_\_ East/West (circle one), \_\_\_\_\_ County, Kansas.
- (C) One in the \_\_\_\_\_ quarter of the \_\_\_\_\_ quarter of the \_\_\_\_\_ quarter of Section \_\_\_\_\_, more particularly described as being near a point \_\_\_\_\_ feet North and \_\_\_\_\_ feet West of the Southeast corner of said section, in Township \_\_\_\_\_ South, Range \_\_\_\_\_ East/West (circle one), \_\_\_\_\_ County, Kansas.
- (D) One in the \_\_\_\_\_ quarter of the \_\_\_\_\_ quarter of the \_\_\_\_\_ quarter of Section \_\_\_\_\_, more particularly described as being near a point \_\_\_\_\_ feet North and \_\_\_\_\_ feet West of the Southeast corner of said section, in Township \_\_\_\_\_ South, Range \_\_\_\_\_ East/West (circle one), \_\_\_\_\_ County, Kansas.

If the source of supply is groundwater, a separate application shall be filed for each proposed well or battery of wells, except that a single application may include up to four wells within a circle with a quarter (¼) mile radius in the same local source of supply which do not exceed a maximum diversion rate of 20 gallons per minute per well.

A battery of wells is defined as two or more wells connected to a common pump by a manifold; or not more than four wells in the same local source of supply within a 300 foot radius circle which are being operated by pumps not to exceed a total maximum diversion rate of 800 gallons per minute and which supply water to a common distribution system.

6. The owner of the point of diversion, if other than the applicant is (please print):

Robert J. Patterson Family Trust - 4136 SE Highway 400 - Leon, Kansas 67074  
(name, address and telephone number)

You must provide evidence of legal access to, or control of, the point of diversion from the landowner or the landowner's authorized representative. Provide a copy of a recorded deed, lease, easement or other document with this application. In lieu thereof, you may sign the following sworn statement:

I have legal access to, or control of, the point of diversion described in this application from the landowner or the landowner's authorized representative. I declare under penalty of perjury that the foregoing is true and correct.

Executed on December 22, 2021.

Kristina Semisch  
Applicant's Signature

The applicant must provide the required information or signature irrespective of whether they are the landowner. Failure to complete this portion of the application will cause it to be unacceptable for filing and the application will be returned to the applicant.

7. The proposed project for diversion of water will consist of one (1) existing public water supply well  
(number of wells, pumps or dams, etc.)  
and was completed (by) October 19, 1980  
(Month/Day/Year - each was or will be completed)
8. The first actual application of water for the proposed beneficial use was or is estimated to be 08/27/1981  
(Mo/Day/Year)

WATER RESOURCES  
DIVISION  
DEC 27 2021  
KS DEPT OF AGRICULTURE

9. Will pesticide, fertilizer, or other foreign substance be injected into the water pumped from the diversion works?  
 Yes  No If "yes", a check valve shall be required.

All chemigation safety requirements must be met including a chemigation permit and reporting requirements.

10. If you are planning to impound water, please contact the Division of Water Resources for assistance, prior to submitting the application. Please attach a reservoir area capacity table and inform us of the total acres of surface drainage area above the reservoir.

Have you also made an application for a permit for construction of this dam and reservoir with the Division of Water Resources?  Yes  No

- If yes, show the Water Structures permit number here \_\_\_\_\_
- If no, explain here why a Water Structures permit is not required \_\_\_\_\_  
No water structure or reservoir is required for this project.

11. The application must be supplemented by a U.S.G.S. topographic map, aerial photograph or a detailed plat showing the following information. On the topographic map, aerial photograph, or plat, identify the center of the section, the section lines or the section corners and show the appropriate section, township and range numbers. Also, please show the following information:

- (a) The location of the proposed point(s) of diversion (wells, stream-bank installations, dams, or other diversion works) should be plotted as described in Paragraph No. 5 of the application, showing the North-South distance and the East-West distance from a section line or southeast corner of section.
- (b) If the application is for groundwater, please show the location of any existing water wells of any kind within ½ mile of the proposed well or wells. Identify each existing well as to its use and furnish the name and mailing address of the property owner or owners. If there are no wells within ½ mile, please advise us.
- (c) If the application is for surface water, the names and addresses of the landowner(s) ½ mile downstream and ½ mile upstream from your property lines must be shown.
- (d) The location of the proposed place of use should be shown by crosshatching on the topographic map, aerial photograph or plat.
- (e) Show the location of the pipelines, canals, reservoirs or other facilities for conveying water from the point of diversion to the place of use.

A 7.5 minute U.S.G.S. topographic map may be obtained by providing the section, township and range numbers to: Kansas Geological Survey, 1930 Constant, Campus West, University of Kansas, Lawrence, Kansas 66047.

12. List any application, appropriation of water, water right, or vested right file number that covers the same diversion points or any of the same place of use described in this application. Also list any other recent modifications made to existing permits or water rights in conjunction with the filing of this application.

File No. 34,692 (Point of Diversion and Place of Use)

File Nos. BU 006 and 46998 (Place of Use)

No additional Quantity: Proposed quantity of water to be limited to 36.2 million gallons of water per year,

when combined with prior rights.

WATER RESOURCES  
RECEIVED

DEC 27 2021

KANSAS DEPT. OF AGRICULTURE

13. Furnish the following well information if the proposed appropriation is for the use of groundwater. If the well has not been completed, give information obtained from test holes, if available.

Information below is from:  Test holes  Well as completed  Drillers log attached

Well location as shown in paragraph No.	(A)	(B)	(C)	(D)
Date Drilled	_____	_____	_____	_____
Total depth of well	_____	_____	_____	_____
Depth to water bearing formation	_____	_____	_____	_____
Depth to static water level	_____	_____	_____	_____
Depth to bottom of pump intake pipe	_____	_____	_____	_____

14. The relationship of the applicant to the proposed place where the water will be used is that of Owner  
(owner, tenant, agent or otherwise)

15. The owner(s) of the property where the water is used, if other than the applicant, is (please print):

City of Leon - 111 S. Main St. - Leon, Kansas 67079  
(name, address and telephone number)

\_\_\_\_\_  
(name, address and telephone number)

16. The undersigned states that the information set forth above is true to the best of his/her knowledge and that this application is submitted in good faith.

Dated at Leon, Kansas, this \_\_\_\_\_ day of December, 2021.  
(month) (year)

Kristina Semisch

(Applicant Signature)

By \_\_\_\_\_  
(Agent or Officer Signature)

\_\_\_\_\_  
(Agent or Officer - Please Print)

Assisted by Kenneth A. Kopp, P.G. Kansas Rural Water Assn. Date: December 21, 2021  
(office/title)

WATER RESOURCES RECEIVED

DEC 27 2021

KANSAS DEPT. OF AGRICULTURE

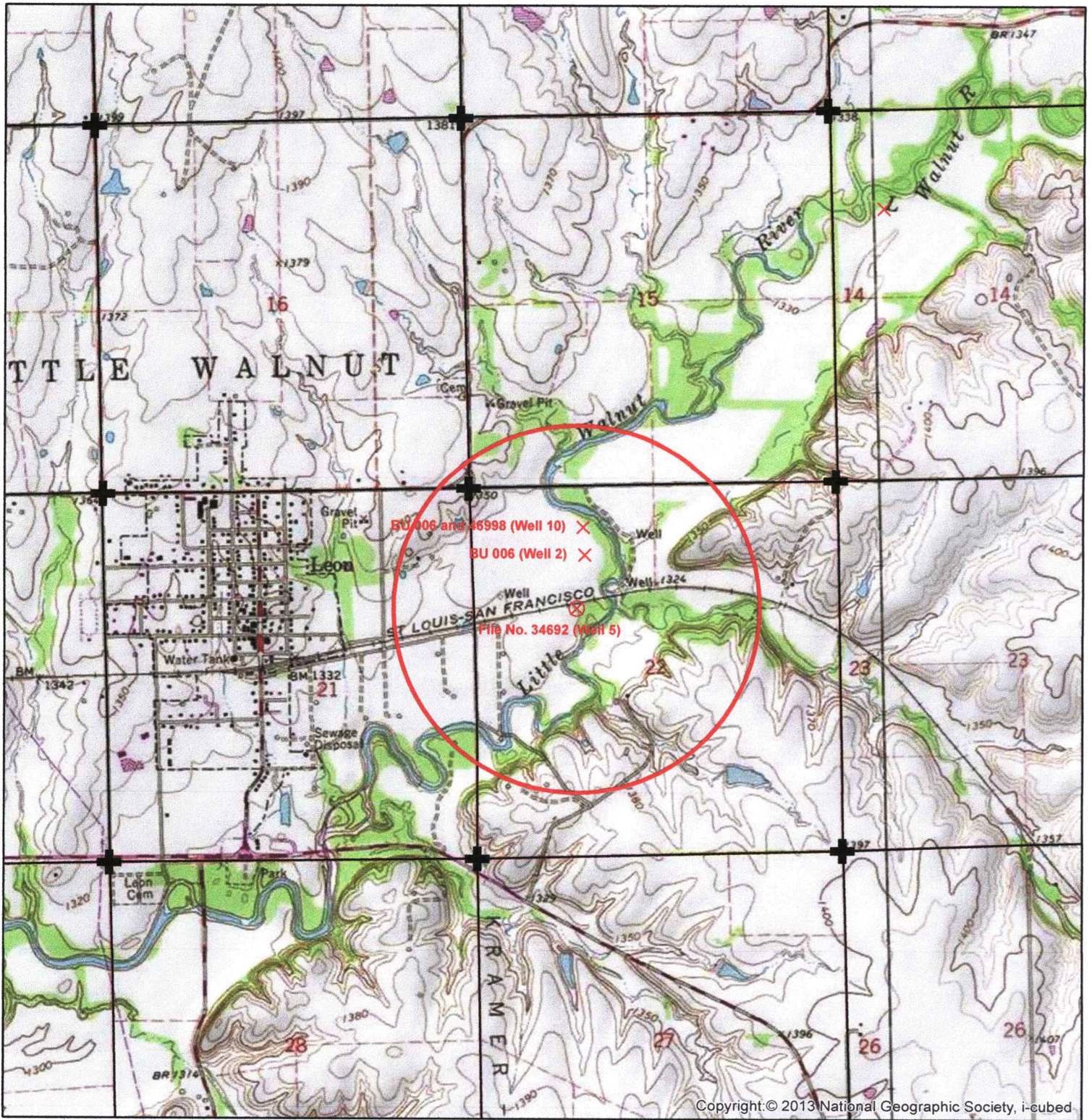

Copyright © 2013 National Geographic Society, i-cubed

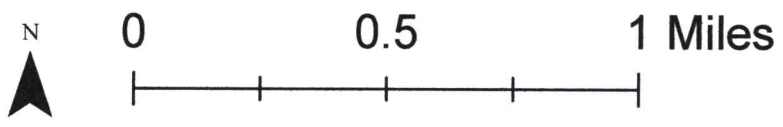

**Legend**

- ⊗ Requested Well
- × Other Authorized Wells
- ⊕ Section Corners
- 2640' Buffer

# City of Leon, Kansas: New Application

Locations of currently authorized wells.

RESOURCES RECEIVED  
 DEC 27 2021  
 DEPT OF AGRICULTURE



**SECTION 3: PROJECTED FUTURE WATER NEEDS**

PLEASE COMPLETE THE FOLLOWING TABLE SHOWING YOUR FUTURE WATER REQUIREMENTS FOR THE NEXT 20 YEARS:

	Column 1 Raw Water Diverted Under Your Rights	Column 2 Water Purchased From All Sources	Column 3 Water Sold to Other Public Water Suppliers	Column 4 Water Sold to Your Industrial, Stock, and Bulk Customers	Column 5 Water Sold to Your Residential and Commercial Customers	Column 6 Other Metered Water	Column 7 Remaining Water Used (See Explanation on other side)
Year 5	25.0 MGY	10.0 MGY	0	0	27.0 MGY	1.0 MGY	7.0 MGY
Year 10	25.0 MGY	10.0 MGY	0	0	27.0 MGY	1.0 MGY	7.0 MGY
Year 15	25.0 MGY	10.0 MGY	0	0	27.0 MGY	1.0 MGY	7.0 MGY
Year 20	25.0 MGY	10.0 MGY	0	0	27.0 MGY	1.0 MGY	7.0 MGY
<b>TOTAL WATER = Columns 1 + 2</b>			<b>ACCOUNTED FOR WATER = Columns 3 + 4 + 5 + 6</b>			<b>UNACCOUNTED FOR WATER</b>	

**SECTION 4: POPULATION AND SERVICE CONNECTIONS**

ESTIMATE THE NUMBER OF PERSONS DIRECTLY SERVED BY YOUR WATER DISTRIBUTION SYSTEM

PAST POPULATION - PROVIDE INFORMATION BELOW:  
(CENSUS BUREAU INFORMATION)

LAST 20 YEARS	POPULATION
20 years ago	817
15 years ago	722
10 years ago	640
5 years ago	704
Last Year	704

PROJECTED FUTURE POPULATION

ESTIMATE FUTURE POPULATION AND SUBSTANTIATE NUMBERS ON SEPARATE ATTACHMENTS

NEXT 20 YEARS	POPULATION
Year 5	705
Year 10	705
Year 15	705
Year 20	705

DEC 27 2022

Provide number of current active service connections:

260 Residential                      0 Industrial                      0 Other (specify) \_\_\_\_\_  
32 Commercial                      0 Pasture/ Stockwater/ Feedlot                      292 Total

**SECTION 5: PRESENT GALLONS PER PERSON PER DAY**

CALCULATE YOUR GALLONS PER PERSON PER DAY

Water in Columns 5, 6, and 7 + Population + 365 Days/Year = Gallons per Person per Day

18312                      ÷ 704                      ÷ 365 Days/Year = 50.17 GALLONS PER PERSON PER DAY.  
Amount of water in Columns 5, 6, and 7 of Section 1                      Population from Last Year of Section 4

**SECTION 6: AREA TO BE SERVED**

Describe the area to be served or provide the legal description of the location where the water is to be used including any other city of water supply system (i.e. Rural Water District): City of Leon, Kanas, and immediate vicinity.

You may attach additional information you believe will assist in informing the Division of the need for your request.



USE TYPEWRITER OR BALL POINT PEN-PRESS FIRMLY, PRINT CLEARLY.

WATER WELL RECORD  
KSA 82a-1201-1215

WATER WELL RECORD

DEC 27 2021

Kansas Department of Health and Environment-Division of Environment (Water well Contractors) Topeka, Kansas 66620

1. Location of well:		County <b>Butler</b>	Fraction <b>SW 1/4 SE 1/4 NW 1/4</b>	Section number <b>22</b>	Township number <b>T 27</b>	Range number <b>S R 6 E/W</b>
2. Distance and direction from nearest town or city: <b>East in Leon</b> <b>1 mile next to RR track</b> Street address of well location if in city:				3. Owner of well: <b>City of Leon TEST #5</b> R.R. or street: City, state, zip code: <b>Leon, Kansas 67074</b>		
4. Locate with "X" in section below:		Sketch map:		Bore hole dia. <b>2 1/2</b> in. Completion date _____ Well depth <b>100</b> ft. <b>10-19-80</b>		
				7. <input checked="" type="checkbox"/> Cable tool <input type="checkbox"/> Rotary <input type="checkbox"/> Driven <input type="checkbox"/> Dug <input type="checkbox"/> Hollow rod <input type="checkbox"/> Jetted <input type="checkbox"/> Bored <input type="checkbox"/> Reverse rotary		
5. Type and color of material		From	To	8. Use: <input type="checkbox"/> Domestic <input checked="" type="checkbox"/> Public supply <input type="checkbox"/> Industry <input type="checkbox"/> Irrigation <input type="checkbox"/> Air conditioning <input type="checkbox"/> Stock <input type="checkbox"/> Lawn <input type="checkbox"/> Oil field water <input type="checkbox"/> Other		
Soil and clay		0	18	9. Casing: Material <b>steel</b> Height: Above or below _____ Threaded _____ Welded _____ Surface _____ in. RMP _____ PVC _____ Weight _____ lbs./ft.		
Gravel (possible water)		18	23	10. Screen: Manufacturer's name <b>Abraham, Plummer, &amp; Brown</b> Type <b>Slots</b> Dia. <b>16"</b> Slot/gauze <b>1/2</b> Length <b>5</b> Set between <b>18</b> ft. and <b>25</b> ft. _____ ft. and _____ ft.		
Shale-green (possible water)		23	25	11. Static water level: _____ mo./day/yr. <b>25</b> ft. below land surface Date <b>10-18-80</b>		
Lime-white		25	28	12. Pumping level below land surfaces: <b>Comp. Draw</b> Dn. _____ ft. after _____ hrs. pumping _____ g.p.m. _____ ft. after _____ hrs. pumping _____ g.p.m. Estimated maximum yield <b>1200 gph</b> g.p.m.		
Shale-blue		28	33	13. Water sample submitted: _____ mo./day/yr. Yes <input type="checkbox"/> No <input checked="" type="checkbox"/> Date _____		
Lime-blue		33	37	14. Well head completion: <input type="checkbox"/> Pitless adapter _____ Inches above grade		
Shale-blue		37	48	15. Well grouted? <b>yes</b> With: <input checked="" type="checkbox"/> Neat cement <input type="checkbox"/> Bentonite <input type="checkbox"/> Concrete Depth: From <b>3</b> ft. to <b>18</b> ft.		
Shale-gray		48	57	16. Nearest source of possible contamination: ft. <b>1500</b> Direction <b>SW</b> Type <b>Tank battery</b> Well disinfected upon completion? <input checked="" type="checkbox"/> Yes <input type="checkbox"/> No		
Redbed (water on top of this)		57	71	17. Pump: <input checked="" type="checkbox"/> Not installed Manufacturer's name _____ Model number _____ HP _____ Volts _____ Length of drop pipe _____ ft. capacity _____ g.p.m. Type: <input type="checkbox"/> Submersible <input type="checkbox"/> Turbine <input type="checkbox"/> Jet <input type="checkbox"/> Reciprocating <input type="checkbox"/> Centrifugal <input type="checkbox"/> Other		
Shale-green & lime		71	79	18. Water well contractor's certification: This well was drilled under my jurisdiction and this report is true to the best of my knowledge and belief. <b>Abraham, Plummer, &amp; Brown 181A</b> Business name _____ License No. _____ Address <b>Leon, Kansas 67074</b> Signed <b>Jay Abraham</b> Date <b>11-9</b> Authorized representative		
Shale-gray		79	85	19. Remarks: <b>#9 section will determine the amount of casing</b>		
Shale-blue		85	100	20. Topography: <input type="checkbox"/> Hill <input type="checkbox"/> Slope <input type="checkbox"/> Upland <input checked="" type="checkbox"/> Valley		

Forward the white, blue and pink copies to the Department of Health and Environment

Form WWC-5

## FEE SCHEDULE

1. The fee for an application for a permit to appropriate water for beneficial use, except for domestic use, shall be (see paragraph No. 2 below if requesting storage):

ACRE-FEET	FEE
0-100	\$200.00
101-320	\$300.00
More than 320	\$300.00 plus \$20.00 for each additional 100 acre-feet or any part thereof.

2. The fee for an application in which storage is requested, except for domestic use, shall be:

ACRE-FEET	FEE
0-250	\$200.00
More than 250	\$200.00 plus \$20.00 for each additional 250 acre-feet of storage or any part thereof.

Note: If an application requests both direct use *and* storage, the fee charged shall be as determined under No. 1 or No. 2 above, whichever is greater, but not both fees.

3. The fee for an application for a permit to appropriate water for water power or dewatering purposes shall be \$100.00 plus \$200.00 for each 100 cubic feet per second, or part thereof, of the diversion rate requested.

Note: The applicant shall notify the Chief Engineer and pay the statutorily required field inspection fee of \$400.00 when construction of the works for diversion has been completed, except that for applications filed on or after July 1, 2009, for works constructed for sediment control use and for evaporation from a groundwater pit for industrial use shall be accompanied by a field inspection fee of \$200.00.

### MAKE CHECKS PAYABLE TO THE KANSAS DEPARTMENT OF AGRICULTURE

#### ATTENTION

A Water Conservation Plan may be required per K.S.A. 82a-733. A statement that your application for permit to appropriate water may be subject to the minimum desirable streamflow requirements per K.S.A. 82a-703a, b, and c may also be required from you. After the Division of Water Resources has had the opportunity to review your application, you will be notified whether or not you will need to submit a Water Conservation Plan. You also may be required to install a water flow meter or water stage measuring device on your diversion works prior to diverting water. There may be other special conditions or Groundwater Management District regulations that you will need to comply with if this application is approved.

#### CONVERSION FACTORS

1 acre-foot equals 325,851 gallons

1 million gallons equal 3.07 acre-feet

WATER DIVISION  
KANSAS

DEC 27 2021

DEPARTMENT OF AGRICULTURE

**Table 3: Gallons per capita per day by public water supplier – continued**

Public Water Supplier	DWR ID	EPA Water System Number	GPCD Region <sup>1</sup>	Source water RPA	Gallons per capita-day					Average (2013 – 17)	In Regional Average
					2013	2014	2015	2016	2017		
Lawrence	10239	KS2004503	8L	Ks	112	104	96	100	95	101	Y
Leavenworth	10277	KS2010317	8L	Mo	94	86	83	95	97	91	Y
Leavenworth Co. RWD #01	34178	KS2010316	8M	Mo	na	na	59	na	na	59	Y
Leavenworth Co. RWD #01C	15267	KS2010323	8M	Mo	57 <sup>2</sup>	41 <sup>2</sup>	37 <sup>2</sup>	44 <sup>2</sup>	76	51	Y
Leavenworth Co. RWD #02	34179	KS2010319	8M	Mo	116	103	103	na	115	109	Y
Leavenworth Co. RWD #05	34180	KS2010318	8M	Mo	82	80	70	70	70	74	Y
Leavenworth Co. RWD #06	33868	KS2010305	8M	Mo	76	73 <sup>2</sup>	73 <sup>2</sup>	83 <sup>2</sup>	68 <sup>2</sup>	75	Y
Leavenworth Co. RWD #07	33869	KS2010320	8M	Ks	71	66	64	68	70	68	Y
Leavenworth Co. RWD #08	34181	KS2010309	8M	Mo	76	73	na	66	71	71	Y
Leavenworth Co. RWD #09	15276	KS2010308	8M	Mo	80	70	75	76	69	74	Y
Leavenworth Co. RWD #10	34371	KS2010315	8M	Ks	68	na	na	88	91 <sup>2</sup>	82	Y
Lebanon	10279	KS2018304	6S	Sr	96	91	93 <sup>2</sup>	85 <sup>2</sup>	88 <sup>2</sup>	90	Y
Lebo	10280	KS2003104	7M	Mc	67	61	57	55	63	61	Y
Lecompton	10287	KS2004501	8M	Ks	55	50	51	49	71	55	Y
Lehigh	10317	KS2011506	7S	Ne	82	87	84	90	82	85	Y
Lenora	10379	KS2013705	4	Sr	193	176	176	182	164	178	Y
<b>Leon</b>	<b>10381</b>	<b>KS2001515</b>	<b>7M</b>	<b>Ew</b>	<b>114</b>	<b>107</b>	<b>98</b>	<b>61</b>	<b>80</b>	<b>92</b>	<b>Y</b>
Leonardville	10399	KS2016120	7S	Ks	74	69 <sup>2</sup>	71 <sup>2</sup>	86	85	77	Y
Leoti	10402	KS2020301	2	Us	249	196	167	151	149 <sup>2</sup>	182	Y
LeRoy	10405	KS2003109	7M	Ne	54	53	na	51	51	52	Y
Lewis	10437	KS2004702	5	Gb	132	120	116	120	155	129	Y
Liberal	10482	KS2017504	2	Ci	191	296	119	162	149	184	Y
Liebenthal	20452	KS2016508	5	Ss	72	79	75	75	65	73	Y
Lincoln Center	10543	KS2010501	6ML	Ss	96	101	94	86	92	94	Y
Lindsborg	10570	KS2011308	7M	Ss	100	97	97	92	101	98	Y
Linn	10585	KS2020104	7S	Ks	93	88	79	79	88	86	Y
Linn Co. RWD #01	33757	KS2010702	8M	Mc	96	82	88	86 <sup>2</sup>	88 <sup>2</sup>	88	Y
Linn Co. RWD #02	34376	KS2010707	8M	Mc	56	76	68	69	63	66	Y
Linn Co. RWD #03	33758	KS2010708	8M	Mc	107	147	85	88	77	101	Y
Linn Valley	65869	KS2010712	8M	Mc	na	na	na	na	45	45	Y

FINANCES  
DEC 27 2021  
STATE

Population of Cities in Kansas, 1900-2020

City	1900	1910	1920	1930	1940	1950	1960	1970	1980	1990	2000	2010	2020
Lafontaine <sup>1</sup>	-	-	-	-	-	-	-	-	-	-	-	-	58
La Harpe	-	2,080	1,001	756	624	511	529	509	687	650	706	578	480
Lake City <sup>1</sup>	-	-	-	-	-	-	-	-	-	-	-	-	47
Lake Quivira	-	-	-	-	-	-	-	-	1,087	983	932	906	1,014
Lakin	-	337	556	739	709	1,618	1,432	1,570	1,823	2,060	2,316	2,216	2,205
Lancaster	-	220	184	188	163	200	196	279	274	299	291	298	246
Lane	-	272	351	291	234	200	282	254	249	247	256	225	241
Langdon	-	-	204	181	208	128	97	93	84	62	72	42	39
Lansing	-	-	-	-	-	-	1,264	3,797	5,307	7,120	9,199	11,265	11,239
Larned	-	2,911	3,139	3,532	3,533	4,447	5,001	4,567	4,811	4,490	4,236	4,054	3,769
Latham	-	-	334	291	307	218	203	156	148	160	164	139	96
Latimer	-	-	-	124	84	34	40	29	31	20	21	20	31
Lawrence	10,862	12,374	12,456	13,726	14,390	23,351	32,858	45,698	52,738	65,608	80,098	87,643	94,934
Leavenworth	20,735	19,363	16,912	17,466	19,220	20,579	22,052	25,147	33,656	38,495	35,420	35,251	37,351
Leawood	-	-	-	-	-	1,167	7,466	10,645	13,360	19,693	27,656	31,867	33,902
Lebanon	-	731	822	723	652	610	583	517	440	364	303	218	178
Lebo	-	560	572	590	522	575	498	589	966	835	961	940	885
Lecompton	-	386	310	288	250	263	304	434	576	619	608	625	588
Lehigh	-	385	370	315	296	240	178	168	189	180	215	175	161
Lenexa	-	383	472	452	502	803	2,487	5,549	18,639	34,110	40,238	48,190	57,434
Lenora	-	454	520	519	537	511	512	439	444	329	306	250	207
Leon	-	494	427	587	573	518	541	510	667	707	645	704	669
Leona	-	-	-	-	164	130	110	72	73	39	88	48	41
Leonardville	-	376	325	392	342	320	378	412	437	374	398	449	432
Leoti	-	288	392	618	816	1,250	1,401	1,916	1,869	1,738	1,598	1,534	1,475
LeRoy	-	861	815	788	751	695	601	551	701	568	593	561	451
Levant <sup>1</sup>	-	-	-	-	-	-	-	-	-	-	-	61	68
Lewis	-	557	439	512	481	475	486	525	551	451	486	451	400
Liberal	426	1,716	3,613	5,294	4,410	7,134	13,813	13,862	14,911	16,573	19,666	20,525	19,825
Liberty	-	385	247	246	254	185	233	185	174	140	95	123	99
Liebenthal	-	-	-	-	265	211	191	169	163	112	111	103	92
Lincoln Center	-	1,508	1,613	1,732	1,761	1,636	1,717	1,582	1,599	1,381	1,349	1,297	1,171
Lincolnvill	-	-	260	270	255	228	244	218	235	197	225	203	168
Lindsborg	-	1,939	1,897	2,016	1,913	2,383	2,609	2,764	3,155	3,077	3,321	3,458	3,776
Linn	-	-	282	340	395	395	466	388	483	472	425	410	387
Linn Valley	-	-	-	-	-	-	-	-	-	-	562	804	956
Linwood	-	323	364	295	299	261	375	323	343	409	374	375	415
Little River	-	661	749	618	603	635	552	493	529	496	536	557	472
Logan	-	714	585	743	703	859	846	760	720	633	603	589	460
Lone Elm	-	-	-	131	97	82	69	66	55	32	27	25	27

1207  
 2021  
 1207

**DATA ENTRY SYSTEM ID NUMBER SHEET**

**FILE NUMBER** 50696

<b>APPLICANT PERSON ID &amp; SEQ #</b>	<b>51869</b>	<b>PDIV ID</b>	<b>BATTERY ID</b>
<u>10381</u>			

<b>LANDOWNER PERSON ID &amp; SEQ #</b>	<b>30191</b>	<b>PUSE ID</b>
<u>10381</u>		

<b>WATER USE CORRESPONDENT PERSON ID &amp; SEQ #</b>
<u>10381</u>