

Submit completed application to:
 Kansas Department of Agriculture
 Division of Water Resources
 Field Office for your area.

Call for address:

Topeka -- (785) 296-5733
 Stafford -- (620) 234-5311
 Stockton -- (785) 425-6787
 Garden City -- (620) 276-2901
<http://agriculture.ks.gov/dwr>

DWR FIELD OFFICE APPLICATION FOR APPROVAL TO CHANGE THE PLACE OF USE AND/OR THE POINT OF DIVERSION



STATE OF KANSAS

WATER METER REQUIRED

Filing Fee Must Accompany the Application, K.S.A. 82a-708b(b), as amended.
 Fee Schedule is on the third page of this application form.

Paragraph Nos. 1, 2, 3 & 5 must be completed. Complete all other applicable portions. If change in point of diversion is greater than 100 feet, or if place of use will be changed, include a topographic map or detailed plat showing the authorized and proposed point(s) of diversion and/or place of use.

RECEIVED
 11:30am
 OCT 04 2022

File No. 15314

Stafford Field Office
 Division of Water Resources

1. Application is hereby made for approval of the Chief Engineer to change the (check one or both):

Place of Use Point of Diversion

under the water right which is the subject of this application in accordance with the conditions described below.

The source of supply is: Groundwater Surface water

2. Name and address of Applicant: Lee Anne Williams

722 West 12th Street, Larned, KS 67550

Phone Number: (620)285-1142

Email address: leew1953@yahoo.com

Name and address of Water Use Correspondent: Bryan L & Shannon Fischer

1649 L RD, Larned, KS 67550-5313

Phone Number: ()

Email address: _____

3. The presently authorized place of use is:

Owner of Land ---- NAME: * see supplemental page 1b (5 owners)

**see supplemental page 1b (1 owner)

ADDRESS: * see supplemental page 1b (5 owners)

**see supplemental page 1b (1 owner)

(If there is more than one landowner, attach supplemental sheets as necessary.)

Sec.	Twp.	Range	NE¼				NW¼				SW¼				SE¼				TOTAL ACRES
			NE¼	NW¼	SW¼	SE¼	NE¼	NW¼	SW¼	SE¼	NE¼	NW¼	SW¼	SE¼	NE¼	NW¼	SW¼	SE¼	
*10	22S	18W									40	40	40	40					160
**10	22S	18W															40	40	80

4. If this application is for a change in place of use, it is proposed that the place of use be changed to:

Owner of Land ---- NAME: NO CHANGES

ADDRESS: NO CHANGES

(If there is more than one landowner, attach supplemental sheets as necessary.)

Sec.	Twp.	Range	NE¼				NW¼				SW¼				SE¼				TOTAL ACRES
			NE¼	NW¼	SW¼	SE¼	NE¼	NW¼	SW¼	SE¼	NE¼	NW¼	SW¼	SE¼	NE¼	NW¼	SW¼	SE¼	

For Office Use Only: Code CGT Fee \$ 200- TR # _____ Receipt Date _____ Check # 4923

5. **Presently authorized point of diversion:**
 One in the SW Quarter of the SW Quarter of the SW Quarter of Section 10, Township 22 South, Range 18 (W), in Pawnee County, Kansas, 60 feet North 4770 feet West of Southeast corner of section.
 Authorized Rate 735 GPM Authorized Quantity 148.5 acre-feet Depth of well -- (feet)
(DWR use only: Computer ID No. 3 (pdiv id # 49975) GPS 55 feet North 4830 feet West)
 This point will not be changed This point will be changed as follows: No change, point better described with GPS as follows:
Proposed point of diversion: (Complete only if change is requested or if existing point is better described by GPS)
 One in the SW Quarter of the SW Quarter of the SW Quarter of Section 10, Township 22 South, Range 18 (W), in Pawnee County, Kansas, 55 feet North 4830 feet West of Southeast corner of section.
 Proposed Rate no change Proposed Quantity 118 acre feet Proposed well depth (feet) no change
 This point is: Additional Well Geo Center List other water rights that will use this point none

6. **Presently authorized point of diversion:**
 One in the NW Quarter of the NW Quarter of the SW Quarter of Section 10, Township 22 South, Range 18 (W), in Pawnee County, Kansas, 2550 feet North 5140 feet West of Southeast corner of section.
 Authorized Rate 735 GPM (limited) Authorized Quantity 145.5 acre-feet Depth of well -- (feet)
(DWR use only: Computer ID No. 6 (pdiv id # 55018) GPS 2633 feet North 5223 feet West)
 This point will not be changed This point will be changed as follows: No change, point better described with GPS as follows:
Proposed point of diversion: (Complete only if change is requested or if existing point is better described by GPS)
 One in the NW Quarter of the NW Quarter of the SW Quarter of Section 10, Township 22 South, Range 18 (W), in Pawnee County, Kansas, 2633 feet North 5223 feet West of Southeast corner of section.
 Proposed Rate no change Proposed Quantity 176 Proposed well depth (feet) no change
 This point is: Additional Well Geo Center List other water rights that will use this point PN-065

7. The changes herein are desired for the following reasons?
 (please be specific) We are shifting quantity between wells to facilitate an "even" division of the water rights from an authorized acre foot per acre standpoint in the near future.

8. If a well, is the test hole log attached? Yes No

9. The change(s) (was)(will be) completed by?
n/a-paper change

10. If the point of diversion is a well:
 (a) What are you going to do with the old well?
n/a-paper change
 (b) When will this be done? --

11. Groundwater Management District recommendation attached?
 Yes No

12. Assisted by CRC-SFFO

13a. If the proposed point of diversion will be relocated more than 300 feet but within 2,640 feet of the existing point of diversion, attach a topographic map or aerial photograph. For groundwater sources, show all wells (including domestic) within one-half mile of the proposed point of diversion and the names and mailing addresses of the owners. For surface water sources, show the names and addresses of the landowner(s) one-half mile downstream and one-half mile upstream from your property lines

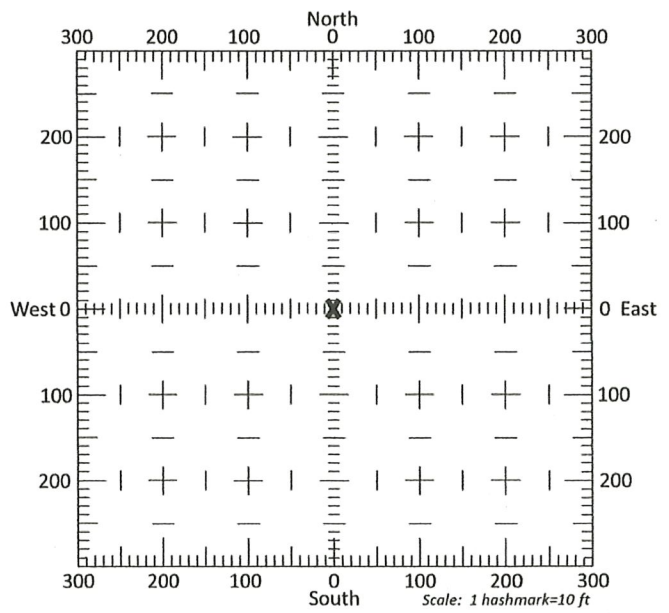

13b. If the proposed point of diversion will be relocated within 300 feet of the existing point of diversion, indicate its location on the diagram shown above in relation to the existing point of diversion. **(PLEASE NOTE: The "X" in center of diagram above represents the presently authorized point of diversion.)**

OCT 04 2022

Stafford Field Office
 Division of Water Resources

14. If the proposed groundwater point of diversion is 300 or fewer feet from the existing point of diversion, complete the following:

- (a) Does the undersigned represent all owners of the currently authorized place(s) of use identified in this application?
 Yes No (If no, all owners must sign this application.)
- (b) Will the ownership interest of any owner of the currently authorized place(s) of use identified in this application be adversely affected if this application is approved as requested?
 Yes No (If yes, all owners must sign this application.)
- (c) If this application is not approved expeditiously, will there be substantial damage to property, public health or safety?
 Yes No (If no, all owners must sign this application.)

If the application proposes a surface water change in point of diversion, a groundwater change in point of diversion greater than 300 feet, or a change in place of use, the application must be signed by all owners of the currently authorized place of use, or their duly authorized agent (attach notarized statement authorizing representation).

I hereby verify, being first duly sworn upon my oath or affirmation and under penalty of perjury, that I am of lawful age and the owner, the spouse of the owner, or a duly authorized agent of the owner(s) to make this application on their behalf, in regards to the water right(s) to which this application pertains. I further verify that the statements contained in this application are true, correct and complete.

Dated at Basehor, Kansas, Kansas, this 8th day of September, 2022.

Johanna A. H. Stueckemann
(Owner)

NONE
(Spouse)

JOHANNA A. H. STUECKEMANN
(Please Print)

(Please Print)

(Owner)

(Spouse)

(Please Print)

(Please Print)

(Owner)

(Spouse)

(Please Print)

(Please Print)

RECEIVED
OCT 04 2022

State of Kansas }
County of Leavenworth } SS

Stafford Field Office
Division of Water Resources

I hereby certify that the foregoing application was signed in my presence and sworn to before me this 8 day of Sept, 2022.

Jackie Robison
Notary Public

My Commission Expires 3-29-2023.

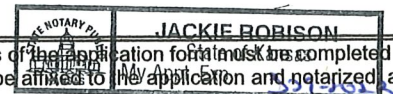

ONLY COMPLETE APPLICATIONS WILL BE PROCESSED. To be complete, all of the applicable portions of the application form must be completed with accurate information; maps, if necessary, must be included; signatures of all the appropriate owners must be affixed to the application and notarized, and the appropriate fee must be paid.

FEE SCHEDULE

Each application to change the place of use or the point of diversion under this section shall be accompanied by the application fee set forth in the schedule below: Make checks payable to: **Kansas Department of Agriculture**

- (1) Application to change a point of diversion 300 feet or less \$100
- (2) Application to change a point of diversion more than 300 feet \$200
- (3) Application to change the place of use \$200

14. If the proposed groundwater point of diversion is 300 or fewer feet from the existing point of diversion, complete the following:
- (a) Does the undersigned represent all owners of the currently authorized place(s) of use identified in this application?
 Yes No (If no, all owners must sign this application.)
 - (b) Will the ownership interest of any owner of the currently authorized place(s) of use identified in this application be adversely affected if this application is approved as requested?
 Yes No (If yes, all owners must sign this application.)
 - (c) If this application is not approved expeditiously, will there be substantial damage to property, public health or safety?
 Yes No (If no, all owners must sign this application.)

If the application proposes a surface water change in point of diversion, a groundwater change in point of diversion greater than 300 feet, or a change in place of use, the application must be signed by all owners of the currently authorized place of use, or their duly authorized agent (attach notarized statement authorizing representation).

I hereby verify, being first duly sworn upon my oath or affirmation and under penalty of perjury, that I am of lawful age and the owner, the spouse of the owner, or a duly authorized agent of the owner(s) to make this application on their behalf, in regards to the water right(s) to which this application pertains. I further verify that the statements contained in this application are true, correct and complete.

Dated at Larned, Kansas, this 17 day of September, 2022.

<u>Ross Kirkwood</u>		
(Owner)		(Spouse)
<u>Ross Kirkwood</u>		
(Please Print)		(Please Print)
<u>L. Kirk</u>		
(Owner)		(Spouse)
<u>Levi Kirkwood</u>		
(Please Print)		(Please Print)
<u>Chaska Starr</u>		
(Owner)		(Spouse)
<u>Tasha Starr</u>		
(Please Print)		(Please Print)

RECEIVED
OCT 04 2022

Stafford Field Office
Division of Water Resources

State of Kansas }
County of _____ } SS



I hereby certify that the foregoing application was signed in my presence and sworn to before me this 17th day of September, 2022.

Megan Mawhirter
Notary Public

My Commission Expires 1-22-24.

ONLY COMPLETE APPLICATIONS WILL BE PROCESSED. To be complete, all of the applicable portions of the application form must be completed with accurate information; maps, if necessary, must be included; signatures of all the appropriate owners' must be affixed to the application and notarized; and the appropriate fee must be paid.

FEE SCHEDULE

Each application to change the place of use or the point of diversion under this section shall be accompanied by the application fee set forth in the schedule below: Make checks payable to: **Kansas Department of Agriculture**

(1) Application to change a point of diversion 300 feet or less	\$100
(2) Application to change a point of diversion more than 300 feet	\$200
(3) Application to change the place of use	\$200

14. If the proposed groundwater point of diversion is 300 or fewer feet from the existing point of diversion, complete the following:

- (a) Does the undersigned represent all owners of the currently authorized place(s) of use identified in this application?
 Yes No (If no, all owners must sign this application.)
- (b) Will the ownership interest of any owner of the currently authorized place(s) of use identified in this application be adversely affected if this application is approved as requested?
 Yes No (If yes, all owners must sign this application.)
- (c) If this application is not approved expeditiously, will there be substantial damage to property, public health or safety?
 Yes No (If no, all owners must sign this application.)

If the application proposes a surface water change in point of diversion, a groundwater change in point of diversion greater than 300 feet, or a change in place of use, the application must be signed by all owners of the currently authorized place of use, or their duly authorized agent (attach notarized statement authorizing representation).

I hereby verify, being first duly sworn upon my oath or affirmation and under penalty of perjury, that I am of lawful age and the owner, the spouse of the owner, or a duly authorized agent of the owner(s) to make this application on their behalf, in regards to the water right(s) to which this application pertains. I further verify that the statements contained in this application are true, correct and complete.

Dated at _____, Kansas, this _____ day of _____, 20_____.

Lee Anne Williams

(Owner)

(Spouse)

Lee Anne Williams

(Please Print)

(Please Print)

(Owner)

(Spouse)

(Please Print)

(Please Print)

(Owner)

(Spouse)

(Please Print)

(Please Print)

RECEIVED

OCT 04 2022

Stafford Field Office
Division of Water Resources

State of Kansas }
County of Pawnee } SS

I hereby certify that the foregoing application was signed in my presence and sworn to before me this 12th day of September, 2022.

NOTARY PUBLIC - State of Kansas
JOLENE REASON
My Appt Expires 11-1-25

Jolene Reason

Notary Public

My Commission Expires 11-1-25

ONLY COMPLETE APPLICATIONS WILL BE PROCESSED. To be complete, all of the applicable portions of the application form must be completed with accurate information; maps, if necessary, must be included; signatures of all the appropriate owners' must be affixed to the application and notarized; and the appropriate fee must be paid.

FEE SCHEDULE

Each application to change the place of use or the point of diversion under this section shall be accompanied by the application fee set forth in the schedule below: Make checks payable to: **Kansas Department of Agriculture**

- (1) Application to change a point of diversion 300 feet or less \$100
- (2) Application to change a point of diversion more than 300 feet \$200
- (3) Application to change the place of use \$200

14. If the proposed groundwater point of diversion is 300 or fewer feet from the existing point of diversion, complete the following:
- (a) Does the undersigned represent all owners of the currently authorized place(s) of use identified in this application?
 Yes No (If no, all owners must sign this application.)
 - (b) Will the ownership interest of any owner of the currently authorized place(s) of use identified in this application be adversely affected if this application is approved as requested?
 Yes No (If yes, all owners must sign this application.)
 - (c) If this application is not approved expeditiously, will there be substantial damage to property, public health or safety?
 Yes No (If no, all owners must sign this application.)

If the application proposes a surface water change in point of diversion, a groundwater change in point of diversion greater than 300 feet, or a change in place of use, the application must be signed by all owners of the currently authorized place of use, or their duly authorized agent (attach notarized statement authorizing representation).

I hereby verify, being first duly sworn upon my oath or affirmation and under penalty of perjury, that I am of lawful age and the owner, the spouse of the owner, or a duly authorized agent of the owner(s) to make this application on their behalf, in regards to the water right(s) to which this application pertains. I further verify that the statements contained in this application are true, correct and complete.

Dated at Santa Valley, ^{Arizona} ~~Kansas~~, this 4th day of September, 20 22.

Layna Dechant
 (Owner)
Layna Dechant
 (Please Print)

 (Owner)

 (Please Print)

 (Owner)

 (Please Print)

Sam Dechant
 (Spouse)
Gary Dechant
 (Please Print)

 (Spouse)

 (Please Print)

 (Spouse)

 (Please Print)

RECEIVED

OCT 04 2022

Stafford Field Office
 Division of Water Resources

State of ~~Kansas~~ ^{Arizona} } SS
 County of Pinal

I hereby certify that the foregoing application was signed in my presence and sworn to before me this 4th day of September, 20 22.

My Commission Expires 12/6/2025

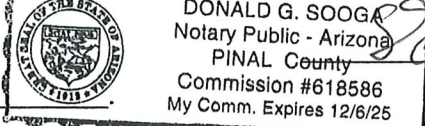

Donald G. Sooga
 Notary Public

ONLY COMPLETE APPLICATIONS WILL BE PROCESSED. To be complete, all of the applicable portions of the application form must be completed with accurate information; maps, if necessary, must be included; signatures of all the appropriate owners' must be affixed to the application and notarized; and the appropriate fee must be paid.

FEE SCHEDULE

Each application to change the place of use or the point of diversion under this section shall be accompanied by the application fee set forth in the schedule below: Make checks payable to: **Kansas Department of Agriculture**

(1) Application to change a point of diversion 300 feet or less	\$100
(2) Application to change a point of diversion more than 300 feet	\$200
(3) Application to change the place of use	\$200

SUMMARY ORDER APPROVING APPLICATION FOR CHANGE AND IMPOSING CONDITIONS

This Summary Order is issued under authority of K.S.A. 82a-708b, as amended, and K.A.R. 5-5-1, *et seq.* and other applicable provisions of the *Kansas Water Appropriation Law, K.S.A. 82a-701 et. seq.*, and rules and regulations promulgated thereunder. With the exception of those conditions expressly contained herein, this Summary Order does not change the terms, conditions and limitations of File No. 15314.

1. A change application was received on 10/4/2022 requesting that the place of use and / or point of diversion authorized under the above-referenced file number be changed as described in the application.
2. On and after the effective date of this summary order, the authorized place(s) of use shall be located substantially as shown on the topographic map accompanying the application to change the place of use. Applicable Not Applicable
3. The change in point of diversion shall not impair existing rights and shall be limited to the same source or sources of water as previously authorized. The point of diversion authorized by this summary order shall be located within a foot radius of the authorized point(s) of diversion. Applicable Not Applicable
4. The point(s) of diversion described herein is administratively corrected to be more accurately described using the Global Positioning System (GPS), as described in the application. Applicable Not Applicable
5. The point(s) of diversion authorized herein shall not actually be located more than feet from the previously authorized point(s) of diversion. Applicable Not Applicable
6. As required by K.A.R. 5-3-5d, if the works for diversion is a well with a diversion rate of 100 gallons per minute or more, a tube or other device suitable for making water level measurements shall be installed, operated and maintained in accordance with K.A.R. 5-6-13. Applicable Not Applicable
7. ²⁰²³ **The owner of the authorized place(s) of use shall properly install an acceptable water flow meter on or before December 31, 2023,** or before the first use of water, whichever occurs first. The water flow meter shall be installed, operated and maintained in accordance with K.A.R. 5-1-4 through 5-1-12. As required by K.S.A. 82a-732, as amended, and K.A.R. 5-3-5e, the owner shall maintain records and report the reading of the water flow meter and the total quantity of water diverted annually to the Chief Engineer by March 1 following the end of each calendar year.
 Applicable Not Applicable
8. **Installation of the works for diversion of water shall be completed on or before December 31, 2023,** or within any authorized extension of time. By March 1, ²⁰²⁴ the applicant shall notify the Chief Engineer that construction of the works for diversion has been completed, on the form provided by the Chief Engineer, as required by K.A.R. 5-8-4e.
 Applicable Not Applicable
9. **The completed well log shall be submitted with the required notice.** Applicable Not Applicable * TMA 10/7/22
10. All diversion works into which any type of chemical or other foreign substance will be injected into the water shall be equipped with an in-line, automatic, quick-closing check valve capable of preventing pollution of the source of the water supply. The check valve(s) shall be installed, operated and maintained in accordance with K.A.R. 5-3-5c. Applicable Not Applicable
11. Additional Conditions are attached. Yes No
12. In accordance with K.S.A. 82a-708a, as amended, and K.A.R. 5-5-14, all of the owners of the authorized place(s) of use of water appropriated under the above-referenced file number are responsible for compliance with its terms, conditions and limitations, as amended and/or supplemented by this Summary Order, and with applicable provisions of the *Kansas Water Appropriation Law* and the *Rules and Regulations* promulgated thereunder. Failure to comply with these provisions may result in civil penalties pursuant to K.S.A. 82a-737, as amended, and/or the suspension or revocation and dismissal of the water or appropriation right or any other enforcement actions authorized by law.

RECEIVED

Administrative Appeal and Effective Date of Order

If you are aggrieved by this order, pursuant to K.S.A. 82a-1901, you may request an evidentiary hearing before the Chief Engineer or request administrative review by the Secretary of Agriculture. A request for hearing by the Chief Engineer must be filed within **15 days** of service of this Order and a request for administrative review by the Secretary must be filed within **30 days** pursuant to K.S.A. 77-531. Any request for administrative review must state a basis for review pursuant to K.S.A. 77-527. File any request with **Kansas Department of Agriculture, Legal Division, 1320 Research Park Drive, Manhattan, KS 66502.** Failure to timely request a hearing or review may preclude review under the Kansas Judicial Review Act.

For Use by Register of Deeds

FOR OFFICE USE ONLY
**APPLICATION APPROVED AND
SUMMARY ORDER ISSUED**

NOV 04 2022

By: Jeff Luntin ^{Stafford Field Office}
Duly Authorized Designee of the Chief Engineer ^{Division of Water Resources}

(Print Name): Jeff Laresman
Division of Water Resources - Kansas Department of Agriculture

Date of Issuance: 11/3/2022

State of Kansas)

County of Stafford) SS

Acknowledged before me on 11/3/2022

by Faith Curtis

Signature: Faith Curtis
Notary Public

My commission expires: _____



Transfer of 20.5 AF quantity between wells:
 N well ID #6: 145.5 AF -> 176 AF
 S well ID #3: 148.5 AF -> 118 AF

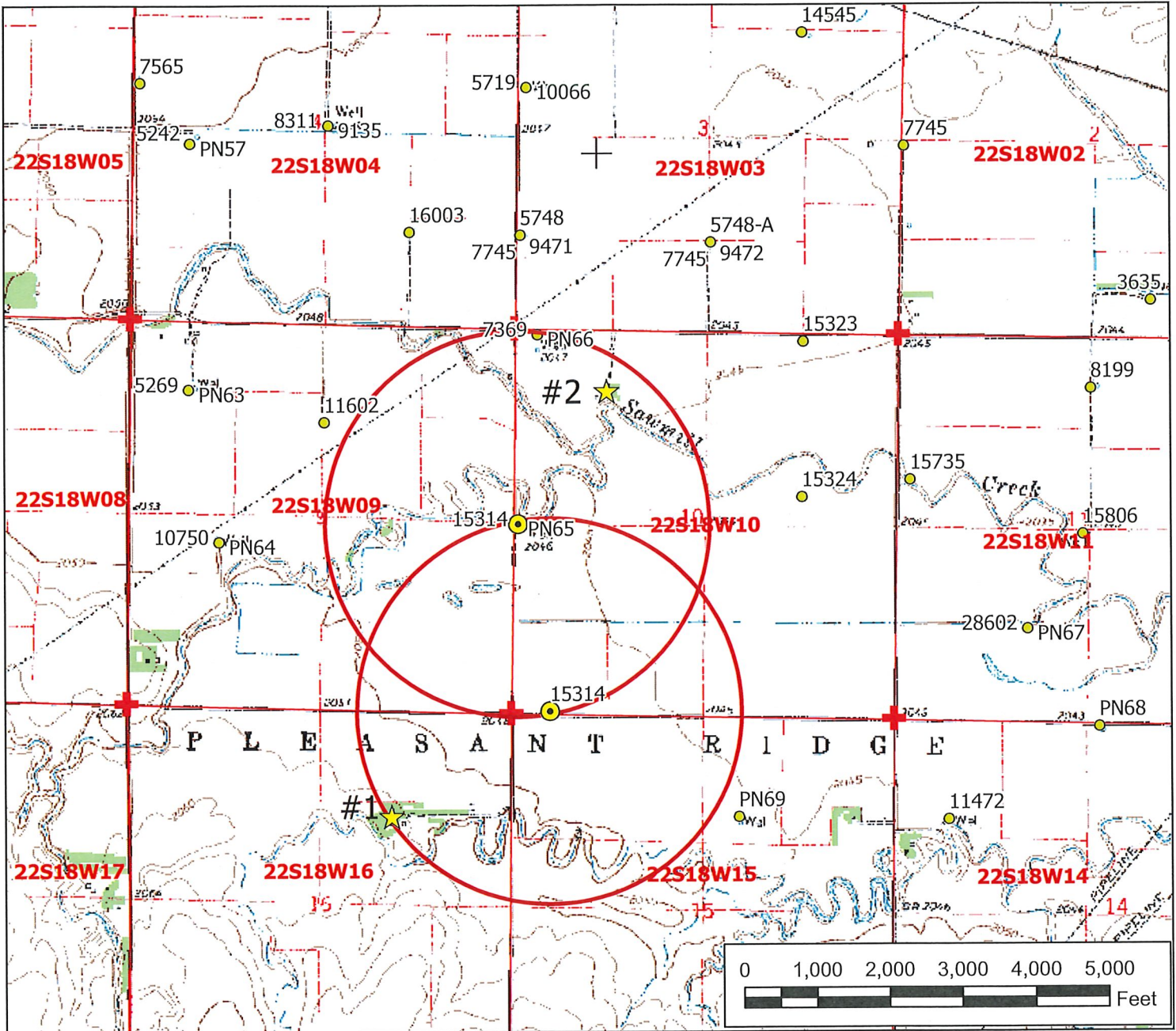

Legend

- Water Appropriation
- Authorized Point of Diversion
- ★ Domestic Well
- ⊕ Section Corner
- Section Line
- Half Mile Circle

Water Right, File No. 15314

Change in Point of Diversion Map 10-22-18W // Pawnee County



To the best of my knowledge, all points of diversion within one-half mile of the proposed point of diversion have been shown.

Signature / Date

10/10/2022 TMA/SFFO 1:24,000 scale

Stafford Field Office
300 S. Main Street
Stafford, KS 67578-1521



Phone: 620-234-5311
Fax: 620-234-6900
www.agriculture.ks.gov

Mike Beam, Secretary

Laura Kelly, Governor

November 4, 2022

Lee Anne Williams
722 West 12th Street
Larned, KS 67550

Re: Water Right, File No(s). 15314

Dear Water Right Owner:

Enclosed is the order executed by the Chief Engineer, Division of Water Resources, Kansas Department of Agriculture, approving the application for change under the above referenced file number(s).

Your attention is directed to the enclosures and to the terms, conditions and limitations specified in this approval for change. An acceptable water flow meter must be installed on your well before any water is applied as authorized under this change approval. A copy of the approved list of Certified Water Flowmeters can be found at www.agriculture.ks.gov/divisions-programs/dwr/water-appropriation/water-flowmeters. Regulations regarding the installation of flowmeters, measurement tubes and check valves can be found at <https://www.agriculture.ks.gov/divisions-programs/dwr/water-appropriation>. This order requires that a notice and completion of works form be submitted once the diversion works are completed, including a properly installed flowmeter. This form is available at www.agriculture.ks.gov/divisions-programs/dwr/water-appropriation/change-applications. If you do not have access to the internet, please contact this office and we will send you a paper copy of the referenced information.

Since this order modifies the original document referred to above, it should be recorded with the Register of Deeds as other instruments affecting real estate.

Any abandoned well must be plugged in accordance with the requirements of Article 30 of the Rules and Regulations as adopted by the Kansas Department of Health and Environment.

Should you have any questions, please feel free to contact this office. If you wish to refer to a specific file, please reference it when you contact us.

Sincerely,

A handwritten signature in black ink, appearing to read "Jeff Lanterman".

Jeff Lanterman
Water Commissioner

Enclosures

pc: Water Rights Section
Groundwater Management District No. 5

CERTIFICATE OF SERVICE

On this **4 November 2022**, I hereby certify that the attached Change in Point of Diversion, File No. 15314 dated 11/3/2022 was mailed to the following:

Lee Anne Williams
722 West 12th Street
Larned, KS 67550

pc: Water Rights Section
GMD #5

Faith Curtis

Staff