

NOTICE

This scan only represents the application as filed. The information contained herein meets the requirements of K.A.R. 5-3-1 or K.A.R. 5-5-1, and has been found acceptable for filing in the office of the Chief Engineer. The application should not be considered to be a complete application as per K.A.R. 5-3-1b or K.A.R. 5-5-2a.

FEB 13 2023

12/5

THE STATE OF KANSAS



KANSAS DEPARTMENT OF AGRICULTURE
Mike Beam, Secretary of Agriculture

DIVISION OF WATER RESOURCES
Earl D. Lewis Jr., Chief Engineer

50966

File Number _____
This item to be completed by the Division of Water Resources.

APPLICATION FOR PERMIT TO
APPROPRIATE WATER FOR BENEFICIAL USE

Filing Fee Must Accompany the Application
(Please refer to Fee Schedule attached to this application form.)

To the Chief Engineer of the Division of Water Resources, Kansas Department of Agriculture,
1320 Research Park Drive, Manhattan, Kansas 66502:

1. Name of Applicant (Please Print): Paul Kelsey; Kelsey Investments, Inc.
Address: 716 N 119th Street West Suite 112
City: Wichita State KS Zip Code 67234
Telephone Number: (316) 648-4625

2. The source of water is: surface water in Unnamed Tributary to Westlink Tributary to Cowskin Creek
(stream)
OR groundwater in _____
(drainage basin)

Certain streams in Kansas have minimum target flows established by law or may be subject to administration when water is released from storage for use by water assurance district members. If your application is subject to these regulations on the date we receive your application, you will be sent the appropriate form to complete and return to the Division of Water Resources.

3. The maximum quantity of water desired is 104.3 Initial Fill
22.3 Annual acre-feet OR _____ gallons per calendar year,
to be diverted at a maximum rate of EVAP Rate gallons per minute OR _____ cubic feet per second.

Once your application has been assigned a priority, the requested maximum rate of diversion and maximum requested quantity of water under that priority number can **NOT** be increased. Please be certain your requested maximum rate of diversion and maximum quantity of water are appropriate and reasonable for your proposed project and are in agreement with the Division of Water Resources' requirements.

4. The water is intended to be appropriated for (Check use intended):
(a) Artificial Recharge (b) Irrigation (c) Recreational (d) Water Power
(e) Industrial (f) Municipal (g) Stockwatering (h) Sediment Control
(i) Domestic (j) Dewatering (k) Hydraulic Dredging (l) Fire Protection
(m) Thermal Exchange (n) Contamination Remediation

YOU **MUST** COMPLETE AND ATTACH ADDITIONAL DIVISION OF WATER RESOURCES FORM(S) PROVIDING INFORMATION TO SUBSTANTIATE YOUR REQUEST FOR THE AMOUNT OF WATER FOR THE INTENDED USE REFERENCED ABOVE.

For Office Use Only:
F.O. 2 GMD 2 Meets K.A.R. 5-3-1 (YES/NO) Use REC Source G / S County SG By ALB Date 2/14/23
Code REG Fee \$ 300 TR # _____ Receipt Date 2-13-23 Check # 00397

2/15/2023
LMoody

5. The location of the proposed wells, pump sites or other works for diversion of water is:

Note: For the application to be accepted, the point of diversion location must be described to at least a 10 acre tract, unless you specifically request a 60 day period of time in which to locate the site within a specifically described, minimal legal quarter section of land.

- (A) One in the SE quarter of the SW quarter of the NW quarter of Section 31, more particularly described as being near a point 2720 feet North and 3750 feet West of the Southeast corner of said section, in Township 26S South, Range 1 East/West (circle one), Sedgwick County, Kansas.
- (B) One in the _____ quarter of the _____ quarter of the _____ quarter of Section _____, more particularly described as being near a point _____ feet North and _____ feet West of the Southeast corner of said section, in Township _____ South, Range _____ East/West (circle one), _____ County, Kansas.
- (C) One in the _____ quarter of the _____ quarter of the _____ quarter of Section _____, more particularly described as being near a point _____ feet North and _____ feet West of the Southeast corner of said section, in Township _____ South, Range _____ East/West (circle one), _____ County, Kansas.
- (D) One in the _____ quarter of the _____ quarter of the _____ quarter of Section _____, more particularly described as being near a point _____ feet North and _____ feet West of the Southeast corner of said section, in Township _____ South, Range _____ East/West (circle one), _____ County, Kansas.

If the source of supply is groundwater, a separate application shall be filed for each proposed well or battery of wells, except that a single application may include up to four wells within a circle with a quarter (1/4) mile radius in the same local source of supply which do not exceed a maximum diversion rate of 20 gallons per minute per well.

A battery of wells is defined as two or more wells connected to a common pump by a manifold; or not more than four wells in the same local source of supply within a 300 foot radius circle which are being operated by pumps not to exceed a total maximum diversion rate of 800 gallons per minute and which supply water to a common distribution system.

6. The owner of the point of diversion, if other than the applicant is (please print):

 (name, address and telephone number)

Same as Applicant
 (name, address and telephone number)

You must provide evidence of legal access to, or control of, the point of diversion from the landowner or the landowner's authorized representative. Provide a copy of a recorded deed, lease, easement or other document with this application. In lieu thereof, you may sign the following sworn statement:

I have legal access to, or control of, the point of diversion described in this application from the landowner or the landowner's authorized representative. I declare under penalty of perjury that the foregoing is true and correct.

Executed on FEB 7, 2023.

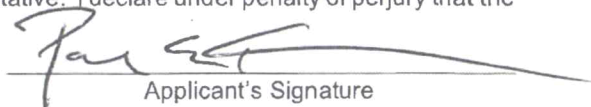
 Applicant's Signature

The applicant must provide the required information or signature irrespective of whether they are the landowner. Failure to complete this portion of the application will cause it to be unacceptable for filing and the application will be returned to the applicant.

- 7. The proposed project for diversion of water will consist of 2 Surface Water Ponds
(number of wells, pumps or dams, etc.)
 and (was) (will be) completed (by) 06/01/2023
(Month/Day/Year - each was or will be completed)
- 8. The first actual application of water for the proposed beneficial use was or is estimated to be 06/01/2023
(Mo/Day/Year)

WATER RESOURCES
RECEIVED

FEB 13 2023

KS DEPT OF AGRICULTURE

- 9. Will pesticide, fertilizer, or other foreign substance be injected into the water pumped from the diversion works?
 Yes No If "yes", a check valve shall be required.

All chemigation safety requirements must be met including a chemigation permit and reporting requirements.

- 10. If you are planning to impound water, please contact the Division of Water Resources for assistance, prior to submitting the application. Please attach a reservoir area capacity table and inform us of the total acres of surface drainage area above the reservoir.

Have you also made an application for a permit for construction of this dam and reservoir with the Division of Water Resources? Yes No

- If yes, show the Water Structures permit number here _____
- If no, explain here why a Water Structures permit is not required _____
Drainage area is 135.7 acres. Not large enough for DWR Jurisdiction.

- 11. The application must be supplemented by a U.S.G.S. topographic map, aerial photograph or a detailed plat showing the following information. On the topographic map, aerial photograph, or plat, identify the center of the section, the section lines or the section corners and show the appropriate section, township and range numbers. Also, please show the following information:

- (a) The location of the proposed point(s) of diversion (wells, stream-bank installations, dams, or other diversion works) should be plotted as described in Paragraph No. 5 of the application, showing the North-South distance and the East-West distance from a section line or southeast corner of section.
- (b) If the application is for groundwater, please show the location of any existing water wells of any kind within 1/2 mile of the proposed well or wells. Identify each existing well as to its use and furnish the name and mailing address of the property owner or owners. If there are no wells within 1/2 mile, please advise us.
- (c) If the application is for surface water, the names and addresses of the landowner(s) 1/2 mile downstream and 1/2 mile upstream from your property lines must be shown.
- (d) The location of the proposed place of use should be shown by crosshatching on the topographic map, aerial photograph or plat.
- (e) Show the location of the pipelines, canals, reservoirs or other facilities for conveying water from the point of diversion to the place of use.

A 7.5 minute U.S.G.S. topographic map may be obtained by providing the section, township and range numbers to: Kansas Geological Survey, 1930 Constant, Campus West, University of Kansas, Lawrence, Kansas 66047.

- 12. List any application, appropriation of water, water right, or vested right file number that covers the same diversion points or any of the same place of use described in this application. Also list any other recent modifications made to existing permits or water rights in conjunction with the filing of this application.

WATER RESOURCES
RECEIVED

FEB 13 2023

KS DEPT OF AGRICULTURE

13. Furnish the following well information if the proposed appropriation is for the use of groundwater. If the well has not been completed, give information obtained from test holes, if available.

Information below is from: Test holes Well as completed Drillers log attached

Well location as shown in paragraph No.	(A)	(B)	(C)	(D)
Date Drilled	_____	_____	_____	_____
Total depth of well	_____	_____	_____	_____
Depth to water bearing formation	_____	_____	_____	_____
Depth to static water level	_____	_____	_____	_____
Depth to bottom of pump intake pipe	_____	_____	_____	_____

14. The relationship of the applicant to the proposed place where the water will be used is that of

Owner
(owner, tenant, agent or otherwise)

15. The owner(s) of the property where the water is used, if other than the applicant, is (please print):

Same as Applicant

(name, address and telephone number)

(name, address and telephone number)

16. The undersigned states that the information set forth above is true to the best of his/her knowledge and that this application is submitted in good faith.

Dated at WICHITA, Kansas, this 7 day of FEB, 2023.
(month) (year)

(Applicant Signature)

By _____
(Agent or Officer Signature)

(Agent or Officer - Please Print)

Assisted by Brent Chesnut, PE Baughman Date: 01/23/2023
(office/title)

WATER RESOURCES
RECEIVED

FEB 13 2023

FEE SCHEDULE

1. The fee for an application for a permit to appropriate water for beneficial use, except for domestic use, shall be (see paragraph No. 2 below if requesting storage):

ACRE-FEET	FEE
0-100	\$200.00
101-320	\$300.00
More than 320	\$300.00 plus \$20.00 for each additional 100 acre-feet or any part thereof.

2. The fee for an application in which storage is requested, except for domestic use, shall be:

ACRE-FEET	FEE
0-250	\$200.00
More than 250	\$200.00 plus \$20.00 for each additional 250 acre-feet of storage or any part thereof.

Note: If an application requests both direct use *and* storage, the fee charged shall be as determined under No. 1 or No. 2 above, whichever is greater, but not both fees.

3. The fee for an application for a permit to appropriate water for water power or dewatering purposes shall be \$100.00 plus \$200.00 for each 100 cubic feet per second, or part thereof, of the diversion rate requested.

Note: The applicant shall notify the Chief Engineer and pay the statutorily required field inspection fee of \$400.00 when construction of the works for diversion has been completed, except that for applications filed on or after July 1, 2009, for works constructed for sediment control use and for evaporation from a groundwater pit for industrial use shall be accompanied by a field inspection fee of \$200.00.

MAKE CHECKS PAYABLE TO THE KANSAS DEPARTMENT OF AGRICULTURE

ATTENTION

A Water Conservation Plan may be required per K.S.A. 82a-733. A statement that your application for permit to appropriate water may be subject to the minimum desirable streamflow requirements per K.S.A. 82a-703a, b, and c may also be required from you. After the Division of Water Resources has had the opportunity to review your application, you will be notified whether or not you will need to submit a Water Conservation Plan. You also may be required to install a water flow meter or water stage measuring device on your diversion works prior to diverting water. There may be other special conditions or Groundwater Management District regulations that you will need to comply with if this application is approved.

CONVERSION FACTORS

1 acre-foot equals 325,851 gallons

1 million gallons equal 3.07 acre-feet

WATER RESOURCES
RECEIVED

FEB 13 2023

KS DEPT OF AGRICULTURE

RECREATIONAL USE SUPPLEMENTAL SHEET

File No. _____

Name of Applicant (Please Print): Paul Kelsey - Cranor Addition

1. Please indicate type of recreational use (boating, fishing, swimming, etc.): _____
Fishing, Swimming, Aesthetics

2. Please summarize how the water will be used and justify the quantity of water requested: _____
Water will be used to initially fill new recreation ponds and to fill yearly evaporative losses that occur.

Requested quantity for initial fill and evaporation.

Quantity for Initial Fill (104.3 Ac-Ft) and Evaporation (22.3 Ac-Ft).

Pond Surface Area(s) is 13.4 Acres.

3. Please complete the following table showing estimated future water requirements:

ESTIMATED FUTURE WATER DIVERTED/STORED	
NEXT 5 YEARS	WATER TO BE DIVERTED (ACRE-FEET OR GALLONS)
Year 1	104.3 Ac-Ft
Year 2	22.3 Ac-Ft
Year 3	22.3 Ac-Ft
Year 4	22.3 Ac-Ft
Year 5	22.3 Ac-Ft

Please attach any additional information, tables, or curves showing past, present and estimated future water requirements to substantiate the amount of water requested.

4. Please designate the legal description of the location where the water is to be used by providing the fractional part of the Section, Township and Range.

SE 1/4, SW 1/4, NW1/4, Section 31, Township 26S Range 1W

**WATER RESOURCES
RECEIVED**

FEB 13 2023

KS DEPT OF AGRICULTURE

You may attach any additional information you believe will assist in informing the Division of the need for your request.

(Date)

Kansas Department of Agriculture
Division of Water Resources
Earl D. Lewis, Jr., Chief Engineer
1320 Research Park Drive
Manhattan, Kansas 66502

Re: Application
File No. _____

Minimum Desirable Streamflow

I understand that a Minimum Desirable Streamflow requirement has been established by the legislature for the source of supply to which the above referenced application applies.

I understand that diversion of water pursuant to this application will be subject to regulation any time Minimum Desirable Streamflow requirements are not being met.

I also understand that if this application is approved, there could be times, as determined by the Division of Water Resources, when I would not be allowed to divert water. I realize that this could affect the economics of my decision to appropriate water.

I am aware of the above factors, and with the knowledge thereof, request that the Division of Water Resources proceed with processing and approval, if possible, of the above referenced application.



Signature of Applicant

State of Kansas)
County of Sedgewick) ss

PAUL E. KELSEY

(Print Applicant's Name)

I hereby certify that the foregoing instrument was signed in my presence and sworn to before me this 7th day of February, 20 23.





Notary Public

My Commission Expires:
09-20-2026

WATER RESOURCES
RECEIVED

FEB 13 2023

KS DEPT OF AGRICULTURE

**MINIMUM DESIRABLE STREAMFLOW FORM TO BE USED WHEN
APPLICABLE WHEN FILING AN APPLICATION FOR PERMIT
TO APPROPRIATE WATER FOR BENEFICIAL USE**

The Kansas Legislature has established minimum desirable streamflows for the streams listed below. If your proposed diversion of water is going to be from one of these watercourses or adjacent alluvial aquifers, please complete the back side of this page and submit it along with your application for permit to appropriate water.

Arkansas River
Big Blue River
Chapman Creek
Chikaskia River
Cottonwood River
Delaware River
Little Arkansas River
Little Blue River
Marais des Cygnes River
Medicine Lodge River
Mill Creek (Wabaunsee Co. area)
Neosho River

Ninnescah River
North Fork Ninnescah River
Rattlesnake Creek
Republican River
Saline River
Smoky Hill River
Solomon River
South Fork Ninnescah
Spring River
Walnut River
Whitewater River

**WATER RESOURCES
RECEIVED**

FEB 13 2023

KS DEPT OF AGRICULTURE

EXHIBIT
CRANOR ADDITION
MAIZE, SEDGWICK COUNTY, KANSAS

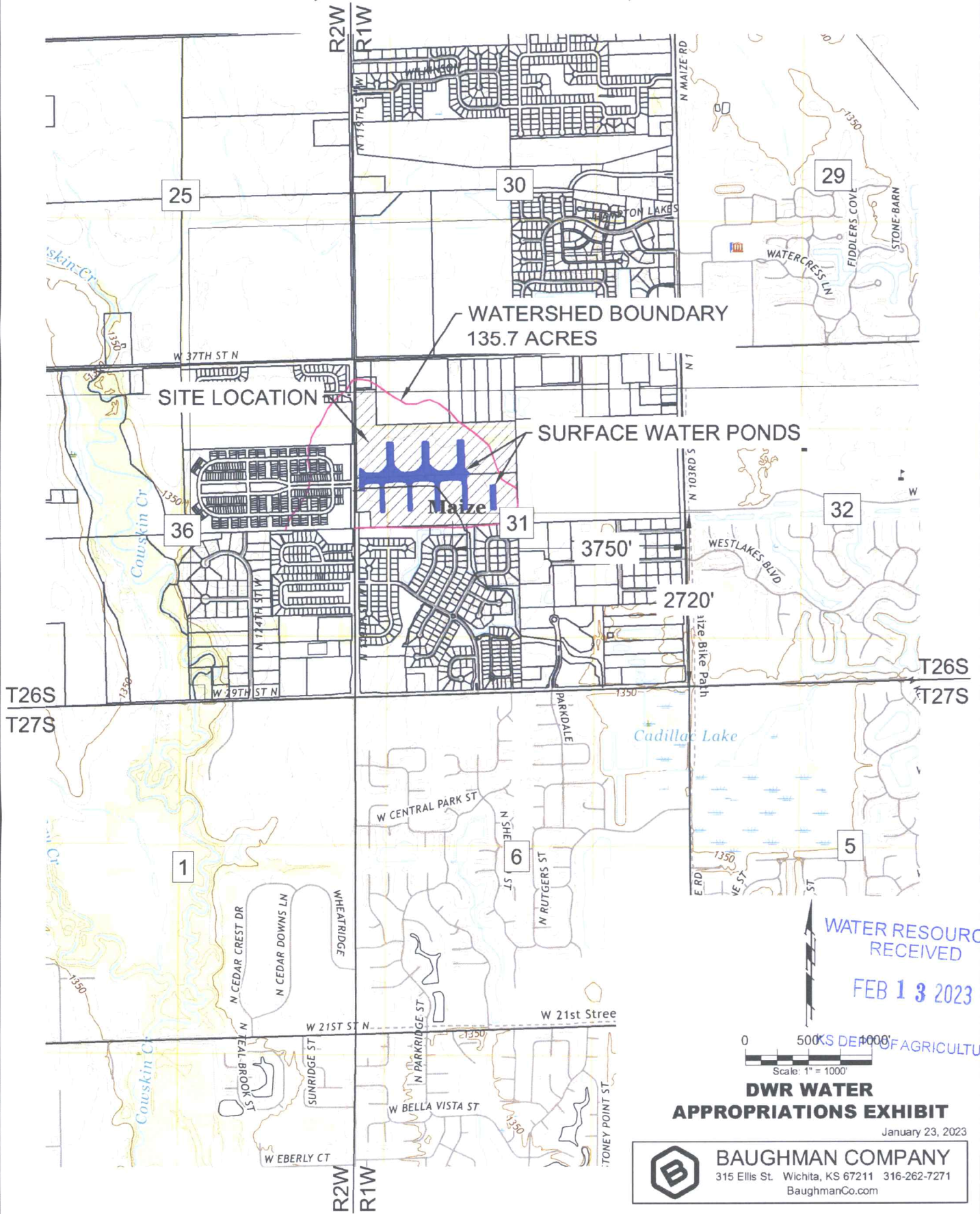

E:\Projects\Cranor Addition\Kelsey 118m\22-04-P768\Water Resources\DWR Appropriations\Topo Exhibit.dwg

BAUGHMAN COMPANY
 315 Ellis St. Wichita, KS 67211 316-262-7271
 BaughmanCo.com



Comp. by: Brent Chesnut

Date: 1/23/2023

Sheet 1 of 1

Chkd. by:

Date:

Job No.

Project: Cranor Addition

Element: DWR Appropriations - Capacity Table

Cranor Main Pond					
Storage Estimate					
Elevation	Stage	Contour Area	Inc. Storage	Storage	Storage
	(ft)	(sq ft)	(cuft)	(cuft)	(acft)
1340.00	0	103,636	0	0	0.00
1341.00	1	113,759	108,698	108,698	2.50
1342.00	2	123,956	118,858	227,555	5.22
1343.00	3	134,225	129,091	356,646	8.19
1344.00	4	144,568	139,397	496,042	11.39
1345.00	5	154,982	149,775	645,817	14.83
1346.00	6	321,134	238,058	883,875	20.29
1347.00	7	350,082	335,608	1,219,483	28.00
1348.00	8	379,148	364,615	1,584,098	36.37
1349.00	9	408,329	393,739	1,977,837	45.40
1350.00	10	437,618	422,974	2,400,810	55.12
1351.00	11	467,010	452,314	2,853,124	65.50
1352.00	12	496,493	481,752	3,334,876	76.56
1353.00	13	526,053	511,273	3,846,149	88.30
1354.00	14	555,673	540,863	4,387,012	100.71

STAGE- STORAGE

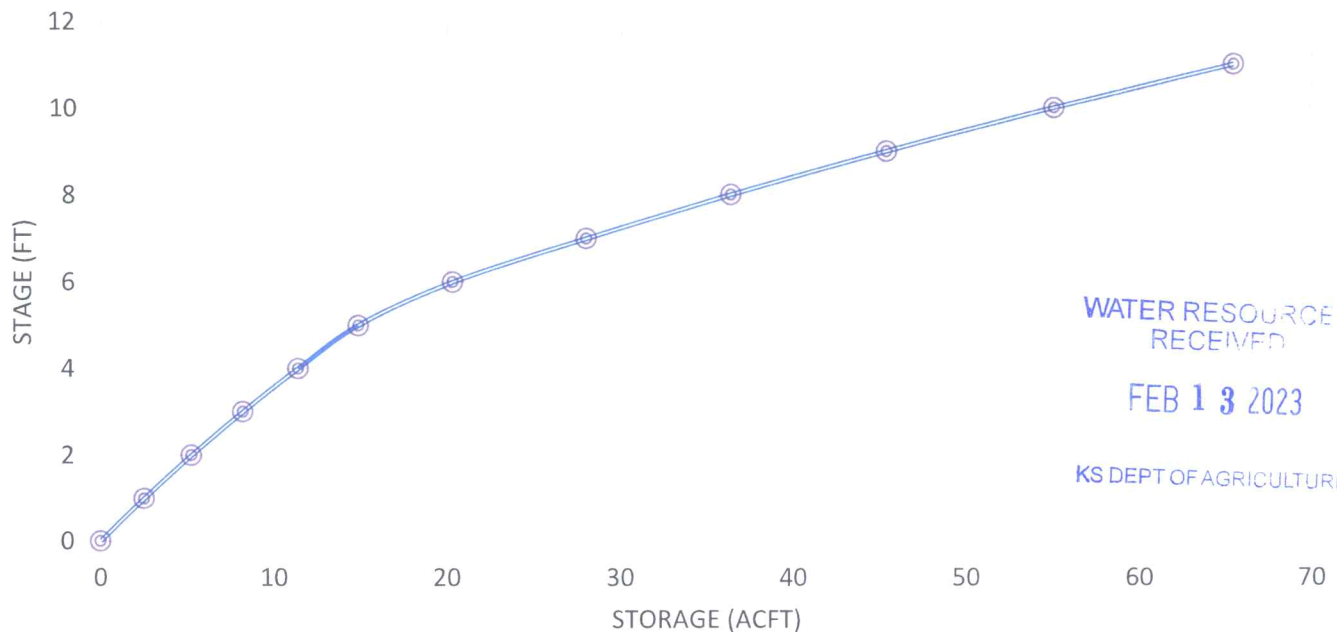



Comp. by: Brent Chesnut

Date: 1/23/2023

Sheet 1 of 1

Chkd. by:

Date:

Job No.

Project: Cranor Addition

Element: DWR Appropriations - Capacity Table

Cranor East Pond					
Storage Estimate					
Elevation	Stage	Contour Area	Inc. Storage	Storage	Storage
	(ft)	(sq ft)	(cuft)	(cuft)	(acft)
1346.00	0	9,867	0	0	0.00
1347.00	1	12,117	10,992	10,992	0.25
1348.00	2	14,438	13,278	24,270	0.56
1349.00	3	16,825	15,632	39,901	0.92
1350.00	4	19,278	18,052	57,953	1.33
1351.00	5	21,792	20,535	78,488	1.80
1352.00	6	24,365	23,079	101,566	2.33
1353.00	7	26,994	25,680	127,246	2.92
1354.00	8	29,680	28,337	155,583	3.57

STAGE-STROAGE

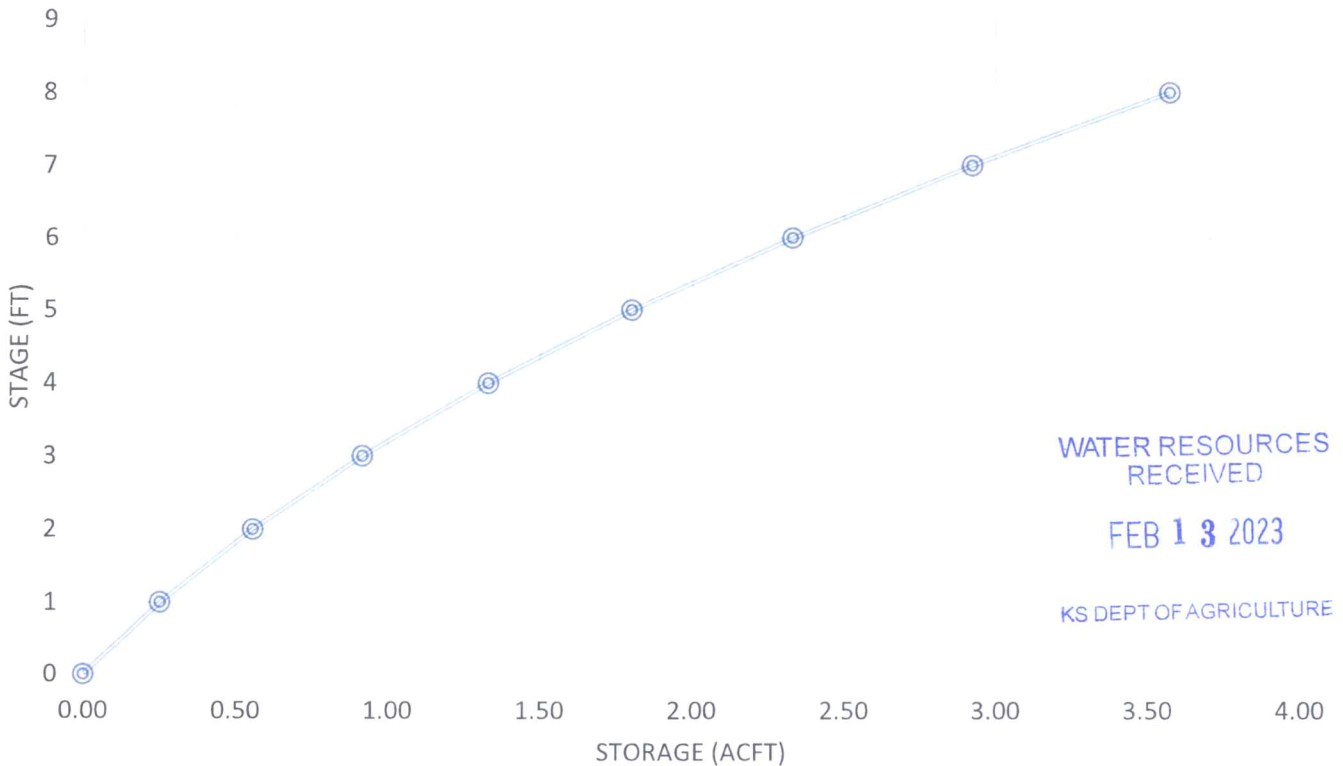

WATER RESOURCES RECEIVED

FEB 13 2023

KS DEPT OF AGRICULTURE



Comp. by: Brent Chesnut

Date: 1/23/2023

Sheet 1 of 1

Chkd. by:

Date:

Job No.

Project: Cranor Addition

Element: DWR Appropriations - Evaporation Loss Calculation

*Potential Net Evaporation = 20 Inches

Total Pond Surface Area = 13.4 Acres

Total Potential Net Evaporation per Year = 22.3 Acre Feet

* Potential Net Evaporation, in Inches, for Kansas (Annual Average Evaporation minus Annual Normal Precipitation), Kansas Department of Agriculture Division of Water Resources Subbasin Water Resources Management Program, September 6, 1996 (https://agriculture.ks.gov/docs/default-source/dwr-water-appropriation-forms/newevapomap.pdf?sfvrsn=1e92316_2)

WATER RESOURCES
RECEIVED

FEB 13 2023

KS DEPT OF AGRICULTURE

DATA ENTRY SYSTEM ID NUMBER SHEET

FILE NUMBER 50966

APPLICANT PERSON ID & SEQ #	PDIV ID	BATTERY ID
<u>68864</u>	<u>90086</u>	

LANDOWNER PERSON ID & SEQ #	PUSE ID
<u>68864</u>	<u>71240</u>

WATER USE CORRESPONDENT PERSON ID & SEQ #
<u>68864</u>