

NOTICE

This scan only represents the application as filed. The information contained herein meets the requirements of K.A.R. 5-3-1 or K.A.R. 5-5-1, and has been found acceptable for filing in the office of the Chief Engineer. The application should not be considered to be a complete application as per K.A.R. 5-3-1b or K.A.R. 5-5-2a.



THE STATE OF KANSAS

WATER RESOURCES RECEIVED

APR 19 2023

1259

KS DEPT OF AGRICULTURE

KANSAS DEPARTMENT OF AGRICULTURE
Mike Beam, Secretary of Agriculture

DIVISION OF WATER RESOURCES
Earl D. Lewis Jr., Chief Engineer

File Number 51017

This item to be completed by the Division of Water Resources.

APPLICATION FOR PERMIT TO APPROPRIATE WATER FOR BENEFICIAL USE

Filing Fee Must Accompany the Application
(Please refer to Fee Schedule attached to this application form.)

To the Chief Engineer of the Division of Water Resources, Kansas Department of Agriculture,
1320 Research Park Drive, Manhattan, Kansas 66502:

1. Name of Applicant (Please Print): Whispering Lakes HOA Attn: Stephanie Avery Vice President
Address: 1814 S Teakwood Ct
City: Wichita State KS Zip Code 67230
Telephone Number: (316) 305-2002 Email: stephavery76@gmail.com

2. The source of water is: [] surface water in (stream)
OR [x] groundwater in Walnut River (drainage basin)

Certain streams in Kansas have minimum target flows established by law or may be subject to administration when water is released from storage for use by water assurance district members. If your application is subject to these regulations on the date we receive your application, you will be sent the appropriate form to complete and return to the Division of Water Resources.

3. The maximum quantity of water desired is 6.8 acre-feet OR gallons per calendar year, to be diverted at a maximum rate of 500 gallons per minute OR cubic feet per second.

Once your application has been assigned a priority, the requested maximum rate of diversion and maximum requested quantity of water under that priority number can NOT be increased. Please be certain your requested maximum rate of diversion and maximum quantity of water are appropriate and reasonable for your proposed project and are in agreement with the Division of Water Resources' requirements.

4. The water is intended to be appropriated for (Check use intended):
(a) [] Artificial Recharge (b) [] Irrigation (c) [x] Recreational (d) [] Water Power
(e) [] Industrial (f) [] Municipal (g) [] Stockwatering (h) [] Sediment Control
(i) [] Domestic (j) [] Dewatering (k) [] Hydraulic Dredging (l) [] Fire Protection
(m) [] Thermal Exchange (n) [] Contamination Remediation

YOU MUST COMPLETE AND ATTACH ADDITIONAL DIVISION OF WATER RESOURCES FORM(S) PROVIDING INFORMATION TO SUBSTANTIATE YOUR REQUEST FOR THE AMOUNT OF WATER FOR THE INTENDED USE REFERENCED ABOVE.

For Office Use Only:
F.O. 2 GMD Meets K.A.R. 5-3-1 (YES/NO) Use REC Source G/S County SG By ALB Date 4/19/23
Code RE2 Fee \$ 300 TR # Receipt Date 4/19/23 Check # 1504

4/27/2023
LMoody

APR 19 2023

KS DEPT OF AGRICULTURE

5. The location of the proposed wells, pump sites or other works for diversion of water is:

Note: For the application to be accepted, the point of diversion location must be described to at least a 10 acre tract, unless you specifically request a 60 day period of time in which to locate the site within a specifically described, minimal legal quarter section of land.

- (A) One in the NW quarter of the SW quarter of the NE quarter of Section 36, more particularly described as being near a point 3,626 feet North and 1,237 feet West of the Southeast corner of said section, in Township 27 South, Range 2 East, Sedgwick County, Kansas.
- (B) One in the _____ quarter of the _____ quarter of the _____ quarter of Section _____, more particularly described as being near a point _____ feet North and _____ feet West of the Southeast corner of said section, in Township _____ South, Range _____, _____ County, Kansas.
- (C) One in the _____ quarter of the _____ quarter of the _____ quarter of Section _____, more particularly described as being near a point _____ feet North and _____ feet West of the Southeast corner of said section, in Township _____ South, Range _____, _____ County, Kansas.
- (D) One in the _____ quarter of the _____ quarter of the _____ quarter of Section _____, more particularly described as being near a point _____ feet North and _____ feet West of the Southeast corner of said section, in Township _____ South, Range _____, _____ County, Kansas.

If the source of supply is groundwater, a separate application shall be filed for each proposed well or battery of wells, except that a single application may include up to four wells within a circle with a quarter (1/4) mile radius in the same local source of supply which do not exceed a maximum diversion rate of 20 gallons per minute per well.

A battery of wells is defined as two or more wells connected to a common pump by a manifold; or not more than four wells in the same local source of supply within a 300 foot radius circle which are being operated by pumps not to exceed a total maximum diversion rate of 800 gallons per minute and which supply water to a common distribution system.

6. The owner of the point of diversion, if other than the applicant is (please print):

Whispering Lakes HOA, INC, 1900 E Douglas Ave, Ste 100, Wichita, KS 67214-4227
(name, address and telephone number)

(name, address and telephone number)

You must provide evidence of legal access to, or control of, the point of diversion from the landowner or the landowner's authorized representative. Provide a copy of a recorded deed, lease, easement or other document with this application. In lieu thereof, you may sign the following sworn statement:

I have legal access to, or control of, the point of diversion described in this application from the landowner or the landowner's authorized representative. I declare under penalty of perjury that the foregoing is true and correct.

Executed on April 17, 2023 [Signature]
Applicant's Signature

The applicant must provide the required information or signature irrespective of whether they are the landowner. Failure to complete this portion of the application will cause it to be unacceptable for filing and the application will be returned to the applicant.

7. The proposed project for diversion of water will consist of One well and one 4.3-acre pond
(number of wells, pumps or dams, etc.)
and was completed April 24, 2012
(Month/Day/Year - each was or will be completed)

8. The first actual application of water for the proposed beneficial use was or is estimated to be April 24, 2012
(Mo/Day/Year)

9. Will pesticide, fertilizer, or other foreign substance be injected into the water pumped from the diversion works?

Yes No If "yes", a check valve shall be required.

All chemigation safety requirements must be met including a chemigation permit and reporting requirements.

10. If you are planning to impound water, please contact the Division of Water Resources for assistance, prior to submitting the application. Please attach a reservoir area capacity table and inform us of the total acres of surface drainage area above the reservoir.

Have you also made an application for a permit for construction of this dam and reservoir with the Division of Water Resources? Yes No

• If yes, show the Water Structures permit number here N/A

• If no, explain here why a Water Structures permit is not required N/A

11. The application must be supplemented by a U.S.G.S. topographic map, aerial photograph or a detailed plat showing the following information. On the topographic map, aerial photograph, or plat, identify the center of the section, the section lines or the section corners and show the appropriate section, township and range numbers. Also, please show the following information:

(a) The location of the proposed point(s) of diversion (wells, stream-bank installations, dams, or other diversion works) should be plotted as described in Paragraph No. 5 of the application, showing the North-South distance and the East-West distance from a section line or southeast corner of section.

(b) If the application is for groundwater, please show the location of any existing water wells of any kind within 1/2 mile of the proposed well or wells. Identify each existing well as to its use and furnish the name and mailing address of the property owner or owners. If there are no wells within 1/2 mile, please advise us.

(c) If the application is for surface water, the names and addresses of the landowner(s) 1/2 mile downstream and 1/2 mile upstream from your property lines must be shown.

(d) The location of the proposed place of use should be shown by crosshatching on the topographic map, aerial photograph or plat.

(e) Show the location of the pipelines, canals, reservoirs or other facilities for conveying water from the point of diversion to the place of use.

A 7.5 minute U.S.G.S. topographic map may be obtained by providing the section, township and range numbers to: Kansas Geological Survey, 1930 Constant, Campus West, University of Kansas, Lawrence, Kansas 66047.

12. List any application, appropriation of water, water right, or vested right file number that covers the same diversion points or any of the same place of use described in this application. Also list any other recent modifications made to existing permits or water rights in conjunction with the filing of this application.

File No. _____

13. Furnish the following well information if the proposed appropriation is for the use of groundwater. If the well has not been completed, give information obtained from test holes, if available.

Information below is from: Test holes Well as completed Drillers log attached

Well location as shown in paragraph No.	(A)	(B)	(C)	(D)
Date Drilled	04/24/12	_____	_____	_____
Total depth of well	70'	_____	_____	_____
Depth to water bearing formation	2'	_____	_____	_____
Depth to static water level	13'	_____	_____	_____
Depth to bottom of pump intake pipe	70'	_____	_____	_____

14. The relationship of the applicant to the proposed place where the water will be used is that of Agent
(owner, tenant, agent or otherwise)

15. The owner(s) of the property where the water is used, if other than the applicant, is (please print):

Whispering Lakes HOA, INC, 1900 E Douglas Ave, Ste 100, Wichita, KS 67214-4227
(name, address and telephone number)

(name, address and telephone number)

16. The undersigned states that the information set forth above is true to the best of his/her knowledge and that this application is submitted in good faith.

Dated at 4-14-23, Kansas, this 14 day of April, 2023.
(month) (year)

[Signature]
(Applicant Signature)

By [Signature]
(Agent or Officer Signature)

Stephanu Avemy
(Print Name)

Assisted by JNE // ESII SFFO Date: 03/24/2023
(office/title)

APR 19 2023

FEE SCHEDULE

1. The fee for an application for a permit to appropriate water for beneficial use, except for domestic use, shall be (see paragraph No. 2 below if requesting storage):

ACRE-FEET	FEE
0-100	\$200.00
101-320	\$300.00
More than 320	\$300.00 plus \$20.00 for each additional 100 acre-feet or any part thereof.

2. The fee for an application in which storage is requested, except for domestic use, shall be:

ACRE-FEET	FEE
0-250	\$200.00
More than 250	\$200.00 plus \$20.00 for each additional 250 acre-feet of storage or any part thereof.

Note: If an application requests both direct use *and* storage, the fee charged shall be as determined under No. 1 or No. 2 above, whichever is greater, but not both fees.

3. The fee for an application for a permit to appropriate water for water power or dewatering purposes shall be \$100.00 plus \$200.00 for each 100 cubic feet per second, or part thereof, of the diversion rate requested.

Note: The applicant shall notify the Chief Engineer and pay the statutorily required field inspection fee of \$400.00 when construction of the works for diversion has been completed, except that for applications filed on or after July 1, 2009, for works constructed for sediment control use and for evaporation from a groundwater pit for industrial use shall be accompanied by a field inspection fee of \$200.00.

MAKE CHECKS PAYABLE TO THE KANSAS DEPARTMENT OF AGRICULTURE

ATTENTION

A Water Conservation Plan may be required per K.S.A. 82a-733. A statement that your application for permit to appropriate water may be subject to the minimum desirable streamflow requirements per K.S.A. 82a-703a, b, and c may also be required from you. After the Division of Water Resources has had the opportunity to review your application, you will be notified whether or not you will need to submit a Water Conservation Plan. You also may be required to install a water flow meter or water stage measuring device on your diversion works prior to diverting water. There may be other special conditions or Groundwater Management District regulations that you will need to comply with if this application is approved.

CONVERSION FACTORS

1 acre-foot equals 325,851 gallons

1 million gallons equal 3.07 acre-feet



Legend

- Water Appropriation
- Proposed Point of Diversion
- ⊕ Section Corner
- Section Line
- ▭ Half-Mile
- ▨ Proposed Place of Use

WATER RESOURCES RECEIVED

Application, File No. _____
36-27-2E // Sedgwick County

APR 19 2023

KS DEPT OF AGRICULTURE

Due to the large number of wells within 1/2 mile, the applicant requests a legal notification be published in the area newspaper for notification to nearby well owners.

[Handwritten Signature] 4-17-23

Signature / Date

03/24/2023 JNE/SFFO 1:12,000

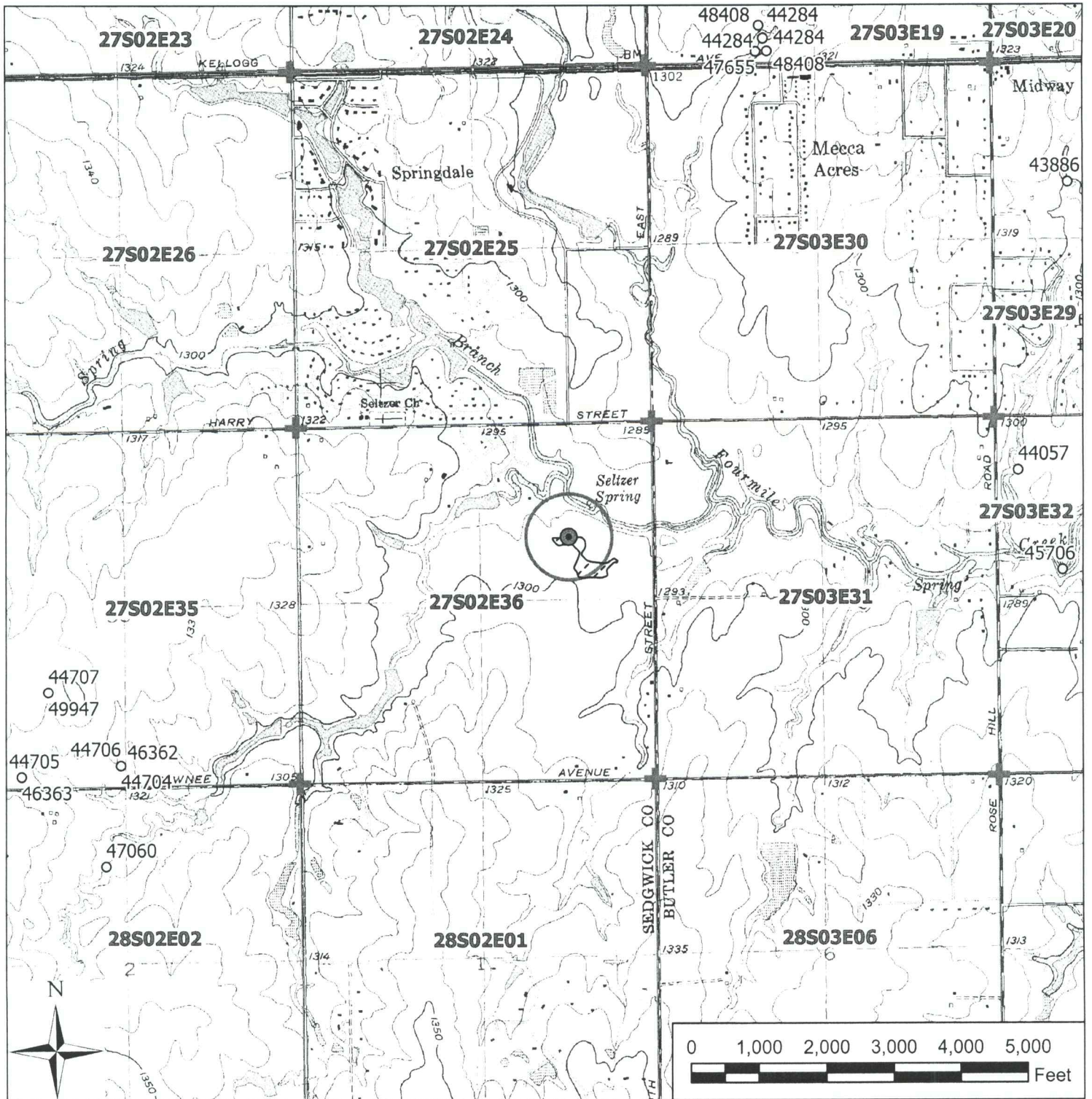

Legend

- Water Appropriation
- Proposed Point of Diversion
- ⊕ Section Corner
- ▭ Section Line
- ▭ Half-Mile
- ▨ Proposed Place of Use

Application, File No. _____
36-27-2E // Sedgwick County

WATER RESOURCES RECEIVED

APR 19 2023

Due to the large number of wells within 1/2 mile, the applicant requests a legal notification be published in the area newspaper for notification to nearby well owners.

KS DEPT OF AGRICULTURE

[Signature] 4-17-23

Signature / Date

03/24/2023 JNE/SFFO 1:24,000

APR 19 2023

RECREATIONAL USE SUPPLEMENTAL SHEET

File No. _____

Name of Applicant (Please Print): Whispering Lakes HOA INC

1. Please indicate type of recreational use (boating, fishing, swimming, etc.): _____

Aesthetic purposes

2. Please summarize how the water will be used and justify the quantity of water requested: _____

4.3 acre surface area x 19" (potential net evaporation) / 12"/ft = 6.8 acre-feet

3. Please complete the following table showing estimated future water requirements:

ESTIMATED FUTURE WATER DIVERTED/STORED	
NEXT 5 YEARS	WATER TO BE DIVERTED (ACRE-FEET OR GALLONS)
Year 1	6.8 AF
Year 2	6.8 AF
Year 3	6.8 AF
Year 4	6.8 AF
Year 5	6.8 AF

Please attach any additional information, tables, or curves showing past, present and estimated future water requirements to substantiate the amount of water requested.

4. Please designate the legal description of the location where the water is to be used by providing the fractional part of the Section, Township and Range.

4.3-acre pond located in the Northeast Quarter of Section 36, Township 27 South, Range 2 East,

Sedgwick County, Kansas

You may attach any additional information you believe will assist in informing the Division of the need for your request.

APR 19 2023

(Date)

Kansas Department of Agriculture
Division of Water Resources
David W. Barfield, Chief Engineer
1320 Research Park Drive
Manhattan, Kansas 66502

Re: Application
File No. _____

Minimum Desirable Streamflow

Dear Sir:

I understand that a Minimum Desirable Streamflow requirement has been established by the legislature for the source of supply to which the above referenced application applies.

I understand that diversion of water pursuant to this application will be subject to regulation any time Minimum Desirable Streamflow requirements are not being met.

I also understand that if this application is approved, there could be times, as determined by the Division of Water Resources, when I would not be allowed to divert water. I realize that this could affect the economics of my decision to appropriate water.

I am aware of the above factors, and with the knowledge thereof, request that the Division of Water Resources proceed with processing and approval, if possible, of the above referenced application.

[Signature]

Signature of Applicant

State of Kansas)
County of Sedgwick) ss

Stephan Avey

(Print Applicant's Name)

I hereby certify that the foregoing instrument was signed in my presence and sworn to before me this 14th day of April, 2023.

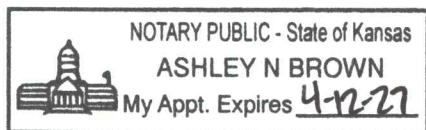

[Signature]

Notary Public

My Commission Expires:

APR 19 2003

**MINIMUM DESIRABLE STREAMFLOW FORM TO BE USED WHEN
APPLICABLE WHEN FILING AN APPLICATION FOR PERMIT KS DEPT OF AGRICULTURE
TO APPROPRIATE WATER FOR BENEFICIAL USE**

The Kansas Legislature has established minimum desirable streamflows for the streams listed below. If your proposed diversion of water is going to be from one of these watercourses or adjacent alluvial aquifers, please complete the back side of this page and submit it along with your application for permit to appropriate water.

Arkansas River
Big Blue River
Chapman Creek
Chikaskia River
Cottonwood River
Delaware River
Little Arkansas River
Little Blue River
Marais des Cygnes River
Medicine Lodge River
Mill Creek (Wabaunsee Co. area)
Neosho River

Ninnescah River
North Fork Ninnescah River
Rattlesnake Creek
Republican River
Saline River
Smoky Hill River
Solomon River
South Fork Ninnescah
Spring River
Walnut River
Whitewater River

WATER WELL RECORD

Form WWC-5

Division of Water Resources App. No.

1 LOCATION OF WATER WELL: County: <u>Sedgwick</u> Street/Rural Address of Well Location; if unknown, distance & direction from nearest town or intersection: If at owner's address, check here <input checked="" type="checkbox"/> .	Fraction: <u>1/4 NE 1/4 SW 1/4 NE 1/4</u>	Section Number: <u>36</u>	Township No.: <u>T 27 S</u>	Range Number: <u>R 7</u> <input checked="" type="checkbox"/> E <input type="checkbox"/> W
2 WATER WELL OWNER: <u>Whispering Lakes HOA</u> RR#, Street Address, Box #: <u>15314 E Rosewood St</u> City, State, ZIP Code: <u>Wichita, KS</u>		Global Positioning System (GPS) information: Latitude: (in decimal degrees) Longitude: (in decimal degrees) Elevation: Datum: <input type="checkbox"/> WGS 84, <input type="checkbox"/> NAD 83, <input type="checkbox"/> NAD 27 Collection Method: <input type="checkbox"/> GPS unit (Make/Model:) <input type="checkbox"/> Digital Map/Photo, <input type="checkbox"/> Topographic Map, <input type="checkbox"/> Land Survey Est. Accuracy: <input type="checkbox"/> <3 m, <input type="checkbox"/> 3-5 m, <input type="checkbox"/> 5-15 m, <input type="checkbox"/> >15 m		

3 LOCATE WELL WITH AN "X" IN SECTION BOX: N <table border="1" style="width: 100%; height: 100px; text-align: center;"> <tr><td> </td><td> </td><td> </td></tr> <tr><td> </td><td> </td><td> </td></tr> <tr><td> </td><td> </td><td> </td></tr> </table> S -----1 mile-----										4 DEPTH OF COMPLETED WELL <u>70</u> ft. Depth(s) Groundwater Encountered (1)..... ft. (2)..... ft. (3)..... ft. WELL'S STATIC WATER LEVEL..... <u>13</u> ft. below land surface measured on mo/day/yr..... Pump test data: Well water was.....ft. after..... hours pumping..... gpm EST. YIELD.....gpm. Well water was.....ft. after..... hours pumping..... gpm Bore Hole Diameter .. <u>12</u> in. toft., andin. toft. WELL WATER TO BE USED AS: <input type="checkbox"/> Public water supply <input type="checkbox"/> Geothermal <input type="checkbox"/> Injection well <input type="checkbox"/> Domestic <input type="checkbox"/> Feedlot <input type="checkbox"/> Oil field water supply <input type="checkbox"/> Dewatering <input type="checkbox"/> Other (Specify below) <input type="checkbox"/> Irrigation <input type="checkbox"/> Industrial <input checked="" type="checkbox"/> Domestic-lawn & garden <input type="checkbox"/> Monitoring well Was a chemical/bacteriological sample submitted to Department? <input type="checkbox"/> Yes <input checked="" type="checkbox"/> No If yes, mo/day/yr sample was submitted..... Water well disinfected? <input checked="" type="checkbox"/> Yes <input type="checkbox"/> No

5 TYPE OF CASING USED: Steel PVC Other

CASING JOINTS: Glued Clamped Welded Threaded

Casing diameter 5 in. to 70 ft., Diameter in. to ft., Diameter in. to ft.

Casing height above land surface..... 16 in., Weight 16.0 lbs./ft., Wall thickness or gauge No.

TYPE OF SCREEN OR PERFORATION MATERIAL:
 Steel Stainless Steel PVC Other (Specify)
 Brass Galvanized Steel None used (open hole)

SCREEN OR PERFORATION OPENINGS ARE:
 Continuous slot Mill slot Gauze wrapped Torch cut Drilled holes None (open hole)
 Louvered shutter Key punched Wire wrapped Saw cut Other (specify)

SCREEN-PERFORATED INTERVALS: From..... 30 ft. to 70 ft., From ft. to ft.
 From..... ft. to ft., From ft. to ft.

GRAVEL PACK INTERVALS: From..... 24 ft. to 70 ft., From ft. to ft.
 From..... ft. to ft., From ft. to ft.

6 GROUT MATERIAL: Neat cement Cement grout Bentonite Other

Grout Intervals: From..... 4 ft. to 24 ft., From ft. to ft., From ft. to ft.

What is the nearest source of possible contamination:
 Septic tank Lateral lines Pit privy Livestock pens Insecticide storage Other (specify below)
 Sewer lines Cesspool Sewage lagoon Fuel storage Abandoned water well
 Watertight sewer lines Seepage pit Feedyard Fertilizer storage Oil well/gas well

Direction from well North Distance from well 40'

FROM	TO	LITHOLOGIC LOG	FROM	TO	LITHO. LOG (cont.) or PLUGGING INTERVALS
0	2	Top Soil			
2	13	Clay			
13	67	Shale			
67	70	Lime Stone			

7 CONTRACTOR'S OR LANDOWNER'S CERTIFICATION: This water well was constructed, reconstructed, or plugged under my jurisdiction and was completed on (mo/day/year) 4-24-12 and this record is true to the best of my knowledge and belief.

Kansas Water Well Contractor's License No. 11 This Water Well Record was completed on (mo/day/year) 5-1-12 under the business name of Chase Drilling by (signature) [Signature]

INSTRUCTIONS: Use typewriter or ball point pen. PLEASE PRESS FIRMLY and PRINT clearly. Please fill in blanks and check the correct answers. Send three copies (white, blue, pink) to Kansas Department of Health and Environment, Bureau of Water, Geology Section, 1000 SW Jackson St., Suite 420, Topeka, Kansas 66612-1367. Telephone 785-296-5524. Send one copy to WATER WELL OWNER and retain one for your records. Include fee of \$5.00 for each constructed well. Visit us at <http://www.kdheks.gov/waterwell/index.html>.

DATA ENTRY SYSTEM ID NUMBER SHEET

FILE NUMBER 51017

APPLICANT PERSON ID & SEQ #	PDIV ID	BATTERY ID
68992	90291	

LANDOWNER PERSON ID & SEQ #	PUSE ID
68992	71355

WATER USE CORRESPONDENT PERSON ID & SEQ #
68992