

APR 24 2024

13:25

KS Dept. of Agriculture



State of Kansas

Submit To: CHIEF ENGINEER
Division of Water Resources
Kansas Department of Agriculture
1320 Research Park Drive
Manhattan, Kansas 66502
http://agriculture.ks.gov/dwr

APPLICATION FOR APPROVAL TO CHANGE THE PLACE OF USE, THE POINT OF DIVERSION OR THE USE MADE OF THE WATER UNDER AN EXISTING WATER RIGHT

Filing Fee Must Accompany the Application (Please refer to Fee Schedule on signature page of application form.)

Paragraph Nos. 1, 2, 3, 4 & 8 must be completed. Complete all other applicable portions. A topographic map or detailed plat showing the authorized and proposed points(s) of diversion and /or place of use must accompany this application.

1. Application is hereby made for approval of the Chief Engineer to change the

- Place of Use
Point of Diversion
Use Made of Water

File No. 13882

2. Name of applicant: Skybound, LP

Address: 2450 Hwy 86

City, State and Zip: Friona, TX 79035

Phone Number: (806) 265-3310 E-mail address: harryd@blueskyfarms.com

What is your relationship to the water right; owner tenant agent other? If other, please explain.

Name of water use correspondent: Skybound, LP

Address: 2450 Hwy. 86

City, State and Zip: Friona, TX 79035

Phone Number: (806) 265-3310 E-mail address: harryd@blueskyfarms.com

3. The change(s) proposed herein are desired for the following reasons (please be specific): Change in use made of water for dual use for stockwater and irrigation use to support new dairy and add dairy site as place of use.

The change(s) (was) (will be) completed by Upon construction of dairy that has been approved of KDHE Livestock Waste Permit for Blue Sky Farms.

For Office Use Only: F.O. 2 GMD 5 Meets K.A.R. 5-5-1 (YES) NO Use IRR Source G/S County ED By KJN Date 4/29/24 Code C-2 Fee \$ 500 TR # Receipt Date 4-24-24 Check # 16149

PDIV: 27217

5/1/2024 KAnderson

APR 24 2024

4. The presently authorized place of use is:

Owner of Land — NAME: Skybound, LP KS Dept. of Agriculture
ADDRESS: 2450 Hwy. 86, Friona, TX 79035

Sec.	Twp.	Range	NE¼				NW¼				SW¼				SE¼				TOTAL ACRES
			NE¼	NW¼	SW¼	SE¼	NE¼	NW¼	SW¼	SE¼	NE¼	NW¼	SW¼	SE¼	NE¼	NW¼	SW¼	SE¼	
17	25S	17W					40	40	40	40									160

List any other water rights that cover this place of use. _____

Owner of Land — NAME: _____
ADDRESS: _____

Sec.	Twp.	Range	NE¼				NW¼				SW¼				SE¼				TOTAL ACRES
			NE¼	NW¼	SW¼	SE¼	NE¼	NW¼	SW¼	SE¼	NE¼	NW¼	SW¼	SE¼	NE¼	NW¼	SW¼	SE¼	

List any other water rights that cover this place of use. _____

(If there are more than two landowners, attach additional sheets as necessary.)

5. It is proposed that the place of use be changed to:

Owner of Land — NAME: Skybound, LP
ADDRESS: 2450 Hwy 86, Friona, TX 79035

Sec.	Twp.	Range	NE¼				NW¼				SW¼				SE¼				TOTAL ACRES
			NE¼	NW¼	SW¼	SE¼	NE¼	NW¼	SW¼	SE¼	NE¼	NW¼	SW¼	SE¼	NE¼	NW¼	SW¼	SE¼	
17 (IRR)	25S	17W					40	40	40	40									160
18 (STK)	25S	17W	X	X	X	X	X	X	X	X	X	X				X			
			(N/2, N/2 OF SW¼ AND NW¼PT OF SE¼)																

List any other water rights that cover this place of use. for STK POU - 13882, 17726, 17727, 20114, 30699, 30700, 17730, 20113, 17728, 17729, 22824, 17725, 17731, 17732, 21391, 22822, 22823, 30254, 30698, 36724

Owner of Land — NAME: _____
ADDRESS: _____

Sec.	Twp.	Range	NE¼				NW¼				SW¼				SE¼				TOTAL ACRES
			NE¼	NW¼	SW¼	SE¼	NE¼	NW¼	SW¼	SE¼	NE¼	NW¼	SW¼	SE¼	NE¼	NW¼	SW¼	SE¼	

List any other water rights that cover this place of use. _____

IF MORE SPACE IS NEEDED, ATTACH ADDITIONAL SHEETS AS NECESSARY

6. The presently authorized point(s) of diversion (is) (are) 1 Well - IRR
(Provide description and number of points)
7. The proposed point(s) of diversion (is) (are) 1 Well - IRR/STK
(Provide description and number of points)

WATER RESOURCES
 RECEIVED
 APR 24 2024

List all presently authorized point(s) of diversion:

8. **Presently authorized point of diversion:**
 One in the _____ Quarter of the NC Quarter of the NW Quarter
 of Section 17, Township 25 South, Range 17 (E/W),
 in Edwards County, Kansas, n/a feet North n/a feet West of Southeast corner of section.
 Authorized Rate 9 1 5 g p m Authorized Quantity 221 ac-ft
 (DWR use only: Computer ID No. _____ GPS _____ feet North _____ feet West)
 This point will not be changed This point will be changed as follows:
Proposed point of diversion: (Complete only if change is requested)
 One in the _____ Quarter of the _____ Quarter of the _____ Quarter
 of Section _____, Township _____ South, Range _____ (E/W),
 in _____ County, Kansas, _____ feet North _____ feet West of Southeast corner of section.
 Proposed Rate _____ Proposed Quantity _____
 This point is: Additional Well Geo Center List other water rights that will use this point _____

9. **Presently authorized point of diversion:**
 One in the _____ Quarter of the _____ Quarter of the _____ Quarter
 of Section _____, Township _____ South, Range _____ (E/W),
 in _____ County, Kansas, _____ feet North _____ feet West of Southeast corner of section.
 Authorized Rate _____ Authorized Quantity _____
 (DWR use only: Computer ID No. _____ GPS _____ feet North _____ feet West)
 This point will not be changed This point will be changed as follows:
Proposed point of diversion: (Complete only if change is requested)
 One in the _____ Quarter of the _____ Quarter of the _____ Quarter
 of Section _____, Township _____ South, Range _____ (E/W),
 in _____ County, Kansas, _____ feet North _____ feet West of Southeast corner of section.
 Proposed Rate _____ Proposed Quantity _____
 This point is: Additional Well Geo Center List other water rights that will use this point _____

10. **Presently authorized point of diversion:**
 One in the _____ Quarter of the _____ Quarter of the _____ Quarter
 of Section _____, Township _____ South, Range _____ (E/W),
 in _____ County, Kansas, _____ feet North _____ feet West of Southeast corner of section.
 Authorized Rate _____ Authorized Quantity _____
 (DWR use only: Computer ID No. _____ GPS _____ feet North _____ feet West)
 This point will not be changed This point will be changed as follows:
Proposed point of diversion: (Complete only if change is requested)
 One in the _____ Quarter of the _____ Quarter of the _____ Quarter
 of Section _____, Township _____ South, Range _____ (E/W),
 in _____ County, Kansas, _____ feet North _____ feet West of Southeast corner of section.
 Proposed Rate _____ Proposed Quantity _____
 This point is: Additional Well Geo Center List other water rights that will use this point _____

11. Describe the current condition of and future plans for any point(s) of diversion which will no longer be used. _____

IF MORE SPACE IS NEEDED, ATTACH ADDITIONAL SHEETS AS NECESSARY

APR 24 2024

File No. 13882

12. The presently authorized use of water is for IRR KS Dept. of Agriculture purposes.
It is proposed that the use be changed to IRR/STK purposes.
13. If changing the place of use and/or use made of water, describe how the consumptive use will not be increased.
As per KAR 5-5-9, 83.4% consumptive use percentage for Edwards County
IRR to STK > 221 ac-ft * 83.4% = 184.31 ac-ft or 60.059 MGY STK or IRR to be authorized
Should a future request for change in use made of water be filed for IRR, then the limited amount will go away and
the authorized quantity be retained at 221 ac-ft for IRR. No reduction in total acres as majority of the operation of
this water right will continue as irrigation use and the effluent will return to the irrigated land. Therefore, no increase
(Please show any calculations here.) in consumptive use with same net acres.
14. It is requested that the maximum annual quantity of water be reduced to N/A (acre-feet or million gallons).
15. It is requested that the maximum rate of diversion of water be reduced to N/A gallons per minute (c.f.s.).
16. The application must include either a topographic map or detailed plat. A U.S. Geological Survey Topographic Map, scale 1:24,000, is available through the Kansas Geological Survey, 1930 Constant Avenue, University of Kansas, Lawrence, Kansas 66047-3726 (www.usgs.gov). The map should show the location of the presently authorized point(s) of diversion. Distances North and West of the Southeast corner of the section must be shown. The presently authorized place of use should also be shown. Identify the center of the section, the section lines and the section corners and show the appropriate section, township, and range numbers on the map. In addition the following information must also be shown on the map.
- a. If a change in the location of the point(s) of diversion is proposed, show:
- 1) The location of the proposed point(s) of diversion. Distances North and West of the Southeast corner of the section must be shown. Please be certain that the information shown on the map agrees with the information shown in Paragraph Nos. 9, 10 and 11 of the application.
 - 2) If the source of supply is groundwater, please show the location of existing water wells of any kind, including domestic wells, within 1/2 mile of the proposed well or wells. Identify each well as to its use and furnish name and mailing address of the property owner or owners. If there are no wells within 1/2 mile, please indicate so on the map.
 - 3) If the source of supply is surface water, the names and mailing addresses of all landowner(s) 1/2 mile downstream and 1/2 mile upstream from your property lines must be shown.
- b. If a change in the place of use is desired, show the proposed place of use by crosshatching on the map. Please be certain that the information shown on the map agrees with the information shown in Paragraph No. 5 of the application.
17. Attach documentation to show the change(s) proposed herein will not impair existing water rights and relates to the same local source of supply as to which the water right relates. This information may include statements, plats, geology reports, well logs, test hole logs, and other information as necessary information to show the above. Additional comments may be made below.
No change in source of supply or local source of supply proposed.

18. If the proposed change(s) does not meet all applicable rules and regulations of the Kansas Water Appropriation Act, please identify the rules and regulations for which you request a waiver. State the reason why a waiver is needed and why the request should be granted. Attach documentation showing that granting the request will not impair existing water rights and will not prejudicially and unreasonably affect the public interest.

IF MORE SPACE IS NEEDED, ATTACH ADDITIONAL SHEETS AS NECESSARY

APR 24 2024

File No. 13882

KS Dept. of Agriculture

Any use of water that is not as authorized by the water right or permit to authorize water before the chief engineer approves this application is a violation of the Kansas Water Appropriation Act for which criminal or civil penalties may be assessed. Such violation is a class C misdemeanor, punishable by a fine not to exceed \$500 and/or a term of confinement not to exceed one month in the county jail. K.S.A. 82a-728(b). Civil penalties shall be not less than \$100 nor more than \$1,000 per violation. In the case of a continuing violation, each day such violation continues may be deemed a separate violation. In addition to these penalties the water right may be modified or suspended. K.S.A. 82a-737, as amended.

The application must be signed by all owners of the place of use authorized under the water right and his or her spouse, if married. Please indicate if there is no spouse. If land is being purchased under contract, the seller must sign as landowner until such time as the contract is completed.

In the event that all applicants cannot appear before one notary public, they may as necessary sign separate copies of the application before any notary public conveniently available to them. All copies signed in this manner shall be considered to be valid parts of the application.

If the request is signed on behalf of any Owner by someone with legal authority to do so (for example, an agent, one who has power of attorney, or an executor, executrix, conservator), it will be necessary to attach proper documents showing such authority.

I declare that I am an owner of the currently authorized place of use as identified herein, or that I represent all such owners and am authorized to make this application on their behalf, and declare further that the statements contained herein are true, correct, and complete. By filing this application I authorize the chief engineer to permanently reduce the quantity of water and/or rate of diversion as specified in sections 14 and 15 of this application.

Dated at Amarillo, ^{TX} Kansas, this 28 day of March, 2024.

[Signature] (Owner) _____ (Spouse) _____

Skybound, LP, by Harry DeWit, Pres. of its GP (Please Print) _____ (Please Print) _____

_____ (Owner) _____ (Spouse)

_____ (Please Print) _____ (Please Print)

_____ (Owner) _____ (Spouse)

_____ (Please Print) _____ (Please Print)

State of Texas }
County of Randall } SS

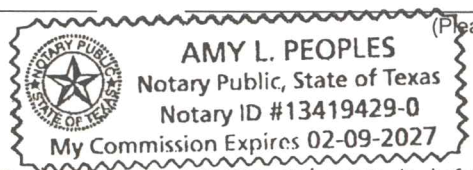

I hereby certify that the foregoing application was signed in my presence and sworn to before me this 28 day of March, 2024.

[Signature]
Notary Public

My Commission Expires 02-09-2027.

FEE SCHEDULE

Each application to change the place of use, the point of diversion or the use made of the water under this section shall be accompanied by the application fee set forth in the schedule below:

- (1) Application to change a point of diversion 300 feet or less \$100
- (2) Application to change a point of diversion more than 300 feet \$200
- (3) Application to change the place of use \$200
- (4) Application to change the use made of the water \$300

Make check payable to Kansas Department of Agriculture.

APR 24 2024

KS Dept. of Agriculture

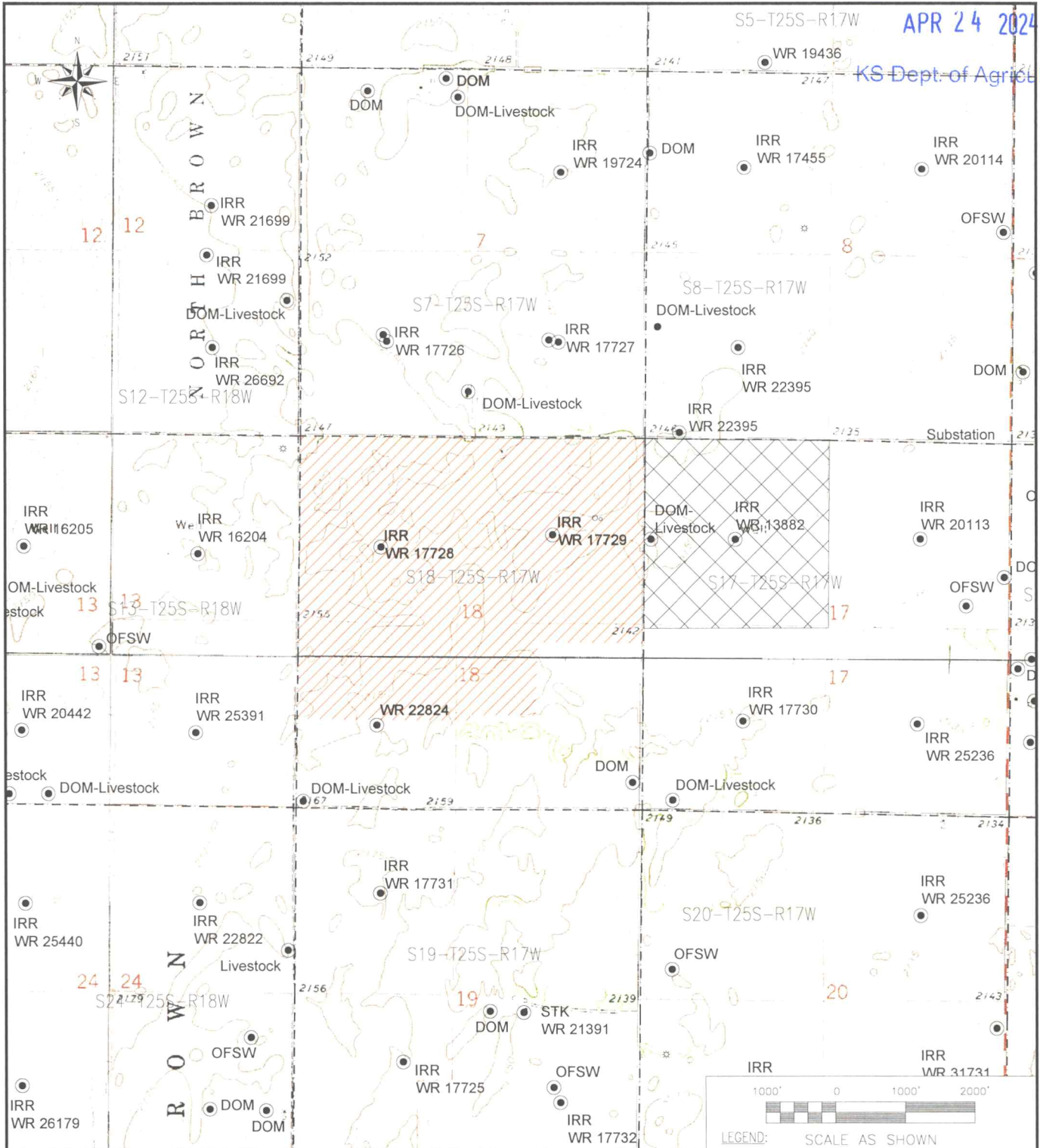

- Wells off the subject properties are shown based on KGS Interactive Map – Kansas Water Wells WWC5.
 - Change in Place of Use under Files: 13882
 - Proposed Dual Use IRR/STK. Stock use requested for Section 18–Proposed Dairy Location.
- Source: USDA–NRCS. Geospatial Data Gateway. Available at: <http://datagateway.nrcs.usda.gov/>. Digital Raster Graphic County Mosaic by NRCS – Accessed 03/2022. from download document the source scale denominator is 24,000.

IRR

LEGEND: SCALE AS SHOWN

- Denotes Sections/Section Corners
- /// Denotes Approved Place of Use
- /// Denotes Requested Place of Use for STK
- /// Denotes Requested Place of Use for IRR
- Denotes Well

Skybound, LP
Lewis, KS
Edwards County

DWR Change Application-WR 13882
Figure 1
Date: Mar 2024

ENVIRO-AG
EAE
ENGINEERING, INC.

Enviro-Ag Engineering, Inc.
ENGINEERING CONSULTANTS
3404 Airway Boulevard
AMARILLO, TEXAS 79118
TEL (806) 353-6123 FAX (806) 353-4132

<u>WELL_ID/PDIV</u>		<u>TOWNSHIP</u>	<u>TWN_DIR</u>	<u>RANGE</u>	<u>RANGE_DIR</u>	<u>SECTION</u>	<u>SPOT</u>	<u>LONGITUDE</u>	<u>LATITUDE</u>	<u>OWNER*</u>	<u>ADDRESS*</u>	<u>WELL USE</u>
<u>ID</u>	<u>COUNTY</u>											
13835	Edwards	25	S	17	W	8	SE NE SE	-99.20644	37.888032	D. R. Lauck Oil Co.	221 S Broadway Suite 400, Wichita, KS 67202	Oil Field Water Supply
102009	Edwards	25	S	17	W	8	SW NW SW	-99.22242	37.88813	McLean, Doug	101 Marsh Ave, Kinsley, KS 67547	Domestic, Livestock
395683	Edwards	25	S	17	W	8	SW SW SW	-99.22243	37.884517	McLean, Doug	101 Marsh Ave, Kinsley, KS 67547	Irrigation
13874	Edwards	25	S	17	W	17	C SE NE	-99.20763	37.878065	H-30 Drilling, Inc.	200 N Main, Wichita, KS 67202	Oil Field Water Supply
32786	Edwards	25	S	17	W	17	NE NC	-99.21033	37.87984	Skybound, LP	2450 Hwy 86, Friona, TX 79035	Irrigation
13873	Edwards	25	S	17	W	17	C SE	-99.20994	37.8726204	McLean, Doug	PO Box 560, Norton, KS 67654	Irrigation
47258	Edwards	25	S	17	W	17	SE NC	-99.21045	37.8726	TDN, LP	PO Box 560, Norton, KS 67654	Irrigation
452488	Edwards	25	S	17	W	17	SW SW SW	-99.22249	37.8699935	Skybound, LP	2450 Hwy 86, Friona, TX 79035	Domestic, Livestock
6568	Edwards	25	S	17	W	17	SW NC	-99.21947	37.8727	Skybound, LP	2450 Hwy 86, Friona, TX 79035	Irrigation
455110	Edwards	25	S	17	W	7	SE NE SE	-99.22463	37.8881366	Skybound, LP	2450 Hwy 86, Friona, TX 79035	Irrigation
	Edwards	25	S	17	W	18	map in Section			Skybound, LP	2450 Hwy 86, Friona, TX 79035	

Data obtained from the WWCs Water Well Database Query and WIMAS Water Rights Database (<https://kgs.ku.edu/water-resources-and-geohydrology/>)
 *Well Owner as noted on WWCs database and Addresses obtained from the Open Records for Kansas Appraisers - Edwards County (<https://www.kansasgis.org/orka/map.cfm>) OR from the well log obtained from WWCs Database Query (<https://www.kgs.ku.edu/Magellan/WaterWell/index.html>)

WATER RESOURCES
 RECEIVED
 APR 24 2024
 KS Dept. of Agriculture



Corporate Office:
3404 Airway Blvd.
Amarillo TX 79118

Central Texas:
9855 FM 847
Dublin TX 76446

New Mexico:
110 East Mill Road
Artesia NM 88210

April 19, 2024

Chief Engineer
Division of Water Resources
Kansas Department of Agriculture
1320 Research Park Drive
Manhattan, KS 66502

WATER RESOURCES
RECEIVED
APR 24 2024
KS Dept. of Agriculture

Re: Application for Approval to Change the Place of Use and Use Made of
Water for Water Right File Nos. 13882 and 36724 – Edwards County, KS

Dear Chief Engineer,
Attached are applications for approval to change the place of use and use
made of water to dual use for irrigation and stock for the above referenced Water
Right Files. The appropriate application fees are attached.

If you have any questions or require additional information, please give me a call
at 806/350-5463 or email me at mshoemaker@enviroag.com.

Sincerely,

Marsha Shoemaker

Marsha Shoemaker
Enviro-Ag Engineering, Inc.

Enclosures

Cc: Skybound, LP