

Submit completed application to:  
 Kansas Department of Agriculture  
 Division of Water Resources  
 Field Office for your area.

Call for address:  
 Topeka - (785) 296-5733  
 Stafford - (620) 234-5311  
 Stockton - (785) 425-6787  
 Garden City - (620) 276-2901  
<http://agriculture.ks.gov/dwr>

## DWR FIELD OFFICE APPLICATION FOR APPROVAL TO CHANGE THE PLACE OF USE AND/OR THE POINT OF DIVERSION WATER METER REQUIRED



STATE OF KANSAS

Filing Fee Must Accompany the Application, K.S.A. 82a-708b(b), as amended.  
 Fee Schedule is on the third page of this application form.

Paragraph Nos. 1, 2, 3 & 5 must be completed. Complete all other applicable portions. If change in point of diversion is greater than 100 feet, or if place of use will be changed, include a topographic map or detailed plat showing the authorized and proposed point(s) of diversion and/or place of use.

File No. 38917

RECEIVED  
 10:16 am  
 APR 08 2024

1. Application is hereby made for approval of the Chief Engineer to change the (check one or both):

Place of Use                       Point of Diversion

under the water right which is the subject of this application in accordance with the conditions described below.

The source of supply is:                       Groundwater                       Surface water

Stafford Field Office  
 Division of Water Resources

2. Name and address of Applicant: Bowman Enterprises LLC

Wilroads Feed Yard, 11449 Lariat Way, Dodge City KS 67801-6694

Phone Number: (620)225-3960                      Email address: travis@wvllc.com

Name and address of Water Use Correspondent: Bowman Enterprises LLC

Wilroads Feed Yard, 11449 Lariat Way, Dodge City KS 67801-6694

Phone Number: (620)225-3960                      Email address: travis@wvllc.com

3. The presently authorized place of use is:

Owner of Land --- NAME: Bowman Enterprises LLC

ADDRESS: Wilroads Feed Yard, 11449 Lariat Way, Dodge City KS 67801-6694

(If there is more than one landowner, attach supplemental sheets as necessary.)

Sec.	Twp.	Range	NE¼				NW¼				SW¼				SE¼				TOTAL ACRES
			NE¼	NW¼	SW¼	SE¼	NE¼	NW¼	SW¼	SE¼	NE¼	NW¼	SW¼	SE¼	NE¼	NW¼	SW¼	SE¼	
No	Change																		

4. If this application is for a change in place of use, it is proposed that the place of use be changed to:

Owner of Land --- NAME: No Change

ADDRESS: \_\_\_\_\_

(If there is more than one landowner, attach supplemental sheets as necessary.)

Sec.	Twp.	Range	NE¼				NW¼				SW¼				SE¼				TOTAL ACRES
			NE¼	NW¼	SW¼	SE¼	NE¼	NW¼	SW¼	SE¼	NE¼	NW¼	SW¼	SE¼	NE¼	NW¼	SW¼	SE¼	

For Office Use Only: Code _____	Fee \$ <u>200</u>	TR # _____	Receipt Date _____	Check # <u>CC</u>
---------------------------------	-------------------	------------	--------------------	-------------------

5. **Presently authorized point of diversion:**  
 One in the Northeast Quarter of the Southwest Quarter of the Northwest Quarter of Section 9, Township 27 South, Range 24 W, in Ford County, Kansas, 3,651 feet North 4,198 feet West of Southeast corner of section.  
 Authorized Rate 50 gpm Authorized Quantity 8.15 mgv Depth of well 174 (feet)  
 (DWR use only: Computer ID No. 10 GPS N/A feet North N/A feet West)  
 This point will not be changed  This point will be changed as follows:  No change, point better described with GPS as follows:  
**Proposed point of diversion: (Complete only if change is requested or if existing point is better described by GPS)**  
 One in the Northeast Quarter of the Northeast Quarter of the Southeast Quarter of Section 9, Township 27 South, Range 24 W, in Ford County, Kansas, 2,077 feet North 411 feet West of Southeast corner of section.  
 Proposed Rate no change Proposed Quantity no change Proposed well depth (feet) ~225.  
 This point is:  Additional Well  Geo Center List other water rights that will use this point 19521-D1.

6. **Presently authorized point of diversion:**  
 One in the \_\_\_\_\_ Quarter of the \_\_\_\_\_ Quarter of the \_\_\_\_\_ Quarter of Section \_\_\_\_\_, Township \_\_\_\_\_ South, Range \_\_\_\_\_ (E/W), in \_\_\_\_\_ County, Kansas, \_\_\_\_\_ feet North \_\_\_\_\_ feet West of Southeast corner of section.  
 Authorized Rate \_\_\_\_\_ Authorized Quantity \_\_\_\_\_ Depth of well \_\_\_\_\_ (feet)  
 (DWR use only: Computer ID No. \_\_\_\_\_ GPS \_\_\_\_\_ feet North \_\_\_\_\_ feet West)  
 This point will not be changed  This point will be changed as follows:  No change, point better described with GPS as follows:  
**Proposed point of diversion: (Complete only if change is requested or if existing point is better described by GPS)**  
 One in the \_\_\_\_\_ Quarter of the \_\_\_\_\_ Quarter of the \_\_\_\_\_ Quarter of Section \_\_\_\_\_, Township \_\_\_\_\_ South, Range \_\_\_\_\_ (E/W), in \_\_\_\_\_ County, Kansas, \_\_\_\_\_ feet North \_\_\_\_\_ feet West of Southeast corner of section.  
 Proposed Rate \_\_\_\_\_ Proposed Quantity \_\_\_\_\_ Proposed well depth (feet) \_\_\_\_\_.  
 This point is:  Additional Well  Geo Center List other water rights that will use this point \_\_\_\_\_.

7. The changes herein are desired for the following reasons?  
 (please be specific) Move File No. 38917 to existing well under File No. 19251-D1 to consolidate the water rights. No new well will be drilled.

8. If a well, is the test hole log attached?  Yes  No

9. The change(s) (was)(will be) completed by?  
Upon approval of change application

10. If the point of diversion is a well:  
 (a) What are you going to do with the old well?  
Plug it  
 (b) When will this be done? ASAP

11. Groundwater Management District recommendation attached?  
 Yes  No

12. Assisted by EKF/SFFO

13a. If the proposed point of diversion will be relocated more than 300 feet but within 2,640 feet of the existing point of diversion, attach a topographic map or aerial photograph. For groundwater sources, show all wells (including domestic) within one-half mile of the proposed point of diversion and the names and mailing addresses of the owners. For surface water sources, show the names and addresses of the landowner(s) one-half mile downstream and one-half mile upstream from your property lines

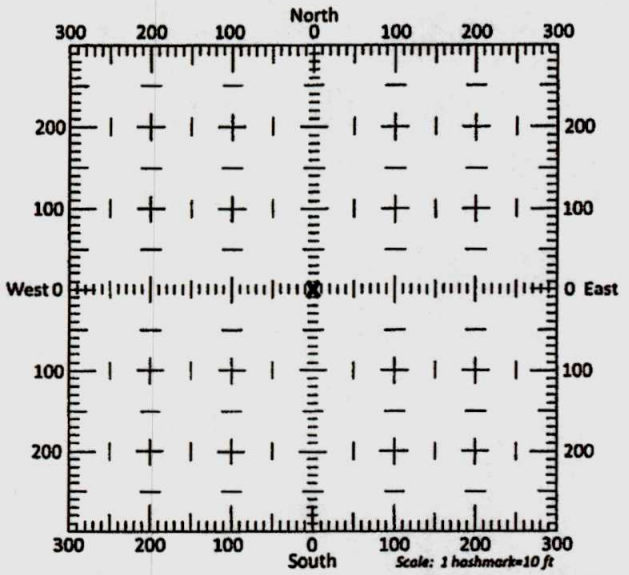

13b. If the proposed point of diversion will be relocated within 300 feet of the existing point of diversion, indicate its location on the diagram shown above in relation to the existing point of diversion. (PLEASE NOTE: The "X" in center of diagram above represents the presently authorized point of diversion.)

RECEIVED

APR 08 2024

14. If the proposed groundwater point of diversion is 300 or fewer feet from the existing point of diversion, complete the following:

- (a) Does the undersigned represent all owners of the currently authorized place(s) of use identified in this application?  
 Yes     No    (If no, all owners must sign this application.)
- (b) Will the ownership interest of any owner of the currently authorized place(s) of use identified in this application be adversely affected if this application is approved as requested?  
 Yes     No    (If yes, all owners must sign this application.)
- (c) If this application is not approved expeditiously, will there be substantial damage to property, public health or safety?  
 Yes     No    (If no, all owners must sign this application.)

If the application proposes a surface water change in point of diversion, a groundwater change in point of diversion greater than 300 feet, or a change in place of use, the application must be signed by all owners of the currently authorized place of use, or their duly authorized agent (attach notarized statement authorizing representation).

I hereby verify, being first duly sworn upon my oath or affirmation and under penalty of perjury, that I am of lawful age and the owner, the spouse of the owner, or a duly authorized agent of the owner(s) to make this application on their behalf, in regards to the water right(s) to which this application pertains. I further verify that the statements contained in this application are true, correct and complete.

Dated at \_\_\_\_\_, Kansas, this 5<sup>th</sup> day of April, 2024.

[Signature]  
 \_\_\_\_\_  
 (Owner)  
 \_\_\_\_\_  
 (Please Print)  
 \_\_\_\_\_  
 (Owner)  
 \_\_\_\_\_  
 (Please Print)  
 \_\_\_\_\_  
 (Owner)  
 \_\_\_\_\_  
 (Please Print)

\_\_\_\_\_  
 (Spouse)  
 \_\_\_\_\_  
 (Please Print)  
 \_\_\_\_\_  
 (Spouse)  
 \_\_\_\_\_  
 (Please Print)  
 \_\_\_\_\_  
 (Spouse)  
 \_\_\_\_\_  
 (Please Print)

State of Kansas }  
County of Ford } SS

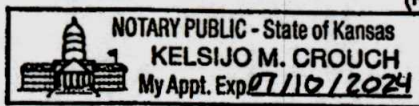

I hereby certify that the foregoing application was signed in my presence and sworn to before me this 5<sup>th</sup> day of April, 2024.

Kelsijo M. Crouch  
Notary Public

My Commission Expires 07/10/2024.

**ONLY COMPLETE APPLICATIONS WILL BE PROCESSED.** To be complete, all of the applicable portions of the application form must be completed with accurate information; maps, if necessary, must be included; signatures of all the appropriate owners' must be affixed to the application and notarized; and the appropriate fee must be paid.

**FEE SCHEDULE**

Each application to change the place of use or the point of diversion under this section shall be accompanied by the application fee set forth in the schedule below: Make checks payable to: **Kansas Department of Agriculture**

- (1) Application to change a point of diversion 300 feet or less ..... \$100
- (2) Application to change a point of diversion more than 300 feet ..... \$200
- (3) Application to change the place of use ..... \$200

RECEIVED

APR 08 2024

**SUMMARY ORDER APPROVING APPLICATION FOR CHANGE AND IMPOSING CONDITIONS**

This Summary Order is issued under authority of K.S.A. 82a-708b, as amended, and K.A.R. 5-5-1, et seq. and other applicable provisions of the *Kansas Water Appropriation Law, K.S.A. 82a-701 et. seq.*, and rules and regulations promulgated thereunder. With the exception of those conditions expressly contained herein, this Summary Order does not change the terms, conditions and limitations of File No. 38197

1. A change application was received on April 4, 2024 requesting that the place of use and / or point of diversion authorized under the above-referenced file number be changed as described in the application.
2. On and after the effective date of this summary order, the authorized place(s) of use shall be located substantially as shown on the topographic map accompanying the application to change the place of use.  Applicable  Not Applicable
3. The change in point of diversion shall not impair existing rights and shall be limited to the same source or sources of water as previously authorized. The point of diversion authorized by this summary order shall be located within a 300 foot radius of the authorized point(s) of diversion.  Applicable  Not Applicable
4. The point(s) of diversion described herein is administratively corrected to be more accurately described using the Global Positioning System (GPS), as described in the application.  Applicable  Not Applicable
5. The point(s) of diversion authorized herein shall not actually be located more than 2,232 feet from the previously authorized point(s) of diversion.  Applicable  Not Applicable
6. As required by K.A.R. 5-3-5d, if the works for diversion is a well with a diversion rate of 100 gallons per minute or more, a tube or other device suitable for making water level measurements shall be installed, operated and maintained in accordance with K.A.R. 5-6-13.  Applicable  Not Applicable
7. The owner of the authorized place(s) of use shall properly install an acceptable water flow meter on or before December 31, 2024, or before the first use of water, whichever occurs first. The water flow meter shall be installed, operated and maintained in accordance with K.A.R. 5-1-4 through 5-1-12. As required by K.S.A. 82a-732, as amended, and K.A.R. 5-3-5e, the owner shall maintain records and report the reading of the water flow meter and the total quantity of water diverted annually to the Chief Engineer by March 1 following the end of each calendar year.  Applicable  Not Applicable
8. Installation of the works for diversion of water shall be completed on or before December 31, 2024, or within any authorized extension of time. By March 1, 2025 the applicant shall notify the Chief Engineer that construction of the works for diversion has been completed, on the form provided by the Chief Engineer, as required by K.A.R. 5-8-4e.  Applicable  Not Applicable
9. The completed well log shall be submitted with the required notice.  Applicable  Not Applicable
10. All diversion works into which any type of chemical or other foreign substance will be injected into the water shall be equipped with an in-line, automatic, quick-closing check valve capable of preventing pollution of the source of the water supply. The check valve(s) shall be installed, operated and maintained in accordance with K.A.R. 5-3-5c.  Applicable  Not Applicable
11. Additional Conditions are attached.  Yes  No
12. In accordance with K.S.A. 82a-708a, as amended, and K.A.R. 5-5-14, all of the owners of the authorized place(s) of use of water appropriated under the above-referenced file number are responsible for compliance with its terms, conditions and limitations, as amended and/or supplemented by this Summary Order, and with applicable provisions of the *Kansas Water Appropriation Law* and the *Rules and Regulations* promulgated thereunder. Failure to comply with these provisions may result in civil penalties pursuant to K.S.A. 82a-737, as amended, and/or the suspension or revocation and dismissal of the water or appropriation right or any other enforcement actions authorized by law.

**Administrative Appeal and Effective Date of Order**

If you are aggrieved by this order, pursuant to K.S.A. 82a-1901, you may request an evidentiary hearing before the Chief Engineer or request administrative review by the Secretary of Agriculture. A request for hearing by the Chief Engineer must be filed within 15 days of service of this Order and a request for administrative review by the Secretary must be filed within 30 days pursuant to K.S.A. 77-531. Any request for administrative review must state a basis for review pursuant to K.S.A. 77-527. File any request with Kansas Department of Agriculture, Legal Division, 1320 Research Park Drive, Manhattan, KS 66502. Failure to timely request a hearing or review may preclude review under the Kansas Judicial Review Act.

*For Use by Register of Deeds*

**FOR OFFICE USE ONLY  
APPLICATION APPROVED AND  
SUMMARY ORDER ISSUED**

By: Jeff Lanterman  
 Only Authorized Designee of the Chief Engineer  
 (Print Name): Jeff Lanterman  
 Division of Water Resources - Kansas Department of Agriculture  
 Date of Issuance: 5/30/24  
 State of Kansas )  
 County of Statterd ) SS  
 Acknowledged before me on 5/30/2024  
 by Jeff Lanterman  
 Signature: Chelsi Snodgrass  
 Notary Public

My commission expires



RECEIVED

APR 08 2024



CHELSEI SNODGRASS  
My Appointment Expires

Stafford Field Office  
Division of Water Resources

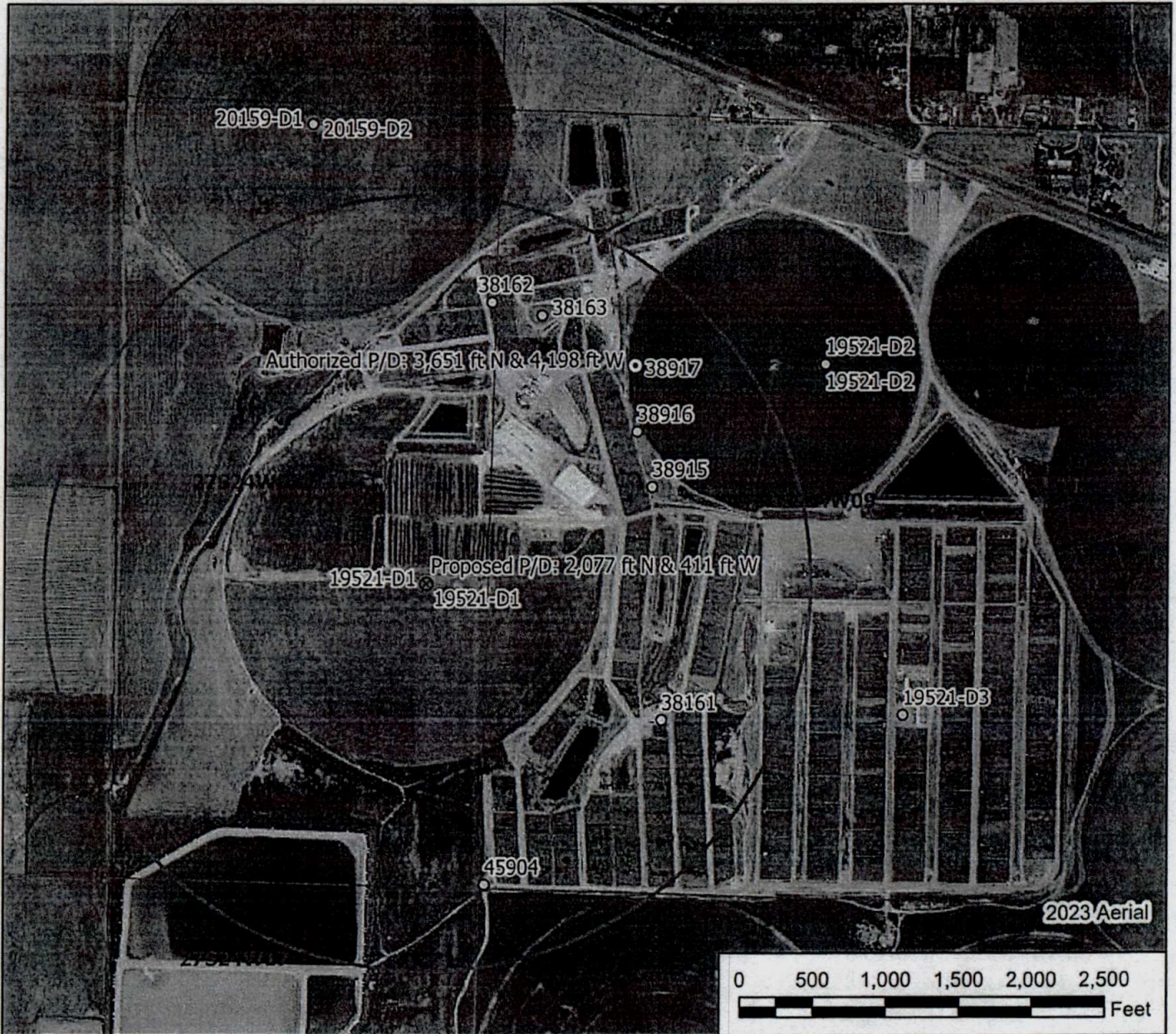

**Legend**

- Water Appropriation
- Proposed Point of Diversion
- ⊙ Authorized Point of Diversion
- ☆ Domestic Well
- ⊕ Section Corner
- Section Line

## Water Right, File No. 38917

### Change in Point of Diversion Application Map 8 & 9-27W-24W // Ford County

To the best of my knowledge, all points of diversion within one-half mile of the proposed point of diversion have been shown, and unless noted otherwise, are all owned by the applicant.

RECEIVED

APR 08 2024

Signature / Date *[Handwritten Signature]*

4/8/24



4/2/2024 EKF/SFFO 1:12,000 scale

Stafford Field Office  
300 S. Main Street  
Stafford, KS 67578-1521



Phone: 620-234-5311  
Fax: 620-234-6900  
[www.agriculture.ks.gov](http://www.agriculture.ks.gov)

Mike Beam, Secretary

Laura Kelly, Governor

May 30<sup>th</sup> 2024

Bowman Enterprises LLC  
ATTN: Wilroads Feed Yard  
11449 Larait Way  
Dodge City, KS 67801-6694

Re: Water Right, File No(s). 38915,38916,38917

Dear Water Right Owner:

Enclosed is an order executed by the Chief Engineer, Division of Water Resources, Kansas Department of Agriculture, approving the application for change under the referenced file number(s).

Your attention is directed to the enclosures and to the terms, conditions and limitations specified in this approval for change. An acceptable water flow meter must be installed on your well before any water is applied as authorized under this change approval. A copy of the approved list of Certified Water Flowmeters as well as <http://agriculture.ks.gov/divisions-programs/dwr/water-appropriation/water-flowmeters>. If you do not have access to the internet, please contact this office and we will send you a paper copy of the referenced information.

Since this order modifies the original document referred to above, it should be recorded with the Register of Deeds as other instruments affecting real estate.

This order requires that a notice and completion of works form be submitted once the diversion works are completed, including a properly installed flowmeter. This form is available at the referenced website.

Any abandoned well must be plugged in accordance with the requirements of Article 30 of the Rules and Regulations as adopted by the Kansas Department of Health and Environment.

Should you have any questions, please feel free to contact this office. If you wish to refer to a specific file, please reference it when you contact us.

Sincerely,

A handwritten signature in black ink, appearing to read "Jeff Lanterman".

Jeff Lanterman  
Water Commissioner

Enclosures

pc: Water Rights Section  
Groundwater Management District No.

## CERTIFICATE OF SERVICE

On this **30th** day of **May, 2024**, I hereby certify that the attached Change in Point of Diversion for Water Right, File No. **38915,38916,38917**, dated **May 30th, 2024** was mailed via First Class U.S. mail to the following:

Bowman Enterprises LLC  
ATTN: Wilroads Feed Yard  
11449 Larait Way  
Dodge City, KS 67801-6694

A copy of the letter was sent via electronic mail to the following:

GMD 3

  
-----  
Staff