

Submit To: CHIEF ENGINEER
Division of Water Resources
Kansas Department of Agriculture
1320 Research Park Drive
Manhattan, Kansas 66502
http://agriculture.ks.gov/dwr

**APPLICATION FOR APPROVAL TO
CHANGE THE PLACE OF USE, THE
POINT OF DIVERSION OR THE USE
MADE OF THE WATER UNDER AN
EXISTING WATER RIGHT**



Filing Fee Must Accompany the Application
(Please refer to Fee Schedule on signature page of application form.)

Paragraph Nos. 1, 2, 3, 4 & 8 must be completed. Complete all other applicable portions. A topographic map or detailed plat showing the authorized and proposed points(s) of diversion and /or place of use must accompany this application.

1. Application is hereby made for approval of the Chief Engineer to change the

- Place of Use
- (Check one or more) Point of Diversion
- Use Made of Water

File No. 49337-D1

2. Name of applicant: GKW, LLC

Address: PO Box 75337

City, State and Zip: WICHITA, KS 67211

Phone Number: (316) 295-8028 E-mail address: jay.russell@jrussellco.com

What is your relationship to the water right; owner tenant agent other? If other, please explain. _____

Name of water use correspondent: Blayne Martin, Martin's Central Sand Co. Inc.

Address: 7945 N. Broadway

City, State and Zip: Valley Center, KS 67147

Phone Number: (316) 832-9227 E-mail address: _____

3. The change(s) proposed herein are desired for the following reasons (please be specific): _____

Proposed change is for conversion of existing irrigation right to industrial water right for groundwater pit evaporation loss. Groundwater pit to be excavated through hydraulic dredging.

Conversion will result in changes to Use Made of Water, Place of Use and Point of Diversion.

The change(s) (was) (will be) completed by April 2029 (Date)

For Office Use Only:	
F.O. <u>2</u> GMD <u>2</u> Meets K.A.R. 5-5-1 <input checked="" type="checkbox"/> YES / NO Use <u>IRR</u> Source <input checked="" type="checkbox"/> G / S County <u>SG</u> By <u>KJN</u> Date <u>6/11/24</u>	
Code <u>C-3</u> Fee \$ <u>700</u> TR # _____ Receipt Date <u>6-7-24</u> Check # <u>51772</u>	

***CHANGE ENTERED ON BASE WR IN WRIS.**

6/11/2024
KAnderson

JUN 07 2024

File No. 49337-D1

4. The presently authorized place of use is: KS Dept. of Agriculture

Owner of Land — NAME: GENE & KAY WOODARD LIVING TRUST

ADDRESS: 3940 N SOLANO ST WICHITA, KS 67205

Sec.	Twp.	Range	NE¼				NW¼				SW¼				SE¼				TOTAL ACRES
			NE¼	NW¼	SW¼	SE¼	NE¼	NW¼	SW¼	SE¼	NE¼	NW¼	SW¼	SE¼	NE¼	NW¼	SW¼	SE¼	
20	26S	1W	30	11	13	30												84	

List any other water rights that cover this place of use. 49337-D2

Owner of Land — NAME: _____

ADDRESS: _____

Sec.	Twp.	Range	NE¼				NW¼				SW¼				SE¼				TOTAL ACRES
			NE¼	NW¼	SW¼	SE¼	NE¼	NW¼	SW¼	SE¼	NE¼	NW¼	SW¼	SE¼	NE¼	NW¼	SW¼	SE¼	

List any other water rights that cover this place of use. _____

(If there are more than two landowners, attach additional sheets as necessary.)

5. It is proposed that the place of use be changed to:

Owner of Land — NAME: GKW, LLC

ADDRESS: PO Box 75337 WICHITA, KS 67211

Sec.	Twp.	Range	NE¼				NW¼				SW¼				SE¼				TOTAL ACRES
			NE¼	NW¼	SW¼	SE¼	NE¼	NW¼	SW¼	SE¼	NE¼	NW¼	SW¼	SE¼	NE¼	NW¼	SW¼	SE¼	
20	26S	1W	12.4	0	5	16												33.4	

List any other water rights that cover this place of use. 49337-D2

Owner of Land — NAME: _____

ADDRESS: _____

Sec.	Twp.	Range	NE¼				NW¼				SW¼				SE¼				TOTAL ACRES
			NE¼	NW¼	SW¼	SE¼	NE¼	NW¼	SW¼	SE¼	NE¼	NW¼	SW¼	SE¼	NE¼	NW¼	SW¼	SE¼	

List any other water rights that cover this place of use. _____

IF MORE SPACE IS NEEDED, ATTACH ADDITIONAL SHEETS AS NECESSARY

JUN 07 2024

File No. 49337-D1

KS Dept. of Agriculture

- 6. The presently authorized point(s) of diversion (is) ~~(are)~~ one well (Provide description and number of points)
- 7. The proposed point(s) of diversion (is) ~~(are)~~ one groundwater pit (Provide description and number of points)

List all presently authorized point(s) of diversion:

8. **Presently authorized point of diversion:**
 One in the NE Quarter of the SE Quarter of the NE Quarter of Section 20, Township 26 South, Range 1 (E/W), in Sedgwick County, Kansas, 3955 feet North 597 feet West of Southeast corner of section. Authorized Rate 34.5 Authorized Quantity 65.5
 (DWR use only: Computer ID No. _____ GPS _____ feet North _____ feet West)
 This point will not be changed This point will be changed as follows:
Proposed point of diversion: (Complete only if change is requested)
 One in the NW Quarter of the SE Quarter of the NE Quarter of Section 20, Township 26 South, Range 1 (E/W), in Sedgwick County, Kansas, 3839 feet North 1060 feet West of Southeast corner of section. Proposed Rate 34.5 evap Proposed Quantity 55.7 AF (85% reduction pursuant to KAR 5-5-9)
 This point is: Additional Well Geo Center List other water rights that will use this point none

9. **Presently authorized point of diversion:**
 One in the _____ Quarter of the _____ Quarter of the _____ Quarter of Section _____, Township _____ South, Range _____ (E/W), in _____ County, Kansas, _____ feet North _____ feet West of Southeast corner of section. Authorized Rate _____ Authorized Quantity _____
 (DWR use only: Computer ID No. _____ GPS _____ feet North _____ feet West)
 This point will not be changed This point will be changed as follows:
Proposed point of diversion: (Complete only if change is requested)
 One in the _____ Quarter of the _____ Quarter of the _____ Quarter of Section _____, Township _____ South, Range _____ (E/W), in _____ County, Kansas, _____ feet North _____ feet West of Southeast corner of section. Proposed Rate _____ Proposed Quantity _____
 This point is: Additional Well Geo Center List other water rights that will use this point _____

10. **Presently authorized point of diversion:**
 One in the _____ Quarter of the _____ Quarter of the _____ Quarter of Section _____, Township _____ South, Range _____ (E/W), in _____ County, Kansas, _____ feet North _____ feet West of Southeast corner of section. Authorized Rate _____ Authorized Quantity _____
 (DWR use only: Computer ID No. _____ GPS _____ feet North _____ feet West)
 This point will not be changed This point will be changed as follows:
Proposed point of diversion: (Complete only if change is requested)
 One in the _____ Quarter of the _____ Quarter of the _____ Quarter of Section _____, Township _____ South, Range _____ (E/W), in _____ County, Kansas, _____ feet North _____ feet West of Southeast corner of section. Proposed Rate _____ Proposed Quantity _____
 This point is: Additional Well Geo Center List other water rights that will use this point _____

11. Describe the current condition of and future plans for any point(s) of diversion which will no longer be used. _____
Existing irrigation well will be plugged per KDHE regulations during development process of groundwater pit. GMD2 Plugging Agreement attached.

IF MORE SPACE IS NEEDED, ATTACH ADDITIONAL SHEETS AS NECESSARY

JUN 07 2024

File No. 49337-D1

KS Dept. of Agriculture

12. The presently authorized use of water is for Irrigation purposes.
It is proposed that the use be changed to Industrial (sand & gravel operation, evap. loss) purposes.
13. If changing the place of use and/or use made of water, describe how the consumptive use will not be increased.
Water right quantity reduced to 85% of authorized quantity pursuant to K.A.R. 5-5-9 to account for change in consumptive use for the application. The adjusted value complies with annual net evaporation loss (20") pursuant to K.A.R. 5-6-3 for proposed pit excavation surface area. Adjusted and applied value will account for proposed 100% consumptive use from evaporation.
(Please show any calculations here.)
14. It is requested that the maximum annual quantity of water be reduced to 55.7 (acre-feet ~~or million gallons~~).
15. It is requested that the maximum rate of diversion of water be reduced to evaporation gallons per minute (____ c.f.s.).
16. The application must include either a topographic map or detailed plat. A U.S. Geological Survey Topographic Map, scale 1:24,000, is available through the Kansas Geological Survey, 1930 Constant Avenue, University of Kansas, Lawrence, Kansas 66047-3726 (www.usgs.gov). The map should show the location of the presently authorized point(s) of diversion. Distances North and West of the Southeast corner of the section must be shown. The presently authorized place of use should also be shown. Identify the center of the section, the section lines and the section corners and show the appropriate section, township, and range numbers on the map. In addition the following information must also be shown on the map.
- a. If a change in the location of the point(s) of diversion is proposed, show:
- 1) The location of the proposed point(s) of diversion. Distances North and West of the Southeast corner of the section must be shown. Please be certain that the information shown on the map agrees with the information shown in Paragraph Nos. 9, 10 and 11 of the application.
 - 2) If the source of supply is groundwater, please show the location of existing water wells of any kind, including domestic wells, within ½ mile of the proposed well or wells. Identify each well as to its use and furnish name and mailing address of the property owner or owners. If there are no wells within ½ mile, please indicate so on the map.
 - 3) If the source of supply is surface water, the names and mailing addresses of all landowner(s) ½ mile downstream and ½ mile upstream from your property lines must be shown.
- b. If a change in the place of use is desired, show the proposed place of use by crosshatching on the map. Please be certain that the information shown on the map agrees with the information shown in Paragraph No. 5 of the application.
Applicant requests that nearby well owners be notified by public notice due to large number of potential wells within 1/2 mile radius of application.
17. Attach documentation to show the change(s) proposed herein will not impair existing water rights and relates to the same local source of supply as to which the water right relates. This information may include statements, plats, geology reports, well logs, test hole logs, and other information as necessary information to show the above. Additional comments may be made below.
Proposed change application will not impair existing water rights. The proposed point of diversion will be completed in the same local source of supply <500 feet from authorized point of diversion. The average net evaporation loss rate will result in negligible aquifer drawdown and impact. The groundwater pit as opposed to the current irrigation well will result in less net annual and seasonal drawdown.
18. If the proposed change(s) does not meet all applicable rules and regulations of the Kansas Water Appropriation Act, please identify the rules and regulations for which you request a waiver. State the reason why a waiver is needed and why the request should be granted. Attach documentation showing that granting the request will not impair existing water rights and will not prejudicially and unreasonably affect the public interest.
Application appears to not meet non-domestic spacing (groundwater pit edge to groundwater pit edge) under K.A.R. 5-22-2. There net drawdown in the area will be reduced from the conversion of a pumping well to groundwater pit.

IF MORE SPACE IS NEEDED, ATTACH ADDITIONAL SHEETS AS NECESSARY

JUN 07 2024

File No. 49337-D1

KS Dept. of Agriculture

Any use of water that is not as authorized by the water right or permit to authorize water before the chief engineer approves this application is a violation of the Kansas Water Appropriation Act for which criminal or civil penalties may be assessed. Such violation is a class C misdemeanor, punishable by a fine not to exceed \$500 and/or a term of confinement not to exceed one month in the county jail. K.S.A. 82a-728(b). Civil penalties shall be not less than \$100 nor more than \$1,000 per violation. In the case of a continuing violation, each day such violation continues may be deemed a separate violation. In addition to these penalties the water right may be modified or suspended. K.S.A. 82a-737, as amended.

The application must be signed by all owners of the place of use authorized under the water right and his or her spouse, if married. Please indicate if there is no spouse. If land is being purchased under contract, the seller must sign as landowner until such time as the contract is completed.

In the event that all applicants cannot appear before one notary public, they may as necessary sign separate copies of the application before any notary public conveniently available to them. All copies signed in this manner shall be considered to be valid parts of the application.

If the request is signed on behalf of any Owner by someone with legal authority to do so (for example, an agent, one who has power of attorney, or an executor, executrix, conservator), it will be necessary to attach proper documents showing such authority.

I declare that I am an owner of the currently authorized place of use as identified herein, or that I represent all such owners and am authorized to make this application on their behalf, and declare further that the statements contained herein are true, correct, and complete. By filing this application I authorize the chief engineer to permanently reduce the quantity of water and/or rate of diversion as specified in sections 14 and 15 of this application.

Dated at WICHITA, Kansas, this 31 day of MAY, 2024.

Eugene Woodard (Owner)

K Woodard (Spouse)

EUGENE WOODARD (Please Print)

KAY WOODARD (Please Print)

(Owner)

(Spouse)

JAY RUSSELL - GKN, LLC (Please Print)

(Please Print)

(Owner)

(Spouse)

(Please Print)

(Please Print)

State of Kansas } County of Sedgwick } SS



I hereby certify that the foregoing application was signed in my presence and sworn to before me this 31st day of May, 2024.

[Signature] Notary Public

My Commission Expires 09/20/2026

FEE SCHEDULE

Each application to change the place of use, the point of diversion or the use made of the water under this section shall be accompanied by the application fee set forth in the schedule below:

- (1) Application to change a point of diversion 300 feet or less \$100
(2) Application to change a point of diversion more than 300 feet \$200
(3) Application to change the place of use \$200
(4) Application to change the use made of the water \$300

Make check payable to Kansas Department of Agriculture.

1320 Research Park Drive
Manhattan, KS 66502
785-564-6700
www. agriculture.ks.gov



900 SW Jackson, Room 456
Topeka, KS 66612
785-296-3556

Mike Beam, Secretary

Laura Kelly, Governor

June 14, 2024

GKW LLC
PO BOX 75337
WICHITA KS 67211

RE: File No(s). **49337**

Dear Sir or Madam:

The Division of Water Resources (Division) has received your application(s) to change the place of use, point of diversion or use made of water for the file number(s) referenced above. Please be aware that the Division may have a large number of pending applications on hand at times and makes every attempt to process them in the order in which they are received. You will be contacted if additional information is required.

Please note, this letter only acknowledges receipt of your application(s) and does not guarantee approval. In accordance with the provisions of the Kansas Water Appropriation(s) Act, the use of water as proposed prior to approval of the application(s) is unlawful.

Additional information about the process may be found on our website at agriculture.ks.gov/divisions-programs/dwr. If you have any other questions, please contact our office at 785-564-6640 or your local Stafford Field Office at 620-234-5311. If you call, please reference the file number so we can help you more efficiently.

Sincerely,

Kristen Baum
New Applications and Changes Supervisor
Water Appropriation Program



- Proposed Point of Diversion
- ▨ Proposed Groundwater Pit
- ▲ Groundwater Rights
- PLSS Sections (S-T-R)

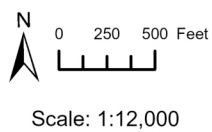

7/24/2024

Water Resources
Received

KS Dept Of Agriculture

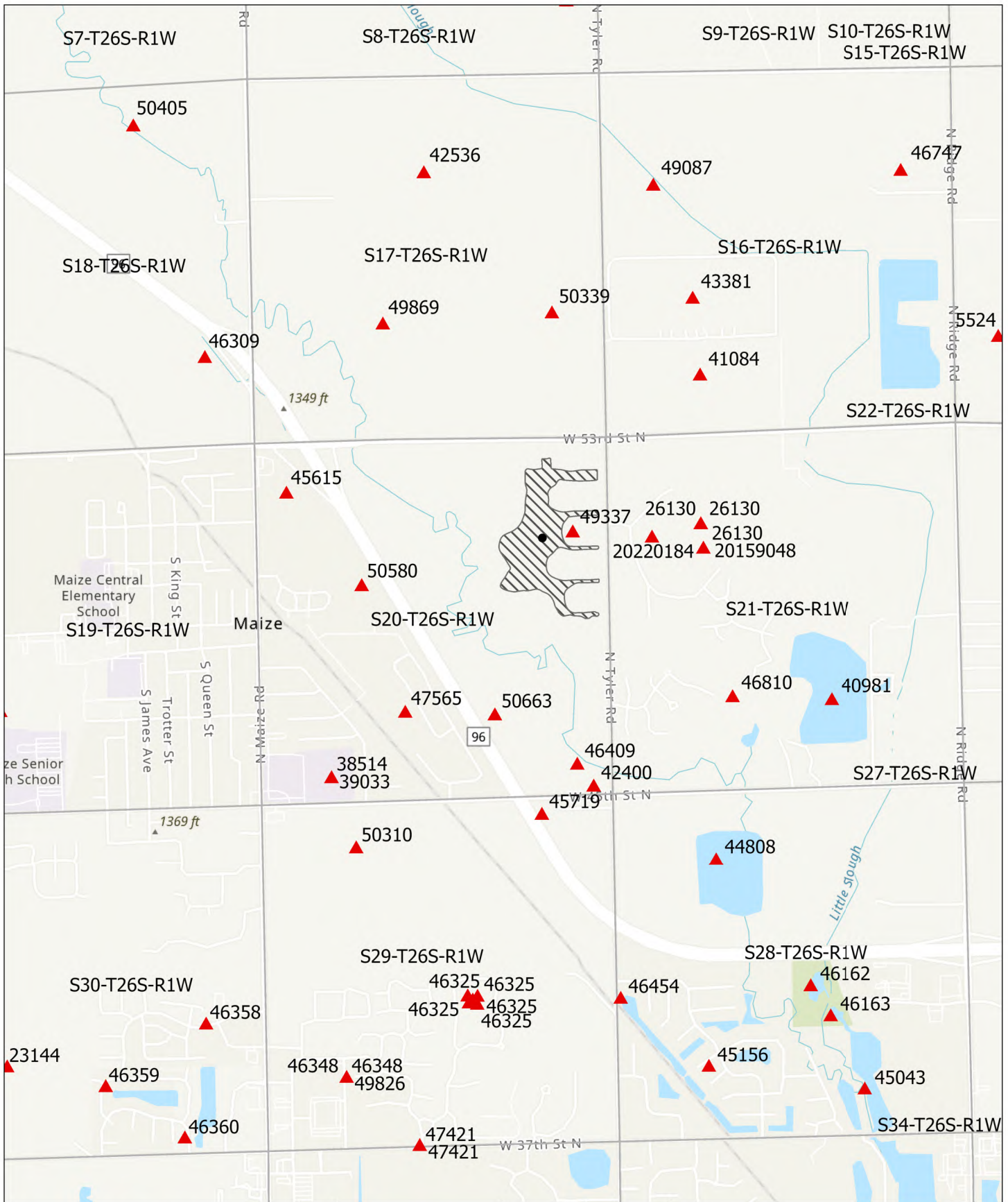

- Proposed Point of Diversion
- ▨ Proposed Groundwater Pit
- ▲ Groundwater Rights
- PLS Sections (S-T-R)

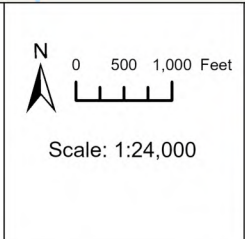

7/24/2024

Water Resources
Received

KS Dept Of Agriculture