

Submit To:  
CHIEF ENGINEER  
Division of Water Resources  
Kansas Department of Agriculture  
1320 Research Park Drive  
Manhattan, KS 66502-5000  
<http://agriculture.ks.gov/dwr>

# APPLICATION FOR PERMIT TO APPROPRIATE WATER FOR BENEFICIAL USE

WATER RESOURCES  
RECEIVED  
AUG 05 2024  
14:10  
KS Dept. of Agriculture



State of Kansas

62

**STATUTORY FILING FEE MUST ACCOMPANY THIS APPLICATION**  
**Please refer to the Fee Schedule attached to this application form.**

File Number: **51284**

This item to be completed by the Division of Water Resources staff.

1. Name of Applicant: ILS Farms  
Address: 551 SW 30 RD  
City: Great Bend State: KS Zip Code: 67530  
Phone: 620-792-6166 Email: Water@ilsbeef.com

2. The source of water is:  surface water in \_\_\_\_\_ (stream)  
 groundwater in ARKANSAS RIVER (drainage basin)

8/6/2024  
KJN

3. The maximum annual quantity of water desired is 195  acre-feet  gallons  
to be diverted at a maximum rate of 800  gpm  c.f.s.  natural flows  natural evaporation  
 This project involves surface water storage and redirection. The maximum annual quantity of water desired to be  
rediverted is \_\_\_\_\_  acre-feet  gallons, at a rate of \_\_\_\_\_  gpm  c.f.s.

### Conversion Factors

1 acre-foot (AF) = 325,851 gallons  
1 million gallons (mg) = 3.07 acre-foot (AF)  
1 cubic foot per second (c.f.s.) = 448.8 gallons per minute (gpm)

**IMPORTANT:** Once your application has been assigned a priority date and file number, the requested maximum rate of diversion and maximum requested annual quantity of water under that priority number can **NOT** be increased. Please be certain your requested maximum rate of diversion and maximum annual quantity of water are appropriate and reasonable for your proposed project.

4. The water is intended to be appropriated for the following use(s):  
 Artificial Recharge\*  Irrigation\*  Recreational\*  Water Power\*  
 Industrial\*  Municipal\*  Stockwatering\*  Sediment Control  
 Domestic  Dewatering  Hydraulic Dredging  Fire Protection  
 Thermal Exchange  Contamination Remediation

**\*IMPORTANT:** You **must** submit a supplemental form providing information to substantiate your request for the quantity of water listed in Item No. 3 for the intended use(s) referenced above.

FOR OFFICE USE ONLY							
FO	<u>2</u>	GMD	<u>5</u>	DUA	-	Use	<u>IRR</u>
Code	<u>BE2</u>	Fee \$	<u>300</u>	TR #		Source	<u>GW</u>
						County	<u>PN</u>
						By	<u>KJN</u>
						Date	<u>8/6/24</u>
						Receipt Date	<u>8-5-24</u>
						Check #	<u>2475</u>

8/6/2024  
KJN

AUG 05 2024

File No. \_\_\_\_\_

KS Dept. of Agriculture

5. The location(s) of the proposed diversion work(s) (well, pumpsite, etc.) are described below. Note that for the application to be accepted, the point of diversion location(s) **must** be described to at least a 10-acre tract, unless you specifically request a 60-day period of time in which to locate the site within a specifically described, minimal legal quarter section of land. You can specify a nickname for the point of diversion via the A.K.A. line to help you identify it.

If the source of supply is groundwater, a separate application shall be filed for each proposed well or battery of wells, except that a single application may include up to four wells within a circle with a quarter (1/4) mile radius in the same local source of supply which do not exceed a maximum diversion rate of 20 gallons per minute per well.

A battery of wells is defined as two or more wells connected to a common pump by a manifold; or not more than four wells in the same local source of supply within a 300-foot radius circle which are being operated by pumps not to exceed a total maximum diversion rate of 800gpm and which supply water to a common distribution system.

- (A) One in the \_\_\_\_\_ quarter of the \_\_\_\_\_ quarter of the SE quarter of Section 15, more particularly described as being near a point 1320 feet North and 1320 feet West of the Southeast corner of said section, in Township 23 South, Range 16 E W, Pawnee County, KS. A.K.A: 62
- (B) One in the \_\_\_\_\_ quarter of the \_\_\_\_\_ quarter of the \_\_\_\_\_ quarter of Section \_\_\_\_\_, more particularly described as being near a point \_\_\_\_\_ feet North and \_\_\_\_\_ feet West of the Southeast corner of said section, in Township \_\_\_\_\_ South, Range \_\_\_\_\_ E W, \_\_\_\_\_ County, KS. A.K.A: \_\_\_\_\_
- (C) One in the \_\_\_\_\_ quarter of the \_\_\_\_\_ quarter of the \_\_\_\_\_ quarter of Section \_\_\_\_\_, more particularly described as being near a point \_\_\_\_\_ feet North and \_\_\_\_\_ feet West of the Southeast corner of said section, in Township \_\_\_\_\_ South, Range \_\_\_\_\_ E W, \_\_\_\_\_ County, KS. A.K.A: \_\_\_\_\_
- (D) One in the \_\_\_\_\_ quarter of the \_\_\_\_\_ quarter of the \_\_\_\_\_ quarter of Section \_\_\_\_\_, more particularly described as being near a point \_\_\_\_\_ feet North and \_\_\_\_\_ feet West of the Southeast corner of said section, in Township \_\_\_\_\_ South, Range \_\_\_\_\_ E W, \_\_\_\_\_ County, KS. A.K.A: \_\_\_\_\_
- (E) One in the \_\_\_\_\_ quarter of the \_\_\_\_\_ quarter of the \_\_\_\_\_ quarter of Section \_\_\_\_\_, more particularly described as being near a point \_\_\_\_\_ feet North and \_\_\_\_\_ feet West of the Southeast corner of said section, in Township \_\_\_\_\_ South, Range \_\_\_\_\_ E W, \_\_\_\_\_ County, KS. A.K.A: \_\_\_\_\_

Updated  
Footages 9/18/24  
BMM

6. The proposed project for diversion of water will consist of 1 well  
(number of wells, pumps, dams, etc.)  
and was/will be completed on or by the following date: ASAP  
(date each was or will be completed)

7. The first actual application of water for the proposed beneficial use was or is estimated to be ASAP  
(Date)

8. List any application, appropriation of water, water right, or vested right file number that covers the same point(s) of diversion or any of the same place of use described in this application. Also list any other recent modifications made to existing permits or water rights in conjunction with the filing of this application.  
New Application in accordance of KAR 5-25-22  
Moving WR # 19937 to new location



AUG 05 2024

File No. \_\_\_\_\_

KS Dept. of Agriculture

9. Will pesticide, fertilizer, or other foreign substance be injected into the water pumped from the diversion works?

Yes  No

If **yes**, a check valve shall be required. All chemigation safety requirements must be met including a chemigation permit and reporting requirements.

10. If you are planning to impound water, please contact DWR prior to submitting this application. Please attach a reservoir area capacity table and inform us of the total acres of surface drainage area above the reservoir.

Have you made an application for a permit for construction of this dam and reservoir with DWR?  Yes  No

If yes, write the Water Structures permit number here: \_\_\_\_\_

11. Furnish a detailed topographic or aerial map that depicts the following information:

The application **must** be supplemented by a topographic map, aerial photograph or a detailed plat showing the information described in A-D below.

- (A) The center of the section, the section lines or the section corners, and labels showing the appropriate section, township and range numbers, as well as a north arrow and scale,
- (B) The location of the proposed point(s) of diversion (wells, stream-bank installations, dams, or other diversion works) described in Item No. 5 of the application, showing the North-South distance and the East-West distance from a section line or southeast corner of section,
- (C) The location of the proposed place of use identified by crosshatching,
- (D) **For Groundwater Use**, the location of any existing water wells of any kind within 1/2 mile of the proposed well or wells and indicate for each well its type of use and the name and mailing address of the property owner or owners, (If there are no wells within 1/2 mile, please indicate that on the map.)

**For Surface Water Use**, the names and addresses of the landowner(s) 1/2 mile downstream and 1/2 mile upstream from your property lines, and

(E) The locations of proposed or existing dams, dikes, reservoirs, canals, pipelines, power houses, and any other structures for the purpose of storing, conveying, or using water.

12. For groundwater use, furnish copies of the driller's logs for all test holes or completed wells. Please ensure that the driller's logs provide depth to the static water level. If driller's logs cannot be obtained for an existing well, provide the following information:

Well location as shown in Item No. 5	(A)	(B)	(C)	(D)	(E)
Date drilled	_____	_____	_____	_____	_____
Total depth of well	_____	_____	_____	_____	_____
Depth to static water level	_____	_____	_____	_____	_____

13. The owner(s) of the point of diversion, if other than the applicant is:

**ILS Land LLC, PO Box 1506 Great Bend KS 67550, 620-792-6166**

\_\_\_\_\_  
(name, address, and phone)

\_\_\_\_\_  
(name, address, and phone)

AUG 05 2024

File No. \_\_\_\_\_

KS Dept. of Agriculture

14. The owner(s) of the property where the water is used, if other than the applicant, is:

ILS Land LLC, PO Box 1506 Great Bend KS 67550, 620-792-6166

(name, address, and phone)

\_\_\_\_\_  
(name, address, and phone)

15. The relationship of the applicant to the proposed place where the water will be used is that of:

Owner     Agent     Tenant     Other: \_\_\_\_\_

16. A water use correspondent (WUC) must be designated. The WUC will be mailed the annual water use report, which must be filed with the Division by March 1 of each year. Failure to timely file an accurate water use report will subject the owner(s) to a civil fine of up to \$1,000 and potential suspension of the water appropriation or right. By signing this application, I verify that the owner(s) of the water right or permit have confirmed that the following person or agent should be designated as the WUC:

ILS Land LLC, PO Box 1506 Great Bend KS 67550, 620-792-6166

(name, address, and phone)

17. I understand that if this application is approved, there could be times, as determined by the Division of Water Resources, when I would not be allowed to divert water. This could affect the economics of my decision to appropriate water. Situations where this might occur may include times when minimum desirable streamflow (MDS) requirements are not met, when Assurance District or Water Marketing releases are made from storage in federal reservoirs, when a Water Reservation Right upstream of a federal reservoir is administered, or when water rights administration becomes necessary to prevent impairment.

I declare, under penalty of perjury, that I have legal access to or control of, the point(s) of diversion described in this application from the landowner or the landowner's authorized representative.

By signing below, I verify that the information set forth above is true to the best of my knowledge, I agree with all statements made above, and that this application is submitted in good faith.



(Applicant Signature)

08/01/2024

(Date)

Garret Smith

(Applicant Name – please print)

Director of Farm Operations

(Applicant Title, if applicable – please print)

Assisted by Daniel Bird

STFO/Environmental Scientist

(office/title)

Date: 7/30/2024



AUG 05 2024

**FEE SCHEDULE**

Make checks payable to the Kansas Department of Agriculture.

KS Dept. of Agriculture

1. The fee for an application for a permit to appropriate water for beneficial use, except for domestic, waterpower, dewatering, or sediment control use, shall be (see No. 2 below if requesting storage):

Million Gallons (mg)	Acre-Feet (AF)	Fee
≤ 32.585	≤ 100	\$200.00
32.586 - 104.272	100.1 – 320.0	\$300.00
> 104.272	> 320	\$300.00 plus \$20 for each additional 100AF (32.586mg) or any part thereof

2. The fee for an application in which **storage** of water is requested, except for domestic use, shall be:

Million Gallons (mg)	Acre-Feet (AF)	Fee
≤ 81.462	≤ 249.9	\$200.00
≥ 81.463	≥ 250	\$200.00 plus \$20 for each additional 100AF (32.586mg) or any part thereof

**Note:** If an application requests both direct use *and* storage, the fee charged shall be as determined under No. 1 or No. 2 above, whichever is greater, but not both fees.

3. The fee for an application for **waterpower** or **dewatering** use shall be \$100.00 plus \$200.00 for each 44,880 gallons per minute (100 c.f.s.), or part thereof, of the diversion rate requested.

**IMPORTANT NOTICE**

If this application is approved, the applicant shall notify the Chief Engineer when the diversion works (well, pump, reservoir, pit, etc.) has/have been completed via the *Notice of Completion of Diversion Works* form (DWR 1-203.11) and along with the statutorily required field inspection fee of:

- \$200.00 for sediment control use or groundwater pits for industrial use, or
- \$400.00 for all other uses made of water

Failure to complete the diversion works by the deadline specified in the *Approval of Application and Permit to Proceed* (or any subsequent extension of time of said deadline) and/or failure to submit the proper notice and field inspection fee will result in the dismissal of the appropriation and forfeiture of any priority associated with it.

**For assistance with this application, please contact the Division of Water Resources (DWR).**

**Manhattan HQ**  
1320 Research Park Dr.  
Manhattan, KS 66502  
785-564-6638

**Topeka Field Office**  
1131 SW Winding Rd, Ste 400  
Topeka, KS 66615  
785-296-5733

**Stafford Field Office**  
300 S. Main St  
Stafford, KS 67578  
620-234-5311

**Stockton Field Office**  
820 S. Walnut  
Stockton, KS 67669  
785-425-6787

**Garden City Field Office**  
4532 W. Jones Ave, Ste B  
Garden City, KS 67846  
620-276-2901

**Helpful Sources of Information**

DWR Water Appropriation Program  
DWR Water Appropriation Forms  
KGS Water Well Completion Records  
DWR Structures Program

<https://agriculture.ks.gov/divisions-programs/dwr/water-appropriation>  
<https://agriculture.ks.gov/divisions-programs/dwr/water-appropriation/water-appropriation-forms>  
<https://www.kgs.ku.edu/Magellan/WaterWell/index.html>  
<https://agriculture.ks.gov/divisions-programs/dwr/dam-safety/permit-requirements>



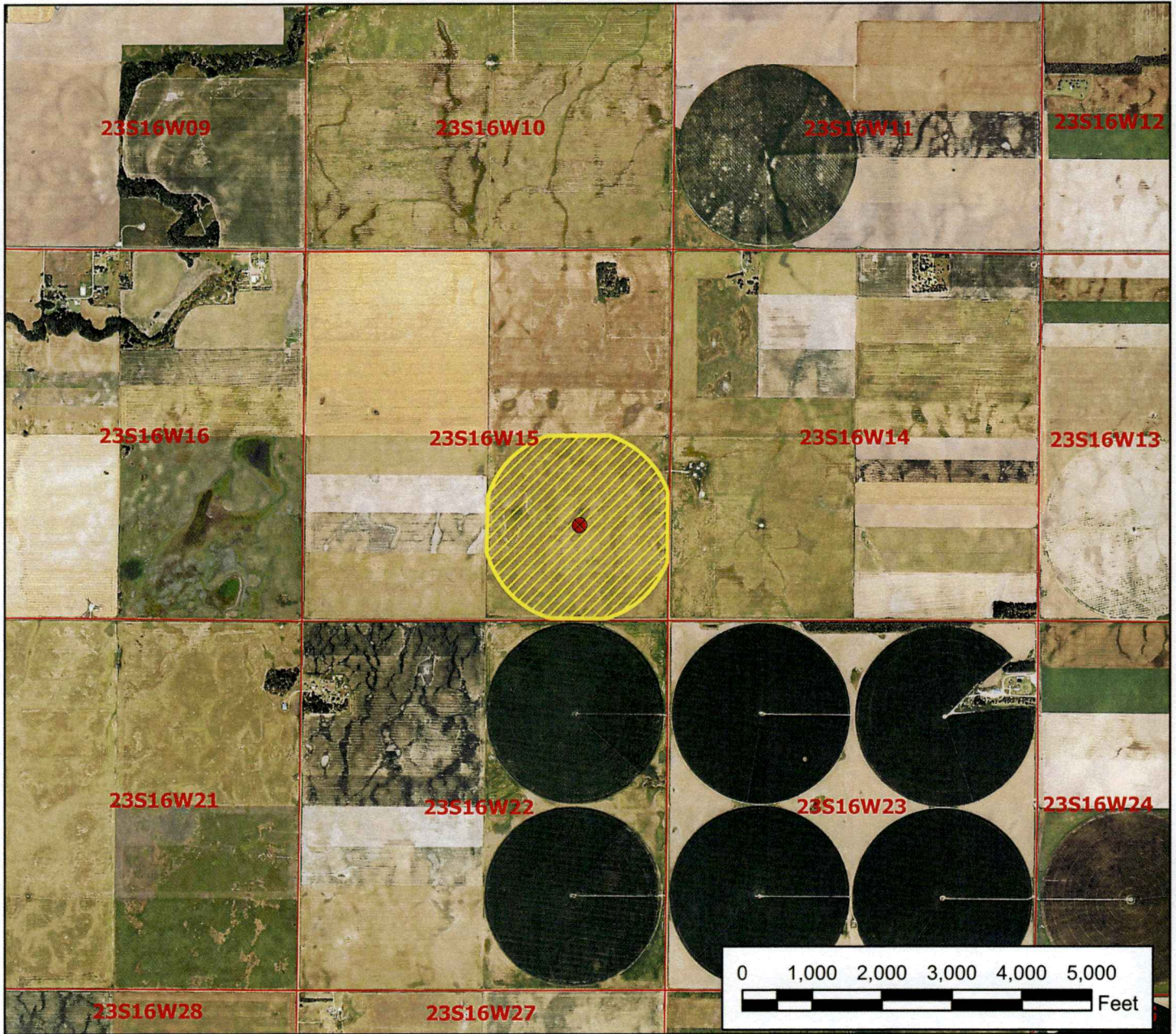

**Legend**

- Water Appropriation
- Proposed Point of Diversion
- ✚ Section Corner
- Section Line
- ▨ Place of Use

# Application for Water Appropriation

## Application Map 15-23-16 // Pawnee County



To the best of my knowledge, all points of diversion within one-half mile of the proposed point of diversion have been shown.

Signature / Date

07/30/2024 DKB/SFFO 1:25,000 scale



WATER RESOURCES  
RECEIVED

AUG 05 2024

KS Dept. of Agriculture

## IRRIGATION USE SUPPLEMENTAL SHEET

File No. \_\_\_\_\_

Name of Applicant (Please Print): ILS Farms

1. Please supply the name and address of each landowner, the legal description of the lands to be irrigated, and designate the actual number of acres to be irrigated in each forty acre tract or fractional portion thereof:

**Landowner of Record** NAME: ILS Land LLC

ADDRESS: PO Box 1506 Great Bend KS 67550

S	T	R	NE¼				NW¼				SW¼				SE¼				TOTAL				
			NE	NW	SW	SE	NE	NW	SW	SE	NE	NW	SW	SE	NE	NW	SW	SE					
<b>15</b>	<b>23</b>	<b>16</b>																32.5	32.5	32.5	32.5	130	

**Landowner of Record** NAME: \_\_\_\_\_

ADDRESS: \_\_\_\_\_

S	T	R	NE¼				NW¼				SW¼				SE¼				TOTAL				
			NE	NW	SW	SE	NE	NW	SW	SE	NE	NW	SW	SE	NE	NW	SW	SE					

**Landowner of Record** NAME: \_\_\_\_\_

ADDRESS: \_\_\_\_\_

S	T	R	NE¼				NW¼				SW¼				SE¼				TOTAL				
			NE	NW	SW	SE	NE	NW	SW	SE	NE	NW	SW	SE	NE	NW	SW	SE					

AUG 05 2024

KS Dept. of Agriculture

2. Please complete the following information for the description of the operation for the irrigation project. Attach supplemental sheets as needed.

a. Indicate the soils in the field(s) and their intake rates:

Soil Name	Percent of field (%)	Intake Rate (in/hr)	Irrigation Design Group
_____	_____	_____	_____
_____	_____	_____	_____
_____	_____	_____	_____
_____	_____	_____	_____
Total:	100 %		

b. Estimate the average land slope in the field(s): \_\_\_\_\_ %

Estimate the maximum land slope in the field(s): \_\_\_\_\_ %

c. Type of irrigation system you propose to use (check one):

- Center pivot      \_\_\_\_\_ Center pivot - LEPA      \_\_\_\_\_ "Big gun" sprinkler  
 Gravity system (furrows)      \_\_\_\_\_ Gravity system (borders)      \_\_\_\_\_ Sideroll sprinkler

Other, please describe: \_\_\_\_\_

d. System design features:

i. Describe how you will control tailwater:

ii. For sprinkler systems:

(1) Estimate the operating pressure at the distribution system: \_\_\_\_\_ psi

(2) What is the sprinkler package design rate? \_\_\_\_\_ gpm

(3) What is the wetted diameter (twice the distance the sprinkler throws water) of a sprinkler on the outer 100 feet of the system? \_\_\_\_\_ feet

(4) Please include a copy of the sprinkler package design information.

e. Crop(s) you intend to irrigate. Please note any planned crop rotations:

f. Please describe how you will determine when to irrigate and how much water to apply (particularly important if you do not plan a full irrigation).

You may attach any additional information you believe will assist in informing the Division of the need for your request.



1320 Research Park Drive  
Manhattan, KS 66502  
785-564-6700  
www. agriculture.ks.gov



900 SW Jackson, Room 456  
Topeka, KS 66612  
785-296-3556

Mike Beam, Secretary

Laura Kelly, Governor

August 9, 2024

ILS FARMS  
551 SW 30 ROAD  
GREAT BEND KS 67530

RE: Application, File No(s). **51284**

Dear Sir or Madam:

The Division of Water Resources (Division) has received your application(s) for a permit to appropriate water for beneficial use. Your application(s) has been assigned the file number(s) referenced above. Please be aware that the Division may have a large number of pending applications on hand at times and makes every attempt to process them in the order in which they are received. You will be contacted if additional information is required.

Please note, this letter only acknowledges receipt of your application(s) and does not guarantee approval. In accordance with the provisions of the Kansas Water Appropriation Act, the use of water as proposed prior to approval of the application(s) is unlawful.

Additional information about the process may be found on our website at [agriculture.ks.gov/divisions-programs/dwr](http://agriculture.ks.gov/divisions-programs/dwr). If you have any other questions, please contact our office at 785-564-6640 or your local Stafford Field Office at 620-234-5311. If you call, please reference the file number so we can help you more efficiently.

Sincerely,

Kris Neuhauser  
New Applications Lead  
Water Appropriation Program

9/18/2024

**From:** Water Resources  
Baum, Kristen [KDA]  
**Sent:** Received  
Wed 9/18/2024 1:37 PM  
**To:** Milner, Brandon [KDA]  
KS Dept Of Agriculture  
**Cc:** Conant, Cameron [KDA]  
**Subject:** ILS 60 days to locate files

Hi Brandon,

Ken and I discussed these applications today with Cameron. We need to take these out of 60 days to locate status and assign them the feet distances we used as place holders. Those are the spots where they actually want their wells to be located. They will work on getting us test holes at a later date if we need them. Can you make these edits to the application and save my email for the record?

Thanks,

**Kristen A. Baum, Environmental Scientist**  
Water Appropriation Program  
Division of Water Resources  
Kansas Department of Agriculture  
(785) 564-6627  
[kristen.baum@ks.gov](mailto:kristen.baum@ks.gov)

9/18/2024

Water Resources  
Received

KS Dept Of Agriculture