

MAY 23 2024

13:34

KS Dept. of Agriculture

Submit To: CHIEF ENGINEER  
Division of Water Resources  
Kansas Department of Agriculture  
1320 Research Park Drive  
Manhattan, Kansas 66502  
http://agriculture.ks.gov/dwr

**APPLICATION FOR APPROVAL TO  
CHANGE THE PLACE OF USE, THE  
POINT OF DIVERSION OR THE USE  
MADE OF THE WATER UNDER AN  
EXISTING WATER RIGHT**



State of Kansas

*Filing Fee Must Accompany the Application  
(Please refer to Fee Schedule on signature page of application form.)*

**Paragraph Nos. 1, 2, 3, 4 & 8 must be completed. Complete all other applicable portions.** A topographic map or detailed plat showing the authorized and proposed points(s) of diversion and /or place of use must accompany this application.

1. Application is hereby made for approval of the Chief Engineer to change the

Place of Use

(Check one or more)  Point of Diversion

Use Made of Water

File No. 6,536

2. Name of applicant: Rural Water District No. 1, Jefferson Co., KS

Address: 112 E. Main St.

City, State and Zip: Meriden, KS 66512

Phone Number: ( 785 ) 484-2680 E-mail address: rwd1meriden@gmail.com

What is your relationship to the water right;  owner  tenant  agent  other? If other, please explain. \_\_\_\_\_

Name of water use correspondent: Rod Bigham, Board of Directors chairman

Address: same

City, State and Zip: \_\_\_\_\_

Phone Number: ( \_\_\_\_\_ ) \_\_\_\_\_ E-mail address: \_\_\_\_\_

3. The change(s) proposed herein are desired for the following reasons (please be specific): \_\_\_\_\_

conversion of water right from single-point to a battery

The change(s) (was) (will be) completed by December 31, 2025

(Date)

<b>For Office Use Only:</b>											
F.O.	<u>1</u>	<u>GMD</u>	Meets K.A.R. 5-5-1	<input checked="" type="checkbox"/> YES / <input type="checkbox"/> NO	Use	<u>MUN</u>	Source	<input checked="" type="checkbox"/> G / <input type="checkbox"/> S	County	<u>JF</u>	
Code	<u>CLT</u>	Fee \$	<u>700</u>	TR #		Receipt Date	<u>5-23-24</u>	By	<u>KJN</u>	Date	<u>5/24/24</u>
						Check #	<u>10241</u>				

MAY 23 2024

4. The presently authorized place of use is:

Owner of Land — NAME: \_\_\_\_\_  
ADDRESS: \_\_\_\_\_

KS Dept. of Agriculture

Sec.	Twp.	Range	NE¼				NW¼				SW¼				SE¼				TOTAL ACRES
			NE¼	NW¼	SW¼	SE¼	NE¼	NW¼	SW¼	SE¼	NE¼	NW¼	SW¼	SE¼	NE¼	NW¼	SW¼	SE¼	

List any other water rights that cover this place of use. \_\_\_\_\_

Owner of Land — NAME: \_\_\_\_\_  
ADDRESS: \_\_\_\_\_

Sec.	Twp.	Range	NE¼				NW¼				SW¼				SE¼				TOTAL ACRES
			NE¼	NW¼	SW¼	SE¼	NE¼	NW¼	SW¼	SE¼	NE¼	NW¼	SW¼	SE¼	NE¼	NW¼	SW¼	SE¼	

List any other water rights that cover this place of use. \_\_\_\_\_

(If there are more than two landowners, attach additional sheets as necessary.)

5. It is proposed that the place of use be changed to:

Owner of Land — NAME: \_\_\_\_\_  
ADDRESS: \_\_\_\_\_

Sec.	Twp.	Range	NE¼				NW¼				SW¼				SE¼				TOTAL ACRES
			NE¼	NW¼	SW¼	SE¼	NE¼	NW¼	SW¼	SE¼	NE¼	NW¼	SW¼	SE¼	NE¼	NW¼	SW¼	SE¼	

List any other water rights that cover this place of use. \_\_\_\_\_

Owner of Land — NAME: \_\_\_\_\_  
ADDRESS: \_\_\_\_\_

Sec.	Twp.	Range	NE¼				NW¼				SW¼				SE¼				TOTAL ACRES
			NE¼	NW¼	SW¼	SE¼	NE¼	NW¼	SW¼	SE¼	NE¼	NW¼	SW¼	SE¼	NE¼	NW¼	SW¼	SE¼	

List any other water rights that cover this place of use. \_\_\_\_\_

**IF MORE SPACE IS NEEDED, ATTACH ADDITIONAL SHEETS AS NECESSARY**

6. The presently authorized point(s) of diversion (is) (are) see below WATER RESOURCES RECEIVED

7. The proposed point(s) of diversion (is) (are) see below MAY 23 2024

List all presently authorized point(s) of diversion:

KS Dept. of Agriculture

8. **Presently authorized point of diversion:**

One in the SW Quarter of the SW Quarter of the SW Quarter of Section 18, Township 11 South, Range 17 E (E/W), in Jefferson County, Kansas, 531 feet North 4942 feet West of Southeast corner of section.

Authorized Rate \_\_\_\_\_ Authorized Quantity \_\_\_\_\_

(DWR use only: Computer ID No. \_\_\_\_\_ GPS \_\_\_\_\_ feet North \_\_\_\_\_ feet West)

This point will not be changed  This point will be changed as follows:

**Proposed point of diversion: (Complete only if change is requested)**

One in the \_\_\_\_\_ Quarter of the \_\_\_\_\_ Quarter of the \_\_\_\_\_ Quarter of Section \_\_\_\_\_, Township \_\_\_\_\_ South, Range \_\_\_\_\_ (E/W), in \_\_\_\_\_ County, Kansas, \_\_\_\_\_ feet North \_\_\_\_\_ feet West of Southeast corner of section.

Proposed Rate \_\_\_\_\_ Proposed Quantity \_\_\_\_\_

This point is:  Additional Well  Geo Center List other water rights that will use this point \_\_\_\_\_.

9. **Presently authorized point of diversion:**

One in the \_\_\_\_\_ Quarter of the \_\_\_\_\_ Quarter of the \_\_\_\_\_ Quarter of Section \_\_\_\_\_, Township \_\_\_\_\_ South, Range \_\_\_\_\_ (E/W), in \_\_\_\_\_ County, Kansas, \_\_\_\_\_ feet North \_\_\_\_\_ feet West of Southeast corner of section.

Authorized Rate \_\_\_\_\_ Authorized Quantity \_\_\_\_\_

(DWR use only: Computer ID No. \_\_\_\_\_ GPS \_\_\_\_\_ feet North \_\_\_\_\_ feet West)

This point will not be changed  This point will be changed as follows:

**Proposed point of diversion: (Complete only if change is requested)** PROPOSED NEW WELL

One in the SW Quarter of the SW Quarter of the SW Quarter of Section 18, Township 11 South, Range 17 E (E/W), in Jefferson County, Kansas, 540 feet North 5130 feet West of Southeast corner of section.

Proposed Rate \_\_\_\_\_ Proposed Quantity \_\_\_\_\_

This point is:  Additional Well  Geo Center List other water rights that will use this point \_\_\_\_\_.

10. **Presently authorized point of diversion:**

One in the \_\_\_\_\_ Quarter of the \_\_\_\_\_ Quarter of the \_\_\_\_\_ Quarter of Section \_\_\_\_\_, Township \_\_\_\_\_ South, Range \_\_\_\_\_ (E/W), in \_\_\_\_\_ County, Kansas, \_\_\_\_\_ feet North \_\_\_\_\_ feet West of Southeast corner of section.

Authorized Rate \_\_\_\_\_ Authorized Quantity \_\_\_\_\_

(DWR use only: Computer ID No. \_\_\_\_\_ GPS \_\_\_\_\_ feet North \_\_\_\_\_ feet West)

This point will not be changed  This point will be changed as follows:

**Proposed point of diversion: (Complete only if change is requested)** PROPOSED NEW CENTER OF BATTERY

One in the SW Quarter of the SW Quarter of the SW Quarter of Section 18, Township 11 South, Range 17 E (E/W), in Jefferson County, Kansas, 536 feet North 5036 feet West of Southeast corner of section.

Proposed Rate \_\_\_\_\_ Proposed Quantity \_\_\_\_\_

This point is:  Additional Well  Geo Center List other water rights that will use this point \_\_\_\_\_.

11. Describe the current condition of and future plans for any point(s) of diversion which will no longer be used. \_\_\_\_\_

**IF MORE SPACE IS NEEDED, ATTACH ADDITIONAL SHEETS AS NECESSARY**



MAY 23 2024

File No. 6,536

KS Dept. of Agriculture

12. The presently authorized use of water is for \_\_\_\_\_ purposes.  
It is proposed that the use be changed to \_\_\_\_\_ purposes.

13. If changing the place of use and/or use made of water, describe how the consumptive use will not be increased.  
\_\_\_\_\_  
\_\_\_\_\_  
\_\_\_\_\_

(Please show any calculations here.)

14. It is requested that the maximum annual quantity of water be reduced to \_\_\_\_\_ (acre-feet or million gallons).

15. It is requested that the maximum rate of diversion of water be reduced to \_\_\_\_\_ gallons per minute (\_\_\_\_\_ c.f.s.).

16. The application must include either a topographic map or detailed plat. A U.S. Geological Survey Topographic Map, scale 1:24,000, is available through the Kansas Geological Survey, 1930 Constant Avenue, University of Kansas, Lawrence, Kansas 66047-3726 ([www.usgs.gov](http://www.usgs.gov)). The map should show the location of the presently authorized point(s) of diversion. Distances North and West of the Southeast corner of the section must be shown. The presently authorized place of use should also be shown. Identify the center of the section, the section lines and the section corners and show the appropriate section, township, and range numbers on the map. In addition the following information must also be shown on the map.

- a. If a change in the location of the point(s) of diversion is proposed, show:
  - 1) The location of the proposed point(s) of diversion. Distances North and West of the Southeast corner of the section must be shown. Please be certain that the information shown on the map agrees with the information shown in Paragraph Nos. 9, 10 and 11 of the application.
  - 2) If the source of supply is groundwater, please show the location of existing water wells of any kind, including domestic wells, within 1/2 mile of the proposed well or wells. Identify each well as to its use and furnish name and mailing address of the property owner or owners. If there are no wells within 1/2 mile, please indicate so on the map.
  - 3) If the source of supply is surface water, the names and mailing addresses of all landowner(s) 1/2 mile downstream and 1/2 mile upstream from your property lines must be shown.
- b. If a change in the place of use is desired, show the proposed place of use by crosshatching on the map. Please be certain that the information shown on the map agrees with the information shown in Paragraph No. 5 of the application.

17. Attach documentation to show the change(s) proposed herein will not impair existing water rights and relates to the same local source of supply as to which the water right relates. This information may include statements, plats, geology reports, well logs, test hole logs, and other information as necessary information to show the above. Additional comments may be made below.  
\_\_\_\_\_  
\_\_\_\_\_  
\_\_\_\_\_

18. If the proposed change(s) does not meet all applicable rules and regulations of the Kansas Water Appropriation Act, please identify the rules and regulations for which you request a waiver. State the reason why a waiver is needed and why the request should be granted. Attach documentation showing that granting the request will not impair existing water rights and will not prejudicially and unreasonably affect the public interest.

The existing irrigation well, authorized by water right 29,352, does not meet the 1,320 foot spacing requirement for this new right. However, this well and the RWD No. 1 existing well #2 have had no history of interference. Since the maximum rate of diversion is not to be increased, and the location of the new well is further away from #29,352, there should be no adverse impact to adding this new well through the creation of a battery.

**IF MORE SPACE IS NEEDED, ATTACH ADDITIONAL SHEETS AS NECESSARY**

MAY 23 2024

File No. 6,536

KS Dept. of Agriculture

Any use of water that is not as authorized by the water right or permit to authorize water before the chief engineer approves this application is a violation of the Kansas Water Appropriation Act for which criminal or civil penalties may be assessed. Such violation is a class C misdemeanor, punishable by a fine not to exceed \$500 and/or a term of confinement not to exceed one month in the county jail. K.S.A. 82a-728(b). Civil penalties shall be not less than \$100 nor more than \$1,000 per violation. In the case of a continuing violation, each day such violation continues may be deemed a separate violation. In addition to these penalties the water right may be modified or suspended. K.S.A. 82a-737, as amended.

**The application must be signed by all owners of the place of use authorized under the water right and his or her spouse, if married. Please indicate if there is no spouse.** If land is being purchased under contract, the seller must sign as landowner until such time as the contract is completed.

In the event that all applicants cannot appear before one notary public, they may as necessary sign separate copies of the application before any notary public conveniently available to them. All copies signed in this manner shall be considered to be valid parts of the application.

If the request is signed on behalf of any Owner by someone with legal authority to do so (for example, an agent, one who has power of attorney, or an executor, executrix, conservator), it will be necessary to attach proper documents showing such authority.

**I declare that I am an owner of the currently authorized place of use as identified herein, or that I represent all such owners and am authorized to make this application on their behalf, and declare further that the statements contained herein are true, correct, and complete. By filing this application I authorize the chief engineer to permanently reduce the quantity of water and/or rate of diversion as specified in sections 14 and 15 of this application.**

Dated at Moriden, Kansas, this 14 day of May, 20 24.

Rod Bigam  
(Owner)

\_\_\_\_\_  
(Spouse)

Rod Bigam, RWD No. 1 Chairman

(Please Print)

\_\_\_\_\_  
(Please Print)

\_\_\_\_\_  
(Owner)

\_\_\_\_\_  
(Spouse)

\_\_\_\_\_  
(Please Print)

\_\_\_\_\_  
(Please Print)

\_\_\_\_\_  
(Owner)

\_\_\_\_\_  
(Spouse)

\_\_\_\_\_  
(Please Print)

\_\_\_\_\_  
(Please Print)

State of Kansas }  
County of Jefferson } SS

I hereby certify that the foregoing application was signed in my presence and sworn to before me this 14 day of May, 20 24.

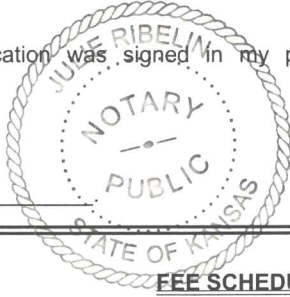

Julie Ribelin  
Notary Public  
Julie Ribelin

My Commission Expires 1/27/27

**FEE SCHEDULE**

Each application to change the place of use, the point of diversion or the use made of the water under this section shall be accompanied by the application fee set forth in the schedule below:

- (1) Application to change a point of diversion 300 feet or less . . . . . \$100
- (2) Application to change a point of diversion more than 300 feet . . . . . \$200
- (3) Application to change the place of use . . . . . \$200
- (4) Application to change the use made of the water . . . . . \$300

Make check payable to **Kansas Department of Agriculture.**



MAY 23 2024

KS Dept. of Agriculture

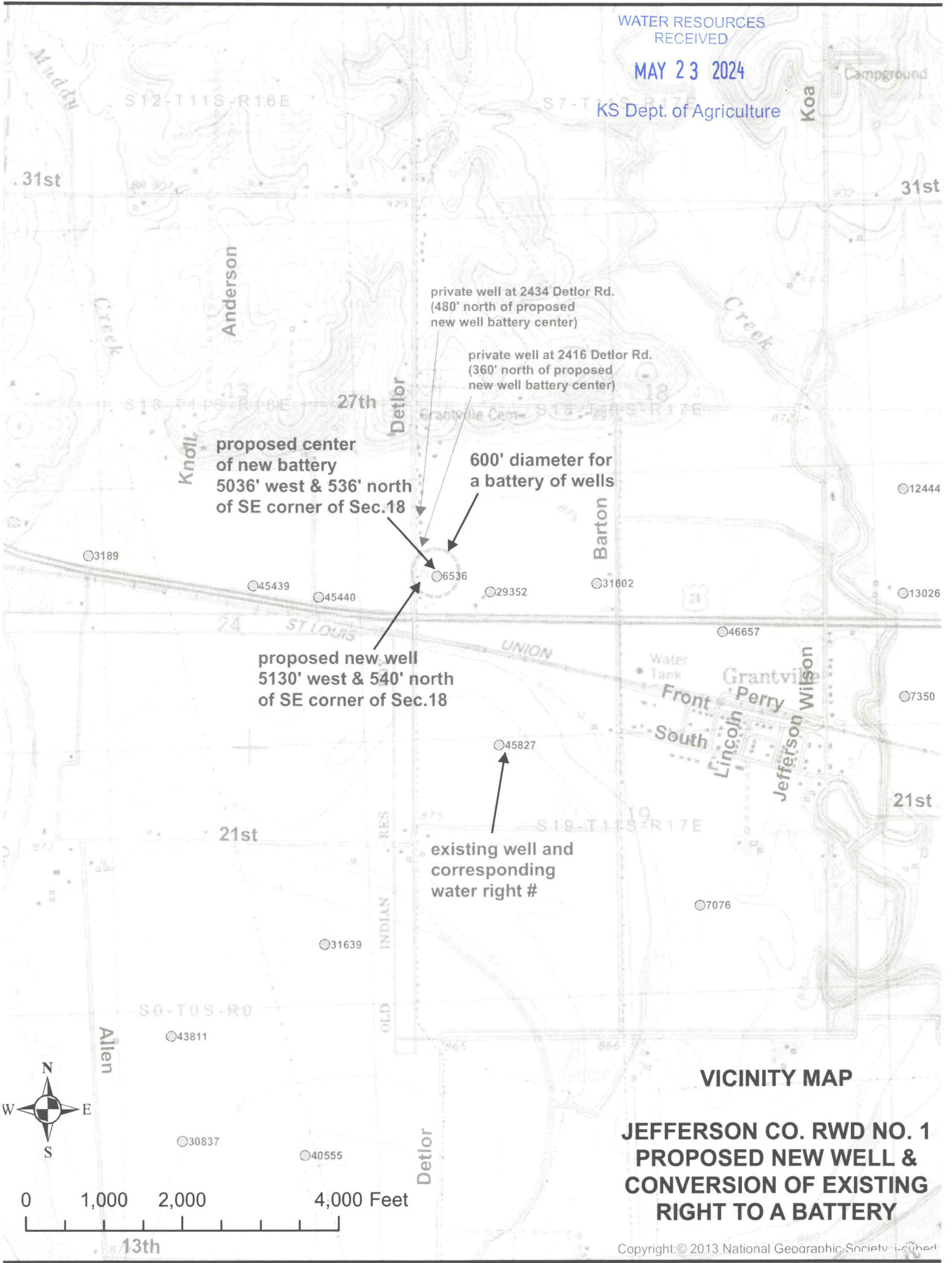

proposed center  
of new battery  
5036' west & 536' north  
of SE corner of Sec.18

private well at 2434 Detlor Rd.  
(480' north of proposed  
new well battery center)

private well at 2416 Detlor Rd.  
(360' north of proposed  
new well battery center)

600' diameter for  
a battery of wells

proposed new well  
5130' west & 540' north  
of SE corner of Sec.18

existing well and  
corresponding  
water right #



0 1,000 2,000 4,000 Feet

**VICINITY MAP**

**JEFFERSON CO. RWD NO. 1  
PROPOSED NEW WELL &  
CONVERSION OF EXISTING  
RIGHT TO A BATTERY**