

Submit To: CHIEF ENGINEER
Division of Water Resources
Kansas Department of Agriculture
1320 Research Park Drive
Manhattan, Kansas 66502
http://agriculture.ks.gov/dwr

**APPLICATION FOR APPROVAL TO
CHANGE THE PLACE OF USE, THE
POINT OF DIVERSION OR THE USE
MADE OF THE WATER UNDER AN
EXISTING WATER RIGHT**



State of Kansas

Filing Fee Must Accompany the Application
(Please refer to Fee Schedule on signature page of application form.)

Paragraph Nos. 1, 2, 3, 4 & 8 must be completed. Complete all other applicable portions. A topographic map or detailed plat showing the authorized and proposed points(s) of diversion and /or place of use must accompany this application.

WATER RESOURCES
RECEIVED

MAY 03 2024
1450

KS DEPT OF AGRICULTURE

1. Application is hereby made for approval of the Chief Engineer to change the

- Place of Use
(Check one or more) Point of Diversion
 Use Made of Water

File No. 717

2. Name of applicant: ICL Specialty Products, LLC

Address: 440 N 9th Street

City, State and Zip: Lawrence, KS 66044

Phone Number: (785) 749-8160

E-mail address: shane.munsch@icl-group.com

What is your relationship to the water right; owner tenant agent other? If other, please explain. _____

Name of water use correspondent: ICL Specialty Products, LLC

Address: 440 N 9th Street

City, State and Zip: Lawrence, KS 66044

Phone Number: (785) 749-8160

E-mail address: shane.munsch@icl-group.com

3. The change(s) proposed herein are desired for the following reasons (please be specific): Recently, Well 14 has been unable to supply plant demand by itself. Over the last few years, well rehabilitations have seen diminishing returns. This well was installed in 2003 and has run its course. A replacement is required to support ICL's operations.

The change(s) (was) (will be) completed by 10/31/2024

(Date)

For Office Use Only:

F.O. 1 GMD - Meets K.A.R. 5-5-1 YES / NO Use IND Source S County DG By KJN Date 5/6/24
Code CLT Fee \$ 100 TR # PY2405KC724 Receipt Date 5/3/24 Check # _____

5/7/2024
KAnderson

MAY 03 2024

4. The presently authorized place of use is:

Owner of Land — NAME: Same as applicant - No change

ADDRESS: KS DEPT OF AGRICULTURE

Sec.	Twp.	Range	NE¼				NW¼				SW¼				SE¼				TOTAL ACRES		
			NE¼	NW¼	SW¼	SE¼	NE¼	NW¼	SW¼	SE¼	NE¼	NW¼	SW¼	SE¼	NE¼	NW¼	SW¼	SE¼			

List any other water rights that cover this place of use. _____

Owner of Land — NAME: _____

ADDRESS: _____

Sec.	Twp.	Range	NE¼				NW¼				SW¼				SE¼				TOTAL ACRES			
			NE¼	NW¼	SW¼	SE¼	NE¼	NW¼	SW¼	SE¼	NE¼	NW¼	SW¼	SE¼	NE¼	NW¼	SW¼	SE¼				

List any other water rights that cover this place of use. _____

(If there are more than two landowners, attach additional sheets as necessary.)

5. It is proposed that the place of use be changed to:

Owner of Land — NAME: _____

ADDRESS: _____

Sec.	Twp.	Range	NE¼				NW¼				SW¼				SE¼				TOTAL ACRES				
			NE¼	NW¼	SW¼	SE¼	NE¼	NW¼	SW¼	SE¼	NE¼	NW¼	SW¼	SE¼	NE¼	NW¼	SW¼	SE¼					

List any other water rights that cover this place of use. _____

Owner of Land — NAME: _____

ADDRESS: _____

Sec.	Twp.	Range	NE¼				NW¼				SW¼				SE¼				TOTAL ACRES					
			NE¼	NW¼	SW¼	SE¼	NE¼	NW¼	SW¼	SE¼	NE¼	NW¼	SW¼	SE¼	NE¼	NW¼	SW¼	SE¼						

List any other water rights that cover this place of use. _____

IF MORE SPACE IS NEEDED, ATTACH ADDITIONAL SHEETS AS NECESSARY

MAY 03 2024

6. The presently authorized point(s) of diversion (is) (are) Well 14, 7A & 6A
(Provide description and number of points)
7. The proposed point(s) of diversion (is) (are) Well 14
KS DEPT OF AGRICULTURE
(Provide description and number of points)

List all presently authorized point(s) of diversion:

8. **Presently authorized point of diversion:**
 One in the SW Quarter of the NE Quarter of the NE Quarter of Section 29, Township 12 South, Range 20 E (E/W), in Douglas County, Kansas, 4,010 feet North 892 feet West of Southeast corner of section.
 Authorized Rate 500 gpm Authorized Quantity 262.8 mgy
 (DWR use only: Computer ID No. _____ GPS Well 14 feet North _____ feet West)
 This point will not be changed This point will be changed as follows:
Proposed point of diversion: (Complete only if change is requested)
 One in the SW Quarter of the NE Quarter of the NE Quarter of Section 29, Township 12 South, Range 20 E (E/W), in Douglas County, Kansas, TBD feet North TBD feet West of Southeast corner of section.
 Proposed Rate 500 gpm Proposed Quantity 262.8 mpy
 This point is: Additional Well Geo Center List other water rights that will use this point _____

9. **Presently authorized point of diversion:**
 One in the SE Quarter of the NE Quarter of the NE Quarter of Section 29, Township 12 South, Range 20 E (E/W), in Douglas County, Kansas, 4,313 feet North 178 feet West of Southeast corner of section.
 Authorized Rate 500 gpm Authorized Quantity 262.8 mgy
 (DWR use only: Computer ID No. _____ GPS Well 7A feet North _____ feet West)
 This point will not be changed This point will be changed as follows:
Proposed point of diversion: (Complete only if change is requested)
 One in the _____ Quarter of the _____ Quarter of the _____ Quarter of Section _____, Township _____ South, Range _____ (E/W), in _____ County, Kansas, _____ feet North _____ feet West of Southeast corner of section.
 Proposed Rate _____ Proposed Quantity _____
 This point is: Additional Well Geo Center List other water rights that will use this point _____

10. **Presently authorized point of diversion:**
 One in the NE Quarter of the SW Quarter of the NE Quarter of Section 29, Township 12 South, Range 20 E (E/W), in Douglas County, Kansas, 3,789 feet North 1,609 feet West of Southeast corner of section.
 Authorized Rate 500 gpm Authorized Quantity 262.8 mgy
 (DWR use only: Computer ID No. _____ GPS Well 6A feet North _____ feet West)
 This point will not be changed This point will be changed as follows:
Proposed point of diversion: (Complete only if change is requested)
 One in the _____ Quarter of the _____ Quarter of the _____ Quarter of Section _____, Township _____ South, Range _____ (E/W), in _____ County, Kansas, _____ feet North _____ feet West of Southeast corner of section.
 Proposed Rate _____ Proposed Quantity _____
 This point is: Additional Well Geo Center List other water rights that will use this point _____

11. Describe the current condition of and future plans for any point(s) of diversion which will no longer be used. Old well will be plugged per KDHE regulations.

IF MORE SPACE IS NEEDED, ATTACH ADDITIONAL SHEETS AS NECESSARY

12. The presently authorized use of water is for _____ purposes.
It is proposed that the use be changed to _____ purposes.

13. If changing the place of use and/or use made of water, describe how the consumptive use will not be increased.

WATER RESOURCES
RECEIVED

MAY 03 2024

KS DEPT OF AGRICULTURE

(Please show any calculations here.)

14. It is requested that the maximum annual quantity of water be reduced to _____ (acre-feet or million gallons).

15. It is requested that the maximum rate of diversion of water be reduced to _____ gallons per minute (_____ c.f.s.).

16. The application must include either a topographic map or detailed plat. A U.S. Geological Survey Topographic Map, scale 1:24,000, is available through the Kansas Geological Survey, 1930 Constant Avenue, University of Kansas, Lawrence, Kansas 66047-3726 (www.usgs.gov). The map should show the location of the presently authorized point(s) of diversion. Distances North and West of the Southeast corner of the section must be shown. The presently authorized place of use should also be shown. Identify the center of the section, the section lines and the section corners and show the appropriate section, township, and range numbers on the map. In addition the following information must also be shown on the map.

a. If a change in the location of the point(s) of diversion is proposed, show:

- 1) The location of the proposed point(s) of diversion. Distances North and West of the Southeast corner of the section must be shown. Please be certain that the information shown on the map agrees with the information shown in Paragraph Nos. 9, 10 and 11 of the application.
- 2) If the source of supply is groundwater, please show the location of existing water wells of any kind, including domestic wells, within 1/2 mile of the proposed well or wells. Identify each well as to its use and furnish name and mailing address of the property owner or owners. If there are no wells within 1/2 mile, please indicate so on the map.
- 3) If the source of supply is surface water, the names and mailing addresses of all landowner(s) 1/2 mile downstream and 1/2 mile upstream from your property lines must be shown.

b. If a change in the place of use is desired, show the proposed place of use by crosshatching on the map. Please be certain that the information shown on the map agrees with the information shown in Paragraph No. 5 of the application.

17. Attach documentation to show the change(s) proposed herein will not impair existing water rights and relates to the same local source of supply as to which the water right relates. This information may include statements, plats, geology reports, well logs, test hole logs, and other information as necessary information to show the above. Additional comments may be made below.

18. If the proposed change(s) does not meet all applicable rules and regulations of the Kansas Water Appropriation Act, please identify the rules and regulations for which you request a waiver. State the reason why a waiver is needed and why the request should be granted. Attach documentation showing that granting the request will not impair existing water rights and will not prejudicially and unreasonably affect the public interest.

IF MORE SPACE IS NEEDED, ATTACH ADDITIONAL SHEETS AS NECESSARY

Any use of water that is not as authorized by the water right or permit to authorize water **before** the chief engineer approves this application is a violation of the Kansas Water Appropriation Act for which criminal or civil penalties may be assessed. Such violation is a class C misdemeanor, punishable by a fine not to exceed \$500 and/or a term of confinement not to exceed one month in the county jail. K.S.A. 82a-728(b). Civil penalties shall be not less than \$100 nor more than \$1,000 per violation. In the case of a continuing violation, each day such violation continues may be deemed a separate violation. In addition to these penalties the water right may be modified or suspended. K.S.A. 82a-737, as amended.

The application must be signed by all owners of the place of use authorized under the water right and his or her spouse, if married. Please indicate if there is no spouse. If land is being purchased under contract, the seller must sign as landowner until such time as the contract is completed.

In the event that all applicants cannot appear before one notary public, they may as necessary sign separate copies of the application before any notary public conveniently available to them. All copies signed in this manner shall be considered to be valid parts of the application.

If the request is signed on behalf of any Owner by someone with legal authority to do so (for example, an agent, one who has power of attorney, or an executor, executrix, conservator), it will be necessary to attach proper documents showing such authority.

I declare that I am an owner of the currently authorized place of use as identified herein, or that I represent all such owners and am authorized to make this application on their behalf, and declare further that the statements contained herein are true, correct, and complete. By filing this application I authorize the chief engineer to permanently reduce the quantity of water and/or rate of diversion as specified in sections 14 and 15 of this application.

Dated at Lawrence, Kansas, this 29th day of April, 2024.

<u>Jason B. Miller</u> (Owner)	_____	(Spouse)
<u>Jason B. Miller</u> (Please Print)	_____	(Please Print)
_____	_____	(Spouse)
_____	_____	(Please Print)
_____	_____	(Spouse)
_____	_____	(Please Print)

State of Kansas }
County of Douglas } SS

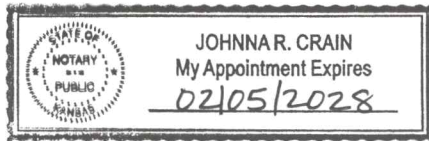

I hereby certify that the foregoing application was signed in my presence and sworn to before me this 29 day of April, 2024.

J Crain
Notary Public

My Commission Expires 02/05/28.

FEE SCHEDULE

Each application to change the place of use, the point of diversion or the use made of the water under this section shall be accompanied by the application fee set forth in the schedule below:

- (1) Application to change a point of diversion 300 feet or less \$100
- (2) Application to change a point of diversion more than 300 feet \$200
- (3) Application to change the place of use \$200
- (4) Application to change the use made of the water \$300

Make check payable to **Kansas Department of Agriculture.**

WATER RESOURCES
RECEIVED

MAY 03 2024

KS DEPT OF AGRICULTURE

Bismark Grove

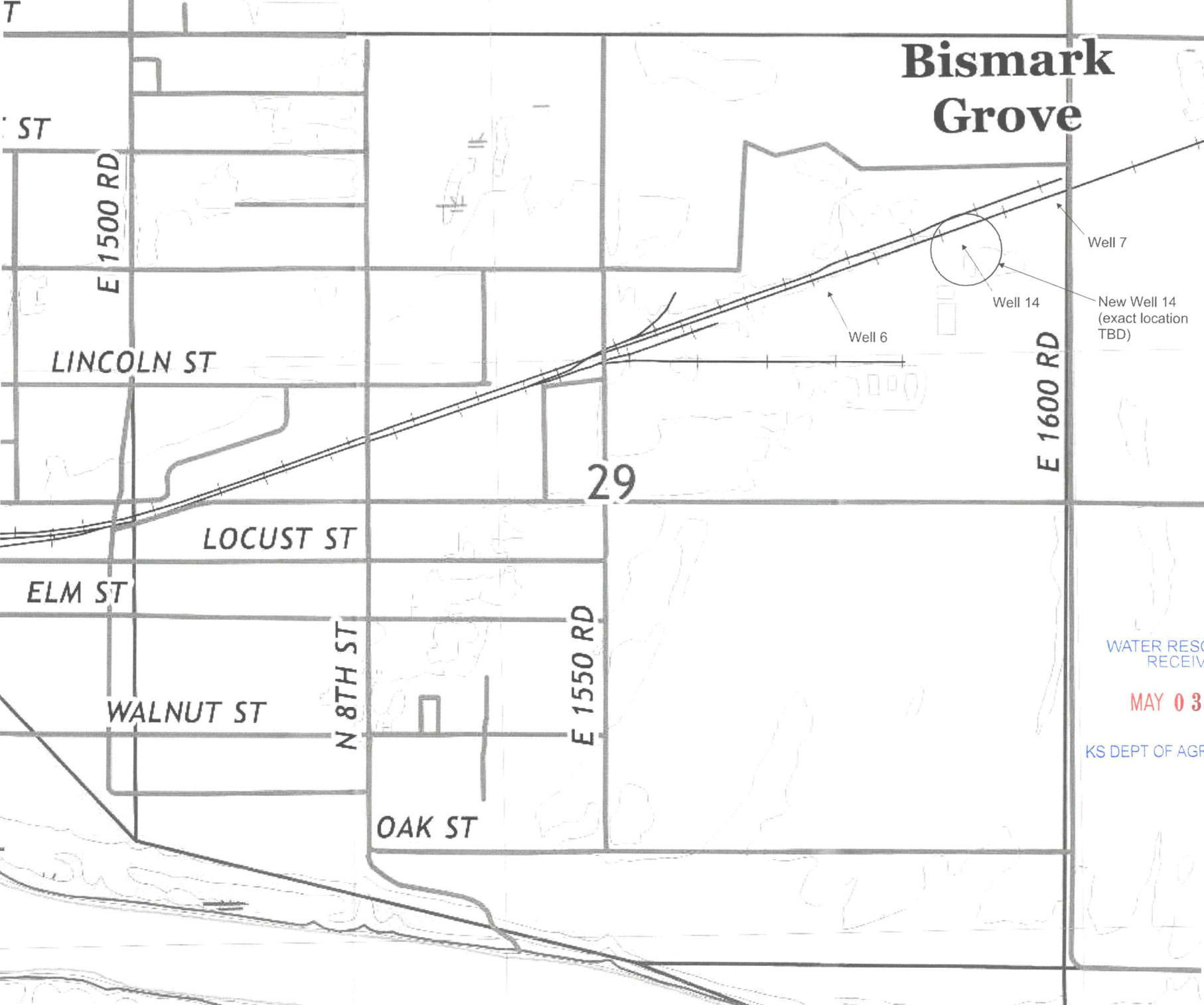

WATER RESOURCES
RECEIVED

MAY 03 2024

KS DEPT OF AGRICULTURE

MAY 03 2024



U.S. DEPARTMENT OF THE INTERIOR
U.S. GEOLOGICAL SURVEY



KS DEPT OF AGRICULTURE

LAWRENCE EAST QUADRANGLE
KANSAS
7.5-MINUTE SERIES

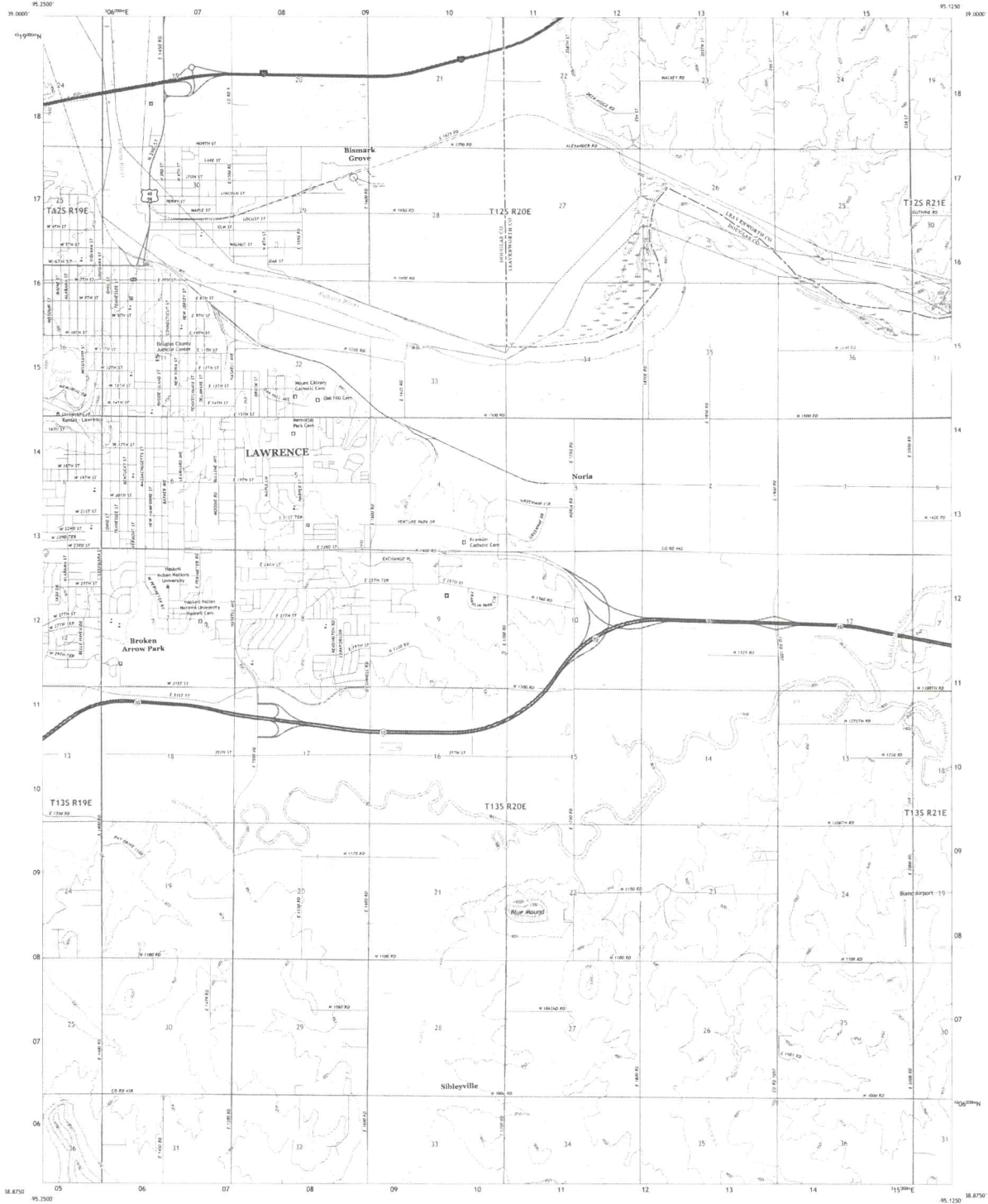

Produced by the United States Geological Survey
North American Datum of 1983 (NAD83)
World Geodetic System of 1984 (WGS84) Projection and
1:250,000 scale grid (National Geographic Grid) Zone 18
This map is not a legal document. Users may be
generally for this map scale. Please check with government
agencies for more information.
Imagery: NAIP August 2017, Derivative 2017
Base: U.S. Census Bureau, 2015
Hydrography: National Hydrography Dataset, 2011
Contours: National Elevation Dataset, 2017
Roads: Multi-Scale Vector, Intersected File, 2018
Place Names: National Geographic, 2018
Boundaries: National Wetlands Inventory, 1983

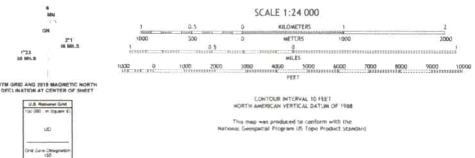

ROAD CLASSIFICATION

Expressway	Local Connector
Secondary Hwy	Local Road
Artery	RD
Interstate Route	IA Route
	Unimproved

LAWRENCE EAST, KS
2022



1320 Research Park Drive
Manhattan, KS 66502
785-564-6700
www. agriculture.ks.gov



900 SW Jackson, Room 456
Topeka, KS 66612
785-296-3556

Mike Beam, Secretary

Laura Kelly, Governor

May 10, 2024

ICL SPECIALTY PRODUCTS LLC
440 N 9TH STREET
LAWRENCE KS 66044

RE: File No(s). 717

Dear Sir or Madam:

The Division of Water Resources (Division) has received your application(s) to change the place of use, point of diversion or use made of water for the file number(s) referenced above. Please be aware that the Division may have a large number of pending applications on hand at times and makes every attempt to process them in the order in which they are received. You will be contacted if additional information is required.

Please note, this letter only acknowledges receipt of your application(s) and does not guarantee approval. In accordance with the provisions of the Kansas Water Appropriation(s) Act, the use of water as proposed prior to approval of the application(s) is unlawful.

Additional information about the process may be found on our website at agriculture.ks.gov/divisions-programs/dwr. If you have any other questions, please contact our office at 785-564-6640 or your local Topeka Field Office at 785-296-5733. If you call, please reference the file number so we can help you more efficiently.

Sincerely,

A handwritten signature in black ink that reads "Kristen A. Baum". The signature is written in a cursive style.

Kristen Baum
New Applications and Changes Supervisor
Water Appropriation Program