

Kansas Department of Agriculture
Division of Water Resources
PERMIT OF NEW APPLICATION WORKSHEET

1. File Number: <p style="text-align: center; font-size: 1.2em;">49,490</p>	2. Status Change Date: <p style="text-align: center; font-size: 1.2em;"><i>8/12/2016</i></p>	3. Field Office: <p style="text-align: center; font-size: 1.2em;">3</p>	4. GMD: <p style="text-align: center; font-size: 1.2em;">0</p>
5. Status: <input checked="" type="checkbox"/> Approved <input type="checkbox"/> Denied by DWR/GMD <input type="checkbox"/> Dismiss by Request/Failure to Return			
6. Enclosures: <input type="checkbox"/> Check Valve <input checked="" type="checkbox"/> N of C Form <input type="checkbox"/> Water Tube <input type="checkbox"/> Driller Copy <input type="checkbox"/> Meter			
<p>7a. Applicant(s) Person ID 40452 New to system <input type="checkbox"/> Add Seq# 1</p> <p>KANSAS DEPT OF WILDLIFE PARKS & TOURISM ACTIVE DIVERSIONS (STKFO) 1020 S KANSAS AVE FL 2 TOPEKA KS 66612-1389</p> <p>7b. Landowner(s) Person ID _____ New to system <input type="checkbox"/> Add Seq# _____</p> <p>7a.</p>	<p>7c. Landowner(s) Person ID _____</p> <p>7d.</p>		
<p>8. WUR Correspondent Person ID _____ New to system <input type="checkbox"/> Add Seq# _____ Overlap File (s) WUC Notarized WUC Form <input type="checkbox"/> Agree <input type="checkbox"/> Yes <input type="checkbox"/> No</p> <p>7a.</p>	<p>9. Use of Water: Changing? <input type="checkbox"/> Yes <input checked="" type="checkbox"/> No</p> <p style="padding-left: 40px;"><input type="checkbox"/> Groundwater <input checked="" type="checkbox"/> Surface Water</p> <p><input type="checkbox"/> IRR <input checked="" type="checkbox"/> REC <input type="checkbox"/> DEW <input type="checkbox"/> MUN</p> <p><input type="checkbox"/> STK <input type="checkbox"/> SED <input type="checkbox"/> DOM <input type="checkbox"/> CON</p> <p><input type="checkbox"/> HYD DRG <input type="checkbox"/> WTR PWR <input type="checkbox"/> ART RECHRG</p> <p><input type="checkbox"/> IND SIC: _____ <input type="checkbox"/> OTHER: _____</p>		
10. Completion Date: <u>12/31/2017</u> 11. Perfection Date: <u>12/31/2021</u> 12. Exp Date: _____			
13. Conservation Plan Required? <input type="checkbox"/> Yes <input checked="" type="checkbox"/> No Date Required: _____ Date Approved: _____ Date to Comply: _____			
14. Water Level Measuring Device? <input type="checkbox"/> Yes <input checked="" type="checkbox"/> No Date to Comply: _____ Date WLMD Installed: _____			
<p>Date Prepared: 8/10/2016 By: EMC Date Entered: <i>8/15/2016</i> By: <i>WM</i></p>			

File No. **49,490** 15. Formation Code: **NF** Drainage Basin: **REPUBLICAN** County: **CLOUD** Special Use: Stream: **BUFFALO CREEK TRIB 3**

16. Points of Diversion										17. Rate and Quantity					
MOD	DEL	ENT	PDIV	Qualifier	S	T	R	ID	'N	'W	Authorized		Additional		Overlap PD Files
											Rate gpm	Quantity af	Rate gpm	Quantity af	
√			84774								NF	100	NF	100	NONE

18. Storage: Rate _____ NF Quantity _____ ac/ft Additional Rate _____ NF Additional Quantity _____ ac/ft

19. Limitation: _____ af/yr at _____ gpm (_____ cfs) when combined with file number(s) _____
 Limitation: _____ af/yr at _____ gpm (_____ cfs) when combined with file number(s) _____

20. Meter Required? Yes No To be installed by _____ Date Acceptable Meter Installed _____

21. Place of Use T MOD DEL ENT	PUSE	S	T	R	ID	NE¼				NW¼				SW¼				SE¼				Total	Owner	Chg? NO	Overlap Files		
						NE ¼	NW ¼	SW ¼	SE ¼	NE ¼	NW ¼	SW ¼	SE ¼	NE ¼	NW ¼	SW ¼	SE ¼	NE ¼	NW ¼	SW ¼	SE ¼						
MOD	67448																								7a.	NO	NONE

Comments:

KANSAS DEPARTMENT OF AGRICULTURE
Division of Water Resources

M E M O R A N D U M

TO: Files

DATE: August 10, 2016

FROM: Erin McGrogan

RE: Application, File No. 49,490

The Kansas Department of Wildlife Parks and Tourism has filed the above-referenced application to appropriate 100 acre-feet of surface water from natural flows of a tributary to Buffalo Creek (Lower Republican River), for recreational use in a wildlife marsh. As typical for these types of projects, the surface water will be collected via natural flows (especially during flood events). The marsh is located in the Northeast Quarter and South Half of the Southeast Quarter of Section 16, Township 5 South, Range 5 West, in Cloud County, Kansas and is owned by the applicant. The point of diversion represents the water control structure (stop log). Structures Program staff permitted the water control structure in 2014 under LCD-0074.

The application is designed to allow for the storage volume of the marsh at .7 feet elevation, with evaporative loss determined as follows: 54.5 acres x 22 inches (NET Cloud County) / 12 inches per foot x 1 year = 100 acre-feet. Included with this proposed quantity will be an amount for seepage and the quantity to maintain at a depth of .7 feet for the 54.5 acres of marsh.

For wetland projects such as this the water levels are typically maintained only between October 1 and April 1 of each year, and then natural vegetation will be allowed to grow in the dry pools during the remaining time. The applicant provided information that the waterfowl migration for this project was approximately August 15 through May 15, each year. Conditions are maintained with the availability of surface water flows and are determined by the Republican River standard diversion conditions for the permit for such projects.

The applicant provided information regarding property owners within one-half mile of the property line. The two owners were notified in a DWR correspondence dated June 20, 2016 on the applicant's intent to appropriate water. On July 1, 2016 DWR received a correspondence from the law firm of Allen, Sweet, & Carter LLC representing six property owners. The major concern it appears was related to flood control and drainage problems associated with the levee. The attorney correspondence was forwarded to the Water Structures Program in the Stream Obstruction's Unit of DWR. A further response to the appropriations application was sent from DWR to the firm representing the property owners on July 7, 2016. The Stream Obstruction Unit also responded to the attorney's concern in a DWR correspondence dated July 8, 2016. No response has been received as to the date of this memorandum from the law firm or property owners. All non-domestic surface water diversion located within two mile of the proposed point of diversion is owned by the applicant.

A flow meter is not practical and should not be required as a condition of the approval of this application. The applicant will be required to maintain records from which the amount of water actually diverted may be readily determined. This is consistent with permits granted for similar types of projects.

In an August 3, 2016 e-mail, Kelly Stewart Water Commissioner, Stockton Field Office, recommended that the referenced application be approved with the applicable surface water diversion conditions for the permit for the Republican River.

Based upon the above discussion, the area is open to new applications, the project is in the public interest, and there is no indication that the proposed beneficial use of water will impair existing water rights, it is recommended that the referenced application be approved.

Erin McGrogan

Erin McGrogan
Environmental Scientist
Water Appropriation Program

1320 Research Park Drive
Manhattan, Kansas 66502
(785) 564-6700



900 SW Jackson, Room 456
Topeka, Kansas 66612
(785) 296-3556

Jackie McClaskey, Secretary

Governor Sam Brownback

August 15, 2016

KANSAS DEPT OF WILDLIFE PARKS & TOURISM
2446 250 ROAD
WEBBER KS 66970

FILE COPY

RE: Appropriation of Water, File No. 49,490

Dear Sir or Madam:

There is enclosed a permit to appropriate water authorizing you to proceed with construction of the proposed diversion works (except those dams and stream obstructions regulated by K.S.A. 82a-301 through 305a), to divert such unappropriated water as may be available from the source and at the location specified in the permit, and to use it for the purpose and at the location described in the permit.

Your attention is directed to the enclosures and to the terms, conditions, and limitations specified in this permit. Records must be maintained from which the quantity of water actually diverted may be readily determined. Such records shall be furnished to the Chief Engineer by March 1 following the end of each calendar year.

Failure to notify the Chief Engineer of the Division of Water Resources of the completion of the diversion works within the time allowed, or within any authorized extension of time thereof, will result in the dismissal of this permit. Enclosed is a form which may be used to notify the Chief Engineer that the proposed diversion works have been completed.

All requests for extensions of time to complete diversion works, or to perfect appropriations, must be submitted to the Chief Engineer before the expiration of time originally set forth in the permit to complete diversion works or to perfect an appropriation. If for any reason, you require an extension of time, you must request it before the expiration of time set forth in this permit. Failure to comply with this regulation will result in the dismissal of your permit or your water right. Any request for an extension of time shall be accompanied by the required statutory fee, which is currently \$100.00.

There is also enclosed an information sheet setting forth the procedure to obtain a Certificate of Appropriation which will establish the extent of your water right. If you have any questions, please contact our office. If you wish to discuss a specific file, please have the file number ready so that we may help you more efficiently.

Sincerely,

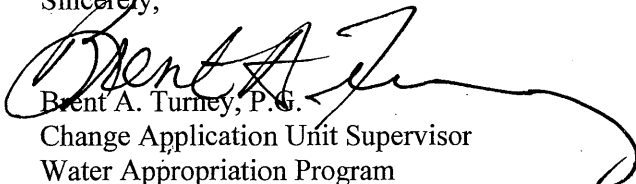
Brent A. Turney, P.E.
Change Application Unit Supervisor
Water Appropriation Program

BAT: emc

Enclosures
pc: Stockton Field Office



KANSAS DEPARTMENT OF AGRICULTURE
Jackie McClaskey, Secretary of Agriculture

DIVISION OF WATER RESOURCES
David W. Barfield, Chief Engineer

**APPROVAL OF APPLICATION
and
PERMIT TO PROCEED**

(This is not a Certificate of Appropriation)

FILE COPY

This is to certify that I have examined Application, **File No. 49,490** of the applicant

**KANSAS DEPT OF WILDLIFE PARKS & TOURISM
2446 250 ROAD
WEBBER KANSAS 66970**

for a permit to appropriate water for beneficial use, together with the maps, plans and other submitted data, and that the application is hereby approved and the applicant is hereby authorized, subject to vested rights and prior appropriations, to proceed with the construction of the proposed diversion works (except those dams and stream obstructions regulated by K.S.A. 82a-301 through 305a, as amended), and to proceed with all steps necessary for the application of the water to the approved and proposed beneficial use and otherwise perfect the proposed appropriation subject to the following terms, conditions and limitations:

1. That the priority date assigned to such application is **October 23, 2015**.
2. That the water sought to be appropriated shall be used for recreational purposes in a wildlife marsh located in the Northeast Quarter of the Southeast Quarter (NE $\frac{1}{4}$ SE $\frac{1}{4}$) and the South Half of the Southeast Quarter (S $\frac{1}{2}$ SE $\frac{1}{4}$) of Section 16, Township 5 South, Range 5 West, Cloud County.
3. That the appropriation sought shall be limited to all natural flows of an unnamed tributary to the Verdigris River, identified in the office of the Chief Engineer as Buffalo Creek Trib 3 (Republican), not needed to satisfy all vested rights and prior appropriation rights, to be stored to a maximum extent of **100 acre-feet** per calendar year in a wildlife marsh created by one (1) water control structure located in the Northeast Quarter of the Southeast Quarter of the Southeast Quarter (NE $\frac{1}{4}$ SE $\frac{1}{4}$ SE $\frac{1}{4}$) of Section 16, more particularly described as being near a point 1,320 feet North and 75 feet West of the Southeast corner of said section, in Township 5 South, Range 5 West, Cloud County, Kansas, located substantially as shown on the topographic map accompanying the application.
4. That installation of works for diversion of water shall be completed on or before **December 31, 2017** or within any authorized extension thereof. The applicant shall notify the Chief Engineer and pay the statutorily required field inspection fee, which is currently \$400.00, when construction of the works has been completed. Failure to timely submit the notice and the fee will result in revocation of the permit. Any request for an extension of time shall be submitted prior to the expiration of the deadline and shall be accompanied by the required statutory fee, which is currently \$100.00.
5. That the proposed appropriation shall be perfected by the actual application of water to the proposed beneficial use on or before **December 31, 2021** or any authorized extension thereof. Any request for an extension of time shall be submitted prior to the expiration of the deadline and shall be accompanied by the required statutory fee, which is currently \$100.00.

6. That the applicant shall not be deemed to have acquired a water appropriation for a quantity in excess of the amount approved herein nor in excess of the amount found by the Chief Engineer to have been actually used for the approved purpose during one calendar year subsequent to approval of the application and within the time specified for perfection or any authorized extension thereof.
7. That the use of water herein authorized shall not be made so as to impair any use under existing water rights nor prejudicially and unreasonably affect the public interest.
8. That the right of the appropriator shall relate to a specific quantity of water and such right must allow for a reasonable raising or lowering of the static water level and for the reasonable increase or decrease of the streamflow at the appropriator's point of diversion.
9. That this permit does not constitute authority under K.S.A. 82a-301 through 305a to construct any dam or other obstruction; nor does it grant any right-of-way, or authorize entry upon or injury to, public or private property.
10. That the applicant shall maintain accurate and complete records from which the quantity of water diverted during each calendar year may be readily determined and the applicant shall file an annual water use report with the Chief Engineer by March 1 following the end of each calendar year. Failure to file the annual water use report by the due date shall cause the applicant to be subject to a civil penalty.
11. That no water user shall engage in nor allow the waste of any water diverted under the authority of this permit.
12. That failure without cause to comply with provisions of the permit and its terms, conditions and limitations will result in the forfeiture of the priority date, revocation of the permit and dismissal of the application.
13. That the right to appropriate water under authority of this permit is subject to any minimum desirable streamflow requirements identified and established pursuant to K.S.A. 82a-703c for the source of supply to which this water right applies.
14. That the stream flow shall not be stopped at the first riffle below the point of diversion while diversion is taking place under the authority of this water right or permit.
15. That in order to implement the provisions of K.A.R. 5-3-11(d)(6), no water shall be diverted unless the written permission of the Chief Engineer, or an authorized representative of the Chief Engineer, is obtained each time the applicant desires to divert water. The approval of this permit is not an indication that surface water will be available from this source of supply, or that written permission will be granted to divert water.

CERTIFICATE OF SERVICE

On this 15th day of August, 2016, I hereby certify that the foregoing Approval of Application, File No. 49,490, dated August 12, 2016 was mailed postage prepaid, first class, US mail to the following:

KANSAS DEPT OF WILDLIFE PARKS & TOURISM
2446 250 ROAD
WEBBER KS 66970

With photocopies to:

Stockton Field Office

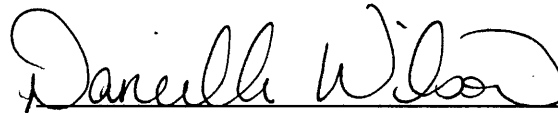

Division of Water Resources

THE STATE



APPLICATION COMPLETE
8/8/2016
OF KANSAS

WATER RESOURCES RECEIVED

OCT 23 2015

11:37

KS DEPT OF AGRICULTURE

KANSAS DEPARTMENT OF AGRICULTURE
Jackie McClaskey, Secretary of Agriculture

DIVISION OF WATER RESOURCES
David W. Barfield, Chief Engineer

File Number 49,490
This item to be completed by the Division of Water Resources.

**APPLICATION FOR PERMIT TO
APPROPRIATE WATER FOR BENEFICIAL USE**

Filing Fee Must Accompany the Application
(Please refer to Fee Schedule attached to this application form.)

UNACCEPTABLE PRIORITY
WATER RESOURCES RECEIVED
SEP 08 2015
12:05
KS DEPT OF AGRICULTURE

To the Chief Engineer of the Division of Water Resources, Kansas Department of Agriculture,
1320 Research Park Drive, Manhattan, Kansas 66502:

1. Name of Applicant (Please Print): Kansas Dept. of Wildlife, Parks and Tourism
Address: 2446 250 Rd
City: Webber State KS Zip Code 66970
Telephone Number: (785) 753-4971

2. The source of water is: surface water in Buffalo Creek Trib 3, Republican (lower Republican)
Buffalo Creek Waterashed (stream)
OR groundwater in _____ (drainage basin)

Certain streams in Kansas have minimum target flows established by law or may be subject to administration when water is released from storage for use by water assurance district members. If your application is subject to these regulations on the date we receive your application, you will be sent the appropriate form to complete and return to the Division of Water Resources.

3. The maximum quantity of water desired is 100 acre-feet OR _____ gallons per calendar year, to be diverted at a maximum rate of NF * gallons per minute OR _____ cubic feet per second.

* KAB/DWR 10/23/15

Once your application has been assigned a priority, the requested maximum rate of diversion and maximum requested quantity of water under that priority number can **NOT** be increased. Please be certain your requested maximum rate of diversion and maximum quantity of water are appropriate and reasonable for your proposed project and are in agreement with the Division of Water Resources' requirements.

4. The water is intended to be appropriated for (Check use intended):
(a) Artificial Recharge (b) Irrigation (c) Recreational (d) Water Power
(e) Industrial (f) Municipal (g) Stockwatering (h) Sediment Control
(i) Domestic (j) Dewatering (k) Hydraulic Dredging (l) Fire Protection
(m) Thermal Exchange (n) Contamination Remediation

YOU **MUST** COMPLETE AND ATTACH ADDITIONAL DIVISION OF WATER RESOURCES FORM(S) PROVIDING INFORMATION TO SUBSTANTIATE YOUR REQUEST FOR THE AMOUNT OF WATER FOR THE INTENDED USE REFERENCED ABOVE.

For Office Use Only:
F.O. 3 GMD 0 Meets K.A.R. 5-3-1 (YES/NO) Use REC Source G/S County CD By AJW Date 10/23/15
Code REG Fee \$ 200 TR # 2011058 Receipt Date _____ Check # _____

5. The location of the proposed wells, pump sites or other works for diversion of water is:

Note: For the application to be accepted, the point of diversion location must be described to at least a 10 acre tract, unless you specifically request a 60 day period of time in which to locate the site within a specifically described, minimal legal quarter section of land.

(A) One in the NE quarter of the SE quarter of the SE quarter of Section 16, more particularly described as being near a point 1320 feet North and 75 feet West of the Southeast corner of said section, in Township 5 South, Range 5 West (circle one), Cloud County County, Kansas.

(B) One in the _____ quarter of the _____ quarter of the _____ quarter of Section _____, more particularly described as being near a point _____ feet North and _____ feet West of the Southeast corner of said section, in Township _____ South, Range _____ East/West (circle one), _____ County, Kansas.

(C) One in the _____ quarter of the _____ quarter of the _____ quarter of Section _____, more particularly described as being near a point _____ feet North and _____ feet West of the Southeast corner of said section, in Township _____ South, Range _____ East/West (circle one), _____ County, Kansas.

(D) One in the _____ quarter of the _____ quarter of the _____ quarter of Section _____, more particularly described as being near a point _____ feet North and _____ feet West of the Southeast corner of said section, in Township _____ South, Range _____ East/West (circle one), _____ County, Kansas.

If the source of supply is groundwater, a separate application shall be filed for each proposed well or battery of wells, except that a single application may include up to four wells within a circle with a quarter (1/4) mile radius in the same local source of supply which do not exceed a maximum diversion rate of 20 gallons per minute per well.

A battery of wells is defined as two or more wells connected to a common pump by a manifold; or not more than four wells in the same local source of supply within a 300 foot radius circle which are being operated by pumps not to exceed a total maximum diversion rate of 800 gallons per minute and which supply water to a common distribution system.

6. The owner of the point of diversion, if other than the applicant is (please print):

(name, address and telephone number)

(name, address and telephone number)

You must provide evidence of legal access to, or control of, the point of diversion from the landowner or the landowner's authorized representative. Provide a copy of a recorded deed, lease, easement or other document with this application. In lieu thereof, you may sign the following sworn statement:

I have legal access to, or control of, the point of diversion described in this application from the landowner or the landowner's authorized representative. I declare under penalty of perjury that the foregoing is true and correct.

Executed on 15TH DAY OF AUGUST 2015.

[Signature]
Applicant's Signature

The applicant must provide the required information or signature irrespective of whether they are the landowner.
Failure to complete this portion of the application will cause it to be unacceptable for filing and the application will be returned to the applicant.

7. The proposed project for diversion of water will consist of one 4,335 ft long retention berm
(number of wells, pumps or dams, etc.)

and (was) completed (by) May/15/ 2015
(Month/Day/Year, each was or will be completed)

8. The first actual application of water for the proposed beneficial use was or is estimated to be 10/01/2015
(Mo/Day/Year)

WATER RESOURCES
RECEIVED

OCT 23 2015

UNACCEPTABLE FOR PRIORITY
WATER RESOURCES
RECEIVED
SEP 08 2015

SCANNED

9. Will pesticide, fertilizer, or other foreign substance be injected into the water pumped from the diversion works?
 Yes No If "yes", a check valve shall be required.

All chemigation safety requirements must be met including a chemigation permit and reporting requirements.

10. If you are planning to impound water, please contact the Division of Water Resources for assistance, prior to submitting the application. Please attach a reservoir area capacity table and inform us of the total acres of surface drainage area above the reservoir.

Have you also made an application for a permit for construction of this dam and reservoir with the Division of Water Resources? Yes No

- If yes, show the Water Structures permit number here LCD-0074
- If no, explain here why a Water Structures permit is not required _____

11. The application must be supplemented by a U.S.G.S. topographic map, aerial photograph or a detailed plat showing the following information. On the topographic map, aerial photograph, or plat, identify the center of the section, the section lines or the section corners and show the appropriate section, township and range numbers. Also, please show the following information:

- (a) The location of the proposed point(s) of diversion (wells, stream-bank installations, dams, or other diversion works) should be plotted as described in Paragraph No. 5 of the application, showing the North-South distance and the East-West distance from a section line or southeast corner of section.
- (b) If the application is for groundwater, please show the location of any existing water wells of any kind within 1/2 mile of the proposed well or wells. Identify each existing well as to its use and furnish the name and mailing address of the property owner or owners. If there are no wells within 1/2 mile, please advise us.
- (c) If the application is for surface water, the names and addresses of the landowner(s) 1/2 mile downstream and 1/2 mile upstream from your property lines must be shown.
- (d) The location of the proposed place of use should be shown by crosshatching on the topographic map, aerial photograph or plat.
- (e) Show the location of the pipelines, canals, reservoirs or other facilities for conveying water from the point of diversion to the place of use.

A 7.5 minute U.S.G.S. topographic map may be obtained by providing the section, township and range numbers to: Kansas Geological Survey, 1930 Constant, Campus West, University of Kansas, Lawrence, Kansas 66047.

12. List any application, appropriation of water, water right, or vested right file number that covers the same diversion points or any of the same place of use described in this application. Also list any other recent modifications made to existing permits or water rights in conjunction with the filing of this application.

WATER RESOURCES
RECEIVED

OCT 23 2015
SCANNING

KS DEPT OF AGRICULTURE

WATER RESOURCES
RECEIVED
SEP 28 2015
UNACCEPTABLE FOR PRIORITY
KS DEPT OF AGRICULTURE

**RECREATIONAL USE
SUPPLEMENTAL SHEET**

File No. 49490

Name of Applicant (Please Print): Kansas Dept. Of Wildlife, Parks and Tourism

1. Please indicate type of recreational use (boating, fishing, swimming, etc.): wetland for wildlife use

2. Please summarize how the water will be used and justify the quantity of water requested: This constructed wetland laying just out of the Buffalo Creek riparian zone in the SE1/4 of Sec 16 T5S, R5W in Clod County, Kansas will impound a shallow wetland created by the construction of a 4,335 foot long retention berm with two in-line water control structures with stoplogs for water control with an average depth of 0.7 feet will fill by receiving water from precipitation runoff and out-of-bank flow from Buffalo Creek. This wetland will be seasonal in nature in that water will normally be diverted and stored during waterfowl migration times typically from about August 15 through May 15. The rest of the time the wetland will be dewatered in order to grow beneficial plants attractive to wildlife. The surface acres have been calculated at 54.5 with an average depth of 0.7 ft resulting in approximately 41.0 ac-ft of storage. Given the annual net evaporation at this site of 22 inches plus a standard seepage factor the annual amount of water requested is approximately 100 acre-feet.

* 54.5 acres x 22" / 12" per foot = 99 AF with 100 AF requested

Reasonable based on 1 year Net Evap for Clod County (22")

54.5 acres depth average .7 foot retain then release,

Storage + Seepage = 41.0 AF Aug - May per year
9 months

3. Please complete the following table showing estimated future water requirements:

ESTIMATED FUTURE WATER DIVERTED/STORED

NEXT 5 YEARS	WATER TO BE DIVERTED (ACRE-FEET OR GALLONS)
Year 1	100
Year 2	100
Year 3	100
Year 4	100
Year 5	100

Please attach any additional information, tables, or curves showing past, present and estimated future water requirements to substantiate the amount of water requested.

- 4. Please designate the legal description of the location where the water is to be used by providing the fractional part of the Section, Township and Range.

NE1/4 SE

1/4 plus the S1/2 SE1/4 of Sec. 16, T5S, R5W Cloud County, Kansas

You may attach any additional information you believe will assist in informing the Division of the need for your request.

WATER RESOURCES
RECEIVED

OCT 20 2015
SCANNED

WATER RESOURCES
RECEIVED
UNACCEPTABLE FOR PRIORITY
SEP 18 2015
KS DEPT OF AGRICULTURE

13. Furnish the following well information if the proposed appropriation is for the use of groundwater. If the well has not been completed, give information obtained from test holes, if available.

Information below is from: Test holes Well as completed Drillers log attached

Well location as shown in paragraph No.	(A)	(B)	(C)	(D)
Date Drilled	_____	_____	_____	_____
Total depth of well	_____	_____	_____	_____
Depth to water bearing formation	_____	_____	_____	_____
Depth to static water level	_____	_____	_____	_____
Depth to bottom of pump intake pipe	_____	_____	_____	_____

14. The relationship of the applicant to the proposed place where the water will be used is that of

Manager
(owner, tenant, agent or otherwise)

15. The owner(s) of the property where the water is used, if other than the applicant, is (please print):

Loren Sweat, 221 50 Rd, Jamestown KS 66948
(name, address and telephone number)

Lee Stanford, 400 Sunset Dr, Salina KS 67401
(name, address and telephone number)

16. The undersigned states that the information set forth above is true to the best of his/her knowledge and that this application is submitted in good faith.

Dated at 11:30 AM, Kansas, this 15th day of August, 2015.
(month) (year)

KANSAS DEPT. OF WILDLIFE, PARKS AND TOURISM
(Applicant Signature)

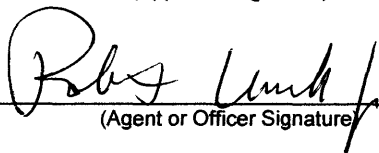
By 
(Agent or Officer Signature)

ROBERT L. UNRUH JR
(Agent or Officer - Please Print)

Assisted by _____ Date: _____
(office/title)

WATER RESOURCES
RECEIVED

OCT 23 2015
SCANNED

KS DEPT OF AGRICULTURE

WATER RESOURCES
RECEIVED
UNACCEPTABLE FOR PRIORITY
SEP 6 2015
KS DEPT OF AGRICULTURE

06/17/2016
(Date)

Kansas Department of Agriculture
Division of Water Resources
David W. Barfield, Chief Engineer
1320 Research Park Drive
Manhattan, Kansas 66502

Re: Application File No. 49490

Minimum Desirable Streamflow

Dear Sir:

I understand that a Minimum Desirable Streamflow requirement has been established by the legislature for the source of supply to which the above referenced application applies.

I understand that diversion of water pursuant to this application will be subject to regulation any time Minimum Desirable Streamflow requirements are not being met.

I also understand that if this application is approved, there could be times, as determined by the Division of Water Resources, when I would not be allowed to divert water. I realize that this could affect the economics of my decision to appropriate water.

I am aware of the above factors, and with the knowledge thereof, request that the Division of Water Resources proceed with processing and approval, if possible, of the above referenced application.

FOR KANSAS DEPARTMENT OF WILDLIFE,
PARKS AND TOURISM
Robert L. Unruh Jr. by
Signature of Applicant

State of Kansas)
County of Jewell) ss

ROBERT L. UNRUH JR
(Print Applicant's Name)

I hereby certify that the foregoing instrument was signed in my presence and sworn to before me this 17th day of June, 2016.

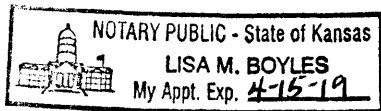

Lisa M Boyles
Notary Public

My Commission Expires: 4-15-19

WATER RESOURCES
RECEIVED

JUN 22 2016

**MINIMUM DESIRABLE STREAMFLOW FORM TO BE USED WHEN
APPLICABLE WHEN FILING AN APPLICATION FOR PERMIT
TO APPROPRIATE WATER FOR BENEFICIAL USE**

The Kansas Legislature has established minimum desirable streamflows for the streams listed below. If your proposed diversion of water is going to be from one of these watercourses or adjacent alluvial aquifers, please complete the back side of this page and submit it along with your application for permit to appropriate water.

Arkansas River
Big Blue River
Chapman Creek
Chikaskia River
Cottonwood River
Delaware River
Little Arkansas River
Little Blue River
Marais des Cygnes River
Medicine Lodge River
Mill Creek (Wabaunsee Co. area)
Neosho River

Ninnescah River
North Fork Ninnescah River
Rattlesnake Creek
Republican River
Saline River
Smoky Hill River
Solomon River
South Fork Ninnescah
Spring River
Walnut River
Whitewater River

**WATER RESOURCES
RECEIVED**

JUN 22 2016

KS DEPT OF AGRICULTURE

FEE SCHEDULE

1. The fee for an application for a permit to appropriate water for beneficial use, except for domestic use, shall be (see paragraph No. 2 below if requesting storage):

ACRE-FEET	FEE
0-100	\$200.00
101-320	\$300.00
More than 320	\$300.00 plus \$20.00 for each additional 100 acre-feet or any part thereof.

2. The fee for an application in which storage is requested, except for domestic use, shall be:

ACRE-FEET	FEE
0-250	\$200.00
More than 250	\$200.00 plus \$20.00 for each additional 250 acre-feet of storage or any part thereof.

Note: If an application requests both direct use *and* storage, the fee charged shall be as determined under No. 1 or No. 2 above, whichever is greater, but not both fees.

3. The fee for an application for a permit to appropriate water for water power or dewatering purposes shall be \$100.00 plus \$200.00 for each 100 cubic feet per second, or part thereof, of the diversion rate requested.

Note: The applicant shall notify the Chief Engineer and pay the statutorily required field inspection fee of \$400.00 when construction of the works for diversion has been completed, except that for applications filed on or after July 1, 2009, for works constructed for sediment control use and for evaporation from a groundwater pit for industrial use shall be accompanied by a field inspection fee of \$200.00.

MAKE CHECKS PAYABLE TO THE KANSAS DEPARTMENT OF AGRICULTURE

ATTENTION

A Water Conservation Plan may be required per K.S.A. 82a-733. A statement that your application for permit to appropriate water may be subject to the minimum desirable streamflow requirements per K.S.A. 82a-703a, b, and c may also be required from you. After the Division of Water Resources has had the opportunity to review your application, you will be notified whether or not you will need to submit a Water Conservation Plan. You also may be required to install a water flow meter or water stage measuring device on your diversion works prior to diverting water. There may be other special conditions or Groundwater Management District regulations that you will need to comply with if this application is approved.

CONVERSION FACTORS

1 acre-foot equals 325,851 gallons

1 million gallons equal 3.07 acre-feet

WATER RESOURCES
RECEIVED

SCANNED
OCT 23 2015

KS DEPT OF AGRICULTURE

UNACCEPTABLE FOR PRIORITY
WATER RESOURCES
RECEIVED
SEP 10 2015
KS DEPT OF AGRICULTURE

McGrogan, Erin

From: Stewart, Kelly
Sent: Wednesday, August 03, 2016 8:23 AM
To: McGrogan, Erin
Cc: Hageman, Rebecca
Subject: RE: File No. 49,490 KDWPT 16-5S-5W, Cloud County. 54.5 acres wetland; LCD-0074;

Erin,

I have no objection to the approval of this application provided the standard language regarding permissions to divert water are included in the permit conditions.

Kelly

From: McGrogan, Erin
Sent: Tuesday, August 2, 2016 2:21 PM
To: Stewart, Kelly <Kelly.Stewart@ks.gov>
Subject: File No. 49,490 KDWPT 16-5S-5W, Cloud County. 54.5 acres wetland; LCD-0074;

Kelly, Enclosed is the review for the KDWPT marsh that is currently in place with the referenced structures permit. Attached are the plans of the structure, memo, and spacing information, with nearby letter with concerns .

Thank you.

Erin

Erin McGrogan, Environmental Scientist
Division of Water Resources
1320 Research Park Drive
Manhattan, Kansas 66502
(785) 564-6640
erin.mcgrogan@ks.gov

AMOUNT STATISTICS REPORT FOR POINTS OF DIVERSION UNDER A 49490 00

#####

AMOUNT STATISTICS REPORT FOR POINTS OF DIVERSION UNDER A 49490 00 REC

Water Right and Points of Diversion Within 2.00 miles of point defined as:

1320 Feet North and 75 Feet West of the Southeast Corner of Section 16 T 5S R 5W

SURFACE WATER ONLY

```

=====
File Number   Use ST SR Dist (ft) Q4 Q3 Q2 Q1 FeetN FeetW Sec Twp Rng ID Batt Auth_Quan Add_Quan Unit
A__ 46061 00 REC NK S      4139 -- SW SE SE 100  940  9  5  5W  1      .00      .00 AF
A__ 47255 00 REC LO S      5146 -- NE NE SE 2565  380 15  5  5W  4      .00      .00 AF
A__ 48128 00 REC KE S      4249 -- SW SE SE  200 1000  9  5  5W  2     550.00      .00 AF
A__ 49490 00 REC AY S         0 -- NE SE SE 1320   75 16  5  5W  1     100.00    100.00 AF
=====

```

```

=====
Total Net Quantities Authorized:   Direct      Storage
Total Requested Amount (AF) =      100.00      .00
Total Permitted Amount (AF) =         .00      .00
Total Inspected Amount (AF) =         .00     550.00
Total Pro_Cert Amount (AF) =         .00      .00
Total Certified Amount (AF) =         .00     2314.00
Total Vested Amount (AF) =         .00      .00
TOTAL AMOUNT (AF) =      100.00     2864.00
=====

```

An * after the source of supply indicates a pending application for change under the file number.
 An * after the ID indicates a 15 AF exemption was granted under the file number.
 A "G" in the Batt column indicates the GEO CTR of a battery. A "B" indicates a well in the battery.
 The number in the Batt column is the number of wells in the battery.

Water Rights and Points of Diversion Within 2.00 miles of point defined as:

1320 Feet North and 75 Feet West of the Southeast Corner of Section 16 T 5S R 5W

SURFACE WATER ONLY

WATER USE CORRESPONDENTS:

```

=====
File Number   Use ST SR
A__ 46061 00 REC NK S
> KANSAS DEPT OF WILDLIFE PARKS & TOURISM
> STAGE LEVELS ONLY (STKFO)
> 1020 S KANSAS AVE FL 2
> TOPEKA KS 66612
> -----
A__ 47255 00 REC LO S
> KANSAS DEPT OF WILDLIFE PARKS & TOURISM
> STAGE LEVELS ONLY (STKFO)
> 1020 S KANSAS AVE FL 2
> TOPEKA KS 66612
> -----
A__ 48128 00 REC KE S
> KANSAS DEPT OF WILDLIFE PARKS & TOURISM
> STAGE LEVELS ONLY (STKFO)
> 1020 S KANSAS AVE FL 2
> TOPEKA KS 66612
> -----
A__ 49490 00 REC AY S
> KANSAS DEPT OF WILDLIFE PARKS & TOURISM
=====

```

> STAGE LEVELS ONLY (STKFO)
> 1020 S KANSAS AVE FL 2
> TOPEKA KS 66612

>-----

=====

#####

1320 Research Park Drive
Manhattan, Kansas 66502
(785) 564-6700



900 SW Jackson, Room 456
Topeka, Kansas 66612
(785) 296-3556

Jackie McClaskey, Secretary

Governor Sam Brownback

August 10, 2016

Wade Carter
Allen, Sweet, and Carter LLC
212 North Concord
Minneapolis, KS 67467

Re: Pintail Marsh
WSN: LCD-0074
WR Application File No. 49490

Dear Mr. Carter:

On August 10, 2016, the Division of Water Resources Stream Obstructions Unit received via email your August 10, 2016 letter to Erin McGrogan and Janelle Phillips regarding neighboring land owners' concerns with the Pintail Marsh (WSN LCD-0074). The project is a constructed wetland located in the SE quarter of Section 16, Township 5 South, Range 5 West, Cloud County Kansas.

The submitted application and plans to build the wetland area were reviewed in 2014 to be in compliance with K.S.A. 24-126 and K.A.R. 5-45. The project was approved and permitted on August 14, 2014.

A hydraulic analysis was submitted by Kansas Department of Wildlife, Parks and Tourism. That hydraulic analysis was forwarded to you on July 18, 2016 as part of Open Records Request #7982. I have included another copy of the submitted analysis with this letter. If you have any questions, or if I can be of assistance, please contact me at 785-564-6656.

Sincerely,

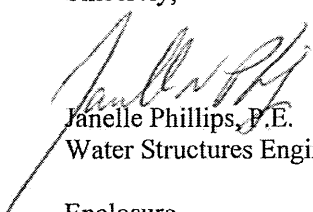

Janelle Phillips, P.E.
Water Structures Engineer

Enclosure

pc: Kelly Stewart – Water Commissioner – Stockton Field Office
Erin McGrogan – Water Appropriations – Manhattan Office

WATER RESOURCES
RECEIVED

AUG 10 2016

KS DEPT OF AGRICULTURE

ATTACHMENT 4
BUFFALO CREEK FLOW DATA

WATER RESOURCES
RECEIVED

JUL 03 2014

KS DEPT OF AGRICULTURE

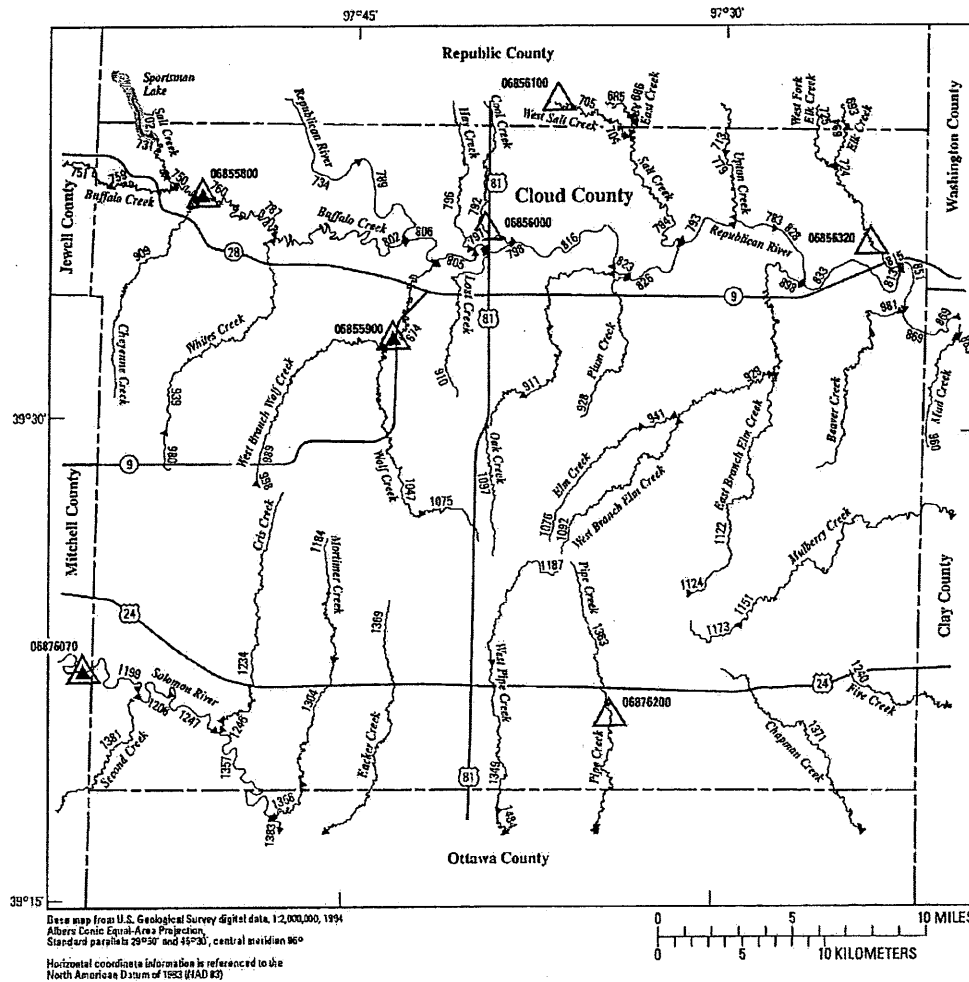

EXPLANATION

- ◀ 1357 Location of streamflow-statistics determination site (small triangle) and associated identification number—small triangle points in downstream direction
- 06876070 ▲ U.S. Geological Survey streamflow-gaging station and number used for estimates of flow duration
- 06876200 ▲ U.S. Geological Survey streamflow-gaging station and number used for estimates of peak-discharge frequency values
- 1355 Lake and determination site identification number

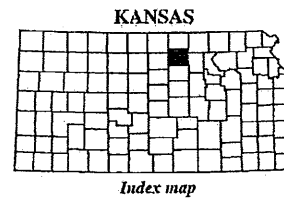

Figure 25. Location of streamflow-statistics determination sites, associated identification numbers, and U.S. Geological Survey streamflow-gaging stations used in the flow-duration and peak-discharge frequency analyses for Cloud County.

WATER RESOURCES RECEIVED
 AUG 10 2016
 KS DEPT OF AGRICULTURE

WATER RESOURCES RECEIVED
 JUL 03 2014
 KS DEPT OF AGRICULTURE

148 Estimates of Flow Duration, Mean Flow, and Peak-Discharge Frequency Values for Kansas Stream Locations

Table 21. Estimated flow-duration values, mean flow values, and peak-discharge frequency values for controlled and uncontrolled flow stream segments on the 1999 Kansas Surface Water Register for Cloud County.

[KSWR, Kansas Surface Water Register; CUSEGA, catalog unit segment number alpha; mi², square miles; ft³/s, cubic feet per second; HYDRO, lake or other hydrologic structure; NA, not applicable; NRDitch, irrigation ditch; NRTribal, tribal stream]

Determination site identification number (fig. 25)	KSWR CUSEGA number	Stream segment by county (table 112)				Stream name	Contributing drainage area (mi ²)	Estimated flow-duration values (ft ³ /s) for indicated percentage of time flow equaled or exceeded				
		1st	2nd	3rd	4th			90	75	50	25	10
								percent	percent	percent	percent	percent
702	HYDRO	CD	RP		HYDRO	137	NA	NA	NA	NA	NA	
705	1025001725	CD	RP		West Salt Creek	70.8	0	0.91	3.47	9.21	23.8	
713	1025001752	CD	RP		Upton Creek	14.2	0	0	.61	1.45	4.15	
724	1025001715	CD	RP		Elk Creek	45.5	0	.69	2.87	7.40	18.6	
725	1025001716	CD	RP		West Fork Elk Creek	26.8	0	.22	1.61	4.05	10.3	
731	1025001730	CD			Salt Creek	142	0	1.53	5.22	15.6	43.8	
734	1025001728	CD	RP		Republican River	21,200	119	158	251	544	1,130	
750	1025001730	CD			Salt Creek	142	0	1.53	5.23	15.6	43.8	
751	1025001737	CD	JW		Buffalo Creek	150	0	1.74	5.63	16.5	46.2	
759	1025001737	CD			Buffalo Creek	154	0	1.78	5.76	17.0	47.6	
760	1025001729	CD			Buffalo Creek	298	.70	2.92	9.96	34.8	109	
779	1025001752	CD			Upton Creek	19.4	0	0	.93	2.30	6.22	
783	1025001718	CD			Republican River	22,100	121	185	319	657	1,430	
787	1025001729	CD			Buffalo Creek	348	.95	3.10	11.0	41.0	133	
789	1025001726	CD			Republican River	21,200	119	158	252	545	1,130	
792	1025001750	CD	RP		Cool Creek	11.9	0	.20	.74	1.16	2.74	
793	1025001718	CD			Republican River	22,000	121	184	316	651	1,420	
794	1025001719	CD	RP		Salt Creek	199	.72	4.09	12.2	31.4	80.2	
796	1025001749	CD	RP		Hay Creek	19.3	0	.31	1.30	2.61	6.02	
797	1025001726	CD			Republican River	21,700	113	170	284	577	1,250	
798	1025001726	CD			Republican River	21,800	113	171	286	581	1,260	
802	1025001729	CD			Buffalo Creek	405	1.40	4.21	14.0	48.3	152	
805	1025001726	CD			Republican River	21,700	113	170	283	576	1,250	
806	1025001726	CD			Republican River	21,700	114	168	279	572	1,230	
813	1025001713	CD			Republican River	22,100	172	341	563	901	1,900	
815	1025001714	CD			Elk Creek	85.5	0	1.78	5.64	14.4	35.8	
816	1025001726	CD			Republican River	21,800	114	172	288	587	1,270	
823	1025001726	CD			Republican River	21,800	115	173	292	595	1,290	
826	1025001726	CD			Republican River	21,800	115	174	294	600	1,300	
828	1025001717	CD			Republican River	22,100	121	186	319	658	1,430	
833	1025001717	CD			Republican River	22,100	124	190	328	679	1,480	
851	1025001713	CD			Republican River	22,200	126	194	338	703	1,530	
874	1025001738	CD			Wolf Creek	59.6	0	.10	1.00	4.30	17.0	
898	1025001739	CD			Elm Creek	77.0	0	1.26	4.24	10.9	27.6	
909	1025001755	CD			Cheyenne Creek	40.9	0	0	1.15	3.18	8.87	
910	1025001757	CD			Lost Creek	14.1	0	.38	1.20	2.11	4.49	
911	1025001758	CD			Oak Creek	30.7	0	.64	2.16	4.73	10.8	

WATER RESOURCES
RECEIVED
JUL 03 2014
KS DEPT OF AGRICULTURE

Table 21. Estimated flow-duration values, mean flow values, and peak-discharge frequency values for controlled and uncontrolled flow stream segments on the 1999 Kansas Surface Water Register for Cloud County.—Continued

[KSWR, Kansas Surface Water Register; CUSEGA, catalog unit segment number alpha; mi², square miles; ft³/s, cubic feet per second; HYDRO, lake or other hydrologic structure; NA, not applicable; NRDitch, irrigation ditch; NRTribal, tribal stream]

Determination site identification number (fig. 25)	Estimated mean flow (ft ³ /s)	Estimated peak discharge (ft ³ /s) for indicated peak-discharge frequency					
		2-year	5-year	10-year	25-year	50-year	100-year
702	NA	NA	NA	NA	NA	NA	NA
705	19.0	676	1,870	3,250	5,920	8,780	12,600
713	4.29	860	2,100	3,250	5,080	6,640	8,460
724	14.6	1,130	2,690	4,190	6,580	8,740	11,200
725	8.70	1,140	2,840	4,420	6,970	9,160	11,800
731	29.6	1,590	3,920	6,210	9,940	13,400	17,400
734	501	6,500	10,900	23,200	33,800	44,300	55,600
750	29.6	1,570	3,870	6,140	9,850	13,300	17,300
751	30.6	1,600	3,920	6,200	9,910	13,300	17,300
759	31.4	1,550	3,810	6,040	9,710	13,100	17,100
760	61.5	1,970	4,570	7,130	11,500	15,600	20,600
779	5.87	1,030	2,530	3,930	6,160	8,070	10,300
783	668	8,200	14,200	19,400	27,500	34,900	43,600
787	71.7	1,670	3,890	6,140	10,100	14,000	18,900
789	502	6,500	10,900	23,100	33,600	44,000	55,300
792	3.05	720	1,790	2,790	4,370	5,730	7,320
793	661	8,090	14,000	19,200	27,300	34,700	43,300
794	55.6	1,910	4,530	7,220	11,900	16,500	22,400
796	5.37	943	2,370	3,720	5,860	7,720	9,890
797	577	6,720	11,700	16,300	24,000	31,400	40,400
798	581	6,790	11,800	16,400	24,200	31,600	40,600
802	83.1	1,640	3,900	6,230	10,300	14,400	19,600
805	574	6,710	11,700	16,600	24,400	31,900	41,000
806	565	6,680	11,600	17,400	25,600	33,500	42,800
813	765	8,490	19,200	29,600	46,200	61,400	79,400
815	26.3	546	1,350	2,170	3,640	5,100	6,910
816	588	6,900	12,000	16,700	24,400	31,800	40,800
823	597	7,050	12,300	17,000	24,800	32,200	41,100
826	603	7,140	12,400	17,200	25,000	32,400	41,300
828	669	8,210	14,300	19,400	27,600	35,000	43,600
833	693	8,600	14,900	20,300	28,500	35,900	44,500
851	720	9,040	15,700	21,200	29,600	36,900	45,400
874	11.0	910	1,770	2,490	3,570	4,490	5,520
898	21.4	1,610	3,880	6,050	9,490	12,600	16,100
909	8.06	1,030	2,610	4,140	6,600	8,830	11,300
910	4.02	775	1,940	3,040	4,780	6,290	8,050
911	8.67	942	2,320	3,640	5,720	7,590	9,660

WATER RESOURCES RECEIVED

WATER RESOURCES RECEIVED

AUG 10 2016

JUL 03 2014

KS DEPT OF AGRICULTURE

KS DEPT OF AGRICULTURE

150 Estimates of Flow Duration, Mean Flow, and Peak-Discharge Frequency Values for Kansas Stream Locations

Table 21. Estimated flow-duration values, mean flow values, and peak-discharge frequency values for controlled and uncontrolled flow stream segments on the 1999 Kansas Surface Water Register for Cloud County.—Continued

[KSWR, Kansas Surface Water Register; CUSEGA, catalog unit segment number alpha; mi², square miles; ft³/s, cubic feet per second; HYDRO, lake or other hydrologic structure; NA, not applicable; NRDitch, irrigation ditch; NRTribal, tribal stream]

Determination site identification number (fig. 25)	KSWR CUSEGA number	Stream segment by county (table 112)				Stream name	Contributing drainage area (mi ²)	Estimated flow-duration values (ft ³ /s) for indicated percentage of time flow equaled or exceeded				
		1st	2nd	3rd	4th			90 percent	75 percent	50 percent	25 percent	10 percent
928	1025001760	CD				Plum Creek	15.1	0	0	0.66	1.44	3.90
929	1025001739	CD				Elm Creek	36.3	0	0.24	1.79	4.69	12.2
939	1025001754	CD				Whites Creek	46.2	0	.21	1.74	4.51	11.6
941	1025001739	CD				Elm Creek	12.0	0	0	.47	.97	2.83
980	1025001754	CD				Whites Creek	20.2	0	0	.48	1.17	3.48
981	1025001761	CD				Beaver Creek	21.0	0	0	0.81	2.01	5.71
989	1025001756	CD				West Branch Wolf Creek	25.2	0	0	.44	1.48	5.43
998	1025001756	CD				West Branch Wolf Creek	2.57	0	0	0	0	0
1047	1025001738	CD				Wolf Creek	28.1	0	.14	1.18	3.05	8.68
1075	1025001738	CD				Wolf Creek	7.43	0	0	0	0	.63
1076	1025001739	CD				Elm Creek	10.5	0	0	.43	.79	2.34
1092	1025001759	CD				West Branch Elm Creek	14.7	0	0	.56	1.36	3.98
1097	1025001758	CD				Oak Creek	16.4	0	.04	.94	2.01	4.96
1122	1025001762	CD				East Branch Elm Creek	28.0	0	0	1.19	3.23	8.90
1124	1025001762	CD				East Branch Elm Creek	4.22	0	0	0	0	.24
1173	1025001740	CD				Mulberry Creek	7.20	0	0	.29	.41	1.52
1184	1026001549	CD				Mortimer Creek	14.3	0	0	.38	.86	2.75
1187	1026001511	CD				West Pipe Creek	14.3	0	0	.60	1.36	3.79
1199	1026001512	CD	MC			Solomon River	5,740	30.0	63.0	187	531	1,940
1206	1026001512	CD				Solomon River	5,770	30.6	63.5	187	529	1,930
1234	1026001548	CD				Cris Creek	31.6	0	.06	1.28	3.20	8.20
1246	1026001548	CD				Cris Creek	31.8	0	.06	1.28	3.21	8.23
1247	1026001512	CD				Solomon River	5,780	30.8	63.7	187	529	1,920
1304	1026001549	CD				Mortimer Creek	25.5	0	0	.64	1.75	5.21
1349	1026001511	CD	OT			West Pipe Creek	33.2	0	.13	1.57	4.13	10.8
1356	1026001549	CD	OT			Mortimer Creek	27.5	0	0	.67	1.86	5.55
1357	1026001512	CD	OT			Solomon River	5,820	31.9	64.5	186	526	1,900
1363	1026001510	CD	OT			Pipe Creek	40.5	0	.54	2.53	6.52	16.4
1369	1026001550	CD	OT			Eacker Creek	30.6	0	0	1.10	2.94	8.01
1371	102600084	CD	OT			Chapman Creek	38.5	.09	.57	2.47	6.34	16.2
1381	1026001551	CD	MC			Second Creek	23.1	0	0	.69	1.58	4.19

WATER RESOURCES RECEIVED

JUL 03 2014

KS DEPT OF AGRICULTURE

Table 21. Estimated flow-duration values, mean flow values, and peak-discharge frequency values for controlled and uncontrolled flow stream segments on the 1999 Kansas Surface Water Register for Cloud County.—Continued

[KSWR, Kansas Surface Water Register; CUSEGA, catalog unit segment number alpha; mi², square miles; ft³/s, cubic feet per second; HYDRO, lake or other hydrologic structure; NA, not applicable; NRDitch, irrigation ditch; NRTribal, tribal stream]

Determination site identification number (fig. 25)	Estimated mean flow (ft ³ /s)	Estimated peak discharge (ft ³ /s) for indicated peak-discharge frequency					
		2-year	5-year	10-year	25-year	50-year	100-year
928	4.06	826	2,060	3,220	5,060	6,660	8,510
929	10.3	1,250	3,040	4,750	7,440	9,850	12,500
939	10.2	1,230	3,040	4,780	7,560	10,100	12,900
941	3.24	734	1,820	2,830	4,430	5,810	7,410
980	4.03	851	2,210	3,510	5,610	7,440	9,590
981	5.81	1,090	2,680	4,160	6,520	8,550	10,900
989	5.13	1,010	2,500	3,880	6,100	8,000	10,200
998	0	274	671	1,030	1,600	2,090	2,660
1047	6.82	1,100	2,690	4,160	6,150	8,530	10,900
1075	1.57	540	1,320	2,050	3,190	4,170	5,300
1076	2.82	678	1,670	2,600	4,060	5,330	6,790
1092	4.21	855	2,110	3,270	5,120	6,710	8,560
1097	4.64	855	2,140	3,350	5,290	6,960	8,900
1122	8.17	1,280	3,180	4,950	7,770	10,200	13,100
1124	1.05	431	1,030	1,560	2,400	3,120	3,950
1173	2.16	601	1,440	2,200	3,400	4,420	5,590
1184	3.35	763	1,930	3,020	4,770	6,280	8,040
1187	3.97	809	2,010	3,130	4,920	6,460	8,250
1199	561	3,100	6,050	8,000	10,300	11,800	13,100
1206	561	3,150	6,150	8,230	10,700	12,400	14,000
1234	7.44	1,100	2,710	4,240	6,670	8,840	11,300
1246	7.47	1,080	2,660	4,180	6,580	8,730	11,100
1247	561	3,160	6,180	8,300	10,800	12,600	14,200
1304	5.58	1,050	2,690	4,250	6,770	8,960	11,500
1349	9.27	1,380	3,270	5,060	7,840	10,300	13,100
1356	5.91	1,090	2,810	4,450	7,080	9,380	12,100
1357	561	3,240	6,360	8,710	11,500	13,600	15,700
1363	13.0	532	1,270	2,000	3,220	4,380	5,760
1369	7.53	1,200	2,920	4,550	7,110	9,410	12,000
1371	13.2	1,490	3,490	5,370	8,300	10,900	13,800
1381	4.46	881	2,320	3,700	5,960	7,930	10,200

WATER RESOURCES RECEIVED WATER RESOURCES RECEIVED

AUG 10 2016 JUL 03 2014

KS DEPT OF AGRICULTURE KS DEPT OF AGRICULTURE

ATTACHMENT 5
HYDROLOGIC AND HYDRAULIC ANALYSIS RESULTS

WATER RESOURCES
RECEIVED

JUL 03 2014

KS DEPT OF AGRICULTURE

HEC-RAS RESULTS SUMMARY								
HEC-RAS	River: Buffalo Creek		Reach: Channel	Profiles: 2-year, 5-year, 10-year, 25-year, 50-year, & 100-year				
Reach	River Sta	Profile	Plan	Temp	Spec. Gravity of Sediments	Discharge	E.G. Slope	W.S. Elev
				(°F)	(g/cm ³)	(cfs)	(ft/ft)	(ft)
CHANNEL	441.28	2-yr	Existing	55	2.65	1550	0.005	1384.48
CHANNEL	441.28	2-yr	Proposed	55	2.65	1550	0.005	1384.48
CHANNEL	441.28	5-yr	Existing	55	2.65	3810	0.005	1387.49
CHANNEL	441.28	5-yr	Proposed	55	2.65	3810	0.005	1387.49
CHANNEL	441.28	10-yr	Existing	55	2.65	6040	0.005	1389.60
CHANNEL	441.28	10-yr	Proposed	55	2.65	6040	0.005	1389.60
CHANNEL	441.28	25-yr	Existing	55	2.65	9710	0.005	1390.80
CHANNEL	441.28	25-yr	Proposed	55	2.65	9710	0.005	1390.80
CHANNEL	441.28	50-yr	Existing	55	2.65	13100	0.005	1391.22
CHANNEL	441.28	50-yr	Proposed	55	2.65	13100	0.005	1391.21
CHANNEL	441.28	100-yr	Existing	55	2.65	17100	0.005	1391.54
CHANNEL	441.28	100-yr	Proposed	55	2.65	17100	0.005	1391.54

WATER RESOURCES
 RECEIVED
 JUL 03 2014
 KS DEPT OF AGRICULTURE

WATER RESOURCES
 RECEIVED
 AUG 10 2016
 KS DEPT OF AGRICULTURE

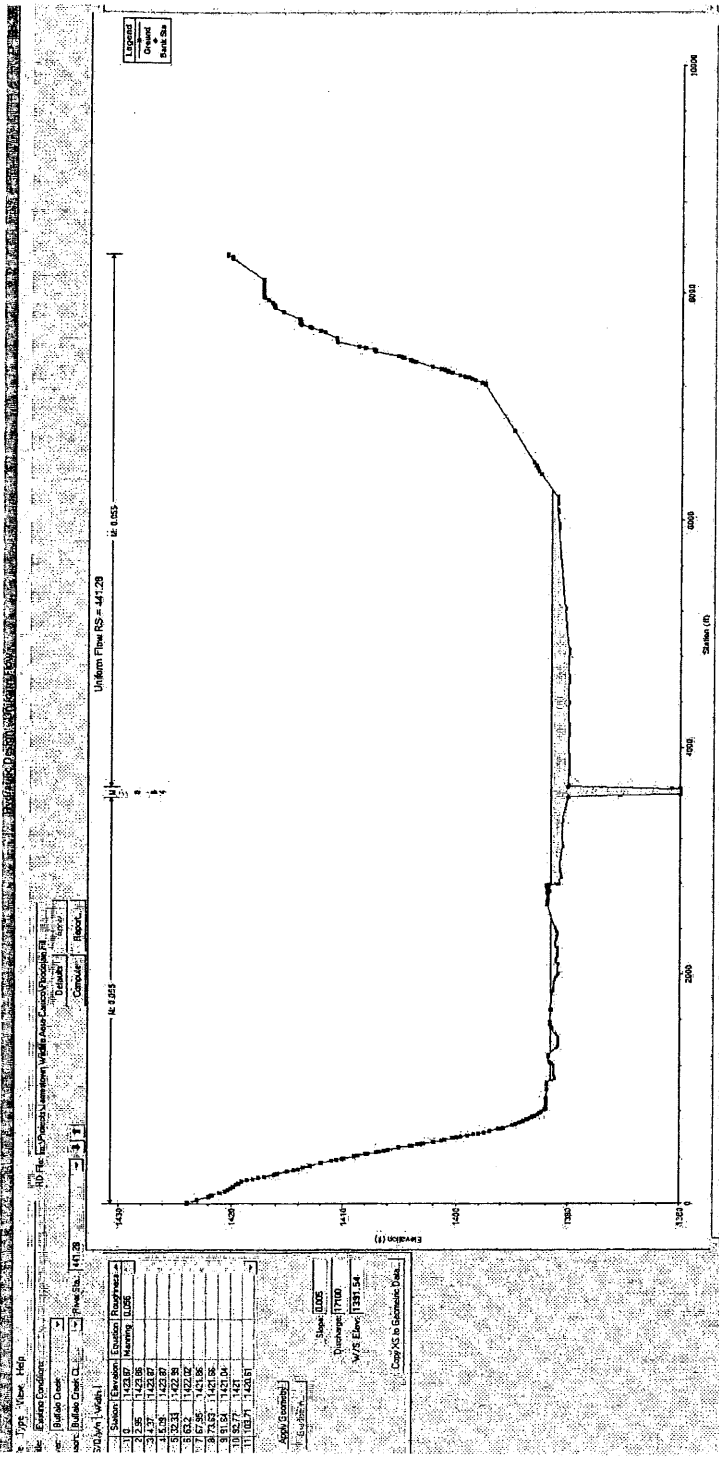

1795 - Elev. Help
 File: Project Information | View | Print | Compute | Report
 Project: Buffalo Creek Cl. 141.29
 Station: 0+00.00
 Slope: 0.005

Station	Elevation	Structure
0+00.00	1435.00	Manhole
0+25.00	1425.00	
0+50.00	1420.00	
0+75.00	1415.00	
1+00.00	1410.00	
1+25.00	1410.00	
1+50.00	1410.00	
1+75.00	1410.00	
2+00.00	1410.00	

App: Storm8
 Slope: 0.005
 Diameter: 18.00
 M/S Elev: 141.29
 Copy/MS is Bestmate Data

WATER RESOURCES
 RECEIVED
 JUL 03 2014
 MS DEPT OF AGRICULTURE

Uniform Flow Results
 Project: Buffalo Creek - Reach: Buffalo Creek Cl. 141.29
 Station: Uniform Flow for Water Station Elevation

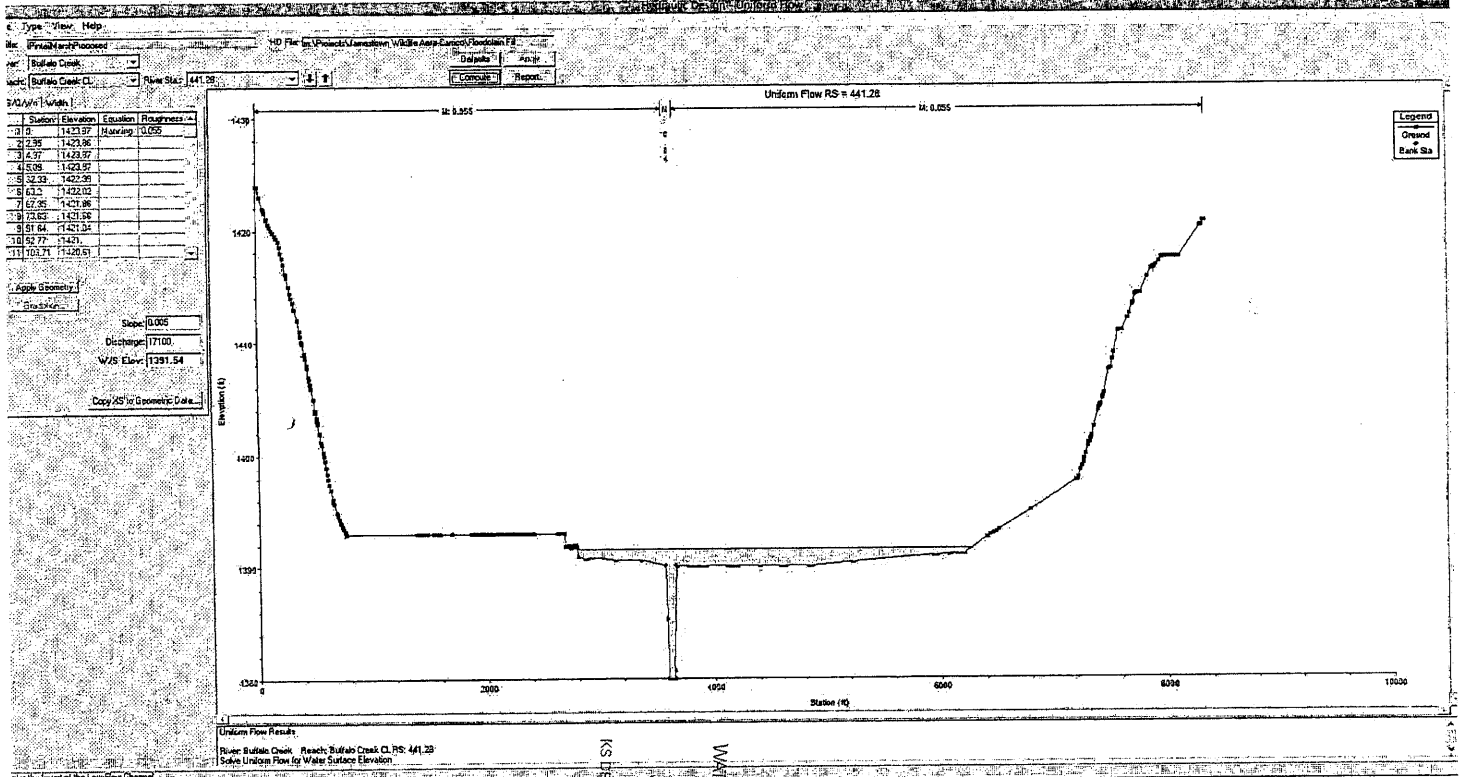

WATER RESOURCES
 RECEIVED
 AUG 10 2016
 KS DEPT OF AGRICULTURE

ALLEN, SWEET & CARTER, LLC

212 North Concord
Minneapolis, Kansas 67467

Joseph A. Allen
James D. Sweet
Wade M. Carter

(785) 392-2105 - phone
(877) 392-2106 - toll free
(785) 392-3233 - fax

August 10, 2016

Sent Via Email: Erin.McGrogan@ks.gov

Erin McGrogan
1320 Research Park Drive
Manhattan KS 66502

Cc via Fax: (785) 425-6842

Kelly Stewart, Water Commissioner
Kansas Department of Agriculture
Division of Water Resources - Stockton Field Office
820 S. Walnut St.
Stockton, KS 67669

Cc via Email: janelle.phillips@ks.gov
Janelle Phillips
Stream and Flood Plain Permits
1320 Research Park Drive
Manhattan, KS 66502
Janelle.phillips@ks.gov

RE: Application, File No. ~~49,490~~/File No. 49,490

Dear Mrs. McGrogan and Mrs. Phillips,

I have received both your letter and appreciate the same. I have spoken to my clients on your response as well as addressed the issue with Dennis Larsen who owns another neighboring property. At this time, my clients are in objection to any pumping out of the Buffalo Creek which will divert water and change the natural flow of water across their property. Please be advised that this is our formal objection to the proposed permit.

I will be scheduling a meeting with the area land owners in the near future. Additionally, a request has been submitted for the hydraulic analysis which has yet to be provided. As soon as the requested information is supplied, I will meet with the area land owners and discuss the

possibility of filing suit for damages, injunction and/or other equitable relief due to the changes that have been proposed to the flow of water out of the Buffalo Creek.

I shall additionally contact the Cloud County Attorney as well as the road and bridge administrator to see if they share similar concerns in the roadway and ditches being used/damaged by the diverted flow from the Buffalo Creek pursuant to the proposed changes. I would suspect that they are in objection as well.

Please feel free to contact me at your earliest convenience to discuss this matter in more detail.

Sincerely,

/s/ Wade M. Carter
Wade M. Carter

WMC/ccl

cc: Loren Sweat
George Carter
Janette Gelvin
June Knox
Virginia Hughes
Deanna Sweat

1320 Research Park Drive
Manhattan, Kansas 66502
(785) 564-6700



900 SW Jackson, Room 456
Topeka, Kansas 66612
(785) 296-3556

Jackie McClaskey, Secretary

Governor Sam Brownback

July 8, 2016

Wade Carter
Allen, Sweet, and Carter LLC
212 North Concord
Minneapolis, KS 67467

Re: Pintail Marsh
WSN: LCD-0074
WR Application File No. 49490

Dear Mr. Carter:

On July 7, 2016, the Division of Water Resources Stream Obstructions Unit was forwarded your July 5, 2016 letter to Erin McGrogan regarding neighboring land owners concerns with the Pintail Marsh (WSN LCD-0074). The project is a constructed wetland located in the SE quarter of Section 16, Township 5 South, Range 5 West, Cloud County Kansas.

The submitted application and plans to build the wetland area were reviewed in 2014 to be in compliance with K.S.A. 24-126 and K.A.R. 5-45. The project was approved and permitted on August 14, 2014.

A hydraulic analysis was submitted by Kansas Department of Wildlife, Parks and Tourism. You may obtain a copy of that analysis by submitting an open records request. Records can be requested using an online request form at <http://agriculture.ks.gov/document-services/open-records-request>. If you have any questions, or if I can be of assistance, please contact me at 785-564-6656.

Sincerely,

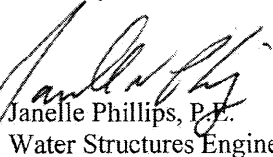

Janelle Phillips, P.E.
Water Structures Engineer

pc: Kelly Stewart – Water Commissioner – Stockton Field Office
Erin McGrogan – Water Appropriations – Manhattan Office

ALLEN, SWEET & CARTER, LLC

212 North Concord
Minneapolis, Kansas 67467

Joseph A. Allen
James D. Sweet
Wade M. Carter

(785) 392-2105 - phone
(877) 392-2106 - toll free
(785) 392-3233 - fax

July 1, 2016

Sent Via Email: Erin.McGrogan@ks.gov

Erin McGrogan
1320 Research Park Drive
Manhattan Kansas 66502

Cc via Fax: (785) 425-6842

Kelly Stewart, Water Commissioner
Kansas Department of Agriculture
Division of Water Resources - Stockton Field Office
820 S. Walnut St.
Stockton, KS 67669

WATER RESOURCES
RECEIVED

JUL 05 2016

RE: Application, File No. 49,490

KS DEPT OF AGRICULTURE

Dear Mrs. McGrogan,

Please be advised that I have been retained on behalf of several of the land owners who own an adjacent property in regards to a letter sent to Loren Sweet. I have been directed to provide you a listing of comments, concerns and questions in regards to the proposed changes that will affect my clients' property listed in File No. 49,530.

My clients have several concerns involving the diversion dam and proposed flooding of the field to the West of their property. They have noticed that the recent changes to the property listed in the above referenced file number have changes the flow of water onto their property. The diversion dam is presently forcing water to the North side of the diversion dam. This water is then forced to run down the road back to the drainage channel that runs to the East across my clients' property. This has caused damage to the roadway and extra silt to be deposited in my clients' drainage channel. The channel is getting silted in and has created a situation where water is now standing under the bridge at the point of diversion.

My clients are of the position that the changes proposed in the above referenced file number will exacerbate this problem and eventually cause more silt to build up on their property severely damaging the drainage channel. My clients are also of the opinion that the State should,

SCANNED

at the least, pay to make improvements to the drainage channel including but not limited to having the silt block removed and other required modifications to allow the additional flow of water to reach the Buffalo Creek across their property.

My clients have noted that there have been three major floods over the last year and that this problem will likely only get worse with extra water stored on the State property as proposed in the above referenced file number. My clients would like to be made aware of any site studies or hydrological studies that show the effect of the additional water on their property. Specifically, the diversion dam appears to be obstructing the natural stream flow. Have any studies been completed to determine the effects of this change to the property and how the proposed changes will magnify this effect?

Please contact me at your earliest convenience to discuss this matter in more detail.

Sincerely,



Wade M. Carter

WMC/wmc

cc: Loren Sweat
George Carter
Janette Gelvin
June Knox
Virginia Hughes
Deanna Sweat

**WATER RESOURCES
RECEIVED**

JUL 05 2016

KS DEPT OF AGRICULTURE

SCANNED

1320 Research Park Drive
Manhattan, Kansas 66502
(785) 564-6700



900 SW Jackson, Room 456
Topeka, Kansas 66612
(785) 296-3556

Jackie McClaskey, Secretary

Governor Sam Brownback

ALLEN SWEET & CARTER LLC
ATTN WADE CARTER
212 NORTH CONCORD
MINNEAPOLIS KS 67467

July 7, 2016

Re: Pending Application,
File No. 49,490; Levee Water Structure No. LCD-0074

Dear Mr. Carter:

This will acknowledge receipt of your letter, received in this office on July 5, 2016 in which you expressed concerns regarding the proposed appropriation of surface water by Kansas Department of Wildlife, Parks, and Tourism of Webber, Kansas under the above referenced application. Please note the corrected file number for this location with accompanying water structure permit number. The proposed 54.5 acre wetland is located in the Southeast Quarter of Section 16, Township 5 South, Range 5 West, Cloud County, Kansas.

We are in the process of thoroughly reviewing this pending application to ensure that it complies with the Kansas Water Appropriation Act and applicable rules and regulations. The Chief Engineer is required to approve applications for water appropriation unless the proposed appropriation will impair existing water rights or prejudicially and unreasonably affect the public interest.

It appears that your client's concerns have more to do with the water diversion and associated drainage within the permitted control structure. The levee water structure associated with this proposed wetland was approved in 2014 under Water Structure No. LCD-0074 through the Stream Obstructions Unit with the Division of Water Resources. I have forwarded your letter of concern to this unit. If you have additional questions please contact:

Division of Water Resource
Stream and Flood Plain Permits
Attn. Janelle Phillips, PE
1320 Research Park Drive
Manhattan, Kansas 66502
<mailto:janelle.phillips@ks.gov>

If an applicant without cause fails to comply with the provisions of the permit and its terms, conditions and limitations, it could result in the forfeiture of the priority date, revocation of the permit and dismissal of the application. If you have any further questions, please contact me at 785-564-6640. If you wish to discuss a specific file, please have the file number ready so that I may help you more efficiently.

Sincerely,

Erin McGrogan
Environmental Scientist
Water Appropriation Program

FILE COPY

Pc: Stockton Field Office
 DWR Water Structures Attn. Stream Obstructions Janelle Phillips, P.E.



1320 Research Park Drive
Manhattan, Kansas 66502
(785) 564-6700

900 SW Jackson, Room 456
Topeka, Kansas 66612
(785) 296-3556

Jackie McClaskey, Secretary

Governor Sam Brownback

June 20, 2016

FILE COPY

LOREN SWEAT
221 50 RD
JAMESTOWN KS 66948

Re: Application,
File No. **49,490**

Dear Sir or Madam:

This is to advise you that Kansas Department of Wildlife Parks, and Tourism of Webber, Kansas has filed the application referred to above for a permit to appropriate **100** acre-feet of surface water per calendar year from pump site located on a tributary to Buffalo Creek, for recreation use to supply a yearly evaporation quantity from a 54.5 acre seasonal wetland. The location of the proposed pump site is as follows:

One (1) pump site in the Northeast Quarter of the Southeast Quarter of the Southeast Quarter (NE $\frac{1}{4}$ SE $\frac{1}{4}$ SE $\frac{1}{4}$), of Section 16, Township 5 South, Range 5 West, Cloud County, Kansas.

A map is enclosed indicating the location of the point of diversion. Records in this office indicate that you may own land along the stream in this vicinity and you are notified of receipt of this application in order that you may be fully informed of the location of the applicant's point of diversion and proposed use of water. Consideration will be given to comments or other information which you desire to submit to this office **within 15 days** from the date of this letter. If you have any questions or comments, you may also contact me at (785) 564-6640. If you call, please reference the file number so I can help you more efficiently.

Sincerely,

Erin McGrogan
Environmental Scientist
Permits Unit

Enclosure

pc: Stockton Field Office
KDWPT Webber Ks.

SCANNED

OCT 29 1988

KS DEPT OF AGRICULTURE

LEE STAN FORD
460 SUNSET DR
SALINA, KS 67401

WATER RESOURCES RECEIVED

UNACCEPTABLE
WATER RESOURCES RECEIVED



INDICATED AREA (WATER SURFACE ELEV. 1392.57)
 AREA = 51.5 ACRES
 MAX DEPTH = 2.3 FT
 WATER VOLUME = 68,000 CU FT (1.0 ACRE-FT)

KDMW PT

BARZLO CREEK

30TH ROAD

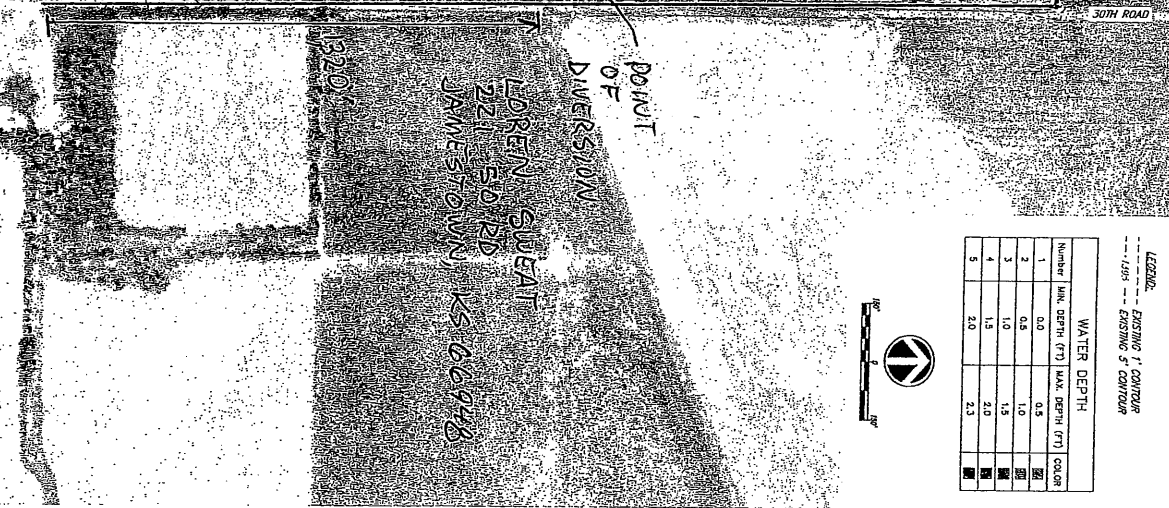

POINT OF DIVERSION

LOREN SUBAT
ZELLS RD
JAMESTOWN, KS 66948



WATER DEPTH			
Number	MIN. DEPTH (FT)	MAX. DEPTH (FT)	COLOR
1	0.0	0.5	1
2	0.5	1.0	2
3	1.0	1.5	3
4	1.5	2.0	4
5	2.0	2.3	5

LEGEND
 --- EXISTING 1' CONTOUR
 --- EXISTING 5' CONTOUR

DATE: NOV 14
 DRAWN BY: N/A
 CHECKED BY: JB
 CC:

STATE WATER STORAGE DISTRICT

5

PINTAIL MARSH IMPROVEMENTS
 JAMESTOWN WILDLIFE AREA
 JAMESTOWN, KANSAS

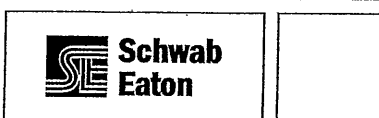

49,490

49490



1320 Research Park Drive
Manhattan, Kansas 66502
(785) 564-6700

900 SW Jackson, Room 456
Topeka, Kansas 66612
(785) 296-3556

Jackie McClaskey, Secretary

Governor Sam Brownback

June 20, 2016

FILE COPY

LEE STANFORD
400 SUNSET DR
SALINA KS 67401

Re: Application.
File No. 49,490

Dear Sir or Madam:

This is to advise you that Kansas Department of Wildlife Parks, and Tourism of Webber, Kansas has filed the application referred to above for a permit to appropriate 100 acre-feet of surface water per calendar year from pump site located on a tributary to Buffalo Creek, for recreation use to supply a yearly evaporation quantity from a 54.5 acre seasonal wetland. The location of the proposed pump site is as follows:

One (1) pump site in the Northeast Quarter of the Southeast Quarter of the Southeast Quarter (NE $\frac{1}{4}$ SE $\frac{1}{4}$ SE $\frac{1}{4}$), of Section 16, Township 5 South, Range 5 West, Cloud County, Kansas.

A map is enclosed indicating the location of the point of diversion. Records in this office indicate that you may own land along the stream in this vicinity and you are notified of receipt of this application in order that you may be fully informed of the location of the applicant's point of diversion and proposed use of water. Consideration will be given to comments or other information which you desire to submit to this office **within 15 days** from the date of this letter. If you have any questions or comments, you may also contact me at (785) 564-6640. If you call, please reference the file number so I can help you more efficiently.

Sincerely,

Erin McGrogan
Environmental Scientist
Permits Unit

Enclosure

pc: Stockton Field Office
KDWPT Webber Ks.

SCANNED

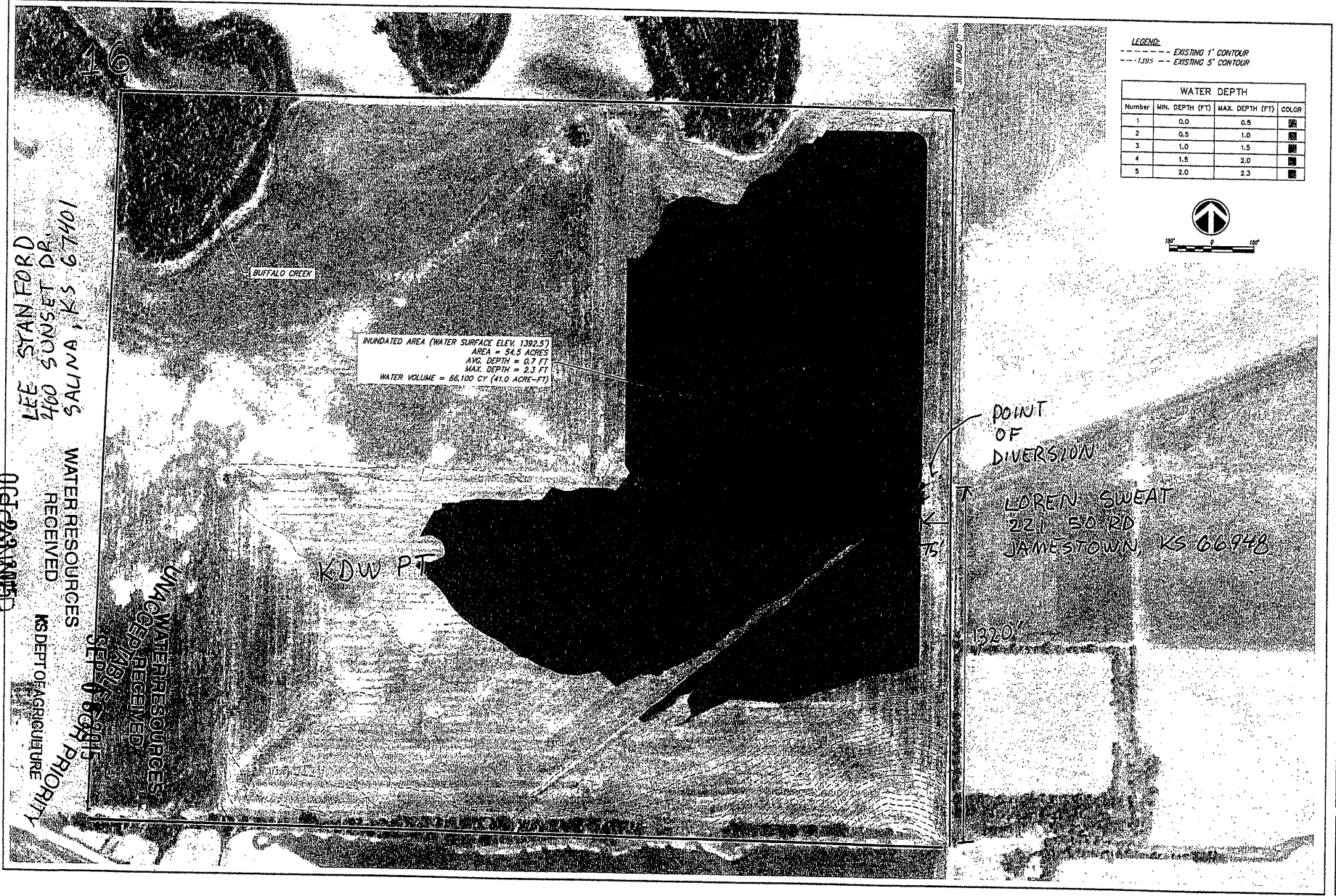

KS DEPT OF AGRICULTURE

OC SCANED



PINTAIL MARSH IMPROVEMENTS
 JAMESTOWN WILDLIFE AREA
 JAMESTOWN, KANSAS

Revised:

Date: May 14

Schwab-Eaton Project Number: N/A

Drawn By: JB

Checked By: CC

Sheet Name: WETLAND STORAGE

Sheet No.: 5

7616h
 49196

Real Estate Information

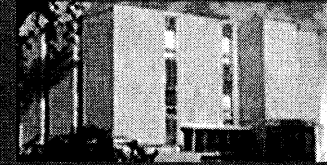

This database was last updated on 7/5/2016 at 2:02 AM

[Return to County Website](#) | [Log Out](#)

[New Search](#)

Parcel Search Results

To view the details of a parcel, click the Property # in the upper left corner of each record.

Select	Owner	Legal	Property	Appraised Entities	Previous Values
Item(s)	Information	Description	Class		
<input type="checkbox"/>	015-055-16-0-00-00-002.00-0 COLEMAN, ROGER D TRUST Property Address: 200 Vale Rd Jamestown, KS 66948	S16, T05, R05, ACRES 272.02, NW4 NE4, S2 NE4, & NW4 EXC RD ROW	Agricultural Use - A	Land: Building: Total:	\$72,650 \$00 \$72,650
<input type="checkbox"/>	015-055-16-0-00-00-001.00-0 KS DEPT OF WILDLIFE & PARKS Property Address: 276 Vale Rd Jamestown, KS 66948	S16, T05, R05, ACRES 38.57, NE4 NE4 EXC RD ROW	Agricultural Use - A	Land: Building: Total:	\$11,210 \$00 \$11,210
<input type="checkbox"/>	015-055-16-0-00-00-003.00-0 STANFORD, LEE R Property Address: 201 Union Rd Jamestown, KS 66948	S16, T05, R05, ACRES 189.12, SW4 & NW4 SE4 EXC RR & RD ROW & EXC TR BEG 655' W & 60.1' N OF SW COR OF SE4; TH NWLY 303.5', N 346', E 280.5'	Agricultural Use - A	Land: Building: Total:	\$54,840 \$00 \$54,840

<input type="checkbox"/>	015-055-16-0-00-00-004.00-0	S16, T05, R05, ACRES 116.23, NE4 SE4 & S2 SE4	Agricultural Use - A	Land:	\$34,330
	STATE OF KANSAS	EXC RD ROW		Building:	\$00
	Property Address:			Total:	\$34,330
	2101 N 30th Rd				
	Jamestown, KS 66948				
<input type="checkbox"/>	015-055-16-0-00-00-003.01-4	S16, T05, R05, ACRES 2.7, TR BEG 655' W &	Residential - R	Land:	\$5,630
	WEBER, TRENTON L	60.1' N OF SW COR OF SE4; TH NWLY 303.5', N		Building:	\$1,950
	Property Address:	346', E 280.5, S 462' TO POB		Total:	\$7,580
	237 Union Rd K28 Hwy				
	Jamestown, KS 66948				

49490

Operations Office
512 SE 25th Ave.
Pratt, KS 67124-8174



phone: 620-672-5911
fax: 620-672-6020
www.kdwp.state.ks.us

Robin Jennison, Secretary

Department of Wildlife Parks and
Tourism

Sam Brownback, Governor

**LOVEWELL PUBLIC LANDS
2446 250 ROAD
WEBBER, KS 66970
(785) 753-4971/FAX (785) 753-4981**

Kenneth Kopp, P.G.
New Appropriations
Division of Water Resources
Kansas Department of Agriculture
1320 Research Park Drive
Manhattan, KS 66502-5000

Dear Mr. Kopp,

I have enclosed an application for a new water right for a small recreational/wildlife wetland located in the NE1/4 SE1/4 and the S1/2 SE1/4 of Sec. 16, T5S, R5W in Cloud County, Kansas. We constructed a 4,335 foot long retention berm controlled by 2, Agri-Drain, in-line structures. We completed the structures work (LCD-0074) on May 15, 2015.

This will be a seasonal wetland that will impound approximately 41 acre-feet over 54.5 acres. The water source will be natural precipitation runoff and/or overflow from nearby Buffalo Creek. We would like to have water annually in the wetland for waterfowl migration from about August 15 until May 15. The rest of the year we will have the wetland dewatered. We understand that this wetland will be subject to MDS requirements for the Lower Republican River and are used to working under these restrictions. I have enclosed a packet of forms and a map as per the requirements for a new application. Please let me know if you have any more questions or need more information I can be reached at the office information above or the information below my signature.

Sincerely,

Rob Unruh
Wildlife Area Manager
(785)342 2125
rob.unruh@ksoutdoors.com

UNACCEPTABLE FOR PRIORITY
WATER RESOURCES RECEIVED
OCT 08 2015
KS DEPT OF AGRICULTURE

WATER RESOURCES RECEIVED
OCT 23 2015
SCANNED
KS DEPT OF AGRICULTURE

NEW STREAM WORKSHEET

ES KAB

Date: 10/23/15

File No. 49490

Basin Name: Republican Basin No. 27

Stream Name: Buffalo Creek Trib 3 (Republican)

Stream location (confluence with parent stream):

Section 15, Township 5 South, Range 5 (~~East~~) West

Map Color Coding:

Basin Stream – Blue

Named Main Stream off Basin Stream – Yellow

Named Stream off Main Stream – Green

× Unnamed Trib (1, 2, 3, 4, etc.) – Pink

Unnamed Trib to Unnamed Trib (A, B, C, etc.) – Orange

Unnamed Trib to Unnamed Trib to Unnamed Trib (1, 2, 3, etc.) – Purple

Stream No. 3840 (computer assigned - entered by data entry staff)

Date Entered 11/4/2015 By LLM

SCANNED



1320 Research Park Drive
Manhattan, Kansas 66502

Jackie McClaskey, Secretary

Phone: (785) 564-6700
Fax: (785) 564-6777
Email: ksag@kda.ks.gov
www.agriculture.ks.gov
Sam Brownback, Governor

October 27, 2015

KANSAS DEPT. OF WILDLIFE, PARKS AND TOURISM
2446 250 RD
WEBBER KS 66970

RE: Application
File No. 49490

Dear Sir or Madam:

Your application for permit to appropriate water in 16-5S-5W in Cloud County, was received and has been assigned the file number noted above.

As a matter of record, the Division of Water Resources has on hand a large number of applications awaiting processing. Therefore to be fair to all concerned, and so that we can process those applications on hand in the order they were received, we intend to concentrate on the backlog of applications until the issue is resolved. Once review of your application has begun, we will contact you, if additional information is required.

In accordance with the provisions of the Kansas Water Appropriation Act, a portion of which is included below, the use of water as proposed prior to approval of the application is unlawful. Once approved, compliance with the terms, conditions and limitations of the permit is necessary. Conservation of the water resources of Kansas is required.

Section 82a-728 of the Kansas Water Appropriation Act, provides (a) except for the appropriation of water for the purpose of domestic use, . . . it shall be unlawful for any person to appropriate or threaten to appropriate water from any source without first applying for and obtaining a permit to appropriate water in accordance with the provisions of the Water Appropriation Act or for any person to violate any condition of a vested right, appropriation right or an approved application for a permit to appropriate water for beneficial use.

(b) (1) The violation of any provision of this section by any person is a class C misdemeanor . . .

A class C misdemeanor is punishable by a fine not to exceed \$500 and/or a term of confinement not to exceed one month in the county jail. Each day that the violation occurs constitutes a separate offense.

If you have any questions, please contact me at (785) 564-6634. If you wish to discuss a specific file, please have the file number ready so that we may help you more efficiently.

Sincerely,

Kenneth A. Kopp, P.G.
New Application Unit Supervisor
Water Appropriation Program

KAK: DLW
pc: STOCKTONField Office
GMD 0

OCT 23 2015

LEE STANFORD
2400 SUNSET DR.
SALINA, KS 67401

UNACCEPTABLE FOR PRIORITY
WATER RESOURCES RECEIVED
SEP 6 2015
UNACCEPTABLE FOR PRIORITY
WATER RESOURCES RECEIVED
OCT 23 2015

16

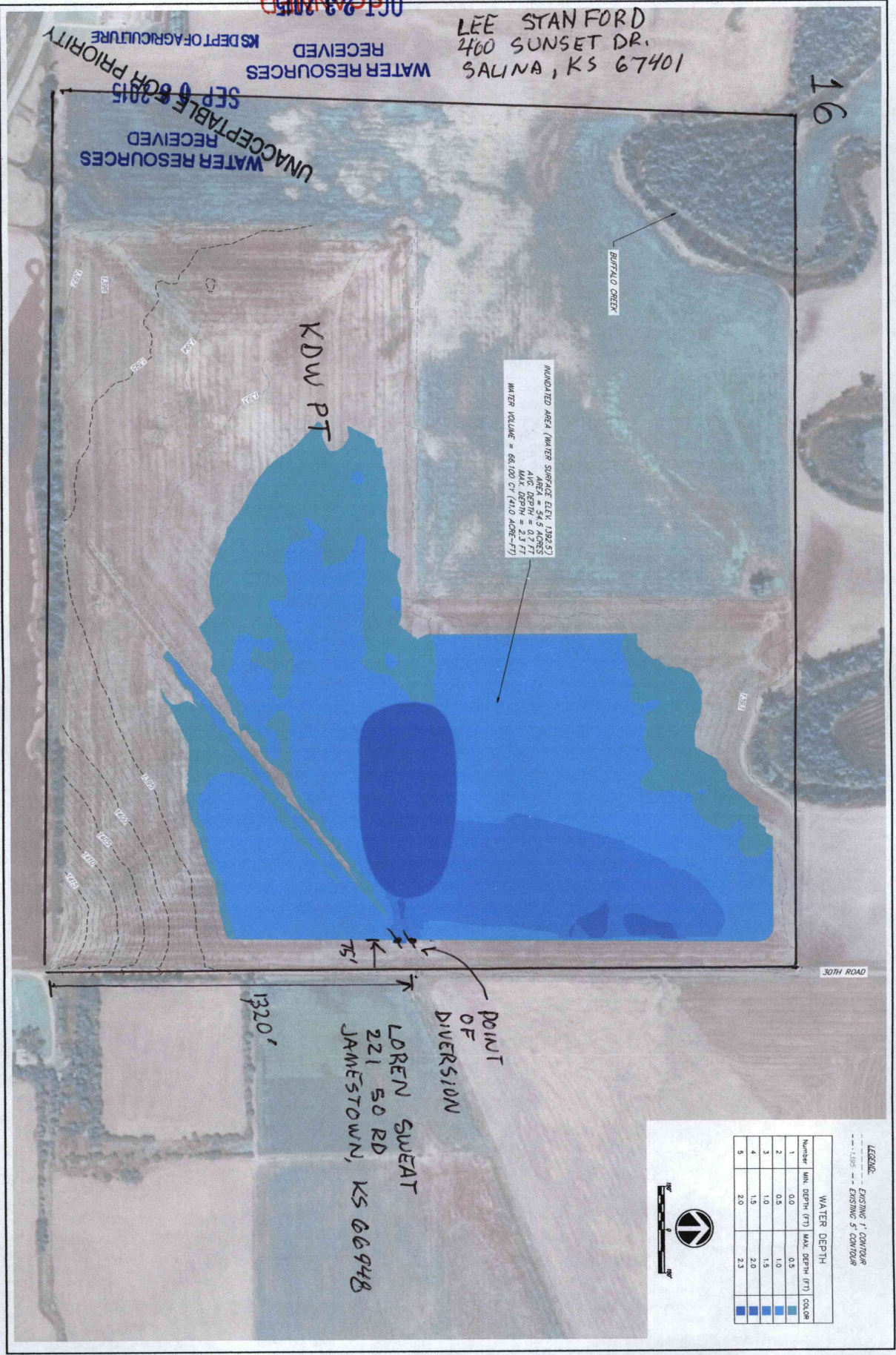

LEGEND:

--- 1.35' --- EXISTING 1' CONTOUR
--- 1.50' --- EXISTING 5' CONTOUR

WATER DEPTH			
Number	MIN. DEPTH (FT)	MAX. DEPTH (FT)	COLOR
1	0.0	0.5	Lightest Blue
2	0.5	1.0	Light Blue
3	1.0	1.5	Medium Blue
4	1.5	2.0	Dark Blue
5	2.0	2.3	Darkest Blue



POINT OF DIVERSION
LOREN SWEAT
221 50 RD
JAMESTOWN, KS 66948

1320'

75'

KDW PT

BUFFALO CREEK

30TH ROAD

06h6h
49490

49,490

5

Date: May 14
Scale: N/A
Drawn By: J8
Checked By: CC

PINTAIL MARSH IMPROVEMENTS
JAMESTOWN WILDLIFE AREA
JAMESTOWN, KANSAS



Sheet No.:

PINTAIL MARSH IMPROVEMENTS

KANSAS DEPT. WILDLIFE, PARKS & TOURISM

JAMESTOWN WILDLIFE AREA

JAMESTOWN, KANSAS

April 14

APPROVED

This 14 day of Aug, 2014

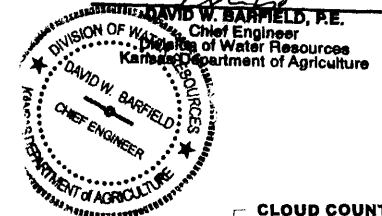

CLOUD COUNTY

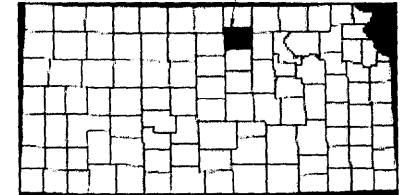

PERMIT DOCUMENT
FOR INFORMATIONAL USE ONLY

REDUCED

WATER RESOURCES
RECEIVED

JUL 03 2014

KANSAS DEPT. OF AGRICULTURE



1125 Garden Way • Manhattan, Kansas 66502
Phone (785)238-4687 • Fax (785)338-6419

DRAWING INDEX	
DRAWING NO.	DRAWING TITLE
1	COVER SHEET
2	EXISTING CONDITIONS
3	PROPOSED IMPROVEMENTS
4	FILL VOLUMES
5	GEOMETRIC ANALYSIS
6	XS 441.28 (0+00 TO 42+00)
7	XS 441.28 (42+00 TO 84+00)

HORIZONTAL/VERTICAL CONTROL				
ID	NORTHING	EASTING	ELEVATION	DESCRIPTION
CP-1	-4339.50	9122.95	1390.91	NAIL SET
CP-2	-4395.62	12745.40	1396.77	NAIL SET
CP-3	-7050.20	9875.23	1391.94	1/2" BAR FOUND
CP-4	-8360.50	9866.22	1393.91	1/2" BAR FOUND
CP-5	-9670.83	9857.18	1416.73	1/2" BAR FOUND

PROJECT LOCATION

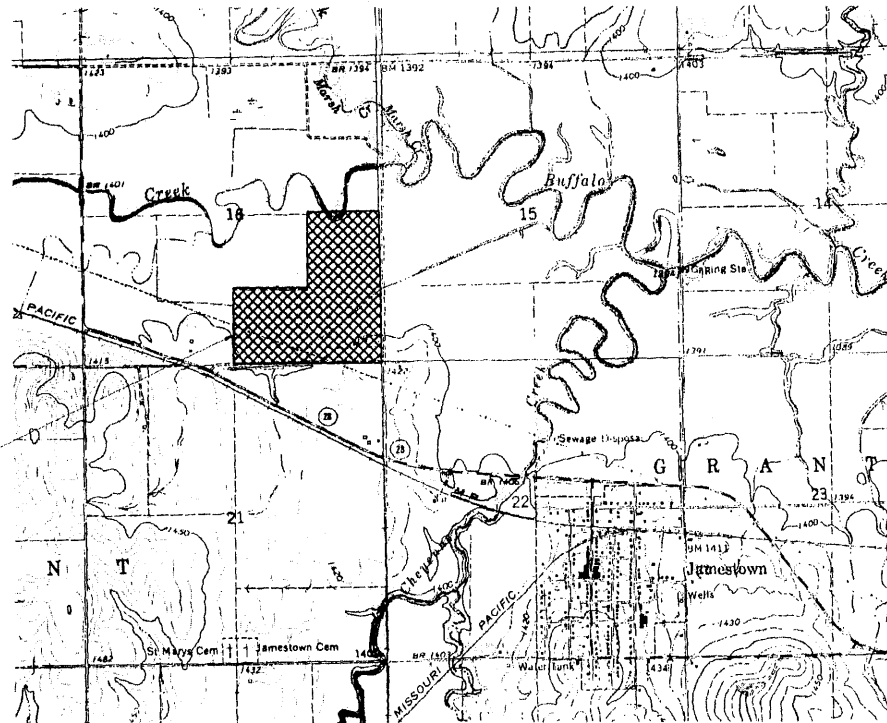

PROJECT LOCATION MAP

SCALE: 1" = 1,000'

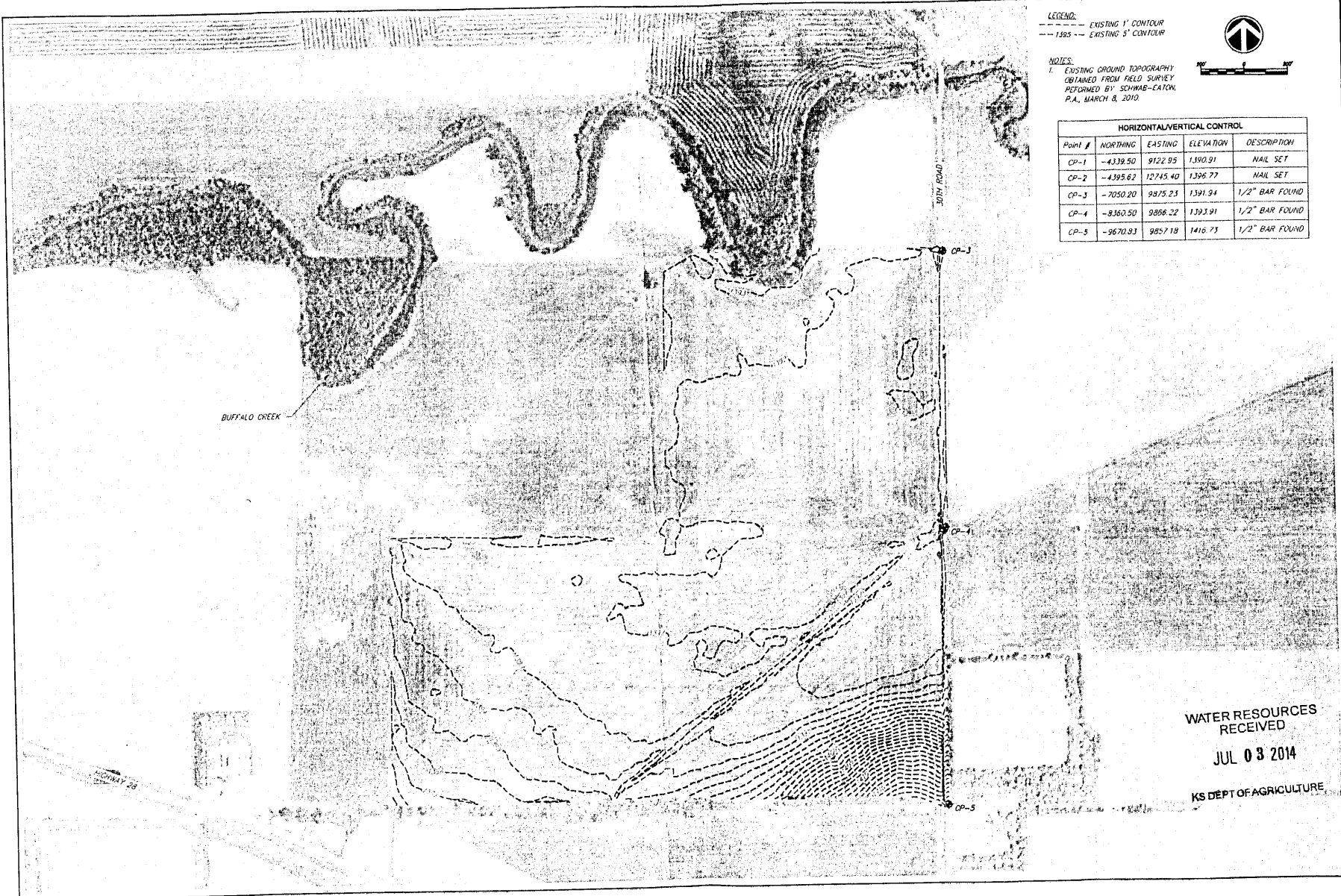

LEGEND:
 --- EXISTING 1' CONTOUR
 --- 1385 --- EXISTING 5' CONTOUR



NOTES:
 1. EXISTING GROUND TOPOGRAPHY OBTAINED FROM FIELD SURVEY PERFORMED BY SCHWAB-EATON, P.A., MARCH 8, 2010.

HORIZONTAL/VERTICAL CONTROL				
Point #	NORTHING	EASTING	ELEVATION	DESCRIPTION
CP-1	-4339.50	9122.95	1390.91	NAIL SET
CP-2	-4395.62	12745.40	1396.77	NAIL SET
CP-3	-7050.20	9875.23	1391.94	1/2" BAR FOUND
CP-4	-8360.50	9866.22	1393.91	1/2" BAR FOUND
CP-5	-9670.83	9857.18	1416.73	1/2" BAR FOUND

BUFFALO CREEK

30TH ROAD

CP-3

CP-1

CP-5

WATER RESOURCES RECEIVED
 JUL 03 2014
 KS DEPT OF AGRICULTURE



PINTAIL MARSH IMPROVEMENTS
 JAMESTOWN WILDLIFE AREA
 JAMESTOWN, KANSAS

Revisions:
 Date: April 14
 Schwab-Eaton Project Number: N/A
 Drawn By: JB
 Checked By: CC

Sheet Name: EXISTING CONDITIONS
 Sheet No.: 2

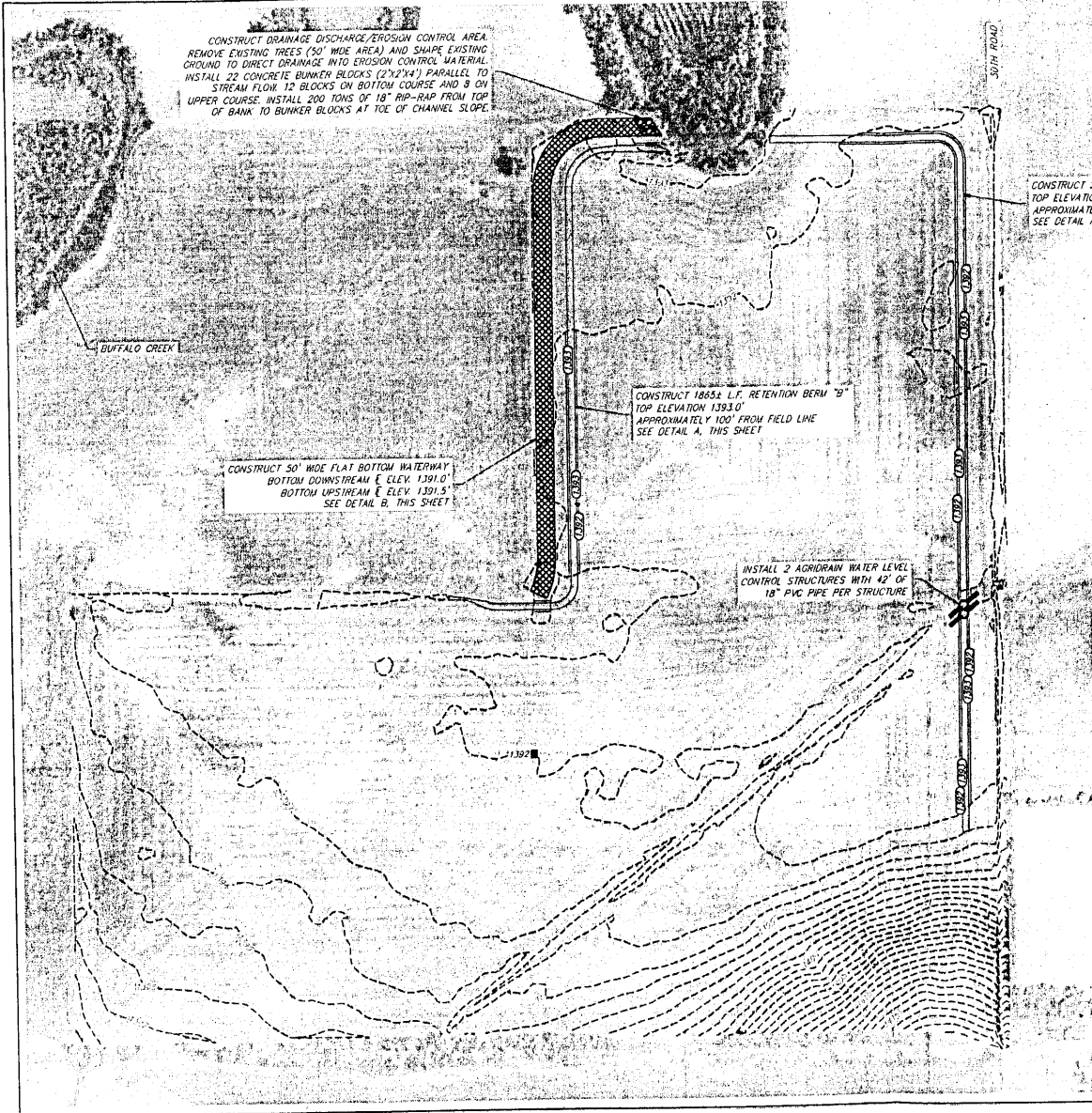

LEGEND:
 --- EXISTING 1' CONTOUR
 ---1.95 --- EXISTING 5' CONTOUR
 --- 1393 --- PROPOSED 1' CONTOUR

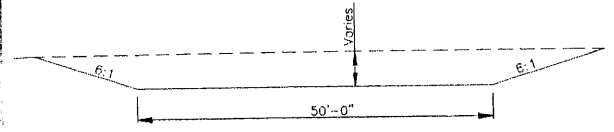

WATERWAY (TYPICAL)

NOT TO SCALE

WATER RESOURCES RECEIVED

JUL 03 2014

KS DEPT OF AGRICULTURE

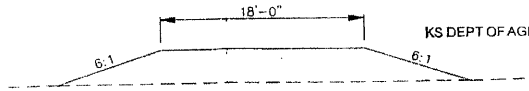

RETENTION BERM (TYPICAL)

NOT TO SCALE



PINTAIL MARSH IMPROVEMENTS
 JAMESTOWN WILDLIFE AREA
 JAMESTOWN, KANSAS

Revision:

Date:
 April 14

Schwab-Eaton
 Project Number:
 N/A

Drawn By:
 JB

Checked By:
 CC

Sheet Name:
 PROPOSED IMPROVEMENTS
 Sheet No.:

3

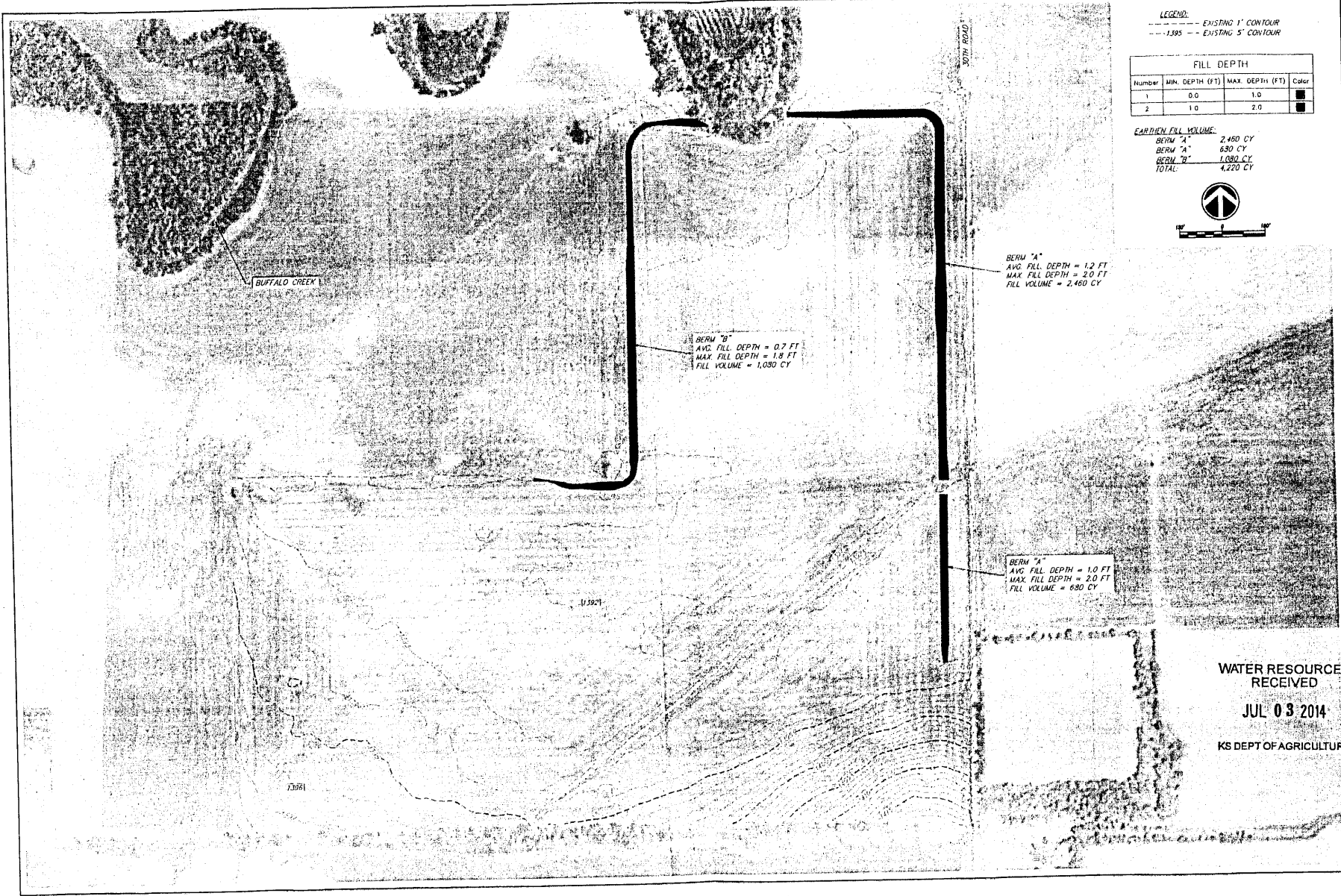

LEGEND:
 --- EXISTING 1' CONTOUR
 ---1.95 --- EXISTING 5' CONTOUR

FILL DEPTH			
Number	MIN. DEPTH (FT)	MAX. DEPTH (FT)	Color
1	0.0	1.0	■
2	1.0	2.0	■

EARLIEN FILL VOLUME:
 BERM "A" 2,460 CY
 BERM "A" 630 CY
 BERM "B" 1,090 CY
 TOTAL 4,220 CY

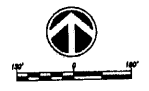

BUFFALO CREEK

BERM "B"
 AVG. FILL DEPTH = 0.7 FT
 MAX. FILL DEPTH = 1.8 FT
 FILL VOLUME = 1,090 CY

BERM "A"
 AVG. FILL DEPTH = 1.2 FT
 MAX. FILL DEPTH = 2.0 FT
 FILL VOLUME = 2,460 CY

BERM "A"
 AVG. FILL DEPTH = 1.0 FT
 MAX. FILL DEPTH = 2.0 FT
 FILL VOLUME = 630 CY

WATER RESOURCES
 RECEIVED
 JUL 03 2014
 KS DEPT OF AGRICULTURE

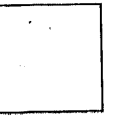

PINTAIL MARSH IMPROVEMENTS
 JAMESTOWN WILDLIFE AREA
 JAMESTOWN, KANSAS

Revised:
 Date: April 14
 Schwab-Eaton Project Number: N/A
 Drawn By: JB
 Checked By: CC

Sheet Name: FILL VOLUMES
 Sheet No.: 4

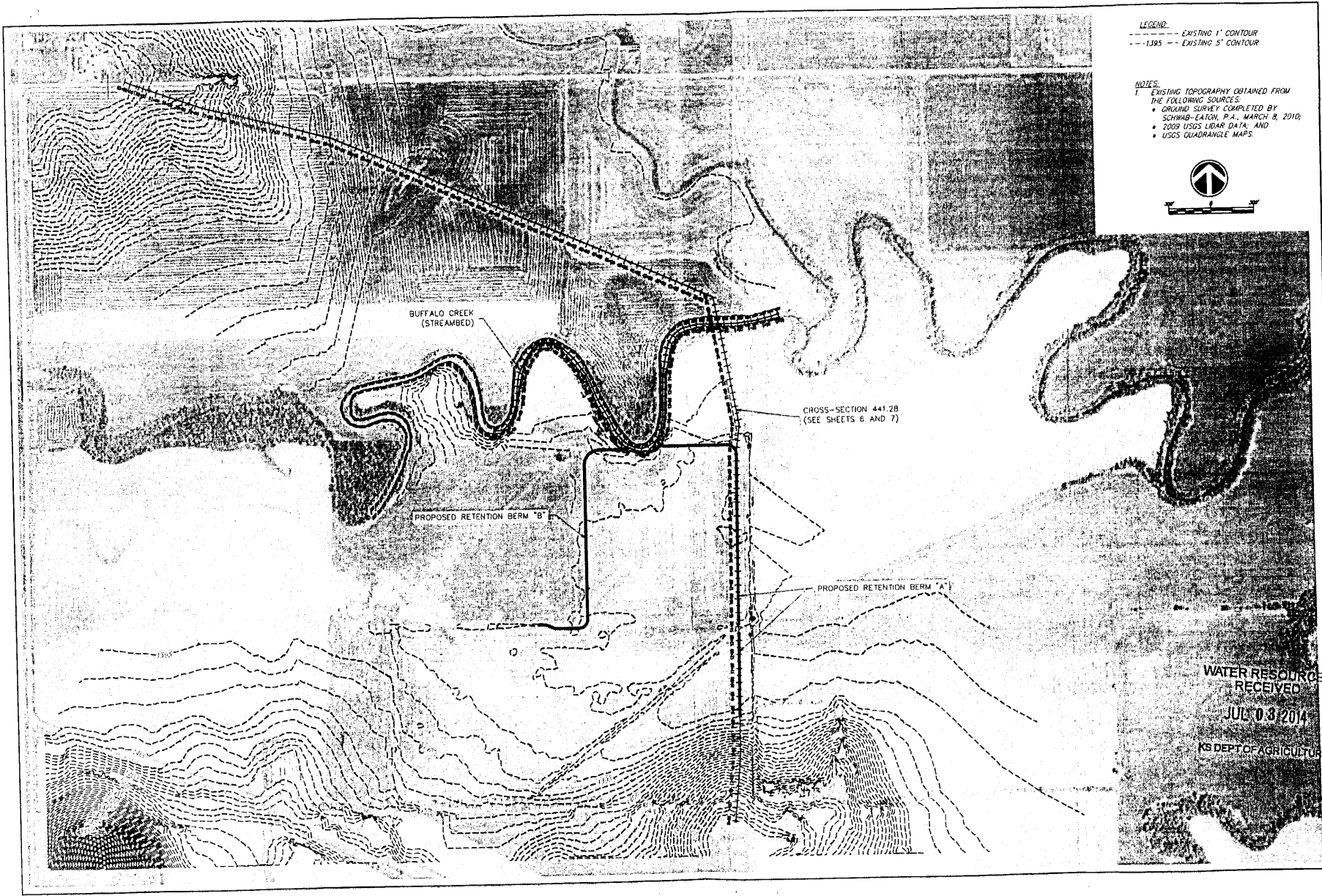

LEGEND:
 --- EXISTING 1' CONTOUR
 - - - EXISTING 5' CONTOUR

NOTES:
 1. EXISTING TOPOGRAPHY OBTAINED FROM THE FOLLOWING SOURCES:
 • GROUND SURVEY COMPLETED BY SCHWAB-EATON, P.A., MARCH 8, 2010;
 • 2009 USGS LIDAR DATA; AND
 • USGS QUADRANGLE MAPS.



WATER RESOURCES RECEIVED
 JUL 03/2014
 KS DEPT OF AGRICULTURE

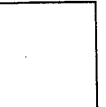

PINTAIL MARSH IMPROVEMENTS
 JAMESTOWN WILDLIFE AREA
 JAMESTOWN, KANSAS

Revision:
 Date: April 14
 Schwab-Eaton Project Number: N/A
 Drawn By: JB
 Checked By: CC

Sheet Name: GEOMETRIC ANALYSIS
 Sheet No.: 5

CROSS-SECTION ANALYSIS:

- ELEVATION OF PROPOSED RETENTION BEHM ALONG CROSS-SECTION = 2,800 FT
- FLOODPLAIN WIDTH AT CROSS-SECTION = 2,800 FT
- FLOODPLAIN WIDTH AT CROSS-SECTION = 2,800 FT
- FLOODPLAIN WIDTH AT CROSS-SECTION = 2,800 FT
- FLOODPLAIN WIDTH AT CROSS-SECTION = 2,800 FT

NOTE:

- FLOODPLAIN WIDTH APPROXIMATED FROM INTERPOLATING THE 100-YEAR WATER ELEVATION AND FLOODPLAIN WIDTH SHOULD BE CONSIDERED APPROXIMATE.
- FLOODPLAIN WIDTH APPROXIMATED FROM INTERPOLATING THE 100-YEAR WATER ELEVATION AND FLOODPLAIN WIDTH SHOULD BE CONSIDERED APPROXIMATE.
- FLOODPLAIN WIDTH APPROXIMATED FROM INTERPOLATING THE 100-YEAR WATER ELEVATION AND FLOODPLAIN WIDTH SHOULD BE CONSIDERED APPROXIMATE.
- FLOODPLAIN WIDTH APPROXIMATED FROM INTERPOLATING THE 100-YEAR WATER ELEVATION AND FLOODPLAIN WIDTH SHOULD BE CONSIDERED APPROXIMATE.

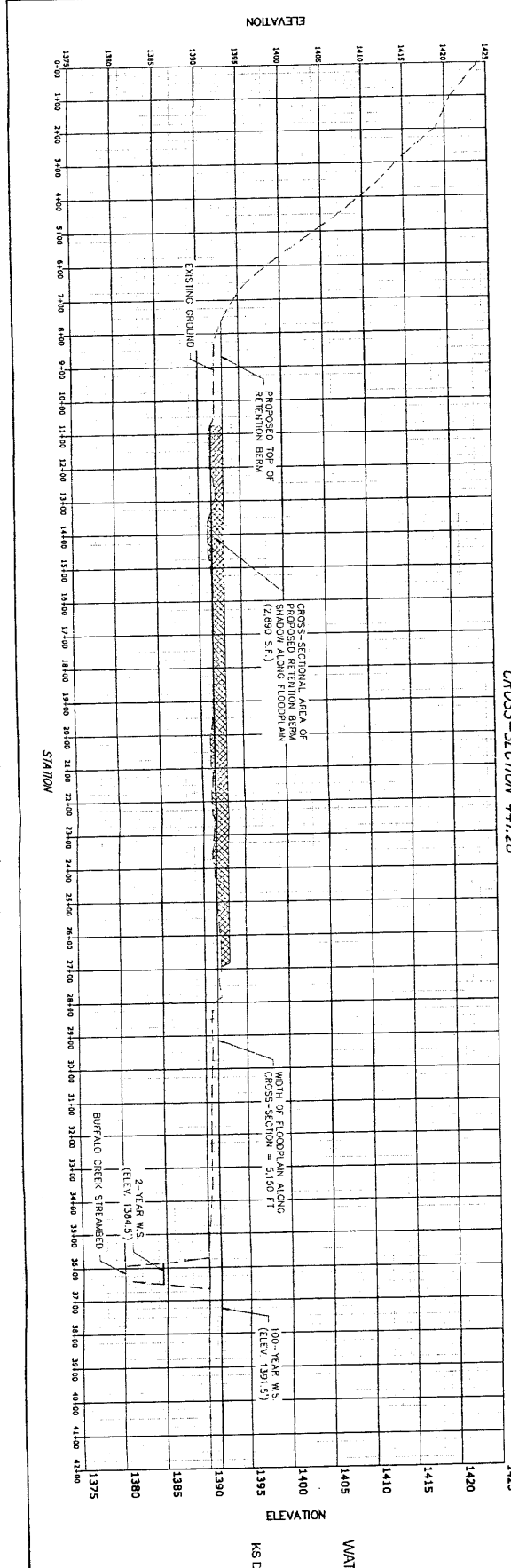
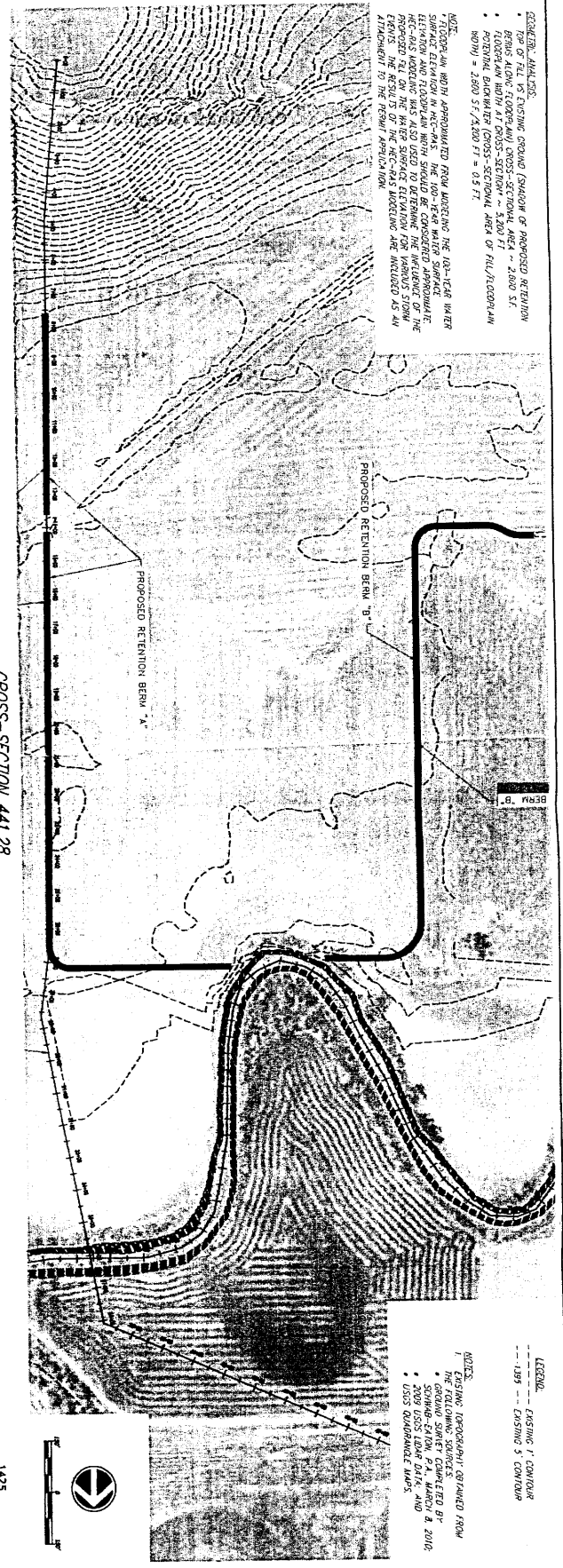

LEGEND:

- EXISTING 1' CONTOUR
- - - EXISTING 5' CONTOUR

NOTES:

- EXISTING TOPOGRAPHY OBTAINED FROM THE NATIONAL ENGINEERING CONSULTING SOCIETY SURVEY COMPLETED BY SCHEIDT & SPOON, P.A., MARCH & 2010.
- 2009 USGS DATA ELEV. 400
- USGS SPANVILLE DAMS.

PINTAIL MARSH IMPROVEMENTS
JAMESTOWN WILDLIFE AREA
JAMESTOWN, KANSAS



WATER RESOURCES RECEIVED
JUL 03 2014
KS DEPT. OF AGRICULTURE
APRIL 14

Project No.: N/A
Drawn By: JB
Checked By: CC

Sheet No.: 28 of 41 (28 of 41)
TO: 423-00
Sheet No.: 6

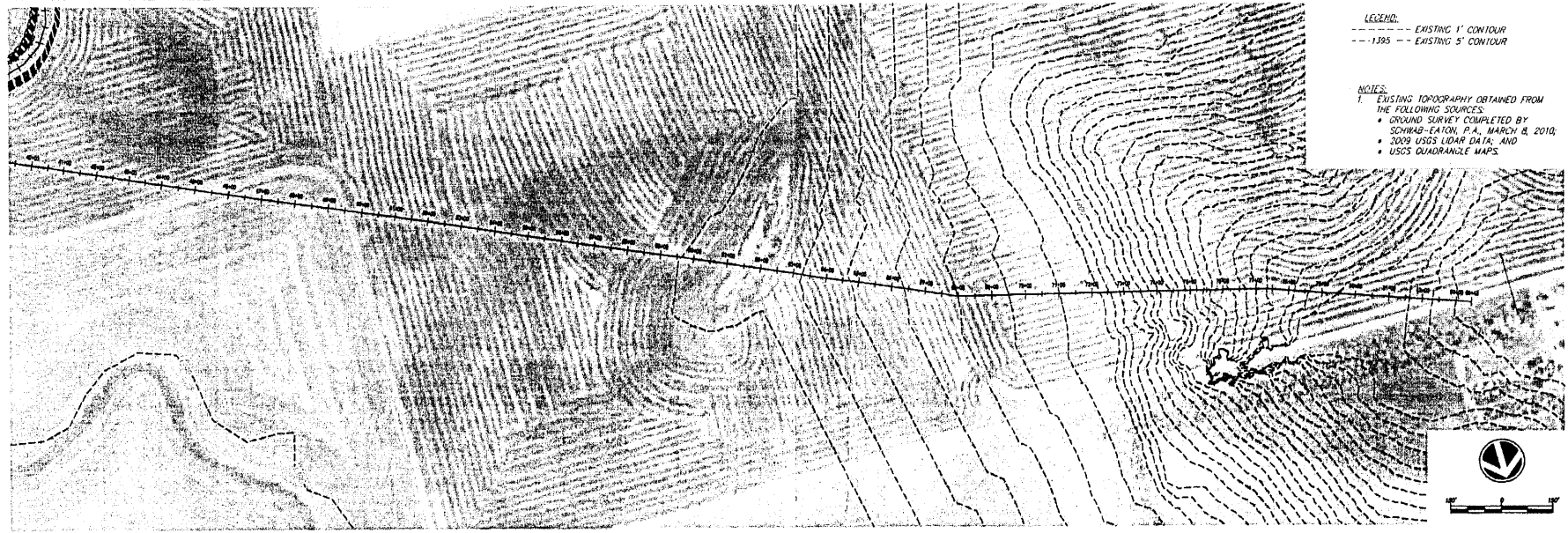

CROSS-SECTION 441.28

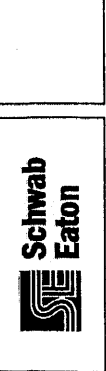
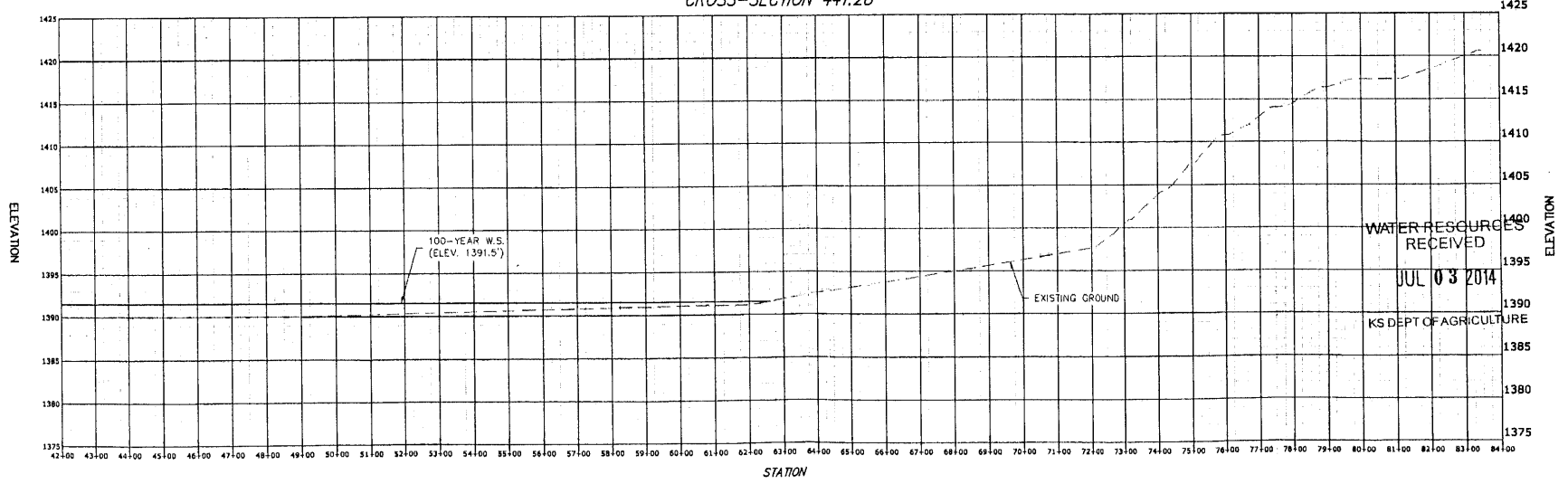

PINTAIL MARSH IMPROVEMENTS
 JAMESTOWN WILDLIFE AREA
 JAMESTOWN, KANSAS

Revisions:

Date:
 April 14

Schwab-Eaton
 Project Number:
 N/A

Drawn By:
 JB

Checked by:
 CC

Sheet Name:
 XS 441.28 (42+00
 TO 84+00)

Sheet No.:
7