

NOTICE

This scan only represents the application as filed. The information contained herein meets the requirements of K.A.R. 5-3-1 or K.A.R. 5-5-1, and has been found acceptable for filing in the office of the Chief Engineer. The application should not be considered to be a complete application as per K.A.R. 5-3-1b or K.A.R. 5-5-2a.

THE STATE OF KANSAS



KANSAS DEPARTMENT OF AGRICULTURE
Jackie McClaskey, Secretary of Agriculture

DIVISION OF WATER RESOURCES
David W. Barfield, Chief Engineer

WATER RESOURCES RECEIVED

File Number 49,747

This item to be completed by the Division of Water Resources.

WATER RESOURCES RECEIVED

DEC 12 2016
UNACCEPTABLE FOR PRIORITY
1:00
KS DEPT OF AGRICULTURE

DEC 22 2016
12:42
KS DEPT OF AGRICULTURE

APPLICATION FOR PERMIT TO APPROPRIATE WATER FOR BENEFICIAL USE

Filing Fee Must Accompany the Application
(Please refer to Fee Schedule attached to this application form.)

To the Chief Engineer of the Division of Water Resources, Kansas Department of Agriculture,
1320 Research Park Drive, Manhattan, Kansas 66502:

1. Name of Applicant (Please Print): Bestifor Farms LLC LP
Address: 1817 East Frontage Rd
City: Belleville State KS Zip Code 66935
Telephone Number: (785) 527-2450

2. The source of water is: surface water in Republican River (stream)
OR groundwater in _____ (drainage basin)

Certain streams in Kansas have minimum target flows established by law or may be subject to administration when water is released from storage for use by water assurance district members. If your application is subject to these regulations on the date we receive your application, you will be sent the appropriate form to complete and return to the Division of Water Resources.

3. The maximum quantity of water desired is 2248 AF acre-feet OR _____ gallons per calendar year, to be diverted at a maximum rate of 6732 gpm gallons per minute OR 15 cubic feet per second.

Once your application has been assigned a priority, the requested maximum rate of diversion and maximum requested quantity of water under that priority number can **NOT** be increased. Please be certain your requested maximum rate of diversion and maximum quantity of water are appropriate and reasonable for your proposed project and are in agreement with the Division of Water Resources' requirements.

4. The water is intended to be appropriated for (Check use intended):
(a) Artificial Recharge (b) Irrigation (c) Recreational (d) Water Power
(e) Industrial (f) Municipal (g) Stockwatering (h) Sediment Control
(i) Domestic (j) Dewatering (k) Hydraulic Dredging (l) Fire Protection
(m) Thermal Exchange (n) Contamination Remediation

YOU **MUST** COMPLETE AND ATTACH ADDITIONAL DIVISION OF WATER RESOURCES FORM(S) PROVIDING INFORMATION TO SUBSTANTIATE YOUR REQUEST FOR THE AMOUNT OF WATER FOR THE INTENDED USE REFERENCED ABOVE.

For Office Use Only:			
F.O. <u>3</u>	GMD <input type="checkbox"/>	Meets K.A.R. 5-3-1 (YES/NO) <u>Use REC</u>	Source <u>G</u> County <u>RR</u>
Code <u>213</u>	Fee \$ <u>700</u>	TR # _____	By <u>ASW</u> Date <u>12/22/16</u>
		Receipt Date <u>12/22/16</u>	Check # <u>28443</u>

28408

12/27/2016 UMM

5. The location of the proposed wells, pump sites or other works for diversion of water is:

Note: For the application to be accepted, the point of diversion location must be described to at least a 10 acre tract, unless you specifically request a 60 day period of time in which to locate the site within a specifically described, minimal legal quarter section of land.

(A) One in the SW quarter of the SW quarter of the SW quarter of Section 29, more particularly described as being near a point 150 feet North and 4650 feet West of the Southeast corner of said section, in Township 3 South, Range 4W, Republic _____ County, Kansas.

(B) One in the _____ quarter of the _____ quarter of the _____ quarter of Section _____, more particularly described as being near a point _____ feet North and _____ feet West of the Southeast corner of said section, in Township _____ South, Range _____ East/West (circle one), _____ County, Kansas.

(C) One in the _____ quarter of the _____ quarter of the _____ quarter of Section _____, more particularly described as being near a point _____ feet North and _____ feet West of the Southeast corner of said section, in Township _____ South, Range _____ East/West (circle one), _____ County, Kansas.

(D) One in the _____ quarter of the _____ quarter of the _____ quarter of Section _____, more particularly described as being near a point _____ feet North and _____ feet West of the Southeast corner of said section, in Township _____ South, Range _____ East/West (circle one), _____ County, Kansas.

If the source of supply is groundwater, a separate application shall be filed for each proposed well or battery of wells, except that a single application may include up to four wells within a circle with a quarter (1/4) mile radius in the same local source of supply which do not exceed a maximum diversion rate of 20 gallons per minute per well.

A battery of wells is defined as two or more wells connected to a common pump by a manifold; or not more than four wells in the same local source of supply within a 300 foot radius circle which are being operated by pumps not to exceed a total maximum diversion rate of 800 gallons per minute and which supply water to a common distribution system.

6. The owner of the point of diversion, if other than the applicant is (please print):

Thayne or Jeanie Larson owners of Bestifor Farms LLC Applicants
(name, address and telephone number)

You must provide evidence of legal access to, or control of, the point of diversion from the landowner or the landowner's authorized representative. Provide a copy of a recorded deed, lease, easement or other document with this application. In lieu thereof, you may sign the following sworn statement:

I have legal access to, or control of, the point of diversion described in this application from the landowner or the landowner's authorized representative. I declare under penalty of perjury that the foregoing is true and correct.

Executed on December 19th, 2016 Thayne Larson
Applicant's Signature

The applicant must provide the required information or signature irrespective of whether they are the landowner. Failure to complete this portion of the application will cause it to be unacceptable for filing and the application will be returned to the applicant.

7. The proposed project for diversion of water will consist of One pump; one dam; one reservoir
(number of wells, pumps or dams, etc.)
and will be completed (by) June 2017
(Month/Day/Year - each was or will be completed)

8. The first actual application of water for the proposed beneficial use was or is estimated to be summer 2017
(Mo/Day/Year)

9. Will pesticide, fertilizer, or other foreign substance be injected into the water pumped from the diversion works?
 Yes No. If "yes", a check valve shall be required.

All chemigation safety requirements must be met including a chemigation permit and reporting requirements.

10. If you are planning to impound water, please contact the Division of Water Resources for assistance, prior to submitting the application. Please attach a reservoir area capacity table and inform us of the total acres of surface drainage area above the reservoir.

Have you also made an application for a permit for construction of this dam and reservoir with the Division of Water Resources? Yes No

- If yes, show the Water Structures permit number here: Not yet available
- If no, explain here why a Water Structures permit is not required: the design and final plans for the dam are being developed.

11. The application must be supplemented by a U.S.G.S. topographic map, aerial photograph or a detailed plat showing the following information. On the topographic map, aerial photograph, or plat, identify the center of the section, the section lines or the section corners and show the appropriate section, township and range numbers. Also, please show the following information:

- (a) The location of the proposed point(s) of diversion (wells, stream-bank installations, dams, or other diversion works) should be plotted as described in Paragraph No. 5 of the application, showing the North-South distance and the East-West distance from a section line or southeast corner of section.
- (b) If the application is for groundwater, please show the location of any existing water wells of any kind within 1/2 mile of the proposed well or wells. Identify each existing well as to its use and furnish the name and mailing address of the property owner or owners. If there are no wells within 1/2 mile, please advise us.
- (c) If the application is for surface water, the names and addresses of the landowner(s) 1/2 mile downstream and 1/2 mile upstream from your property lines must be shown.
- (d) The location of the proposed place of use should be shown by crosshatching on the topographic map, aerial photograph or plat.
- (e) Show the location of the pipelines, canals, reservoirs or other facilities for conveying water from the point of diversion to the place of use.

A 7.5 minute U.S.G.S. topographic map may be obtained by providing the section, township and range numbers to: Kansas Geological Survey, 1930 Constant, Campus West, University of Kansas, Lawrence, Kansas 66047.

12. List any application, appropriation of water, water right, or vested right file number that covers the same diversion points or any of the same place of use described in this application. Also list any other recent modifications made to existing permits or water rights in conjunction with the filing of this application.

None

WATER RESOURCES RECEIVED

DEC 22 2016

KS DEPT OF AGRICULTURE

WATER RESOURCES RECEIVED

UNACCEPTABLE FOR PRIORITY DEC 12 2016

KS DEPT OF AGRICULTURE

13. Furnish the following well information if the proposed appropriation is for the use of groundwater. If the well has not been completed, give information obtained from test holes, if available.

Information below is from: Test holes Well as completed Drillers log attached

Well location as shown in paragraph No.	(A)	(B)	(C)	(D)
Date Drilled	_____	_____	_____	_____
Total depth of well	_____	_____	_____	_____
Depth to water bearing formation	_____	_____	_____	_____
Depth to static water level	_____	_____	_____	_____
Depth to bottom of pump intake pipe	_____	_____	_____	_____

14. The relationship of the applicant to the proposed place where the water will be used is that of

_____ (owner, tenant, agent or otherwise)

15. The owner(s) of the property where the water is used, if other than the applicant, is (please print):

_____ (name, address and telephone number)

_____ (name, address and telephone number)

16. The undersigned states that the information set forth above is true to the best of his/her knowledge and that this application is submitted in good faith.

Dated at Bellefonte, Kansas, this 8th day of December, 2011.
(month) (year)

Bastien James
(Applicant Signature)

By Thayne A. Hanson
(Agent or Officer Signature)

Thayne A. Hanson
(Agent or Officer - Please Print)

Assisted by _____ (office/title) Date: _____

RECEIVED WATER RESOURCES
RECEIVED WATER RESOURCES
KS DEPT OF AGRICULTURE
KS DEPT OF AGRICULTURE

49747

Tyler Larson Application File No.

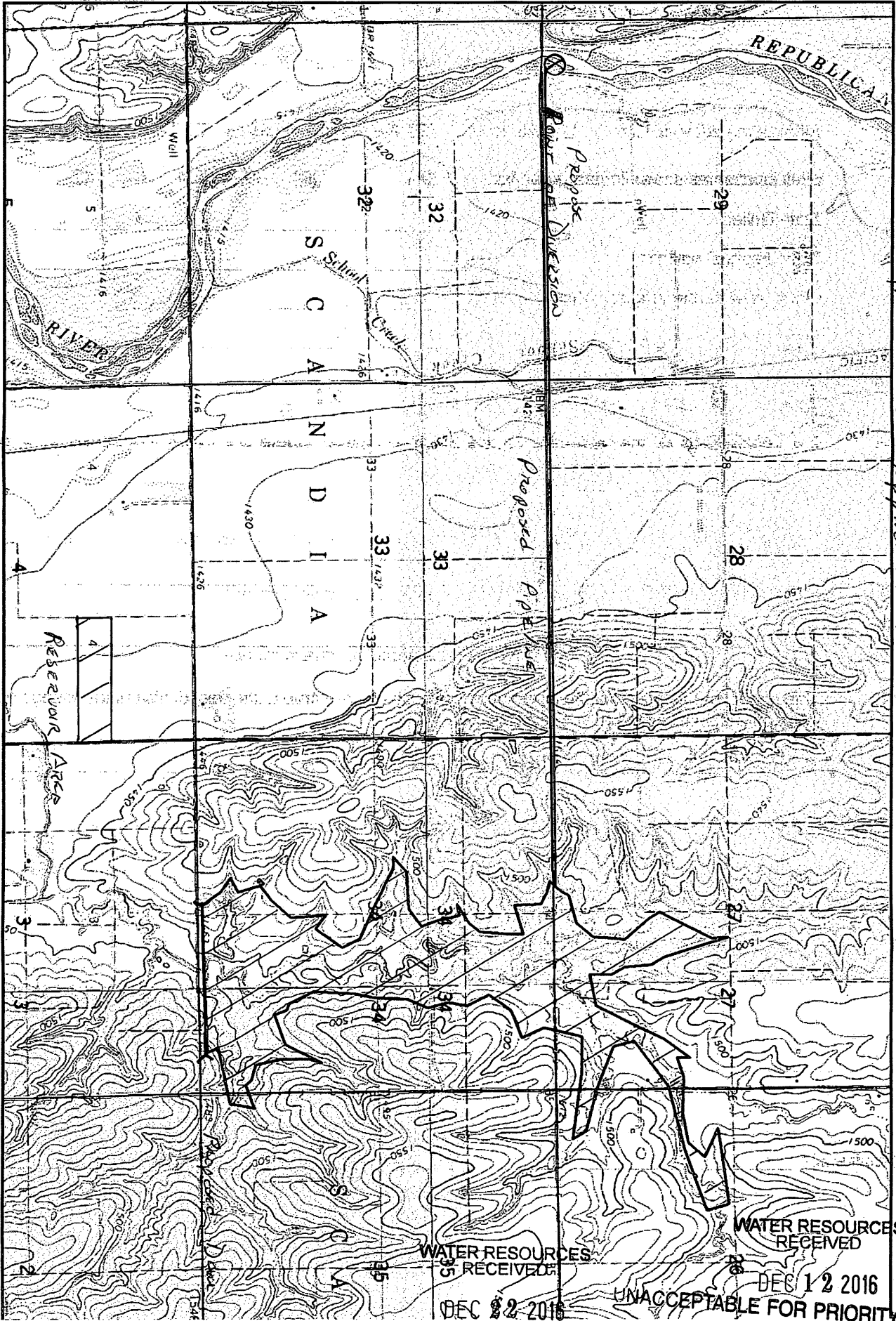

Universal Transverse Mercator (UTM) Projection Zone 14
North American Datum of 1983

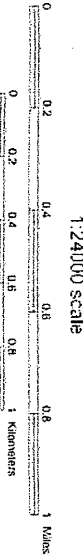

Magnetic declination of 3E at center of map
on March 17, 2011

WATER RESOURCES RECEIVED

DEC 22 2016

WATER RESOURCES RECEIVED

DEC 12 2016

UNACCEPTABLE FOR PRIORITY

**RECREATIONAL USE
SUPPLEMENTAL SHEET**

File No. 491747

Name of Applicant (Please Print): BESTFOR FARMS ~~LLC~~ LP

1. Please indicate type of recreational use (boating, fishing, swimming, etc.): _____
Boating, Fishing, Hunting, Swimming

2. Please summarize how the water will be used and justify the quantity of water requested: _____
THE INTENT IS TO MAINTAIN THE RESERVOIR AT CAPACITY THROUGH OFF-SEASON DIVERSIONS. THE DEPTH MUST REMAIN AT OR ABOVE 8 FEET TO SUPPORT WINTERING AN ANNUAL FISHERY.

3. Please complete the following table showing estimated future water requirements:

ESTIMATED FUTURE WATER DIVERTED/STORED	
NEXT 5 YEARS	WATER TO BE DIVERTED (ACRE-FEET OR GALLONS)
Year 1	1000 AF
Year 2	2000 AF
Year 3	2248 AF
Year 4	2248 AF
Year 5	2248 AF

Please attach any additional information, tables, or curves showing past, present and estimated future water requirements to substantiate the amount of water requested.

4. Please designate the legal description of the location where the water is to be used by providing the fractional part of the Section, Township and Range.
SW 1/4 Sec. 26 ; SE 1/4 Sec. 27 ; East 1/2 Sec. 34
All in Township 3 South, Range 4 West in Republic Co. KS

You may attach any additional information you believe will assist in informing the Division of the need for your request.

WATER RESOURCES RECEIVED

WATER RESOURCES RECEIVED

DEC 22 2016

UNACCEPTABLE FOR PRIORITY DEC 12 2016

FEE SCHEDULE

1. The fee for an application for a permit to appropriate water for beneficial use, except for domestic use, shall be (see paragraph No. 2 below if requesting storage):

ACRE-FEET	FEE
0-100	\$200.00
101-320	\$300.00
More than 320	\$300.00 plus \$20.00 for each additional 100 acre-feet or any part thereof.

2. The fee for an application in which storage is requested, except for domestic use, shall be:

ACRE-FEET	FEE
0-250	\$200.00
More than 250	\$200.00 plus \$20.00 for each additional 250 acre-feet of storage or any part thereof.

200
+ # 200
+ # 160

560

Note: If an application requests both direct use *and* storage, the fee charged shall be as determined under No. 1 or No. 2 above, whichever is greater, but not both fees.

3. The fee for an application for a permit to appropriate water for water power or dewatering purposes shall be \$100.00 plus \$200.00 for each 100 cubic feet per second, or part thereof, of the diversion rate requested.

Note: The applicant shall notify the Chief Engineer and pay the statutorily required field inspection fee of \$400.00 when construction of the works for diversion has been completed, except that for applications filed on or after July 1, 2009, for works constructed for sediment control use and for evaporation from a groundwater pit for industrial use shall be accompanied by a field inspection fee of \$200.00.

MAKE CHECKS PAYABLE TO THE KANSAS DEPARTMENT OF AGRICULTURE

ATTENTION

A Water Conservation Plan may be required per K.S.A. 82a-733. A statement that your application for permit to appropriate water may be subject to the minimum desirable streamflow requirements per K.S.A. 82a-703a, b, and c may also be required from you. After the Division of Water Resources has had the opportunity to review your application, you will be notified whether or not you will need to submit a Water Conservation Plan. You also may be required to install a water flow meter or water stage measuring device on your diversion works prior to diverting water. There may be other special conditions or Groundwater Management District regulations that you will need to comply with if this application is approved.

CONVERSION FACTORS

1 acre-foot equals 325,851 gallons
1 million gallons equal 3.07 acre-feet

WATER RESOURCES RECEIVED

DEC 12 2016

WATER RESOURCES RECEIVED

DEC 22 2016

UNACCEPTABLE FOR PRIORITY

49,747



1320 Research Park Drive
Manhattan, Kansas 66502
(785) 564-6700

900 SW Jackson, Room 456
Topeka, Kansas 66612
(785) 296-3556

Jackie McClaskey, Secretary

Governor Sam Brownback

December 16, 2016

WATER RESOURCES
RECEIVED

BESTIFOR FARMS LP
1817 EAST FRONTAGE RD
BELLEVILLE KS 66935

DEC 22 2016

KS DEPT OF AGRICULTURE

Re: Unacceptable Application

Dear Sir or Madam:

Returned herewith is your Application for Permit to Appropriate Water for Beneficial Use received by the Division of Water Resources on December 12, 2016 with Check No. 28408 in the amount of \$560. This application is not acceptable for filing in its present form.

Effective July 1, 2009, K.S.A. 82a-709 requires all applicants for new appropriation rights for the beneficial use of water in the State of Kansas to provide evidence of legal access to or control of the point of diversion from the landowner or the landowner's authorized representative. Applicants may provide a copy of a recorded deed, lease, easement or other document with the application. **In lieu of providing this documentary evidence, you may sign Paragraph No. 6 of the original permit application (where indicated), which constitutes a sworn statement.** Please note that the enclosed new application must bear an **original signature**. Photocopies or fax signatures are not acceptable.

The required fee as stated on the enclosed fee schedule OR as stated on the bottom of the signature page of the application was incorrect. Therefore, we find it necessary to return the application to you. Upon submitting the application to this office with the required fee, it will be further examined and processed. Based on the information received, \$700 is needed for the filing fee.

Upon return of the acceptable application with required original signatures and information, it will be assigned a priority based upon the date and time it is received in the office of the Chief Engineer. If you have any questions, please contact me at (785) 564-6631 or alex.whitesell@ks.gov.

Sincerely,

Alex Whitesell
Environmental Scientist
Water Appropriation Program

enclosure



1320 Research Park Drive
Manhattan, Kansas 66502

Jackie McClaskey, Secretary

Phone: (785) 564-6700
Fax: (785) 564-6777
Email: ksag@kda.ks.gov
www.agriculture.ks.gov
Sam Brownback, Governor

December 23, 2016

BESTIOR FARMS LP
1817 EAST FRONTAGE RD
BELLEVILLE KS 66935

FILE COPY

RE: Application
File No. 49747

Dear Sir or Madam:

Your application for permit to appropriate water in 29-3S-4W in Republic County, was received and has been assigned the file number noted above.

As a matter of record, the Division of Water Resources has on hand a large number of applications awaiting processing. Therefore to be fair to all concerned, and so that we can process those applications on hand in the order they were received, we intend to concentrate on the backlog of applications until the issue is resolved. Once review of your application has begun, we will contact you, if additional information is required.

In accordance with the provisions of the Kansas Water Appropriation Act, a portion of which is included below, the use of water as proposed prior to approval of the application is unlawful. Once approved, compliance with the terms, conditions and limitations of the permit is necessary. Conservation of the water resources of Kansas is required.

Section 82a-728 of the Kansas Water Appropriation Act, provides (a) except for the appropriation of water for the purpose of domestic use, . . . it shall be unlawful for any person to appropriate or threaten to appropriate water from any source without first applying for and obtaining a permit to appropriate water in accordance with the provisions of the Water Appropriation Act or for any person to violate any condition of a vested right, appropriation right or an approved application for a permit to appropriate water for beneficial use.

(b) (1) The violation of any provision of this section by any person is a class C misdemeanor . . .

A class C misdemeanor is punishable by a fine not to exceed \$500 and/or a term of confinement not to exceed one month in the county jail. Each day that the violation occurs constitutes a separate offense.

If you have any questions, please contact me at (785) 564-6645. If you wish to discuss a specific file, please have the file number ready so that we may help you more efficiently.

Sincerely,

Brent A Turney, P.G.
Change Application Unit Supervisor
Water Appropriation Program

BAT: dlw
pc: STOCKTON Field Office
GMD