

Kansas Department of Agriculture / Division of Water Resources
Stockton Field Office

TO: HEADQUARTERS

RE Vested Right; Water Right; Appropriation of Water; Application

File No(s). 48,885 & 48,887

County RA

Enclosed are the following checked items:

A FIR Full Partial Inspection Return to Field Office
 Proposed Certificate to deliver to Certificate Unit

Meter Order: GMD#4
 Lower Smoky
 Other _____

A Compliance Check Inspection on _____

Meter Install New App Chg App Other _____

In Compliance Not in Compliance, why _____

Modify Point of Diversion No Yes, document attached

Indicate all overlapping p/d files _____

An application and judgment sheet with recommendation.

A memorandum dated _____

A request for an extension of time to perfect or complete.

A verified report.

A closure request.

A field investigation report.

Notice of Non-Compliance _____

Violation

Date

An ownership change (name(s) and address(es) below).

A water use report for _____

A letter dated _____

A copy of an Approval to Change the place of use and/or point of diversion,

Filing Fee attached. \$400.00

#5977

An Advanced copy of a change application and the filing fee, to be processed at the field office.

An original field office change application and the filing fee needing headquarters office review and further processing.

Other: _____

Assistant Water Commissioner

9-1-17
Date

CHECK SHEET

Short Change

File No. 48885

Field Office No. 3

GMD No. _____

1. **Plugging agreement obtained for GMD?** Yes No Non Applicable

2. **Is Landowner correct as currently shown in WRIS?** Yes No **Address Change?** YES
 If applicable, list Place of Use Overlap File Nos. _____

3. **Is Water Use Correspondent correct as currently shown in WRIS?** Yes No **Address Change?** NO
 Name of Former WUC _____ Name of New WUC _____

4. a. **Point of diversion computer ID No(s).** n/a for point(s) being changed.
 b. **Show feet distances from the** SE **corner of the section for the new point(s) of diversion:**

Action	PDIV ID	Geo Ctr?	Sec	Twp	Rng	'N	'W	County	Qualifiers

c. **If multiple points of diversion exist and rates and quantities are individually assigned, show:**

Old PDIV ID	Authorized Rate	Additional Rate	Authorized Quantity	Additional Quantity
_____	_____ gpm/cfs	_____ gpm/cfs	_____ af/mgy	_____ af/mgy
_____	_____ gpm/cfs	_____ gpm/cfs	_____ af/mgy	_____ af/mgy
_____	_____ gpm/cfs	_____ gpm/cfs	_____ af/mgy	_____ af/mgy

d. **Name of Drainage Basin** _____ **Is this correctly shown in WRIS?** Yes No

e. **Formation Name & No.** _____ **Special Use Area** _____

5. **Distances from the previous/original p/d:** _____ ' N / S _____ ' E / W

6. WATER RIGHT ACTION TRAIL COMMENTS

09/01/2017 Change Application Received (date accepted for priority)
09/01/2017 Change Approved
 Notice and Proof by ____/____/____
 _____/____/____ Completion Requirement Removed (Change No. C____)

7. METER ACTION TRAIL COMMENTS

_____/____/____ DWR Meter Required by ____/____/____

8. **Base Acres** _____ **Year** _____ **Minimum Reasonable Quantity** _____

Date Created **9/1/17** by **Billinger**
 Date Entered _____ by _____

CHECK SHEET ATTACHMENT

9. Changes to the place of use will be:

File Number **48885**

Action	Owner Person ID	Place Use ID #	Sec.	Twp.	Range		NE¼				NW¼				SW¼				SE¼				TOTAL ACRES				
							NE¼	NW¼	SW¼	SE¼	NE¼	NW¼	SW¼	SE¼	NE¼	NW¼	SW¼	SE¼	NE¼	NW¼	SW¼	SE¼					
MOD	NEW1	65401	13	02S	35W	Acres Authorized					37	14	15.5	32.5													99
						New Acres					37	14	15.5	32.5													
MOD	NEW2	65402	13	02S	35W	Acres Authorized		5.5	3.5																		9
						New Acres		5.5	3.5																		
MOD	NEW3	NEW	13	02S	35W	Acres Authorized									30	36.5	18	13									97.5
						New Acres									30	36.5	18	13									
						Acres Authorized																					
						New Acres																					

Names and Address:

<p>1. Person ID # <u>NEW1</u></p> <p><u>A. MARTIN & MARILYN KOPRIVA</u></p> <p><u>9359 ROAD 12</u></p> <p><u>ATWOOD, KS 67730-3250</u></p>	<p>2. Person ID # <u>NEW2</u></p> <p><u>JULIA KOPRIVA</u></p> <p><u>301 N 4TH ST APT B</u></p> <p><u>ATWOOD, KS 67730</u></p>	<p>3. Person ID # <u>NEW3</u></p> <p><u>MARILYN KOPRIVA</u></p> <p><u>9359 ROAD 12</u></p> <p><u>ATWOOD, KS 67730-3250</u></p>
--	--	--

GENERAL INSTRUCTIONS

- | | | |
|--|---|--|
| <p>1. Give to Applicant:</p> <ul style="list-style-type: none"> a. <u>Original</u> application/approval b. Original receipt (one for <u>each</u> application) c. Information packet containing: <ul style="list-style-type: none"> • Notice and Proof form • Water Meter Specifications • Acceptable Meter list • Water level measurement tube specifications • Check Valve specifications • Pink Sheet - K.S.A. 82a-728 letter • Form stating to record in Register of Deeds Office (OPTIONAL AS NEEDED) | <p>2. Send to headquarters:</p> <ul style="list-style-type: none"> a. Good, <u>microfilmable</u> copy of application and/or approval and this check sheet b. Original check and copy of receipt c. Test hole log d. GMD recommendation, if any e. Map or aerial photograph, if any <p>3. Send to KDHE: Letter (KDHE.LT) advising of location of abandoned well. <input type="checkbox"/></p> | <p>4. Date stamp received and approved.</p> <p>5. Complete ownership and WUC change information.</p> |
|--|---|--|

ADDITIONAL PHOTOCOPIES

CONDITIONS

1. Insert notice and proof date.
2. Type or print applicant's/owner's name on line.
3. Complete notary statement.

Kansas
Department of Agriculture
Division of Water Resources

Stockton Field Office
820 S. Walnut
Stockton, Kansas 67669-0192
Jackie McClaskey, Secretary
David W. Barfield, Chief Engineer
Kelly Stewart, Water Commissioner

Phone: (785) 425-6787
Fax: (785) 425-6842
www.agriculture.ks.gov
Sam Brownback, Governor

September 1, 2017

JIM KOPRIVA
9359 ROAD 12
ATWOOD KS 67730

Re: Appropriations of Water, File Nos. 48,885 & 48,887

Dear Mr. Kopriva:

Enclosed are two (2) orders executed by David W. Barfield, Chief Engineer, Division of Water Resources, Kansas Department of Agriculture, approving the applications for change under the above referenced file numbers.

Your attention is directed to the terms, conditions, and limitations specified in these approvals for change.

Since these orders modify the original certificates, they should be recorded with the Register of Deeds as other instruments affecting real estate.

These documents are summary orders by this agency regarding these matters. These orders shall become final if requests for hearings are not filed with the Chief Engineer within 15 days of the date of service of these orders.

If you have any questions, please feel free to contact this office. If you wish to refer to a specific file, please reference it when you contact us.

Sincerely,

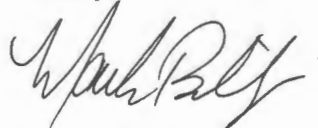

Mark Billinger
Assistant Water Commissioner

MB:rh
Enclosures

CERTIFICATE OF SERVICE

On this 1st day of September, 2017, I hereby certify that the attached SUMMARY ORDERS APPROVING APPLICATIONS FOR CHANGE in PLACE OF USE for appropriations of water, File Nos. 48,885 & 48,887, dated on the 1st day of Septmeber, 2017, were mailed postage prepaid, first class, U.S. mail, to the following:

JIM KOPRIVA
9359 ROAD 12
ATWOOD KS 67730

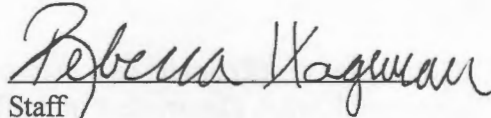
Staff

Submit completed application to:
 Kansas Department of Agriculture
 Division of Water Resources
 Field Office for your area.

Call for address:

Topeka -- (785) 296-5733
 Stafford -- (620) 234-5311
 Stockton -- (785) 425-6787
 Garden City -- (620) 276-2901
<http://agriculture.ks.gov/dwr>

DWR FIELD OFFICE APPLICATION FOR APPROVAL TO CHANGE THE PLACE OF USE AND/OR THE POINT OF DIVERSION



STATE OF KANSAS
 APPLICATION COMPLETE
 9/11/17
 Reviewer ms

Filing Fee Must Accompany the Application, K.S.A. 82a-708b(b), as amended.
 Fee Schedule is on the third page of this application form.

Paragraph Nos. 1, 2, 3 & 5 must be completed. Complete all other applicable portions. If change in point of diversion is greater than 100 feet, or if place of use will be changed, include a topographic map or detailed plat showing the authorized and proposed point(s) of diversion and/or place of use.

RECEIVED

File No. 48885

SEP 01 2017
 11:20 a.m.
 Stockton Field Office
 Division of Water Resources

1. Application is hereby made for approval of the Chief Engineer to change the (check one or both):

Place of Use Point of Diversion

under the water right which is the subject of this application in accordance with the conditions described below.

The source of supply is: Groundwater Surface water

2. Name and address of Applicant: Jim Kopriva

9359 Road 12 Atwood KS, 67730

Phone Number: (785)626-3920 Email address: _____

Name and address of Water Use Correspondent: Jim Kopriva

9359 Road 12 Atwood KS, 67730

Phone Number: (785)626-3920 Email address: _____

3. The presently authorized place of use is:

Owner of Land ---- NAME: A. Martin & Marilyn Kopriva B. Julia Kopriva C. Marilyn Kopriva

ADDRESS: 9359 Road 12 Atwood KS, 67730-3250 301 N. 4th St. Apt. B Atwood, KS 67730 9359 Road 12 Atwood KS, 67730-3250

(If there is more than one landowner, attach supplemental sheets as necessary.)

Sec.	Twp.	Range	NE¼				NW¼				SW¼				SE¼				TOTAL ACRES
			NE¼	NW¼	SW¼	SE¼	NE¼	NW¼	SW¼	SE¼	NE¼	NW¼	SW¼	SE¼	NE¼	NW¼	SW¼	SE¼	
A. 13	2	35 W					12	1	12	40									65
B. 13	2	35 W	1	12	40	12													65
C. 13	2	35 W									40	14	1	11					66

4. If this application is for a change in place of use, it is proposed that the place of use be changed to:

Owner of Land ---- NAME: A. Martin & Marilyn Kopriva B. Julia Kopriva C. Marilyn Kopriva

ADDRESS: 9359 Road 12 Atwood KS, 67730-3250 301 N. 4th St. Apt. B Atwood, KS 67730 9359 Road 12 Atwood KS, 67730-3250

(If there is more than one landowner, attach supplemental sheets as necessary.)

Sec.	Twp.	Range	NE¼				NW¼				SW¼				SE¼				TOTAL ACRES
			NE¼	NW¼	SW¼	SE¼	NE¼	NW¼	SW¼	SE¼	NE¼	NW¼	SW¼	SE¼	NE¼	NW¼	SW¼	SE¼	
A. 13	2	35 W					37	14	15.5	32.5									99
B. 13	2	35 W		5.5	3.5														9
C. 13	2	35 W									30	36.5	18	13					97.5

For Office Use Only: Code _____ Fee \$ _____ TR # _____ Receipt Date _____ Check # _____

5. **Presently authorized point of diversion:**
 One in the _____ Quarter of the _____ Quarter of the _____ Quarter
 of Section _____, Township _____ South, Range _____ (E/W),
 in _____ County, Kansas, _____ feet North _____ feet West of Southeast corner of section.
 Authorized Rate _____ Authorized Quantity _____ Depth of well _____ (feet)
(DWR use only: Computer ID No. _____ GPS _____ feet North _____ feet West)
 This point will not be changed This point will be changed as follows: No change, point better described with GPS as follows:
Proposed point of diversion: (Complete only if change is requested or if existing point is better described by GPS)
 One in the _____ Quarter of the _____ Quarter of the _____ Quarter
 of Section _____, Township _____ South, Range _____ (E/W),
 in _____ County, Kansas, _____ feet North _____ feet West of Southeast corner of section.
 Proposed Rate _____ Proposed Quantity _____ Proposed well depth (feet) _____
 This point is: Additional Well Geo Center List other water rights that will use this point _____

6. **Presently authorized point of diversion:**
 One in the _____ Quarter of the _____ Quarter of the _____ Quarter
 of Section _____, Township _____ South, Range _____ (E/W),
 in _____ County, Kansas, _____ feet North _____ feet West of Southeast corner of section.
 Authorized Rate _____ Authorized Quantity _____ Depth of well _____ (feet)
(DWR use only: Computer ID No. _____ GPS _____ feet North _____ feet West)
 This point will not be changed This point will be changed as follows: No change, point better described with GPS as follows:
Proposed point of diversion: (Complete only if change is requested or if existing point is better described by GPS)
 One in the _____ Quarter of the _____ Quarter of the _____ Quarter
 of Section _____, Township _____ South, Range _____ (E/W),
 in _____ County, Kansas, _____ feet North _____ feet West of Southeast corner of section.
 Proposed Rate _____ Proposed Quantity _____ Proposed well depth (feet) _____
 This point is: Additional Well Geo Center List other water rights that will use this point _____

7. The changes herein are desired for the following reasons?
 (please be specific) n/a

13a. If the proposed point of diversion will be relocated within 100 feet of the existing point of diversion, indicate its location on the diagram below in relation to the existing point of diversion. (PLEASE NOTE: The "X" in center of diagram below represents presently authorized point of diversion.)

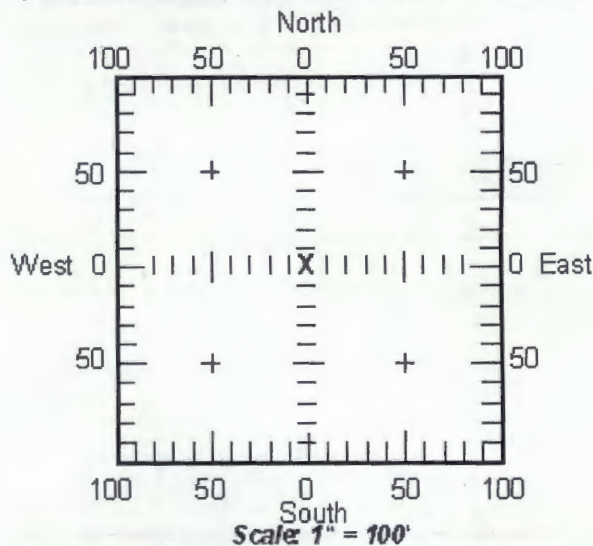

8. If a well, is the test hole log attached? Yes No

9. The change(s) (was)(will be) completed by?
n/a

10. If the point of diversion is a well:
 (a) What are you going to do with the old well?
n/a

(b) When will this be done? n/a

11. Groundwater Management District recommendation attached? Yes No

12. Assisted by DLM

13b. If the proposed point of diversion will be relocated more than 100 feet but within 1320 feet from the existing point of diversion, attach a topographic map or aerial photograph. For groundwater sources, show all wells (including domestic) within one-half mile of the proposed point of diversion and the names and mailing addresses of the owners. For surface water sources, show the names and addresses of the landowner(s) one-half mile downstream and one-half mile upstream from your property lines.

SUMMARY ORDER APPROVING APPLICATION FOR CHANGE AND IMPOSING CONDITIONS

This Summary Order is issued under authority of K.S.A. 82a-708b, as amended, and K.A.R. 5-5-1, *et seq.* and other applicable provisions of the *Kansas Water Appropriation Law, K.S.A. 82a-701 et. seq.*, and rules and regulations promulgated thereunder, With the exception of those conditions expressly contained herein, this Summary Order does not change the terms, conditions and limitations of File No. 48885.

1. A change application was received on 9-1-17 requesting that the place of use and / or point of diversion authorized under the above-referenced file number be changed as described in the application.
2. On and after the effective date of this summary order, the authorized place(s) of use shall be located substantially as shown on the topographic map accompanying the application to change the place of use. Applicable Not Applicable
3. The change in point of diversion shall not impair existing rights and shall be limited to the same source or sources of water as previously authorized. The point of diversion authorized by this summary order shall be located within a _____ foot radius of the authorized point(s) of diversion. Applicable Not Applicable
4. The point(s) of diversion authorized herein shall not actually be located more than _____ feet from the previously authorized point(s) of diversion. Applicable Not Applicable
5. As required by K.A.R. 5-3-5d, if the works for diversion is a well with a diversion rate of 100 gallons per minute or more, a tube or other device suitable for making water level measurements shall be installed, operated and maintained in accordance with K.A.R. 5-6-13. Applicable Not Applicable
6. The owner of the authorized place(s) of use shall properly install an acceptable water flow meter on or before **December 31, 20**_____, or before the first use of water, whichever occurs first. The water flow meter shall be installed, operated and maintained in accordance with K.A.R. 5-1-4 through 5-1-12. As required by K.S.A. 82a-732, as amended, and K.A.R. 5-3-5e, the owner shall maintain records and report the reading of the water flow meter and the total quantity of water diverted annually to the Chief Engineer by March 1 following the end of each calendar year.
 Applicable Not Applicable
7. Installation of the works for diversion of water shall be completed on or before **December 31, 20**_____, or within any authorized extension of time. By March 1, 20_____ the applicant shall notify the Chief Engineer that construction of the works for diversion has been completed, on the form provided by the Chief Engineer, as required by K.A.R. 5-8-4e.
 Applicable Not Applicable
8. The completed well log shall be submitted with the required notice. Applicable Not Applicable
9. All diversion works into which any type of chemical or other foreign substance will be injected into the water shall be equipped with an in-line, automatic, quick-closing check valve capable of preventing pollution of the source of the water supply. The check valve(s) shall be installed, operated and maintained in accordance with K.A.R. 5-3-5c. Applicable Not Applicable
10. Additional Conditions are attached. Yes No
11. In accordance with K.S.A. 82a-708a, as amended, and K.A.R. 5-5-14, all of the owners of the authorized place(s) of use of water appropriated under the above-referenced file number are responsible for compliance with its terms, conditions and limitations, as amended and/or supplemented by this Summary Order, and with applicable provisions of the *Kansas Water Appropriation Law* and the *Rules and Regulations* promulgated thereunder. Failure to comply with these provisions may result in civil penalties pursuant to K.S.A. 82a-737, as amended, and/or the suspension or revocation and dismissal of the water or appropriation right or any other enforcement actions authorized by law.

Administrative Appeal and Effective Date of Order

If you are aggrieved by this order, pursuant to K.S.A. 82a-1901, you may request an evidentiary hearing before the Chief Engineer or request administrative review by the Secretary of Agriculture. A request for hearing by the Chief Engineer must be filed within **15 days** of service of this Order and a request for administrative review by the Secretary must be filed within **30 days** pursuant to K.S.A. 77-531. Any request for administrative review must state a basis for review pursuant to K.S.A. 77-527. File any request with **Kansas Department of Agriculture, Legal Division, 1320 Research Park Drive, Manhattan, KS 66502**. Failure to timely request a hearing or review may preclude review under the Kansas Judicial Review Act.

For Use by Register of Deeds

FOR OFFICE USE ONLY
**APPLICATION APPROVED AND
SUMMARY ORDER ISSUED**

By: [Signature]
Duly Authorized Designee of the Chief Engineer

(Print Name): Mark B. [Signature]
Division of Water Resources - Kansas Department of Agriculture

Date of Issuance: 9-1-17

State of Kansas _____)
County of ROOKS _____) SS

Acknowledged before me on 9-1-17
by Mark Billinger

Signature: [Signature]
Notary Public

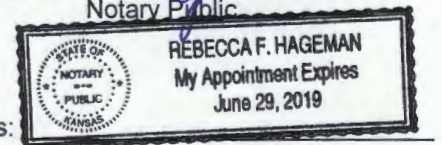

My commission expires: 6-29-19

(Notary Seal)

File No. 48885

Application to Change the Place of Use For Water Right File 48885

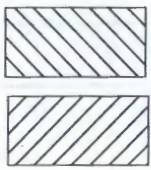
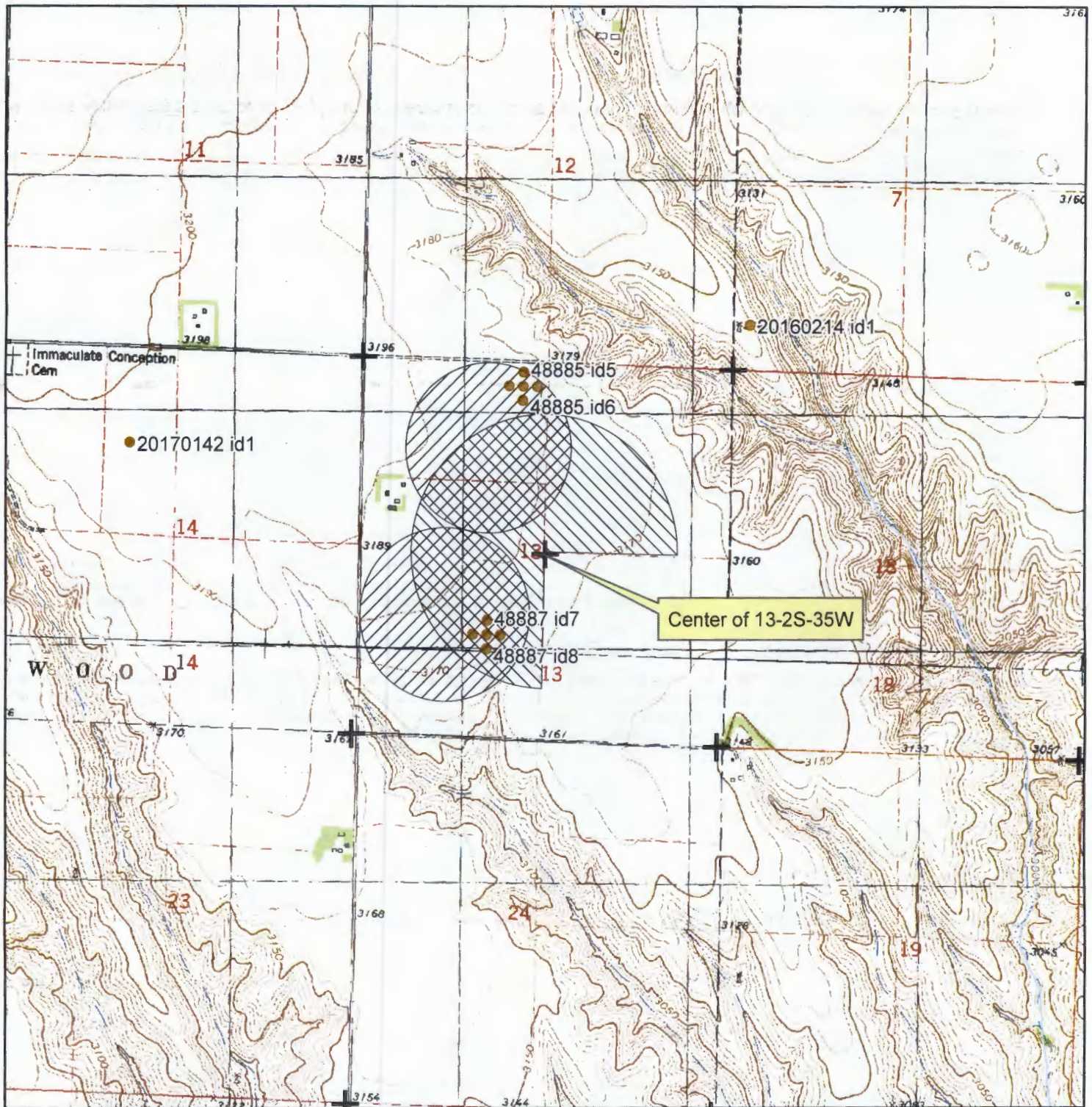

Authorized Place of Use

Proposed Place of Use

▲ Surface Water Point of Diversion

● Groundwater Point of Diversion

1:24,000



All wells within 1/2 mile of proposed well location are