

NOTICE

This scan only represents the application as filed. The information contained herein meets the requirements of K.A.R. 5-3-1 or K.A.R. 5-5-1, and has been found acceptable for filing in the office of the Chief Engineer. The application should not be considered to be a complete application as per K.A.R. 5-3-1b or K.A.R. 5-5-2a.

THE STATE OF KANSAS



KANSAS DEPARTMENT OF AGRICULTURE
Jackie McClaskey, Secretary of Agriculture

DIVISION OF WATER RESOURCES
David W. Barfield, Chief Engineer

File Number 49,841
This item to be completed by the Division of Water Resources.

WATER RESOURCES RECEIVED

APPLICATION FOR PERMIT TO APPROPRIATE WATER FOR BENEFICIAL USE
Filing Fee Must Accompany the Application
(Please refer to Fee Schedule attached to this application form.)

JUN 19 2017
10:39 am
KS DEPT OF AGRICULTURE

To the Chief Engineer of the Division of Water Resources, Kansas Department of Agriculture,
109 SW 9th Street, Second Floor, Topeka, KS 66612-1283:

1. Name of Applicant (Please Print): U.S.D. 271
Address: 201 N. Cypress
City: Stockton State KS. Zip Code 67669
Telephone Number: (785) 425-6039

2. The source of water is: [] surface water in (stream)
OR [x] groundwater in S.F. Solomon River (drainage basin)

Certain streams in Kansas have minimum target flows established by law or may be subject to administration when water is released from storage for use by water assurance district members. If your application is subject to these regulations on the date we receive your application, you will be sent the appropriate form to complete and return to the Division of Water Resources.

3. The maximum quantity of water desired is 5.00 acre-feet OR gallons per calendar year, to be diverted at a maximum rate of 95 gallons per minute OR cubic feet per second.

Once your application has been assigned a priority, the requested maximum rate of diversion and maximum requested quantity of water under that priority number can NOT be increased. Please be certain your requested maximum rate of diversion and maximum quantity of water are appropriate and reasonable for your proposed project and are in agreement with the Division of Water Resources' requirements.

4. The water is intended to be appropriated for (Check use intended):
(a) [] Artificial Recharge (b) [x] Irrigation (c) [] Recreational (d) [] Water Power
(e) [] Industrial (f) [] Municipal (g) [] Stockwatering (h) [] Sediment Control
(i) [] Domestic (j) [] Dewatering (k) [] Hydraulic Dredging (l) [] Fire Protection
(m) [] Thermal Exchange (n) [] Contamination Remediation

YOU MUST COMPLETE AND ATTACH ADDITIONAL DIVISION OF WATER RESOURCES FORM(S) PROVIDING INFORMATION TO SUBSTANTIATE YOUR REQUEST FOR THE AMOUNT OF WATER FOR THE INTENDED USE REFERENCED ABOVE.

For Office Use Only:
F.O. 3 GMD Meets K.A.R. 5-3-1 (YES/NO) Use IRR Source GYS County PO By AW Date 6/19/17
Code REG Fee \$ 100 TR # Receipt Date 6/19/17 Check # 41169

6/21/2017 LLM

New Application - Groundwater
Assisted by Division of Water Resources
Stockton Field Office

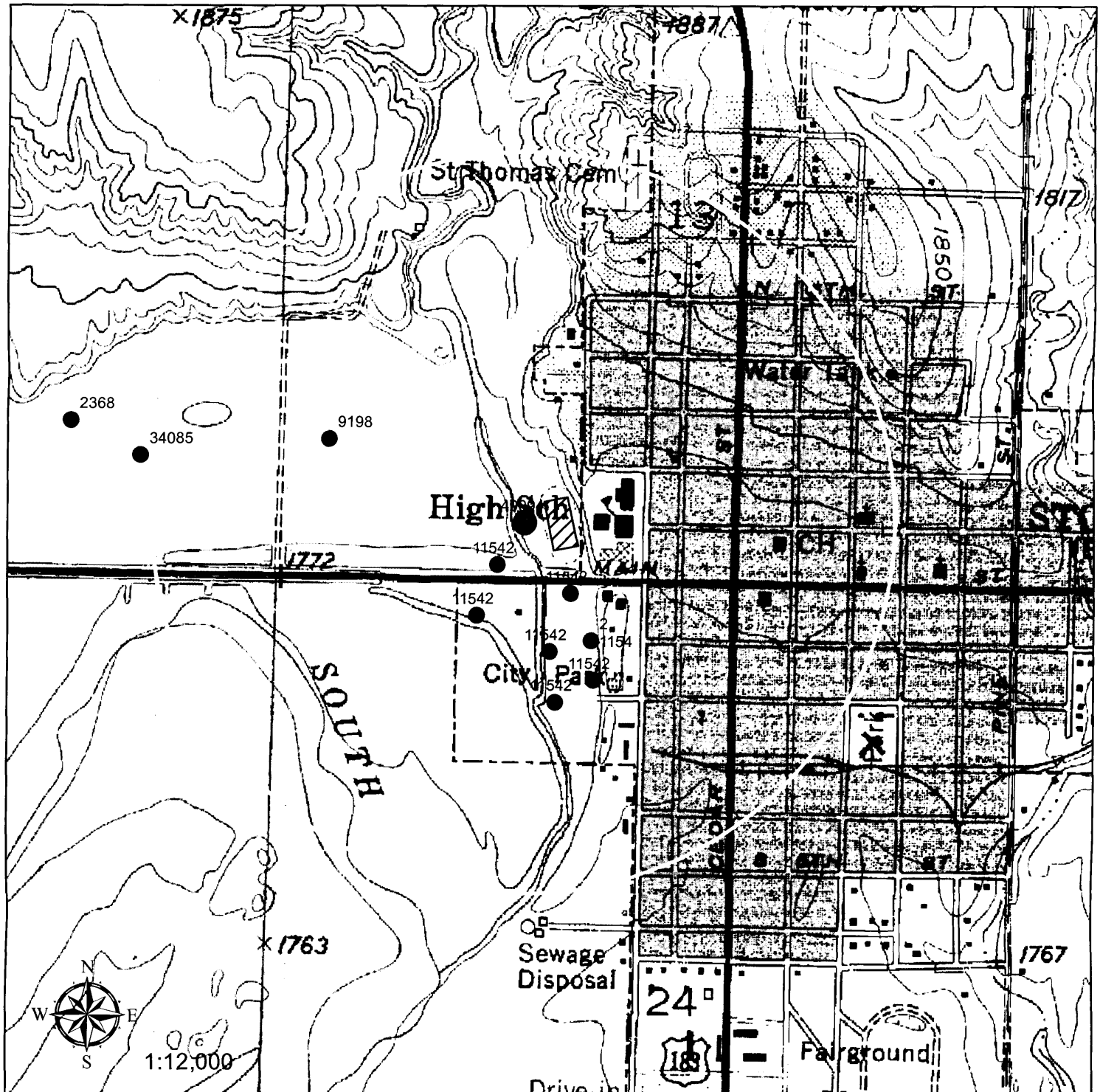

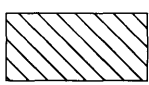
 Proposed Place of Use

● Proposed Point of Diversion

1/2 mile radius

▲ Surface Water Point of Diversion
● Groundwater Point of Diversion

Signature Required

Shelby Soyne
 By signing this I am stating that to the best of my knowledge that all wells within 1/2 mile of proposed well location are identified on this map.

IRRIGATION USE SUPPLEMENTAL SHEET

File No. 49,861

Name of Applicant (Please Print): USD 271

1. Please supply the name and address of each landowner, the legal description of the lands to be irrigated, and designate the actual number of acres to be irrigated in each forty acre tract or fractional portion thereof:

Landowner of Record NAME: U.S.D. 271

ADDRESS: 201 N. Cypress Stockton, Ks. 67669

S	T	R	NE¼				NW¼				SW¼				SE¼				TOTAL
			NE	NW	SW	SE	NE	NW	SW	SE	NE	NW	SW	SE	NE	NW	SW	SE	
13	7	18w																1.7	1.7

Landowner of Record NAME: _____

ADDRESS: _____

S	T	R	NE¼				NW¼				SW¼				SE¼				TOTAL
			NE	NW	SW	SE	NE	NW	SW	SE	NE	NW	SW	SE	NE	NW	SW	SE	

Landowner of Record NAME: _____

ADDRESS: _____

S	T	R	NE¼				NW¼				SW¼				SE¼				TOTAL
			NE	NW	SW	SE	NE	NW	SW	SE	NE	NW	SW	SE	NE	NW	SW	SE	

2. Please complete the following information for the description of the operation for the irrigation project. Attach supplemental sheets as needed.

a. Indicate the soils in the field(s) and their intake rates:

Soil Name	Percent of field (%)	Intake Rate (in/hr)	Irrigation Design Group
_____	_____	_____	_____
_____	_____	_____	_____
_____	_____	_____	_____
_____	_____	_____	_____
Total:	100 %		

b. Estimate the average land slope in the field(s): _____ %

Estimate the maximum land slope in the field(s): _____ %

c. Type of irrigation system you propose to use (check one):

- Center pivot Center pivot - LEPA "Big gun" sprinkler
 Gravity system (furrows) Gravity system (borders) Sideroll sprinkler

Other, please describe: _____

d. System design features:

i. Describe how you will control tailwater:

ii. For sprinkler systems:

(1) Estimate the operating pressure at the distribution system: _____ psi

(2) What is the sprinkler package design rate? _____ gpm

(3) What is the wetted diameter (twice the distance the sprinkler throws water) of a sprinkler on the outer 100 feet of the system? _____ feet

(4) Please include a copy of the sprinkler package design information.

e. Crop(s) you intend to irrigate. Please note any planned crop rotations: The proposed place of use is a football field planted to fescue which is why we are requesting a quantity greater than 1.4 FT/AC. Fescue grass requires a higher amount of water thus we are requesting a quantity of 3 FT/AC.

f. Please describe how you will determine when to irrigate and how much water to apply (particularly important if you do not plan a full irrigation).

VOLUNTARY WAIVER OF HEARING & DISMISSAL OF WATER RIGHT

To: Kansas Department of Agriculture
Division of Water Resources (DWR)
1320 Research Park Drive
Manhattan, Kansas 66502
<http://agriculture.ks.gov/dwr>

Re: Appropriation of Water
Water Right
Vested Right
Term Permit
(Check Appropriate Box Above)
File No. 49094

The undersigned owner(s) and/or authorized agent(s) of the above referenced water right, or permit, freely and voluntarily request that the file be dismissed and its priority forfeited. By signing this waiver, I am indicating my understanding and agreement that I am relinquishing all right, title and interest in said water right.

The signature(s) below represent all present owners (or an authorized agent) for the file number shown above (attach duplicate copies of this document as necessary).

The signature(s) below also indicate(s) a waiver of any right to a hearing or an appeal that I/we may have had regarding the dismissal and termination of the above referenced file. I/we recognize that if this closure request is submitted to the Division of Water Resources, it will terminate this water right and forfeit any priority associated with it forever.

Indicate here if you wish to retain the well(s) for domestic use (DWR water right not required):

The voluntary dismissal is contingent upon the approval of a new application

Shelly Swayne
(Signature of Owner or Authorized Agent)

(Signature of Spouse or Title of Authorized Agent)

Shelly Swayne - Superintendent
(Please print name here)

(Please print name here)

201 N. Cypress
(Mailing Address)

(Mailing Address)

Stockton, KS 67669
(City, State, Zip)

(City, State, Zip)

ACKNOWLEDGMENT

State of Kansas)
County of Booke)

This instrument was acknowledged before me this 15 day of JUNE, 2017 by
(owners:) SHELLY SWAYNE

(Seal)



Kelly C. Stewart
Notary Public

My appointment expires:
8/30/17

KLS/STKFO
DWR Initials

1320 Research Park Drive
Manhattan, Kansas 66502

Jackie McClaskey, Secretary



Phone: (785) 564-6700
Fax: (785) 564-6777
Email: ksag@kda.ks.gov
www.agriculture.ks.gov
Sam Brownback, Governor

June 20, 2017

FILE COPY

USD 271
201 N CYPRESS
STOCKON KS 67669

RE: Application
File No. 49861

Dear Sir or Madam:

Your application for permit to appropriate water in 13-7S-18W in Rooks County, was received and has been assigned the file number noted above.

As a matter of record, the Division of Water Resources has on hand a large number of applications awaiting processing. Therefore to be fair to all concerned, and so that we can process those applications on hand in the order they were received, we intend to concentrate on the backlog of applications until the issue is resolved. Once review of your application has begun, we will contact you, if additional information is required.

In accordance with the provisions of the Kansas Water Appropriation Act, a portion of which is included below, the use of water as proposed prior to approval of the application is unlawful. Once approved, compliance with the terms, conditions and limitations of the permit is necessary. Conservation of the water resources of Kansas is required.

Section 82a-728 of the Kansas Water Appropriation Act, provides (a) except for the appropriation of water for the purpose of domestic use, . . . it shall be unlawful for any person to appropriate or threaten to appropriate water from any source without first applying for and obtaining a permit to appropriate water in accordance with the provisions of the Water Appropriation Act or for any person to violate any condition of a vested right, appropriation right or an approved application for a permit to appropriate water for beneficial use.

(b) (1) The violation of any provision of this section by any person is a class C misdemeanor . . .

A class C misdemeanor is punishable by a fine not to exceed \$500 and/or a term of confinement not to exceed one month in the county jail. Each day that the violation occurs constitutes a separate offense.

If you have any questions, please contact me at (785) 564-6645. If you wish to discuss a specific file, please have the file number ready so that we may help you more efficiently.

Sincerely,

A handwritten signature in black ink that reads "Kristen A. Baum". The signature is written in a cursive style with a large, stylized "K" and "B".

Kristen A. Baum
New Applications Unit Supervisor
Water Appropriation Program

BAT: dlw
pc: STOCKTON Field Office
GMD