

# NOTICE

This scan only represents the application as filed. The information contained herein meets the requirements of K.A.R. 5-3-1 or K.A.R. 5-5-1, and has been found acceptable for filing in the office of the Chief Engineer. The application should not be considered to be a complete application as per K.A.R. 5-3-1b or K.A.R. 5-5-2a.

Submit To: CHIEF ENGINEER  
Division of Water Resources  
Kansas Department of Agriculture  
1320 Research Park Drive  
Manhattan, KS 66502  
[www.ksda.gov/dwr](http://www.ksda.gov/dwr)

**APPLICATION FOR APPROVAL TO  
CHANGE THE PLACE OF USE, THE  
POINT OF DIVERSION OR THE USE  
MADE OF THE WATER UNDER AN  
EXISTING WATER RIGHT**



State of Kansas

**Filing Fee Must Accompany the Application**  
(Please refer to Fee Schedule on signature page of application form.)

**Paragraph Nos. 1, 2, 3, 4 & 8 must be completed. Complete all other applicable portions.** A topographic map or detailed plat showing the authorized and proposed points(s) of diversion and /or place of use must accompany this application.

1. Application is hereby made for approval of the Chief Engineer to change the

- Place of Use  
(Check one or more)  Point of Diversion  
 Use Made of Water

Water Resources  
Received

JUL 02 2018

1:28

KS Dept Of Agriculture

File No. 31,036

RECEIVED  
10:30 AM  
JUN 29 2018  
Stockton Field Office  
Division of Water Resources

2. Name of applicant: Douglas Wayne Martin

Address: 10210 Polfer LN

City, State and Zip: Kansas City, MO 66109-4066

Phone Number: ( ) \_\_\_\_\_ E-mail address: \_\_\_\_\_

What is your relationship to the water right;  owner  tenant  agent  other? If other, please explain. \_\_\_\_\_

Name of water use correspondent: Douglas Wayne Martin

Address: 10210 Polfer LN

City, State and Zip: Kansas City, MO 66109-4066

Phone Number: ( ) \_\_\_\_\_ E-mail address: \_\_\_\_\_

3. The change(s) proposed herein are desired for the following reasons (please be specific): To completely overlap the place use between file nos. 12074, 15153, 15620, 19627, 23709, and 31036. File no. 242 will be voluntarily dismissed to allow for the approval of this overlap due to non-use issues. The industrial portion of this right will remain unchanged.

The change(s) (was) (will be) completed by 12/31/18.  
(Date)

For Office Use Only:	F.O. <u>3</u>	GMD <u>1</u>	Meets K.A.R. 5-5-1 (YES / NO) Use <u>IRR</u>	Source <u>G/S</u>	County <u>SD</u>	By <u>AW</u>	Date <u>7/2/18</u>
Code <u>CPU</u>	Fee \$ <u>200</u>	TR # _____	Receipt Date <u>7/2/18</u>	Check # <u>1529</u>			

7/5/18 DAW

4. The presently authorized place of use is:

Owner of Land — NAME: Douglas Wayne Martin

ADDRESS: 10210 Polfer LN Kansas City, MO 66109-4066

Sec.	Twp.	Range	NE¼				NW¼				SW¼				SE¼				TOTAL ACRES
			NE¼	NW¼	SW¼	SE¼	NE¼	NW¼	SW¼	SE¼	NE¼	NW¼	SW¼	SE¼	NE¼	NW¼	SW¼	SE¼	
32	10	26 W	21	39	15	25													100

List any other water rights that cover this place of use. 242, 12074

Owner of Land — NAME: \_\_\_\_\_

ADDRESS: \_\_\_\_\_

Sec.	Twp.	Range	NE¼				NW¼				SW¼				SE¼				TOTAL ACRES
			NE¼	NW¼	SW¼	SE¼	NE¼	NW¼	SW¼	SE¼	NE¼	NW¼	SW¼	SE¼	NE¼	NW¼	SW¼	SE¼	

List any other water rights that cover this place of use. \_\_\_\_\_

(If there are more than two landowners, attach additional sheets as necessary.)

5. It is proposed that the place of use be changed to:

Owner of Land — NAME: Douglas Wayne Martin

ADDRESS: 10210 Polfer LN Kansas City, MO 66109-4066

Sec.	Twp.	Range	NE¼				NW¼				SW¼				SE¼				TOTAL ACRES
			NE¼	NW¼	SW¼	SE¼	NE¼	NW¼	SW¼	SE¼	NE¼	NW¼	SW¼	SE¼	NE¼	NW¼	SW¼	SE¼	
32	10	26 W	21	39	15	25	30	19.3	29.1	16					40	40	40	40	354.4

List any other water rights that cover this place of use. 12074, 15153, 15620, 19627, 23709

Owner of Land — NAME: \_\_\_\_\_

ADDRESS: \_\_\_\_\_

Sec.	Twp.	Range	NE¼				NW¼				SW¼				SE¼				TOTAL ACRES
			NE¼	NW¼	SW¼	SE¼	NE¼	NW¼	SW¼	SE¼	NE¼	NW¼	SW¼	SE¼	NE¼	NW¼	SW¼	SE¼	

List any other water rights that cover this place of use. \_\_\_\_\_

JUL 02 2018

RECEIVED  
JUN 29 2018  
Stockton Field Office  
Division of Water Resources

Water Resources  
Received

6. The presently authorized point(s) of diversion is three (3) wells  
(Provide description and number of points)
7. The proposed point(s) of diversion (is) (are) no change requested.  
(Provide description and number of points)

**List all presently authorized point(s) of diversion:**

8. **Presently authorized point of diversion:**  
 One in the \_\_\_\_\_ Quarter of the \_\_\_\_\_ Quarter of the \_\_\_\_\_ Quarter  
 of Section \_\_\_\_\_, Township \_\_\_\_\_ South, Range \_\_\_\_\_ W,  
 in \_\_\_\_\_ County, Kansas, \_\_\_\_\_ feet North \_\_\_\_\_ feet West of Southeast corner of section.  
 Authorized Rate \_\_\_\_\_ Authorized Quantity \_\_\_\_\_  
**(DWR use only: Computer ID No. \_\_\_\_\_ GPS \_\_\_\_\_ feet North \_\_\_\_\_ feet West)**  
 This point will not be changed     This point will be changed as follows:  
**Proposed point of diversion: (Complete only if change is requested)**  
 One in the \_\_\_\_\_ Quarter of the \_\_\_\_\_ Quarter of the \_\_\_\_\_ Quarter  
 of Section \_\_\_\_\_, Township \_\_\_\_\_ South, Range \_\_\_\_\_ W,  
 in \_\_\_\_\_ County, Kansas, \_\_\_\_\_ feet North \_\_\_\_\_ feet West of Southeast corner of section.  
 Proposed Rate \_\_\_\_\_ Proposed Quantity \_\_\_\_\_  
 This point is:  Additional Well     Geo Center    List other water rights that will use this point \_\_\_\_\_

9. **Presently authorized point of diversion:**  
 One in the \_\_\_\_\_ Quarter of the \_\_\_\_\_ Quarter of the \_\_\_\_\_ Quarter  
 of Section \_\_\_\_\_, Township \_\_\_\_\_ South, Range \_\_\_\_\_ W,  
 in \_\_\_\_\_ County, Kansas, \_\_\_\_\_ feet North \_\_\_\_\_ feet West of Southeast corner of section.  
 Authorized Rate \_\_\_\_\_ Authorized Quantity \_\_\_\_\_  
**(DWR use only: Computer ID No. \_\_\_\_\_ GPS \_\_\_\_\_ feet North \_\_\_\_\_ feet West)**  
 This point will not be changed     This point will be changed as follows:  
**Proposed point of diversion: (Complete only if change is requested)**  
 One in the \_\_\_\_\_ Quarter of the \_\_\_\_\_ Quarter of the \_\_\_\_\_ Quarter  
 of Section \_\_\_\_\_, Township \_\_\_\_\_ South, Range \_\_\_\_\_ W,  
 in \_\_\_\_\_ County, Kansas, \_\_\_\_\_ feet North \_\_\_\_\_ feet West of Southeast corner of section.  
 Proposed Rate \_\_\_\_\_ Proposed Quantity \_\_\_\_\_  
 This point is:  Additional Well     Geo Center    List other water rights that will use this point \_\_\_\_\_

10. **Presently authorized point of diversion:**  
 One in the \_\_\_\_\_ Quarter of the \_\_\_\_\_ Quarter of the \_\_\_\_\_ Quarter  
 of Section \_\_\_\_\_, Township \_\_\_\_\_ South, Range \_\_\_\_\_ W,  
 in \_\_\_\_\_ County, Kansas, \_\_\_\_\_ feet North \_\_\_\_\_ feet West of Southeast corner of section.  
 Authorized Rate \_\_\_\_\_ Authorized Quantity \_\_\_\_\_  
**(DWR use only: Computer ID No. \_\_\_\_\_ GPS \_\_\_\_\_ feet North \_\_\_\_\_ feet West)**  
 This point will not be changed     This point will be changed as follows:  
**Proposed point of diversion: (Complete only if change is requested)**  
 One in the \_\_\_\_\_ Quarter of the \_\_\_\_\_ Quarter of the \_\_\_\_\_ Quarter  
 of Section \_\_\_\_\_, Township \_\_\_\_\_ South, Range \_\_\_\_\_ W,  
 in \_\_\_\_\_ County, Kansas, \_\_\_\_\_ feet North \_\_\_\_\_ feet West of Southeast corner of section.  
 Proposed Rate \_\_\_\_\_ Proposed Quantity \_\_\_\_\_  
 This point is:  Additional Well     Geo Center    List other water rights that will use this point \_\_\_\_\_

11. Describe the current condition of and future plans for any point(s) of diversion which will no longer be used. \_\_\_\_\_

**IF MORE SPACE IS NEEDED, ATTACH ADDITIONAL SHEETS AS NECESSARY**

12. The presently authorized use of water is for irrigation/industrial purposes.  
It is proposed that the use be changed to no change requested purposes.

13. If changing the place of use and/or use made of water, describe how the consumptive use will not be increased.  
The consumptive use will not be increased because we are creating a complete overlap between the water rights involved.

RECEIVED

JUN 29 2018

Stockton Field Office  
Division of Water Resources

(Please show any calculations here.)

14. It is requested that the maximum annual quantity of water be reduced to n/a (acre-feet or million gallons).

15. It is requested that the maximum rate of diversion of water be reduced to n/a gallons per minute (C.F.S.).

16. The application must include either a topographic map or detailed plat. A U.S. Geological Survey Topographic Map, scale 1:24,000, is available through the Kansas Geological Survey, 1930 Constant Avenue, University of Kansas, Lawrence, Kansas 66047-3726 ([www.usgs.gov](http://www.usgs.gov)). The map should show the location of the presently authorized point(s) of diversion. Distances North and West of the Southeast corner of the section must be shown. The presently authorized place of use should also be shown. Identify the center of the section, the section lines and the section corners and show the appropriate section, township, and range numbers on the map. In addition the following information must also be shown on the map.

- a. If a change in the location of the point(s) of diversion is proposed, show:
  - 1) The location of the proposed point(s) of diversion. Distances North and West of the Southeast corner of the section must be shown. Please be certain that the information shown on the map agrees with the information shown in Paragraph Nos. 9, 10 and 11 of the application.
  - 2) If the source of supply is groundwater, please show the location of existing water wells of any kind, including domestic wells, within 1/2 mile of the proposed well or wells. Identify each well as to its use and furnish name and mailing address of the property owner or owners. If there are no wells within 1/2 mile, please indicate so on the map.
  - 3) If the source of supply is surface water, the names and mailing addresses of all landowner(s) 1/2 mile downstream and 1/2 mile upstream from your property lines must be shown.
- b. If a change in the place of use is desired, show the proposed place of use by crosshatching on the map. Please be certain that the information shown on the map agrees with the information shown in Paragraph No. 5 of the application.

17. Attach documentation to show the change(s) proposed herein will not impair existing water rights and relates to the same local source of supply as to which the water right relates. This information may include statements, plats, geology reports, well logs, test hole logs, and other information as necessary information to show the above. Additional comments may be made below.

No change to source of supply; no impairment will occur.

18. If the proposed change(s) does not meet all applicable rules and regulations of the Kansas Water Appropriation Act, please identify the rules and regulations for which you request a waiver. State the reason why a waiver is needed and why the request should be granted. Attach documentation showing that granting the request will not impair existing water rights and will not prejudicially and unreasonably affect the public interest.

All regs met.

**IF MORE SPACE IS NEEDED, ATTACH ADDITIONAL SHEETS AS NECESSARY**

**JUL 02 2018**

Any use of water that is not as authorized by the water right or permit to authorize water **before** the chief engineer approves this application is a violation of the Kansas Water Appropriation Act for which criminal or civil penalties may be assessed. Such violation is a class C misdemeanor, punishable by a fine not to exceed \$500 and/or a term of confinement not to exceed one month in the county jail. K.S.A. 82a-728(b). Civil penalties shall be not less than \$100 nor more than \$1,000 per violation. In the case of a continuing violation, each day such violation continues may be deemed a separate violation. In addition to these penalties the water right may be modified or suspended. K.S.A. 82a-737, as amended.

**The application must be signed by all owners of the place of use authorized under the water right and his or her spouse, if married. Please indicate if there is no spouse.** If land is being purchased under contract, the seller must sign as landowner until such time as the contract is completed.

In the event that all applicants cannot appear before one notary public, they may as necessary sign separate copies of the application before any notary public conveniently available to them. All copies signed in this manner shall be considered to be valid parts of the application.

If the request is signed on behalf of any Owner by someone with legal authority to do so (for example, an agent, one who has power of attorney, or an executor, executrix, conservator), it will be necessary to attach proper documents showing such authority.

I declare that I am an owner of the currently authorized place of use as identified herein, or that I represent all such owners and am authorized to make this application on their behalf, and declare further that the statements contained herein are true, correct, and complete. By filing this application I authorize the chief engineer to permanently reduce the quantity of water and/or rate of diversion as specified in sections 14 and 15 of this application.

Dated at SLAWNAC, Kansas, this 26<sup>th</sup> day of June, 2018.

<u>Douglas Martin</u> (Owner)	_____	(Spouse)
<u>Douglas Martin</u> (Please Print)	_____	(Please Print)
_____	_____	(Spouse)
_____	_____	(Please Print)
_____	_____	(Spouse)
_____	_____	(Please Print)

State of Kansas )  
County of Jhwsa ) SS

I hereby certify that the foregoing application was signed in my presence and sworn to before me this 26<sup>th</sup> day of June, 2018.

[Signature]  
Notary Public

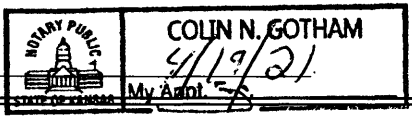
My Commission Expires \_\_\_\_\_  

**FEE SCHEDULE**

Each application to change the place of use, the point of diversion or the use made of the water under this section shall be accompanied by the application fee set forth in the schedule below:

- (1) Application to change a point of diversion 300 feet or less . . . . . \$100
- (2) Application to change a point of diversion more than 300 feet . . . . . \$200
- (3) Application to change the place of use . . . . . \$200
- (4) Application to change the use made of the water . . . . . \$300

Make check payable to **Kansas Department of Agriculture.**

# Application to Change the Place of Use

## Water Right File No. 31,036

**RECEIVED**

JUL 29 2018

Stockton Field Office  
Division of Water Resources

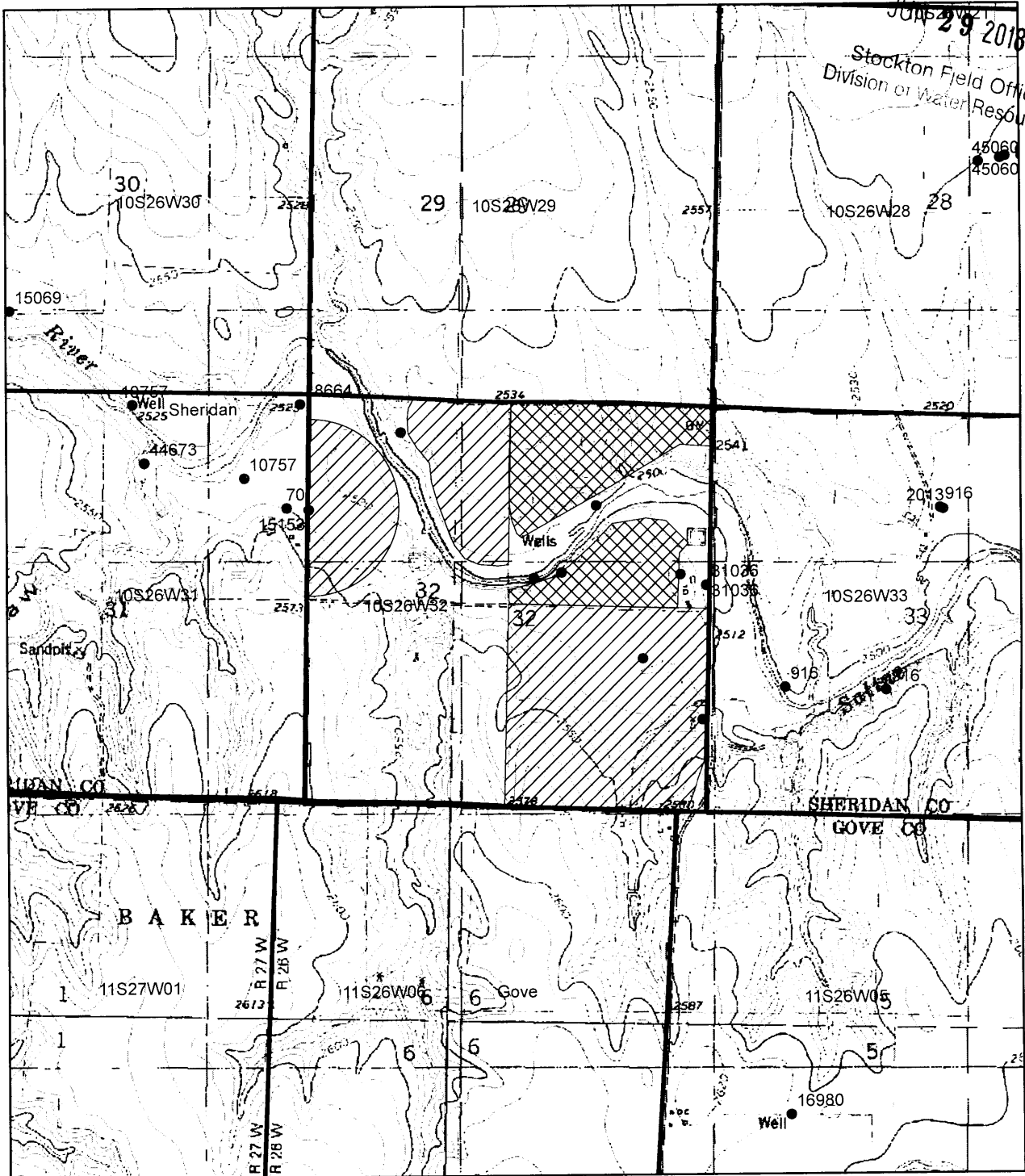

Currently Authorized Place of Use

Proposed Place of Use

Water Resources  
Received



1:24,000

Signature \_\_\_\_\_

Date **JUL 02 2018**

KS Dept Of Agriculture

STATE OF KANSAS

DEPARTMENT OF AGRICULTURE  
DIVISION OF WATER RESOURCES  
STOCKTON FIELD OFFICE  
820 S. WALNUT  
STOCKTON, KS 67669-0192



PHONE: (785) 425-6787  
FAX: (785) 425-6842  
www.agriculture.ks.gov

GOVERNOR JEFF COLYER, M.D.  
JACKIE McCLASKEY, SECRETARY OF AGRICULTURE

June 7, 2018

DOUGLAS WAYNE MARTIN  
10210 POLFER LN  
KANSAS CITY MO 66109-4066

Re: Water Right, File Nos. 242, 12074, 15153, 15620, 19627, 23709, & 31036

Dear Mr. Martin:

After discussions between our office and your tenant, Kevin Broeckelman, it was determined that changes in place of use are needed to completely overlap all of the acres collectively covered by the above referenced water rights.

I have completed all of changes for you, however, your notarized signature (and your spouse, if applicable) are required on the back of each application.

In addition, there is a voluntary dismissal form for file no. 242 that must be signed, notarized, and returned with the change applications. This file has a long history of non-use and is likely to be deemed abandoned. We cannot approve the proposed changes unless you agree to dismiss file no. 242 due to its non-use issues.

Once you have reviewed and completed the paperwork, please return all the applications, maps, and the voluntary dismissal form to the Manhattan address shown on the top left corner of each application. Please be sure to include a check for the application processing fees in the amount of \$1,200.00 (\$200 per application). The check should be payable to the Kansas Department of Agriculture.

If you have any questions, please feel free to contact me at this office.

Sincerely,

David L. Means  
Environmental Scientist

DLM  
pc: GMD4

Water Resources  
Received

JUL 02 2018

KS Dept Of Agriculture

RECEIVED

JUN 29 2018

Stockton Field Office  
Division of Water Resources



**VOLUNTARY WAIVER OF HEARING & DISMISSAL OF WATER RIGHT**

To: Kansas Department of Agriculture  
 Division of Water Resources (DWR)  
 1320 Research Park Drive  
 Manhattan, Kansas 66502  
<http://agriculture.ks.gov/dwr>

Re: Appropriation of Water   
 Water Right   
 Vested Right   
 Term Permit   
(Check Appropriate Box Above)  
 File No. 242

The undersigned owner(s) and/or authorized agent(s) of the above referenced water right, or permit, freely and voluntarily request that the file be dismissed and its priority forfeited. By signing this waiver, I am indicating my understanding and agreement that I am relinquishing all right, title and interest in said water right.

The signature(s) below represent all present owners (or an authorized agent) for the file number shown above (attach duplicate copies of this document as necessary).

The signature(s) below also indicate(s) a waiver of any right to a hearing or an appeal that I/we may have had regarding the dismissal and termination of the above referenced file. I/we recognize that if this closure request is submitted to the Division of Water Resources, it will terminate this water right and forfeit any priority associated with it forever.

Indicate here if you wish to retain the well(s) for domestic use (DWR water right not required):

Douglas Martin  
 (Signature of Owner or Authorized Agent)  
Douglas Martin  
 (Please print name here)  
 \_\_\_\_\_  
 (Mailing Address)  
 \_\_\_\_\_  
 (City, State, Zip)

\_\_\_\_\_  
 (Signature of Spouse or Title of Authorized Agent)  
 \_\_\_\_\_  
 (Please print name here)  
 \_\_\_\_\_  
 (Mailing Address)  
 \_\_\_\_\_  
 (City, State, Zip)

RECEIVED

JUN 29 2018

Stockton Field Office  
 Division of Water Resources

**ACKNOWLEDGMENT**

State of Kansas )  
 County of Johnson )

This instrument was acknowledged before me this 26 day of June, 2018 by  
 (owners:) Douglas Martin  
 (Seal)

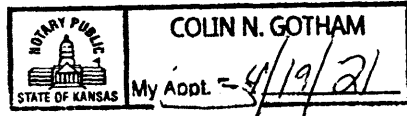

[Signature]  
 Notary Public

My appointment expires:

Water Resources  
 Received

DLM-STKFO  
 DWR Initials

**JUL 02 2018**

Kansas Department of Agriculture / Division of Water Resources  
Stockton Field Office

TO: HEADQUARTERS

RE  Vested Right;  Water Right;  Appropriation of Water;  Application

File No(s). 242, 12074, 15153, 15620, 19627 County SD

Enclosed are the following checked items: 23709, 31036

A  FIR  Full  Partial Inspection  Return to Field Office  
 Proposed Certificate to deliver to Certificate Unit

Meter Order:  GMD#4  
 Lower Smoky  
 Other \_\_\_\_\_

A Compliance Check Inspection on \_\_\_\_\_  
 Meter Install  New App  Chg App  Other \_\_\_\_\_  
 In Compliance  Not in Compliance, why \_\_\_\_\_

Modify Point of Diversion  No  Yes, document attached

Indicate all overlapping p/d files \_\_\_\_\_

An application and judgment sheet with recommendation.

A memorandum dated \_\_\_\_\_

A request for an extension of time to perfect or complete.

A verified report.

A closure request. #242

A field investigation report-

Notice of Non-Compliance \_\_\_\_\_

Water Resources  
Received

JUL 02 2018

KS Dept-Of Agriculture

Violation

Date

An ownership change (name(s) and address(es) below).

A water use report for \_\_\_\_\_

A letter dated 6-7-18

A copy of an Approval to Change the  place of use and/or  point of diversion,  
 Filing Fee attached.

An Advanced copy of a change application and the filing fee, to be processed at the field office.

An original ~~copy~~ ~~change~~ application and the filing fee needing headquarters office review and further processing.

Other: \_\_\_\_\_

  
Water Commissioner

6-29-18  
Date

# STATE OF KANSAS

DEPARTMENT OF AGRICULTURE  
1320 RESEARCH PARK DRIVE  
MANHATTAN, KS 66502  
PHONE: (785) 564-6700  
FAX: (785) 564-6777

900 SW JACKSON, ROOM 456  
TOPEKA, KS 66612  
PHONE: (785) 296-3556  
www.agriculture.ks.gov



GOVERNOR JEFF COLYER, M.D.  
JACKIE McCLASKEY, SECRETARY OF AGRICULTURE

DOUGLAS WAYNE MARTIN  
10210 POLFER LN  
KANSAS CITY, MO 66109

July 3, 2018

RE: File No 31036

Dear Sir or Madam:

An application for approval of the Chief Engineer to change the following condition or conditions of the file number referred to above has been received:

- place of use            PU  
 point of diversion  
 use made of water

As a matter of record, the Division of Water Resources has on hand a large number of applications awaiting processing. Therefore, to be fair to all concerned, and so that we can process those applications on hand in the order they were received, we intend to concentrate on the backlog of applications until the issue is resolved. You will be contacted regarding this application as soon as it has been examined.

In accordance with the provisions of the Kansas Water Appropriation Act, a portion of which is included below, the use of water prior to approval of the application is unlawful. You should not proceed and divert water as indicated by your plans in your application for a change for this file until you receive approval for this change from the Chief Engineer. Once approved, compliance with the terms, conditions and limitations of the permit is necessary. Conservation of the water resources of Kansas is required.

**Section 82a-728 of the Kansas Water Appropriation Act, provides (a) except for the appropriation of water for the purpose of domestic use, . . . it shall be unlawful for any person to appropriate or threaten to appropriate water from any source without first applying for and obtaining a permit to appropriate water in accordance with the provisions of the Water Appropriation Act or for any person to violate any condition of a vested right, appropriation right or an approved application for a permit to appropriate water for beneficial use.**

**(b) (1) The violation of any provision of this section by any person is a class C misdemeanor...**

**A class C misdemeanor is punishable by a fine not to exceed \$500 and/or a term of confinement not to exceed one month in the county jail. Each day that the violation occurs constitutes a separate offense.**

If you have any questions, please contact me at (785) 564-6645. If you wish to discuss a specific file, please have the file number ready so that we may help you more efficiently.

Sincerely,

Brent Tourney, L.G.  
Change Applications Unit Supervisor  
Water Appropriation Program

BAT: DLW  
pc: STOCKTON Field Office    GMD4