

NOTICE

This scan only represents the application as filed. The information contained herein meets the requirements of K.A.R. 5-3-1 or K.A.R. 5-5-1, and has been found acceptable for filing in the office of the Chief Engineer. The application should not be considered to be a complete application as per K.A.R. 5-3-1b or K.A.R. 5-5-2a.

Submit To: CHIEF ENGINEER
Division of Water Resources
Kansas Department of Agriculture
1320 Research Park Drive
Manhattan, KS 66502
www.ksda.gov/dwr

**APPLICATION FOR APPROVAL TO
CHANGE THE PLACE OF USE, THE
POINT OF DIVERSION OR THE USE
MADE OF THE WATER UNDER AN
EXISTING WATER RIGHT**



State of Kansas

Filing Fee Must Accompany the Application
(Please refer to Fee Schedule on signature page of application form.)

Paragraph Nos. 1, 2, 3, 4 & 8 must be completed. Complete all other applicable portions. A topographic map or detailed plat showing the authorized and proposed points(s) of diversion and /or place of use must accompany this application.

1. Application is hereby made for approval of the Chief Engineer to change the

- Place of Use
(Check one or more) Point of Diversion
 Use Made of Water

WATER RESOURCES
RECEIVED

JAN 08 2018
11:13
KS DEPT OF AGRICULTURE

File No. 47,657

2. Name of applicant: GALE A & MARY WALZ

Address: 445 RS 877

City, State and Zip: SAINT FRANCIS KS 67756

Phone Number: (785)332-2012 E-mail address: _____

What is your relationship to the water right; owner tenant agent other? If other, please explain. _____

Name of water use correspondent: SAME AS ABOVE

Address: _____

City, State and Zip: _____

Phone Number: () _____ E-mail address: _____

3. The change(s) proposed herein are desired for the following reasons (please be specific): PROPOSED EXPANSION OF THE EXISTING PIT WITH A NEW APPLICATION

The change(s) WILL BE completed by 12/2020 (Date)

For Office Use Only:					
F.O. <u>3</u>	GMD <u>4</u>	Meets K.A.R. 5-5-1 (YES/NO) <u>(YES)</u>	Use <u>IND</u>	Source <u>G/S</u> County <u>CN</u>	By <u>AW</u> Date <u>1/8/18</u>
Code <u>CA</u>	Fee \$ <u>200</u>	TR # _____	Receipt Date <u>1/8/18</u>	Check # <u>1005</u>	

1/12/2018 AW

4. The presently authorized place of use is:

Owner of Land — NAME: GALE A & MARY WALZ

ADDRESS: 445 RS 877 SAINT FRANCIS, KS 67756

Sec.	Twp.	Range	NE¼				NW¼				SW¼				SE¼				TOTAL ACRES
			NE¼	NW¼	SW¼	SE¼	NE¼	NW¼	SW¼	SE¼	NE¼	NW¼	SW¼	SE¼	NE¼	NW¼	SW¼	SE¼	
20	04S	41W	6.0 ACRE PIT																

List any other water rights that cover this place of use. _____

Owner of Land — NAME: _____

ADDRESS: _____

Sec.	Twp.	Range	NE¼				NW¼				SW¼				SE¼				TOTAL ACRES
			NE¼	NW¼	SW¼	SE¼	NE¼	NW¼	SW¼	SE¼	NE¼	NW¼	SW¼	SE¼	NE¼	NW¼	SW¼	SE¼	

List any other water rights that cover this place of use. 45,185

(If there are more than two landowners, attach additional sheets as necessary.)

5. It is proposed that the place of use be changed to:

Owner of Land — NAME: GALE A & MARY WALZ

ADDRESS: 445 RS 877 SAINT FRANCIS, KS 67756

Sec.	Twp.	Range	NE¼				NW¼				SW¼				SE¼				TOTAL ACRES
			NE¼	NW¼	SW¼	SE¼	NE¼	NW¼	SW¼	SE¼	NE¼	NW¼	SW¼	SE¼	NE¼	NW¼	SW¼	SE¼	
20	04S	41W	7.5 ACRE PIT																

List any other water rights that cover this place of use. _____

Owner of Land — NAME: _____

ADDRESS: _____

Sec.	Twp.	Range	NE¼				NW¼				SW¼				SE¼				TOTAL ACRES
			NE¼	NW¼	SW¼	SE¼	NE¼	NW¼	SW¼	SE¼	NE¼	NW¼	SW¼	SE¼	NE¼	NW¼	SW¼	SE¼	

WATER RESOURCES RECEIVED

List any other water rights that cover this place of use. 45,185 AND NEW APPLICATION

JAN 08 2018

6. The presently authorized point(s) of diversion is A GROUNDWATER PIT
(Provide description and number of points)

7. The proposed point(s) of diversion is A GROUNDWATER PIT
(Provide description and number of points)

List all presently authorized point(s) of diversion:

8. **Presently authorized point of diversion:**
 One in the NW Quarter of the NE Quarter of the NE Quarter of Section 20, Township 04 South, Range 41 W, in CHEYENNE County, Kansas, 4879 feet North 864 feet West of Southeast corner of section.
 Authorized Rate 0 Authorized Quantity 4.008 MGY
 (DWR use only: Computer ID No. _____ GPS _____ feet North _____ feet West)
 This point will not be changed This point will be changed as follows:
Proposed point of diversion: (Complete only if change is requested)
 One in the _____ Quarter of the _____ Quarter of the _____ Quarter of Section _____, Township _____ South, Range _____ W, in _____ County, Kansas, _____ feet North _____ feet West of Southeast corner of section.
 Proposed Rate _____ Proposed Quantity _____
 This point is: Additional Well Geo Center List other water rights that will use this point _____

9. **Presently authorized point of diversion:**
 One in the _____ Quarter of the _____ Quarter of the _____ Quarter of Section _____, Township _____ South, Range _____ W, in _____ County, Kansas, _____ feet North _____ feet West of Southeast corner of section.
 Authorized Rate _____ Authorized Quantity _____
 (DWR use only: Computer ID No. _____ GPS _____ feet North _____ feet West)
 This point will not be changed This point will be changed as follows:
Proposed point of diversion: (Complete only if change is requested)
 One in the _____ Quarter of the _____ Quarter of the _____ Quarter of Section _____, Township _____ South, Range _____ W, in _____ County, Kansas, _____ feet North _____ feet West of Southeast corner of section.
 Proposed Rate _____ Proposed Quantity _____
 This point is: Additional Well Geo Center List other water rights that will use this point _____

10. **Presently authorized point of diversion:**
 One in the _____ Quarter of the _____ Quarter of the _____ Quarter of Section _____, Township _____ South, Range _____ W, in _____ County, Kansas, _____ feet North _____ feet West of Southeast corner of section.
 Authorized Rate _____ Authorized Quantity _____
 (DWR use only: Computer ID No. _____ GPS _____ feet North _____ feet West)
 This point will not be changed This point will be changed as follows:
Proposed point of diversion: (Complete only if change is requested)
 One in the _____ Quarter of the _____ Quarter of the _____ Quarter of Section _____, Township _____ South, Range _____ W, in _____ County, Kansas, _____ feet North _____ feet West of Southeast corner of section.
 Proposed Rate _____ Proposed Quantity _____
 This point is: Additional Well Geo Center List other water rights that will use this point _____

11. Describe the current condition of and future plans for any point(s) of diversion which will no longer be used. _____

IF MORE SPACE IS NEEDED, ATTACH ADDITIONAL SHEETS AS NECESSARY
 WATER RESOURCES RECEIVED
 JAN 08 2018

Any use of water that is not as authorized by the water right or permit to authorize water **before** the chief engineer approves this application is a violation of the Kansas Water Appropriation Act for which criminal or civil penalties may be assessed. Such violation is a class C misdemeanor, punishable by a fine not to exceed \$500 and/or a term of confinement not to exceed one month in the county jail. K.S.A. 82a-728(b). Civil penalties shall be not less than \$100 nor more than \$1,000 per violation. In the case of a continuing violation, each day such violation continues may be deemed a separate violation. In addition to these penalties the water right may be modified or suspended. K.S.A. 82a-737, as amended.

The application must be signed by all owners of the place of use authorized under the water right and his or her spouse, if married. Please indicate if there is no spouse. If land is being purchased under contract, the seller must sign as landowner until such time as the contract is completed.

In the event that all applicants cannot appear before one notary public, they may as necessary sign separate copies of the application before any notary public conveniently available to them. All copies signed in this manner shall be considered to be valid parts of the application.

If the request is signed on behalf of any Owner by someone with legal authority to do so (for example, an agent, one who has power of attorney, or an executor, executrix, conservator), it will be necessary to attach proper documents showing such authority.

I declare that I am an owner of the currently authorized place of use as identified herein, or that I represent all such owners and am authorized to make this application on their behalf, and declare further that the statements contained herein are true, correct, and complete. By filing this application I authorize the chief engineer to permanently reduce the quantity of water and/or rate of diversion as specified in sections 14 and 15 of this application.

Dated at St Francis, Kansas, this 3 day of January, 20 18.

Gale A. Walz
(Owner)

GALE WALZ
(Please Print)

(Owner)

(Please Print)

(Owner)

(Please Print)

Mary C. Walz
(Spouse)

MARY C. WALZ
(Please Print)

(Spouse)

(Please Print)

(Spouse)

(Please Print)

State of Kansas }
County of Cheyenne } SS

I hereby certify that the foregoing application was signed in my presence and sworn to before me this 3 day of January, 20 18.

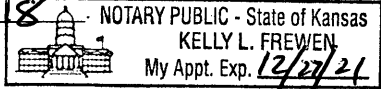

Kelly L. Frewen
Notary Public

My Commission Expires 12/27/2021.

FEE SCHEDULE

Each application to change the place of use, the point of diversion or the use made of the water under this section shall be accompanied by the application fee set forth in the schedule below:

- (1) Application to change a point of diversion 300 feet or less \$100
- (2) Application to change a point of diversion more than 300 feet \$200
- (3) Application to change the place of use \$200
- (4) Application to change the use made of the water \$300

Make check payable to **Kansas Department of Agriculture.**

**WATER RESOURCES
RECEIVED**

JAN 08 2018

Application to Change the Place of Use
 For Water Right File # 45,185 & 47,657

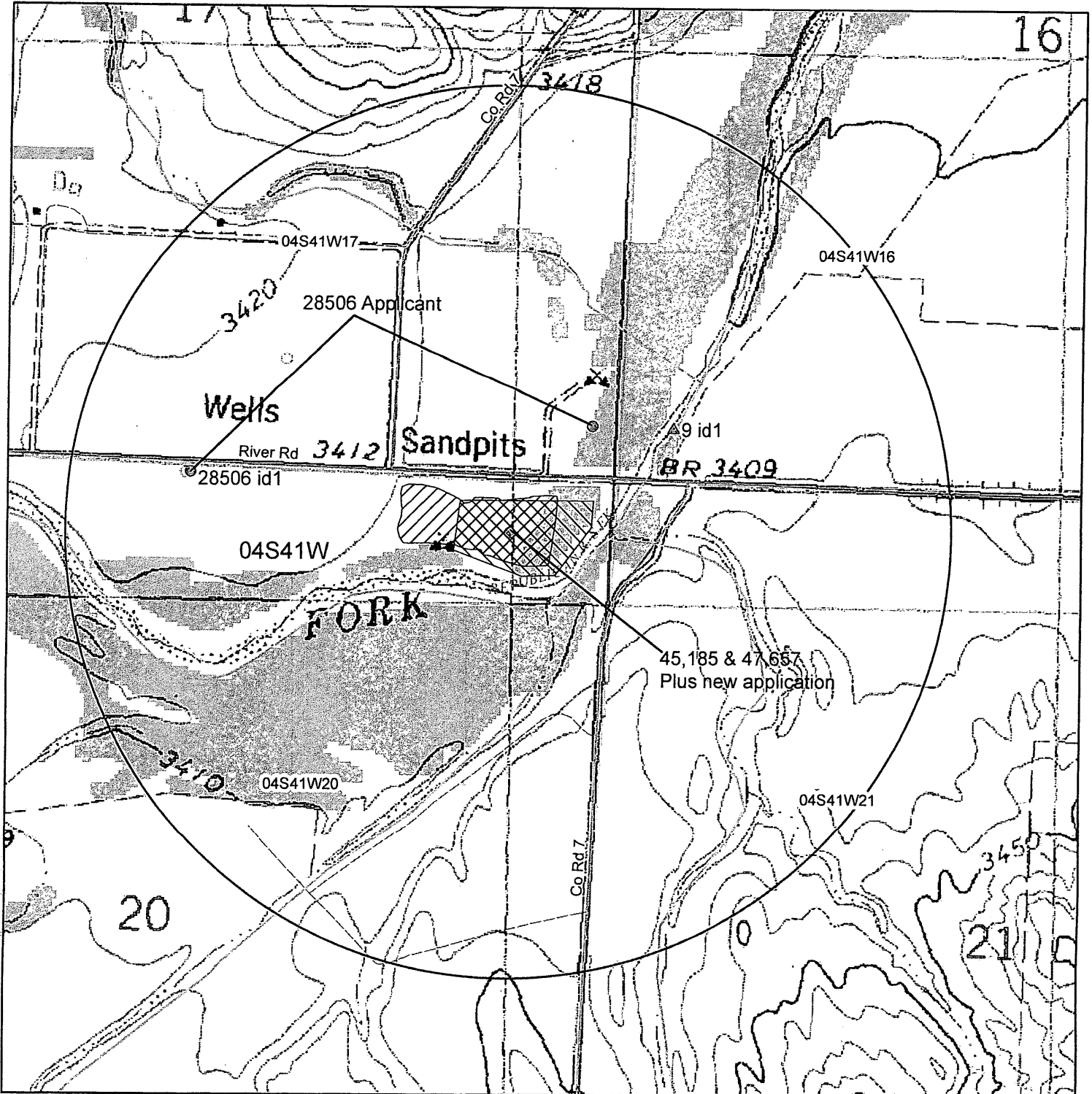

Authorized Place of Use



Proposed Place of Use

▲ Surface Water Point of Diversion

● Groundwater Point of Diversion

1:10,000

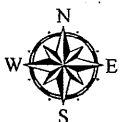

WATER RESOURCES
 RECEIVED

JAN 08 2018

KS DEPT OF AGRICULTURE

THE STATE OF KANSAS



KANSAS DEPARTMENT OF AGRICULTURE
Jackie McClaskie, Secretary of Agriculture

DIVISION OF WATER RESOURCES
David W. Barfield, Chief Engineer

NOTICE OF INTENT TO OPEN OR EXPAND A
SAND AND GRAVEL PIT OPERATION

(In accordance with K.S.A. 82s-734(c), K.A.R. 5-13-1, and amendments thereto)

File No. _____ (Office Use Only)

WATER RESOURCES
RECEIVED

1. Operator Name (Please Print) GALE A & MARY WALZ

JAN 08 2018

Address 445 RS 877

KS DEPT OF AGRICULTURE

SAINT FRANCIS, KS 67756

Telephone (785)332-2012

2. Please designate the legal description of the pit. 7.5 acres in the NE $\frac{1}{4}$ of the NE $\frac{1}{4}$ of the NE $\frac{1}{4}$ of Section 20, Township 04 South, Range 41 West, CHEYENNE County, Kansas.
3. Outline on an aerial photograph or topographical map the current and FINAL outline of the proposed pit, and attach it to the Notice of Intent. The photograph or map shall indicate the legal description of the location of the proposed pit and the scale of the map or photograph.
4. What year did, or will, the excavation of the pit begin? 12/31/03
5. Indicate the proposed final size of the pit in acres. 7.5 acres.
6. Estimate the year the pit will be completed? 12/31/20
7. By what method will the pit be excavated?
Hydraulic _____ Mechanical _____ Other _____
8. Will you have any other diversions of water at the pit site besides hydraulic dredging, such as pumpsites or wells? Yes _____ No x. If yes, please specify the type of diversion and use to be made of the water. _____
9. Attach a copy of the Reclamation Plan you have on file with the State Conservation Commission.

Proposed Expansion of Existing Sand and Gravel Pit
 Project: 47,657, 45,185 & New Application
 Gale Walz

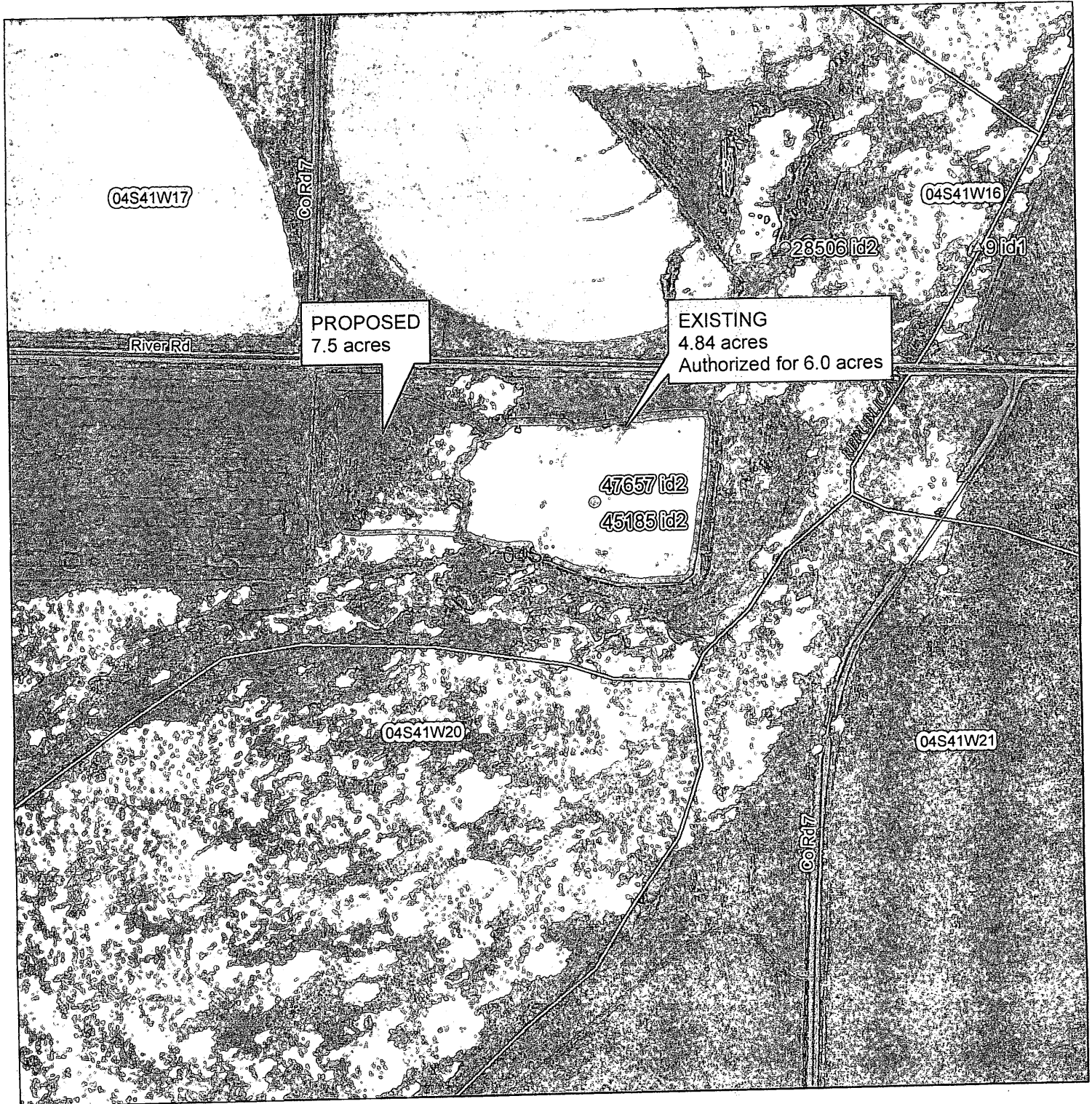

PROPOSED
7.5 acres

EXISTING
4.84 acres
Authorized for 6.0 acres

47657 Id2
45185 Id2

04S

04S41W20

04S41W21

04S41W17

04S41W16

River Rd

Co Rd 17

Co Rd 17

19th Rd

▲ Surface Water Point of Diversion

● Groundwater Point of Diversion

1:4,191



WATER RESOURCES
RECEIVED

JAN 08 2018

KS DEPT OF AGRICULTURE

1320 Research Park Drive
Manhattan, Kansas 66502
(785) 564-6700



900 SW Jackson, Room 456
Topeka, Kansas 66612
(785) 296-3556

Jackie McClaskey, Secretary

Governor Sam Brownback

GALE A & MARY WALZ

January 11, 2018

445 RS 877
SAINT FRANCIS, KS 67756

RE: File No 47657

Dear Sir or Madam:

An application for approval of the Chief Engineer to change the following condition or conditions of the file number referred to above has been received:

- place of use PU
- point of diversion
- use made of water

As a matter of record, the Division of Water Resources has on hand a large number of applications awaiting processing. Therefore, to be fair to all concerned, and so that we can process those applications on hand in the order they were received, we intend to concentrate on the backlog of applications until the issue is resolved. You will be contacted regarding this application as soon as it has been examined.

In accordance with the provisions of the Kansas Water Appropriation Act, a portion of which is included below, the use of water prior to approval of the application is unlawful. You should not proceed and divert water as indicated by your plans in your application for a change for this file until you receive approval for this change from the Chief Engineer. Once approved, compliance with the terms, conditions and limitations of the permit is necessary. Conservation of the water resources of Kansas is required.

Section 82a-728 of the Kansas Water Appropriation Act, provides (a) except for the appropriation of water for the purpose of domestic use, . . . it shall be unlawful for any person to appropriate or threaten to appropriate water from any source without first applying for and obtaining a permit to appropriate water in accordance with the provisions of the Water Appropriation Act or for any person to violate any condition of a vested right, appropriation right or an approved application for a permit to appropriate water for beneficial use.

(b) (1) The violation of any provision of this section by any person is a class C misdemeanor...

A class C misdemeanor is punishable by a fine not to exceed \$500 and/or a term of confinement not to exceed one month in the county jail. Each day that the violation occurs constitutes a separate offense.

If you have any questions, please contact me at (785) 564-6645. If you wish to discuss a specific file, please have the file number ready so that we may help you more efficiently.

Sincerely,

A handwritten signature in cursive script that reads "Brent A. Tourney".

Brent Tourney, L.G.
Change Applications Unit Supervisor
Water Appropriation Program

BAT: DLW
pc: STOCKTON Field Office GMD4