

Kansas Department of Agriculture
 Division of Water Resources
CHANGE: P/U WORKSHEET

1. File Number: 8,612	2. Status Change Date:	3. Change Num: C1	4. Field Office: 03	5. GMD: 04
6. Status: <input checked="" type="checkbox"/> Approved <input type="checkbox"/> Denied by DWR/GMD <input type="checkbox"/> Dismiss by Request/Failure to Return				7. Filing Date of Change: 11/16/18
8a. Applicant(s) New to system <input type="checkbox"/>		Person ID 55296 Add Seq# _____	8c. Landowner(s) New to system <input type="checkbox"/>	
HICKERT FARM INC ROGER HICKERT PRESIDENT PO BOX 50 ANTON, CO 80801				
*MODIFY				
8b. Landowner(s) New to system <input type="checkbox"/>		Person ID 55296 Add Seq# _____	8d. WUC New to system <input type="checkbox"/>	
HICKERT FARM INC ROGER HICKERT PRESIDENT PO BOX 50 ANTON, CO 80801		RAYMOND SLIPKE 28058 LINCOLN ST LENORA, KS 67645-9649		
*MODIFY				
9. Documents and Enclosure(s): <input type="checkbox"/> DWR Meter(s) Date to Comply: _____ <input type="checkbox"/> N & P Date to Comply: _____				
<input type="checkbox"/> Anti-Reverse Meter <input type="checkbox"/> Meter Seal <input type="checkbox"/> Check Valve <input type="checkbox"/> N & P Form <input type="checkbox"/> Water Tube <input type="checkbox"/> Driller Copy <input type="checkbox"/> H & E Letter				
<input type="checkbox"/> Conservation Plan Date Required: _____ Date Approved: _____ Date to Comply: _____				
10. Use Made of Water From: _____ To: _____				
			Date Prepared: 12/3/18 By: BILLINGER	
			Date Entered: _____ By: _____	

File No. **8612** 11. County: **GH** Basin: **N F SOLOMON RIVER** Stream: Formation Code: **211** Special Use:

12. Points of Diversion											Rate and Quantity				
CHK											Authorized		Additional		
MOD	PDIV	Qualifier	S	T	R	ID	'N	'W	Comment (AKA Line)	Rate	Quantity	Rate	Quantity	Overlap PD Files	
DEL										gpm	af	gpm	af		
ENT															

NO CHANGE

13. Storage: Rate _____ NF Quantity _____ ac/ft Additional Rate _____ NF Additional Quantity _____ ac/ft

14. Limitation: _____ af/yr at _____ gpm (_____ cfs) when combined with file number(s) _____
 Limitation: _____ af/yr at _____ gpm (_____ cfs) when combined with file number(s) _____

15. 5YR Allocation: Allocation Type _____ Start Year _____ 5 YR Amount _____ Amount Unit _____ Base Acres _____ Comment _____

16. Place of Use							NE¼				NW¼				SW¼				SE¼				Total	Owner	Chg?	Overlap Files
CHK							NE	NW	SW	SE	NE	NW	SW	SE	NE	NW	SW	SE	NE	NW	SW	SE				
MOD	PUSE	S	T	R	ID		¼	¼	¼	¼	¼	¼	¼	¼	¼	¼	¼	¼	¼	¼	¼	¼				
DEL																										
ENT																										
MOD	8533	27	6	25	W 1		40	40	40	40	40	40	40	40					40	40	40	40	480	8b	MOD 25819	

Base Acres: Year: Minimum Reasonable Quantity:

Comments: **COMPLETE OVERLAP WITH FILE 25819**

STATE OF KANSAS

DEPARTMENT OF AGRICULTURE
DIVISION OF WATER RESOURCES
STOCKTON FIELD OFFICE
820 S. WALNUT
STOCKTON, KS 67669-0192



PHONE: (785) 425-6787
FAX: (785) 425-6842
www.agriculture.ks.gov

GOVERNOR JEFF COLYER, M.D.
JACKIE McCLASKEY, SECRETARY OF AGRICULTURE

December 3, 2018

HICKERT FARM INC
ROGER HICKERT PRESIDENT
P.O. BOX 50
ANTON, CO 80801

Re: Water Rights, File Nos. 8,612 & 25,819

Dear Mr. Hickert:

Enclosed are two (2) orders executed by David W. Barfield, Chief Engineer, Division of Water Resources, Kansas Department of Agriculture, approving the applications for change under the above referenced file numbers.

Your attention is directed to the terms, conditions, and limitations specified in these approvals for change.

Since these orders modify the original certificates, they should be recorded with the Register of Deeds as other instruments affecting real estate.

These documents are summary orders by this agency regarding these matters. These orders shall become final if requests for hearings are not filed with the Chief Engineer within 15 days of the date of service of these orders.

If you have any questions, please feel free to contact this office. If you wish to refer to a specific file, please reference it when you contact us.

Sincerely,

Mark Billinger
Assistant Water Commissioner

MB:rh
Enclosures
pc: G.M.D. No. 4

CERTIFICATE OF SERVICE

On this 3rd day of December, 2018, I hereby certify that the attached **SUMMARY ORDERS APPROVING APPLICATIONS FOR CHANGE in PLACE OF USE** for water rights, File Nos. 8,612 & 25,819, dated on the 3rd day of December, 2018, were mailed postage prepaid, first class, U.S. mail, to the following:

HICKERT FARM INC
ROGER HICKERT PRESIDENT
P.O. BOX 50
ANTON, CO 80801

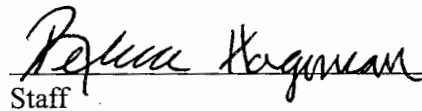
Staff

Copies of these Change Approvals were sent to the following:

Groundwater Management District No. 4
P.O. Box 905
Colby, KS 67701

Submit completed application to:
 Kansas Department of Agriculture
 Division of Water Resources
 Field Office for your area.
 Call for address:
 Topeka -- (785) 862-6300
 Stafford -- (620) 234-5311
 Stockton -- (785) 425-6787
 Garden City -- (620) 276-2901
www.ksda.gov/dwr

DWR FIELD OFFICE APPLICATION FOR APPROVAL TO CHANGE THE PLACE OF USE AND/OR THE POINT OF DIVERSION



STATE OF KANSAS

APPLICANT'S NAME
 12 3 18
 mb

Filing Fee Must Accompany the Application, K.S.A. 82a-708b(b), as amended.
 Fee Schedule is on the third page of this application form.

Paragraph Nos. 1, 2, 3 & 5 must be completed. Complete all other applicable portions. If change in point of diversion is greater than 100 feet, or if place of use will be changed, include a topographic map or detailed plat showing the authorized and proposed point(s) of diversion and/or place of use.

RECEIVED

File No. 8612

NOV 16 2018
 3:45 p.m.

Stockton Field Office
 Division of Water Resources

1. Application is hereby made for approval of the Chief Engineer to change the (check one or both):

Place of Use Point of Diversion

under the water right which is the subject of this application in accordance with the conditions described below.

The source of supply is: Groundwater Surface water

2. Name and address of Applicant: Hickert Farm, Inc. Roger Hickert President

P.O. Box 50 Anton Colorado 80801

Phone Number: (970)554-0020

Email address: NA

Name and address of Water Use Correspondent: Raymond Slipke

No Change proposed

Phone Number: ()

Email address:

3. The presently authorized place of use is:

Owner of Land ---- NAME: Hickert Farm, Inc

ADDRESS: PO Box 50 Anton CO. 80801

(If there is more than one landowner, attach supplemental sheets as necessary.)

Sec.	Twp.	Range	NE¼				NW¼				SW¼				SE¼				TOTAL ACRES
			NE¼	NW¼	SW¼	SE¼	NE¼	NW¼	SW¼	SE¼	NE¼	NW¼	SW¼	SE¼	NE¼	NW¼	SW¼	SE¼	
27	6	25W	40	40			40	40	40	40									240

4. If this application is for a change in place of use, it is proposed that the place of use be changed to:

Owner of Land ---- NAME: Hickert Farms Inc

ADDRESS: PO Box 50 Anton CO. 80801

(If there is more than one landowner, attach supplemental sheets as necessary.)

Sec.	Twp.	Range	NE¼				NW¼				SW¼				SE¼				TOTAL ACRES
			NE¼	NW¼	SW¼	SE¼	NE¼	NW¼	SW¼	SE¼	NE¼	NW¼	SW¼	SE¼	NE¼	NW¼	SW¼	SE¼	
27	6	25W	40	40	40	40	40	40	40	40					40	40	40	40	480

For Office Use Only: Code _____ Fee \$ _____ TR # _____ Receipt Date _____ Check # _____

5. **Presently authorized point of diversion:**
 One in the NC Quarter of the SE Quarter of the NW Quarter
 of Section 27, Township 6 South, Range 25 W,
 in Graham County, Kansas, 3544 feet North 3091 feet West of Southeast corner of section.
 Authorized Rate 900 Gpm Authorized Quantity 448 AF Depth of well NA (feet)
 (DWR use only: Computer ID No. _____ GPS _____ feet North _____ feet West)
 This point will not be changed This point will be changed as follows: UPDATE point of diversion better described with GPS as:
Proposed point of diversion: (Complete only if change is requested)
 One in the _____ Quarter of the _____ Quarter of the _____ Quarter
 of Section _____, Township _____ South, Range _____ (EW),
 in _____ County, Kansas, _____ feet North _____ feet West of Southeast corner of section.
 Proposed Rate _____ Proposed Quantity _____ Proposed well depth (feet) _____
 This point is: Additional Well Geo Center List other water rights that will use this point _____

6. **Presently authorized point of diversion:**
 One in the _____ Quarter of the _____ Quarter of the _____ Quarter
 of Section _____, Township _____ South, Range _____ (EW),
 in _____ County, Kansas, _____ feet North _____ feet West of Southeast corner of section.
 Authorized Rate _____ Authorized Quantity _____ Depth of well _____ (feet)
 (DWR use only: Computer ID No. _____ GPS _____ feet North _____ feet West)
 This point will not be changed This point will be changed as follows: UPDATE point of diversion better described with GPS as:
Proposed point of diversion: (Complete only if change is requested)
 One in the _____ Quarter of the _____ Quarter of the _____ Quarter
 of Section _____, Township _____ South, Range _____ (EW),
 in _____ County, Kansas, _____ feet North _____ feet West of Southeast corner of section.
 Proposed Rate _____ Proposed Quantity _____ Proposed well depth (feet) _____
 This point is: Additional Well Geo Center List other water rights that will use this point _____

7. Why do you need a new point of diversion? NA

8. If a well, is the test hole log attached? Yes No

9. When do you propose to complete the new point of diversion?
NA

10. If the point of diversion is a well:
 (a) What are you going to do with the old well?
NA

(b) When will this be done? NA

11. Groundwater Management District recommendation attached? Yes No

12. Assisted by Scott E Ross

the diagram below in relation to the existing point of diversion.
 (PLEASE NOTE: The "X" in center of diagram below represents presently authorized point of diversion.)

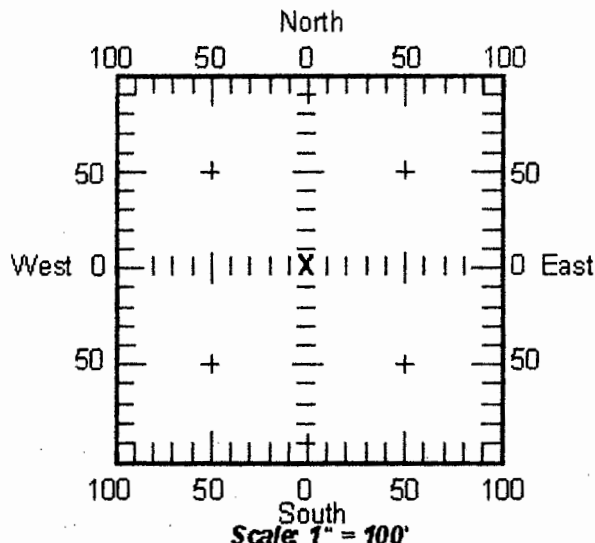

13b. If the proposed point of diversion will be relocated more than 100 feet but within 2640 feet from the existing point of diversion, attach a topographic map or aerial photograph. For groundwater sources, show all wells (including domestic) within one-half mile of the proposed point of diversion and the names and mailing addresses of the owners. For surface water sources, show the names and addresses of the landowner(s) one-half mile downstream and one-half mile upstream from your property lines.

14. If the proposed groundwater point of diversion is 300 or fewer feet from existing point of diversion, complete the following:

- (a) Does the undersigned represent all owners of the currently authorized place(s) of use identified in this application?
 Yes No (If no, all owners must sign this application.)
- (b) Will the ownership interest of any owner of the currently authorized place(s) of use identified in this application be adversely affected if this application is approved as requested?
 Yes No (If yes, all owners must sign this application.)
- (c) If this application is not approved expeditiously, will there be substantial damage to property, public health or safety?
 Yes No (If no, all owners must sign this application.)

If the application proposes a surface water change in point of diversion, a groundwater change in point of diversion greater than 300 feet, or a change in place of use, the application must be signed by all owners of the currently authorized place of use, or their duly authorized agent (attach notarized statement authorizing representation).

I hereby verify, being first duly sworn upon my oath or affirmation and under penalty of perjury, that I am of lawful age and the owner, the spouse of the owner, or a duly authorized agent of the owner(s) to make this application on their behalf, in regard to the water right(s) to which this application pertains. I further verify that the statements contained in this application are true, correct and complete.

Dated at Anton, Colorado, ^{EMM} ~~Kansas~~, this 14th day of November, 20 18.

HICKERT FARM INC,
by Roger Hickert, President
(Owner)

ROGER HICKERT
(Please Print)

(Owner)

(Please Print)

(Owner)

(Please Print)

(Spouse)

(Please Print)

(Spouse)

(Please Print)

(Spouse)

(Please Print)

State of ~~Kansas~~ Colorado } ^{EMM - RIA}
County of Washington } SS

I hereby certify that the foregoing application was signed in my presence and sworn to before me this 14 day of November, 20 18.

Elva M Masters
Notary Public

My Commission Expires 04-09-2022

ONLY COMPLETE APPLICATIONS WILL BE PROCESSED. To be complete, all of the applicable portions of the application form must be completed with accurate information; maps, if necessary, must be included; signatures of all the appropriate owners' must be affixed to the application and notarized; and the appropriate fee must be paid.

FEE SCHEDULE

Each application to change the place of use or the point of diversion under this section shall be accompanied by the application fee set forth in the schedule below. Make checks payable to: **Kansas Department of Agriculture**

- (1) Application to change a point of diversion 300 feet or less \$100
- (2) Application to change a point of diversion more than 300 feet \$200
- (3) Application to change the place of use \$200

ELVA M MASTERS
NOTARY PUBLIC
STATE OF COLORADO
NOTARY ID 19944005886
MY COMMISSION EXPIRES APRIL 09, 2022

RECEIVED

NOV 16 2018

SUMMARY ORDER APPROVING APPLICATION FOR CHANGE AND IMPOSING CONDITIONS

This Summary Order is issued under authority of K.S.A. 82a-708b, as amended, and K.A.R. 5-14-3 and other applicable provisions of the *Kansas Water Appropriation Law, K.S.A. 82a-701 et. seq.*, and rules and regulations promulgated thereunder, K.A.R. 5-1-1 *et. seq.* With the exception of those conditions expressly contained herein, this Summary Order does not change the terms, conditions and limitations of File No. 8612.

1. A change application was received on 11/16/18 requesting that the place of use and / or point of diversion authorized under the above-referenced file number be changed as described in the application.
2. On and after the effective date of this summary order, the authorized place(s) of use shall be located substantially as shown on the topographic map accompanying the application to change the place of use. Applicable Not Applicable
3. The change in point of diversion shall not impair existing rights and shall be limited to the same source or sources of water as previously authorized. The point of diversion authorized by this summary order shall be located within a _____ foot radius of the authorized point(s) of diversion. Applicable Not Applicable
4. The point(s) of diversion authorized herein shall not actually be located more than _____ feet from the previously authorized point(s) of diversion. Applicable Not Applicable
5. As required by K.A.R. 5-3-5d, if the works for diversion is a well with a diversion rate of 100 gallons per minute or more, a tube or other device suitable for making water level measurements shall be installed, operated and maintained in accordance with K.A.R. 5-6-13. Applicable Not Applicable
6. **The owner of the authorized place(s) of use shall properly install an acceptable water flow meter on or before December 31, 20____, or before the first use of water, whichever occurs first.** The water flow meter shall be installed, operated and maintained in accordance with K.A.R. 5-1-4 through 5-1-12. As required by K.S.A. 82a-732, as amended, and K.A.R. 5-3-5e, the owner shall maintain records and report the reading of the water flow meter and the total quantity of water diverted annually to the Chief Engineer by March 1 following the end of each calendar year.
 Applicable Not Applicable
7. **Installation of the works for diversion of water shall be completed on or before December 31, 20____, or within any authorized extension of time.** By March 1, 20____ the applicant shall notify the Chief Engineer that construction of the works for diversion has been completed, on the form provided by the Chief Engineer, as required by K.A.R. 5-8-4e.
 Applicable Not Applicable
8. **The completed well log shall be submitted with the required notice.** Applicable Not Applicable
9. All diversion works into which any type of chemical or other foreign substance will be injected into the water shall be equipped with an in-line, automatic, quick-closing check valve capable of preventing pollution of the source of the water supply. The check valve(s) shall be installed, operated and maintained in accordance with K.A.R. 5-3-5c. Applicable Not Applicable
10. Additional Conditions are attached. Yes No
11. In accordance with K.S.A. 82a-708a, as amended, and K.A.R. 5-5-14, all of the owners of the authorized place(s) of use of water appropriated under the above-referenced file number are responsible for compliance with its terms, conditions and limitations, as amended and/or supplemented by this Summary Order, and with applicable provisions of the *Kansas Water Appropriation Law* and the *Rules and Regulations* promulgated thereunder. Failure to comply with these provisions may result in civil penalties pursuant to K.S.A. 82a-737, as amended, and/or the suspension or revocation and dismissal of the water or appropriation right or any other enforcement actions authorized by law.

Administrative Appeal and Effective Date of Order

You have the right to a hearing in accordance with K.A.R. 5-14-3 before this Summary Order becomes final action of the Kansas Department of Agriculture. Any request for a hearing must be filed with the **Chief Engineer, Division of Water Resources, Kansas Department of Agriculture, 109 SW 9th Street, Topeka, Kansas 66612**, within 15 days after the date shown on the Certificate of Service attached hereto. If a hearing is not requested in accordance with K.A.R. 5-14-3, this Summary Order will become effective on the 15th day after the date shown on the Certificate of Service.

For Use by Register of Deeds

FOR OFFICE USE ONLY
APPLICATION APPROVED AND SUMMARY ORDER ISSUED

By: Mark Billinger
Duly Authorized Designee of the Chief Engineer

(Print Name): MARIL BILLINGER
Division of Water Resources - Kansas Department of Agriculture

Date of Issuance: 12/3/18

State of Kansas)

County of ROOKS) SS

Acknowledged before me on 12-3-18

by Mark Billinger

Signature: Rebecca F. Hageman
Notary Public

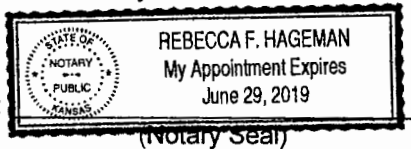

My commission expires: 6-29-19

Application to Change the Place of Use File No. 8612

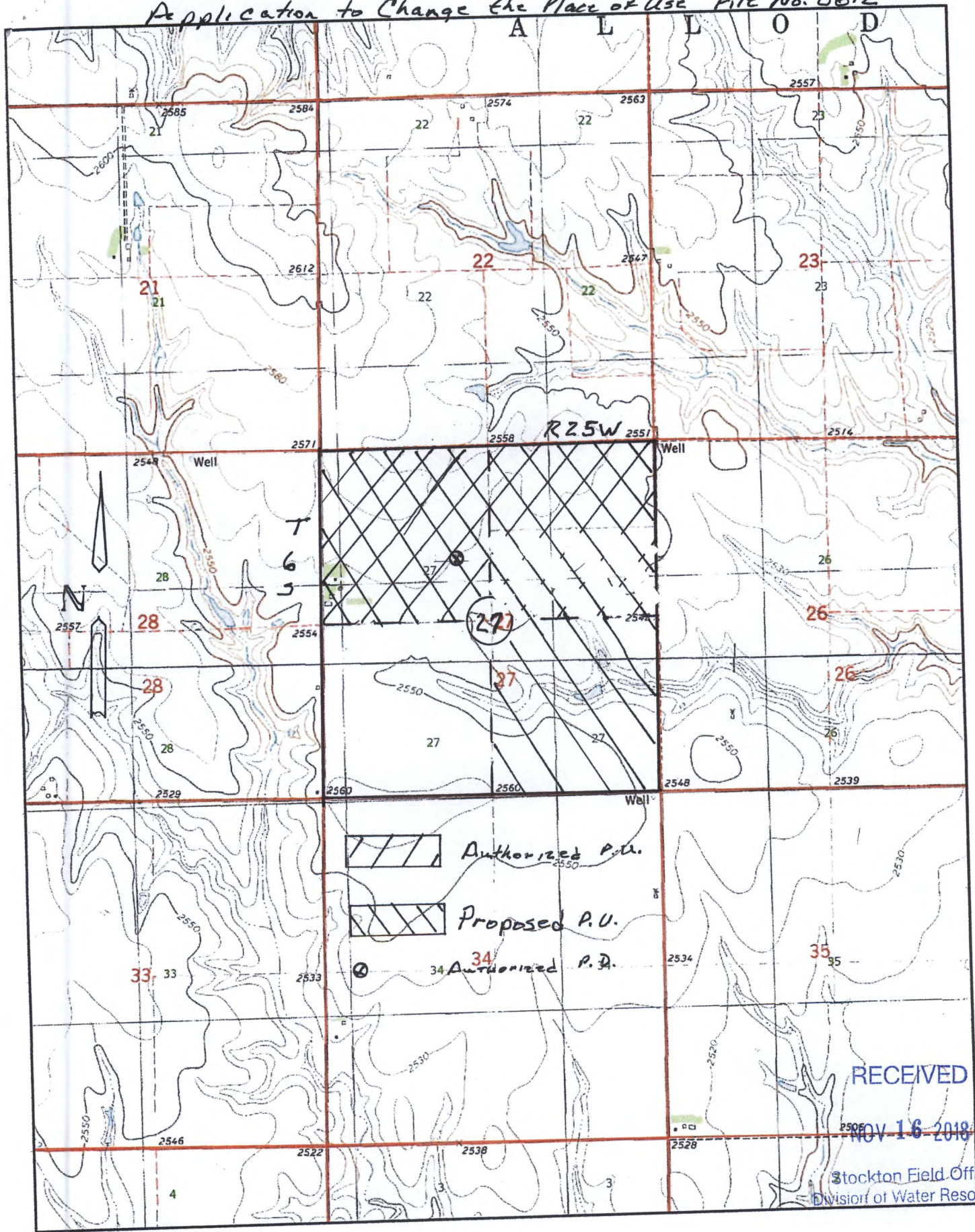

Universal Transverse Mercator (UTM) Projection Zone 14
North American Datum of 1983

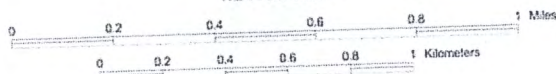

RECEIVED
NOV 16 2018
Stockton Field Office
Division of Water Resources
Magnetic declination of 6E at center of map
on March 17, 2011

DEPARTMENT OF AGRICULTURE
DIVISION OF WATER RESOURCES
STOCKTON FIELD OFFICE
820 S. WALNUT
STOCKTON, KS 67669-0192

STATE OF KANSAS



PHONE: (785) 425-6787
FAX: (785) 425-6842
www.agriculture.ks.gov

GOVERNOR JEFF COLYER, M.D.
JACKIE McCLASKEY, SECRETARY OF AGRICULTURE

November 20, 2018

GROUNDWATER MANAGEMENT DISTRICT NO 4
PO BOX 905
COLBY KS 67701

Re: Water Right, File Nos. 8,612 & 25,819

Dear Ladies and Gentlemen:

Reference is made to the applications referred to above which appear to be in proper form.

We are delaying any further action until **December 7, 2018** to allow you time to submit your recommendation concerning these applications.

Please submit your recommendation within the allotted time or any authorized extension of time thereof. If you wish to refer to a specific file, please reference it when you contact us.

Sincerely,

Kelly C. Stewart
Water Commissioner

KCS:rfh
Enclosures

SCANNED



**NORTHWEST KANSAS
GROUNDWATER MANAGEMENT
DISTRICT NO. 4**

1290 West 4th Street
P.O. Box 905
Colby, Kansas 67701-0905

November 20, 2018

Kelly Stewart
Division of Water Resources
Stockton Field Office
820 S. Walnut
Stockton, Kansas 67669-0192

RE: Applications 8,612 & 25,819
Hickert Farm

Dear Kelly,

The Northwest Kansas Groundwater Management District has reviewed the above referenced applications and based on our records and the information supplied by the applicant, we have determined that the following recommendations be made to the Chief Engineer:
If you have any questions, please contact this office.

Approve applications for place of use

Sincerely,

Ray Luhman
Manager

RPL: jem

RECEIVED

DEC 03 2018

Stockton Field Office
Division of Water Resources