

NOTICE

This scan only represents the application as filed. The information contained herein meets the requirements of K.A.R. 5-3-1 or K.A.R. 5-5-1, and has been found acceptable for filing in the office of the Chief Engineer. The application should not be considered to be a complete application as per K.A.R. 5-3-1b or K.A.R. 5-5-2a.

Submit To: CHIEF ENGINEER
Division of Water Resources
Kansas Department of Agriculture
1320 Research Park Drive
Manhattan, KS 66502
www.ksda.gov/dwr

**APPLICATION FOR APPROVAL TO
CHANGE THE PLACE OF USE, THE
POINT OF DIVERSION OR THE USE
MADE OF THE WATER UNDER AN
EXISTING WATER RIGHT**



State of Kansas

Water Resources
Received

JUN 07 2018

12:31

KS Dept Of Agriculture

Filing Fee Must Accompany the Application
(Please refer to Fee Schedule on signature page of application form.)

Paragraph Nos. 1, 2, 3, 4 & 8 must be completed. Complete all other applicable portions. A topographic map or detailed plat showing the authorized and proposed points(s) of diversion and /or place of use must accompany this application.

1. Application is hereby made for approval of the Chief Engineer to change the

Place of Use

(Check one or more)

Point of Diversion

Use Made of Water

File No. 9,051-D2

2. Name of applicant: CRAIG INGRAM

Address: 220 W 1100 RD

City, State and Zip: LONG ISLAND, KS 67647-4001

Phone Number: (785)543-4055

E-mail address: glingram2000@yahoo.com

What is your relationship to the water right; owner tenant agent other? If other, please explain.

Name of water use correspondent: CRAIG & GENNINE INGRAM

Address: 220 W 1100 RD

City, State and Zip: LONG ISLAND, KS 67647-4001

Phone Number: ()

E-mail address:

3. The change(s) proposed herein are desired for the following reasons (please be specific): TO MOVE POINT OF
DIVERSION DOWNSTREAM AND OVERLAP PU WITH FILES 545, 7860, 11424, 17871, 19478, 20824, 29620, 33786, 36663,

36740 & 37,170

FO : 3 GMP: meets
C-2 KAR 55-1
\$400

IRR

S

PL

6/7/18

AJW

check#

6/7/18

12968

6/7/18
DAW

The change(s) (will be) completed by 12/31/2018

(Date)

For Office Use Only:

F.O. GMD Meets K.A.R. 5-5-1 (YES / NO) Use Source G / S County By Date

Code Fee \$ TR # Receipt Date Check #

DWR 1-120 (Revised 06/29/2009) Assisted by: M. BILLINGER

File No. 9.051-D2

4. The presently authorized place of use is:

Owner of Land $\frac{3}{4}$ NAME: CRAIG & GENINE INGRAM SILVERSTONE & DAKES CANAL
INC

ADDRESS: 220 W 1100 RD LONG ISLAND, KS 67647-4001 71035 F RD ORLEANS, NE 68966

Sec.	Twp.	Range	NE $\frac{1}{4}$				NW $\frac{1}{4}$				SW $\frac{1}{4}$				SE $\frac{1}{4}$				TOTAL ACRES
			NE $\frac{1}{4}$	NW $\frac{1}{4}$	SW $\frac{1}{4}$	SE $\frac{1}{4}$	NE $\frac{1}{4}$	NW $\frac{1}{4}$	SW $\frac{1}{4}$	SE $\frac{1}{4}$	NE $\frac{1}{4}$	NW $\frac{1}{4}$	SW $\frac{1}{4}$	SE $\frac{1}{4}$	NE $\frac{1}{4}$	NW $\frac{1}{4}$	SW $\frac{1}{4}$	SE $\frac{1}{4}$	
5	1S	19W						L-2 30	L-1 40									70	
6	1S	19W	L-2 22.8						L-1 18.8									41.6	

List any other water rights that cover this place of use. 559, 34451, 35016 & 36976

Owner of Land $\frac{3}{4}$ NAME:

ADDRESS:

Sec.	Twp.	Range	NE $\frac{1}{4}$				NW $\frac{1}{4}$				SW $\frac{1}{4}$				SE $\frac{1}{4}$				TOTAL ACRES
			NE $\frac{1}{4}$	NW $\frac{1}{4}$	SW $\frac{1}{4}$	SE $\frac{1}{4}$	NE $\frac{1}{4}$	NW $\frac{1}{4}$	SW $\frac{1}{4}$	SE $\frac{1}{4}$	NE $\frac{1}{4}$	NW $\frac{1}{4}$	SW $\frac{1}{4}$	SE $\frac{1}{4}$	NE $\frac{1}{4}$	NW $\frac{1}{4}$	SW $\frac{1}{4}$	SE $\frac{1}{4}$	

List any other water rights that cover this place of use.

(If there are more than two landowners, attach additional sheets as necessary.)

5. It is proposed that the place of use be changed to:

Owner of Land $\frac{3}{4}$ NAME: NELSON FARMS INC

ADDRESS: BOX 38 LONG ISLAND, KS 67647

Sec.	Twp.	Range	NE $\frac{1}{4}$				NW $\frac{1}{4}$				SW $\frac{1}{4}$				SE $\frac{1}{4}$				TOTAL ACRES
			NE $\frac{1}{4}$	NW $\frac{1}{4}$	SW $\frac{1}{4}$	SE $\frac{1}{4}$	NE $\frac{1}{4}$	NW $\frac{1}{4}$	SW $\frac{1}{4}$	SE $\frac{1}{4}$	NE $\frac{1}{4}$	NW $\frac{1}{4}$	SW $\frac{1}{4}$	SE $\frac{1}{4}$	NE $\frac{1}{4}$	NW $\frac{1}{4}$	SW $\frac{1}{4}$	SE $\frac{1}{4}$	
05	01S	19W															31	32	63
08	01S	19W	40	40	30	9													119

1. The presently authorized place of use is:

Owner of Land $\frac{3}{4}$ NAME:

ADDRESS:

Sec.	Twp.	Range	NE $\frac{1}{4}$				NW $\frac{1}{4}$				SW $\frac{1}{4}$				SE $\frac{1}{4}$				TOTAL ACRES
			NE $\frac{1}{4}$	NW $\frac{1}{4}$	SW $\frac{1}{4}$	SE $\frac{1}{4}$	NE $\frac{1}{4}$	NW $\frac{1}{4}$	SW $\frac{1}{4}$	SE $\frac{1}{4}$	NE $\frac{1}{4}$	NW $\frac{1}{4}$	SW $\frac{1}{4}$	SE $\frac{1}{4}$	NE $\frac{1}{4}$	NW $\frac{1}{4}$	SW $\frac{1}{4}$	SE $\frac{1}{4}$	

List any other water rights that cover this place of use.

Owner of Land $\frac{3}{4}$ NAME:

ADDRESS:

Sec.	Twp.	Range	NE $\frac{1}{4}$				NW $\frac{1}{4}$				SW $\frac{1}{4}$				SE $\frac{1}{4}$				TOTAL ACRES
			NE $\frac{1}{4}$	NW $\frac{1}{4}$	SW $\frac{1}{4}$	SE $\frac{1}{4}$	NE $\frac{1}{4}$	NW $\frac{1}{4}$	SW $\frac{1}{4}$	SE $\frac{1}{4}$	NE $\frac{1}{4}$	NW $\frac{1}{4}$	SW $\frac{1}{4}$	SE $\frac{1}{4}$	NE $\frac{1}{4}$	NW $\frac{1}{4}$	SW $\frac{1}{4}$	SE $\frac{1}{4}$	

List any other water rights that cover this place of use.

(If there are more than two landowners, attach additional sheets as necessary.)

2. It is proposed that the place of use be changed to:

Owner of Land $\frac{3}{4}$ NAME: MARGARET JANE QUINN ESTATE

ADDRESS: LISA C QUINN EXECUTRIX 225 STATE ST PHILLIPSBURG, KS 67661

Sec.	Twp.	Range	NE $\frac{1}{4}$				NW $\frac{1}{4}$				SW $\frac{1}{4}$				SE $\frac{1}{4}$				TOTAL ACRES
			NE $\frac{1}{4}$	NW $\frac{1}{4}$	SW $\frac{1}{4}$	SE $\frac{1}{4}$	NE $\frac{1}{4}$	NW $\frac{1}{4}$	SW $\frac{1}{4}$	SE $\frac{1}{4}$	NE $\frac{1}{4}$	NW $\frac{1}{4}$	SW $\frac{1}{4}$	SE $\frac{1}{4}$	NE $\frac{1}{4}$	NW $\frac{1}{4}$	SW $\frac{1}{4}$	SE $\frac{1}{4}$	
07	01S	19W															3	32	35

List any other water rights that cover this place of use. 545, 7860, 11424, 17871, 19478, 20824, 29620, 33786, 36663, 36740, 37170

Owner of Land $\frac{3}{4}$ NAME: WATKINS FAMILY TRUST

ADDRESS: BILL WATKINS 8100 E CAMELBACK RD SUITE 42 SCOTTSDALE, AZ 85251

Sec.	Twp.	Range	NE $\frac{1}{4}$				NW $\frac{1}{4}$				SW $\frac{1}{4}$				SE $\frac{1}{4}$				TOTAL ACRES
			NE $\frac{1}{4}$	NW $\frac{1}{4}$	SW $\frac{1}{4}$	SE $\frac{1}{4}$	NE $\frac{1}{4}$	NW $\frac{1}{4}$	SW $\frac{1}{4}$	SE $\frac{1}{4}$	NE $\frac{1}{4}$	NW $\frac{1}{4}$	SW $\frac{1}{4}$	SE $\frac{1}{4}$	NE $\frac{1}{4}$	NW $\frac{1}{4}$	SW $\frac{1}{4}$	SE $\frac{1}{4}$	
08	01S	19W								31	40	8.5	2.5						82

List any other water rights that cover this place of use. 545, 7860, 11424, 17871, 19478, 20824, 29620, 33786, 36663, 36740, 37170

Water Resources
Received
JUN 07 2018
KS Dept Of Agriculture

1. The presently authorized place of use is:

Owner of Land $\frac{3}{4}$ NAME:

ADDRESS:

Sec.	Twp.	Range	NE $\frac{1}{4}$				NW $\frac{1}{4}$				SW $\frac{1}{4}$				SE $\frac{1}{4}$				TOTAL ACRES		
			NE $\frac{1}{4}$	NW $\frac{1}{4}$	SW $\frac{1}{4}$	SE $\frac{1}{4}$	NE $\frac{1}{4}$	NW $\frac{1}{4}$	SW $\frac{1}{4}$	SE $\frac{1}{4}$	NE $\frac{1}{4}$	NW $\frac{1}{4}$	SW $\frac{1}{4}$	SE $\frac{1}{4}$	NE $\frac{1}{4}$	NW $\frac{1}{4}$	SW $\frac{1}{4}$	SE $\frac{1}{4}$			

List any other water rights that cover this place of use.

Owner of Land $\frac{3}{4}$ NAME:

ADDRESS:

Sec.	Twp.	Range	NE $\frac{1}{4}$				NW $\frac{1}{4}$				SW $\frac{1}{4}$				SE $\frac{1}{4}$				TOTAL ACRES			
			NE $\frac{1}{4}$	NW $\frac{1}{4}$	SW $\frac{1}{4}$	SE $\frac{1}{4}$	NE $\frac{1}{4}$	NW $\frac{1}{4}$	SW $\frac{1}{4}$	SE $\frac{1}{4}$	NE $\frac{1}{4}$	NW $\frac{1}{4}$	SW $\frac{1}{4}$	SE $\frac{1}{4}$	NE $\frac{1}{4}$	NW $\frac{1}{4}$	SW $\frac{1}{4}$	SE $\frac{1}{4}$				

List any other water rights that cover this place of use.

(If there are more than two landowners, attach additional sheets as necessary.)

2. It is proposed that the place of use be changed to:

Owner of Land $\frac{3}{4}$ NAME: BERNARD A VAN KOOTEN TRUST #2

ADDRESS: GERALDINE VAN KOOTEN 217 W 35TH ST HAYS, KS 67601

Sec.	Twp.	Range	NE $\frac{1}{4}$				NW $\frac{1}{4}$				SW $\frac{1}{4}$				SE $\frac{1}{4}$				TOTAL ACRES				
			NE $\frac{1}{4}$	NW $\frac{1}{4}$	SW $\frac{1}{4}$	SE $\frac{1}{4}$	NE $\frac{1}{4}$	NW $\frac{1}{4}$	SW $\frac{1}{4}$	SE $\frac{1}{4}$	NE $\frac{1}{4}$	NW $\frac{1}{4}$	SW $\frac{1}{4}$	SE $\frac{1}{4}$	NE $\frac{1}{4}$	NW $\frac{1}{4}$	SW $\frac{1}{4}$	SE $\frac{1}{4}$					
18	01S	19W	10																			10	

List any other water rights that cover this place of use. 545, 7860, 11424, 17871, 19478, 20824, 29620, 33786, 36663, 36740, 37170

Owner of Land $\frac{3}{4}$ NAME:

ADDRESS:

Sec.	Twp.	Range	NE $\frac{1}{4}$				NW $\frac{1}{4}$				SW $\frac{1}{4}$				SE $\frac{1}{4}$				TOTAL ACRES					
			NE $\frac{1}{4}$	NW $\frac{1}{4}$	SW $\frac{1}{4}$	SE $\frac{1}{4}$	NE $\frac{1}{4}$	NW $\frac{1}{4}$	SW $\frac{1}{4}$	SE $\frac{1}{4}$	NE $\frac{1}{4}$	NW $\frac{1}{4}$	SW $\frac{1}{4}$	SE $\frac{1}{4}$	NE $\frac{1}{4}$	NW $\frac{1}{4}$	SW $\frac{1}{4}$	SE $\frac{1}{4}$						

List any other water rights that cover this place of use.

Water Resources
 Received
JUN 07 2018
 KS Dept Of Agriculture

1. The presently authorized point(s) of diversion 4 SURFACE WATER DIVERSIONS

(Provide description and number of points)

2. The proposed point(s) of diversion A SINGLE (1) SURFACE WATER DIVERSION

(Provide description and number of points)

List all presently authorized point(s) of diversion:

8. Presently authorized point of diversion:

One in the _____ Quarter of the _____ Quarter of the LOT 2, N2 OF NW Quarter

of Section 5 , Township 1 South, Range 19 W,

in PHILLIPS County, Kansas, 5200 feet North 4320 feet West of Southeast corner of section.

Authorized Rate 1045 GPM Authorized Quantity 36.5 AF

(DWR use only: Computer ID No. 8 GPS _____ feet North _____ feet West)

This point will not be changed This point will be changed as follows:

Proposed point of diversion: (Complete only if change is requested)

One in the _____ Quarter of the _____ Quarter of the _____ Quarter

of Section _____ , Township _____ South, Range _____ W,

in _____ County, Kansas, _____ feet North _____ feet West of Southeast corner of section.

Proposed Rate _____ Proposed Quantity _____

This point is: Additional Well Geo Center List other water rights that will use this point

9.

Presently authorized point of diversion:

One in the _____ Quarter of the _____ Quarter of the _____ Quarter

of Section _____ , Township _____ South, Range _____ (E/W),

in _____ County, Kansas, _____ feet North _____ feet West of Southeast corner of section.

Authorized Rate _____ Authorized Quantity _____

(DWR use only: Computer ID No. _____ GPS _____ feet North _____ feet West)

This point will not be changed This point will be changed as follows:

Proposed point of diversion: (Complete only if change is requested)

One in the _____ Quarter of the _____ Quarter of the _____ Quarter

of Section _____ , Township _____ South, Range _____ W,

in _____ County, Kansas, _____ feet North _____ feet West of Southeast corner of section.

Proposed Rate _____ Proposed Quantity _____

This point is: Additional Well Geo Center List other water rights that will use this point

**Water Resources
Received
JUN 07 2018
KS Dept Of Agriculture**

10.

Presently authorized point of diversion:

One in the	Quarter of the	Quarter of the	Quarter
of Section	, Township	South, Range	W,
in	County, Kansas,	feet North	feet West of Southeast corner of section.

Authorized Rate	Authorized Quantity
(DWR use only: Computer ID No.	GPS
feet North	feet West)

This point will not be changed This point will be changed as follows:

Proposed point of diversion: (Complete only if change is requested)

One in the	Quarter of the	Quarter of the	Quarter
of Section	, Township	South, Range	(E/W),
in	County, Kansas,	feet North	feet West of Southeast corner of section.

Proposed Rate	Proposed Quantity
---------------	-------------------

This point is: Additional Well Geo Center List other water rights that will use this point

11. Describe the current condition of and future plans for any point(s) of diversion which will no longer be used. PUMPSITES

WILL BE ABANDONED AND EQUIPMENT REMOVED

ORIGINAL REVIEW
 REVIEWED
 APR 25 4 08
 AUTHORITY TO ISSUE

List any other water rights that cover this place of use. 545, 7860, 11424, 17871, 19478, 20824, 29620, 33786, 36663, 36740, 37170

Owner of Land ^{3/4} NAME: CRAIG & GENINE INGRAM LIVING TRUSTS

ADDRESS: 220 W 1100 RD LONG ISLAND KS, 67647-4001

Sec.	Twp.	Range	NE¼				NW¼				SW¼				SE¼				TOTAL ACRES					
			NE¼	NW¼	SW¼	SE¼	NE¼	NW¼	SW¼	SE¼	NE¼	NW¼	SW¼	SE¼	NE¼	NW¼	SW¼	SE¼						
07	01S	19W																	15				35	50
08	01S	19W					36	10.5																46.5
18	01S	19W	36	18	34	30	L-1 32	L-2 35	L-2 26	L-1 4														215

List any other water rights that cover this place of use. 545, 7860, 11424, 17871, 19478, 20824, 29620, 33786, 36663, 36740, 37170

IF MORE SPACE IS NEEDED, ATTACH ADDITIONAL SHEETS AS NECESSARY

File No. 9.051-D2

6. The presently authorized point(s) of diversion 4 SURFACE WATER DIVERSIONS

(Provide description and number of points)

7. The proposed point(s) of diversion A SINGLE (1) SURFACE WATER DIVERSION

(Provide description and number of points)

List all presently authorized point(s) of diversion:

Presently authorized point of diversion:

One in the _____ Quarter of the _____ Quarter of the LOT 1, S2 OF NE Quarter
of Section 6, Township 1 South, Range 19 W,
in PHILLIPS County, Kansas, 3260 feet North 950 feet West of Southeast corner of
section.
Authorized Rate 1045 GPM Authorized Quantity 36.5 AF
(DWR use only: Computer ID No. 4 GPS _____ feet North _____ feet West)

This point will not be changed This point will be changed as follows: BETTER DESCR. BY GPS AS:

Proposed point of diversion: (Complete only if change is requested)

One in the NW Quarter of the NE Quarter of the NW Quarter
of Section 8, Township 1 South, Range 19 W,
in PHILLIPS County, Kansas, 5109 feet North 3647 feet West of Southeast corner of
section.
Proposed Rate 1045 GPM Proposed Quantity 36.5 AF **Water Resources**
Received

This point is: Additional Well Geo Center List other water rights that will use this point

JUN 07 2018

Presently authorized point of diversion:

KS Dept Of Agriculture

One in the Quarter of the Quarter of the LOT 2, N2 OF NE Quarter
of Section 6, Township 1 South, Range 19 W,
in PHILLIPS County, Kansas, 3965 feet North 1200 feet West of Southeast corner of
section.

Authorized Rate 1045 GPM Authorized Quantity 36.5
(DWR use only: Computer ID No. 5 GPS feet North feet West)

This point will not be changed This point will be changed as follows:
Proposed point of diversion: (Complete only if change is requested)

One in the Quarter of the Quarter of the Quarter
of Section , Township South, Range W,
in County, Kansas, feet North feet West of Southeast corner of section.

Proposed Rate Proposed Quantity
This point is: Additional Well Geo Center List other water rights that will use this point

Presently authorized point of diversion:

One in the Quarter of the Quarter of the LOT 2, N2 OF NE Quarter
of Section 6, Township 1 South, Range 19 W,
in PHILLIPS County, Kansas, 4890 feet North 800 feet West of Southeast corner of
section.

Authorized Rate 1045 GPM Authorized Quantity 36.5 AF
(DWR use only: Computer ID No. 2 GPS feet North feet West)

This point will not be changed This point will be changed as follows:
Proposed point of diversion: (Complete only if change is requested)

One in the Quarter of the Quarter of the Quarter
of Section , Township South, Range W,
in County, Kansas, feet North feet West of Southeast corner of section.

Proposed Rate Proposed Quantity
This point is: Additional Well Geo Center List other water rights that will use this point

11. Describe the current condition of and future plans for any point(s) of diversion which will no longer be used. PUMPSITES
WILL BE ABANDONED AND EQUIPMENT REMOVED

IF MORE SPACE IS NEEDED, ATTACH ADDITIONAL SHEETS AS NECESSARY

Any use of water that is not as authorized by the water right or permit to authorize water before the chief engineer approves this application is a violation of the Kansas Water Appropriation Act for which criminal or civil penalties may be assessed. Such violation is a class C misdemeanor, punishable by a fine not to exceed \$500 and/or a term of confinement not to exceed one month in the county jail. K.S.A. 82a-728(b). Civil penalties shall be not less than \$100 nor more than \$1,000 per violation. In the case of a continuing violation, each day such violation continues may be deemed a separate violation. In addition to these penalties the water right may be modified or suspended. K.S.A. 82a-737, as amended.

The application must be signed by all owners of the place of use authorized under the water right and his or her spouse, if married. Please indicate if there is no spouse. If land is being purchased under contract, the seller must sign as landowner until such time as the contract is completed.

In the event that all applicants cannot appear before one notary public, they may as necessary sign separate copies of the application before any notary public conveniently available to them. All copies signed in this manner shall be considered to be valid parts of the application.

If the request is signed on behalf of any Owner by someone with legal authority to do so (for example, an agent, one who has power of attorney, or an executor, executrix, conservator), it will be necessary to attach proper documents showing such authority.

I declare that I am an owner of the currently authorized place of use as identified herein, or that I represent all such owners and am authorized to make this application on their behalf, and declare further that the statements contained herein are true, correct, and complete. By filing this application I authorize the chief engineer to permanently reduce the quantity of water and/or rate of diversion as specified in sections 14 and 15 of this application.

Dated at Lond Island, Kansas, this 4th day of June, 20 18

Silverstone & Hakes Canal INC

(Owner) (Spouse)

(Please Print) (Please Print) Vance Dake

(Owner) (Spouse)

(Please Print) (Please Print)

(Owner) (Spouse) *Craig Ingram Trustee*

(Please Print) (Please Print) Craig Ingram

Water Resources
Received

JUN 07 2018

KS Dept Of Agriculture

State of Kansas)

) SS

County of Phillips

I hereby certify that the foregoing application was signed in my presence and sworn to before me this 4th day of June, 20 18.

Arthur L. Lee



12. The presently authorized use of water is for IRRIGATION purposes.

It is proposed that the use be changed to NO CHANGE purposes.

13. If changing the place of use and/or use made of water, describe how the consumptive use will not be increased.

REMOVING AUTH PLACE OF USE AND OVERLAPPING PLACE OF USE WITH FILES

545, 7860, 11424, 17871, 19478, 20824, 29620, 33786, 36663, 36740, 37170

(Please show any calculations here.)

14. It is requested that the maximum annual quantity of water be reduced to N/A (acre-feet or million gallons).

15. It is requested that the maximum rate of diversion of water be reduced to N/A gallons per minute (c.f.s.).

16. The application must include either a topographic map or detailed plat. A U.S. Geological Survey Topographic Map, scale 1:24,000, is available through the Kansas Geological Survey, 1930 Constant Avenue, University of Kansas, Lawrence, Kansas 66047-3726 (www.usgs.gov). The map should show the location of the presently authorized point(s) of diversion. Distances North and West of the Southeast corner of the section must be shown. The presently authorized place of use should also be shown. Identify the center of the section, the section lines and the section corners and show the appropriate section, township, and range numbers on the map. In addition the following information must also be shown on the map.

a. If a change in the location of the point(s) of diversion is proposed, show:

- 1) The location of the proposed point(s) of diversion. Distances North and West of the Southeast corner of the section must be shown. Please be certain that the information shown on the map agrees with the information shown in Paragraph Nos. 9, 10 and 11 of the application.
- 2) If the source of supply is groundwater, please show the location of existing water wells of any kind, including domestic wells, within ½ mile of the proposed well or wells. Identify each well as to its use and furnish name and mailing address of the property owner or owners. If there are no wells within ½ mile, please indicate so on the map.
- 3) If the source of supply is surface water, the names and mailing addresses of all landowner(s) ½ mile downstream and ½ mile upstream from your property lines must be shown.

b. If a change in the place of use is desired, show the proposed place of use by crosshatching on the map. Please be certain that the information shown on the map agrees with the information shown in Paragraph No. 5 of the application.

17. Attach documentation to show the change(s) proposed herein will not impair existing water rights and relates to the same local source of supply as to which the water right relates. This information may include statements, plats, geology reports, well logs, test hole logs, and other information as necessary information to show the above. Additional comments may be made below.

18. If the proposed change(s) does not meet all applicable rules and regulations of the Kansas Water Appropriation Act, please identify the rules and regulations for which you request a waiver. State the reason why a waiver is needed and why the request should be granted. Attach documentation showing that granting the request will not impair existing water rights and will not prejudicially and unreasonably affect the public interest.

My Commission Expires

FEE SCHEDULE

Each application to change the place of use, the point of diversion or the use made of the water under this section shall be accompanied by the application fee set forth in the schedule below:

(1) Application to change a point of diversion 300 feet or less	\$100
(2) Application to change a point of diversion more than 300 feet	\$200
(3) Application to change the place of use	\$200
(4) Application to change the use made of the water	\$300

Make check payable to **Kansas Department of Agriculture.**

Water Resources
Received

JUN 07 2018

KS Dept Of Agriculture

Water Right Agreement

File # 9,051-D2

This surface water agreement jointly owned equally between Craig Ingram, and Genine Ingram address 220 West 1100 road, Long Island KS. 67647 and Silverstone and Dakes Canal, a Nebraska Corporation, address 71035 F Road, Orleans, NE. 68966.

The purpose of this agreement is to change the point of diversion to section 8-1-19 Phillips County KS, more particularly located 5,109 feet North 3,647 feet West from the Southeast corner of the section.

We will change the place of use until Silverstone and Dakes Canal and Craig and Genine Ingram agree to place a center pivot on the land we jointly own in section 5&6 of 1-19 Phillips County KS, known as the Battle Creek farm.

Craig and Genine Ingram agree to pay all fees to DWR to move the water right, when an agreement is made to place a center pivot on Battle Creek, Craig and Genine Ingram agree to return the full authorized 36.5 acre feet of water back to its original place of use. We may keep the point of diversion and pipe the water back to the property as we have a Swine Facility with lagoons to mix with effluent for fertilizer application, and three phase electricity for pumps and pivot prospects.

It is also understood that many other water rights owned by Nelson Farms, Craig and Genine Ingram, Watkins Family Trust, and Old Stone Pork are being pumped into the swine facilities lagoons which create a comingling effect and now Silverstone & Dakes Canal will be included in this agreement that states in no way will any water rights be jeopardized by the comingling and no one can claim any part of any other persons water rights now or in the future.

Silverstone Dakes Canal Silverstone & Dakes Canal INC.
Arthur L. Lee Trustee

State of Kansas County of Phillips

This instrument was acknowledged before me this 4 day of 6, 2018 by

Owners Vance Dake

Owner Craig Ingram

(Seal) 

Public [Signature]

Notary

Water Resources
Received
JUN 07 2018
KS Dept Of Agriculture

My appointment expires: 3-6-21

Submit To: CHIEF ENGINEER
Division of Water Resources
Kansas Department of Agriculture
1320 Research Park Drive
Manhattan, KS 66502
www.ksda.gov/dwr

**APPLICATION FOR APPROVAL TO
CHANGE THE PLACE OF USE, THE
POINT OF DIVERSION OR THE USE
MADE OF THE WATER UNDER AN
EXISTING WATER RIGHT**



State of Kansas

Filing Fee Must Accompany the Application
(Please refer to Fee Schedule on signature page of application form.)

Paragraph Nos. 1, 2, 3, 4 & 8 must be completed. Complete all other applicable portions. A topographic map or detailed plat showing the authorized and proposed points(s) of diversion and /or place of use must accompany this application.

1. Application is hereby made for approval of the Chief Engineer to change the

Place of Use

(Check one or more) Point of Diversion

Use Made of Water

File No. 9,051-D2

2. Name of applicant: CRAIG INGRAM

Address: 220 W 1100 RD

City, State and Zip: LONG ISLAND, KS 67647-4001

Phone Number: (785)543-4055 E-mail address: glingram2000@yahoo.com

What is your relationship to the water right; owner tenant agent other? If other, please explain. _____

Name of water use correspondent: CRAIG & GENNINE INGRAM

Address: 220 W 1100 RD

City, State and Zip: LONG ISLAND, KS 67647-4001

Phone Number: () E-mail address: _____

3. The change(s) proposed herein are desired for the following reasons (please be specific): TO MOVE POINT OF DIVERSION DOWNSTREAM AND OVERLAP PU WITH FILES 545, 7860, 11424, 17871, 19478, 20824, 29620, 33786, 36663, 36740 & 37,170

The change(s) (will be) completed by 12/31/2018
(Date)

For Office Use Only:							
F.O. Code	GMD	Meets K.A.R. 5-5-1 (YES / NO)	Use	Source	G / S County	By	Date
			Fee \$	TR #	Receipt Date	Check #	

4. The presently authorized place of use is:

Owner of Land — NAME: CRAIG & GENINE INGRAM SILVERSTONE & DAKES CANAL INC

ADDRESS: 220 W 1100 RD LONG ISLAND, KS 67647-4001 71035 F RD ORLEANS, NE 68966

Sec.	Twp.	Range	NE¼				NW¼				SW¼				SE¼				TOTAL ACRES
			NE¼	NW¼	SW¼	SE¼	NE¼	NW¼	SW¼	SE¼	NE¼	NW¼	SW¼	SE¼	NE¼	NW¼	SW¼	SE¼	
5	1S	19W						L-2 30	L-1 40										70
6	1S	19W	L-2 22.8															L-1 18.8	41.6

List any other water rights that cover this place of use. 559, 34451, 35016 & 36976

Owner of Land — NAME: _____

ADDRESS: _____

Sec.	Twp.	Range	NE¼				NW¼				SW¼				SE¼				TOTAL ACRES
			NE¼	NW¼	SW¼	SE¼	NE¼	NW¼	SW¼	SE¼	NE¼	NW¼	SW¼	SE¼	NE¼	NW¼	SW¼	SE¼	

List any other water rights that cover this place of use. _____

(If there are more than two landowners, attach additional sheets as necessary.)

5. It is proposed that the place of use be changed to:

Owner of Land — NAME: NELSON FARMS INC

ADDRESS: BOX 38 LONG ISLAND, KS 67647

Sec.	Twp.	Range	NE¼				NW¼				SW¼				SE¼				TOTAL ACRES	
			NE¼	NW¼	SW¼	SE¼	NE¼	NW¼	SW¼	SE¼	NE¼	NW¼	SW¼	SE¼	NE¼	NW¼	SW¼	SE¼		
05	01S	19W																31	32	63
08	01S	19W	40	40	30	9														119

List any other water rights that cover this place of use. 545, 7860, 11424, 17871, 19478, 20824, 29620, 33786, 36663, 36740, 37170

Owner of Land — NAME: CRAIG & GENINE INGRAM LIVING TRUSTS

ADDRESS: 220 W 1100 RD LONG ISLAND KS, 67647-4001

Sec.	Twp.	Range	NE¼				NW¼				SW¼				SE¼				TOTAL ACRES		
			NE¼	NW¼	SW¼	SE¼	NE¼	NW¼	SW¼	SE¼	NE¼	NW¼	SW¼	SE¼	NE¼	NW¼	SW¼	SE¼			
07	01S	19W													15				35	50	
08	01S	19W					36	10.5													46.5
18	01S	19W	36	18	34	30	L-1 32	L-2 35	L-2 26	L-1 4										215	

List any other water rights that cover this place of use. 545, 7860, 11424, 17871, 19478, 20824, 29620, 33786, 36663, 36740, 37170

IF MORE SPACE IS NEEDED, ATTACH ADDITIONAL SHEETS AS NECESSARY

6. The presently authorized point(s) of diversion are 4 SURFACE WATER DIVERSIONS
(Provide description and number of points)

7. The proposed point(s) of diversion is A SINGLE (1) SURFACE WATER DIVERSION
(Provide description and number of points)

List all presently authorized point(s) of diversion:

8. **Presently authorized point of diversion:**
 One in the _____ Quarter of the _____ Quarter of the LOT 1, S2 OF NE Quarter of Section 6, Township 1 South, Range 19 W, in PHILLIPS County, Kansas, 3260 feet North 950 feet West of Southeast corner of section. Authorized Rate 1045 GPM Authorized Quantity 36.5 AF
 (DWR use only: Computer ID No. 4 GPS _____ feet North _____ feet West)
 This point will not be changed This point will be changed as follows: **BETTER DESCR. BY GPS AS:**
Proposed point of diversion: (Complete only if change is requested)
 One in the NW Quarter of the NE Quarter of the NW Quarter of Section 8, Township 1 South, Range 15 W, in PHILLIPS County, Kansas, 5109 feet North 3647 feet West of Southeast corner of section. Proposed Rate 1045 GPM Proposed Quantity 36.5 AF
 This point is: Additional Well Geo Center List other water rights that will use this point _____

9. **Presently authorized point of diversion:**
 One in the _____ Quarter of the _____ Quarter of the LOT 2, N2 OF NE Quarter of Section 6, Township 1 South, Range 19 W, in PHILLIPS County, Kansas, 3965 feet North 1200 feet West of Southeast corner of section. Authorized Rate 1045 GPM Authorized Quantity 36.5
 (DWR use only: Computer ID No. 5 GPS _____ feet North _____ feet West)
 This point will not be changed This point will be changed as follows:
Proposed point of diversion: (Complete only if change is requested)
 One in the _____ Quarter of the _____ Quarter of the _____ Quarter of Section _____, Township _____ South, Range _____ W, in _____ County, Kansas, _____ feet North _____ feet West of Southeast corner of section. Proposed Rate _____ Proposed Quantity _____
 This point is: Additional Well Geo Center List other water rights that will use this point _____

10. **Presently authorized point of diversion:**
 One in the _____ Quarter of the _____ Quarter of the LOT 2, N2 OF NE Quarter of Section 6, Township 1 South, Range 19 W, in PHILLIPS County, Kansas, 4890 feet North 800 feet West of Southeast corner of section. Authorized Rate 1045 GPM Authorized Quantity 36.5 AF
 (DWR use only: Computer ID No. 2 GPS _____ feet North _____ feet West)
 This point will not be changed This point will be changed as follows:
Proposed point of diversion: (Complete only if change is requested)
 One in the _____ Quarter of the _____ Quarter of the _____ Quarter of Section _____, Township _____ South, Range _____ W, in _____ County, Kansas, _____ feet North _____ feet West of Southeast corner of section. Proposed Rate _____ Proposed Quantity _____
 This point is: Additional Well Geo Center List other water rights that will use this point _____

11. Describe the current condition of and future plans for any point(s) of diversion which will no longer be used. PUMPSITES WILL BE ABANDONED AND EQUIPMENT REMOVED

IF MORE SPACE IS NEEDED, ATTACH ADDITIONAL SHEETS AS NECESSARY

12. The presently authorized use of water is for IRRIGATION purposes.
It is proposed that the use be changed to NO CHANGE purposes.
13. If changing the place of use and/or use made of water, describe how the consumptive use will not be increased.
REMOVING AUTH PLACE OF USE AND OVERLAPPING PLACE OF USE WITH FILES
545, 7860, 11424, 17871, 19478, 20824, 29620, 33786, 36663, 36740, 37170
-
- (Please show any calculations here.)
14. It is requested that the maximum annual quantity of water be reduced to N/A (acre-feet or million gallons).
15. It is requested that the maximum rate of diversion of water be reduced to N/A gallons per minute (____ c.f.s.).
16. The application must include either a topographic map or detailed plat. A U.S. Geological Survey Topographic Map, scale 1:24,000, is available through the Kansas Geological Survey, 1930 Constant Avenue, University of Kansas, Lawrence, Kansas 66047-3726 (www.usgs.gov). The map should show the location of the presently authorized point(s) of diversion. Distances North and West of the Southeast corner of the section must be shown. The presently authorized place of use should also be shown. Identify the center of the section, the section lines and the section corners and show the appropriate section, township, and range numbers on the map. In addition the following information must also be shown on the map.
- a. If a change in the location of the point(s) of diversion is proposed, show:
 - 1) The location of the proposed point(s) of diversion. Distances North and West of the Southeast corner of the section must be shown. Please be certain that the information shown on the map agrees with the information shown in Paragraph Nos. 9, 10 and 11 of the application.
 - 2) If the source of supply is groundwater, please show the location of existing water wells of any kind, including domestic wells, within ½ mile of the proposed well or wells. Identify each well as to its use and furnish name and mailing address of the property owner or owners. If there are no wells within ½ mile, please indicate so on the map.
 - 3) If the source of supply is surface water, the names and mailing addresses of all landowner(s) ½ mile downstream and ½ mile upstream from your property lines must be shown.
 - b. If a change in the place of use is desired, show the proposed place of use by crosshatching on the map. Please be certain that the information shown on the map agrees with the information shown in Paragraph No. 5 of the application.
17. Attach documentation to show the change(s) proposed herein will not impair existing water rights and relates to the same local source of supply as to which the water right relates. This information may include statements, plats, geology reports, well logs, test hole logs, and other information as necessary information to show the above. Additional comments may be made below.
-
-
-
-
18. If the proposed change(s) does not meet all applicable rules and regulations of the Kansas Water Appropriation Act, please identify the rules and regulations for which you request a waiver. State the reason why a waiver is needed and why the request should be granted. Attach documentation showing that granting the request will not impair existing water rights and will not prejudicially and unreasonably affect the public interest.
-

IF MORE SPACE IS NEEDED, ATTACH ADDITIONAL SHEETS AS NECESSARY

Any use of water that is not as authorized by the water right or permit to authorize water **before** the chief engineer approves this application is a violation of the Kansas Water Appropriation Act for which criminal or civil penalties may be assessed. Such violation is a class C misdemeanor, punishable by a fine not to exceed \$500 and/or a term of confinement not to exceed one month in the county jail. K.S.A. 82a-728(b). Civil penalties shall be not less than \$100 nor more than \$1,000 per violation. In the case of a continuing violation, each day such violation continues may be deemed a separate violation. In addition to these penalties the water right may be modified or suspended. K.S.A. 82a-737, as amended.

The application must be signed by all owners of the place of use authorized under the water right and his or her spouse, if married. Please indicate if there is no spouse. If land is being purchased under contract, the seller must sign as landowner until such time as the contract is completed.

In the event that all applicants cannot appear before one notary public, they may as necessary sign separate copies of the application before any notary public conveniently available to them. All copies signed in this manner shall be considered to be valid parts of the application.

If the request is signed on behalf of any Owner by someone with legal authority to do so (for example, an agent, one who has power of attorney, or an executor, executrix, conservator), it will be necessary to attach proper documents showing such authority.

I declare that I am an owner of the currently authorized place of use as identified herein, or that I represent all such owners and am authorized to make this application on their behalf, and declare further that the statements contained herein are true, correct, and complete. By filing this application I authorize the chief engineer to permanently reduce the quantity of water and/or rate of diversion as specified in sections 14 and 15 of this application.

Dated at _____, Kansas, this _____ day of _____, 20_____.

(Owner)

(Spouse)

(Please Print)

(Please Print)

(Owner)

(Spouse)

(Please Print)

(Please Print)

(Owner)

(Spouse)

(Please Print)

(Please Print)

State of Kansas }
County of _____ } SS

I hereby certify that the foregoing application was signed in my presence and sworn to before me this _____ day of _____, 20_____.

My Commission Expires _____

Notary Public

FEE SCHEDULE

Each application to change the place of use, the point of diversion or the use made of the water under this section shall be accompanied by the application fee set forth in the schedule below:

- (1) Application to change a point of diversion 300 feet or less \$100
- (2) Application to change a point of diversion more than 300 feet \$200
- (3) Application to change the place of use \$200
- (4) Application to change the use made of the water \$300

Make check payable to **Kansas Department of Agriculture.**

1. The presently authorized place of use is:

Owner of Land — NAME: _____

ADDRESS: _____

Sec.	Twp.	Range	NE¼				NW¼				SW¼				SE¼				TOTAL ACRES		
			NE¼	NW¼	SW¼	SE¼	NE¼	NW¼	SW¼	SE¼	NE¼	NW¼	SW¼	SE¼	NE¼	NW¼	SW¼	SE¼			

List any other water rights that cover this place of use. _____

Owner of Land — NAME: _____

ADDRESS: _____

Sec.	Twp.	Range	NE¼				NW¼				SW¼				SE¼				TOTAL ACRES			
			NE¼	NW¼	SW¼	SE¼	NE¼	NW¼	SW¼	SE¼	NE¼	NW¼	SW¼	SE¼	NE¼	NW¼	SW¼	SE¼				

List any other water rights that cover this place of use. _____

(If there are more than two landowners, attach additional sheets as necessary.)

2. It is proposed that the place of use be changed to:

Owner of Land — NAME: BERNARD A VAN KOOTEN TRUST #2

ADDRESS: GERALDINE VAN KOOTEN 217 W 35TH ST HAYS, KS 67601

Sec.	Twp.	Range	NE¼				NW¼				SW¼				SE¼				TOTAL ACRES			
			NE¼	NW¼	SW¼	SE¼	NE¼	NW¼	SW¼	SE¼	NE¼	NW¼	SW¼	SE¼	NE¼	NW¼	SW¼	SE¼				
18	01S	19W		10																	10	

List any other water rights that cover this place of use. 545, 7860, 11424, 17871, 19478, 20824, 29620, 33786, 36663, 36740, 37170

Owner of Land — NAME: _____

ADDRESS: _____

Sec.	Twp.	Range	NE¼				NW¼				SW¼				SE¼				TOTAL ACRES				
			NE¼	NW¼	SW¼	SE¼	NE¼	NW¼	SW¼	SE¼	NE¼	NW¼	SW¼	SE¼	NE¼	NW¼	SW¼	SE¼					

List any other water rights that cover this place of use. _____

STATE OF KANSAS

DEPARTMENT OF AGRICULTURE
1320 RESEARCH PARK DRIVE
MANHATTAN, KS 66502
PHONE: (785) 564-6700
FAX: (785) 564-6777

900 SW JACKSON, ROOM 456
TOPEKA, KS 66612
PHONE: (785) 296-3556
www.agriculture.ks.gov



GOVERNOR JEFF COLYER, M.D.
JACKIE McCLASKEY, SECRETARY OF AGRICULTURE

CRAIG INGRAM
220 W 1100 RD
LONG ISLAND, KS 67647

June 8, 2018

RE: File No 9051-D2

Dear Sir or Madam:

An application for approval of the Chief Engineer to change the following condition or conditions of the file number referred to above has been received:

- place of use PU/PD
 point of diversion
 use made of water

As a matter of record, the Division of Water Resources has on hand a large number of applications awaiting processing. Therefore, to be fair to all concerned, and so that we can process those applications on hand in the order they were received, we intend to concentrate on the backlog of applications until the issue is resolved. You will be contacted regarding this application as soon as it has been examined.

In accordance with the provisions of the Kansas Water Appropriation Act, a portion of which is included below, the use of water prior to approval of the application is unlawful. You should not proceed and divert water as indicated by your plans in your application for a change for this file until you receive approval for this change from the Chief Engineer. Once approved, compliance with the terms, conditions and limitations of the permit is necessary. Conservation of the water resources of Kansas is required.

Section 82a-728 of the Kansas Water Appropriation Act, provides (a) except for the appropriation of water for the purpose of domestic use, . . . it shall be unlawful for any person to appropriate or threaten to appropriate water from any source without first applying for and obtaining a permit to appropriate water in accordance with the provisions of the Water Appropriation Act or for any person to violate any condition of a vested right, appropriation right or an approved application for a permit to appropriate water for beneficial use.

(b) (1) The violation of any provision of this section by any person is a class C misdemeanor...

A class C misdemeanor is punishable by a fine not to exceed \$500 and/or a term of confinement not to exceed one month in the county jail. Each day that the violation occurs constitutes a separate offense.

If you have any questions, please contact me at (785) 564-6645. If you wish to discuss a specific file, please have the file number ready so that we may help you more efficiently.

Sincerely,

Brent Tourney, L.G.
Change Applications Unit Supervisor
Water Appropriation Program

BAT: DLW
pc: STOCKTON Field Office GMD

Application to Change the Point of Diversion and Place of Use for Water Right, File # 9,051-D2

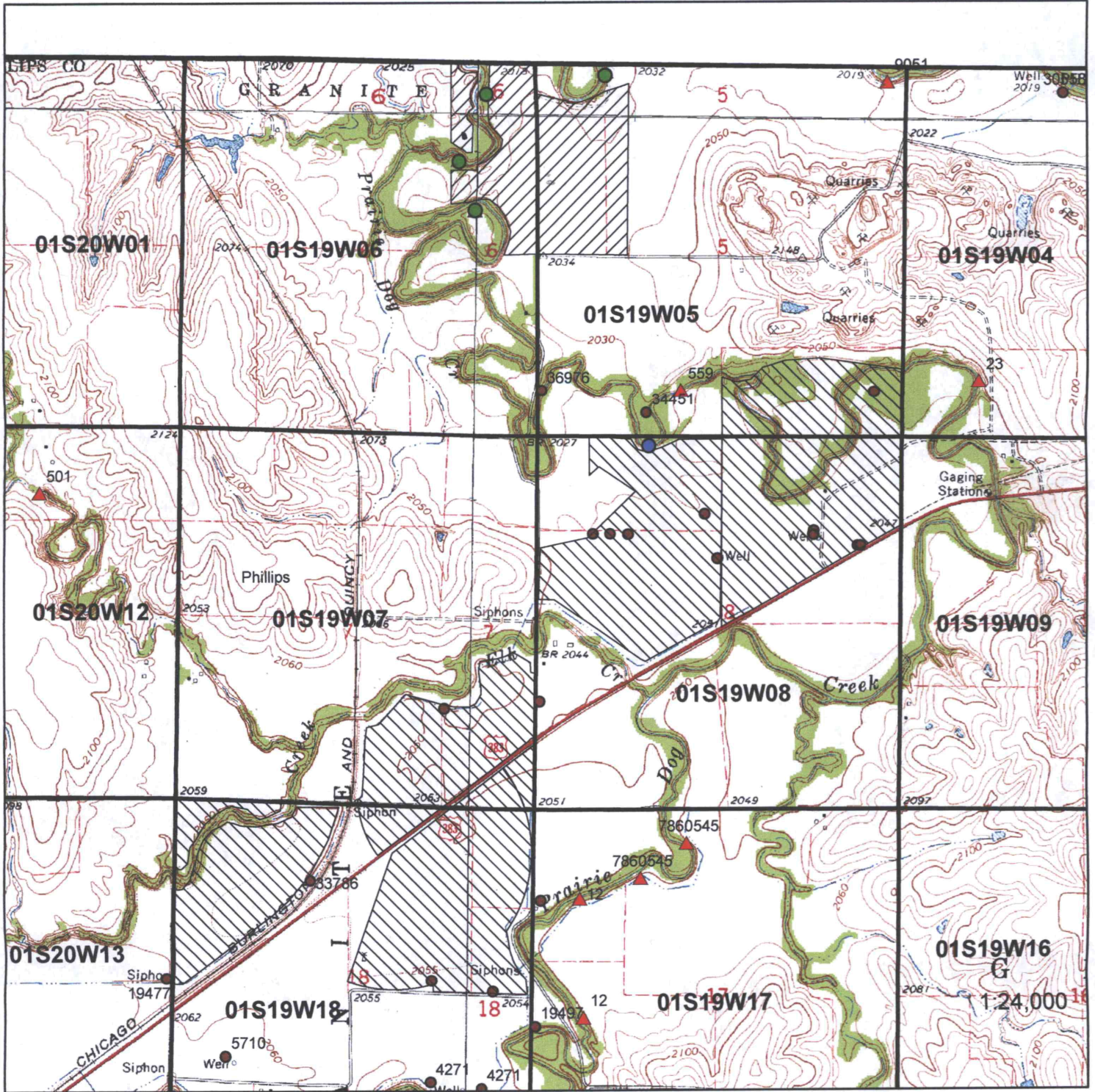

Present p/u



Proposed p/u



Present p/d



Proposed p/d

Water Resources
Received

JUN 07 2018

All landowners both 1/2 mile upstream and 1/2 mile downstream of the proposed point of diversion are provided:

[Signature] 6-1-2018

Signature

Date