

Stockton Field Office  
820 S. Walnut  
Stockton, KS 67669-0192



Phone: 785-425-6787  
Fax: 785-425-6842  
www.agriculture.ks.gov

Mike Beam, Secretary

Laura Kelly, Governor

December 26, 2019

FLOYD CHAPMAN INC  
PO BOX 264  
GUYMON, OK 73942

Re: Water Right, File No. 17,930

Dear Mr. Chapman:

Enclosed is the order executed by David W. Barfield, Chief Engineer, Division of Water Resources, Kansas Department of Agriculture, approving the application for change under the above referenced file number.

Your attention is directed to the terms, conditions, and limitations specified in this approval for change. Also, the approval of the order requires the installation of a water flow meter(s) on the point(s) of diversion authorized under the above referenced file number by **December 31, 2020**. Please complete and return the enclosed Notice of Completion of Diversion Works when a water flow meter has been installed. A copy of the Chief Engineer's specifications for the water flow meters are found in K.A.R. 5-1-4 through K.A.R. 5-1-12 along with a partial list of those flow meters found to be acceptable for installation in Kansas can be found on our website at the following web address:

<http://agriculture.ks.gov/meters>

Please note that all meters must be installed and maintained in accordance with the specifications for water flow meters referenced above.

The abandoned water well must be plugged in accordance with the requirements of Article 30 of the Rules and Regulations as adopted by the Kansas Department of Health and Environment (KDHE). If the well is to be retained by the landowner for other purposes, a copy of the legal transfer of responsibility for maintenance of the well must be forwarded to KDHE Geology Section, 1000 SW Jackson, Suite 420, Topeka, Kansas 66612, telephone number (785) 296-5524. More information is available online at: <http://kdheks.gov/waterwell>

Since this order modifies the original certificate, it should be recorded with the Register of Deeds just as other legal documents affecting real estate. Such records are maintained at the Register of Deeds Office in the county wherein the place of use is located.

**This document is a summary order by this agency regarding this matter.** This order shall become final if a request for a hearing is not filed with the Chief Engineer within 15 days of the date of service of this order.

(over)

SCANNED

If you have any questions, please feel free to contact this office at (785)425-6787. If you wish to refer to a specific file, please reference it when you contact us.

Sincerely,



Mark Billinger  
Assistant Water Commissioner

MB:rfh  
Enclosures  
pc: G.M.D.4 & David Schippers

**CERTIFICATE OF SERVICE**

On this 26<sup>th</sup> day of December, 2019, I hereby certify that the attached **SUMMARY ORDER APPROVING APPLICATION FOR CHANGE in POINT OF DIVERSION** for water right, File No. 17,930, dated on the 24<sup>th</sup> day of December, 2019, was mailed postage prepaid, first class, U.S. mail, to the following:

FLOYD CHAPMAN INC  
PO BOX 264  
GUYMON, OK 73942

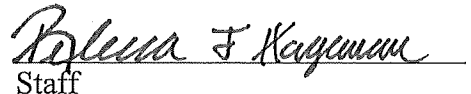
  
Staff

A copy of the Change Approval was sent to the following:

Groundwater Management District No. 4  
P.O. Box 905  
Colby, KS 67701

DAVID SCHIPPERS  
941 4TH ST  
HOXIE, KS 67740

Submit completed application to:  
 Kansas Department of Agriculture  
 Division of Water Resources  
 Field Office for your area.

Call for address:

Topeka -- (785) 296-5733  
 Stafford -- (620) 234-5311  
 Stockton -- (785) 425-6787  
 Garden City -- (620) 276-2901  
<http://agriculture.ks.gov/dwr>

## DWR FIELD OFFICE APPLICATION FOR APPROVAL TO CHANGE THE PLACE OF USE AND/OR THE POINT OF DIVERSION



**STATE OF KANSAS**

APPLICATION COMPLETE

12 / 27 / 19

Reviewer MB

WATER METER REQUIRED

Filing Fee Must Accompany the Application, K.S.A. 82a-708b(b), as amended.  
 Fee Schedule is on the third page of this application form.

Paragraph Nos. 1, 2, 3 & 5 must be completed. Complete all other applicable portions. If change in point of diversion is greater than 100 feet, or if place of use will be changed, include a topographic map or detailed plat showing the authorized and proposed point(s) of diversion and/or place of use.

RECEIVED

DEC 24 2019  
 3:41 p.m.

Stockton Field Office  
 Division of Water Resources

File No. 17,930

1. Application is hereby made for approval of the Chief Engineer to change the (check one or both):

Place of Use                       Point of Diversion

under the water right which is the subject of this application in accordance with the conditions described below.

The source of supply is:                       Groundwater                       Surface water

2. Name and address of Applicant: FLOYD CHAPMAN INC C/O CHUCK CHAPMAN  
PO BOX 264 GUYMON OK, 73942

Phone Number: (580) 651-2617                      Email address: \_\_\_\_\_

Name and address of Water Use Correspondent: DAVID SCHIPPERS  
941 4TH ST HOXIE, KS 67740

Phone Number: (    ) \_\_\_\_\_                      Email address: \_\_\_\_\_

3. The presently authorized place of use is:  
 Owner of Land ---- NAME: FLOYD CHAPMAN INC  
 ADDRESS: PO BOX 264 GUYMON OK, 73942

(If there is more than one landowner, attach supplemental sheets as necessary.)

Sec.	Twp.	Range	NE¼				NW¼				SW¼				SE¼				TOTAL ACRES
			NE¼	NW¼	SW¼	SE¼	NE¼	NW¼	SW¼	SE¼	NE¼	NW¼	SW¼	SE¼	NE¼	NW¼	SW¼	SE¼	
32	9S	28W									30.5	30.5	30.5	30.5	30.5	30.5	30.5	30.5	244

4. If this application is for a change in place of use, it is proposed that the place of use be changed to:  
 Owner of Land ---- NAME: NO CHANGE  
 ADDRESS: \_\_\_\_\_

(If there is more than one landowner, attach supplemental sheets as necessary.)

Sec.	Twp.	Range	NE¼				NW¼				SW¼				SE¼				TOTAL ACRES
			NE¼	NW¼	SW¼	SE¼	NE¼	NW¼	SW¼	SE¼	NE¼	NW¼	SW¼	SE¼	NE¼	NW¼	SW¼	SE¼	

For Office Use Only: Code \_\_\_\_\_ Fee \$ \_\_\_\_\_ TR # \_\_\_\_\_ Receipt Date \_\_\_\_\_ Check # \_\_\_\_\_

5. **Presently authorized point of diversion:**  
 One in the NE Quarter of the NW Quarter of the SE Quarter  
 of Section 32, Township 9 South, Range 28 W,  
 in SD County, Kansas, \_\_\_\_\_ feet North \_\_\_\_\_ feet West of Southeast corner of section.  
 Authorized Rate 535 GPM Authorized Quantity 325 AF Depth of well \_\_\_\_\_ (feet)  
**(DWR use only: Computer ID No. 1 GPS 2090 feet North 1921 feet West)**  
 This point will not be changed  This point will be changed as follows:  No change, point better described with GPS as follows:  
**Proposed point of diversion: (Complete only if change is requested or if existing point is better described by GPS)**  
 One in the NE Quarter of the NW Quarter of the SE Quarter  
 of Section 32, Township 9 South, Range 28 W,  
 in SD County, Kansas, 2093 feet North 1883 feet West of Southeast corner of section.  
 Proposed Rate 535 GPM Proposed Quantity 325 AF Proposed well depth (feet) \_\_\_\_\_.  
 This point is:  Additional Well  Geo Center List other water rights that will use this point \_\_\_\_\_.

6. **Presently authorized point of diversion:**  
 One in the \_\_\_\_\_ Quarter of the \_\_\_\_\_ Quarter of the \_\_\_\_\_ Quarter  
 of Section \_\_\_\_\_, Township \_\_\_\_\_ South, Range \_\_\_\_\_ (E/W),  
 in \_\_\_\_\_ County, Kansas, \_\_\_\_\_ feet North \_\_\_\_\_ feet West of Southeast corner of section.  
 Authorized Rate \_\_\_\_\_ Authorized Quantity \_\_\_\_\_ Depth of well \_\_\_\_\_ (feet)  
**(DWR use only: Computer ID No. \_\_\_\_\_ GPS \_\_\_\_\_ feet North \_\_\_\_\_ feet West)**  
 This point will not be changed  This point will be changed as follows:  No change, point better described with GPS as follows:  
**Proposed point of diversion: (Complete only if change is requested or if existing point is better described by GPS)**  
 One in the \_\_\_\_\_ Quarter of the \_\_\_\_\_ Quarter of the \_\_\_\_\_ Quarter  
 of Section \_\_\_\_\_, Township \_\_\_\_\_ South, Range \_\_\_\_\_ (E/W),  
 in \_\_\_\_\_ County, Kansas, \_\_\_\_\_ feet North \_\_\_\_\_ feet West of Southeast corner of section.  
 Proposed Rate \_\_\_\_\_ Proposed Quantity \_\_\_\_\_ Proposed well depth (feet) \_\_\_\_\_.  
 This point is:  Additional Well  Geo Center List other water rights that will use this point \_\_\_\_\_.

7. The changes herein are desired for the following reasons?  
 (please be specific) REDIRILL WELL DUE TO CASING  
PROBLEMS

8. If a well, is the test hole log attached?  Yes  No

9. The change(s) (was)(will be) completed by?  
UPON APPROVAL

10. If the point of diversion is a well:  
 (a) What are you going to do with the old well?  
PLUG OR CAP  
 (b) When will this be done? UPON COMPLETION

11. Groundwater Management District recommendation attached?  
 Yes  No

12. Assisted by BILLINGER - STKFO

13a. If the proposed point of diversion will be relocated more than 300  
feet but within 2,640 feet of the existing point of diversion, attach  
 a topographic map or aerial photograph. For groundwater  
 sources, show all wells (including domestic) within one-half mile  
 of the proposed point of diversion and the names and mailing  
 addresses of the owners. For surface water sources, show the  
 names and addresses of the landowner(s) one-half mile  
 downstream and one-half mile upstream from your property  
 lines

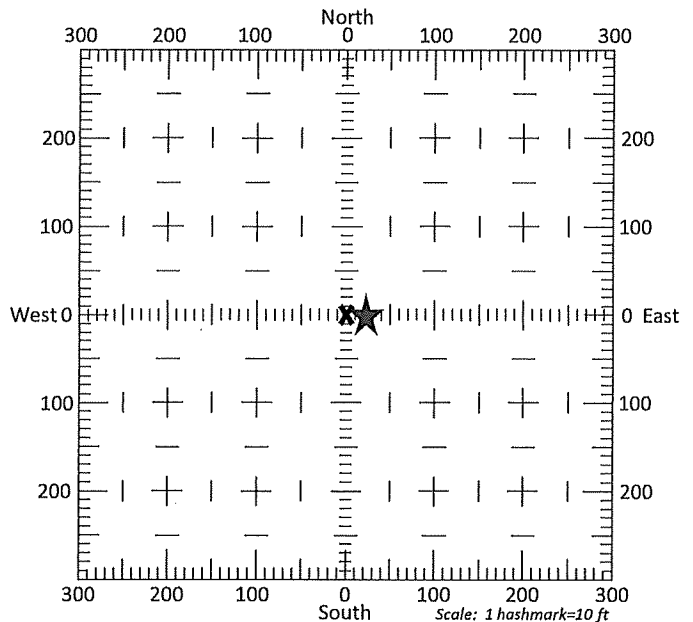

13b. If the proposed point of diversion will be relocated within 300 feet  
 of the existing point of diversion, indicate its location on the  
 diagram shown above in relation to the existing point of  
 diversion. (PLEASE NOTE: The "X" in center of diagram  
 above represents the presently authorized point of  
 diversion.)

14. If the proposed groundwater point of diversion is 300 or fewer feet from the existing point of diversion, complete the following:

- (a) Does the undersigned represent all owners of the currently authorized place(s) of use identified in this application?  
 Yes     No    (If no, all owners must sign this application.)
- (b) Will the ownership interest of any owner of the currently authorized place(s) of use identified in this application be adversely affected if this application is approved as requested?  
 Yes     No    (If yes, all owners must sign this application.)
- (c) If this application is not approved expeditiously, will there be substantial damage to property, public health or safety?  
 Yes     No    (If no, all owners must sign this application.)

If the application proposes a surface water change in point of diversion, a groundwater change in point of diversion greater than 300 feet, or a change in place of use, the application must be signed by all owners of the currently authorized place of use, or their duly authorized agent (attach notarized statement authorizing representation).

I hereby verify, being first duly sworn upon my oath or affirmation and under penalty of perjury, that I am of lawful age and the owner, the spouse of the owner, or a duly authorized agent of the owner(s) to make this application on their behalf, in regards to the water right(s) to which this application pertains. I further verify that the statements contained in this application are true, correct and complete.

Dated at \_\_\_\_\_, Kansas, this \_\_\_\_\_ day of \_\_\_\_\_, 20\_\_\_\_\_.

Floyd Chapman Sr. - C Chapman Res. \_\_\_\_\_  
 (Owner) (Spouse)

Floyd Chapman Jr. \_\_\_\_\_  
 (Please Print) (Please Print)

\_\_\_\_\_  
 (Owner) (Spouse)

\_\_\_\_\_  
 (Please Print) (Please Print)

\_\_\_\_\_  
 (Owner) (Spouse)

\_\_\_\_\_  
 (Please Print) (Please Print)

State of Oklahoma }  
 County of Texas } SS

I hereby certify that the foregoing application was signed in my presence and sworn to before me this 19th day of December, 2019.

My Commission Expires 08/30/2023

Bailey Kane  
 Notary Public

**NOTARY PUBLIC, State of Oklahoma**  
 Commission # 1904  
 Texas County  
 Bailey Kane  
 My Commission Expires 08/30/2023

ONLY COMPLETE APPLICATIONS WILL BE PROCESSED. To be complete, all of the applicable portions of the application must be completed with accurate information; maps, if necessary, must be included; signatures of all the appropriate owners' must be affixed to the application and notarized; and the appropriate fee must be paid.

**FEE SCHEDULE**

Each application to change the place of use or the point of diversion under this section shall be accompanied by the application fee set forth in the schedule below: Make checks payable to: **Kansas Department of Agriculture**

- (1) Application to change a point of diversion 300 feet or less ..... \$100
- (2) Application to change a point of diversion more than 300 feet ..... \$200
- (3) Application to change the place of use ..... \$200

RECEIVED  
 DEC 24 2019

**SUMMARY ORDER APPROVING APPLICATION FOR CHANGE AND IMPOSING CONDITIONS**

This Summary Order is issued under authority of K.S.A. 82a-708b, as amended, and K.A.R. 5-5-1, *et seq.* and other applicable provisions of the *Kansas Water Appropriation Law, K.S.A. 82a-701 et. seq.*, and rules and regulations promulgated thereunder, With the exception of those conditions expressly contained herein, this Summary Order does not change the terms, conditions and limitations of File No. 17,930

1. A change application was received on 12/24/19 requesting that the place of use and / or point of diversion authorized under the above-referenced file number be changed as described in the application.
2. On and after the effective date of this summary order, the authorized place(s) of use shall be located substantially as shown on the topographic map accompanying the application to change the place of use.  Applicable  Not Applicable
3. The change in point of diversion shall not impair existing rights and shall be limited to the same source or sources of water as previously authorized. The point of diversion authorized by this summary order shall be located within a 50 foot radius of the authorized point(s) of diversion.  Applicable  Not Applicable
4. The point(s) of diversion described herein is administratively corrected to be more accurately described using the Global Positioning System (GPS), as described in the application.  Applicable  Not Applicable
5. The point(s) of diversion authorized herein shall not actually be located more than \_\_\_\_\_ feet from the previously authorized point(s) of diversion.  Applicable  Not Applicable
6. As required by K.A.R. 5-3-5d, if the works for diversion is a well with a diversion rate of 100 gallons per minute or more, a tube or other device suitable for making water level measurements shall be installed, operated and maintained in accordance with K.A.R. 5-6-13.  Applicable  Not Applicable
7. The owner of the authorized place(s) of use shall properly install an acceptable water flow meter on or before **December 31, 2020**, or before the first use of water, whichever occurs first. The water flow meter shall be installed, operated and maintained in accordance with K.A.R. 5-1-4 through 5-1-12. As required by K.S.A. 82a-732, as amended, and K.A.R. 5-3-5e, the owner shall maintain records and report the reading of the water flow meter and the total quantity of water diverted annually to the Chief Engineer by March 1 following the end of each calendar year.  
 Applicable  Not Applicable
8. Installation of the works for diversion of water shall be completed on or before **December 31, 2020**, or within any authorized extension of time. By March 1, 2021 the applicant shall notify the Chief Engineer that construction of the works for diversion has been completed, on the form provided by the Chief Engineer, as required by K.A.R. 5-8-4e.  
 Applicable  Not Applicable
9. The completed well log shall be submitted with the required notice.  Applicable  Not Applicable
10. All diversion works into which any type of chemical or other foreign substance will be injected into the water shall be equipped with an in-line, automatic, quick-closing check valve capable of preventing pollution of the source of the water supply. The check valve(s) shall be installed, operated and maintained in accordance with K.A.R. 5-3-5c.  Applicable  Not Applicable
11. Additional Conditions are attached.  Yes  No
12. In accordance with K.S.A. 82a-708a, as amended, and K.A.R. 5-5-14, all of the owners of the authorized place(s) of use of water appropriated under the above-referenced file number are responsible for compliance with its terms, conditions and limitations, as amended and/or supplemented by this Summary Order, and with applicable provisions of the *Kansas Water Appropriation Law* and the *Rules and Regulations* promulgated thereunder. Failure to comply with these provisions may result in civil penalties pursuant to K.S.A. 82a-737, as amended, and/or the suspension or revocation and dismissal of the water or appropriation right or any other enforcement actions authorized by law.

**Administrative Appeal and Effective Date of Order**

If you are aggrieved by this order, pursuant to K.S.A. 82a-1901, you may request an evidentiary hearing before the Chief Engineer or request administrative review by the Secretary of Agriculture. A request for hearing by the Chief Engineer must be filed within **15 days** of service of this Order and a request for administrative review by the Secretary must be filed within **30 days** pursuant to K.S.A. 77-531. Any request for administrative review must state a basis for review pursuant to K.S.A. 77-527. File any request with **Kansas Department of Agriculture, Legal Division, 1320 Research Park Drive, Manhattan, KS 66502**. Failure to timely request a hearing or review may preclude review under the Kansas Judicial Review Act.

*For Use by Register of Deeds*

FOR OFFICE USE ONLY  
**APPLICATION APPROVED AND SUMMARY ORDER ISSUED**

By: [Signature]  
Duly Authorized Designee of the Chief Engineer  
(Print Name): Mark Brewster  
Division of Water Resources - Kansas Department of Agriculture  
Date of Issuance: 12/24/19  
State of Kansas )  
County of ROOKS ) SS  
Acknowledged before me on 12-24-19  
by Mark Billinger  
Signature: [Signature]  
Notary Public

My commission expires 6-29-23

