

Kansas Department of Agriculture / Division of Water Resources
Stockton Field Office

TO: HEADQUARTERS

RE Vested Right; Water Right; Appropriation of Water; Application

File No(s). 8,718 + 4595 County DC

Enclosed are the following checked items:

A _____ FIR Full Partial Inspection Return to Field Office
 Proposed Certificate to deliver to Certificate Unit

Meter Order: GMD#4
 Lower Smoky.
 Other _____

A Compliance Check Inspection on _____
 Meter Install New App Chg App Other _____
 In Compliance Not in Compliance, why _____

Modify Point of Diversion No Yes, document attached

Indicate all overlapping p/d files _____

- An application and judgment sheet with recommendation.
- A memorandum dated _____
- A request for an extension of time to perfect or complete.
- A verified report.
- A closure request.
- A field investigation report-
- Notice of Non-Compliance _____

Violation _____ Date _____

- An ownership change (name(s) and address(es) below).
- A water use report for _____
- A letter dated _____

A copy of an Approval to Change the place of use and/or point of diversion. (File 8,718 only)
 Filing Fee attached. \$3005
\$100.00

An Advanced copy of a change application and the filing fee, to be processed at the field office.

An original field office change application and the filing fee needing headquarters office review and further processing.

Other: Juliet Johnson Revocable Trust
8427 High Dr.
Lea wood, KS 66206-1525

Kelly A. Stewart
Water Commissioner

5-7-19
Date

Kansas Department of Agriculture
 Division of Water Resources
CHANGE: P/D P/U UMW WORKSHEET

1. File Number: 8,718	2. Status Change Date:	3. Change Num: C2	4. Field Office: 03	5. GMD:
---------------------------------	------------------------	-----------------------------	-------------------------------	---------

6. Status: <input checked="" type="checkbox"/> Approved <input type="checkbox"/> Denied by DWR/GMD <input type="checkbox"/> Dismiss by Request/Failure to Return	7. Filing Date of Change:
--	---------------------------

8a. Applicant(s) Person ID _____
 New to system Add Seq# _____

RICK & JULIE JOHNSON
8427 HIGH DR
LEAWOOD, KS 66206

8c. Landowner(s) Person ID _____
 New to system Add Seq# _____

8b. Landowner(s) Person ID _____
 New to system Add Seq# _____

RICK & JULIE JOHNSON
8427 HIGH DR
LEAWOOD, KS 66206

8d. WUC Person ID _____
 New to system Add Seq# _____

RICK & JULIE JOHNSON
8427 HIGH DR
LEAWOOD, KS 66206

9. Documents and Enclosure(s): DWR Meter(s) Date to Comply: 12/31/19 N & P Date to Comply: 3/1/20

Anti-Reverse Meter Meter Seal Check Valve N & P Form Water Tube Driller Copy H & E Letter

Conservation Plan Date Required: _____ Date Approved: _____ Date to Comply: _____

10. Use Made of Water From: _____ To: _____

Date Prepared: **5/7/19** By: **BILLINGER**
 Date Entered: _____ By: _____

File No. **8718** 11. County: DC Basin: SAPPA CREEK Stream: Formation Code: 113 Special Use: RRC-SAPPA C

12. Points of Diversion										Rate and Quantity							
CHK	MOD	DEL	ENT	PDIV	Qualifier	S	T	R	ID	'N	'W	Comment (AKA Line)	Authorized		Additional		Overlap PD Files
													Rate gpm	Quantity af	Rate gpm	Quantity af	
CHK	696				NW NE SW	16	3S	29W	1	2600	3360		460	135	460	135	
DEL	49023				NE SW NE	21	3S	29W	2	3530	1700		1000	113	1000	113	
ENT	NEW				NE SW NE	21	3S	29W	NEW	3580	1700		1000	113	1000	113	

13. Storage: Rate _____ NF Quantity _____ ac/ft Additional Rate _____ NF Additional Quantity _____ ac/ft

14. Limitation: _____ af/yr at _____ gpm (_____ cfs) when combined with file number(s) _____
 Limitation: _____ af/yr at _____ gpm (_____ cfs) when combined with file number(s) _____

15. 5YR Allocation: Allocation Type _____ Start Year _____ 5 YR Amount _____ Amount Unit _____ Base Acres _____ Comment _____

16. Place of Use																		Total	Owner	Chg?	Overlap Files								
CHK	MOD	DEL	ENT	PUSE	S	T	R	ID		NE¼				NW¼								SW¼				SE¼			
										NE ¼	NW ¼	SW ¼	SE ¼	NE ¼	NW ¼	SW ¼	SE ¼	NE ¼	NW ¼	SW ¼	SE ¼	NE ¼	NW ¼	SW ¼	SE ¼				
CHK	11254	16	3S	29W	1									39	1	9	20									69	8b.	Y	4595
CHK	884	21	3S	29W	1					27	20	40	30	37	5	6	23									188	8b.	Y	4595

Base Acres: Year: Minimum Reasonable Quantity:

Comments:

Stockton Field Office
820 S. Walnut
Stockton, KS 67669-0192



Phone: 785-425-6787
Fax: 785-425-6842
www.agriculture.ks.gov

Mike Beam, Secretary

Laura Kelly, Governor

May 7, 2019

Julia A. Johnson Rev. Trust
8427 High Dr.
Leaewood, KS 66206-1525

Re: Water Right, File No. 8,718

Dear Ms. Johnson:

Enclosed is the order executed by David W. Barfield, Chief Engineer, Division of Water Resources, Kansas Department of Agriculture, approving the application for change under the above referenced file number.

Your attention is directed to the terms, conditions, and limitations specified in this approval for change. Also, the approval of the order requires the installation of a water flow meter(s) on the point(s) of diversion authorized under the above referenced file number by **December 31, 2019**. Please complete and return the enclosed Notice of Completion of Diversion Works when a water flow meter has been installed. A copy of the Chief Engineer's specifications for the water flow meters are found in K.A.R. 5-1-4 through K.A.R. 5-1-12 along with a partial list of those flow meters found to be acceptable for installation in Kansas can be found on our website at the following web address:

<http://agriculture.ks.gov/meters>

Please note that all meters must be installed and maintained in accordance with the specifications for water flow meters referenced above.

The abandoned water well must be plugged in accordance with the requirements of Article 30 of the Rules and Regulations as adopted by the Kansas Department of Health and Environment (KDHE). If the well is to be retained by the landowner for other purposes, a copy of the legal transfer of responsibility for maintenance of the well must be forwarded to KDHE Geology Section, 1000 SW Jackson, Suite 420, Topeka, Kansas 66612, telephone number (785) 296-5524. More information is available online at: <http://kdheks.gov/waterwell>

Since this order modifies the original certificate, it should be recorded with the Register of Deeds just as other legal documents affecting real estate. Such records are maintained at the Register of Deeds Office in the county wherein the place of use is located.

This document is a summary order by this agency regarding this matter. This order shall become final if a request for a hearing is not filed with the Chief Engineer within 15 days of the date of service of this order.

(over)

If you have any questions, please feel free to contact this office at (785)425-6787. If you wish to refer to a specific file, please reference it when you contact us.

Sincerely,



Mark Billinger
Assistant Water Commissioner

MB:rfh
Enclosures

CERTIFICATE OF SERVICE

On this 7th day of May, 2019, I hereby certify that the attached **SUMMARY ORDER APPROVING APPLICATION FOR CHANGE in POINT OF DIVERSION** for water right, File No. 8,718, dated on the 7th day of May, 2019, was mailed postage prepaid, first class, U.S. mail, to the following:

Julia A. Johnson Rev. Trust
8427 High Dr.
Leawood, KS 66206-1525

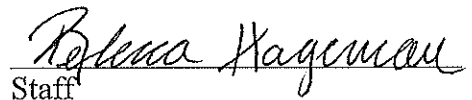

Staff

Submit completed application to:
 Kansas Department of Agriculture
 Division of Water Resources
 Field Office for your area.

Call for address:

Topeka -- (785) 296-5733
 Stafford -- (620) 234-5311
 Stockton -- (785) 425-6787
 Garden City -- (620) 276-2901
<http://agriculture.ks.gov/dwr>

DWR FIELD OFFICE APPLICATION FOR APPROVAL TO CHANGE THE PLACE OF USE AND/OR THE POINT OF DIVERSION



WATER METER REQUIRED

STATE OF KANSAS

APPLICATION COMPLETE

5/6/19

Reviewer MB

**Filing Fee Must Accompany the Application, K.S.A. 82a-708b(b), as amended.
 Fee Schedule is on the third page of this application form.**

Paragraph Nos. 1, 2, 3 & 5 must be completed. Complete all other applicable portions. If change in point of diversion is greater than 100 feet, or if place of use will be changed, include a topographic map or detailed plat showing the authorized and proposed point(s) of diversion and/or place of use.

RECEIVED

File No. 8718

MAY 06 2019
 3:46 p.m.
 Stockton Field Office
 Division of Water Resources

1. Application is hereby made for approval of the Chief Engineer to change the (check one or both):

Place of Use Point of Diversion

under the water right which is the subject of this application in accordance with the conditions described below.

The source of supply is: Groundwater Surface water

2. Name and address of Applicant: Rick and Julie Johnson, 8427 High Dr.,

Leawood, KS 66206

Phone Number: (785)475-4482 Email address: _____

Name and address of Water Use Correspondent: Rick and Julie Johnson, 8427 High Dr.,

Leawood, KS 66206

Phone Number: () _____ Email address: _____

3. The presently authorized place of use is:

Owner of Land ---- NAME: Rick and Julie Johnson

ADDRESS: 8427 High Dr., Leawood, KS 66206

(If there is more than one landowner, attach supplemental sheets as necessary.)

Sec.	Twp.	Range	NE¼				NW¼				SW¼				SE¼				TOTAL ACRES
			NE¼	NW¼	SW¼	SE¼	NE¼	NW¼	SW¼	SE¼	NE¼	NW¼	SW¼	SE¼	NE¼	NW¼	SW¼	SE¼	
16	03S	29W									39	01	09	20					69
21	03S	29W	27	20	40	30	37	05	06	23									188

4. If this application is for a change in place of use, it is proposed that the place of use be changed to:

Owner of Land ---- NAME: _____

ADDRESS: _____

(If there is more than one landowner, attach supplemental sheets as necessary.)

Sec.	Twp.	Range	NE¼				NW¼				SW¼				SE¼				TOTAL ACRES
			NE¼	NW¼	SW¼	SE¼	NE¼	NW¼	SW¼	SE¼	NE¼	NW¼	SW¼	SE¼	NE¼	NW¼	SW¼	SE¼	

For Office Use Only: Code _____ Fee \$ _____ TR # _____ Receipt Date _____ Check # _____

5. **Presently authorized point of diversion:**
 One in the NE Quarter of the SW Quarter of the NE Quarter of Section 21, Township 03 South, Range 29 W, in Decatur County, Kansas, 3530 feet North 1700 feet West of Southeast corner of section. Authorized Rate 1000 GPM Authorized Quantity 113AF Depth of well _____ (feet)
 (DWR use only: Computer ID No. 2 GPS 3530 feet North 1700 feet West)
 This point will not be changed This point will be changed as follows: No change, point better described with GPS as follows:
Proposed point of diversion: (Complete only if change is requested or if existing point is better described by GPS)
 One in the NE Quarter of the SW Quarter of the NE Quarter of Section 21, Township 03 South, Range 29 W, in Decatur County, Kansas, 3580 feet North 1700 feet West of Southeast corner of section. Proposed Rate 1000 GPM Proposed Quantity 113 AF Proposed well depth (feet) _____
 This point is: Additional Well Geo Center List other water rights that will use this point _____

6. **Presently authorized point of diversion:**
 One in the NW Quarter of the NE Quarter of the SW Quarter of Section 16, Township 3 South, Range 29 (E/W), in DC County, Kansas, 2600 feet North 3360 feet West of Southeast corner of section. Authorized Rate 460 GPM Authorized Quantity 135 AF Depth of well _____ (feet)
 (DWR use only: Computer ID No. 1 GPS _____ feet North _____ feet West)
 This point will not be changed This point will be changed as follows: No change, point better described with GPS as follows:
Proposed point of diversion: (Complete only if change is requested or if existing point is better described by GPS)
 One in the _____ Quarter of the _____ Quarter of the _____ Quarter of Section _____, Township _____ South, Range _____ (E/W), in _____ County, Kansas, _____ feet North _____ feet West of Southeast corner of section. Proposed Rate _____ Proposed Quantity _____ Proposed well depth (feet) _____
 This point is: Additional Well Geo Center List other water rights that will use this point _____

7. The changes herein are desired for the following reasons?
 (please be specific) Redril of an existing well

8. If a well, is the test hole log attached? Yes No

9. The change(s) (was)(will be) completed by?

10. If the point of diversion is a well:
 (a) What are you going to do with the old well?

 (b) When will this be done? _____

11. Groundwater Management District recommendation attached? Yes No

12. Assisted by KS and SW

13a. If the proposed point of diversion will be relocated more than 300 feet but within 2,640 feet of the existing point of diversion, attach a topographic map or aerial photograph. For groundwater sources, show all wells (including domestic) within one-half mile of the proposed point of diversion and the names and mailing addresses of the owners. For surface water sources, show the names and addresses of the landowner(s) one-half mile downstream and one-half mile upstream from your property lines

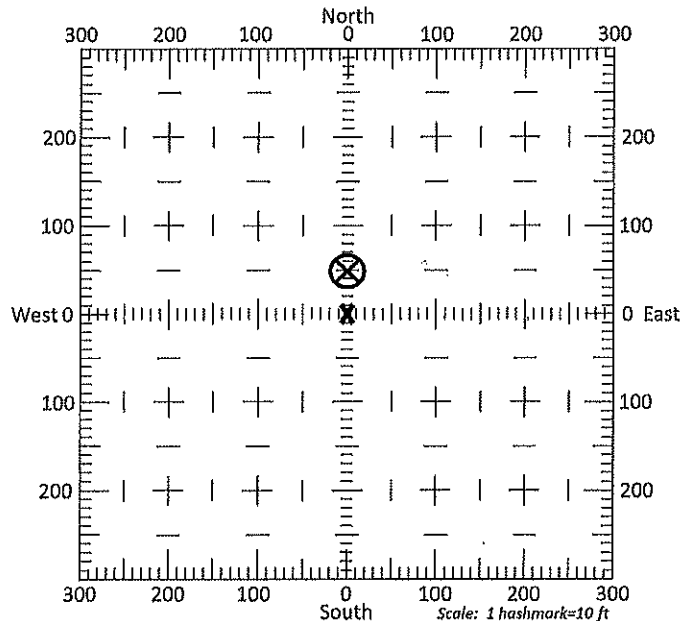

13b. If the proposed point of diversion will be relocated within 300 feet of the existing point of diversion, indicate its location on the diagram shown above in relation to the existing point of diversion. (PLEASE NOTE: The "X" in center of diagram above represents the presently authorized point of diversion.)

14. If the proposed groundwater point of diversion is 300 or fewer feet from the existing point of diversion, complete the following:

- (a) Does the undersigned represent all owners of the currently authorized place(s) of use identified in this application?
 Yes No (If no, all owners must sign this application.)
- (b) Will the ownership interest of any owner of the currently authorized place(s) of use identified in this application be adversely affected if this application is approved as requested?
 Yes No (If yes, all owners must sign this application.)
- (c) If this application is not approved expeditiously, will there be substantial damage to property, public health or safety?
 Yes No (If no, all owners must sign this application.)

If the application proposes a surface water change in point of diversion, a groundwater change in point of diversion greater than 300 feet, or a change in place of use, the application must be signed by all owners of the currently authorized place of use, or their duly authorized agent (attach notarized statement authorizing representation).

I hereby verify, being first duly sworn upon my oath or affirmation and under penalty of perjury, that I am of lawful age and the owner, the spouse of the owner, or a duly authorized agent of the owner(s) to make this application on their behalf, in regards to the water right(s) to which this application pertains. I further verify that the statements contained in this application are true, correct and complete.

Dated at PRAIRIE VILLAGE, Kansas, this 3RD day of MAY, 20 19.

Julie Johnson
 (Owner)
JULIE JOHNSON
 (Please Print)

Rick Johnson
 (Spouse)
RICK JOHNSON
 (Please Print)

(Owner)

(Spouse)

(Please Print)

(Please Print)

(Owner)

(Spouse)

(Please Print)

(Please Print)

State of Kansas
County of Johnson

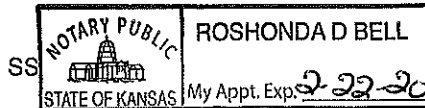

I hereby certify that the foregoing application was signed in my presence and sworn to before me this 3rd day of May, 20 19.

Roshonda D. Bell
 Notary Public

My Commission Expires 2-22-20

ONLY COMPLETE APPLICATIONS WILL BE PROCESSED. To be complete, all of the applicable portions of the application form must be completed with accurate information; maps, if necessary, must be included; signatures of all the appropriate owners' must be affixed to the application and notarized; and the appropriate fee must be paid.

FEE SCHEDULE

Each application to change the place of use or the point of diversion under this section shall be accompanied by the application fee set forth in the schedule below: Make checks payable to: **Kansas Department of Agriculture**

- (1) Application to change a point of diversion 300 feet or less \$100
- (2) Application to change a point of diversion more than 300 feet \$200
- (3) Application to change the place of use \$200

RECEIVED

MAY 06 2019

SUMMARY ORDER APPROVING APPLICATION FOR CHANGE AND IMPOSING CONDITIONS

This Summary Order is issued under authority of K.S.A. 82a-708b, as amended, and K.A.R. 5-5-1, *et seq.* and other applicable provisions of the *Kansas Water Appropriation Law*, K.S.A. 82a-701 *et seq.*, and rules and regulations promulgated thereunder, With the exception of those conditions expressly contained herein, this Summary Order does not change the terms, conditions and limitations of File No. 8718.

1. A change application was received on 5/6/19 requesting that the place of use and / or point of diversion authorized under the above-referenced file number be changed as described in the application.
2. On and after the effective date of this summary order, the authorized place(s) of use shall be located substantially as shown on the topographic map accompanying the application to change the place of use. Applicable Not Applicable
3. The change in point of diversion shall not impair existing rights and shall be limited to the same source or sources of water as previously authorized. The point of diversion authorized by this summary order shall be located within a 50 foot radius of the authorized point(s) of diversion. Applicable Not Applicable
4. The point(s) of diversion described herein is administratively corrected to be more accurately described using the Global Positioning System (GPS), as described in the application. Applicable Not Applicable
5. The point(s) of diversion authorized herein shall not actually be located more than _____ feet from the previously authorized point(s) of diversion. Applicable Not Applicable
6. As required by K.A.R. 5-3-5d, if the works for diversion is a well with a diversion rate of 100 gallons per minute or more, a tube or other device suitable for making water level measurements shall be installed, operated and maintained in accordance with K.A.R. 5-6-13. Applicable Not Applicable
7. **The owner of the authorized place(s) of use shall properly install an acceptable water flow meter on or before December 31, 20 19**, or before the first use of water, whichever occurs first. The water flow meter shall be installed, operated and maintained in accordance with K.A.R. 5-1-4 through 5-1-12. As required by K.S.A. 82a-732, as amended, and K.A.R. 5-3-5e, the owner shall maintain records and report the reading of the water flow meter and the total quantity of water diverted annually to the Chief Engineer by March 1 following the end of each calendar year. Applicable Not Applicable
8. **Installation of the works for diversion of water shall be completed on or before December 31, 20 19**, or within any authorized extension of time. By March 1, 20 20 the applicant shall notify the Chief Engineer that construction of the works for diversion has been completed, on the form provided by the Chief Engineer, as required by K.A.R. 5-8-4e. Applicable Not Applicable
9. **The completed well log shall be submitted with the required notice.** Applicable Not Applicable
10. All diversion works into which any type of chemical or other foreign substance will be injected into the water shall be equipped with an in-line, automatic, quick-closing check valve capable of preventing pollution of the source of the water supply. The check valve(s) shall be installed, operated and maintained in accordance with K.A.R. 5-3-5c. Applicable Not Applicable
11. Additional Conditions are attached. Yes No
12. In accordance with K.S.A. 82a-708a, as amended, and K.A.R. 5-5-14, all of the owners of the authorized place(s) of use of water appropriated under the above-referenced file number are responsible for compliance with its terms, conditions and limitations, as amended and/or supplemented by this Summary Order, and with applicable provisions of the *Kansas Water Appropriation Law* and the *Rules and Regulations* promulgated thereunder. Failure to comply with these provisions may result in civil penalties pursuant to K.S.A. 82a-737, as amended, and/or the suspension or revocation and dismissal of the water or appropriation right or any other enforcement actions authorized by law.

Administrative Appeal and Effective Date of Order

If you are aggrieved by this order, pursuant to K.S.A. 82a-1901, you may request an evidentiary hearing before the Chief Engineer or request administrative review by the Secretary of Agriculture. A request for hearing by the Chief Engineer must be filed within **15 days** of service of this Order and a request for administrative review by the Secretary must be filed within **30 days** pursuant to K.S.A. 77-531. Any request for administrative review must state a basis for review pursuant to K.S.A. 77-527. File any request with **Kansas Department of Agriculture, Legal Division, 1320 Research Park Drive, Manhattan, KS 66502**. Failure to timely request a hearing or review may preclude review under the Kansas Judicial Review Act.

For Use by Register of Deeds

FOR OFFICE USE ONLY
APPLICATION APPROVED AND SUMMARY ORDER ISSUED

By: [Signature]
Duly Authorized Designee of the Chief Engineer

(Print Name): Mark Billinger
Division of Water Resources - Kansas Department of Agriculture

Date of Issuance: 5/7/19

State of Kansas)
County of Rooks) SS

Acknowledged before me on 5-7-19
by Mark Billinger

Signature: Rebecca F. Hageman
Notary Public

My commission expires: 6-29-19

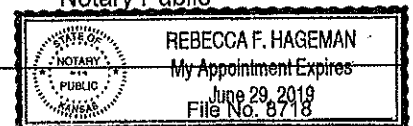

(Notary Seal)

RECEIVED

MAY 06 2019

Stockton Field Office
Division of Water Resources