

NOTICE

This scan only represents the application as filed. The information contained herein meets the requirements of K.A.R. 5-3-1 or K.A.R. 5-5-1, and has been found acceptable for filing in the office of the Chief Engineer. The application should not be considered to be a complete application as per K.A.R. 5-3-1b or K.A.R. 5-5-2a.

MAY 04 2020

12:46

KS Dept Of Agriculture

Submit To: CHIEF ENGINEER
Division of Water Resources
Kansas Department of Agriculture
1320 Research Park Drive
Manhattan, KS 66502
www.ksda.gov/dwr

**APPLICATION FOR APPROVAL TO
CHANGE THE PLACE OF USE, THE
POINT OF DIVERSION OR THE USE
MADE OF THE WATER UNDER AN
EXISTING WATER RIGHT**



State of Kansas

Filing Fee Must Accompany the Application
(Please refer to Fee Schedule on signature page of application form.)

Paragraph Nos. 1, 2, 3, 4 & 8 must be completed. Complete all other applicable portions. A topographic map or detailed plat showing the authorized and proposed points(s) of diversion and /or place of use must accompany this application.

1. Application is hereby made for approval of the Chief Engineer to change the

- Place of Use
- (Check one or more) Point of Diversion
- Use Made of Water

File No. TH003

2. Name of applicant: City of Brewster - Attn: Mike Schultz

Address: PO Box 147

City, State and Zip: Brewster, KS 67732

Phone Number: (785)694-2205 E-mail address: brewsterks@st-tel.net

What is your relationship to the water right; owner tenant agent other? If other, please explain. _____

Name of water use correspondent: City of Brewster - Attn: Mike Schultz

Address: PO Box 147

City, State and Zip: Brewster, KS 67732

Phone Number: (785)694-2205 E-mail address: brewsterks@st.tel.net

3. The change(s) proposed herein are desired for the following reasons (please be specific): Currently authorized well is contaminated; moving to a new location in order to fully utilize this vested right.

The change(s) (was) (will be) completed by 12/31/21 (Date)

For Office Use Only:															
F.O. Code	<u>3</u>	GMD	<u>4</u>	Meets K.A.R. 5-5-1	<input checked="" type="checkbox"/> YES / <input type="checkbox"/> NO	Use	<u>MUN</u>	Source	<input checked="" type="checkbox"/> G / <input type="checkbox"/> S	County	<u>TH</u>	By	<u>BMM</u>	Date	<u>5/5/20</u>
Fee \$	<u>2000</u>	TR #		Receipt Date	<u>5/1/2020</u>	Check #	<u>26581</u>								

5/6/2020
LMoody

4. The presently authorized place of use is:

Owner of Land — NAME: No change requested.

ADDRESS: _____

Sec.	Twp.	Range	NE¼				NW¼				SW¼				SE¼				TOTAL ACRES
			NE¼	NW¼	SW¼	SE¼	NE¼	NW¼	SW¼	SE¼	NE¼	NW¼	SW¼	SE¼	NE¼	NW¼	SW¼	SE¼	

List any other water rights that cover this place of use. _____

Owner of Land — NAME: _____

ADDRESS: _____

Sec.	Twp.	Range	NE¼				NW¼				SW¼				SE¼				TOTAL ACRES
			NE¼	NW¼	SW¼	SE¼	NE¼	NW¼	SW¼	SE¼	NE¼	NW¼	SW¼	SE¼	NE¼	NW¼	SW¼	SE¼	

List any other water rights that cover this place of use. _____

(If there are more than two landowners, attach additional sheets as necessary.)

Water Resources
Received

MAY 04 2020

5. It is proposed that the place of use be changed to:

Owner of Land — NAME: _____

ADDRESS: _____

KS Dept Of Agriculture

Sec.	Twp.	Range	NE¼				NW¼				SW¼				SE¼				TOTAL ACRES
			NE¼	NW¼	SW¼	SE¼	NE¼	NW¼	SW¼	SE¼	NE¼	NW¼	SW¼	SE¼	NE¼	NW¼	SW¼	SE¼	

List any other water rights that cover this place of use. _____

Owner of Land — NAME: _____

ADDRESS: _____

Sec.	Twp.	Range	NE¼				NW¼				SW¼				SE¼				TOTAL ACRES
			NE¼	NW¼	SW¼	SE¼	NE¼	NW¼	SW¼	SE¼	NE¼	NW¼	SW¼	SE¼	NE¼	NW¼	SW¼	SE¼	

List any other water rights that cover this place of use. _____

IF MORE SPACE IS NEEDED, ATTACH ADDITIONAL SHEETS AS NECESSARY

- 6. The presently authorized point(s) of diversion is one well
(Provide description and number of points)
- 7. The proposed point(s) of diversion is one well
(Provide description and number of points)

List all presently authorized point(s) of diversion:

8. **Presently authorized point of diversion:**
 One in the SE Quarter of the NE Quarter of the NE Quarter of Section 18, Township 8 South, Range 36 W, in Thomas County, Kansas, 4,580 feet North 362 feet West of Southeast corner of section.
 Authorized Rate 250 gpm Authorized Quantity 55 AF
 (DWR use only: Computer ID No. 3 GPS feet North feet West)
 This point will not be changed This point will be changed as follows:
Proposed point of diversion: (Complete only if change is requested)
 One in the SE Quarter of the SW Quarter of the SW Quarter of Section 7, Township 8 South, Range 36 W, in Thomas County, Kansas, 162 feet North 4,120 feet West of Southeast corner of section.
 Proposed Rate 250 gpm Proposed Quantity 55 AF
 This point is: Additional Well Geo Center List other water rights that will use this point 10738

9. **Presently authorized point of diversion:**
 One in the Quarter of the Quarter of the Quarter of Section , Township South, Range W, in County, Kansas, feet North feet West of Southeast corner of section.
 Authorized Rate Authorized Quantity
 (DWR use only: Computer ID No. GPS feet North feet West)
 This point will not be changed This point will be changed as follows:
Proposed point of diversion: (Complete only if change is requested)
 One in the Quarter of the Quarter of the Quarter of Section , Township South, Range W, in County, Kansas, feet North feet West of Southeast corner of section.
 Proposed Rate Proposed Quantity
 This point is: Additional Well Geo Center List other water rights that will use this point

10. **Presently authorized point of diversion:**
 One in the Quarter of the Quarter of the Quarter of Section , Township South, Range W, in County, Kansas, feet North feet West of Southeast corner of section.
 Authorized Rate Authorized Quantity
 (DWR use only: Computer ID No. GPS feet North feet West)
 This point will not be changed This point will be changed as follows:
Proposed point of diversion: (Complete only if change is requested)
 One in the Quarter of the Quarter of the Quarter of Section , Township South, Range W, in County, Kansas, feet North feet West of Southeast corner of section.
 Proposed Rate Proposed Quantity
 This point is: Additional Well Geo Center List other water rights that will use this point

Water Resources
 Received
 MAY 04 2020
 KS Dept Of Agriculture

- 11. Describe the current condition of and future plans for any point(s) of diversion which will no longer be used. Current p/d will still be authorized under water right file no. 22,231.

IF MORE SPACE IS NEEDED, ATTACH ADDITIONAL SHEETS AS NECESSARY

12. The presently authorized use of water is for MUN purposes.
It is proposed that the use be changed to no change purposes.

13. If changing the place of use and/or use made of water, describe how the consumptive use will not be increased.

n/a

Water Resources
Received

MAY 04 2020

KS Dept Of Agriculture

(Please show any calculations here.)

14. It is requested that the maximum annual quantity of water be reduced to n/a (acre-feet or million gallons).

15. It is requested that the maximum rate of diversion of water be reduced to n/a gallons per minute (____ c.f.s.).

16. The application must include either a topographic map or detailed plat. A U.S. Geological Survey Topographic Map, scale 1:24,000, is available through the Kansas Geological Survey, 1930 Constant Avenue, University of Kansas, Lawrence, Kansas 66047-3726 (www.usgs.gov). The map should show the location of the presently authorized point(s) of diversion. Distances North and West of the Southeast corner of the section must be shown. The presently authorized place of use should also be shown. Identify the center of the section, the section lines and the section corners and show the appropriate section, township, and range numbers on the map. In addition the following information must also be shown on the map.

a. If a change in the location of the point(s) of diversion is proposed, show:

- 1) The location of the proposed point(s) of diversion. Distances North and West of the Southeast corner of the section must be shown. Please be certain that the information shown on the map agrees with the information shown in Paragraph Nos. 9, 10 and 11 of the application.
- 2) If the source of supply is groundwater, please show the location of existing water wells of any kind, including domestic wells, within 1/2 mile of the proposed well or wells. Identify each well as to its use and furnish name and mailing address of the property owner or owners. If there are no wells within 1/2 mile, please indicate so on the map.
- 3) If the source of supply is surface water, the names and mailing addresses of all landowner(s) 1/2 mile downstream and 1/2 mile upstream from your property lines must be shown.

b. If a change in the place of use is desired, show the proposed place of use by crosshatching on the map. Please be certain that the information shown on the map agrees with the information shown in Paragraph No. 5 of the application.

17. Attach documentation to show the change(s) proposed herein will not impair existing water rights and relates to the same local source of supply as to which the water right relates. This information may include statements, plats, geology reports, well logs, test hole logs, and other information as necessary information to show the above. Additional comments may be made below.

Proposed change meets GMD4 Reg 5-24-2 (c)(1)(B). The current p/d authorizes TH003, 10738, & 22231. TH003 and 10738 are going to move to the same new well. 22231 will stay at the current p/d. This is not requiring an additional well as TH003 previously authorized 2 wells and 10738 was previously authorized as an irrigation well before it was moved to the existing well covered by 22231.

18. If the proposed change(s) does not meet all applicable rules and regulations of the Kansas Water Appropriation Act, please identify the rules and regulations for which you request a waiver. State the reason why a waiver is needed and why the request should be granted. Attach documentation showing that granting the request will not impair existing water rights and will not prejudicially and unreasonably affect the public interest.

All regs met.

IF MORE SPACE IS NEEDED, ATTACH ADDITIONAL SHEETS AS NECESSARY

Any use of water that is not as authorized by the water right or permit to authorize water before the chief engineer approves this application is a violation of the Kansas Water Appropriation Act for which criminal or civil penalties may be assessed. Such violation is a class C misdemeanor punishable by a fine not to exceed \$500 and/or a term of confinement not to exceed one month in the county jail. K.S.A. 82a-728(b). Civil penalties shall be not less than \$100 nor more than \$1,000 per violation. In the case of a continuing violation, each day such violation continues may be deemed a separate violation. In addition to these penalties the water right may be modified or suspended. K.S.A. 82a-737, as amended.

The application must be signed by all owners of the place of use authorized under the water right and his or her spouse, if married. Please indicate if there is no spouse. If land is being purchased under contract, the seller must sign as landowner until such time as the contract is completed.

In the event that all applicants cannot appear before one notary public, they may as necessary sign separate copies of the application before any notary public conveniently available to them. All copies signed in this manner shall be considered to be valid parts of the application.

If the request is signed on behalf of any Owner by someone with legal authority to do so (for example, an agent, one who has power of attorney, or an executor, executrix, conservator), it will be necessary to attach proper documents showing such authority.

I declare that I am an owner of the currently authorized place of use as identified herein, or that I represent all such owners and am authorized to make this application on their behalf, and declare further that the statements contained herein are true, correct, and complete. By filing this application I authorize the chief engineer to permanently reduce the quantity of water and/or rate of diversion as specified in sections 14 and 15 of this application.

Dated at Brewster, Kansas, this 27 day of April, 2020.

City of Brewster by Michael L. Schulte City Supt. (Owner) _____ (Spouse)

City of BREWSTER by MICHAEL L. SCHULTE City Supt. (Please Print) _____ (Please Print)

(Owner) _____ (Spouse)

(Please Print) _____ (Please Print)

(Owner) _____ (Spouse)

(Please Print) _____ (Please Print)

State of Kansas }
County of Thomas } SS

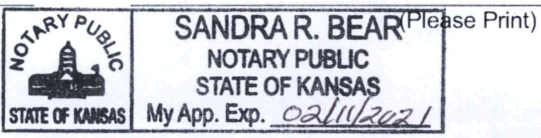

I hereby certify that the foregoing application was signed in my presence and sworn to before me this 27th day of April, 2020

Sandra R. Bear
Notary Public

My Commission Expires 02/11/2021

FEE SCHEDULE

Each application to change the place of use, the point of diversion or the use made of the water under this section shall be accompanied by the application fee set forth in the schedule below:

- (1) Application to change a point of diversion 300 feet or less \$100
- (2) Application to change a point of diversion more than 300 feet \$200
- (3) Application to change the place of use \$200
- (4) Application to change the use made of the water \$300

Make check payable to **Kansas Department of Agriculture.**

Water Resources
Received
MAY 04 2020
KS Dept Of Agriculture

Application for Change in Point of Diversion Vested Right, File No. TH003

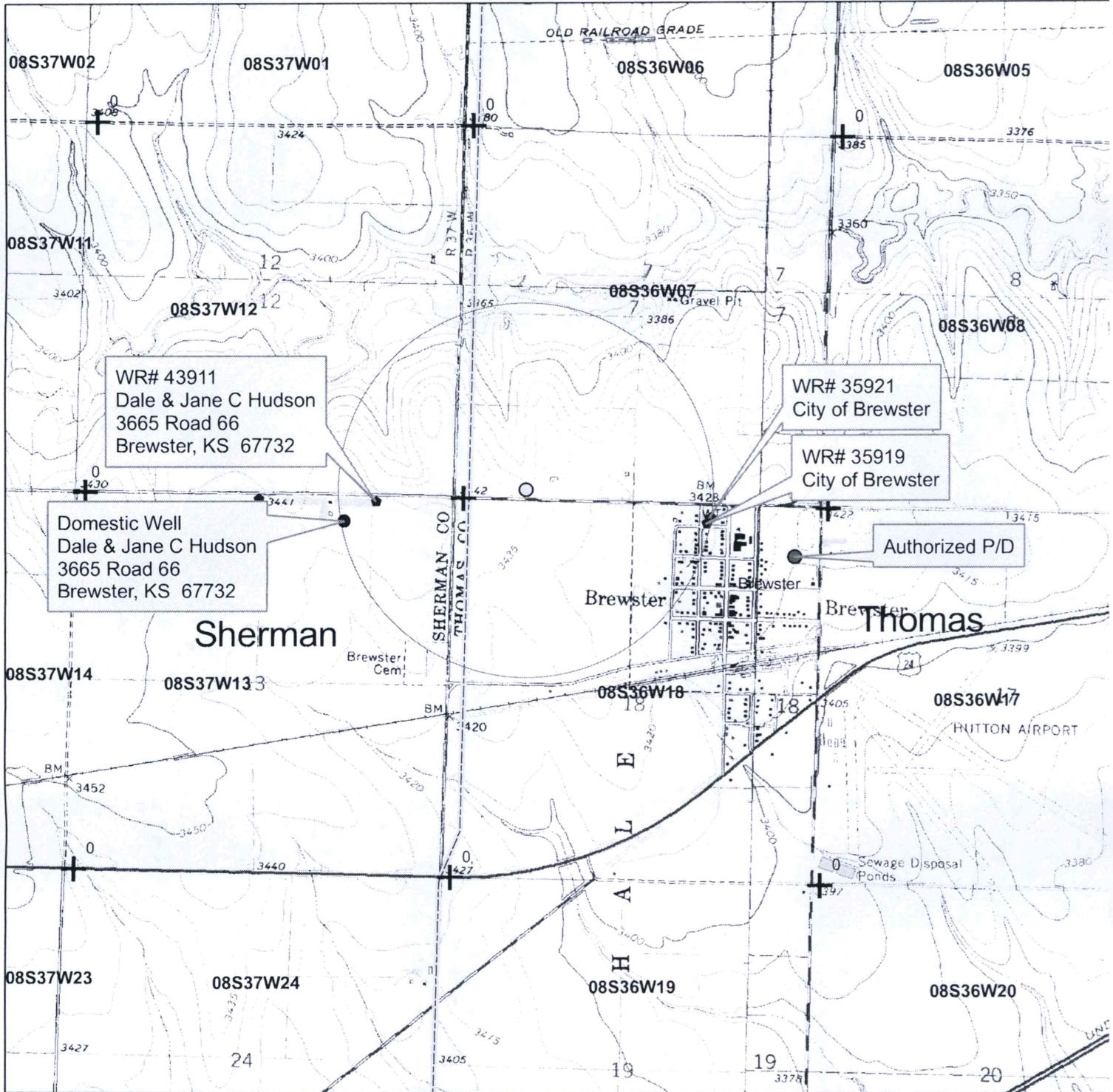

- + Section Corners
- Authorized Point of Diversion
- Proposed Point of Diversion
- 1/2 mile radius

The names and addresses of the owners of all wells of any kind within 1/2 mile of the proposed point of diversion are shown.

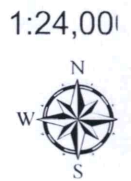

Signature Required