

Submit completed application to:
 Kansas Department of Agriculture
 Division of Water Resources
 Field Office for your area.
 Call for address:

Topeka -- (785) 296-5733
 Stafford -- (620) 234-5311
 Stockton -- (785) 425-6787
 Garden City -- (620) 276-2901
<http://agriculture.ks.gov/dwr>

DWR FIELD OFFICE APPLICATION FOR APPROVAL TO CHANGE THE PLACE OF USE AND/OR THE POINT OF DIVERSION



STATE OF KANSAS

Filing Fee Must Accompany the Application, K.S.A. 82a-708b(b), as amended.
 Fee Schedule is on the third page of this application form.

Paragraph Nos. 1, 2, 3 & 5 must be completed. Complete all other applicable portions. If change in point of diversion is greater than 100 feet, or if place of use will be changed, include a topographic map or detailed plat showing the authorized and proposed point(s) of diversion and/or place of use.

RECEIVED

APR 01 2021
 3:30 pm

Stockton Field Office
 Division of Water Resources

File No. 2,147

1. Application is hereby made for approval of the Chief Engineer to change the (check one or both):

Place of Use Point of Diversion

under the water right which is the subject of this application in accordance with the conditions described below.

The source of supply is: Groundwater Surface water

2. Name and address of Applicant: BRADLEY B & ANN M COX

1439 W GRANITE RD LONG ISLAND, KS 67647

Phone Number: () _____ Email address: _____

Name and address of Water Use Correspondent: SAME AS APPLICANT

Phone Number: () _____ Email address: _____

3. The presently authorized place of use is:

Owner of Land ---- NAME: BRADLEY B & ANN M COX

ADDRESS: 1439 W GRANITE RD LONG ISLAND, KS 67647

(If there is more than one landowner, attach supplemental sheets as necessary.)

Sec.	Twp.	Range	NE¼				NW¼				SW¼				SE¼				TOTAL ACRES
			NE¼	NW¼	SW¼	SE¼	NE¼	NW¼	SW¼	SE¼	NE¼	NW¼	SW¼	SE¼	NE¼	NW¼	SW¼	SE¼	
32	1S	20W											4	12					16
32	1s	20w													38	22	19	40	119

4. If this application is for a change in place of use, it is proposed that the place of use be changed to:

Owner of Land ---- NAME: no change

ADDRESS: _____

(If there is more than one landowner, attach supplemental sheets as necessary.)

Sec.	Twp.	Range	NE¼				NW¼				SW¼				SE¼				TOTAL ACRES
			NE¼	NW¼	SW¼	SE¼	NE¼	NW¼	SW¼	SE¼	NE¼	NW¼	SW¼	SE¼	NE¼	NW¼	SW¼	SE¼	

For Office Use Only: Code _____ Fee \$ _____ TR # _____ Receipt Date _____ Check # _____

APR 01 2021

5. Presently authorized point of diversion:

One in the NE Quarter of the SW Quarter of the SE Quarter of Section 32, Township 1 South, Range 20 W, in PL County, Kansas, 2290 feet North 1550 feet West of Southeast corner of section. Authorized Rate 1000 GPM Authorized Quantity 119 AF Depth of well (feet)

(DWR use only: Computer ID No. 1 GPS feet North feet West)

This point will not be changed This point will be changed as follows: No change, point better described with GPS as follows:

Proposed point of diversion: (Complete only if change is requested or if existing point is better described by GPS)

One in the NC Quarter of the SE Quarter of the SW Quarter of Section 32, Township 1 South, Range 20 W, in PL County, Kansas, 720 feet North 3160 feet West of Southeast corner of section. Proposed Rate 1000 GPM Proposed Quantity 119 AF Proposed well depth (feet)

This point is: Additional Well Geo Center List other water rights that will use this point 5,249

6. Presently authorized point of diversion:

One in the NW Quarter of the SW Quarter of the SE Quarter of Section 32, Township 1 South, Range 20 W, in PL County, Kansas, 1110 feet North 2250 feet West of Southeast corner of section. Authorized Rate Authorized Quantity Depth of well (feet)

(DWR use only: Computer ID No. 2 GPS feet North feet West)

This point will not be changed This point will be changed as follows: No change, point better described with GPS as follows:

Proposed point of diversion: (Complete only if change is requested or if existing point is better described by GPS)

One in the Quarter of the Quarter of the Quarter of Section Township South, Range (E/W), in County, Kansas, feet North feet West of Southeast corner of section. Proposed Rate Proposed Quantity Proposed well depth (feet)

This point is: Additional Well Geo Center List other water rights that will use this point

7. The changes herein are desired for the following reasons? (please be specific) TO REDUCE TO ONE PUMPSITE OLAPPED WITH 5249.

8. If a well, is the test hole log attached? Yes No

9. The change(s) (was)(will be) completed by? UPON APPROVAL

10. If the point of diversion is a well: (a) What are you going to do with the old well? (b) When will this be done?

11. Groundwater Management District recommendation attached? Yes No

12. Assisted by M BILLINGER

13a. If the proposed point of diversion will be relocated more than 300 feet but within 2,640 feet of the existing point of diversion, attach a topographic map or aerial photograph.

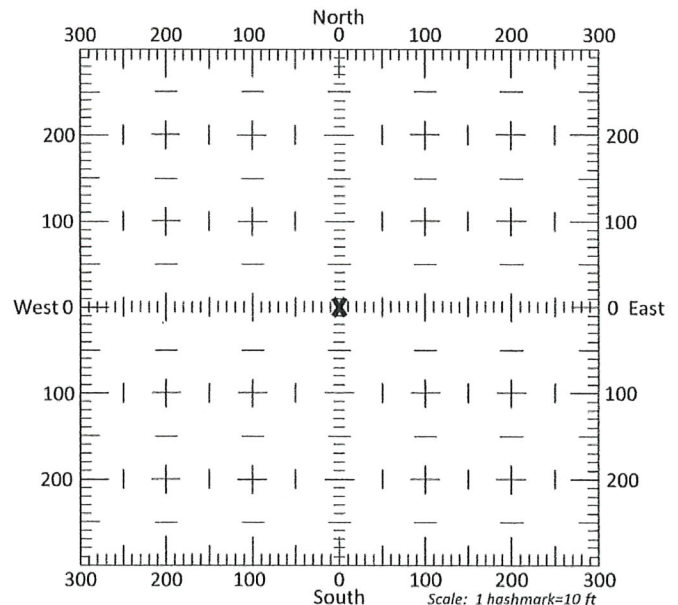

13b. If the proposed point of diversion will be relocated within 300 feet of the existing point of diversion, indicate its location on the diagram shown above in relation to the existing point of diversion. (PLEASE NOTE: The "X" in center of diagram above represents the presently authorized point of diversion.)

APPLICATION FOR APPROVAL TO CHANGE THE PLACE OF USE AND/OR POINT OF DIVERSION SUPPLEMENTAL SHEET FILE NO. 2,147

Stockton Field Office Division of Water Resources

Presently authorized point of diversion: One in the SW Quarter of the SE Quarter of the SW Quarter of Section 32, Township 1 South, Range 20 W, in PL County, Kansas, 400 feet North 3465 feet West of Southeast corner of section. Authorized Rate Authorized Quantity Depth of well (feet) (DWR use only: Computer ID No. 3 GPS feet North feet West) [] This point will not be changed [X] This point will be changed as follows: [] No change, point better described with GPS as follows: Proposed point of diversion: (Complete only if change is requested or if existing point is better described by GPS) One in the Quarter of the Quarter of the Quarter of Section Township South, Range W, in County, Kansas, feet North feet West of Southeast corner of section. Proposed Rate Proposed Quantity Proposed well depth (feet) This point is: [] Additional Well [] Geo Center List other water rights that will use this point

Presently authorized point of diversion: One in the Quarter of the Quarter of the Quarter of Section Township South, Range W, in County, Kansas, feet North feet West of Southeast corner of section. Authorized Rate Authorized Quantity Depth of well (feet) (DWR use only: Computer ID No. GPS feet North feet West) [] This point will not be changed [] This point will be changed as follows: [] No change, point better described with GPS as follows: Proposed point of diversion: (Complete only if change is requested or if existing point is better described by GPS) One in the Quarter of the Quarter of the Quarter of Section Township South, Range W, in County, Kansas, feet North feet West of Southeast corner of section. Proposed Rate Proposed Quantity Proposed well depth (feet) This point is: [] Additional Well [] Geo Center List other water rights that will use this point

Presently authorized point of diversion: One in the Quarter of the Quarter of the Quarter of Section Township South, Range (E/W), in County, Kansas, feet North feet West of Southeast corner of section. Authorized Rate Authorized Quantity Depth of well (feet) (DWR use only: Computer ID No. GPS feet North feet West) [] This point will not be changed [] This point will be changed as follows: [] No change, point better described with GPS as follows: Proposed point of diversion: (Complete only if change is requested or if existing point is better described by GPS) One in the Quarter of the Quarter of the Quarter of Section Township South, Range (E/W), in County, Kansas, feet North feet West of Southeast corner of section. Proposed Rate Proposed Quantity Proposed well depth (feet) This point is: [] Additional Well [] Geo Center List other water rights that will use this point

Presently authorized point of diversion: One in the Quarter of the Quarter of the Quarter of Section Township South, Range (E/W), in County, Kansas, feet North feet West of Southeast corner of section. Authorized Rate Authorized Quantity Depth of well (feet) (DWR use only: Computer ID No. GPS feet North feet West) [] This point will not be changed [] This point will be changed as follows: [] No change, point better described with GPS as follows: Proposed point of diversion: (Complete only if change is requested or if existing point is better described by GPS) One in the Quarter of the Quarter of the Quarter of Section Township South, Range (E/W), in County, Kansas, feet North feet West of Southeast corner of section. Proposed Rate Proposed Quantity Proposed well depth (feet) This point is: [] Additional Well [] Geo Center List other water rights that will use this point

Application to Change the Point of Diversion
For Water Right File # 2,147

APR 01 2021

Stockton Field Office
Division of Water Resources

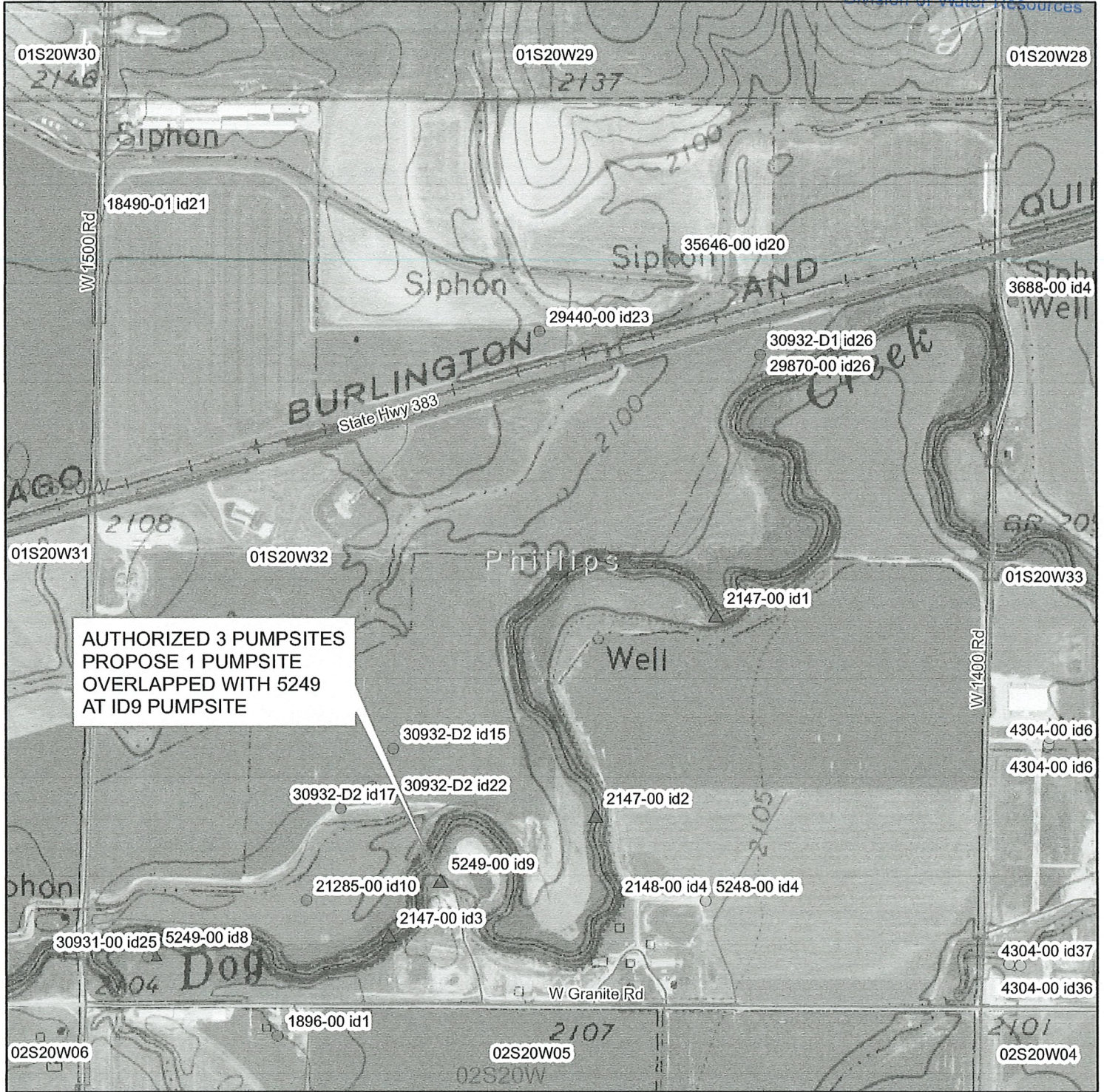

- ▲ Surface Water Point of Diversion
- Groundwater Point of Diversion

1:10,000

Signature Required

Bradley Cox

By signing this I am stating that to the best of my knowledge that all landowners within 1/2 mile upstream and 1/2 mile downstream of property boundaries are identified on an attachment to this map.

