

NOTICE

This scan only represents the application as filed. The information contained herein meets the requirements of K.A.R. 5-3-1 or K.A.R. 5-5-1, and has been found acceptable for filing in the office of the Chief Engineer. The application should not be considered to be a complete application as per K.A.R. 5-3-1b or K.A.R. 5-5-2a.

1320 Research Park Drive
Manhattan, KS 66502
785-564-6700
www. agriculture.ks.gov



900 SW Jackson, Room 456
Topeka, KS 66612
785-296-3556

Mike Beam, Secretary

Laura Kelly, Governor

2/24/2023, 3:06 PM

50976

File Number _____

This item to be completed by the Division of Water Resources.

Water Resources
Received

KS Dept Of Agriculture

**APPLICATION FOR PERMIT TO
APPROPRIATE WATER FOR BENEFICIAL USE**

Filing Fee Must Accompany the Application
(Please refer to Fee Schedule attached to this application form.)

To the Chief Engineer of the Division of Water Resources, Kansas Department of Agriculture,
1320 Research Park Drive, Manhattan, Kansas 66502:

1. Name of Applicant (Please Print): TIETJEN & SON
Address: PO BOX 116
City: BYRON State NE Zip Code 68325
Telephone Number: (402) 768-4217
2. The source of water is: surface water in REPUBLICAN RIVER (stream)
OR groundwater in _____ (drainage basin)

Certain streams in Kansas have minimum target flows established by law or may be subject to administration when water is released from storage for use by water assurance district members. If your application is subject to these regulations on the date we receive your application, you will be sent the appropriate form to complete and return to the Division of Water Resources.

3. The maximum quantity of water desired is 334 acre-feet OR _____ gallons per calendar year, to be diverted at a maximum rate of 1000 gallons per minute OR _____ cubic feet per second.

Once your application has been assigned a priority, the requested maximum rate of diversion and maximum requested quantity of water under that priority number can **NOT** be increased. Please be certain your requested maximum rate of diversion and maximum quantity of water are appropriate and reasonable for your proposed project and are in agreement with the Division of Water Resources' requirements.

4. The water is intended to be appropriated for (Check use intended):
- | | | | |
|--|--|---|---|
| (a) <input type="checkbox"/> Artificial Recharge | (b) <input checked="" type="checkbox"/> Irrigation | (c) <input type="checkbox"/> Recreational | (d) <input type="checkbox"/> Water Power |
| (e) <input type="checkbox"/> Industrial | (f) <input type="checkbox"/> Municipal | (g) <input type="checkbox"/> Stockwatering | (h) <input type="checkbox"/> Sediment Control |
| (i) <input type="checkbox"/> Domestic | (j) <input type="checkbox"/> Dewatering | (k) <input type="checkbox"/> Hydraulic Dredging | (l) <input type="checkbox"/> Fire Protection |
| (m) <input type="checkbox"/> Thermal Exchange | (n) <input type="checkbox"/> Contamination Remediation | | |

YOU **MUST** COMPLETE AND ATTACH ADDITIONAL DIVISION OF WATER RESOURCES FORM(S) PROVIDING INFORMATION TO SUBSTANTIATE YOUR REQUEST FOR THE AMOUNT OF WATER FOR THE INTENDED USE REFERENCED ABOVE.

For Office Use Only:

F.O. 3 GMD _____ Meets K.A.R. 5-3-1 (YES / NO) Use IRR Source G/S County RP By ALB Date 2/27/23
Code RE3 Fee \$ 320 TR # PY00054427 Receipt Date 2/24/23 Check # _____

3/2/2023
LMoody

5. The location of the proposed wells, pump sites or other works for diversion of water is:

Note: For the application to be accepted, the point of diversion location must be described to at least a 10 acre tract, unless you specifically request a 60 day period of time in which to locate the site within a specifically described, minimal legal quarter section of land.

(A) One in the NE quarter of the SW quarter of the NE quarter of Section 29, more particularly described as being near a point 3791 feet North and 1910 feet West of the Southeast corner of said section, in Township 01 South, Range 04 WEST, REPUBLIC County, Kansas.

(B) One in the _____ quarter of the _____ quarter of the _____ quarter of Section _____, more particularly described as being near a point _____ feet North and _____ feet West of the Southeast corner of said section, in Township _____ South, Range _____ East/West (circle one), _____ County, Kansas.

(C) One in the _____ quarter of the _____ quarter of the _____ quarter of Section _____, more particularly described as being near a point _____ feet North and _____ feet West of the Southeast corner of said section, in Township _____ South, Range _____ East/West (circle one), _____ County, Kansas.

(D) One in the _____ quarter of the _____ quarter of the _____ quarter of Section _____, more particularly described as being near a point _____ feet North and _____ feet West of the Southeast corner of said section, in Township _____ South, Range _____ East/West (circle one), _____ County, Kansas.

If the source of supply is groundwater, a separate application shall be filed for each proposed well or battery of wells, except that a single application may include up to four wells within a circle with a quarter (1/4) mile radius in the same local source of supply which do not exceed a maximum diversion rate of 20 gallons per minute per well.

A battery of wells is defined as two or more wells connected to a common pump by a manifold; or not more than four wells in the same local source of supply within a 300 foot radius circle which are being operated by pumps not to exceed a total maximum diversion rate of 800 gallons per minute and which supply water to a common distribution system.

2/24/2023

6. The owner of the point of diversion, if other than the applicant is (please print):

(name, address and telephone number) Water Resources
Received

(name, address and telephone number) KS Dept Of Agriculture

You must provide evidence of legal access to, or control of, the point of diversion from the landowner or the landowner's authorized representative. Provide a copy of a recorded deed, lease, easement or other document with this application. In lieu thereof, you may sign the following sworn statement:

I have legal access to, or control of, the point of diversion described in this application from the landowner or the landowner's authorized representative. I declare under penalty of perjury that the foregoing is true and correct.

Executed on February 21, 2023. Tietzen & Sons LLC by [Signature] President
Applicant's Signature

The applicant must provide the required information or signature irrespective of whether they are the landowner. Failure to complete this portion of the application will cause it to be unacceptable for filing and the application will be returned to the applicant.

7. The proposed project for diversion of water will consist of pond with 128.7 af storage and pumpsite out of it _____ and WILL completed (by) 2024
(number of wells, pumps or dams, etc.)
(Month/Day/Year - each was or will be completed)

8. The first actual application of water for the proposed beneficial use was or is estimated to be 2024
(Mo/Day/Year)

- 9. Will pesticide, fertilizer, or other foreign substance be injected into the water pumped from the diversion works?
 Yes No If "yes", a check valve shall be required.

All chemigation safety requirements must be met including a chemigation permit and reporting requirements.

- 10. If you are planning to impound water, please contact the Division of Water Resources for assistance, prior to submitting the application. Please attach a reservoir area capacity table and inform us of the total acres of surface drainage area above the reservoir.

Have you also made an application for a permit for construction of this dam and reservoir with the Division of Water Resources? Yes No 2/24/2023

- If yes, show the Water Structures permit number here DRP-0146 Water Resources Received
- If no, explain here why a Water Structures permit is not required _____

_____ KS Dept Of Agriculture

- 11. The application must be supplemented by a U.S.G.S. topographic map, aerial photograph or a detailed plat showing the following information. On the topographic map, aerial photograph, or plat, identify the center of the section, the section lines or the section corners and show the appropriate section, township and range numbers. Also, please show the following information:

- (a) The location of the proposed point(s) of diversion (wells, stream-bank installations, dams, or other diversion works) should be plotted as described in Paragraph No. 5 of the application, showing the North-South distance and the East-West distance from a section line or southeast corner of section.
- (b) If the application is for groundwater, please show the location of any existing water wells of any kind within 1/2 mile of the proposed well or wells. Identify each existing well as to its use and furnish the name and mailing address of the property owner or owners. If there are no wells within 1/2 mile, please advise us.
- (c) If the application is for surface water, the names and addresses of the landowner(s) 1/2 mile downstream and 1/2 mile upstream from your property lines must be shown.
- (d) The location of the proposed place of use should be shown by crosshatching on the topographic map, aerial photograph or plat.
- (e) Show the location of the pipelines, canals, reservoirs or other facilities for conveying water from the point of diversion to the place of use.

A 7.5 minute U.S.G.S. topographic map may be obtained by providing the section, township and range numbers to: Kansas Geological Survey, 1930 Constant, Campus West, University of Kansas, Lawrence, Kansas 66047.

- 12. List any application, appropriation of water, water right, or vested right file number that covers the same diversion points or any of the same place of use described in this application. Also list any other recent modifications made to existing permits or water rights in conjunction with the filing of this application.

THIS WILL COVER PLACE OF USE AUTHORIZED BY 30096 & 34083

UPON APPROVAL OF THIS APPLICATION, CHANGES OF PLACE OF USE WILL BE MADE ON

THE ABOVE TWO REFERENCED FILES TO FORM A COMPLETE OVERLAP.

THIS APPLICATION WILL HAVE A STORAGE COMPONENT OF 128.7 AF AND A DIRECT USE

COMPONENT OF 334 AF FOR IRRIGATION (1.2AF/ACRE X 278 ACRES). PU INCLUDES POND.

13. Furnish the following well information if the proposed appropriation is for the use of groundwater. If the well has not been completed, give information obtained from test holes, if available.

Information below is from: Test holes Well as completed Drillers log attached

Well location as shown in paragraph No.	(A)	(B)	(C)	(D)
Date Drilled	_____	_____	_____	_____
Total depth of well	_____	_____	_____	_____
Depth to water bearing formation	_____	_____	_____	_____
Depth to static water level	_____	_____	_____	_____
Depth to bottom of pump intake pipe	_____	_____	_____	_____

14. The relationship of the applicant to the proposed place where the water will be used is that of agent
(owner, tenant, agent or otherwise)

15. The owner(s) of the property where the water is used, if other than the applicant, is (please print):
SARAH J DERIENZO LIVING TRUST PO BOX 6493 LINCOLN, NE 68506-0493
(name, address and telephone number)

(name, address and telephone number)

16. The undersigned states that the information set forth above is true to the best of his/her knowledge and that this application is submitted in good faith.

Dated at Byron, ~~Kansas~~ ^{Nebraska}, this 21st day of February, 2023.
(month) (year)

Tietjen & Son by [Signature] President
(Applicant Signature)

2/24/2023

Water Resources
Received

KS Dept Of Agriculture

By _____
(Agent or Officer Signature)

(Agent or Officer - Please Print)

Assisted by M BILLINGER ASST WC Date: 2/16/23
(office/title)

FEE SCHEDULE

1. The fee for an application for a permit to appropriate water for beneficial use, except for domestic use, shall be (see paragraph No. 2 below if requesting storage):

ACRE-FEET	FEE
0-100	\$200.00
101-320	\$300.00
More than 320	\$300.00 plus \$20.00 for each additional 100 acre-feet or any part thereof.

2. The fee for an application in which storage is requested, except for domestic use, shall be:

ACRE-FEET	FEE
0-250	\$200.00
More than 250	\$200.00 plus \$20.00 for each additional 250 acre-feet of storage or any part thereof.

Note: If an application requests both direct use *and* storage, the fee charged shall be as determined under No. 1 or No. 2 above, whichever is greater, but not both fees.

3. The fee for an application for a permit to appropriate water for water power or dewatering purposes shall be \$100.00 plus \$200.00 for each 100 cubic feet per second, or part thereof, of the diversion rate requested.

Note: The applicant shall notify the Chief Engineer and pay the statutorily required field inspection fee of \$400.00 when construction of the works for diversion has been completed, except that for applications filed on or after July 1, 2009, for works constructed for sediment control use and for evaporation from a groundwater pit for industrial use shall be accompanied by a field inspection fee of \$200.00.

MAKE CHECKS PAYABLE TO THE KANSAS DEPARTMENT OF AGRICULTURE**ATTENTION**

A Water Conservation Plan may be required per K.S.A. 82a-733. A statement that your application for permit to appropriate water may be subject to the minimum desirable streamflow requirements per K.S.A. 82a-703a, b, and c may also be required from you. After the Division of Water Resources has had the opportunity to review your application, you will be notified whether or not you will need to submit a Water Conservation Plan. You also may be required to install a water flow meter or water stage measuring device on your diversion works prior to diverting water. There may be other special conditions or Groundwater Management District regulations that you will need to comply with if this application is approved.

CONVERSION FACTORS

1 acre-foot equals 325,851 gallons

1 million gallons equal 3.07 acre-feet

**MINIMUM DESIRABLE STREAMFLOW FORM TO BE USED WHEN
APPLICABLE WHEN FILING AN APPLICATION FOR PERMIT
TO APPROPRIATE WATER FOR BENEFICIAL USE**

The Kansas Legislature has established minimum desirable streamflows for the streams listed below. If your proposed diversion of water is going to be from one of these watercourses or adjacent alluvial aquifers, please complete the back side of this page and submit it along with your application for permit to appropriate water.

Arkansas River
Big Blue River
Chapman Creek
Chikaskia River
Cottonwood River
Delaware River
Little Arkansas River
Little Blue River
Marais des Cygnes River
Medicine Lodge River
Mill Creek (Wabaunsee Co. area)
Neosho River

Ninnescah River
North Fork Ninnescah River
Rattlesnake Creek
Republican River
Saline River
Smoky Hill River
Solomon River
South Fork Ninnescah
Spring River
Walnut River
Whitewater River

2/24/2023

Water Resources
Received

KS Dept Of Agriculture

February 21, 2023

(Date)

Kansas Department of Agriculture
Division of Water Resources
Earl D. Lewis, Jr., Chief Engineer
1320 Research Park Drive
Manhattan, Kansas 66502

2/24/2023

Water Resources
Received

KS Dept Of Agriculture

Re: Application
File No. _____

Minimum Desirable Streamflow

I understand that a Minimum Desirable Streamflow requirement has been established by the legislature for the source of supply to which the above referenced application applies.

I understand that diversion of water pursuant to this application will be subject to regulation any time Minimum Desirable Streamflow requirements are not being met.

I also understand that if this application is approved, there could be times, as determined by the Division of Water Resources, when I would not be allowed to divert water. I realize that this could affect the economics of my decision to appropriate water.

I am aware of the above factors, and with the knowledge thereof, request that the Division of Water Resources proceed with processing and approval, if possible, of the above referenced application.

Tietjen & Son by Tyler Tietjen President
Signature of Applicant

Nebraska
State of ~~Kansas~~)
County of Thayer) ss)

Tietjen & Son by Tyler Tietjen
(Print Applicant's Name)

I hereby certify that the foregoing instrument was signed in my presence and sworn to before me this 21st day of February, 2023.

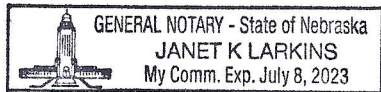

Janet K. Larkins
Notary Public

My Commission Expires: July 8, 2023

EVELYN A HURLEY TRUST 1

706 FIR RD

REPUBLIC, KS 66964-8048

2/24/2023

Water Resources
Received

JOSHUA D ROE

8685 BEGELOW RD

WESTMORELAND, KS 66549-9437

KS Dept Of Agriculture

VAN NORTWICK FAMILY TRUST

ATTN: LYNN VAN NORTWICK

1614 23 ST

BELLEVILLE, KS 66935-2809

Project: Tietjen Irrigation Reservoir

Stage Storage Table

2/24/2023

Water Resources
Received

KS Dept Of Agriculture

Elevation (Feet)	Surface Area (Acres)	Dam Height (feet)	Incremental Volume (Acre-FT)	Cumulative volume of Storage (Acre-FT)	Note
1533	0.00	0	0.00		Streambed at Centerline
1534	1.52	1	0.76	0.8	
1535	2.35	2	1.94	2.7	
1536	3.32	3	2.83	5.5	
1537	4.52	4	3.92	9.4	
1538	6.55	5	5.53	15.0	
1539	8.77	6	7.66	22.6	
1540	10.75	7	9.76	32.4	
1541	12.30	8	11.53	43.9	
1542	13.88	9	13.09	57.0	
1543	15.75	10	14.82	71.8	
1544	17.96	11	16.85	88.7	
1545	20.00	12	18.98	107.7	
1546	21.98	13	20.99	128.7	
1547	24.06	14	23.02	151.7	
1548	26.49	15	25.28	177.0	
1549	29.51	16	28.00	205.0	
1550	32.94	17	31.23	236.2	

2. Please complete the following information for the description of the operation for the irrigation project. Attach supplemental sheets as needed.

a. Indicate the soils in the field(s) and their intake rates:

Soil Name	Percent of field (%)	Intake Rate (in/hr)	Irrigation Design Group
_____	_____	_____	_____
_____	_____	_____	_____
_____	_____	_____	_____
_____	_____	_____	_____
Total:	100 %		

b. Estimate the average land slope in the field(s): _____%

Estimate the maximum land slope in the field(s): _____%

c. Type of irrigation system you propose to use (check one):

- Center pivot
 _____ Center pivot - LEPA
 _____ "Big gun" sprinkler
 _____ Gravity system (furrows)
 _____ Gravity system (borders)
 _____ Sideroll sprinkler

Other, please describe: _____

d. System design features:

2/24/2023

i. Describe how you will control tailwater: TILLAGE, IRRIGATION SCHEDULING

Water Resources Received

KS Dept Of Agriculture

ii. For sprinkler systems:

(1) Estimate the operating pressure at the distribution system: 35 _____ psi

(2) What is the sprinkler package design rate? 800 _____ gpm

(3) What is the wetted diameter (twice the distance the sprinkler throws water) of a sprinkler on the outer 100 feet of the system? _____ feet

(4) Please include a copy of the sprinkler package design information.

e. Crop(s) you intend to irrigate. Please note any planned crop rotations: CORN, SOYBEANS, ALFALFA, SORGHUM, WHEAT

f. Please describe how you will determine when to irrigate and how much water to apply (particularly important if you do not plan a full irrigation). SOIL MOISTURE

You may attach any additional information you believe will assist in informing the Division of the need for your request.

**IRRIGATION USE
SUPPLEMENTAL SHEET**

Water Resources
Received

File No. _____

KS Dept Of Agriculture

Name of Applicant (Please Print): TIETJEN & SON

1. Please supply the name and address of each landowner, the legal description of the lands to be irrigated, and designate the actual number of acres to be irrigated in each forty acre tract or fractional portion thereof:

Landowner of Record NAME: SARAH J DERIENZO LIVING TRUST
ADDRESS: PO BOX 6493 LINCOLN, NE 68506-0493

S	T	R	NE¼				NW¼				SW¼				SE¼				TOTAL
			NE	NW	SW	SE	NE	NW	SW	SE	NE	NW	SW	SE	NE	NW	SW	SE	
29	1S	04W			37	37				21	20			15	40	40	38	30	278

Landowner of Record NAME: _____
ADDRESS: _____

S	T	R	NE¼				NW¼				SW¼				SE¼				TOTAL
			NE	NW	SW	SE	NE	NW	SW	SE	NE	NW	SW	SE	NE	NW	SW	SE	

Landowner of Record NAME: _____
ADDRESS: _____

S	T	R	NE¼				NW¼				SW¼				SE¼				TOTAL
			NE	NW	SW	SE	NE	NW	SW	SE	NE	NW	SW	SE	NE	NW	SW	SE	

New Application - Surface Water

Water Resources
Received

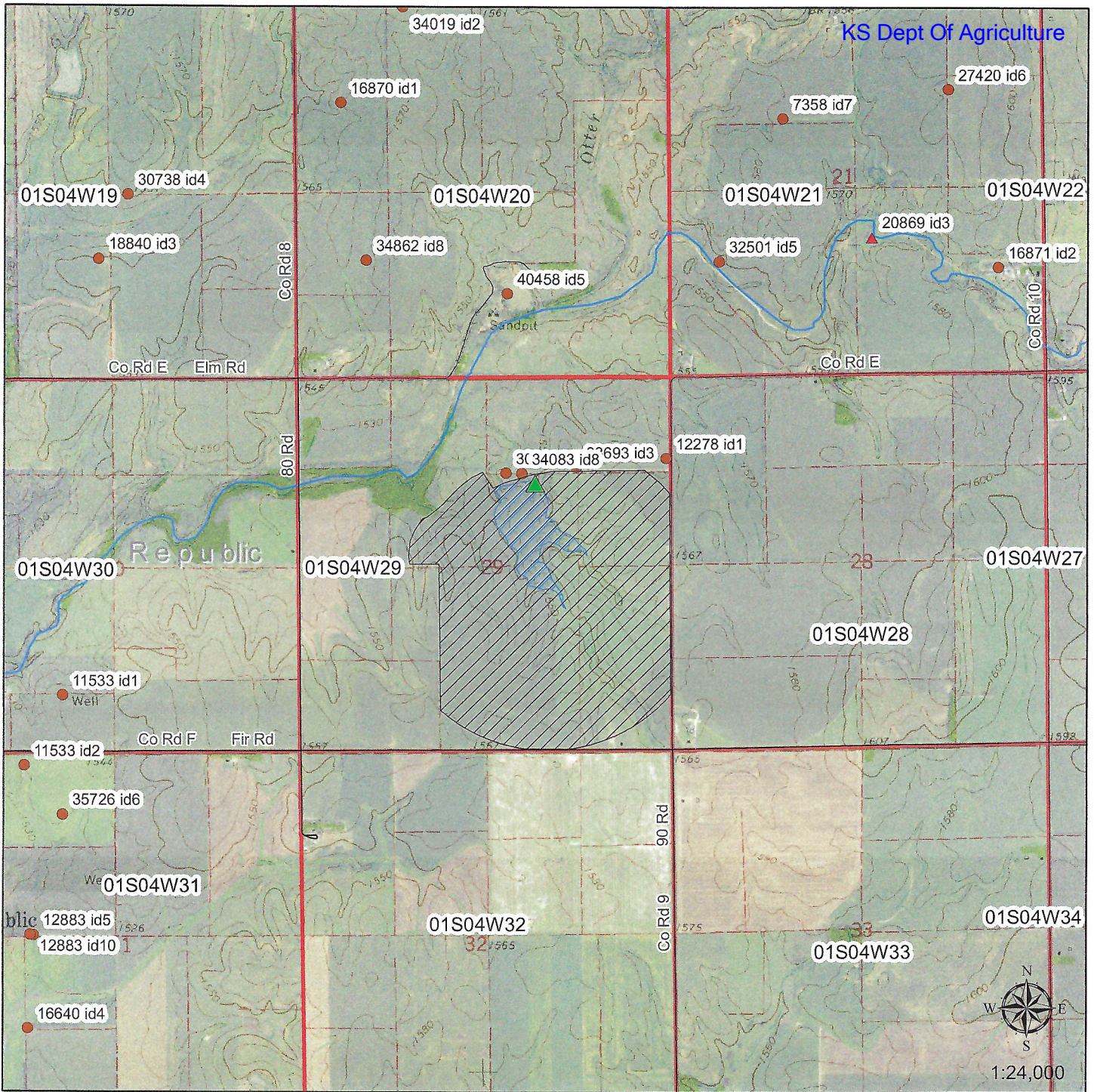

Signature Required

Tietjen & Son by [Signature] President

By signing this I am stating that to the best of my knowledge that all landowners within 1/2 mile upstream and downstream of my property are identified on this map or listed on an attachment to this map.

▲ Surface Water Point of Diversion

● Groundwater Point of Diversion

▲ Proposed Point of Diversion



Proposed Place of Use

2/24/2023

Water Resources
Received

KS Dept Of Agriculture

Tietjen Irrigation Reservoir

29-01S-04W ~~Sec 35 T1S R4W~~

Drainage Area = 525 Acres

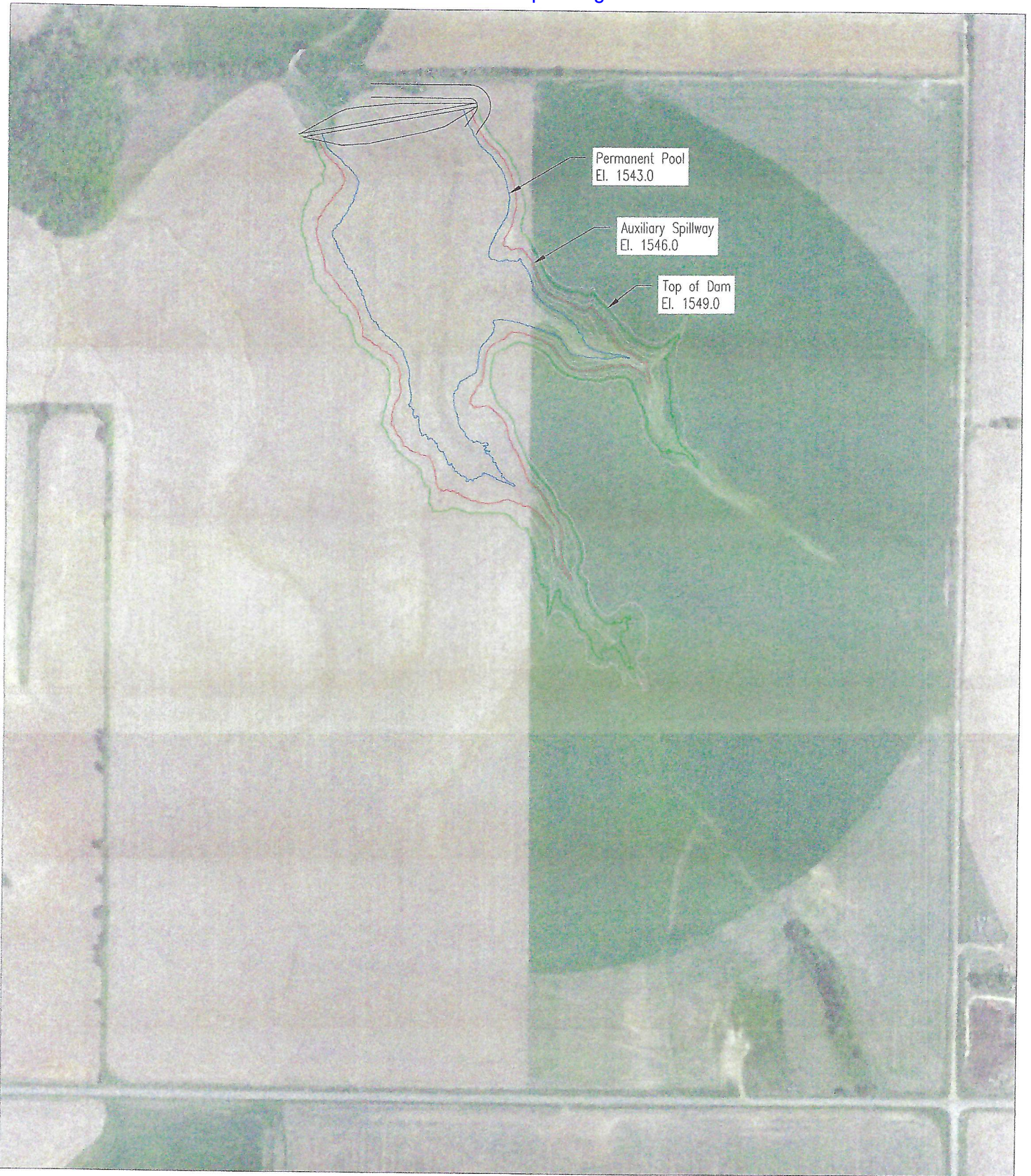

DATA ENTRY SYSTEM ID NUMBER SHEET

FILE NUMBER 50976

APPLICANT PERSON ID & SEQ #	90116	PDIV ID	BATTERY ID
<u>60813</u>			

LANDOWNER PERSON ID & SEQ #	17076	PUSE ID
<u>63970</u>		

WATER USE CORRESPONDENT PERSON ID & SEQ #
<u>60813</u>