

Submit To:
CHIEF ENGINEER
Division of Water Resources
Kansas Department of Agriculture
1320 Research Park Drive
Manhattan, KS 66502-5000
http://agriculture.ks.gov/dwr

APPLICATION FOR PERMIT TO APPROPRIATE WATER FOR BENEFICIAL USE



State of Kansas

STATUTORY FILING FEE MUST ACCOMPANY THIS APPLICATION
Please refer to the Fee Schedule attached to this application form.

WATER RESOURCES
RECEIVED

NOV 08 2024

File Number: **51354**
This item to be completed by the Division of Water Resources staff.

KS DEPT OF AGRICULTURE
2:30 PM

1. Name of Applicant: ELLIS COUNTY PUBLIC WORKS
Address: 1195 280TH AVE
City: HAYS State: KS Zip Code: 67601
Phone: _____ Email: ghaas@ellisco.net

2. The source of water is: surface water in _____ (stream)
 groundwater in BIG CREEK/SMOKY HILL (drainage basin)

3. The maximum annual quantity of water desired is 15 acre-feet gallons
to be diverted at a maximum rate of 45 gpm c.f.s. natural flows natural evaporation
 This project involves surface water storage and redirection. The maximum annual quantity of water desired to be
rediverted is _____ acre-feet gallons, at a rate of _____ gpm c.f.s.

Conversion Factors

1 acre-foot (AF) = 325,851 gallons
1 million gallons (mg) = 3.07 acre-feet (AF)
1 cubic foot per second (c.f.s.) = 448.8 gallons per minute (gpm)

IMPORTANT: Once your application has been assigned a priority date and file number, the requested maximum rate of diversion and maximum requested annual quantity of water under that priority number can **NOT** be increased. Please be certain your requested maximum rate of diversion and maximum annual quantity of water are appropriate and reasonable for your proposed project.

4. The water is intended to be appropriated for the following use(s):

<input type="checkbox"/> Artificial Recharge*	<input type="checkbox"/> Irrigation*	<input type="checkbox"/> Recreational*	<input type="checkbox"/> Water Power*
<input checked="" type="checkbox"/> Industrial*	<input type="checkbox"/> Municipal*	<input type="checkbox"/> Stockwatering*	<input type="checkbox"/> Sediment Control
<input type="checkbox"/> Domestic	<input type="checkbox"/> Dewatering	<input type="checkbox"/> Hydraulic Dredging	<input type="checkbox"/> Fire Protection
<input type="checkbox"/> Thermal Exchange	<input type="checkbox"/> Contamination Remediation		

***IMPORTANT:** You **must** submit a supplemental form providing information to substantiate your request for the quantity of water listed in Item No. 3 for the intended use(s) referenced above.

FOR OFFICE USE ONLY															
FO	<u>3</u>	GMD	-	DUA	-	Use	<u>IND</u>	Source	<u>GW</u>	County	<u>EL</u>	By	<u>KJN</u>	Date	<u>11/12/24</u>
Code	<u>R99</u>	Fee \$	<u>200</u>	TR #	<u>PY2411R776D</u>	Receipt Date	<u>11/8/2024</u>	Check #							

5. The location(s) of the proposed diversion work(s) (well, pumpsite, etc.) are described below. Note that for the application to be accepted, the point of diversion location(s) **must** be described to at least a 10-acre tract, unless you specifically request a 60-day period of time in which to locate the site within a specifically described, minimal legal quarter section of land. You can specify a nickname for the point of diversion via the A.K.A. line to help you identify it.

If the source of supply is groundwater, a separate application shall be filed for each proposed well or battery of wells, except that a single application may include up to four wells within a circle with a quarter (¼) mile radius in the same local source of supply which do not exceed a maximum diversion rate of 20 gallons per minute per well.

A battery of wells is defined as two or more wells connected to a common pump by a manifold; or not more than four wells in the same local source of supply within a 300-foot radius circle which are being operated by pumps not to exceed a total maximum diversion rate of 800gpm and which supply water to a common distribution system.

- (A) One in the NW quarter of the SE quarter of the NE quarter of Section 16, more particularly described as being near a point 3607 feet North and 829 feet West of the Southeast corner of said section, in Township 13 South, Range 18 E W, ELLIS County, KS. A.K.A: _____
- (B) One in the _____ quarter of the _____ quarter of the _____ quarter of Section _____, more particularly described as being near a point _____ feet North and _____ feet West of the Southeast corner of said section, in Township _____ South, Range _____ E W, _____ County, KS. A.K.A: _____
- (C) One in the _____ quarter of the _____ quarter of the _____ quarter of Section _____, more particularly described as being near a point _____ feet North and _____ feet West of the Southeast corner of said section, in Township _____ South, Range _____ E W, _____ County, KS. A.K.A: _____
- (D) One in the _____ quarter of the _____ quarter of the _____ quarter of Section _____, more particularly described as being near a point _____ feet North and _____ feet West of the Southeast corner of said section, in Township _____ South, Range _____ E W, _____ County, KS. A.K.A: _____
- (E) One in the _____ quarter of the _____ quarter of the _____ quarter of Section _____, more particularly described as being near a point _____ feet North and _____ feet West of the Southeast corner of said section, in Township _____ South, Range _____ E W, _____ County, KS. A.K.A: _____

6. The proposed project for diversion of water will consist of 1 WELL
(number of wells, pumps, dams, etc.)
and was/will be completed on or by the following date: 4/19/94
(date each was or will be completed)

7. The first actual application of water for the proposed beneficial use was or is estimated to be 2025
(Date)

8. List any application, appropriation of water, water right, or vested right file number that covers the same point(s) of diversion or any of the same place of use described in this application. Also list any other recent modifications made to existing permits or water rights in conjunction with the filing of this application.

A TERM PERMIT WAS ALSO SUBMITTED TO START THE PROJECT EARLIER AND THE TERM CAN BE DISMISSED UPON APPROVAL OF THIS APPLICATION
45 GPM REQUESTED ON APPLICATION BUT APPLICANT MAY REDUCE RATE FOR APPROVAL
WILL REQUIRE A WAIVER OF SPACING DUE TO LOW PUMPING VOLUME

9. Will pesticide, fertilizer, or other foreign substance be injected into the water pumped from the diversion works?

Yes No If yes, a check valve shall be required. All chemigation safety requirements must be met including a chemigation permit and reporting requirements.

10. If you are planning to impound water, please contact DWR prior to submitting this application. Please attach a reservoir area capacity table and inform us of the total acres of surface drainage area above the reservoir.

Have you made an application for a permit for construction of this dam and reservoir with DWR? Yes No

If yes, write the Water Structures permit number here: N/A

11. Furnish a detailed topographic or aerial map that depicts the following information:

The application **must** be supplemented by a topographic map, aerial photograph or a detailed plat showing the information described in A-D below.

- (A) The center of the section, the section lines or the section corners, and labels showing the appropriate section, township and range numbers, as well as a north arrow and scale,
- (B) The location of the proposed point(s) of diversion (wells, stream-bank installations, dams, or other diversion works) described in Item No. 5 of the application, showing the North-South distance and the East-West distance from a section line or southeast corner of section,
- (C) The location of the proposed place of use identified by crosshatching,
- (D) **For Groundwater Use**, the location of any existing water wells of any kind within 1/2 mile of the proposed well or wells and indicate for each well its type of use and the name and mailing address of the property owner or owners, (If there are no wells within 1/2 mile, please indicate that on the map.)

For Surface Water Use, the names and addresses of the landowner(s) 1/2 mile downstream and 1/2 mile upstream from your property lines, and
- (E) The locations of proposed or existing dams, dikes, reservoirs, canals, pipelines, power houses, and any other structures for the purpose of storing, conveying, or using water.

12. For groundwater use, furnish copies of the driller's logs for all test holes or completed wells. Please ensure that the driller's logs provide depth to the static water level. If driller's logs cannot be obtained for an existing well, provide the following information:

Well location as shown in Item No. 5	(A)	(B)	(C)	(D)	(E)
Date drilled	<u>4/19/94</u>	_____	_____	_____	_____
Total depth of well	<u>538</u>	_____	_____	_____	_____
Depth to static water level	<u>315</u>	_____	_____	_____	_____

13. The owner(s) of the point of diversion, if other than the applicant is:

ELLIS COUNTY PUBLIC WORKS

(name, address, and phone)

(name, address, and phone)

14. The owner(s) of the property where the water is used, if other than the applicant, is:

THE COUNTY OF ELLIS COUNTY

(name, address, and phone)

(name, address, and phone)

15. The relationship of the applicant to the proposed place where the water will be used is that of:

Owner Agent Tenant Other: COUNTY GOV

16. A water use correspondent (WUC) must be designated. The WUC will be mailed the annual water use report, which must be filed with the Division by March 1 of each year. Failure to timely file an accurate water use report will subject the owner(s) to a civil fine of up to \$1,000 and potential suspension of the water appropriation or right. By signing this application, I verify that the owner(s) of the water right or permit have confirmed that the following person or agent should be designated as the WUC:

ELLIS COUNTY PUBLIC WORKS 1195 280TH AVE HAYS, KS 67601

(name, address, and phone)

17. I understand that if this application is approved, there could be times, as determined by the Division of Water Resources, when I would not be allowed to divert water. This could affect the economics of my decision to appropriate water. Situations where this might occur may include times when minimum desirable streamflow (MDS) requirements are not met, when Assurance District or Water Marketing releases are made from storage in federal reservoirs, when a Water Reservation Right upstream of a federal reservoir is administered, or when water rights administration becomes necessary to prevent impairment.

I declare, under penalty of perjury, that I have legal access to or control of, the point(s) of diversion described in this application from the landowner or the landowner's authorized representative.

By signing below, I verify that the information set forth above is true to the best of my knowledge, I agree with all statements made above, and that this application is submitted in good faith.

Gary Haas

(Applicant Signature)

11/8/24

(Date)

Gary Haas

(Applicant Name – please print)

Weed Control Supervisor

(Applicant Title, if applicable – please print)

Assisted by MB STKFO

ASST WC

(office/title)

Date: 10/22/24

WATER RESOURCES
RECEIVED

NOV 08 2024

KS DEPT OF AGRICULTURE

FEE SCHEDULE

Make checks payable to the Kansas Department of Agriculture.

1. The fee for an application for a permit to appropriate water for beneficial use, except for domestic, waterpower, dewatering, or sediment control use, shall be (see No. 2 below if requesting storage):

Million Gallons (mg)	Acre-Feet (AF)	Fee
≤ 32.585	≤ 100	\$200.00
32.586 - 104.272	100.1 - 320.0	\$300.00
> 104.272	> 320	\$300.00 plus \$20 for each additional 100AF (32.586mg) or any part thereof

2. The fee for an application in which storage of water is requested, except for domestic use, shall be:

Million Gallons (mg)	Acre-Feet (AF)	Fee
≤ 81.462	≤ 249.9	\$200.00
≥ 81.463	≥ 250	\$200.00 plus \$20 for each additional 100AF (32.586mg) or any part thereof

Note: If an application requests both direct use *and* storage, the fee charged shall be as determined under No. 1 or No. 2 above, whichever is greater, but not both fees.

3. The fee for an application for **waterpower** or **dewatering** use shall be \$100.00 plus \$200.00 for each 44,880 gallons per minute (100 c.f.s.), or part thereof, of the diversion rate requested.

IMPORTANT NOTICE

If this application is approved, the applicant shall notify the Chief Engineer when the diversion works (well, pump, reservoir, pit, etc.) has/have been completed via the *Notice of Completion of Diversion Works* form (DWR 1-203.11) and along with the statutorily required field inspection fee of:

- \$200.00 for sediment control use or groundwater pits for industrial use, or
- \$400.00 for all other uses made of water

Failure to complete the diversion works by the deadline specified in the *Approval of Application and Permit to Proceed* (or any subsequent extension of time of said deadline) and/or failure to submit the proper notice and field inspection fee will result in the dismissal of the appropriation and forfeiture of any priority associated with it.

For assistance with this application, please contact the Division of Water Resources (DWR).

Manhattan HQ
1320 Research Park Dr.
Manhattan, KS 66502
785-564-6638

Topeka Field Office
1131 SW Winding Rd, Ste 400
Topeka, KS 66615
785-296-5733

Stafford Field Office
300 S. Main St
Stafford, KS 67578
620-234-5311

Stockton Field Office
820 S. Walnut
Stockton, KS 67669
785-425-6787

Garden City Field Office
4532 W. Jones Ave, Ste B
Garden City, KS 67846
620-276-2901

Helpful Sources of Information

DWR Water Appropriation Program
DWR Water Appropriation Forms
KGS Water Well Completion Records
DWR Structures Program

<https://agriculture.ks.gov/divisions-programs/dwr/water-appropriation>
<https://agriculture.ks.gov/divisions-programs/dwr/water-appropriation/water-appropriation-forms>
<https://www.kgs.ku.edu/Magellan/WaterWell/index.html>
<https://agriculture.ks.gov/divisions-programs/dwr/dam-safety/permit-requirements>

WATER RESOURCES
RECEIVED

NOV 08 2024

KS DEPT OF AGRICULTURE

NOV 08 2024

New Application Groundwater

KS DEPT OF AGRICULTURE

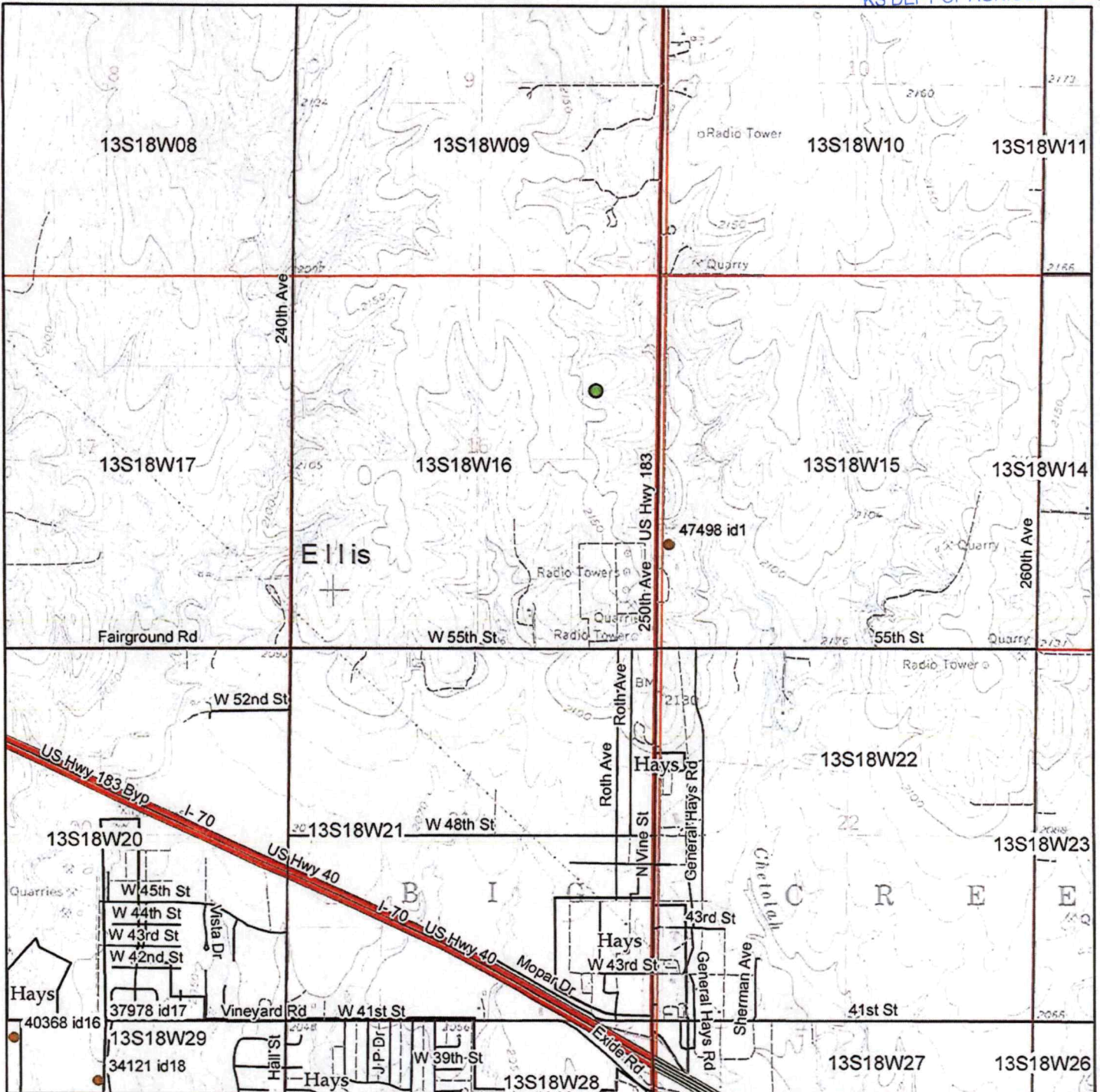

● Proposed Point(s)
of Diversion

▲ Surface Water Point of Diversion

● Groundwater Point of Diversion

1:24,000

Signature Required

By signing this I am stating that to the best of my knowledge
that all wells within 1/2 mile of proposed well location are
identified on this map.



NOV 08 2024

**INDUSTRIAL USE
SUPPLEMENTAL SHEET**

KS DEPT OF AGRICULTURE

File No. _____

Name of Applicant (Please Print): ELLIS CO. PUBLIC WORKS

1. Please describe type of industry or product produced: HERBICIDE SPRAYING, ROAD MAINTENANCE
 _____ Standard Industrial Classification Code Number: _____

2. Please complete the following table to show your past and present water requirements:

PAST PRODUCT PRODUCTION AND WATER DIVERTED, IF APPLICABLE

LAST 5 YEARS	AMOUNT OF PRODUCT	WATER DIVERTED (GALLONS)	GALLONS PER PRODUCT PER DAY
5 years ago	15 AF	15 AF	VARIABLE
Last year	15 AF	15 AF	VARIABLE
Present year	15 AF	15 AF	VARIABLE

3. Please complete the following table to show your future water requirements:

ESTIMATED FUTURE PRODUCT PRODUCTION AND WATER DIVERTED

NEXT 5 YEARS	AMOUNT OF PRODUCT	WATER TO BE DIVERTED (GALLONS)	GALLONS PER PRODUCT PER DAY
Year 1	15 AF	15 AF	VARIABLE
Year 2	15 AF	15 AF	VARIABLE
Year 3	15 AF	15 AF	VARIABLE
Year 4	15 AF	15 AF	VARIABLE
Year 5	15 AF	15 AF	VARIABLE

Number of days of operation of the industry per year is 365 days.

Please attach any tables, curves or additional information showing past, present and estimated future water requirements to substantiate the amount of water requested.

4. Please designate the legal description of the location where the water is to be used. Show in the space provided below the Section (S), Township (T), and Range (R), and the number of acres in each forty acre tract or fractional portion thereof.

S	T	R	NE¼				NW¼				SW¼				SE¼				TOTAL
			NE	NW	SW	SE	NE	NW	SW	SE	NE	NW	SW	SE	NE	NW	SW	SE	
																		EL COUNTY	

FOR KATIE* CAN USE 16-13S-18W FOR PU LEGAL. PU COMMENT: ELLIS COUNTY

You may attach any additional information you believe will assist in informing the Division of the need for your request.

11/12/2024
KJN

1320 Research Park Drive
Manhattan, KS 66502
785-564-6700
www. agriculture.ks.gov



900 SW Jackson, Room 456
Topeka, KS 66612
785-296-3556

Mike Beam, Secretary

Laura Kelly, Governor

November 15, 2024

ELLIS COUNTY PUBLIC WORKS
1195 280TH AVE
HAYS KS 67601

RE: Application, File No(s). **51354**

Dear Sir or Madam:

The Division of Water Resources (Division) has received your application(s) for a permit to appropriate water for beneficial use. Your application(s) has been assigned the file number(s) referenced above. Please be aware that the Division may have a large number of pending applications on hand at times and makes every attempt to process them in the order in which they are received. You will be contacted if additional information is required.

Please note, this letter only acknowledges receipt of your application(s) and does not guarantee approval. In accordance with the provisions of the Kansas Water Appropriation Act, the use of water as proposed prior to approval of the application(s) is unlawful.

Additional information about the process may be found on our website at agriculture.ks.gov/divisions-programs/dwr. If you have any other questions, please contact our office at 785-564-6640 or your local Stockton Field Office at 785-425-6787. If you call, please reference the file number so we can help you more efficiently.

Sincerely,

A handwritten signature in black ink that reads "Kris Neuhauser". The signature is written in a cursive style with a long horizontal flourish at the end.

Kris Neuhauser
New Applications Lead
Water Appropriation Program