

Submit To:
 CHIEF ENGINEER
 Division of Water Resources
 Kansas Department of Agriculture
 1320 Research Park Drive
 Manhattan, KS 66502-5000
<http://agriculture.ks.gov/dwr>

APPLICATION FOR PERMIT TO APPROPRIATE WATER FOR BENEFICIAL USE



State of Kansas

STATUTORY FILING FEE MUST ACCOMPANY THIS APPLICATION
 Please refer to the Fee Schedule attached to this application form.

WATER RESOURCES
 RECEIVED

File Number: **51387**

This item to be completed by the Division of Water Resources staff.

DEC 26 2024

KS DEPT OF AGRICULTURE

1. Name of Applicant: KANSAS DEPARTMENT OF WILDLIFE PARKS & TOURISM
 Address: 1020 S KANSAS AVE FL2
 City: TOPEKA State: KS Zip Code: 66612-1389
 Phone: _____ Email: _____

11:20 AM

2. The source of water is: surface water in SMOKY HILL RIVER (stream)
 groundwater in _____ (drainage basin)

3. The maximum annual quantity of water desired is 1,407 acre-feet gallons
 to be diverted at a maximum rate of 10,000 gpm c.f.s. natural flows natural evaporation
 This project involves surface water storage and redirection. The maximum annual quantity of water desired to be
 rediverted is _____ acre-feet gallons, at a rate of _____ gpm c.f.s.

Conversion Factors

1 acre-foot (AF) = 325,851 gallons
 1 million gallons (mg) = 3.07 acre-feet (AF)
 1 cubic foot per second (c.f.s.) = 448.8 gallons per minute (gpm)

IMPORTANT: Once your application has been assigned a priority date and file number, the requested maximum rate of diversion and maximum requested annual quantity of water under that priority number can **NOT** be increased. Please be certain your requested maximum rate of diversion and maximum annual quantity of water are appropriate and reasonable for your proposed project.

4. The water is intended to be appropriated for the following use(s):

| | | | |
|---|--|---|---|
| <input type="checkbox"/> Artificial Recharge* | <input type="checkbox"/> Irrigation* | <input checked="" type="checkbox"/> Recreational* | <input type="checkbox"/> Water Power* |
| <input type="checkbox"/> Industrial* | <input type="checkbox"/> Municipal* | <input type="checkbox"/> Stockwatering* | <input type="checkbox"/> Sediment Control |
| <input type="checkbox"/> Domestic | <input type="checkbox"/> Dewatering | <input type="checkbox"/> Hydraulic Dredging | <input type="checkbox"/> Fire Protection |
| <input type="checkbox"/> Thermal Exchange | <input type="checkbox"/> Contamination Remediation | | |

***IMPORTANT:** You **must** submit a supplemental form providing information to substantiate your request for the quantity of water listed in Item No. 3 for the intended use(s) referenced above.

| | | | | | | | |
|---------------------|------------|--------|------------|--------------|-------------------|--------|---------------|
| FOR OFFICE USE ONLY | | | | | | | |
| FO | <u>3</u> | GMD | - | DUA | - | Use | <u>REC</u> |
| Code | <u>PE3</u> | Fee \$ | <u>520</u> | TR # | <u>AA00405675</u> | Source | <u>SW</u> |
| | | | | Receipt Date | <u>12/26/2024</u> | County | <u>EW</u> |
| | | | | By | <u>KJN</u> | Date | <u>1/3/24</u> |
| | | | | Check # | | | |

INTERFUND #

DEC 26 2024

File No. _____ KS DEPT OF AGRICULTURE

5. The location(s) of the proposed diversion work(s) (well, pumpsite, etc.) are described below. Note that for the application to be accepted, the point of diversion location(s) **must** be described to at least a 10-acre tract, unless you specifically request a 60-day period of time in which to locate the site within a specifically described, minimal legal quarter section of land. You can specify a nickname for the point of diversion via the A.K.A. line to help you identify it.

If the source of supply is groundwater, a separate application shall be filed for each proposed well or battery of wells, except that a single application may include up to four wells within a circle with a quarter (1/4) mile radius in the same local source of supply which do not exceed a maximum diversion rate of 20 gallons per minute per well.

A battery of wells is defined as two or more wells connected to a common pump by a manifold; or not more than four wells in the same local source of supply within a 300-foot radius circle which are being operated by pumps not to exceed a total maximum diversion rate of 800gpm and which supply water to a common distribution system.

- (A) One in the NE quarter of the SW quarter of the NW quarter of Section 14, more particularly described as being near a point 3,447 feet North and 4,179 feet West of the Southeast corner of said section, in Township 16 South, Range 7 E W, ELLSWORTH County, KS. A.K.A: STUMPS PUMP
- (B) One in the _____ quarter of the _____ quarter of the _____ quarter of Section _____, more particularly described as being near a point _____ feet North and _____ feet West of the Southeast corner of said section, in Township _____ South, Range _____ E W, _____ County, KS. A.K.A: _____
- (C) One in the _____ quarter of the _____ quarter of the _____ quarter of Section _____, more particularly described as being near a point _____ feet North and _____ feet West of the Southeast corner of said section, in Township _____ South, Range _____ E W, _____ County, KS. A.K.A: _____
- (D) One in the _____ quarter of the _____ quarter of the _____ quarter of Section _____, more particularly described as being near a point _____ feet North and _____ feet West of the Southeast corner of said section, in Township _____ South, Range _____ E W, _____ County, KS. A.K.A: _____
- (E) One in the _____ quarter of the _____ quarter of the _____ quarter of Section _____, more particularly described as being near a point _____ feet North and _____ feet West of the Southeast corner of said section, in Township _____ South, Range _____ E W, _____ County, KS. A.K.A: _____

6. The proposed project for diversion of water will consist of 1 GATOR PUMP
(number of wells, pumps, dams, etc.)
and was/will be completed on or by the following date: 12/31/25
(date each was or will be completed)

7. The first actual application of water for the proposed beneficial use was or is estimated to be 2025
(Date)

8. List any application, appropriation of water, water right, or vested right file number that covers the same point(s) of diversion or any of the same place of use described in this application. Also list any other recent modifications made to existing permits or water rights in conjunction with the filing of this application.
50,334 AUTHORIZES THE STORAGE AND CONTROL STRUCTURES
LOCATED ON USACE LAND, OPERATED BY KDWP

9. Will pesticide, fertilizer, or other foreign substance be injected into the water pumped from the diversion works?

Yes No If yes, a check valve shall be required. All chemigation safety requirements must be met including a chemigation permit and reporting requirements.

10. If you are planning to impound water, please contact DWR prior to submitting this application. Please attach a reservoir area capacity table and inform us of the total acres of surface drainage area above the reservoir.

Have you made an application for a permit for construction of this dam and reservoir with DWR? Yes No

If yes, write the Water Structures permit number here: NOT REQUIRED AS PER DWR

11. Furnish a detailed topographic or aerial map that depicts the following information:

The application **must** be supplemented by a topographic map, aerial photograph or a detailed plat showing the information described in A-D below.

- (A) The center of the section, the section lines or the section corners, and labels showing the appropriate section, township and range numbers, as well as a north arrow and scale,
- (B) The location of the proposed point(s) of diversion (wells, stream-bank installations, dams, or other diversion works) described in Item No. 5 of the application, showing the North-South distance and the East-West distance from a section line or southeast corner of section,
- (C) The location of the proposed place of use identified by crosshatching,
- (D) **For Groundwater Use**, the location of any existing water wells of any kind within 1/2 mile of the proposed well or wells and indicate for each well its type of use and the name and mailing address of the property owner or owners, (If there are no wells within 1/2 mile, please indicate that on the map.)

For Surface Water Use, the names and addresses of the landowner(s) 1/2 mile downstream and 1/2 mile upstream from your property lines, and

- (E) The locations of proposed or existing dams, dikes, reservoirs, canals, pipelines, power houses, and any other structures for the purpose of storing, conveying, or using water.

12. For groundwater use, furnish copies of the driller's logs for all test holes or completed wells. Please ensure that the driller's logs provide depth to the static water level. If driller's logs cannot be obtained for an existing well, provide the following information:

| Well location as shown in Item No. 5 | (A) | (B) | (C) | (D) | (E) |
|--------------------------------------|-------|-------|-------|-------|-------|
| Date drilled | _____ | _____ | _____ | _____ | _____ |
| Total depth of well | _____ | _____ | _____ | _____ | _____ |
| Depth to static water level | _____ | _____ | _____ | _____ | _____ |

13. The owner(s) of the point of diversion, if other than the applicant is:

(name, address, and phone)

(name, address, and phone)

WATER RESOURCES RECEIVED

DEC 26 2024

14. The owner(s) of the property where the water is used, if other than the applicant, is:

UNITED STATES OF AMERICA ARMY CORPS OF ENGINEERS AVE Q, KANOPOLIS, KS 67454

(name, address, and phone)

(name, address, and phone)

15. The relationship of the applicant to the proposed place where the water will be used is that of:

Owner Agent Tenant Other: _____

16. A water use correspondent (WUC) must be designated. The WUC will be mailed the annual water use report, which must be filed with the Division by March 1 of each year. Failure to timely file an accurate water use report will subject the owner(s) to a civil fine of up to \$1,000 and potential suspension of the water appropriation or right. By signing this application, I verify that the owner(s) of the water right or permit have confirmed that the following person or agent should be designated as the WUC:

KANSAS DEPT OF WILDLIFE & PARKS ATTN EMMA GOEMANN (STKFO) 512 SE 25TH AVE PRATT, KS 67124

(name, address, and phone)

17. I understand that if this application is approved, there could be times, as determined by the Division of Water Resources, when I would not be allowed to divert water. This could affect the economics of my decision to appropriate water. Situations where this might occur may include times when minimum desirable streamflow (MDS) requirements are not met, when Assurance District or Water Marketing releases are made from storage in federal reservoirs, when a Water Reservation Right upstream of a federal reservoir is administered, or when water rights administration becomes necessary to prevent impairment.

I declare, under penalty of perjury, that I have legal access to or control of, the point(s) of diversion described in this application from the landowner or the landowner's authorized representative.

By signing below, I verify that the information set forth above is true to the best of my knowledge, I agree with all statements made above, and that this application is submitted in good faith.

Scott Thomasson
(Applicant Signature)

12/3/2024
(Date)

SCOTT THOMASSON
(Applicant Name - please print)

PUBLIC LANDS MANAGER - KDWP.
(Applicant Title, if applicable - please print)

Assisted by MB STKFO

ASST WC
(office/title)

Date: 11/01/24

DEC 26 2024

FEE SCHEDULE

KS DEPT OF AGRICULTURE

Make checks payable to the Kansas Department of Agriculture.

1. The fee for an application for a permit to appropriate water for beneficial use, except for domestic, waterpower, dewatering, or sediment control use, shall be (see No. 2 below if requesting storage):

| Million Gallons (mg) | Acre-Feet (AF) | Fee |
|----------------------|----------------|---|
| ≤ 32.585 | ≤ 100 | \$200.00 |
| 32.586 - 104.272 | 100.1 – 320.0 | \$300.00 |
| > 104.272 | > 320 | \$300.00 plus \$20 for each additional 100AF (32.586mg) or any part thereof |

2. The fee for an application in which **storage** of water is requested, except for domestic use, shall be:

| Million Gallons (mg) | Acre-Feet (AF) | Fee |
|----------------------|----------------|---|
| ≤ 81.462 | ≤ 249.9 | \$200.00 |
| ≥ 81.463 | ≥ 250 | \$200.00 plus \$20 for each additional 100AF (32.586mg) or any part thereof |

Note: If an application requests both direct use *and* storage, the fee charged shall be as determined under No. 1 or No. 2 above, whichever is greater, but not both fees.

3. The fee for an application for **waterpower** or **dewatering** use shall be \$100.00 plus \$200.00 for each 44,880 gallons per minute (100 c.f.s.), or part thereof, of the diversion rate requested.

IMPORTANT NOTICE

If this application is approved, the applicant shall notify the Chief Engineer when the diversion works (well, pump, reservoir, pit, etc.) has/have been completed via the *Notice of Completion of Diversion Works* form (DWR 1-203.11) and along with the statutorily required field inspection fee of:

- \$200.00 for sediment control use or groundwater pits for industrial use, or
- \$400.00 for all other uses made of water

Failure to complete the diversion works by the deadline specified in the *Approval of Application and Permit to Proceed* (or any subsequent extension of time of said deadline) and/or failure to submit the proper notice and field inspection fee will result in the dismissal of the appropriation and forfeiture of any priority associated with it.

For assistance with this application, please contact the Division of Water Resources (DWR).

Manhattan HQ
1320 Research Park Dr.
Manhattan, KS 66502
785-564-6638

Topeka Field Office
1131 SW Winding Rd, Ste 400
Topeka, KS 66615
785-296-5733

Stafford Field Office
300 S. Main St
Stafford, KS 67578
620-234-5311

Stockton Field Office
820 S. Walnut
Stockton, KS 67669
785-425-6787

Garden City Field Office
4532 W. Jones Ave, Ste B
Garden City, KS 67846
620-276-2901

Helpful Sources of Information

DWR Water Appropriation Program
DWR Water Appropriation Forms
KGS Water Well Completion Records
DWR Structures Program

<https://agriculture.ks.gov/divisions-programs/dwr/water-appropriation>
<https://agriculture.ks.gov/divisions-programs/dwr/water-appropriation/water-appropriation-forms>
<https://www.kgs.ku.edu/Magellan/WaterWell/index.html>
<https://agriculture.ks.gov/divisions-programs/dwr/dam-safety/permit-requirements>

DEC 26 2024

New Application - Surface Water

KS DEPT OF AGRICULTURE

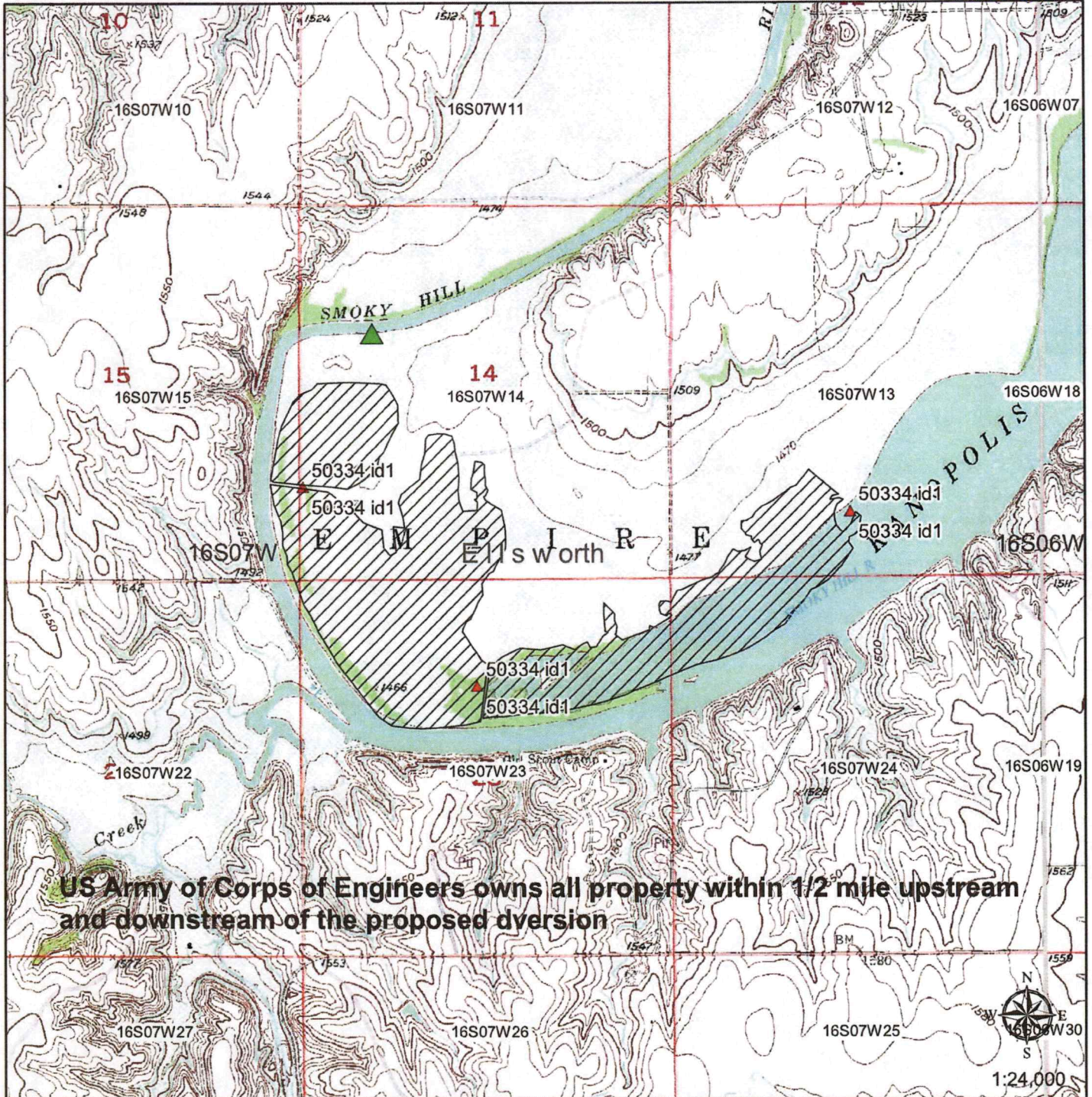

Signature Required

Sweet Thumann

By signing this I am stating that to the best of my knowledge that all landowners within 1/2 mile upstream and downstream of my property are identified on this map or listed on an attachment to this map.

- ▲ Surface Water Point of Diversion
- Groundwater Point of Diversion
- ▨ Proposed Place of Use
- ▲ Proposed Point(s) of Diversion

DEC 26 2024

**RECREATIONAL USE
SUPPLEMENTAL SHEET**

File No. _____

Name of Applicant (Please Print): KDWP

1. Please indicate type of recreational use (boating, fishing, swimming, etc.): MARSH
FOR WATERFOWL, WILDLIFE AND GENERAL RECREATION

2. Please summarize how the water will be used and justify the quantity of water requested: _____
NORTH STRUCTURE STORES 93.433 AF WITH 47.144 SURFACE ACRES
MIDDLE STRUCTURE STORES 273.219 AF WITH 181.321 SURFACE ACRES
EAST STRUCTURE STORES 227.381 AF WITH 132.779 SURFACE ACRES
TOTAL STORAGE = 594.033 AF TOTAL SURFACE AREA = 361.244 ACRES
594.033 AF STORAGE PLUS ONE YEAR EVAPORATION (2.25 AF/ACRE) = 1407 AF

3. Please complete the following table showing estimated future water requirements:

| ESTIMATED FUTURE WATER DIVERTED/STORED | |
|---|--|
| NEXT 5 YEARS | WATER TO BE DIVERTED (ACRE-FEET OR GALLONS) |
| Year 1 | 1407 |
| Year 2 | 1407 |
| Year 3 | 1407 |
| Year 4 | 1407 |
| Year 5 | 1407 |

Please attach any additional information, tables, or curves showing past, present and estimated future water requirements to substantiate the amount of water requested.

4. Please designate the legal description of the location where the water is to be used by providing the fractional part of the Section, Township and Range.

SEE FOLLOWING PAGE FOR ACRE DESCRIPTIONS AND ATTACHED DESIGN PLANS

** NOTE US ARMY CORPS OF ENGINEERS OWNS ALL LAND WITHIN 1/2 MILE UPSTREAM AND DOWNSTREAM OF THE PROPOSED POINTS OF DIVERSION

| S | T | R | NE¼ | | | | NW¼ | | | | SW¼ | | | | SE¼ | | | | TOTAL | | | | |
|----|-----|----|-----|----|----|-----|-----|----|-----|----|-----|----|----|----|-----|-----|------|-----|-------|--|--|-----|-----|
| | | | NE | NW | SW | SE | NE | NW | SW | SE | NE | NW | SW | SE | NE | NW | SW | SE | | | | | |
| 15 | 16S | 7W | | | | | | | | | | | | | | | | 7.5 | | | | 7.5 | 15 |
| 14 | 16S | 7W | | | | | | | | 3 | | | | 10 | 35 | 29 | 35 | | | | | 5 | 117 |
| 13 | 16S | 7W | | | | | | | | | | | 1 | | | 6.5 | 31.5 | | | | | | 39 |
| 23 | 16S | 7W | 18 | 9 | 17 | 8.5 | 35 | 33 | 6.5 | 22 | | | | | | | | | | | | | 149 |
| 24 | 16S | 7W | | | | | 9 | 33 | | | | | | | | | | | | | | | 42 |

You may attach any additional information you believe will assist in informing the Division of the need for your request.

WATER RESOURCES
RECEIVED

DEC 26 2024

KS DEPT OF AGRICULTURE

1320 Research Park Drive
Manhattan, KS 66502
785-564-6700
www. agriculture.ks.gov



900 SW Jackson, Room 456
Topeka, KS 66612
785-296-3556

Mike Beam, Secretary

Laura Kelly, Governor

January 14, 2025

KANSAS DEPARTMENT OF WILDLIFE PARKS & TOURISM
1020 S KANSAS AVE FL2
TOPEKA KS 66612-1389

RE: Application, File No(s). **51387**

Dear Sir or Madam:

The Division of Water Resources (Division) has received your application(s) for a permit to appropriate water for beneficial use. Your application(s) has been assigned the file number(s) referenced above. Please be aware that the Division may have a large number of pending applications on hand at times and makes every attempt to process them in the order in which they are received. You will be contacted if additional information is required.

Please note, this letter only acknowledges receipt of your application(s) and does not guarantee approval. In accordance with the provisions of the Kansas Water Appropriation Act, the use of water as proposed prior to approval of the application(s) is unlawful.

Additional information about the process may be found on our website at agriculture.ks.gov/divisions-programs/dwr. If you have any other questions, please contact our office at 785-564-6640 or your local Stockton Field Office at 785-425-6787. If you call, please reference the file number so we can help you more efficiently.

Sincerely,

Kris Neuhauser
New Applications Lead
Water Appropriation Program